

# windham

## accent cabinet with drawer

style # WNCBDW2DBK (black)  
dpci # 249-16-0022

style # WNCBDW2DRD (red)  
dpci # 249-16-0023

style # WNCBDW2DBL (teal)  
dpci # 249-16-0021

style # WNCBDW2DGY (grey)  
dpci # 249-16-0026

style # WNCBDW2DWH (shell)  
dpci # 249-16-0013

style # WNCBDW2DYL (yellow)  
dpci # 249-16-0029

style # WNCBDW2DGG (green garnish)  
dpci # 249-16-4302

style # WNCBDW2DOV (overcast)  
dpci # 249-16-4306

style # WNCBDW2DBN (banana split)  
dpci # 249-16-4315

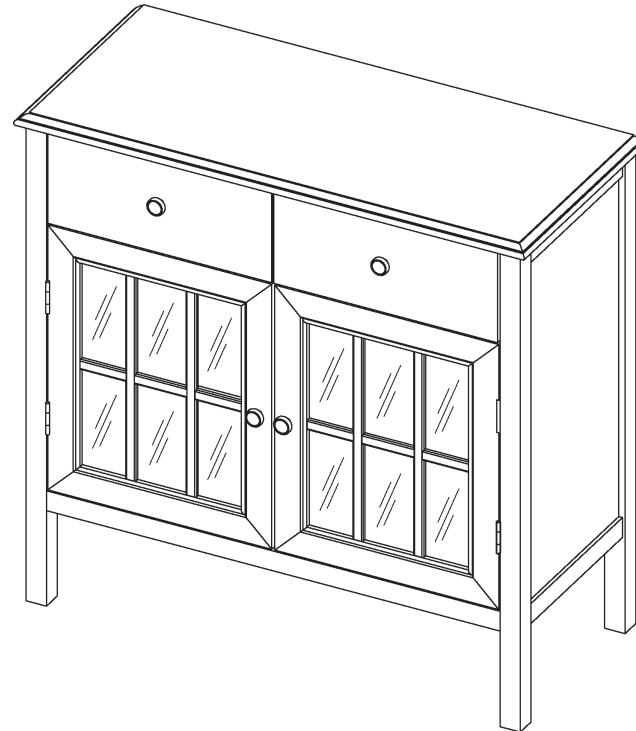

>> assembly instructions



Congratulations on your latest Target purchase.

Now what? Don't start sweating over this box of parts. This will be easy. We did the hard work for you. All you need to do is follow our simple instructions and you'll be on your way to transforming your room in no time. Good luck—though we're confident you won't need it.

## before you begin

1. Check for damaged or missing parts. Call 1-855-MYTGTHOME (855-698-4846) to order missing supplies.
2. Use the carton as a working surface to prevent product damage during assembly.
3. Gather all tools prior to assembly.

## tools needed

---

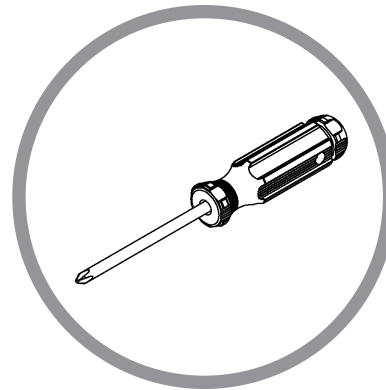
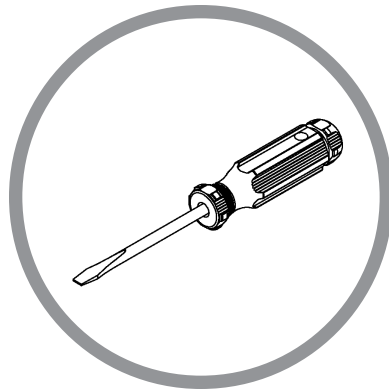
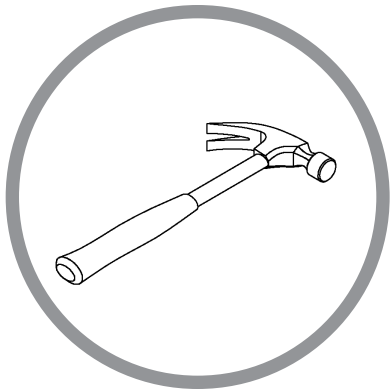

# table of contents

introduction	2
hardware	4-5
parts list	6
how to use the cam lock system	7
assembly	8-17
how to adjust door alignment	18

# hardware

---

(H1) x 16  
wooden dowel

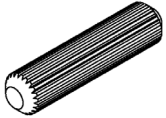

(H2) x 6  
cam bolt

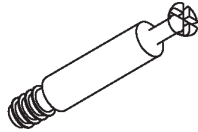

(H3) x 6  
cam

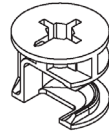

(H4) x 4  
bolt

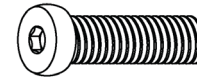

(H5) x 6  
washer



(H6) x 4  
lock washer

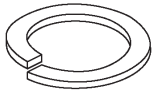

(H7) x 1  
allen wrench

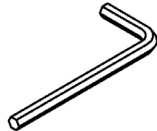

(H8) x 19  
5/8" pan-head screw

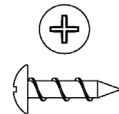

(H9) x 4  
knob

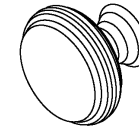

(H10) x 4  
knob bolt



(H11) x 8  
short flat-head screw

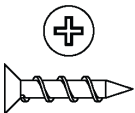

(H12) x 4  
shelf supports

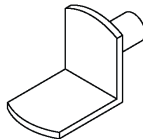

(H13) x 2  
small cam bolt

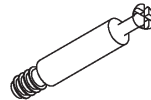

(H14) x 2  
small cam



(H15) x 8  
long flat-head screw

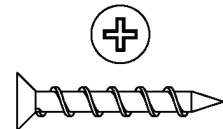

# hardware

---

(H16) x 1  
wall anchor

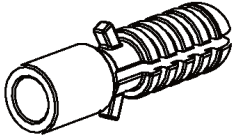

(H17) x 1  
38mm wall screw

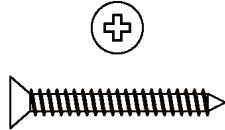

(H18) x 1  
wall strap



(H19) x 1  
19mm pan-head screw

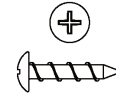

# exploded diagram

ITEM	DESCRIPTION	QUANTITY
1	top panel	1
2	left side panel	1
3	right side panel	1
4	bottom panel	1
5	adjustable shelf	1
6	left door	1
7	right door	1
8	back panel	1
9	trim	1
10	drawer front	1
11	left drawer side	1
12	right drawer side	1
13	drawer back	1
14	drawer panel	1
15	drawer rail	1

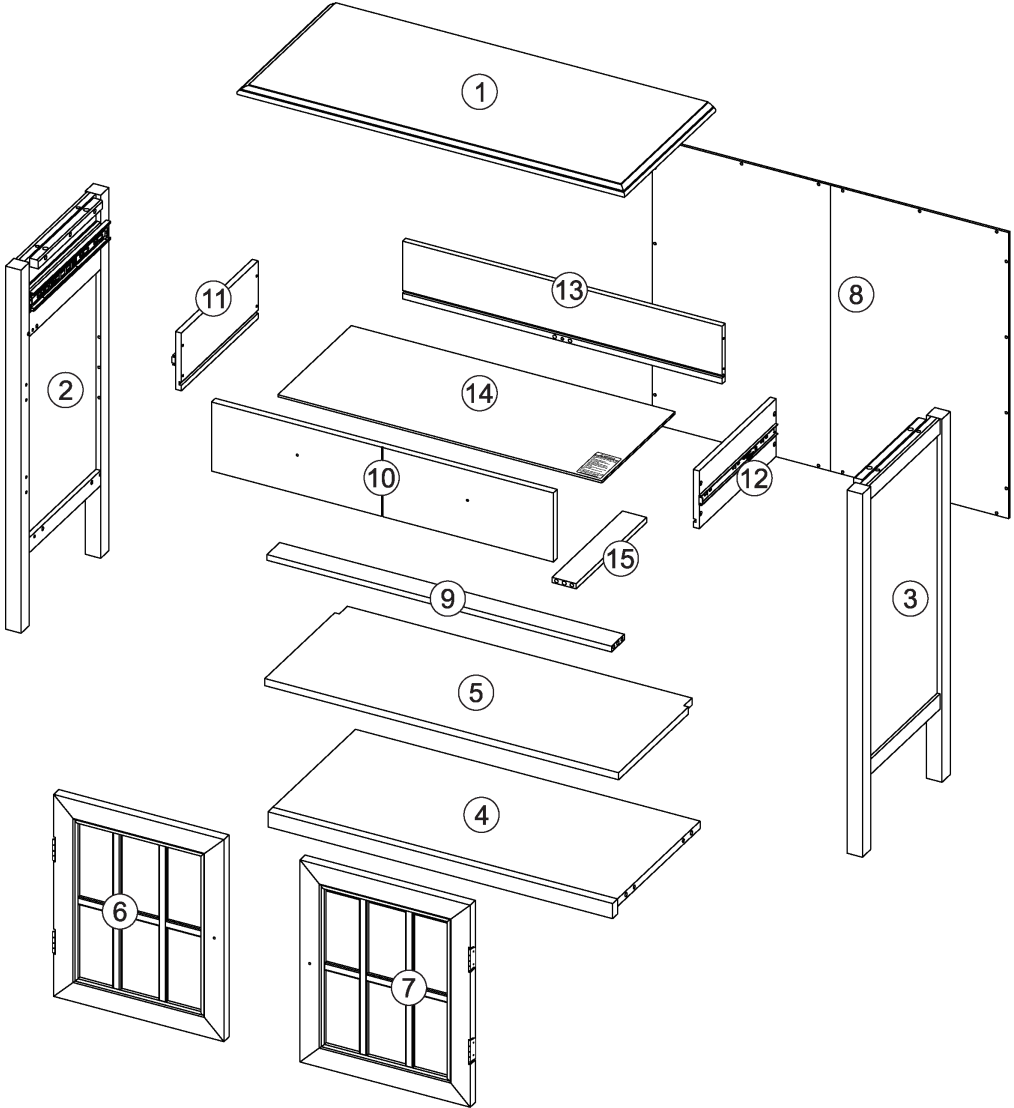

# how to use the cam lock system

---

1.

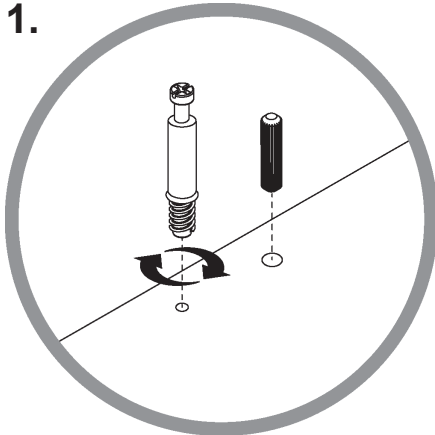

Screw cam bolt into panel

2.

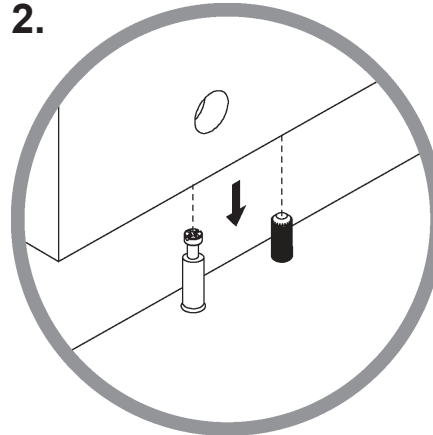

Align cam bolt(s) with cross-bored hole(s) and insert all the way until panels are flush

3.

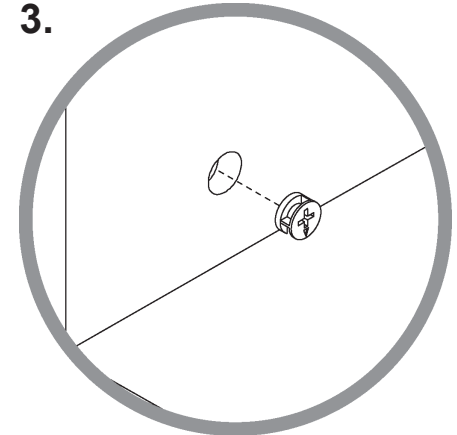

Push cam into panel - arrow feature on cam top points to panel edge

4.

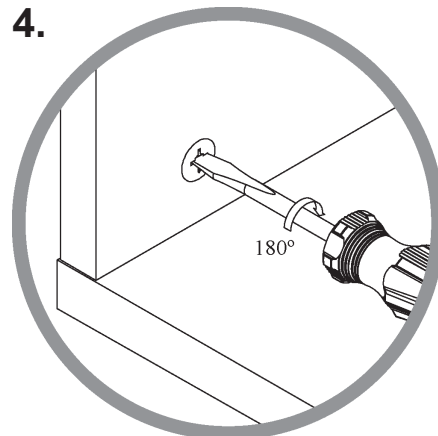

Rotate cam(s) clockwise 180° to lock panels together

5.

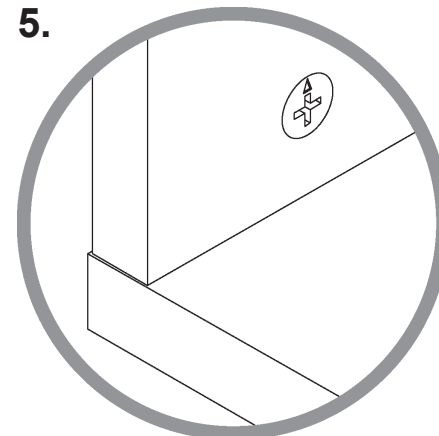

Panels should be tight against each other and connection should be rigid

## step 1: attach trim and bottom panel to left side panel

---

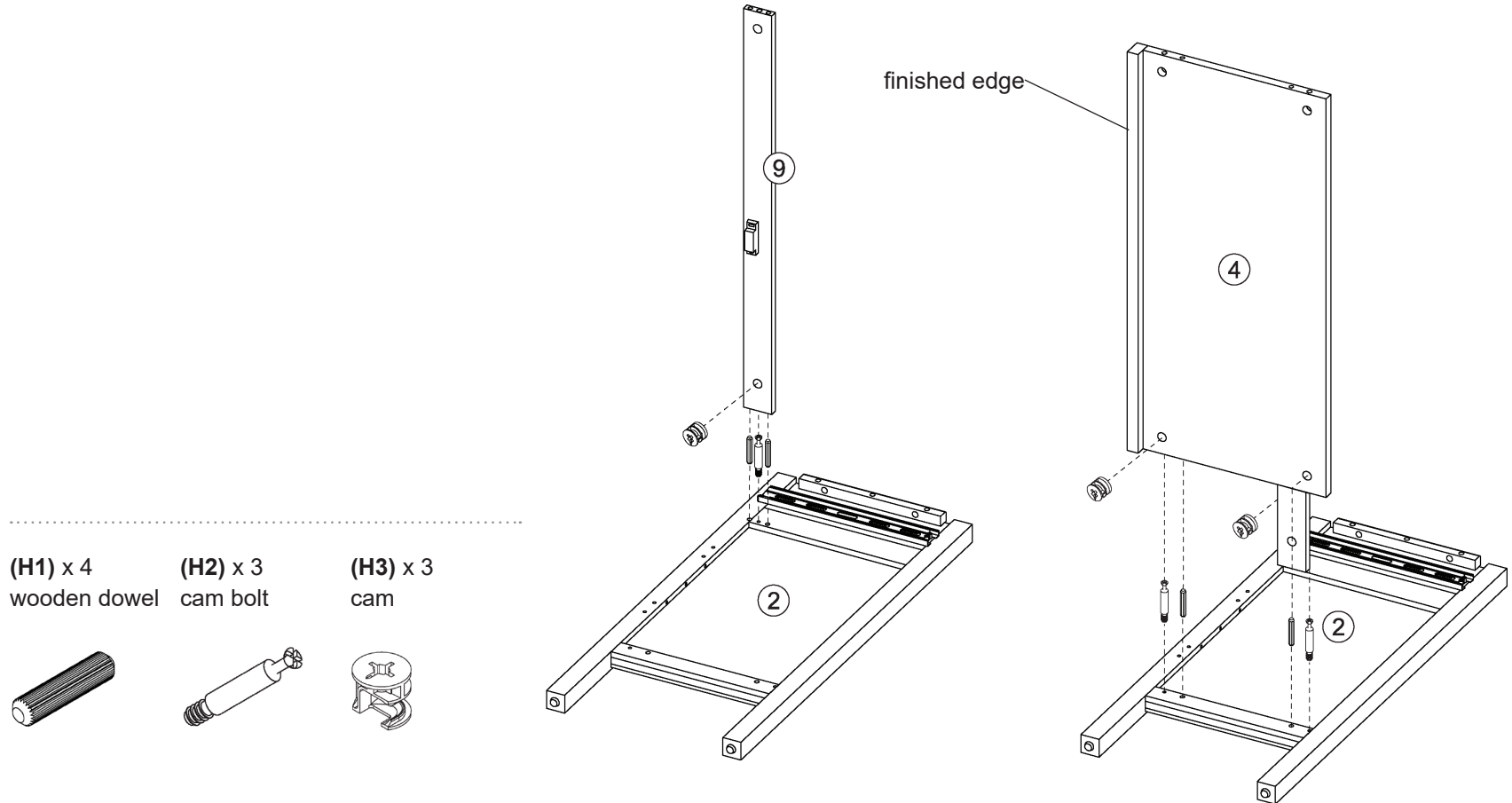

- 1.1. Carefully tap small wooden dowels into place in left side panel. Leave 1/2" of the dowels sticking out.
- 1.2. Screw-In cam bolts must be screwed down flush in left side panel.
- 1.3. Refer to page 7 for instructions on how to use the cam lock system. Do not over tighten bolts.



## step 2: attach right side panel

---

**(H1) x 4**  
wooden dowel

**(H2) x 3**  
cam bolt

**(H3) x 3**  
cam

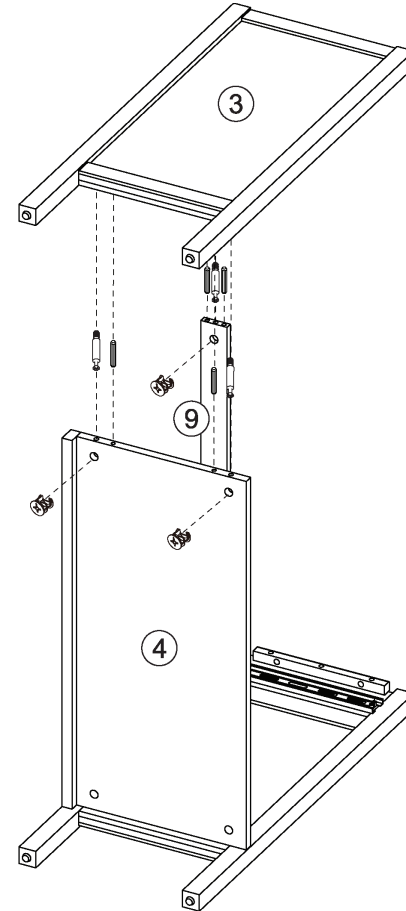
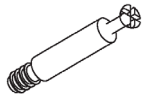
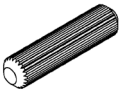

- 2.1. Carefully tap small wooden dowels into place in right side panel. Leave 1/2" of the dowels sticking out.
- 2.2. Screw-In cam bolts must be screwed down flush in right side panel.
- 2.3. Refer to page 7 for instructions on how to use the cam lock system. Do not over tighten bolts.

## step 3: attach top panel

---

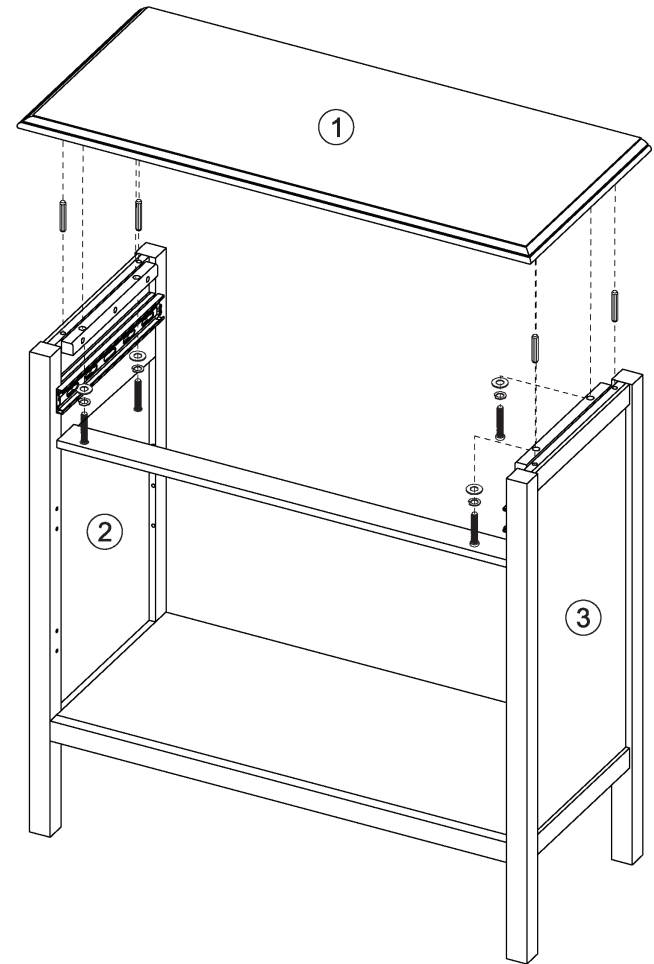
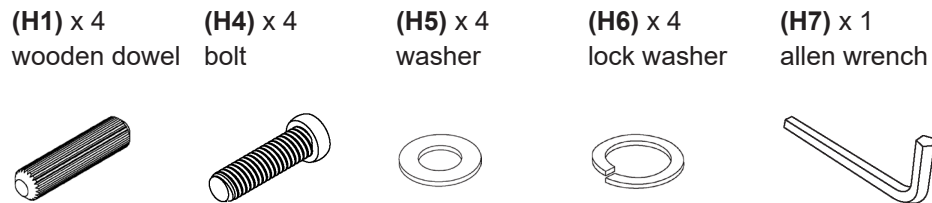

3.1. Carefully tap small wooden dowels into place in top panel. Leave 1/2" of the dowels sticking out.

3.2. Align bolts with pre-drilled holes to attach side panels to top panel. Do not over tighten bolt.

## step 4: attach back panel

**\*\*FAILURE TO FOLLOW ALL DIRECTIONS ON THIS PAGE MAY RESULT IN UNEVEN DOOR ALIGNMENT\*\***

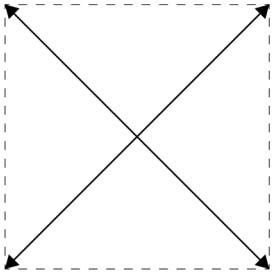

Begin by installing all of the screws along one edge of the back panel. Next, using a square or tape measure, make sure that the cabinet is square. (If using a tape measure, the distance from one corner, diagonally to the other corner should be the same in both directions.) If not, apply gentle pressure to the diagonally opposite corners to shift case into alignment. Re-measure to ensure equal distances. Install the remaining screws, starting with the corners.

**(H8) x 19**  
5/8" pan-head  
screw

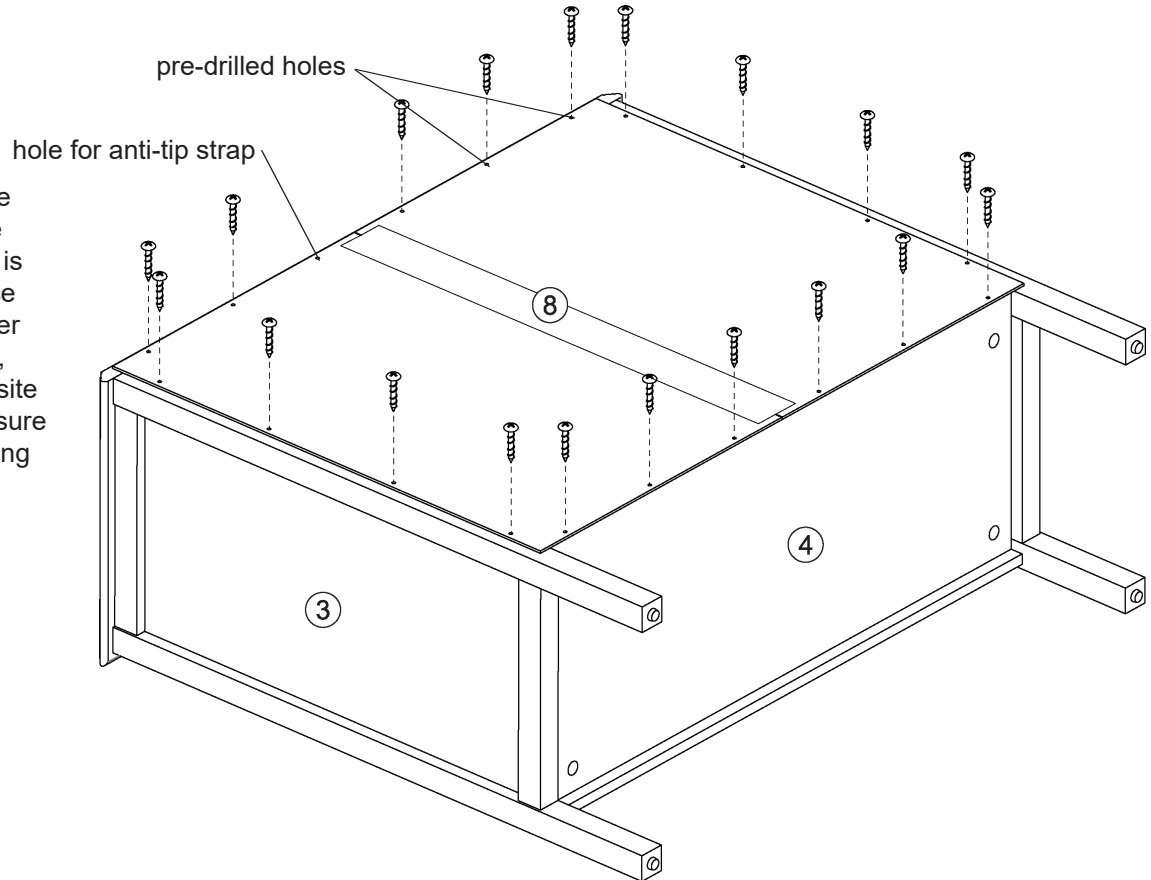

4.1. Make sure the pan-head screws go through the pre-drilled holes properly to attach back panel. Do not over tighten screws.

## step 5: attach knobs to doors

---

(H9) x 2  
knob



(H10) x 2  
knob bolt

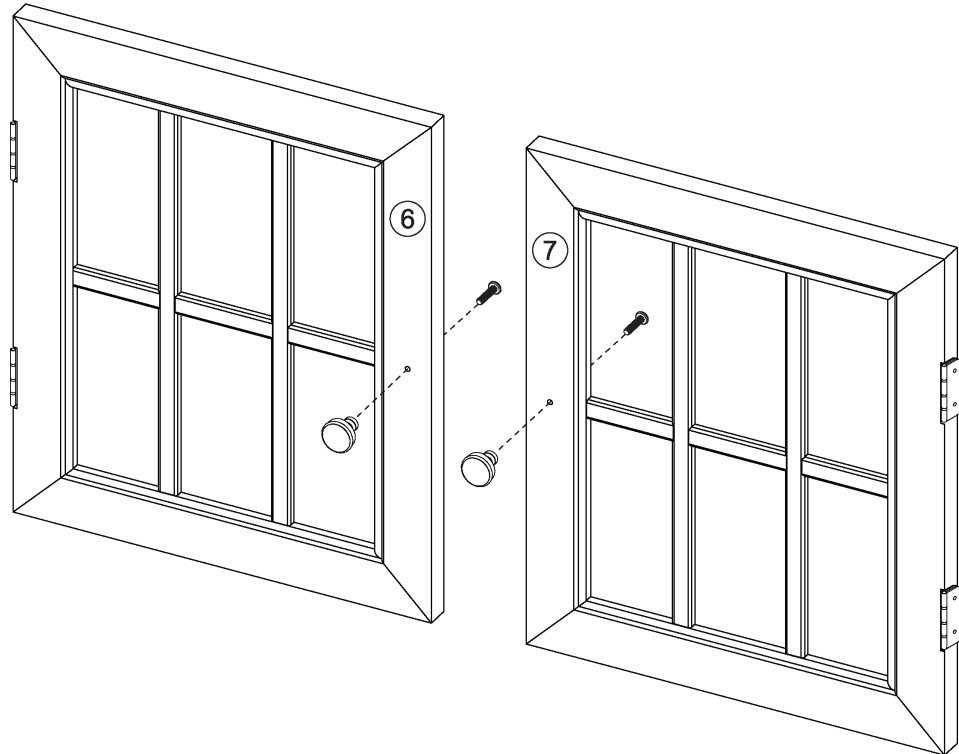

5.1 Align knob bolts with pre-drilled holes to attach knobs to doors. Do not over tighten bolts.

## step 6: attach doors to cabinet

---

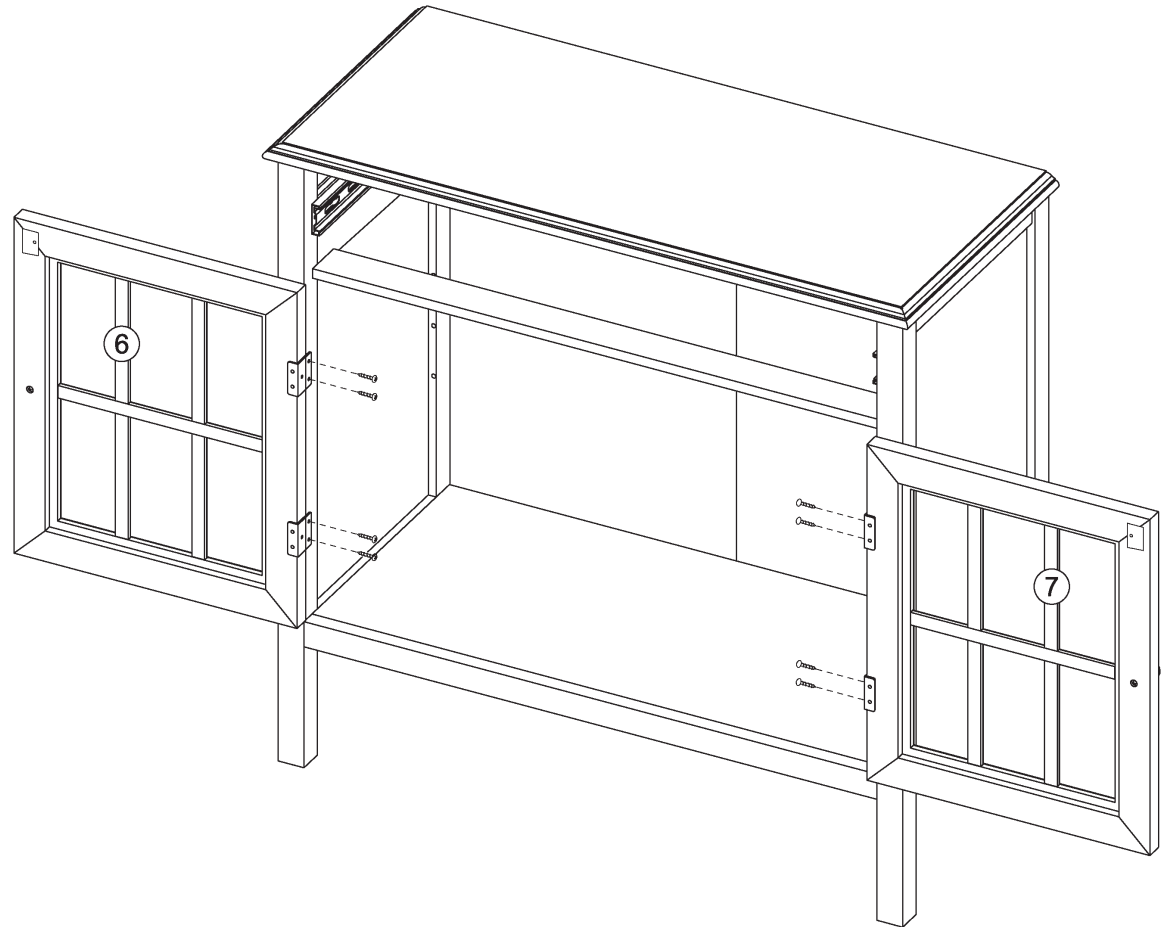

(H11) x 8  
short flat-head  
screw

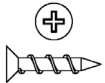

6.1 Align flat-head screws with pre-drilled holes to attach doors to cabinet. Do not over tighten screws.

## step 7: install adjustable shelves

---

(H12) x 4  
shelf supports

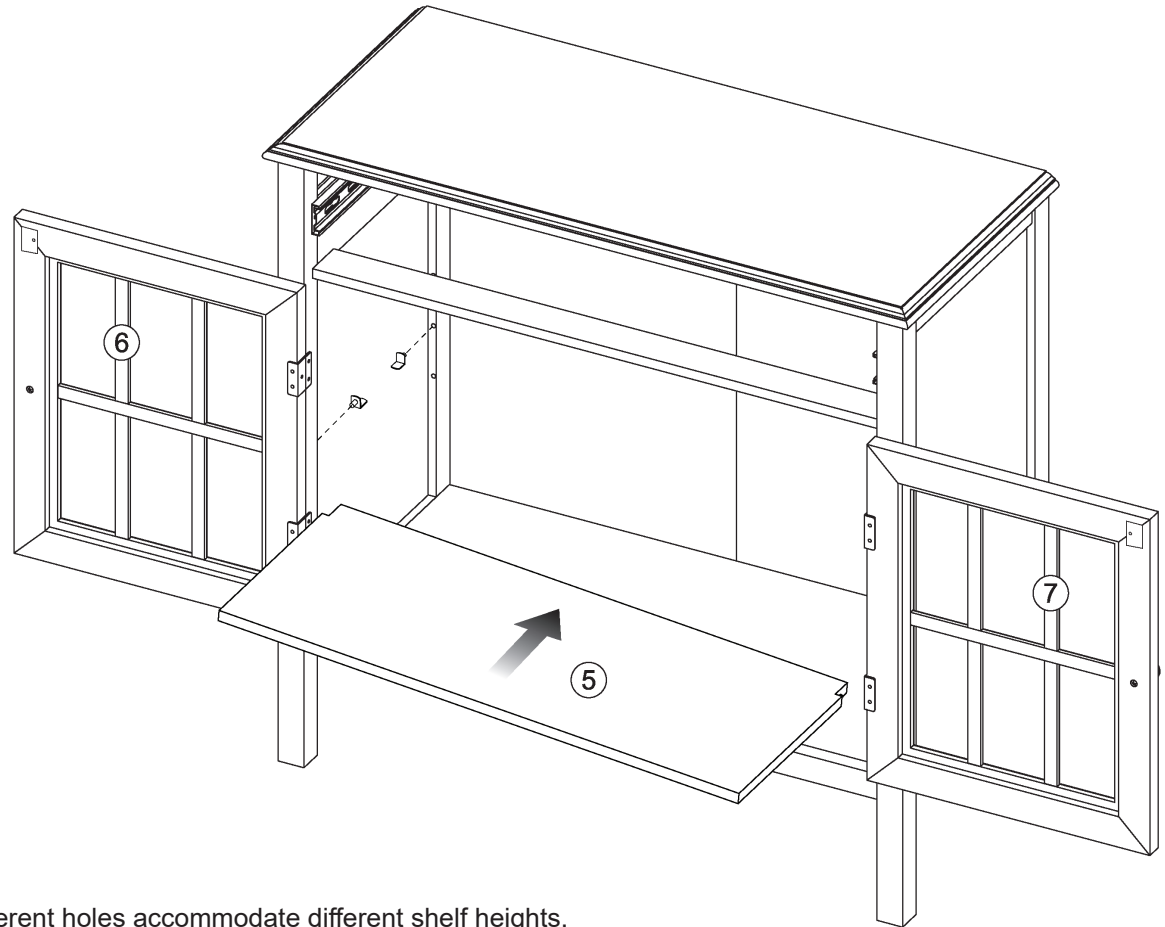
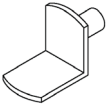

7.1. Insert shelf supports into desired hole. Different holes accommodate different shelf heights.

7.2. Angle shelf to fit between the rails and set on top of shelf supports.

## step 8: assemble drawer box

---

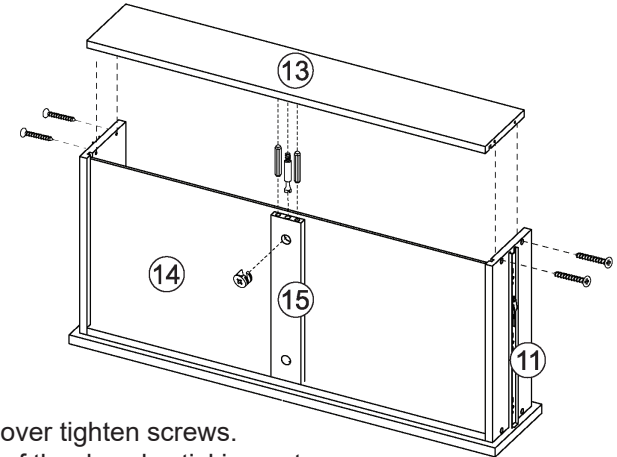
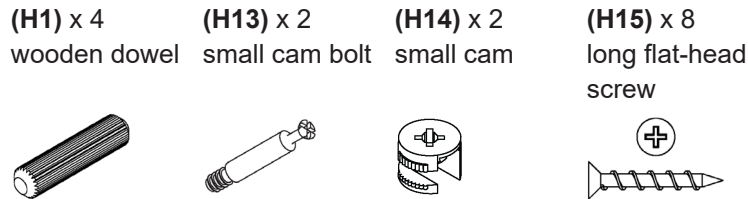
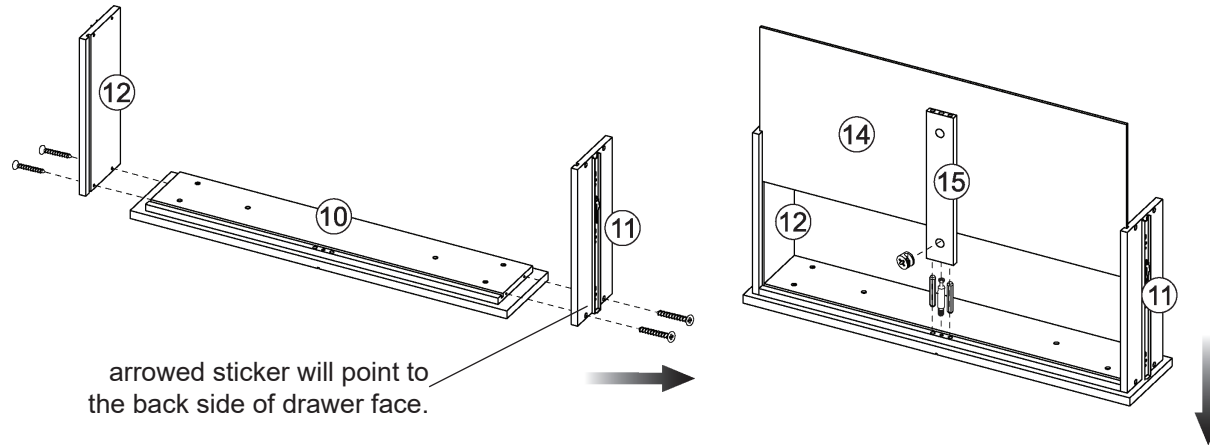

- 8.1. Align flat-head screws with pre-drilled holes to attach drawer sides to drawer front. Do not over tighten screws.
- 8.2. Carefully tap small wooden dowels into place in drawer front and drawer back. Leave 1/2" of the dowels sticking out.
- 8.3. Screw-In cam bolts must be screwed down flush in drawer front and drawer back.
- 8.4. Refer to page 7 for instructions on how to use the cam lock system. Do not over tighten bolts.
- 8.5. Align flat-head screws with pre-drilled holes to attach drawer back. Do not over tighten screws.

## step 9: install drawer and knob

---

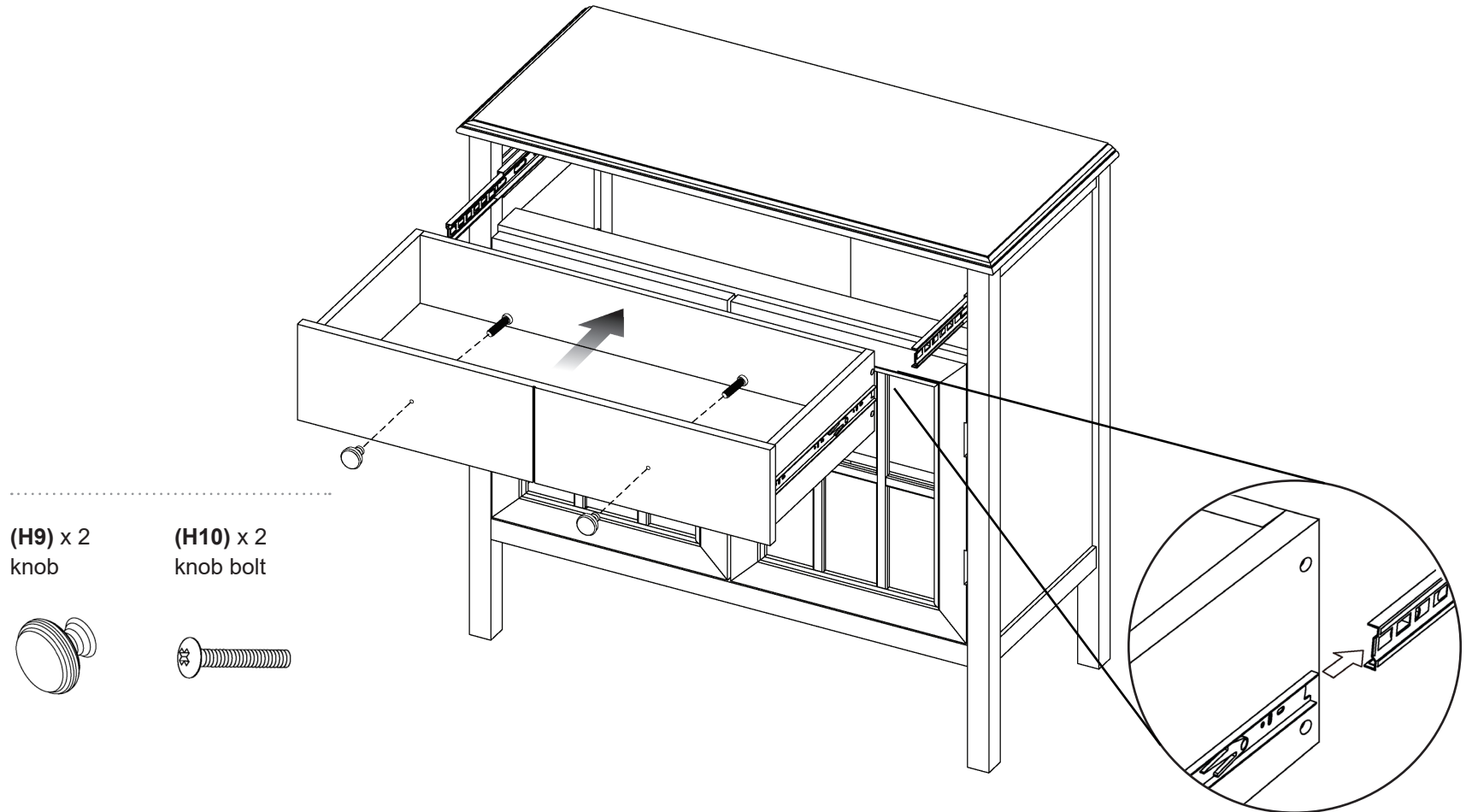

9.1 Align knob bolts with pre-drilled holes to attach knobs to drawer. Do not over tighten bolts.

9.2 Align tracks on drawer box with tracks on left side panel and right side panel.



## step 10: install anti-tip kit

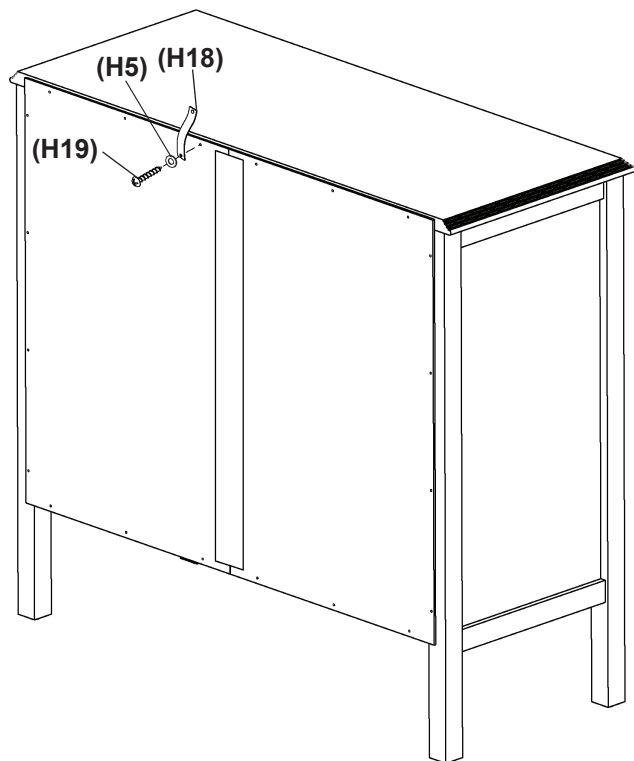

Position against wall

Mark position of strap hole on wall

Drill 1/4" hole

Tap in wall anchor

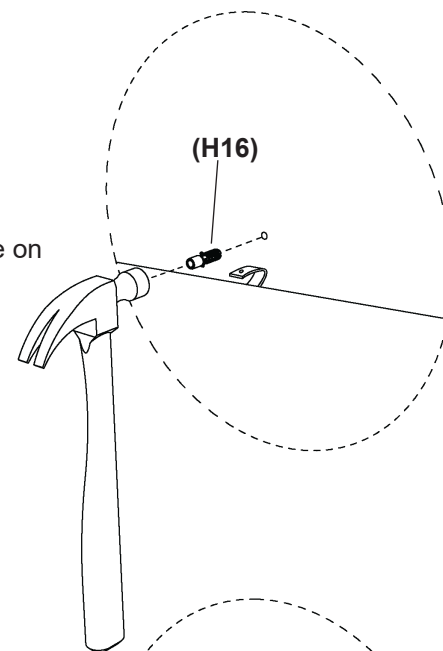

Fasten anti-tip strap with flat-head screw provided

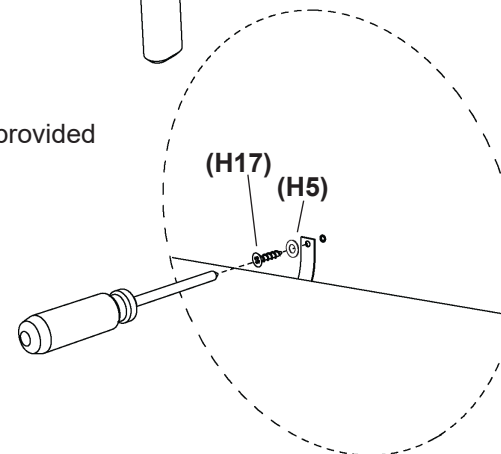

(H16) x 1  
wall anchor

(H17) x 1  
38mm wall screw

(H18) x 1  
wall strap

(H5) x 2  
washer

(H19) x 1  
19mm pan-head screw

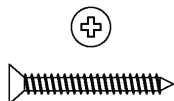
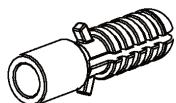

# how to adjust door alignment

---

## Tips for proper door alignment:

- Adjustable levelers will reduce minor door mis-alignments caused by an uneven floor.
- Use a level to determine if the cabinet top is level. If not, start with the levelers retracted and adjust them as needed. To retract the levelers turn them counterclockwise. To extend the levelers turn them clockwise.
- If door mis-alignment persists, refer back to Step 4 (pg. 11) for additional information. If the cabinet is not square you will need to repeat this step.

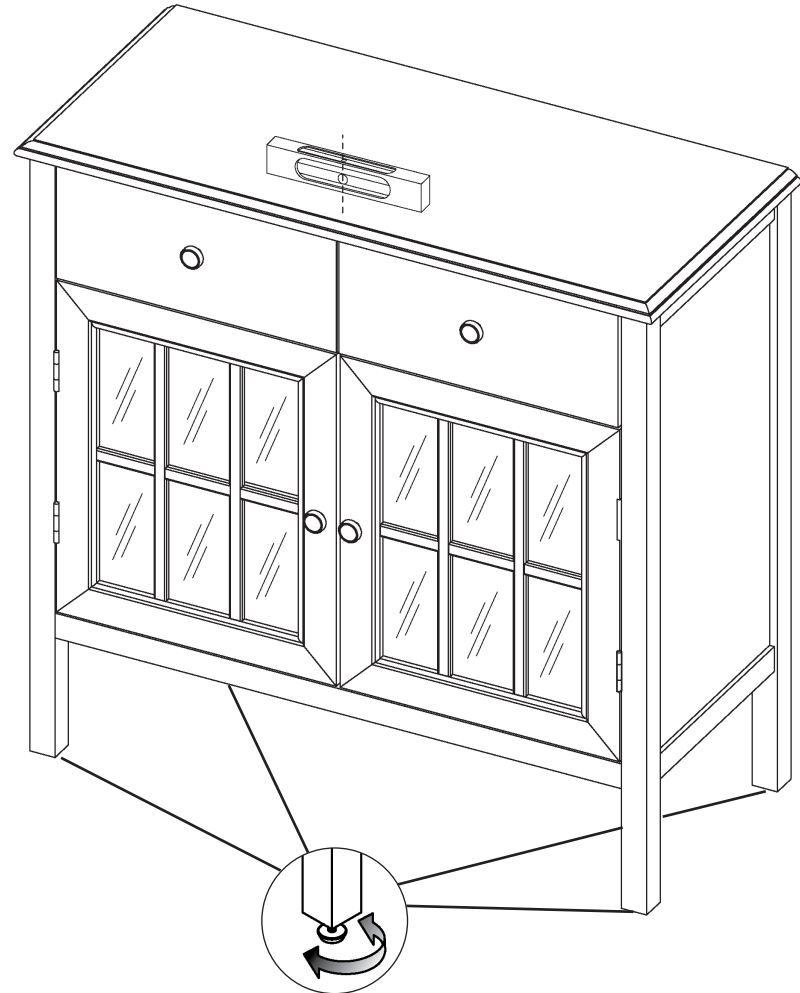

adjustable leg levelers

<b>⚠ WARNING</b>	
	<b>Serious or fatal crushing injuries can occur from furniture tip-over. To help prevent tip-over:</b>
	<ul style="list-style-type: none"><li>• Install tip-over restraint provided.</li><li>• Place heaviest items in the lowest drawers.</li><li>• Do not set TV's or other heavy objects on top of this product, unless the product is specifically designed to accommodate them.</li><li>• Never allow children to climb or hang on drawers, doors, or shelves.</li><li>• Never open more than one drawer at a time.</li></ul>
	<p><b>(OR)</b></p> <ul style="list-style-type: none"><li>• Do not defeat or remove the drawer interlock system.</li></ul> <p><b>Use of tip-over restraints may only reduce, but not eliminate, the risk of tip-over.</b></p> <p><i>This is a permanent label. Do not remove.</i></p>

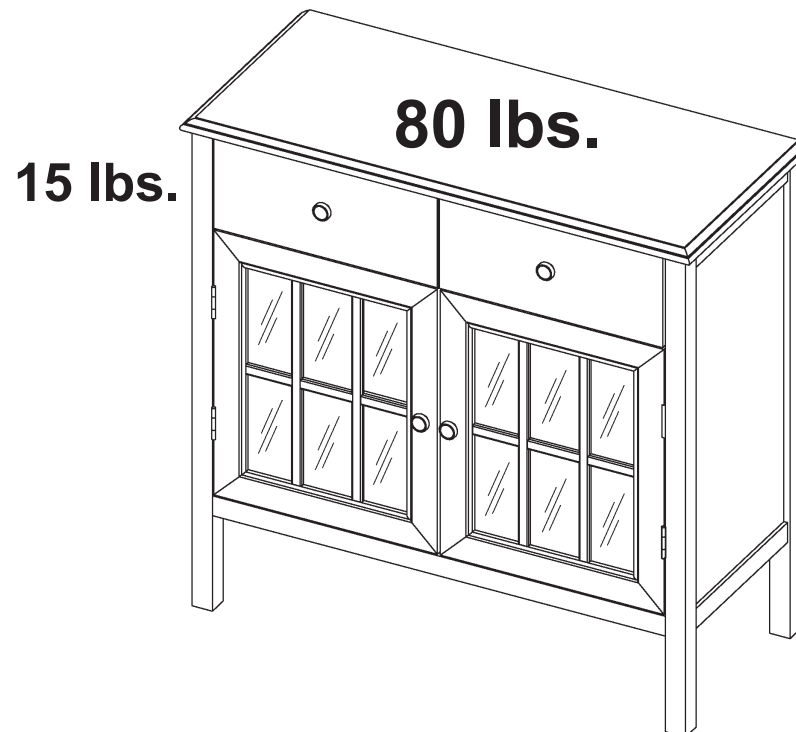

1. This unit has been designed for the weight shown. Exceeding this recommended weight could result in excessive “sagging” of the top. Extreme overloading can cause failure of the top and possible injury.
2. Furniture Care Instructions: Dust with a clean, lint-free cloth. Use a spray furniture polish as needed.

