



SEW
EURODRIVE

Revision



Synchronous Servomotors

CMP40 – CMP100

CMPZ71 – CMPZ100



Revision

Measuring the working air gap of the BY brake

1 Revision



INFORMATION

This revision describes amendments made to the operating instructions "Synchronous Servomotors CMP40 – 100, CMPZ71 – 100" (part number 16907213/EN, edition 07/2010). The following chapters are amended:

- Chapter 7.2: "Notes on the BY brake", page 67

Please use the data and descriptions made in this chapter. This document does not replace the above mentioned operating instructions.

1.1 *Measuring the working air gap of the BY brake*



INFORMATION

Customers can check the working air gap for inspection purposes.

The working air gap can be measured via the stroke of the pressure plate when the brake is released. The permitted working air gap for brake sizes BY2, BY4 and BY8 is 0.15 – 0.6 mm. If the working air gap exceeds 0.6 mm, the brake will have to be replaced.

The working air gap cannot be adjusted.



1.1.1 Brake with manual brake release

1. Isolate the motor and brake from the power supply and safeguard them against unintentional power-up.
2. Remove the forced cooling fan, if installed.
3. Connect the brake to the power supply.
4. Release and apply the brake electrically. When doing so, measure the stroke ΔH of the pressure plate at the studs. This stroke ΔH corresponds to the working air gap.

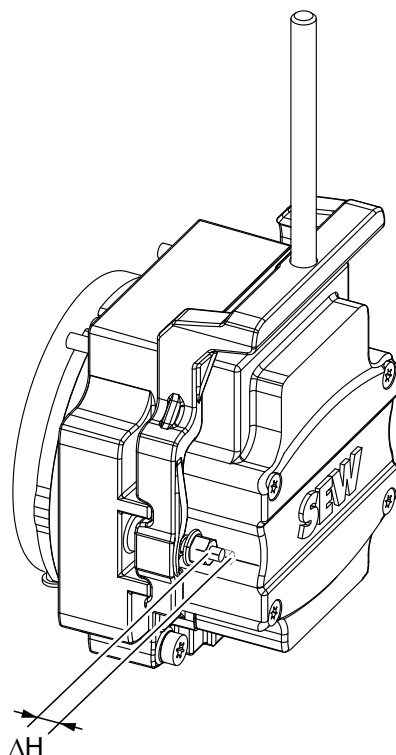

4386101131



Revision

Measuring the working air gap of the BY brake

1.1.2 Brake without manual brake release

1. Isolate the motor and brake from the supply and safeguard them against unintentional power-up.
2. Remove the forced cooling fan, if installed.
3. Remove the closing caps [1] from the two boreholes.
4. Insert one screw each into the boreholes.

SEW-EURODRIVE recommends the following screws:

Brake sizes	Screw size	Part number
BY2, BY4	M5x75	1328 145 3
BY8	M6x70	0011 834 6

5. Connect the brake to the power supply.
6. Release and apply the brake electrically. When doing so, measure the stroke ΔH of the pressure plate at the studs. This stroke ΔH corresponds to the working air gap.
7. Remove the two screws when you have finished measuring the working air gap.
8. Close the two boreholes with new closing caps [1].

The following table shows the part numbers for the replacement closing caps:

Brake sizes	Part number
BY2, BY4	1328 148 8
BY8	1322 534 0

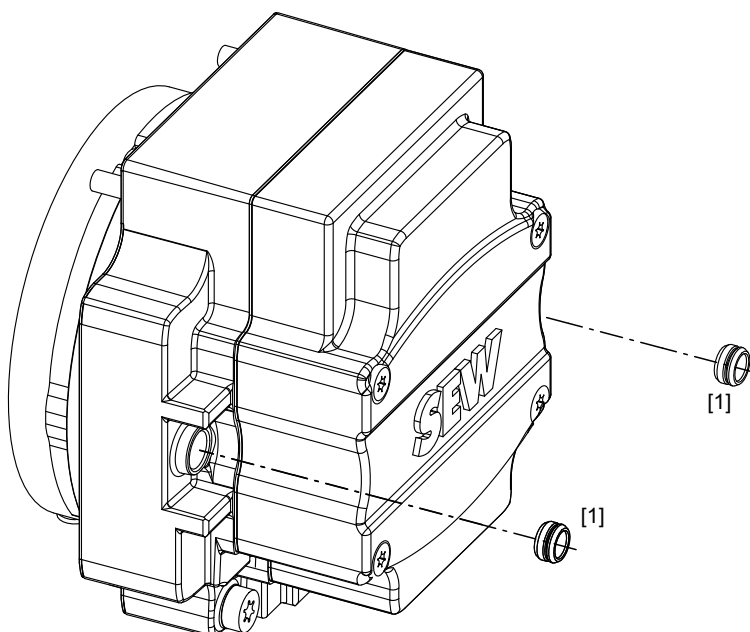

4386103563