

## Overview

This guide pertains to the DXL-TX-4K60 DXLite 4K60 Transmitter (**FG1010-311**). The purpose of this document is to illustrate how the device is to be installed and set up in its simplest configuration by a trained technician.

## What's in the Box?

The following items are included with the DXL-TX-4K60:

- [1] 3-pin Phoenix Male Connector (3.5 mm, 3 pins)
- [1] 2-pin Phoenix Male Connector (3.5 mm, 2 pins)
- [1] Broadband IR Receiver(30-50KHz)
- [1] Power Adapter (DC 12V 2A) with lock-ring plug
- [1] US exchangeable Wall Plug adapters
- [1] EU exchangeable Wall Plug adapters
- [1] UK exchangeable Wall Plug adapters
- [1] AU exchangeable Wall Plug adapters
- [2] Mounting ears
- [4] Mounting screws

## Power

Active power requirements:

- Voltage, DC (typical): 12VDC
- Power consumption (max): 5.8W

## Environmental Requirements

The environmental requirements for the DXL-TX-4K60 are as follows:

- **Operating Temperature:** 32° F (0° C) to 122° F (50° C)
- **Storage Temperature:** 14° F (-10° C) to 140° F (60° C)
- **Operating Humidity:** 10% to 90% RH (non-condensing)
- **Storage Humidity:** 10% to 90% RH (non-condensing)

## Installation

### Connections

1. Attach a HDMI cable from your video source to the HDMI IN port on the DXL-TX-4K60. This video source can be a Blu-ray player, game console, Satellite/cable box, a media server or any HDMI video output.
2. Attach the IR Receiver to the DXL-TX-4K60 IR Input port (if required).
3. If required, connect a IR Emitter (supplied by others) to the IR TX port.
4. If you want connect a USB Host device to the unit connect it to the USB Host Port and set the USB Host switch on the DXL-TX-4K60's front panel to the Host position.
5. If you want to use the DXL-TX-4K60 to output USB from a Host on a HDBT receiver, then connect USB devices to the DXL-TX-4K60 and place the front panel switch to the USB Device position.
6. Connect a RS-232 cable to the RS-232 port if you want to pass RS-232 control through the HDBT path to a device on the far end.
7. If the HDBT receiving device can supply power over HDBT then there is no need to attach the power supply to the unit. If the unit does not power up when the HDBT cable is connected use the external power supply supplied with the DXL-TX-4K60. To do this, attach the correct AC Plug adapter and plug the connector into the DXL-TX-4K60 and plug power supply into the wall.
8. Make sure all devices are powered on.

## Attaching Installation Brackets

To attach the installation brackets:

1. Attach the installation bracket to the enclosure using the screws that were provided in the package separately.
2. The bracket is attached to the enclosure as shown.
3. Repeat steps 1-2 for the other side of the unit.
4. Attach the brackets to the surface you want to hold the unit against using the screws (provided by others).

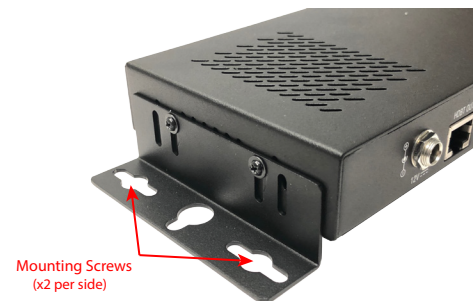

## Additional Documentation

Additional documentation for this device is available at [www.amx.com](http://www.amx.com). Refer to the AMX DXL-TX-4K60 DXLite 4K60 Transmitter Instruction Manual for additional details on installing, upgrading, and controlling the DXLite 4K60 Transmitter.