

Model: ASUS\_Z008D (ZE550ML),  
ASUS\_Z00AD (ZE551ML)

Before you start, ensure that you have read all the safety information and operating instructions in this **User Guide** to prevent injury or damage to your device.

**NOTE:** For the latest updates and more detailed information, please visit [www.asus.com](http://www.asus.com).

### Front features

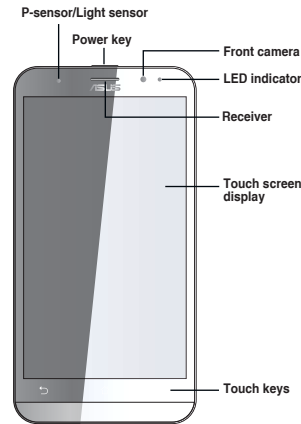

### Side features

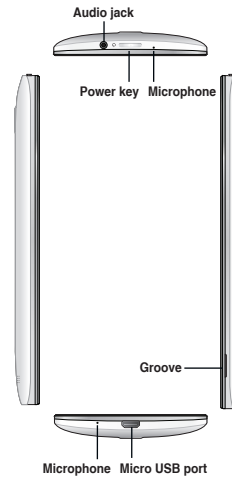

**NOTE:** Pry open the rear cover from the groove.

### Rear features

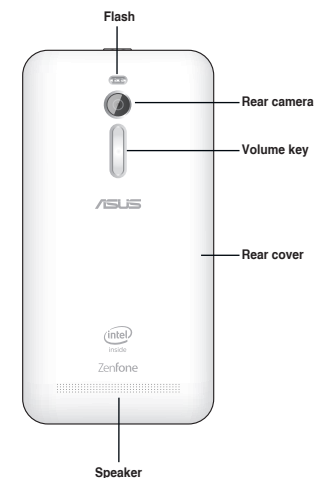

#### NOTES:

- Remove the rear cover to display the dual micro SIM and microSD card slots.
- The micro SIM card slots support WCDMA, DC-HSPA, GSM/EDGE, and FDD-LTE network bands.
- The microSD card slot supports microSD and microSDHC card formats.

### Charging your ASUS Phone

**To charge your ASUS Phone:**

- Connect the USB connector into the power adapter's USB port.
- Connect the other end of the micro USB cable to your ASUS Phone.
- Plug the power adapter into a wall socket.

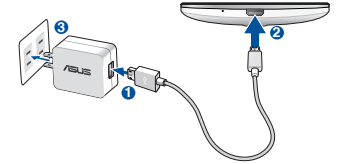

#### IMPORTANT!

- When using your ASUS Phone while it is plugged to a power outlet, the grounded power outlet must be near to the unit and easily accessible.
- When charging your ASUS Phone through your computer, ensure that you plug the micro USB cable to your computer's USB 2.0 / USB 3.0 port.
- Avoid charging your ASUS Phone in an environment with ambient temperature of above 35°C (95°F).

#### NOTES:

- Use only the power adapter that came with your device. Using a different power adapter may damage your device.
- Using the bundled power adapter and ASUS Phone signal cable to connect your ASUS Phone to a power outlet is the best way to charge your ASUS Phone.
- The input voltage range between the wall outlet and this adapter is AC 100V - 240V. The output voltage of the micro USB cable is +9V=2A, 18W / +5.2V=1.35A, 7W.

# ASUS Phone IN SEARCH OF INCREDIBLE

User Guide



E10273

### Installing a micro SIM card

**To install a micro SIM card:**

- Locate the groove on the bottom-right corner of your ASUS Phone.

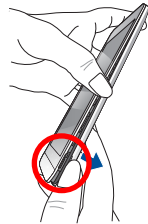

- Pry the cover loose and then pull the rear cover off.

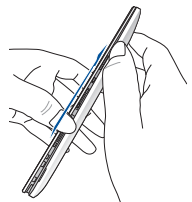

- Insert the micro SIM card into one of the slots.

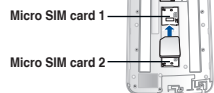

### Installing a microSD card

**To install a microSD card:**

- Locate the groove on the bottom-right corner of your ASUS Phone.

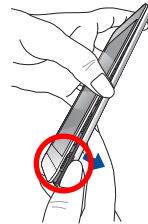

- Pry the cover loose and then pull the rear cover off.

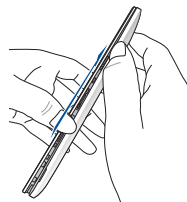

- Insert the microSD card into the microSD card slot.



**IMPORTANT:** Use only a micro SIM card on your ASUS Phone. A trimmed SIM card may not properly fit into and may not be detected by your ASUS Phone.

**CAUTION:** Do not use sharp tools or solvent on your device to avoid scratches on it.

### Turning your ASUS Phone on or off

Press the power key at the top of your ASUS Phone to power the device on or to power it off.

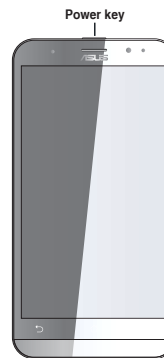

**IMPORTANT:** The first time you power on your ASUS Phone, you will see the Welcome screen. Touch the menu to select your preferred language then touch **Next Step**. Follow the onscreen instructions to set up your ASUS Phone.

### FCC Regulations:

This device complies with part 15 of the FCC Rules. Operation is subject to the following two conditions: (1) This device may not cause harmful interference, and (2) this device must accept any interference received, including interference that may cause undesired operation.

Changes or modifications not expressly approved by the party responsible for compliance could void the user's authority to operate the equipment.

This equipment has been tested and found to comply with the limits for a Class B digital device, pursuant to part 15 of the FCC Rules. These limits are designed to provide reasonable protection against harmful interference in a residential installation. This equipment generates, uses and can radiate radio frequency energy and, if not installed and used in accordance with the instructions, may cause harmful interference to radio communications. However, there is no guarantee that interference will not occur in a particular installation. If this equipment does cause harmful interference to radio or television reception, which can be determined by turning the equipment off and on, the user is encouraged to try to correct the interference by one or more of the following measures:

- Reorient or relocate the receiving antenna.
- Increase the separation between the equipment and receiver.
- Connect the equipment into an outlet on a circuit different from that to which the receiver is connected.
- Consult the dealer or an experienced radio/TV technician for help.

### IC Regulations:

This device complies with Industry Canada's licence-exempt RSSs. Operation is subject to the following two conditions:

- This device may not cause interference; and
- This device must accept any interference, including interference that may cause undesired operation of the device.

Le présent appareil est conforme aux CNR d'Industrie Canada applicables aux appareils radio exempts de licence. L'exploitation est autorisée aux deux conditions suivantes:

- l'appareil ne doit pas produire de brouillage, et
- l'utilisateur de l'appareil doit accepter tout brouillage radioélectrique subi, même si le brouillage est susceptible d'en compromettre le fonctionnement."

#### CAN ICES-3(B)/NMB-3(B)

The device could automatically discontinue transmission in case of absence of information to transmit, or operational failure. Note that this is not intended to prohibit transmission of control or signaling information or the use of repetitive codes where required by the technology.

- the device for operation in the band 5150–5250 MHz is only for indoor use to reduce the potential for harmful interference to co-channel mobile satellite systems;
- the maximum antenna gain permitted for devices in the band 5725–5825 MHz shall comply with the e.i.r.p. limits specified for point-to-point and non point-to-point operation as appropriate.

The IC ID for this device is 3568A-Z00AD.

