

FLEETWOOD.
Driven to Explore

American Tradition Floor Plans, Standard Features and Options

{American Tradition}

A M E R I C A N T R A D I T I O N C l a s s A D i e s e l 2 0 0 5



Floor Plans

38X
Triple Slide-Out
Sleeps 2

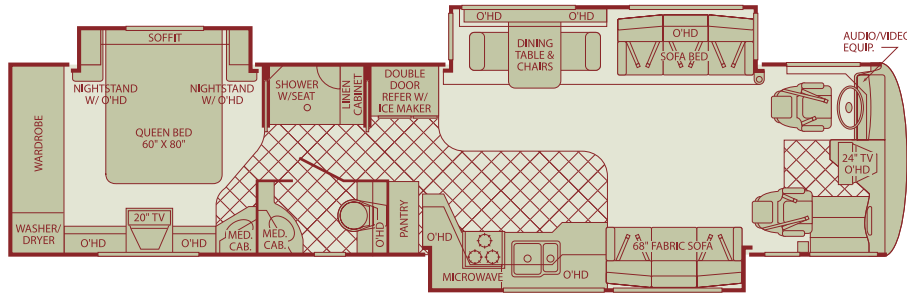

40J
Triple Slide-Out
Sleeps 2

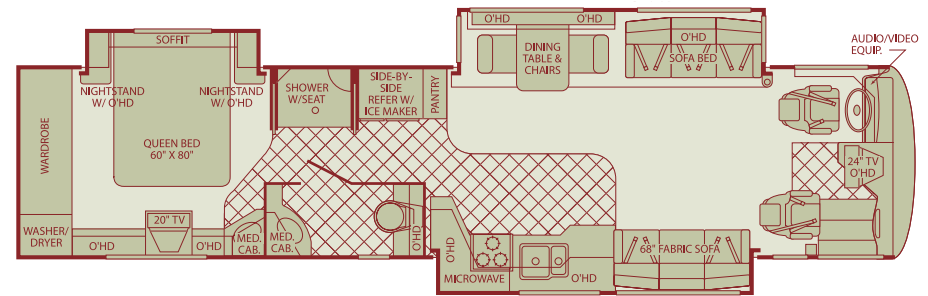

40Q
Double Slide-Out
Sleeps 2

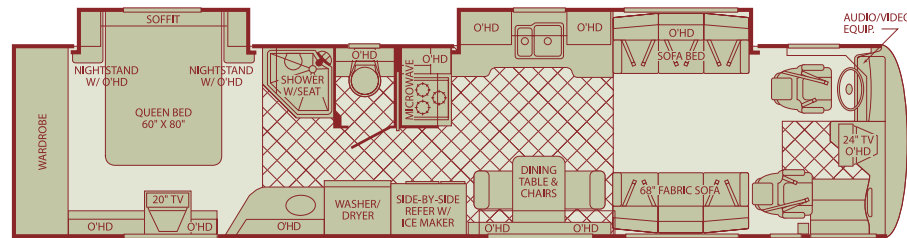

40V
Triple Slide-Out
Sleeps 2

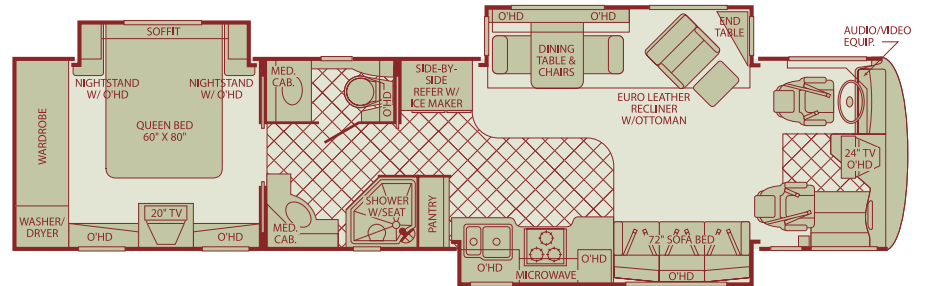

Options

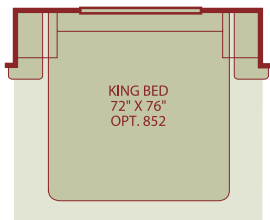

Available in all floor plans.

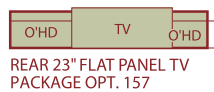

Available in all floor plans.



Available in all floor plans.



Available in all floor plans
Options 897, 884 not
available in 42R

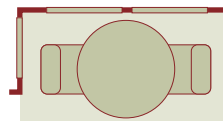

Available in floor plans:
38X, 40J, 40L, 40N, 40V, 42R

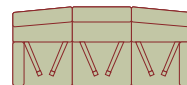

Available in floor plans:
38X, 40J, 40L, 42R

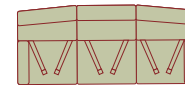

Available in floor plans:
40N, 40Q, 40V, 40W



Available in floor plans:
38X, 40J, 40L, 40Q, 40W



Available in
floor plans:
40N, 40V



Available in
all floor plans.

American Tradition

Floor Plans

40L
Quad Slide-Out
Sleeps 2

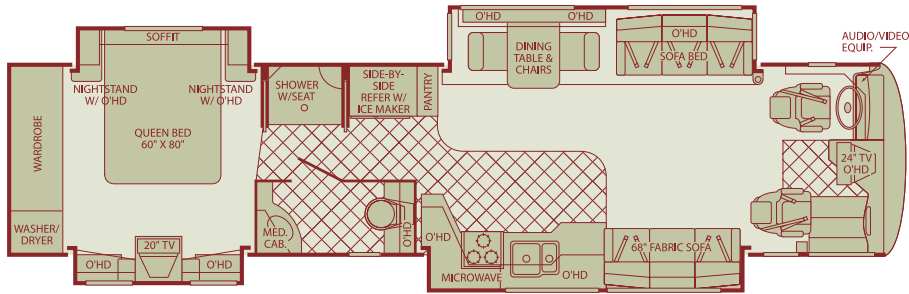

40N
Triple Slide-Out
Sleeps 2

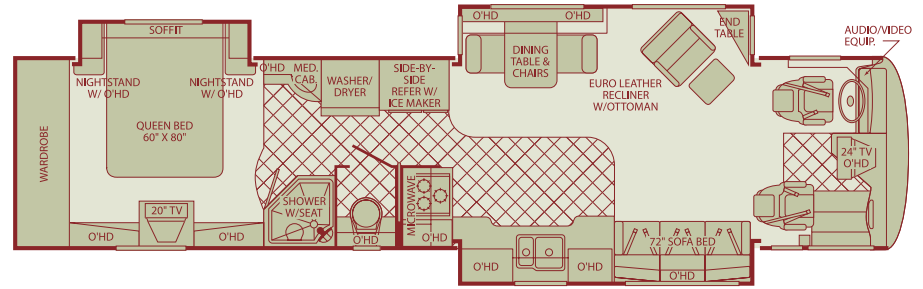

40W
Double Slide-Out
Sleeps 2

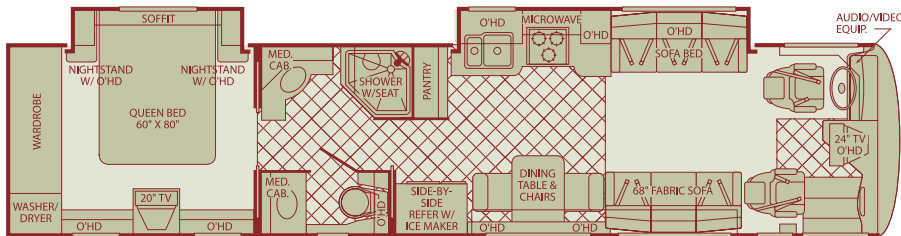

42R
Quad Slide-Out
Sleeps 2

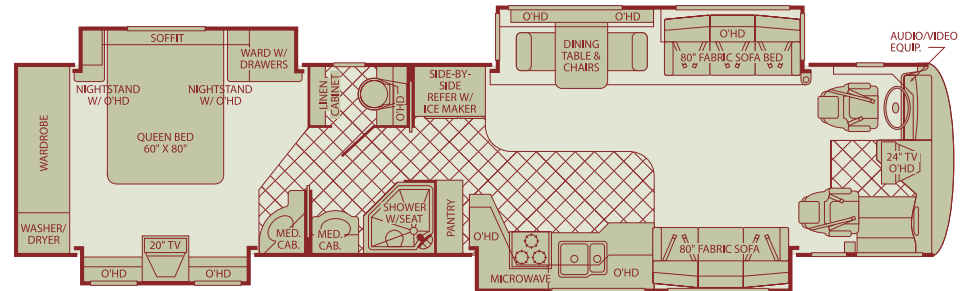

Seatbelt configuration may vary depending on options chosen. Sleeping capacity based on standard layout. Optional furniture may increase or decrease sleeping capacity.



68" LEATHER SOFA
OPT. 211
Available in floor plans:
38X, 40J, 40L, 40Q, 40W

80" LEATHER SOFA
Available in 42R

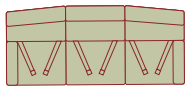

80" LEATHER SOFA BED
OPT. 198
Available in floor plans:
38X, 40J, 40L, 42R

72" LEATHER SOFA BED
available in: 40N, 40Q,
40V, 40W



FACING DINETTE OPT. 830
Available in floor plans:
38X, 40J, 40L, 40N, 40V, 42R



NORCOLD REFRIGERATOR
4 DOOR
W/ICE MAKER
OPT. 149

Available in
floor plans:
40J, 40L, 40N,
40Q, 40V, 40W,
42R



FRONT 32" FLAT PANEL
TV PACKAGE
OPT. 157
Available in
all floor plans.



RECESSED
COOKTOP
OPT. 116
Available in
all floor plans.



WASHER/
DRYER
READY
OPT. 129
Available in
all floor plans.

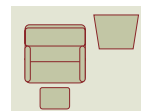

LEATHER RECLINER
W/FOOTREST AND
END TABLE OPT. 494
Available in floor plans:
38X, 40J, 40L, 42R

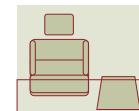

LEATHER RECLINER
W/FOOTREST AND
END TABLE OPT. 494
& PASSENGER SIDE SOFA
O'HEAD OPT. 630
Available in floor plans:
40Q, 40W

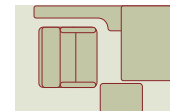

DESK W/FREE-STANDING
EURO LEATHER RECLINER
W/OTTOMAN OPT. 870
Available in floor plans:
38X, 40J, 40L, 42R

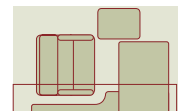

DESK W/FREE-STANDING
EURO LEATHER RECLINER
W/OTTOMAN OPT. 870
& PASSENGER SIDE SOFA
O'HEAD OPT. 630
Available in floor plans:
40Q, 40W

Weights and Measurements

WEIGHTS	38X	40J	40L	40N	40Q	40V	40W	42R
GVWR (lbs.)¹	34,600	34,600	34,600	34,600	34,600	34,600	34,600	44,600
Front GAWR (lbs.)²	14,600	14,600	14,600	14,600	14,600	14,600	14,600	14,600
Rear GAWR (lbs.)²	20,000	20,000	20,000	20,000	20,000	20,000	20,000	20,000
Tag Axle GAWR (lbs.)²	N/A	N/A	N/A	N/A	N/A	N/A	N/A	10,000
Base Weight (lbs.)³	27,750	28,000	28,500	28,000	27,750	28,000	27,500	32,500
GCWR (lbs.)⁴	49,600	49,600	49,600	49,600	49,600	49,600	49,600	59,600
Hitch Rating Weight (lbs.)[*]	15,000	15,000	15,000	15,000	15,000	15,000	15,000	15,000
Tongue Weight (lbs.)[*]	1,500	1,500	1,500	1,500	1,500	1,500	1,500	1,500

MEASUREMENTS

Wheelbase	254"	266"	266"	266"	266"	266"	266"	290"
Overall Length⁵	38' 11.5"	39' 11.5"	39' 11.5"	39' 11.5"	39' 11.5"	39' 11.5"	39' 11.5"	41' 11.5"
Overall Height (w/AC)	12' 8"	12' 8"	12' 8"	12' 8"	12' 8"	12' 8"	12' 8"	12' 8"
Overall Width (maximum)⁶	101.5"	101.5"	101.5"	101.5"	101.5"	101.5"	101.5"	101.5"
Interior Height (maximum)	82"	82"	82"	82"	82"	82"	82"	82"
Interior Width (maximum)	96"	96"	96"	96"	96"	96"	96"	96"

TANK AND LIQUID CAPACITIES

Fresh Water Holding Tank (gal.)	95	95	95	95	95	95	95	120
Grey Water Holding Tank (gal.)	70	70	70	70	70	70	70	60
Black Water Holding Tank (gal.)	40	40	40	40	40	40	40	40
Appliance LPG Tank (WC)⁷	38	38	38	38	38	38	38	38
Water Heater Tank (gal.)	10	10	10	10	10	10	10	10
Fuel Capacity (gal.)	125	125	125	125	125	125	125	150

Liquid Weight Reference: Water (gal.) = (8.3 lbs./3.8 kgs.) Fuel (gal.) = (7.1 lbs./3.2 kgs.) LPG (gal.) = (4.2 lbs./1.9 kgs.)

Metric Conversion: Multiply pounds x 0.453 to obtain kilograms. Multiply gallons x 3.785 to obtain liters.

CHASSIS

Frame: Liberty Chassis	Transmission: Allison® 3000 MH, 6 Speed w/Electronic Shifter
Engine: Cat® C9 400 HP, 8.8L	Alternator Amps: 200 Amp Leece Neville
Torque: 1150 lb.-ft. @ 1400 RPM	Tires: Goodyear® 295/80R 22.5 H

1. GVWR (Gross Vehicle Weight Rating): Means the maximum permissible loaded weight of the motor home. The GVWR is equal to or greater than the sum of the unloaded vehicle weight plus the net carrying capacity.
2. GAWR (Gross Axle Weight Rating): Means the maximum permissible loaded weight a specific axle is designed to carry.
3. Base Weight: Means the estimated weight of the motor home without fuel, options, water, cargo or passengers.
4. GCWR (Gross Combined Weight Rating): Means the value specified by the motor home manufacturer as the maximum allowable loaded weight of this motor home with its towed vehicle. Towing & braking capacities may differ. Refer to Fleetwood & chassis manufacturer manuals for complete information.
5. Length taken from front bumper to rear bumper (excludes accessories).
6. Excludes safety equipment & awnings.
7. Tank Manufacturer's listed water capacity (WC). Actual LP Gas capacity is 80% of water listing as required by the safety code.

N/A = Not Applicable

* The chassis manufacturer recommends the installation of a supplemental brake-control system to activate the brakes on the vehicle or trailer you are towing.

IMPORTANT— PLEASE READ: Product information, photography and illustrations included in this publication were as accurate as possible at the time of printing. For further product information and changes, please visit our website at www.fleetwoodrv.com or contact your local Fleetwood dealer. Prices, materials, design and specifications are subject to change without notice. All weights, fuel, liquid capacities and dimensions are approximate. Fleetwood has designed its recreational vehicles to provide a variety of uses for customers. Each vehicle features optimal seating, sleeping, storage and fluid capacities. The user is responsible for selecting the proper combination of loads (i.e., occupants, equipment, fluids, cargo, etc.) to ensure that the vehicle's capacities are not exceeded.

Liberty Chassis

Fleetwood® Exclusive.

In true American Coach Fashion, American Coach set out to design a superior, one-of-a-kind chassis that would be able to overcome the structural challenges created by designing floor plans with triple and quad slide-outs. The result: The Liberty Chassis. This exclusive American Coach design (patent pending) strengthens the structural integrity of the driving platform by creating a strong and rigid frame that resists flexing and provides a comfortable and unforgettable driving experience.

- ➊ **Huge 15,000 lbs. Towing Capacity.** Easily tows your favorite vehicle.
- ➋ **Laminated Storage Liners.** Easy to maintain, neat, clean look, durable.
- ➌ **E-Coated Structure.** Protects against corrosion. Enhances longevity, quality and reliability.
- ➍ **All Steel Structure.** Minimizes flex, enhances driving experience, strength and longevity.
- ➎ **Center-Mounted Fuel Tank.** Improved weight distribution.
- ➏ **Independent Front Suspension.** Optimum handling, enhances driving experience.

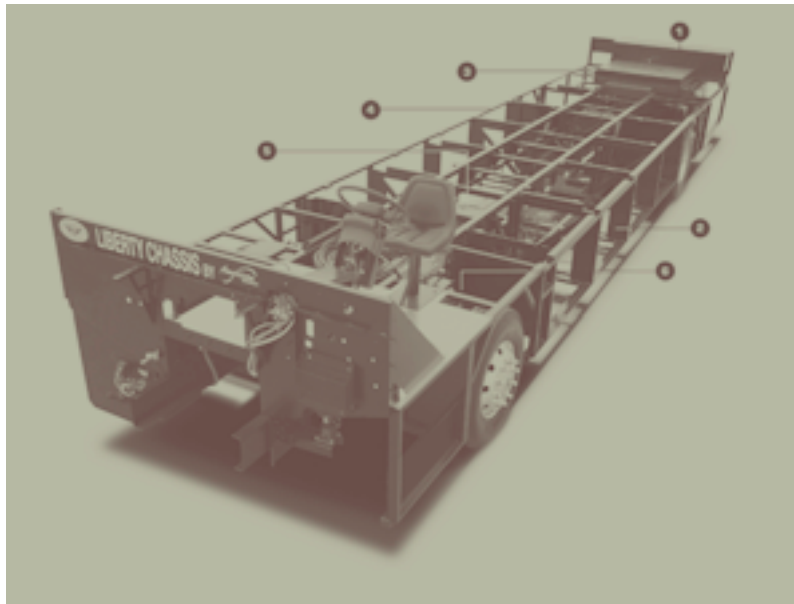

Setting the Standard in Motor Home Quality.

Fleetwood® prototypes are exposed to thousands of miles of durability testing. Those components that don't survive are redesigned until they do. This sets our standard in safety and durability.

Numerous floor plan choices. American Coach offers a wide variety of floor plans including double, triple and quad slides. This provides many choices to accommodate each customer's distinct needs.

Vacu-bond® Roof, Sidewalls and Floor. The Vacu-bond® process adds a great deal of structural integrity by laminating the sidewalls, floors and roof into a strong composite structure. This construction method is considered superior when compared to most competitors.

More Power. Tradition comes equipped with a Cat® C9 with 400 HP engine with 1150 lb.-ft. of torque @ 1400 RPM. This gives you plenty of power to tour the country at any pace you like.

The Pneumatic Entry Door Air Lock (optional). Is a unique feature that minimizes air intrusion, and wind noise when you are on the go. Avionics® has designed a superior entry door for American Coach.

Name Brand Components. Spartan®, Sony®, Dupont®, Avionics®, Flexsteel®, Moen®, Onan®, Norcold® and Dometic® to name a few. We gather the best name brands in the industry to create a superior coach for you.

Standard Features

Interior

THROUGHOUT

- **Energy Management System (50 Amp)***
- **Deluxe Ball Bearing, Full Extension Drawer Guides***
- **TuffPEX® Plumbing System***
- **Denso Climate Control System***
- **(2) 13.5 M Low Profile Roof Air Conditioners***
- **(3) 13.5 M Low Profile Roof Air Conditioners (42' Model Only)***
- **Whole Coach Water Filtration System***
- 2-Stage High Efficient Furnaces w/Thermostat & Auto Ignition (15/22M & 23/34M)
- Sensa Tank RV 100 Tank Level Monitoring System (Interior & Exterior Monitor)
- TV Cable Ready
- Park Telephone Ready
- Rigid Furnace Ducting

DRIVER CONVENIENCE

- **Rear Vision System w/One-Way Audio (Camera & Monitor)***
- Flexsteel® Leather Driver/Passenger Seats w/Manual Lumbar/ 6-Way Power Driver Seat
- Passenger Drink Holder
- Driver Drink Holder
- Tilt/Telescoping Steering Wheel

LIVING ROOM

- **Sony® 24" Vega Flat Screen TV***
- **Sony® Home Theater System***
- **Flexsteel® Leather Euro Recliner w/Ottoman (40V & 40N Models Only)***

BATHROOM

- **Solid Surface Lavy Countertop w/Porcelain Bowl & Moen® Faucet***
- **Moen® Hand Held Shower Head***
- **Diagonally Laid Ceramic Tile Flooring***

* Denotes Fleetwood's Key Features

- Automated Electrical Control System (Includes Whole House Surge Protector)
- Power TV Antenna w/Warning Alarm & (2) Jacks
- Magnum Energy 2500-Watt Inverter/130 Amp Charger
- Magnum Energy Battery Monitor
- Multi-Point Water Pump Switching
- Direct Spark Ignition 10 Gallon Water Heater 120V/LPG
- Front Windshield Privacy Curtain
- Diagonally Laid Ceramic Tile Floor at Front Entry
- Entry Step Switch at Entry Wall
- Interior Multiplexed Switches
- Day/Night Pleated Shades
- Centralized Control Panel Display Center
- Padded Vinyl Ceiling
- Front Overhead to Include Electronics
- Deluxe Padded Window Treatments
- 12V Fluorescent Ceiling Lights
- Skylight Cover (Select Models)
- Washer/Dryer (Vented)
- Lined Shelves
- Choice of Walnut, Regency Cherry, Clear White Maple or Windsor Birch Cabinetry
- Wood Front TV Overhead Cabinetry
- Wood Drawers
- Solid Core Raised Panel Upper Cabinet Doors
- Lined Cabinet Bottoms & Shelves
- LPG Detector/Alarm
- Smoke Detector/Alarm
- Fire Extinguisher
- CO Detector/Alarm

- Auxiliary Start Switch
- Auxiliary Fog Lights
- Power Driver Window
- Driver Side Pull Down Shade
- Power Driver/Passenger Sun Visors
- Top Mounted Intermittent Windshield Wipers
- w/Sprayer Nozzles
- Visteon® AM/FM Radio & Single CD-Dash
- Manual Air Dump Switch

- **Pre-Programmed Harmony® Remote Control (Controls ALL Electronics)***
- Flexsteel® Fabric Loveseat (38X, 40Q, 40W, 40J & 40L Models Only)

- Deluxe Medicine Cabinet
- Skylight in Shower
- Shower Door w/Privacy Glass
- Residential China Bowl Flush Toilet w/Hand Sprayer
- Shower Caddy (ABS or Molded into the Shower Enclosure)

- I.C.C. Light Switch
- (2) Auxiliary 12V Dash Receptacles
- Adjustable Brake & Throttle Pedals
- Driver/Passenger Map Lights
- Battery Disconnect Switch
- Pneumatic Step Well Cover
- Back Lighted Instrument Panel
- Cruise Control
- Smart Wheel

- Flexsteel® Fabric Sofa Bed
- TracVision® Domed Digital Satellite System

- Power Bath Vent
- Fiberglass Shower Enclosure w/Molded Seat (Select Models)

GALLEY

- **Dometic® 120V/LPG Electric 12 Cu. Ft. Side by Side Refrigerator w/Icemaker (N/A 38X)***
- **Recessed 3 Burner Range w/Oven & Solid Surface Covers***
- **GE® Convection Microwave Oven w/Built In Range Hood***

BEDROOM

- **Solid Surface Nightstand Countertops***
- **Sony® 20" Vega Flat Screen TV***
- **Generator Start/Stop Switch***

- **Solid Surface Galley Countertop & Sink Covers***
- **Diagonally Laid Ceramic Tile Flooring***
- Solid Surface Dinette Table w/Extension & 4 Chairs
- Large 60/40 Split Stainless Steel Galley Sink

- 60" x 80" Full Queen Bed
- Fabric Decor Headboard
- Cedar Lined Wardrobe
- Day/Night Pleated Shades

- Additional Receptacles in Galley
- Cabinet Storage for the Range & Galley Sink Covers
- High Rise Galley Faucet w/Extendable Sprayer
- Hinged Plumbing & Access Panels (Galley & Bath Areas)
- 120V Outlet & Telephone Jack at Dinette

- Wardrobe Light
- Shoe Storage in Wardrobe Closet
- Secondary Phone Jack
- Second Lavy Sink (Select Models)

Options Interior

THROUGHOUT

- V.I.P. Factory Delivery
- Automatic Generator Start System
- Passenger Side Sofa Overhead Cabinet
- Desk w/Flexsteel® Leather Euro Recliner w/Ottoman (Select Models)
- Hydronic Heating System (N/A 38X & 40L)
- Central Vacuum System w/Tool Kit
- Power Vent w/Rain Sensors (All Vents, Galley, Bath & Shower Area)

DRIVER CONVENIENCE

- Color GPS Navigation System w/Trip Tek
- Color GPS Navigation System
- OnStar® Navigation System (Includes One Year Subscription)
- In Dash CD-6 Radio w/Sirius® Radio (Includes One Year Subscription)
- CB Radio Ready (Power & Antenna)
- Keyless Entry Includes Key FOB
- Spacious Flexsteel® Leather Passenger Seat /6-Way Power/Electric Footrest

- Night Vision-Raytheon
- Night Vision-Raytheon w/Lexan® Acrylic Shield
- Trip Tek

GALLEY

- Nuheat™ Heated Tile Floor (Galley to Entry)
- Norcold® 4 Door 12 Cu. Ft. Refrigerator w/Icemaker (N/A 38X)
- Recessed 3 Burner Cook Top (Brush Stainless Finish)
- CSA-Recessed Cook Top
- Free Standing Dinette w/Bay Windows (Eliminates Wall Storage Unit & Increases Window Size/38" Round Table is Made From Hardwood)
- Facing Dinette
- Nuheat™ Heated Tile Floor (Galley Only)
- Galley to Entry Tile Flooring (Carpet Required Under Flush Floor Areas) (N/A on 40L Model)

LIVING ROOM

- Flexsteel® Free Standing Leather Recliner (Includes End Table) (Select Models)
- 58" Flexsteel® Leather Love Seat (40N & 40V)
- 68" Flexsteel® Leather Sofa (Select Models)

- 72" Flexsteel® Leather Sofa (Select Models)
- 80" Flexsteel® Leather Sofa (Select Models)
- Flexsteel® Leather Sofa Bed w/Air Mattress (60"x72" Bed Size-Select Models)
- Flexsteel® Leather Sofa Bed w/Removable Arms (Select Models)
- Flexsteel® Leather Love Seat w/Removable Arms (Select Models)
- Front 32" Sony® Flat Panel TV and a 23" Sony® Flat Panel TV in Bedroom

BEDROOM

- Washer/Dryer Ready (Delete W/D Feature/Add 2 Shelves)
- King Bed (72" x 76")
- Shirt Wardrobe w/Drawers at Rear Wall
- Full Length Wardrobe at Rear Wall
- Bedroom Ceiling Fan
- Heat Pump AC

BATHROOM

- Nuheat™ Heated Tile Floor (Std Bath Area)
- Shower Enclosure w/Obscure Reeded Glass

Standard Features

Exterior

THROUGHOUT

- **Power Entry Step w/Last Out Feature***
- **Carefree Electric Patio Awning (Color Coded to Graphic Package)***
- **Trailer Hitch Receiver 15,000 lbs.***
- Auxiliary Fog Lamps
- Mud Flaps, Front & Rear
- Utility Light Front & Rear
- Hadley® Air Horns
- Aluminum Wheels
- Onan® 7.5 kW Quiet Diesel Generator w/Manual Slide-Out Tray
- Onan® 10.0 kW Quiet Diesel Generator w/Power Slide-Out Tray (42' Model only)
- (4) 12V Maintenance Free AGM House Batteries (Group 27)
- (2) 12V Chassis Batteries (2000 CCA)
- Electronic Battery Control Center
- One Piece "Bus Style" Windshield
- Chrome "Bus Style" Heated Mirrors w/Remote Adjustments
- Gelcoat Fiberglass Exterior Sidewalls
- Domed One-Piece Fiberglass Roof w/Radius Corners
- Redesigned Full Fiberglass Front Cap
- Full Fiberglass Rear Cap
- Large Windshield Washer Bottle
- Manual Generator Slide-Out
- 30" Front Entry Door w/Dead Bolt
- Protective Vinyl Front Cover
- Fiberglass Front & Rear Quarter Panels
- Fiberglass Molded Front Bumper
- Fiberglass Wheel Trim
- Window Awnings (Bedroom & Front Roadside Window)
- Halogen Headlights

BODY STRUCTURE

- **Vacu-bond® Sidewall, Roof & Floor Construction***
- **Light Weight Aluminum Wall Construction***
- **Insulation In Sub Floors, Front & Rear***
- Steel Surface on Front Bulkhead/Engine Frame
- Insulated Storage Area
- Bonded Windshield w/Frame
- Interlocking Extrusions– Floor & Roof

AUTOMOTIVE

- **Anti-Lock Brake System (ABS)***
- **4-Point Leveling Jacks***
- **Tire Pressure Check Gauge***
- Chassis Service Panel
- 295/80R LRH 22.5" Radial Tires
- Allison® 3000 MH, 6-Speed Automatic Transmission
- Exhaust Brake On-Off

STORAGE

- **Drop In Pin Retention System for the Side Hinged Luggage Doors***
- **Side Hinged Compartment Bay Storage Doors* (Most Locations)**
- Luggage Compartment Lights

SAFETY/CONVENIENCE

- **Dual Pane Windows w/Screens***
- (4) Turn Signal Lamps on Each Side of Coach
- Integrated Seat Belts/Driver & Passenger Seats
- Front & Rear Docking Lights

- Color Coded Awnings & Awning Arms
- Exterior Convenience Light at Dump Valves
- Holding Tank w/Low Point Drain Valves
- Dual Holding Tank San-T-Flush™ System
- Spray Wand w/Soap Dispenser & Paper Towel Holder
- Fresh Water Gravity Fill
- Variable Speed Aquatec Water Pump
- Park Telephone Ready
- Patio Receptacles
- Two Piece Rear Ladder
- Full Width Rear Rock Guard w/Logo
- Power Cord Reel w/50 AMP Service (42' model only)

- Heated Water & Holding Tank Compartments

- Full Air Brakes w/Automatic Slack Adjusters
- Air Ride Suspension w/Bilstein® Shocks-Spartan®

- (4) 12V Electrical Outlets in Exterior Luggage Compartments Near Each Corner of Coach

- Lighted Entry Assist Handle
- Back-Up Alarm
- Porch Light

Options Exterior

THROUGHOUT

- Exterior Entertainment Center (24" Vega TV w/Swivel Slide Out Tray w/Top Mount Hinged Door)(Location is Under S/O Box on Select Models)
- (6) Exterior Graphics Packages
- Girard Electric Patio & Window Awning Package
- "A" Tray Package (2) 90"
- "B" Tray Package (2) 54" & (2) 36"
- "C" Tray Package (1) 90", (1) 54", (1) 36"
- "D" Tray Package (1) 54" and (1) 36"
- Exterior Spot Light
- Pneumatic Door Air Lock
- Acrylic Shield
- Solar Charging Panel (70 Watts)
- Norcold® 12V/120V Chest Refrigerator/Freezer AC/DC

BODY STRUCTURE

- Spartan® IFS Chassis w/400 HP Cat® C9 Engine (Independent Front Suspension)
- CSA Spartan® Package
- Air & Hydraulic Leveling System

Fleetwood Exclusives

- **Liberty Chassis w/Electro-Coated Platform***
- **Complete TuffPEX® Plumbing System***
- **Independent Front Suspension (Standard)***
- **55 Degree Turning Radius***
- **15,000 lb. Trailer Hitch Receiver***
- **"Maintenance Free" (4) Absorbed Glass Mat 12- Volt Batteries (AGM)***
- **Roof Mounted Engine Air Intake***
- **Radius, Interlocking Aluminum Framed and Vacu-Bonded® Roof Structure***
- **50" Tall, One-Piece Windshield Bonded to Steel***
- **Wide Entry Door, with Pneumatic Entry Door Locks (optional) and "Doggy" Window***
- **Denso Dash A/C System with Approximately 17,000 BTU Cooling***
- **ESP–Energy System Protect (5,000 Joules of Surge Protection)***
- **Power Driver Window***
- **Built in Dash Storage Cabinetry with Snack Tray***
- **Solid Surface Countertops***

* Denotes Fleetwood's Key Features

What Drives You?

Maybe it's feeling like you're the only one on Earth. Perhaps it's the unique sense of closeness with the great outdoors. Or, it might be the joy that comes from spending quality time with family and friends. Whatever the reason, we know that you have a strong drive to experience everything that comes with spending time on the road. And for more than 50 years, we've shared that passion with you. Because we're RV enthusiasts ourselves, you can see our passion in the vehicles we design and build. Own a Fleetwood, and you'll feel like you're not just traveling, but embarking on an experience unlike any other. Set your own course for adventure and get out there and explore the world around you. Once you do, you'll see what it is that drives us — it's you.

RV OWNERCARE* is a limited one-year/15,000-mile and three-year/50,000-mile structural warranty, whichever occurs first, and it is fully transferable for the first 12 months. RV OWNERCARE is one of the RV industry's most comprehensive programs and includes systems, appliances, components and construction, with no deductible and no service charge. RV OWNERCARE coverage is provided from a company that will be around in the future to service your needs. See your nearest Fleetwood dealer for a full explanation of benefits and restrictions.

CLUB FLEETWOOD As a Fleetwood owner, you're eligible to become a member of our owners' group, Club Fleetwood. It's a perfect way to meet other Fleetwood owners who love to travel to beautiful resorts and vacation spots all across America. Call (877) 577-2560 and join the fun! Or visit www.fleetwood.com/clubs to learn more. For American Coach specific club information contact: American Coach Association (602) 625-7854, www.americancoachassoc.com or FMCA Chapter (505) 280-0513, www.americancoach-fmca.com.

FLEETWOODRV.COM To locate a dealer near you, visit our website or call 1-800-444-4905. We can also be contacted at Fleetwood Customer Relations, P.O. Box 7638, Riverside, CA 92513-7638.



www.fleetwoodrv.com

IMPORTANT—PLEASE READ Product information, photography and illustrations included in this publication were as accurate as possible at the time of printing. For further product information and changes, please visit our website at www.fleetwoodrv.com or contact your local Fleetwood dealer. Prices, materials, design and specifications are subject to change without notice. All weights, fuel, liquid capacities and dimensions are approximate. Fleetwood has designed its recreational vehicles to provide a variety of uses for customers. Each vehicle features optimal seating, sleeping, storage and fluid capacities. The user is responsible for selecting the proper combination of loads (i.e.: occupants, equipment, fluids, cargo, etc.) to ensure that the vehicle's capacities are not exceeded.

Your local Fleetwood dealer is:

*For complete info see your Fleetwood dealer. © 2004. Fleetwood Enterprises, Inc. Printed in the USA. Inventory control number AT05F2 10/04.

