

STEP 6: On-screen setup and activation

Follow the instructions
on your TV screen.

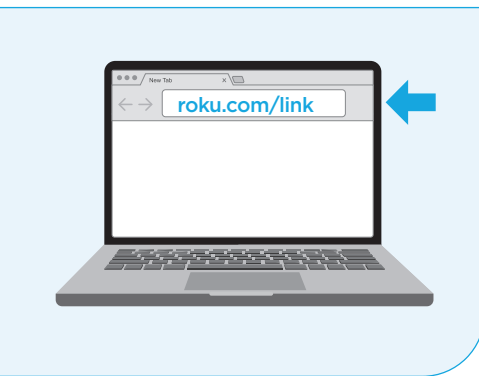

Activate your
streaming player by
using your computer
or smartphone to link
to a Roku account.

IMPORTANT: Make sure you type **roku.com/link** into the browser being careful not to misspell or add extra characters. Typing this incorrectly may take you to fraudulent websites.

Common questions

Why do I need to create a Roku account?

Before you can start streaming, channels must be downloaded and installed on your streaming player. To accomplish this, your streaming player must be linked to a Roku account. With a Roku account, not only can you add channels from the Roku Channel Store, but you can also manage your subscriptions, view your purchase history, and update payment method. For more information, visit go.roku.com/whyaccount

Why do I need to enter a credit card?

Saving a payment method makes it easy to rent or buy movies on demand, subscribe to popular services, and enroll in free trials. Charges will not be made without your authorization. For more information, visit go.roku.com/paymenthelp

What should I do if my streaming player is not connecting to my wireless network?

Your streaming player connects to your wireless network the same as your laptop or smartphone. If these other devices can access the internet, then your streaming player should be able to do the same. Make sure to select the same network name, and enter the same password you use with the other devices. Remember that passwords are case-sensitive and easy to enter incorrectly. For more help, visit go.roku.com/wireless

Can I take my Roku streaming player with me when I travel?

Yes. You can bring your streaming player and watch your favorite entertainment when you travel. Remember to also bring the power adapter, remote and any cables you use to connect your streaming player at home, and make sure your destination has a good internet connection. You will also need a computer or smartphone with wireless capabilities and a web browser to help get your streaming player connected to the network. For more details, visit go.roku.com/travelwithroku

Adhesive strip instructions

You have the option of attaching your streaming player to your TV using the included double-sided adhesive strip. This strip is removable and will not leave a sticky residue. However, it can only be used one time! Keep in mind that your streaming player requires a direct line of sight with your remote control. To order more strips, go to roku.com/accessories

To apply adhesive strip

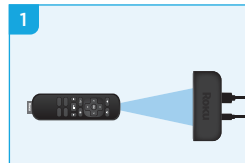

Choose a flat surface to attach your streaming player. Before attaching make sure the area is clean and in line of sight to your remote.

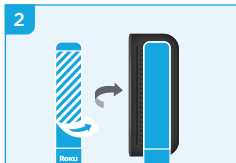

Remove striped liner from the double-sided adhesive strip. Press adhesive to the bottom of the streaming player.

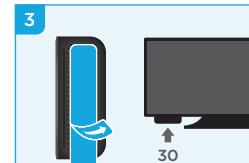

Remove other liner. Firmly press streaming player to the desired location for 30 seconds.

To remove adhesive strip

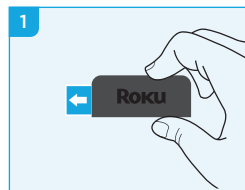

Hold the streaming player in place. Gently pull adhesive strip sideways.

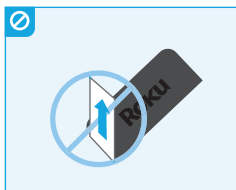

Do not pull the adhesive strip towards you.

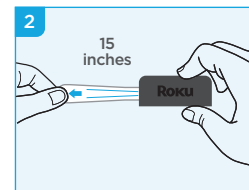

Stretch the strip slowly to the side (at least 15 inches) to release.

Need more help getting started?

go.roku.com/expressplus



Video
tutorials



Wireless
help

Getting the most out of your Roku streaming player.

go.roku.com/usingroku



Add
channels



Mobile
app

Tips, what's streaming for free and more...

blog.roku.com



ROKU Express+

Quick Start Guide

Roku

© 2017 Roku, Inc. All rights reserved. ROKU and the ROKU logo are the registered trademarks of Roku, Inc.



What's included

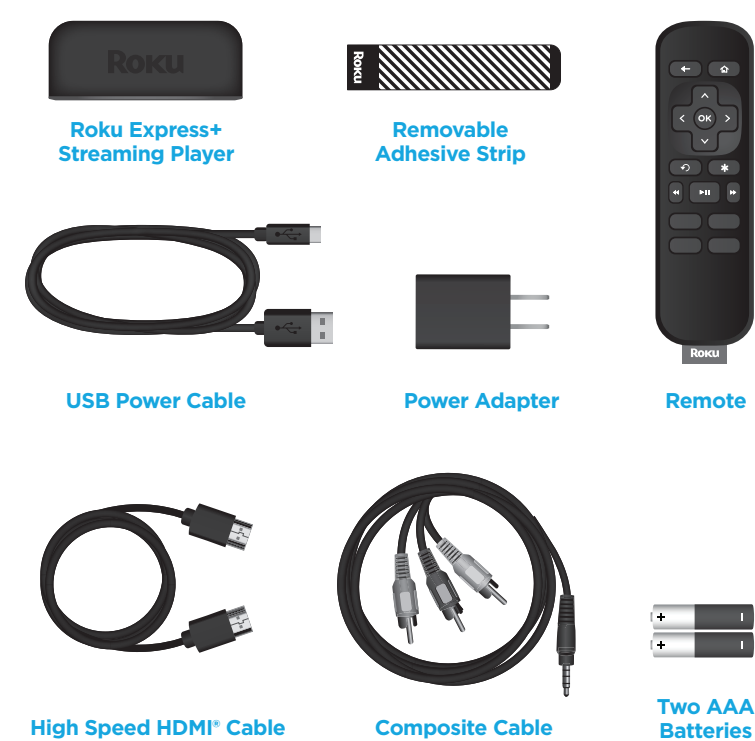

Setup

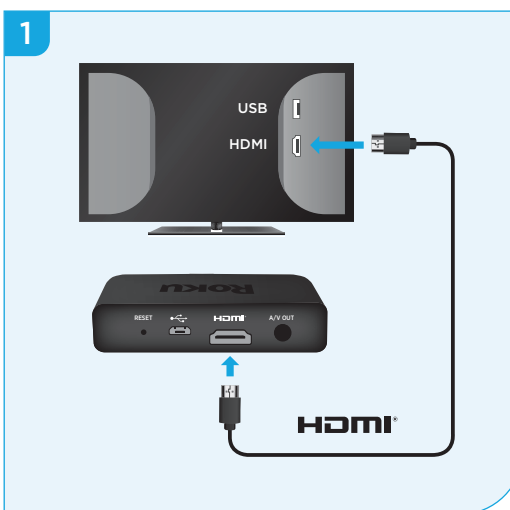

STEP 1: Connect to TV

Use the included High Speed HDMI® Cable (or your own HDMI® cable) to connect your streaming player to your TV.

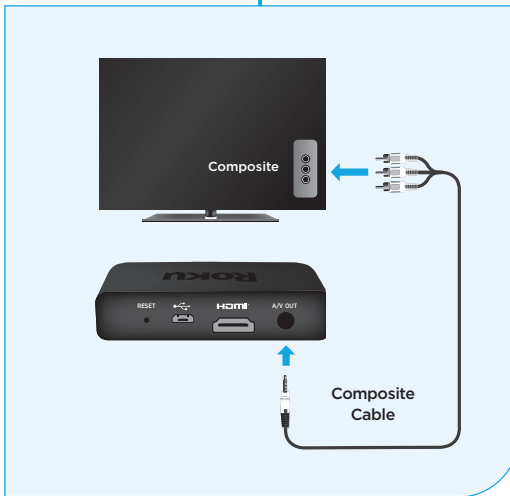

For TVs that don't have an HDMI connector, use the included composite cable.

NOTE: Streaming will be in standard definition.

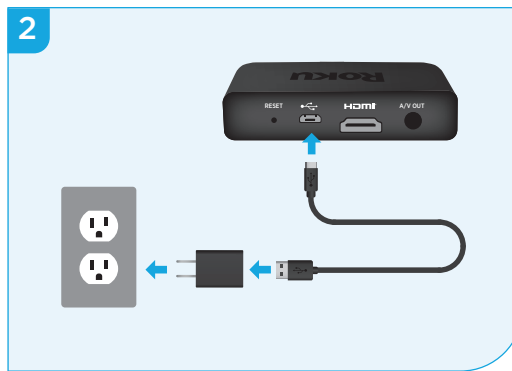

STEP 2: Connect to power

For the best streaming experience, use the included USB power cable and power adapter to connect your streaming player to a wall outlet.

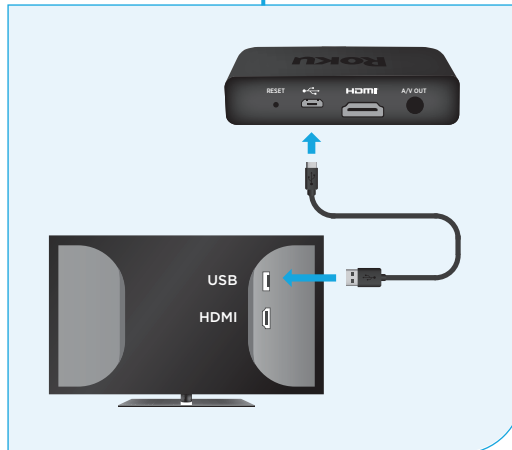

Or use the included USB power cable to connect to the USB port on your TV.

NOTE: Not all TV USB ports provide enough power.

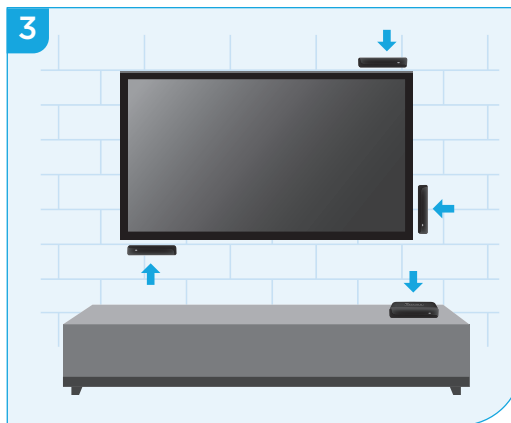

STEP 3: Position Roku streaming player

Place the streaming player near your TV.

The streaming player can be attached to your TV with the included double-sided adhesive strip. The strip is for single-use and can be removed.

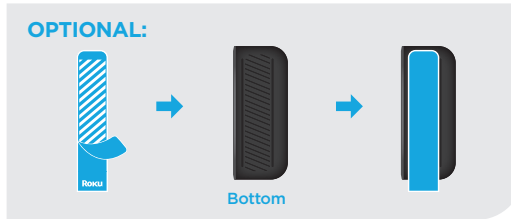
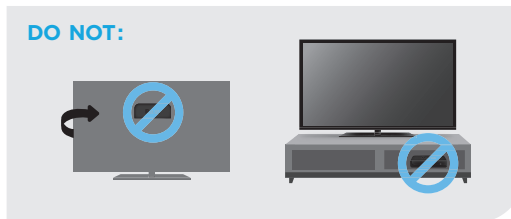

DO make sure that the front of your streaming player has direct line of sight with your remote control.

DO NOT place your streaming player behind the TV.

DO NOT place inside a TV cabinet. Doing so may cause overheating.

For proper use, see **adhesive strip instructions** located at the end of this Quick Start Guide.

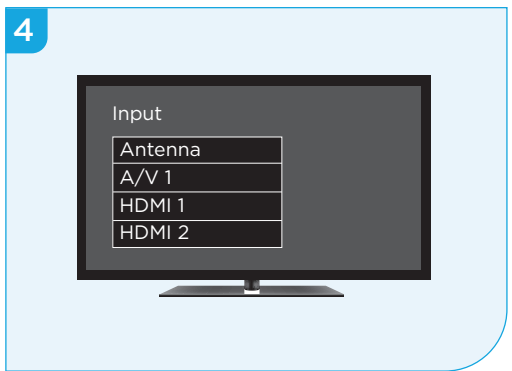

STEP 4: Power on TV and select input

Use your TV remote to power on your TV and select the input you used to connect your streaming player.

For help on how to select the correct input, visit [go.roku.com/selectinput](https://www.roku.com/selectinput)

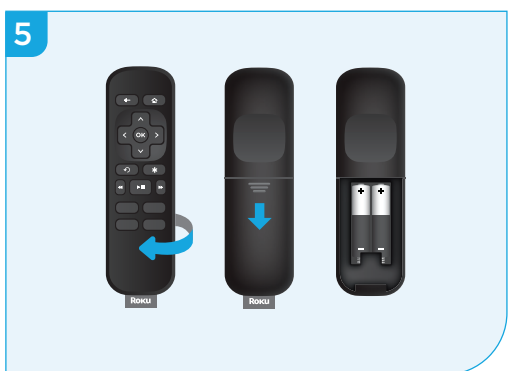

STEP 5: Insert batteries

On the back side of the remote, slide open the battery cover. Insert included batteries placing the negative (-) ends in first.