

**GIGA
PoE Plus**

ALL Giga PoE Plus
Management Switching Hub

GA-ML16TPoE+

Product Number:PN261693

**New
Release!**

All Giga + PoE Plus

Operating Temperature **50°C**

Robust Lightning Surge Tolerance **10kV**

Loop detect & shutdown Loop History

PoE Auto-reboot Function



Max Power Supply
250W

PoE Port
16port
(port1-16)

1. All port Gigabit Ethernet & Power over Ethernet Plus (PoE+)

- All port is corresponding to Gigabit Ethernet.
- Port 1-16 : 10/100/1000BASE-T
- Port 17-20 : 10/100/1000BASE-T and SFP extension slot (selectable)
- Port 1-16 can supply power conforming with IEEE802.3af/at.
- Supplying power up to 30W per port
- Supplying power up to 250W in total

2. Operating Temperature : 50°C

- Support **50 degree** Celsius operating temperature.
- Operable in high temperature such as switchbox, corridor and warehouse

3. Robust Lightning Surge Tolerance : 10kV

- Have lightning surge tolerance 10kV to port side (induced lightning surge) .
- About 90% of induced lightning surge is less than 10kV in Japan.

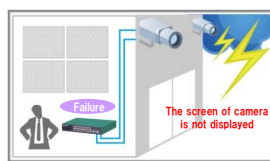
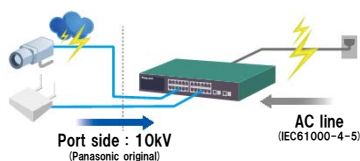

Notice:
-It does not mean that we guarantee the product is immune to malfunction.
-Strongly recommend to install lightning arresters on power unit, port side of switch and port side of power receiving unit.
-Repair fee due to lightning strike will be applicable even though the products is under warranty period.

4. Loop detect & shutdown / Loop History

- Detecting a looping, shutdown the port automatically, and notice to user with LED Lighting.
- Will be able to find out which port looping occur in the last 3 days. (LED display)

Notice:
•Due to network design or traffic condition, the expected effect may not be obtained sufficiently.
(Taking a long time to shutdown, cannot shut down...etc)

5. PoE Auto-reboot Function

- Cannot communicate with PoE device (camera, ip phone...etc) , execute **PoE OFF/ON automatically**.
- This function is installed in switching hub, so PC is not needed.

- To monitor PoE device, there are 3 methods.
- LLDP / Ping / Bandwidth monitoring. (The detail is below.)

LLDP Monitoring

Monitoring LLDP packet regularly, when not receiving it continuously, execute PoE OFF/ON.



Easy setting

Ping Monitoring

Executing ping regularly, when ping is failed continuously, execute PoE OFF/ON.



Widely usable

Bandwidth Monitoring

When bandwidth is less than the threshold during a certain term, execute PoE OFF/ON.

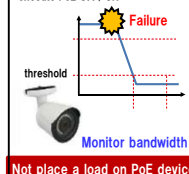

Not place a load on PoE device

Example of Use

PoE Network

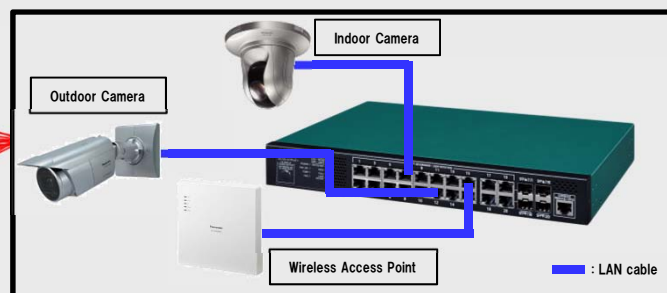
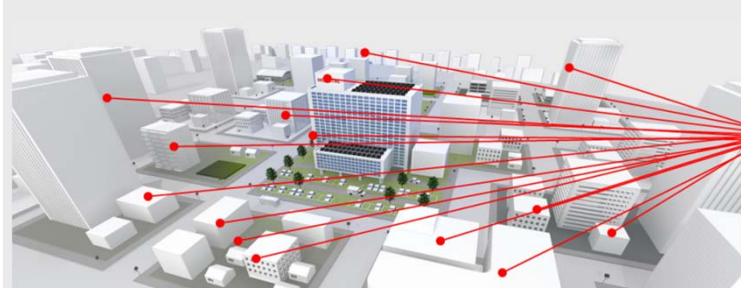

Specification:

Product Number: PN261693

Product Name: GA-ML16TPoE+

Interface	
10/100/1000BASE-T	20
PoE Port	16
SFP Extension Port	4
Others	Console
Auto Negotiation	Yes
Auto MDI/MDI-X	Yes
Flow Control	Yes
Switching Capacity	
Switching Capacity	40.0Gbps
Forwarding Rate	29.7Mpps
Mac Address Table	16K / Unit
Packet Buffer	2.0Mbyte
Management	
Configuration Method	Console/Telnet/SSH
ZEQUO assist Plus	IP Address Easy Setting
PoE Timer	-
Panasonic IP Address Easy Setting	Yes
Layer 2 Switch Function	
VLAN	Tagged VLAN/ Port VLAN Private VLAN/MAC address-based VLAN Subnet-based VLAN/Protocol-based VLAN Asymmetric VLAN/Voice VLAN Dynamic VLAN/Guest VLAN
VLAN Number	4,094
Internet Mansion	Yes
Port Grouping	Yes
Spanning Tree	Yes
Link Aggregation	Yes (Max 10 Groups Max 8 Port)
Ring Protocol	Yes
Port Monitoring	Yes (1:n)
Multicast	IGMP snooping/IGMP Querier MLD snooping/Multicast filtering Yes (8 Level)
QoS	Strict Priority Queuing Weighted Round Robin Weighted Deficit Round Robin
IEEE802.1X	Yes
WEB Authentication	Yes
MAC Authentication	Yes
Triple Authentication	Yes
Step Authentication	Yes
EAP Flame Transmission	Yes
ACL	Yes

PoE Function	
Standard	IEEE802.3at, IEEE802.3af
Power Supplying Method	Alternative A
PoE Port	16
Max Power Supply per Port	30W
Max Power Supply Whole Device	250W
PoE Schedule	Yes
PoE Auto-reboot	Yes
Loop Guard Feature	
Loop Guard Function	Yes
Loop Detect/ Block	Yes
Loop History	Yes
BPD Guard	-
Storm Control	Yes
Rating / Operating Environment	
Rated Input Capacity	AC100-240V 50/60Hz
Operating Temp.	0~50°C
Operating Humidity	20 to 80%RH (No Condensing)
Storage Temp.	-20 to 70°C
Storage Humidity	10 to 90%RH (No Condensing)
Fan	Yes
Size	
External Dimensions	H44×W330×D230mm
Installation Method/ Accessories	
Accessories	Manual, CD-ROM, Power Cord, Rubber Foot, 19 inch rack mount bracket
Power Cord Fall Prevention	Yes

Size(mm):

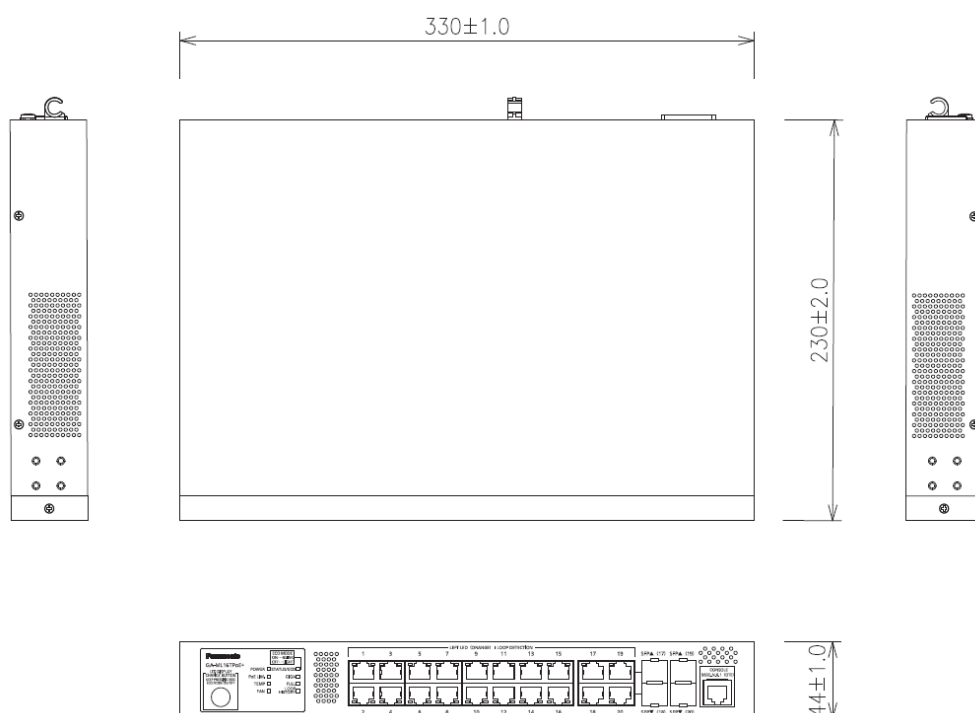

WEBSITE: <http://panasonic.co.jp/ls/plsnw/english/index.html>