

**KMM-BT525HD**  
**KMM-X503**  
**KMM-BT325U**

**KMM-BT325**  
**KMM-BT250U**  
**KMM-BT225U**

**KMR-M325BT**

DIGITAL MEDIA RECEIVER

**INSTRUCTION MANUAL**

RÉCEPTEUR MULTIMÉDIA NUMÉRIQUE

**MODE D'EMPLOI**

RECEPTOR DE MEDIOS DIGITALES

**MANUAL DE INSTRUCCIONES**

JVCKENWOOD Corporation

#### **For your records**

Record the serial number, found on the back of the unit, in the spaces designated on the warranty card, and in the space provided below. Refer to the model and serial numbers whenever you call upon your Kenwood dealer for information or service on the product.

Model KMM-BT525HD/KMM-X503/KMM-BT325U/KMM-BT325/KMM-BT250U/KMM-BT225U/KMR-M325BT

Serial number \_\_\_\_\_

*US Residents Only*

**Register Online**

Register your Kenwood product at <http://www.kenwood.com/usa/>

**Información acerca de la eliminación de equipos eléctricos y electrónicos al final de la vida útil (aplicable a los países que hayan adoptado sistemas independientes de recogida de residuos)**



Los productos con el símbolo de un contenedor con ruedas tachado no podrán ser desechados como residuos domésticos. Los equipos eléctricos y electrónicos al final de la vida útil, deberán ser reciclados en instalaciones que puedan dar el tratamiento adecuado a estos productos y a sus subproductos residuales correspondientes. Póngase en contacto con su administración local para obtener información sobre el punto de recogida más cercano. Un tratamiento correcto del reciclaje y la eliminación de residuos ayuda a conservar los recursos y evita al mismo tiempo efectos perjudiciales en la salud y el medio ambiente.

**Informação sobre a eliminação de pilhas**

Este produto não deve ser eliminado como lixo doméstico geral. Devolva a pilha usada ao revendedor ou entidade autorizada para que a mesma seja devolvida ao fabricante ou importador. A reciclagem e a eliminação de lixo de maneira apropriada ajudarão a conservar os recursos naturais ao mesmo tempo que prevenirão os efeitos prejudiciais à nossa saúde e ao meio ambiente.

**CALIFORNIA, USA ONLY**

This product contains a CR Coin Cell Lithium Battery which contains Perchlorate Material—special handling may apply. See [www.dtsc.ca.gov/hazardouswaste/perchlorate](http://www.dtsc.ca.gov/hazardouswaste/perchlorate)

**FCC WARNING**

This equipment may generate or use radio frequency energy. Changes or modifications to this equipment may cause harmful interference unless the modifications are expressly approved in the instruction manual. The user could lose the authority to operate this equipment if an unauthorized change or modification is made.

**FCC NOTE**

This equipment has been tested and found to comply with the limits for a Class B digital device, pursuant to Part 15 of the FCC Rules. These limits are designed to provide reasonable protection against harmful interference in a residential installation. This equipment may cause harmful interference to radio communications, if it is not installed and used in accordance with the instructions. However, there is no guarantee that interference will not occur in a particular installation. If this equipment does cause harmful interference to radio or television reception, which can be determined by turning the equipment off and on, the user is encouraged to try to correct the interference by one or more of the following measures:

- Reorient or relocate the receiving antenna.
- Increase the separation between the equipment and receiver.
- Connect the equipment into an outlet on a circuit different from that to which the receiver is connected.
- Consult the dealer or an experienced radio/TV technician for help.

**Supplier's Declaration of Conformity**

Trade Name: KENWOOD

Products: DIGITAL MEDIA RECEIVER

Model Name: KMM-BT525HD/KMM-X503/KMM-BT325U/KMM-BT325/  
KMM-BT250U/KMM-BT225U/KMR-M325BT

Responsible Party: JVC KENWOOD USA CORPORATION  
2201 East Dominguez Street, Long Beach, CA 90810, U.S.A.  
PHONE: 310 639-9000

THIS DEVICE COMPLIES WITH PART 15 OF THE FCC RULES. OPERATION IS SUBJECT TO THE FOLLOWING TWO CONDITIONS:

- (1) THIS DEVICE MAY NOT CAUSE HARMFUL INTERFERENCE, AND
- (2) THIS DEVICE MUST ACCEPT ANY INTERFERENCE RECEIVED, INCLUDING INTERFERENCE THAT MAY CAUSE UNDESIRE OPERATION.

**IC (Industry Canada) Notice**

This device complies with Industry Canada's licence-exempt RSSs.

Operation is subject to the following two conditions:

- (1) This device may not cause interference; and
- (2) This device must accept any interference, including interference that may cause undesired operation of the device.

**Note de IC (Industrie Canada)**

Le présent appareil est conforme aux CNR d'Industrie Canada applicables aux appareils radio exempts de licence.

L'exploitation est autorisée aux deux conditions suivantes:

- (1) l'appareil ne doit pas produire de brouillage;
- (2) l'utilisateur de l'appareil doit accepter tout brouillage radioélectrique subi, même si le brouillage est susceptible d'en compromettre le fonctionnement.

Contains Bluetooth Module

**KMM-BT525HD / KMM-X503 / KMM-BT325U /  
KMM-BT325 / KMM-BT250U / KMM-BT225U :**

FCC ID: ZWY8811X

IC ID: 12033A-8811X

**KMR-M325BT :**

FCC ID: ZWY8350X

IC ID: 12033A-8350X

This transmitter must not be co-located or operated in conjunction with any other antenna or transmitter.

**CAUTION**

This equipment complies with FCC/IC radiation exposure limits set forth for an uncontrolled environment and meets the FCC radio frequency (RF) Exposure Guidelines and RSS-102 of the IC radio frequency (RF) Exposure rules. This equipment has very low levels of RF energy that it deemed to comply without maximum permissive exposure evaluation (MPE). But it is desirable that it should be installed and operated keeping the radiator at least 20 cm or more away from person's body.

**ATTENTION**

Cet équipement est conforme aux limites d'exposition aux rayonnements énoncées pour un environnement non contrôlé et respecte les règles les radioélectriques (RF) de la FCC lignes directrices d'exposition et d'exposition aux fréquences radioélectriques (RF) CNR-102 de l'IC. Cet équipement émet une énergie RF très faible qui est considérée comme conforme sans évaluation de l'exposition maximale autorisée (MPE). Cependant, il est souhaitable qu'il devrait être installé et utilisé en gardant une distance de 20 cm ou plus entre le radiateur et le corps humain.

**Para cumplimiento de la IFT:**

"La operación de este equipo está sujeta a las siguientes dos condiciones:

- (1) es posible que este equipo o dispositivo no cause interferencia perjudicial y
- (2) este equipo o dispositivo debe aceptar cualquier interferencia, incluyendo la que pueda causar su operación no deseada"

# SOFTWARE LICENSE AGREEMENT

The software embedded in the Product (hereinafter the "Licensed Software") provided by Licensor is copyrighted to or sublicensable by the Licensor, and this Agreement provides for the terms and conditions which Users shall follow in order to use the Licensed Software.

The User shall use the Licensed Software by agreeing with the terms of this Software License Agreement. This Agreement shall be deemed completed at the time the User (hereinafter the "User") initially used the Product in which the "Licensed Software" is embedded.

The Licensed Software may include the software which has been licensed to the Licensor directly or indirectly from any third party. In such case, some third parties require the Users to follow their conditions for use separately from this Software License Agreement. Such software shall not be subject to this Agreement, and the Users are urged to read the "Important Notice concerning the Software" to be provided separately below.

## Article 1 General Provision

The Licensor shall grant to the User a non-exclusive and non-transferable (other than the exceptional case referred to in Article 3, Paragraph 1) licensed to use the Licensed Software within the country of the User. (the country where the User bought the Product (hereinafter the "Country"))

## Article 2 License

1. The license granted under this Agreement shall be the right to use the Licensed Software in the Product.
2. The User shall not duplicate, copy, modify, add, translate or otherwise alter, or lease the Licensed Software and any related documents, whether in whole or in part.
3. The use of the Licensed Software shall be limited to personal purpose, and the Licensed Software shall not be distributed, licensed or sub-licensed whether it is for commercial purpose or not.
4. The User shall use the Licensed Software according to the directions described in the operation manual or help file, and is prohibited to use or duplicate any data in a manner violating the Copyright Law or any other laws and regulations by applying whole or a part of the Licensed Software.

## Article 3 Conditions for Grant of License

1. When the User transfers the Product, it may also transfer the license to use the Licensed Software embedded in the Product (including any related materials, updates and upgrades) on condition that no original, copies or related materials continue in the possession of the User, and that the User shall cause the transferee to comply with this Software License Agreement.
2. The User shall not carry out reverse engineering, disassembling, decompiling or any other code analysis works in connection with the Licensed Software.

## Article 4 Right pertaining to the Licensed Software

Any and all copyrights and other rights pertaining to the Licensed Software and related documents shall belong to the Licensor or the original holder of the right who granted to the Licensor the license or sublicense for the Licensed Software (hereinafter the "Original Rightholder"), and the User shall not be entitled to any right other than the license granted hereunder, in respect of the Licensed Software and any related documents.

## Article 5 Indemnification of Licensor

1. Neither the Licensor nor the Original Rightholder shall be liable for any damage incurred by the User or any third party due to the exercise of the license granted to the User under this Agreement, unless otherwise restricted by law.
2. The Licensor will offer no guarantee for the merchantability, convertibility and consistency with certain objective of the Licensed Software.

## Article 6 Liability to Third Party

If any dispute has arisen with any third party due to an infringement upon a copyright, patent or any other intellectual property right that was caused by the User's use of the Licensed Software, the User shall settle such dispute at its own cost and hold the Licensor and the Original Rightholder harmless from any inconvenience it may cause.

## Article 7 Confidentiality

The User shall keep the confidentiality of such portion of the Licensed Software, related documents thereof or any other information to be granted under this Agreement, as well as the conditions of this Agreement as has not yet entered the public domain, and shall not disclose or divulge the same to any third party without approval of the Licensor.

## Article 8 Termination

In case the User falls under any of the events described in the following items, the Licensor may immediately terminate this Agreement or claim that the User compensates for the damage incurred by the Licensor due to such event:

- (1) when the User violated any provision of this Agreement; or
- (2) when a petition has been filed against the User for an attachment, provisional attachment, provisional disposition or any other compulsory execution.

## Article 9 Destruction of the Licensed Software

If this Agreement is terminated pursuant to the provision of Article 8, the User shall destroy the Licensed Software, any related documents and copies thereof within two (2) weeks from such date of termination.

#### Article 10 Protection of Copyright

1. The copyright and all the other intellectual property rights relating to the Licensed Software shall belong to the Licensor and the Original Rightholder, and in no event shall they be under the ownership of the User.
2. The User shall, whenever it uses the Licensed Software, comply with any laws relating to the copyright and other intellectual property rights.

#### Article 11 Export Restriction

1. It is prohibited to export the Licensed Software and any related documents outside the country of the User (including transmission thereof outside the country of the User via Internet of other communication tools).
2. The User shall understand that the Licensed Software shall be subject to the export restrictions adopted by the country of User and any other countries.
3. The User shall agree that the software will be subject to any and all applicable international and domestic laws (including the export control regulation of the country of User and any other countries, and any restrictions concerning the end-users, the use by end-users and importing countries to be provided by the country of User and any other countries, and any other governmental authorities).

#### Article 12 Miscellaneous

1. In the event any part of this Agreement is invalidated by operation of law, the residual provisions shall continue in force.
2. Matters not stipulated in this Agreement or any ambiguity or question raised in the construction of this Agreement shall be provided or settled upon good-faith consultation between the Licensor and the User.
3. The Licensor and the User hereby agree that this Agreement is governed by the laws of Japan, and any dispute arising from, and relating to the rights and obligations under, this Agreement shall be submitted to the exclusive jurisdiction of the Tokyo District Court for its first instance.

## Important Notice concerning the Software

-jansson

Copyright (c) 2009-2012 Petri Lehtinen <petri@digip.org>

Permission is hereby granted, free of charge, to any person obtaining a copy of this software and associated documentation files (the "Software"), to deal in the Software without restriction, including without limitation the rights to use, copy, modify, merge, publish, distribute, sublicense, and/or sell copies of the Software, and to permit persons to whom the Software is furnished to do so, subject to the following conditions:

The above copyright notice and this permission notice shall be included in all copies or substantial portions of the Software.

THE SOFTWARE IS PROVIDED "AS IS", WITHOUT WARRANTY OF ANY KIND, EXPRESS OR IMPLIED, INCLUDING BUT NOT LIMITED TO THE WARRANTIES OF MERCHANTABILITY, FITNESS FOR A PARTICULAR PURPOSE AND NONINFRINGEMENT. IN NO EVENT SHALL THE AUTHORS OR COPYRIGHT HOLDERS BE LIABLE FOR ANY CLAIM, DAMAGES OR OTHER LIABILITY, WHETHER IN AN ACTION OF CONTRACT, TORT OR OTHERWISE, ARISING FROM, OUT OF OR IN CONNECTION WITH THE SOFTWARE OR THE USE OR OTHER DEALINGS IN THE SOFTWARE.

-cJSON

Copyright (c) 2009 Dave Gamble

Permission is hereby granted, free of charge, to any person obtaining a copy of this software and associated documentation files (the "Software"), to deal in the Software without restriction, including without limitation the rights to use, copy, modify, merge, publish, distribute, sublicense, and/or sell copies of the Software, and to permit persons to whom the Software is furnished to do so, subject to the following conditions:

The above copyright notice and this permission notice shall be included in all copies or substantial portions of the Software.

THE SOFTWARE IS PROVIDED "AS IS", WITHOUT WARRANTY OF ANY KIND, EXPRESS OR IMPLIED, INCLUDING BUT NOT LIMITED TO THE WARRANTIES OF MERCHANTABILITY, FITNESS FOR A PARTICULAR PURPOSE AND NONINFRINGEMENT. IN NO EVENT SHALL THE AUTHORS OR COPYRIGHT HOLDERS BE LIABLE FOR ANY CLAIM, DAMAGES OR OTHER LIABILITY, WHETHER IN AN ACTION OF CONTRACT, TORT OR OTHERWISE, ARISING FROM, OUT OF OR IN CONNECTION WITH THE SOFTWARE OR THE USE OR OTHER DEALINGS IN THE SOFTWARE.

-CMP

The MIT License (MIT)

Copyright (c) 2014 Charles Gunyon

Permission is hereby granted, free of charge, to any person obtaining a copy of this software and associated documentation files (the "Software"), to deal in the Software without restriction, including without limitation the rights to use, copy, modify, merge, publish, distribute, sublicense, and/or sell copies of the Software, and to permit persons to whom the Software is furnished to do so, subject to the following conditions:

The above copyright notice and this permission notice shall be included in all copies or substantial portions of the Software.

THE SOFTWARE IS PROVIDED "AS IS", WITHOUT WARRANTY OF ANY KIND, EXPRESS OR IMPLIED, INCLUDING BUT NOT LIMITED TO THE WARRANTIES OF MERCHANTABILITY, FITNESS FOR A PARTICULAR PURPOSE AND NONINFRINGEMENT. IN NO EVENT SHALL THE AUTHORS OR COPYRIGHT HOLDERS BE LIABLE FOR ANY CLAIM, DAMAGES OR OTHER LIABILITY, WHETHER IN AN ACTION OF CONTRACT, TORT OR OTHERWISE, ARISING FROM, OUT OF OR IN CONNECTION WITH THE SOFTWARE OR THE USE OR OTHER DEALINGS IN THE SOFTWARE.

# CONTENTS

BEFORE USE	2
BASICS	3
GETTING STARTED	4
1 Select the display language and cancel the demonstration	
2 Set the clock and date	
3 Set the initial settings	
HD Radio™ tuner	6
RADIO	8
USB/iPod/ANDROID	10
AUX	12
Pandora®	13
iHeartRadio®	14
Spotify	15
SiriusXM® Radio	16
BLUETOOTH®	19
AUDIO SETTINGS	27
DISPLAY SETTINGS	30
REFERENCES	32
Maintenance	
More information	
TROUBLESHOOTING	36
INSTALLATION/CONNECTION	39
SPECIFICATIONS	43

# BEFORE USE

## IMPORTANT

- To ensure proper use, please read through this manual before using this product. It is especially important that you read and observe Warnings and Cautions in this manual.
- Please keep the manual in a safe and accessible place for future reference.

## ⚠ WARNING

- Do not operate any function that takes your attention away from safe driving.
- Do not ingest the battery, Chemical Burn Hazard.

The remote control supplied with this product contains a coin/button cell battery.

If the coin/button cell battery is swallowed, it can cause severe internal burns in just 2 hours and can lead to death.

Keep new and used batteries away from children.

If the battery compartment does not close securely, stop using the product and keep it away from children.

If you think batteries might have been swallowed or placed inside any part of the body, seek immediate medical attention.

## ⚠ Caution

### Volume setting:

- Adjust the volume so that you can hear sounds outside the car to prevent accidents.
- Lower the volume before playing digital sources to avoid damaging the speakers by the sudden increase of the output level.

### General:

- Avoid using the external device if it might hinder safe driving.
- Make sure all important data has been backed up. We shall bear no responsibility for any loss of recorded data.
- Never put or leave any metallic objects (such as coins or metal tools) inside the unit to prevent a short circuit.
- USB rating is indicated on the main unit. To view, detach the faceplate. (Page 3)
- Depending on the types of cars, the antenna will automatically extend when you turn on the unit with the antenna control wire connected (page 41). Turn off the unit or change the source to STANDBY when parking at a low ceiling area.

### Remote control (RC-406):

- Do not leave the remote control in hot places such as on the dashboard.
- The Lithium battery is in danger of explosion if replaced incorrectly. Replace it only with the same or equivalent type.
- The battery pack or batteries shall not be exposed to excessive heat such as sunshine, fire or the like.

## How to read this manual

- Operations are explained mainly using buttons on the faceplate of **KMM-BT325U**.
- English indications are used for the purpose of explanation. You can select the display language from the **[FUNCTION]** menu. (Page 5)
- **[XX]** indicates the selected items.
- (Page XX) indicates references are available on the stated page.

# BASICS

## Faceplate

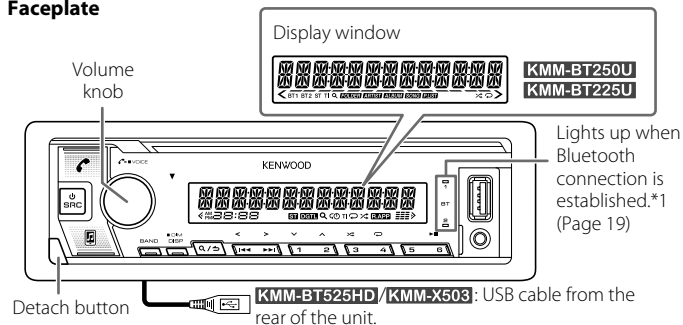

### Attach



### Detach

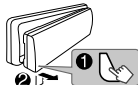

### How to reset

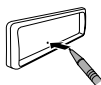

Reset the unit within 5 seconds after detaching the faceplate.

## Remote control (RC-406) (supplied for KMM-BT325U)

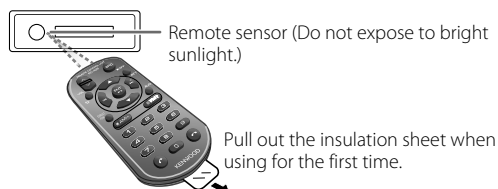

**KMM-BT525HD / KMM-X503 / KMM-BT325U:** Can be remotely controlled with an optionally purchased remote control.

**KMM-BT250U / KMM-BT225U / KMR-M325BT:** Remote control functions are not available.

### How to replace the battery

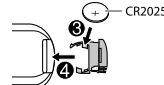
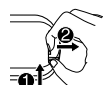

### To

### On the faceplate

### On the remote control

Turn on the power

Press **SRC**.  
• Press and hold to turn off the power.\*2

Press and hold **SRC** to turn off the power.  
(Pressing **SRC** does not turn on the power.)

Adjust the volume

Turn the volume knob.

Press **VOL** **▲** or **VOL** **▼**.  
• Press and hold **VOL** **▲** to continuously increase the volume to 15.

Press **ATT** during playback to attenuate the sound.  
• Press again to cancel.

Select a source

Press **SRC** repeatedly.

Press **SRC** repeatedly.

Change the display information\*3

Press **DISP** repeatedly. (Page 34, 35)

(Not available)

\*1 Only for **KMM-BT525HD / KMM-X503 / KMM-BT325U / KMM-BT325 / KMR-M325BT**.

\*2 For **KMR-M325BT**: The power will automatically turn off after 20 minutes when in standby mode (Auto Power Off).

\*3 For **KMM-BT325U**: You can also turn off the display information by pressing **DISP** repeatedly. (Page 34)

# GETTING STARTED

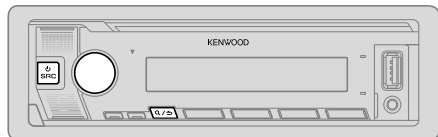

## 1 Select the display language and cancel the demonstration

When you turn on the power for the first time (or [FACTORY RESET] is set to [YES], see page 5), the display shows: "SEL LANGUAGE" → "PRESS" → "VOLUME KNOB"

- 1 Turn the volume knob to select [ENG] (English) or [SPA] (Spanish), then press the knob.  
[ENG] is selected for the initial setup.  
Then, (except for [KMR-M325BT]) the display shows: "CANCEL DEMO" → "PRESS" → "VOLUME KNOB".
- 2 Press the volume knob again.  
[YES] is selected for the initial setup.
- 3 Press the volume knob again.  
"DEMO OFF" appears.

## 2 Set the clock and date

- 1 Press the volume knob to enter [FUNCTION].
- 2 Turn the volume knob to select [CLOCK], then press the knob.

### To adjust the clock

- 3 Turn the volume knob to select [CLOCK ADJUST], then press the knob.
- 4 Turn the volume knob to make the settings, then press the knob.  
Hour → Minute
- 5 Turn the volume knob to select [CLOCK FORMAT], then press the knob.
- 6 Turn the volume knob to select [12H] or [24H], then press the knob.

### To set the date

- 7 Turn the volume knob to select [DATE FORMAT], then press the knob.
- 8 Turn the volume knob to select [DD/MM/YY] or [MM/DD/YY], then press the knob.
- 9 Turn the volume knob to select [DATE SET], then press the knob.
- 10 Turn the volume knob to make the settings, then press the knob.  
Day → Month → Year or Month → Day → Year
- 11 Press and hold **Q/↵** to exit.

To return to the previous setting item, press **Q/↵**.

## 3 Set the initial settings

- 1 Press **⏻SRC** repeatedly to enter STANDBY.
- 2 Press the volume knob to enter [FUNCTION].
- 3 Turn the volume knob to select an item (see the following table), then press the knob.
- 4 Repeat step 3 until the desired item is selected or activated.
- 5 Press and hold **Q/↵** to exit.

To return to the previous setting item, press **Q/↵**.

Default: [XX]

### [AUDIO CONTROL]

#### [SWITCH PREOUT]

(For [KMM-BT250U] / [KMM-BT225U])

[REAR]/[SUB-W]: Selects whether rear speakers or a subwoofer are connected to the line out terminals on the rear (through an external amplifier). (Page 42)



## GETTING STARTED

<b>[DISPLAY]</b>	
<b>[EASY MENU]</b>	<p>(For <b>KMM-BT525HD</b> / <b>KMM-X503</b> / <b>KMM-BT325U</b> / <b>KMM-BT325</b> / <b>KMR-M325BT</b>)</p> <p>When entering <b>[FUNCTION]</b>...</p> <p><b>[ON]</b>: <b>[ZONE 1]</b> illumination changes to white color. ;</p> <p><b>[OFF]</b>: <b>[ZONE 1]</b> illumination remains as <b>[COLOR SELECT]</b> color. (Page 31)</p> <ul style="list-style-type: none"> <li>• <b>[ZONE 2]</b> illumination changes to light blue color when you enter <b>[FUNCTION]</b>, irregardless of the <b>[EASY MENU]</b> setting.</li> <li>• Refer to the illustration on page 30 for zone identification.</li> </ul>
<b>[TUNER SETTING]</b>	
<b>[PRESET TYPE]</b>	<p><b>[NORMAL]</b>: Memorizes one station for each preset button in each band (FM1/FM2/FM3/AM). ; <b>[MIX]</b>: Memorizes one station or SiriusXM channel for each preset button, regardless of the selected band or SiriusXM channel.</p>
<b>[SYSTEM]</b>	
<b>[KEY BEEP]</b>	<b>[ON]</b> : Activates the keypress tone. ; <b>[OFF]</b> : Deactivates.
<b>[SOURCE SELECT]</b>	
<b>[PANDORA SRC]</b>	<b>[ON]</b> : Enables PANDORA/PANDORA FRONT/PANDORA REAR/PANDORA BT in source selection. ; <b>[OFF]</b> : Disables. (Page 13)
<b>[IHEART SRC]</b>	<b>[ON]</b> : Enables IHEARTADIO/IHEARTADIO-F/IHEARTADIO-R in source selection. ; <b>[OFF]</b> : Disables. (Page 14)
<b>[SPOTIFY SRC]</b>	<b>[ON]</b> : Enables SPOTIFY/SPOTIFY FRONT/SPOTIFY REAR/SPOTIFY BT in source selection. ; <b>[OFF]</b> : Disables. (Page 15)
<b>[BUILT-IN AUX]</b>	<b>[ON]</b> : Enables AUX in source selection. ; <b>[OFF]</b> : Disables. (Page 12)

<b>[F/W UPDATE]</b>	
<b>[UPDATE SYSTEM]/[UPDATE HD]</b> (for <b>KMM-BT525HD</b> / <b>KMM-X503</b> )	
<b>[F/W UP xxxx]</b>	<p><b>[YES]</b>: Starts upgrading the firmware. ; <b>[NO]</b>: Cancels (upgrading is not activated).</p> <p>For details on how to update the firmware, visit <a href="http://www.kenwood.com/cs/ce/&gt;">www.kenwood.com/cs/ce/&gt;</a>.</p>
<b>[FACTORY RESET]</b>	<p><b>[YES]</b>: Resets the settings to default (except the stored station). ;</p> <p><b>[NO]</b>: Cancels.</p>
<b>[CLOCK]</b>	
<b>[CLOCK DISPLAY]</b>	<p>(Except for <b>KMR-M325BT</b>)</p> <p><b>[ON]</b>: The clock time is shown on the display even when the unit is turned off. ; <b>[OFF]</b>: Cancels.</p>
<b>[ENGLISH]</b>	Select the display language for <b>[FUNCTION]</b> menu and music information if applicable.
<b>[ESPAÑOL]</b>	By default, <b>[ENGLISH]</b> is selected.

### Register the marine remote ID (for **KMR-M325BT**)

Applicable only when you connect KENWOOD Marine Remote Control unit (KCA-RC55MR, optional accessory) to this unit.

- For connection, see "Connecting external components" on page 42.
- Refer also to the supplied instruction manual of the KENWOOD Marine Remote Control unit for more information.

## GETTING STARTED

### Preparation:

Press **SRC** repeatedly to enter STANDBY, then press the volume knob to enter [FUNCTION].

- 1 Turn the volume knob to select an item, then press the knob.

[SYSTEM] → [REM SETTING] → [REMOTE ID SET]

Remote control ID list is displayed.

- [YES] indicates that this ID is already registered.
- [NO] indicates that this ID is available.

- 2 Turn the volume knob to select an available ID [REM ID1]/[REM ID2]/[REM ID3], then press the knob.

"REGISTERING" appears on the display window.

To register, on the KENWOOD Marine Remote Control unit:

- Press ENTER to register as [REM ID1].
- Press SRC to register as [REM ID2].
- Press DISP to register as [REM ID3].

Once the ID is registered, "COMPLETED" appears.

### To delete the registered ID

- 1 Turn the volume knob to select an item, then press the knob.

[SYSTEM] → [REM SETTING] → [REMOTE ID DEL]

- 2 Turn the volume knob to select the ID to delete [ID1 DELETE]/[ID2 DELETE]/[ID3 DELETE], then press the knob.

- 3 Turn the volume knob to select [YES] to delete the selected ID, and select [NO] to cancel.

- To exit, press and hold **Q/△**.
- To return to the previous setting item, press **Q/△**.

## HD Radio™ tuner (for [KMM-BT525HD]/[KMM-X503])

You can tune in to both conventional and HD Radio broadcasts.

- To find HD Radio stations in your area, visit <<http://www.hdradio.com>>.

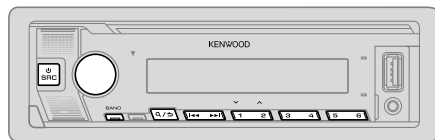

### Search for a station

- 1 Press **SRC** repeatedly to select HD RADIO.
- 2 Press **BAND** repeatedly (or press #FM+/\*AM- on the remote control) to select FM1/FM2/FM3/AM.
- 3 Press **◀▶** (or press **◀▶** (+) on the remote control) to search for a station or channel.

You can store up to 18 stations/channels for FM and 6 stations/channels for AM.

- **To store a station or channel:** Press and hold one of the number buttons (1 to 6).
- **To select a stored station or channel:** Press one of the number buttons (1 to 6) (or press one of the number buttons (1 to 6) on the remote control).

### Direct Access Tuning (using the remote control)

- 1 Press **DIRECT** to enter Direct Access Tuning.
  - 2 Press the number buttons to enter a station frequency or channel number.
  - 3 Press **ENT▶▶** to search for station or channel.
- To cancel, press **△** or **DIRECT**.
  - If no operation is done for 10 seconds after step 2, Direct Access Tuning is automatically canceled.

### Select an HD Radio multicast channel

Many HD Radio stations offer more than one channel programming. This service is called multicasting. While receiving HD Radio multicast channels...

Press **◀◀ / ▶▶** to select your desired channel (HD1 to HD8).

"LINKING" appears while linking to a multicast channel.

### Receive an Emergency Alert message

You can receive an emergency alert message while listening to another source or while in STANDBY, via HD Radio Broadcast.

#### Activate emergency alert message reception

- 1 Press the volume knob to enter [FUNCTION].
- 2 Turn the volume knob to select [TUNER SETTING], then press the knob.
- 3 Turn the volume knob to select [EA], then press the knob.
- 4 Turn the volume knob to select [ON], then press the knob.
- 5 Press and hold **Q/↵** to exit.

- To deactivate emergency alert message reception, select [OFF] in step 4.
- To return to the previous setting item, press **Q/↵**.

#### Receive an emergency alert message

When an emergency alert message is received, it appears and remains on the display until the user performs the "Ignore" function.

- Press **⏻SRC** (or press SRC on the remote control) to ignore the alert message.  
The same emergency alert message will not interrupt again for 12 hours.

#### Display received emergency alert messages

The received emergency alert messages are stored in the Alert Message List, and you can check them later. While listening to the HD RADIO source...

- 1 Press **Q/↵** to display the Alert Message List.
- 2 Turn the volume knob to select a message.
- 3 Press the volume knob to display the information related to the message.
- 4 Press **Q/↵** again to exit.

- "NO LIST" appears when the list is empty.
- This feature can store up to four messages in the list.
- To clear the message list, set [FACTORY RESET] to [YES]. (Page 5)

#### Other settings

- 1 Press the volume knob to enter [FUNCTION].
- 2 Turn the volume knob to select an item (page 8), then press the knob.
- 3 Repeat step 2 until the desired item is selected/activated or follow the instructions stated on the selected item.
- 4 Press and hold **Q/↵** to exit.

To return to the previous setting item, press **Q/↵**.

## HD Radio™ tuner (for KMM-BT525HD/KMM-X503)

Default: [XX]

[TUNER SETTING]	
[SEEK MODE]	Selects the searching method for <b>◀◀ / ▶▶</b> buttons when pressed. [AUTO1]: Automatically search for a station or channel. ; [AUTO2]: Search for a preset station or channel. ; [MANUAL]: Manually search for a station or channel.
[IF BAND]	[AUTO]: Increases the tuner selectivity to reduce interference noises from adjacent FM stations. (Stereo effect may be lost.) ; [WIDE]: Subjects to interference noises from adjacent FM stations, but sound quality will not be degraded and the stereo effect will remain.
[AUTO MEMORY]	[YES]: Automatically starts memorizing 6 stations with good reception. ; [NO]: Cancels. • Selectable only if [NORMAL] is selected for [PRESET TYPE]. (Page 5)
[RECEIVE MODE]	Sets the receive mode of the HD Radio receiver. [AUTO]: Automatically tunes to analog broadcast when there is no digital broadcast. ; [DIGITAL]: Tunes in to digital broadcast only. ; [ANALOG]: Tunes in to analog broadcast only.
[CLOCK]	
[TIME SYNC]	[ON]: Synchronizes the unit's time to the Radio Broadcast Data System station time. ; [OFF]: Cancels.

## RADIO (for KMM-BT325U/KMM-BT325/KMM-BT250U/KMM-BT225U/KMR-M325BT)

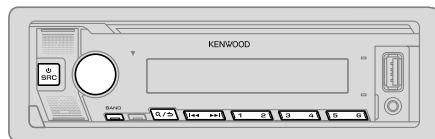

- “ST” lights up when receiving an FM stereo broadcast with sufficient signal strength.
- The unit switches to FM alarm automatically when receiving an alarm signal from FM broadcast.

### Search for a station

- 1 Press **SRC** repeatedly to select RADIO.
- 2 Press **BAND** repeatedly (or press **#FM+/\*AM-** on the remote control) to select FM1/FM2/FM3/AM.
- 3 Press **◀◀ / ▶▶** (or press **◀◀ / ▶▶ (+)** on the remote control) to search for a station.

You can store up to 18 stations for FM and 6 stations for AM.

- **To store a station:** Press and hold one of the number buttons (1 to 6).
- **To select a stored station:** Press one of the number buttons (1 to 6) (or press one of the number buttons (1 to 6) on the remote control).

### Direct Access Tuning (using the remote control)

- 1 Press **DIRECT** to enter Direct Access Tuning.
  - 2 Press the number buttons to enter a station frequency.
  - 3 Press **ENT ▶▶** to search for a station.
- To cancel, press **↶** or **DIRECT**.
  - If no operation is done for 10 seconds after step 2, Direct Access Tuning is automatically canceled.

## RADIO (for **KMM-BT325U**/**KMM-BT325**/**KMM-BT250U**/**KMM-BT225U**/**KMR-M325BT**)

### Other settings

- 1 Press the volume knob to enter [FUNCTION].
- 2 Turn the volume knob to select an item (see the following table), then press the knob.
- 3 Repeat step 2 until the desired item is selected/activated or follow the instructions stated on the selected item.
- 4 Press and hold **Q**/**↵** to exit.

To return to the previous setting item, press **Q**/**↵**.

Default: **[XX]**

[TUNER SETTING]	
[SEEK MODE]	Selects the searching method for <b>◀◀</b> / <b>▶▶</b> buttons when pressed. <b>[AUTO1]</b> : Automatically search for a station. ; <b>[AUTO2]</b> : Search for a preset station. ; <b>[MANUAL]</b> : Manually search for a station.
[AUTO MEMORY]	<b>[YES]</b> : Automatically starts memorizing 6 stations with good reception. ; <b>[NO]</b> : Cancels. • Selectable only if <b>[NORMAL]</b> is selected for <b>[PRESET TYPE]</b> . (Page 5)
[MONO SET]	<b>[ON]</b> : Improves the FM reception, but the stereo effect will be lost. ; <b>[OFF]</b> : Cancels.
[NEWS SET]	(For <b>KMM-BT325</b> ) <b>[ON]</b> : The unit will temporarily switch to News Programme if available. ; <b>[OFF]</b> : Cancels.
[REGIONAL]	(For <b>KMM-BT325</b> ) <b>[ON]</b> : Switches to another station only in the specific region using the "AF" control. ; <b>[OFF]</b> : Cancels.
[AF SET]	(For <b>KMM-BT325</b> ) <b>[ON]</b> : Automatically searches for another station broadcasting the same program in the same Radio Data System network with better reception when the current reception is poor. ; <b>[OFF]</b> : Cancels.

[TI]	<b>[ON]</b> : Allows the unit to temporarily switch to Traffic Information if available ("TI" lights up). ; <b>[OFF]</b> : Cancels.
[PTY SEARCH]	(For <b>KMM-BT325U</b> / <b>KMM-BT250U</b> / <b>KMM-BT225U</b> / <b>KMR-M325BT</b> ) Select the available Program Type (for Radio Broadcast Data System, see page 33), then press <b>◀◀</b> / <b>▶▶</b> to start.  (For <b>KMM-BT325</b> ) <b>1</b> Turn the volume knob to select the available Program Type (for Radio Data System, see page 33), then press the knob. <b>2</b> Turn the volume knob to select the PTY language ( <b>[ENGLISH]</b> / <b>[FRENCH]</b> / <b>[GERMAN]</b> ), then press the knob. <b>3</b> Press <b>◀◀</b> / <b>▶▶</b> to start searching.
[CLOCK]	
[TIME SYNC]	<b>[ON]</b> : Synchronizes the unit's time to the Radio Broadcast Data System/Radio Data System station time. ; <b>[OFF]</b> : Cancels.

- **[MONO SET]**/**[NEWS SET]**/**[REGIONAL]**/**[AF SET]**/**[TI]**/**[PTY SEARCH]** is selectable only when the band is FM1/FM2/FM3.
- If the volume is adjusted during reception of traffic information or news bulletin, the adjusted volume is memorized automatically. It will be applied the next time traffic information or news bulletin is turned on.

# USB/iPod/ANDROID

Selectable source:

- **KMM-BT525HD / KMM-X503**: USB FRONT/USB REAR/  
iPod FRONT/iPod REAR/ANDROID FRONT/ANDROID  
REAR
- **KMM-BT325U / KMM-BT325 / KMM-BT250U /  
KMM-BT225U / KMR-M325BT**: USB/iPod USB/  
ANDROID

## Start playback

The source changes automatically and playback starts.

USB input terminal

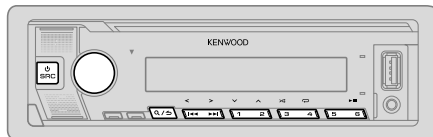
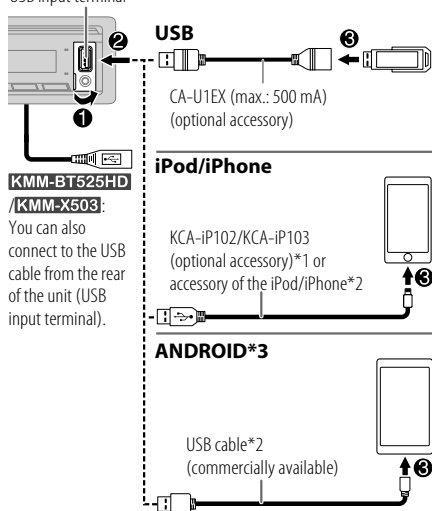

To	On the faceplate	On the remote control
Play back/pause	Press 6 ►  .	Press ENT ►  .
Reverse/Fast-forward*4	Press and hold ◀◀ / ▶▶.	Press and hold ◀◀ / ▶▶ (+).
Select a file	Press ◀◀ / ▶▶.	Press ◀◀ / ▶▶ (+).
Select a folder*5	Press 2 ^ / 1 v.	Press #FM+/*AM-.
Repeat play*4*6	Press 4 ↺ repeatedly. [FILE REPEAT]/[FOLDER REPEAT]/[ALL REPEAT]: MP3/WMA/AAC/WAV/FLAC file [FILE REPEAT]/[FOLDER REPEAT]/[REPEAT OFF]: iPod	
Random play*4*6	Press 3 ↻ repeatedly. [FOLDER RANDOM]/[RANDOM OFF]: MP3/WMA/AAC/WAV/FLAC file or iPod	
	Press and hold 3 ↻ to select [ALL RANDOM].	

\*1 KCA-iP102: 30-pin type, KCA-iP103: Lightning type

\*2 Do not leave the cable inside the car when not used.

\*3 You can control Android device using the Android device itself via other media player application installed in the Android device.

\*4 Not applicable for ANDROID.

\*5 This does not work for iPod/ANDROID.

\*6 For iPod: Applicable only when [MODE OFF] is selected. (Page 11)

## USB/iPod/ANDROID

### Select music drive

While in USB/USB FRONT/USB REAR source, press 5 repeatedly.

Stored songs in the following drive will be played back.

- Selected internal or external memory of a smartphone (Mass Storage Class).
- Selected drive of a multiple drive device.

### Settings to use KENWOOD Remote application

KENWOOD Remote application is designed to control the KENWOOD car receiver's operations from the iPhone/iPod (via USB input terminal).

- For **KMM-BT525HD/KMM-X503/KMM-BT325U/KMM-BT325/KMR-M325BT**, "R.APP" indicator on the display window lights up when KENWOOD Remote application is connected.

#### Preparation:

- Install the latest version of KENWOOD Remote application on your device before connecting.
- For more information, visit <[www.kenwood.com/cs/ce/](http://www.kenwood.com/cs/ce/)>.

You can make the settings in the same way as connection via Bluetooth. (Page 25)

### Listen to TuneIn Radio/TuneIn Radio Pro

While listening to TuneIn Radio or TuneIn Radio Pro, connect the iPod/iPhone to the USB input terminal of the unit.

- The unit will output the sound from these applications.

### Select control mode

While in iPod USB/iPod FRONT/iPod REAR source (or iPod BT source), press 5 repeatedly.

**[MODE ON]:** Control iPod using the iPod itself. However, you can still perform play/pause, file skip, fast-forward or fast-reverse from this unit.

**[MODE OFF]:** Control iPod from this unit.

### Select a file from a folder/list

For iPod, applicable only when [MODE OFF] is selected.

- 1 Press **Q/↵**.
- 2 Turn the volume knob to select a folder/list, then press the knob.
- 3 Turn the volume knob to select a file, then press the knob.

#### Quick search (applicable only for USB/USB FRONT/USB REAR source)

If you have many files, you can search through them quickly.

Turn the volume knob quickly to browse through the list quickly.

#### Skip search (applicable only for iPod USB/iPod FRONT/iPod REAR source or iPod BT source)

Press **◀◀ / ▶▶** to search at a preset skip search ratio. (Page 12)

- Pressing and holding **◀◀ / ▶▶** searches at a 10% ratio.

#### Alphabet search (applicable only for iPod USB/iPod FRONT/iPod REAR source or iPod BT source)

You can search for a file according to the first character.

- 1 Turn the volume knob quickly to enter character search.
- 2 Turn the volume knob to select the character.
  - Select **"\*"** to search for a character other than A to Z, 0 to 9.
- 3 Press **◀◀ / ▶▶** to move to the entry position.
  - You can enter up to 3 characters.
- 4 Press the volume knob to start searching.

- To return to the root folder/first file/top menu, press 5. (Not applicable for BT AUDIO source.)
- To return to the previous setting item, press **Q/↵**.
- To cancel, press and hold **Q/↵**.

## USB/iPod/ANDROID

### Direct Music Search (using the remote control)

- 1 Press DIRECT.
  - 2 Press the number buttons to enter a file number.
  - 3 Press ENT ►|| to search for music.
- To cancel, press ⏮ or DIRECT.
  - Not available if Random Play is selected.
  - Not applicable for iPod USB/iPod FRONT/iPod REAR and ANDROID/ANDROID FRONT/ANDROID REAR source.

### Other settings

- 1 Press the volume knob to enter [FUNCTION].
- 2 Turn the volume knob to select an item (see the following table), then press the knob.
- 3 Repeat step 2 until the desired item is selected or activated.
- 4 Press and hold Q/⏮ to exit.

To return to the previous setting item, press Q/⏮.

Default: [XX]

[USB]	
[MUSIC DRIVE]	[DRIVE CHANGE]: The next drive ([DRIVE 1] to [DRIVE 4]) is selected automatically and playback starts. Repeat steps 1 to 3 to select the following drives.
[SKIP SEARCH]	[0.5%]/[1%]/[5%]/[10%]: While listening to iPod USB/iPod FRONT/iPod REAR source (or iPod BT source), selects the skip search ratio over the total files.

## AUX

### Preparation:

- Select [ON] for [BUILT-IN AUX] in [SOURCE SELECT]. (Page 5)

### Start listening

- 1 Connect a portable audio player (commercially available).

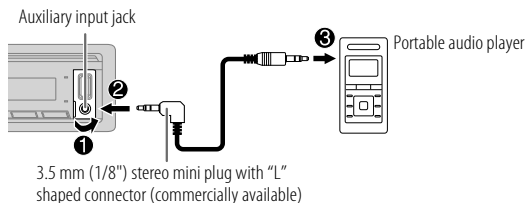

- 2 Press SRC repeatedly to select AUX.
- 3 Turn on the portable audio player and start playback.

### Set the AUX name

While listening to a portable audio player connected to the unit...

- 1 Press the volume knob to enter [FUNCTION].
- 2 Turn the volume knob to select [SYSTEM], then press the knob.
- 3 Turn the volume knob to select [AUX NAME SET], then press the knob.
- 4 Turn the volume knob to select an item, then press the knob.  
[AUX] (default)/[DVD]/[PORTABLE]/[GAME]/[VIDEO]/[TV]
- 5 Press and hold Q/⏮ to exit.

To return to the previous setting item, press Q/⏮.



## Preparation:

Install the latest version of the Pandora application on your device (iPhone/iPod touch), then create an account and log in to Pandora.

- Select [ON] for [PANDORA SRC] in [SOURCE SELECT]. (Page 5)

## Start listening

- 1 Start up the Pandora application on your device.
- 2 Connect your device to the USB input terminal.

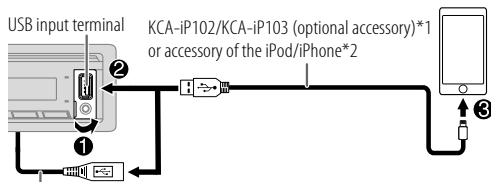

**KMM-BT525HD/KMM-X503**: You can also connect to the USB cable from the rear of the unit.

- 3 Press **⏻SRC** repeatedly to select PANDORA/PANDORA FRONT/PANDORA REAR.  
Broadcast starts automatically.

To	On the faceplate	On the remote control
Play back/pause	Press 6 <b>▶▶</b> .	Press ENT <b>▶▶</b> .
Skip a track	Press <b>▶▶</b> .	Press <b>▶▶</b> (+).
Select thumbs up or thumbs down*3	Press 2 <b>^</b> / 1 <b>∇</b> .	Press #FM+/*AM-.

\*1 KCA-iP102: 30-pin type, KCA-iP103: Lightning type

\*2 Do not leave the cable inside the car when not used.

\*3 If thumbs down is selected, the current track is skipped.

## Create and store a new station

- 1 Press **Q/↵**.
- 2 Turn the volume knob to select [NEW STATION], then press the knob.
- 3 Turn the volume knob to select [FROM ARTIST] or [FROM TRACK], then press the knob.  
A new station is created based on the current artist or current song.
- 4 Press and hold one of the number buttons (3, 4 or 5) to store.

**To select a stored station:** Press one of the number buttons (3, 4 or 5).

## Search for a registered station

- 1 Press **Q/↵**.
  - 2 Turn the volume knob to select an item, then press the knob.  
[SORT BY DATE]: According to the registered date  
[SORT BY A-Z]: By alphabetical order
  - 3 Turn the volume knob (or press **▲** / **▼** on the remote control) to select the desired station.
  - 4 Press the volume knob (or press ENT **▶▶** on the remote control) to confirm.
- To cancel, press and hold **Q/↵**.

## Bookmark current song information

Press and hold the volume knob.

"BOOKMARKED" appears and the information is stored to your device.

- The bookmark is available on your Pandora account but not on this unit.

## Delete a station

While listening to PANDORA...

- 1 Press **Q/↵**.
- 2 Turn the volume knob to select [STATION DEL], then press the knob.
- 3 Turn the volume knob to select [SORT BY DATE] or [SORT BY A-Z], then press the knob.
- 4 Turn the volume knob to select the desired station to delete, then press the knob.
- 5 Turn the volume knob to select [YES], then press the knob.
- 6 Press and hold **Q/↵** to exit.

To return to the previous setting item, press **Q/↵**.

## Preparation:

Install the latest version of iHeartAuto application on your device (iPhone/iPod touch), then create an account and log in to iHeartRadio.

- Select [ON] for [IHEART SRC] in [SOURCE SELECT]. (Page 5)

## Start listening

- 1 Start up the iHeartAuto application on your device.
- 2 Connect your device to the USB input terminal.

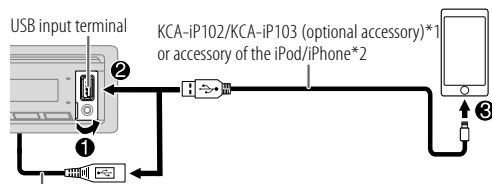

**KMM-BT525HD / KMM-X503**: You can also connect to the USB cable from the rear of the unit.

- 3 Press **SRC** repeatedly to select IHEARTRADIO/IHEARTRADIO-F/IHEARTRADIO-R.  
Broadcast starts automatically

\*1 KCA-iP102: 30-pin type, KCA-iP103: Lightning type

\*2 Do not leave the cable inside the car when not used.

To	On the faceplate	On the remote control
Play back/pause	Press 6 <b>▶  </b> .	Press ENT <b>▶  </b> .
Skip a track for custom station	Press <b>▶ </b> .	Press <b>▶ </b> (+).
Select thumbs up or thumbs down	Press 2 <b>^</b> / 1 <b>v</b> .	( Not available )
Create a new/custom station	Press and hold 1.	( Not available )
Scan for live station	<ol style="list-style-type: none"> <li>1 Press and hold 2 to start scanning.</li> <li>2 Press and hold 2 again to listen to the station.</li> </ol>	( Not available )

## Search and store a station

- 1 Press **Q/△**.
- 2 Turn the volume knob to select a category, then press the knob.
- 3 Turn the volume knob (or press **▲** / **▼** on the remote control) to select the desired station.
- 4 Press the volume knob (or press ENT **▶||** on the remote control) to confirm.  
When a city list appears, you can search cities in alphabetical order by turning the volume knob quickly.

To cancel, press and hold **Q/△**.

**To store a station:** Press and hold one of the number buttons (3, 4 or 5).

**To select a stored station:** Press one of the number buttons (3, 4 or 5).

# Spotify

## Preparation:

Install the latest version of the Spotify application on your device (iPhone/iPod touch), then create an account and log in to Spotify.

- Select [ON] for [SPOTIFY SRC] in [SOURCE SELECT]. (Page 5)

## Start listening

- 1 Start up the Spotify application on your device.
- 2 Connect your device to the USB input terminal.

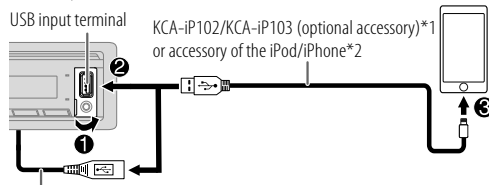

**KMM-BT525HD / KMM-X503**: You can also connect to the USB cable from the rear of the unit.

- 3 Press **SRC** repeatedly to select SPOTIFY/SPOTIFY FRONT/SPOTIFY REAR.  
Broadcast starts automatically

To	On the faceplate	On the remote control
Play back/pause	Press 6 <b>▶  </b> .	Press ENT <b>▶  </b> .
Skip a track	Press 1 <b>◀◀*3 / ▶▶</b> .	Press 1 <b>◀◀*3 / ▶▶ (+)</b> .
Select thumbs up or thumbs down*4	Press 2 <b>▲ / 1 ▼</b> .	Press #FM+/*AM-.
Start radio	Press and hold 5.	( Not available )
Repeat play*5	Press 4 <b>↺</b> repeatedly. [REPEAT ALL], [REPEAT ONE]*3, [REPEAT OFF]	( Not available )

To	On the faceplate	On the remote control
Random play*5	Press 3 <b>⌂</b> repeatedly*3. [SHUFFLE ON], [SHUFFLE OFF]	( Not available )

\*1 KCA-iP102: 30-pin type, KCA-iP103: Lightning type

\*2 Do not leave the cable inside the car when not used.

\*3 Available for premium account users only.

\*4 This feature is available for tracks in Radio only. If thumbs down is selected, the current track is skipped.

\*5 Available for tracks in Playlists only.

## Save favorite song information

While listening to the Radio on Spotify...

**Press and hold the volume knob.**

"SAVED" appears and the information is stored to "Your Music" or "Your Library" on your Spotify account.

To unsave, repeat the same procedure.

"REMOVED" appears and the information is removed from "Your Music" or "Your Library" on your Spotify account.

## Search for a song or station

- 1 Press **Q/⌂**.
- 2 Turn the volume knob to select a list type, then press the knob.  
The list types displayed differ depending on the information sent from Spotify.
- 3 Turn the volume knob (or press **▲ / ▼** on the remote control) to select the desired song or station.
- 4 Press the volume knob (or press ENT **▶||** on the remote control) to confirm.  
You can browse through the list quickly by turning the volume knob quickly.

To cancel, press and hold **Q/⌂**.

# SiriusXM® Radio (for KMM-BT525HD/KMM-X503/KMM-BT325U/KMR-M325BT)

Only SiriusXM® brings you more of what you love to listen to, all in one place. Get over 140 channels, including commercial-free music plus the best sports, news, talk, comedy and entertainment. Welcome to the world of satellite radio. A SiriusXM Vehicle Tuner and Subscription are required. For more information, visit <[www.siriusxm.com](http://www.siriusxm.com)>.

## Preparation:

- 1 Connect the optional SiriusXM Vehicle Tuner (commercially available).

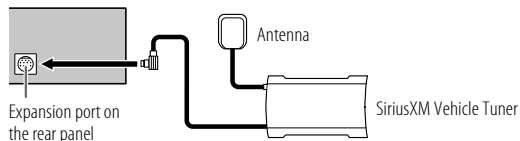

- 2 Check your Radio ID for activation.

The SiriusXM Radio ID is required for activation and can be found by tuning to Channel 0 as well as on the label found on the SiriusXM Vehicle Tuner and its packaging.

The Radio ID does not include the letters I, O, S or F.

- 3 Activate the subscription.

For users in the U.S.A.:

Online: Go to <[www.siriusxm.com](http://www.siriusxm.com)>

Phone: Call 1-866-635-2349

For users in Canada:

Online: Go to <[www.siriusxm.ca/subscribe-now](http://www.siriusxm.ca/subscribe-now)>

Phone: Call 1-877-438-9677

- 4 Press SRC repeatedly to select SIRIUS XM to start updating.

## Start listening

- 1 Press SRC repeatedly to select SIRIUS XM.
- 2 Press BAND repeatedly to select a band.
- 3 Press Q / .  
"Q" lights up.
- 4 Turn the volume knob to select a category, then press the knob.  
If "ALL CHANNELS" is selected, all the available channels will be shown.
- 5 Turn the volume knob to select a channel, then press the knob.  
(or)  
Press to search for a channel manually.
  - Pressing and holding changes the channel rapidly.

If a locked channel or a mature channel is selected, a pass code input screen appears. Enter the pass code to receive the channel. (Page 18)

## Direct Access Tuning (using the remote control)

- 1 Press DIRECT to enter Direct Access Tuning.
  - 2 Press the number buttons to enter a channel number.
  - 3 Press ENT to search for the channel.
- To cancel, press or DIRECT.
  - If no operation is done for 10 seconds after step 2, Direct Access Tuning is automatically canceled.

**SiriusXM Keymode**

Press and hold the volume knob to change the keymode (channel or replay). (Default: Channel keymode)

⏮️ lights up when replay keymode is selected.

When channel keymode is selected...

To	On the faceplate	On the remote control
Select a channel	Press <b>◀◀</b> / <b>▶▶</b> .	Press <b>◀◀</b> / <b>▶▶</b> (+).
Change a channel rapidly	Press and hold <b>◀◀</b> / <b>▶▶</b> .	Press and hold <b>◀◀</b> / <b>▶▶</b> (+).
Store a channel of the current band	Press and hold one of the number buttons (1 to 6).	(Not available)
Select a stored channel of the current band	Press one of the number buttons (1 to 6).	Press one of the number buttons (1 to 6).

When replay keymode is selected...

To	On the faceplate	On the remote control
Play back/pause	Press <b>6</b> <b>▶▶</b> .	Press <b>ENT</b> <b>▶▶</b> .
Skip backward/forward	Press <b>◀◀</b> / <b>▶▶</b> .	Press <b>◀◀</b> / <b>▶▶</b> (+).
Rewind/Fast-forward	Press and hold <b>◀◀</b> / <b>▶▶</b> .	Press and hold <b>◀◀</b> / <b>▶▶</b> (+).
Go to Live	Press 1.	Press 1.

**SmartFavorites and TuneStart™**

User stored channels are recognized as SmartFavorite channels\*. The SiriusXM Vehicle Tuner automatically buffers the broadcast content in the background.

- SmartFavorites feature is available with SXV200 or later SiriusXM Vehicle Tuner.

\* SXV300 (and later) SiriusXM Vehicle Tuner can use all 18 stored channels as SmartFavorites. The SXV200 SiriusXM Vehicle Tuner can use 6 stored channels from the current band as SmartFavorites.

When you select a SmartFavorite channel, you can rewind and replay up to 30 minutes of any of the missed news, talk, sports or music content.

- Playback starts from the beginning of the song if **[TUNE START]** is set to **[ON]** (page 18) for most music channels stored as a SmartFavorite.

**Press one of the number buttons (1 to 6) to select a stored channel.**

**TuneScan™**

You can get a short preview of the songs that you have missed on each of your SmartFavorites music channels or a music channel currently tuned into.

**Press and hold BAND to start scanning the first 6 seconds of the recorded music contents.**

- To listen to the current song, press the volume knob to stop scanning. The unit continues playing the current song.
- To select the previous/next song, press **◀◀** / **▶▶**.
- To cancel scanning, press and hold the volume knob. Playback returns to the channel before you entered TuneScan.

## SiriusXM® Radio (for **KMM-BT525HD**/**KMM-X503**/**KMM-BT325U**/**KMR-M325BT**)

### SiriusXM settings

- 1 Press the volume knob to enter [FUNCTION].
- 2 Turn the volume knob to select an item (see the following table), then press the knob.
- 3 Repeat step 2 until the desired item is selected/activated or follow the instructions stated on the selected item.
- 4 Press and hold **Q/S** to exit.

To return to the previous setting item, press **Q/S**.

Default: **[XX]**

[SIRIUS XM]	
[SEEK MODE]	Selects the tuning method for <b>◀◀</b> / <b>▶▶</b> buttons when pressed. <b>[CHANNEL]</b> : Manually search for a channel. ; <b>[PRESET]</b> : Search for a preset channel of the selected band.
[CHANNEL LOCK]	To unlock settings: <ol style="list-style-type: none"> <li>1 Turn the volume knob to select a number.</li> <li>2 Press <b>◀◀</b> / <b>▶▶</b> to move to the entry position.</li> <li>3 Repeat steps 1 and 2 to enter the current pass code. (Initial pass code is 0000.)</li> <li>4 Press the volume knob to confirm.</li> </ol>
[CODE SET]	<ol style="list-style-type: none"> <li>1 Turn the volume knob to select a number.</li> <li>2 Press <b>◀◀</b> / <b>▶▶</b> to move to the entry position.</li> <li>3 Repeat steps 1 and 2 to enter a new 4-digit pass code.</li> <li>4 Press the volume knob to confirm.</li> <li>5 Repeat steps 1 to 4 to reconfirm the pass code.</li> </ol> <ul style="list-style-type: none"> <li>• Make a note of the new pass code to enter channel lock settings for next time.</li> </ul>

[LOCK SETTING]	<b>[MATURE CH]</b> : Selects the SiriusXM-defined lock setting. ; <b>[USER DEFINED]</b> : Selects the individual channels the user wants to lock. ; <b>[OFF]</b> : Cancels.
[CHANNEL EDIT]*1	<ol style="list-style-type: none"> <li>1 Turn the volume knob to select a category, then press the knob.</li> <li>2 Turn the volume knob to select a channel you want to lock, then press the knob. "L" appears in front of the channel number.</li> <li>3 Press and hold <b>Q/S</b> to exit.</li> </ol>
[CHANNEL CLEAR]*1	<b>[YES]</b> : Clears all the locked channels. ; <b>[NO]</b> : Cancels.
[TUNE START]*2	<b>[ON]</b> : All qualified music channels in the SmartFavorites will start playback from the beginning of the song. ; <b>[OFF]</b> : Cancels.
[SIGNAL LEVEL]	Shows the strength ( <b>[NO SIGNAL]</b> / <b>[WEAK]</b> / <b>[GOOD]</b> / <b>[STRONG]</b> ) of the current received signal.
[BUFFER USAGE]	Shows the memory usage ( <b>[0%]</b> to <b>[100%]</b> ) for Replay buffer.
[SXM RESET]	<b>[YES]</b> : Resets all SiriusXM settings to default. ; <b>[NO]</b> : Cancels.

\*1 Displayed only when **[LOCK SETTING]** is set to **[USER DEFINED]**.

\*2 Available only if the connected SiriusXM Vehicle Tuner is SXV200 or later that supports SmartFavorites.

# BLUETOOTH®

## BLUETOOTH — Connection

### Supported Bluetooth profiles

- Hands-Free Profile (HFP)
- Advanced Audio Distribution Profile (A2DP)
- Audio/Video Remote Control Profile (AVRCP)
- Serial Port Profile (SPP)
- Phonebook Access Profile (PBAP)

### Supported Bluetooth codecs

- Sub Band Codec (SBC)
- Advanced Audio Coding (AAC)
- aptX codec (Qualcomm® aptX™) (for **KMR-M325BT**)

### Connect the microphone

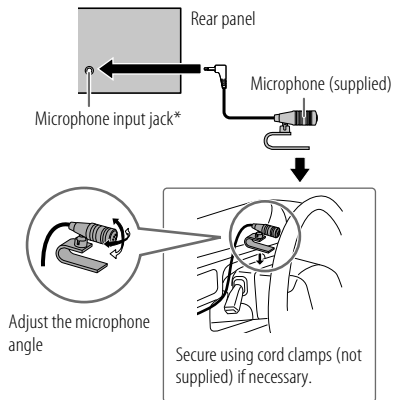

\* For the location of the microphone input terminal/microphone input jack, refer to page 42.

Depending on the operating system and the firmware version of your mobile phone, Bluetooth features may not work with this unit.

### Pair and connect a Bluetooth device for the first time

- 1 Press **⏻SRC** to turn on the unit.
- 2 Search and select the name of your receiver ("**KMM-BT5\***" / "**KMM-X5\***" / "**KMM-BT3\***" / "**KMM-BT2\***" / "**KMR-M3\***") on the Bluetooth device.  
"PAIRING" → "PASS XXXXXX" → "Device name" → "PRESS" → "VOLUME KNOB" appears on the display.
  - For some Bluetooth devices, you may need to enter the Personal Identification Number (PIN) code immediately after searching.
- 3 Press the volume knob to start pairing.  
"PAIRING OK" appears when pairing is completed.

Once pairing is completed, Bluetooth connection is established automatically.

- **KMM-BT525HD / KMM-X503 / KMM-BT325U / KMM-BT325 / KMR-M325BT**: "BT1" and/or "BT2" indicator on the faceplate lights up.
- **KMM-BT250U / KMM-BT225U**: "BT1" and/or "BT2" on the display window lights up.

- This unit supports Secure Simple Pairing (SSP).
- Up to five devices can be registered (paired) in total.
- Once the pairing is completed, the Bluetooth device will remain registered in the unit even if you reset the unit. To delete the paired device, see **[DEVICE DELETE]** on page 23.
- A maximum of two Bluetooth phones and one Bluetooth audio device can be connected at any time.  
However, while in BT AUDIO source, you can connect to five Bluetooth audio devices and switch between these five devices. (Page 24)
- Some Bluetooth devices may not automatically connect to the unit after pairing. Connect the device to the unit manually.
- Refer to the instruction manual of the Bluetooth device for more information.

## BLUETOOTH®

### Auto Pairing

When you connect iPhone/iPod touch to the USB input terminal, pairing request (via Bluetooth) is automatically activated.

Press the volume knob to pair once you have confirmed the device name.

Automatic pairing request is activated only if:

- Bluetooth function of the connected device is turned on.
- [AUTO PAIRING] is set to [ON]. (Page 23)

### BLUETOOTH — Mobile phone

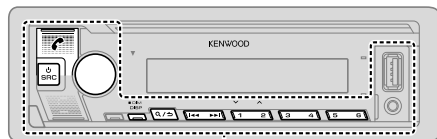

ZONE 2

### Receive a call

When there is an incoming call:

- **KMM-BT525HD / KMM-X503 / KMM-BT325U / KMM-BT325 / KMR-M325BT**: ZONE 2 illuminates in green color and flashes.
- The unit answers the call automatically if [AUTO ANSWER] is set to a selected time. (Page 21)

During a call:

- **KMM-BT525HD / KMM-X503 / KMM-BT325U / KMM-BT325 / KMR-M325BT**: ZONE 1 illuminates according to the settings made for [DISPLAY] (page 31) and ZONE 2 illuminates in green color.
- If you turn off the unit or detach the faceplate, Bluetooth is disconnected.

The following operations may differ or be unavailable depending on the connected phone.

To	On the faceplate	On the remote control
First incoming call...		
Answer a call	Press  or the volume knob or one of the number buttons (1 to 6).	Press .
Reject a call	Press .	Press .
End a call	Press .	Press .
While talking on the first incoming call...		
Answer another incoming call and hold the current call	Press .	Press .
Reject another incoming call	Press .	Press .
While having two active calls...		
End current call and activate held call	Press .	Press .
Swap between the current call and held call	Press .	Press .
Adjust the phone volume*1 [00] to [35] (Default: [15])	Turn the volume knob during a call.	Press VOL *2 or VOL  during a call.
Switch between hands-free and private talk modes*3	Press 6  during a call.	( Not available )

\*1, \*2, \*3: See page 21.



## BLUETOOTH®



\*1 This adjustment will not affect the volume of the other sources.



\*2 Press and hold VOL  to continuously increase the volume to 15.

\*3 Operations may vary according to the connected Bluetooth device.

### Improve the voice quality

While talking on the phone...



- 1 Press the volume knob to enter [FUNCTION].
- 2 Turn the volume knob to select an item (see the following table), then press the knob.
- 3 Repeat step 2 until the desired item is selected or activated.
- 4 Press and hold   to exit.



To return to the previous setting item, press  .

Default: [XX]

[MIC GAIN]	[-10] to [+10] ([-4]): The sensitivity of the microphone increases as the number increases.
[NR LEVEL]	[-5] to [+5] ([0]): Adjust the noise reduction level until the least noise is being heard during a phone conversation.
[ECHO CANCEL]	[-5] to [+5] ([0]): Adjust the echo cancellation delay time until the least echo is being heard during a phone conversation.





### Make the setting for answering a call



- 1 Press  to enter Bluetooth mode.
- 2 Turn the volume knob to select [SETTINGS], then press the knob.
- 3 Turn the volume knob to select [AUTO ANSWER], then press the knob.
- 4 Turn the volume knob to select the time (in seconds) for the unit to answer the call automatically, then press the knob.  
[01] to [30], or select [OFF] to cancels. (Default: [OFF])
- 5 Press and hold   to exit.

To return to the previous setting item, press  .

### Make a call

You can make a call from the call history, phonebook, or dialing the number. Call by voice is also possible if your mobile phone has the feature.

- 1 Press  to enter Bluetooth mode.  
“(First device name)” appears.
  - If two Bluetooth phones are connected, press  again to switch to the other phone.  
“(Second device name)” appears.
- 2 Turn the volume knob to select an item (see the following table), then press the knob.
- 3 Repeat step 2 until the desired item is selected/activated or follow the instructions stated on the selected item.
- 4 Press and hold   to exit.

To return to the previous setting item, press  .

[CALL HISTORY]	(Applicable only if the phone supports PBAP.) <ol style="list-style-type: none"><li>1 Press the volume knob to select a name or a phone number.<ul style="list-style-type: none"><li>• “I” indicates call received, “O” indicates call made, “M” indicates call missed.</li><li>• Press DISP to change the display category (NUMBER or NAME).</li><li>• “NO DATA” appears if there is no recorded call history or call number.</li></ul></li><li>2 Press the volume knob to call.</li></ol>
----------------	---

## [PHONE BOOK]

(Applicable only if the phone supports PBAP.)

- 1 Turn the volume knob quickly to enter alphabet search mode (if the phonebook contains many contacts).  
The first menu (ABCDEFGHIJK) appears.
  - To go to the other menu (LMNOPQRSTUVWXYZ), press 2 / 1 .
  - To select the desired first letter, turn the volume knob or press / , then press the knob.  
Select "1" to search with numbers and select "\*" to search with symbols.
- 2 Turn the volume knob to select a name, then press the knob.
- 3 Turn the volume knob to select a phone number, then press the knob to call.
  - The phonebook of the connected phone is automatically transferred to the unit when pairing.
  - Contacts are categorized as: HM (home), OF (office), MO (mobile), OT (other), GE (general)
  - This unit can display only non-accent letters. (Accent letters such as "ü" are shown as "u".)

## [NUMBER DIAL]

- 1 Turn the volume knob to select a number (0 to 9) or character (\*, #, +).
- 2 Press / to move the entry position.  
Repeat steps 1 and 2 until you finish entering the phone number.
- 3 Press the volume knob to call.  
(or using the remote control)
- 1 Press the number buttons (0 to 9) to enter the phone number.
- 2 Press to call.

## [VOICE]

Speak the name of the contact you want to call or the voice command to control the phone functions. (See "Make a call using voice recognition".)

[LOW]/[MID]/[FULL]: Shows the strength of the battery.\*

[NO SIGNAL]/[LOW]/[MID]/[MAX]: Shows the strength of the current received signal.\*

\* Functionality depends on the type of the phone used.



## Make a call using voice recognition

- 1 Press and hold to activate the voice recognition of the connected phone.
  - 2 Speak the name of the contact you want to call or the voice command to control the phone functions.
- Supported Voice Recognition features vary for each phone. Refer to the instruction manual of the connected phone for details.

## Settings in memory



## Store a contact in memory

You can store up to 6 contacts into the number buttons (1 to 6).

- 1 Press to enter Bluetooth mode.
- 2 Turn the volume knob to select [CALL HISTORY], [PHONE BOOK] or [NUMBER DIAL], then press the knob.
- 3 Turn the volume knob to select a contact or enter a phone number.  
If a contact is selected, press the volume knob to show the phone number.
- 4 Press and hold one of the number buttons (1 to 6).  
"STORED" appears when the contact is stored.

To erase a contact from the preset memory, select [NUMBER DIAL] in step 2 and store a blank number.



## Make a call from memory

- 1 Press to enter Bluetooth mode.
- 2 Press one of the number buttons (1 to 6).
- 3 Press the volume knob to call.  
"NO MEMORY" appears if there is no contact stored.

## Other settings

- 1 Press the volume knob to enter [FUNCTION].
- 2 Turn the volume knob to select an item (see the following table), then press the knob.
- 3 Repeat step 2 until the desired item is selected/activated or follow the instructions stated on the selected item.
- 4 Press and hold **Q/S** to exit.

To return to the previous setting item, press **Q/S**.

Default: **[XX]**

[BT MODE]	
[PHONE SELECT]*	Selects the phone or audio device to connect or disconnect. "✳" appears in front of the device name when connected.
[AUDIO SELECT]*	"▷" appears in front of the current playback audio device.
[DEVICE DELETE]	<ol style="list-style-type: none"> <li>1 Turn the volume knob to select a device to delete, then press the knob.</li> <li>2 Turn the volume knob to select <b>[YES]</b> or <b>[NO]</b>, then press the knob.</li> </ol>
[PIN CODE EDIT] (0000)	<p>Changes the PIN code (up to 6 digits).</p> <ol style="list-style-type: none"> <li>1 Turn the volume knob to select a number.</li> <li>2 Press <b>◀◀/▶▶</b> to move the entry position. Repeat steps 1 and 2 until you finish entering the PIN code.</li> <li>3 Press the volume knob to confirm.</li> </ol>
[RECONNECT]	<b>[ON]</b> : The unit is automatically reconnected when the last connected Bluetooth device is within the connectable range.; <b>[OFF]</b> : Cancels.
[AUTO PAIRING]	<b>[ON]</b> : The unit is automatically paired with the supported Bluetooth device (iPhone/iPod touch) when it is connected through USB input terminal. Depending on the operating system of the connected device, this function may not work.; <b>[OFF]</b> : Cancels.

\* You can only connect a maximum of two Bluetooth phones and one Bluetooth audio device at any time.

## [INITIALIZE]

**[YES]**: Initializes all the Bluetooth settings (including stored pairing, phonebook, and etc.).; **[NO]**: Cancels.

## Bluetooth test mode

You can check the connectivity of the supported profile between the Bluetooth device and the unit.

- Make sure there is no Bluetooth device paired.

### 1 Press and hold **Q**.

"PLEASE PAIR YOUR PHONE PIN 0000" appears on the display.

### 2 Search and select the name of your receiver ("KMM-BT5\*"/ "KMM-X5\*"/ "KMM-BT3\*"/ "KMM-BT2\*"/ "KMR-M3\*") on the Bluetooth device.

### 3 Operate the Bluetooth device to confirm pairing.

"TESTING" flashes on the display.

## The connectivity result (OK or NG) appears after the test.

PAIRING: Pairing status

HF CNT: Hands-Free Profile (HFP) compatibility

AUD CNT: Advanced Audio Distribution Profile (A2DP) compatibility

PB DL: Phonebook Access profile (PBAP) compatibility

To cancel test mode, press and hold **Q SRC** to turn off the unit.

## BLUETOOTH®

### BLUETOOTH — Audio

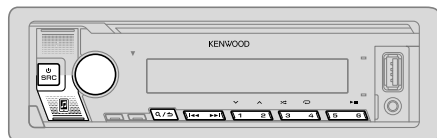

While in BT AUDIO source, you can connect to five Bluetooth audio devices and switch between these five devices.

#### Audio player via Bluetooth

- 1 Press **SRC** repeatedly (or press SRC on the remote control) to select BT AUDIO.
  - Pressing **[BT]** enters BT AUDIO directly.
- 2 Operate the audio player via Bluetooth to start playback.

To	On the faceplate	On the remote control
Play back/pause	Press 6 <b>▶  </b> .	Press ENT <b>▶  </b> .
Select group or folder	Press 2 <b>▲</b> / 1 <b>▼</b> .	Press #FM+/*AM-.
Reverse skip/ Forward skip	Press <b>◀◀</b> / <b>▶▶</b> .	Press <b>◀◀</b> / <b>▶▶</b> (+).
Reverse/Fast-forward	Press and hold <b>◀◀</b> / <b>▶▶</b> .	Press and hold <b>◀◀</b> / <b>▶▶</b> (+).

To	On the faceplate	On the remote control
Repeat play	Press 4 <b>↺</b> repeatedly. [ALL REPEAT], [FILE REPEAT], [REPEAT OFF]	( Not available )
Random play	Press and hold 3 <b>⌘</b> to select [ALL RANDOM]. • Press 3 <b>⌘</b> to select [RANDOM OFF].	( Not available )
Select a file from a folder/list	Refer to "Select a file from a folder/list" on page 11.	( Not available )
Switch between connected Bluetooth audio devices	Press 5.*	( Not available )

\* Pressing the "Play" key on the connected device itself also causes switching of sound output from the device.

Operations and display indications may differ according to their availability on the connected device.

## Settings to use KENWOOD Remote application

KENWOOD Remote application is designed to control the KENWOOD car receiver's operations from the iPhone/iPod (via Bluetooth or via USB input terminal) or Android smartphone (via Bluetooth).

- For **KMM-BT525HD/KMM-X503/KMM-BT325U/KMM-BT325/KMR-M325BT**, "RAPP" indicator on the display window lights up when KENWOOD Remote application is connected.

### Preparation:

- Install the latest version of KENWOOD Remote application on your device before connecting.
- For more information, visit <[www.kenwood.com/cs/ce/](http://www.kenwood.com/cs/ce/)>.

- Press the volume knob to enter [FUNCTION].
- Turn the volume knob to select an item (see the following table), then press the knob.
- Repeat step 2 until the desired item is selected or activated.
- Press and hold **Q/↵** to exit.

To return to the previous setting item, press **Q/↵**.

Default: **[XX]**

### [REMOTE APP]

[SELECT]	Selects the device (IOS or ANDROID) to use the application.
[IOS]	<p>[YES]: Selects iPhone/iPod to use the application via Bluetooth or connected via USB input terminal. ; [NO]: Cancels.</p> <p>If IOS is selected, select iPod BT source (or iPod USB/iPod FRONT/iPod REAR source if your iPhone/iPod is connected via USB input terminal) to activate the application.</p> <ul style="list-style-type: none"> <li>The connectivity of the application will be interrupted or disconnected if:           <ul style="list-style-type: none"> <li>You change from iPod BT source to any playback source connected via the USB input terminal.</li> <li>You change from iPod USB/iPod FRONT/iPod REAR source to iPod BT source.</li> </ul> </li> </ul>

[ANDROID]	[YES]: Selects Android smartphone to use the application via Bluetooth. ; [NO]: Cancels.
[ANDROID LIST]*	Selects the Android smartphone to use from the list.
[STATUS]	<p>Shows the status of the selected device.</p> <p>[IOS CONNECTED]: You are able to use the application using the iPhone/iPod connected via Bluetooth or USB input terminal.</p> <p>[IOS NOT CONNECTED]: No IOS device is connected to use the application.</p> <p>[ANDROID CONNECTED]: You are able to use the application using the Android smartphone connected via Bluetooth.</p> <p>[ANDROID NOT CONNECTED]: No Android device is connected to use the application.</p>

\* Displayed only when [ANDROID] of [SELECT] is set to [YES].

### Listen to iPhone/iPod via Bluetooth

You can listen to the songs on the iPhone/iPod via Bluetooth on this unit.

Press **⏮SRC** repeatedly to select iPod BT.

- You can operate the iPod/iPhone in the same way as iPod/iPhone via USB input terminal. (Page 10)
- If you plug in an iPhone/iPod to the USB input terminal while listening to iPod BT source, the source automatically changes to iPod USB/iPod FRONT/iPod REAR. Press **⏮SRC** to select iPod BT if the device is still connected via Bluetooth.

### Internet radio via Bluetooth

You can listen to internet radio (Pandora, iHeartRadio and Spotify) on the iPhone/iPod touch/Android device via Bluetooth on this unit.

- Make sure the USB input terminal is not connected to any device.

### Listen to Pandora

#### Preparation:

Select [ON] for [PANDORA SRC] in [SOURCE SELECT]. (Page 5)

- 1 Start up the Pandora application on your device.
- 2 Connect your device via Bluetooth connection. (Page 19)
- 3 Press  SRC repeatedly to select PANDORA (for iPhone/iPod) or PANDORA BT (for Android device).

The source switches and broadcast starts automatically.

- You can operate Pandora in the same way as Pandora via USB input terminal. (Page 13)

### Listen to iHeartRadio

#### Preparation:

Select [ON] for [IHEART SRC] in [SOURCE SELECT]. (Page 5)

- 1 Start up the iHeartAuto application on your device.
- 2 Connect your device via Bluetooth connection. (Page 19)
- 3 Press  SRC repeatedly to select IHEARTRADIO.

The source switches and broadcast starts automatically.

- You can operate iHeartRadio in the same way as iHeartRadio via USB input terminal. (Page 14)

### Listen to Spotify

#### Preparation:

Select [ON] for [SPOTIFY SRC] in [SOURCE SELECT]. (Page 5)

- 1 Start up the Spotify application on your device.
- 2 Connect your device via Bluetooth connection. (Page 19)
- 3 Press  SRC repeatedly to select SPOTIFY (for iPhone/iPod) or SPOTIFY BT (for Android device).

The source switches and broadcast starts automatically.

- You can operate Spotify in the same way as Spotify via USB input terminal. (Page 15)

# AUDIO SETTINGS

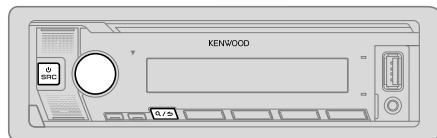

- 1 Press the volume knob to enter [FUNCTION].
- 2 Turn the volume knob to select an item (see the following table), then press the knob.
- 3 Repeat step 2 until the desired item is selected or activated.
- 4 Press and hold **Q/** to exit.

(or using the remote control)

- 1 Press AUD to enter [AUDIO CONTROL].
- 2 Press **▲/▼** to select an item, then press ENT **▶||**.

To return to the previous setting item, press **Q/**.

Default: **[XX]**

[AUDIO CONTROL]	
[SUB-W LEVEL]	[LEVEL -50] to [LEVEL +10] ( <b>[LEVEL 0]</b> ): Adjusts the subwoofer output level.
[EASY EQ]	Adjusts your own sound settings. <ul style="list-style-type: none"> <li>• The settings are stored to [USER] in [PRESET EQ].</li> <li>• The settings made may affect the current settings of [MANUAL EQ].</li> </ul>
[SW]:	[LEVEL -50] to [LEVEL +10] (Default: <b>[LEVEL 0]</b> )
[BASS]:	[LEVEL -9] to [LEVEL +9] ( <b>[LEVEL 0]</b> )
[MID]:	[LEVEL -9] to [LEVEL +9] ( <b>[LEVEL 0]</b> )
[TRE]:	[LEVEL -9] to [LEVEL +9] ( <b>[LEVEL 0]</b> )

[MANUAL EQ]	Adjusts your own sound settings for each source. <ul style="list-style-type: none"> <li>• The settings are stored to [USER] in [PRESET EQ].</li> <li>• The settings made may affect the current settings of [EASY EQ].</li> </ul>	
[62.5HZ]	[LEVEL]	[LEVEL -9] to [LEVEL +9] ( <b>[LEVEL 0]</b> ): Adjusts the level to memorize for each source. (Before making an adjustment, select the source you want to adjust.)
	[BASS EXTEND]	[ON]: Turns on the extended bass. ; [OFF]: Cancels.
[100HZ]/[160HZ]/ [250HZ]/[400HZ]/ [630HZ]/[1KHZ]/ [1.6KHZ]/[2.5KHZ]/ [4KHZ]/[6.3KHZ]/ [10KHZ]/[16KHZ]	[LEVEL]	[LEVEL -9] to [LEVEL +9] ( <b>[LEVEL 0]</b> ): Adjusts the level to memorize for each source. (Before making an adjustment, select the source you want to adjust.)
[Q FACTOR]		[1.35]/[1.50]/[2.00]: Adjusts the quality factor.
[PRESET EQ]	[NATURAL]/[ROCK]/[POPS]/[EASY]/[TOP40]/[JAZZ]/[POWERFUL]/[USER]: Selects a preset equalizer suitable to the music genre. (Select [USER] to use the settings made in [EASY EQ] or [MANUAL EQ].)	
[BASS BOOST]	[LV1] to [LV5]	Selects your preferred bass boost level. ; [OFF]: Cancels.
[LOUDNESS]	[LV1]/[LV2]	Selects your preferred low or high frequencies boost to produce a well-balanced sound at low volume. ; [OFF]: Cancels.
[SUBWOOFER SET]	[ON]	Turns on the subwoofer output. ; [OFF]: Cancels.
[FADER]	[R15] to [F15] ( <b>[0]</b> )	Adjusts the front and rear speaker output balance.
[BALANCE]	[L15] to [R15] ( <b>[0]</b> )	Adjusts the left and right speaker output balance.
[VOLUME OFFSET]	[-15] to [+6] ( <b>[0]</b> ): Presets the initial volume level of each source by comparing to the FM volume level. (Before adjustment, select the source you want to adjust.)	

## AUDIO SETTINGS

<b>[SOUND EFFECT]</b>	
<b>[SOUND RECSTR]</b> (Sound reconstruction)	(Not applicable for RADIO source, AUX source and SIRIUS XM source.) <b>[ON]</b> : Creates realistic sound by compensating the high-frequency components and restoring the rise-time of the waveform that are lost in audio data compression. ; <b>[OFF]</b> : Cancels.
<b>[SPACE ENHANCE]</b>	(Not applicable for RADIO source.) <b>[SML]/[MED]/[LRG]</b> : Virtually enhances the sound space. ; <b>[OFF]</b> : Cancels.
<b>[SND REALIZER]</b>	<b>[LV1]/[LV2]/[LV3]</b> : Virtually makes the sound more realistic. ; <b>[OFF]</b> : Cancels.
<b>[STAGE EQ]</b>	<b>[LOW]/[MID]/[HI]</b> : Virtually adjusts the sound position heard from the speakers. ; <b>[OFF]</b> : Cancels.
<b>[DRIVE EQ]</b>	<b>[ON]</b> : Boosts the frequency to reduce the noise heard from outside the car or running noise of the tyres. ; <b>[OFF]</b> : Cancels.
<b>[SPEAKER SIZE]</b> The frequency and slope settings are automatically set for the crossover of the selected speaker.	
<b>[FRONT]</b>	<b>[SIZE]</b> <b>[3.5"]/[4"]/[4.75"]/[5"]/[6.5"]/[6.75"]/[7"]/[4×6]/[5×7]/[6×8]/[6×9]/[7×10]</b> : Selects according to the connected speaker size for optimum performance.
	<b>[TWEETER]</b> <b>[SMALL]/[MIDDLE]/[LARGE]</b> : Selects according to the size range of the connected tweeter for optimum performance. ; <b>[NONE]</b> : Not connected.
<b>[REAR]</b>	<b>[3.5"]/[4"]/[4.75"]/[5"]/[6.5"]/[6.75"]/[7"]/[4×6]/[5×7]/[6×8]/[6×9]/[7×10]</b> : Selects according to the connected speaker size for optimum performance. ; <b>[NONE]</b> : Not connected.
<b>[SUBWOOFER]</b>	<b>[6.5"]/[8"]/[10"]/[12"]/[15" OVER]</b> : Selects according to the connected speaker size for optimum performance. ; <b>[NONE]</b> : Not connected.

<b>[X ' OVER]</b>		
<b>[TWEETER]</b>	<b>[FRQ]</b>	<b>[1KHZ]/[1.6KHZ]/[2.5KHZ]/[4KHZ]/[5KHZ]/[6.3KHZ]/[8KHZ]/[10KHZ]/[12.5KHZ]</b> : Adjusts the crossover frequency for the tweeter speaker.
	<b>[GAIN LEFT]</b>	<b>[-8] to [0]</b> : Adjusts the output volume of the left tweeter.
	<b>[GAIN RIGHT]</b>	<b>[-8] to [0]</b> : Adjusts the output volume of the right tweeter.
<b>[FRONT HPF]</b>	<b>[F-HPF FRQ]</b>	<b>[30HZ]/[40HZ]/[50HZ]/[60HZ]/[70HZ]/[80HZ]/[90HZ]/[100HZ]/[120HZ]/[150HZ]/[180HZ]/[220HZ]/[250HZ]</b> : Adjusts the crossover frequency for the selected speakers (high pass filter). ; <b>[THROUGH]</b> : All signals are sent to the selected speakers.
	<b>[F-HPF SLOPE]</b>	<b>[-6DB]/[-12DB]/[-18DB]/[-24DB]</b> : Adjusts the crossover slope. (Selectable only if a setting other than <b>[THROUGH]</b> is selected for <b>[F-HPF FRQ]</b> .)
	<b>[F-HPF GAIN]</b>	<b>[-8] to [0]</b> : Adjusts the output volume of the selected speaker.
<b>[REAR HPF]</b>	<b>[R-HPF FRQ]</b>	(Refer to <b>[FRONT HPF]</b> settings above.)
	<b>[R-HPF SLOPE]</b>	
<b>[SUBWOOFER LPF]</b>	<b>[R-HPF GAIN]</b>	
	<b>[SW LPF FRQ]</b>	<b>[30HZ]/[40HZ]/[50HZ]/[60HZ]/[70HZ]/[80HZ]/[90HZ]/[100HZ]/[120HZ]/[150HZ]/[180HZ]/[220HZ]/[250HZ]</b> : Adjusts the crossover frequency for the subwoofer (low pass filter). ; <b>[THROUGH]</b> : All signals are sent to the subwoofer.



## AUDIO SETTINGS

[SW LPF SLOPE]	[−6DB]/[−12DB]/[−18DB]/[−24DB]: Adjusts the crossover slope. (Selectable only if a setting other than [THROUGH] is selected for [SW LPF FRQ].)
[SW LPF PHASE]	[REVERSE] (180°)/[NORMAL] (0°): Selects the phase of the subwoofer output to be in line with the speaker output for optimum performance.
[SW LPF GAIN]	[−8] to [0]: Adjusts the output volume of the subwoofer.
[DTA SETTINGS]	For settings, see “Digital Time Alignment settings” on the right column.
[CAR SETTINGS]	

• (For **KMM-BT250U**/**KMM-BT225U**)

The following item is selectable only if [SWITCH PREOUT] is set to [SUB-W] (page 4):

- [SUB-W LEVEL]
- [SUBWOOFER SET]
- [SW LEVEL] of [EASY EQ]
- [SUBWOOFER] of [SPEAKER SIZE]
- [SUBWOOFER LPF] of [X ' OVER]
- [SUBWOOFER] of [DISTANCE] and [GAIN] in [DTA SETTINGS]

• The following item is selectable only if [SUBWOOFER SET] is set to [ON] (page 27):

- [SUB-W LEVEL]
- [SW LEVEL] of [EASY EQ]
- [SUBWOOFER] of [SPEAKER SIZE]
- [SUBWOOFER LPF] of [X ' OVER]
- [SUBWOOFER] of [DISTANCE] and [GAIN] in [DTA SETTINGS]

• The following item is selectable only if a setting other than [NONE] is selected for [TWEETER], [REAR] and [SUBWOOFER] of [SPEAKER SIZE]:

- [TWEETER], [REAR HPF], [SUBWOOFER LPF] of [X ' OVER]

### Digital Time Alignment settings

Digital Time Alignment sets the delay time of the speaker output to create a more suitable environment for your vehicle.

- For more information, see “Determining the value for [DISTANCE] and [GAIN] of [DTA SETTINGS]” on page 30.

[DTA SETTINGS]	
[POSITION]	Selects your listening position (reference point). [ALL]: Not compensating ; [FRONT RIGHT]: Front right seat ; [FRONT LEFT]: Front left seat ; [FRONT ALL]: Front seats
[DISTANCE]	[0FT] to [20.01FT]: Fine adjust the distance to compensate. (Before making an adjustment, select the speaker you want to adjust.)
[GAIN]	[−8DB] to [0DB]: Fine adjust the output volume of the selected speaker. (Before making an adjustment, select the speaker you want to adjust.)
[DTA RESET]	[YES]: Resets the settings ([DISTANCE] and [GAIN]) of the selected [POSITION] to default. ; [NO]: Cancels.
[CAR SETTINGS]	
Identify your car type and rear speaker location in order to make the adjustment for [DTA SETTINGS].	
[CAR TYPE]	[COMPACT]/[FULL SIZE CAR]/[WAGON]/[MINIVAN]/[SUV]/ [MINIVAN(LONG)]: Selects the type of vehicle. ; [OFF]: Not compensating.
[R-SP LOCATION]	Selects the location of the rear speakers in your vehicle to calculate the furthest distance from the listening position selected (reference point). • [DOOR]/[REAR DECK]: Selectable only when [CAR TYPE] is selected as [OFF], [COMPACT], [FULL SIZE CAR], [WAGON] or [SUV]. • [2ND ROW]/[3RD ROW]: Selectable only when [CAR TYPE] is selected as [MINIVAN] or [MINIVAN(LONG)].

## AUDIO SETTINGS

- Before making an adjustment for [DISTANCE] and [GAIN] of [DTA SETTINGS], select the speaker you want to adjust:  
[FRONT LEFT]/[FRONT RIGHT]/[REAR LEFT]/[REAR RIGHT]/[SUBWOOFER]  
– You can only select [REAR LEFT], [REAR RIGHT] and [SUBWOOFER] if a setting other than [NONE] is selected for [REAR] and [SUBWOOFER] of [SPEAKER SIZE].
- [R-SP LOCATION] of [CAR SETTING] is selectable only if a setting other than [NONE] is selected for [REAR] of [SPEAKER SIZE].

### Determining the value for [DISTANCE] and [GAIN] of [DTA SETTINGS]

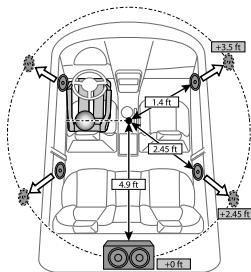

If you specify the distance from the center of the currently set listening position to every speaker, the delay time will be automatically computed and set.

- 1 Determines the center of the currently set listening position as the reference point.
- 2 Measures the distances from the reference point to the speakers.
- 3 Calculates the differences between the distance of the furthest speaker (rear speaker) and other speakers.
- 4 Sets the [DISTANCE] calculated in step 3 for individual speakers.
- 5 Adjusts [GAIN] for individual speakers.

Example: When [FRONT ALL] is selected as the listening position

## DISPLAY SETTINGS

Zone identification for color settings and brightness settings

KMM-BT525HD  
KMM-X503  
KMM-BT325U  
KMM-BT325  
KMR-M325BT

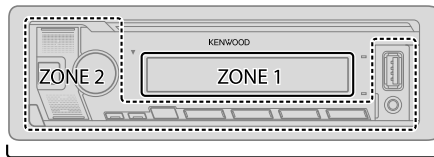

Zone identification for brightness setting

KMM-BT250U  
KMM-BT225U

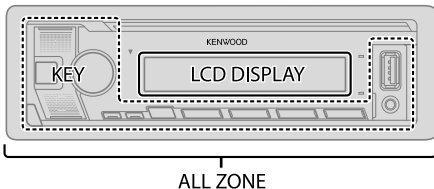

### Set the dimmer

Press and hold DISP (DIM) to turn on or off the dimmer.

- If you have set [DIMMER TIME] (page 31), it will be canceled once you press and hold this button.

## DISPLAY SETTINGS

### Other settings

- 1 Press the volume knob to enter [FUNCTION].
- 2 Turn the volume knob to select an item (see the following table), then press the knob.
- 3 Repeat step 2 until the desired item is selected/activated or follow the instructions stated on the selected item.
- 4 Press and hold **Q/↵** to exit.

To return to the previous setting item, press **Q/↵**.

Default: **[XX]**

### [DISPLAY]

- [COLOR SELECT]** (For **[KMM-BT525HD / KMM-X503 / KMM-BT325U / KMM-BT325 / KMR-M325BT]**)  
Selects illumination colors for **[ALL ZONE]**, **[ZONE 1]** and **[ZONE 2]** separately.
- 1 Select a zone (**[ZONE 1]**, **[ZONE 2]**, **[ALL ZONE]**). (See the illustration on page 30.)
  - 2 Select a color for the selected zone.  
**[INITIAL COLOR] / [VARIABLE SCAN] / [CUSTOM R/G/B] / [RED1] / [RED2] / [RED3] / [PURPLE1] / [PURPLE2] / [PURPLE3] / [PURPLE4] / [BLUE1] / [BLUE2] / [BLUE3] / [SKYBLUE1] / [SKYBLUE2] / [LIGHTBLUE] / [AQUA1] / [AQUA2] / [GREEN1] / [GREEN2] / [GREEN3] / [YELLOWGREEN1] / [YELLOWGREEN2] / [YELLOW] / [ORANGE1] / [ORANGE2] / [ORANGERED]**  
Default:  
**[KMM-BT525HD / KMM-X503 / KMM-BT325U / KMM-BT325 : [VARIABLE SCAN] / KMR-M325BT : [INITIAL COLOR]**

To make your own color, select **[CUSTOM R/G/B]**. The color you have made will be stored in **[CUSTOM R/G/B]**.

- 1 Press the volume knob to enter the detailed color adjustment.
- 2 Press **◀/▶** to select the color (**[R] / [G] / [B]**) to adjust.
- 3 Turn the volume knob to adjust the level (**[0]** to **[9]**), then press the knob.

### [DIMMER]

Dims the illumination.

**[ON]**: Dimmer is turned on.

**[OFF]**: Dimmer is turned off.

**[DIMMER TIME]**: Set the dimmer on and off time.

1 Turn the volume knob to adjust the **[ON]** time, then press the knob.

2 Turn the volume knob to adjust the **[OFF]** time, then press the knob.

Default: **[ON]: [6:00PM] ; [OFF]: [6:00AM]**

### [BRIGHTNESS]

1 Select a zone. (See the illustration on page 30.)

2 **[LVL 00]** to **[LVL 31]**: Set the brightness level for the selected zone.

### [TEXT SCROLL]

**[ONCE]**: Scrolls the display information once. ; **[AUTO]**: Repeats scrolling at 5-second intervals. ; **[OFF]**: Cancels.

### [LEVEL METER]

(For **[KMM-BT525HD / KMM-X503 / KMM-BT325U / KMM-BT325 / KMR-M325BT]**)

**[ON]**: Shows the level meter on the display window (as shown below). ;

**[OFF]**: Cancels.



Level meter

# REFERENCES

## ■ Maintenance

### Cleaning the unit

Wipe off dirt on the faceplate with a dry silicone or soft cloth.

### Cleaning the connector

Detach the faceplate and clean the connector gently with a cotton swab. Be careful not to damage the connector.

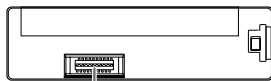

Connector (on the reverse side of the faceplate)

## ■ More information

- For:
- Latest firmware updates and latest compatible item list
  - KENWOOD original application
  - Any other latest information

Visit <[www.kenwood.com/cs/ce/](http://www.kenwood.com/cs/ce/)>.

### Playable files

- Playable audio file for USB mass storage class device:  
MP3 (.mp3), WMA (.wma), AAC (.aac), AAC (.m4a), WAV (.wav), FLAC (.flac)
- Playable USB device file system: FAT12, FAT16, FAT32  
Even when audio files comply with the standards listed above, playback may be impossible depending on the types or conditions of media or devices.
- For detailed information and notes about the playable audio files, visit  
<[www.kenwood.com/cs/ce/audiofile/](http://www.kenwood.com/cs/ce/audiofile/)>.

### About USB devices

- You cannot connect a USB device via a USB hub.
- Connecting a cable whose total length is longer than 5 m may result in abnormal playback.
- This unit cannot recognize a USB device whose rating is other than 5 V and exceeds 1.5 A.

### About iPod/iPhone

- Via USB input terminal:  
Made for
  - iPod touch (5th and 6th generation)
  - iPod nano (7th generation)
  - iPhone 4S, 5, 5S, 5C, 6, 6 Plus, 6S, 6S Plus, SE, 7, 7 Plus, 8, 8 Plus, X
- Via Bluetooth:  
Made for
  - iPod touch (5th and 6th generation)
  - iPhone 4S, 5, 5S, 5C, 6, 6 Plus, 6S, 6S Plus, SE, 7, 7 Plus, 8, 8 Plus, X
- It is not possible to browse video files on the “Videos” menu in **[MODE OFF]**.
- The song order displayed on the selection menu of this unit may differ from that of the iPod/iPhone.
- You cannot operate iPod if “KENWOOD” or “✓” is displayed on iPod.
- Depending on the version of the operating system of the iPod/iPhone, some functions may not operate on this unit.

### About Android device

- This unit supports Android OS 4.1 and above.
- Some Android devices (with OS 4.1 and above) may not fully support Android Open Accessory (AOA) 2.0.
- If the Android device supports both mass storage class device and AOA 2.0, this unit always playback via AOA 2.0 as priority.

### About Pandora

- Pandora is only available in certain countries.  
For more information, visit <[www.pandora.com/legal](http://www.pandora.com/legal)>.
- Because Pandora is a third-party service, the specifications are subject to change without prior notice. Accordingly, compatibility may be impaired, or some or all of the services may become unavailable.
- Some functions of Pandora cannot be operated from this unit.
- For issues using the application, please contact Pandora at <[pandora-support@pandora.com](mailto:pandora-support@pandora.com)>.

## REFERENCES

### About iHeartRadio

- iHeartRadio® is a third-party service, therefore the specifications are subject to change without prior notice. Accordingly, compatibility may be impaired or some or all of the services may become unavailable.
- Some iHeartRadio® functionality cannot be operated from this unit.

### About Spotify

- Spotify application supports:
  - iPhone 4S, 5, 5S, 5C, 6, 6 Plus, 6S, 6S Plus, SE, 7, 7 Plus (iOS 8 or above)
  - iPod touch (5th and 6th generation)
  - Android OS 4.0.3 or above
- Spotify is a third party service, therefore the specifications are subject to change without prior notice. Accordingly, compatibility may be impaired or some or all of the services may become unavailable.
- Some functions of Spotify cannot be operated from this unit.
- For issues using the application, please contact Spotify at <www.spotify.com>.

### About Bluetooth

- Depending on the Bluetooth version of the device, some Bluetooth devices may not be able to connect to this unit.
- This unit may not work with some Bluetooth devices.
- Signal conditions vary, depending on the surroundings.

### About Program Type

For Radio Broadcast Data System:

[SPEECH]:

[NEWS], [INFORM] (information), [SPORTS], [TALK], [LANGUAGE], [REL TALK] (religious talk), [PERSONLTY] (personality), [PUBLIC], [COLLEGE], [HABL ESP] (spanish talk), [WEATHER]

[MUSIC]:

[ROCK], [CLS ROCK] (classic rock), [ADLT HIT] (adult hits), [SOFT RCK] (softrock), [TOP 40], [COUNTRY], [OLDIES], [SOFT], [NOSTALGA] (nostalgia), [JAZZ], [CLASSICL] (classical), [R & B] (rhythm and blues), [SOFT R&B] (soft rhythm and blues), [REL MUSC] (religious music), [MUSC ESP] (spanish music), [HIP HOP]

For Radio Data System:

[SPEECH]:

[NEWS], [AFFAIRS], [INFO] (information), [SPORT], [EDUCATE], [DRAMA], [CULTURE], [SCIENCE], [VARIED], [WEATHER], [FINANCE], [CHILDREN], [SOCIAL], [RELIGION], [PHONE IN], [TRAVEL], [LEISURE], [DOCUMENT]

[MUSIC]:

[POP M] (music), [ROCK M] (music), [EASY M] (music), [LIGHT M] (music), [CLASSICS], [OTHER M] (music), [JAZZ], [COUNTRY], [NATION M] (music), [OLDIES], [FOLK M] (music)

The unit will search for the Program Type categorized under [SPEECH] or [MUSIC] if selected.

### About HD Radio™ Technology

HD2/HD3

- Adjacent to traditional main stations are extra local FM channels. These HD2/HD3 Channels provide new, original music as well as deep cuts into traditional genre.

Digital Sound

- Digital, CD-quality sound. HD Radio Technology enables local radio stations to broadcast a clean digital signal. AM sounds like today's FM and FM sounds like a CD.

Program Info

- Program Info provides song name, artist, station ID, and other relevant data to enrich the listening experience.

Emergency Alerts

- Emergency Alert delivers critical and life-saving messages to the public during emergency situations.

## REFERENCES

### Change the display information

(for **KMM-BT525HD** / **KMM-X503** / **KMM-BT325U** / **KMM-BT325** / **KMR-M325BT**)

Each time you press DISP, the display information changes.

- If the information is unavailable or not recorded, "NO TEXT", "NO INFO", or other information (eg. station name) appears or display will be blank.

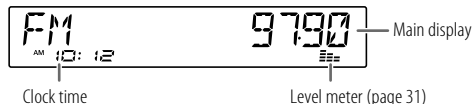

Source name	Display information: Main display
STANDBY	Source name ➔ Date ➔ Turns off the display* ➔ back to the beginning
HD RADIO	(For <b>KMM-BT525HD</b> / <b>KMM-X503</b> )  For digital stations only: Source name ➔ Station name ➔ Song title/Artist ➔ Song title/Album ➔ Frequency ➔ Date ➔ back to the beginning  For FM Radio Broadcast Data System stations only: Source name/Program type ➔ Radio text ➔ Radio text+ ➔ Radio text+ song title/Radio text+ artist ➔ Frequency ➔ Date ➔ back to the beginning
RADIO	(For <b>KMM-BT325U</b> / <b>KMM-BT325</b> / <b>KMR-M325BT</b> )  Frequency ➔ Date ➔ Turns off the display* ➔ back to the beginning  For FM Radio Broadcast Data System/FM Radio Data System stations only: Station name/Program type ➔ Radio text ➔ Radio text+ ➔ Radio text+ song title/Radio text+ artist ➔ Frequency ➔ Date ➔ Turns off the display* ➔ back to the beginning
USB/USB FRONT/ USB REAR	For MP3/WMA/AAC/WAV/FLAC files: Song title/Artist ➔ Album title/Artist ➔ Folder name ➔ File name ➔ Playing time ➔ Date ➔ Turns off the display* ➔ back to the beginning

Source name	Display information: Main display
iPod USB/ iPod FRONT/ iPod REAR/iPod BT	When [MODE OFF] is selected (page 11): Song title/Artist ➔ Album title/Artist ➔ Playing time ➔ Date ➔ Turns off the display* ➔ back to the beginning
ANDROID/ ANDROID FRONT/ ANDROID REAR	Source name ➔ Date ➔ Turns off the display* ➔ back to the beginning
PANDORA/ PANDORA FRONT/ PANDORA REAR/ PANDORA BT	Station name ➔ Shared/Radio ➔ Song title ➔ Artist ➔ Album title ➔ Playing time ➔ Date ➔ Turns off the display* ➔ back to the beginning
IHEARTADIO/ IHEARTADIO-F/ IHEARTADIO-R	Station name ➔ Song title/Artist ➔ Date ➔ Turns off the display* ➔ back to the beginning
SPOTIFY/ SPOTIFY FRONT/ SPOTIFY REAR/ SPOTIFY BT	Context title ➔ Song title ➔ Artist ➔ Album title ➔ Playing Time ➔ Date ➔ Turns off the display* ➔ back to the beginning
SIRIUS XM	(For <b>KMM-BT525HD</b> / <b>KMM-X503</b> / <b>KMM-BT325U</b> / <b>KMR-M325BT</b> ) Channel number ➔ Channel name ➔ Artist ➔ Song title ➔ Content information ➔ Category name ➔ Date ➔ back to the beginning
BT AUDIO	Song title/Artist ➔ Album title/Artist ➔ Playing time ➔ Date ➔ Turns off the display* ➔ back to the beginning
AUX	Source name ➔ Date ➔ Turns off the display* ➔ back to the beginning

\* Only for **KMM-BT325**

## REFERENCES

### Change the display information

(for **KMM-BT250U**/**KMM-BT225U**)

Each time you press DISP, the display information changes.

- If the information is unavailable or not recorded, "NO TEXT", "NO INFO", or other information (eg. station name) appears or display will be blank.

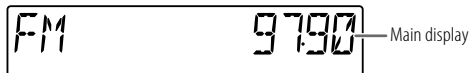

Source name	Display information: Main display
STANDBY	Source name/Clock ➡ Clock ➡ back to the beginning
RADIO	Source name/Clock ➡ Frequency ➡ Clock ➡ back to the beginning  For FM Radio Broadcast Data System only: Source name/Clock ➡ Station name/Program type ➡ Radio text ➡ Radio text+ ➡ Radio text+ song title/Radio text+ artist ➡ Frequency ➡ Clock ➡ back to the beginning
USB	For MP3/WMA/AAC/WAV/FLAC files: Source name/Clock ➡ Song title/Artist ➡ Album title/Artist ➡ Folder name ➡ File name ➡ Playing time ➡ Clock ➡ back to the beginning
iPod USB/iPod BT	When <b>[MODE OFF]</b> is selected (page 11): Source name/Clock ➡ Song title/Artist ➡ Album title/Artist ➡ Playing time ➡ Clock ➡ back to the beginning
ANDROID	Source name/Clock ➡ Clock ➡ back to the beginning
PANDORA/ PANDORA BT	Source name/Clock ➡ Station name ➡ Shared/Radio ➡ Song title ➡ Artist ➡ Album title ➡ Playing time ➡ Clock ➡ back to the beginning

Source name	Display information: Main display
IHEARTRADIO	Source name/Clock ➡ Station name ➡ Song title/Artist ➡ Clock ➡ back to the beginning
SPOTIFY/ SPOTIFY BT	Source name/Clock ➡ Context title ➡ Song title ➡ Artist ➡ Album title ➡ Playing Time ➡ Clock ➡ back to the beginning
BT AUDIO	Source name/Clock ➡ Song title/Artist ➡ Album title/Artist ➡ Playing time ➡ Clock ➡ back to the beginning
AUX	Source name/Clock ➡ Clock ➡ back to the beginning

# TROUBLESHOOTING

Symptom	Remedy
General	Sound cannot be heard. <ul style="list-style-type: none"> <li>Adjust the volume to the optimum level.</li> <li>Check the cords and connections.</li> </ul>
	"MISWIRING CHECK WIRING THEN PWR ON" appears. <ul style="list-style-type: none"> <li>Turn the power off, then check to be sure the terminals of the speaker wires are insulated properly. Turn the power on again.</li> </ul>
	"PROTECTING SEND SERVICE" appears. <ul style="list-style-type: none"> <li>Send the unit to the nearest service center.</li> </ul>
	Source cannot be selected. <ul style="list-style-type: none"> <li>Check the [SOURCE SELECT] setting. (Page 5)</li> </ul>
	<ul style="list-style-type: none"> <li>Sound cannot be heard.</li> <li>The unit does not turn on.</li> <li>Information shown on the display is incorrect.</li> </ul> <ul style="list-style-type: none"> <li>Clean the connectors. (Page 32)</li> </ul>
	The unit does not work at all. <ul style="list-style-type: none"> <li>Reset the unit. (Page 3)</li> </ul>
	Correct characters are not displayed. <ul style="list-style-type: none"> <li>This unit can only display uppercase letters, numbers, and a limited number of symbols.</li> <li>Depending on the display language you have selected (page 5), some characters may not be displayed correctly.</li> </ul>
HD Radio tuner/ Radio	(For <b>KMR-M325BT</b> ) "SET ERROR"/"DEL ERROR" <ul style="list-style-type: none"> <li>Setting/deleting the remote control ID is unsuccessful. Turn the power off, then turn on the power and perform the operation again. (Page 5)</li> </ul>
	<ul style="list-style-type: none"> <li>Radio reception is poor.</li> <li>Static noise while listening to the radio.</li> </ul> <ul style="list-style-type: none"> <li>Connect the antenna firmly.</li> </ul>

Symptom	Remedy
USB/iPod	Playback order is not as intended. <ul style="list-style-type: none"> <li>The playback order is determined by the order in which file name were recorded (USB).</li> </ul>
	Elapsed playing time is not correct. <ul style="list-style-type: none"> <li>This depends on the recording process earlier (USB).</li> </ul>
	"READING" keeps flashing. <ul style="list-style-type: none"> <li>Do not use too many hierarchical levels and folders.</li> <li>Reattach the device (USB/iPod/iPhone).</li> </ul>
	"UNSUPPORTED DEVICE" appears. <ul style="list-style-type: none"> <li>Check whether the connected USB device is compatible with this unit and ensure the file systems are in supported formats. (Page 32)</li> <li>Reattach the USB device.</li> </ul>
	"UNRESPONSIVE DEVICE" appears. <ul style="list-style-type: none"> <li>Make sure the USB device is not malfunction and reattach the USB device.</li> </ul>
	"USB HUB IS NOT SUPPORTED" appears. <ul style="list-style-type: none"> <li>This unit cannot support a USB device connected via a USB hub.</li> </ul>
	<ul style="list-style-type: none"> <li>The source does not change to "USB" when you connect a USB device while listening to another source.</li> <li>"USB ERROR" appears.</li> </ul> <ul style="list-style-type: none"> <li>The USB port is drawing more power than the design limit. Turn the power off and unplug the USB device. Then, turn on the power and reattach the USB device. If this does not solve the problem, turn the power off and on (or reset the unit) before replacing with another USB device.</li> </ul>
	The iPod/iPhone does not turn on or does not work. <ul style="list-style-type: none"> <li>Check the connection between this unit and iPod/iPhone.</li> <li>Disconnect and reset the iPod/iPhone using hard reset.</li> </ul>
	"LOADING" appears when you enter search mode by pressing <b>Q/5</b> . <ul style="list-style-type: none"> <li>This unit is still preparing the iPod/iPhone music list. It may take some time to load, try again later.</li> </ul>
	"NA FILE" <ul style="list-style-type: none"> <li>Make sure the media (USB) contain supported audio files. (Page 32)</li> </ul>
	"COPY PRO" <ul style="list-style-type: none"> <li>A copy-protected file is played (USB)</li> </ul>



## TROUBLESHOOTING

Symptom	Remedy
USB/iPod	"NO DEVICE" Connect a device (USB), and change the source to USB again.
	"NO MUSIC" Connect a device (USB) that contains playable audio files.
	"iPod ERROR" <ul style="list-style-type: none"> <li>Reconnect the iPod.</li> <li>Reset the iPod.</li> </ul>
ANDROID	<ul style="list-style-type: none"> <li>Sound cannot be heard during playback.</li> <li>Sound output only from the Android device.</li> </ul>
	<ul style="list-style-type: none"> <li>Reconnect the Android device.</li> <li>Launch any media player application on the Android device and start playback.</li> <li>Relaunch the current media player application or use another media player application.</li> <li>Restart the Android device.</li> <li>If this does not solve the problem, the connected Android device is unable to route the audio signal to unit. (Page 32)</li> <li>If USB connection does not work, connect the Android device via Bluetooth or through auxiliary input jack.</li> </ul>
	"NO DEVICE" or "READING" keeps flashing. <ul style="list-style-type: none"> <li>Reconnect the Android device.</li> <li>If USB connection does not work, connect the Android device via Bluetooth or through auxiliary input jack.</li> </ul>
	Playback is intermittent or sound skips. Turn off the power saving mode on the Android device.
	"NO MUSIC" / "ANDROID ERROR" <ul style="list-style-type: none"> <li>Make sure Android device contains playable audio files.</li> <li>Reconnect the Android device.</li> <li>Restart the Android device.</li> </ul>
Pandora	"ADD ERROR" New station creation is unsuccessful.
	"CHECK DEVICE" Check the Pandora application on your device.
	"NO SKIPS" The skip limit has been reached.
	"NO STATIONS" No stations are found.

Symptom	Remedy
Pandora	"STATION LIMIT" The number of registered stations has reached its limit. Retry after deleting unnecessary stations from your device.
	"UPGRADE APP" Make sure you have installed the latest version of the Pandora application on your device.
	"CONNECT ERROR" Communication is unstable.
	"RATING ERROR" Registration of thumbs up/thumbs down has failed due to insufficient network connectivity.
	"THUMBS N/A" Registration of thumbs up/thumbs down is not allowed.
iHeartRadio	"LICENSE ERROR" You try to access from a country which Pandora is not deliverable.
	Station cannot be selected. If "Explicit Content" in <b>[Account Settings]</b> is checked in the web version of iHeartRADIO, custom stations become unavailable.
Spotify	"NOT CONNECTED" Link to the application is impossible.
	"DISCONNECTED" USB is disconnected from the head unit. Please make sure the device is connected properly through USB.
	"CONNECTING" <ul style="list-style-type: none"> <li>Connected via USB input terminal: The device is connecting to the head unit. Please wait.</li> <li>Connected via Bluetooth: The Bluetooth is disconnected. Please check Bluetooth connection and make sure both the device and unit are paired and connected.</li> </ul>
	"CHECK APP" The Spotify application is not connected properly or user is not login. End the Spotify application and restart. Then, log in to your Spotify account.
SiriusXM® Radio	"CH LOCKED LOCK CODE?" The selected channel is locked. Enter the correct pass code to unlock. (Page 18)
	"CHAN UNSUB" The selected channel is unsubscribed. Call 1-866-635-2349 in the U.S.A. or 1-877-438-9677 in Canada to subscribe. (Page 16)

## TROUBLESHOOTING

Symptom	Remedy
SiriusXM® Radio	"CH UNAVAIL" The selected channel is unavailable. For more information about the SiriusXM channel lineup, visit <www.siriusxm.com>.
	"CHECK ANTENNA" Check that the antenna and its connection are in good condition.
	"CHECK TUNER" Make sure the SiriusXM Vehicle Tuner is connected to the unit.
	"NO SIGNAL" Make sure the antenna is mounted outside the vehicle.
	"SUBSCRIPTION UPDATED — PRESS ENTER TO CONTINUE." Your subscription is updated. Press the volume knob to continue.
	"CODE ERROR" Make sure you have entered the correct pass code. (Page 18)
	"NO CONTENT" There is insufficient content to start TuneScan.
	"SCAN CANCEL" TuneScan has been aborted.
Bluetooth®	No Bluetooth device is detected. • Search from the Bluetooth device again. • Reset the unit. (Page 3)
	Pairing cannot be made. • Make sure you have entered the same PIN code to both the unit and Bluetooth device. • Delete pairing information from both the unit and the Bluetooth device, then perform pairing again. (Page 19)
	Echo or noise is heard during a phone conversation. • Adjust the microphone unit's position. (Page 19) • Check the <b>[ECHO CANCEL]</b> setting. (Page 21)
	Phone sound quality is poor. • Reduce the distance between the unit and the Bluetooth device. • Move the car to a place where you can get a better signal reception.

Symptom	Remedy
Bluetooth®	Voice calling method is not successful. • Use voice calling method in a more quiet environment. • Reduce the distance from the microphone when you speak the name. • Make sure the same voice as the registered voice tag is used.
	Sound is being interrupted or skipped during playback of a Bluetooth audio player. • Reduce the distance between the unit and the Bluetooth audio player. • Turn off, then turn on the unit and try to connect again. • Other Bluetooth devices might be trying to connect to the unit.
	The connected Bluetooth audio player cannot be controlled. • Check whether the connected Bluetooth audio player supports Audio/Video Remote Control Profile (AVRCP). (Refer to the instructions of your audio player.) • Disconnect and connect the Bluetooth player again.
	"NOT SUPPORT" The connected phone does not support Voice Recognition feature or phonebook transfer.
	"NO ENTRY"/"NO PAIR" There is no registered device connected/found via Bluetooth.
	"ERROR" Try the operation again. If "ERROR" appears again, check if the device supports the function you have tried.
	"NO INFO"/"NO DATA" Bluetooth device cannot get the contact information.
	"HF ERROR XX"/ "BT ERROR" Reset the unit and try the operation again. If this does not solve the problem, consult your nearest service center.
	"SWITCHING NG" The connected phones might not support phone switching feature.
	The Bluetooth connection between the Bluetooth device and the unit is unstable. Delete the unused registered Bluetooth device from the unit. (Page 23)

# INSTALLATION/CONNECTION

## ▲ Warning

- The unit can only be used with a 12 V DC power supply, negative ground.
- Disconnect the battery's negative terminal before wiring and mounting.
- Do not connect Battery wire (yellow) and Ignition wire (red) to the car chassis or Ground wire (black) to prevent a short circuit.
- To prevent short circuit:
  - Insulate unconnected wires with vinyl tape.
  - Be sure to ground this unit to the car's chassis again after installation.
  - Secure the wires with cable clamps and wrap vinyl tape around the wires that comes into contact with metal parts to protect the wires.

## ▲ Caution

- For safety's sake, leave wiring and mounting to professionals. Consult the car audio dealer.
- Install this unit in the console of your vehicle. Do not touch the metal parts of this unit during and shortly after use of the unit. Metal parts such as the heat sink and enclosure become hot.
- Do not connect the ⊖ wires of speakers to the car chassis or Ground wire (black), or connect them in parallel.
- Mount the unit at an angle of less than 30°.
- If your vehicle wiring harness does not have the ignition terminal, connect Ignition wire (red) to the terminal on the vehicle's fuse box which provides 12 V DC power supply and is turned on and off by the ignition key.
- Keep all cables away from heat dissipate metal parts.
- After the unit is installed, check whether the brake lamps, blinkers, wipers, etc. on the car are working properly.
- If the fuse blows, first make sure the wires are not touching car's chassis, then replace the old fuse with one that has the same rating.

## Part list for installation

(A) Faceplate (×1)



(B) Trim plate (×1)



(C) Mounting sleeve (×1)

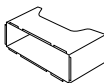

(D) Wiring harness (×1)

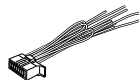

(E) Extraction key (×2)

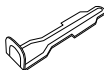

(F) Screws\*

 M5 × 7 mm (×4)

 M5 × 6 mm (×4)

 M4 × 8 mm (×1)

\* Supplied for **KMM-BT525HD / KMM-X503 / KMM-BT325 / KMR-M325BT**.

## Basic procedure

- 1 Remove the key from the ignition switch, then disconnect the ⊖ terminal of the car battery.
- 2 Connect the wires properly.  
See "Wiring connection" on page 41.
- 3 Install the unit to your car.  
See "Installing the unit (in-dash mounting)" on page 40.
- 4 Connect the ⊖ terminal of the car battery.
- 5 Press  SRC to turn on the power.
- 6 Detach the faceplate and reset the unit within 5 seconds. (Page 3)

## Installing the unit (in-dash mounting)

1

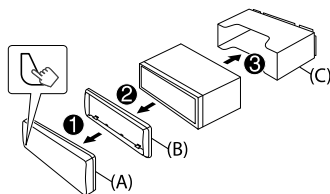

2

2 Do the required wiring.  
(Page 41)

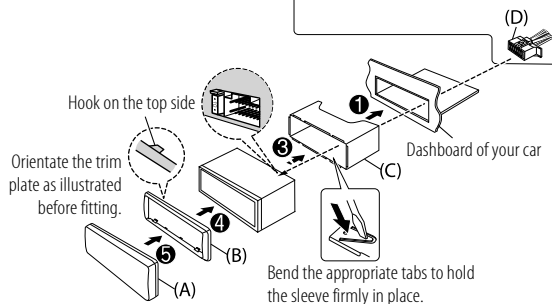

## Installing the unit (without mounting sleeve)

- 1 Remove the mounting sleeve and trim plate from the unit.
- 2 Align the holes in the unit (on both sides) with the vehicle mounting bracket and secure the unit with screws (supplied/commercially available).

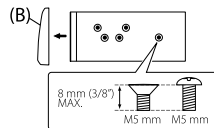

⚠ Use only the specified screws. Using wrong screws might damage the unit.

## Removing the unit

- 1 Detach the faceplate.
- 2 Remove the trim plate.
- 3 Insert the extraction keys deeply into the slots on each side, then follow the arrows as shown on the illustration.

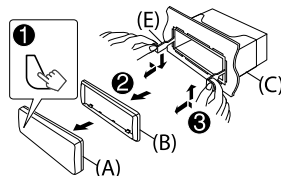

## INSTALLATION/CONNECTION

### Wiring connection

#### IMPORTANT

We recommend installing the unit with a commercially available custom wiring harness specific for your car and leave this job to professionals for your safety. Consult your car audio dealer.

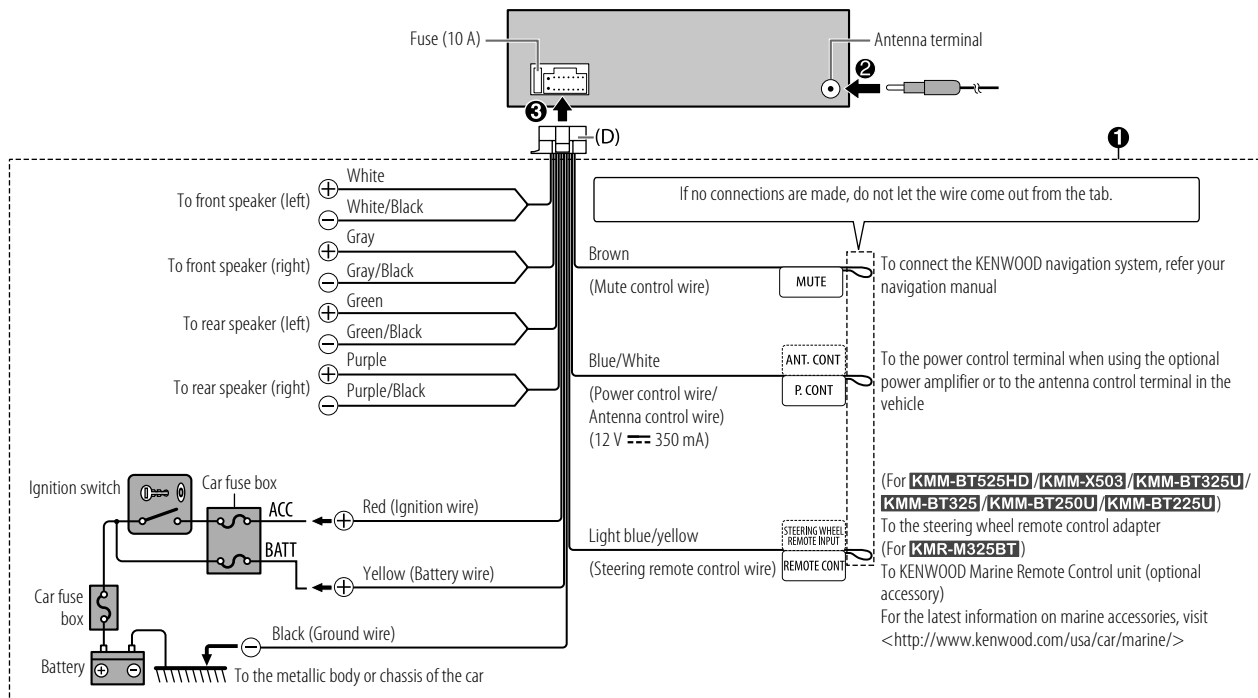

## INSTALLATION/CONNECTION

### Connecting external components

#### KMM-BT525HD / KMM-X503

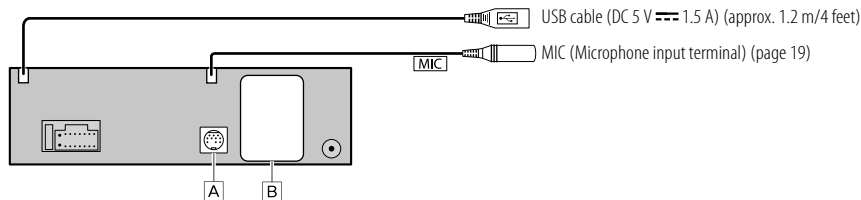

#### KMM-BT325U / KMR-M325BT

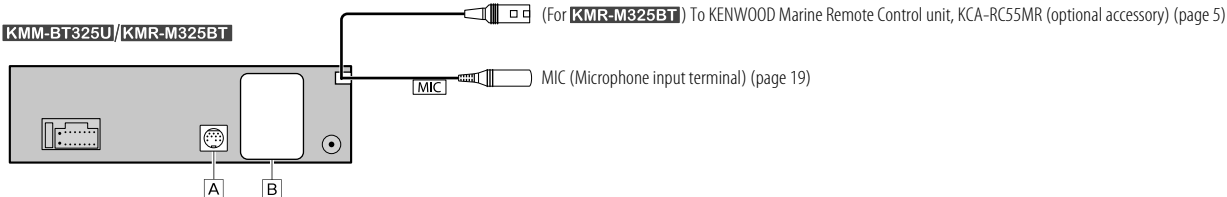

#### KMM-BT325 / KMM-BT250U / KMM-BT225U

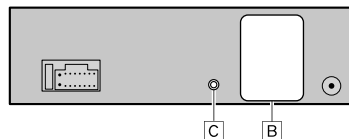

**A** Expansion port (12 V  $\equiv$  500 mA): To the optional SiriusXM Vehicle Tuner (commercially available) (page 16)

#### **B** Output terminals

When connecting to an external amplifier, connect its ground wire to the car's chassis to avoid damaging the unit.

**KMM-BT525HD**  
**KMM-X503**  
**KMM-BT325U**  
**KMM-BT325**  
**KMR-M325BT**



**KMM-BT250U**  
**KMM-BT225U**



**C** Microphone input jack (page 19)

# SPECIFICATIONS

KMM-BT525HD / KMM-X503 :		
Tuner	FM	Frequency Range
		87.9 MHz — 107.9 MHz (200 kHz step)
		Usable Sensitivity (S/N = 30 dB)
		7.2 dBf (0.63 $\mu$ V/75 $\Omega$ )
		Quieting Sensitivity (DIN S/N = 46 dB)
		15.2 dBf (1.58 $\mu$ V/75 $\Omega$ )
	Digital FM	Frequency Response ( $\pm 3$ dB)
		30 Hz — 15 kHz
		Signal-to-Noise Ratio (MONO)
		68 dB
		Stereo Separation (1 kHz)
		40 dB
	AM	Frequency Range
		87.9 MHz — 107.9 MHz (200 kHz step)
		Frequency Response ( $\pm 3$ dB)
		20 Hz — 20 kHz
	Digital AM	Signal-to-Noise Ratio (STEREO)
		75 dB
		Frequency Range
		530 kHz — 1 700 kHz (10 kHz step)
		Usable Sensitivity (S/N = 20 dB)
		29 dB $\mu$ (28.2 $\mu$ V)

KMM-BT325U / KMM-BT325 / KMM-BT250U / KMM-BT225U / KMR-M325BT			
Tuner	FM	Frequency Range	KMM-BT325U / KMM-BT250U / KMM-BT225U / KMR-M325BT : 87.9 MHz — 107.9 MHz (200 kHz step)  KMM-BT325 : 87.5 MHz — 108.0 MHz (50 kHz step)
		Usable Sensitivity (S/N = 30 dB)	8.2 dBf (0.71 μV/75 Ω)
		Quieting Sensitivity (DIN S/N = 46 dB)	17.2 dBf (2.0 μV/75 Ω)
		Frequency Response (±3 dB)	30 Hz — 15 kHz
		Signal-to-Noise Ratio (MONO)	64 dB
		Stereo Separation (1 kHz)	40 dB
		AM	Frequency Range
	Usable Sensitivity (S/N = 20 dB)		29 dBμ (28.2 μV)
	USB	USB Standard	USB 1.1, USB 2.0 (Full speed)
		File System	FAT12/16/32
Maximum Supply Current		DC 5 V  1.5 A	
Frequency Response (±1 dB)		20 Hz — 20 kHz	
Signal-to-Noise Ratio		99 dB (1 kHz)	
Dynamic Range		93 dB	
Channel Separation		KMM-BT525HD / KMM-X503 : 91 dB  KMM-BT325U / KMM-BT325 / KMM-BT250U / KMM-BT225U / KMR-M325BT : 89 dB	

## SPECIFICATIONS

Subject to change without notice.

USB	MP3 Decode	Compliant with MPEG-1/2 Audio Layer-3
	WMA Decode	Compliant with Windows Media Audio
	AAC Decode	AAC-LC ".aac", ".m4a" files
	WAV Decode	Linear-PCM
	FLAC Decode	FLAC file (Up to 96 kHz/24 bit)
Auxiliary	Frequency Response ( $\pm 3$ dB)	20 Hz — 20 kHz
	Input Maximum Voltage	1 000 mV
	Input Impedance	30 k $\Omega$
Bluetooth	Version	Bluetooth 3.0
	Frequency Range	2.402 GHz — 2.480 GHz
	RF Output Power (E.I.R.P.)	+4 dBm (MAX), Power Class 2
	Maximum Communication Range	Line of sight approx. 10 m (32.8 ft)
	Profile	HFP 1.6 (Hands-Free Profile) A2DP (Advanced Audio Distribution Profile) AVRCP 1.5 (Audio/Video Remote Control Profile) PBAP (Phonebook Access Profile) SPP (Serial Port Profile)
Audio	Maximum Output Power	50 W $\times$ 4
	Full Bandwidth Power (at less than 1 % THD)	22 W $\times$ 4
	Speaker Impedance	4 $\Omega$ — 8 $\Omega$

Audio	Tone Action	Band 1: 62.5 Hz $\pm$ 9 dB Band 2: 100 Hz $\pm$ 9 dB Band 3: 160 Hz $\pm$ 9 dB Band 4: 250 Hz $\pm$ 9 dB Band 5: 400 Hz $\pm$ 9 dB Band 6: 630 Hz $\pm$ 9 dB Band 7: 1 kHz $\pm$ 9 dB Band 8: 1.6 kHz $\pm$ 9 dB Band 9: 2.5 kHz $\pm$ 9 dB Band 10: 4 kHz $\pm$ 9 dB Band 11: 6.3 kHz $\pm$ 9 dB Band 12: 10 kHz $\pm$ 9 dB Band 13: 16 kHz $\pm$ 9 dB
	Preout Level/Load (USB)	<b>KMM-X503:</b> 5 000 mV/10 k $\Omega$ load  <b>KMM-BT525HD / KMR-M325BT:</b> 4 000 mV/10 k $\Omega$ load  <b>KMM-BT325U / KMM-BT325 / KMM-BT250U / KMM-BT225U:</b> 2 500 mV/10 k $\Omega$ load
	Preout Impedance	$\leq$ 600 $\Omega$
General	Operating Voltage	12 V DC car battery
	Installation Size (W $\times$ H $\times$ D)	182 mm $\times$ 53 mm $\times$ 100 mm (7-3/16" $\times$ 2-1/16" $\times$ 3-15/16")
	Net Weight (includes Trimplate, Mounting Sleeve)	<b>KMM-BT525HD / KMM-X503 / KMR-M325BT:</b> 0.7 kg (1.5 lbs)  <b>KMM-BT325U / KMM-BT325:</b> 0.6 kg (1.4 lbs)  <b>KMM-BT250U / KMM-BT225U:</b> 0.6 kg (1.3 lbs)



**HD Radio®**

This HD Radio receiver enables:

HD2/HD3

Digital Sound

Program Info

Emergency Alerts



**iHeart**  
RADIO



**SiriusXM**  
READY

**pandora**®

Made for

**iPhone** | **iPod**

**Qualcomm**  
aptX™



**Spotify**®

**Bluetooth**®



#### libFLAC

Copyright (C) 2000-2009 Josh Coalson

Copyright (C) 2011-2013 Xiph.Org Foundation

Redistribution and use in source and binary forms, with or without modification, are permitted provided that the following conditions are met:

- Redistributions of source code must retain the above copyright notice, this list of conditions and the following disclaimer.
- Redistributions in binary form must reproduce the above copyright notice, this list of conditions and the following disclaimer in the documentation and/or other materials provided with the distribution.
- Neither the name of the Xiph.Org Foundation nor the names of its contributors may be used to endorse or promote products derived from this software without specific prior written permission.

THIS SOFTWARE IS PROVIDED BY THE COPYRIGHT HOLDERS AND CONTRIBUTORS "AS IS" AND ANY EXPRESS OR IMPLIED WARRANTIES, INCLUDING, BUT NOT LIMITED TO, THE IMPLIED WARRANTIES OF MERCHANTABILITY AND FITNESS FOR A PARTICULAR PURPOSE ARE DISCLAIMED. IN NO EVENT SHALL THE FOUNDATION OR CONTRIBUTORS BE LIABLE FOR ANY DIRECT, INDIRECT, INCIDENTAL, SPECIAL, EXEMPLARY, OR CONSEQUENTIAL DAMAGES (INCLUDING, BUT NOT LIMITED TO, PROCUREMENT OF SUBSTITUTE GOODS OR SERVICES; LOSS OF USE, DATA, OR PROFITS; OR BUSINESS INTERRUPTION) HOWEVER CAUSED AND ON ANY THEORY OF LIABILITY, WHETHER IN CONTRACT, STRICT LIABILITY, OR TORT (INCLUDING NEGLIGENCE OR OTHERWISE) ARISING IN ANY WAY OUT OF THE USE OF THIS SOFTWARE, EVEN IF ADVISED OF THE POSSIBILITY OF SUCH DAMAGE.

- Microsoft and Windows Media are either registered trademarks or trademarks of Microsoft Corporation in the United States and/or other countries.
- HD Radio Technology manufactured under license from iBiquity Digital Corporation. U.S. and Foreign Patents. For patents see <http://dts.com/patents>. HD Radio™ and the HD, HD Radio, and "ARC" logos are registered trademarks or trademarks of iBiquity Digital Corporation in the United States and/or other countries.
- Use of the Made for Apple badge means that an accessory has been designed to connect specifically to the Apple product(s) identified in the badge, and has been certified by the developer to meet Apple performance standards. Apple is not responsible for the operation of this device or its compliance with safety and regulatory standards. Please note that the use of this accessory with an Apple product may affect wireless performance.
- Apple, iPhone, iPod, iPod nano, iPod touch, and Lightning are trademarks of Apple Inc., registered in the U.S. and other countries.
- Pandora, the Pandora logo, and the Pandora trade dress are trademarks or registered trademarks of Pandora Media, Inc., used with permission.
- iHeartRadio® and iHeartAuto™ are trademarks owned by iHeartMedia, Inc. All uses are authorized under license.
- Sirius, XM and all related marks and logos are trademarks of Sirius XM Radio Inc. All rights reserved.
- SPOTIFY and the Spotify logo are among the registered trademarks of Spotify AB.
- Android is a trademark of Google LLC.
- The "AAC" logo is a trademark of Dolby Laboratories.
- The Bluetooth® word mark and logos are registered trademarks owned by the Bluetooth SIG, Inc. and any use of such marks by JVC KENWOOD Corporation is under license. Other trademarks and trade names are those of their respective owners.
- Qualcomm aptX is a product of Qualcomm Technologies International, Ltd. Qualcomm is a trademark of Qualcomm Incorporated, registered in the United States and other countries, used with permission. aptX is a trademark of Qualcomm Technologies International, Ltd., registered in the United States and other countries, used with permission.

## KMM-BT525HD KMM-X503 KMM-BT325U

## KMM-BT325 KMM-BT250U KMM-BT225U

## KMR-M325BT

DIGITAL MEDIA RECEIVER

### Quick Start Guide

RÉCEPTEUR MULTIMÉDIA NUMÉRIQUE

### Guide de démarrage rapide

RECEPTOR DE MEDIOS DIGITALES

### Guía de inicio rápido

JVC KENWOOD Corporation

For your records

Record the serial number, found on the back of the unit, in the spaces designated on the warranty card, and in the space provided below. Refer to the model and serial numbers whenever you call upon your Kenwood dealer for information or service on the product.

Model KMM-BT525HD/KMM-X503/KMM-BT325U/KMM-BT325/KMM-BT250U/KMM-BT225U/KMR-M325BT

Serial number \_\_\_\_\_

*US Residents Only*

### Register Online

Register your Kenwood product at <http://www.kenwood.com/usa/>

For detailed operations and information, refer to the INSTRUCTION MANUAL on the following website:  
Pour les opérations et les informations détaillées, reportez-vous au MODE D'EMPLOI sur le site web suivant:  
Para obtener más información y detalles sobre las operaciones, consulte el MANUAL DE INSTRUCCIONES en el siguiente sitio web:



[<www.kenwood.com/cs/ce/>](http://www.kenwood.com/cs/ce/)

**Información acerca de la eliminación de equipos eléctricos y electrónicos al final de la vida útil (aplicable a los países que hayan adoptado sistemas independientes de recogida de residuos)**



Los productos con el símbolo de un contenedor con ruedas tachado no podrán ser desechados como residuos domésticos. Los equipos eléctricos y electrónicos al final de la vida útil, deberán ser reciclados en instalaciones que puedan dar el tratamiento adecuado a estos productos y a sus subproductos residuales correspondientes. Póngase en contacto con su administración local para obtener información sobre el punto de recogida más cercano. Un tratamiento correcto del reciclaje y la eliminación de residuos ayuda a conservar los recursos y evita al mismo tiempo efectos perjudiciales en la salud y el medio ambiente.

**Informação sobre a eliminação de pilhas**

Este produto não deve ser eliminado como lixo doméstico geral. Devolva a pilha usada ao revendedor ou entidade autorizada para que a mesma seja devolvida ao fabricante ou importador. A reciclagem e a eliminação de lixo de maneira apropriada ajudarão a conservar os recursos naturais ao mesmo tempo que prevenirão os efeitos prejudiciais à nossa saúde e ao meio ambiente.

**FCC WARNING**

This equipment may generate or use radio frequency energy. Changes or modifications to this equipment may cause harmful interference unless the modifications are expressly approved in the instruction manual. The user could lose the authority to operate this equipment if an unauthorized change or modification is made.

**FCC NOTE**

This equipment has been tested and found to comply with the limits for a Class B digital device, pursuant to Part 15 of the FCC Rules. These limits are designed to provide reasonable protection against harmful interference in a residential installation. This equipment may cause harmful interference to radio communications, if it is not installed and used in accordance with the instructions. However, there is no guarantee that interference will not occur in a particular installation. If this equipment does cause harmful interference to radio or television reception, which can be determined by turning the equipment off and on, the user is encouraged to try to correct the interference by one or more of the following measures:

- Reorient or relocate the receiving antenna.
- Increase the separation between the equipment and receiver.
- Connect the equipment into an outlet on a circuit different from that to which the receiver is connected.
- Consult the dealer or an experienced radio/TV technician for help.

**Supplier's Declaration of Conformity**

Trade Name: KENWOOD  
Products: DIGITAL MEDIA RECEIVER  
Model Name: KMM-BT525HD/KMM-X503/KMM-BT325U/KMM-BT325/  
KMM-BT250U/KMM-BT225U/KMR-M325BT  
Responsible Party: JVC KENWOOD USA CORPORATION  
2201 East Dominguez Street, Long Beach, CA 90810, U.S.A.  
PHONE: 310 639-9000

THIS DEVICE COMPLIES WITH PART 15 OF THE FCC RULES. OPERATION IS SUBJECT TO THE FOLLOWING TWO CONDITIONS:

- (1) THIS DEVICE MAY NOT CAUSE HARMFUL INTERFERENCE, AND
- (2) THIS DEVICE MUST ACCEPT ANY INTERFERENCE RECEIVED, INCLUDING INTERFERENCE THAT MAY CAUSE UNDESIRE OPERATION.

**IC (Industry Canada) Notice**

This device complies with Industry Canada's licence-exempt RSSs.

Operation is subject to the following two conditions:

- (1) This device may not cause interference; and
- (2) This device must accept any interference, including interference that may cause undesired operation of the device.

**Note de IC (Industrie Canada)**

Le présent appareil est conforme aux CNR d'Industrie Canada applicables aux appareils radio exempts de licence.

L'exploitation est autorisée aux deux conditions suivantes:

- (1) l'appareil ne doit pas produire de brouillage;
- (2) l'utilisateur de l'appareil doit accepter tout brouillage radioélectrique subi, même si le brouillage est susceptible d'en compromettre le fonctionnement.

Contains Bluetooth Module

**KMM-BT525HD/KMM-X503/KMM-BT325U/  
KMM-BT325/KMM-BT250U/KMM-BT225U:**

FCC ID: ZWY8811X

IC ID: 12033A-8811X

**KMR-M325BT:**

FCC ID: ZWY8350X

IC ID: 12033A-8350X

This transmitter must not be co-located or operated in conjunction with any other antenna or transmitter.

**CAUTION**

This equipment complies with FCC/IC radiation exposure limits set forth for an uncontrolled environment and meets the FCC radio frequency (RF) Exposure Guidelines and RSS-102 of the IC radio frequency (RF) Exposure rules. This equipment has very low levels of RF energy that it deemed to comply without maximum permissive exposure evaluation (MPE). But it is desirable that it should be installed and operated keeping the radiator at least 20cm or more away from person's body.

**ATTENTION**

Cet équipement est conforme aux limites d'exposition aux rayonnements énoncées pour un environnement non contrôlé et respecte les règles des radioélectriques (RF) de la FCC lignes directrices d'exposition et d'exposition aux fréquences radioélectriques (RF) CNR-102 de l'IC. Cet équipement émet une énergie RF très faible qui est considérée comme conforme sans évaluation de l'exposition maximale autorisée (MPE). Cependant, il est souhaitable qu'il devrait être installé et utilisé en gardant une distance de 20 cm ou plus entre le radiateur et le corps humain.

**Para cumplimiento de la IFT:**

"La operación de este equipo está sujeta a las siguientes dos condiciones:

- (1) es posible que este equipo o dispositivo no cause interferencia perjudicial y
- (2) este equipo o dispositivo debe aceptar cualquier interferencia, incluyendo la que pueda causar su operación no deseada"

# SOFTWARE LICENSE AGREEMENT

The software embedded in the Product (hereinafter the "Licensed Software") provided by Licensor is copyrighted to or sublicensable by the Licensor, and this Agreement provides for the terms and conditions which Users shall follow in order to use the Licensed Software.

The User shall use the Licensed Software by agreeing with the terms of this Software License Agreement. This Agreement shall be deemed completed at the time the User (hereinafter the "User") initially used the Product in which the "Licensed Software" is embedded.

The Licensed Software may include the software which has been licensed to the Licensor directly or indirectly from any third party. In such case, some third parties require the Users to follow their conditions for use separately from this Software License Agreement. Such software shall not be subject to this Agreement, and the Users are urged to read the "Important Notice concerning the Software" to be provided separately below.

## Article 1 General Provision

The Licensor shall grant to the User a non-exclusive and non-transferable (other than the exceptional case referred to in Article 3, Paragraph 1) licensed to use the Licensed Software within the country of the User. (the country where the User bought the Product (hereinafter the "Country"))

## Article 2 License

1. The license granted under this Agreement shall be the right to use the Licensed Software in the Product.
2. The User shall not duplicate, copy, modify, add, translate or otherwise alter, or lease the Licensed Software and any related documents, whether in whole or in part.
3. The use of the Licensed Software shall be limited to personal purpose, and the Licensed Software shall not be distributed, licensed or sub-licensed whether it is for commercial purpose or not.
4. The User shall use the Licensed Software according to the directions described in the operation manual or help file, and is prohibited to use or duplicate any data in a manner violating the Copyright Law or any other laws and regulations by applying whole or a part of the Licensed Software.

## Article 3 Conditions for Grant of License

1. When the User transfers the Product, it may also transfer the license to use the Licensed Software embedded in the Product (including any related materials, updates and upgrades) on condition that no original, copies or related materials continue in the possession of the User, and that the User shall cause the transferee to comply with this Software License Agreement.
2. The User shall not carry out reverse engineering, disassembling, decompiling or any other code analysis works in connection with the Licensed Software.

## Article 4 Right pertaining to the Licensed Software

Any and all copyrights and other rights pertaining to the Licensed Software and related documents shall belong to the Licensor or the original holder of the right who granted to the Licensor the license or sublicense for the Licensed Software (hereinafter the "Original Rightholder"), and the User shall not be entitled to any right other than the license granted hereunder, in respect of the Licensed Software and any related documents.

## Article 5 Indemnification of Licensor

1. Neither the Licensor nor the Original Rightholder shall be liable for any damage incurred by the User or any third party due to the exercise of the license granted to the User under this Agreement, unless otherwise restricted by law.
2. The Licensor will offer no guarantee for the merchantability, convertibility and consistency with certain objective of the Licensed Software.

## Article 6 Liability to Third Party

If any dispute has arisen with any third party due to an infringement upon a copyright, patent or any other intellectual property right that was caused by the User's use of the Licensed Software, the User shall settle such dispute at its own cost and hold the Licensor and the Original Rightholder harmless from any inconvenience it may cause.

## Article 7 Confidentiality

The User shall keep the confidentiality of such portion of the Licensed Software, related documents thereof or any other information to be granted under this Agreement, as well as the conditions of this Agreement as has not yet entered the public domain, and shall not disclose or divulge the same to any third party without approval of the Licensor.

## Article 8 Termination

In case the User falls under any of the events described in the following items, the Licensor may immediately terminate this Agreement or claim that the User compensates for the damage incurred by the Licensor due to such event:

- (1) when the User violated any provision of this Agreement; or
- (2) when a petition has been filed against the User for an attachment, provisional attachment, provisional disposition or any other compulsory execution.

## Article 9 Destruction of the Licensed Software

If this Agreement is terminated pursuant to the provision of Article 8, the User shall destroy the Licensed Software, any related documents and copies thereof within two (2) weeks from such date of termination.

#### Article 10 Protection of Copyright

1. The copyright and all the other intellectual property rights relating to the Licensed Software shall belong to the Licensor and the Original Rightholder, and in no event shall they be under the ownership of the User.
2. The User shall, whenever it uses the Licensed Software, comply with any laws relating to the copyright and other intellectual property rights.

#### Article 11 Export Restriction

1. It is prohibited to export the Licensed Software and any related documents outside the country of the User (including transmission thereof outside the country of the User via Internet of other communication tools).
2. The User shall understand that the Licensed Software shall be subject to the export restrictions adopted by the country of User and any other countries.
3. The User shall agree that the software will be subject to any and all applicable international and domestic laws (including the export control regulation of the country of User and any other countries, and any restrictions concerning the end-users, the use by end-users and importing countries to be provided by the country of User and any other countries, and any other governmental authorities).

#### Article 12 Miscellaneous

1. In the event any part of this Agreement is invalidated by operation of law, the residual provisions shall continue in force.
2. Matters not stipulated in this Agreement or any ambiguity or question raised in the construction of this Agreement shall be provided or settled upon good-faith consultation between the Licensor and the User.
3. The Licensor and the User hereby agree that this Agreement is governed by the laws of Japan, and any dispute arising from, and relating to the rights and obligations under, this Agreement shall be submitted to the exclusive jurisdiction of the Tokyo District Court for its first instance.

## Important Notice concerning the Software

-jansson

Copyright (c) 2009-2012 Petri Lehtinen <petri@digip.org>

Permission is hereby granted, free of charge, to any person obtaining a copy of this software and associated documentation files (the "Software"), to deal in the Software without restriction, including without limitation the rights to use, copy, modify, merge, publish, distribute, sublicense, and/or sell copies of the Software, and to permit persons to whom the Software is furnished to do so, subject to the following conditions:

The above copyright notice and this permission notice shall be included in all copies or substantial portions of the Software.

THE SOFTWARE IS PROVIDED "AS IS", WITHOUT WARRANTY OF ANY KIND, EXPRESS OR IMPLIED, INCLUDING BUT NOT LIMITED TO THE WARRANTIES OF MERCHANTABILITY, FITNESS FOR A PARTICULAR PURPOSE AND NONINFRINGEMENT. IN NO EVENT SHALL THE AUTHORS OR COPYRIGHT HOLDERS BE LIABLE FOR ANY CLAIM, DAMAGES OR OTHER LIABILITY, WHETHER IN AN ACTION OF CONTRACT, TORT OR OTHERWISE, ARISING FROM, OUT OF OR IN CONNECTION WITH THE SOFTWARE OR THE USE OR OTHER DEALINGS IN THE SOFTWARE.

-cJSON

Copyright (c) 2009 Dave Gamble

Permission is hereby granted, free of charge, to any person obtaining a copy of this software and associated documentation files (the "Software"), to deal in the Software without restriction, including without limitation the rights to use, copy, modify, merge, publish, distribute, sublicense, and/or sell copies of the Software, and to permit persons to whom the Software is furnished to do so, subject to the following conditions:

The above copyright notice and this permission notice shall be included in all copies or substantial portions of the Software.

THE SOFTWARE IS PROVIDED "AS IS", WITHOUT WARRANTY OF ANY KIND, EXPRESS OR IMPLIED, INCLUDING BUT NOT LIMITED TO THE WARRANTIES OF MERCHANTABILITY, FITNESS FOR A PARTICULAR PURPOSE AND NONINFRINGEMENT. IN NO EVENT SHALL THE AUTHORS OR COPYRIGHT HOLDERS BE LIABLE FOR ANY CLAIM, DAMAGES OR OTHER LIABILITY, WHETHER IN AN ACTION OF CONTRACT, TORT OR OTHERWISE, ARISING FROM, OUT OF OR IN CONNECTION WITH THE SOFTWARE OR THE USE OR OTHER DEALINGS IN THE SOFTWARE.

-CMP

The MIT License (MIT)

Copyright (c) 2014 Charles Gunyon

Permission is hereby granted, free of charge, to any person obtaining a copy of this software and associated documentation files (the "Software"), to deal in the Software without restriction, including without limitation the rights to use, copy, modify, merge, publish, distribute, sublicense, and/or sell copies of the Software, and to permit persons to whom the Software is furnished to do so, subject to the following conditions:

The above copyright notice and this permission notice shall be included in all copies or substantial portions of the Software.

THE SOFTWARE IS PROVIDED "AS IS", WITHOUT WARRANTY OF ANY KIND, EXPRESS OR IMPLIED, INCLUDING BUT NOT LIMITED TO THE WARRANTIES OF MERCHANTABILITY, FITNESS FOR A PARTICULAR PURPOSE AND NONINFRINGEMENT. IN NO EVENT SHALL THE AUTHORS OR COPYRIGHT HOLDERS BE LIABLE FOR ANY CLAIM, DAMAGES OR OTHER LIABILITY, WHETHER IN AN ACTION OF CONTRACT, TORT OR OTHERWISE, ARISING FROM, OUT OF OR IN CONNECTION WITH THE SOFTWARE OR THE USE OR OTHER DEALINGS IN THE SOFTWARE.

# INSTALLATION/CONNECTION

## ▲ Warning

- The unit can only be used with a 12 V DC power supply, negative ground.
- Disconnect the battery's negative terminal before wiring and mounting.
- Do not connect Battery wire (yellow) and Ignition wire (red) to the car chassis or Ground wire (black) to prevent a short circuit.
- To prevent short circuit:
  - Insulate unconnected wires with vinyl tape.
  - Be sure to ground this unit to the car's chassis again after installation.
  - Secure the wires with cable clamps and wrap vinyl tape around the wires that comes into contact with metal parts to protect the wires.

## ▲ Caution

- For safety's sake, leave wiring and mounting to professionals. Consult the car audio dealer.
- Install this unit in the console of your vehicle. Do not touch the metal parts of this unit during and shortly after use of the unit. Metal parts such as the heat sink and enclosure become hot.
- Do not connect the  $\ominus$  wires of speakers to the car chassis or Ground wire (black), or connect them in parallel.
- Mount the unit at an angle of less than 30°.
- If your vehicle wiring harness does not have the ignition terminal, connect Ignition wire (red) to the terminal on the vehicle's fuse box which provides 12 V DC power supply and is turned on and off by the ignition key.
- Keep all cables away from heat dissipate metal parts.
- After the unit is installed, check whether the brake lamps, blinkers, wipers, etc. on the car are working properly.
- If the fuse blows, first make sure the wires are not touching car's chassis, then replace the old fuse with one that has the same rating.

## ■ Basic procedure

- 1 Remove the key from the ignition switch, then disconnect the  $\ominus$  terminal of the car battery.
- 2 Connect the wires properly. See "Wiring connection" on page 3.
- 3 Install the unit to your car. See "Installing the unit (in-dash mounting)".
- 4 Connect the  $\ominus$  terminal of the car battery.
- 5 Press  $\odot$  SRC to turn on the power.
- 6 Detach the faceplate and reset the unit within 5 seconds. See "How to reset" on page 4.

### Installing the unit (in-dash mounting)

1

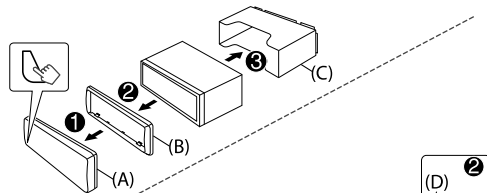

2

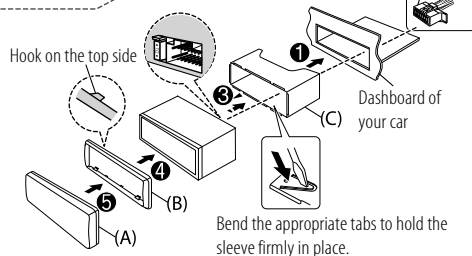

### Installing the unit (without mounting sleeve)

- 1 Remove the mounting sleeve and trim plate from the unit.
- 2 Align the holes in the unit (on both sides) with the vehicle mounting bracket and secure the unit with screws (supplied/ commercially available).

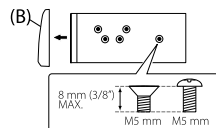

▲ Use only the specified screws.  
Using wrong screws might damage the unit.

### Removing the unit

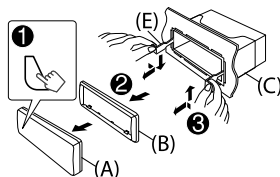

### Part list (supplied)

- (A) Faceplate (x1)  
 (B) Trimplate (x1)  
 (C) Mounting sleeve (x1)  
 (D) Wiring harness (x1)  
 (E) Extraction key (x2)
- (F) Screw (supplied for  
**KMM-BT525HD/ KMM-X503/**  
**KMM-BT325/ KMR-M325BT**)
- ① M5 × 7 mm (x4)
  - ② M5 × 6 mm (x4)
  - ③ M4 × 8 mm (x1)

### Wiring connection

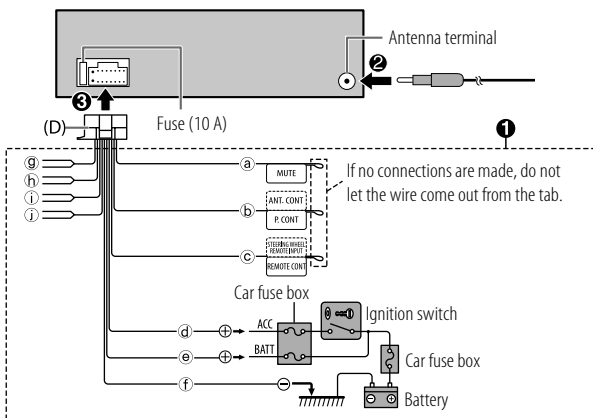

- (a) Brown: To connect the KENWOOD navigation system, refer your navigation manual
- (b) Blue/white: To the power control terminal when using the optional power amplifier or to the antenna control terminal in the vehicle
- (c) Light blue/yellow: To the steering wheel remote control adapter or to KENWOOD Marine Remote Control unit (optional accessory) for **KMR-M325BT**
- (d) Red: Ignition 12 V
- (e) Yellow: Battery 12 V
- (f) Black: Ground
- (g) White ⊕, White/black ⊖: Front speaker (left)
- (h) Gray ⊕, Gray/black ⊖: Front speaker (right)
- (i) Green ⊕, Green/black ⊖: Rear speaker (left)
- (j) Purple ⊕, Purple/black ⊖: Rear speaker (right)



## BEFORE USE

### IMPORTANT

- To ensure proper use, please read through this Guide before using this product. It is especially important that you read and observe Warnings and Cautions in this Guide.
- Please keep the Guide in a safe and accessible place for future reference.

### ▲ Warning

Do not operate any function that takes your attention away from safe driving.

### ▲ Caution

#### Volume setting:

- Adjust the volume so that you can hear sounds outside the car to prevent accidents.
- Lower the volume before playing digital sources to avoid damaging the speakers by the sudden increase of the output level.

#### General:

- Avoid using the external device if it might hinder safe driving.
- Make sure all important data has been backed up. We shall bear no responsibility for any loss of recorded data.
- Never put or leave any metallic objects (such as coins or metal tools) inside the unit to prevent a short circuit.
- USB rating is indicated on the main unit. To view, detach the faceplate.
- Depending on the types of cars, the antenna will automatically extend when you turn on the unit with the antenna control wire connected. Turn off the unit or change the source to STANDBY when parking at a low ceiling area.

## BASICS

### Faceplate

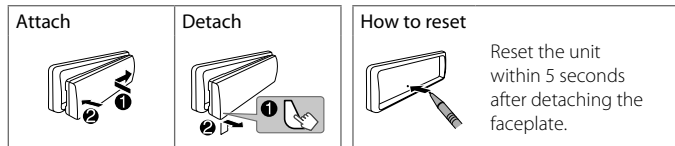
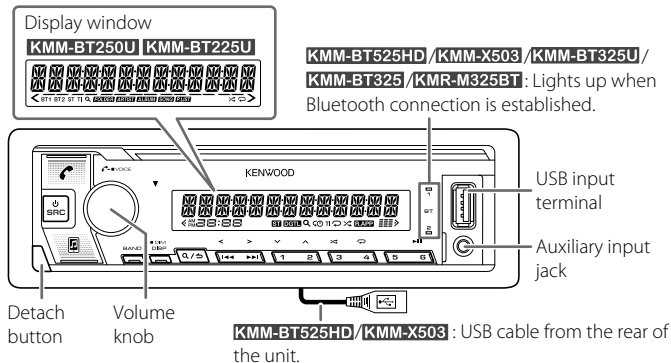

To	On the faceplate
Turn on the power	Press <b>SRC</b> . • Press and hold to turn off the power.
Adjust the volume	Turn the volume knob.
Select a source	Press <b>SRC</b> repeatedly.
Change the display information	Press <b>DISP</b> repeatedly.

# GETTING STARTED

## 1 Select the display language and cancel the demonstration

When you turn on the power for the first time (or [FACTORY RESET] is set to [YES]), the display shows: "SEL LANGUAGE" → "PRESS" → "VOLUME KNOB"

- 1 Turn the volume knob to select [ENG] (English) or [SPA] (Spanish), then press the knob.  
[ENG] is selected for the initial setup.  
Then, (except for [KMR-M325BT]) the display shows: "CANCEL DEMO" → "PRESS" → "VOLUME KNOB".
- 2 Press the volume knob again.  
[YES] is selected for the initial setup.
- 3 Press the volume knob again.  
"DEMO OFF" appears.

## 2 Set the clock and date

- 1 Press the volume knob to enter [FUNCTION].
- 2 Turn the volume knob to select [CLOCK], then press the knob.

### To adjust the clock

- 3 Turn the volume knob to select [CLOCK ADJUST], then press the knob.
- 4 Turn the volume knob to make the settings, then press the knob.  
Hour → Minute
- 5 Turn the volume knob to select [CLOCK FORMAT], then press the knob.
- 6 Turn the volume knob to select [12H] or [24H], then press the knob.

### To set the date

- 7 Turn the volume knob to select [DATE FORMAT], then press the knob.
- 8 Turn the volume knob to select [DD/MM/YY] or [MM/DD/YY], then press the knob.
- 9 Turn the volume knob to select [DATE SET], then press the knob.

- 10 Turn the volume knob to make the settings, then press the knob.

Day → Month → Year or Month → Day → Year

- 11 Press and hold Q/↵ to exit.

To return to the previous setting item, press Q/↵.

## 3 Set the initial settings

- 1 Press ⏻SRC repeatedly to enter STANDBY.
- 2 Press the volume knob to enter [FUNCTION].
- 3 Turn the volume knob to select an item (see the following table), then press the knob.
- 4 Repeat step 3 until the desired item is selected or activated.
- 5 Press and hold Q/↵ to exit.

To return to the previous setting item, press Q/↵.



Default: [XX]

[SYSTEM]	
[KEY BEEP]	[ON]: Activates the keypress tone. ; [OFF]: Deactivates.
[FACTORY RESET]	[YES]: Resets the settings to default (except the stored station). ; [NO]: Cancels.
[CLOCK]	
[CLOCK DISPLAY]	(Except for [KMR-M325BT]) [ON]: The clock time is shown on the display even when the unit is turned off. ; [OFF]: Cancels.
[ENGLISH]	Select the display language for [FUNCTION] menu and music information if applicable.
[ESPANOL]	By default, [ENGLISH] is selected.

## HD Radio™ tuner/RADIO

For **KMM-BT525HD/KMM-X503**, you can tune in to both conventional and HD Radio broadcasts.

### Search for a station or channel

- 1 Press  SRC repeatedly to select HD RADIO/RADIO.
- 2 Press BAND repeatedly to select FM1/FM2/FM3/AM.
- 3 Press   to search for a station or channel.

### Settings in memory

You can store up to 18 stations/channels for FM and 6 stations/channels for AM.

#### Store a station or channel

While listening to a station/channel....

Press and hold one of the number buttons (1 to 6).









#### Select a stored station or channel

Press one of the number buttons (1 to 6).

## USB/iPod/ANDROID

### Start playback

The source changes automatically and playback starts when you attach a device (USB device/ iPod/iphone/ Android device) to the USB input terminal.

To	On the faceplate
Play back/pause	Press 6  .
Reverse/Fast-forward	Press and hold   .
Select a file	Press   .
Select a folder	Press 2  / 1  .
Repeat play	Press 4  repeatedly.
Random play	Press 3  repeatedly.

# FUNCTIONS SETTINGS

- 1 Press the volume knob to enter [FUNCTION].
- 2 Turn the volume knob to select an item, then press the knob.
- 3 Repeat step 2 until the desired item is selected or activated.
- 4 Press and hold **Q/↵** to exit.

To return to the previous setting item, press **Q/↵**.

- Refer to the INSTRUCTION MANUAL on the following website for the detailed explanation of each item: <[www.kenwood.com/cs/ce/](http://www.kenwood.com/cs/ce/)>
- The availability of each item vary depending on the model.













## [FUNCTION] menu items

- [AUDIO CONTROL] : Sets your preferred audio settings.  
[DISPLAY] : Sets your preferred control for the display window.  
[TUNER SETTING] : Settings for HD radio or radio source.  
[SIRIUS XM] : Settings for Sirius XM tuner.  
[USB] : Settings for using a USB device.  
[BT MODE] : Settings for using a Bluetooth device.  
[REMOTE APP] : Settings for using smartphone to control this unit.  
[MIC GAIN]\* : Sets the sensitivity of the microphone.  
[NR LEVEL]\* : Adjusts the noise reduction level.  
[ECHO CANCEL]\* : Adjusts the echo cancellation delay time.  
[SYSTEM] : Settings for this unit.  
[CLOCK] : Adjusts the clock.  
[ENGLISH] : Selects language for the menu and music information.  
[ESPANOL] : Selects language for the menu and music information.  
[DEMO MODE] : Activates or deactivates the display demonstration.

\* Applicable only while talking on the phone.

## Examples of some well-used settings

### ■ Subwoofer Level Setting

- 1 Press the volume knob to enter [FUNCTION].  
 FUNCTION
- 2 Turn the volume knob to select [AUDIO CONTROL], then press the knob.  
 AUDIO CONTROL → 
- 3 Turn the volume knob to select [SUBWOOFER SET], then press the knob.  
 SUBWOOFER SET → 
- 4 Turn the volume knob to select [SW SET ON], then press the knob.  
 SW SET ON → 
- 5 Turn the volume knob to select [SUB-W LEVEL], then press the knob.  
 SUB-W LEVEL → 
- 6 Turn the volume knob to adjust the subwoofer level, then press the knob.  
 SW LEVEL +7 → 
- 7 Press and hold **Q/↵** to exit.  

Note:

For **KMM-BT250U/KMM-BT225U**, you need to set [SWITCH PREOUT] to [SUB-W] in standby mode before you can make the above settings.

## Illumination Color Setting

For **KMM-BT525HD/KMM-X503/KMM-BT325U/KMM-BT325/KMR-M325BT**, you can set your preferred illumination color for each zone.

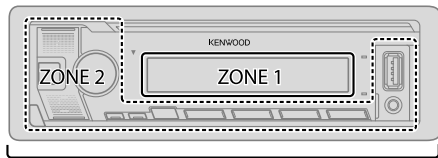

- 1 Press the volume knob to enter [FUNCTION].



- 2 Turn the volume knob to select [DISPLAY], then press the knob.

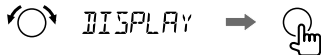

- 3 Turn the volume knob to select [COLOR SELECT], then press the knob.

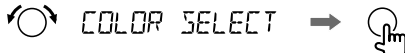

- 4 Turn the volume knob to select a zone ([ALL ZONE], [ZONE 1], [ZONE 2]), then press the knob.



- 5 Turn the volume knob to select a color for the selected zone, then press the knob.



- 6 Repeat step 4 and step 5 to set color for other zones.

- 7 Press and hold **Q** / **↶** to exit.



## OTHER INFORMATION

For playback operations of **AUX, SPOTIFY, Pandora®, iHeartRadio®, SiriusXM® Radio** sources, refer to the INSTRUCTION MANUAL on the following website: <[www.kenwood.com/cs/ce/](http://www.kenwood.com/cs/ce/)>

- The availability of each source vary depending on the model.

### Note for specifications

Bluetooth Frequency Range:

2.402 GHz — 2.480 GHz

Bluetooth RF Output Power (E.I.R.P.):

+4 dBm (MAX), Power Class 2

Speaker Impedance:

4 Ω — 8 Ω

Operating Voltage:

12 V DC car battery

# BLUETOOTH®

Depending on the operating system and the firmware version of your mobile phone, Bluetooth features may not work with this unit.

## ■ Connect the microphone

Connect the supplied microphone to the microphone input terminal/jack on the rear panel.

Adjust the microphone angle

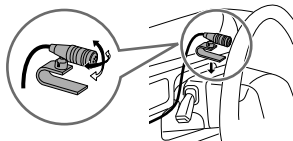

Secure using cord clamps (not supplied) if necessary.

## ■ Pair and connect a Bluetooth device for the first time

- 1 Press **⏻** SRC to turn on the unit.
- 2 Search and select the name of your receiver ("KMM-BT5\*"/"KMM-X5\*"/"KMM-BT3\*"/"KMM-BT2\*"/"KMR-M3\*") on the Bluetooth device.  
"PAIRING" → "PASS XXXXXX" → "Device name" → "PRESS" → "VOLUME KNOB" appears on the display.
  - For some Bluetooth devices, you may need to enter the Personal Identification Number (PIN) code immediately after searching.
- 3 Press the volume knob to start pairing.  
"PAIRING OK" appears when pairing is completed.

Once pairing is completed, Bluetooth connection is established automatically.

- **KMM-BT525HD / KMM-X503 / KMM-BT325U / KMM-BT325 / KMR-M325BT**: "BT1" and/or "BT2" indicator on the faceplate lights up.
- **KMM-BT250U / KMM-BT225U**: "BT1" and/or "BT2" on the display window lights up.

## ■ Answer a call

Press **📞** or the volume knob or one of the number buttons (1 to 6).

- To adjust the phone volume [00] to [35], turn the volume knob.
- To end a call, press **📞**.

## ■ Audio player via Bluetooth

- 1 Press **⏻** SRC repeatedly to select BT AUDIO.
  - Pressing **📶** enters BT AUDIO directly.
- 2 Operate the audio player via Bluetooth to start playback.

To	On the faceplate
Play back/pause	Press 6 <b>▶  </b> .
Select group or folder	Press 2 <b>^</b> / 1 <b>∇</b> .
Reverse skip/Forward skip	Press <b>◀◀</b> / <b>▶▶</b> .
Reverse/Fast-forward	Press and hold <b>◀◀</b> / <b>▶▶</b> .
Repeat play	Press 4 <b>🔄</b> repeatedly.
Random play	Press and hold 3 <b>🎲</b> to select [ALL RANDOM].

- Microsoft and Windows Media are either registered trademarks or trademarks of Microsoft Corporation in the United States and/or other countries.
- HD Radio Technology manufactured under license from iBiquity Digital Corporation. U.S. and Foreign Patents. For patents see <http://dts.com/patents>. HD Radio™ and the HD, HD Radio, and "ARC" logos are registered trademarks or trademarks of iBiquity Digital Corporation in the United States and/or other countries.
- Use of the Made for Apple badge means that an accessory has been designed to connect specifically to the Apple product(s) identified in the badge, and has been certified by the developer to meet Apple performance standards. Apple is not responsible for the operation of this device or its compliance with safety and regulatory standards. Please note that the use of this accessory with an Apple product may affect wireless performance.
- Apple, iPhone, iPod, iPod nano, iPod touch, and Lightning are trademarks of Apple Inc., registered in the U.S. and other countries.
- Pandora, the Pandora logo, and the Pandora trade dress are trademarks or registered trademarks of Pandora Media, Inc., used with permission.
- iHeartRadio® and iHeartAuto™ are trademarks owned by iHeartMedia, Inc. All uses are authorized under license.
- Sirius, XM and all related marks and logos are trademarks of Sirius XM Radio Inc. All rights reserved.
- SPOTIFY and the Spotify logo are among the registered trademarks of Spotify AB.
- Android is a trademark of Google LLC.
- The "AAC" logo is a trademark of Dolby Laboratories.
- The Bluetooth® word mark and logos are registered trademarks owned by the Bluetooth SIG, Inc. and any use of such marks by JVC KENWOOD Corporation is under license. Other trademarks and trade names are those of their respective owners.
- Qualcomm aptX is a product of Qualcomm Technologies International, Ltd. Qualcomm is a trademark of Qualcomm Incorporated, registered in the United States and other countries, used with permission. aptX is a trademark of Qualcomm Technologies International, Ltd., registered in the United States and other countries, used with permission.

**HD Radio®**

This HD Radio receiver enables:

HD2/HD3

Digital Sound

Program Info

Emergency Alerts



**(SiriusXM)**  
READY

**pandora®**

Made for  
**iPhone | iPod**

**Qualcomm®**  
**aptX™**



**Spotify®**

**Bluetooth®**



MILITARY

Units purchased through the U.S.A. military exchange service overseas may be serviced under warranty in the continental U.S.A., subject to the following conditions.  
1) The original warranty is in effect.  
2) Proof of purchase is provided to the servicer.

WARRANTY FOR MILITARY MARKET

JVC KENWOOD corporation is proud of the quality and workmanship of its audio equipment. This unit has been properly designed, tested and inspected before it was shipped to you. If properly installed and operated in accordance with instructions furnished, it should give you an optimum reliable performance.

WARRANTY PERIOD

This product is warranted for a period of (1) year from the date of the original purchase.

SCOPE OF WARRANTY

Except as specified below, this warranty covers all defects in materials and workmanship of the Kenwood brand products.

During the warranty period, any authorized Kenwood Service Center in the military market listed in the back of this warranty card will provide you free-of-charge both parts and labor required to correct any defect in materials or workmanship.

The following are not covered by this warranty.  
1. Voltage conversions.  
2. Periodic check-ups which do not disclose any defect covered by the warranty.  
3. Cabinets, grilles, other exterior finishes, belts, tape heads, and other non-durable parts and accessories.  
4. Units on which the serial number has been effaced, modified or removed.  
5. Installation and/or removal charges.  
6. Damaged magnetic tapes.  
7. House call charges for any repairs.  
8. Shipping or delivery charges to or from an authorized Kenwood Service Center.  
9. This warranty will not cover any failure that is due to any of the following conditions in accordance with the visual inspection of the authorized Kenwood Service Center:  
\* Improper maintenance or repair, including the installation of parts or accessories that do not conform to the quality and specifications of the original parts.  
\* Misuse, abuse, neglect, unauthorized product modification or failure to follow instructions contained in the Owner's Manual.  
\* Accidental or intentional damages.  
\* Repairs or attempted repairs by an unauthorized agency. (All repairs must be performed at an authorized Kenwood Service Center.)  
\* Damages or deteriorations caused during shipment (Claims must be presented to the carrier).  
\* Damages or deteriorations resulting from removal and/or replacement.

PURCHASER'S RESPONSIBILITIES

As the purchaser of a new Kenwood brand product, you are requested to do the following in order to obtain Kenwood warranty service.  
1. Retain your sales slip or other evidence of purchase for proving your eligibility for requesting Kenwood warranty service.  
2. Make your unit available to an authorized Kenwood Service Center in the military market for inspection and approved warranty service, or ship your unit in its original carton box or equivalent, fully insured and shipping charges prepaid, to the authorized Kenwood Service Center.

LIMITATION OF IMPLIED WARRANTIES

Any and all implied warranties, including warranties of merchantability and fitness for a particular purpose, shall be limited in duration to the length of this warranty.

EXCLUSION OF CERTAIN DAMAGES

KENWOOD's liability for any defective product is limited to the repair or replacement of said product, at our option, and shall not include damages of any kind, whether incidental, consequential or otherwise, except to the extent prohibited by applicable law.

KENWOOD AUTHORIZED SERVICE CENTERS IN MILITARY MARKET

JAPAN:

Yokota

Kenwood Rep.,; c/o  
Yokota BX, JAAX AAFES-PAC,  
APO San Francisco 96328

Zama

Kenwood Rep.,; c/o  
Zama PX, JAAX AAFES-PAC,  
APO San Francisco 96343

Misawa

Kenwood Rep.,; c/o  
Misawa BX, JAAX AAFES-PAC,  
APO San Francisco 96519

Yokosuka

Kenwood Rep.,; c/o  
A-33, Yokosuka NEX No. 260-010  
FPO Seattle 98760

Atsugi

Kenwood Rep.,; c/o  
Atsugi NEX No. 260-020 FPO Seattle  
98767

Iwakuni

Kenwood Rep.,; c/o  
Marine Corps Exchange, Marine Corps  
Air Station,  
FPO Seattle 98764

Sasebo

Sasebo NEX;  
Navy Exchange 260-040  
F.A. Box 115 FPO Seattle 98766

Okinawa

Kenwood Rep.,; c/o  
OWAX, AAFES-PAC, APO San Francisco  
96230

KOREA:

Kenwood Rep.,; c/o  
KOAX Repair Shop, AAFES-PAC  
DD-Camp Market, APO San Francisco  
96488

GUAM:

Kenwood Rep.,; c/o  
Guam NEX No. 230-010;  
FPO San Francisco 96630  
Kenwood Rep.,; c/o  
GUAX, AAFES-PAC, APO San Francisco  
96334

U.S.A.:

In The Continental U.S.A.

For Nearest Authorized Service Center;  
Tel: 1-800-536-9663  
www.us.jvckenwood.com

EUROPE:

Please inquire at the military resale outlets where you bought your Kenwood products, or  
JVCKENWOOD DEUTSCHLAND GMBH:  
Konrad-Adenauer Allee 1-11, 61118 Bad Vilbel, Germany

KENWOOD

# Warranty Card

Identification du produit  
Modelo do aparelho e numero de série  
Model number & serial number

Revendeur & cachet  
Nome da loja e carimbo  
Dealer & stamp

Date d'achat  
Data da compra  
Purchase date

Nome & adresse du client  
Nome e endereço do cliente  
Name & address of customer

Attention:

This card and receipt (or invoice) are necessary to purchase a new panel in case of theft or damage.

Attention:

Vous aurez besoin de cette carte et du reçu (ou de la facture) pour acheter un nouveau panneau en cas de vol ou d'endommagement.

Atenção:

Em caso de dano ou perda do painel frontal, este Certificado de Garantia e a Nota Fiscal de compra serão requisitados para a aquisição de um novo painel.

© B46-0824-00/04 (K) (15/11)



