

General Illumination Square Shower Downlight with nTune

6"

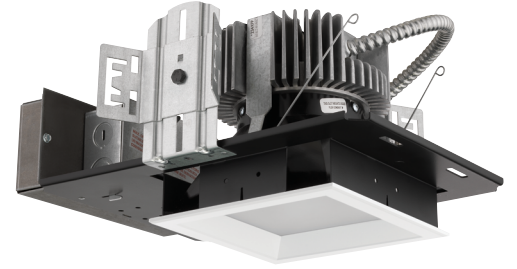

OVERVIEW

Feature Set

- Tunable White solution that reproduces natural light patterns and colors, complements materials, and supports productivity.
- Rhythm Range (2700K-6500K) follows the cycle of daylight
- Productivity Range (3000K-5000K) to re-energize and inspire, ideal for collaboration
- WARMDIM® Range (3000K-1800K) for relaxing; warm and comfortable when dimmed
- Non-conductive dead-front trim
- Flush or regressed lensed trim with antimicrobial finish for wipe-down areas
- Rated 65,000 hours (L80) at 25°C ambient temperature
- Dim to Dark 100% - 0.1%

Distribution



Superior Performance

Nominal lumens	750	1000	1500	2000	2500	3000	3500	4000	4500
Delivered	776	1058	1445	1864	2220	2663	3053	3565	3769
Wattage	11	14	19	24	29	34	40	48	50
Efficacy	74	77	77	78	78	78	77	75	75

\*80 CRI, 3500K

COMPLIMENTARY PRODUCTS

Coordinated Apertures | Multiple Layers of Light



General Illumination Layer | EVO



High Center Beam Layer | Incito



EVO + Incito — Multiple Layers of Light

Core



Downlight



Adjustable



Open Wallwash



Lensed Wallwash



Cylinder



Pinhole



Bevel



Hyperbolic

Healthcare



MRI



Surgical Suite



Patient Room

Special Applications



Dynamic



Food Service



Vandal/Tamper



Clean Room



Shower



Steam Room

A+ Capable options indicated by this color background.

Luminaire Type:

Catalog Number:

**EXAMPLE: EVO6SQSH TUWH PROR/10 DFFAMF SOL MVOLT NLT**

Series	Dynamic Feature	Dynamic Range <sup>1</sup>	Nominal lumens values <sup>2</sup>	Reflector/Lens Setting/Flange Color	Lens
<b>EVO6SQSH</b> 6" Square Patient Downlight	<b>TUWH</b> Tunable White <b>WDIM</b> Warm Dimming	<b>PROR</b> Productivity Range (3000K-5000K) <b>RHYR</b> Rhythm Range (2700K-6500K)	<b>/10</b> 1000 lumens	<b>DFR</b> Regressed lensed white trim <b>DFF</b> Flush lensed white trim <b>DFRAMF</b> Regressed lensed white trim with antimicrobial finish <b>DFFAMF</b> Flush lensed white trim with antimicrobial finish	<b>SOL</b> Textured Lens <b>SMO</b> Smooth Lens
			<b>/15</b> 1500 lumens		
			<b>/20</b> 2000 lumens		
			<b>/25</b> 2500 lumens		
			<b>/30</b> 3000 lumens		

Voltage	Control Interface Type	Options
<b>MVOLT</b> Multi-Volt <b>120</b> 120V <b>277</b> 277V	<b>NLT<sup>3</sup></b> nLight nTune interface <b>NLTER<sup>3</sup></b> nLight nTune interface with emergency circuit <b>ZT</b> 0-10V dimming <b>DALI</b> DALI logarithmic dimming to <1%.	<b>SF</b> Single fuse. Specify 120V or 277V. <b>E10WCPR<sup>4</sup></b> Emergency battery pack, 10W Constant Power, CA Title 20 compliant with remote test switch <b>BGTD</b> Bodine generator transfer device

**ACCESSORIES — order as separate catalog numbers (shipped separately)**

<b>FCS 7TSN XXX</b>	Fresco Lighting Control; XXX = Color. Refer to <a href="#">FRESCO</a> spec sheet for additional options.
<b>nPODM 2P DX CCT XX</b>	nLight 2 Channels, On/off + raise/lower control, CCT, XX = Color
<b>nPODM 4S DX XX</b>	nLight 4 Scene Control, On/off + raise/lower control, XX = Color
<b>nPODM 4S XX</b>	nLight 4 Scene Control, XX = Color

**ORDERING NOTES**

1. PROR and RHYR available only with TUWH. HALR available only with WDIM.
2. Nominal lumen values when tested at 3500K.
3. Requires power from nLight network bridge or nPS 80.
4. Voltage specific (120V or 277V). Not available with battery pack options.

**Optical Assembly**

Fully serviceable and upgradeable lensed LED light engine suitable for field maintenance or service from below the ceiling. Unitized optics shall have mechanical attachment of the light engine to the lower reflector for complete optical alignment.

**Electrical**

The luminaire shall operate from a 50 or 60 Hz ±3 Hz AC line over a voltage ranging from 120 VAC to 277 VAC. The fluctuations of line voltage shall have no visible effect on the luminous output.

The luminaire shall have a power factor of 90% or greater at all standard operating voltages and full luminaire output.

Sound Rated A+. Driver shall be >80% efficient at full load across all input voltages.

Input wires shall be 18AWG, 300V minimum, solid copper.

**Controls**

Tunable white nTune™ is an all-digital light color temperature control within an nLight enabled luminaire.

nTune™ allows color temperature settings through the Productivity Range of 3000K to 5000K or Rhythm Range of 2700K to 6500K.

Refer to nLight Programming User's Guide for instructions on customizing your application with SensorView™.

**Dimming**

The luminaire shall be capable of continuous dimming without perceivable stroboscopic flicker as measured by flicker index (ANSI/IES RP-16-10) over a range of 100 – 0.1% of rated lumen output with a smooth shut off function to step to 0%.

**Construction**

Luminaire housing shall be constructed of 16-gauge galvanized steel and have preinstalled telescopic mounting bars with maximum 32" and minimum 15" extension and 4" vertical adjustment.

Luminaires shall be suitable for installation in ceilings up to 1½" thick. (specify ceiling thickness adapter to extend frame to accommodate ceiling thickness up to 5").

Tool-less adjustments shall be possible after installation.

The assembly and manufacturing process for the luminaire shall be designed to assure all internal components are adequately supported to withstand mechanical shock and vibration.

25°C ambient temperature standard (1/2" clearance on all sides from non-combustible materials in non-IC applications, unless marked spacing noted otherwise).

For use in insulated ceilings, a 3" clearance on all sides from insulation is required (unless marked spacing noted otherwise).

**Listings**

Fixtures are CSA certified to meet US and Canadian Standards: All fixtures manufactured in strict accordance with the appropriate and current requirements of the "Standards for Safety" to UL, wet location covered ceiling.

**Photometrics**

LEDs tested to LM-80 standards. Measured by IESNA Standard LM-79-08 in an accredited lab. Lumen output shall not decrease by more than 20% over the minimum operational life of 60,000 hours.

**Buy American**

This product is assembled in the USA and meets the Buy America(n) government procurement requirements under FAR, DFARS and DOT. Please refer to [www.acuitybrands.com/buy-american](http://www.acuitybrands.com/buy-american) for additional information.

**Warranty**

5-year limited warranty. Complete warranty terms located at: [www.acuitybrands.com/support/customer-support/terms-and-conditions](http://www.acuitybrands.com/support/customer-support/terms-and-conditions)

**Note:**

Actual performance may differ as a result of end user environment and application.

All values are design or typical values, measured under laboratory conditions at 25 °C.

**A+ Capable Luminaire**

This item is an A+ capable luminaire, which has been designed and tested to provide consistent color appearance and out-of-the-box control compatibility with simple commissioning.

- All configurations of this luminaire meet the Acuity Brands' specification for chromatic consistency
- This luminaire is part of an A+ Certified solution for nLight® control networks when ordered with drivers marked by a shaded background\*
- This luminaire is part of an A+ Certified solution for nLight® control networks, providing advanced control functionality at the luminaire level, when selection includes driver and control options marked by a shaded background\*

To learn more about A+, visit [www.acuitybrands.com/aplus](http://www.acuitybrands.com/aplus).

\*See ordering tree for details

DFF SMO - Flush Clear									
Nominal Lumens	750	1000	1500	2000	2500	3000	3500	4000	4500
Delivered	776	1058	1445	1864	2220	2663	3053	3565	3769
Wattage	11	14	19	24	29	34	40	48	50
Efficacy	74	77	77	78	78	78	77	75	75

\*Lumen output for 80CRI - 3500K

DFF SOL - Flush Textured									
Nominal Lumens	750	1000	1500	2000	2500	3000	3500	4000	4500
Delivered	578	789	1078	1390	1655	1986	2276	2658	2811
Wattage	10	14	19	24	28	34	40	48	50
Efficacy	56	57	58	58	59	58	57	56	56

\*Lumen output for 80CRI - 3500K

DFR SMO - Regressed Clear									
Nominal Lumens	750	1000	1500	2000	2500	3000	3500	4000	4500
Delivered	636	868	1186	1529	1821	2185	2504	2925	3092
Wattage	10	14	19	24	28	34	40	48	50
Efficacy	61	63	64	64	65	64	63	61	61

\*Lumen output for 80CRI - 3500K

DFR SOL - Regressed Textured									
Nominal Lumens	750	1000	1500	2000	2500	3000	3500	4000	4500
Delivered	578	789	1078	1390	1655	1986	2276	2658	2811
Wattage	10	14	19	24	28	34	40	48	50
Efficacy	56	57	58	58	59	58	57	56	56

\*Lumen output for 80CRI - 3500K

Driver Default Dimming Curve			
Nomenclature	Min Dimming	Driver Dim Curve	Control Dim Curve
ZT	0.1%	Linear	Linear/Logarithmic
DALI	0.1%	Linear	Linear/Logarithmic

**MAINSTREAM DYNAMIC TUNABLE WHITE WITH NTUNE TECHNOLOGY**

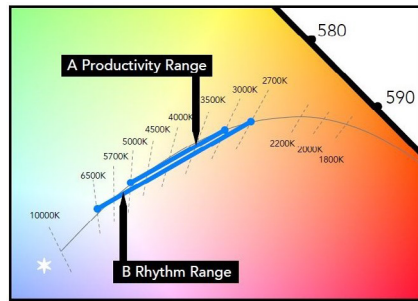

- A** Productivity Range 3000K to 5000K
- B** Rhythm Range 2700K to 6500K

Tunable white nTune™ is an all digital light color temperature control within an nLight enabled luminaire. This brings tunable white lighting control into the mainstream with repeatable, consistent results in an economical luminaire form and system already familiar to schools. Designers and facility operators are granted the freedom to tie scenes to specific activities or to complement colors or materials within a visual environment. nTune™ allows color temperature settings through the Productivity Range of 3000K to 5000K or Rhythm Range of 2700K to 6500K. Refer to nLight Programming User's Guide for instructions on customizing to your application with SensorView™.

**TUNABLE WHITE GPHD**

- Gamut:** One dimensional warm-Cool
- Path:** Direct 3000K to 5000K (Productivity Range) or 2700K to 6500K (Rhythm Range)
- Handle:** Two Natural Language Handles: Intensity and CCT
- Data:** nLight with nTune technology for both handles of control

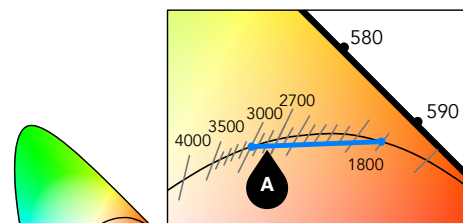

- A** Halogen Range 3000K to 1800K

How to Estimate Delivered Lumens in Emergency Mode
<b>Delivered Lumens = 1.25 x P x LPW</b>
P = Output power of emergency driver. P = 10W for PS1055CP
LPW = Lumen per watt rating of the luminaire. This information is available on the ABL luminaire spec sheet.

DIMENSIONAL DATA

\*Dimensions in inches [centimeters]

Aperture: 6 1/4" [15.9]      Ceiling Opening: 7 1/8" [18.1] self-flanged  
 Overlap Trim: 7 1/2" [19.1]

**Standard**

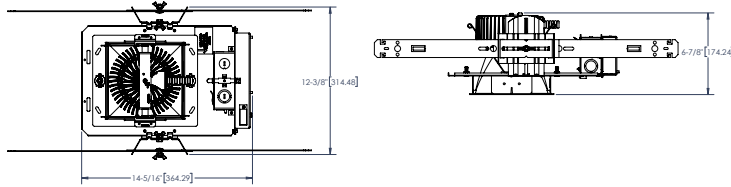

**Battery Pack**

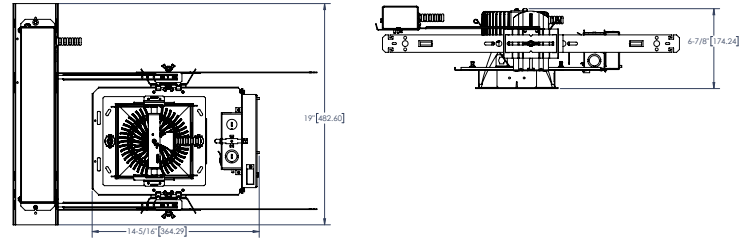

**CP Standard**

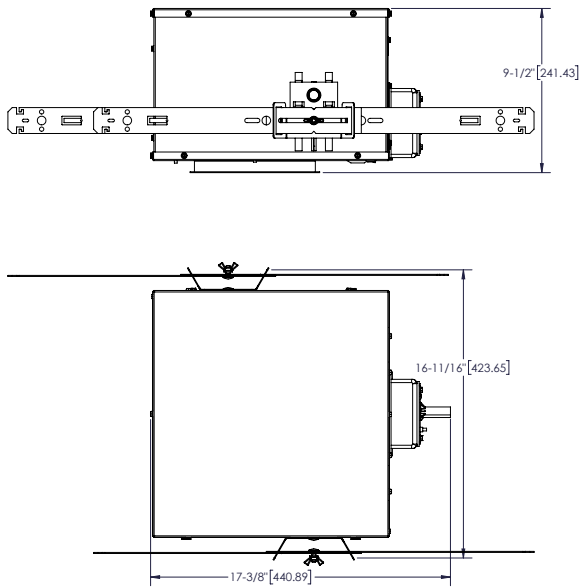

Photometry

**EV06SQSH TUWH RHYR /45 6DFF SMO CRI80 3500K**

INPUT WATTS: 50.3, DELIVERED LUMENS: 3769, LM/W=74.9, 0.91 S/MH, TEST NO. LTL29890P195

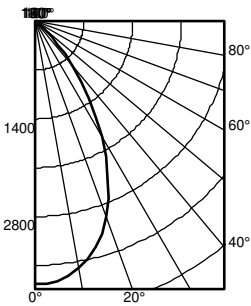

Ave Lumens	Zone Lumens % Lamp	pf pc pw	80%			20% 70%			50%					
			50%	30%	10%	50%	30%	10%	50%	30%	10%			
0	3774	0° - 30°	2411.8	64.0	0	119	119	119	116	116	116	111	111	111
5	3736	0° - 40°	3252.7	86.3	1	110	108	105	108	106	104	104	102	100
15	3362	0° - 60°	3723.9	98.8	2	102	98	94	100	96	93	97	94	91
25	2473	0° - 90°	3767.9	100.0	3	94	89	85	93	88	84	90	86	83
35	1350	90° - 120°	0.0	0.0	4	88	82	77	87	81	77	84	80	76
45	466	90° - 130°	0.1	0.0	5	82	75	71	81	75	71	79	74	70
55	96	90° - 150°	0.4	0.0	6	76	70	65	75	69	65	74	69	65
65	28	90° - 180°	1.5	0.0	7	71	65	60	71	65	60	69	64	60
75	11	0° - 180°	3769.4	*100.0	8	67	61	56	66	60	56	65	60	56
85	3				9	63	57	52	62	56	52	61	56	52
90	0				10	59	53	49	59	53	49	58	53	49

Mounting Height	Initial FC Center Beam	50% beam - 49.3°		10% beam - 80.2°	
		Diameter	FC	Diameter	FC
8.0	124.7	5.0	62.4	9.3	12.5
10.0	67.1	6.9	33.5	12.6	6.7
12.0	41.8	8.7	20.9	16.0	4.2
14.0	28.5	10.5	14.3	19.4	2.9
16.0	20.7	12.4	10.4	22.7	2.1

**EV06SQSH TUWH RHYR /45 6DFF SOL CRI80 3500K**

INPUT WATTS: 50.3, DELIVERED LUMENS: 3608, LM/W=71.7, 0.96 S/MH, TEST NO. LTL29889P195

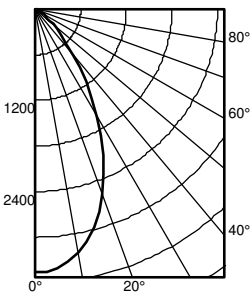

Ave Lumens	Zone Lumens % Lamp	pf pc pw	80%			20% 70%			50%					
			50%	30%	10%	50%	30%	10%	50%	30%	10%			
0	3465	0° - 30°	2111.5	58.5	0	119	119	119	116	116	116	111	111	111
5	3423	0° - 40°	2842.3	78.8	1	109	106	103	107	104	102	103	101	99
15	2975	0° - 60°	3418.9	94.7	2	100	95	91	98	94	90	95	91	88
25	2118	0° - 90°	3608.5	100.0	3	92	86	81	90	85	81	88	83	79
35	1168	90° - 180°	0.0	0.0	4	85	78	73	83	78	73	81	76	72
45	495	0° - 180°	3608.5	*100.0	5	78	72	67	77	71	67	76	70	66
55	198				6	73	66	61	72	66	61	70	65	61
65	105				7	68	61	57	67	61	56	66	60	56
75	61				8	64	57	52	63	57	52	62	56	52
85	17				9	60	53	49	59	53	49	58	53	49
90	3				10	56	50	46	56	50	46	55	49	45

Mounting Height	Initial FC Center Beam	50% beam - 47.2°		10% beam - 80.2°	
		Diameter	FC	Diameter	FC
8.0	114.5	4.8	57.3	9.3	11.5
10.0	61.6	6.6	30.8	12.6	6.2
12.0	38.4	8.3	19.2	16.0	3.8
14.0	26.2	10.1	13.1	19.4	2.6
16.0	19.0	11.8	9.5	22.7	1.9

**EV06SQSH TUWH RHYR /45 6DFR SMO CRI80 3500K**

INPUT WATTS: 50.3, DELIVERED LUMENS: 3092, LM/W=61.5, 0.93 S/MH, TEST NO. LTL29892P36

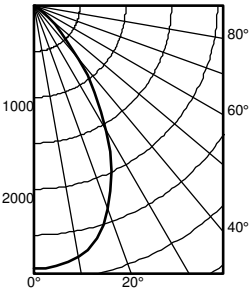

Ave Lumens	Zone Lumens % Lamp	pf pc pw	80%			20% 70%			50%					
			50%	30%	10%	50%	30%	10%	50%	30%	10%			
0	2870	0° - 30°	1908.2	61.7	0	119	119	119	116	116	116	111	111	111
5	2849	0° - 40°	2628.2	85.0	1	110	107	105	108	106	103	104	102	100
15	2632	0° - 60°	3058.2	98.9	2	102	97	94	100	96	93	97	93	91
25	1990	0° - 90°	3092.3	100.0	3	94	89	84	93	88	84	90	86	82
35	1160	90° - 180°	0.0	0.0	4	87	81	77	86	80	76	84	79	75
45	427	0° - 180°	3092.3	*100.0	5	81	75	70	80	74	70	78	73	69
55	85				6	75	69	64	75	69	64	73	68	64
65	21				7	70	64	59	70	64	59	68	63	59
75	9				8	66	59	55	65	59	55	64	59	55
85	2				9	62	56	51	61	55	51	60	55	51
90	0				10	58	52	48	58	52	48	57	51	48

Mounting Height	Initial FC Center Beam	50% beam - 51.0°		10% beam - 82.4°	
		Diameter	FC	Diameter	FC
8.0	94.9	5.2	47.4	9.6	9.5
10.0	51.0	7.1	25.5	13.1	5.1
12.0	31.8	9.1	15.9	16.6	3.2
14.0	21.7	11.0	10.9	20.1	2.2
16.0	15.7	12.9	7.9	23.6	1.6

**EV06SQSH TUWH RHYR /45 6DFR SOL CRI80 3500K**

INPUT WATTS: 50.3, DELIVERED LUMENS: 2810, LM/W=55.9, 0.87 S/MH, TEST NO. LTL29891P195

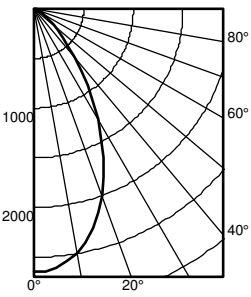

Ave Lumens	Zone Lumens % Lamp	pf pc pw	80%			20% 70%			50%					
			50%	30%	10%	50%	30%	10%	50%	30%	10%			
0	2649	0° - 30°	1635.2	58.2	0	119	119	119	116	116	116	111	111	111
5	2614	0° - 40°	2223.6	79.1	1	109	106	104	107	105	102	103	101	99
15	2291	0° - 60°	2694.4	95.9	2	100	96	92	98	94	91	95	92	89
25	1651	0° - 90°	2810.7	100.0	3	92	86	82	91	85	81	88	83	80
35	941	90° - 180°	0.0	0.0	4	85	79	74	84	78	73	82	76	72
45	410	0° - 180°	2810.7	*100.0	5	79	72	67	78	71	67	76	70	66
55	158				6	73	66	62	72	66	61	71	65	61
65	74				7	68	61	57	67	61	57	66	60	56
75	33				8	64	57	52	63	57	52	62	56	52
85	4				9	60	53	49	59	53	49	58	53	49
90	0				10	56	50	46	56	50	46	55	49	45

Mounting Height	Initial FC Center Beam	50% beam - 47.8°		10% beam - 81.4°	
		Diameter	FC	Diameter	FC
8.0	87.6	4.9	43.8	9.5	8.8
10.0	47.1	6.6	23.6	12.9	4.7
12.0	29.4	8.4	14.7	16.3	2.9
14.0	20.0	10.2	10.0	19.8	2.0
16.0	14.5	12.0	7.3	23.2	1.5

**nLight® Wired** The nLight® solution is a digital networked lighting control system that provides both energy savings and increased user configurability by cost effectively integrating time-based, daylight-based, sensor-based and manual lighting control schemes.

**Possibilities for nLight® wired**

**Fixtures ordered *without* the NLT option**

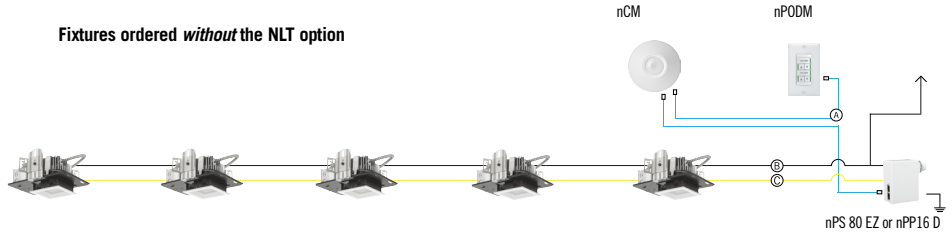

**Fixtures ordered *with* the NLT option**

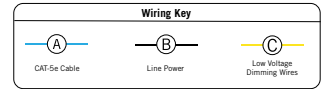
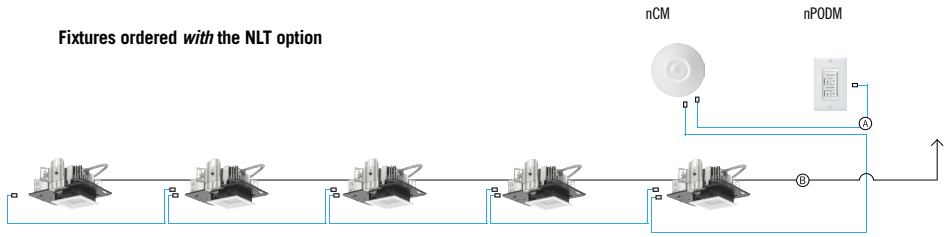

**nLight® Wired Control Accessories**

Order as separate catalog number. Visit [nLight](http://nLight.com).

Wall Switches	Model Number
On/Off single pole	nPODM XX
On/Off two pole	nPODM 2P XX
On/Off & raise/lower single pole	nPOD DX XX
On/Off & raise/lower two pole	nPODM 2P DX XX
Graphic touchscreen	nPOD GFX XX
<b>Photocell Controls</b>	
Dimming	nCM ADCX

**nLight® Wired Control Accessories (cont.)**

Occupancy Sensors (PIR/dual tech)	Model Number
Small motion 360°, ceiling	nCM 9 / nCM PDT 9
Large motion 360°, ceiling	nCM 10 / nCM PDT 10
Wide View	nWV 16 / nWV PDT 16
Wall switch with raise/lower	nWSX LV DX / nWSX PDT LV DX
<b>Cat-5 Cables (plenum rated)</b>	
10', CAT5	CAT5 10FT J1
15', CAT5	CAT5 15FT J1