

P.A.C. TOOL MOUNTING SYSTEMS



TOOLOK AND TOOLOK HD

- Fast, easy locking and instant release
- Grip range 1/8" to 1 1/2"
- NFPA 1901 Compliant 9G impact
- Tested and certified NFPA 1901 compliant

TOOLOK HD

- Wider mounting base for increased stability
- Stronger, more durable base
- Thicker walled locking strap
- Lifetime warranty



NEW

BN470 Toolok HD

\$28.95

STOW-N-LOC

IDEAL FOR EXTERIOR MOUNTING

FAST tool storage with clamp-action brackets.
PLUS simple positive locking strap when ready.

- Grip range 1" to 1 1/2" diameter
- Adjustable, high-strength, fast-action locking strap
- **2 Heights:** Tall: For long hooks
Short: For close mounting
- NFPA 1901 Compliant 9G impact



BL263 Stow-N-Loc Tall

\$46.95

BL264 Stow-N-Loc Short

\$46.95

COIL LOK

- Easily adjusted strap for various conditions and sizes
- Stainless steel fasteners provided
- Multiple objects can be hung together
- Non-conclusive
- Adjustable lock strap capable to 5400 psi tensile strength
- Strap retainer block included
- Adjusted to mount horizontally
- Mounts to PAC tool boards and other flat surfaces



NEW

BN317 Coil Lok

\$43.95

JUMBO LOK

- 3 pivot positions
- Adjustable mounting bracket with grip range of .375" to 3.250"
- 3" square Hurst rams and 3" D Holmatro rams
- Mounts folding ladders, electric drills, heavy-duty jacks, nozzles, chains and more
- NFPA 1901 Compliant 9G impact
- Dual poles
- Playpipes
- *Ship. wt. 1 lb.*

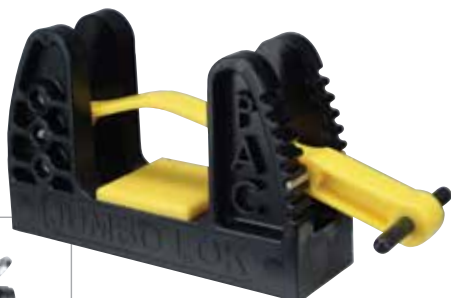

BC018 Jumbo Lok

\$64.95

HANDLELOC STRETCHLOK SYSTEM

- Innovative, adjustable mounting bracket
- Secure mounting for tools, axe handles, poles and equipment up to 1 3/4" in diameter
- Quick release for easy retrieval
- Made of elastomer
- NFPA 1901 Compliant 9G impact
- *Ship. wt. 1 lb*



AF659 Handleloc Stretchlok System

\$39.95

KEEP YOUR TOOLS ORGANIZED WITH P.A.C. MOUNTS



FLEXMOUNT BRACKETS

Flexible Y-shaped mounting brackets designed to provide a secure grip-type mount that wraps around poles, nozzles and a wide variety of other tools and equipment with a grip range from 1½" to 2½". Made from a unique state-of-the-art elastomer that is exceptionally tough, non-sparking and resistant to impact. There's no springs to corrode or break. Hardware/fasteners included. *Ship. wt. 1 lb.*



AF658	Flexmount Bracket	\$42.95
AW337	Short Flexmount Bracket	\$37.95

UNIVERSAL SAW KIT

The Universal Saw Kit provides a simple easy to use mount for rescue saws. This kit can also be used for many other saw mounting applications. Includes two Universal Mounts, Extended Super Adjustamount, Spacer Blocks and a 12" long unistrut section.



- Molded from high quality materials
- Includes stainless steel fasteners
- Weather, UV resistant
- Non-conductive

BN313	Universal Saw Kit	\$137.95
-------	-------------------	----------

CYLINDER MOUNT

- Perfect fit for 1 quart fuel cans and small extinguishers
- Two sizes: 5" (medium) and 7" (tall)
- Mounts cylindrical items up to 3½" diameter
- Wall mounted
- PAC Trac compatible
- Non-metallic
- Chemical resistant material
- Lightweight and durable
- Flame retardant



BN588	Cylinder Mount - Med	\$44.95
BN589	Cylinder Mount - Tall	\$47.95

FAST LOK KIT

SECURING LARGER & HEAVIER ITEMS HAS NEVER BEEN EASIER

FEATURES:

- Easily and quickly secure equipment even with gloved hands
- Track base provides fast setup and adjustment
- No metal to metal contact
- UV resistant
- Fast locking lever
- Adjustable strap length and width supports
- NFPA 1901 Compliant

SECURES:

- Fire extinguishers
- Air cylinders
- Hydraulic pumps
- Rescue tools
- Chain saws
- Oxygen cylinders
- Much more

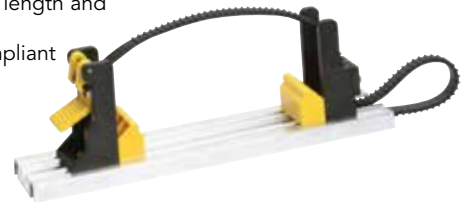

BL664	Fast Lok Kit 18" Black Strap, 15" Usable Strap	\$119.95
BL665	Fast Lok Kit 33" Black Strap, 30" Usable Strap	\$133.95

IRONSLOK AND IRONSLOK HD



- Safe, secure and dependable storage
- Fits 30" halligan, 36" flathead, 6 or 8 lb. force axe
- Mounts horizontal or vertical
- NFPA 1901 Compliant 9G impact
- *Ship. wt. 7 lbs*

IRONSLOK HD

- Designed for larger irons, including the PIG axe



AW391	Ironslok	\$261.95
BN314	Ironslok HD Kit	\$309.95

SPREADER BASE MOUNT KIT

- Mounts vertically or horizontally
- Provides secure, quick-acting mounting
- Made of rugged, molded urethane
- Resistant to weather, impact, UV and corrosion
- Includes spreader base, adjustamount kit and fastener packet
- *Ship. wt. 3 lbs.*

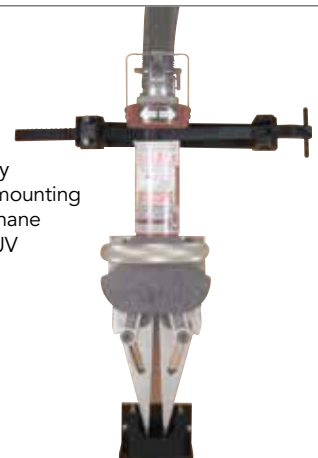

BN585FL	Spreader Base Mount Kit with Fastlok	\$159.95
BN585JL	Spreader Base Mount Kit with Jumbo	\$107.95
BN585SA	Spreader Base Mount Kit with Super Adjustamount	\$107.95

SECURE YOUR TOOLS WITH ZIAMATIC

APPARATUS EQUIPMENT

WALL MOUNT CAN HOLDERS

Wall mount can holders lower the risk of rolling, falling, leaking, denting, and puncturing during transport. Keeps cans organized and easy to locate in a hurry. Mount it to a compartment wall and save space on the shelf below. *Ship. wt. 3-5.1 lbs.*

- BL674 and BL754: Fits 32 oz. (3³/₈" diameter) cans or 32 oz. (2⁷/₈"x4¹/₄" quart containers
- BL713: Fits 12 oz. cans up to 2³/₄" diameter
- BL755: Fits 1 gallon cans (7"x4¹/₂"")



BL754



BL755

BL674	Premixed Can Holder	\$49.95
BL713	Spray Can Holder	\$49.95
BL754	Double Premix Holder	\$89.95
BL755	Gallon Premix Holder	\$49.95

SLEDGE HAMMER BRACKET

Designed for use with 2 to 16 lb. Double Face Sledges and 1 to 3 lb. Dead Blow Hammers. Bracket is 2³/₄"Hx3"D - expandable from 5¹/₄" to 8³/₄"W to fit various-sized tools. Made of stainless steel for years of lasting service. *Ship. wt. 3 lbs.*

AS325	Sledge Hammer Bracket	\$90.95
-------	-----------------------	---------

AXE HOLDER BRACKET

Designed for use with 6-pound flat or pick head axe. Bracket is 5"Hx2¹/₈"D. Expands from 7¹/₄" to 8¹/₄"W to fit most axeheads. 2¹/₂"Hx1¹/₄"W slot in end for pick to protrude. Axe blade protected by a replaceable plastic sleeve. Pinned handle holder accepts up to 2⁵/₁₆"W handle. Stainless steel for trouble-free service. *Ship. wt. 4 lbs.*

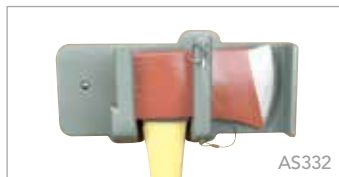

AS332



AS331

AS325

AS331	Axe Holder Bracket	\$168.95
AS332	Axe Wall Mounting Bracket	\$143.95

QUIC-MOUNT® BOLT CUTTER BRACKET

Designed for use with 18" to 36" bolt cutters with adjustable stop and pin. Utility straps hold the bolt cutter handles firmly in place. Comes with one fixed strap and one variable strap. *Ship. wt. 3 lbs.*



AR158	Quic-Mount® Bolt Cutter Bracket	\$93.95
-------	---------------------------------	---------

ROUND GAS CAN MOUNT

Round gas can mount was designed for safety cans with 9" and 13" diameter bases. The safety can is held in place by a 1" nylon safety strap with a quick-release buckle. *Ship. wt. 7 lbs.*



CAN NOT INCLUDED



AS328	Gas Can Mount Up to 2 Gal.	9 ³ / ₄ "IDx2 ¹ / ₈ "D	\$91.95
BD079	Gas Can Mount Up to 5 Gal.	13 ¹ / ₂ "IDx2 ¹ / ₈ "D	\$105.95

CHAIN SAW MOUNT

Mount chain saws, abrasive cut-off saws and other gasoline engine tools on these specially designed brackets. Absorbent pad collects fluids and may be changed as required. Safety strap secures the saw on the bracket. *Ship. wt. 10-12 lbs.*



SAW NOT INCLUDED



AS326	Large Mount - 11 ¹ / ₂ "x17 ¹ / ₂ "	\$148.95
AS327	Small Mount - 10"x15"	\$141.95

QUIC-BAR®/AXE MOUNTING BRACKET SET

Brackets may be mounted to store the bar and axe combination either vertically or horizontally. Variable straps secure the tools for carrying. Add an adjustable shoulder strap and you are ready for business. *Ship. wt. 7 lbs.*



TOOLS NOT INCLUDED

AS329	Quic-Bar/Axe Mounting Bracket Set w/Stop	\$189.95
AS330	Straps for Quic-Bar® & Axe Mounting Bracket	\$78.95

D-SIZE OXYGEN CYLINDER BRACKET

The Oxygen Cylinder Bracket has two 4" clips to securely hold a D-size oxygen cylinder. Durable green powder coated steel clips, backplate and footplate. Multiple sets of countersunk holes allow the bracket assembly to flush mount to any surface and gives multiple positioning for the clips and the footplate. A Velcro® safety strap is attached to each bracket.



BL511 D-Size Oxygen Cylinder Bracket \$78.95

SHOVEL MOUNTING BRACKET

New shovel mounting system holds one or two shovels securely in place. Bracket adjusts to hold one or two handles with no rattle or movement. Hanger projections secure the shovel heads with a 7 1/4"Wx4"H base and four mounting holes.



BE076 Shovel Hanger 7 1/4"Wx4"H Base \$61.95
 BE077 Shovel Bracket for 1 or 2 Tools \$39.95

ADAPTER HANGER

Adapter hanger is ideal for mounting couplings, adapters, electrical cords, hoses, etc. Mounting plate is 4" square, post is 6" long and mounted on a 60° angle. *Ship. wt. 1 lb.*

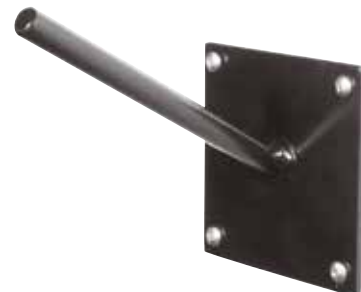

AS324 Adapter Hanger \$45.95

UNIVERSAL SAW BRACKET

This unique Universal Saw Bracket is able to mount chain saws, rotary saws, electric and all others. Made from 1/8" powder coated aluminum, it offers multiple anchor points to attach the heavy duty Velcro® strap. An absorbent, replaceable felt pad is supplied and held in place by the mounting bolts.



BL510 Universal Saw Bracket \$141.95

NYLON STRAP KIT

Nylon Strap Kits include two bolt down footman loops brackets and a 1.00" nylon strap with a pinch and release buckle. Ideal for strapping down tools and or large equipment such as vent fans, cribbing, rescue jacks and other hard to secure items. Sizes listed are listed are the maximum lengths and may be adjusted to secure smaller items.



BH118 1"x30" Nylon Strap Kit \$25.95
 BH119 1"x48" Nylon Strap Kit \$27.95
 BH120 1"x64" Nylon Strap Kit \$29.95

HORIZONTAL MOUNTING POSTS

Want to eliminate the head-ache of stacking 1 1/2"-2 1/2" couplings, adapters and accessories? These remarkably simple and unique Horizontal Mounting Posts for double male or female configurations are designed to save cabinet storage space and improve overall truck neatness and efficiency. With no stacking, you can instantly spot the size adapter or coupling you need. Special stainless steel spring clip provides secure holding yet quick-action release. Durable construction materials will not corrode, swell or crack. Single screw mounting takes only minutes.



BE304	Double Female 1 1/2"	\$27.95
BE305	Double Male 1 1/2"	\$27.95
BE306	Double Female 2 1/2"	\$34.95
BE307	Double Male 2 1/2"	\$34.95

STORZ HARDCOAT MOUNTING PLATES

High-tensile aluminum construction with anodized finish to resist abrasion and corrosion. *Ship wt. 1 lb.*



AF63801	4" Plate	\$28.95
AF63802	5" Plate	\$29.95

STORZ LOK

- Corrosion-free
- Mounts in any position
- **Strong:** Resistant to heat and cold
- **Fast Acting:** Mount or dismount
- **Easy-to-use:** No moving parts
- **Self-locking:** The automatic lock on the coupling locks it in place
- **Rattle Resistant:** The "quiet mount" no metal-to-metal contact



BL265

BC019	Storz Lok 4" Mount	\$45.95
BC020	Storz Lok 5" Mount	\$52.95
BL265	Storz Lok 6" Mount	\$72.95

MOUNTING PLATE

Male mounting plate is made of aluminum. *Ship. wt. 1 lb.*



BL365	1 1/2"	2 1/2"	3"	4"	4 1/2"	5"	6"
	\$25.95	\$30.95	\$34.95	\$51.95	\$58.95	\$67.95	\$69.95

HOLDS ANY THREADED FITTING SECURELY

Self-draining with three center mounting holes. Aluminum NST Threads.



BL366	1 1/2"	2 1/2"	3"	4"	4 1/2"	5"	6"
	\$29.95	\$39.95	\$47.95	\$64.95	\$70.95	\$80.95	\$86.95

QUICK ACTION NOZZLE HOLDER

Running board holder for nozzles and fittings. Positive grip, triple-lock lugs. Designed for NST threads, but will fit similar threads. The spring and lever handle permits proper tension with a quick, easy release. *Ship. wt. 2 lbs.*

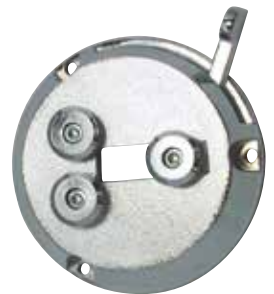

G321	2 1/2" Chrome Plated	\$39.95
G421	1 1/2" Chrome Plated	\$38.95

BOOSTER NOZZLE HOLDER TWO-POSITION MOUNTING BRACKET FOR VERSATILITY

This neoprene rubber cup mount is the ideal way to mount pre-connected nozzles on fire and emergency vehicles. Bracket sold separately. *Ship. wt. 3 lbs.*



SHOWN WITH
OPTIONAL U402

U400	Nozzle Cup Mount 3 1/2" I.D.	\$78.95
U401	Nozzle Cup Mount 5 1/2" I.D.	\$101.95
U402	Nylon Coated Bracket (Black)	\$45.95

AUTO CHARGE 11-FOR DUAL BATTERIES

Auto Charge 11 is a fully automatic battery charger for vehicles with dual battery systems. The unit contains two completely independent chargers to sense and control the current to the batteries. Thus parasitic loads on one battery have no effect on the second battery. Total output current is limited to protect the charger but may be supplied to either battery if the adjacent battery does not require it. Normally the current output is proportioned between batteries as required. Comes complete with charging indicator panel. 3-year warranty. 120v input. *Ship. wt. 12 lbs.*



SPECIFY VOLTAGE: 6, 12, or 24
Y644 Auto Charge 11 \$533.95

AUTO CHARGE 2000 KIT

COMPLETE CHARGING SYSTEM AT AN AFFORDABLE PRICE

Auto Charge 2000 is a high-output, dual battery charger that independently charges two batteries. Includes the Auto Charge 2000 automatic battery charger and Auto Eject (20 amp) automatic power line disconnect, providing a complete vehicle charging system that saves you money. Unique electronic sensing circuits sense the true battery voltage while eliminating the need for external sense wires. There is no overcharging and no water boil off. What's more, a built-in battery saver handles the problem of battery loading from rechargeable hand lights, portable radios and other loads. Comes complete with weatherproof, bar graph display that shows the charging condition of each battery; may be remotely mounted. 120v input, 15 amp output. 3-year warranty. *Ship. wt. 17 lbs.*



- Auto Charge 2000
- Auto Eject (20 amp)
- Charge display

AC905 Auto Charge 2000 Kit \$921.95

PUMP PLUS

AIR COMPRESSOR/BATTERY CHARGER PACKAGE

The Pump Plus is a small air compressor and a completely automatic battery charger packaged together. The air compressor is designed to be mounted on vehicles with air brakes to maintain the air pressure in the air brake system while the vehicle is not in use. A pressure switch senses the system pressure and operates the compressor whenever the pressure drops below a predetermined level. Battery charger is completely automatic and is for vehicles with dual battery systems. The batteries are automatically charged and maintain full charge while still being isolated from each other. This unit contains two independent chargers to sense and control the current to the batteries. Designed to mount directly on the vehicle. 12v compressor has 1-yr. warranty; Battery Charger comes with 3-yr. warranty. *Ship. wt. 20 lbs.*



AUTOMATIC DUAL BATTERY CHARGER

Z112A	Pump Plus HO Package	\$1,064.95
Z111	12v DC Auto Pump Compressor	\$575.95
Z112	120v AC Auto Pump Compressor	\$654.95

USB DUAL PORT

- Dual USB charging ports
- Quick and easy way to recharge electronic devices in a vehicle
- 3 Amps max output allows simultaneous charging of two USB devices
- Built-in LED indicator indicates device is powered
- Designed for easy installation in vehicle switch panels
- Reverse polarity protected
- Can be connected to 12V switched ignition or directly to battery
- **Cut-Out-Size:** 1.45"x0.83"
- 3-year warranty
- *Ship. wt. 1 lb.*



BL645	USB Dual Port	\$46.95
BN592	USB Dual Port with Cover	\$58.95

BACK-UP CAMERA SYSTEMS

Proven in the industry, 5" or 7" HD digital LCD system with ultra-clear image in a durable housing, 3 A/V inputs with audio, IP 69 waterproof camera with night vision (white infrared), 65' camera cable, remote bracket. Verity Rear Vision Systems will include a slim base heavy-duty mount free of charge to make installing a breeze.



BN144	Back-Up Camera System with 5" Diagonal Monitor	\$475.95
BN145	Back-Up Camera System with 7" Diagonal Monitor	\$515.95

INVIEW 360 CAMERA

The inView 360™ provides the apparatus driver with split screen view. The bird's-eye view is always visible providing a 360° view around the vehicle. This unique view allows the operator to see pedestrians and obstacles in close proximity to the apparatus or vehicle. The second view on the display switches between front/left/right/rear views depending on the operational conditions. The system is networked between the turn signals, and vehicle reverse so the screen automatically switches to left, right, and rear viewing when turning or backing up. An in-cab toggle switch allows the operator to override the default camera view for complete control over the system.



PACKAGE INCLUDES:

- Front camera
- Rear camera
- 2 side cameras
- Controller
- Cable kit
- Toggle switch
- Monitor is available as an option



BN328	inView 360™ Camera	\$1,949.95
-------	--------------------	------------

SUPER AUTO EJECT & AUTO EJECT

Super Auto Eject is a completely sealed automatic power line disconnect. This prevents contamination of the mechanism by road dirt and insures long, reliable life. Comes with a weatherproof cover that is spring loaded to close, preventing water from entering. A solenoid wired to the vehicle's starter is energized when the engine is started. This instantaneously drives the plug from the receptacle. This simple, reliable device eliminates the broken cables which result when drivers forget to remove the shore line when driving away. The Auto Eject comes without sealed housing. All units come with 120v AC connector. Both models are weatherproof. *Ship. wt. 2 lbs.*

SUPER AUTO EJECT
REAR HOUSING INCLUDED



AUTO EJECT
REAR HOUSING
NOT INCLUDED



SPECIFY COLOR: Red, White, Yellow or Gray

AG130	Super Auto Eject, 15 Amp	\$318.95
AG131	Super Auto Eject, 20 Amp	\$350.95
Y885	Auto Eject, 15 Amp	\$248.95
AF527	Auto Eject, 20 Amp	\$286.95

AUTOMATIC AIR EJECT

This simple, reliable, solid brass device permits pressurizing the vehicle's air pressure system from an external source. Automatically, when the engine is started, the air line is disconnected. Comes with the mating connector, check valve and simple installation instructions. Full 2-year warranty. *Ship. wt. 3 lbs.*

- Automatically disconnects air line when vehicle is started
- Eliminates broken air lines



AG133



AB034	Automatic Air Eject	\$298.95
AG133	Weatherproof Adapter Kit	\$60.95

TANKVISION PRO 300

The TankVision Pro is the fire industry's first multi-color tank level display. It uses a pressure sensor to sense the amount of liquid in the tank and can be calibrated to accurately display the volume in tanks of all shapes and sizes. *Ship. wt. 3 lbs.*



NEW



- Various Programmable multi-color tank level displays available
- More accurate tank level display
- Fractional scale standard, also available with percentage scale
- 9 LED level indicators with fractional scale
- 10 LED level indicators with percentage scale
- Programmable brightness control
- Full 180° wide-view, easy to see display
- The TankVision Pro is available for water, class A foam, and class B foam tanks
- Each display has a distinctive color and style



AR317	TankVision Pro 300 Gauge Kit, with Master Display Sensor and 10' Cable	\$482.14
AS309	TankVision Pro In-Cab Mini Display for Water	\$182.75
AS312	TankVision Pro Remote Driver for "Large Light" Display	\$299.95

WATER LEVEL MONITOR

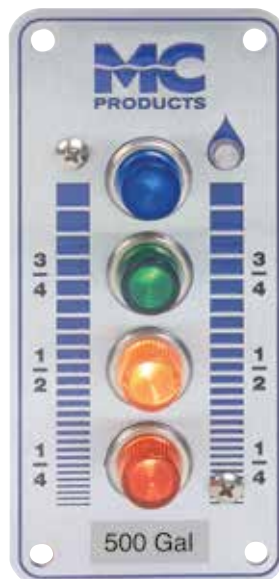

R157

Easy-to-read indicator. Water Level Monitor uses four red lights to show water level in sequence as water drains away. Complete unit includes control box, bezel plate, and stainless steel sensor. *Ship. wt. 1 lb.*

AB016 Includes: 4 domed lenses, 4 replacement bulbs, 2 plate screws and 1 bulb extracting tool

R157 SPECIFY: 12 or 24-Volt, and Tank Dimensions

R157	Water Level Monitor - Negative Ground	\$189.95
AB016	Service Kit for Water Level Monitor	\$19.95

QUINT WATER LEVEL MONITOR

Five-light readout that uses green, amber and red lenses with red flashing refill light. Complete unit consists of readout, bezel plate and stainless steel sensor. Additional readout available without sensor. *Ship. wt. 5 lbs.*

AB017 Includes: 5 domed lenses, 4 replacement bulbs, 1 flasher replacement bulb, 2 plate screws and 1 bulb extracting tool

X940 SPECIFY: 12 or 24-volt, and Tank Dimensions

X940	Quint Water Level Monitor - Negative Ground	\$233.95
X942	Additional Readout	\$129.95
AB017	Service Kit for Quint Level Monitor	\$24.95

LIQUID-FILLED GAUGES

ELIMINATES NEEDLE PULSATION FOR ACCURATE AND EASY READINGS

Crystal-clear Interlube keeps needle fluctuation to a minimum. The SUBZ II freeze-proof isolator keeps gauge working down to -40°F. It's also weather tight so there is no condensation; stops corrosion. Lubricates internal parts, stops wear, maintains accuracy under temperature fluctuations. Zytel (nylon) case with bright stainless steel trim ring has plexiglass lens. 6" gauge has cast aluminum case. Gauges measure 0-600 psi and up to 30" vacuum. *Ship. wt. 5 lbs.*

BLACK AND WHITE FACE GAUGES WITHOUT LOGO ARE AVAILABLE

T179	2 1/2" Liquid-Filled Compound Gauge	\$45.95
AK075	2 1/2" Liquid-Filled Compound Gauge with Bottom Connection	\$43.95
T180	3 1/2" Liquid-Filled Compound Gauge	\$71.95
AK076	3 1/2" Liquid-Filled Compound Gauge with Bottom Connection	\$71.95
T181	4 1/2" Liquid-Filled Compound Gauge	\$96.95
U966	Similar to T181 but with 1000 psi	\$96.95
U967	6" Liquid-Filled Compound Gauge	\$540.95



PANEL HOLE SIZE NEEDED FOR GAUGE INSTALLATION:

2.5" 2.69"(68.33mm)	3.5" 3.78"(96.01mm)
4.5" 4.85"(123.19mm)	Tolerance -.020"(0.51mm)

HEAVY DUTY SWING-OUT™ VALVES

Designed for the harsh realities of today's fire service when water contaminants challenge a valve's sealing capabilities. Swing-Out™ design for quicker and easier servicing. No need to remove valves from plumbing when servicing. Operating pressures to 250 psi (17 bar).

MEETS NFPA



- 90° handle travel
- Stainless steel ball with Hydromax provides longer valve life and improved sealing abilities
- Simple two seated design



Cat#	Description	Size	Weight	Price
P880	Heavy Duty Swing-Out™ Valve	1"	6 lbs.	\$200.95
P881	Heavy Duty Swing-Out™ Valve	1½"	8 lbs.	\$254.95
P882	Heavy Duty Swing-Out™ Valve	2"	12 lbs.	\$344.95
P883	Heavy Duty Swing-Out™ Valve	2½"	24 lbs.	\$419.95
P884	Heavy Duty Swing-Out™ Valve	3"	28 lbs.	\$630.95

BUTTERFLY VALVES

- Rotating the handle to open disc ¼ turn allows an almost unrestricted water flow
- The 10 position lever handle with positive detents allows the valve to be opened or closed incrementally for a controlled water flow
- Comes standard with a bleeder valve
- Available with 4", 4½", 5" or 6" male or female hose
- Ship. wt. 45 lbs.



LEVER HANDLE

BL272	6" NHSWFLH x 6" NHM	\$889.95
BL273	5" NHSWFLH x 5" NHM	\$889.95
BL274	4.5" NHSWFLH x 4.5" NHM	\$889.95
BL275	4" NHSWFLH x 4" NHM	\$889.95

HANDWHEEL

BL276	6" NHSWFLH x 6" NHM	\$1,036.95
BL277	5" NHSWFLH x 5" NHM	\$1,036.95
BL278	4.5" NHSWFLH x 4.5" NHM	\$1,036.95
BL279	4" NHSWFLH x 4" NHM	\$1,036.95

VALVE REPAIR KITS

Valve repair kits are convenient, economical and easy-to-use. Each kit contains the most frequently replaced parts to help cut down on maintenance time and costs. Kits come sealed to ensure a clean and adequate supply of parts for each job. Kits now are with new Fusion CF™ Composite ball. *Ship. wt. 1 lb.*

* Valve and nozzle repair kits are available for most Akron, Elkhart and more. Call for details.



Kits for Akron 7800 & 7600 Swing-Out™ Series Valves w/Tork-Lok

AK103	1" Valve Repair Kit	\$72.95
AK104	1½" Valve Repair Kit	\$85.95
AK105	2" Valve Repair Kit	\$116.95
AK106	2½" Valve Repair Kit	\$107.95
AK107	3" & 3½" Valve Repair Kit	\$183.95

Kits for Darley Standard and Full-Flow Valves (excludes ball)

KA00007	2½" Valve Repair Kit for Standard Valves	\$50.95
KA00009	2½" Valve Repair Kit for Full Flow Valves	\$100.95

TANKER DUMP VALVE

Install your own dump valve. Simply screw in the male NPT threaded flange that comes with the package. To this you bolt the valve itself and another NPT threaded flange (gaskets included). It's quick-opening, full-flow, compact, bubble-tight, is easily maintained and mounts in any position. The valve body is rust-proof epoxy coated aluminum. *Allow 4-6 weeks for delivery. Ship wt. 19 lbs.*



SPECIFY THREADS AND SIZES

		Disc Diameter	
M718	3" Dump Valve Package	3⅜"	\$145.95
M719	4" Dump Valve Package	4⅜"	\$209.95
M720	5" Dump Valve Package	5⅞"	\$560.95
R689	6" Dump Valve Package	6⅞"	\$680.95



MAGNESIUM ANODE POLE
ATTRACTS RUST & CORROSION

Sacrificial catalytic action of these magnesium anodes can help to prevent rust or corrosion from attacking your booster tank. Threaded mounting plate suspends the 3/4"x32" solid anode in the tank water. Bar is easily cut to fit tanks less than 32" deep. Comes with flange and gasket. *Ship. wt. 3 lbs.*

U971	Magnesium Anode Pole	\$67.95
------	----------------------	---------



GROUND SWEEP NOZZLE

Designed for use in fixed system applications. Adjustable nozzles can be pre-set at the factory or set in the field at time of installation. The fog pattern, which can be set up to 120°, can easily be set or adjusted at the job site. *Ship. wt. 1 lb.*

SPECIFY MALE OR FEMALE NPT (TAPERED)

Z321	3/4" Fixed Nozzle	\$190.95
Z322	1" Fixed Nozzle	\$212.95



MATTYDALE SWIVEL

Rugged cast brass elbow for use with mattydale hose beds. 1 1/2" NPT female free swivel inlet with 1 1/2" NST male outlet. Rough brass finish. *Ship. wt. 4 lbs.*

U307A	1 1/2" NPT x 1 1/2" NST	\$113.95
U307B	2" NPT x 1 1/2" NST	\$118.95
U307C	2 1/2" NPT x 2 1/2" NST	\$334.95

DARLEY HEAT EXCHANGER

Can be installed in the engine cooling system of any pumper. Instead of going directly into the engine cooling system, mixing with the anti-freeze solution, diluting it and then going out through the radiator overflow pipe, the flow of cool water from the pump bypasses through the condenser coils in the Heat Exchanger. The liquid in the cooling system circulates around the condenser coils and is completely cooled. Prevents loss of anti-freeze solution. Measures 24" long. *Ship. wt. 10 lbs.*



F618	Darley Heat Exchanger	\$260.95
------	-----------------------	----------

RADIATOR HEAT EXCHANGER
FITS BETWEEN RADIATOR HOSES

Does the same job as our F618 Heat Exchanger but fits between the radiator hoses to make installation easier. Only additional connections required are tube lines from pump discharge to return line to suction side of pump. Measures 9 1/2" long. *Ship. wt. 9 lbs.*



SPECIFY SIZE: 1 3/4", 2" or 2 1/4"

R592A	Radiator Heat Exchanger	\$265.95
-------	-------------------------	----------

VERNIER THROTTLE CONTROL

Easily installed throttle designed for apparatus. Provides both instant and micro meter fine adjustment together with a locking action which is not affected by vibration while pumping. Throttles are shipped complete, ready-to-install in 15' or 20' lengths. *Ship. wt. 5 lbs.*



NEW LOW PRICE

F62101	15' Vernier Throttle Control	\$36.95
F62103	20' Vernier Throttle Control	\$39.95

AIR PRIMER

- Super quiet
- Lightweight and small mounting space
- **Power:** Air operated (No electrical power required)
- Corrosion resistant brass construction
- **Oil-less Design:** Environmentally safe
- Self draining
- No moving parts
- **Air Requirements:** (2) Barrel = 7 cfm (3) Barrel = 10 cfm
- BL012 & BL013: For Darley/Waterous pumps
- BL014 & BL015: For Hale pumps

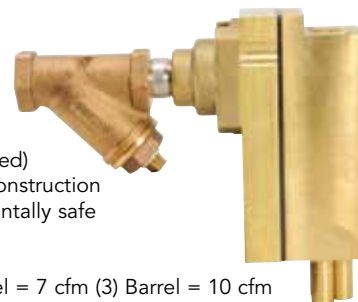

BL012	Air Primer (2) Barrel .75" F NPT-Remote Mtd.	\$932.95
BL013	Air Primer (3) Barrel .75" F NPT-Remote Mtd.	\$932.95
BL014	Air Primer (2) Barrel H-Midship Direct Mtd.	\$932.95
BL015	Air Primer (3) Barrel H-Midship Direct Mtd.	\$932.95

BOOSTER HOSE REELS

INCLUDE ALL THE INFORMATION BELOW.
SPECIFY LEFT/RIGHT BASED ON FACING OUTLET.

For Manual: Specify crank side (left or right)
Specify inlet side (left or right)
Note: Must be same side as motor/crank
Specify Color: Red, Silver, White or Primer Coat
Specify Size No. (see chart)
Specify 90° or Straight Inlet swivel
Specify size (3/4" or 1") and outlet thread type

For Electric: Specify motor side (left or right)
and motor position (front or back)
Note: Must be same side as motor/crank



**RUGGED, LONG
LASTING BOOSTER
HOSE REEL IN CHOICE OF
STEEL OR ALUMINUM TO
HANDLE YOUR 3/4" OR 1"
I.D. BOOSTER HOSE.**

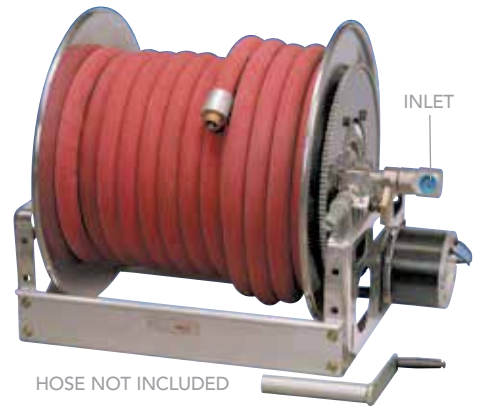

HOSE NOT INCLUDED

ELECTRIC REWIND BOOSTER HOSE REELS

AM167	Aluminum Booster Hose Reel	\$1,539.95
AM168	Steel Booster Hose Reel	\$1,184.95

MANUAL BOOSTER HOSE REELS

AM169	Aluminum Booster Hose Reel	\$1,099.95
AM170	Steel Booster Hose Reel	\$714.95

OPTION

AZ633	Roller and Spool Installed	\$189.95
-------	----------------------------	----------

Size No.	HOSE REEL CAPACITY IN FEET		OVERALL REEL DIMENSIONS IN INCHES			APPROX. STEEL WT. LBS. (CRANK)		APPROX. ALUMINUM WT. LBS. (CRANK)	
	I.D. 3/4" O.D. 1 1/32"	I.D. 1" O.D. 1 1/16"	E	F	G	Net.	Ship.	Net.	Ship.
01	150	100	21 5/8	34 1/4	21 1/2	102	144	80	122
02	150	100	23	25 3/4	23 1/2	92	134	75	117
03	250	150	23	32 1/4	23 1/2	105	147	82	124
04	200	100	28 3/4	18 1/4	29 7/8	100	150	80	130
05	250	150	28 3/4	21 1/4	29 7/8	107	157	83	133

"F" dimension is the same for both electric & manual models. Add 40 lbs. to weights shown for electric models.

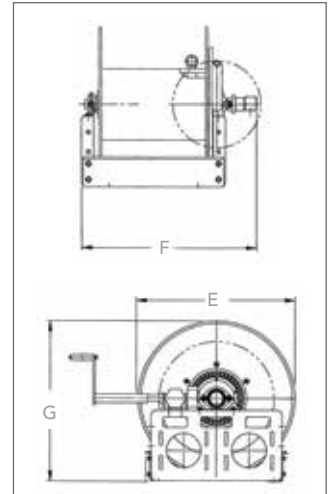

ROLLER AND SPOOL ASSEMBLY

Speed your hose handling and reduce wear on hose. Buffed stainless steel rollers. Assembly includes roller, 2 blocks, 2 spools, bearings and all fastenings. Length of roller should be the same as the reel drum length. (Larger sizes are available for an extra charge). *Ship. wt. 13 lbs.*



SPECIFY LENGTH: Up to 38"

R698	Roller and Spool Assembly	\$154.95
------	---------------------------	----------

SWIVEL JOINTS

Pressure balanced design for low rotation torque. Hardened carbon steel barrel for strength and long wear. NPT threads. *Ship. wt. 3 lbs.*



AF774	1 1/2" Swivel Joint	\$249.95
T961	1" Swivel Joint	\$101.95
T963	1" Seal Kit for T961	\$39.95

DROP-IN STYLE BOOSTER REEL

These reels are an excellent choice for drop-in units or smaller apparatus compartments where space is a premium. They're built to the same design standards as our larger reels, just lighter in weight and more compact. Available in either electric or crank rewind. Reels will hold up to 100' of 1" or 200' of 3/4" booster hose. **Dimensions:** (E) Crank/16.5", (E) Elec/19", (F) Crank/46.62", (F) Elec/39.75", (G) 18.12".

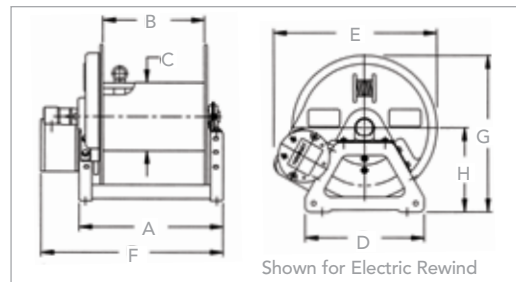

Shown for Electric Rewind

AJ513	Drop-In Style Booster Reel/Electric	\$799.95
AJ514	Drop-In Style Booster Reel/Crank	\$399.95

BRACKETS, TUBING & GRAB RAILS

The F615 Surface Mount End Bracket bolts to any horizontal or vertical flat surface. The F617 Center Mount Bracket is used in the center of long railings for support. The AB044 Slip-Resistant Grab Rail is extruded aluminum tubing with black rubber inserts. *Ship. wt. 1 lb.*



AB044: SPECIFY LENGTH NEEDED

F615	Surface Mount End Bracket	\$13.95/ea.
F617	Center Mount Bracket	\$12.95/ea.
AB044	Aluminum Slip-Resistant Grab Rail	\$16.95/ft.

DECORATIVE CHROME-PLATED FIRE BELL

Beautiful, large 12" Fire Bell, cast in bronze with polished chrome finish. Comes with stand and clapper. Available with your choice of decorative ornamental top eagle or acorn nut. *Ship. wt. 40 lbs.*



R181	12" Bell with Eagle, Chrome-Plated	\$1,445.95
R182	12" Bell with Acorn, Chrome-Plated	\$1,515.95
AS418	12" Bell with Eagle, Gold	\$1,643.95

QUIC-CHOC® FOLDING WHEEL CHOCK

This new folding aluminum wheel chock requires only a 6"Hx10½"W x20⅞"D area for storage. Can be stored under fire or rescue vehicles. The collapsible design allows the chock to lock in the open position simply by pulling out the back casting and pushing down. Just release the safety latch to close back into the folding position. Convenient carrying handle makes transport and placement of chock a snap. Made of high-tensile strength aluminum with rear opening, hand grip and a double row of rugged teeth to grip almost any surface. Meets applicable NFPA standards.



REQUIRES LESS STORAGE SPACE



- Can be used with tires up to 44" in diameter in the open position



AG083	Folding Wheel Chock	\$308.95
AG084	Folding Wheel Chock Horizontal Holder	\$89.95

CONVERT YOUR WHEEL CHOCK FOR WILDLAND FIRE FIGHTING

BA159	Wildlands Adapter for Folding Wheel Chock	\$54.95
BA160	Wildlands Adapter Horizontal Holder	\$129.95

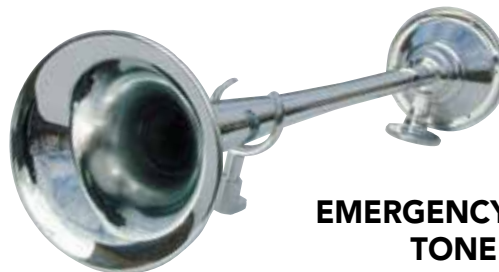

EMERGENCY STUTTER TONE AIRHORN

Emergency vehicles can travel with more safety when equipped with emergency airhorns emitting directional, machine gun series of blasts. Operates on pressure up to 125 lbs. controlled by an electric valve. Connects directly to air brake junction box. Chrome plated; measures 24½" with 6" flare. *Ship. wt. 7 lbs.*

AA957	Emergency Stutter Tone Airhorn	\$314.95
-------	--------------------------------	----------

OVERSIZED FOLDING STEPS

Easily installed on apparatus wherever a convenient assist step is needed. Folds up flush against mounting surface. Made of high-strength die cast, zinc/aluminum alloy with corrugated safety step to prevent slipping. *Ship. wt. 1 lb.*



AB990	Oversize Folding Step	\$65.95
AB043	Stainless Steel Folding Handhold	\$21.95

FOLDING STEP



- High quality CASS 24 chrome plate finish
- Dual LED light integration with full seal housing
- Ball-bearing rotation with no metal to metal contact
- Integral grab handle
- Largest platform on the market (8.7"x6.7")
- Reflective tape with color options
- Cast recess for circular logo options on platform
- Bolt pattern retrofitable
- NFPA Compliant tread pattern for the most weatherable conditions

BN604	Folding Step	\$58.95
BN320	Folding Step with Lights	\$63.95

TURTLE TILE® COMPARTMENT MATTING

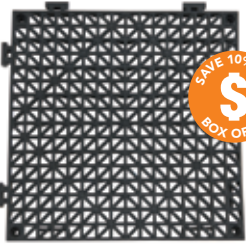

SAVE 10% ON
BOX OF 36



SHOWN WITH OPTIONAL
EDGE & CORNER RAMPS

- 3/4" profile
- Heavy-duty
- Fast and easy-to-install
- Open grid profile for instant drainage
- Made in USA from recycled plastic
- Modular and interlocking
- Resistant to most hydraulic fluids
- Mount brackets directly to tiles
- Dimensions: 12"x12"x3/4"
- Shop additional colors on edarley.com

COLOR: Black		Box of 36	Each
AF680	Turtle Tile®	\$179.95	\$6.95
AF681	Male Edge	—	\$4.95
AF682	Female Edge	—	\$4.95
BP370	Male Corner Ramp	—	\$3.95
BP372	Female Corner Ramp	—	\$3.95



TRUCK MADE™ STORAGE SOLUTIONS

"ORGANIZING AMERICA'S FIRE TRUCKS"



- Won't rust, crack or dent
- Mounts directly into compartments with the U308 equipment glides
- FDA-approved non-porous material
- Lightweight and stackable
- Perfect for any hazardous or bio-terrorist compliance issue
- Custom sizes and engravable front plates are available. Call for details.



SPECIFY COLOR: Matte Black, Gloss Black, Gloss White, Matte Blue, Matte Red or Matte Yellow

AZ526	3"x22"x30" Polypropylene Tray	\$159.95
AZ527	3"x22"x40" Polypropylene Tray	\$159.95
AZ528	10"x10"x22" Polypropylene Box	\$144.95
AZ529	10"x10"x40" Polypropylene Box	\$199.95

EMERGENCY VEHICLE REFLECTIVE STRIPING

For improved visibility and a more professional look to all your emergency vehicles. Reflective striping with pressure-sensitive adhesive backing. Comes in 150' rolls so you can cut to size depending on the area of coverage. Easy-to-install. Comes standard in white. *Ship. wt. 5 lbs.*



Cat#		1"	2"	3"	4"	6"
AZ467	Red Striping	\$61.95	\$132.95	\$196.95	N/A	N/A
AZ469	White Striping	\$61.95	\$132.95	\$183.95	\$245.95	\$393.95

FIREMAN'S FRIEND DRYING CLOTH

This large 17"x27" drying cloth soaks up large volumes of water and other liquids quickly. The soft, absorbent material will not scratch or leave lint. It dries quicker and easier than chamois or any other towel you can find. *Ship. wt. 1 lb.*



T235	Fireman's Friend	\$12.95
	Case of 6	\$9.95/ea.



SUNSTRIP ULTRABRIGHT LED LIGHT

ULTRABRIGHT WHITE LED LIGHT FOR COMPARTMENTS, PANELS, UNDER BODY APPLICATIONS, WALKWAYS & STAIRWELLS

- More than 300 lumens of LED light per 18" length
- LEDs housed in a strong 5/8" diameter lexan tube
- Designed tough to withstand any vehicle vibration
- Waterproof and submersible
- Great for all applications and easy to install
- Long operating hours – rated at 50,000 hours
- 5-year LED lighting warranty

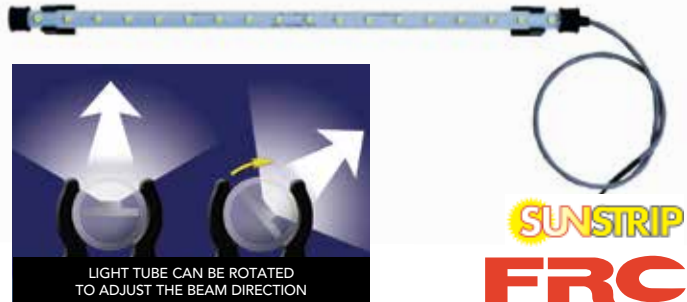

LIGHT TUBE CAN BE ROTATED
TO ADJUST THE BEAM DIRECTION



A Safe Fleet Brand

Cat#	Description	Length	Lumens	Current@12v	Price
BK352	LED 12vdc SUNSTRIP Light	9"	150	0.17 amps	\$65.92
BK353	LED 12vdc SUNSTRIP Light	18"	300	0.35 amps	\$81.81
BK354	LED 12vdc SUNSTRIP Light	27"	450	0.52 amps	\$114.66
BK355	LED 12vdc SUNSTRIP Light	36"	600	0.70 amps	\$133.56
BK356	LED 12vdc SUNSTRIP Light	45"	750	0.87 amps	\$167.45

LITTLE GIANT DEFENDER™ LADDER

The Little Giant Defender™ was specifically engineered for firefighters who need speed and strength in a rapid-response portable ladder system.

- Reflective, heat sensitive labels
- Easy-to-use Rock Lock® adjuster
- Built-in dual Ratchet™ levers. Adjust up to 8.5" on each side over uneven ground
- Tip & Glide™ wheels
- Wide-flared extension ladder for improved side-tip stability
- Adapts to almost any situation, offering a safe, stable climbing solution
- Capable of dozens of configurations, including A-frame, staircase, extension, and 90°
- Exceeds all OSHA & ANSI standards. Certified to NFPA requirements 1931/1932
- Rated to 300 lbs.
- Built-in dual Ratchet Levelers™ adjust up to 8.5" on each side over uneven ground
- Counts as ISO footage on apparatus

Cat#	Description	Stepladder		Extension		Wt.	Price
		Min Ht.	Max Ht.	Min Ht.	Max Ht.		
BN613	17' Defender™ Ladder	4'	7'	9'	15'	39 lbs.	\$503.95
BN614	22' Defender™ Ladder	5'	9'	11'	19'	47 lbs.	\$571.95



LITTLE GIANT OVERHAUL LADDER

Little Giant Ladder Overhaul Ladder extends to 17', but it is small enough to carry into an elevator, up a flight of stairs, or around tight corners. The ladder is just 4'7" tall when retracted. Articulating ladder systems that meet the requirements of NFPA 1901-2009.

- Safety Insight™ photo-luminescent glowing rungs
- Patented Rock Lock™ adjusters
- Wide-stance leg levelers adjust over uneven ground
- Tip & Glide™ wheels
- 90° position for extraction rescue
- Access uneven surfaces, staircases, and hard-to-reach places
- Ratchet Levelers™
- Roof and rafter hooks
- Dual-position spike feet
- Counts as ISO footage on apparatus

Cat#	Description	Stepladder		Extension		Wt.	Price
		Min Ht.	Max Ht.	Min Ht.	Max Ht.		
BN615	17' Overhaul Ladder	4'	7'	9'	15'	52.3 lbs.	\$1,036.95



All ladders over 8' are shipped via motor freight. All orders **MUST BE** inspected before acceptance upon delivery.

USE SKULL SAVERS DON'T RISK LADDER INJURIES

Walking into the heel of a ladders always painful and extremely dangerous. Skull Saver is easily visible and cushions any contact. Slight tug opens the Velcro® fastener, closes with finger pressure. Stays on in high winds, rain, or ice. Includes extra strap for permanent attachment to apparatus. *Contact us for pricing on custom sizes. Ship. wt. 6 lbs.*



AW345



R891	Single Leg 4" Hx9"Wx5"D	\$70.92
R891XA	Super (A)* 23" Hx9"Wx8"D	\$119.90
R891XB	Super (B)** 22" Hx5"Wx8"D	\$119.90
U697	Super Duper 27" Hx12"Wx8"D	\$134.88
AW345	USA Flag 23" Hx9"Wx8"D	\$119.90
AW346	USA Flag 27" Hx12"Wx8"D	\$134.88

*Super (A) model is for two-section ladders made after June 1984.

**Super (B) model is for two-section ladders made prior to June 1984.

LOCKING LADDER BRACKET

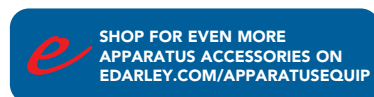

AF694	Locking Ladder Bracket	\$109.95/ea.
-------	------------------------	--------------

DUO SAFETY LADDERS



ALUMINUM FIRE LADDERS

TWO-SECTION (900-A SERIES)

Solid beam aluminum construction. Duo-Safety exclusive tongue and groove construction that holds sections firmly and rigidly, without brackets, hooks, or obstructions.

Cat#	Length	Closed	Width	Weight	Price
S965A	20'	12' 2 ³ / ₄ "	21 ³ / ₄ "	60 lbs.	\$580.95
S965	24'	14' 2 ³ / ₄ "	21 ³ / ₄ "	71 lbs.	\$648.95

Banking thickness = 5³/₈"

THREE-SECTION (1225-A SERIES)

Cat#	Length	Closed	Width	Weight	Price
S970A	30'	13' 3"	24"	108 lbs.	\$990.95
S970	35'	15' 3"	24"	130 lbs.	\$1,085.95

Banking thickness = 9¹/₈"

FOLDING LADDERS

Lightweight, these ladders fold into a compact bundle for storing or carrying. In the open position, special locking devices keep the ladders absolutely rigid. Equipped with Duo-Safety Ladder shoes as an extra precaution. 300 lb. duty rated.

ALUMINUM (585-A SERIES)

Cat#	Length	Closed	Width	Weight	Price
S956	8' 3 ¹ / ₄ "	9' 3 ¹ / ₂ "	12 ¹ / ₈ "	14 lbs.	\$183.95
S956A	9' 3 ¹ / ₄ "	10' 3 ¹ / ₂ "	12 ¹ / ₈ "	16 lbs.	\$206.95
S957	10' 3 ¹ / ₄ "	11' 3 ¹ / ₂ "	12 ¹ / ₈ "	19 lbs.	\$221.95
S958	12' 3 ¹ / ₄ "	13' 3 ¹ / ₂ "	12 ¹ / ₈ "	21 lbs.	\$239.95
S959	14' 3 ¹ / ₄ "	15' 3 ¹ / ₂ "	12 ¹ / ₈ "	24 lbs.	\$253.95

Banking thickness = 1³/₄" x 3¹/₄"

FIBERGLASS FIRE LADDERS

Fire ladders using extruded fiberglass channel rail construction and aluminum rungs welded to aluminum bocks and riveted to the fiberglass side rails. Safety yellow color for better visibility.

TWO-SECTION LADDERS (YGE-2 SERIES)

Cat#	Extended	Closed	Width	Nested	Weight	Price
R639	16'	10'	23"	7"	80 lbs.	\$699.95
R640	20'	12' 3 ¹ / ₂ "	23"	7"	94 lbs.	\$961.95
R641	24'	14' 3 ¹ / ₂ "	23"	7"	105 lbs.	\$1,040.95

WALL LADDERS (YGW SERIES)

Cat#	Length	Width	Height	Weight	Price
R642	12'	19 ¹ / ₄ "	3 ³ / ₈ "	28 lbs.	\$347.95
R643	14'	19 ¹ / ₄ "	3 ³ / ₈ "	32 lbs.	\$370.95
R644	16'	19 ¹ / ₄ "	3 ³ / ₈ "	37 lbs.	\$381.95

ROOF LADDERS (YGR SERIES)

Cat#	Length	Closed	Width	Weight	Price
R645	12'	19 ¹ / ₄ "	3 ³ / ₈ "	33 lbs.	\$370.95
R646	14'	19 ¹ / ₄ "	3 ³ / ₈ "	38 lbs.	\$401.95
R647	16'	19 ¹ / ₄ "	3 ³ / ₈ "	42 lbs.	\$452.95

ALUMINUM ROOF LADDERS

Channel Rail construction gives extra strength without cumbersome weight.

(775-A SERIES)

Cat#	Length	Width	Weight	Price
S976	10' 2 ¹ / ₂ "	19"	24 lbs.	\$253.95
S977	12' 2 ¹ / ₂ "	19"	28 lbs.	\$277.95
S978	14' 2 ¹ / ₂ "	19"	31 lbs.	\$302.95

Banking thickness = 2³/₄"

All ladders over 8' are shipped via motor freight. All orders **MUST BE** inspected before acceptance upon delivery.

ALCO-LITE ALUMINUM LADDER COMPANY

TRUSS TYPE LADDERS

TWO-SECTION LADDERS (TEL SERIES)

Oversized 2 1/4" pulley for easy operation. 45' and larger ladders equipped with stay poles.

	Ext. Closed		Banking		Wt.	Price
	L	L	W	Thickness		
Z354	20'	13'0"	22 1/4"	6 7/16"	93 lbs.	\$1,011.95
Z355	24'	15'4"	22 1/4"	6 7/16"	110 lbs.	\$1,113.95
Z356	28'	16'6"	22 1/4"	6 7/16"	118 lbs.	\$1,312.95
Z357	30'	17'8"	22 1/4"	6 7/16"	126 lbs.	\$1,421.95
Z358	35'	20'0"	22 1/4"	6 7/16"	141 lbs.	\$2,029.95
Z359	40'	22'4"	23 1/2"	8 1/8"	214 lbs.	\$2,222.95
Z360	45'	25'10"	23 1/2"	8 1/8"	232 lbs.	\$2,306.95

THREE-SECTION LADDERS (TEL3 SERIES)

3-fly section activated by cable and operates automatically with center section. Oversized 2 1/4" pulley for easy operation. 45' and larger ladders equipped with stay poles.

	Ext. Closed		Banking		Wt.	Price
	L	L	W	Thickness		
Z347	24'	12'0"	25 3/8"	9 1/16"	142 lbs.	\$1,801.95
Z348	28'	13'2"	25 3/8"	9 1/16"	154 lbs.	\$1,832.95
Z349	30'	14'4"	25 3/8"	9 1/16"	163 lbs.	\$1,520.95
Z350	35'	15'6"	25 3/8"	9 1/16"	175 lbs.	\$1,885.95
Z351	40'	16'8"	27"	9 1/16"	223 lbs.	\$1,996.95
Z352	45'	19'0"	27"	10 3/4"	242 lbs.	\$2,635.95
Z353	50'	20'2"	27"	10 3/4"	273 lbs.	\$2,928.95

ROOF LADDERS (TRL SERIES)

Designed for scaling roofs. High-strength steel, 3/4" rotating roof hooks with reinforcing brace.

	L	W	Wt.	Price
Z362	12'5"	19 1/16"	43 lbs.	\$532.95
Z363	14'9"	19 1/16"	50 lbs.	\$563.95
Z364	16'11"	19 1/16"	56 lbs.	\$640.95
Z365	18'2"	19 1/16"	60 lbs.	\$668.95

Z362-Z367 Banking thickness = 3 3/4"

	L	W	Wt.	Price
Z366	20'6"	19 1/16"	65 lbs.	\$586.95
Z367	24'0"	19 1/16"	76 lbs.	\$851.95
AR162	26'4"	19 1/16"	92 lbs.	\$945.95
AR163	28'8"	19 1/16"	100 lbs.	\$1,020.95

AR162 and AR163 Banking thickness = 5 1/8"

COMBINATION LADDERS

Functionally engineered for ease of operation as a step or extension ladder with dozens of uses. Compact design converts easily to extension ladder or "A" ladder. Accessible from both sides. Special heavy duty "A" bracket allows for quick, easy set-up. Meets NFPA.

	L		A-Ht		A-W		Wt.	Price
	L	A-Ht	A-W	W				
P704	6'2"	5'10"	4'3"	20 1/2"	27 lbs.	\$522.95		
P705	7'4"	7'0"	4'11"	20 1/2"	29 lbs.	\$588.95		
P706	8'6"	8'2"	5'4"	20 1/2"	33 lbs.	\$622.95		
P707	9'8"	9'1"	6'5"	20 1/2"	38 lbs.	\$671.95		

Banking thickness = 6 3/8"

ALUMINUM PUMPER TYPE LADDERS

TWO-SECTION LADDER (PEL SERIES)

Oversized 2 1/4" pulley for easy operation.

	Ext. Closed		Banking		Wt.	Price
	L	L	W	Thickness		
Z373	12'	8'5"	21"	5 1/16"	48 lbs.	\$494.95
Z374	14'	9'7"	21"	5 1/16"	53 lbs.	\$545.95
Z375	16'	10'9"	21"	5 1/16"	59 lbs.	\$598.95
Z376	20'	12'0"	21"	5 1/16"	66 lbs.	\$672.95
Z377	24'	14'3"	21"	5 1/16"	75 lbs.	\$748.95
Z378	28'	16'7"	22"	5 13/16"	114 lbs.	\$971.95
Z379	30'	17'9"	22"	5 13/16"	122 lbs.	\$1,048.95
Z380	35'	20'1"	22"	5 13/16"	139 lbs.	\$1,181.95

THREE-SECTION LADDERS (PEL3 SERIES)

3-fly section activated by cable and operates automatically with center section. Oversized 2 1/4" pulley for easy operation.

	Extd. Closed		Banking		Wt.	Price
	L	L	W	Thickness		
Z368	24'	12'2"	23 1/2"	7 1/4"	105 lbs.	\$1,070.95
Z369	28'	13'4"	25"	8 1/4"	145 lbs.	\$1,170.95
Z370	30'	14'6"	25"	8 1/4"	158 lbs.	\$1,295.95
Z371	35'	15'8"	25"	8 1/4"	170 lbs.	\$1,388.95
Z372	40'	17'0"	26"	8 1/4"	220 lbs.	\$2,027.95

ROOF LADDERS (PRL SERIES)

High-strength steel, 3/4" rotating roof hooks with reinforcing brace for durability.

	L	W	Wt.	Price
Z381	8'5"	18 1/2"	27 lbs.	\$254.95
Z382	10'9"	18 1/2"	33 lbs.	\$319.95
Z383	12'0"	18 1/2"	36 lbs.	\$340.95
Z384	14'3"	18 1/2"	42 lbs.	\$364.95

Banking thickness = 2 7/8"

	L	W	Wt.	Price
Z385	16'7"	18 1/2"	48 lbs.	\$413.95
AR160	18'10"	18 1/2"	54 lbs.	\$421.95
AR161	20'0"	18 1/2"	60 lbs.	\$589.95

Banking thickness = 2 7/8"

FOLDING ATTIC LADDERS

The ultimate in lightweight portability for low to medium height access. Folds laterally into 5 1/4" wide. Hinge locks ladder into position. Features carrying handles and large, heavy cast aluminum swivel safety shoes for traction. Meets NFPA.

	Open		Folded		Wt.	Price
	L	L	W	W		
Z390	8'3"	9'3"	5 1/4"	15 1/2"	12 lbs.	\$221.95
Z391	10'6"	11'5"	5 1/4"	15 1/2"	14 lbs.	\$265.95
Z392	12'8"	13'8"	5 1/4"	15 1/2"	17 lbs.	\$288.95
Z393	14'11"	15'11"	5 1/4"	15 1/2"	21 lbs.	\$314.95

Banking thickness = 2"



All ladders over 8' are shipped via motor freight. All orders **MUST BE** inspected before acceptance upon delivery.

EMERGENCY LIGHTS AND SIRENS

FOCUS LAMPHEAD

VERSATILE LOW PROFILE LAMPHEAD. COMPACT. DURABLE.

DON'T WASTE PRECIOUS LIGHT

The high intensity FOCUS lamphead does not waste precious light. It is designed to focus 100% of the light produced into the area where it is needed. The FOCUS is built tough and has a compact design that allows it to be mounted in places that traditional lighting fixtures do not fit.

BREAKTHROUGH IN SCENE LIGHTING

The FOCUS lamphead was designed to light up the emergency scene evenly, putting 100% of the light on the scene. A high percentage of the light produced by a conventional light fixture is wasted away from the emergency scene and gets dim at a distance. The FOCUS lamphead uses a uniquely designed patented reflector to eliminate wasted light. The curved reflector has over 50 parabolic surfaces that redirect all of the light produced and focus it evenly into the action areas. This allows the FOCUS to put all of the light onto the scene, providing more light close to the vehicle as well as being brighter at a distance.

AM262: Top mount, top raise pole with FOCUS lamphead

AM263: Side mount, bottom raise pole with FOCUS lamphead

AM266: FOCUS lamphead only

SPECIFY WATTAGE

Watts	Volts	Amps	AM262	AM263	AM266
300	12	25	\$810.55	\$810.55	\$416.38
500	120	4.2	\$716.81	\$716.81	\$323.78
1000	120	8.3	\$810.35	—	\$387.53
1000	240	4.2	\$810.55	—	\$387.53



SPECTRA LED LAMPHEAD SERIES

THE BRIGHTEST LED SCENE LIGHTS AVAILABLE.

The SPECTRA LED lamphead outputs an impressive 20,000 lumens of super bright white light. The advanced lens and unique arrangement of LEDs generates a uniform flood and spot combination light pattern. This light pattern provides enhanced work area visibility as well as illuminates objects at a farther distance. The NEW SPECTRA MAX outputs an unmatched 28,000 lumens of ultrabright light making it the brightest LED scene light available. All SPECTRA series lampheads can be used with any FRC telescopic poles, tripods, non-telescopic mounts, and brow mounts.

- Available as 20,000 lumens SPECTRA or 28,000 lumens SPECTRA MAX
- Unique arrangement of LEDs provides more light in a compact lamphead
- Models available in 120/240 VAC or 12/24 VDC
- Whiter light, closer to natural sunlight
- Uniform high quality white light with the widest light pattern
- Long operating hours, rated at 50,000 hours
- Instant-on at full intensity
- 5-year LED lighting warranty



BL749	SPECTRA LED Lamphead 120 VAC 20k Lumens	\$1,420.95
BL750	SPECTRA MAX LED Lamphead 12/24 VDC 28k Lumens	\$1,562.95
BL751	SPECTRA LED Lamphead 120 VAC 20k Lumens Portable with On/Off Switch	\$1,714.95
BL752	SPECTRA MAX LED Lamphead 120 VAC 28k Lumens with Standard Tripod	\$2,059.95

STREAMLIGHT™ PORTABLE SCENE LIGHT II 10,000 LUMENS, WATERPROOF, STACKABLE

Turn to a higher power with the Portable Scene Light II. With zero deployment time, it features a compact footprint, a 360° rotating head, and it's stackable for "light tower" capability with multi-level lighting. *Dimensions: 16"x11"x12"*

- 18 LEDs within wide pattern parabolic reflectors produce a smooth, high lumen flood pattern
- Five intensity levels correspond to desired run time
- 360° rotating head
- High-impact, thermoplastic housing mounted in a virtually indestructible alloy steel frame IPX7 rated; waterproof to 1m for 30 minutes
- Lithium ion batteries charge in 6 hours
- Batteries will continue to charge while plugged into an AC or DC power source
- Limited lifetime warranty



STACKABLE,
SOLD INDIVIDUALLY



APPARATUS EQUIPMENT

BP080 Streamlight™ Portable Scene Light II - 120 AC/12V DC

\$799.95

QUADRAFLARE™ 9"X7" LED PERIMETER WARNING LIGHT

- NFPA 1901 and GSA KKK-E compliant models
- Outstanding off-axis warning
- 26 built-in flash patterns, including "Quad-X" and "Steady"
- Flash patterns are push-button programmable
- Independent side control on split LED models
- Clear or color lens options
- Available with built-in flasher featuring 16 selectable patterns
- 5-year warranty on LED components

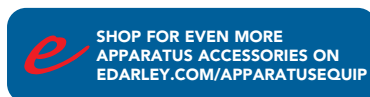

SPECIFY LED COLOR: Amber, Blue or Red



BG199	QuadraFlare™ Color Lens LED Warning Light*	\$151.95
BG200	QuadraFlare™ Clear Lens LED Warning Light	\$151.95
BG201	Chrome Trim Bezel with Gasket	\$14.95
BH077	9"x7" QuadraFlare™ LED Warning Light Colored Lens	\$235.95
BH078	9"x7" QuadraFlare™ LED Warning Light Clear Lens	\$235.95
BH095	Chrome Trim Bezel	\$21.95
BH096	Black Trim Bezel	\$19.95



SHOWN W/BG201

VANTAGEPOINT REMOTE CONTROL LIGHT ALLOWS FOR MAXIMUM PAN-TILT MOTION

Whether searching for a person in an emergency situation or illuminating a house number, VantagePoint offers the ultimate in remote control lighting. High-intensity LEDs deliver ultra-bright white light taking performance to the next level. Control the unit from inside the vehicle or remotely from up to 130' (40 m) away. Operators will appreciate the unique stow feature because the light returns to the forward facing position when turned off.

- 360° continuous horizontal rotation
- Pan and tilt motion
- Total tilt positioning of 115°
- Ultra bright 6720 lumens
- Weatherproof to IP67
- Two remote controls included
- Flashing alert
- 5 year limited warranty



BP327 VantagePoint Remote Control LED Light

\$547.95

HONDA GENERATOR LIGHTS

EU1000/EU2000 Honda Generator with 500W LED/quartz lamp head kit provides 500 watts of LED lighting. These generator/lighting units are powered by the Honda inverter-style generator and are light-weight and fold for compact storage.

- **Clean Power:** run sensitive electronics
- **Eco-Throttle Technology:** long running time
- **Parallel Operation:** optional linking doubles power
- **Simultaneous AC/DC**

USES

- Emergencies
- Public Services & Utilities
- Recreation

Cat#	Generator	Light Watts	Price
BN256	Honda EU1000	500 Quartz Lamp	\$1,685.95
BN257	Honda EU1000	500 LED Lamp	\$2,608.95
BN258	Honda EU2000	500 Quartz Lamp	\$2,018.95
BN259	Honda EU2000	500 LED Lamp	\$2,938.95



NEW

THE REVEL SCOUT SCENE LIGHT

Revel Scout Scene Light is designed to increase the safety of both firefighters and emergency responders. With versatile mounting options; set, hang, strap, spike and a removable, rechargeable battery, the Revel Scout revolutionizes the operational ease of fire scene lighting. The Revel Scout combines a spot and flood light pattern of 14,000 lumens in a 12 lb. package, and the LED tactical scene light can be used to evenly light exterior scenes and interior spaces.

- Fast, flexible deployment
- Light where you need it
- Integrated strap included to secure to horizontal object, ladder rung, etc.
- On/off toggle switch to turn light on and off and adjust to 4 light levels
- Corrosion-free construction
- Zero deployment time
- **Battery Type:** 28v LI-ION, **Weight:** 3 lbs. **charge time:** 1 hr
- **Warranty:** Light Assembly: 6 years, battery and charger: 1 year



VIDEO ONLINE ▶

LIGHT PERFORMANCE

- **Four Light Levels:** High, medium, low, spot
- **Light Output:** 14,000, 8,000, 2,000, 6,000 lumens
- **Average Run Time:** high - 1.2 hrs, medium - 3 hrs, low - 7 hrs, spot - 3.5 hrs



BN312	Revel Scout Scene Light	\$1,267.95
-------	-------------------------	------------

OPTIMUM PORTABLE LIGHT BRIGHTEST LAMPHEADS AVAILABLE

EFFICIENCY

- The brightest and best designed lights in the industry. A unique reflector design transfers more light from the bulb to the scene.

RELIABLE & TESTED

- Manufactured from heavy-duty, thick aluminum for long life and many hours of dependable performance. Tested under actual emergency situations.



AZ509	Portable Light 500W 120V QTZ with 15 Amp 3-Prong Twist-Lock	\$639.45
-------	---	----------

PORTABLE HAND LIGHT

A powerful 500w (120v) light head features a highly-polished specular hammertone reflector which almost doubles its light output. Sturdy aluminum housing with high-temperature carrying handle and tilt control knob. Heavy-duty ground tripod base with rubber footings. Optional mounting bracket allows you to mount it in any position. Meets NFPA; UL Listed. *Ship. wt. 3 lbs.*



AR301	Portable Hand Light	\$332.95
AR302	Mounting Bracket	\$60.95

HONDA 4000 W ECONOMY SERIES GENERATOR

RUGGED AND RELIABLE, THE ECONOMY SERIES GENERATORS ARE EASY TO TAKE ANYWHERE. JUST LOAD 'EM UP AND GO.

- 4000 watts maximum of rugged economical, portable power
- Honda GX commercial grade engine
- Oil alert
- Digital Automatic Voltage Regulator (DAVR)
- AC circuit breaker/protectors and 120/240V operation
- Recoil start
- Runs 15 hrs. on 1/2 load
- Delivers the best of both worlds: reliability and cost savings
- Dimensions: 26.8"x22.8"x22.5"
- Weight: 155 lbs.
- 3-year warranty



BL748 Honda 4000 W Economy Series Generator \$1,793.95

DIESEL GENERATORS

- Individual circuit breakers
- Kohler® engine
- Electric start/recoil start
- Automatic low-oil shutdown
- Voltmeter
- Hour meter
- Heavy-duty frame
- Steel fuel tank
- Extended run-time
- Easy maintenance
- 2-year warranty
- Weight: 266 lbs.
- Run-Time: 14 hrs @ 50% load



Cat#	Watts	HP	Weight	Dimensions	Price
BL418	6000	10	187 lbs.	35 1/2"x23"x24 1/2"	\$5,899.95

HONDA GENERATORS



- Heavy-duty frame protects generator from damage
- Larger 6.6 gallon fuel tank for longer run times
- Multiple front panel outlets for easy power connections
- Wide handles for easy transport
- Honda GX Industrial Commercial engine for easy starting, reliability, and Oil Alert®
- Oversized muffler for quieter operation
- Four step fuel filtering provides consistent fuel to prevent carburetor plugging
- AVR provides consistent, stable power output, superior to brushless generators
- Auto Choke for easier starting in varying conditions

Cat#	Watts	HP	Weight	Dimensions	Price
BB088	5000	11	223 lbs.	41.9"x27.2"x29.2"	\$2,613.95
BB089	6500	13	227 lbs.	41.9"x27.2"x29.2"	\$3,286.95

CORD REEL LIGHT

Cord Reel Lights are reverse-wired live cord reels, which allows a plug on the cord to be plugged into a power source while the Cord Reel Light is carried to the fire ground or work site. The Cord Reel Light allows the scene to be illuminated while providing a receptacle for additional tools or lights. Akron Brass Cord Reel Lights come in 10" cord reels with either 500 or 750 watt low profile Beta Light heads.

- Heavy-duty construction
- Powder coated
- Live slip ring design
- Adjustable tension nut
- 6' direct wire pigtail (10/3 Black)
- Meets NFPA requirements



Cord not included

Cat#	Watts	HP	Weight	Dimensions	Price
BB090	5000	11	223 lbs.	41.9"x27.2"x29.2"	\$2,613.95
BB092	7500	13	227 lbs.	41.9"x27.2"x29.2"	\$3,286.95



FEDERAL SIGNAL 100 WATT SPEAKER

The 100 watt speaker uses advanced housing material and field replaceable neodymium drivers to provide effective, high-quality sound at an affordable price. The speaker only weighs 6 lbs. and measures 7.7"Wx5.7"Hx4.7"D. The speaker is easily rotated allowing for either vertical, or horizontal mount orientation, and the P.E.T. (polyethylene terephthalate) housing material is exceptionally strong, while resistant to heat, moisture and will not corrode as most metallic materials do. *Ship wt. 6 lbs.*



AW243 100 Watt Speaker \$177.95

TRUCK MOUNT SPEAKER

Rectangular speaker is perfect for truck mounting. Made to take the heavy and extended use of today's vehicle applications. Has black baked enamel finish on the driver and rectangular bell is black plastic. *Ship. wt. 10 lbs.*



AB343 100-Watt Truck Mount Speaker \$136.95

PA 300 ELECTRONIC SIREN

PLUG IN PC BOARD - INCLUDES AIRHORN SOUND

The W691 provides all basic siren tones; TAP II, PA, radio rebroadcast, as well as a built-in airhorn sound with siren override. It is protected against all failure modes by a fuse that is replaceable without tools and can operate from any 12-volt positive or negative ground vehicle electrical system. Taps are included for 100 or 200-watt speakers. Comes complete with a swinging bracket which enables mounting in a variety of positions. *Ship. wt. 6 lbs.*



ILLUMINATED
FACE PLATE



W691 PA 300 Electronic Siren \$356.95

FEDERAL Q ELECTROMECHANICAL SIREN

**BEAUTIFUL, STREAMLINED, CHROME PLATED,
COMMANDS RESPECT**

This siren includes grille, brake, and chrome finish. It is designed to be pedestal mounted but is also offered less the rear housing for flush mounting. Heavy-duty coaster clutch is subject to very little wear. The unique clutch design delivers a longer coast-down sound once power is removed, thereby reducing battery drain. For quick silencing, an electric brake is also a standard feature. 12-volt, operating current 100 amps. The AC895 model comes complete with stainless steel finish, grille, brake, pedestal and rear housing. Model AC896 is for flush mounting and does not include pedestal or rear housing. 123 dB at 10 feet *Ship. wt. 49 lbs.*



CHROME PLATED



AC895 Electromechanical Siren \$1,941.95
AC896 Electromechanical Siren, for Flush Mounting \$1,743.95