

TROUBLESHOOTING FREQUENTLY ASKED QUESTIONS

TROUBLESHOOTING		
TROUBLE	PROBABLE CAUSE	SOLUTION
• Unit does not turn on.	<ul style="list-style-type: none"> ☛ Not plugged in. ☛ Outlet not functioning. 	<ul style="list-style-type: none"> ✓ Plug in unit. ✓ Have outlet replaced by a licensed electrician.
• Mist output minimal to none.	<ul style="list-style-type: none"> ☛ Cool mist is invisible. ☛ The filter has not absorbed water. 	<ul style="list-style-type: none"> ✓ Operate in High (3) setting. ✓ Wait 30 minutes for filter to absorb water.
• Filter turns brown.	<ul style="list-style-type: none"> ☛ The filter has absorbed minerals. 	<ul style="list-style-type: none"> ✓ Replace your filters (HWF100) by calling 1-800-546-5437, or visiting www.holmesproducts.com.
• FilterCheck® is not working.	<ul style="list-style-type: none"> ☛ Takes 30 minutes to register. 	<ul style="list-style-type: none"> ✓ Allow the humidifier to run continuously for 30 minutes for the FilterCheck® Indicator to reflect the filter condition.
• Humidifier continuously displays 21%.	<ul style="list-style-type: none"> ☛ Humidity at the humidifier is at or below 21%. 	<ul style="list-style-type: none"> ✓ Continue to operate humidifier to raise the room humidity.
• Humidifier continuously displays 90%.	<ul style="list-style-type: none"> ☛ Humidity at the humidifier is at or above 90%. 	<ul style="list-style-type: none"> ✓ Stop operating the humidifier if the humidity level is too high.

FREQUENTLY ASKED QUESTIONS	
Question	Answer
• What are the variables that affect run time?	<p>The estimated run time for this humidifier is based on average room conditions. The actual run time of your humidifier is dependent on numerous variables such as:</p> <ul style="list-style-type: none"> ✓ Air exchange in the room where the humidifier is placed. ✓ Room construction of the room where the humidifier is placed. ✓ Temperature of the room where the humidifier is placed. ✓ Humidity levels in the room where the humidifier is placed. ✓ Movement of occupants and the opening and closing of doors in the room where the humidifier is placed. ✓ Home furnishings in the room where the humidifier is placed.
• How do I remove film on water tank?	<ul style="list-style-type: none"> ✓ See Daily Maintenance instructions. Regular cleaning is recommended.
• How can I extend the run time?	<ul style="list-style-type: none"> ✓ Run your unit on the lowest setting. ✓ If your unit has electronics, set it to your desired humidity level. The unit will turn on and off, which will extend the run time. ✓ Fill the tank all the way full, place it on the base, let the water empty into the base until it stops bubbling, then refill the tank full again. This ensures maximum water capacity and will extend run time.

STORAGE INSTRUCTIONS

STORAGE INSTRUCTIONS

When not using your humidifier for an extended period of time:

1. Dispose of the filters. DO NOT leave in unit.
2. Clean, rinse and thoroughly dry the humidifier as directed in weekly maintenance. DO NOT leave any water in the unit when storing. Leaving water in the unit may render the unit inoperable for the following season.
3. Place the humidifier in the original carton and store in a cool, dry place.
4. Order your replacement filter for next year's use.

REPLACEMENT ACCESSORIES

To order the replacement accessories you can do any of the following:

- Visit your local retailer
- Go to www.holmesproducts.com
- Call Consumer Service at 1-800-546-5437

If you have any questions regarding your product or would like to learn more about other Holmes® products, please contact our Consumer Service Department at 1-800-546-5437 or visit our website www.holmesproducts.com. For inquiries regarding recycling and proper disposal of this product, please contact your local waste management facility.

WARRANTY INFORMATION

1 YEAR LIMITED WARRANTY

Sunbeam Products, Inc. doing business as Jarden Consumer Solutions or if in Canada, Sunbeam Corporation (Canada) Limited doing business as Jarden Consumer Solutions (collectively "JCS") warrants that for a period of one year from the date of purchase, this product will be free from defects in material and workmanship. JCS, at its option, will repair or replace this product or any component of the product found to be defective during the warranty period. Replacement will be made with a new or remanufactured product or component. If the product is no longer available, replacement may be made with a similar product of equal or greater value. This is your exclusive warranty. Do NOT attempt to repair or adjust any electrical or mechanical functions on this product. Doing so will void this warranty.

This warranty is valid for the original retail purchaser from the date of initial retail purchase and is not transferable. Keep the original sales receipt. Proof of purchase is required to obtain warranty performance. JCS dealers, service centers, or retail stores selling JCS products do not have the right to alter, modify or any way change the terms and conditions of this warranty.

This warranty does not cover normal wear of parts or damage resulting from any of the following: negligent use or misuse of the product, use on improper voltage or current, use contrary to the operating instructions, disassembly, repair or alteration by anyone other than JCS or an authorized JCS service center. Further, the warranty does not cover: Acts of God, such as fire, flood, hurricanes and tornadoes.

What are the limits on JCS's Liability?

JCS shall not be liable for any incidental or consequential damages caused by the breach of any express, implied or statutory warranty or condition.

Except to the extent prohibited by applicable law, any implied warranty or condition of merchantability or fitness for a particular purpose is limited in duration to the duration of the above warranty.

JCS disclaims all other warranties, conditions or representations, express, implied, statutory or otherwise.

JCS shall not be liable for any damages of any kind resulting from the purchase, use or misuse of, or inability to use the product including incidental, special, consequential or similar damages or loss of profits, or for any breach of contract, fundamental or otherwise, or for any claim brought against purchaser by any other party.

Some provinces, states or jurisdictions do not allow the exclusion or limitation of incidental or consequential damages or limitations on how long an implied warranty lasts, so the above limitations or exclusion may not apply to you.

This warranty gives you specific legal rights, and you may also have other rights that vary from province to province, state to state or jurisdiction to jurisdiction.

WARRANTY INFORMATION

How to Obtain Warranty Service

In the U.S.A.

If you have any questions regarding this warranty or would like to obtain warranty service, please call 1-800-546-5437 and a convenient service center address will be provided to you.

In Canada

If you have any questions regarding this warranty or would like to obtain warranty service, please call 1-800-546-5437 and a convenient service center address will be provided to you.

In the U.S.A., this warranty is offered by Sunbeam Products, Inc. doing business as Jarden Consumer Solutions located in Boca Raton, Florida 33431. In Canada, this warranty is offered by Sunbeam Corporation (Canada) Limited doing business as Jarden Consumer Solutions, located at 20 B Hereford Street, Brampton, Ontario L6Y 0M1. If you have any other problem or claim in connection with this product, please write our Consumer Service Department. **PLEASE DO NOT RETURN THIS PRODUCT TO ANY OF THESE ADDRESSES OR TO THE PLACE OF PURCHASE.**

Holmes®

Owner's Guide HCM730

INFO HOT-LINE: If, after reading this owner's guide you have any questions or comments, please call 1-800-546-5437 and a Customer Service Representative will be happy to assist you.



FILTER #: HWF100(2)
FILTRTYPE:WICK



Cool Mist Tower Humidifier

PLEASE READ AND SAVE THESE IMPORTANT INSTRUCTIONS

© 2016 Sunbeam Products, Inc. doing business as Jarden Consumer Solutions. All Rights Reserved. Distributed by Products, Inc. doing business as Jarden Consumer Solutions, Boca Raton, FL 33431.

P.N. 166330 Rev B

HCM730_16EM1

Printed In China
GDS-H0146814-SL

PLEASE READ AND SAVE THESE IMPORTANT SAFETY INSTRUCTIONS

When using electrical appliances, basic safety precautions should always be followed to reduce the risk of fire, electric shock, and injury to persons, including the following:

1. Read all instructions before using the appliance.
2. To avoid fire or shock hazard, plug the appliance directly into a 120V AC electrical outlet.
3. Keep the cord out of heavy traffic areas. To avoid fire hazard, NEVER put the cord under rugs or near heat registers. DO NOT place humidifier near heat sources such as stoves, radiators, and heaters. DO locate your humidifier on an inside wall near an electrical outlet. The humidifier should be at least 4 inches (10 cm) away from the wall for best results.
4. NEVER place humidifier in an area where it is accessible to children. NEVER use humidifier in a closed room, particularly where a child may be sleeping, resting, or playing (a closed room may result in excessive humidity).
5. Do not attempt to refill humidifier without first unplugging the unit from its electrical outlet. Failure to heed this warning may cause personal injury. Be sure to unplug the unit by pulling on the plug and not the cord.
6. NEVER place anything over moisture outlet when the unit is running.
7. NEVER drop or insert any object into any openings.
8. DO NOT operate any appliance with a damaged cord or plug, after the appliance malfunctions, or if it has been dropped or damaged in any manner. Return appliance to manufacturer for examination, electrical or mechanical adjustment, or repair.
9. Use appliance only for intended household use as described in this manual. Any other use not recommended by the manufacturer may cause fire, electric shock, or injury to persons. The use of attachments not recommended or sold by the manufacturer may cause injury.
10. DO NOT use outdoors.
11. Humidifier should be unplugged when not in use.
12. NEVER tilt, move, or attempt to empty unit while it is

PLEASE READ AND SAVE THESE IMPORTANT SAFETY INSTRUCTIONS

THIS APPLIANCE HAS A POLARIZED PLUG (one blade is wider than the other). To reduce the risk of electric shock, this plug is intended to fit in a polarized outlet only one way. If the plug does not fit fully in the outlet, reverse the plug. If it still does not fit, contact a qualified electrician to install the proper outlet.

DO NOT ATTEMPT TO MODIFY THIS PLUG OR DEFEAT THIS SAFETY FEATURE IN ANY WAY.

FEATURES - OPERATIONS

PRODUCT NOTICES

1. If moisture forms on the walls or windows of the room, turn off the humidifier. The room already has plenty of humidity and additional moisture may cause damage.
2. Always place humidifier on a firm, flat, level surface. A waterproof mat or pad is recommended for use under the humidifier. NEVER place it on a rug or carpet, or on a finished floor that may be damaged by exposure to water or moisture.
3. DO NOT allow the Moisture Outlet to directly face the wall. Moisture could cause damage, particularly to wall paper.
4. To prevent damage to surfaces, do not place humidifier under overhanging surfaces.

Cord and Plug Instructions:

The length of cord used on this appliance was selected to reduce the hazards of becoming tangled in, or tripping over a longer cord. If a longer cord is necessary an approved extension cord may be used. The electrical rating of the extension cord must be equal to or greater than the rating of the humidifier (refer to the rating information placed on the humidifier). Care must be taken to arrange the extension cord so that it will not drape over the countertop or tabletop where it can be pulled on by children or accidentally tripped over.

HOW COOL MIST WORKS

Your Holmes® Cool Mist humidifier draws dry air through the rear air intake grill area. This air is then passed through a moisture-laden wick filter, which retains the minerals and deposits in the water. The resulting moist air is directed back into the room from the top air grill.

NOTE: This humidification system provides a cool, invisible moisture output. It is normal not to see the mist.

NOTE: A humidity level below 20% can be unhealthy and uncomfortable. The recommended humidity level is between 40%-50%.

PRE-OPERATING INSTRUCTIONS

1. Be sure the humidifier is switched to OFF and the unit is disconnected from the electrical outlet.
2. Select a location for your humidifier, on a flat surface, about 4 inches (10 cm) away from the wall. DO NOT place the humidifier on a finished floor or near furniture, which can be damaged by too much moisture or water. Place on a moisture resistant surface.

NOTE: The first time you use your humidifier, saturate your wick filter and run the humidifier for 30 minutes before reading the filter meter. This will ensure that you receive the most accurate reading upon your first use.

FILLING THE WATER TANK

1. Remove the tank from the housing of the humidifier by grabbing the handle of the tank and pulling the tank out of the housing and then bring the tank to the faucet. (See Figure 3)
2. Turn the tank upside down and twist off the tank cap by turning counter clockwise. Fill tank with cool, fresh tap water. DO NOT fill with warm water as this may cause leaking. (See Figure 4)
3. To Replace the cap on tank, align arrows and turn to align to lock position. Ensure tank is closed FIRMLY. (See Figure 5)

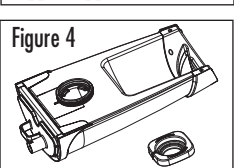
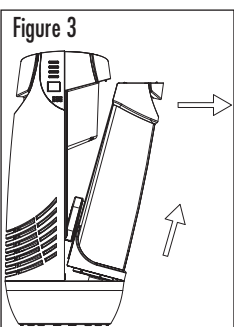
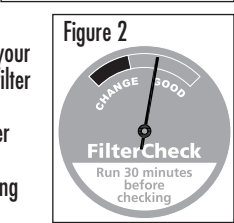
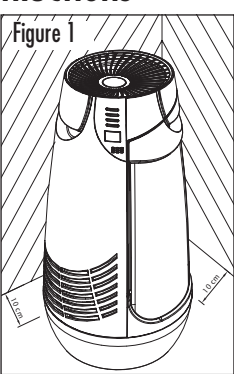

FEATURES - OPERATIONS

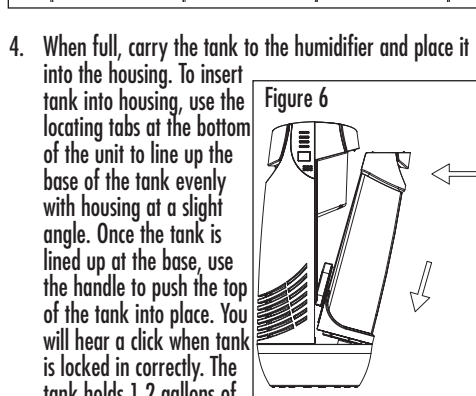
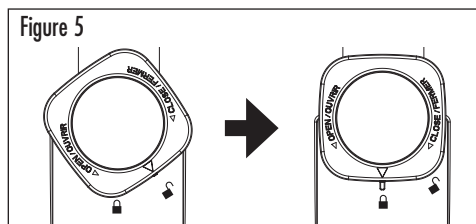

4. When full, carry the tank to the humidifier and place it into the housing. To insert tank into housing, use the locking tabs at the bottom of the unit to line up the base of the tank evenly with housing at a slight angle. Once the tank is lined up at the base, use the handle to push the top of the tank into place. You will hear a click when tank is locked in correctly. The tank holds 1.2 gallons of water. The tank will immediately begin to empty into the base. (See Figure 6)

NOTE: You may hear a "gurgling noise" as tank fills. This is completely normal.

5. Plug the power cord into a 120V AC electrical outlet.

OPERATING INSTRUCTIONS

- NOTE:** The humidifier produces clean, cool, INVISIBLE moisture. It is normal not to see the moisture.
1. Allow up to 30 minutes for the filter to fully absorb water and the unit to produce the maximum moisture output.
 2. Press the Power Button (⏻) to turn the humidifier on, the humidifier will run at High setting and "3" will illuminate on the display. After 2 seconds, the display will return to show the room humidity.
 3. If you want to switch to Medium/Low settings, press the Power Button (⏻) again. Each press of the button will cycle through the speed settings (High-Medium-Low-Off), and the selected setting (3-2-1-0F) will appear on the display.
 4. To shut the humidifier off at any setting, press and hold the Power Button (⏻) for 3 seconds and "0F" will illuminate on the display.

Digital Humidistat Control

Your humidifier is equipped with a digital humidistat that allows you to set your humidifier to your desired comfort level by pressing the up/down buttons (▲/▼) to adjust the humidity level ranging from 30% to 60%. The selected humidity level will illuminate on the display.

NOTE: For the most accurate humidity reading, run your humidifier for 1 hour before reading the humidistat.

When the room humidity level rises above the set humidity, the humidifier will stop. When the room humidity level drops below the set humidity, the humidifier will turn on automatically to maintain the preset humidity level.

WARNING: DO NOT move the humidifier with water in the tank or the humidifier base. The moving action of the water may activate the water tank's release nozzle and overflow the humidifier base. This may cause the humidifier to function intermittently, or stop emitting mist. Should this occur, simply remove the excess water from the humidifier base.

NOTES:

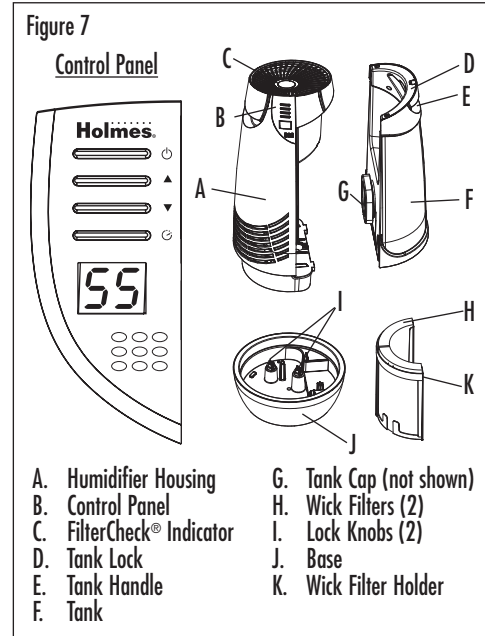

FEATURES - OPERATIONS

- **High** setting is ideal for overly dry environments where faster moisture relief is desired. This setting allows the fan to operate at its full capacity to produce the maximum moisture level. **Low** setting will produce the longest run time and have a quieter performance which is ideal for sleeping and when desiring more quiet environments.
- Allow up to 30 minutes for the filter to fully absorb water and for the unit to produce moisture.

Timer

Your humidifier is equipped with 24-Hour Auto Shut-off Timer feature. This allows you to program your humidifier to shut off automatically after running a defined time interval.

1. Press the Timer Button (⌚) once. The "0" will illuminate on display.
2. Press the up/down buttons (▲/▼) to adjust from 0 to 24 to select your desired time interval for the humidifier to shut-off automatically.
3. The selected hour will appear on the display.
4. When timer is set, you may check the remaining time while humidifier is still in operation. Press the Timer Button and the remaining time (e.g., 7) will illuminate on the display.
5. To cancel the Timer feature, press the **Timer Button** (⌚). The remaining time will appear on the screen. Press the down button to "0". The Timer will then be cancelled.

NOTE: When the water tank is empty, and the base is almost empty, you need to refill the tank. The fan will continue to run to help dry the humidifier. Shut off and unplug the unit. Please follow the Daily Cleaning Instructions. Refill the tank as directed in Filling the Water Tanks Instructions.

NOTE: If moisture forms on the walls or windows, turn off the humidifier.

REPLACING THE FILTERS

Through normal use, waterborne minerals and sediment become trapped in the wick filter. The harder your water, the greater the amount of minerals in the water, and the more often you will need to change your filter.

You will be able to monitor the life of the filter in your humidifier by checking the FilterCheck® Indicator.

NOTE: After 30 minutes of use, FilterCheck® Indicator will move and indicate your filter condition.

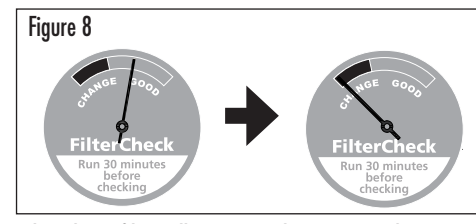

A brand new filter will register in the section reading GOOD filter. After frequent use of your humidifier, the FilterCheck® Indicator will let you know when the filters need to be changed. (See Figure 8)

When the needle is in the CHANGE section, this means the proper amount of moisture is not getting into your air due to the excessive minerals and sediment that have become trapped on your filters. At this point, you should replace your filter. It is important to change your filter as indicated to obtain stated performance level.

To replace the filter, follow the steps below:

1. Turn the unit off and disconnect from the electrical outlet.
2. Remove the tank from the housing.
3. Unlock the housing from the base by turning the lock knob to the unlocked position. (See Figure 9)
4. Lift the housing straight up and place to the side.
5. Unlock the wick holder from the base by turning the lock knob to the unlocked position.
6. Remove the wicks from the wick holder. (See Figure 10)
7. Follow the weekly cleaning instructions.

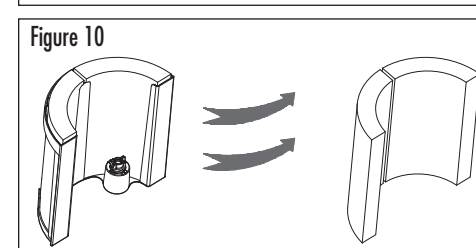
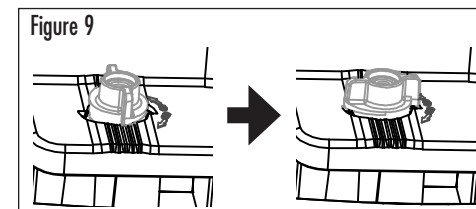

FEATURES - OPERATIONS CLEANING / MAINTENANCE

8. Insert new filters into the wick holder and lock the wick holder back onto the base.
9. Replace the housing onto the base and lock it into place.
10. Fill the tank and place back into housing, you will hear a click sound when the tank is locked on the housing properly.
11. Repeat Operating Instructions.

It will take about 30 minutes for the humidifier to reach maximum output.

NOTE: You can purchase replacement filters (model BWFT100) at a local retailer, by calling 1-800-546-5437, or by visiting www.holmesproducts.com. It is recommended that a replacement filter is purchased for uninterrupted use.

CLEANING AND MAINTENANCE INSTRUCTIONS

Humidifiers provide comfort by adding moisture to dry, heated indoor air. To benefit most from the humidifier and avoid product misuse, follow all instructions carefully. Please note that this is an electrical appliance and requires attention when in use.

In addition, if you do not follow the recommended care and maintenance guidelines, micro-organisms may be able to grow in the water within the water tank. You must routinely follow the cleaning procedures that follow in order to ensure proper, efficient operation of your humidifier. Proper maintenance and cleaning is essential to the continued performance of your unit and the avoidance of algae or bacteria build-up.

Daily Maintenance

1. Be sure the unit is OFF and is disconnected from the electrical outlet.
2. Remove the housing and the tank from the humidifier and place in sink or tub.
3. Carry the base of the unit to the sink, remove the wick, place in sink, drain any remaining water and rinse thoroughly to remove any sediment or dirt. Wipe clean, and dry with a clean cloth or paper towel.
4. Drain the water from the tank into the sink and rinse tank thoroughly. Wipe clean, and dry with a clean cloth or paper towel.

5. Put filters back into wick holder making sure the rivet attaches to the holder. Lock the wick holder back into place. Replace the housing and lock it into place. Refill the tank with cool tap water as instruction earlier in the filling instructions. Do not overfill.
6. Follow Operating Instructions.

Weekly Maintenance

To Remove Scale:

1. Repeat steps 1-4 above.
2. Clean the base by partially filling the base with one 8-oz cups of undiluted white vinegar. Leave this solution in the base for 20 minutes, while cleaning all the interior surfaces with a soft brush. Remove base scale by wiping the base with a cloth dampened with undiluted white vinegar.
3. Rinse with clean warm water to remove the cleaning solution before disinfecting the tank.

To Disinfect Humidifier Base and Tank:

1. Fill humidifier tank 1/2 full with water and 1/2 tablespoon of chlorine bleach.
2. Let the solution stand for 20 minutes, swishing every few minutes. Wet all surfaces.
3. Carefully empty the tank after 20 minutes, and rinse with warm water until you cannot detect any bleach smell. Dry with a clean cloth or paper towel.
4. Place filter back into tank and refill the water tank as directed in Operating Instructions, and turn the unit on.