

2009 Hyundai Accent L4-1.6L

Vehicle > Transmission and Drivetrain > Manual Transmission/Transaxle > Service and Repair > Removal and Replacement

REPAIR PROCEDURES (M5CF1)

Removal

CAUTION:

- Use fender covers to avoid damaging painted surfaces.
- To avoid damage, unplug the wiring connectors carefully while holding the connector portion.

NOTE:

- Mark all wiring and hoses to avoid mis-connection.

1. Remove the battery(A) after removing the battery terminal.

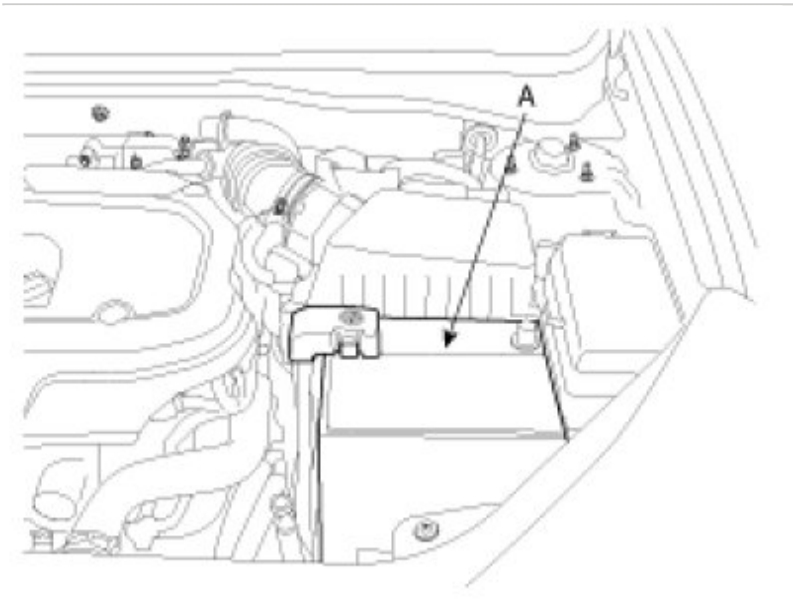

2. Remove the intake air hose and air cleaner assembly.
 - (1) Disconnect the air flow sensor connector(A).
 - (2) Disconnect the air cleaner hose(D) from the bleeder hose(B).
 - (3) Remove the intake air hose and air cleaner upper cover(C).

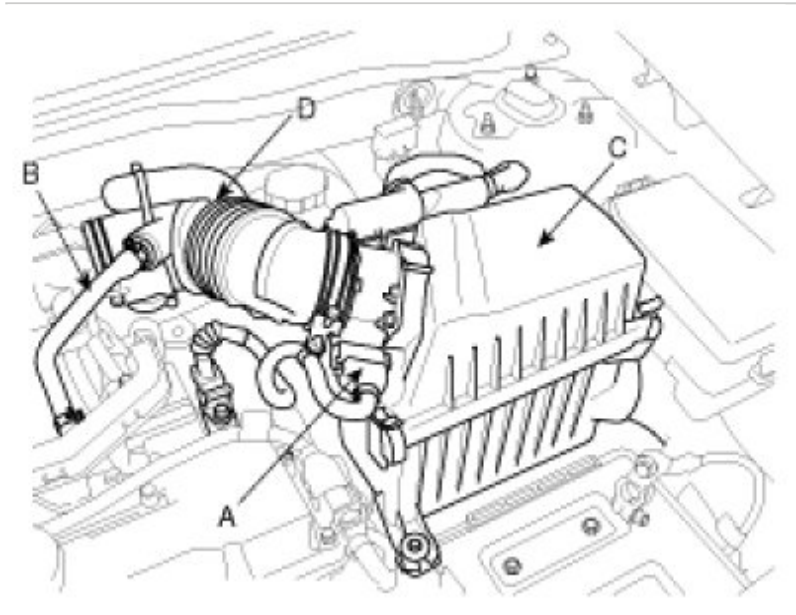

(4) Disconnect the ECM connector(A, B).

(5) Remove the air cleaner element and lower cover(C).

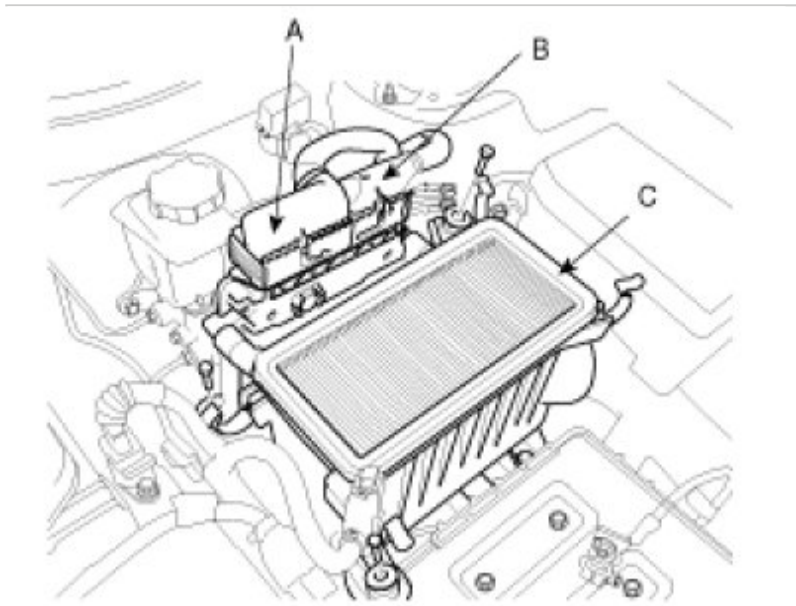

3. Remove the battery tray(A).

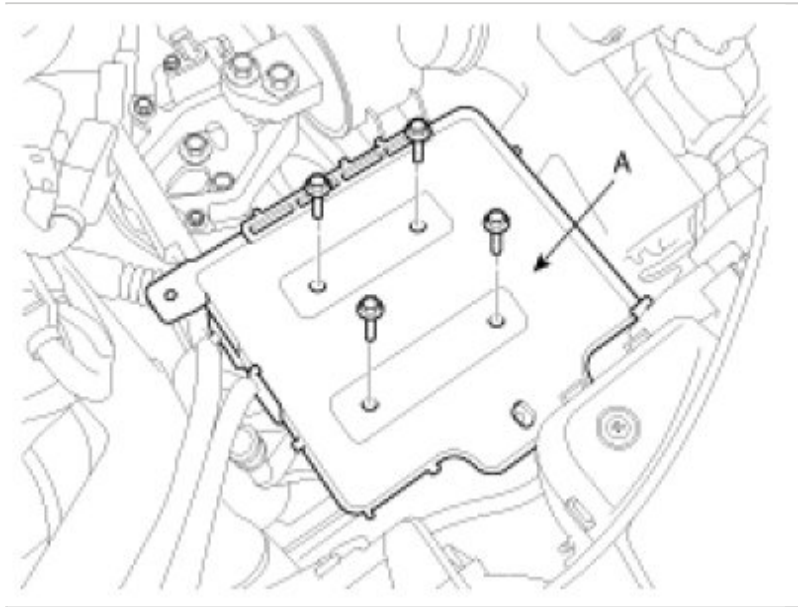

4. Remove the ground cable from transaxle(A).

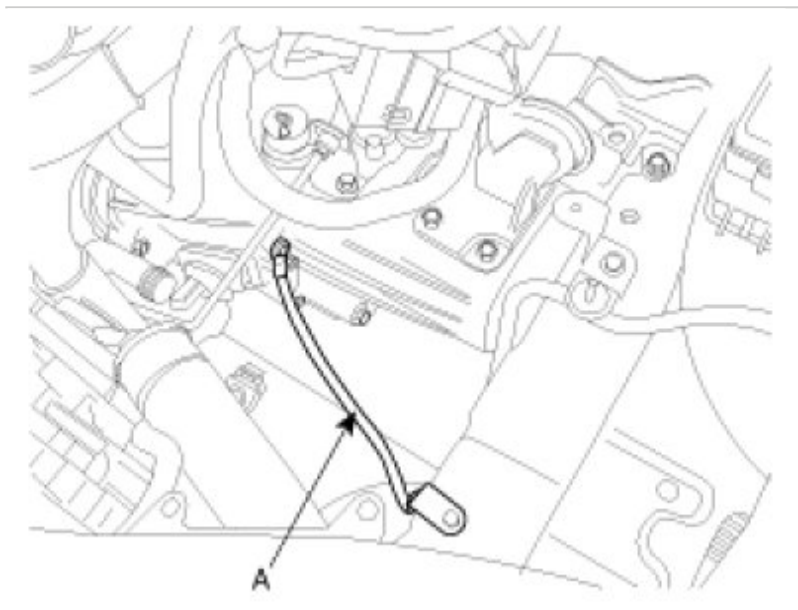

5. Remove the transaxle wire harness connectors and control cable from transaxle.
(1)Remove the tube bracket (A) from the transaxle.

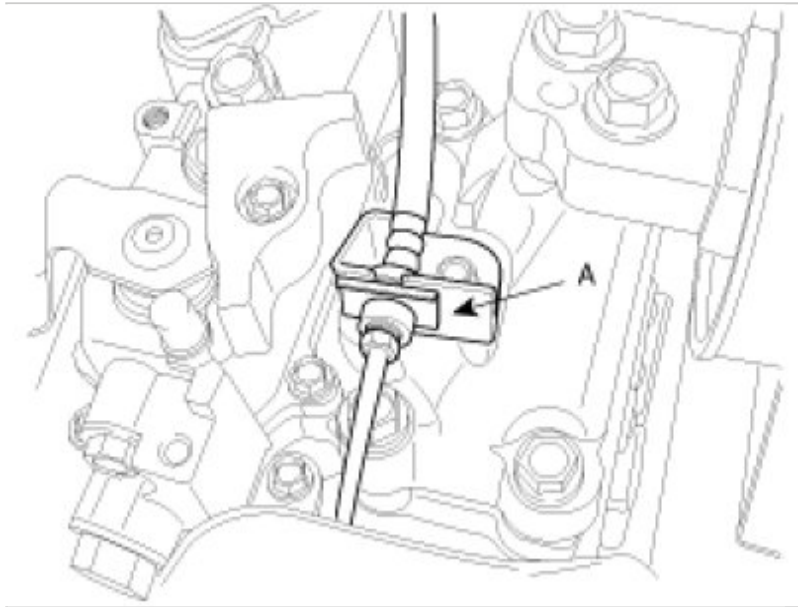

(2) Remove the two bolts (A) of the bracket holding the flexible hose.

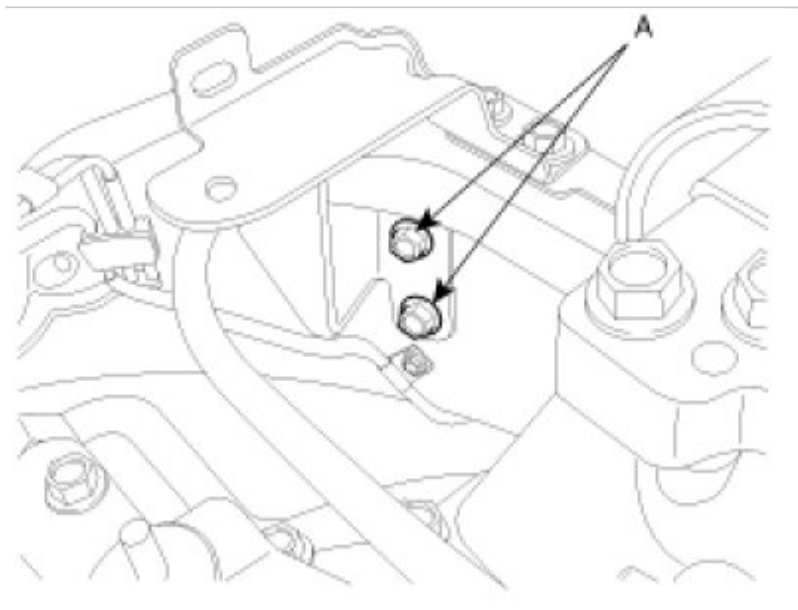

(3) Remove the clutch release cylinder (A).

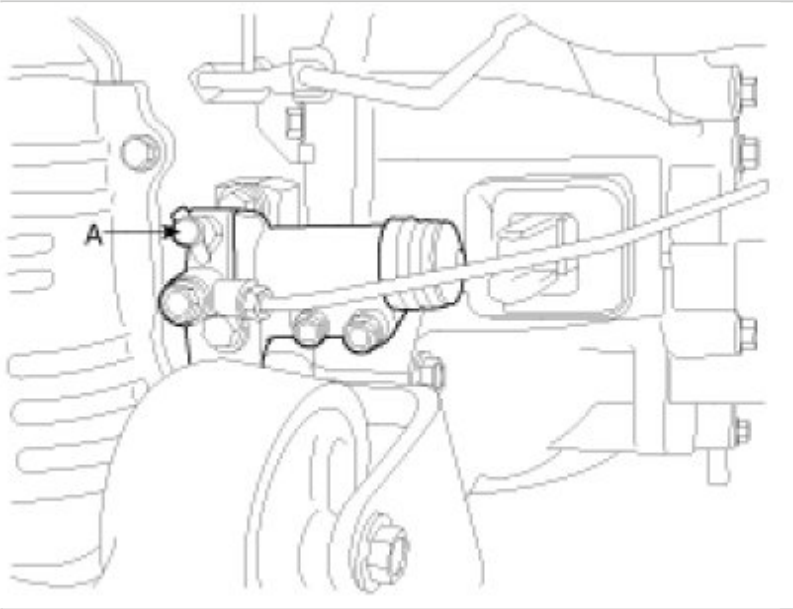

(4) Remove the transaxle control cable (A).

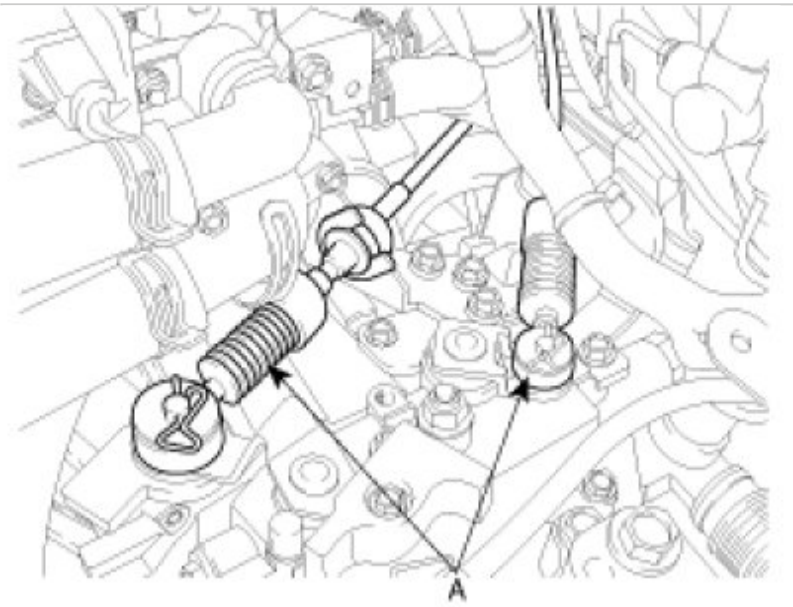

(5) Disconnect the vehicle speed sensor (A).

(6) Disconnect the back lamp switch connector (B).

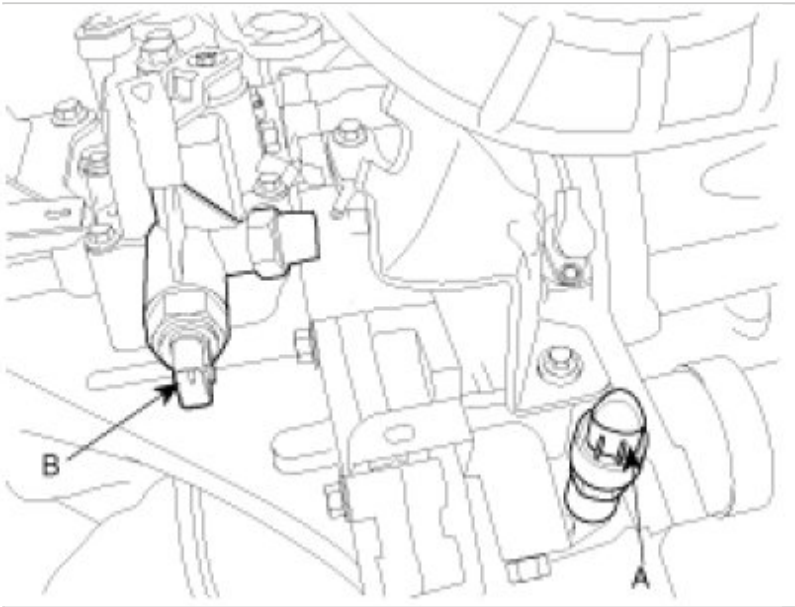

6. Remove the under cover (A).

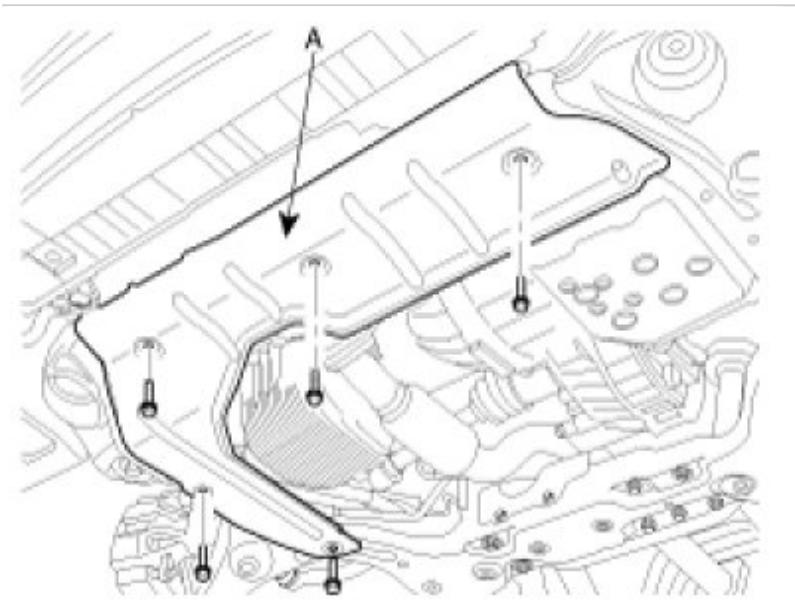

7. Remove the two side cover nut (A).

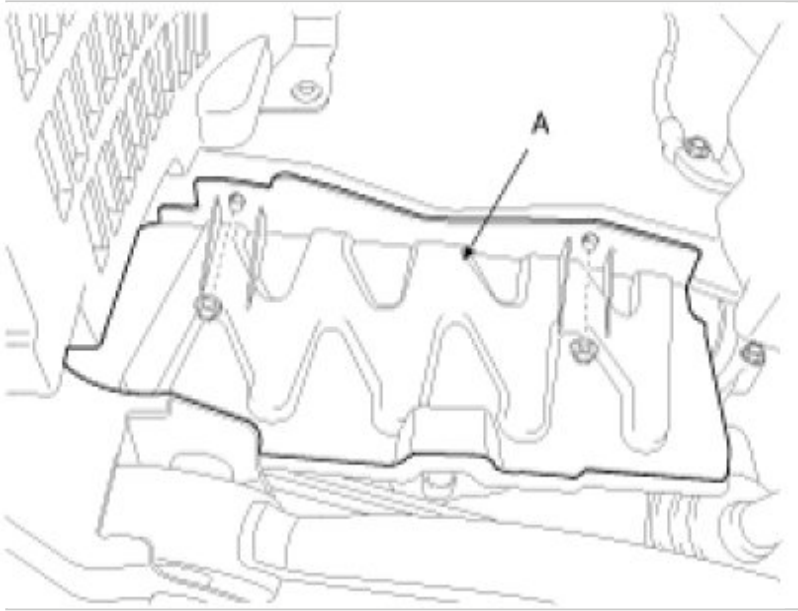

8. Disconnect the power steering return hose (A) to drain power steering oil.

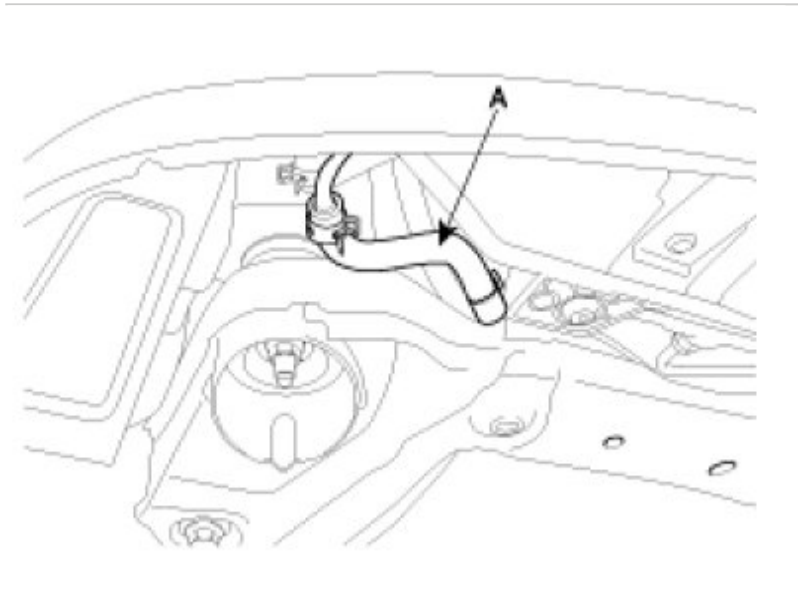

9. Remove the bolt connecting the universal joint and the pinion shaft
10. Remove the transaxle upper mounting bolts from the engine.
11. Remove the transaxle mounting support bracket (A).

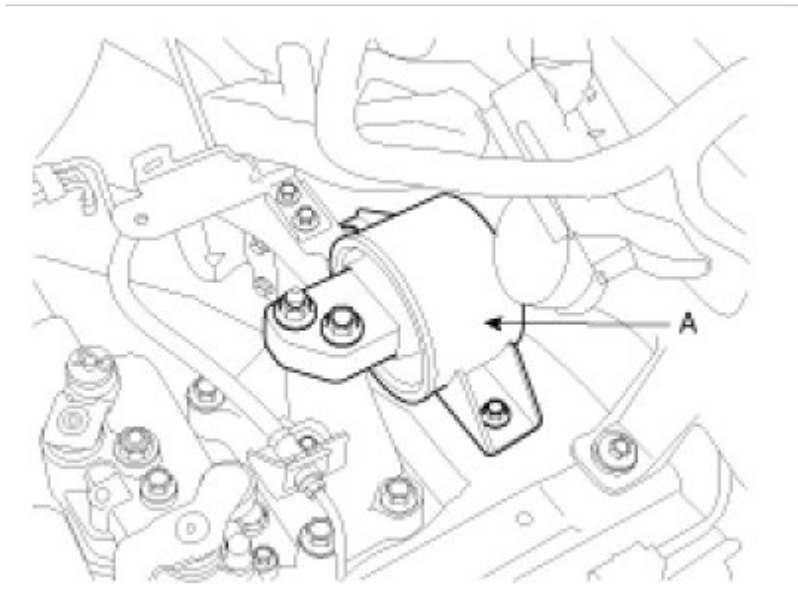

12. Using the SST(09200-38001), hold the engine and transaxle assembly safely.

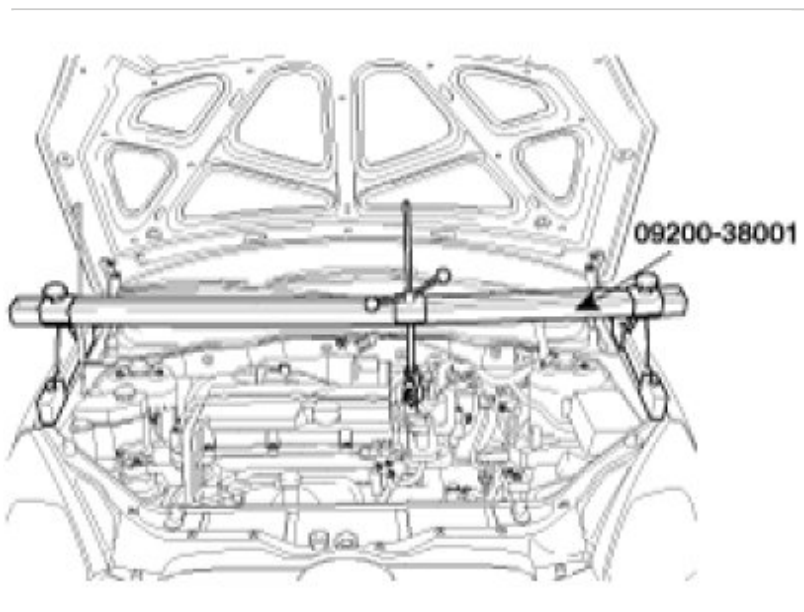

13. Disconnect the lower arm assembly from the knuckle. (see DS group)
14. Disconnect the tie rod end ball joint from the knuckle after removing the split pin. (see DS group)
15. Disconnect the stabilizer bar link. (see SS group)
16. Remove the front roll stopper mounting bolt. (see ST group)
17. Remove the rear roll stopper mounting bolt. (see ST group)
18. Remove the exhaust pipe mounting rubber (A) from the sub frame.

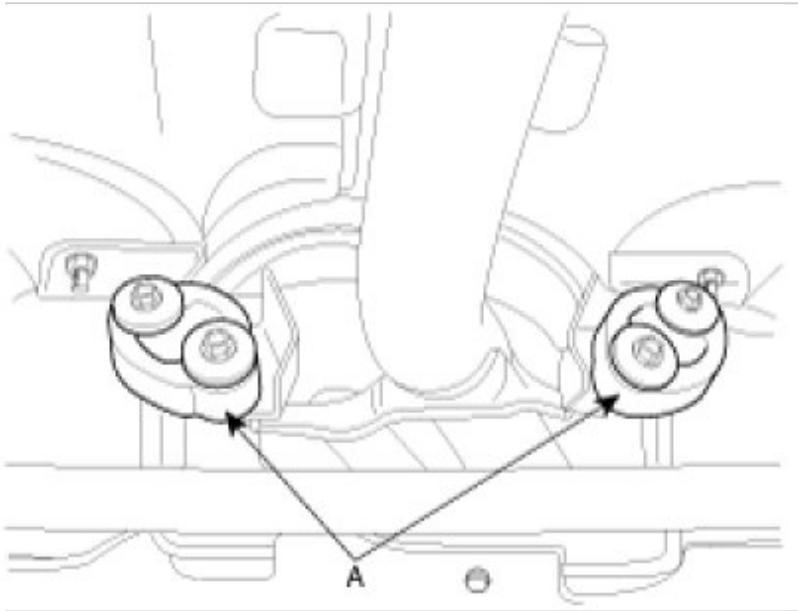

19. Remove the sub frame. (see ST group)

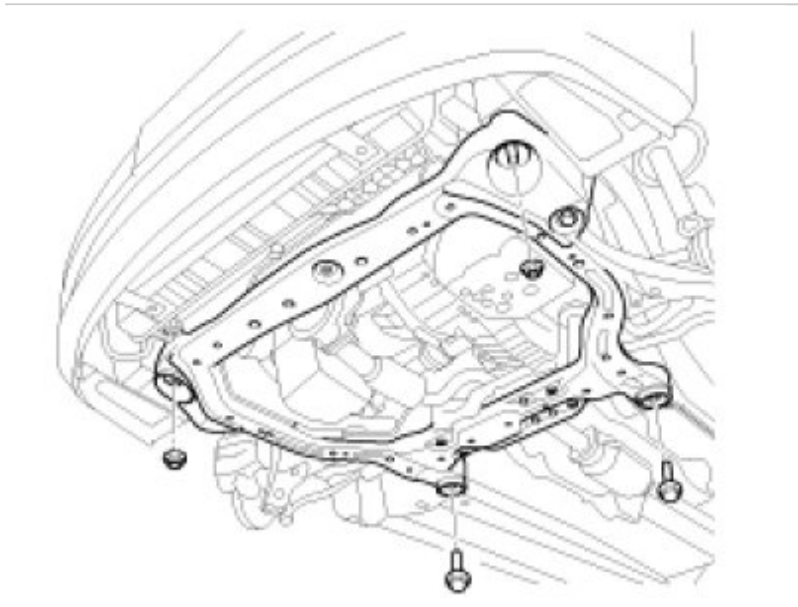

20. Remove drive shaft from transaxle.

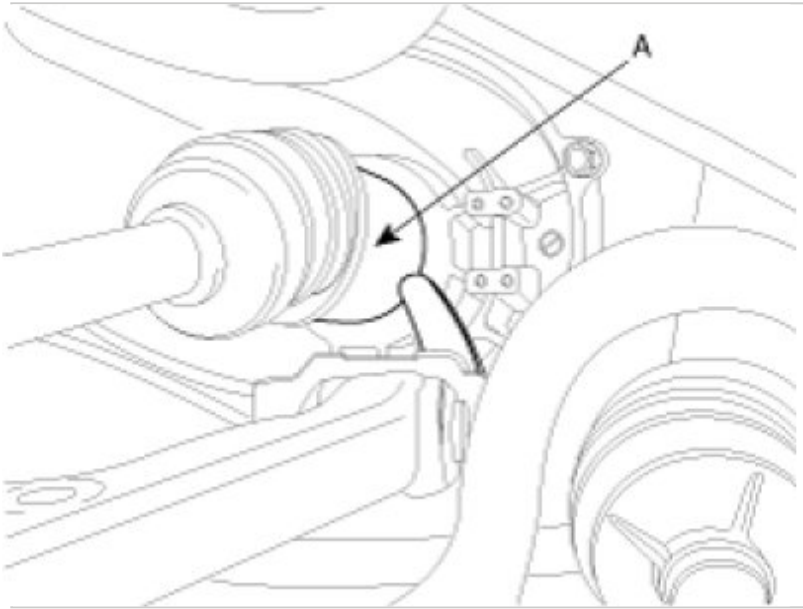

21. Remove the two cable bracket bolts (A).

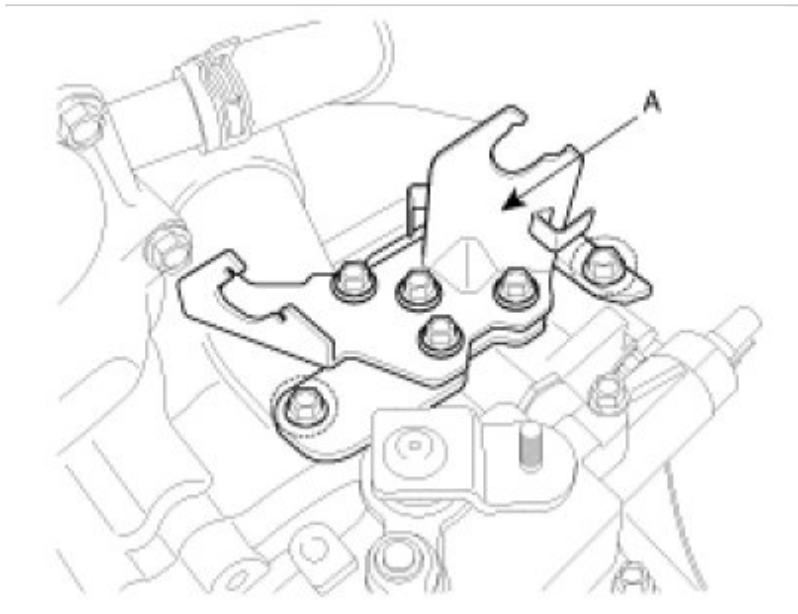

22. Remove the engine start motor mounting bolts (A).

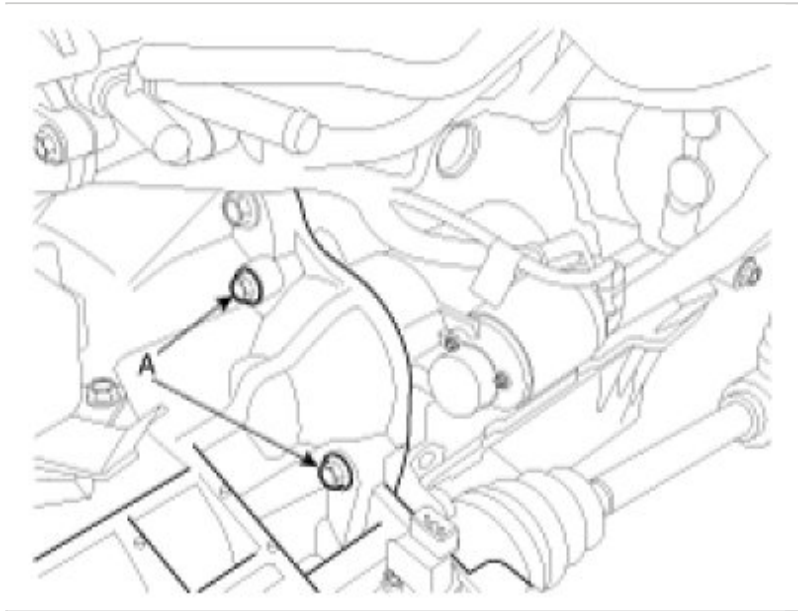

23. Remove the transaxle lower mounting bolts(A).

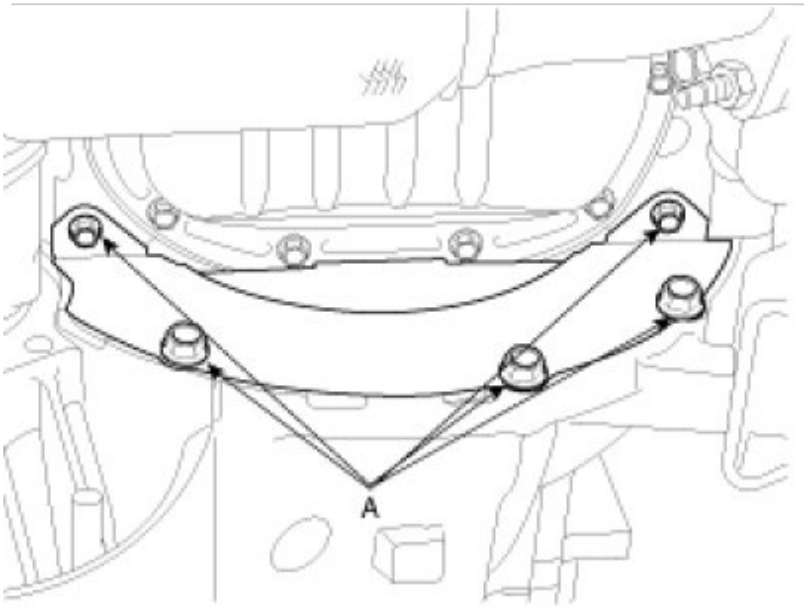

24. Remove the transaxle assembly by lifting the vehicle.

CAUTION:

When removing the transaxle assembly, be careful not to damage any surrounding parts or body components.

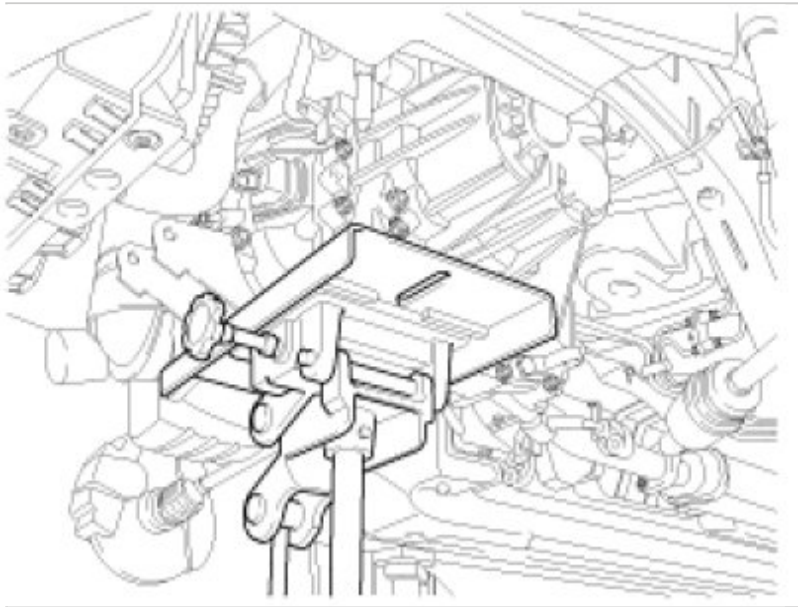

Installation

Installation is in the reverse order of removal.

Perform the following :

- Adjust the shift cable.
- Refill the transaxle with fluid.
- Refill the radiator with engine coolant.
- Bleed air from the cooling system with the heater valve open.
- Clean the battery posts and cable terminals with sandpaper, assemble them, and apply grease to prevent corrosion.

1. Lowering the vehicle or lifting up a jack, install the transaxle assembly.

CAUTION:

When installing the transaxle assembly, be careful not to damage any surrounding parts or body components.

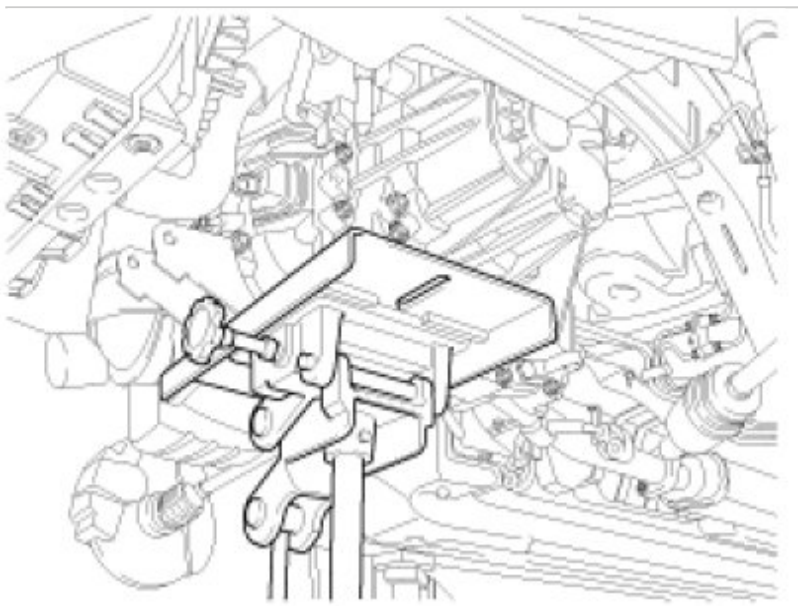

2. Install the transaxle lower mounting bolts(A).

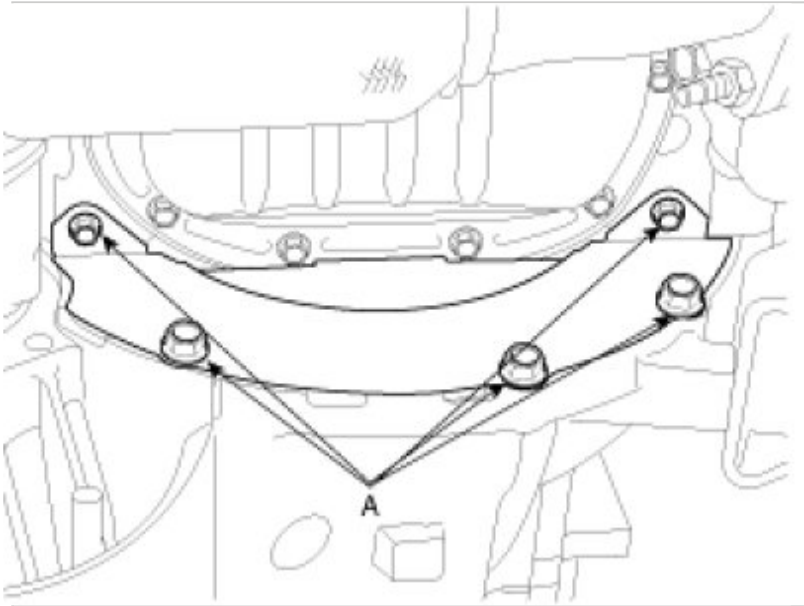

3. Install drive shaft to transaxle.

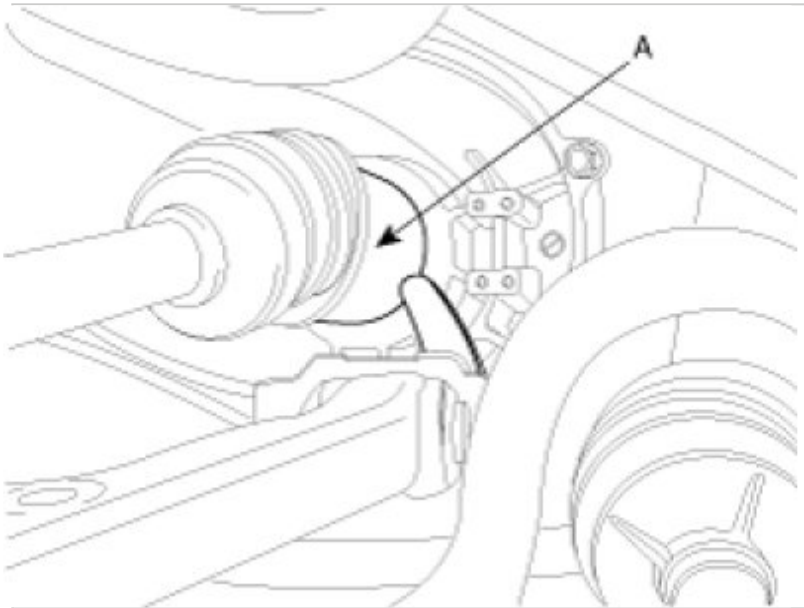

4. Install the sub frame. (see ST-group)

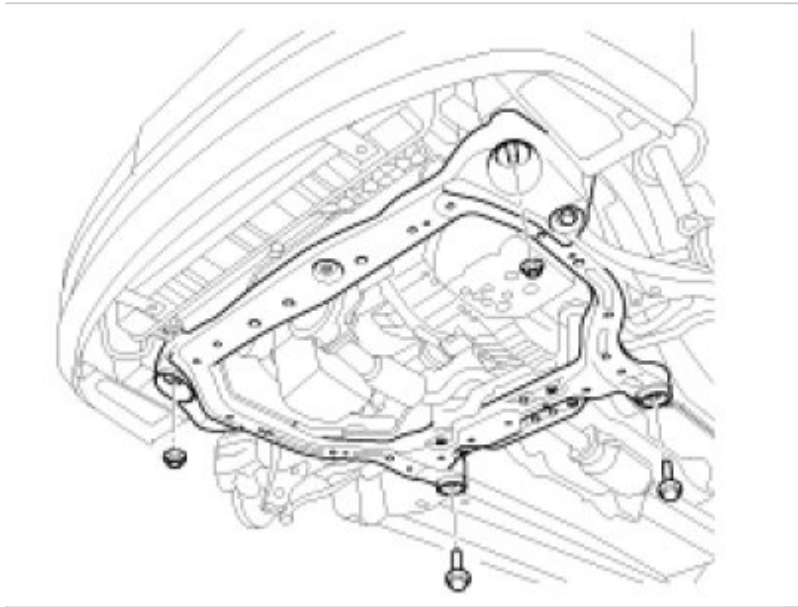

5. Install the exhaust pipe mounting rubber (A) to the sub frame.

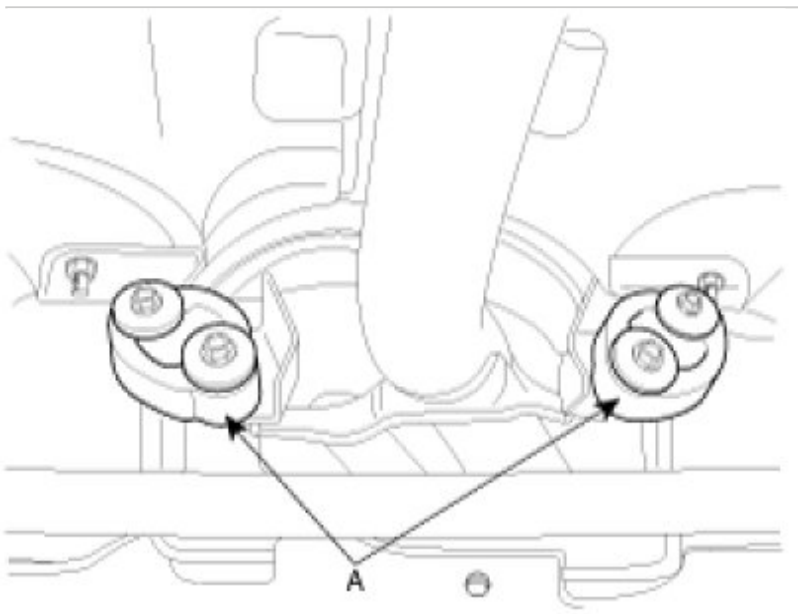

6. Connect the power steering return hose (A).

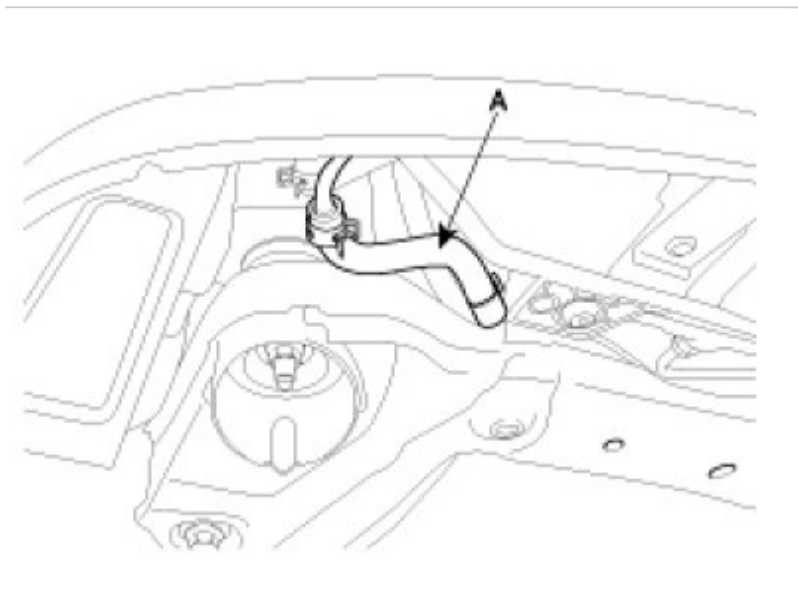

7. Install the rear roll stopper mounting bolt. (see ST-group)
8. Install the front roll stopper mounting bolt. (see ST-group)
9. Connect the stabilizer bar link. (see SS-group)
10. Connect the tie rod end ball joint from the knuckle after removing the split pin. (see DS-group)
11. Connect the lower arm assembly from the knuckle. (see DS-group)
12. Install the bolt connecting the universal joint and the pinion shaft.
13. Install the under cover (A).

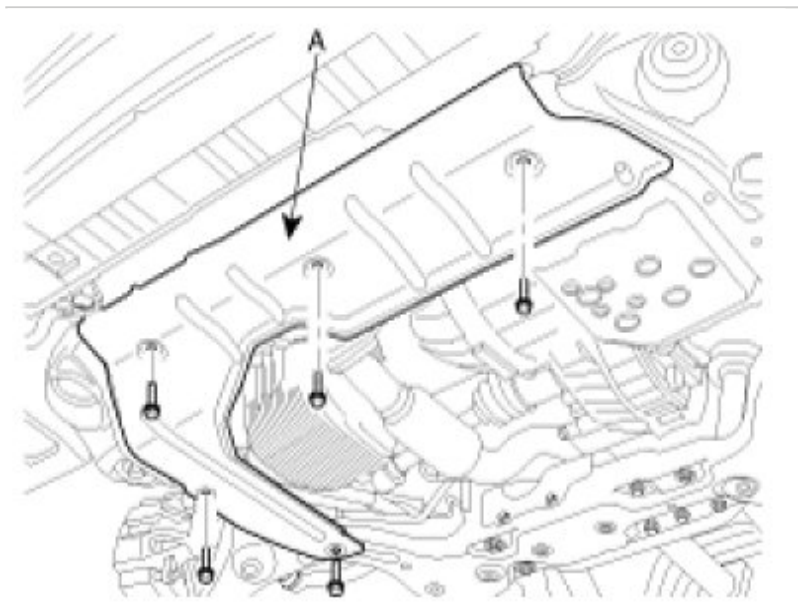

14. Install the two side cover nut (A).

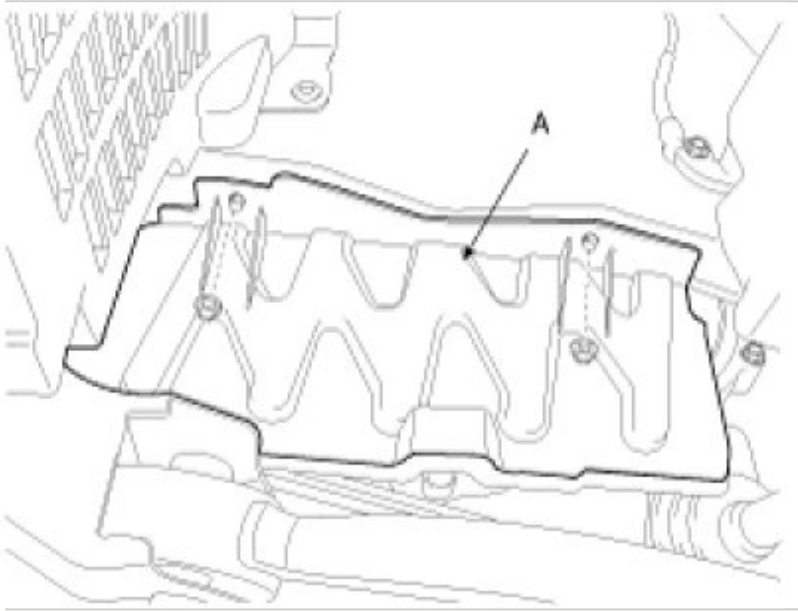

15. Install the transaxle upper mounting bolts from the engine.
16. Install the transaxle mounting support bracket (A).

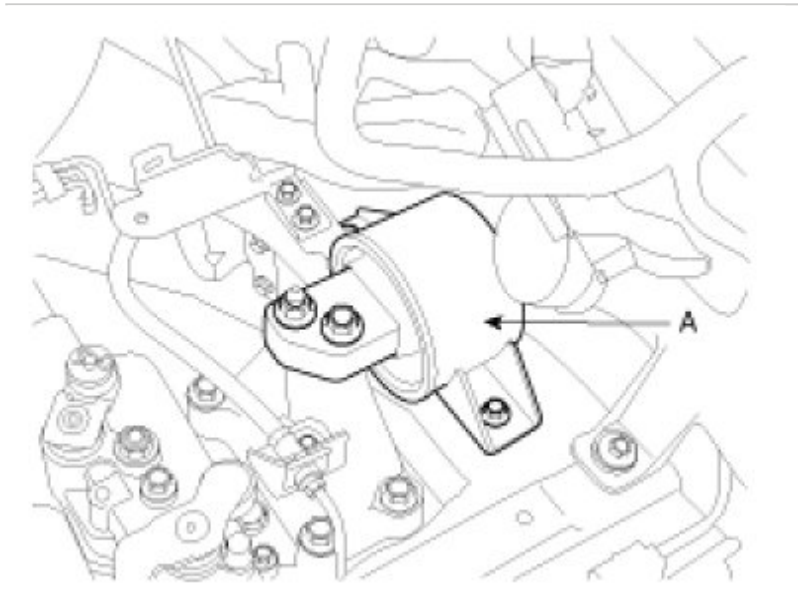

17. Remove the SST(09200-38001).

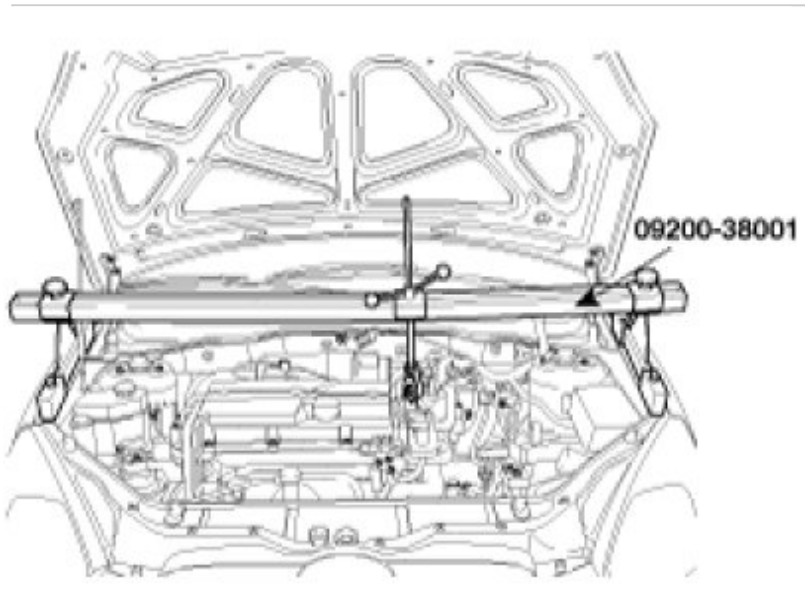

18. Install the engine start motor mounting bolts (A).

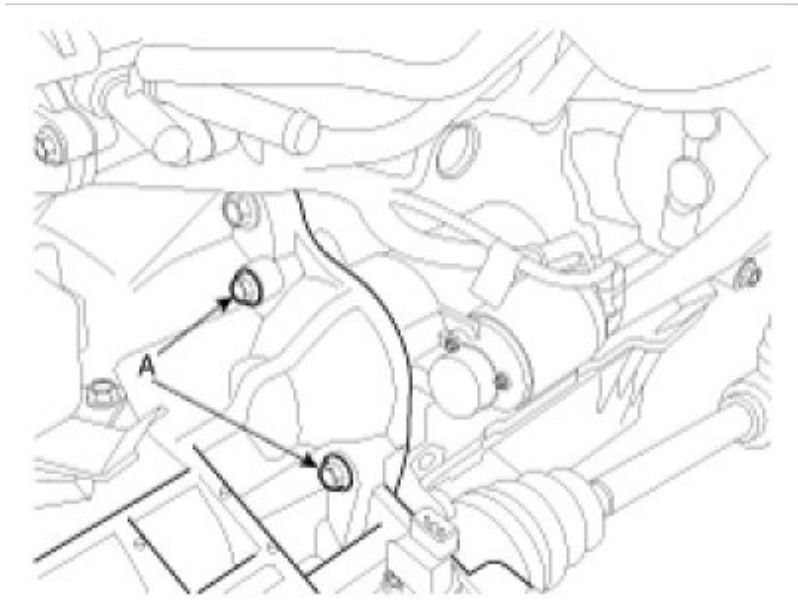

19. Install the two cable bracket bolts (A).

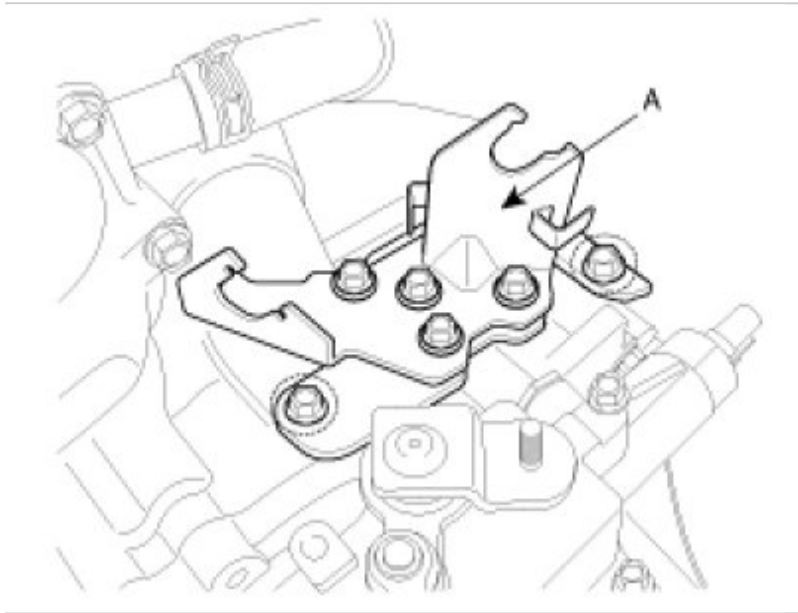

20. Install the transaxle wire harness connectors and control cable to transaxle.

(1) Connect the back lamp switch connector (B).

(2) Connect the vehicle speed sensor (A).

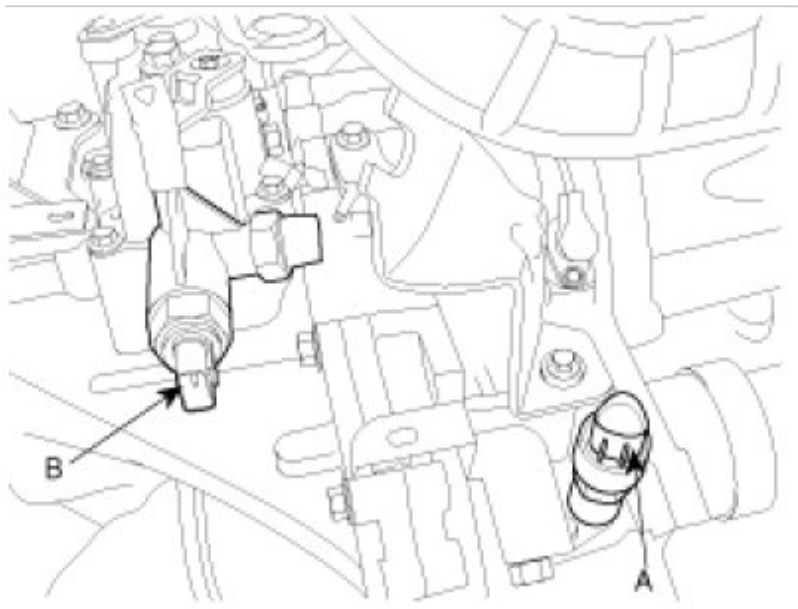

(3) Install the transaxle control cable (A).

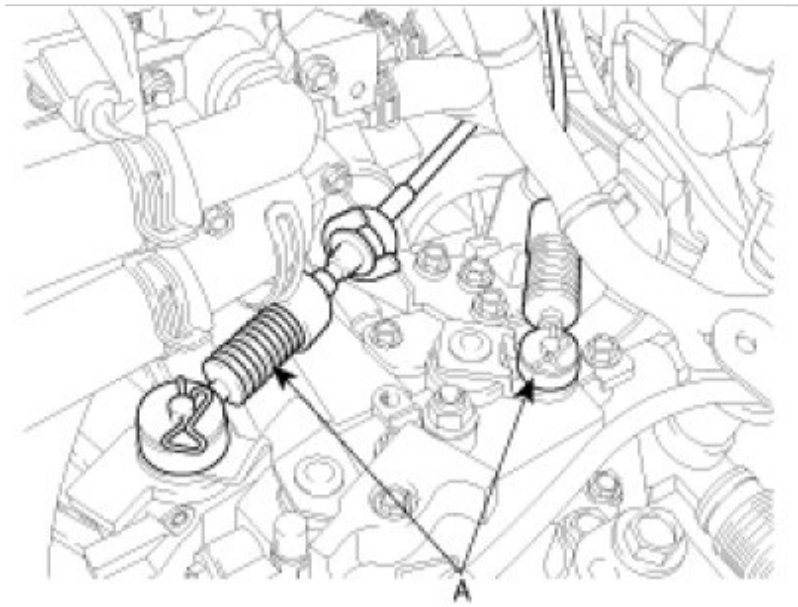

(4) Install the clutch release cylinder (A).

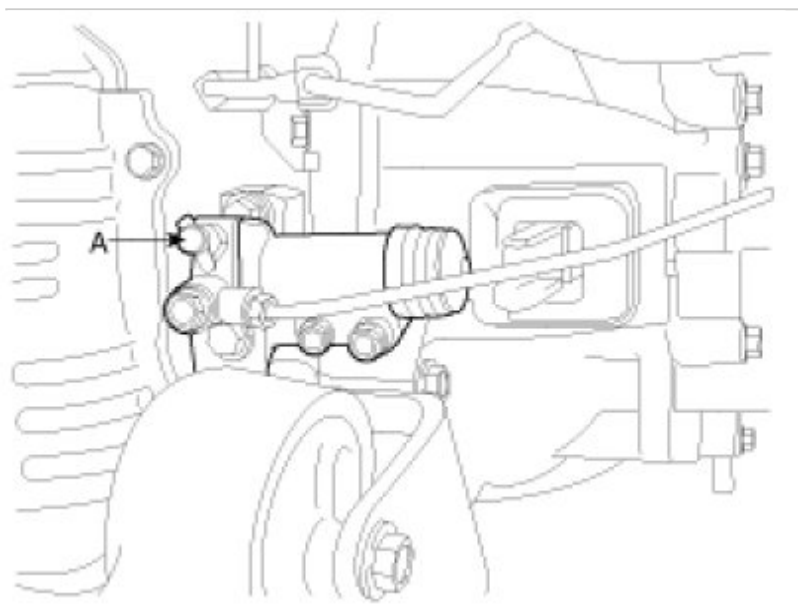

(5) Install the two bolts (A) of the bracket holding the flexible hose.

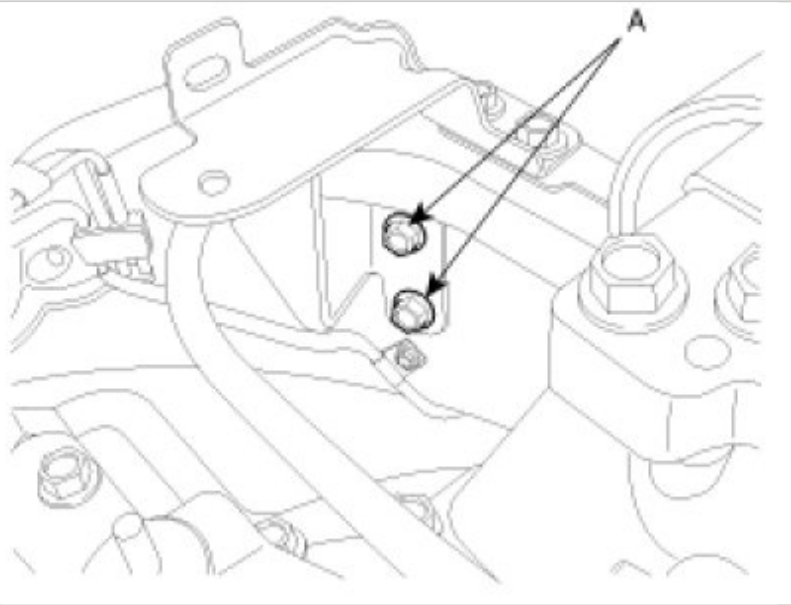

(6) Install the tube bracket (A) from the transaxle.

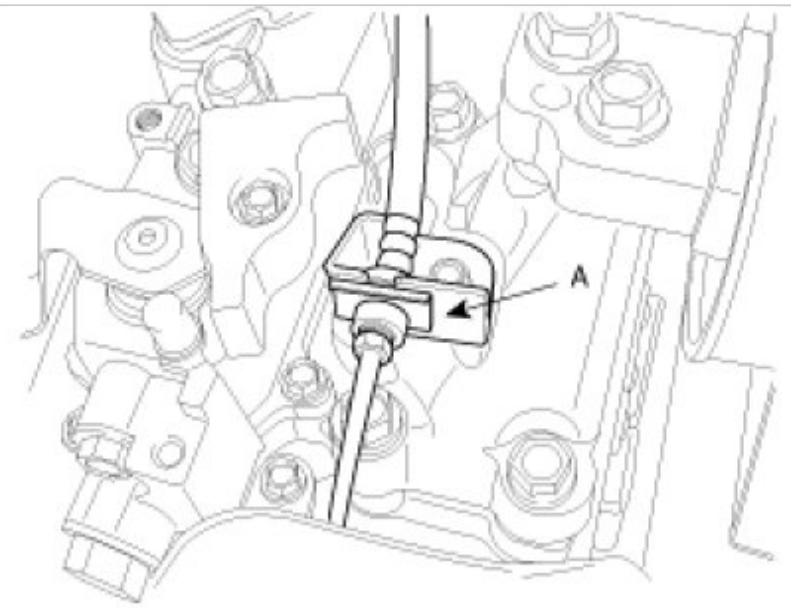

21. Install the ground cable to transaxle (A).

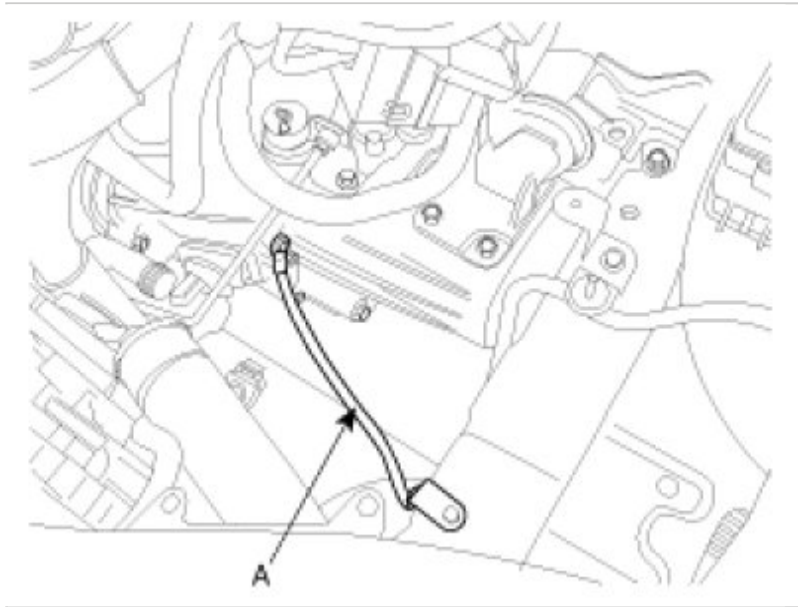

22. Install the battery tray(A).

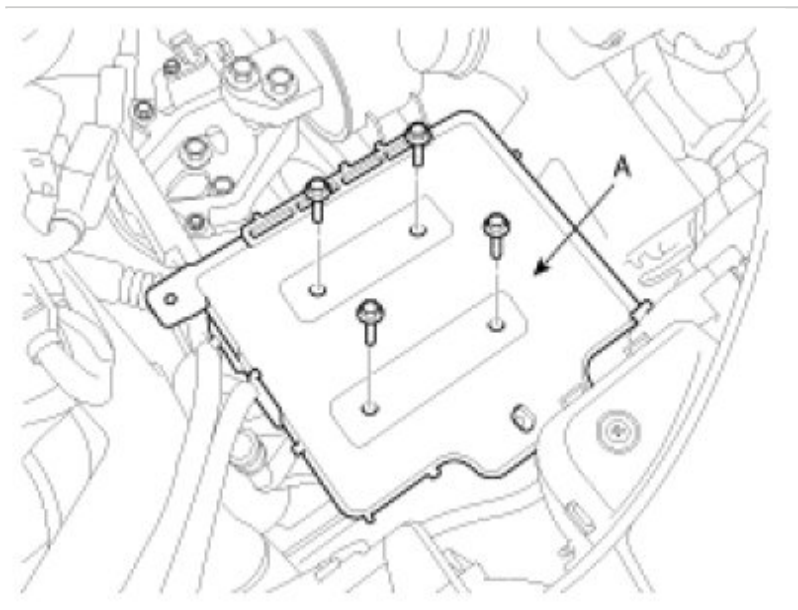

23. Install the intake air hose and air cleaner assembly.

- (1) Install the air cleaner element and lower cover (C).
- (2) Connect the ECM connector (A, B).
- (3) Install the intake air hose and air cleaner upper cover (C).

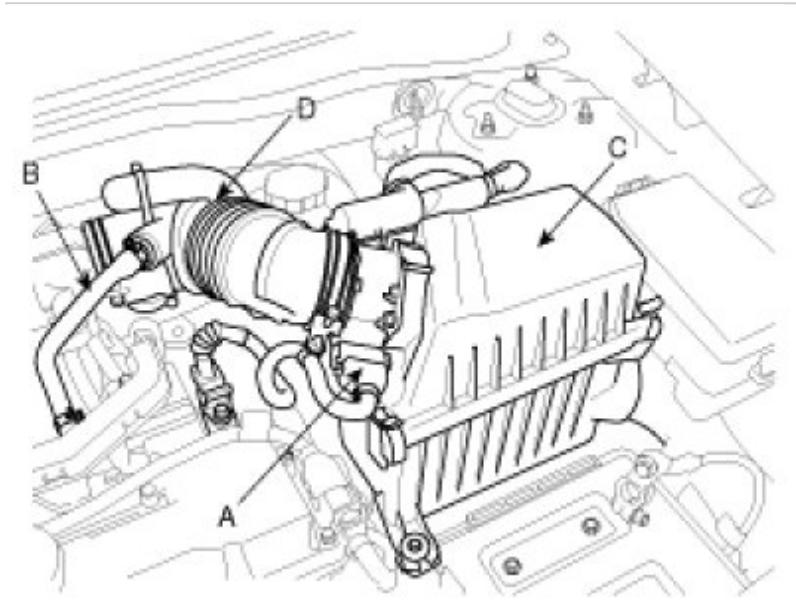

(4) Connect the air cleaner hose (D) from the bleeder hose (B).

(5) Connect the air flow sensor connector (A).

24. Install the battery (A) after installing the battery terminal.

