



Peerless® Series 211A™

All repair parts orders - no minimum charges.

Please order with code number.

All prices quoted are in U.S. dollars.

All prices subject to change without notice.

All prices F.O.B. Bally, PA

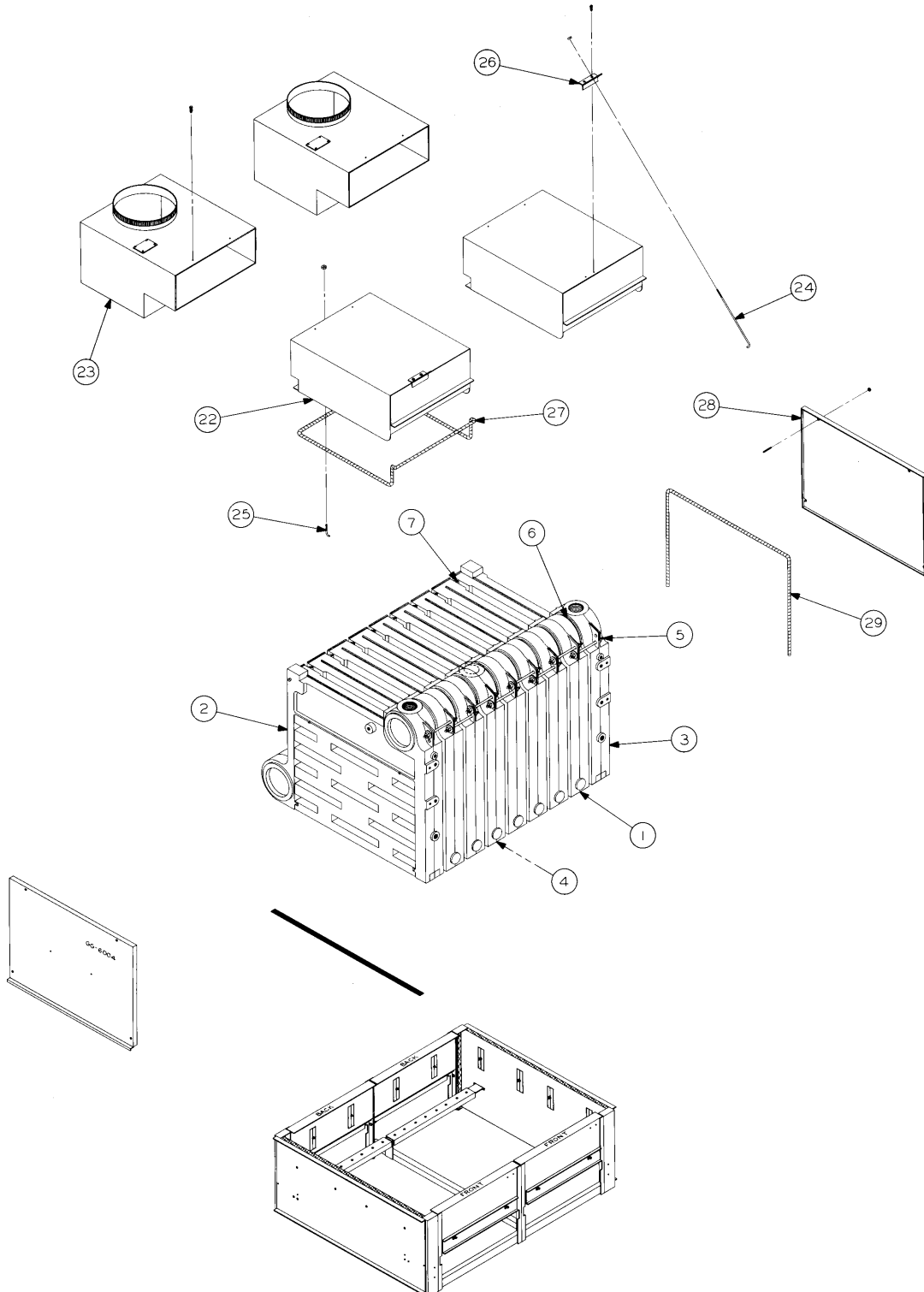



Peerless® Series 211A™

All repair parts orders - no minimum charges.

Please order with code number.

All prices quoted are in U.S. dollars.

All prices subject to change without notice.

All prices F.O.B. Bally, PA

	Description	Quantity Required	Stock Code	Trade Price
1	50# Right Hand End Section – GG1024	1	90059	\$2,823
2	50# Left Hand End Section – GG1023	1	90625	\$2,964
3	50# Plain Intermediate Section – GG1000	–	90356	\$2,107
4	50# Tapped Intermediate Section (Top Tappings) – GG1025	–	90065	\$2,288
–	50# Plain Intermediate Section w/ Insp. Tapping (Bottom Tappings) – GG1000-2	–	90358	\$2,402
–	80# Right Hand End Section – GG1024-1	–	90060	\$3,056
–	80# Left Hand End Section – GG1023-1	–	90626	\$3,196
–	80# Plain Intermediate Section – GG1000-1	–	90357	\$2,112
–	80# Tapped Intermediate Section – GG1025-1	–	90066	\$2,520
–	80# Plain Intermediate Section w/ Insp. Tapping – GG1000-3	–	90359	\$2,402
5	Tie Rod, 2 per Joint	2	90090	\$37
6	Flow Port Gasket, 2 per Section	2	51670	\$20
7	Hi Temp Rope for Sections, 5/8" (16 mm) ** Price per foot **	7.ft	55723	\$6
N/S	Section Assy Kit, 8 Seals, Rope Hardware Pyrodeal (4/5 Section)	–	GG1030	\$476
N/S	Section Assy Kit, 10 Seals, Rope Hardware Pyrodeal (6 Section)	–	GG1030-1	\$552
N/S	Section Assy Kit, 12 Seals, Rope Hardware Pyrodeal (7 Section)	–	GG1030-2	\$657
N/S	Section Assy Kit, 14 Seals, Rope Hardware Pyrodeal (8 Section)	–	GG1030-3	\$762
8	Base Right End Panel w/ Insulation	1	90737	\$759
	Base Left End Panel w/ Insulation	1	90738	\$759
8a	Knitted Tape 1 X 1/16 X 7ft.	1	99	\$4
9	Base Front Panel Sub-Assembly w/ Insulation – 16-7/8" (429 mm) Wide 211A-04	1	90932	\$180
	Base Front Panel Sub-Assembly w/ Insulation – 22-1/2" (571 mm) Wide 211A-05	1	91800	\$249
	Base Front Panel Sub-Assembly w/ Insulation – 28-1/8" (714 mm) Wide 211A-06	1	91801	\$267
	Base Front Panel Sub-Assembly w/ Insulation – 33-3/4" (857 mm) Wide 211A-07	1	91802	\$336
	Base Front Panel Sub-Assembly w/ Insulation – 39-3/8" (1 m) Wide 211A-08	1	91803	\$398
10	Base Back Panel Sub-Assembly w/ Insulation – 16-7/8" (429 mm) Wide 211A-04	1	90934	\$162
	Base Back Panel Sub-Assembly w/ Insulation – 22-1/2" (571 mm) Wide 211A-05	1	91804	\$249
	Base Back Panel Sub-Assembly w/ Insulation – 28-1/8" (714 mm) Wide 211A-06	1	91805	\$295
	Base Back Panel Sub-Assembly w/ Insulation – 33-3/4" (857 mm) Wide 211A-07	1	91806	\$342
	Base Back Panel Sub-Assembly w/ Insulation – 39-3/8" (1 m) Wide 211A-08	1	91807	\$398
11	Base Front or Back Panel Insulation – For 16-7/8" (429 mm) Wide Panel 211A-04	1	50848	\$39
	Base Front or Back Panel Insulation – For 22-1/2" (571 mm) Wide Panel 211A-05	1	50849	\$40
	Base Front or Back Panel Insulation – For 28-1/8" (714 mm) Wide Panel 211A-06	1	50850	\$45
	Base Front or Back Panel Insulation – For 33-3/4" (857 mm) Wide Panel 211A-07	1	50851	\$51
	Base Front or Back Panel Insulation – For 39-3/8" (1 m) Wide Panel 211A-08	1	50852	\$61
12	Base Left/Right End Panel Insulation	2	50853	\$86
13	Insulation Fastener, 1-1/2" x 5" 16 Gauge, (12 per base)	1	GG2104	\$8
13a	Bolt 10-24x1-1/2" RD, SS, (12 per base), Local Hdwr Supply	–	–	–
13b	Nut, 10-24x SS, (12 per base), Local Hdwr Supply	–	–	–
14	Burner Support Channel Clip	2	90590	\$15
15	Burner Support Channel – For 16-7/8" (429 mm) Wide Base Panel 211A-04	1	90585	\$43
	Burner Support Channel – For 22-1/2" (571 mm) Wide Base Panel 211A-05	1	90586	\$63
	Burner Support Channel – For 28-1/8" (714 mm) Wide Base Panel 211A-06	1	90587	\$59
	Burner Support Channel – For 33-3/4" (857 mm) Wide Base Panel 211A-07	1	90588	\$71
	Burner Support Channel – For 39-3/8" (1 m) Wide Base Panel 211A-08	1	90589	\$98
16	Angle Tie Brace (Angle Tie Brace Assembly)	1	90326	\$131

Peerless® Series 211A™

All repair parts orders - no minimum charges.

Please order with code number.

All prices quoted are in U.S. dollars.

All prices subject to change without notice.

All prices F.O.B. Bally, PA

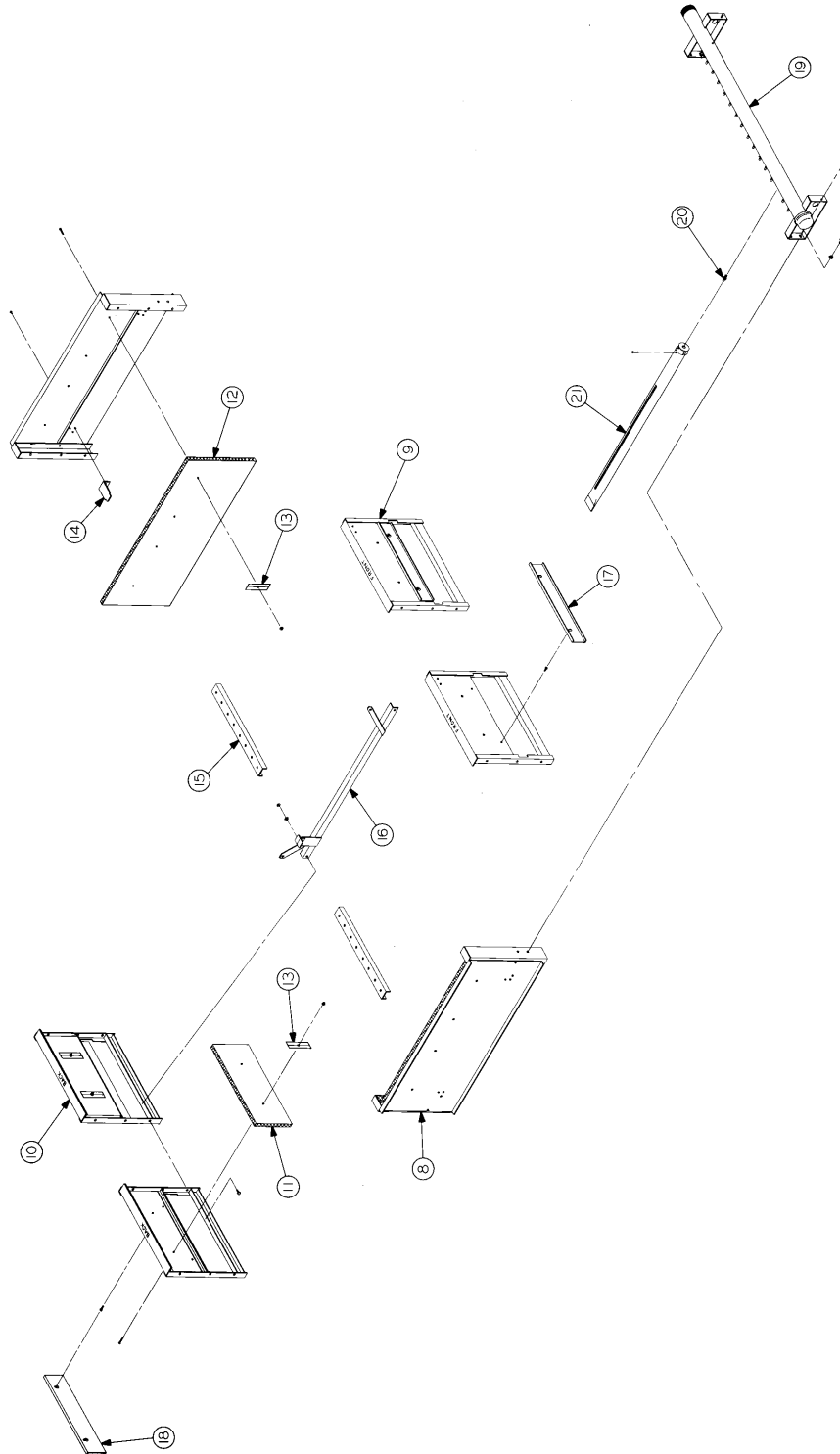



Peerless® Series 211A™

All repair parts orders - no minimum charges.

Please order with code number.

All prices quoted are in U.S. dollars.

All prices subject to change without notice.

All prices F.O.B. Bally, PA

	Description	Quantity Required	Stock Code	Trade Price
17	Base Front Panel Cover Plate – 14-3/4" (375 mm) Wide Base Panel 211A-04	1	90316	\$14
	Base Front Panel Cover Plate – 20-3/8" (518 mm) Wide Base Panel 211A-05	1	90318	\$34
	Base Front Panel Cover Plate – 26" (660 mm) Wide Base Panel 211A-06	1	90320	\$35
	Base Front Panel Cover Plate – 31-5/8" (803 mm) Wide Base Panel 211A-07	1	90322	\$40
	Base Front Panel Cover Plate – 37-1/4" (946 mm) Wide Base Panel 211A-08	1	90324	\$43
18	Base Back Panel Cover Plate – 14-3/4" (375 mm) Wide Base Panel 211A-04	1	90317	\$21
	Base Back Panel Cover Plate – 20-3/8" (518 mm) Wide Base Panel 211A-05	1	90319	\$37
	Base Back Panel Cover Plate – 26" (660 mm) Wide Base Panel 211A-06	1	90321	\$43
	Base Back Panel Cover Plate – 31 -5/8" (803 mm) Wide Base Panel 211A-07	1	90323	\$46
	Base Back Panel Cover Plate – 37-1/4" (946 mm) Wide Base Panel 211A-08	1	90325	\$59
21	Steel Burner (specify qty. required, see manual)	–	51045	\$55
	Steel Burner w/ Pilot Mounting Clip (specify, see manual)	–	51046	\$68
–	Burner Support Clip GG2070	1	90590	\$15
22	Flue Collector – 16" (406 mm) Wide, Box-14A	1	90557	\$286
	Flue Collector – 21-9/16" (548 mm) Wide, Box-14B	1	90558	\$305
	Flue Collector – 27-1/8" (689 mm) Wide, Box-14C	1	90559	\$350
23	Draft Hood – For GG-5000 w/ 12" (305 mm) Dia. Outlet	1	90399	\$273
	Draft Hood – For GG-5000-1 w/ 12" (305 mm) Dia. Outlet	1	90400	\$298
	Draft Hood – For GG-5000-1 w/ 14" (356 mm) Dia. Outlet	1	90401	\$313
	Draft Hood – For GG-5000-2 w/ 14" (356 mm) Dia. Outlet	1	90402	\$345
24	Front Flue Collector Hook Bolt, Per Collector	1	GG5003	\$12
25	Black Flue Collector Hook Bolt, Per Collector	1	GG5004	\$12
26	Flue Collector Mounting Bracket, Per Collector ** Price per foot **	2.ft	GG5005	\$12
27	Hi Temp Rope for Flue Collector, 5/8" (16 mm) ** Price per foot **	2 ft	55723	\$6
28	Cleanout Cover Plate Sub-Assembly – Set of 2	2.ft	90489	\$1,167
29	Hi Temp Rope for Cleanout Cover Plate, 5/8" (2 ft per Cleanout]	1	55723	\$6
–	Common End Panel and Cleanout Cover Plate Assembly – Carton No. 12	1	90282	\$1,586
–	Intermediate Panel Jacket Assembly – Carton No. 12A	1	90283	\$642
–	Intermediate Panel Jacket Assembly – Carton No. 12B	1	90284	\$689
–	Intermediate Panel Jacket Assembly – Carton No. 12C	1	90285	\$783
–	Intermediate Panel Jacket Assembly – Carton No. 12D	1	90286	\$839
–	Intermediate Panel Jacket Assembly – Carton No. 12E	1	90287	\$1,001
–	Steam Gauge (steam boilers only)	1	51769	\$48
–	Gauge Glass Set (steam boilers only)	1	50513	\$93
–	Hi Temp Sealing Cement	1	55726	\$41
–	Rope Seal Adhesive, Sta-Put Spray	–	55485	\$63
–	Orifice Spud (specify gas and altitude) – X4026	–	51729	\$12
–	CTN 211A Clean Out Cover Plate w/ Hardware	–	90489	\$1,167

Peerless® Series 211A™

All repair parts orders - no minimum charges.

Please order with code number.

All prices quoted are in U.S. dollars.

All prices subject to change without notice.

All prices F.O.B. Bally, PA

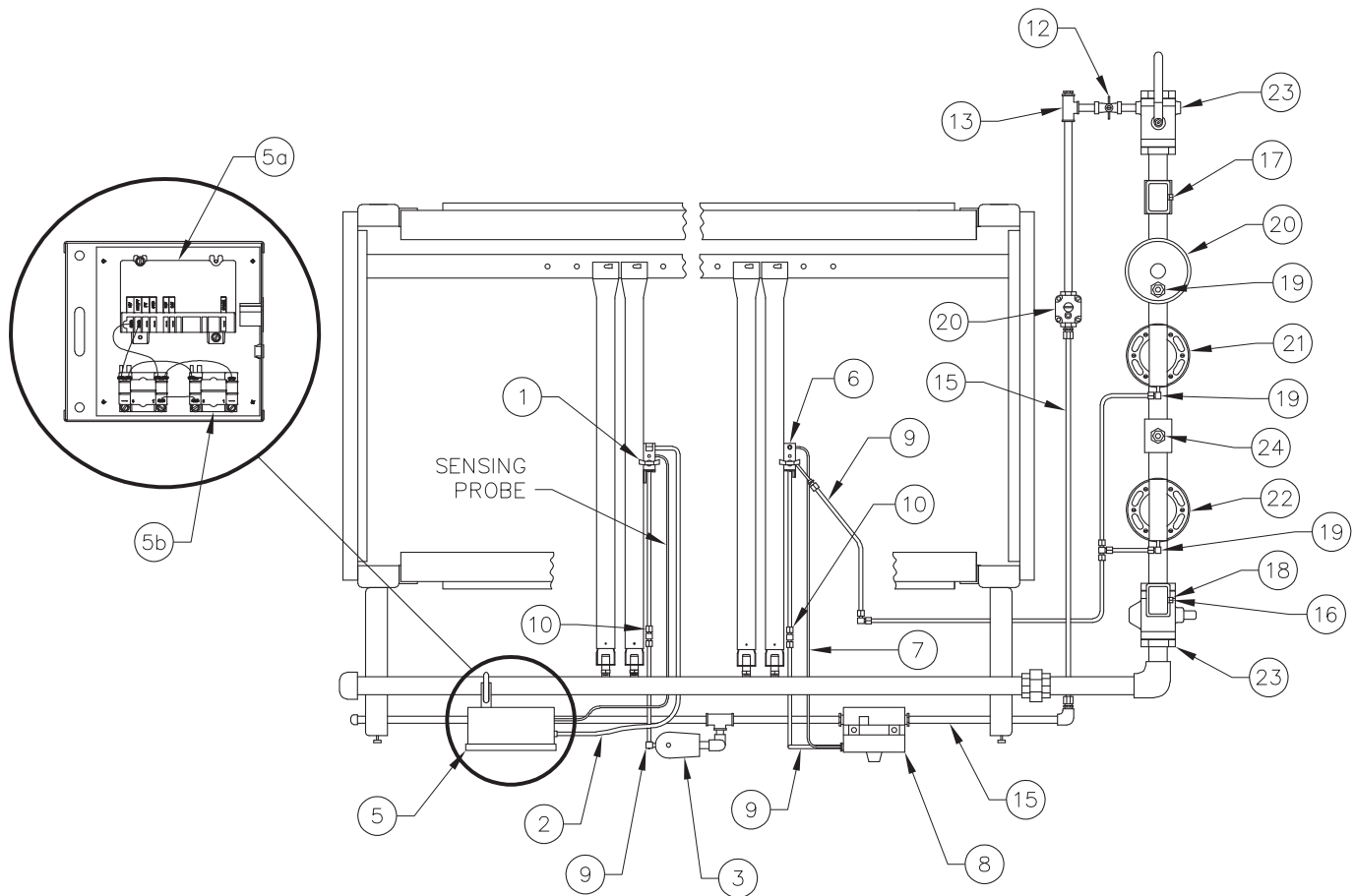



Peerless® Series 211A™

All repair parts orders - no minimum charges.
Please order with code number.
All prices quoted are in U.S. dollars.
All prices subject to change without notice.
All prices F.O.B. Bally, PA

	Description	Quantity Required	Stock Code	Trade Price
Spark(E/E) Ignition System				
N/S	RM7890A Sprk (obsolete 2008)	1	50658	–
N/S	RM7890A-1056 (requires a jumper wire / terminals 3 & 20, & 6 & 7)	1	50665	\$683
N/S	Ignition Transformer (E-E system)	1	51299	\$242
1b	KIT Sprk NAT W/WIRE ASSY OBS 2020	1	90462	\$384
1b	KIT Sprk NAT Pilot Assy Q179 Nat.	1	51036	CF
1b	KIT Sprk NAT Pilot Assy Q179 LP	1	51037	CF
3b	120V Pilot Gas Valve Baso H91BA-3 1/4"	1	50753	\$119
Standing E-M Ignition System				
N/S	RM7890C Stdg (obsolete 2013)	1	50659	\$715
1a	KIT Stdg NAT w/ Wire & Thermocouple Assy (obsolete 2013)	1	90463	\$270
N/S	Orifice LP for Stdg Pilot †	1	50635	\$40
3	Thermo-Pilot Gas Valve Baso H17CA-1 3/8	1	50752	\$288
8	3/8" Standing Aux. Pilot Valve Nat & LP	1	50752	\$288
6	Standing Aux. Pilot	1	50556	\$22
6	Standing Aux. Pilot , LP STDG .014 AB	1	50557	\$50
7	36" Lead Thermocouple	1	50839	\$39
Spark HSP Ignition System				
5a	Ign Ctrl Hon S8610M3009	1	50672	\$169
1	Pilot - (HSP) Nat. 0.22 AB Orifice	1	50996	\$60
2	*Ignition & Sensing Cable w/32" Green Hi-Temp. Gr. Wire	1	50640	\$34
3	24V Pilot Gas Valve Baso H91BG-2, 1/4	1	50754	\$126
3b	120V Pilot Gas Valve Baso H91BA-3 1/4	1	50753	\$119
5b	*Switching Relay, (for 120V Gas Valves)	1	50566	\$35
	Transformer - 40VA	1	50791	\$54
	Transformer - 100VA	1	51716	\$218
5	Ignition Control Mtg. Box	1	X3009	\$158
6	Standing Aux. Pilot	1	50556	\$22
7	Standing Aux. Pilot Thermocouple	1	50839	\$39
8	Thermo-Pilot Gas Valve Baso H17CA-1 3/8 for Aux Pilot	1	50752	\$288
9	1/4" Pilot Tubing, alum. ** Price per foot **	1	718	\$5
10	1/4" Union Compression, Brass ** Price per foot **	1	769	\$6
N/S	Bleed Clip	1	50636	\$6
Misc gas train				
12	1/4" Gas Pilot Shut Off valve	1	50559	\$22
13	Adapter 3/8" x 1/4"	1	53	\$6
14	Bleed restrictor, (Main valve bleed)	1	50631	\$20
15	3/8" Pilot Tubing, alum. ** Price per foot **	1	719	\$13
16	1/8" Leak test cock Kit w/ plug, fittings assembly	1	90957	\$61

	Description	Quantity Required	Stock Code	Trade Price
Gas switches				
17	Low Gas Pressure Switch, MR	1	50700	\$208
18	High Gas Pressure Switch, MR	1	50656	\$17
19	Vent limit,	1	50656	\$17
Regulators				
20	1/4" Gas Regulator	1	50643	\$39
	3/4" Gas Regulator	1	50644	\$131
	1" Gas Regulator	1	50645	\$196
	1-1/4" Gas Regulator	1	50647	\$355
	1-1/2" Gas Regulator	1	50646	\$355
	2" Gas Regulator	1	50648	\$710
	2-1/2" Gas Regulator	1	50642	\$1,432
	3" Gas Regulator	1	50641	\$585
120 Volt Diaphragm Valves				
21-22	1" NPT. 120 Volt Diaphragm Valves	1	50598	\$602
	1-1/4" NPT. 120 Volt Diaphragm Valves	1	50599	\$575
	1-1/2" NPT. 120 Volt Diaphragm Valves	1	50600	\$655
	2" NPT. 120 Volt Diaphragm Valves	1	50601	\$928
	2-1/2" NPT. 120 Volt Diaphragm Valves.	1	50602	\$1,012
	3" NPT. 120 Volt Diaphragm Valves	1	50603	\$1,588
120 Volt Solenoid Valves				
21-22	1" NPT. 120 Volt Solenoid Valves (obsolete 2007)	1	50741	\$908
	1 1/4" NPT. 120 Volt Solenoid Valves	1	50743	\$897
	1 1/2" NPT. 120 Volt Solenoid Valves (obsolete 2007)	1	50744	\$674
	2" NPT. 120 Volt Solenoid Valves	1	50746	\$1,287
	2 1/2" NPT. 120 Volt Solenoid Valves	1	50747	\$1,833
	3" NPT. 120 Volt Solenoid Valves (obsolete 2007)	1	50745	\$1,017
Shut Off Valves				
23	1/4" F X 1/4" F Pilot Ball Valve	2	50599	\$575
	1", LH SHUT-OFF	2	51703	\$93
	1-1/4", LH SHUT-OFF	2	51704	\$123
	1-1/2", LH SHUT-OFF	2	51705	\$211
	50-GB7-A1 2", LH SHUT-OFF	2	51706	\$294
	50-803-08, 2-1/2", LH SHUT-OFF	2	50524	\$408
	64-100-01, 3", LH SHUT-OFF	2	50568	\$568