

Joy

简体中文用户指南
系列: Joy

欢迎使用本机	03
操作指南	04
产品配件列表	08
让您的Blueair空气净化器 发挥极致功效	09
使用说明	10
滤网	12
滤网寿命换算表	16
欢迎加入Blueair会员俱乐部	17
售后服务指南	19

欢迎使用本机

感谢您选购Blueair空气净化器,在使用前请您花几分钟时间熟悉一些基本的操作。

欢迎加入Blueair会员俱乐部

请您收到空气净化器后尽快通过以下方式获取延保服务，以延长有效的产品保修期。并在日后购买替换滤网时享受折扣优惠。



网上注册

www.blueair.cn

登陆官网，自行按操作步骤注册
以获得相应延保服务。



拨打400全国统一客服热线

400-006-9693

由客服输入唯一机身编码进行注册
得到客服确认即可。



填写保修卡

将保修卡按要求填写完整，
并投指导寄回相应服务地址。



可登陆微信公众号
完成产品注册

服务信息

更可通过官方微信和天猫旗舰店
获取最新服务信息。

环保，Blueair 不遗余力行动中！

Blueair空气净化器在最大限度地改善室内空气质量的同时，对环境的影响降至最低限值。整机都可以回收再利用。

操作指南

安全指南

布鲁雅尔 (Blueair) Joy 说明书适用于 (Blueair) Joy L 机型。布鲁雅尔 (Blueair) Joy 空气净化器是一种电器产品，在您第一次使用它之前，请参阅这些安全说明，提高警惕，从而减少火灾、触电和受伤的危险。请记住保修是限制性的，只适用于根据说明正确使用的情況。

- 为避免触电和火险，请使用我们提供的电源线，将电源线直接插入一个合适的插座插口（请查看电器上的电压标签）。
- 如果插头与您的插口不一致，则请一位专业电工来为您安装一个合适的插座，请不要以任何方式来改装插头本身。如若电源线损坏。为避免危险，请通知专职维修人员更换。
- 请确保不让儿童玩耍或者使用机器，以防出现意外。
- 长时间不使用机器时，请拔掉插头，否则易发生因绝缘层老化而触电，或者漏电而引发火灾。严禁在有易燃易爆物品的场所使用该机器。
- 请勿让布鲁雅尔 (Blueair) 空气净化器进水。
- 请仅使用布鲁雅尔 (Blueair) 提供的专用滤网。



布鲁雅尔 (Blueair) 空气净化机的放置

请将机器放置在空气自由流通的地方，摆放时距离其他物体至少15cm。
请勿放置于：



直接放置或依靠在软性家具上，如床上用品或窗帘。



靠近热源如电暖炉、壁炉或烤箱；靠近氧气罐等其他易燃品；
靠近电学敏感设备如电脑15cm范围。



潮湿区域如浴室、洗衣房等机器有可能接触到水的地方。



户外。

机器的连接及使用

首先，请将电源线的插头插入电源插座。打开您的布鲁雅尔（Blueair）机器，开关按钮上的灯亮时表示机器在正常运作。初次使用时，为了快速地净化您房间内的空气，我们建议您先将风档调至最高风速（此档位亦可在白天或空气高度污染时使用）。高速档位运行数十分钟后，请将机器调节到您想要的风速使用。一般情况下，我们建议您在晚上使用低风速运行机器。

维护和保养

布鲁雅尔（Blueair）空气净化器融合了时尚简约的设计风格，高品质的材质和制作工艺。为使机器保持最佳状态高效运行，我们建议您定期对机器进行清洁。在清洁维护和更换过滤网的时候，请务必先切断电源。

为确保其发挥出最佳功效，请认真保养您的 Joy 空气净化器。

不定期使用真空吸尘器清除主滤网内外的灰尘。

根据实际运行状况，应每 6 个月换一次主滤网。（具体更换周期视实际情况而定）更换主滤网之前，确保要拔下设备的电源插头。

打开设备更换滤网时，可使用真空吸尘器清除设备内部累积的灰尘。

不定期以干抹布擦拭设备顶部。

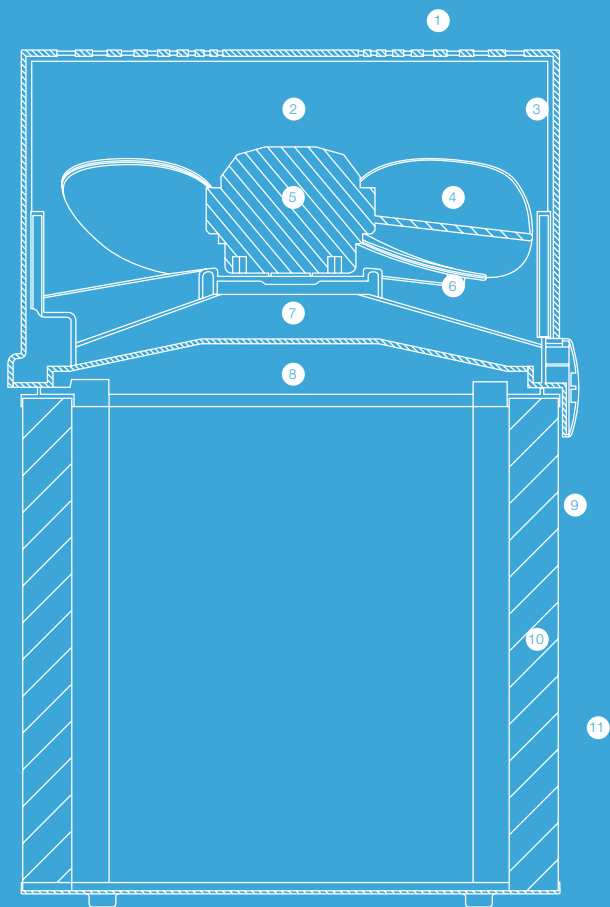

工作原理

- ① 出风口
- ② 离子室
- ③ 机身内臂
- ④ 扇页
- ⑤ 电机
- ⑥ 风扇底座
- ⑦ 防护格栅
- ⑧ 滤网更换开关
- ⑨ 前置滤网
- ⑩ 除烟去味复合滤网
- ⑪ 360° 进风口

Joy L 产品套装

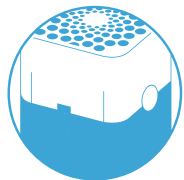

Joy L 空气净化器

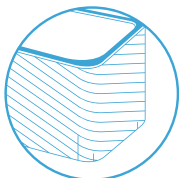

除烟去味复合滤网



前置滤网
(内含附赠4色前置滤网)

可选配件

- 粒子滤网
多色前置滤网

产品型号	清单明细	数量
Joy L 	Joy L 整机内置滤网 电源线 (连机内置) 说明书包装盒 Joy L系列说明书 欢迎信 前置滤网	1 1 1 1 1 4

让您的Blueair 空气净化器发挥极致功效

Blueair系统的使用十分简便。您只需确保这台空气净化机的规格适合房间大小，并遵照推荐的滤网更换时间表更换滤网即可。请记住：正如空调和加热器都有气流量的限值那样。每一套空气净化器也有其可以净化的空气量限值。请务必遵循常识性的认知范畴。

使用时请适当关闭窗口

在炎热的夏天，如果您打开窗户就不能期望空调高效地工作，因为您可以明显感觉到热空气的涌入和冷空气的流出。即便您无法看到受污染的空气流入和洁净的空气流出，在使用空气净化器时请适当关闭窗口。

（可根据需求适当留3-5厘米缝隙）。

您还必须紧闭房门

正如您在寒冷冬季的夜晚可能将屋子的一部分密闭起来、以保持加热器更有效地运行那样，相对封闭的空间能使您的这套空气净化器获得最佳的运行效果。

建议每天24小时运行您的空气净化系统

为了获得最佳的效果，您应当每天24小时、每周7天持续运行这一台Blueair空气净化器。24小时不间断运行，就确保持续地为室内供应洁净、健康的空气。Blueair空气净化器旨在实现非常低的功率消耗；事实上，即使不同的型号和工作速度，Blueair空气净化机的能耗在特定条件下等同于单个白织单灯泡照明的数值。

使用说明

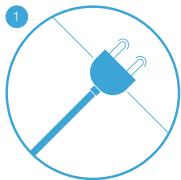

1
插上 Joy L 空气净化机的插头。

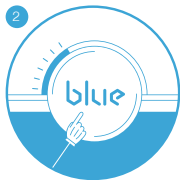

2
触摸按钮将其打开。



3
如果指示灯呈白色亮起，则表示设备工作正常。

开/关和速度控制

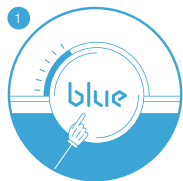

开/低速

触摸一次可打开设备，同时将其设为推荐的节能速度。



中速

触摸两次将其设为中速。



高速

触摸三次将其设为高速。

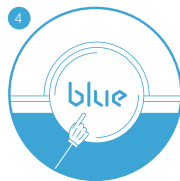

关

再触摸一次即可关闭设备。

此外，Joy L 如果遇到停电、拔下插头或是使用了电源开关定时器，当电源恢复时，Joy L 会按照设定的速度重新启动。

按钮控制功能

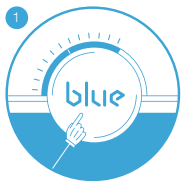

更换滤网指示灯

如果指示灯变黄(经过5个月的运行后),则该订购新滤网了。

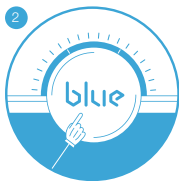

更换滤网

如果指示器灯光变红(又1个月过后),则应立即更换主滤网。



确认收悉滤网警报

按住此按钮3秒钟,可确认收悉滤网更换提示警报。

可以在指示灯光变红之前,也就是刚刚变黄时,更换滤网。这种情况下,只需更换滤网并重置设备,即可再用6个月。(参见“更换主滤网”)

清理或清洗前置滤网

不定期使用真空吸尘器清除前置滤网外部附着的灰尘。卸下前置滤网之前，拔下设备电源插头。

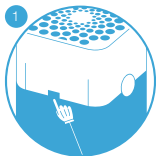

更换前置滤网之前，请轻按设备两侧的释放按钮，直至顶部和底部完全分离。

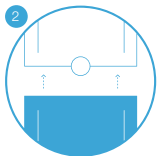

提起设备顶部



轻拉前置滤网并使其与设备底部分离，从而将其卸下。

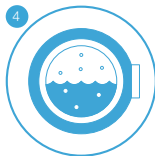

将前置滤网放入洗衣机中以低温柔柔洗涤。*



将前置滤网对准上角，把滤网装回设备底部。

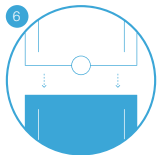

将设备顶部与底部卡位对接，用力压直至听到咔嚓声。

插上设备插头，触摸按钮重新启动。

- *1.可用各种洗衣粉及肥皂洗涤
- 2.洗涤温度在45摄氏度以下
- 3.可机洗，可手洗
- 4.不可暴晒
- 5.不可烘干

更换主滤网

更换主滤网之前，一定要拔下设备电源。



如果指示灯呈红色亮起，则表明是时候更换主滤网了。

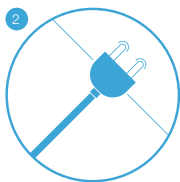

关闭设备并拔下插头。

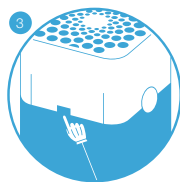

轻按设备两侧的释放按钮，直至听到咔嗒声。

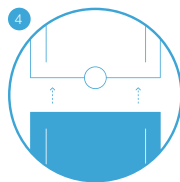

提起设备顶部。

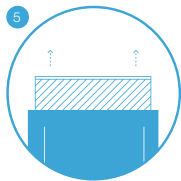

将滤网从设备上取下。

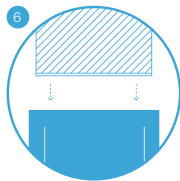

将新滤网折叠扁平状打开至立方体状，并重新插入。

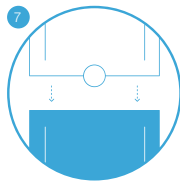

用力按压设备顶部以使其卡入新滤网，直至听到咔嗒声。

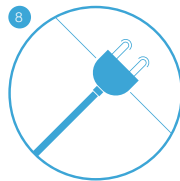

插上设备插头。



按住 Joy L 按钮 3 秒可重置设备。指示器闪烁 3 下后由红变白。

滤网

本设备随机自带除烟去味复合滤网。此类滤网可去除下述污染物：



PM2.5*



灰尘



花粉



宠物毛屑



霉菌



尘螨



细菌



VOC



烟雾



化学品



油烟

*直径不小于 2.5 微米的颗粒物

Blueair 还提供粒子滤网购买选项，请咨询 400-006-9693 获取详情

为确保良好的性能，Blueair 建议应当定期更换滤网，更换周期请参考附页 - |，建议不超过12个月。(具体更换周期视使用情况而定)

在中国，Blueair 提供便捷的滤网订购服务。您可以联系当地的经销商或 Blueair 公司了解详情。重要事项只能使用原厂生产的 Blueair 滤网，以确保您的这台设备的运转正常，并符合保修的要求。

滤网使用寿命换算表- I

当居室的换气率为0.6, 将室内污染物维持在35ug/m³, 达到12h后, 净化器至少应处理的颗粒物质量, 见表G.1。

单位为毫克

G.1 空气净化器的 颗粒物日均处理量	室外颗粒物质量浓度C _{out} (μg/m ³)						
	100	150	200	250	300	350	400
10	6	13	20	26	33	40	47
15	9	19	29	40	50	60	71
20	12	25	39	53	67	81	94
25	14	32	49	66	84	101	118
30	17	38	59	79	100	121	142
35	20	44	69	93	117	141	165
40	23	51	78	106	134	161	189
45	26	57	88	119	150	181	213
50	29	63	98	132	167	202	236

注1: 室外(大气环境)颗粒物的质量浓度近似采用当地官方公布的细颗粒物的质量浓度(环境空气质量指数)。

注2: 表G.1的应用示例: 如果, 附录D测试出的净化器对颗粒物的累积净化量的区间分档为P3, 净化器的使用面积为20m², 且室外污染物浓度为300ug/m³的情况下, 表G.1对应的日均处理量为67mg, 则净化器可工作(8000~12000)/67≈(119~179)天, 即大约为5个月左右。上述估算值是基于净化器的CADR初始值得出的, 实际使用中, 随着CADR衰减, 净化器工作状态下的“平衡浓度”有可能高于GB/T 18883规定的室内污染物浓度水平要求。

注3: 如果净化器每日工作时间小于或大于12h, 应适当减小或增加表G.1中的数值。

净化器将室内甲醛维持在0.10mg/m³达到12h后, 净化器至少应处理的甲醛质量, 见表G.2。

单位为毫克

G.2 空气净化器的 甲醛日均处理量	室内甲醛的初始稳定浓度C ₀ (mg/m ³)			
	0.15	0.2	0.25	0.3
10	9	17	26	35
15	13	26	39	52
20	17	35	52	69
25	22	43	65	86
30	26	52	78	104
35	30	60	91	121
40	35	69	104	138

注1: 本表清单针对甲醛的释放量(释放速率)选取“较不利原则”。

注2: 表G.2的应用示例: 假设, 附录E测试出的净化器对甲醛的累积净化量的区间分档为F3, 净化器的使用面积为20m², 且室内本底浓度为0.2mg/m³, 表G.2中对应的日均处理量为35mg, 净化器可工作(1000~1500)/35=(28~42)天, 或大约为1个月左右。上述估算值是基于净化器的CADR初始值得出的, 实际使用中, 随着CADR衰减, 净化器工作状态下的“平衡浓度”有可能高于GB/T18883规定的室内污染物浓度水平要求。

注3: 如果净化器每日工作时间小于或大于12h, 应适当减小或增加表G.2中的数值。

欢迎加入Blueair 会员俱乐部

欢迎加入Blueair会员俱乐部

请您收到空气净化器后尽快通过以下方式获取延保服务，以延长有效的产品保修期。并在日后购买替换滤网时享受折扣优惠。



网上注册

www.blueair.cn

登陆官网，自行按操作步骤注册
以获得相应延保服务。



拨打400全国统一客服热线

400-006-9693

由客服输入唯一机身编号进行注册
得到客服确认即可。



填写保修卡

将保修卡按要求填写完整，
并按指导寄回相应服务地址。



微信：
Blueair空气净化器

Blueair 中国

博露雅迹（上海）商贸有限公司

上海市徐汇区漕溪北路398汇智大厦1005室

Email: info@blueair.cn

全国统一客服热线：400-006-9693

产品保修卡 Warranty Card

用户联
User Card

姓名
Name

地址
Add

机器型号
Model

购买日期
Date of purchase

机身编号
Serial number

购买商场
Store purchased from



请在购买本公司产品后立即完整填写此保修卡，并妥善保管。
please complete the form and take care of it!

(有任何问题请联系当地经销商或Blueair中国区服务中心)
(Any questions please contact local distributors or Blueair China service center)

全国服务热线：400-006-9693

请沿此线撕开

产品保修卡 Warranty Card

存档联
File Card

姓名
Name

地址
Add

电话
Phone

机器型号
Model

购买日期
Date of purchase

邮箱
Email

机身编号
Serial number

购买商场
Store purchased from



请在购买本公司商品后立即完整填写此保修卡并通过以上方式注册您的商品。

售后服务指南

免费保修政策

1. 凡购买布鲁雅尔（Blueair）空气净化器Joy系列均可享受Blueair公司提供的整机保修1年，保修时间自购买发票开具日期起计算。

2. 免费保修条件：

- 能提供有效的购机发票或购机凭证；
- 能提供《Blueair空气净化器保修卡》必须在保修期内；
- 非人为原因造成的故障；
- 如无法提供有效购机凭证及保修卡，其购买日期按产品合格证上的出厂日期计算。

3. 非免费保修内容：

- 用户因电源电压不稳，不符合国家安全用电标准（AC220V+10%，50Hz）而造成损坏的；
- 因用户使用不当，保管不善而损坏的；
- 没有《Blueair空气净化器保修卡》和有效的购机凭证的；
- 《Blueair空气净化器保修卡》上的型号、机身号码于所维修空气净化机的产品规格标贴上的型号、机身号码不相符合的；
- 机器底部无完整中文标贴，内容包括产品型号、机身号码及制造商信息；超过保修期的产品；
- 因不可抗力造成损坏的，例如：地震、洪水、火灾等。

4. 非免费保修内容：

参照国家相关规定《部分商品修理更换退货责任规定》执行。

- 在7天内如果属产品质量问题，可以退、换货；
- 在15天内如果出现产品质量问题，可以换货。

5. 保修期内维修指引：

- 如果您购买的布鲁雅尔（Blueair）空气净化器出现故障，请致电Blueair全国统一客服热线400-006-9693；
- 产品维修后，如果故障未能彻底排除，您可以拒绝在《Blueair空气净化器维修记录表》上签名；
- 产品运转正常后，请您在《Blueair空气净化器维修记录表》上签名确认维修内容并提出宝贵意见。
如果是企业单位用户，请加盖企业公章。

Joy

English User Manual
Series: Joy

Welcome	21
Getting Started	22
What's in the Box	26
Getting the most out of your Blueair System	27
Setup	28
Filters	33
Calculation tables for filter service life	34
The Blueair Membership Club	35
After-sales service guide	37

Welcome

Thank you for choosing Blueair. Before you start using your Blueair air purifier, take a few minutes to become familiar with the basics.

Welcome to the Blueair Membership Club

As soon as your air purifier is delivered, please subscribe to the extended warranty service as described below. This membership allows you to obtain a discount when purchasing replacement filters in the future.



Online registration
www.blueair.cn

To extend your limited warranty, please log on to the official website and register according to instructions.



Customer service hotline:
400-006-9693

The unique Serial Number entered for registration will be confirmed by the Customer Service Center.



Fill in the Warranty Card

Please complete the Warranty Card, and mail it back to the relevant address as instructed.



Enter the official Wechat Account, finish Product registration and extend limited warranty

Service information

You can also obtain the latest service information via official Wechat and the TMall flagship store.

Blueair protects the environment!

Blueair air purifiers greatly improve indoor air quality whilst having a minimal impact on the environment.

Getting Started

General safety instructions

The Blueair Joy air purifier is an electrical appliance. Please read the safety instructions before use and take the necessary precautions to reduce the risk of fire, electric shock or injury. The Blueair Limited Warranty applies only if the unit is used according to these instructions.

- To avoid electric shock or fire, only use the power cable provided with your Blueair Joy unit and plug into the correct electrical socket. (Refer to the voltage label on home appliances).
- If the plug does not fit into the socket, please contact authorised maintenance personnel who will replace the socket. Never modify the plug in any way. To avoid a hazard, a damaged supply cord must be replaced by the manufacturer, their service agent, or similarly qualified personnel.
- To prevent accidents, do not allow children to play with the appliance.
- Unplug the unit if it will not be used for a long period of time. This prevents an electric shock or fire caused by aging insulation or leaking electricity.
- Do not place the unit near inflammable and explosive objects.
- Please waterproof the Blueair Joy air purifier.
- Please use only genuine Blueair filters.



Placement

Place the unit in a location that allows air to circulate freely in, out and around the unit. The minimum acceptable distance from another object is 6" or 15 cm. Use only genuine Blueair filters.

Do not place the unit:



Directly on or against soft furnishings, such as bedding or curtains.



Near sources of heat, such as radiators, fireplaces or ovens.



Near wet areas, such as bathrooms or laundry rooms where it may come into contact with water.



Outdoors.

Settings

Plug the power cord firmly and completely into the recessed power cord socket located at the bottom of the unit. Plug the other end into a grounded wall outlet or power strip. For detailed operation, please refer to the user instructions for this model since instructions may vary between models. Set the unit to the maximum speed recommended for fast initial cleaning, daytime use, or heavily polluted air. After a few minutes, adjust the unit to the desired speed. Minimum speed is generally recommended for nighttime use.

Care and Maintenance

Blueair air purifiers feature high quality design, materials and workmanship. To keep your unit in top condition, we recommend routine cleaning. The appliance must be disconnected from the supply mains before cleaning or maintenance.

Take good care of your Blueair Joy air purifier to ensure that it delivers optimal performance.

General care

Occasionally vacuum the pre-filter to remove dust, or wash it on a gentle, low temperature cycle in the washing machine.

Change the main filter every six months, depending on the operating conditions.

When the unit is open to change the filter, vacuum any dust that may have accumulated inside the unit.

Occasionally wipe the top of the unit with a dry dust cloth.

Occasionally vacuum the inside and outside of the main unit to remove any dust.

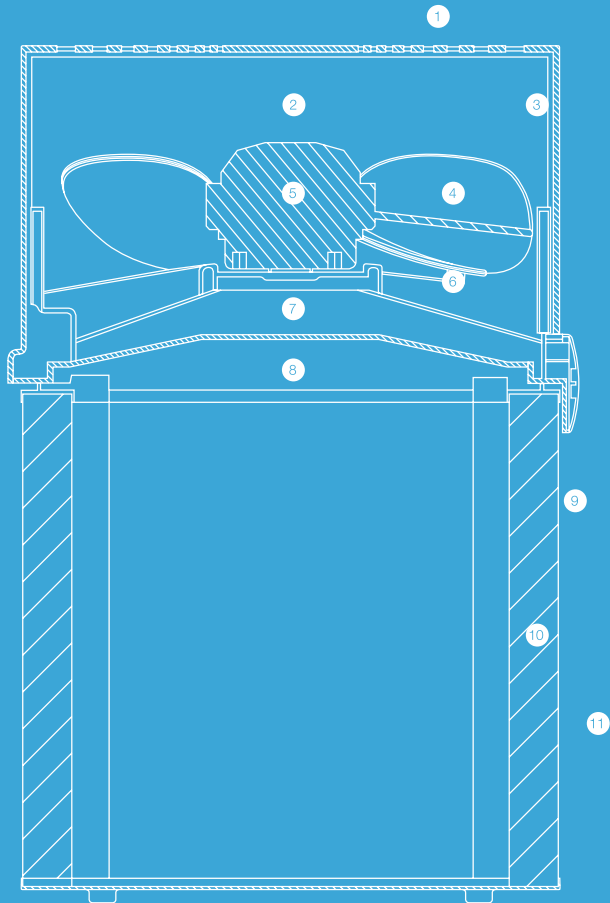

Blueprint

- 1 Air outlet
- 2 Ion chamber (Air stream optimizer)
- 3 Inner wall
- 4 Fan
- 5 Motor
- 6 Fan base
- 7 Protective grill
- 8 Release button for filter
- 9 Pre-filter
- 10 Particle + Carbon filter
- 11 Air inlet 360°

Joy L package

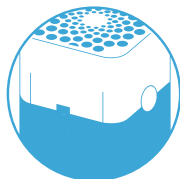

The Joy L air purifier

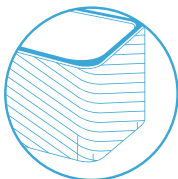

Particle + Carbon filter



Fabric pre-filters
(Five filters included)

Option

- Choice of color for the fabric pre-filter.

Model	Detailed list	Amount
Joy L 	Unit Power cord Kit Box User Manual Joy Series Welcome letter Extra Filters	1 1 1 1 1 4

Getting the most from your Blueair System

The Blueair system is easy to use. Make sure your unit is the right size for your room, and change the filters according to the recommended filter replacement schedule. Remember that, just as air conditioners and heaters have limits to the volume of air they can cool or heat, every air purification system has limits to the volume of air it can clean. Follow these common sense guidelines.

Close your windows

You wouldn't throw open your window on a hot summer day and expect your air conditioner to work efficiently, because you can feel the hot air coming in and the cool air going out. Even though you can't see the contaminated air coming and the clean air going out, the same applies to your air purifier.

Close your doors

Just as you might seal off part of your door on a cold winter night to keep your heater working more efficiently, seal off the room in which your system is working for best results.

Run your system 24 hours a day

For best results, run your Blueair unit 24 hours a day, 7 days a week. Round-the-clock operation ensures that a continuous supply of clean, filtered air constantly circulates throughout the room. Blueair systems are designed for phenomenally low power usage. In fact, it costs about the same to power a Blueair air purifier as it does to power a single light bulb, depending on the unit and the operating speed.

Getting started

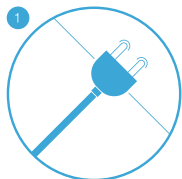

Plug in your Joy L air purifier.

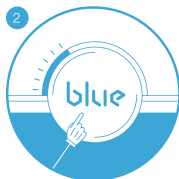

Press the button to turn the unit on. The unit automatically sets itself to the recommended energy-efficient operating speed.



When the indicator light glows white, your unit is working properly.

On/off and speed control

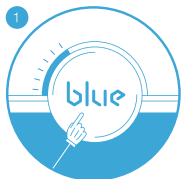

On/Low
Press once to turn the unit on and set it to the recommended energy-efficient speed.

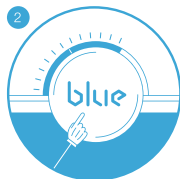

Medium
Press twice to set to medium speed.



High
Press three times to set to high speed.

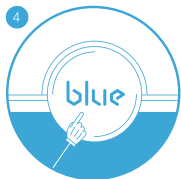

Off
Press a fourth time to turn the unit off.

Moreover, Joy L has an Autostart feature. This means that Joy L will automatically restart at the set speed if a power failure occurs, the unit is unplugged or a power switch timer is used.

Button control functions



1
Change filter indicator
When the indicator turns yellow (after 5 months of operation), it's time to order a new filter.



2
Change filter When the indicator light turns red (after 1 extra month of operation), you should change the main filter.

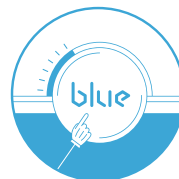

Reset the filter alert Press the button for three seconds to reset the filter alert.

You can change the filter before the indicator light turns red, i.e. when it first turns yellow. In this case, just reset the unit after changing the filter and use for another 6 months. (see "Change the main filter")

Vacuum or wash the pre-filter

Occasionally vacuum the exterior of the fabric pre-filter to remove dust. Before removing the fabric pre-filter, unplug the unit.

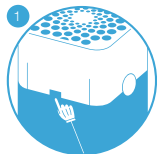

Before replacing the fabric pre-filter, gently press the release buttons on both sides of the unit until you hear a click.

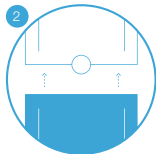

Lift off the top of the unit.

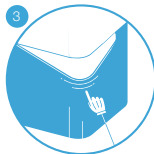

Gently pull and detach the pre-filter from the lower half of the unit.

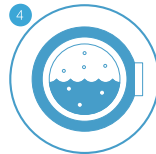

*Wash the pre-filter on a gentle, low temperature cycle in the washing machine.



Re-fit the fabric pre-filter over the bottom part of the unit.

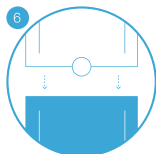

Replace the top of the unit, pressing firmly until you hear a click.

Plug in the unit and touch the button to restart.

*

1. The pre-filter can also be washed using washing powder and soap.
2. The washing temperature should not exceed 45°C.
3. The pre-filter is both machine and hand-washable.
4. Do not expose the pre-filter to direct sunlight.
5. Using a heat dryer is not recommended

Change the main filter

Be sure to unplug the unit before changing the main filter.

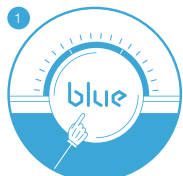

When the indicator light glows red, it's time to change the main filter.

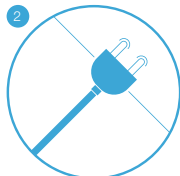

Turn off the unit and unplug it.

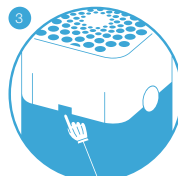

Gently press the release buttons on both sides of the unit until you hear a click.

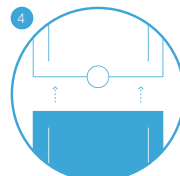

Lift off the top of the unit.

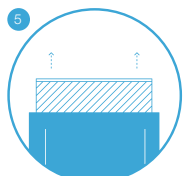

Remove the main filter from the unit.

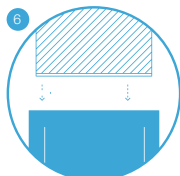

Unfold the replacement filter and insert into the unit.

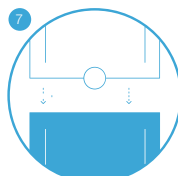

Firmly press the top of the unit onto the replacement filter until you hear a click.

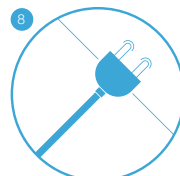

Plug in the unit.



To reset the unit, press the Joy L button for three seconds. The indicator will flash three times, then change from red to white.

Filters

General information

The unit is delivered with a Particle + Carbon filter and five fabric pre-filters. These filters remove the following pollutants:

Particle + Carbon filters remove:



PM2.5*



Dust



Pollen



Pet dander



Mold



Dust mites



Bacteria



VOC



Smoke



Chemicals



Cooking odors

*Particle matter smaller than 2.5 microns

IMPORTANT!

Use only genuine Blueair filters to ensure proper function of your unit and to qualify for full warranty coverage.

Calculation tables for filter service life

With the air exchange rate of 0.6, the indoor pollutants are maintained at $35\mu\text{g}/\text{m}^3$, and after 12 hours, the minimum mass of particles that shall be treated by the air purifier can be found in Table G.1.

G.1 Table G.1 Average daily treatment quantity of particle with air purifier		Outdoor particle mass concentration C_{out} ($\mu\text{g}/\text{m}^3$)							Unit: mg
		100	150	200	250	300	350	400	
Room size (m^2)	10	6	13	20	26	33	40	47	
	15	9	19	29	40	50	60	71	
	20	12	25	39	53	67	81	94	
	25	14	32	49	66	84	101	118	
	30	17	38	59	79	100	121	142	
	35	20	44	69	93	117	141	165	
	40	23	51	78	106	134	161	189	
	45	26	57	88	119	150	181	213	
	50	29	63	98	132	167	202	236	

Note 1: The officially published mass concentration of fine particulate matter (Ambient Air Quality Index) is roughly adopted as mass concentration of outdoor (the ambient atmosphere) particles.

Note 2: An application example of Table G.1: For the range P3 of the air purifier for the particles' Cumulative Cleaning Mass (CCM) tested by Appendix D, with the room size of 20m^2 and mass concentration of outdoor pollutant $300\mu\text{g}/\text{m}^3$, 37mg of daily treatment amount, then the unit can normally work (8000-12000) / 67 = (119-179) days, or around 5 months. The above estimation is based on its initial value of CADR. However, during actual use, with the attenuation of CADR, the "average concentration" of the air purifier may be higher than the concentration level of indoor pollutant specified by GB/T 18883.

Note 3: If the daily working duration of the unit is shorter or longer than 12 hours, the values in Table G.1 shall be appropriately decreased or increased.

With the indoor formaldehyde maintained at $0.10\text{mg}/\text{m}^3$, and after 12 hours, the minimum mass of formaldehyde that shall be treated by the air purifier can be found in Table G.2.

G.2 Table G.2 Average daily treatment quantity of formaldehyde with air purifier		Initial stable concentration of indoor formaldehyde C_0 (mg/m^3)				Unit: mg
		0,15	0,2	0,25	0,3	
Room size (m^2)	10	9	17	26	35	
	15	13	26	39	52	
	20	17	35	52	69	
	25	22	43	65	86	
	30	26	52	78	104	
	35	30	60	91	121	
	40	35	69	104	138	

Note 1: This table adopts "Less favorable principle" to the formaldehyde release (release rate).

Note 2: An application example of Table G.2: For the range P3 of the air purifier for the particles' Cumulative Cleaning Mass (CCM) tested by Appendix D, with the room size of 20m^2 and background concentration of indoor pollutant $0.2\text{mg}/\text{m}^3$, 35mg of daily treatment amount corresponding to that in Table G.2, then the unit can normally work (1000-1500) / 35 = (28-42) days, or around 1 month. The above estimation is based on its initial value of CADR. However, during actual use, with the attenuation of CADR, the "average concentration" of the air purifier may be higher than the concentration level of indoor pollutant specified by GB/T 18883.

Note 3: If the daily working duration of the unit is shorter or longer than 12 hours, the values in Table G.2 shall be appropriately decreased or increased.

Welcome to the Blueair Membership Club

How to join the Blueair Membership Club

As soon as your air purifier is delivered, please subscribe to the extended warranty service as described below. This membership allows you to obtain a discount when purchasing replacement filters in the future.



Online registration
www.blueair.cn

To extend your limited warranty, please log on to the official website and register according to instructions.



Customer service hotline:
400-006-9693

The unique Serial Number entered for registration will be confirmed by the Customer Service Center.



Fill in the Warranty Card

Please complete the Warranty Card as required, and mail it back to the relevant address as instructed.



WeChat:
Blueair air purifier

Blueair China

Blueair (Shanghai) Sales Co., Ltd.

Room 1005, City Gateway, No. 398, North Caoxi Road, Xuhui District, Shanghai, China

Email: info@Blueair.cn Customer service hotline: 400-006-9693

Warranty Card

For clients keep

Name _____

Address _____

Model _____ Serial number _____

Date of purchase _____ Store purchased from _____

Please complete the form and take care of it!
(For any questions, please contact local distributors or Blueair China service center.)
Customer service hotline: 400-006-9693



Warranty Card

For Mail

Name _____

Address _____

Phone _____ Email _____

Model _____ Serial number _____

Date of purchase _____ Store purchased from _____

After purchasing any products from our company, please complete the Warranty Card and register as described above.



After-sales service guide

1. Warranty policy

Blueair air purifier models: the Joy series covered by one(1) year warranty of the whole unit, from the date of purchase as indicated on the relevant invoice.

2. Warranty conditions

- The relevant invoice or other Proof-of-Purchase can be provided.
- The warranty period stated on the Blueair Air Purifier Warranty Card is valid.
- The fault has not been caused by the user.
- If the relevant Proof-of-Purchase and Warranty Card are not provided, then the manufacturing date stated on the Product Qualification Certificate shall be deemed as the date of purchase.

3. Repair fees will be charged when:

- The damage is caused by the unstable voltage of the power supply, which does not comply with the national safety standard for electricity (AC220V+10%, 50Hz).
- The damage is caused by the user's improper use or poor maintenance of the unit.
- The Warranty Card for Blueair Air Purifier or other effective Proof-of-Purchase is not provided.
- The model or serial number on the Product Specification Label of the unit to be repaired is not consistent with that on the Warranty Card for the Blueair Air Purifier.
- There is no complete Chinese label at the bottom of the unit, which shall contain the product's model, serial number and manufacturer's information.
- The product has exceeded its warranty period.
- Damage due to force majeure, such as earthquake, flood, fire etc.

4. The owner will pay repair costs as follows:

- In accordance with relevant clauses of "Provisions for repair, return and exchange for some commodities"
- For any quality issues arising within 7 days of purchase, the unit is returnable or exchangeable.
- For any quality issues arising within 15 days of purchase, the unit is exchangeable.

5. Maintenance guidance within warranty period

- For any fault with your Blueair Air Purifier, please call Blueair Customer Service hotline 400-006-9693.
- If the fault has not been completely eliminated after the unit has been serviced, you can refuse to sign the Maintenance Record Table for the Blueair Air Purifier.
- When the product operates normally, please sign the Maintenance Record Table for the Blueair Air Purifier to confirm that service has been carried out. Please provide comments and/or suggestions. For enterprise users, please use the official enterprise stamp.

有害物质成份及含量表

序号	部件名称	有害物质					
		铅(Pb)	汞(Hg)	镉(Cd)	六价铬(Cr(VI))	多溴联苯(PBB)	多溴二苯醚(PBDE)
1	PCB组件	X	○	○	○	○	○
2	电机	○	○	○	○	○	○
3	塑胶件	○	○	○	○	○	○
4	五金件	○	○	○	○	○	○
5	过滤器组件	○	○	○	○	○	○

“○” :表示该有害物质在该部件所有均质材料中的含量均在GB/T 26572-2011规定的限量要求以下。

“X” :表示该有害物质至少在该部件的某一均质材料中的含量由于现有技术及工艺限制而超出GB/T 26572-2011规定的限量要求。在上述表格中，标注“X”的部件满足欧盟RoHS 2.0法规——欧盟电子电器产品中限制使用某些有害物质的2011/65/EU法规。



备注：所有在中国销售的电器电子产品必须有环保使用限期的标识。该标识的环保使用期限是指在正常使用条件和温度、湿度，并且不包含电池等耗材情况下的使用期限。

www.blueair.com

Blueair AB
Karlavägen 108
115 26 Stockholm
Sweden
Tel: +46 8 679 45 00

Blueair (Shanghai)
Trading Co., Ltd.
Rm 1005 City Gateway
No. 398 North Caoxi Road Xuhui
Distr, Shanghai
Tel: +86 21 6091 0981
Fax: +86 21 6091 0989
info@blueair.cn

Blueair AB Middle East
Jafza One
Office No. AB1503
Jebel Ali Free Zone P.O.
Box No. 263947 Dubai
+971 (4)8821244

Blueair Inc.
Suite 1900
100 N LaSalle Street Chicago
IL 60602
Tel: +1 888 258 3247
Fax: +1 312 727 1153
info@blueair.com

Blueair India
Embassy of Sweden
Nyaya Marg
Chanakyapuri
New Dehli – 110021
Tel: +91 11 4606 7121
Fax: +91 11 4606 7120
india@blueair.se
Toll free info number:
18008331188



www.blueair.cn

博露雅逊（上海）商贸有限公司
上海市徐汇区漕溪北路398号汇智大厦1005室
Email: info@blueair.cn
全国统一客服热线: 400-006-9693



微信:
Blueair空气净化器