

**OXO** on<sup>o</sup>

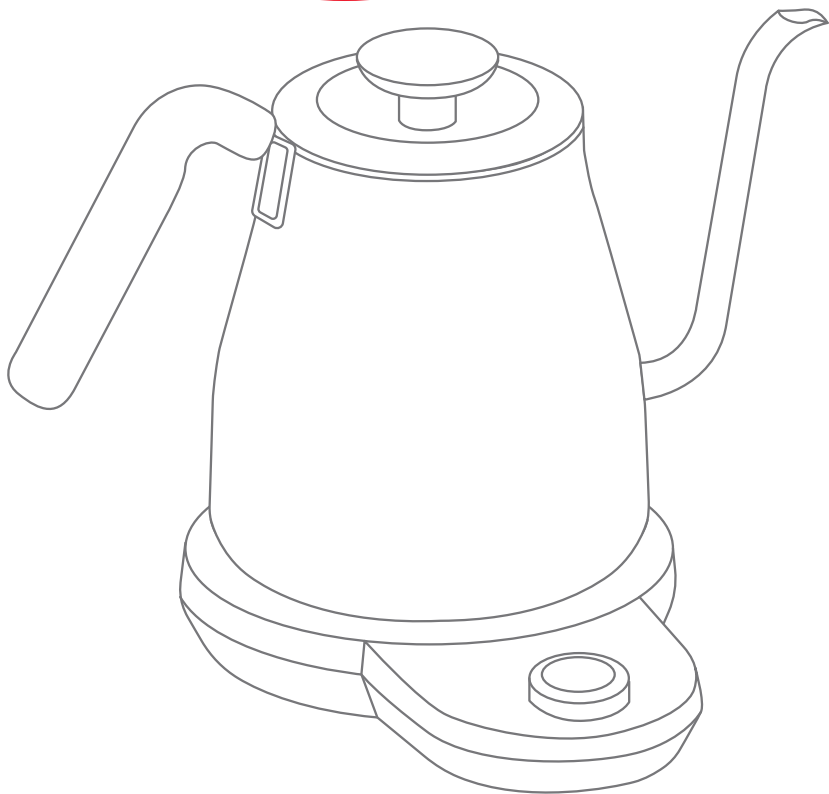

---

**ADJUSTABLE TEMPERATURE POUR-OVER KETTLE**  
**INSTRUCTIONS FOR USE**

---



**CONGRATULATIONS**  
on your new OXO On appliance!

---

Don't forget to register your product  
at [OXO.com/registration.aspx](https://OXO.com/registration.aspx)  
for updates and other relevant information.

Although greatly appreciated, product registration is not required to activate any warranty.

---

## Find balance

---

Pour-over coffee is a labor of love. It requires precision and patience to get it just right, but the result is hand-crafted coffee just the way you like it. At OXO, we love pour-over coffee, but felt the process could be a bit easier (especially for that first cup of the day). That's why our Adjustable Temperature Pour-Over Kettle lets you select your exact water temperature and times the process without a separate tool. We carefully considered the design of the handle and weight of the Kettle for a balanced feel while pouring, plus the gooseneck spout with curved opening provides precision and control. This Kettle ensures your coffee is the way you like it every time.

---

A Note About Safety.....	3	Troubleshooting.....	11
Before We Begin.....	5	Descaling, Cleaning, Care and Storage.....	12
Quick-Start Guide.....	6	Our Guarantee.....	13
Meet Your Kettle.....	7	Registration Info.....	13
The Particulars of Boiling Water....	9		

---

## A Note About Safety



# IMPORTANT SAFEGUARDS

### Read all instructions.

When using electrical appliances, basic safety precautions should always be followed to reduce the risk of fire, electric shock, and/or injury to persons, including the following:

- Read All Instructions. Use this product only as described in this manual.
  - Keep the packaging material (cardboard, plastic, etc.) out of the reach of children (danger of asphyxiation or injury).
  - To protect against fire, electrical shock and injury to persons do not immerse cord, plugs or Kettle/base in water or other liquid.
    - Do not place anything on top of the lid.
    - Do not open the lid during operation as scalding may occur.
    - Do not move appliance while it is switched on.
    - Do not operate Kettle on an inclined surface.
  - Always use the Kettle on a dry, level surface well away from the edge of any countertop.
  - Do not leave the appliance unattended when in use.
  - Do not operate any appliance with a damaged cord or plug, or after the appliance has malfunctioned or has been damaged in any way or is not operating properly.
- Contact OXO Customer Service at (800) 545-4411. **Do not return to store.**
- When using this appliance, provide adequate air space above and on all sides for circulation. Do not use under cabinetry.
  - Do not overfill Kettle past the “MAX” fill line.
  - Do not allow Kettle to boil dry.
  - Always have lid on when Kettle is in use
  - Do not place this appliance on or near a hot gas or electric burner, or where it could touch a heated oven.
  - Do not touch hot surfaces, including the metal areas on the Kettle. Touch only the handle, the knob, and the button on the base.
  - Handle the Kettle with care at all times. Do not use Kettle if it is cracked or handle is loose.
  - Take care to keep fingers, hair, clothing, and other objects clear while removing the Kettle from and returning it to the base.
  - Do not let the cord hang over the edge of a table or counter where it can be pulled on by children or tripped over unintentionally. Do not let the cord hang over or touch hot surfaces or become knotted.
  - The use of accessory attachments not recommended by the appliance manufacturer may result in fire, electric shock or personal injury.
  - Close supervision is necessary when any appliance is used by or near children.
  - Unplug from outlet when not in use and before cleaning. Allow to cool before putting on or taking off parts, and before cleaning the appliance.
  - Do not put any substances other than water and descaling products into the Kettle. Never attempt to cook or warm food in the Kettle.
  - Always attach plug to appliance first, then plug cord into the wall outlet. To disconnect, turn any control to “off,” then remove plug from wall outlet.

## SAVE THESE INSTRUCTIONS.

 **WARNING! Shock Hazard:** This appliance is equipped with a power cord that has a grounding wire with grounding plug. The appliance must be grounded using a 3-hole properly grounded outlet. In the event of an electrical short circuit, grounding reduces the risk of electric shock. If the power outlet is a standard 2-prong wall outlet, it is your personal responsibility and obligation to have it replaced with a properly grounded 3-prong outlet. **Do not, under any circumstances, cut or remove the third (ground) prong from power cord or use adaptor.**

Consult a qualified electrician if the grounding instructions are not completely understood, or if doubt exists as to whether the appliance is properly grounded. Do not plug this appliance into an outlet with a voltage other than specified on the bottom of Kettle.

### SHORT CORD STATEMENT

The length of the cord used on this appliance was selected to reduce the hazards of becoming tangled in, or tripping over a longer cord. If a longer cord is necessary, an approved extension cord may be used. The electrical rating

of the extension cord must be equal to or greater than the rating of this appliance.

Care must be taken to arrange the extension cord so that it will not drape over the countertop or tabletop where it can be pulled on by children or tripped over. To avoid an electrical circuit overload, do not use any high wattage appliance on the same circuit as this appliance.

- Do not touch the Kettle during a boiling cycle. Scalding may occur if the lid is removed/opened during the boiling cycles.
- Do not use this appliance for other than its intended use.
- Do not use outdoors.
- This appliance is intended for household use only.

### **WARNING!**

#### SHOCK HAZARD

ONLY FOR USE WITH 110/120V AC OUTLET.

DO NOT USE ADAPTER.

FAILURE TO FOLLOW THESE INSTRUCTIONS  
CAN RESULT IN DEATH, FIRE OR ELECTRICAL SHOCK.

 This symbol alerts you to important operating and service instructions.

### **WARNING!** RISK OF FIRE OR ELECTRIC SHOCK DO NOT OPEN

WARNING, TO REDUCE THE RISK OF FIRE OR ELECTRIC SHOCK, DO NOT REMOVE COVER (OR BACK)

NO USER-SERVICEABLE PARTS INSIDE

REPAIR SHOULD BE DONE BY AUTHORIZED SERVICE PERSONNEL ONLY

 This symbol alerts you to the risk of fire or electric shock in the accompanying message.

## Before We Begin

1. Remove and recycle or discard all stickers, descriptive labels, cable ties and packing materials, including static stickers and hangtags with ties.
2. Wipe body of Kettle with a soft, damp cloth. Rinse inside and dry thoroughly.

 **CAUTION:** Do not use abrasive pads, harsh chemicals or spray cleaner chemicals to clean. These may damage the surface of the appliance.

3. Fill your Kettle with cold water to the “MAX” level, complete one boiling cycle, and then discard water.

## Quick Start Guide

1. Remove lid and fill Kettle with cold water. Replace lid securely on kettle.
2. Place Kettle securely on base.
3. Plug power cord into 110V/120V outlet.

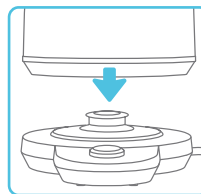

4. Press and hold the OXO button to enter temperature unit menu. Twist dial to choose between Fahrenheit (F) or Celsius (C). Press OXO button again to confirm selection.



5. Press OXO button to enter temperature setting menu. Twist dial to choose desired water temperature between 104°F (40°C) and 212°F (100°C). Press OXO Button to confirm selection. Water will now be heated to your desired temperature and held for 30 minutes.

To cancel at any time, press the OXO button during the boiling cycle.

*To learn more about how to use your Kettle, check out “The Particulars of Boiling Water” on pg. 9.*

*See pg. 12 to learn how to descale your Kettle, as well as other use and care information. (Descaling is a simple process required for all kettles to maintain long-term heating efficiency.)*

## Meet Your Kettle

### **BALANCED DESIGN**

Handle and body designed to provide comfortable balance while pouring for more control and less strain

### **STAY-COOL HANDLE**

Non-slip, comfortable handle and knob on lid provide a secure grip and remains cool to the touch

### **STAINLESS STEEL KETTLE**

Naturally BPA-free stainless steel is perfect for use in the kitchen or at the table

### **CORDLESS KETTLE**

Kettle is cord-free for easy transport when removed from 360° swivel base

### **BUILT-IN TEMPERATURE GUIDE**

Kettle base features temperature guidelines for coffee and tea

### **CONVENIENT STORAGE**

Cord wraps neatly around base for compact, tidy storage

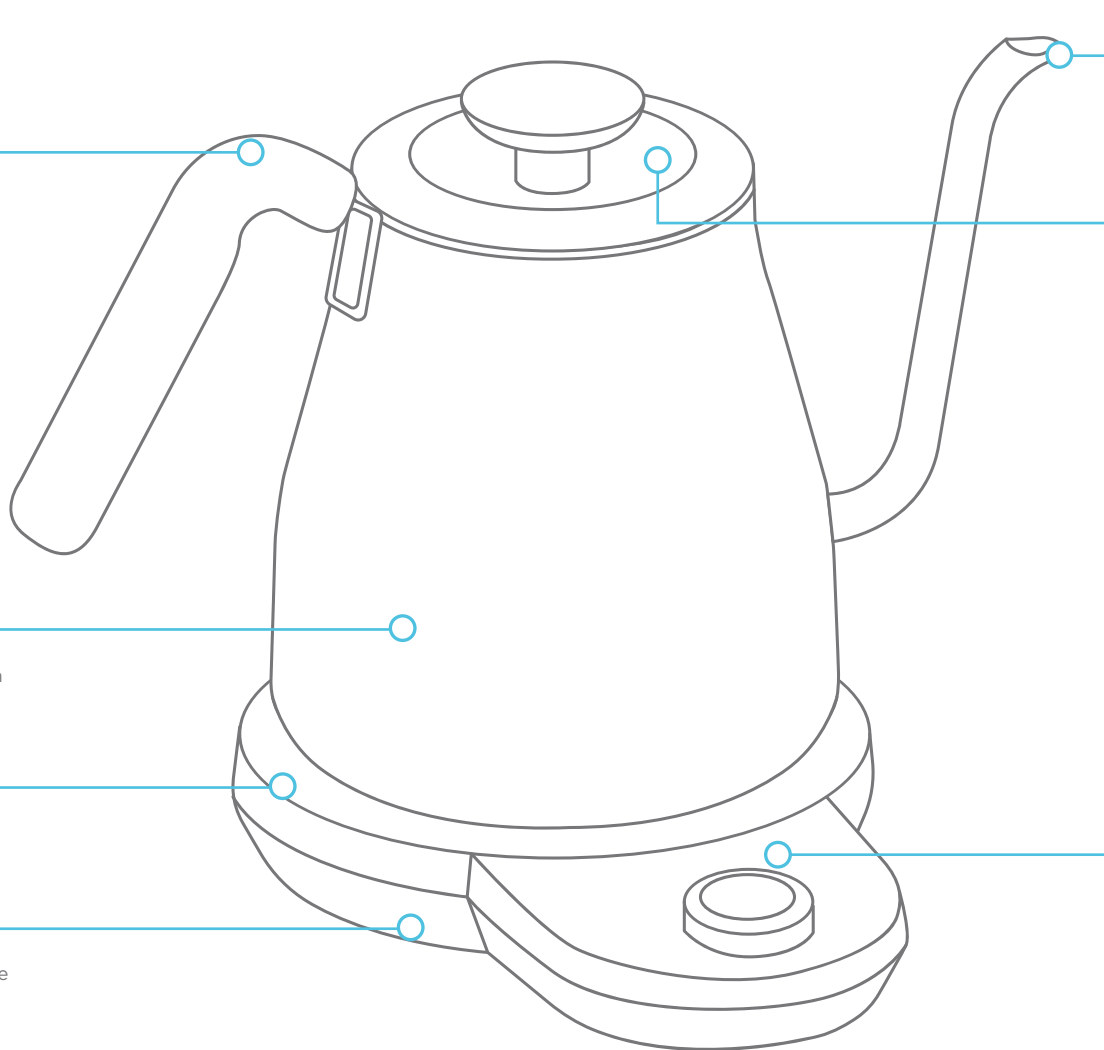

### **PRECISE-POUR GOOSENECK SPOUT**

Unique curved opening and elongated spout provide visibility and a steady flow for precision and control

### **PROTECTIVE SLEEVE**

Silicone layer protects your fingers from heat when opening the lid

### **PRECISE TEMPERATURE CONTROL**

Water is heated to your preferred temperature for coffee or tea in one-degree increments from 104-212°F/40-100°C

### **AUTOMATIC KEEP-WARM FUNCTION + SAFETY SHUTOFF**

Kettle holds water at specified temperature for 30 minutes, then turns off for safety

### **COUNT-UP TIMER**

Built-in timer counts up to keep track of pour-over process

### **INTUITIVE LED DISPLAY**

The backlit screen and one-dial interface allow you to easily choose the exact temperature, and alerts you when the temperature is reached

# The Particulars of Boiling Water

**NOTE:** Your Kettle will operate only when it is positioned on the power base with a desired temperature selected. Your Kettle will automatically switch off once the water has reached desired temperature and been held for 30 minutes. To cancel at any point in the boiling or keep warm stages, press the OXO button.

1. Remove Kettle from base and remove the lid by lifting from the black knob. Fill Kettle to desired level of water. Do not fill beyond the max fill line.

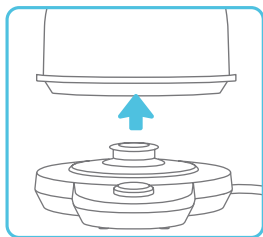

**CAUTION:** Under-filling could result in Kettle switching off before reaching your desired temperature and/or overheating from boiling dry. Over-filling may result in boiling water splashing out of pour spout, and could cause scalding and serious injury. If over-filled, water may also leak from the top and collect in the base of the Kettle.

2. Press lid closed and position Kettle securely on base. Plug power cord into 110V/120V outlet.
 

**NOTE:** Before plugging Kettle into wall outlet, ensure circuit is not overloaded with other appliances.
3. During first use, press OXO button to enter temperature unit menu. Twist dial to choose between Fahrenheit (F) or Celsius (C). Press OXO button again to confirm selection.
4. Press the OXO button to enter temperature setting menu. Twist dial to choose desired water temperature

between 104°F (40°C) and 212°F (100°C). Press OXO Button to confirm selection. Water will now be heated to your desired temperature. The display will show the temperature of the water as it is being heated.

5. Once the water reaches your selected temperature, the Kettle will beep and the “keep-warm” function begins automatically and will hold the water temperature steady for 30 minutes.

Beverage Type	Suggested Temperature
Green & White Tea	175°F/80°C
Oolong Tea	195°F/90°C
Black Tea & Coffee	200°F/93°C
Herbal Tea	208°F/98°C
Boiling Water	212°F/100°C

**NOTE:** This appliance is designed for boiling or heating water only. Never use it to heat or boil any other liquids or food. Never put tea or coffee inside the Kettle.

**NOTE:** Boiling point depends on altitude; at higher elevations, water boils at lower temperatures. If you live above sea level, keep in mind you may not be able to reach 212°F/100°C

**WARNING:** If Kettle is filled to the max line and you select 212°F/100°C while you live at high altitude, hot water may splash out of the spout when trying to reach temperature

6. To cancel at any time, press the OXO button. If you remove Kettle when you are heating up water, return the Kettle to the base within 60 seconds to continue the cycle, otherwise the boiling cycle will automatically be canceled.

**NOTE:** To cancel keep warm at any time, press the OXO button.

7. If you remove Kettle during the “keep-warm” period, return the Kettle to the base within 60 seconds to continue keeping the water at your selected temperature, otherwise the “keep-warm” function will automatically be canceled.

8. When ready, lift Kettle from base and pour slowly to prevent water coming out of the lid. The handle and bottom of the Kettle are designed to stay cool after boiling to protect your hands, and the insulated bottom allows you to place the Kettle on any surface when you’re done pouring.

**NOTE:** Unless canceled, water will be held at your selected temperature for 30 minutes in the “keep-warm” function. After 30 minutes, your Kettle will automatically turn off.

**CAUTION:** Do not put empty Kettle back on base when in “keep-warm” mode. Be sure to turn Kettle off before returning empty Kettle to base.

## Count-Up Timer Mode

When the Kettle has reached the desired temperature it will go into keep-warm mode.

To help keep track of your pour-over process without the need for an additional timer, the OXO On Pour-Over Kettle features an integrated count-up timer.

1. To enter Timer Mode, press and hold the OXO button for 1 second. The “0:00” clock icon will appear and timer will start.
2. Once in Timer Mode, the count-up timer will start. The timer will continue to run until you press the OXO button to stop the timer. Once the timer is stopped it will automatically return to keep-warm mode. To ensure optimum pour-over coffee extraction, the coffee grounds should be in contact with 195-205°F water for 3-4 minutes.

**NOTE:** The timer max is 10 minutes.

3. When in keep-warm mode, simply press the OXO button to turn off the Kettle

**CAUTION:** The Kettle appliance is very hot during use. Do not touch Kettle surface. Beware of burns! Use the handle for lifting, carrying and pouring. If you need extra support, use an oven mitt.

4. Once Kettle has cooled, unplug the power cord and empty excess water from the Kettle. Use the cord wrap under the base for tidy storage.

**NOTE:** The Kettle is designed to remember your last temperature setting

**WARNING:** Do not open the lid during and after operation. This may result in hot or boiling water splashing from the Kettle. Pour all hot water from the Kettle before opening the lid to refill.

## Safety Boil Dry Protection

- The Kettle is fitted with a safety device which protects against overheating should the appliance be operated with insufficient water. If this occurs, the Kettle will stop heating.

- Allow Kettle to cool for approximately 20 minutes before refilling. The safety device will automatically reset when the Kettle has sufficiently cooled.

**WARNING:** This appliance is designed for boiling and heating drinking-quality water only. The lid should always be locked securely into the closed position before use.

Icon	What It Means
	Water is being heated
	Count up timer
	Heated, keep warm function
	Kettle is not properly on the base

**WARNING:** Do not fill the Kettle beyond the max line. This may result in hot water splashing out of the spout.

## Troubleshooting

You have questions, we have answers. For more information, call OXO Customer Service at 1-800-545-4411.

Question/Problem	Explanation/Solution
Kettle is plugged in but will not turn on	➔ If the Kettle is plugged in and turned on without any water in it, it will automatically shut off to prevent overheating. The Kettle will be able to turn on again in a few minutes, after it cools back down to a safe temperature.
Kettle is taking longer than usual to boil	➔ Your Kettle might need to be descaled. See pg. 12 for descaling instructions.
I selected 212°F but the Kettle always stops at 204°F	➔ Check your altitude; your boiling point may be lower than 212°F. The Kettle cannot reach temperatures higher than your altitude's boiling point.

### FIND YOUR BOILING POINT:

Find the boiling point for your exact altitude with our handy online tool:  
[www.oxo.com/boiling-point.phtml](http://www.oxo.com/boiling-point.phtml)



**WARNING!**

#### SHOCK HAZARD

ONLY FOR USE WITH 110/120V AC OUTLET.  
DO NOT USE ADAPTER.

FAILURE TO FOLLOW THESE INSTRUCTIONS  
CAN RESULT IN DEATH, FIRE OR ELECTRICAL SHOCK.



**WARNING!**

RISK OF FIRE OR ELECTRIC SHOCK  
DO NOT OPEN



WARNING, TO REDUCE THE RISK OF FIRE OR ELECTRIC SHOCK, DO NOT  
REMOVE COVER (OR BACK)

NO USER-SERVICEABLE PARTS INSIDE  
REPAIR SHOULD BE DONE BY AUTHORIZED SERVICE PERSONNEL ONLY

## Descaling

**YOUR KETTLE WILL NOT WORK PROPERLY IF IT IS NOT DESCALED REGULARLY.**  
The warranty is voided if descaling is not carried out in accordance with these instructions.

Scale is a naturally occurring buildup of mineral deposits caused by impurities in water or use of hard water. The ideal descaling cycle depends on water hardness. Descal the Kettle every 60 uses. Regular descaling can also increase the service life of the Kettle, allowing it to boil water faster with less energy.

1. Fill Kettle with water to about 2/3 of the max line.
2. Bring solution to a boil.
3. Add descaling solution to fill Kettle to max line. (Descaling solution is available where household cleaning products are sold. We recommend using OXO On Descaling Solution,
4. Let sit for 15 minutes. Discard solution.
5. Rinse Kettle with fresh water. Let dry thoroughly.

available at OXO.com and major retailers that sell OXO On products. Follow the recommended use for solution to water ratio.)

## Cleaning, Care and Storage

### TO CLEAN YOUR KETTLE:

Any service or maintenance other than cleaning should be performed by an authorized service representative. For more information, call OXO Customer Service at 1-800-545-4411.  
**Always unplug power cord from outlet and allow Kettle to cool completely before cleaning.**

1. Rinse out Kettle.
2. Wipe the body of the Kettle with a damp cloth and dry completely with a soft dry cloth.
3. Your Kettle must be descaled every 60 uses. See instructions above.



#### CAUTION:

- To prevent damage to the appliance, do not use alkaline cleaning agents, abrasive pads, harsh chemicals or spray cleaner chemicals when cleaning. Use a soft cloth and mild detergent if desired.
- Do not clean any part of this appliance in the dishwasher.



**WARNING:** Never immerse the Kettle base, power base, power cord or plug in water, or allow liquid to come in contact with these parts.

### STORAGE:

Unplug power cord from outlet and allow Kettle to cool completely before storing. Follow cleaning instructions and store in an upright position. The cord wrap under the Kettle base can be used for tidy cord storage. Do not store anything on top of your Kettle. The Kettle may be stored on base when not in use.

---

## Our Guarantee

---

### TWO-YEAR WARRANTY:

We guarantee everything we make! Starting from the date of purchase, your OXO On Adjustable Temperature Pour-Over Kettle is guaranteed by OXO for two years in the case of any manufacturing defects in materials or workmanship. This OXO warranty is only offered on OXO On appliances sold new and utilized in the US and Canada.

The OXO warranty covers all costs related to restoring the proven defective product through the repair or replacement of any defective part and necessary labor so that it conforms to its original specifications. A replacement product may be provided instead of repairing a defective product. OXO's exclusive obligation under this warranty is limited to such repair or replacement.

**A receipt indicating the purchase date is required for any claims, so please keep it in a safe place.** We recommend that you register your product on our website, [www.oxo.com/registration.aspx](http://www.oxo.com/registration.aspx). Although greatly appreciated, the product registration is not required to activate any warranty and product registration does not eliminate the need for the original proof of purchase.

The warranty does not cover damages resulting from accident, alteration, misuse or abuse of the product and/or uses inconsistent with this Use and Care manual, attempts at repair, theft, use with unauthorized attachments or failure to follow the instructions provided with the product.

The warranty becomes void if: (1) the product is purchased used from a third party seller; or (2) attempts at repair are made by anyone other than OXO.

You may also arrange for service after the warranty expires at an added cost.

For questions, returns, repairs or warranty claims within the US, please visit [www.oxo.com](http://www.oxo.com) or contact OXO Customer Service at **(800) 545-4411**. We will be glad to assist you.

For customer service, claims or questions on sales in Canada, OXO Customer Service will gladly put you in touch with the appropriate individuals.

This warranty gives you specific legal rights, and you may have other legal rights which vary from state to state, country to country or province to province. The customer may assert any such rights at their sole discretion.

### CONTACT INFO:

If you have any trouble with the product during the warranty period, do not attempt to return it to a retail store. Instead, please visit us online at [www.oxo.com](http://www.oxo.com) or contact us at:

#### OXO U.S. Customer Service

**Hours:** Monday – Friday, 8:00am – 5:00pm (ET)

**Phone:** (800) 545-4411 **Fax:** (717) 709-5350

**Mail:** OXO International, Inc. at 1331 S Seventh St. Ste 4,  
Chambersburg, PA 17201-9912

**Email:** [info@oxo.com](mailto:info@oxo.com)

#### Outside the U.S.

Please contact your local distributor or email [info@oxo.com](mailto:info@oxo.com)

### REGISTRATION INFO:

For product registration, please visit us online at [www.oxo.com/registration.aspx](http://www.oxo.com/registration.aspx) or call toll free at **1-800-545-4411**.

Please be advised that as part of our privacy policy we never sell or give away your private information.

---

# Happy Pouring!

---



---

## It's On

---

For over 25 years, OXO's mission has been to provide innovative consumer products that make everyday living easier.

How do we do it? We study people – lefties and righties, male and female, young and old – interacting with products and we identify opportunities for meaningful improvement. Our “question everything” process and relentless attention to detail allow us to design products that help consumers make short work of everyday tasks.

We've applied the same philosophy to OXO On, our line of intelligent kitchen appliances. Through intuitive interfaces, innovative digital controls and backlit LED displays, our On appliances give you the simplicity, functionality and thoughtfulness you've come to expect from OXO...

...all with the touch of a button.

©2017

OXO International Ltd.

1 Helen of Troy Plaza

El Paso, TX 79912

Printed in China

IB-8717100-00