

**AQUA LUNG®**

**Military & Professional**

**2020-21  
BUYER'S GUIDE**





## Personal Aquatic Equipment for Professional and Recreational Use

Since 1943, Aqua Lung has been a leader in manufacturing equipment for adventure, fitness and safety whether in the water, on land or in the air. Each of our brands services the specific needs of our demanding customers through product innovation, worldwide distribution and customer service.

# AQUA LUNG®

---

## Military & Professional

The Aqua Lung Military & Professional (M&P) division focuses on key User Groups: Military, Public Safety & Commercial divers, Water Rescue & SAR personnel, and Aviation.

Our Product Categories include military rebreathers, open-circuit regulators, BCs, exposure wear (dry and wet), diving helmets, and a complete range of dive accessories including instruments, knives, masks, hoods, gloves, and fins.

Aqua Lung has a trusted name and a global reputation for reliability and performance.

Our global team of Subject Matter Experts (SME) stand ready to assist you.

### MILITARY & PROFESSIONAL BRANDS



[www.aqualung.com/militaryandprofessional](http://www.aqualung.com/militaryandprofessional)  
[www.aqualungdrywear.com](http://www.aqualungdrywear.com)



[www.apeksdiving.com](http://www.apeksdiving.com)



[www.gorskihat.com](http://www.gorskihat.com)



## Aqua Lung Canada – M&P Drywear



The former White's Manufacturing created a proud legacy of drywear innovation, quality, and performance in the most demanding environmental conditions. These attributes and White's unique DNA remain embedded in Aqua Lung M&P Drywear. Our drywear products offer an unparalleled, premium, dry use capability for professional divers and marine users globally.

*The legacy continues...*

# MILITARY & PROFESSIONAL BUYER'S GUIDE 2020-21



**AQUA LUNG CANADA**  
distributes these  
professional diving brands



## TABLE OF CONTENTS

<b>INTERSPIRO</b> DIVATOR (AGA) FULL FACE MASK .....	4-5
<b>APEKS</b> MTX REGULATORS.....	6
<b>APEKS</b> XTX REGULATORS .....	7
<b>APEKS</b> REGULATORS .....	8
<b>APEKS</b> SWITCH BLOCK .....	9
VALVES & ACCESSORIES .....	10-11
DIVE INSTRUMENTS .....	12
<b>LIGHT &amp; MOTION</b> SOLA DIVE LIGHTS .....	13
<b>OTS</b> THROUGH-WATER COMMUNICATIONS .....	14
<b>OTS</b> HARDWIRE COMMUNICATIONS .....	15
COMMUNICATIONS ACCESSORIES .....	16
DIVING UMBILICALS.....	17
PROFESSIONAL DIVING HARNESSSES .....	18-19
<b>KIRBY MORGAN</b> DIVE EQUIPMENT .....	20-21
UNDERWATER CUTTING & WELDING .....	22
BUMP HELMET & LOW AIR ALARM .....	23
BC'S & ACCESSORIES .....	24-34
SWIMMER VESTS .....	35
MASKS .....	36-37
SNORKELS.....	38
FINS .....	39-41
GLOVES - NEOPRENE .....	42-43
BOOTS - NEOPRENE.....	44
KNIVES .....	45-47
MISSION SPECIFIC EQUIPMENT .....	48-49
EMERGENCY BREATHING SYSTEMS (EBS).....	50
SURFACE-SUPPLIED DIVE SYSTEM .....	51
<b>AQUA LUNG DRYSUITS</b> .....	52-70
DRYSUIT SIZE CHART.....	71-72
DRYSUIT OPTIONS.....	73-75
DRYSUIT POCKETS.....	76
AQUA LUNG DRYSUIT BOOTS - SEPARATE .....	77
AQUA LUNG DRYSUIT BOOTS - ATTACHED .....	78
AQUA LUNG DRYSUIT UNDERGARMENTS.....	79-83
AQUA LUNG PONCHO.....	84
GLOVES - DRY .....	85
GLOVE RING SYSTEMS.....	86
THERMALS SOCKS & GLOVE LINERS.....	87
HOODS - NEOPRENE AND POLYTEX .....	88
DRYSUIT VALVES .....	89
DRYSUIT VALVES AND HOSES - NON MAG .....	90
DRYSUIT SEALS .....	91-92
DRYSUIT REPAIR ACCESSORIES .....	93
DRYSUIT BAGS.....	94
AQUA LUNG TERMS AND CONDITIONS .....	95

## DIVATOR (AGA) FFM

Proven design for use in arduous conditions, including cold weather/water and diving in Moderately Contaminated Water (MCW). The Interspiro Divator (AGA) MKII FFM is the global “industry standard” equipment for military & professional diving.

- Fully integrated 2nd stage regulator/breathing valve
- Positive and Non-Positive (demand) pressure versions
- Isolated inhalation and exhalation channels
- Double exhaust design
- Low volume visor reduces dead space
- Oral nasal ideal for underwater comms
- Fully compatible with OTS comms systems
- Natural Rubber skirt (NR - black) or silicon skirt (yellow, black)



Part #	Description
IS9631901	Divator Gold silicon FFM w/ 2nd stage (non-positive pressure)
IS9631902	Divator Gold silicon FFM w/ 2nd stage (positive pressure)
IS9631905	Divator Black silicon FFM w/ 2nd stage (non-positive pressure)
IS9631906	Divator Black silicon FFM w/ 2nd stage (positive pressure)
IS9631910	Divator Black NR FFM w/ 2nd stage (non-positive pressure)
IS9631911	Divator Black NR FFM w/ 2nd stage (positive pressure)

## DIVATOR OCTOPUS REGULATOR

- Non-positive pressure regulator design
- Locking lever holds mechanism closed and prevents free flow
- First breath activation of locking lever
- Black and yellow for easy identification
- Octopus Mouthpiece Holder prevents ingress of foreign material



Part #	Description
IS97199-02	Divator Octopus 2nd Stage Regulator, Black/Yellow w/ Mouthpiece
30780-01	Octopus Mouthpiece Holder Kit
AC50039	Octopus Regulator Hose, 39in, Black

## DIVATOR TECHNICAL SUPPORT AND TRAINING

- Aqua Lung Canada is the primary Interspiro Divator distributor for Canada
- A full range of spare parts and accessories is available from Aqua Lung Canada
- Overhaul/service kits and parts are available for purchase by trained technicians only
- A factory authorized 1-day Divator FFM service technician training course is available
- Full details on request





## AMBIENT BREATHING VALVES

- Designed to conserve diver's air supply when on surface
- 2 versions available: Interspiro Hatch and OTS ABV®
- Each supplied pre-attached to visor



Part #	Description
IS96962-01	Interspiro Divator Hatch ABV (fitted to Interspiro Visor)
IS460190710	Interspiro Divator Hatch Service Kit
OT910271-002	OTS-ABV2, Ambient Breathing Valve (fitted to Interspiro AGA FFM Visor)
OT920010-000	OTS-ABV2, Ambient Breathing Valve (fitted to OTS FFM Visor)
OT900409-000	OTS-ABV2 Service Kit

## DIVATOR ACCESSORY RAIL SYSTEM

- Accessory Rail fits easily to left or right hand side of the FFM
- Each rail accommodates up to 2 slide mounts
- Rail system does not interfere with Ambient Breathing Valve (if fitted)
- PLEASE ORDER ALL ITEMS SEPARATELY



Rail and slide mount with Interspiro Light

Part #	Description
30582-51	Rail Holder (Accessory Rail) for Interspiro AGA FFM Visor
920014-000	Rail Holder (Accessory Rail) for OTS FFM Visor
32316-51	Dive Light for Rail System
32315-51	Slide Mount for Light
30584-51	Universal Mount
30581-51	Welding Visor Note: Welding Visor requires qty 2 x Rail Holder

## ACCESSORIES AND SERVICE KITS

- OmniSwivel and Elbow - after market connectors adapt FFM to standard regulator hose
- OTS Mask Bag - protects FFM when not in use
- Interspiro Mini-Test Kit - for mandatory testing during regulator overhaul
- SERVICE KITS AND PARTS ARE AVAILABLE FOR PURCHASE BY TRAINED TECHNICIANS ONLY

Part #	Description
OT134153-001	OTS Mask Bag (for AGA FFM)
ISREG2KIT	Service Kit, Divator Mask w/ Breathing Valve (Universal - all regulators and FFM)
IS190128	Interspiro Mini-Test Kit
30004-51	Level Bar Tool (for AGA FFM)
IS190389	Regulator Hose, 29in. Black Divator (connects directly to 2nd stage regulator)
APF124563	Regulator Hose, MP, 3/8in x 30in, w/ Protector (connects to OmniSwivel)
OSSWA	OmniSwivel (fits Divator FFM)
OSELA	Elbow (fits Divator FFM)



OTS Mask Bag



Mini-Test Kit



OmniSwivel



Elbow (Recommended)



## MTX

The MTX is a military-grade regulator that is designed for frequent use in extreme conditions. The No Diver Control version provides the ultimate in straightforward operation coupled with legendary performance.

- CE certified (EN250A) for cold water use
- Nitrox/oxygen compatible

### MTX SECOND STAGE REGULATOR

- The MTX Second Stage is a derivative of the XTX200.
- MTX – No diver controls, pre-settable cracking effort
- MTX-V – Venturi diver controls, pre-settable cracking effort
- High performance pneumatically-balanced design
- Chrome and/or PVD brass plate front cover with over-moulded elastomer
- Large protective elastomer bumpers on the side and on the top
- Reversible for either a left or right hand gas supply
- Double swivel flexi hose for greater freedom of movement and comfort (standard hose also available)
- Moulded parts provide active protection against MRSA, E-Coli, bacteria and fungi
- Large heat exchanger fitted at hose connection
- Hard wearing, black PVD finish option available

### MTX FIRST STAGE REGULATOR

- The MTX First Stage is recommended for military and professional use
- Over-balanced design allows the medium pressure air output to increase at a rate faster than ambient pressure, resulting in superior performance at depth
- Environmentally sealed diaphragm system is fitted as standard to keep out water and contaminants, and to provide superior resistance to freezing
- Environmental over-moulded end cap prevents ice build-up
- Forged first stage body with heat exchanging ribs for maximum thermal performance
- Forged rotating turret with MP ports in parallel direction for improved hose orientation
- 5 x 3/8" UNF medium pressure ports
- 2 x 7/16" UNF high pressure ports,
- Angled HP ports for optimal hose routing



## SPECIFICATIONS

### Weight:

DIN connection (Total weight including hose) – 1.193kg (2.63lbs)

Yoke connection (Total weight including hose) – 1.339kg (2.95lbs)

### Maximum working pressure:

First stage DIN - 300 bar (4351 psi)

Yoke clamp connection - 232 bar (3365 psi)

### Medium supply pressure:

9-10 bar (131-145psi)

### Temperature Range:

Storage -30°C to 70°C (-22°F to 158°F)

Working Temperature 0.5°C to 55°C (32.9°F to 131°F)

Part #	Description
AP0286, AP0286S	MTX First and Second Stage set, No Adjustment - Yoke
AP0286V, AP0286VS	MTX-V First and Second Stage set, Venturi - Yoke
AP0287, AP0287S	MTX First and Second Stage set, No Adjustment - DIN
AP0287V, AP0287VS	MTX-V First and Second Stage set, Venturi - DIN
AP0290, AP0290S	MTX Second Stage, No Adjustment
AP0290V, AP0290VS	MTX-V Second Stage, Venturi control
AP0288, AP0288S	MTX First Stage - Yoke
AP0289, AP0289S	MTX First Stage - DIN
AP0298	Service Kit, MTX First Stage
AP0299	Service Kit, MTX Second Stage
NOTE: "S" stands for Satin finish	



## XTX200

The XTX200 is the definitive blend of style and high performance.

- CE certified (EN250A) for cold water use
- Compatible to EAN 40 new, out of the box
- **Second Stage regulator** is pneumatically-balanced with diver adjustable controls for opening effort and venturi control
- Superior performance and overall work of breathing
- Regulator can be reversed into left hand configuration
- Diver Changeable Exhaust (DCE) system allows the diver to change from large to smaller exhaust tee; larger exhaust tee provides the best exhaust bubble dispersion, while the smaller tee is lightweight and compact; both are included
- **First Stage regulator** is the proven FSR type
- Over-balanced design allows the medium pressure air output to increase at a rate faster than ambient pressure, resulting in superior performance at depth
- Environmental dry kit is fitted as standard to keep out water and contaminants, and to provide superior resistance to freezing
- 4 x 3/8" UNF medium pressure ports
- 2 x 7/16" UNF high pressure ports
- Reversible XTX second stage can mount to either side of the first stage



Part #	Description
AP0334F	XTX200 - Yoke - Regulator Set
AP0334F-1	XTX200 - DIN - Regulator Set
AP0363F	FSR (XTX200) First Stage - Yoke
AP0363F-1	FSR (XTX200) First Stage - DIN



## XTX 50

The XTX50 provides the benefits of a feature-rich regulator at a moderate price.

- CE certified (EN250A) for cold water use
- Compatible to EAN 40 new, out of the box
- **Second Stage regulator** is pneumatically-balanced with diver adjustable controls for opening effort and venturi control
- Regulator can be reversed into left hand configuration
- Diver Changeable Exhaust (DCE) system allows the diver to change from large to smaller exhaust tee; larger exhaust tee provides the best exhaust bubble dispersion, while the smaller tee is lightweight and compact; both are included
- **First Stage regulator** is the proven DST type
- Over-balanced design allows the medium pressure air output to increase at a rate faster than ambient pressure, resulting in superior performance at depth
- Environmental dry kit is fitted as standard to keep out water and contaminants, and to provide superior resistance to freezing
- DST regulator has 4 x MP ports on a rotating turret for optimal hose routing
- 4 x 3/8" UNF medium pressure ports
- 2 x 7/16" UNF high pressure ports



Part #	Description
AP0332F	XTX50 - Yoke - Regulator Set
AP0332F-1	XTX50 - DIN - Regulator Set
AP0361F	DST (XTX50) First Stage - Yoke
AP0361F1	DST (XTX50) First Stage - DIN
AP0527	DS4 First Stage - Yoke
AP0528	DS4 First Stage - DIN



## 1ST STAGE REGULATORS

- High performance 1st stage regulators ideally suited for professional use
- CE certified (EN250A) for cold water use
- Environmental dry kit is fitted as standard to keep out water and contaminants, and to provide superior resistance to freezing

### FSR 1ST STAGE REGULATOR:

- Flagship XTX200 model
- 4 x MP (all 3/8") ports, 2 x HP ports

### DST (DRY SEALED TURRET) 1ST STAGE REGULATOR:

- XTX50 model - the standard regulator used by the Canadian Forces
- 4 x MP (all 3/8") ports mounted on rotating turret, 2 x HP ports

### DS4 (DRY SEALED 4-PORT) 1ST STAGE REGULATOR:

- 4 x MP (all 3/8") ports, 1 x HP port
- Solid workhorse regulator



FSR 1st Stages



DST 1st Stages



DS4 1st Stages

Part #	Description
AP0363F	Apeks FSR (XTX200) 1st Stage - Yoke
AP0363F-1	Apeks FSR (XTX200) 1st Stage - DIN
AP0361F	Apeks DST (XTX50) 1st Stage - Yoke - All 3/8" Ports
AP0361F-1	Apeks DST (XTX50) 1st Stage - DIN - All 3/8" Ports
AP0527	Apeks DS4 1st Stage - Yoke
AP0528	Apeks DS4 1st Stage - DIN



## XTX40 OCTOPUS

- Pneumatically-balanced with diver adjustable venturi control only (for simplicity)
- CE certified (EN250A) for cold water use
- Left/right reversibility
- High visibility yellow accent front cover and 36" yellow hose
- Small exhaust tee fitted as standard

Part #	Description
AA0341F	XTX40 Octopus



## XTX50 OCTOPUS

- Pneumatically-balanced with diver adjustable control for opening effort and venturi control
- CE certified (EN250A) for cold water use
- Left/right reversibility
- High visibility yellow accent front cover and 36" yellow hose
- Small exhaust tee fitted as standard

Part #	Description
AA0342F-1	XTX50 Octopus







## BAILOUT SWITCH BLOCK

The Bailout Switch Block allows the diver to switch from a primary gas supply to an alternate bailout gas supply (Emergency Gas Supply – EGS). The switch block is used with any diving helmet or full face mask with a medium or low pressure gas supply.

### KEY FEATURES

- Robust, durable and reliable
- User friendly configuration and operation
- All ports marked for easy identification
- Use with surface supply umbilical or scuba cylinder
- CE approved to standard EN15333-1:2008

### PORTS

- 4 x standard 3/8 in MP outlet ports
- 1 x bailout inlet port with 3/8 in hose adapter (male)
- 1 x 1/2 in NPT dual use outlet/inlet port: see versions below

### MOUNTING ARRANGEMENT

- Universal mounting plate suitable for all diver harnesses
- Block retained in place by spring-loaded button catch
- Block easily removable from the harness mounting
- Mounting plate remains fixed to harness

### SWITCH BLOCK VERSIONS

**AP0281/G** For use with the Aqua Lung G3000SS diving helmet

**AP0281** For use with all other diving helmets; includes one way inlet valve and umbilical adapters

**AP0281-PS** Same as AP0281 but with single Scuba adapter, ideal for use with primary and secondary cylinder configuration (e.g. police Public Safety Diving)

Note: All Switch Block versions are supplied with a Mounting Plate

### FLOW RESTRICTOR

An optional flow restrictor is available for use with a suit inflator hose



AP0281-PS



AP0281-PS used with Full Face Mask



AP0281/G



Part #	Description
AP0281-PS	Switch Block w/Non-Return Valve and Scuba Adapter
AP0281	Switch Block w/Non-Return Valve and 4 Adapters
AP0281/G	Switch Block, G3000SS Helmet version
AP0283	Switch Block, Mounting Plate (spare)
AP0730	Flow Restrictor





**AQUA LUNG**  
**300 BAR DIN VALVE**



Part #	Description
054600	4350 DIN VALVE PVD

**AQUA LUNG**  
**PRO K VALVE**



Part #	Description
054605	3300 K PRO VALVE PVD

**AQUA LUNG**  
**TWIN MANIFOLD**



Part #	Description
054615	3300 TWIN MANIFOLD J PVD
054615NR	3300 TWIN MANIFOLD NO RESERVE PVD

**AQUA LUNG**  
**3300 J VALVE PVD**



Part #	Description
054594	3300 J VALVE PVD

Part #	Description
109804	Service Kit 3300 Twin Manifold PVD
109805	Service Kit 3300 J Valve PVD
109806	Service Kit 3300 K Valve PVD
109807	Service Kit 3500 DIN Valve PVD
109803	Activation Pull Rod

## AQUA LUNG / APEKS TECHNICIAN TRAINING

- A factory-authorized 1-day Aqua Lung / Apeks regulator service technician training course is available
- Full details on request
- Overhaul/service kits and parts are available for purchase by trained technicians only



## **APEKS** ADJUSTABLE PRESSURE RELIEF VALVE (APRV)

- Fully-adjustable relief valve
- Prevents gas hose from rupturing if first stage fails
- Recommended safety fitting for all diving operations
- Suitable for any first stage diving regulator
- Adjustable 175 – 245 psi (12 – 17 bar)
- Factory preset to 217 psi (15 bar)



Part #	Description
AP0849K	Adjustable Pressure Relief Valve
AP0251	SERVICE KIT (APRV)

## **APEKS** FLOW RESTRICTOR

- For use with a suit inflator hose
- Restricts air flow in event of hose failure



Part #	Description
AP0730	Flow Restrictor

## **APEKS** FREEFLOW CONTROL DEVICE

- Isolates freeflowing second stages
- Guards against unexpected air loss
- Gives total control of a frozen second stage
- Fits any second stage with standard hose fitting



Part #	Description
AP0233	APEKS Freeflow Control Device
AP0235	Freeflow Control Device, Black
AP02741	Freeflow Control Device, NBC/MIL, Black

## **APEKS** DIN TO YOKE CONVERTER

- Allows quick and easy conversion of existing DIN connector to Yoke without the need for tools



Part #	Description
AP0195	DIN to Yoke Converter

## **APEKS** DIN CONNECTORS & SERVICE KITS



AP0620



AP0211



AP0211/S

Part #	Description
AP0620	DIN Adapter - co-molded handwheel
AP0211	DIN Adapter - chrome
AP0211/S	DIN Adapter - satin
AP0298	Apeks MILPRO 1st Stage Service Kit - NEW FOR 2021
AP0299	Apeks MILPRO 2nd Stage Service Kit - NEW FOR 2021



Apeks analog gauges have strong housings with shock-resistant windows for durability. Gauges are available in imperial or metric units.

### SUBMERSIBLE PRESSURE GAUGE (SPG)

- Slimline gauge case made from nickel plated brass
- Large black figures on luminous background
- Overpressure relief fitted in back of gauge



Apeks SPG,  
Brass, 5000 psi



Console, SPG,  
Compass, 5000 psi

### 2-GAUGE CONSOLE: SPG AND DEPTH GAUGE

- Compact design with clear display
- Maximum depth indicator
- Maximum depth 230 ft (70M)

### 2-GAUGE CONSOLE: SPG AND COMPASS

- Two viewing windows and robust ratchet bezel
- Large, easy to read numbers



Console, 2 Gauge,  
5000 psi, 230 ft

NOTE: Also available in 3-GAUGE CONSOLE version



Aqua Lung analog gauges are durable and designed for ease of use. Gauges have luminescent faces and are available in imperial or metric units

### SUBMERSIBLE PRESSURE GAUGE (SPG)

- Air pressure and temperature in a single display
- Overpressure relief fitted in back of gauge

### 2-GAUGE CONSOLE: SPG AND DEPTH GAUGE

- SPG, depth gauge and writing slate
- Maximum depth indicator
- Maximum depth 200 ft (60M)

### COMPASS MODULE

- Add compass module to upgrade to 3-Gauge Console
- Large, easy to read numbers and side view window
- Secure 360° ratcheting bezel

NOTE: Compass is also available in wrist and bungee mount versions



Single Pressure Gauge BAR



Console 3 Gauge Analog METRIC



Compass, Wrist Mount

Part #	Description
AP0633IMP	Apeks SPG 5000 psi
AP0634IMP	Apeks Console, 2-Gauge, SPG 5000 psi, Compass
AP0635IMP	Apeks Console, 2-Gauge, SPG 5000 psi, 230 ft
AP0636IMP	Apeks Console, 3-Gauge, SPG 5000 psi, 230 ft, Compass
AP0633	Apeks SPG 360 Bar
AP0634	Apeks Console, 2-Gauge, SPG 360 Bar, Compass
AP0635	Apeks Console, 2-Gauge, SPG 360 Bar, 70M
AP0636	Apeks Console, 3-Gauge, SPG 360 Bar, 70M, Compass

Part #	Description
NS114123	Aqua Lung SPG - imperial
NS114117	Aqua Lung Console, 2-Gauge, SPG, Depth Gauge - imperial
NS114124	Aqua Lung SPG - metric
NS114118	Aqua Lung Console, 2-Gauge, SPG, Depth Gauge - metric, Compass
NS114115	Aqua Lung Compass, Module (order for Console)
NS114128	Aqua Lung Compass, Wrist Mount
NS114143	Aqua Lung Compass, Bungee Mount

## SOLA™ DIVE LIGHTS

SOLA™ DIVE lights are trusted and recognized as a premier underwater lighting option. These lights provide more power in a smaller package than any similar product on the market. An ideal choice for the professional diver.

### FEATURES

- Dual-beam: 12 deg Spot OR 60 deg Flood
- 3 power levels in each beam, plus SOS
- Factory sealed and tested
- Depth rated to 90 m (300 ft)
- 1 hour 45 min fast charge time
- Power management display
- Ballistic nylon hands-free strap included
- Pistol Grip and FFM Rail System options
- Weight approx 265 gr / 9.2 oz
- Supplied with smart charger and bag

#### SOLA™ DIVE 2500D

FLOOD	Lumens	Run-Time (min)
HIGH	2500	50
LOW	625	200
SPOT	Lumens	Run-Time (min)
HIGH	1200	50
LOW	300	200

#### SOLA™ DIVE 1200

FLOOD	Lumens	Run-Time (min)
HIGH	1200	70
LOW	300	280
SPOT	Lumens	Run-Time (min)
HIGH	500	70
LOW	125	280



SOLA LIGHT fitted to FFM Rail System

Part #	Description
850-0361-A	SOLA DIVE 2500 w/Hand Strap
850-0144-D	SOLA DIVE 1200D w/Hand Strap
800-0171-A	SOLA Pistol Grip Light Handle
800-0172-B	SOLA D-Ring Kit (use with rail slide)
920029-000	FFM Rail System Slide w/SOLA Mount

AQUA-LUNG CANADA IS THE  
EXCLUSIVE CANADIAN  
DISTRIBUTOR FOR



MORE PRODUCT INFORMATION ONLINE AT  
[WWW.LIGHTANDMOTION.COM](http://WWW.LIGHTANDMOTION.COM)



## WIRELESS SURFACE STATIONS

### AQUACOM® STX-101M SURFACE STATION

- State-of-the-art, multi-channel, portable surface station
- 8 selectable channels (single sideband), 10 watt power output
- Supplied with transducer, 35ft transducer cable and hand-held microphone
- Matched with Aquacom® SSB-1001B Diver Transceiver (8 channels)

### AQUACOM® STX-101 SURFACE STATION

- Portable surface station for professional dive teams
- 4 selectable channels (single sideband), 5 watt power output
- Supplied with transducer, 35ft transducer cable and hand-held microphone
- Matched with Aquacom® SSB-2010 and SSB-2001B-2 Diver Transceivers



Part #	Description
OTSTX101M	Aquacom STX-101M Surface Station
OTSTX101	Aquacom STX-101 Surface Station
OTTHB101	Headset with Boom Microphone (for STX-101/101M)



## DIVER TRANSCIVERS

### AQUACOM® SSB-1001B

- 10 watts, 8 channels
- Matched with STX-101M Surface Station
- VOX and PTT transmit control



### AQUACOM® SSB-2010

- 5 watts, 4 channels
- Matched with STX-101 Surface Station
- VOX and PTT transmit control



### EAR/MICROPHONE ASSEMBLIES FOR FFM

- Configured with Hi-Use OTS Connector, Hot Mic®, dual earphones and PTT button

Part #	Description
OT1001B1	Aquacom SSB-1001B Diver Transceiver
OT2010	Aquacom SSB-2010 Diver Transceiver
OT2001B2	Aquacom SSB-2001B-2 Diver Transceiver
OEMA2	EMA-2, Earphone/Microphone Assembly (for AGA FFM)
OEM-OTS2	Earphone/Microphone Assembly (for Guardian FFM)

**\*\*\* NEW FOR 2021 \*\*\***

### POWERCOM 5000D

- 35 watts, 8 channels
- Matched with STX-101M Surface Station
- VOX and PTT transmit control
- "Scrambler" mode
- Improved range



### POWERCOM 3000D

- 25 watts, 4 channels
- Matched with STX-101 Surface Station
- VOX and PTT transmit control
- "Scrambler" mode
- Improved range



NOTE: All diver transceivers convert to portable surface station with optional CDK-6 Surface Accessory Kit

## PORTABLE DIVER RECALL

- Ideal for control or recall of groups of divers
- Transmits solid tone or siren recall - up to 300M range
- Rugged housing and durable underwater speaker
- Includes PDR-100 Recall Unit, Underwater Speaker, Battery & Charger.

Part #	Description
900450	PDR-100, Portable Diver Recall w/battery & charger





## HARDWIRE SURFACE STATIONS

### AQUACOM® MK-III THREE DIVER INTERCOM

- Communicate with up to 3 divers simultaneously
- 4-wire (Round-Robin) mode
- Colour-coded panel with powerful speaker



MK-III

### AQUACOM® MK2-DCI - TWO DIVER AIR INTERCOM

- Compact, self-contained 2-diver air intercom system (stack up to 6 divers)
- Cross-talk, PTT, diver-select controls, 20 watt power output
- Nominal Battery Life: 20 hours continuous use



MK2-DCI

### AQUACOM® COMBOX - SINGLE DIVER AIR INTERCOM

- Compact, self-contained one diver air intercom system
- 2-wire (PTT) mode only, 20-watt power output
- Nominal Battery Life: 6 hours continuous use
- Powerful heavy-duty front panel speaker



Combox

### AQUACOM® MK-7 BUDDY-LINE PORTABLE AIR INTERCOM

- Compact and lightweight (1.5lb) 2-diver and tender hardwire air intercom
- 4-wire (Round-Robin) mode, 2 watt power output
- Nominal Battery Life: 12 hours continuous use
- Headset with boom microphone supplied as standard



MK-7 Buddy-Line

Part #	Description
OTMKIV	MK-IV - Three Diver Intercom
OTMK2DCI	Aquacom MK2-DCI - Two Diver Intercom
OTCOMBOX	Aquacom ComBox
OTMK7A	Aquacom MK-7 Buddyline System

Note: Photographs not fully to scale

## COMMUNICATIONS ROPE & CABLE

### COMROPE

- CR-4, 4-wire Communications Rope
- 100% polyester, 7/16" kernmantle rope,
- 4-wire shielded cables



Comrope

### FLOATING COMM CABLE

- Buoyant cable minimizes entanglement and reduces drag
- Aramid fiber braid / thermoplastic polyurethane jacket
- Breaking strength (rope with wire): 2592 lbs (1175 kg)
- 4-wire twisted, shielded pairs



Floating Comm Cable

### BAG

- Optional heavy-duty ComRope Bag holds up to 200ft of ComRope or Cable



Part #	Description
910073-001	ComRope, Blue (no connectors)
910073-002	ComRope, Yellow (no connectors)
602033-000	Floating Comm Cable, Yellow (no connectors)
602033-001	Floating Comm Cable, Blue (no connectors)
OTCRB1	ComRope Bag

NOTE: Please specify length (ft), connectors and colour when ordering

## OTS ACCESSORIES

### CDK-6, SURFACE ACCESSORY KIT

- Converts Diver Transceivers into portable surface station
- Dual earphone headset with boom microphone and built-in PTT control
- 55ft / 16.75m transducer cable



### WT-MK2, WIRELESS TENDER SYSTEM (NOT SHOWN)

- Allows tender freedom to move around
- Standalone base unit connects to intercom box, transmits to wireless transceiver unit
- Single earphone headset with boom microphone, 4-wire mode operation

### OTS COMMUNICATIONS GEAR BAG

- Protection for your communications equipment



### HI-USE CONNECTOR

- Easy to use and recommended for all underwater comms equipment



Part #	Description
OTCDK6	CDK-6, Surface Accessory Kit
OTWTMK2	WT-MK2, Wireless Tender System
OT134153-000	OTS Communications Gear Bag
OT900270-000	OTS Hi-Use Connector

## AQUA LUNG COMMS CABLES

- Aqua Lung Canada offers an assembly and testing service for underwater communications lines

### DUAL BANANA PLUG PIGTAIL ASSEMBLY

- Connects ComRope or umbilical comms cable to surface comms box
- 4-wire design: fitted with 2 x dual banana plugs and AMP pin or Hi-Use connector
- Nominal length 18in / 46cm
- For surface use only

AC-DBP



### HELMET COMMS WHIP (NOT SHOWN)

- Replacement underwater comms cable for Kirby Morgan helmets
- 4-wire design: fitted with OTS Hi-Use Connector
- Nominal length 24in / 61cm

AC-CRX



### COMROPE SURFACE EXTENSION LINE, 3M

- Connects ComRope or umbilical comms cable to MK-7 Buddyline unit
- 4-wire design, nominal length 3m / 9ft 10in
- For surface use only

Part #	Description
AC-DBP	Dual Banana Plug Pigtail Assembly w/ AMP Connector
AC-DBP2	Dual Banana Plug Pigtail Assembly w/ Hi-Use Connector
AC-WHIP	Helmet Comms Whip w/ Hi-Use and 2ft Cable (for KM helmet)
AC-CRX	ComRope Surface Extension Line, 3m w/ 1 x AMP-4 pin, 1 x AMP-4 socket
AC-CRX2	ComRope Surface Extension Line, 3m, w/ 1 x Hi-Use, 1 x AMP-4 socket

## STRENGTH-RATED DIVE UMBILICALS

Developed specifically for the Canadian diving market, these umbilicals comply with and surpass the requirements of the CSA Z275.2 Occupational Safety Code for Diving Operations, ADCI Consensus Standards, military specifications, and industry best practice.

Manufactured by Umbilicals International for Aqua-Lung Canada.

- Field-proven, high-strength comms cables
- High visibility colours
- Lightweight and ultra-flexible
- Kink-resistant and durable
- Small diameter and smooth profile for ease of use
- Easy to manage and easy to clean
- Thermoplastic outer jackets exceptionally resistant to degradation
- Wide operating temperature range: -20 deg C to +66 deg C



3-Part Umbilical UDAAQC0103



4-Part Umbilical UDAAQC0104

	UDAAQC0103	UDAAQC0104	UDAAQC0105
No. of Parts in Umbilical	3	4	5
Aquaflow 3/8" Gas Hose	√	√	√
Aquaflow 1/4" Pneumo Hose	√	√	√
Comms /Strength Cable	√	√	√
Basic Video Cable		√	√
Light/Power Cable			√
Rated Minimum Breaking Strength	<b>2200 lb / 1000 kg</b>		

Note: Other configurations and strengths are available - please contact us for details.

## UMBILICAL CONNECTIONS

Standard Fittings	Breathing Gas Hose - JIC #6 barb fittings (banded & tested)
	Pneumo Hose - JIC #4 barb fitting (banded)
	Comms/Diver end - Hi-Use Connector (see page 14)
	Comms/Surface end - AMP 4-Pin connector plus Dual Banana Plug Pigtail Assembly (see page 14)
Optional Fittings (available on request)	O2 fittings for hoses
	Marsh Marine for comms
	Strength-rated drop-forged D-rings (diver and surface ends)

## AQUA LUNG UMBILICAL PURGE KIT

- Designed to flush through diver's umbilical breathing gas hoses
- Prepares hoses for long term stowage using pure nitrogen (N2)
- Use prevents microbial growth and resists excess moisture ingress
- Regulator assembly delivers user-adjusted flow rate up to 15 LPM
- Connection hose 8 ft (2.4 m) and umbilical hose end-caps included



Regulator & Metering Valve Assembly



AC-UPK1 in Transit Case

Part #	Description
AC-UPK1	Aqua Lung Umbilical Purge Kit

## AQUALUNG® H3 DIVING HARNESS

- Strength-Rated Equipment Jacket - CSA and ADCI Compliant, CE Approved
- Multi-function professional diving harness/equipment vest
- Heavy duty with durable webbing and stainless steel hardware
- Dual-action release buckles for simple donning and doffing
- Permanently attached adjustable leg straps
- Extremely comfortable: designed for long endurance dives
- GripLock™ tank bands (2) with heavy duty metal buckles
- Holds single bailout cylinder (all sizes)
- All D-rings, located front and rear, are drop-forged not welded
- Recovery points: rear lifting D-ring (1), shoulder D-rings (2)
- Rated breaking strength: 2200 lb / 1000 kg / 9800 N
- Integrated weight system with dual-action weight release
- Top loading weight pouches can be inserted/removed by tender
- Max weight capacity 60 lb / 27.2 kg (total ditchable 50 lb / 22.7 kg)
- High visibility stitching for pre-use visual inspection
- Labeled with unique serial number, date of manufacture and strength rating
- Fully compliant with CSA, ADCI, IMCA standards and codes



## AQUALUNG® ACCESSORY POUCH

- Versatile pouch for tools and equipment
- Connects easily to harness D-rings
- 2 zipped pockets
- Neoprene sleeve
- 4 attachment clips



Accessory Pouch



Diver in HAZMAT  
COM drysuit  
wearing H3 Harness



Part #	Description
400800	Commercial Diving Harness (H3), complete, size 1 (L)
400801	Commercial Diving Harness (H3), complete, size 2 (XL)
400811	Commercial Diving Harness (H3), Hi-Vis, size 1 (L)
400812	Commercial Diving Harness (H3), Hi-Vis, size 2 (XL)
400807	Accessory Pouch w/ Clips
400803	Diver Recovery Bridle



## AQUA LUNG® H1 PERSONAL DIVER HARNESS

- Strength-rated working and recovery harness
- Robust and durable
- 5-point design is simple to don and adjust
- Designed for long duration use
- All D-rings, located front and rear, are drop-forged not welded
- Recovery points: rear lifting D-ring (1), upper chest D-rings (2)
- Rated breaking strength: 2200 lb / 1000 kg / 9800 N
- Maintains diver in heads-up position during recovery lift
- Attachment points: waist/lower chest D-rings (2)
- Padded sleeves on shoulders, waist and crotch for extended wear
- Adjustable waist belt
- Adjustable leg/crotch straps
- Can be worn underneath a BCD or vest/bell jacket
- When worn underneath a BCD or vest/bell jacket, the H1 allows outer equipment to be removed in an emergency while retaining positive control of the diver.
- Labeled with unique serial number, date of manufacture and strength rating
- Fully compliant with CSA, ADCI, IMCA standards and codes



Part #	Description
AMTC-H1035-BL	H1 Personal Diver Harness

## AQUA LUNG® DIVER RECOVERY BRIDLE

- For use with all diving harnesses and diving helmets
- Enables 2-point extraction/lift of diver
- Rated breaking strength: 2200 lb / 1000 kg / 9800
- Supplied with 3 carabiners for easy connection to lifting point and diver's harness



Part #	Description
400803	Diver Recovery Bridle



## DIVING HELMETS & BAND MASKS

• Aqua Lung Canada is an Authorized KMDSI Dealer, Training Provider and Repair & Service Centre

Part #	Description
DI500026	KMB 18B Band Mask w/Male WP Connectors
DI500029	KMB 28B Band Mask w/Male WP Connectors
DI500041	SL-27 Helmet w/ Male WP Connectors
DI500051	KM-37 Helmet w/ Male WP Connectors
DI500091	KM-77 Helmet w/ Male WP Connectors
DI500101	KM-37SS Helmet w/ Male WP Connectors
DI500701	KM-97 Helmet w/ Male WP Connectors



## COMMON ACCESSORIES FOR HELMETS & BANDMASKS

Part #	Description
DI505110	Replacement Sealed Pull Pin
DI525112	Pull Pin Sleeve Kit
DI525400	Welding Shield Assembly
DI525403	Welding Lens Kit
DI525765	Conversion Kit, 455 Regulator (for 350/450 Regulators)
DI525755	Tri-Valve Exhaust Kit, SL-27
DI525759	Quad-Valve Exhaust Kit, SL-17, KM37/57
DI525620	Regulator Tool Kit, SuperFlow/SuperFlow 350
DI525115	Threaded Insert Test Block Kit
DI525630	455 Regulator Tool Kit
DI555210	Restrictor Adapter (for LP Port)
DI300145	Manifold Block w/Scuba Adapter
255020	Quick Disconnect Hose Assembly



## OVERHAUL KITS AND REBUILD KITS

Part #	Description
DI525358	Soft Goods (Annual) Overhaul Kit, KMB-18/28
DI525360	Soft Goods (Annual) Overhaul Kit, SL-17A/B
DI525365	Soft Goods (Annual) Overhaul Kit, SL-27
DI525363	Soft Goods (Annual) Overhaul Kit, 17K/C & KM-37
DI525380	Soft Goods (Annual) Overhaul Kit, KM-37SS
DI525217	Soft Goods (Annual) Overhaul Kit, KM-57
DI525377	Soft Goods (Annual) Overhaul Kit, KM-77
DI525364	Soft Goods (Annual) Overhaul Kit, KM-97

Part #	Description
DI525309	Regulator Rebuild Kit, SuperFlow/SuperFlow 350
DI525767	455 Balanced Regulator Rebuild Kit
DI525311	Side Block Rebuild Kit
DI525-313	Stainless Steel Side Block Rebuild Kit (KM-37, 77, 97)
DI525330	One Way Valve Kit
DI325095	Manifold Block Rebuild Kit

• Soft Goods (Annual) Overhaul Kits contain all parts required for annual overhaul.  
• Rebuild Kits contain additional hardware that is not normally replaced annually.



## EARPHONE/MICROPHONE ASSEMBLIES

• Configured with Hi-Use OTS Connector, Hot Mic®, dual earphones

Part #	Description
OT900397-000	OTS Ear/Mic Assy for SL-17A/B Helmet, KMB18/28 Band Masks
OT900397-001	OTS Ear/Mic Assy for SL-27, KM-37,47,57 Helmets



Note: Photographs not to scale

## AUTHORIZED KMDSI DEALER

- Aqua Lung Canada is an Authorized KMDSI Dealer, Training Provider and Repair & Service Centre
- A full range of spare parts and accessories is available from Aqua Lung Canada
- Overhaul/service kits and parts are available for purchase by trained technicians only



## KMACS 5 AIR CONTROL PANEL

The Kirby Morgan Air Control System 5 (KMACS 5) is a lightweight portable control box for use in surface-supplied air diving operations. The KMACS 5 controls the air supply, communications (optional) and monitors the depth for 1 or 2 divers. There are 2 versions of the KMACS 5 panel - with or without comms.

- Air supply can be from HP cylinders (max 3000 psi Yoke, 3500 psi DIN)  
OR via LP connection (max 250 psi)
- Adjustable first stage regulator
- Variable pressure settings from 115 to 225 psi are obtainable
- Pneumo system with dual reading gauges for each diver
- Supply cylinders may be changed without interrupting dive
- Reliable and robust design and construction
- Lightweight, high impact polyethylene service case
- Corrosion resistant connections
- Weight: 54lb / 24.5kg (with comms fitted)
- Optional comms system - 2 or 4-wire
- Overhaul kit and servicing instructions now available



Part #	Description
DI400045	KMACS 5, No Communications
DI400046	KMACS 5, with Communications System
DI405175	Air Supply Hose Whip Assembly, Blue
DI405176	Air Supply Hose Whip Assembly, Yellow
DI440150	Gauge, 0-300 psi, LP
DI440155	Gauge, 0-5000 psi, HP
DI440010	Pneumo Gauge, Red
DI440011	Pneumo Gauge, White
DI425090	KMACS-5 Panel - Overhaul Kit
DI425120	Regulator Rebuild Kit, KMACS 5, DCS-2A, DCS-3

## **apeks** US4 35-BAR ADJUSTABLE FIRST STAGE REGULATOR

- For providing emergency air supply from HP cylinder to LP connection on panel
- Adjustable from 145 to 507 psi (10 to 35 bar)
- Surface use only
- Part # AP0519/US4



Note: Photographs not to scale

## KIRBY MORGAN TECHNICAL SUPPORT AND TECHNICIAN TRAINING

- A full range of spare parts and accessories is available from Aqua Lung Canada
- Overhaul/service kits and parts are available for purchase by trained technicians only
- Factory-authorized Kirby Morgan helmet, band mask, and air panel technician training courses are available on request



All KMDSI technician training is conducted by instructors certified by Dive Lab, Florida. Dive Lab is KMDSI's official training center for all KMDSI dealer repair and maintenance technician training

## BROCO UNDERWATER CUTTING EQUIPMENT

Part #	Description
BOBR22	BR-22 Underwater Oxy-Arc Cutting Torch
BOBR22PLUS	BR-22 PLUS Upgraded Underwater Oxy-Arc Cutting Torch
BOHVR401	HVR-4401 High Volume Oxygen Regulator
UW/KS	Single Pole Knife Switch, 400 amp
BOSPK-M	Mini Spare Parts Kit (for BR-22)
BOSPK-C	Complete Spares Kit (for BR-22)
BOBR22RCSK	Complete Spares Kit (for BR-22 PLUS)
BOTA2214	1/4" Torch Collet and Washer Kit
BOTA2238	3/8" Torch Collet and Washer Kit
BOTA2516	5/16" Torch Collet and Washer Kit
BO141825	UW-25 Ultrathermic Cutting Rods 1/4" x 18" (25lb box, qty 131)
BO381825	UW-25 Ultrathermic Cutting Rods 3/8" x 18" (25lb box, qty 66)
BO3818QP	UW-25 Ultrathermic Cutting Rods 3/8" x 18" (QuiverPak, qty 50)



## BROCO UNDERWATER WELDING EQUIPMENT

Part #	Description
BOBR20	Wet Welding Stinger - Electrode Holder (Movable Jaw)
BOBR21	Wet Welding Stinger - Electrode Holder (Compression Head)
<b>SofTouch® Premium Wet Welding Electrodes</b>	
BOUWCS1	1/8" SofTouch Welding Electrodes (8lb, approx 95 rods)
BOUWCS2	5/32" SofTouch Welding Electrodes (8lb, approx 69 rods)
BOUWCS3	3/16" SofTouch Welding Electrodes (8lb, approx 48 rods)
<b>EasyTouch® Wet Welding Electrodes</b>	
BOUWEZ1	1/8" EasyTouch Welding Electrodes (8lb, approx 95 rods)
BOUWEZ2	5/32" EasyTouch Welding Electrodes (8lb, approx 69 rods)
BOUWEZ3	3/16" EasyTouch Welding Electrodes (8lb, approx 48 rods)



## AQUA LUNG BUMP HELMET

The Aqua Lung Full Face Mask Bump Helmet was designed for professional divers using a full face mask in low visibility conditions or where overhead obstructions exist.

- Provides head bump protection in low or no visibility environments
- Fits over a Full Face Mask
- Does not obstruct comms, side rails, or ambient breathing valve
- Easy single-hand release chin strap for emergency ditching
- Internal removable pads to accommodate different size heads
- Hook and loop patches on sides and rear for logo placement
- Adjustable ratcheting head harness
- Reflective patches on each side
- Two light rails – one each side
- Front camera mount



Bump Helmet worn with Divator (AGA) FFM w/rail system and comms



Part #	Description
769490	Bump Helmet Tactical Black
769491	Bump Helmet Hi-Viz Yellow

## AQUA LUNG LOW AIR ALARM

Professional diving requires immense task focus and sometimes a diver can forget to check tank pressure. The Low Air Alarm is pre-set to alert the diver audibly and physically before the situation gets dangerous.

- Supplementary safety device
- Designed for use in low or zero visibility
- Signals diver when air supply drops to 1000 psi (69 bar)
- Emits loud buzzing noise and air bubbles
- No electronics to flood or fail
- Uses second high pressure port on first stage
- Can be turned off underwater
- Will operate for approximately 7 hours after activation
- Attaches to the BCD inflator hose
- Rubber attachment strap included



Part #	Description
108001	Low Air Alarm (1000 psi)



## AQUA LUNG BC1

The Aqua Lung BC1 is a rugged, weight-integrated, back inflation BC designed for military, public safety, and commercial divers. The BC1 is robust and durable and provides superior comfort, fit and stability.

### MODULAR HARNESS SYSTEM

- Removable back pad
- Non-swivel shoulder buckles

### CHANGEABLE WAIST/WEIGHT BELT SYSTEM

SureLock™ 1 weight release system (dependable and reliable)

### GRIPLOCK™ TANK BAND AND BUCKLE

- Secure
- Easy to adjust presets
- Macro and micro adjustments
- Finger saver safety feature
- Highly effective miniature traction pad

### AIR CELL/BLADDER

- Constructed from durable 840 Denier nylon
- Donut shape allows air to migrate left to right
- WTX K-style inflator, w/pull dump
- Four dump valves
- Removable and replaceable
- Three Over-Pressure Relief Valves (OPRV)
- Bladder retraction system
- Adjustable chest strap
- Left and right attachment points

### TOTAL WEIGHT CAPACITY

- All sizes can hold up to 42 lbs ( 19.0 kg) of weight as follows:
  - 32 lbs (14.5 kg) ditchable
  - 10 lbs (4.5 kg) non-ditchable

### LIFT CAPACITIES

- All sizes have a 52 lb (23.5 kg) lift capacity
- Twin cylinder capability



### OPTIONAL ACCESSORIES

Part #	Description	Size
304011	BC 1 W/SL 1, Black	SM
304012	BC 1 W/SL 1, Black	MD
304013	BC 1 W/SL 1, Black	ML
304014	BC 1 W/SL 1, Black	LG
304015	BC 1 W/SL 1, Black	XL

Part #	Description
427029	Accessory Pocket for Blk Diamond or BC1
427038	Optional Crotch Strap Kit
427047	Reflector Kit
D745915	Retractor
427107	Twin Cylinder Kit, Grip Lock
427030	Waistband Expander,BD/BC1(2 REQ'D)





## AQUA LUNG BC1 HI-VIZ

The Aqua Lung BC1 HI-VIZ model is a rugged, weight-integrated, back inflation BC designed for military, public safety, and commercial divers. The BC1 is robust and durable and provides superior comfort, fit and stability.

### MODULAR HARNESS SYSTEM

- Removable back pad
- Non-swivel shoulder buckles

### CHANGEABLE WAIST/WEIGHT BELT SYSTEM

- SureLock™ 1 weight release system (dependable and reliable)

### GRIPLOCK™ TANK BAND AND BUCKLE

- Secure
- Easy to adjust presets
- Macro and micro adjustments
- Finger saver safety feature
- Highly effective miniature traction pad

### AIR CELL/BLADDER

- Constructed from durable 840 Denier nylon
- Donut shape allows air to migrate left to right
- WTX K-style inflator, w/pull dump
- Four dump valves
- Removable and replaceable
- Three Over-Pressure Relief Valves (OPRV)
- Bladder retraction system
- Adjustable chest strap
- Left and right attachment points

### TOTAL WEIGHT CAPACITY

- All sizes can hold up to 42 lbs ( 19.0 kg) of weight as follows:
  - 32 lbs (14.5 kg) ditchable
  - 10 lbs (4.5 kg) non-ditchable

### LIFT CAPACITIES

- All sizes have a 52 lb (23.5 kg) lift capacity
- Twin cylinder capability

### OPTIONAL ACCESSORIES:

- See table on opposite page



Part #	Description	Size
304281	BC 1 W/SL 1,HI-VIZ YELLOW/GREEN	SM
304282	BC 1 W/SL 1,HI-VIZ YELLOW/GREEN	MD
304283	BC 1 W/SL 1,HI-VIZ YELLOW/GREEN	ML
304284	BC 1 W/SL 1,HI-VIZ YELLOW/GREEN	LG
304285	BC 1 W/SL 1,HI-VIZ YELLOW/GREEN	XL



## AQUA LUNG PRO QD M

The PRO QD M is a rugged, weight-integrated, jacket style BC designed with the Military / Public Safety diver in mind. Despite its heavy duty construction, it provides excellent comfort, fit and stability.

- Single bag construction made of durable 100 denier CORDURA®
- Colour - black or Hi-Viz yellow (see below)
- Lift capacity from 27 lbs (12.2 kg) to 61 lbs (27.7 kg)
- Six stainless steel D-rings
- Two large zipper pockets with pull cord
- SureLock™ 1 weight release system (dependable and reliable) plus non-ditchable trim weight pockets
- Knife grommets and instrument retractor attachment point on left pocket
- Two overpressure relief/dump valves



Part #	Description	Size
394031	PRO QD M, BLACK	SM
394032	PRO QD M, BLACK	MD
394033	PRO QD M, BLACK	ML
394034	PRO QD M, BLACK	LG
394035	PRO QD M, BLACK	XL
394036	PRO QD M, BLACK	XXL
427042	Twin Tank Kit	

## AQUA LUNG PRO QD M HI-VIZ

The Pro QD M Hi-Viz BC has all the features of the standard Pro QD M with the addition of Hi-Viz accent panels in and reflective tape on shoulder attachment loops.

The Hi Viz yellow is easier to spot on the surface and the colour absorption rate is better for use underwater, making it the preferred colour choice for public safety divers.



Part #	Description	Size
394381	PRO QD M, HI-VIZ, YELLOW	SM
394382	PRO QD M, HI-VIZ, YELLOW	MD
394383	PRO QD M, HI-VIZ, YELLOW	ML
394384	PRO QD M, HI-VIZ, YELLOW	LG
394385	PRO QD M, HI-VIZ, YELLOW	XL
394386	PRO QD M, HI-VIZ, YELLOW	XXL
427042	TWIN TANK KIT	



## AQUA LUNG BROTULA PSD JACKET BCD

- Single bladder design
- Constructed from tough Armoguard slick skin material:
  - Superior abrasion resistance
  - Fast drying
  - Resists bacterial growth
  - Smooth material is easy to clean and decon
- Swivel buckle shoulder straps for comfort
- Heavy duty breakaway carabiners
- Six stainless steel 2" D-rings
- Removable backpack pad
- Easy to clean
- WTX K-style inflator, w/pull dump
- Double pull zippered pockets on each side
- Two non ditchable weight pockets located on the tank band
- Three pull dumps, two front and one rear



Part #	Description	Size
394192	BC, BROTULA PSD, BLK	MD
394193	BC, BROTULA PSD, BLK	ML
394194	BC, BROTULA PSD, BLK	LG
394195	BC, BROTULA PSD, BLK	XL
427103	WT SYSTEM COMPLETE, 2 EA 10LB	



## APEKS WTX SERIES

The WTX Series is a selection of harnesses, buoyancy cells and accessories which offer unparalleled versatility due to the modular nature of the whole system. Each component can be configured into a customized rig to suit military and professional diving.

## WTX HARNESS

The WTX Harness is the most versatile in the WTX range.

- Can mount directly to a single cylinder using dual nylon cylinder bands or a single tank adapter
- Can accept an Apeks back plate for heavy loads such as twin steel cylinders
- Multiple grommet settings on the waistband allow the attachment of the SureLock™ weight system
- Open shoulder design allows diver to add or remove hardware for total customization
- Made from rugged 1050 denier ballistic nylon
- Removable crotch strap made of 2" (5 cm) soft webbing
- Six x 2" stainless steel D-rings (two, angled, on shoulders, two on hips and two on crotch strap)
- Six x 1" stainless steel D-rings along the sides for accessories
- Two x 1" stainless steel D-rings along the lower back for accessories
- Removable back pad
- Heavy duty stainless steel waist buckle
- Stainless steel triloaders distribute the load between the back, waist and shoulders for a great fit
- SOLAS reflector airway hold-downs can be removed or repositioned
- Chest strap as standard
- Includes two GripLock™ tank bands



WTX Series Twin Cylinder



WTX Harness

Part #	Description	Size
388090	WTX Harness, Small	S
388091	WTX Harness, Medium	M
388093	WTX Harness, Large	L
388095	WTX Harness, XL	XL

## WTX SIZE GUIDE

\*The figures in this guide are approximate, not absolute

SIZE	WAIST RANGE		OVER THE SHOULDER RANGE
	WTX Harness Only	WTX Harness w/ SureLock Wt System	Measured from center of the waistband front to center of waistband back
SM	29-60in / 74-152cm	33-60in / 84-152cm	34-43in / 86-109cm
MD	29-60in / 74-152cm	33-60in / 84-152cm	36-45in / 91-114cm
LG	32-60in / 81-152cm	36-60in / 91-152cm	40-49in / 102-125 cm
XL	34-60in / 86-152cm	38-60in / 97-152cm	42-51in / 107-130cm



## **APEKS** DELUXE ONE-PIECE WEBBED HARNESS

This simple, yet strong, harness can take the load of a fully rigged technical diver. It can be easily customized with the hardware of your choice.

- 12' of solid 2" (5 cm) webbing with center grommet
- 2" (5 cm) wide crotch strap
- 6 stainless 2" (5 cm) D-rings
- Includes neoprene shoulder protectors
- 2 elastic retaining loops on shoulders and one on crotch strap
- Heavy duty stainless waist buckle
- 6 stainless serrated retainers
- Tank bands not included - see GripLock Tank Bands

BACK PLATE NOT INCLUDED WITH DELUXE WEBBED HARNESS



Part #	Description
388040	Deluxe Webbed Harness

## **APEKS** WTX BACKPLATE - STEEL OR ALUMINUM

The backbone of any system-this cleverly designed back plate can be used with the webbed harness or inserted into the WTX Harness.

- Offered in either 304 stainless steel or 6061 anodized aluminum alloy.
- The stainless steel weighs approximately 5 lbs (2.2 kg)
- The aluminum weighs approximately 1 lb 11 oz (753 g)
- 4 each upper and lower slots accommodate nylon cylinder bands so a single cylinder can be strapped directly to the plate. Plate; having a series of 4 slots provides lateral stability of the cylinder that traditional 2 slot plates cannot
- 3 holes at top of plate offer a range of height adjustments for the buoyancy cells and cylinders; corresponding lower center slot allows for lower band bolts that are misaligned
- 2" wide crotch strap slot
- Upper and lower perimeter holes along either side and holes along the bottom allow for the mounting of accessories
- Both offer an electro-plate finish and a laser-etched Apeks logo to enhance the look of the plate



Part #	Description
388030	WTX Steel Back Plate
388028	WTX Aluminum Back Plate

## **APEKS** WTX SINGLE TANK ADAPTER (STA)

The single tank adapter is a great way to quickly attach a single cylinder to a back plate or the WTX harness.

- Made of 316 stainless steel
- Weighs 1 lb 1 oz (490 g) without hardware
- Includes two sets of bolts and one pair of washers and wing nuts
- 1" bolts for directly mounting to back plate
- 1.5" bolts for mounting to back plate inside WTX harness
- Tank bands not included - see GripLock Tank Bands



STA Mounted on Cylinder

Part #	Description
388029	WTX Single Tank Adapter

**apeks SINGLE CYLINDER WINGS (DONUTS)**

- Single cylinder wings designed for Public Safety Divers
- Lift capacities: 30 lb (13.6 kg) and 40 lb (18.1 kg)
- 360 degree bladder design allows air migration
- WTX K-style inflator/airway leads from left shoulder
- Constructed from tough Armoguard slick skin material
  - Superior abrasion resistance
  - Fast drying and resists bacterial growth
  - Smooth material is easy to clean and decon
- Same standard features as the buoyancy cells below
- WTX single tank adapter is not required



Part #	Description
388230	WTX-D30 PSD Wing
388240	WTX-D40 PSD Wing

**apeks WTX BUOYANCY CELLS**

- WTX buoyancy cells (bladders) are versatile and durable
- Buoyancy cells mate directly to WTX harness or back plates using twin tank bands or centre bolts
- 3 upper grommets allow various height settings coupled with a lower slot that compensates for misaligned bolts
- Outer bag constructed from 1000D Armorshield™ Cordura to resist abrasion and fading
- Inner bag constructed from mil-spec welded fabric
- Inflator leads from back top centre of cell; safety cable inside hose prevents hyperextension
- Highly efficient drains allow water to empty quickly after a dive
- 1 pull dump with 1 capped port or 2 pull dump valves
- Accepts WTX Internal Retractor Kit (part number: 388300)



Part #	Description
388345	WTX4, Buoyancy Cell, 1 Pull Dump/1 Cap, w/LP Inflator - 45lb (20.4kg) of lift, single or twin cylinders
388545	WTX4, Buoyancy Cell, 2 Pull Dumps, w/LP Inflator - 45lb (20.4kg) of lift, single or twin cylinders
388360	WTX6, Buoyancy Cell, 1 Pull Dump/1 Cap, w/LP Inflator - 60lb (27.2kg) of lift, twin cylinders only
388300	WTX Internal Retractor Kit

## **APEKS** SURELOCK™ WEIGHT SYSTEM

This popular accessory is ideal when it becomes necessary to add additional weight to your rig.

- Bolts directly to the WTX Harness
- Able to mount to the back plate with use of SureLock™ attachments
- Includes necessary attachment hardware, plus spares
- 2" stainless adjustable D-rings on the outside of each pocket
- Features the SureLock™ mechanical weight release buckles which prevent weights from releasing until you're ready
- Each pocket holds up to 10 lbs (4.5 kg) of lead
- Includes attachment grommets to mount your choice of Deep See knives



Part #	Description
388020	Apeks Surelock Weight System, 10 lbs

## **APEKS** SURELOCK™ ATTACHMENTS

This unique accessory allows you to mount the SureLock™ Weight System directly to the back plate.

- Includes necessary attachment hardware plus spares
- May be used without the SureLock™ Weight System to spread the weight of the cylinders over the hips
- Three different grommet settings allow for proper positioning of the SureLock™ weight pockets



Part #	Description
388045	WTX Surelock Weight System Attachments

## **APEKS** WTX TEK POCKETS

A full range of Tek pockets have been designed to complement the WTX range. They can be attached to your WTX system or any other BC/Wing and/or drysuit.

- The system is modular so you can attach one pocket to the other if space is at a premium; separately sold stainless steel hardware kit available for this
- Large pockets available in heavy duty hook and loop and zipper versions; allows for easy open/close even with thick gloves
- Pockets available: mesh, small cargo, large cargo, thigh

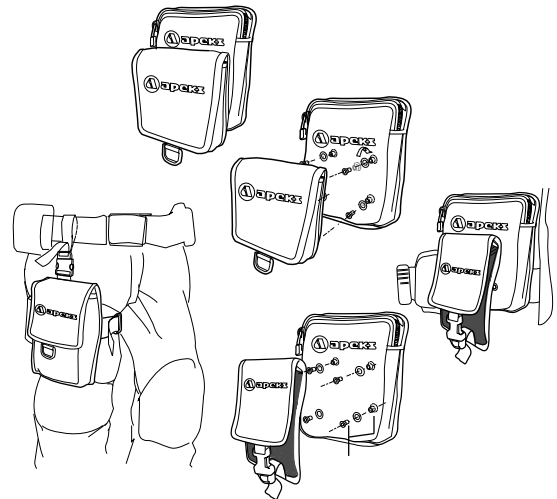

Part #	Description
388000	POCKET,MESH,WTX BC,APEKS
388005	POCKET,SMALL CARGO,WTX BC,APEKS
388010	POCKET,LARGE CARGO,WTX BC,APEKS
388015	POCKET,THIGH,WTX BC,APEKS
388018	KIT,BOLT/NUT 5 PACK FOR APEKS POCKETS

**BC SIZE GUIDE AND LIFT CAPACITY**

\* THE FIGURES IN THIS GUIDE ARE APPROXIMATE, NOT ABSOLUTE.

Model	Size	Height	Weight	Waist Range	Over the Shoulder	Total Weight	Releaseable Weight	Lift in Pounds	Lift in Newtons
<b>PRO QD M</b>	XS	5-5'5	100-125	25-37	32-38	20/9	20/9	27	120
	S	5'2-5'7	120-155	27-42	34-40	28/13	20/9	30	130
	M	5'7-5'10	150-165	30-45	39-45	30/13.5	20/9	35	150
	ML	5'10-6'0	160-190	32-47	41-47	30/13.5	20/9	38	160
	L	6'0-6'2	180-210	35-50	43-49	42/19	32/14.5	47	200
	XL	6'2-6'5	195-240	37-52	45-51	42/19	32/14.5	61	270
<b>BC 1</b>	XXL	6'2-6'5	230-270	44-59	45-51	42/19	32/14.5	61	270
	S	5'4-5'8	145-195	32-45	38-42	42/19	32/14.5	50	220
	M	5'7-5'11	160-210	34-47	40-44	42/19	32/14.5	50	220
	ML	5'9-6'2	175-220	36-49	42-46	42/19	32/14.5	50	220
	L	5'10-6'3	190-235	38-51	44-48	42/19	32/14.5	50	220
	XL	6'0-6'5	195-245	40-53	46-50	42/19	32/14.5	50	220

**MEASUREMENT INSTRUCTIONS**

Waist size in men is normally measured by placing the measuring tape around the waist, cresting the pelvic bone. This measurement is not accurate for BC fitting. The waist size in men should be measured at the height of the belly button just above the pelvic bone (Figure 1). Women's waist size is always measured just above the pelvic bone (Figure 1). This same measurement applies for BC fitting.

Over The Shoulder (OTS) measurement is taken by placing the measuring tape across either the right or left shoulder and reading the distance between the top of the waist line on the back to the top of the waist line in the front (Figure 2). Again, for this measurement in men the waistline is taken to be at the height of the belly button. When fitting the customer in his/her respective waist size and OTS range, inquire what thickness of wetsuit the BC is most likely to be worn with. Calculate about a 2" allowance for the waist measurements for thick, cold water suits.

FIGURE 1: Measuring points for waist size. FIGURE 2: Measuring points for OTS length.

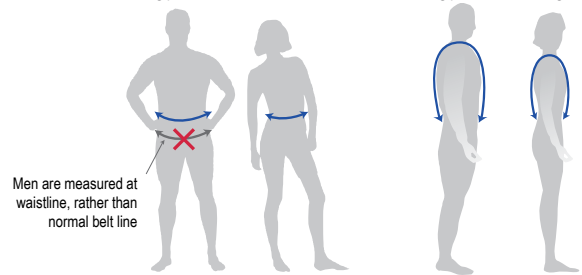



# CAP-OFF KIT, UNIVERSAL DUMP VALVE KIT, CO2 ASSEMBLY, MISC

## CAP-OFF KIT



Key #	Part #	Description
1	<b>15309</b>	<b>Gasket, Connector Seal</b>
2	15665	Cap, Connector, Acme Thread

Key #	Part #	Description
	42754	Universal Dump Valve Kit, Acme Thread
	42722	Universal Dump Valve Kit, Std Thread, Pre-1988
1	10079	Cap, Over Pressure
2	15617	Spring
3	15650	Plate
4	<b>15604</b>	<b>Seal</b>
5	12234	Pull Knob

## UNIVERSAL DUMP VALVE KIT

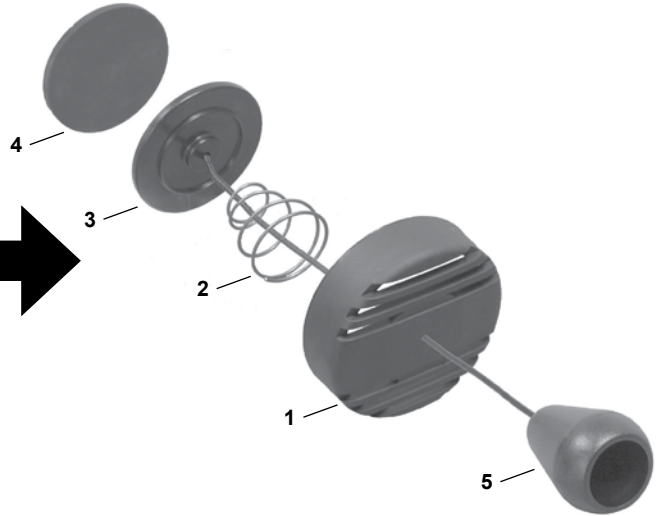

## CO2 ASSEMBLY

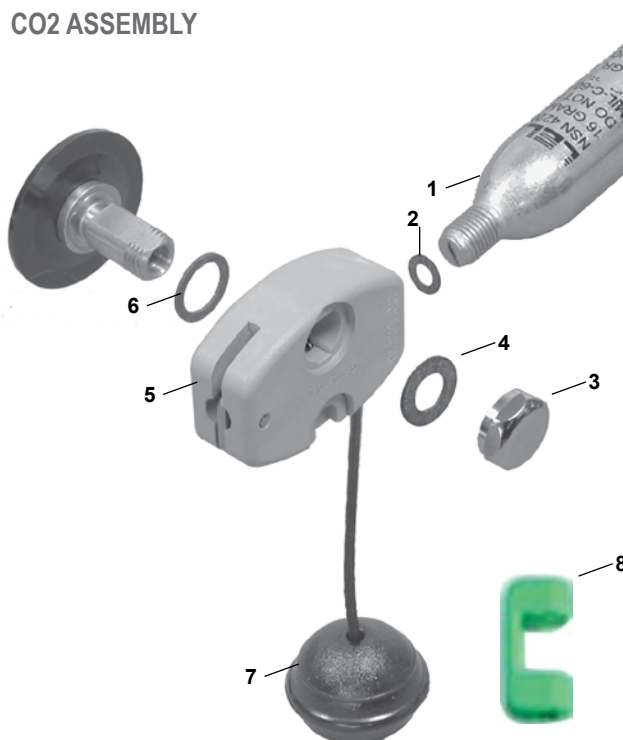

Key #	Part #	Description
1	13211	CO2 Cartridge, 16 gram
	13220	CO2 Cartridge ,38 gram
2	<b>13226</b>	<b>3/8 Gasket</b>
	<b>13227</b>	<b>1/2 Gasket</b>
3	13216	Nut
4	<b>15737</b>	<b>Nut Gasket</b>
5	13207	Detonator
6	<b>15738</b>	<b>Base Gasket</b>
7	12234	Pull Bob
8	13218	Green Clip

Part numbers in **BOLD ITALICS** indicate standard overhaul replacement part.

## AQUA LUNG GRIPLOCK™ TANK BAND

- Reliable and recommended solution for securing dive cylinder to a BC
- Modern design
- Easy to rig and adjust
- Durable metal buckle
- Innovative Finger Saver feature (patent pending) eliminates pinched fingers
- Macro-adjustment is set just once for each cylinder diameter
- Three presets cover the various diameter cylinders in the field today
- Micro-adjustment for fine tuning the fit after the band is on the cylinder
- Rubber traction pad on the backside of the GripLock™ provides added security
- Bands may be retrofitted to all BCs
- Two sizes available—select according to cylinder and BC type
- **NOTE:** GripLock™ tank bands are supplied packaged as single items



Part #	Description
428210	GripLock Tank Band, Long, non-Wrapture™ harness version, for PRO QD M, BC1, and WTX Harness
428230	GripLock Tank Band, Standard Length, Wrapture™ harness version, for WTX Back Plate w/ Deluxe One-Piece Webbed Harness

## AQUA LUNG SCOUT SWIMMERS VEST

- Designed for tactical surface swimming
- Oval neck for easy donning and doffing
- Military H harness straps with D-rings
- Two independent 38-gram CO2 inflators
- Oral inflation tube with locking ring
- Overpressure relief/dump valve
- Single bladder made of heavy duty 1000 denier nylon
- Large front pocket with hook and loop closure
- Attachment straps for emergency air
- Buoyancy 21 lbs (9 liters)
- Replacement CO2 cartridge available
- CO2 handles



Part #	Description
769031	Scout Swimmers Vest Mod 1

## AQUA LUNG RESCUE SWIMMERS VEST

- Designed for tactical surface swimming
- Oval neck for easy donning and doffing
- Quick-disconnect buckle on waist strap for easy in-water removal
- Strobe attachment straps (strobe not included)
- Two independent 38-gram CO2 inflators with beaded handles
- High flow oral inflator for rapid inflation/ deflation
- Single bladder made of heavy duty 1000 denier nylon
- Large front pocket with radio and glow stick retainer straps
- Buoyancy 18 lbs (8 liters)
- Available in black



Part #	Description
769045	SAR Rescue Swimmers Vest

## AQUA LUNG PARA SWIMMERS VEST

- For parachute or surface swimming
- Front panels wrap around empty bladder (Burrito-style)
- Military H harness straps with D-rings
- Two independent 38-gram CO2 inflators with beaded handles
- Large front pocket with hook & loop closure
- Overpressure relief/dump valve
- Single bladder
- Material: heavy duty 420 denier nylon
- Buoyancy 21 lbs (9 liters)
- Replacement CO2 cartridges available



Part #	Description
769041	Para Swimmers Vest Mod 1
769042	Vest, Maritime Swimmer

## AQUA LUNG VENTURA+

- Updated version of this classic mask
- Tempered single glass lens provides excellent visibility
- Patented cardanic joint buckles rotate up and down and in and out
- Counter-posed push-button activation for easy strap adjustment
- Black silicone skirt provides excellent seal



Part #	Description
503849	Ventura +, Blk Sil, Black

## AQUA LUNG TEKNIKA

- Two-piece shock-resistant frame with twin lenses
- Tempered single glass lens provides excellent visibility
- Outer frame made of shock-absorbing techno-polymer
- Patented cardanic joint buckles rotate up and down and in and out
- Counter-posed push-button activation for easy strap adjustment
- Black silicone, fold flat skirt provides excellent seal and fits into BC pockets



Part #	Description
505475	Teknika, Black/Black Silicone

## AQUA LUNG MICROMASK

- Ultra low volume, compact design with twin lenses
- Patented design places lenses in the ocular orbit
- Excellent visibility and easy to clear
- Patented cardanic joint buckles rotate up and down and in and out
- Counter-posed push-button activation for easy strap adjustment
- Black silicone, compact design provides excellent seal and fits into BC pockets



Part #	Description
505495	Micromask, Blk/Blk Silicone



## SPECTRUM FULL FACE MASK

- Offers value-for-money FFM capability, ideal for use with Apeks 2nd stage regulators
- Simple fitting method for regulator
- Tempered glass visor with wide field of view
- Comfortable double seal silicone skirt
- Communications port for OTS comms equipment
- CE certified for use with Apeks regulators



Part #	Description
920036-001	OTS Spectrum FFM, Black Skirt/Clear Lens
920036-101	OTS Spectrum FFM, Black Skirt/Coated Lens





## AQUA LUNG MAUI

- Low volume design
- Tempered single glass lens
- Excellent visibility
- Black silicone skirt provides excellent seal
- Popular mask for military and professional divers



Part #	Description
503350	Maui, Black/Black

## AQUA LUNG WRAPAROUND

- Modern version of this classic U.S. Divers design
- Black coated stainless steel frame
- Three tempered glass lenses for improved side visibility
- Black silicone skirt provides excellent seal



Part #	Description
502620	Wraparound, Black/Black

## AQUA LUNG PACIFICA

- Higher volume design
- Nose pockets and built-in purge valve
- Tempered single glass lens
- Excellent visibility
- Black silicone skirt provides excellent seal



Part #	Description
507810	Pacifica, Black/Black

## AQUA LUNG ATLANTIS II

- Medium volume, oval design
- Nose pockets to assist equalization
- Tempered single glass lens
- Excellent visibility



Part #	Description
507710	Atlantis II, Black/Black

## AQUA LUNG MASKS AND SNORKELS - REPLACEMENT PARTS

Part #	Description
	<b>TEKNIKA, MICRO MASK</b>
502537	Mask strap, clear, w/ retainers
502538	Mask strap, black, w/ retainers
505565	Cardanic buckles (pair)
	<b>WRAPAROUND, PACIFICA, ATLANTIS, MAUI</b>
507709	Mask strap, black silicone
502608	Metal Buckle Kit, Wraparound, Pair of 2

## AQUA LUNG IMPULSE 3

Since its introduction in 1989, the Impulse has been the best selling snorkel in the world. Today, after continued refinement and evolution, the Impulse 3 is more streamlined and higher performing than its predecessors, the Impulse and Impulse 2.

- The Impulse 3 uses a two valve system: if a wave breaks over the snorkel, the patented upper annular valve directs most water out before reaching the mouthpiece—any water that does get past drains out the lower valve
- The reservoir located below the mouthpiece keeps the breathing path clear of excess water; in the rare event you'll need to clear the snorkel, all it takes is an easy puff
- Patented comfo-bite mouthpieces, which eliminate jaw fatigue, are replaceable
- Also available in a non-flex, standard version



Impulse 3 Flex Snorkels

Part #	Description
734420	Impulse 3 Flex, Black/neon yellow
734370	Impulse 3, Flex, Black/Orange
734425	Impulse 3, Non Flex, Black/neon yellow
734590	Impulse 3, Flex, Black/Black
734595	Impulse 3, Non Flex, Black/Black

## AQUA LUNG MILITARY SNORKELS

- Classic and simple neoprene rubber design
- Flex tube or non-flex versions
- Secure keeper for mask strap



Part #	Description
736920	Military Snorkel, Black Neoprene
736930	Military Snorkel, Flex, Black Neoprene

## AQUA LUNG ROCKET II FINS

- Greatly improved design
- Flexible material construction for long distance swimming
- Neutrally buoyant
- Large foot pocket
- Grommet holes for hooking up fins
- Extremely popular with military and professional divers



Rocket II

Part #	Description	Size
621130	Rocket Fin II, Large	9-11
621135	Rocket Fin II, Super	12+
769460	Spring Strap Kit, WEB, MD, 2 each per package	
769061	Spring Strap Kit, WEB, LG, 2 each per package	
769062	Spring Strap Kit, WEB, XL, 2 each per package	

## AQUA LUNG SHREDDER SAR

- Special fin for water rescue, SAR swimming, and helo ops
- Heavy duty adjustable buckle with padded heel and leash
- Large foot pocket



Part #	Description	Size
621150	Shredder SAR, Yellow, Large	10 - 13
621155	Shredder SAR, Black, Large	10 - 13

## AQUA LUNG REPLACEMENT PARTS

Part #	Description
622680	Strap/Buckle Assy, Quick Release (1 each of strap and buckle)
621131	Metal Buckle Kit for Rocket II (pair of 2 for 1 fin)
621132	Fin Strap, Rocket II
621151	Shredder SAR Strap and buckle assy(Pair)
621120	Buckle Kit / Metal

## **APEKS® RK3 HD (HIGH DENSITY) FINS**

The RK3 HD fin is the latest in the RK3 offering. Made from a higher density material than the standard RK3, the RK3 HD fin is stiffer and heavier, making them the ideal fin for drysuit diving. The new, heavier compound makes them negatively buoyant and produces a stiffer blade, providing additional power in heavy currents or surf.

- Based on one of the first vented rubber fins sold in North America and popular among military and professional divers
- Compact, and ultra rugged for use in harsh environments
- Improved foot pocket with spring straps for ease of use with cold hands or thick gloves
- The design has been the standard gear issue fin for military, special ops, coast guard and public safety divers for decades
- Short, wide blade provides maximum forward thrust while maintaining great maneuverability
- Vented blade design reduces resistance on the upstroke and enhances thrust on the downstroke
- The vents also eliminate vortexes that can occur along the back of the blade much in the same way split fins eliminate the vortex
- The blade material is designed to hold up in the toughest environments, temperatures and abuse
- Two large grommet holes designed to fit most carabineers for easy storage of the fins
- Supplied as standard with spring straps
- Custom designed buckle holds spring straps in optimum position
- 3 sizes available: Medium (7-9), Large (9-11) and Super (12+)
- Colors: RK3 HD - Black, Orange, Hi-Viz Yellow



<b>Fin Material</b>	Thermoplastic Rubber
<b>Dimensions</b>	Medium - 19.15in L x 9in W Large - 21.5in L x 9.5in W Super - 22.5 in L x 9.5in W
<b>Weight (pair)</b>	Medium w/ Spring Straps - 5.25 lbs Large w/ Spring Straps – 6.25 lbs Super w/ Spring Straps - 6.75 lbs
<b>Buoyancy</b>	All Sizes with Spring Strap - Slightly Negative
<b>Buckle Attachment</b>	316 stainless steel nut and bolt
<b>Foot pocket</b>	Open heel design
<b>Spring straps</b>	Yes
<b>Vents</b>	Yes
<b>Colors</b>	Black, Gray

Part #	Description	Size
FA2487171M	Fins, RK3 HD, Hi-Viz Yellow (pr)	Medium
FA2487171L	Fins, RK3 HD, Hi-Viz Yellow (pr)	Large
FA2487171XL	Fins, RK3 HD, Hi-Viz Yellow (pr)	Super
FA2470101M	Fins, RK3 HD, Black (pr)	Medium
FA2470101L	Fins, RK3 HD, Black (pr)	Large
FA2470101XL	Fins, RK3 HD, Black (pr)	Super
FA2470808M	Fins, RK3 HD, Orange (pr)	Medium
FA2470808L	Fins, RK3 HD, Orange (pr)	Large
FA2470808XL	Fins, RK3 HD, Orange (pr)	Super



## **apeks RK3 FINS**

The RK3 fin's traditional all rubber design has been the choice of military, special operations, Coast Guard and public safety divers for decades. The RK3 blade material is formulated to hold up in the toughest environments, temperatures, and abuse. The short wide blade provides maximum forward thrust while maintaining great maneuverability. The vented blade design reduces resistance on the upstroke and enhances thrust on the downstroke. The fins are supplied as standard with stainless steel spring straps.

- Custom designed buckle holds spring straps in optimum position
- Custom buckle is attached with stainless steel nut and bolt
- Two large grommet holes on either end are designed to fit most carabineers
- 3 sizes available: Medium (7-9), Large (9-11) and Super (12+)
- Available in 4 colors: Black, White, Orange and Yellow

<b>Fin Material</b>	Thermoplastic Rubber
<b>Dimensions</b>	Medium - 19.15in L x 9in W Large - 21.5in L x 9.5in W Super - 22.5 in L x 9.5in W
<b>Weight (pair)</b>	Medium w/ Spring Straps - 2.25 lbs Large w/ Spring Straps - 2.75 lbs Super w/ Spring Straps - 2.75 lbs
<b>Buoyancy</b>	All Sizes with Spring Strap - Slightly Positive
<b>Buckle Attachment</b>	316 stainless steel nut and bolt
<b>Foot pocket</b>	Open heel design
<b>Spring straps</b>	Yes
<b>Vents</b>	Yes
<b>Colors</b>	Black, White, Orange and Yellow



Part #	Description	Size
621160	Fins, RK3, Black (pr)	Medium
621170	Fins, RK3, Black (pr)	Large
621180	Fins, RK3, Black (pr)	Super
621201	Fins, RK3, White (pr)	Medium
621203	Fins, RK3, White (pr)	Large
621205	Fins, RK3, White (pr)	Super
FA2480808M	Fins, RK3, Orange (pr)	Medium
FA2480808L	Fins, RK3, Orange (pr)	Large

Part #	Description	Size
FA2480808XL	Fins, RK3, Orange (pr)	Super
FA2480707M	Fins, RK3, Yellow (pr)	Medium
FA2480707L	Fins, RK3, Yellow (pr)	Large
FA2480707XL	Fins, RK3, Yellow (pr)	Super
621146	Spring Strap w/ Heel Pad, 2ea	Medium
621147	Spring Strap w/ Heel Pad, 2ea	Large
621148	Spring Strap w/ Heel Pad, 2ea	Super

## AQUA LUNG THERMOCLINE K-GLOVE

- Durable ballistic strength synthetic polymeron palms, fingers and back of fingertips for superior abrasion resistance
- Standard neoprene with glued and blindstitched seams
- Ergonomically designed pre-curved fingers helps minimize hand fatigue
- Adjustable cinch closure at wrist
- Available in 3 mm and 5 mm
- Packaged in a reusable mesh bag with hang tag



Part #	Model	Size
D330131	Men's 3 mm K-Glove	XS
D330132	Men's 3 mm K-Glove	SM
D330133	Men's 3 mm K-Glove	MD
D330135	Men's 3 mm K-Glove	LG
D330136	Men's 3 mm K-Glove	XL
D330137	Men's 3 mm K-Glove	XXL
Part #	Model	Size
D350132	Men's 5 mm K-Glove	SM
D350133	Men's 5 mm K-Glove	MD
D350135	Men's 5 mm K-Glove	LG
D350136	Men's 5 mm K-Glove	XL
D350137	Men's 5 mm K-Glove	XXL

## AQUA LUNG THERMOCLINE FLEX GLOVE

- Made entirely of HS200 high stretch neoprene that stretches to more than 200% of its original size for exceptional comfort, fit and dexterity
- Ergonomically designed pre-curved fingers help minimize hand fatigue
- Rubberized coating on palm for protection and added grip
- Available in 3 mm and 5 mm
- Packaged in reusable mesh bag with hang tag



Part #	Model	Size
D330121	Men's 3 mm Flex Glove	XS
D330122	Men's 3 mm Flex Glove	SM
D330123	Men's 3 mm Flex Glove	MD
D330125	Men's 3 mm Flex Glove	LG
D330126	Men's 3 mm Flex Glove	XL
Part #	Model	Size
D350121	Men's 5 mm Flex Glove	XS
D350122	Men's 5 mm Flex Glove	SM
D350123	Men's 5 mm Flex Glove	MD
D350125	Men's 5 mm Flex Glove	LG
D350126	Men's 5 mm Flex Glove	XL

## AQUA LUNG 5-FINGER HEAT NEOPRENE GLOVES

- 3 mm or 5 mm neoprene all around for warmth
- Closed-cell neoprene featuring gas filled micro bubbles for maximum warmth and dexterity
- Inside of the palm and fingers are lined with a Titanium Slick Skin (TSS)
- Pre-curved palm minimizes hand fatigue
- Dry Seam Construction (DSC) seams, glued, blindstitched, with external seam seal limits water flow

Part #	Description	Size
611890	Heat Series 3 mm Glove	XS
611888	Heat Series 3 mm Glove	S
611887	Heat Series 3 mm Glove	M
611886	Heat Series 3 mm Glove	L
611889	Heat Series 3 mm Glove	XL
611885	Heat Series 3 mm Glove	2XL
Part #	Description	Size
611896	Heat Series 5 mm Glove	XS
611894	Heat Series 5 mm Glove	S
611893	Heat Series 5 mm Glove	M
611892	Heat Series 5 mm Glove	L
611895	Heat Series 5 mm Glove	XL
611891	Heat Series 5 mm Glove	2XL



## AQUA LUNG 3-FINGER HEAT NEOPRENE MITTS

- 6 mm neoprene all around for warmth
- Closed-cell neoprene featuring gas filled micro bubbles for maximum warmth and dexterity
- Inside of the palm and fingers are lined with a Titanium Slick Skin (TSS)
- Pre-curved palm minimizes hand fatigue
- Dry Seam Construction (DSC) seams glued, blindstitched, with external seam seal limits water flow
- Environmentally-friendly packaging.

Part #	Description	Size
611900	Heat Series 6 mm 3-Finger Mitt	S
611899	Heat Series 6 mm 3-Finger Mitt	M
611898	Heat Series 6 mm 3-Finger Mitt	L
611901	Heat Series 6 mm 3-Finger Mitt	XL
611897	Heat Series 6 mm 3-Finger Mitt	2XL
612513	Heat Series 6 mm 3-Finger Mitt =	3XL



## AQUA LUNG 7MM SUPERZIP BOOT

The Superzip boot has an extra-thick sole, heavy-duty protective panels on the upper, and a durable zipper. This is the boot for a diver who needs to be prepared for cold water, rough terrain, and murky, low-viz underwater conditions that hide hazards.

- Ergonomic design with patented, anatomically correct ERGO™ shaped footbed and outsole
- Design matches foot profile, preventing excess water retention and providing support
- 7mm neoprene upper for warmth
- 8mm-thick treaded sole protects against punctures, stings, and slips
- Double thickness panels on heel cap, toe, and top of foot provides added protection and durability
- Hook and loop zipper lock keeps zipper in place
- Small number of seams, all placed away from the widest part of the foot, minimize chafing and maximize comfort
- Durable closures with a heavy-duty, non-corrosive #10 YKK zipper.
- Elastic binding at the top resists wear and tear



Part #	Description	Size
BS186014035	Boot, Superzip, 7MM	3
BS186014036	Boot, Superzip, 7MM	4
BS186014037	Boot, Superzip, 7MM	5
BS186014038	Boot, Superzip, 7MM	6
BS186014039	Boot, Superzip, 7MM	7
BS186014041	Boot, Superzip, 7MM	8
BS186014042	Boot, Superzip, 7MM	9
BS186014043	Boot, Superzip, 7MM	10
BS186014045	Boot, Superzip, 7MM	11
BS186014046	Boot, Superzip, 7MM	12
BS186014047	Boot, Superzip, 7MM	13
BS186014048	Boot, Superzip, 7MM	14

Note: Photographs not to scale



## AQUA LUNG ARGONAUT

Argonaut knives are some of the best and toughest knives available

### ARGONAUT - COMMON FEATURES

- Available in two sizes - the original Argonaut and the smaller sized Argonaut Stunt
- Blade details:
  - Available in two styles: the Spartan and the Blunt
  - Spartan has a spearhead point with rounded die-cut serrations on one edge
  - Blunt has a blunt chisel-like tip with rounded die-cut serrations on one edge
- Handle details:
  - Wrapped from the hilt to provide a spot for the forefinger and extra grip
  - Wrapped twice in 5 mm para-cord and tied off with a 5 in (12.7 cm) leash
  - Handle butt has a point for hammering and breaking
  - Handle skeleton holes are hex wrenches for emergency situations
- Sheaf details:
  - Locking design
  - Made from 2 mm thick Kydex thermoformed acrylic-polyvinyl material
  - Strap holes are 1 in (2.54 cm) long and ¼ in (0.63 cm) wide
  - Supplied with two rubber leg straps, 2 in belt loop extension, BC mount hardware



ARGONAUT STUNT



ARGONAUT



### ARGONAUT

- Blade is 4 7/8 in (12.4 cm) long and the handle is 4 7/8 in (12.4 cm) long
- Butt, handle, hilt and blade are made from one piece of 4 mm thick titanium, coated in black EDP, then sharpened and laser-etched

### ARGONAUT STUNT

- Blade is 3 in (7.6 cm) long and the handle is 4 in (10.1 cm) long
- Butt, handle, hilt and blade are made from one piece of 420 stainless steel, coated in black EDP, then sharpened and laser-etched



## AQUA LUNG NEOPRENE SHEATH

- 5mm Neoprene construction
- Skin-out neoprene back reduces slipping
- Supratex front is abrasion-resistant
- Two large fastex buckles for easy adjustment
- Double layer hook and loop attachment system
- 35" adjustable straps for thigh, calf or arm locations
- Compatible with most Aqua Lung dive knives
- One size fits most



Part #	Description
KN125111	Argonaut Stunt, Blunt
KN124111	Argonaut Stunt, Spartan
1003459	Argonaut Ti Blunt Tip
1003460	Argonaut Ti Spartan Tip
1003458	Neoprene Sheath

## AQUA LUNG BIG SQUEEZE

Aqua Lung Squeeze Lock dive knives are preferred by divers around the world. The patented Squeeze Lock design allows the diver to securely lock the knife in its sheath while offering a quick and easy release with a simple squeeze of the handle. The Big Squeeze knife has a 10.8 cm (4.5 in)...24.2 cm (9.5 in) long overall and can be easily mounted to integrated connection points on most Aqua Lung BCs.

- Patented locking mechanism securely locks knife in sheath, but releases easily with a squeeze of the handle (Patent # 5,926,959)
- 304 stainless steel or high-grade beta alloy titanium
- Nylon with fiberglass-fill handle and sheath for superior impact and abrasion resistance
- Leg strap channels
- 5.1 cm (2 in) locking clip
- Drain holes in sheath
- Lanyard holes



Part #	Description
KN117111	Big Squeeze, Spear Tip, Ti
KN115111	Big Squeeze, Blunt Tip, SS
KN116111	Big Squeeze, Sheeps Foot, SS
41942	Rubber leg straps, 24"

## AQUA LUNG SMALL SQUEEZE

Aqua Lung Squeeze Lock dive knives are preferred by divers around the world. The patented Squeeze Lock design allows the diver to securely lock the knife in its sheath while offering a quick and easy release with a simple squeeze of the handle. The Small Squeeze knife has an 8.9 cm (3.5 in) blade, is 17.8 cm (7 in) long and can be easily mounted to integrated connection points on most Aqua Lung BCs.

- Patented locking mechanism securely locks knife in sheath, but releases easily with a squeeze of the handle (Patent # 5,926,959)
- 304 stainless steel or high grade beta alloy titanium
- Nylon with fiberglass-fill handle and sheath for superior impact and abrasion resistance
- Leg strap channels
- 5.1 cm (2 in) locking clip
- Drain holes in sheath
- Lanyard holes



Part #	Description
KN123111	Small Squeeze, Spear Tip, Ti
KN121111	Small Squeeze, Blunt Tip, SS
KN122111	Small Squeeze, Sheeps Foot, SS
41942	Rubber leg straps, 24"

## AQUA LUNG MASTER KNIFE

- 7 inch serrated blade
- Stainless steel buttcap
- Plastic sheath

Part #	Model
422600	Master Knife
422441	Sheath
422603	Strap Assy.
422613	Ring Retrainer



## AQUA LUNG BIG SQUEEZE

- 4 1/2" blade, overall length 9 1/2"
- 304 series stainless steel or high grade beta alloy titanium
- Patented locking mechanism securely locks knife in sheath, but releases easily with a squeeze of the handle (Patent # 5,926,959)
- Variable mounting options including rubber leg straps, molded belt clip on sheath and optional barnacle nuts and bolts for mounting through fabric (part #416318 on Spare Parts List). Set of 2 nuts and 2 bolts)

Part #	Model
1002725	Big Squeeze Blunt Tip Charcoal
1002726	Big Squeeze Blunt Tip Yellow
1002728	Big Squeeze Drop Point Charcoal
1002729	Big Squeeze Drop Point Yellow
1002731	Big Squeeze Titanium Tanto Tip Charcoal
1002732	Big Squeeze Titanium Tanto Tip Yellow



## AQUA LUNG SQUEEZE LOCK

- 3" blade, overall length 6.5"
- 304 series stainless steel or high grade beta alloy titanium
- Patented locking mechanism securely locks knife in sheath, but releases easily with a squeeze of the handle (Patent #5,926,959)
- Variable mounting options:
  - Stainless steel barnacle nuts and bolts are included for mounting through fabric or for installation on BC with knife grommets
  - Hose mounting straps are included for mounting to the BC inflator hose
- Locking belt clip is integrated into sheath for attaching knife to webbing
- Sheath has molded strap slots for use with optional rubber leg straps

Part #	Model
1002712	Squeeze Lock Blunt Tip Blue
1002713	Squeeze Lock Blunt Tip Charcoal
1002716	Squeeze Lock Blunt Tip Yellow
1002717	Squeeze Lock Titanium Stiletto Tip Blue
1002718	Squeeze Lock Titanium Stiletto Tip Charcoal
1002719	Squeeze Lock Titanium Stiletto Tip Yellow
1002720	Squeeze Lock Titanium Tanto Tip Blue
1002721	Squeeze Lock Titanium Tanto Tip Charcoal
1002722	Squeeze Lock Titanium Tanto Tip Yellow



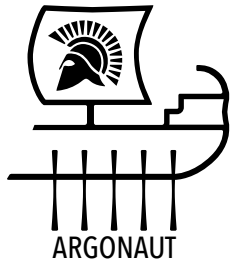

## CACHE MESH BAG

- Designed to accommodate most 4 hour rebreathers
- Two internal pockets
- 1 external mask pocket
- 1 external sand drape pocket to protect equipment when burying ashore
- Designed for use with Cache Stake
- Rugged shoulder strap
- Durable hydrophobic materials
- Exceptionally strong general use dive bag



FRONT



BACK

Part #	Description
100393	Cache Bag

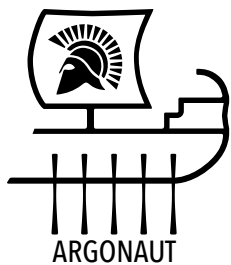

## CACHE STAKE

- Designed for subsurface anchoring of equipment
- Designed for use with Cache Bag
- Aluminum construction, strong but light removable tip--simply unscrew from shaft
- Integrated sliding cylindrical hammer
- Training tip without movable anchors available
- Carabiner not included

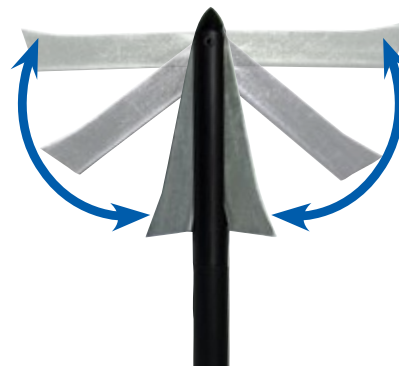

Part #	Model
100392	Cache Stake
100399	Tip, Training Argonaut Cache Stake
100400	Tip, Argonaut Cache Stake, Spare





## ARGONAUT ATTACK BOARD

The Aqua Lung Attack Board offers a precision compass mounted in a rugged, lightweight anodized aluminum frame that will accommodate a wide range of wrist-worn devices and board mounted compasses.



A product within the Argonaut line, designed by, with, and for maritime professionals

- Accepts at least three of the most popular board mounted compasses, user's choice:
  - BEN Marine C1150
  - Ritchie TAC-200-2
  - Brunton 70P
- Mounting slots for two wrist-worn devices, user's choice
- S&S Precision V-Lite™ illuminates both wrist devices and center compass mount
  - Battery provides up to 120 hours run time
  - Preset functions: Dim, bright, blink
- Lightweight, corrosion resistant, anodized aluminum frame
- Sighting post for quick peek bearing acquisition
- Large ergonomic handles designed to accommodate gloves and reduce fatigue
- Neutrally buoyant through use of adjustable neoprene protective compass sleeve
- Lanyard eyelet
- S&S Precision V-Lite™
- Illuminates both wrist devices and center compass mount

Part #	Model
742179	NAV BOARD
742170	NAV BOARD WITH V-LIGHT
742171	NAV BOARD WITH V-LIGHT AND BEN MARINE COMPASS
742172	NAV BOARD WITH V-LIGHT AND RITCHIE COMPASS
742174	NAV BOARD WITH V-LIGHT AND BRUNTON COMPASS
742175	V-LIGHT REPLACEMENT
742176	BEN MARINE COMPASS
742177	RITCHIE COMPASS
742180	BRUNTON COMPASS
742181	SCREW SS COMPASS MOUNT (4 PK)

## AQUA LUNG SURVIVAL EGRESS AIR (SEA)

- The Aqua Lung SEA is the most-used and trusted Compressed Air - Emergency Breathing System (CA-EBS) in the world
- Supplementary compressed air system for aircrew and passengers who fly over water
- Fully field-proven and in service world-wide with military and civilian operators
- Design uses best-practice hose and separate mouthpiece/second stage regulator
- Simple to deploy - hands-free operation - easy mouthpiece retrieval
- Low volume mouthpiece designed to ease clearing of water
- Lightweight (less than 3 lb / 1.4 kg)
- Aluminum cylinder for durability
- Operating pressure: 3000 psi (207 bar)
- Easy-to-read dial gauge
- Full range of support and service equipment available
- Designed and manufactured by Aqua Lung
- 1-day factory-certified technician training course available



108410

Part #	Description
<b>SEA WITH LV2 SECOND STAGE REGULATOR</b>	
108445	SEA/LV2, 1.5 cu ft Cylinder, Dial Gauge, 20 in Hose
108475	SEA/LV2, 1.5 cu ft Cylinder, Dial Gauge, 27 in Hose
108400	SEA/LV2, 2.0 cu ft Cylinder, Dial Gauge, 20 in Hose
108410	SEA/LV2, 2.0 cu ft Cylinder, Dial Gauge, 27 in Hose (offshore version)
<b>SEA WITH MK SECOND STAGE REGULATOR</b>	
108300	SEA-MK, 1.5 cu ft Cylinder, Dial Gauge, 20 in Hose
108320	SEA-MK, 2.0 cu ft Cylinder, Dial Gauge, 20 in Hose
108370	SEA-MK, 2.0 cu ft Cylinder, Dial Gauge, 27 in hose
<b>SEA SERVICE KITS (ONE OF EACH REQUIRED FOR SINGLE SEA UNIT)</b>	
108343	SEA 1st Stage Overhaul Kit
108344	SEA 2nd Stage Overhaul Kit
<b>SEA COMPRESSED AIR FILL ADAPTERS</b>	
108325	SCUBA Cylinder Fill Adapter, 3000 psi (207 bar)
M100656	Compressor Fill Adapter, 3000 psi (207 bar)
AP0649	DIN Fill Adapter, 3000 psi (207 bar)
102865	HP Fill Adapter w/bleed valve (requires hose and shut-off valve)
PRS21-712SS	HP Fill Assembly, complete w/hose, shut-off and bleeder valves
<b>SEA COMMONLY USED ITEMS</b>	
108373	Mouthpiece LV2
108453	SEA/LV2 Mouthpiece Cover
100653	SEA-MK Mouthpiece Cover
102810	Pressure Indicator, Dial, Black, 0-3000 psi (service life 5 years)
NS131111	Pressure Indicator, Dial, Black, 0-232 bar (service life 5 years)
100398	SEA Vice Insert
<b>SEA POUCHES</b>	
AMTC-P1224-BL	SEA Pouch, Waist Belt/Thigh Mount, 1.5 cu ft Cylinder
AMTC-P1270-BL	SEA Pouch, Waist Belt/Thigh Mount, 2.0 cu ft Cylinder
AMTC-P1168-BL	SEA Pouch, MOLLE Vest Mount, 1.5 cu ft Cylinder
AMTC-P1113-BL	SEA Pouch, MOLLE Vest Mount, 2.0 cu ft Cylinder
AMTC-P1059-BL	SEA Pouch, Zipped, MOLLE Vest Mount, 1.5 cu ft Cylinder



102810



108325



102865



AP0649



M100656



PRS21-712SS

Note: Photographs not to scale

## COMPLETE ENSEMBLE FOR PROFESSIONAL DIVING

FULLY-INTEGRATED DIVING SYSTEM FOR SURFACE-SUPPLIED DIVING.

### Aqua Lung Gorski G3000SS DIVING HELMET

Fitted with high performance Apeks 2nd stage regulator. Options include Free Flow conversion kit, accessory rails, and welding shield assembly.

### Aqua Lung H3 HARNESS

Strength-rated harness for umbilical attachment, bailout cylinder, weights, and diver recovery.



### Apeks DST 1st STAGE REGULATOR

Bailout regulator matched and certified with G3000SS Diving Helmet.

### Aqua Lung HAZMAT DRYSUIT

High performance suit for heavy diving tasks, including Contaminated Water Diving (CWD). Fitted with double exhaust and attached yoke for helmet.  
Colour: red/black or all black.

### Aqua Lung DRY GLOVES

Dry cuff ring system with inner and outer gloves for protection.

### Apeks SWITCH BLOCK

Harness-mounted. Allows diver to switch to Emergency Gas Supply (EGS) with either hand.

Optional helmet-mounted  
**Apeks SIDE BLOCK** available.

### Aqua Lung ROCKET II FINS

Large foot pocket fits over boots. Neutrally buoyant  
Optional spring strap kit.

## HAZMAT PUBLIC SAFETY

### PREMIER DRYsuit FOR CONTAMINATED WATER DIVING

The HAZMAT Public Safety (PS) Drysuit is designed with the professional diver in mind. Numerous police and fire departments have been using the HAZMAT PS Drysuit for over fifteen years. The HAZMAT PS incorporates many standard features that meet the professional diver's key requirements for durability and protection especially during Contaminated Water Diving (CWD) tasks.

Using high-performance chemical and abrasion resistant materials, as well as advanced construction techniques, the HAZMAT PS Drysuit provides two layers of water and chemical protection. All seams are reinforced, stitched, then heat sealed at over 600°C inside and out, producing an extremely durable drysuit. This construction results in a smooth interior and exterior surface which enables easy decontamination of most chemicals.

#### KEY FEATURES

- Chemical resistant polyurethane multi-laminate inside and out
- Interior and exterior tape welded seams
- Tear and puncture resistant nylon core
- Highest available abrasion resistance
- Attached 7mm neoprene comfort boots
- Seal Lock Technology (SLT) system fitted as standard:
  - Permanently attached round SLT wrist rings with replaceable Polytex Pro wrist seals
  - Permanently attached SLT neck ring with Polytex hood/neckseal combo
- Apeks contaminated water dual exhaust valve
- Apeks standard inflation valve
- Available in red/black or all black
- Optional convenience zipper
- Easy to clean and decontaminate inside and out
- Includes hood liner, internal suspenders, inflator hose, HAZMAT patch kit and a drysuit bag

#### SIZES

XS, S, SK, M, MT, MK, L, LT, LK, XL, XLK, 2XL, 3XL, 4XL

See online size chart for details

#### HAZMAT MULTI-LAMINATE MATERIAL

- Inner: fully sealed washable, chemical resistant polyurethane
- Interior and exterior tape welded seams
- Tear and puncture resistant nylon core
- Outer: fully sealed washable, chemical resistant polyurethane

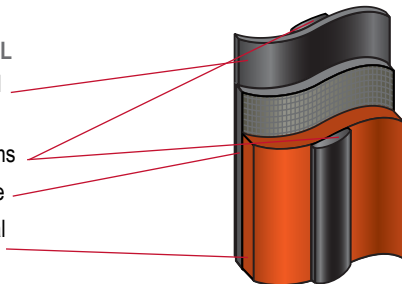

Part #	Description
611983	Drysuit, HAZMAT PS, Red/Black - Made To Order (MTO)
611984	Drysuit, HAZMAT PS, Red/Black - Made To Measure (MTM)
611985	Drysuit, HAZMAT PS, Black - Made To Order (MTO)
611986	Drysuit, HAZMAT PS, Black - Made To Measure (MTM)



EN 14225-2:2005



## HAZMAT COMMERCIAL

### PREMIER DRYsuit FOR CONTAMINATED WATER DIVING

The HAZMAT Commercial (COM) Drysuit is designed with the professional commercial diver in mind. The HAZMAT COM is equipped with a yoke for use with a diving helmet and provides durability and protection especially during Contaminated Water Diving (CWD) tasks. Using high-performance chemical and abrasion resistant materials, as well as advanced construction techniques, the HAZMAT COM Drysuit provides two layers of water and chemical protection. All seams are reinforced, stitched, then heat sealed at over 600°C inside and out, producing an extremely durable drysuit. This construction results in a smooth interior and exterior surface which enables easy decontamination of most chemicals.

#### KEY FEATURES

- Chemical-resistant polyurethane layer inside and out
- Interior and exterior tape welded seams
- Tear and puncture resistant nylon core
- Highest available abrasion resistance
- Attached heavy-duty poly boots
- Permanently attached round wrist rings with replaceable Polytex Pro wrist seals
- Apeks contaminated water (CW) dual exhaust valve
- Apeks standard inflation valve (CW version available)
- Suit is supplied with choice of attached helmet yoke to fit:
  - Kirby Morgan - all models
  - Aqua Lung/Gorski G3000SS
  - Miller, Desco Air hat
- Standard neck seal inside yoke
- Optional convenience zipper
- Optional heavy-duty steel toe and shank boots
- Available in red/black or all black
- Easy to clean and decontaminate inside and out
- Includes hood liner, internal suspenders, inflator hose, HAZMAT patch kit and a drysuit bag

#### SIZES

XS, S, SK, M, MT, MK, L, LT, LK, XL, XLK, 2XL, 3XL, 4XL

See online size chart for details

#### HAZMAT MULTI-LAMINATE MATERIAL

- Inner: fully sealed washable, chemical resistant polyurethane
- Interior and exterior tape welded seams
- Tear and puncture resistant nylon core
- Outer: fully sealed washable, chemical resistant polyurethane

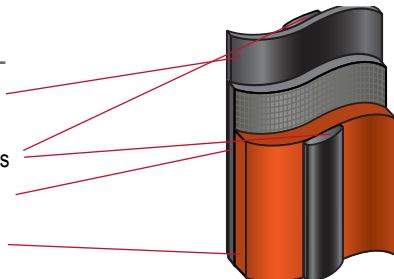

HAZMAT COM shown with fitted helmet neck ring (not included)

Part #	Description
611987	Drysuit, HAZMAT COM, Red/Black - Made to Order (MTO)
611988	Drysuit, HAZMAT COM, Red/Black - Made to Measure (MTM)
611989	Drysuit, HAZMAT COM, Black - Made to Order (MTO)
611990	Drysuit, HAZMAT COM, Black - Made to Measure (MTM)

**USN ANU  
APPROVED**



EN 14225-2:2005

## PRO COM

### DRYSUIT FOR THE PROFESSIONAL WORKING DIVER

The PRO-COM (Professional - Commercial) drysuit is a general purpose drysuit for everyday use. Developed from the premier Aqua Lung HAZMAT drysuit the PRO-COM provides exceptional durability in the harshest working conditions.

#### KEY FEATURES

- Exceptionally durable drysuit for everyday general purpose use
- Lightweight compared to other commercial diving suits
- Multi-laminate polyurethane material provides double water barrier
- Interior and exterior tape welded seams
- Tear and puncture resistant nylon core
- Highest available abrasion resistance
- Fitted Polytex neck and wrist seals
- Attached heavy-duty poly boots
- Apeks standard exhaust valve and standard inflation valve
- No yoke, hood, dry glove rings
- Optional convenience zipper
- Optional heavy-duty steel toe and shank boots
- Available in all black only
- Easy to clean inside and out
- Includes internal suspenders, inflator hose, patch kit and drysuit bag

#### SIZES

XS, S, SK, M, MT, MK, L, LT, LK, XL, XLK, 2XL, 3XL, 4XL

See online size chart for details

#### PRO COM MULTILAMINATE

- Inner: fully sealed washable, chemical resistant polyurethane
- Interior and exterior tape welded seams
- Tear and puncture resistant nylon core
- Outer: fully sealed washable, chemical resistant polyurethane

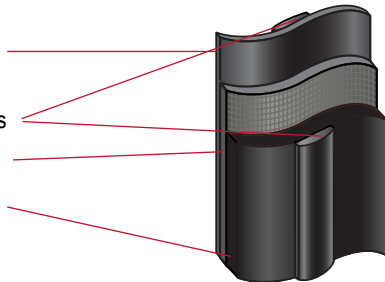

Part #	Description
611218	Drysuit, PRO-COM, Black - Made to Order (MTO)
611217	Drysuit, PRO-COM, Black - Made to Measure (MTM)



EN 14225-2:2005

## AQ-COM1

### DRYSUIT FOR THE PROFESSIONAL WORKING DIVER

The AQ-COM1 drysuit is designed for the professional working diver. The AQ-COM1 uses 7mm neoprene for durability and warmth together with high strength para-aramid panels in key wear areas. An ideal suit for cold water and cold weather diving tasks.

#### FEATURES

- Heavy duty 7mm neoprene
- Suit accommodates heavy duty undergarments
- Reinforced para-aramid neoprene:
  - Elbow/forearms
  - Shoulders
  - Buttocks
  - Legs (inner & outer)
- Neoprene skin-out (i.e. tuck style) neck and wrist seals
- Attached vulcanized rubber boots
- Apeks exhaust and inflate valves
- Inflation hose included
- Easy to repair
- Black/dark gray only



Part #	Description
404110	Drysuit, COM1/AQ, Black, Size SM
404111	Drysuit, COM1/AQ, Black, Size MD
404112	Drysuit, COM1/AQ, Black, Size LG
404113	Drysuit, COM1/AQ, Black, Size XL
404114	Drysuit, COM1/AQ, Black, Size XXL



EN 14225-2:2005

## ENVIRO

### FOR MODERATELY CONTAMINATED WATER DIVING

The ENVIRO Drysuit is used by divers working in Moderately Contaminated Water (MCW) scenarios including biologically contaminated water and vehicle recoveries. The ENVIRO provides mobility and flexibility. It is designed for the professional diver who needs a drysuit that can be thoroughly cleaned but is available at an economical price.

#### KEY FEATURES

- Chemical resistant polyurethane outer surface
- Sewn and exterior tape welded seams
- Tear and puncture resistant nylon inner surface
- High level of abrasion resistance
- Easy to clean and decontaminate
- Attached 7mm neoprene comfort boots
- Seal Lock Technology (SLT) system fitted as standard:
  - Permanently attached round SLT wrist rings with replaceable Polytex Pro wrist seals
  - Permanently attached SLT neck ring with Polytex hood/neckseal combo
- Apeks standard exhaust valve and standard inflation valve
- Available in red/black or all black
- Optional convenience zipper
- Includes hood liner, internal suspenders, inflator hose, HAZMAT patch kit and a drysuit bag

#### SIZES

XS, S, SK, M, MT, MK, L, LT, LK, XL, XLK, 2XL, 3XL, 4XL

See online size chart for details

#### ENVIRO BI-LAMINATE MATERIAL

- Tear and puncture resistant nylon inner
- Outer: fully sealed washable, chemical resistant polyurethane layer
- Smooth exterior seams

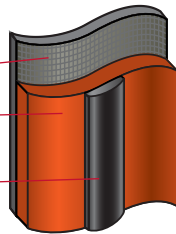

Part #	Description
611216	Drysuit, ENVIRO, Red/Black - Made to Order (MTO)
612215	Drysuit, ENVIRO, Red/Black - Made to Measure (MTM)
611355	Drysuit, ENVIRO, Black - Made to Order (MTO)
611354	Drysuit, ENVIRO, Black - Made to Measure (MTM)



EN 14225-2:2005



## ENVIRO HYBRID

### FOR MODERATELY CONTAMINATED WATER DIVING

The ENVIRO HYBRID Drysuit combines the technologies of the HAZMAT and the ENVIRO into one suit. The HAZMAT's outstanding durability covers the complete bottom of the suit from the waist seam down and the lightweight mobility of the ENVIRO material completes the top of the suit. This combination allows for great upper body movement for swimming while giving superior protection in lower extremities where the suit takes most abuse.

#### KEY FEATURES

- HAZMAT multi-laminate bottom for superior abrasion resistance
- ENVIRO bi-laminate top for superior mobility and flexibility
- Chemical resistant polyurethane outer surface
- Exterior tape welded seams
- Tear and puncture resistant nylon inner surface
- Easy to clean and decontaminate
- Attached 7mm neoprene comfort boots
- Seal Lock Technology (SLT) system fitted as standard:
  - Permanently attached round SLT wrist rings with replaceable Polytex Pro wrist seals
  - Permanently attached SLT neck ring with Polytex hood/neckseal combo
- Apeks standard exhaust valve and standard inflation valve
- Available in red/black or all black
- Optional convenience zipper
- Includes hood liner, internal suspenders, inflator hose, HAZMAT patch kit and a drysuit bag

#### SIZES

XS, S, SK, M, MT, MK, L, LT, LK, XL, XLK, 2XL, 3XL, 4XL

See online size chart for details

#### ENVIRO BI-LAMINATE MATERIAL

- Tear and puncture resistant nylon inner
- Outer: fully sealed washable, chemical resistant polyurethane layer
- Smooth exterior seams

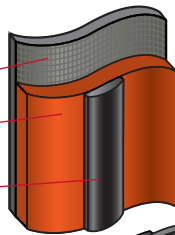

#### HAZMAT MULTI-LAMINATE MATERIAL

- Inner: fully sealed washable, chemical resistant polyurethane
- Interior and exterior tape welded seams
- Tear and puncture resistant nylon core
- Outer: fully sealed washable, chemical resistant polyurethane

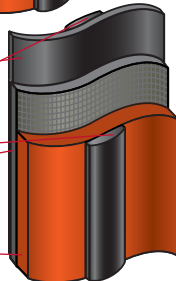

ENVIRO HYBRID shown with optional convenience zipper

Part #	Description
612214	Drysuit, ENVIRO HYBRID, Red/Black - Made to Order (MTO)
612216	Drysuit, ENVIRO HYBRID, Red/Black - Made to Measure (MTM)
612215	Drysuit, ENVIRO HYBRID, Black - Made to Order (MTO)
612217	Drysuit, ENVIRO HYBRID, Black - Made to Measure (MTM)



EN 14225-2:2005

## FUSION TACTICAL

### FIELD-PROVEN DRYSUIT FOR TACTICAL USE

The FUSION TACTICAL drysuit uses patented Fusion technology to offer the ultimate in mobility, warmth, and streamlining. There is no comparable drysuit that can match the performance of this revolutionary design.

#### HOW IT WORKS

Inner layer (standard DryCore or breathable AirCore) is a loose fit shell drysuit incorporating seals, dry zipper, air inflation and exhaust valves to create the waterproof barrier.

Outer layer (exterior skin) made with durable stretch fabrics is attached to the inner layer at the wrists, ankles and dry zipper. This compression layer creates the streamlined fit of the Fusion with unmatched flexibility.

#### KEY FEATURES

- Unmatched flexibility and streamlined design
- Exterior 1mm super stretch neoprene skin, reinforced for high wear
- Removable 2mm neoprene inserts for the elbows and knees
- Multi-Laminate Shell Socks (ideal for use with FUSION2 or EVO4 Boots - purchase separately)
- All black with no reflective piping
- Apeks exhaust and inflate valves
- Twin zip pockets are standard
- Convenience zipper is standard
- Includes internal suspenders, inflator hose, and drysuit bag
- Available in standard DryCore or breathable AirCore versions
- Surface swimmer versions available (no valves)
- Non-Magnetic version available for MCM and EOD use

#### SIZES

2XS/XS, S/M, L/XL, 2XL/3XL, 4XL+ (see online size chart)

#### OPTIONAL SLT SYSTEM

- Part no. 62461, SLT system w/silicone neck and round wrist rings
- Part no. 62949, SLT system w/Polytex neck and round wrist rings
- Part no. 62950, SLT system w/silicone neck and oval wrist rings
- Part no. 62951, SLT system w/Polytex neck and oval wrist rings



FUSION TACTICAL Dive shown with optional SLT neck ring system, wrist rings, EVO4 boots

Part #	Description
611529	Drysuit, Fusion Tactical Dive, Black, 2XS/XS
611028	Drysuit, Fusion Tactical Dive, Black, S/M
611027	Drysuit, Fusion Tactical Dive, Black, L/XL
611528	Drysuit, Fusion Tactical Dive, Black, 2XL/3XL
611530	Drysuit, Fusion Tactical Dive, Black, 4XL+
612524	Drysuit, Fusion Tactical Dive, AirCore, Black, 2XS/XS
612525	Drysuit, Fusion Tactical Dive, AirCore, Black, S/M
612526	Drysuit, Fusion Tactical Dive, AirCore, Black, L/XL
612527	Drysuit, Fusion Tactical Dive, AirCore, Black, 2XL/3XL
612528	Drysuit, Fusion Tactical Dive, AirCore, Black, 4XL+



EN 14225-2:2005

## FUSION TACTICAL MCM

### NON-MAGNETIC DRYsuit FOR MCM AND EOD

The FUSION TACTICAL MCM drysuit uses patented Fusion technology to offer the ultimate in mobility, warmth, and streamlining. There is no comparable drysuit, that can match the performance of this revolutionary design.

#### HOW IT WORKS:

Inner layer (standard DryCore or breathable AirCore) is a loose fit shell drysuit incorporating seals, dry zipper, air inflation and exhaust valves to create the waterproof barrier.

Outer layer (exterior skin) made with durable stretch fabrics is attached to the inner layer at the wrists, ankles and dry zipper. This compression layer creates the streamlined fit of the Fusion with unmatched flexibility.

#### KEY FEATURES

- Unmatched flexibility and streamlined design
- Exterior skin 1 mm super stretch neoprene, reinforced for high wear
- Removable 2 mm neoprene inserts for elbows and knees
- Multi-Laminate Shell Socks (ideal for use with FUSION2 or EVO4 Boots - purchase separately)
- All black with no reflective piping
- Twin zip pockets are standard
- Convenience zipper is standard
- Includes internal suspenders, inflator hose, and drysuit bag
- Available in standard DryCore or breathable AirCore versions

#### NON-MAGNETIC (NM OR MCM) SPECIFICATION

- All materials and components designed to meet requirements of: NATO STANAG 2897 and USN standard MIL-DTL-19595
- Fitted with Apeks NM suit valves and hose
- NM Suit Inflation Systems (SIS) available

#### SIZES

2XS/XS, S/M, L/XL, 2XL/3XL, 4XL+ (see online size chart)

#### OPTIONAL SLT SYSTEM (SPECIFY SEPARATELY)

- Part no. 62461, SLT system w/silicone neck and round wrist rings
- Part no. 62949, SLT system w/Polytex neck and round wrist rings
- Part no. 62950, SLT system w/silicone neck and oval wrist rings
- Part no. 62951, SLT system w/Polytex neck and oval wrist rings

Part #	Description
611965	Drysuit, Fusion Tactical MCM Dive, Black, 2XS/XS
611966	Drysuit, Fusion Tactical MCM Dive, Black, S/M
611535	Drysuit, Fusion Tactical MCM Dive, Black, L/XL
611967	Drysuit, Fusion Tactical MCM Dive, Black, 2XL/3XL
611968	Drysuit, Fusion Tactical MCM Dive, Black, 4XL+
612534	Drysuit, Fusion Tactical MCM Dive, AirCore, Black, 2XS/XS
612535	Drysuit, Fusion Tactical MCM Dive, AirCore, Black, S/M
612536	Drysuit, Fusion Tactical MCM Dive, AirCore, Black, L/XL
612537	Drysuit, Fusion Tactical MCM Dive, AirCore, Black, 2XL/3XL
612538	Drysuit, Fusion Tactical MCM Dive, AirCore, Black, 4XL+



FUSION TACTICAL MCM shown with optional SLT neck ring system, wrist rings, EVO4 boots



EN 14225-2:2005

## FUSION TACTICAL SOF

### FIELD-PROVEN DRYSUIT FOR TACTICAL USE

The FUSION TACTICAL Special Operations Forces (SOF) drysuit uses patented Fusion technology to offer the ultimate in mobility, warmth, and streamlining. There is no comparable drysuit that can match the performance of this revolutionary design.

#### HOW IT WORKS:

Inner layer (standard DryCore or breathable AirCore) is a loose fit shell drysuit incorporating seals, dry zipper, air inflation and exhaust valves to create the waterproof barrier.

Outer layer (exterior skin) made with durable stretch fabrics is attached to the inner layer at the wrists, ankles and dry zipper. This compression layer creates the streamlined fit of the Fusion with unmatched flexibility.

#### KEY FEATURES

- Unmatched flexibility and streamlined design
- Exterior 1mm super stretch neoprene skin, reinforced for high wear
- Removable 2mm neoprene inserts for the elbows and knees
- Multi-Laminate Shell Socks (ideal for use with EVO4 Boots- purchase separately)
- SLT neck and oval wrist rings w/Polytex seals are standard
- Apeks exhaust and inflate valves
- Gray fabric and seams with black edging
- Twin zip pockets are standard
- Convenience zipper is standard
- Includes internal suspenders, inflator hose, and drysuit bag
- Available in standard DryCore or breathable AirCore versions

#### SIZES

2XS/XS, S/M, L/XL, 2XL/3XL, 4XL+ (see online size chart)



FUSION TACTICAL Dive shown with optional EVO4 boots

Part #	Description
612473	Drysuit, Fusion Tactical SOF Dive, Gray, 2XS/XS
612474	Drysuit, Fusion Tactical SOF Dive, Gray, S/M
612475	Drysuit, Fusion Tactical SOF Dive, Gray, L/XL
612476	Drysuit, Fusion Tactical SOF Dive, Gray, 2XL/3XL
612477	Drysuit, Fusion Tactical SOF Dive, Gray, 4XL+



EN 14225-2:2005



## FUSION TACTICAL ONE

### FIELD-PROVEN DRYSUIT FOR SURFACE SWIMMING

The FUSION TACTICAL ONE SWIMMER drysuit uses patented Fusion technology to offer the ultimate in mobility, warmth, and streamlining. There is no comparable drysuit that can match the performance of this revolutionary design.

#### HOW IT WORKS:

Inner layer (standard DryCore or breathable AirCore) is a loose fit shell drysuit incorporating seals and dry zipper to create the waterproof barrier.

Outer layer (exterior skin) made with durable stretch fabrics is attached to the inner layer at the wrists, ankles and dry zipper. This compression layer creates the streamlined fit of the Fusion with unmatched flexibility.

#### KEY FEATURES

- Unmatched flexibility and streamlined design
- Low bulk, high mobility design with back-entry zipper
- Exterior 1mm super stretch neoprene skin, reinforced for high wear
- Oral inflate/deflate tube with lockout, installed under left forearm access zipper (see photo below)
- Convenience zipper is standard
- Multi-Laminate Shell Socks (ideal for use with EVO4 Boots - purchase separately)
- Gray fabric and seams
- Optional thigh pockets
- Includes internal suspenders and drysuit bag
- Available in standard DryCore or breathable AirCore versions

#### SIZES

2XS/XS, S/M, L/XL, 2XL/3XL, 4XL+ (see online size chart)



Oral inflator located under forearm access zipper



FUSION TACTICAL ONE shown with optional EVO4 boots

Part #	Description
612235	Drysuit, Fusion Tactical One Swimmer, Gray, 2XS/XS
612236	Drysuit, Fusion Tactical One Swimmer, Gray, S/M
612237	Drysuit, Fusion Tactical One Swimmer, Gray, L/XL
612238	Drysuit, Fusion Tactical One Swimmer, Gray, 2XL/3XL
612239	Drysuit, Fusion Tactical One Swimmer, Gray, 4XL+



EN 14225-2:2005

## FUSION SAR

### FIELD-PROVEN DRYsuit FOR SAR

The FUSION SAR drysuit uses patented Fusion technology to offer the ultimate in mobility, warmth, and streamlining. There is no comparable drysuit that can match the performance of this revolutionary design.

#### HOW IT WORKS:

Inner layer (standard DryCore or breathable AirCore) is a loose fit shell drysuit incorporating seals, dry zipper, air inflation and exhaust valves to create the waterproof barrier.

Outer layer (exterior skin) made with durable stretch fabrics is attached to the inner layer at the wrists, ankles and dry zipper. This compression layer creates the streamlined fit of the Fusion with unmatched flexibility.

#### KEY FEATURES

- Unmatched flexibility and streamlined design
- Exterior 1mm super stretch neoprene skin reinforced for high wear
- Removable 2mm neoprene inserts for the elbows and knees
- Multi-Laminate Shell Socks (ideal for use with FUSION2 or EVO4 Boots - purchase separately)
- Red with black panels
- Apeks exhaust and inflate valves
- Reflective SAR or RESCUE armbands included
- Optional twin zip pockets
- Includes internal suspenders, inflator hose, and drysuit bag
- Available in standard DryCore or breathable AirCore versions
- Surface swimmer versions available (no valves)

#### SIZES

2XS/XS, S/M, L/XL, 2XL/3XL, 4XL+ (see online size chart)

#### OPTIONAL SLT SYSTEM (SPECIFY SEPARATELY)

- Part no. 62521, SLT system w/Polytex neck seal only
- Part no. 62520, SLT system w/Polytex hood/neck seal combo
- Part no. 62460, SLT system w/silicone neck seal only
- Part no. 62461, SLT system w/silicone neck and round wrist rings
- Part no. 62949, SLT system w/Polytex neck and round wrist rings
- Part no. 62950, SLT system w/silicone neck and oval wrist rings
- Part no. 62951, SLT system w/Polytex neck and oval wrist rings

Part #	Description
611524	Drysuit, Fusion SAR Dive, Red (stock sizes only)
611525	Drysuit, Fusion SAR Dive, Red, S/M
611523	Drysuit, Fusion SAR Dive, Red, L/XL
611522	Drysuit, Fusion SAR Dive, Red, 2XL/3XL
612529	Drysuit, Fusion SAR Dive, AirCore, Red, 2XS/XS
612530	Drysuit, Fusion SAR Dive, AirCore, Red, S/M
612531	Drysuit, Fusion SAR Dive, AirCore, Red, L/XL
612532	Drysuit, Fusion SAR Dive, AirCore, Red, 2XL/3XL
612533	Drysuit, Fusion SAR Dive, AirCore, Red, 4XL+



Fusion SAR drysuit shown with EVO 4 Boots and optional Twin Zip Pockets



EN 14225-2:2005

## FUSION AIRCORE

### BREATHABLE CORE FOR ALL FUSION DRYSUITS

The Fusion AirCore layer adds a new dimension to the unmatched flexibility and outstanding performance of all Fusion Tactical and SAR drysuits.

Designed to replace the standard (DryCore) inner layer in the patented Fusion design the AirCore provides superior comfort by significantly reducing pre/post dive surface overheating. The AirCore is also easier to don and doff and is designed to outlast and outperform other breathable drysuits. The innovative Rapid Zip System (RZ) allows fast drying and easy outer skin changes to match diving requirements.

For tactical users the Fusion AirCore layer is quieter than the standard, non-breathable, (DryCore) version.

#### KEY FEATURES

- AirCore VTec breathable fabric for dryness, warmth, and comfort
- Oversized cut reduces seam/material stress and enhances durability
- AirCore has 25-50% fewer seams to reduce potential for leaks
- RZ System for fast drying and rapid outer skin changes
- Automatically adapts for varied thicknesses of undergarments
- Adapts to individual body shape providing customized fit with outstanding mobility and superior comfort
- Supplied with Seal Lock Technology (SLT) as standard for quick and easy in-field seal repairs
- Smooth inner surface allows easier donning and doffing
- Quieter for tactical operations compared to non-breathable DryCore
- Used with independent outer skins on all current Fusion drysuits
- Also available in Swimmer (no-valve) versions



Fusion AirCore\*

Fusion Outer Skin

\* Sport version in blue shown for visual clarity of separate layers. Tactical and SAR AirCore layer is black.

Part #	Description
612524	Fusion Tactical Dive, AirCore, Black, 2XS/XS
612525	Fusion Tactical Dive, AirCore, Black, S/M
612526	Fusion Tactical Dive, AirCore, Black, L/XL
612527	Fusion Tactical Dive, AirCore, Black, 2XL/3XL
612528	Fusion Tactical Dive, AirCore, Black, 4XL+
612529	Fusion SAR Dive, AirCore, Red, 2XS/XS
612530	Fusion SAR Dive, AirCore, Red, S/M
612531	Fusion SAR Dive, AirCore, Red, L/XL
612532	Fusion SAR Dive, AirCore, Red, 2XL/3XL
612533	Fusion SAR Dive, AirCore, Red, 4XL



EN 14225-2:2005

## KODIAK 360 SAR

### FIELD-PROVEN DRYsuit FOR SAR APPLICATIONS

The KODIAK 360 SAR features full wrap Captive Suspension Flex panels at the waist and thighs, providing maximum flexibility and comfort. The KODIAK 360 SAR is perfect for teams that require drysuits that fit a wide range of divers with optimal performance.

#### KEY FEATURES

- Patented Captive Suspension Panel around waist and knees
- Tough Quadflex nylon material for suit body
- Two Matrix Base Plates and one Compak pocket
- Polytex neck seal and bell-shaped wrist seals (see SLT option)
- Air control knee pads
- Apeks exhaust and inflate valves
- Reflective SAR or RESCUE armband included (please specify)
- Choice of Comfort Boots or Multi-Laminate Shell Socks (ideal for use with EVO4 Boots - purchase separately)
- Includes internal suspenders, inflator hose, and drysuit bag
- Surface swimmer version available (no valves)
- Seal Lock Technology (SLT) system available (see below)

#### SIZES

S, SK, M, MK, L, LK, XL, XLK, 2XL, 3XL

See online size chart for details

#### OPTIONAL SLT SYSTEM (SPECIFY SEPARATELY)

- Part no. 62521, SLT system w/Polytex neck seal only
- Part no. 62520, SLT system w/Polytex hood/neck seal combo
- Part no. 62460, SLT system w/silicone neck seal only
- Part no. 62461, SLT system w/silicone neck, wrist ring (no hood)



KODIAK 360 SAR shown with optional SLT neck ring system, wrist rings, EVO4 boots

Part #	Description
611079	Drysuit, Kodiak 360 SAR, Dive, Red (specify size)
611078	Drysuit, Kodiak 360 SAR, Dive, Red, Made To Measure
611213	Drysuit, Kodiak 360 SAR, Swimmer, Red (specify size)
611212	Drysuit, Kodiak 360 SAR, Swimmer, Red, Made To Measure



EN 14225-2:2005



## KODIAK 360

### FIELD-PROVEN DRYsuit FOR MILITARY USE

The KODIAK 360 features full wrap Captive Suspension Flex panels at the waist and thighs, providing maximum flexibility and comfort. The KODIAK 360 is perfect for teams that require drysuits that fit a wide range of divers with optimal performance.

#### KEY FEATURES

- Patented Captive Suspension Panel around waist and knees
- Tough Quadflex nylon material for suit body
- Two Matrix Base Plates and one Compak pocket
- Polytex neck seal and bell-shaped wrist seals (see SLT option)
- Air control knee pads
- Apeks exhaust and inflate valves
- Choice of Comfort Boots or Multi-Laminate Shell Socks (ideal for use with EVO4 Boots - purchase separately)
- Includes internal suspenders, inflator hose, and drysuit bag
- Surface swimmer version available (no valves)
- Seal Lock Technology (SLT) system available (see below)

#### SIZES

S, SK, M, MK, L, LK, XL, XLK, 2XL, 3XL

See online size chart for details

#### OPTIONAL SLT SYSTEM (SPECIFY SEPARATELY)

- Part no. 62521, SLT system w/Polytex neck seal only
- Part no. 62520, SLT system w/Polytex hood/neck seal combo
- Part no. 62460, SLT system w/silicone neck seal only
- Part no. 62461, SLT system w/silicone neck, wrist ring (no hood)

#### NON-MAGNETIC (NM OR MCM) VERSIONS

- Features as above, plus:
- All materials and components designed to meet requirements of: NATO STANAG 2897 and USN standard MIL-DTL-19595
- Fitted with Apeks NM suit valves and hose
- NM Suit Inflation Systems (SIS) available



KODIAK 360 Dive shown with optional SLT neck ring system, wrist rings, convenience zipper, Comfort Boots

Part #	Description
611035	Drysuit, Kodiak 360, Dive, Black (specify size)
611034	Drysuit, Kodiak 360, Dive, Black, Made To Measure
611037	Drysuit, Kodiak 360 Dive, Non-Mag, Black (specify size)
611974	Drysuit, Kodiak 360 Dive, Non-Mag, Black, Made To Measure



EN 14225-2:2005

## RAPTOR DRYSUIT

### BREATHABLE DRYSUIT FOR WATER RESCUE

The RAPTOR is a long duration breathable drysuit designed for flood, swift- water and other water rescue missions. Based on the field-proven OSPREY drysuit the RAPTOR's improved design incorporates more features. Overall the RAPTOR provides a comfortable stand-by mode while offering protection in unpredictable environments.

#### KEY FEATURES

- True self-entry featuring Captive Zip Design (patent pending)
- Patented adjustable full circumference neoprene neck seal
- Superior fit and comfort assisted by pre-shaped legs and torso
- Comfortable standby mode design with highly flexible T-zip
- Saltwater resistant, waterproof, breathable material
- Attached over jacket for fully donned or standby mode protection
- Anti-flush wader belt located under jacket
- Low profile auto exhaust valve mounted behind neck
- Reinforced padded elbows, knees/shins, and seat
- Neoprene wrist seals with gauntlet overlays and hook & loop cinches
- Lower leg boot gauntlets with hook & loop cinches
- Zippered chest pocket
- Relief/comfort zipper
- Attached soft dry socks (ideal for use with EVO4 Boots)
- Two thigh pockets with securing flaps
- Loop shoulder panels for adhering patches
- High visibility yellow top, black bottom and reflective patches
- Accessories - zipper lube and Instruction Manual

#### SPECIFICATION - MATERIAL

- Breathable/waterproof 3-layer material comprising:
  - Outer: 200 denier nylon, durable, water repellent
  - Core: breathable, salt water resistant polyurethane
  - Inner: protective 18 denier nylon
- Neoprene wrist seals
- 1680 denier nylon reinforced elbows, knees/shins, and seat



RAPTOR suit shown with EVO4 boots (not included)



EVO4



Part #	Description
DR13571XS	Drysuit, Raptor, XS
DR13571SM	Drysuit, Raptor, SM
DR13571SK	Drysuit, Raptor, SK
DR13571MD	Drysuit, Raptor, MD
DR13571MK	Drysuit, Raptor, MK
DR13571LG	Drysuit, Raptor, LG
DR13571LK	Drysuit, Raptor, LK
DR13571XL	Drysuit, Raptor, XL
DR13571XLK	Drysuit, Raptor, XLK
DR135712XL	Drysuit, Raptor, 2XL
DR135713XL	Drysuit, Raptor, 3XL
DR135714XL	Drysuit, Raptor, 4XL

## OSPREY DRYSUIT

### BREATHABLE DRYSUIT FOR WATER RESCUE

The OSPREY is a long duration breathable drysuit designed for swiftwater, flood, and other water rescue missions. The unique design of the OSPREY allows for a comfortable stand-by mode while still offering critical protection in unpredictable environments

#### KEY FEATURES

- True self-entry featuring Captive Zip Design (patent pending)
- Patented adjustable full circumference neoprene neck seal
- Superior fit and comfort assisted by pre-shaped legs and torso
- Comfortable standby mode design with highly flexible T-zip
- Saltwater resistant, waterproof, breathable material
- Attached over jacket for fully donned or standby mode protection
- Anti-flush wader belt located under jacket
- Reinforced padded elbows, knees/shins, and seat
- Neoprene wrist seals with gauntlet overlays and hook & loop cinches
- Lower leg boot gauntlets with hook & loop cinches
- Zippered chest pocket
- Relief/comfort zipper
- Attached soft dry socks (ideal for use with EVO4 Boots)
- Loop shoulder panels for adhering patches
- High visibility red top, black bottom and reflective patches
- Accessories - zipper lube and Instruction Manual

#### SPECIFICATION - MATERIAL

- Breathable/waterproof 3-layer material comprising:
  - Outer: 200 denier nylon, durable, water repellent
  - Core: breathable, salt water resistant polyurethane
  - Inner: protective 18 denier nylon
- Neoprene wrist seals
- 420 denier nylon reinforced elbows, knees/shins, and seat



OSPREY suit shown with EVO4 boots (not included)



EVO4



Part #	Description
612546	Drysuit, Osprey, XS
612507	Drysuit, Osprey, SM
612508	Drysuit, Osprey, SK
612478	Drysuit, Osprey, MD
612479	Drysuit, Osprey, MK
612480	Drysuit, Osprey, LG
612481	Drysuit, Osprey, LK
612482	Drysuit, Osprey, XL
612503	Drysuit, Osprey, XLK
612483	Drysuit, Osprey, 2XL
612484	Drysuit, Osprey, 3XL
612485	Drysuit, Osprey, 4XL

## ENFORCER DRYSUIT

### BREATHABLE DRYSUIT FOR TACTICAL OPERATIONS

The Enforcer is a durable drysuit for surface use in harsh marine environments. The breathable material makes it an ideal choice for high intensity maritime tasks.

#### KEY FEATURES

- True self-entry featuring Captive Zip design
- Patented adjustable full circumference neoprene neck seal
- Fully donned or Stand By modes
- Superior fit and comfort assisted by pre-shaped legs & torso
- Attached over jacket with dry zip protection
- Ballistic nylon padded overlays on elbows, knees/shin, seat
- Wrist gauntlet overlays with hook & loop fastener
- Zip lower leg boot gauntlets with hook & loop fastener
- All-weather collar protects neck seal
- Attached dry socks (ideal for use with EVO4 Boots)
- Pockets:
  - Expanding pockets with closures on arms, thighs, calves
  - All pockets with internal attachment point
  - Arm pockets with loop fastener outer panel for patches
  - Thigh cargo pockets with internal sleeves

#### SPECIFICATION - MATERIAL

- Breathable/waterproof 3-layer material comprising:
  - Outer: 200 denier nylon, durable, water repellent
  - Core: breathable, salt water resistant polyurethane
  - Inner: protective 18 denier nylon
- Neoprene neck seal and wrist seals
- Accessories - zipper lube and Instruction Manual

Part #	Description
612435	Drysuit, Enforcer, 2XS
612436	Drysuit, Enforcer, XS
612437	Drysuit, Enforcer, SM
612438	Drysuit, Enforcer, SK
612439	Drysuit, Enforcer, MD
612440	Drysuit, Enforcer, MT
612441	Drysuit, Enforcer, MK
612442	Drysuit, Enforcer, LG
612443	Drysuit, Enforcer, LT
612444	Drysuit, Enforcer, LK
612445	Drysuit, Enforcer, XL
612446	Drysuit, Enforcer, XLK
612447	Drysuit, Enforcer, 2XL
612448	Drysuit, Enforcer, 3XL
612519	Drysuit, Enforcer, 4XL



ENFORCER suit shown with EVO4 boots (not included)



EVO4





## MOSS-TO

### TACTICAL OPERATIONS DRY SUIT

The MOSS-TO (Maritime Operations Suit System - Tactical Operations) is a durable drysuit for high intensity tactical tasks. The breathable and waterproof material is ideal for all-weather use. The MOSS-TO has a field-proven design and incorporates unique features such as captive suspension flex panels that provide maximum mobility and comfort.

#### KEY FEATURES

- Patented adjustable full circumference neoprene neck seal (Pat. #9,714,074)
- Patented captive suspension panels around waist for excellent flexibility (Pat. #6,715,149)
- Ballistic nylon padded overlays on elbows, knees/shin, seat
- Wrist gauntlet overlays with hook & loop fastener
- Zip lower leg boot gauntlets with hook & loop fastener
- All-weather collar protects neck seal
- Attached dry socks (ideal for use with EVO4 Boots)
- Fitted with adjustable internal suspenders
- Includes quick field repair kit, zipper lube, owner's manual
- Pockets:
  - Expanding design with easy-grip flaps
  - All pockets with internal attachment point
  - Arm pockets with loop fastener outer panel for patches
  - Thigh cargo pockets are streamlined with internal divider

#### SPECIFICATION - MATERIAL

- Vtec™ breathable/waterproof 3-layer material comprising:
  - Outer: 200 denier nylon, durable, water repellent
  - Core: breathable, salt water resistant polyurethane
  - Inner: protective 18 denier nylon
- Neoprene neck seal and wrist seals



Patented design combines ergonomic fit with unprecedented mobility. Outer layer of anti-bacterial, abrasion-resistant stretch material encapsulates the high flex waist zone, for a more ergonomic fit.



MOSS-TO drysuit shown without boots



EVO4 Boots  
(not included)

PART #	DESCRIPTION
612553	DRYSUIT MOSS-TO Grey Size 2XS
612554	DRYSUIT MOSS-TO Grey Size XS
612555	DRYSUIT MOSS-TO Grey Size S
612556	DRYSUIT MOSS-TO Grey Size SK
612557	DRYSUIT MOSS-TO Grey Size M
612558	DRYSUIT MOSS-TO Grey Size MT
612559	DRYSUIT MOSS-TO Grey Size MK
612560	DRYSUIT MOSS-TO Grey Size L
612561	DRYSUIT MOSS-TO Grey Size LT
612562	DRYSUIT MOSS-TO Grey Size LK
612563	DRYSUIT MOSS-TO Grey Size XL
612564	DRYSUIT MOSS-TO Grey Size XLK
612565	DRYSUIT MOSS-TO Grey Size 2XL
612566	DRYSUIT MOSS-TO Grey Size 3XL
612567	DRYSUIT MOSS-TO Grey Size 4XL
612568	KIT, Quick Field Repair, Grey



## KODIAK SWIFTWATER

### FIELD-PROVEN DRYsuit FOR WATER RESCUE

The KODIAK SWIFTWATER features full wrap Captive Suspension Flex panels at the waist and thighs, providing maximum flexibility and comfort. The KODIAK SWIFTWATER is perfect for teams that require drysuits to fit a wide range of users with optimal performance.

#### KEY FEATURES

- Patented Captive Suspension Panel around waist and knees
- Tough Quadflex nylon material for suit body
- Polytex neck seal and bell-shaped wrist seals (see SLT option)
- Air control knee pads
- Reflective SAR or RESCUE armbands included
- Choice of Comfort Boots or Multi-Laminate Shell Socks (ideal for use with EVO4 Boots)
- Optional Matrix base plates and Compak pockets
- Includes internal suspenders and drysuit bag
- Seal Lock Technology (SLT) system available (see below)

#### SIZES

S, SK, M, MK, L, LK, XL, XLK, 2XL, 3XL

See online size chart for details

#### OPTIONAL SLT SYSTEM (SPECIFY SEPARATELY)

- Part no. 62521, SLT system with Polytex neck seal only
- Part no. 62520, SLT system with Polytex hood/neck seal combo
- Part no. 62460, SLT system w/silicone neck seal only
- Part no. 62461, SLT system w/silicone neck and wrist ring system (no hood)



KODIAK SWIFTWATER shown with optional SLT neck ring system, wrist rings, EVO4 boot

Part #	Description
611218	Drysuit, Kodiak Swiftwater, Red (specify size)
611219	Drysuit, Kodiak Swiftwater, Red, Made To Measure

**CE**  
EN 343:2003  
+A1:2007

# DRYSUIT SIZE CHART

## FUSION SIZE CHART

		2XS - XS	SM/MED	LG/XL	2XL-3XL	4XL+
Height	Inch	5'1" - 5'5"	5'5" - 5'9"	5'9" - 6'1"	6'0" - 6'4"	6'0" - 6'10"
	Cm	155 - 168 Cm	168 - 180 Cm	180 - 186 Cm	183 - 195 Cm	183 - 208 Cm
Weight	Lbs	90 - 130 lbs	120 - 170 lbs	160 - 210 lbs	200 - 250 lbs	230 - 350 lbs
	Kg	41 - 59 Kg	55 - 77 Kg	73 - 95 Kg	91 - 114 Kg	105 - 160 Kg
Chest	Inch	30" - 37"	35" - 41"	39" - 45"	43" - 49"	45" - 58"
	Cm	76 - 94 Cm	89 - 105 Cm	99 - 114 Cm	109 - 125	114 - 148 Cm
Waist	Inch	22" - 31"	27" - 36"	31" - 40"	35" - 44"	41" - 58"
	Cm	56 - 79 Cm	69 - 91 Cm	79 - 102 Cm	89 - 112 Cm	104 - 147 Cm
Buttocks	Inch	27" - 36"	32" - 41"	36" - 45"	40" - 49"	46" - 58"
	Cm	69 - 91 Cm	81 - 104 Cm	91 - 114 Cm	102 - 124 Cm	117 - 147 Cm
Crotch To Floor	Inch	26" - 29"	29" - 32"	30" - 33"	32" - 35"	33" - 38"
	Cm	66 - 74 Cm	74 - 81 Cm	76 - 84 Cm	81 - 89 Cm	84 - 97 Cm

## HAZMAT - ENVIRO - ENVIRO HYBRID - PRO COM - KODIAK 360

MEN'S	XS	S	SK	M	MT	MK	L	LT	LK	XL	XLK	2XL	3XL	4XL	
WOMEN'S	8	10	10Q	12	12	12Q	14	14	14Q						
Height	Inch	5'5" - 5'7"	5'7" - 5'9"	5'7" - 5'9"	5'9" - 5'11"	5'11" - 6'1"	5'9" - 5'11"	5'11" - 6'1"	6'1" - 6'3"	5'11" - 6'1"	6'1" - 6'3"	6'1" - 6'3"	6'2" - 6'4"	6'3" - 6'5"	6'4" - 6'6"
	Cm	165-170	170-175	170-175	175-180	180-185	175-180	180-185	185-191	180-185	185-191	185-191	188-193	191-196	193-198
Weight	Lbs	120-140	140-160	170-190	150-170	160-180	180-200	170-190	180-200	200-230	190-210	210-230	210-230	230-260	260-290
	Kg	54-64	64-73	77-86	68-77	73-82	82-91	77-86	82-91	91-104	86-95	95-109	95-104	104-118	118-131
Chest	Inch	33"-37"	35"-39"	39"-43"	37"-41"	37"-41"	41"-45"	39"-43"	39"-43"	43"-47"	41"-45"	46"-50"	43"-47"	46"-50"	48-52
	Cm	84-94	89-99	99-109	94-104	94-104	104-114	99-109	99-109	109-119	104-114	117-127	109-119	117-127	122-132
Waist	Inch	26-30"	28-32"	33-37"	30-34"	30-34"	35-39"	33-37"	33-37"	37-41"	35-39"	40-44"	37-41"	40-44"	42-46
	Cm	66-76	71-81	84-94	76-86	76-86	89-99	84-94	84-94	94-104	89-99	102-112	94-104	102-112	107-117
Buttocks	Inch	33"-35"	34"-37"	39"-42"	36"-39"	36"-39"	41"-44"	39"-42"	39"-42"	43"-46"	41"-44"	45"-48"	43"-46"	45"-48"	47-50
	Cm	84-89	86-94	99-107	91-99	91-99	104-112	99-107	99-107	109-117	104-112	114-122	109-117	114-122	119-127
Shoulder to Crotch	Inch	25"-27"	26"-28"	28"-30"	27"-29"	28"-30"	29"-31"	28"-30"	29"-31"	30"-32"	29"-31"	31"-33"	30"-32"	31"-33"	32-34
	Cm	64-69	66-71	71-76	69-74	69-74	74-79	71-76	74-79	76-81	74-79	79-84	76-81	79-84	81-86
Crotch to Floor	Inch	28"-29"	29"-31"	29"-31"	30"-32"	31"-33"	30"-32"	31"-33"	32"-34"	31"-33"	32"-34"	32"-34"	32"-34"	33"-35"	34"-36"
	Cm	71-74	74-79	74-79	76-81	79-84	76-81	79-84	81-86	79-84	81-86	81-86	81-86	84-89	86-91
Neck	Inch	12.5"-14"	12.5"-14"	14.13"-14.75"	14.13"-14.75"	14.125"-14.75"	14.88"-16.5"	14.88"-16.5"	14.88"-16.5"	16.625" +	16.625" +	16.625" +	16.625" +	16.625" +	16.625" +
	Cm	32-36	32-36	36-37	36-37	36-37	38-42	38-42	38-42	42+	42+	42+	42+	42+	42+
Wrist	Inch	5.75"-6.38"	5.75"-6.38"	6.5"-7.25"	6.5"-7.25"	6.5"-7.25"	6.5"-7.25"	6.5"-7.25"	6.5"-7.25"	7.38"-8.13"	7.38"-8.13"	7.38"-8.13"	7.38"-8.13"	7.38"-8.13"	7.38"-8.13"
	Cm	15-16	15-16	17-18	17-18	17-18	17-18	17-18	17-18	19-21	19-21	19-21	19-21	19-21	19-21

## SHOE SIZES \*NORTH AMERICAN

NA* Shoe Size Mens	5-7	6-8	7-9	7-9	8-10	8-10	8-10	9-11	9-11	9-11	10-12	10-12	11-13	11-13
NA* Shoe Size Womens	6.5-8.5	7.5-9.5	8.5-10.5	8.5-10.5	9.5-11.5	9.5-11.5	9.5-11.5	10.5-12.5	10.5-12.5	10.5-12.5	11.5-13.5	11.5-13.5	12.5-14.5	12.5-14.5
EU Shoe Size	39-40.5	39.5-42	40.5-43	40.5-43	42-44.5	42-44.5	42-44.5	43-46	43-46	43-46	44.5-47	44.5-47	46-48	46-48
UK Shoe Size UK Shoe Size	4-6	5-7	6-8	6-8	7-9	7-9	7-9	8-10	8-10	8-10	9-11	9-11	10-12	10-12

# DRYSUIT SIZE CHART

## RAPTOR/OSPREY/ENFORCER SIZE CHART

MEN'S	S	SK	M	MK	L	LK	XL	XLK	2XL	3XL	4XL	
WOMEN'S	10	10Q	12	12Q	14	14Q						
Height	Inch	5'7" - 5'9"	5'7" - 5'9"	5'9" - 5'11"	5'9" - 5'11"	5'11" - 6'1"	5'11" - 6'1"	6'1" - 6'3"	6'1" - 6'3"	6'2" - 6'4"	6'3" - 6'5"	6'4" - 6'6"
	Cm	170-175	170-175	175-180	175-180	180-185	180-185	185-191	185-191	188-193	191-196	193-198
Weight	Lbs	140-160	170-190	150-170	180-200	170-190	200-230	190-210	210-230	210-230	230-260	260-290
	Kg	64-73	77-86	68-77	82-91	77-86	91-104	86-95	95-109	95-104	104-118	118-131
Chest	Inch	35"-39"	39"-43"	37"-41"	41"-45"	39"-43"	43"-47"	41"-45"	46"-50"	43"-47"	46"-50"	48-52
	Cm	89-99	99-109	94-104	104-114	99-109	109-119	104-114	117-127	109-119	117-127	122-132
Waist	Inch	28-32"	33-37"	30-34"	35-39"	33-37"	37-41"	35-39"	40-44"	37-41"	40-44"	42-46
	Cm	71-81	84-94	76-86	89-99	84-94	94-104	89-99	102-112	94-104	102-112	107-117
Buttocks	Inch	34"-37"	39"-42"	36"-39"	41"-44"	39"-42"	43"-46"	41"-44"	45"-48"	43"-46"	45"-48"	47-50
	Cm	86-94	99-107	91-99	104-112	99-107	109-117	14-112	114-122	109-117	114-122	119-127
Shoulder to Crotch	Inch	26"-28"	28"-30"	27"-29"	29"-31"	28"-30"	30"-32"	29"-31"	31"-33"	30"-32"	31"-33"	32-34
	Cm	66-71	71-76	69-74	74-79	71-76	76-81	74-79	79-84	76-81	79-84	81-86
Crotch to Floor	Inch	29"-31"	29"-31"	30"-32"	30"-32"	31"-33"	31"-33"	32"-34"	32"-34"	32"-34"	33"-35"	34"-36"
	Cm	74-79	74-79	76-81	76-81	79-84	79-84	81-86	81-86	81-86	84-89	86-91
Neck	Inch	12.5"-14"	14.13"-14.75"	14.13"-14.75"	14.88"-16.5"	14.88"-16.5"	16.625" +	16.625" +	16.625" +	16.625" +	16.625" +	16.625" +
	Cm	32-36	36-37	36-37	38-42	38-42	42+	42+	42+	42+	42+	42+
Wrist	Inch	5.75"-6.38"	6.5"-7.25"	6.5"-7.25"	6.5"-7.25"	6.5"-7.25"	7.38"-8.13"	7.38"-8.13"	7.38"-8.13"	7.38"-8.13"	7.38"-8.13"	7.38"-8.13"
	Cm	15-16	17-18	17-18	17-18	17-18	19-21	19-21	19-21	19-21	19-21	19-21

## COM1 DRYSUIT SIZE CHART

SIZES		S	M	L	XL	2XL
Height	Inches	65 - 67	67 - 70.5	71 - 74	74.5 - 77	77 - 81
	cm	165 - 170	171 - 179	180 - 188	189 - 195	196 - 205
Chest	Inches	39 - 41	41 - 43	43.5 - 46.5	47 - 48	48 - 50
	cm	100 - 104	105 - 110	111 - 118	119 - 122	123 - 126
Waist	Inches	32 - 24	34 - 36.5	37 - 38.5	39 - 40	40.5 - 42.5
	cm	82 - 86	87 - 93	94 - 98	99 - 102	103 - 108
Forearm	Inches	11.5 - 12	12.25 - 12.75	13 - 13.75	14 - 14.5	14.5 - 15
	cm	29 - 30.5	31 - 32.5	33 - 35	35.5 - 36.5	37 - 38
Wrist	Inches	4.75	5.25	5.5	5.75	6
	cm	12 - 12.5	13 - 13.5	14	14.5	15
Crotch To Ankle	Inches	27.5 - 28.25	28.75 - 30	30.25 - 31.5	32 - 33	33.5 - 34.75
	cm	70 - 72	73 - 76	77 - 80	81 - 84	85 - 88
Calf	Inches	13.75 - 14	14.5 - 15.25	15.75 - 16.5	17 - 17.5	17.75 - 18
	cm	35 - 36	37 - 39	40 - 42	43 - 44	45 - 46
Zip Length	Inches	31.5	33.5	35.5	35.5	37
	cm	80	85	90	90	95
Boot Size	Inches	8.5	8.5	11 - 12	11 - 12	14
	cm	42	42	45/46	45/46	49



## SEAL LOCK TECHNOLOGY SYSTEM (SLT)

- Allows seal replacement in minutes without any gluing
- Can be used with a Polytex hood/neckseal combo
- Can be used with Silicone or Polytex neckseal
- Will reduce repair costs and down time
- Allows for multiple divers with different neck sizes to use the same suit
- Replacement seals cost the same as, or less than, glued on seals
- Installation tool included



Note: SLT system must be installed at the factory on new suits, or through the repair department on existing suits (if possible)

Part #	Description
62520	SLT Neck System w/Polytex Hood/Neckseal combo
62521	SLT Neck System w/Polytex Neckseal only
62460	SLT Neck System w/Silicone* Neckseal only
62461	Install SLT Neck and Round Wrist Ring System w/Silicone Seals
62950	Install SLT Neck and Oval Wrist Ring System w/Silicone Seals
62949	Install SLT Neck and Round Wrist Ring System w/Polytex Seals
62951	Install SLT Neck and Oval Wrist Ring System w/Polytex Seals

\*Silicone seals not recommended for use in contaminated water

## HOOD/NECK SEAL COMBO FOR SLT NECK SYSTEM

- Polytex hood with built in neck seal
- Field replaceable
- Supplied with universal trim-to-fit neck seal
- Size specific neck seals available on request



Part #	Description
62518	Hood/Neckseal Combo for SLT Neck System - Small
62519	Hood/Neckseal Combo for SLT Neck System - Large

## SLT NECK INNER RING (YELLOW)

- Tough yellow ring used to lock seal in the SLT system



Part #	Description
62458	SLT Neck Inner Ring (Yellow)

## SLT NECK INSTALLATION TOOL

- Used for easy installation of seals in the SLT System



Part #	Description
62459	SLT Neck Installation Tool

## PERMANENTLY INSTALLED WRIST RINGS

### (ROUND)

- Attached directly to the drysuit during production
- Permanent wrist rings mate with Glove Lock and Quick Clamp dry glove ring systems and EZ-On 2 Super Grip Gloves
- Polytex and Silicone seal is removable and replaceable



Part #	Description
611622	Permanent Wrist Rings

## PERMANENTLY INSTALLED WRIST RINGS

### (OVAL)

- Attached directly to the drysuit during production
- Permanent wrist rings mate with Antares dry glove ring system as well as EZ-On 2 Super Grip Gloves
- Oval design is lower profile
- Polytex and Silicone seal is removable and replaceable



Part #	Description
612320	Permanently Installed Wrist Rings - Oval

## PERMANENTLY INSTALLED POLYTEX HOOD

- Designed for contaminated water diving
- Protects ears and head from unwanted contaminants
- Thermal protection may be required under the hood
- Comfortable in cool water

### SIZES

One Size Only

Part #	Description
62360	Attached Polytex Dryhood
611587	Fleece Liner

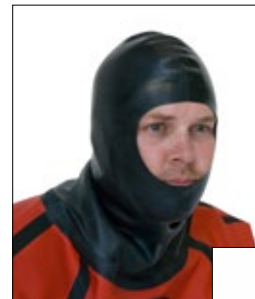

## 10" RELIEF ZIPPER

- Installed as a Made To Order option
- 10" zipper allows divers to relieve themselves at the surface without doffing the drysuit

Part #	Description
62359	10" Relief Zipper



## SAR ARMBAND INSTALLATION

- Stock name (SAR or RESCUE) on 2" strip of yellow nylon
- Custom name also available
- 2" strip of Solas approved reflective material
- Included on all SAR drysuits



Part #	Description
62388	Stock Name Installed On Armband (One Arm)
62374	Custom Name Installed On Armband (One Arm)
62362	Reflective Strip On Armband (One Arm)

## CUSTOM SILK SCREENING

- Have your department name or logo added to each suit
- One time setup charge
- User supplies art work

Part #	Description
62476	Custom Silk Screening

## WHAT ARE POLYTEX SEALS?

Aqua Lung Polytex seals are a combination of vulcanized natural rubber latex and polyurethane. The polyurethane stabilizes the latex and helps inhibit the seal from tearing. Ever get a small tear in a seal and it runs the length when donning the drysuit? Although not indestructible, polytex reduces this tendency and allows for a repair to be made to the seal without having to replace it entirely. Additional anti-aging ingredients are added to combat the effects of ultraviolet light, ozone and copper. These additions make for a tougher, longer lasting seal when compared to standard latex seals.

## FUSION TWIN-ZIP POCKET

- Low profile single top hook and loop closure
- Two grommets under hook and loop closure
- Zippers along side edges allow pocket to bellow out for additional space
- 1 mm GatorTech neoprene construction
- Water drain

Part #	Description
611589	Fusion Twin Zip Thigh Pockets



## CARGO POCKET

- Single wraparound zipper to expand pocket capacity
- Separate zipper for easy access
- Inner D-Ring
- The largest volume pocket

Part #	Description
611796	Cargo Pocket For Matrix Base Plate System



## COMPAK POCKET

- Low profile
- Single top hook and loop closure
- Inner D-Ring
- Pleated for additional space

Part #	Description
611798	Compak Pocket For Matrix Base Plate System





## EVO4 BOOTS

### RUGGED BOOTS FOR PROFESSIONAL USE

Building on nearly two decades of military use the EVO4 sets the standard in performance footwear for diving and for navigating rough and slippery terrain. The Vibram® MEGAGRIP™ sole provides the foundation of the EVO4's unparalleled grip on wet or dry surfaces, rugged longevity, and optimal ground adaptability. The mid-height, low profile, rapid lace-up design offers solid support yet still fits a majority of fin pockets allowing for varied fin techniques and superior comfort.

#### KEY FEATURES

- Vibram® Megagrip Sole™ - world class traction
- Low profile design with flexible ankle support
- Supplied with stiffener insoles for shoreline use
- Thumb loop donning aid
- Para cord laces
- Lace storage pocket
- Fin keeper



Part #	Description
BS138111	Boot, EVO4, Black, Size 5/6
BS138112	Boot, EVO4, Black, Size 7
BS138113	Boot, EVO4, Black, Size 8
BS138114	Boot, EVO4, Black, Size 9
BS138115	Boot, EVO4, Black, Size 10
BS138116	Boot, EVO4, Black, Size 11
BS138117	Boot, EVO4, Black, Size 12
BS138118	Boot, EVO4, Black, Size 13
BS138119	Boot, EVO4, Black, Size 14/15



## FUSION2 BOOTS

### RUGGED BOOTS FOR FUSION DRYSUIT

The Fusion2 is a rugged drysuit boot designed to easily integrate with any Fusion drysuit. The boot is quickly and easily attached and detached from the drysuit. The heavy-duty vulcanized rubber-coated neoprene material minimizes wear and tear.



#### KEY FEATURES

- Hook-and-loop attachment allows boot to be removed and reattached to a Fusion drysuit
- Heavy-duty vulcanized rubber-coated neoprene
- Rugged anti-slip sole for sure footing
- Plastic insert fits inside Fusion dry-sock to lock sock in boot
- Drainage holes allow water to flow out
- Fin strap stop at heel secures fin to boot
- Pull-on loop at heel eases donning
- Boots fit Rocket II, RK3 and Shredder SAR fins

Part #	Description
BS141111	Boot, Fusion2, Black, Size 5/6
BS141112	Boot, Fusion2, Black, Size 7
BS141113	Boot, Fusion2, Black, Size 8
BS141114	Boot, Fusion2, Black, Size 9
BS141115	Boot, Fusion2, Black, Size 10
BS141116	Boot, Fusion2, Black, Size 11
BS141117	Boot, Fusion2, Black, Size 12
BS141118	Boot, Fusion2, Black, Size 13
BS141119	Boot, Fusion2, Black, Size 14/15

## COMFORT BOOT

- 7 mm neoprene inner liner for added warmth
- Tough rubber sole covering and fin keeper
- Your size installed as a Made to Order option

Part #	Mens	Size
62373	5	XS
62371	6	S
62370	7	M
62370	8	M
62369	9	L
62372	10	XL
62365	11	2XL
62365	12	2XL
62367	13	3XL
62367	14	3XL
62368	15	4XL+



## HEAVY DUTY POLY BOOT

### HEAVY DUTY MOLDED DRYSUIT BOOTS

- Heavy duty sole for excellent grip
- Your size installed as a Made to Order option
- Available on the HAZMAT and PRO COM drysuits only

Part #	Mens
62380	8
62381	9
62375	10
62376	11
62377	12
62378	13
62379	14



## HEAVY DUTY STEEL TOE/SHANK BOOT

### HEAVY DUTY STEEL TOE DRYSUIT BOOTS

- Heavy duty drysuit boot
- Steel toe and shank
- Extensive chemical testing available upon request
- Your size installed as a Made to Order option
- Available on the HAZMAT and PRO COM drysuits only.

Part #	Mens	Size
62386	7-8	S
62385	9-10	M
62384	11-12	L
62387	13-14	XL



## MK0 UNDERGARMENT

### ONE-PIECE UNDERGARMENT FOR USE WITH ALL DRYSUITS

The MK0 undergarment is a one-piece bamboo fiber base layer. It is designed to be worn under any of our undergarments and provides excellent moisture wicking performance when worn next to skin. The MK0 can also be worn as a standalone layer in tropical conditions.

#### KEY FEATURES

- Spandex content results in extreme stretch; no need for king sizes
- Smooth LYCRA® stirrups and elastic thumb loops
- Rear convenience flap
- 2-way torso entry/relief zipper
- Non-corroding YKK zippers
- Easy care design
- Designed as a wicking base layer or a primary layer in warm tropical waters above 70°F (21°C) water temperature

#### MATERIALS

- Breathable, moisture-wicking, bamboo blend

#### SIZES

Stock sizes only: XS, S, M, L, XL, 2XL



Part #	Description
611651	Undergarment, MK0 One-Piece, XS
611649	Undergarment, MK0 One-Piece, S
611648	Undergarment, MK0 One-Piece, M
611647	Undergarment, MK0 One-Piece, L
611650	Undergarment, MK0 One-Piece, XL
611646	Undergarment, MK0 One-Piece, 2XL



EN 14225-2:2005

## MK1 UNDERGARMENT

### ONE-PIECE UNDERGARMENT FOR USE WITH ALL DRYSUITS

The MK1 undergarment provides moisture-wicking properties and thermal performance. This allows it to be used as a base wicking layer or as a standalone undergarment for warm water diving.

#### KEY FEATURES

- Spandex content results in extreme stretch; no need for king sizes
- Smooth LYCRA® stirrups and elastic thumb loops
- Rear convenience flap
- 2-way torso entry/relief zipper
- Non-corroding YKK zippers
- Easy care design
- Designed as a wicking base layer or a primary layer in warm tropical waters above 70°F (21°C) water temperature

#### MATERIALS

- Breathable, moisture-wicking, polypropylene micro-fleece

#### SIZES

Stock sizes only: XS, S, M, L, XL, 2XL



Part #	Description
611680	Undergarment, MK1 One-Piece, XS
611676	Undergarment, MK1 One-Piece, S
611674	Undergarment, MK1 One-Piece, M
611672	Undergarment, MK1 One-Piece, L
611678	Undergarment, MK1 One-Piece, XL
611670	Undergarment, MK1 One-Piece, 2XL



EN 14225-2:2005



## MK2 UNDERGARMENT

### ONE-PIECE UNDERGARMENT FOR USE WITH ALL DRYSUITS

The MK2 diving undergarments are extremely versatile and can be layered up or down to match a wide range of environmental and diving conditions.

#### KEY FEATURES

- Complement with MK2 Jacket, MK1 or MK0 Undergarments
- Removable sleeves
- 2 zippered vertical chest pockets
- 2 large fleece-lined hand warming pockets
- Thumb loops for easy donning
- Stirrups keep garment in place when donning
- Non-corroding YKK zippers used throughout
- 2-way zippered rear convenience panel
- 2-way torso/convenience zipper
- 1mm LYCRA®/neoprene 2-way stretch expansion panels at waist and above knees for optimal mobility

#### MATERIALS

- Breathable, moisture-wicking, insulating polar fleece lining
- Stormproof 70 denier, micro-ripstop, water resistant nylon

#### SIZES

Stock sizes only: XS, S, M, L, XL, 2XL, 3XL



Part #	Description
611708	Undergarment, MK2 One-Piece, XS
611704	Undergarment, MK2 One-Piece, S
611702	Undergarment, MK2 One-Piece, M
611700	Undergarment, MK2 One-Piece, L
611706	Undergarment, MK2 One-Piece, XL
611697	Undergarment, MK2 One-Piece, 2XL
611699	Undergarment, MK2 One-Piece, 3XL



EN 14225-2:2005

## MK2 JACKET UNDERGARMENT

### UNDERGARMENT FOR USE WITH ALL DRYSUITS

The MK2 diving undergarments are extremely versatile and can be layered up or down to match a wide range of environmental and diving conditions.

#### KEY FEATURES

- Complement with MK2, MK1 or MK0 undergarments
- Removable sleeves
- 2 zippered chest pockets
- 2 large zippered fleece-lined hand warming pockets
- Thumb loops for easy donning
- Non-corroding YKK zippers used throughout
- Storm shield face guard with fleece liner
- Zip off, fully adjustable, storm hood
- Internal hood flap with adjustable face seal

#### MATERIALS

- Breathable, moisture-wicking, insulating polar fleece lining
- Stormproof 70 denier, micro-ripstop, water resistant nylon

#### SIZES

Stock sizes only: XS, S, M, L, XL, 2XL, 3XL



Part #	Description
611694	Undergarment, MK2 Jacket, XS
611690	Undergarment, MK2 Jacket, S
611688	Undergarment, MK2 Jacket, M
611686	Undergarment, MK2 Jacket, L
611692	Undergarment, MK2 Jacket, XL
611683	Undergarment, MK2 Jacket, 2XL
611685	Undergarment, MK2 Jacket, 3XL



EN 14225-2:2005

## THERMAL FUSION UNDERGARMENT

### ONE-PIECE UNDERGARMENT FOR USE WITH ALL DRYSUITS

The Thermal Fusion is a high performance diving undergarment that maximizes warmth and provides unrivaled flexibility and fit. Designed for use in extreme environments, the superior insulation value of the Thermal Fusion has been validated by independent testing.

#### KEY FEATURES

- Thermal Fusion is recommended for use with all drysuits
- Delivers extreme mobility and superior warmth
- Integrated full-width "kangaroo" hand pocket
- Easy access comfort zip
- Dual-layer: outer stretch skin encapsulates inner thermal (fleece) core,
- ATS (Air Transfer System) with Hi-Flo mesh panels located at inflate/exhaust valve locations to increase airflow, padding and insulation
- Thermal performance independently lab tested
- Thumb loops for easy donning
- Stirrups keep garment in place when donning
- Machine washable

#### MATERIALS

- Power Stretch Pro outer skin
- Polartec 200 fleece core

#### SIZES

- 5 stock sizes: 2XS/XS, S/M, L/XL, 2XL/3XL, 4XL+
- See online size chart for details (sizes match Fusion Drysuits)



Part #	Description
612082	Undergarment, Thermal Fusion, 2XS/XS
612083	Undergarment, Thermal Fusion, S/M
612084	Undergarment, Thermal Fusion, L/XL
612085	Undergarment, Thermal Fusion, 2XL/3XL
612086	Undergarment, Thermal Fusion, 4XL+



EN 14225-2:2005

## DIVER PONCHO

### PROTECTIVE OVERGARMENT FOR STANDBY DIVER

The Poncho provides protection to the Standby Diver, and other support personnel, in severe environmental conditions. The oversized design accommodates the Standby Diver wearing a full set of dive equipment. Watertight and abrasion resistant outer shell ensures that the user remains dry and comfortable and ready for deployment.

#### KEY FEATURES

- Watertight and durable multi-laminate outer shell
- Heavyweight polypropylene fleece interior for warmth
- Large drawstring hood accommodates mask/head gear
- Adjustable hood allows the user to block out the elements
- Hook-and-Loop closure can be opened/closed from either end
- Design ensures a speedy exit in an emergency
- Interior upper back panel reinforced with nylon material to resist abrasion and snagging of equipment
- 2 inside, fleece-lined, hand warming pockets with zip closures
- One size fits all



Oversize Design to fit Equipment



Adjustable Drawstring Hood

Part #	Description
612087	Divers Standby Poncho

**CE**  
EN 343:2003  
+A1:2007

## COMMERCIAL DRY GLOVE W/ POLYTEX SEAL

- Our fully lined dry glove's latex seal is sewn AND welded in place - not glued
- Heavy duty and UV resistant latex seal keeps water out
- Abrasion resistant fingers and palm protect the hand
- Removable 3 mm plush fiber liners offer comfort and warmth
- Designed to work with drysuits

Part #	Description	Size
611783	Commercial Dry Gloves w/ Latex Seals - Pair	M
611782	Commercial Dry Gloves w/ Latex Seals - Pair	L
611784	Commercial Dry Gloves w/ Latex Seals - Pair	XL



## COMMERCIAL DRY GLOVES

- Use in conjunction with Dry Glove Systems
- Dry gloves result in warm, dry hands, and often provide greater dexterity to the diver
- Tough exterior glove provides excellent durability and abrasion resistance
- Inner glove liner provides exceptional warmth with increased dexterity

Part #	Description	Size
611923	Commercial Dry Gloves w/ Separate Fleece Liners - Pair	M
611922	Commercial Dry Gloves w/ Separate Fleece Liners - Pair	L
611924	Commercial Dry Gloves w/ Separate Fleece Liners - Pair	XL



## EZ-ON PRO GLOVES

- Designed to simply stretch over the wrist rings
- Fits both the round and oval wrist rings
- Textured blue exterior with woven cloth interior
- Extended length ensures good hand movement

Part #	Description	Size
612548	Gloves, EZ-On PRO, Blue - Pair	M
612549	Gloves, EZ-On PRO, Blue - Pair	L
612550	Gloves, EZ-On PRO, Blue - Pair	XL

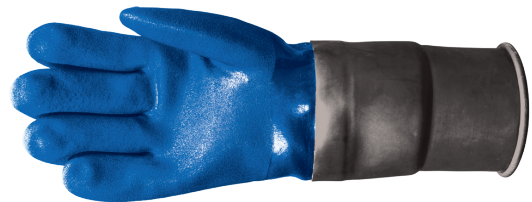

## EZ-ON 2 SUPER GRIP GLOVES

- Durable dry gloves ideal for contaminated water diving or heavy work
- Use with glove rings or simply stretch over wrist rings for a quick, dry, system
- Longer and thicker than traditional rubber gloves
- Black exterior with textured palm
- Glove retention rings and fleece liners sold separately

Part #	Description	Size
GL1450101S	Gloves, EZ-On 2 Super Grip - Pair	S
GL1450101M	Gloves, EZ-On 2 Super Grip - Pair	M
GL1450101L	Gloves, EZ-On 2 Super Grip - Pair	L
GL1450101XL	Gloves, EZ-On 2 Super Grip - Pair	XL





## REMOVEABLE GLOVE LOCK RINGS

- Removable dry glove system – wrist rings and glove rings lock together
- Utilizes an O-ring system with a twist and audible click
- Easily donned and doffed without the assistance of another diver
- Wrist rings include a set of rings (3 size options) to line the inside of your drysuit latex seal, outer ring sandwiches the latex seal, creating a dry cuff on your drysuit
- Glove rings include a set of rings (2 size options) to line the inside of your gloves, outer ring sandwiches the glove, creating a dry cuff on your glove that mates with the wrist rings on the latex seal
- Use with EZ-On 2 Super Grip Gloves or blue commercial dry gloves



Part #	Description	Size
612009	Removable Glove Lock System Complete w/ Gloves and Liners	M
612069	Removable Glove Lock System Complete w/ Gloves and Liners	L
612070	Removable Glove Lock System Complete w/ Gloves and Liners	XL

## REMOVEABLE QUICK CLAMP RINGS

- Removable dry glove system – wrist rings and glove rings lock together
- Utilizes an O-ring system with a friction fit
- Easily donned and doffed without the assistance of another diver
- Wrist rings include a set of rings (3 size options) to line the inside of your latex seal, outer ring sandwiches the latex seal, creating a dry cuff on your drysuit
- Glove rings include a set of rings (2 size options) to line the inside of your gloves, outer ring sandwiches the glove, creating a dry cuff on your glove that mates with the wrist rings (permanently installed or removable)
- Use with EZ-On 2 Super Grip Gloves or blue commercial dry gloves



Part #	Description
62038	Quick Clamp Wrist Rings (pair)
62040	Quick Clamp Glove Rings (pair)

## GLOVE RETENTION RING

- Ensures that the EZ-On 2 Super Grip Glove does not pop off permanent wrist rings
- Heavy duty
- Reusable



Part #	Description
611956	Glove Retention Ring

## NEOPRENE SOCKS

- 3mm neoprene material
- Ergonomic left and right foot shape
- Designed for comfort with a wet or dry suit
- Ideal liner for EVO4 and Fusion Boots
- Glued and blind stitched seams increase warmth
- Durable elastic bound cuff

Part #	Description	Size
BS1630142XS	3mm Neoprene Socks - Pair	XS - 6/7
BS1630142S	3mm Neoprene Socks - Pair	S - 8/9
BS1630142M	3mm Neoprene Socks - Pair	M - 10/11
BS1630142L	3mm Neoprene Socks - Pair	L - 12/13
BS1630142XL	3mm Neoprene Socks - Pair	XL - 14/15



## MK3 GLACIER THERMAL SOCKS

- Our most extreme cold water sock available
- Breathable, moisture-wicking, high loft, insulating polypropylene polar fleece inner lining
- Storm Proof, 70 denier, micro-ripstop, water-resistant, Taslon outer nylon facing
- Primaloft® sandwiched between fleece lining and nylon facing
- Sole and heel are reinforced with a heavier nylon for durability
- Complement this with MK2 or Thermal Fusion Undergarments
- Sock can be worn alone or with a very light polyester sock to minimize laundering.

Part #	Description	Size
611632	MK3 Glacier Thermal Socks - Pair	4/5
611633	MK3 Glacier Thermal Socks - Pair	6/7
611634	MK3 Glacier Thermal Socks - Pair	8/9
611629	MK3 Glacier Thermal Socks - Pair	10/11
611630	MK3 Glacier Thermal Socks - Pair	12/13
611631	MK3 Glacier Thermal Socks - Pair	14/15



## FLEECE LINERS

- This 100% seamless poly glove liner is designed to flex with the glove allowing freedom of movement and reducing the hand fatigue associated with working in cold environments
- Machine washable
- Dries quickly between uses

Part #	Description	Colour	Size
611920	Heavy Weight Fleece Liners - Pair	Yellow	M
611919	Heavy Weight Fleece Liners - Pair	Yellow	L
611921	Heavy Weight Fleece Liners - Pair	Yellow	XL



## HEAT ZIP HOOD

### NEOPRENE HOOD

The HEAT Zip Hood, with its integrated zipper and expanding gusset, makes for easy donning and doffing and a perfect fit. The 7mm neoprene side panels keep you warm and the grip strips keep your mask in place.

#### KEY FEATURES

- Zipper with gusset for comfortable donning and doffing
- Molded vent valves release trapped air from within the hood
- Grip strips located at hood sides prevent mask strap from slipping
- 7mm neoprene side panels for optimum warmth
- Hanging loop at top for quick drying
- Triple glued and blind-stitched construction for warmth
- Weight: 0.5 lb (0.25 kg)



Part #	Description
SU348111	Hood, HEAT Zip, Black, SM
SU348112	Hood, HEAT Zip, Black, MD
SU348113	Hood, HEAT Zip, Black, LG
SU348114	Hood, HEAT Zip, Black, XL

## POLYTEX HOOD

### (SEPARATE)

- Polytex Hood designed to be used not attached to suit
- Seals around the neck over the drysuit neck seal
- Good for suits used in both diving applications and surface applications
- One size fits all



Part #	Description
62410	Polytex Hood (Separate) One Size Fits All

## **CONTAMINATED WATER EXHAUST VALVE**

- Dual diaphragm exhaust valve reduces the chances of water or contaminants entering the suit
- Dumps air faster than other dual diaphragm exhaust valves
- Low profile exhaust valve
- Ratchet dial allows valve to be adjusted to control air flow



Part #	Description
62465	Contaminated Water Exhaust Valve, Red - APEKS

## **CONTAMINATED WATER INFLATOR VALVE**

- In case of a stuck inflator button, the slider shut off allows you to stop the inflation without disconnecting the hose
- Slide valve is marked open/closed with positive click



Part #	Description
62466	Contaminated Water Inflator Valve, Red - APEKS

## **EXHAUST VALVE - STANDARD**

- Standard Apeks low profile exhaust valve
- Ratchet dial allows valve to be adjusted to control air flow



Part #	Description
62231	Exhaust Valve - Standard - APEKS

## **INFLATOR VALVE - STANDARD**

- Standard Apeks swivel inflator valve with nipple protector



Part #	Description
62233	Inflator Valve - Standard - APEKS

## **VALVE PLUG**

- Acts as a plug when exhaust and inflator valves are removed



Part #	Description
62522	Valve Plug - APEKS

## **NON MAGNETIC EXHAUST VALVE**

- Non Magnetic low profile exhaust valve
- Ratchet dial allows valve to be adjusted to control air flow
- All materials and components designed to meet requirements of:  
NATO STANAG 2897 and USN standard MIL-DTL-19595



Part #	Description
62468	Non Magnetic Exhaust Valve - APEKS

## **NON MAGNETIC SWIVEL INFLATOR VALVE**

- Non Magnetic swivel inflator valve with nipple protector
- CEJN type male connector
- All materials and components designed to meet requirements of:  
NATO STANAG 2897 and USN standard MIL-DTL-19595



Part #	Description
62225	Non Magnetic Swivel Inflator Valve, CEJN Connector - APEKS

## **NON MAGNETIC LOW PRESSURE INFLATION HOSE**

- Non Magnetic quick disconnect drysuit inflator hose
- Supplied with hose protectors at both hose ends
- CEJN type female connector
- All materials and components designed to meet requirements of:  
NATO STANAG 2897 and USN standard MIL-DTL-19595



Part #	Description
61892	Non Magnetic Low Pressure Inflation Hose, CEJN Connector - APEKS



## REPLACEMENT POLYTEX NECK SEAL

- User replaceable if purchased with adhesive

Part #	Description	Size
62321	Polytex Neck Seal - W/Dry Adhesive	One Size
62325	Polytex Neck Seal - W/Dry Adhesive	S
62324	Polytex Neck Seal - W/Dry Adhesive	M
62323	Polytex Neck Seal - W/Dry Adhesive	L
62326	Polytex Neck Seal - W/Dry Adhesive	XL
62322	Polytex Neck Seal - W/Dry Adhesive	2XL
62137	Polytex Neck Seal - No Adhesive	One Size
62141	Polytex Neck Seal - No Adhesive	S
62140	Polytex Neck Seal - No Adhesive	M
62139	Polytex Neck Seal - No Adhesive	L
62142	Polytex Neck Seal - No Adhesive	XL
62138	Polytex Neck Seal - No Adhesive	2XL



## REPLACEMENT SILICONE NECK SEAL

- Trim to fit
- Extremely comfortable, good for people with allergies to latex
- Must have SLT Neck System to use - cannot be used with an attached hood

Part #	Description	Size
62455	Silicon Neck Seal	Standard
62524	Silicon Neck Seal	Small



## REPLACEMENT POLYTEX WRIST SEALS (Pair)

- User replaceable if purchased with adhesive
- Bell design in durable Polytex material resists tearing

Part #	Description	Size
62327	Polytex Wrist Seals - W/Dry Adhesive	One Size
62331	Polytex Wrist Seals - W/Dry Adhesive	S
62330	Polytex Wrist Seals - W/Dry Adhesive	M
62329	Polytex Wrist Seals - W/Dry Adhesive	L
62332	Polytex Wrist Seals - W/Dry Adhesive	XL
62328	Polytex Wrist Seals - W/Dry Adhesive	2XL
62145	Polytex Wrist Seals - No Adhesive	One Size
62149	Polytex Wrist Seals - No Adhesive	S
62148	Polytex Wrist Seals - No Adhesive	M
62147	Polytex Wrist Seals - No Adhesive	L
62150	Polytex Wrist Seals - No Adhesive	XL
62146	Polytex Wrist Seals - No Adhesive	2XL



## REPLACEMENT POLYTEX PRO WRIST SEALS (Pair)

- Heavy duty conical manchette design provides more sealing area against skin
- One size—trim to fit

Part #	Description
62333	Pro Wrist Seals - W/Dry Adhesive
62136	Pro Wrist Seals - No Adhesive



## REPLACEMENT SILICONE WRIST SEAL

- Very comfortable
- Trim to fit
- Good for people with latex allergies
- Must have wrist rings on suit to use



Part #	Description
62454	Silicon Wrist Seals, Standard - Each
62502	Silicon Wrist Seals, Small - Each

## REPLACEMENT NEOPRENE WRIST SEALS

- Neoprene wrist seals for Raptor/Osprey



Part #	Description
63050	Raptor/Osprey Neoprene Wrist Seal - Pair
63074	Jig, Raptor/Osprey Neoprene Wrist Seal

## REPLACEMENT POLYTEX ATTACHED HOOD

- Polytex replacement hood for drysuits



Part #	Description
62451	Flared Polytex Hood W/Dry Adhesive
62135	Flared Polytex Hood - No Adhesive

## REPLACEMENT HOOD/NECKSEAL COMBO

- Trim to fit
- Made with durable Polytex material
- Easy to replace in the SLT Neck System
- Field replaceable with dry adhesive



Part #	Description
62519	Polytex Hood/Neck Seal combo for SLT System
62469	Polytex Hood/Neck Seal combo W/Dry Adhesive

## DRYSUIT REPAIR (PATCH) KITS

- Repair and Patch kits include:
  - Material patches
  - Adhesive tape
  - Alcohol prep pads
  - Owner's Manual with instructions
- HAZMAT patch kit is suitable for:
  - HAZMAT
  - ENVIRO HYBRID
  - ENVIRO
- Nylon patch kit is suitable for:
  - FUSION inner DryCore
  - KODIAK 360



*Note: Contents of kits may change as result of continual product improvement policy*

Part #	Description
61800	Patch Kit, HAZMAT
62343	Patch Kit, Black Nylon Drysuit
62948	Patch Kit, ENFORCER
DR911162	Patch Kit, RAPTOR
DR911163	Patch Kit, OSPREY

## DRY ADHESIVE

- 2 strips of dry adhesive tape (16" EA.)
- Apply around wrist to attach Polytex cuffs

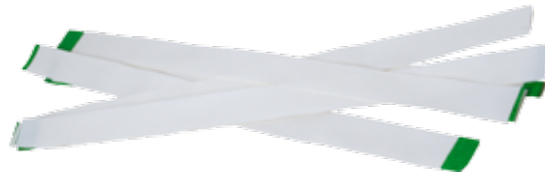

Part #	Description
611577	Dry Adhesive Tape

## DRY ADHESIVE NECK RING

- Allows for easy installation of a Polytex neckseal
- Apply around neck seal to attach Polytex neck seal



Part #	Description
611576	Dry Adhesive Neck Ring

## UV TECH SEAL PROTECTOR

- UV blockers protect surfaces from sun damage and color fading
- Conditions and seals plastic, vinyl, rubber, nylon, fiberglass and more
- Prevents rubber from drying or cracking
- Replaces lost plasticizers
- Improves appearance, enhances color
- Nontoxic, eco-friendly formula



Part #	Description
61832	UV Tech Seal Protector (4 oz)

## AQUA LUNG TRAVELER BACKPACK

- 600 denier heavy duty coated fabric for excellent durability
- Metal YKK coil zippers slide around corners with ease
- Large semi-dry internal sleeve pocket fits undergarments
- Main compartment is fully ventilated with side mesh panels
- Ventilated exterior front pocket - perfect for your Evo 4 Boots
- Molded carrying handles on top and side
- Hideaway padded backpack straps make this bag airport carousel-friendly
- External ID pocket



Part #	Description
611800	Traveler Backpack

## AQUA LUNG MILITARY BAG

- 600 denier heavy duty coated fabric for excellent durability
- Heavy duty non-corrosive YKK plastic tooth zippers chew through grit
- Large semi-dry internal sleeve pocket fits undergarments
- Dual exterior zippered pockets
- Padded on one side with adjustable backpack straps
- Carrying handles with comfort handle wrap and 2" webbing that wraps around bag
- Adjustable shoulder strap with metal swivel hardware
- Large, durable bag used by military and many police/rescue organizations



Part #	Description
611799	Military Bag

## AQUA LUNG PUBLIC SAFETY BAG

- Constructed of 100 denier nylon
- Heavy duty corrosion resistant zipper
- Comfort handle wrap for easy carrying
- Label window on outside of bag



Part #	Description
612323	Public Safety Bag

## AQUA LUNG CANADA - MILITARY & PROFESSIONAL (M&P) ACCOUNTS TERMS & CONDITIONS (T&C) 2020-21

1. All orders or requests for M&P products, or destined for M&P end-users, are to be processed by the Aqua Lung Canada M&P sales team.
2. M&P accounts have no retail or resale privileges unless approved in writing by Aqua Lung Canada M&P manager.
3. Aqua Lung Canada reserves the right to accept or reject all orders at their Saanichton office.
4. M&P accounts are not permitted to export products unless approved in writing by Aqua Lung Canada M&P manager.
5. Applicable excise, sales, use or other taxes will be added as required.
6. All orders will be F.O.B. Saanichton, BC, Canada unless agreed otherwise in writing.
7. Claims for shortage on sealed cartons must be filed with Aqua Lung Canada within 10 days after receipt.
8. Accounts that fail to maintain a current status will be moved to prepay status.
9. Orders will not be processed for past due accounts.
10. No cash refunds. Credit only on account.
11. All returns must be authorized and issued with a return material authorization (RMA) number by Aqua Lung Canada.
12. No return shipment will be accepted freight collect.
13. Failure to meet any of the above criteria can result in account termination at Aqua Lung Canada's sole discretion.
14. Service kits and parts for breathing / life support systems are available for purchase by trained technicians only (proof of training may be required).
15. Sales of specific products (e.g. Aviation) and to specific customers (e.g. Military and Public Safety) are reserved to Aqua Lung Canada. Requests for these sales will be considered on a case-by-case basis upon application.



# AQUALUNG<sup>®</sup>

## Military & Professional



### **AQUALUNG CANADA LTD**

Military & Professional Division  
6820 Kirkpatrick Crescent  
Saanichton  
BC V8M 1Z9 Canada

+1.250.652.5881

[militarycanada@aqualung.com](mailto:militarycanada@aqualung.com)  
[professionaldivecanada@aqualung.com](mailto:professionaldivecanada@aqualung.com)  
[commercialdivecanada@aqualung.com](mailto:commercialdivecanada@aqualung.com)  
[aviationcanada@aqualung.com](mailto:aviationcanada@aqualung.com)

**Part of the  
AQUALUNG GROUP**

[www.aqualung.com/militaryandprofessional](http://www.aqualung.com/militaryandprofessional)  
[www.aqualungdrywear.com](http://www.aqualungdrywear.com)