

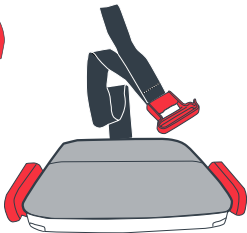

mifold

Grab-and-Go Booster®

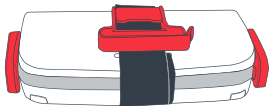

Model Number: MF12-CA
Globally Regulated Version

For Children:

at least 4 years of age

18 to 45 kg (40 to 100 lbs.)

91 cm to 150 cm (36 to 59 inches)

- This child restraint conforms to all applicable Canadian Motor Vehicle Safety Standards 213.2 for use in motor vehicles with lap/shoulder belts.



This child restraint is **NOT** certified for use in aircraft.

Table of Contents

Weight and Height Use Recommendations	1-2
ifold - Booster Seat Parts	3
Warnings	4-5
Proper Use Checklist	6
Selecting a Vehicle Seating Location	7-9
Vehicle Seat Belt Systems	9-10
Storing Your Booster Seat	11
Note About Switchable Retractors	11
Booster seat Installation	12-13
Securing Child on Booster Seat	14-17
Removing Child from Booster Seat	18
Removing and Storage of Booster Seat	18-19
Re-Use After a Crash	19-20
Additional Information	21-23

Weight and Height Use Recommendations

- Child **MUST** be at least 4 years old.
- Child's weight **MUST** be between 18 and 45 kg (40 and 100 lbs.).
- Child's height **MUST** be between 91 and 150 cm (36 and 59 inches).
- Use only with a child that has outgrown their car seat with a 5-point harness and can sit in the booster seat properly for the entire duration of each trip. If your child will not remain seated properly, your child should use a child restraint with a 5-point harness.



Weight and Height Use Recommendations

- Child **MUST** be at least 4 years old.
- Child's weight **MUST** be between 18 and 45 kg (40 and 100 lbs.).
- Child's height **MUST** be between 91 and 150 cm (36 and 59 in.).
- Use only with a child that has outgrown their car seat with a 5-point harness and can sit in the booster seat properly for the entire duration of each trip. If your child will not remain seated properly, your child should use a child restraint with a 5-point harness.
- "Outgrown" means the child's weight or height exceeds the use limits for the car seat.
- "Sitting properly" means the child must remain seated without slouching under lap belt, moving shoulder belt under arm or behind back, or leaning forward or sideways moving out of position so the vehicle belt remains properly positioned.
- A booster seat is designed to position the adult vehicle belt correctly on the child.
- Vehicle lap belt **MUST** be positioned on the pelvis such that it is low on hips, contacting highs and not up on the abdomen.
- Full width of vehicle shoulder belt **MUST** be on child's shoulder (not in contact with the Neck and not off the shoulder).
- Child restraint laws vary from province to province. Check your local laws as they may have specific use requirements.
- **DO NOT** use when:
 - Child does not remain seated properly or does not keep the vehicle belt properly positioned.
 - Child's weight exceeds 45 kg (100 lbs.).
 - Child's height exceeds 150 cm (59 in.).
 - The vehicle belt fits on your child correctly without a booster seat.

mifold - Booster Seat Parts

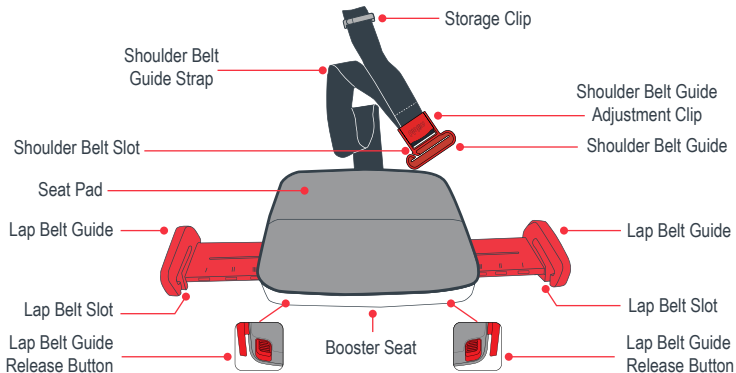

WARNING - DEATH or SERIOUS INJURY can occur

Failure to follow these instructions and car seat labels can result in child striking the vehicle's interior during a sudden stop or crash.

- Proper use is required:
 - Read and follow all instructions and information in this manual, product labels, and in the vehicle owner's manual for Booster Seat and vehicle seat belt use.
 - Improper use of the Booster Seat or vehicle seat belt can result in serious injury or death from a sudden stop or crash.
- Use **ONLY** with children who weigh between 18 and 45 kg (40 and 100 lbs.) and whose height is between 91 and 150 cm (36 and 59 inches) and are at least 4 years old.
- Use only the vehicle's lap and shoulder belt system when restraining a child in this Booster Seat. Lap belt portion **MUST** be inserted through both belt guides.
- Snugly adjust vehicle lap and shoulder belt around child according to vehicle owner's manual.
- Always properly position vehicle belts on child and snugly adjust vehicle belts around child.
 - Vehicle lap belt **MUST** be positioned low on hips, contacting thighs and not up on the abdomen.
 - Vehicle shoulder belt **MUST** be centered on child's shoulder (not touching neck and not off shoulder).
 - **NEVER** use shoulder belt loose, positioned under child's arm, or behind child's back.

WARNING - DEATH or SERIOUS INJURY can occur

- NEVER use Booster Seat with only a vehicle lap belt across front of child. Use of lap belt only can result in serious injury or death.
- NEVER use Booster Seat in a vehicle front seat location unless recommended in vehicle owner's manual.
- Discontinue use of Booster Seat when top of child's ears are above top of vehicle seat back or headrest. Severe head and neck injuries can result without proper head support.
- NEVER use this Booster Seat with vehicle's UAS car seat attachment system.
- Secure Booster Seat even when not occupied. Unsecured items may injure other occupants in a crash.
- DO NOT use Booster Seat if it has been in a crash or is damaged, missing parts or the instruction manual is missing.
- Register child restraint with the manufacturer. See Registration section.
- NEVER leave child unattended.
- This Booster Seat is certified for use in motor vehicles. DO NOT use this Booster Seat in the home, on boats, on aircraft or other non-certified applications.
- Only use Booster Seat on forward-facing vehicle seats with child facing front of vehicle.
- Do not use this child restraint 7 years after the original date of purchase (proof of purchase required) or manufacturing date printed on the Shoulder Belt Guide Adjustment Clip otherwise. Please keep a copy of your invoice with your instruction manual in the manual storage location.

Proper Use Checklist

- ✓ Booster Seat and child's back **MUST** make contact with vehicle seat back.
- ✓ Vehicle Lap and Shoulder Belt **MUST** be properly positioned on child.
 - Lap Belt low on hips, contacting thighs and not up on the abdomen.
 - Shoulder Belt centered on child's shoulder.
 - Lap and Shoulder Belt snugly adjusted around child.
- ✓ If the vehicle owner's manual allows a car seat to be placed in the seating position with a frontal airbag, adjust seat back, away from airbag, as far as possible according to the vehicle owner's manual.



- ✓ Child **MUST** be sitting up, with back against vehicle seat back not slouching down under Vehicle Lap Belt.
- ✓ Top of child's ears are below top of vehicle seat back or vehicle headrest.



No car seat can guarantee protection from injury in every situation, but proper use helps reduce the risk of serious injury or death.

Selecting a Vehicle Seating Location

WARNING

DEATH or SERIOUS INJURY can occur

- DO NOT use Booster Seat in a seating position with a frontal air bag unless recommended by the vehicle manufacturer.
- DO NOT use Booster Seat with a Vehicle Lap Belt **ONLY**.



- Refer to vehicle owner's manual for information on securing children and vehicle seat belt use.
- NOT all vehicle seat belts can be used with the Booster Seat. Read vehicle owner's manual on Booster Seat use and the "Vehicle Seat Belt Systems" section in this manual.

Select a Seating Location To Use:

- Select a vehicle seating location that faces the front of the vehicle and has a Vehicle Lap and Shoulder Belt system.

Selecting a Vehicle Seating Location

Vehicle Seating Locations NOT To Use:

1. Universal Anchorage System (UAS):

- Do not use the vehicle Universal Anchorage System (UAS) with this Booster Car Seat.

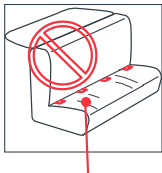

Universal Anchorage System (UAS)

2. Side Facing and Rear Facing Seats:

- DO NOT use on side or rear-facing vehicle seats.

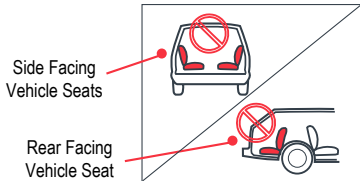

Side Facing Vehicle Seats

Rear Facing Vehicle Seat

Select A Vehicle Seating Location

According to accident statistics, children age 12 and under are safer when properly restrained in the rear seating positions rather than the front seating positions. For vehicles with air bags, refer to vehicle owner's manual for child restraint installation information.

WARNING

DEATH or SERIOUS INJURY can occur

- The back seat is the safest place for children 12 and under.

Vehicle Seat Belt Systems

- This Booster Seat **MUST** be used with a Vehicle Lap and Shoulder Belt system. **DO NOT** use the Vehicle Belt systems in this section.

1. Lap Belts ONLY Systems:

Vehicle Seating Locations With ONLY A Lap Belt:

- Do NOT use seating locations with Lap Belt ONLY.

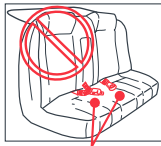

Lap Belt Only

Vehicle Seat Belt Systems

2. Passive Restraint Systems:

A. Motorized Shoulder Belts:

- Do not use seating locations with motorized shoulder belts.

Motorized
Shoulder Belt

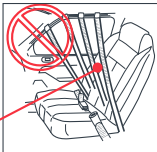

B. Door Mounted Lap And Shoulder Belt:

- Do not use front seating locations where seat belts are mounted to the door.

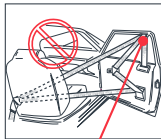

Belts Mounted
To Door

C. Inflatable Seat Belt Systems:

- mifold has revised its recommendations based upon an analysis of vehicle seat belt system test results. The Ford Motor Company Inflatable seat belt system fitted to Ford and Lincoln model vehicles is approved for use with the mifold grab-and-go booster seat under model number MF12-CA. (The model number is printed on the Shoulder Belt Guide Strap).

Storing Your Booster Seat

mifold comes with a Storage Clip which is attached to the end of the Shoulder Belt Guide Strap to hold your mifold tightly closed when stored or carried around.

To close the mifold:

- Fold the mifold and wrap the Shoulder Belt Guide Strap around the folded booster ①.
- Slide the Storage Clip into the Shoulder Belt Guide Strap ②.

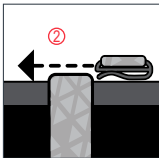

Note About Switchable Retractors

A note about switchable retractors:

Many vehicles have a lap and shoulder belt system in which the retractor can be switched from the emergency locking mode (ELR) to an automatic locking mode (ALR). **The ALR mode is not designed for use with booster car seats** and mifold is not recommended for use with a lap and shoulder belt in the ALR mode.

Note: Should the lap and shoulder belt inadvertently be switched into the automatic locking retractor mode (ALR) and the vehicle seat belt is locked, follow the steps below to remove the lap belt.

1. Pull out and hold the shoulder belt to prevent further retraction.
Be aware not to allow shoulder belt webbing to retract during this entire procedure.
2. Have your child lean away from the vehicle buckle.
3. Lift mifold up on the buckle side and remove lap belt.

If the lap and shoulder belt is inadvertently switched into the locking mode, see steps on page 18 to remove child.

Booster Seat Installation

WARNING

DEATH or SERIOUS INJURY can occur

- Use only with the Vehicle's Lap and Shoulder Belt.
- DO NOT use with a Lap Belt only or Universal Anchorage system (UAS).
- Position and snugly adjust Lap Belt, then position and adjust Shoulder Belt.
 - Lap Belt **MUST** be low on hips, contacting thighs and not up on the abdomen.
 - Shoulder Belt must be centered over shoulder (NOT up on neck or off shoulder).
 - DO NOT use Shoulder Belt loose, positioned under child's arms, or behind child.

1. Adjust the width of the Lap Belt Guides.

The Lap Belt Guides have four adjustment positions, one for storage and transport and three to adjust to child as they grow. Position numbers **I**, **II** and **III** on the Lap Belt Guide arms can be used to quickly position the Lap Belt Guides for repeat use.

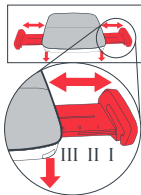

NOTE: The narrowest locked adjustment position is for storage and transportation only.

Booster Seat Installation

- The Lap Belt Guides should be adjusted into the position nearest to, but not touching the sides of the child's thighs.

To adjust width of Lap Belt Guides:

- Pull out and hold Lap Belt Guide Adjustment Button ① and slide Lap Belt Guide out to the maximum position ②. Release Lap Belt Guide Adjustment Button.

Repeat on opposite side.

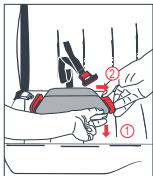

- Adjust to fit child.

- Place Booster Seat with Lap Belt Guides extended on vehicle seat.
- With child sitting on the Booster Seat, slide Lap Belt Guide ① into the position nearest to, but not touching the child's thigh ③.
- Pull out on Lap Belt Guide to check it is locked into position ④.
- Repeat on opposite side.

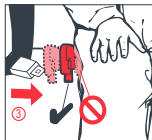

Securing Child on Booster Seat

WARNING

DEATH or SERIOUS INJURY can occur

- DO NOT use Booster Seat in a seating position that has a Vehicle Lap Belt ONLY.
- Vehicle Lap and Shoulder Belt MUST be snugly adjusted around child.
- Vehicle Lap Belt MUST be positioned low on hips, contacting thighs and not up on the abdomen.
- Vehicle Shoulder Belt MUST be over child's chest and centered on shoulder. DO NOT allow child to place Shoulder Belt under arm or behind back.
- NEVER use Booster Seat with only a Lap Belt across front of child. Use of Lap Belt ONLY can result in serious injury or death.

1. Unfold and place Booster Seat on vehicle seat in a seating location that has a Vehicle Lap and Shoulder Belt.

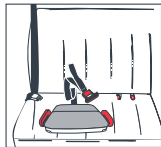

2. Adjust Lap Belt Guides into position for child. See "Booster Seat Installation" section.

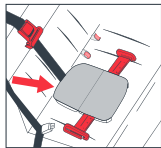

3. Slide Booster Seat back on vehicle seat cushion so that the back of the Booster Seat makes contact with vehicle seat back cushion.

Securing Child on Booster Seat

For contoured vehicle seats, position back of Booster Seat on contour and in contact with vehicle seat back.



4. Seat child on the Booster Seat with child's bottom and back in contact with the vehicle seat back cushion.



5. Secure child with the Vehicle Lap and Shoulder Belt.

- a. Slide Lap Belt portion of vehicle belt completely into the Lap Belt Guides ① and ② and buckle the vehicle seat belt.



NOTES:

- Vehicle Lap Belt **MUST** be inserted through Lap Belt Guides on both sides of seat.
- **DO NOT** place shoulder belt through EITHER Lap Belt Guide.
- **DO NOT** switch lap and shoulder belt into automatic locking retractor (ALR) mode when installing any booster car seat including mifold.



Securing Child on Booster Seat

- b. Pull up on Vehicle Shoulder Belt to remove slack from lap portion of Vehicle Seat Belt and snugly adjust Lap Belt around child. Check that Vehicle Lap Belt is low on hips and contacting thighs.

- c. Place Shoulder Belt Guide Strap behind child's back and adjust the position of the Shoulder Belt Guide so Shoulder Belt Slot is at least 25 mm (1 inch) above top of child's shoulder.



To adjust position of the Shoulder Belt Guide:

- Pull out on Shoulder Belt Guide Adjustment Clip ① to release Shoulder Belt Guide Strap, slide Shoulder Belt Guide into position ② and then press down on the Shoulder Belt Guide Adjustment Clip to lock in place ③.

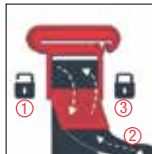

Securing Child on Booster Seat

- d. Slide the Shoulder Belt Guide Adjustment Clip onto the Vehicle Shoulder Belt as shown. The belt must be completely within the Shoulder Belt Guide slot ④.



- e. Pull on Vehicle Shoulder Belt to snugly adjust Vehicle Lap and Shoulder Belt around child according to the vehicle owner's manual. Snugly adjust Lap Belt and then Shoulder Belt.
- f. Check that Vehicle Lap Belt is low on hips and contacting thighs and Vehicle Shoulder Belt is centered on child's shoulder.

WARNING

DEATH or SERIOUS INJURY can occur

- Avoid potential abdominal injury from submarining under Vehicle Lap Belt. Child **MUST** sit with rump and back in contact with the vehicle seat back cushion and vehicle seat belt snugly adjusted.
- To avoid injuries from whiplash, top of child's ears **MUST** be below top of vehicle seat back or headrest.
- Discontinue use of Booster Seat when top of child's ears are above top of vehicle seat back or headrest.

Removing Child from Booster Seat

- Unbuckle Vehicle Lap and Shoulder Belt.
- Slide lap portion of Vehicle Lap and Shoulder Belt out of Lap Belt Guide on buckle side.
- Move Vehicle Lap and Shoulder Belt off of child.
- Remove child from Booster Seat.

Note: Should the lap and shoulder belt inadvertently be switched into the automatic locking retractor mode (ALR) and the vehicle seat belt is locked, follow the steps below to remove the lap belt.

1. Pull out and hold the shoulder belt to prevent further retraction. Be aware not to allow shoulder belt webbing to retract during this entire procedure.
2. Have your child lean away from the vehicle buckle.
3. Lift mifold up on the buckle side and remove lap belt.

If removal of the lap belt is not possible due to the vehicle belt continuing to tighten, the vehicle seat belt should be cut to remove the child.

Removing and Storage of Booster Seat

The mifold Grab-and-Go Booster® folds into a very compact size for easy storage when not in use.

To store Booster Seat:

- Slide Shoulder Belt out of Shoulder Belt Guide Adjustment Clip.
- Slide lap portion of Vehicle Lap Belt out of both Lap Belt Guides.
- Close both Lap Belt Guides into their storage position.
- Remove and fold mifold Booster Seat.

Removing Booster Seat

For transporting Booster Seat when not occupied:

When not occupied, it is recommended to fold and store the mifold in a secure location such as the glove box, trunk, or storage area. However, if it is left on the vehicle seat it **MUST** be secured with a vehicle belt as described below.

- Route lap portion of Vehicle Lap and Shoulder Belt through both Lap Belt Guides.
- Buckle Vehicle Lap and Shoulder Belt and snugly adjust the lap portion of the vehicle belt around Booster Seat.

WARNING

DEATH or SERIOUS INJURY can occur

- Secure this Booster Seat even when not occupied. An unsecured Booster Seat can injure other occupants in a crash.

Re-Use After a Crash

WARNING

DEATH or SERIOUS INJURY can occur

- DO NOT allow any use of this child restraint after a crash where a child was secured in the Booster Seat.
- Do not sell or allow others to use a child restraint that was occupied in a crash.
- This child restraint must be destroyed and replaced if it was occupied during a crash.

Re-Use After a Crash

The mifold Booster Seat is a unique design that absorbs some of the forces in a vehicle crash when occupied by a child. These crash forces can deform parts of the Booster Seat and result in damage that may not be detectable by a visual inspection. As a result, the Booster Seat **MUST** be replaced after any crash in which the Booster Seat was occupied.

For a crash in which the Booster Seat was stored and remained in place or was secured with the lap portion of the vehicle seat belt passing through both lap belt guides, and was unoccupied at the time of crash, the mifold Booster Seat may continue to be used.

Additional Information

Certification:

- **Motor Vehicle Use** - this child restraint meets or exceeds all applicable requirements of Canada's Motor Vehicle Safety Standard 213.2 for use in motor vehicles.

This Booster Seat is for use in passenger cars, multi-purpose vehicles (vans and SUVs), trucks, and school buses that have Vehicle Lap and Shoulder Belt systems.

- **Aircraft Use** -
This Restraint is Not Certified for Use in Aircraft.
Aircraft seats do not provide a lap and shoulder belt system.



Additional Information

This booster seat model is only for sale in Canada.

Using this booster seat model in other countries.

This mifold booster seat is structurally identical to the model that is sold in other countries, and has been tested and certified to regulations UNECE R44/04 for most countries, to FMVSS213 in the USA and to CCC in China. This mifold booster seat can be used by a visitor to any of these countries (except Australia).

Warranty:

- At Carfoldio, we make innovative, high quality products for children. We warrant this product to be free from defects in material and workmanship existing at the time of manufacture for a period of one year from the date of initial purchase (sales receipt is required for proof of purchase). If such a defect is discovered during the limited warranty period, we will, at our sole option, repair or replace your product at no cost to you.

This limited warranty does not cover claims resulting from misuse, failure to follow the instructions on installation, maintenance and use, abuse, alteration, involvement in an accident, and normal wear and tear.

Additional Information

Warranty (continued):

- This limited warranty is exclusive and in lieu of any other warranty, written or oral, including but not limited to any express warranty of merchantability or fitness for a particular purpose. The duration of any implied warranties, including any implied warranty of merchantability or fitness for a particular purpose, is expressly limited to this limited warranty period.

The customer's exclusive remedy for breach of this limited warranty or of any implied warranty or of any other obligation arising by operation of law or otherwise shall be limited as specified herein to repair or replacement, at our sole option. In any event, responsibility for special, incidental and consequential damages is expressly excluded.

Warranty (continued):

- This limited warranty gives you specific legal rights, and you may have other rights that vary from province to province.

For warranty service:

Please call: **1-800-667-8184**

email: **service@mifold.ca**

or write to:

**Elfe Juvenile Products
2520 Ave Marie-Curie,
St-Laurent, QC, H4S 1N1**

Additional Information

Registration and Recall:

- Child restraints could be recalled for safety reasons. You must register this restraint to be reached in a recall. Fill out the registration card attached to the Booster Seat and mail today or send your name, address, e-mail address if available, and the restraint's model number and manufacturing date to: **Elfe Juvenile Products**
2520 Av Marie-Curie,
St-Laurent, QC, H4S 1N1
or call **1-800-667-8184**
or log onto **www.mifold.ca**

Model Number and manufacturing date can be found on the Shoulder Belt Guide Strap label.

Care and Cleaning:

- Surface wash with a mild solution of soap and water. No Bleach. Remove soap by wiping with clean water after washing. Air Dry.

Instruction Manual Storage:

- Store instruction manual in storage compartment located in bottom of Booster Seat.

Replacement Parts:

- This product does not have any replaceable parts.
- For any issues or further information, contact mifold Customer Service at 1-800-667-8184 or by email at service@mifold.ca

For Recall Information:

- Call Transport Canada at **1-800-333-0371**
- Go to **www.tc.gc.ca**
- Call Elfe Juvenile Products at 1-800-667-8184
- Log onto www.mifold.ca
- Email: service@mifold.ca

KEEP INSTRUCTIONS FOR FUTURE USE.

Store instruction manual in storage compartment on bottom of Booster Seat.

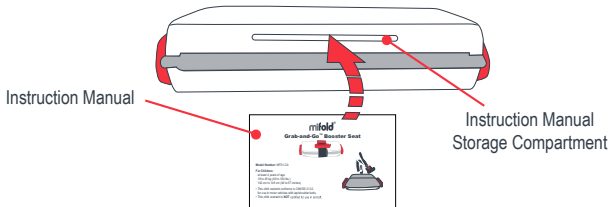

Carfoldio™ and mifold®
are registered trademarks
of Carfoldio Ltd.

This innovative product
is protected by U.S.
Pat. No. 9,376,088,
other patents pending
and various design
registrations.

Manufactured and distributed in the USA by:
Carfoldio Ltd.
10685-B Hazelhurst Dr., #17695
Houston, TX 77043
www.mifold.com

Distributed in Canada by:
Elfe Juvenile Products
2520 Marie-Curie,
Saint-Laurent (QC) H4S 1N1
www.mifold.ca

All pictures are illustrations.
Actual product may vary.

Made in China
© 2021 Carfoldio Ltd.

1606 Rev B - CA (ENG) 21/01