

**TAOTRONICS**

**Questions or Concerns?**

[support@taotronics.com](mailto:support@taotronics.com)



# TAOTRONICS **ICE MAKER**

TT-IC002

**User Manual**

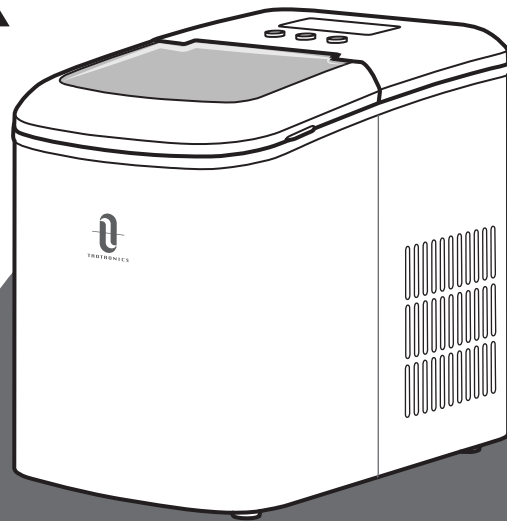

# CONTENTS

1  
01-03

IMPORTANT  
SAFETY  
INSTRUCTIONS

2  
04-07

BEFORE  
USING ICE  
MAKER

3  
08-09

USING  
YOUR ICE  
MAKER

4  
10-11

CLEANING  
AND  
MAINTENANCE

5  
12-13

TROUBLE-  
SHOOTING  
GUIDE

# THANK YOU

FOR BEING OUR CUSTOMER



Your purchase is truly appreciated!  
We hope you are over-the-moon with our product!

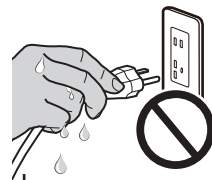

**DO NOT** touch or hold the mains plug with wet hands.



**DO NOT** immerse any part in water or any other liquid.

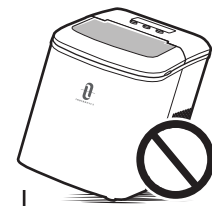

**DO NOT** tip the Ice Maker over.

## IMPORTANT SAFETY INSTRUCTIONS



Settle the appliance for at least 2 hours before plugging in.





# WARNING

WHEN USING ELECTRICAL APPLIANCES, BASIC PRECAUTIONS SHOULD ALWAYS BE FOLLOWED TO REDUCE THE RISK OF FIRE, ELECTRIC SHOCK, AND INJURY TO PERSONS, INCLUDING THE FOLLOWING:

## INTENDED USE

- This appliance is not intended for use by persons (including children) with reduced physical, sensory or mental capabilities, or lack of experience and knowledge, unless they have been given supervision or instruction concerning the use of the appliance by person responsible for their safety.
- Close supervision is necessary when any appliance is used by or near children. Children should be supervised to ensure that they do not play with the appliance. Cleaning and user maintenance shall not be done by children unless they are older than 8 and supervised.
- Use the appliance only for intended household purposes as described in this User Manual. Any other use is not recommended that may cause fire, electric shock, or injury to persons.

## ELECTRICITY SAFETY

- This appliance must be provided with correct voltage via a professionally installed power socket. Make sure the voltage indicated on the label of the appliance is the same as your local supply.
- **DO NOT** operate the appliance if the plug, the main cord or the appliance itself is damaged. Always make sure that the plug is inserted properly into a wall outlet.
- **DO NOT** use an extension cord with this unit.

## RELATED TO USE

- Always make sure to place the Ice Maker on a flat, level surface before operation.
- **DO NOT** let cord hang over edge of table or counter, or touch hot surfaces.
- **DO NOT** use any other liquid to make ice other than water.
- **DO NOT** use mechanical devices to defrost.
- **DO NOT** attempt to disassemble, repair, modify or replace any part any part of your product. All servicing should be performed by qualified personnel only.
- **DO NOT** tip the appliance over. If it is stored tipped over, please set upright for at least 2 hours before plugging it in.
- Always unplug the appliance before cleaning, making any repairs or servicing, or whenever not in use.
- If the appliance is stored in a cold environment, wait at least 3 hours for the appliance to warm to room temperature before plugging it in.

## FOR HOUSEHOLD USE ONLY READ AND SAVE THESE INSTRUCTIONS



**HAVE YOUR ICE  
MAKER CHECKED  
REGULARLY FOR  
ANY SIGN OF  
MALFUNCTION!**

**Check if Plug, cord or appliance is damaged**  
Stop using, check FAQ and contact TaoTronics Support Team.

## SPECIFICATIONS

Model	TT-IC002
Voltage	120V~60Hz
Rated Power	120 W
Daily Capacity	26lbs. / 12kg
Ice Basket Capacity	1.3lbs. / 0.6kg
Water Reservoir Capacity	2.1L

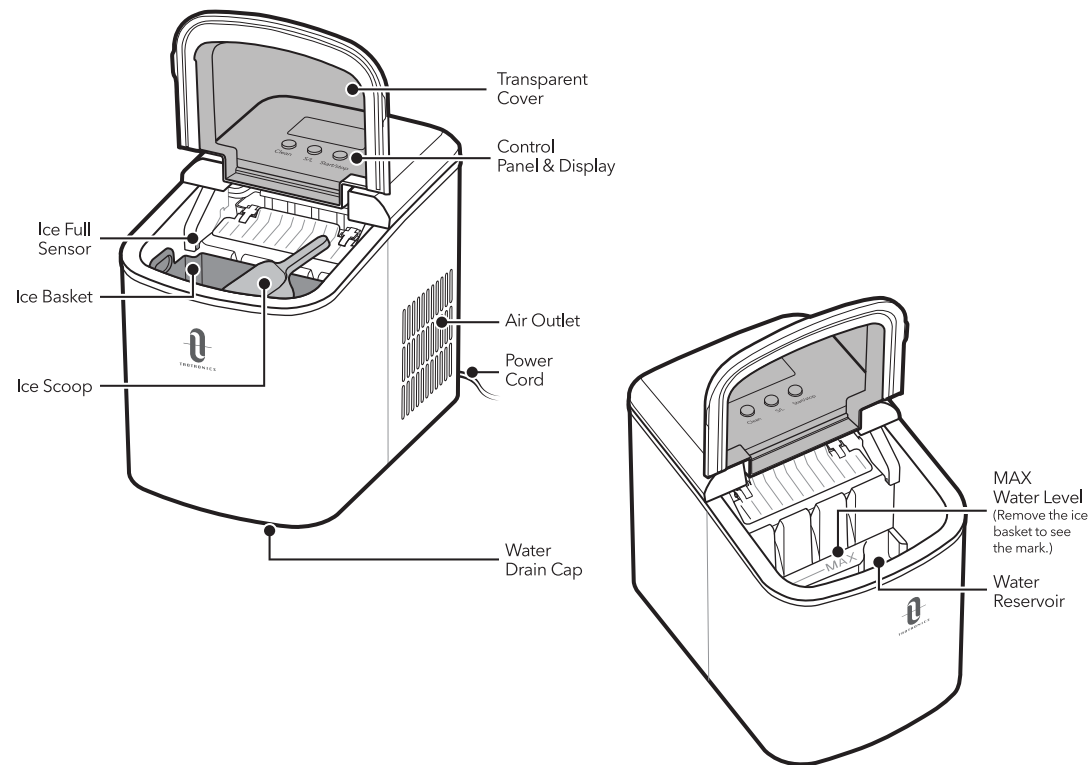

## PREPARING FOR USE



- 1 Remove all exterior and interior packaging. Check that all parts are inside.
- 2 Clean the interior, ice basket and ice scoop with lukewarm water and a soft cloth.
- 3 Place upright on a flat, level surface away from direct sunlight and/or other heat sources.
- 4 Settle the appliance for at least 2 hours before plugging in.

# 2

**BEFORE  
USING ICE  
MAKER**

## CONTROL PANEL AND DISPLAY



### Display Screen



### Control Panel





If you reselect the ice size during ice making, the new size will be made only when the previous cycle is completed.

1.

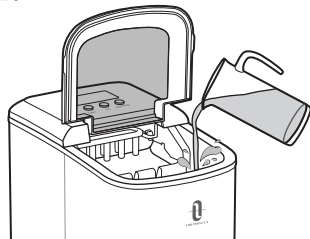

Fill with clean drinking water.  
**Do not** exceed the MAX line.

2.

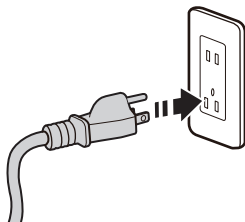

Plug into a properly installed grounded wall outlet.

3.

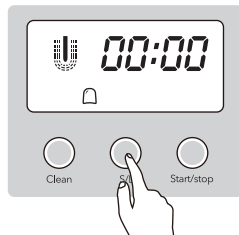

Press **S/L** to select the desired size of ice (Small / Large).

4.

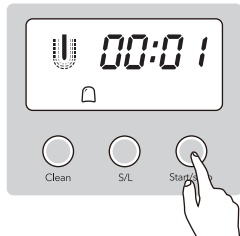

Press **Start/Stop** to start ice making cycle (6~8 minutes).

5.

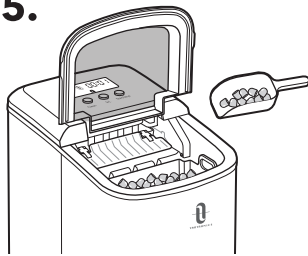

Once ready, remove the ice from the basket with scoop.

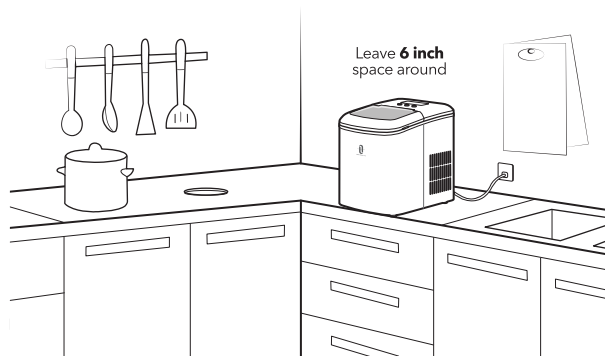

Iced Drinks



First Aid





Smoothies



Fresh Food



**NOTE**

- When  "Add Water" lights up, fill water up to the max level and press "Start/Stop". When  "Ice Full" lights up, remove the ice in time.
- It is recommended to change water every 24 hours to ensure a reasonable hygiene level.
- Not a freezer, please put the ice in use or into freezer once it is made.

# USING YOUR ICE MAKER

## SYSTEM CLEANING



Plug the ice maker into a properly installed grounded wall outlet before system cleaning.

1.

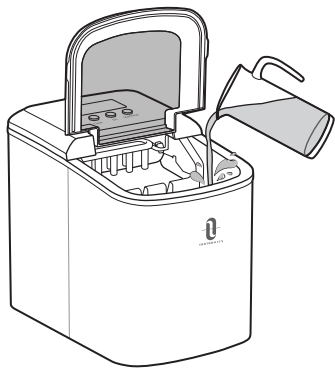

Fill with clean drinking water.  
**Do not** exceed the MAX line.

2.

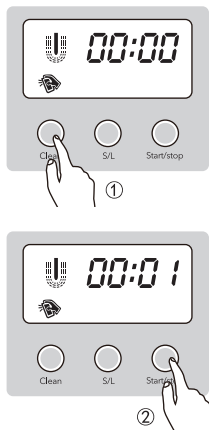

Press **Clean**, then press **Start/Stop** to start cleaning cycle.

3.

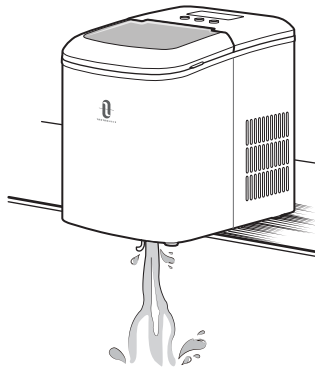

Once completed, drain out the water by unplugging the drain cap.

## REGULAR CLEANING

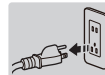

Unplug the ice maker before regular cleaning.



- 1 Take out the ice basket.
- 2 Clean the interior with warm water and a soft cloth.
- 3 Rinse inside parts and drain out the water.
- 4 Clean the exterior with lukewarm water and a soft cloth.
- 5 When not in use for an extended period of time, drain water completely and dry the interior.

# 4 CLEANING AND MAINTENANCE



Problem	Possible Causes	Solution
<b>"Add Water" indicator is on</b>	Lack of water	Fill water up to the max level and press "Start/Stop"
<b>"Ice Full" indicator is on</b>	The ice basket is full	Remove the ice from the basket with scoop
<b>No indicator lights up on display</b>	Not connected to a power source	Be sure to connect to an appropriate electrical outlet
	The fuse blows	Contact TaoTronics Support Team
<b>Ice cubes are sticking together</b>	Incorrect size of ice is selected	Select the small size ice cube
	Ice cubes are left in water reservoir	Stop the appliance, and restart it when the ice cubes melt
<b>Ice making cycle is normal but no ice is being formed</b>	Room or water temperature is too high	Suggested room temperature: 50°F - 105°F / 10°C - 40°C Suggested water temperature: 40°F - 90°F / 4°C - 32°C
	Refrigerant in cooling system is leaking	Contact TaoTronics Support Team
	Pipe in the cooling system is blocked	Contact TaoTronics Support Team
<b>"Ice Full" indicator is not on when the ice basket is full</b>	Ice full sensor failed	Contact TaoTronics Support Team
	Infrared detection is affected by strong light	Move the ice maker to relatively dark place

The troubleshooting guide addresses the most common problems. If problems persist, feel free to contact the Customer Support at

[support@taotronics.com](mailto:support@taotronics.com) 

# 5 TROUBLESHOOTING GUIDE

## WARRANTY AND SERVICE

### Thanks for choosing TaoTronics Ice Maker.

This product is covered with TaoTronics product and labor warranty for 12 months from the date of its original purchase.

### The warranty will not apply in cases of:

- Accident, misuse, or repairs performed by unauthorized personnel.
- Any unit that has been tampered with or used for commercial purpose.
- Normal wear and tear of wearable parts.
- Use of force, damage caused by external influences.
- Damage caused by non-observance of the User Manual, e.g. connection to an unsuitable mains supply or non-compliance with the instructions.
- Partially or completely dismantled appliances.
- Defects caused by or resulting from damages from shipping or from repairs, service, or alteration to the product or any of its parts that have been performed by a repair person not authorized by TaoTronics.

We can only provide after sales service for products that are sold by TaoTronics or TaoTronics authorized retailers and distributors. If you have purchased your unit from a different place, please contact your seller for return and warranty issues.

※ **Please have your invoice and order ID ready before contacting Customer Support.**

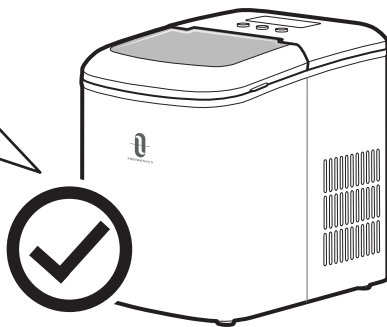

support@taotronics.com



www.taotronics.com



Manufacturer: Shenzhen NearbyExpress Technology Development Co.,Ltd.  
Address: Floor 7, Building E, Galaxy World Phase II, Shenzhen, China



**Intertek**  
MADE IN CHINA

尺寸：160\*120mm

装订成册

材质：封面128克铜版纸 内页80克书纸