



INSTRUCTION MANUAL

MODEL:RIMI-3306



ASSEMBLY GUIDE



Congratulations, you are now the owner of a brand new Rimiking chair!

Before enjoy the comfort chair, you have to put it together. This Assembly Guide will take you through the basic assembly process. To make sure your assembly goes smoothly, please follow the assembly instructions, **and especially the important safety information.**

It is possible to assemble the chair by your own, while having **a second person to help you makes it more easier.**

And please check if there are any missing parts from the package before start. If there be any issues, please don't hesitate to drop us an email and we'll help you out ASAP.

If you run into any difficulty during the assembly, remember to check out the assembly Video to see if you've missed anything. If you're unable to resolve your problems, drop us an email as well and our support team will assist you.



On YouTube: <https://youtu.be/lirAj1cXULc>



WARNING

To ensure proper assembly, follow all steps and use all parts. Failure to follow this warning can result in serious injury to yourself or others.



PACKAGE LIST



①



Back Cushion *1

②



Seat Cushion *1

③



Arms *2

④

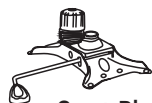

Seat Plate *1

⑤



Lift *1

⑥



Star Base *1

⑦



Casters *5

⑧



Bolts M8*25mm *4

⑨



Bolts M8*35mm *4

⑩



Bolts M8*35mm *4

⑪



Bolts M6*30mm *6

⑫



Bolts M5*12mm *4

⑬



Right Adjuster *1

⑭



Left Adjuster *1

⑮



Right Plastic Cover-01*1

⑯



Left Plastic Cover-01 *1

⑰



Right Plastic Cover-02 *1

⑱

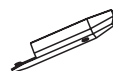

Left Plastic Cover-02 *1

⑲



Head Pillow *1

⑳



Back Pillow *1

㉑



Lift Cover *1

㉒



Plastic Washer *4

㉓



Plastic Caps *4

㉔

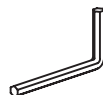

Wrench *2

» ASSEMBLY INSTRUCTION «

STEP 1 : Turn the Star Base(6) upside down, then press the Casters(7) into the holes at the end of each base leg, insert the Lift(5) into the center hole of the Star Base, the Lift Cover(21) should be placed over the Lift.

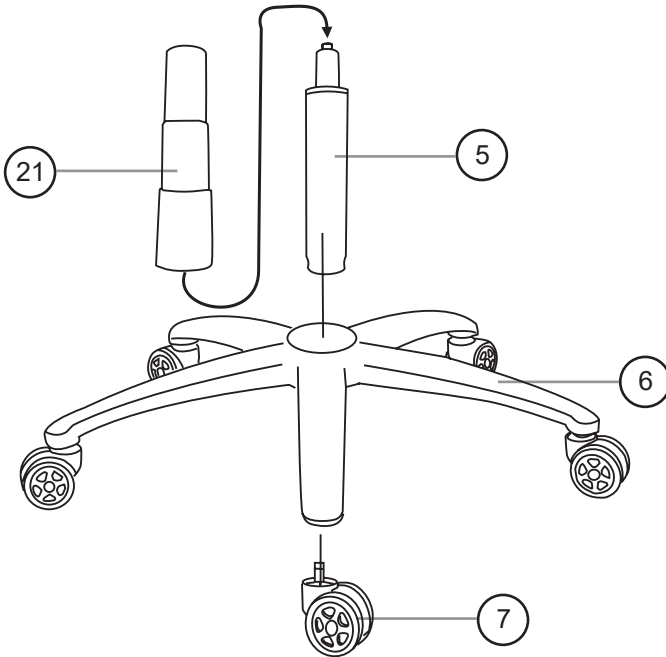

» ASSEMBLY INSTRUCTION «

STEP 2 : Attach the Arms(3) to the seat cushion with Six Bolts M6*30mm(11) , using the Wrench(24) .

Note : Arm rests are labeled with an "L" (left) or "R" (right) to show which sides they should be placed on.

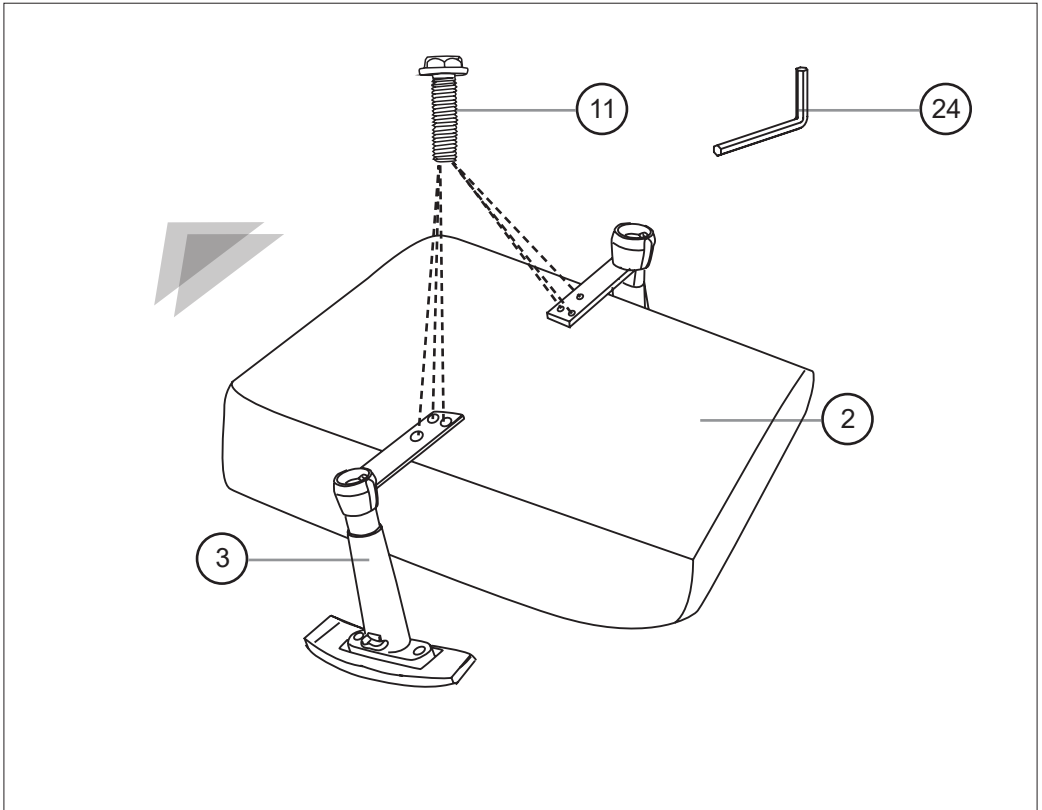

» ASSEMBLY INSTRUCTION «

STEP 3 : Align the Seat Plate(4) over the pre-drilled holes underneath the Seat Cushion(2), make sure that the front of the seat plate is facing the front of the Seat Cushion. Attach the Seat Plate to the Seat Cushion using Four BoltsM8*25mm(8), tighten all the bolts with the Wrench(24), being careful not to miss-thread the bolts or damaged the seat.

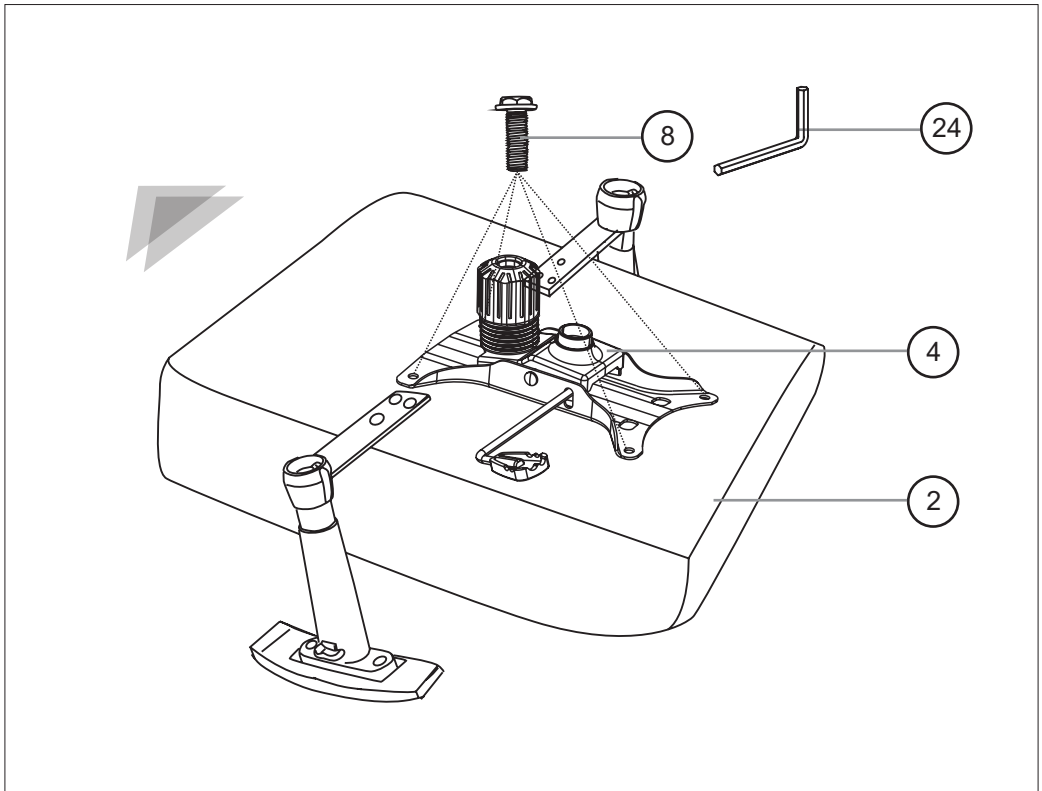

» ASSEMBLY INSTRUCTION «

STEP 4 : Turn the Seat Cushion(2) upright and align the center hole of the seat plate over the lift, then push the seat cushion down onto the lift firmly until the connection is secure.

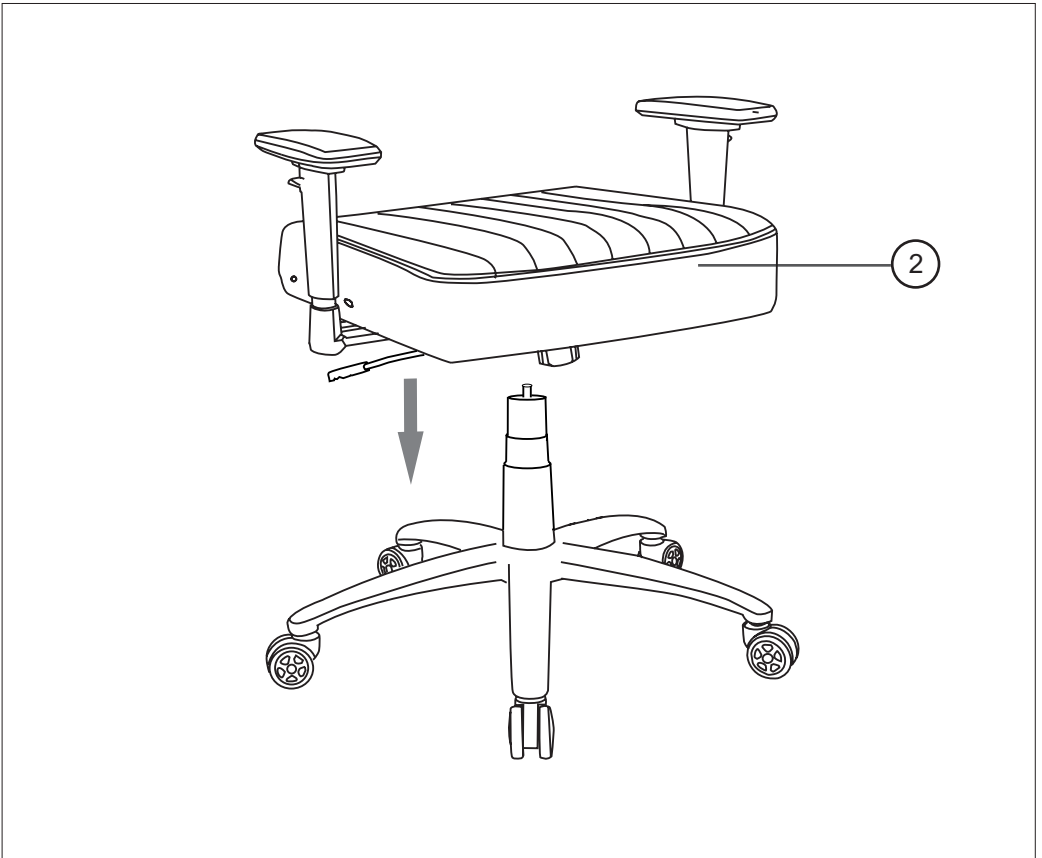

» ASSEMBLY INSTRUCTION «

STEP 5 : Using Adjusters(13/14) to attach Seat Cushion(2) , align the adjusters over the pre-drilled holes underneath the seat cushion with Four Plastic Washers(22) and Four Bolts M8x35mm Bolts(10), tighten all the bolts with the wrench(24).

Note : Do not tighten all the bolts to 100%, make sure it have space to adjust in the next steps.

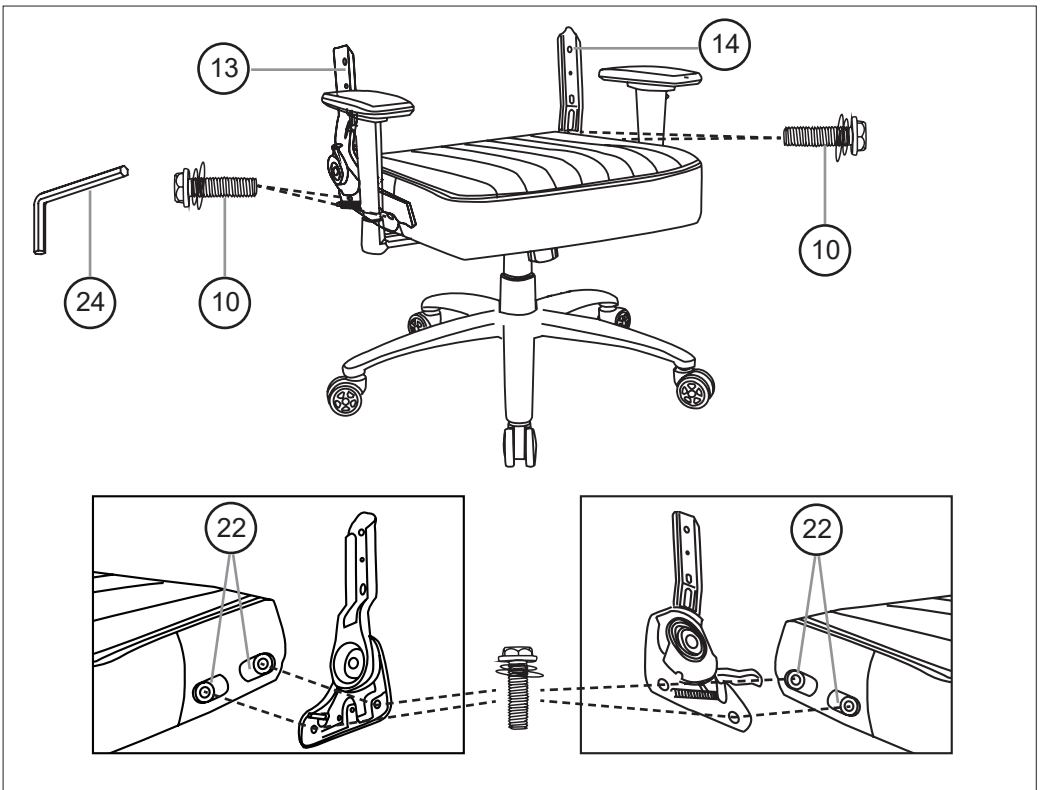

» ASSEMBLY INSTRUCTION «

STEP 6 : Attach Seat Cushion(2) and Back Cushion(1), align adjusters over the pre-drilled holes underneath the Back Cushion with Four Bolts M8x35mm(9), Please Adjust the Balance of Each Sides, then tighten all the bolts with the wrench(24).

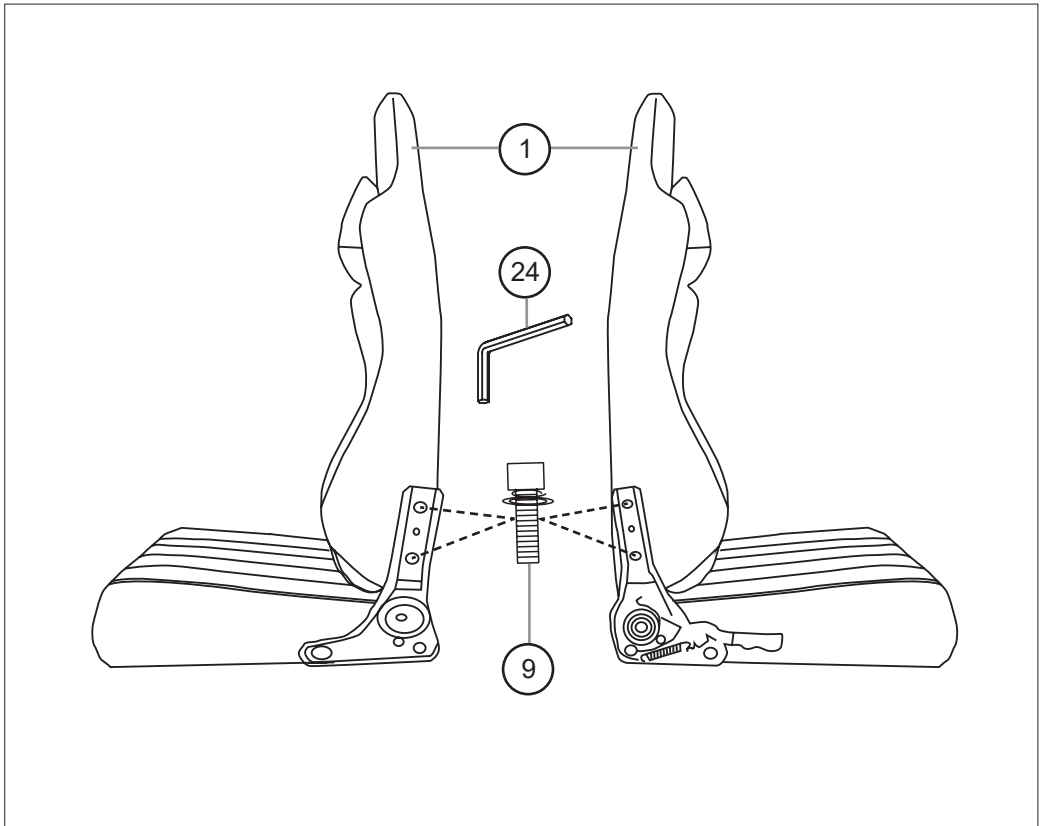

» ASSEMBLY INSTRUCTION



STEP 7 : Attach the Plastic Covers(15/16/17/18) on right and left side with four Bolts M5X12mm(12), using the wrench(24).

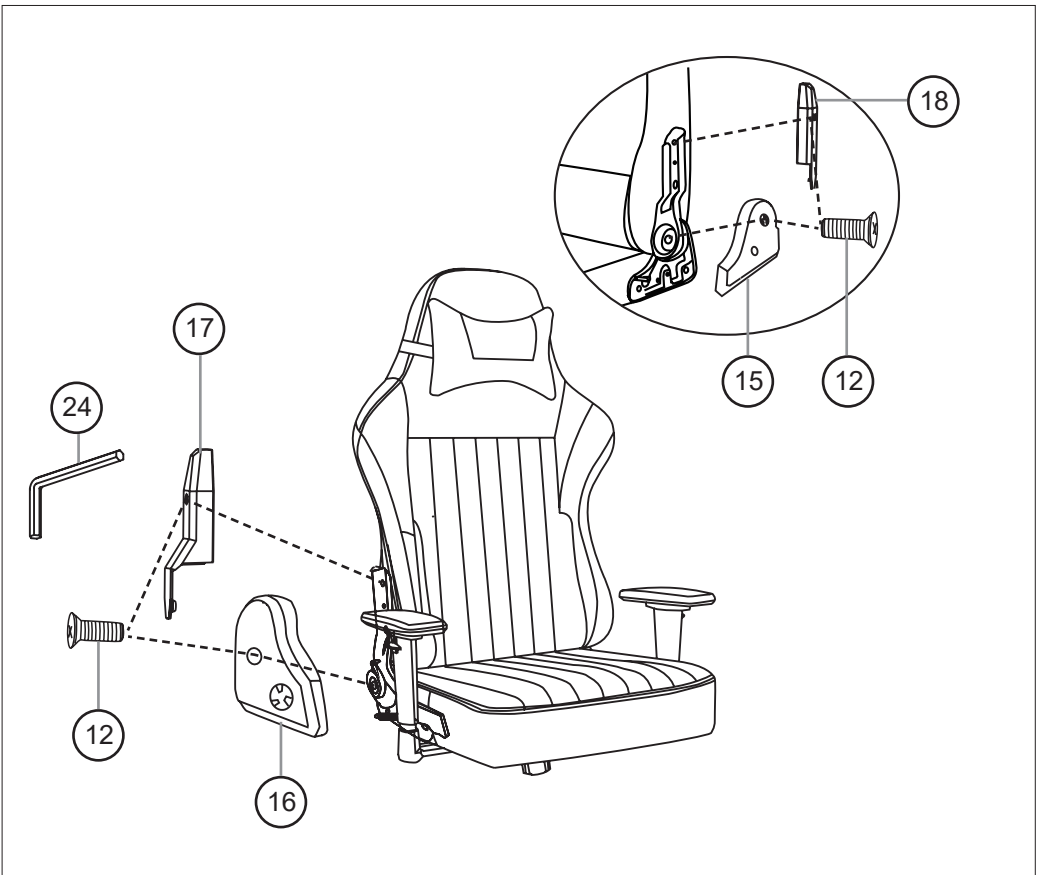

» ASSEMBLY INSTRUCTION «

STEP 8 : Press the Plastic Caps(23) into the Arms holes to cover the bolts.



CAUTION:

Make sure all bolts and screws are fully tightened before using chair.
Lubricate all moving parts and tighten all bolts/screws every 6 month or whenever needed.

» INSTRUCTIONS FOR USE «

1. Seat Height: Paddle-shaped lever on the right side



To raise:

While taking your weight off chair, lift lever up.



To lower:

While seated, lift lever up.

* At the proper height, your feet should rest flat on the floor.

2. Tilt Tension: Long stem under the seat cushion with knob



To increase tension:

While seated, turn knob forward (toward + sign).



To decrease tension:

While seated, turn knob backward (toward - sign).

* Set the tilt tension to control the resistance you feel when leaning back.

» INSTRUCTIONS FOR USE «

3. Operating the tilt lockout



To let your chair tilt back, pull the control handle out.

To stop your chair from tilting, sit forward, then push the control handle in.

4. Backrest Recline



Pull the lever FULLY and lean back slowly until desired angle is achieved, then slowly return the lever to its starting position. Ensure the lever locks back in place.

» INSTRUCTIONS FOR USE «

5. 2D-Function Armrest

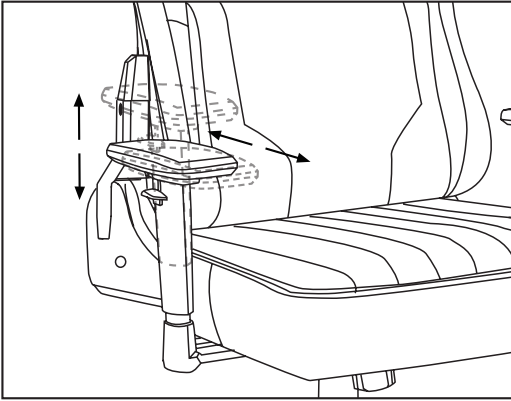

Up and Down

Back and forward

» SAFETY AND MAINTENANCE «

- Do not stand on the chair, Do Not use the chair as stepladder.
- Use this product for seating one person at a time.
- Do not use the chair unless all bolts and screws are firmly secured.
- Avoid contact with sharp objects to prevent puncturing the fabric.
- Every 6 months, check all bolts and screws to ensure they are tight.
- To clean, spot clean only using a damp towel and mild cleaner, first test on a small,, obscure area of fabric.
- Chair weight limit not to exceed 350 lbs.

SAFETY INFORMATION



Sit in the center of the chair, with your back to the backrest



Do not sit at the front edge of the chair



Do not stand on the chair



Do not use the chair with more than one person



Do not push the chair around when a person is sitting in it



Do not push down on the backrest when a person is reclined



Do not place all your weight on the backrest only



Do not place all your hand or fingers near the recline mechanism



LIMITED WARRANTY



Rimiking promises to repair or replace any Rimiking chair that is found to be defective in material or workmanship within one (1) year from the date of original purchase so long as you, the original purchaser, still owns it. This is your sole and exclusive remedy. This warranty is subject to the provisions below.

EXCLUSIONS:

This warranty does not apply and no other warranty applies to:

- Normal wear and tear, which are to be expected over the course of ownership.
- Misuse, abuse or excessive use of the product.
- Modifications or attachments to the product that are not approved by Rimiking.
- Products that were not installed, used, or maintained in accordance with product instructions and warnings.
- Products used for rental or commercial purposes.
- Damage caused by the carrier in-transit is handled under separate terms.

Seating Usage: Normal use for seating is identified as the equivalent of a single shift, forty- (40) hour workweek. To the extent that a seating product is used in a manner exceeding this, the applicable warranty period will be reduced in a pro-rata manner.

Some retailers might have custom models imported direct from the factory and therefore are not supported by our local service team because we don't have the correct parts, please contact your retailer directly for support. If you have any questions about that we will be happy to assist and identify those items.

RETURN POLICY :

We adopt a 30 days return policy which means that all products purchased on this website may be returned to us within the timeframe. You need to contact us within 30 days after the product(s) came into your possession and the product(s) must be returned to us without any undue delays.

Returned products must be returned in the same condition as they were sent and they must be sent in its original packaging.

If the product is not faulty, (i.e. if you changed your mind or if you are unhappy with the product for some other reason), the cost of shipping will fall on you. And it is your responsibility that the package arrives safely to us so we recommend that you use a courier service where it is possible to track the shipment.

If the product is faulty when you receive it please contact us and we will help you out (see more information under Manufacturer Warranty).

We reserve the right to give a partial refund in cases when the product(s) is not in an unused condition, is damaged or have missing parts not due to our error.

HOW RETURNS WORK :

Contact us through the contact form on our website and attach the invoice to the message as a proof of purchase. And please also write the reason for return.

We will then get back to you as soon as possible with information on where to send the product(s).

As soon as we have received the product(s) and made an inspection we will inform you of our decision.

If a refund is approved we will automatically credit the purchase to your credit card or original method of payment.

If the product(s) is damaged, not in its original condition or missing parts we will inform you if you are eligible for a partial refund. This is decided from case to case depending on the severity of the damages or what parts are missing.

 833-969-2075 1 (770) 298-8947

 rimikingservice@outlook.com