

INSTALLATION GUIDE

AGSHome

Smart Garage

AGS001



WARNING

TO PREVENT SERIOUS INJURY FROM YOUR MOVING GARAGE

DOOR OR GATES:

- DO NOT let children use AGSHome Smart Garage Door Opener product and app without adult supervision.
- ONLY operate your AGSHome Smart Garage Door Opener device when you are in clear view of your garage or gate, and you have verified that there are no objects are obstructing the operation of the door.
- ALWAYS wait for garage door or gate to be completely closed.

WHAT'S IN THE BOX

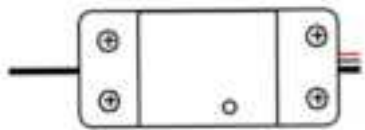

Smart Garage Controller



3M Sticker

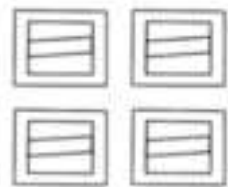

Wire Holders



Zip Ties

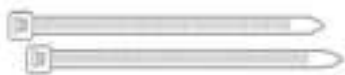

Sensor Mounting Bracket



Screws / Bolts / Nuts

COMPATIBILITY CHECK

Verify the AGSHome Smart Garage Door Controller works with your garage door

1. Look for your garage door on the included "Garage Door Compatibility Guide".
 - Garage door openers with **yellow / purple** learn buttons will likely **NOT** work.
2. Manually ensure your garage door opener is compatible with the Smart Garage Door Controller.
 - Follow the wires from the wall mounted garage controller to your garage door opener.
 - Where the wall mounted garage door controller wires connect to the opener, use a needle nose plier or paperclip to touch the two garage door terminals together.

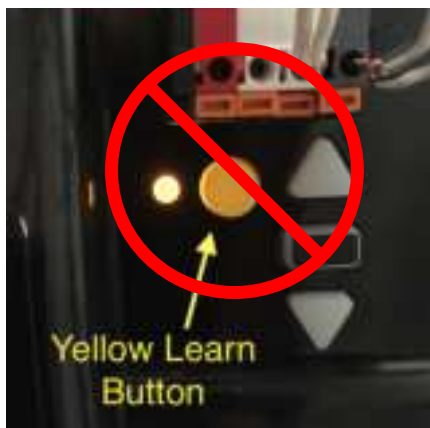

- *If the garage door opens or closes, the Smart Garage Door Controller is compatible with your garage door opener; these will be the terminals the Smart Garage Door Controller will plug into.*

INSTALLATION

1. Check your Wi-Fi

- Check the Wi-Fi signal in the garage, where the **Smart Garage Controller** will be mounted 4 to 5 feet away from the garage door opener.



2. Power up your device

- Find a convenient location and power the **Smart Garage Controller** by plugging it in. The blue LED will start blinking.

3. Download the APP

- Install "**Tuya Smart**" or "**Smart Life**" app on your mobile phone from Apple app store or Google Play store.



Tuya Smart



Smart Life



INSTALLATION

4. Add device in the APP

- Launch the app and select the Plus (**+**) in the top right corner to add a device.
- Select **Electrician**, then select **Smart Garage Door Opener**.
- Tap **Confirm indicator rapidly blink**.
- Connect to your Wi-Fi network, enter password, then select **Confirm**.
- Once you select **Confirm** after entering the password, the app will start to pair the **Smart Garage Door Opener** to your app.

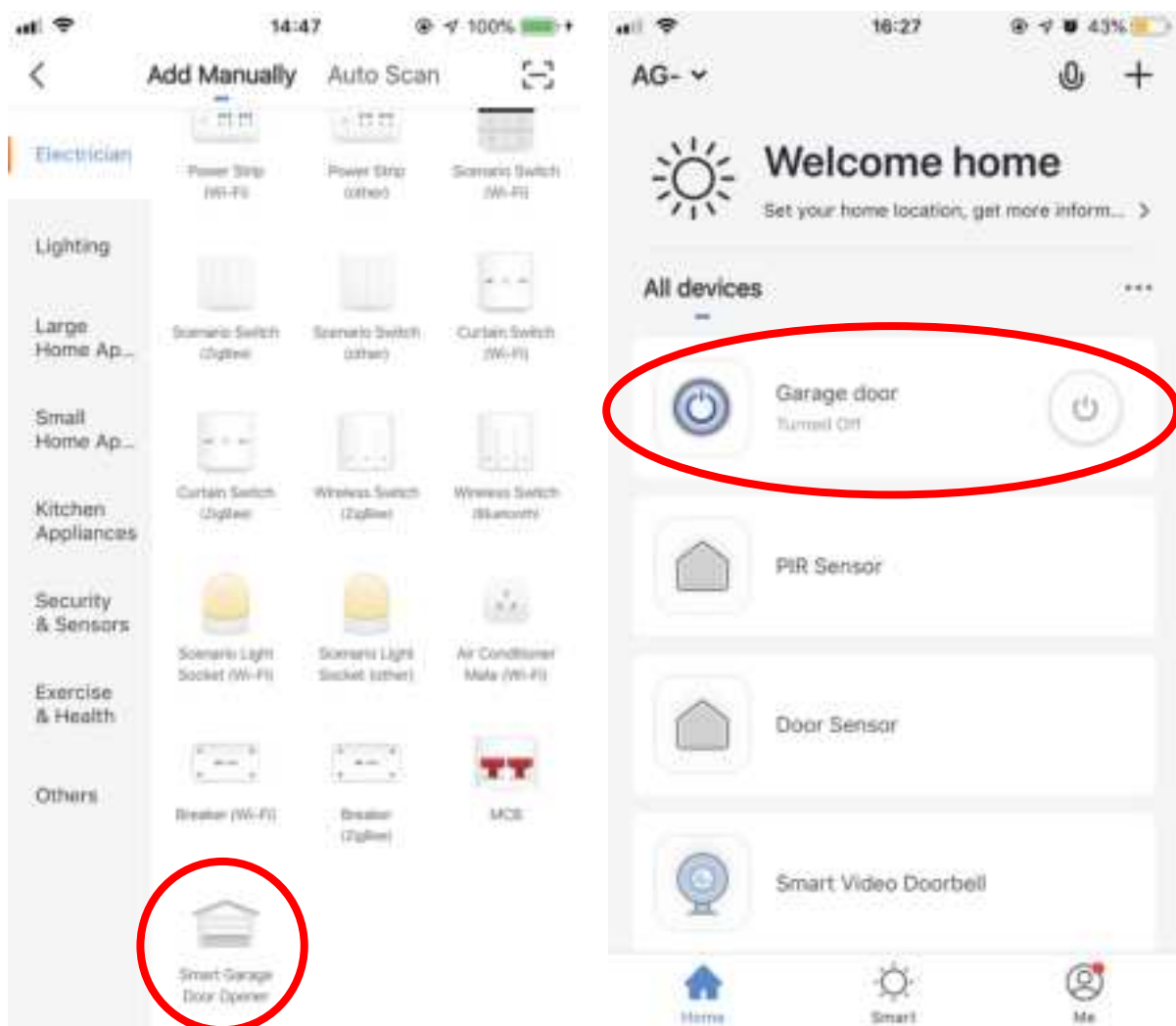

INSTALLATION

Installation Overview

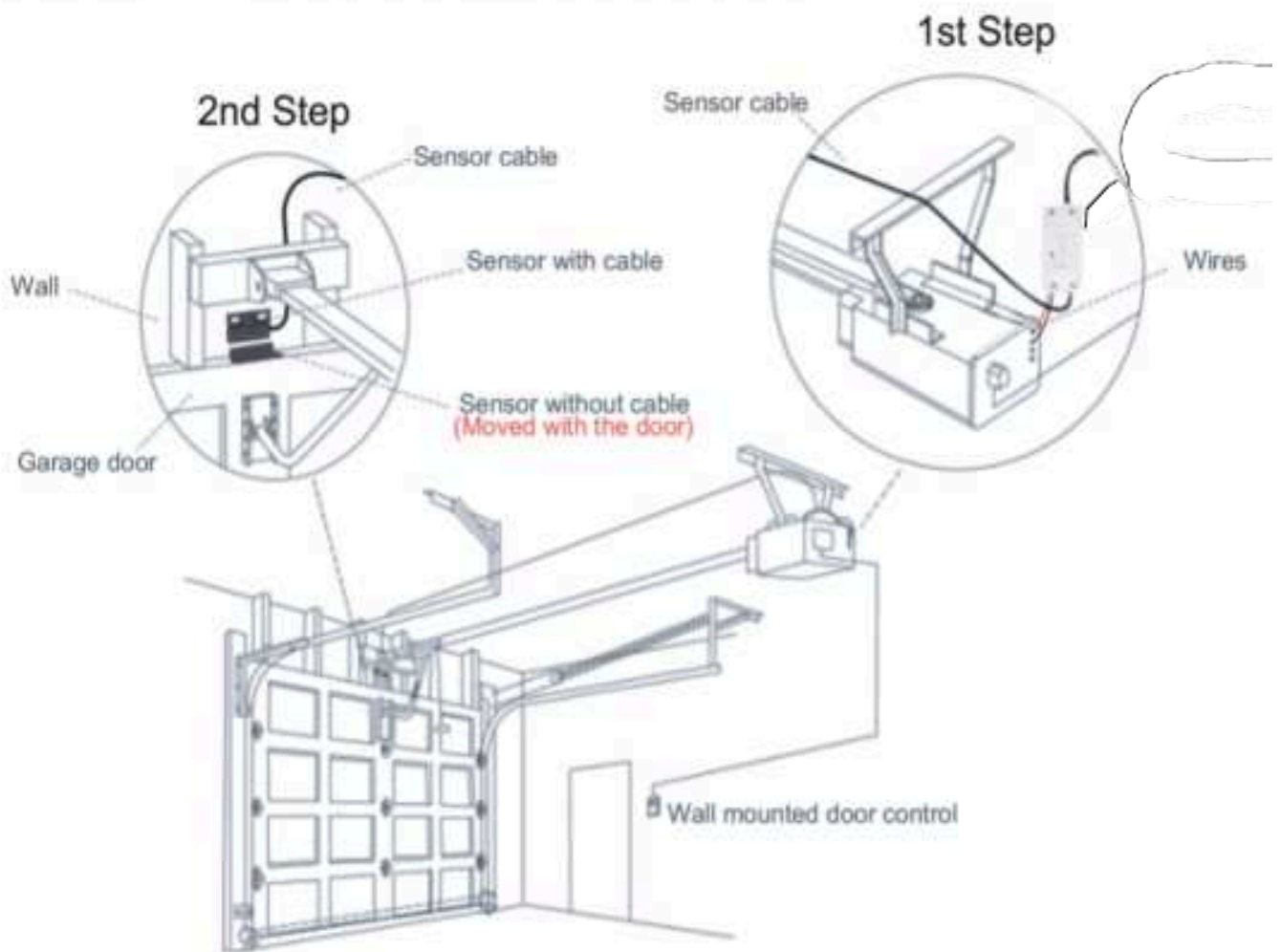

INSTALLATION

5. STEP 1 : Connect Controller to Opener

- Locate the 2 exposed wires coming out of the **Controller**.
- Insert the 2 exposed wires into the terminals on the back of your **Garage Door Opener**.

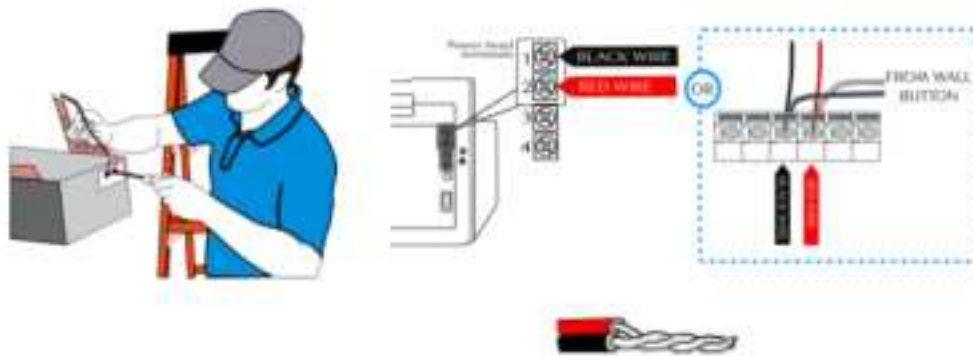

6. STEP 2 : Install the sensor

- The sensor has 2 parts. Both sensor parts must be mounted parallel to each other, and they must be 3 – 15 mm apart, not touching.
- Mount the sensor with wire on the **garage frame wall**, and mount the sensor without wire on the **top of garage door**.

