



SEAT-941

Yamaha G14-G22

RHOX 900 Series Seat Box Kit

Installation Instructions

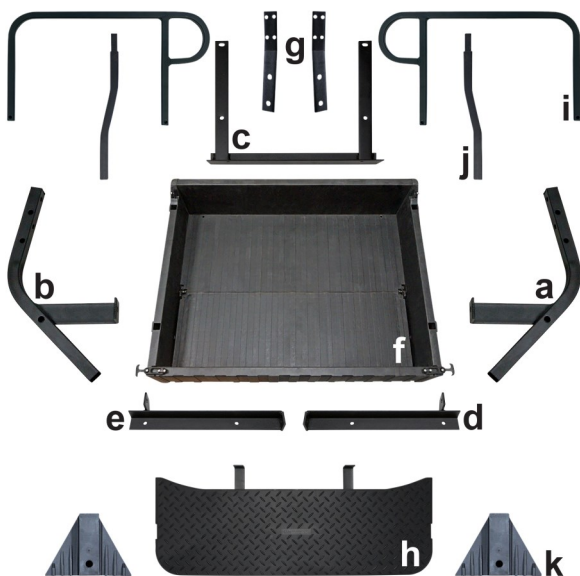

Contents of SEAT-941 Seat Box Kit:

- a (1 ea.) Front Seat Back Support Bracket, Passenger Side
- b (1 ea.) Front Seat Back Support Bracket, Driver Side
- c (1 ea.) Vertical Support Bracket
- d (1 ea.) Horizontal Support Bracket, Passenger Side
- e (1 ea.) Horizontal Support Bracket, Driver Side
- f (1 ea.) Utility Box
- g (2 ea.) Rear Seat Back Brackets
- h (1 ea.) Footplate
- i (2 ea.) Handrails
- j (2 ea.) Handrail Extensions
- k (2 ea.) Footplate Support Brackets
- l (1 ea.) Box of Hardware (Contents on Next Page)

Caution: Please read through the instructions carefully. Installer is responsible for damage if instructions are not followed properly. Look behind each drill or cut location **BEFORE YOU DRILL OR CUT**. Installer is responsible for damage (i.e. drilling/cutting into a wiring harness, battery, fuel tank etc.). Extra installers will be helpful in some parts of the installation. Refer to vehicle's maintenance manual for torquing specifications on reused hardware.

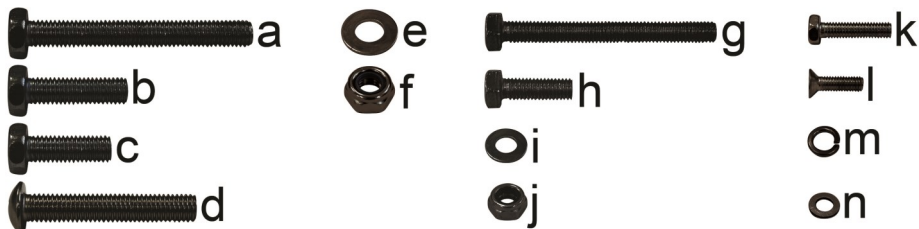

Contents of SEAT-941 Hardware Kit		Bag #1	#2	#3	#4	#5
a	M10 x 80 Hex Head Bolts			2		
b	M10 x 35 Hex Head Bolts		2			
c	M10 x 30 Hex Head Bolts	2	4			
d	M10 x 60 Phillips Head Countersunk Screws		2			
e	M10 Flat Washers	4	12	4		
f	M10 Nylock Nuts	2	6	2		
g	M8 x 75 Hex Head Bolts	2				
h	M8 x 25 Hex Head Bolts				4*	
i	M8 Flat Washers	4			8*	
j	M8 Nylock Nuts	2			4	
k	M6 x 25 Hex Head Bolts					4
l	M6 x 15 Phillips Head Countersunk Screws					4*
m	M6 Lock Washers					4
n	M6 Flat Washers					4

* Hardware is pre-installed on box if not in bags.

Tools Needed For Installation

- Sockets and Open Ended Wrenches: 10mm, 12mm, 1/2", 17mm
- Allen Wrenches: 5mm
- Phillips Screwdriver
- Drill and Drill Bit (5/16")
- Saw with Metal Blade (Optional)
- Rubber Mallet (Optional)

Installation Preparation

1. Engage parking brake.
2. Turn key OFF.
3. Electric Carts Only: Place Tow/Run Switch in Tow.
4. Remove top.

Carts with Non-Collapsible Struts

The factory struts will need to be modified in order to be reused as front struts. Reinstalling the OE top will require TOP-0101 rear struts.

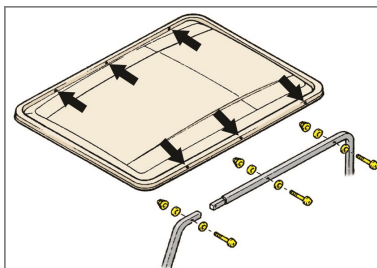

Carts with Non-Collapsible Struts
(Driver Side)

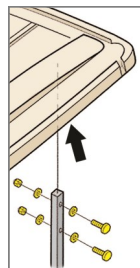

Carts with
Collapsible Struts
(Driver Side)

Carts with Collapsible Struts

If reinstalling the top, keep the top attached to the front struts and prop up the rear of the top using a broom handle or similar tool. Retain hardware.

5. Remove the front seat back cushions (red arrows). Retain hardware.
6. Remove rear struts and sweater basket (black arrows). Retain hardware.

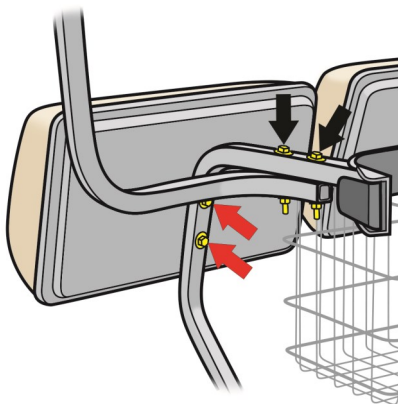

Carts with Non-Collapsible Struts

Sweater basket can be removed with rear struts. Requires TOP-0101 rear struts if reinstalling factory top.

Carts with Collapsible Struts

Sweater basket can be removed separately or with the front seat back supports. Reuse factory rear struts if reinstalling factory top.

7. Remove the access panel. Retain rivets.

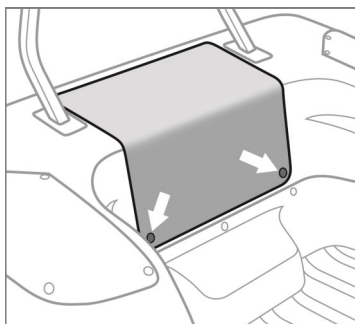

8. Remove the seat back support. Retain hardware and (2) rubber boots.

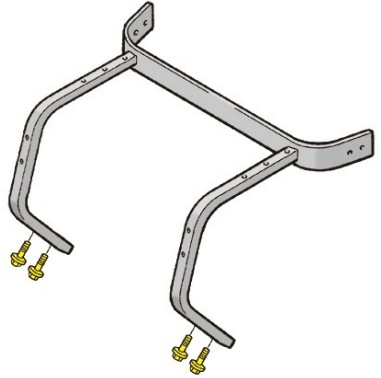

Rear Seat Kit Installation

1. Install the new front seat back support brackets where the original bracket was installed. Mount using Original Hardware and boots.

NOTE: The driver and passenger side brackets are different.

2. Reinstall the access panel using the Original Rivets.

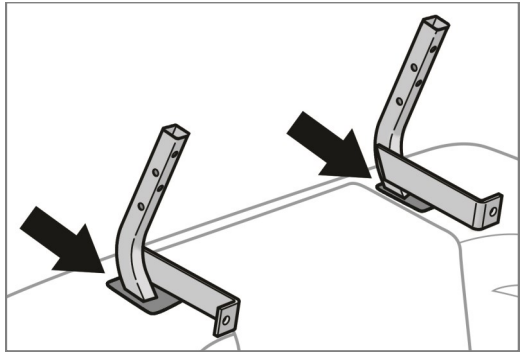

3. Remove the (2) bolts in the bagwell area. Use a 5/16" drill bit to enlarge the (2) holes that the hardware occupied. Drill completely through the frame.
4. Loosely fasten the vertical support bracket to the bagwell area using (2) 8mm x 75 Hex Head Bolts, (4) Flat Washers and (2) Nylock Nuts (**Bag #1**).

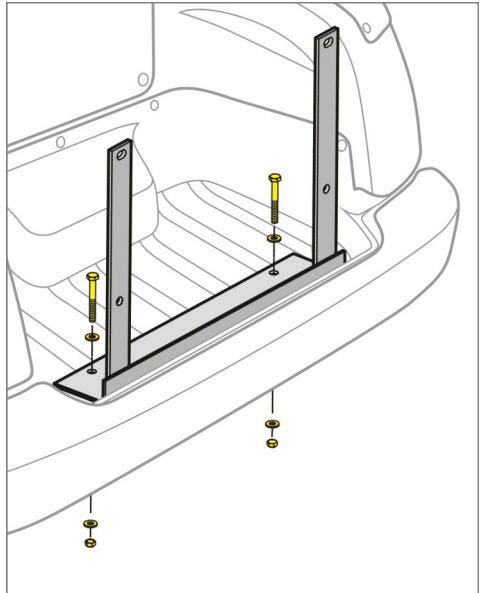

5. Loosely fasten the horizontal support brackets to the front seat back support brackets and vertical support bracket using (4) M10 x 30 Hex Head Bolts, (8) Flat Washers and (4) Nylock Nuts (**Bag #2**).

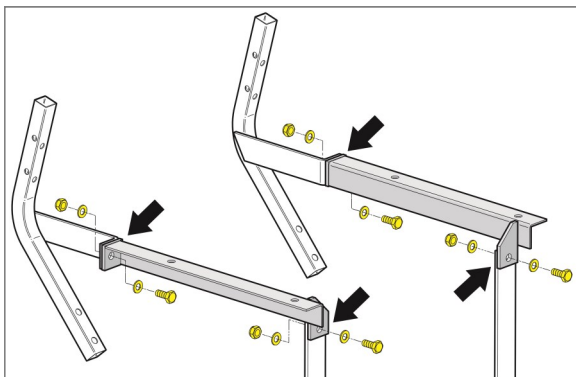

6. Loosely fasten the footplate to the vertical support bracket using (2) M10 x 30 Hex Head Bolts, (4) Flat Washers and (2) Nylock Nuts (**Bag #1**).

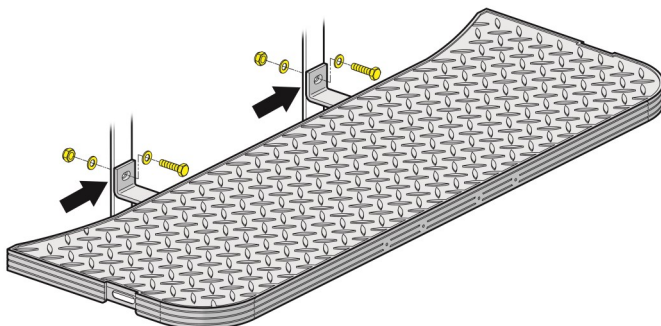

7. Install the front seat back cushion using the Original Hardware. Loosen the front seat back supports if the holes do not align.

8. Loosely fasten the rear seat back brackets to the rear seat back cushion using (4) M6 x 25 Hex Head Bolts, (4) Lock Washers and (4) Flat Washers (black arrows, **Bag #5**).

9. Loosely fasten the seat back assembly to the front of the utility box using (4) M8 x 25 Hex Head Bolts and (4) Flat Washers (red arrows, **Bag #4**).

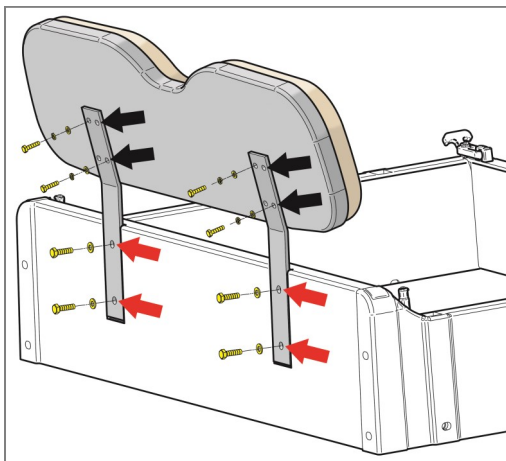

NOTE: Hardware may be pre-installed on box if not in Bag.

10. Tighten the hardware left loose in Steps 8 and 9.

11. Place the seat box assembly on top of the horizontal support brackets. Loosely fasten the box to the brackets using (4) M8 Flat Washers and (4) M8 Nylock Nuts (**Bag #4**).

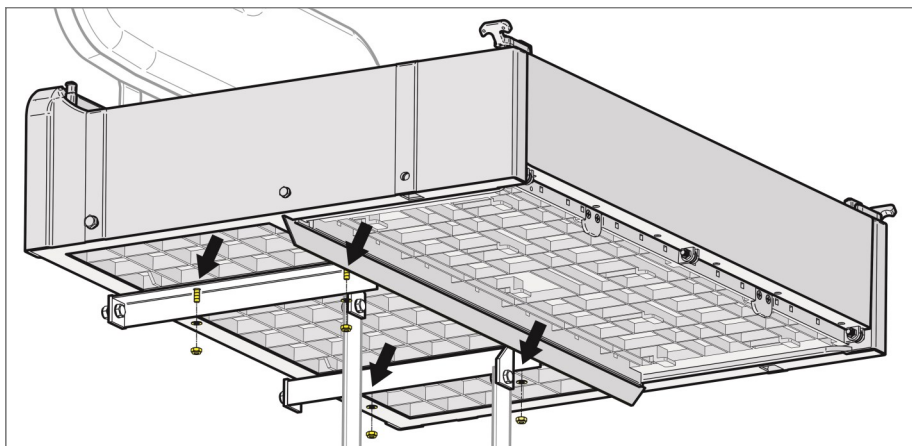

12. Place the handrails and handrail extensions through the openings in the box.
13. Loosely fasten the front portion of the handrails to the box using (2) M10 x 35 Hex Head Bolts and (2) Flat Washers (red arrow, **Bag #2**). Do not overtighten ⚠.
14. Loosely fasten the handrail extensions to the handrails and the box using (2) M10 x 60 Phillips Head Countersunk Screws, (2) Flat Washers and (2) Nylock Nuts (blue arrow, **Bag #2**). Do not overtighten ⚠.
15. Slide the footplate support brackets over the handrail extensions until the holes align. The brackets will cradle the footplate. Loosely fasten the brackets and handrail extensions to the footplate using (2) M10 x 80 Hex Head Bolts (4) Flat Washers and (2) Nylock Nuts (black arrow, **Bag #3**).

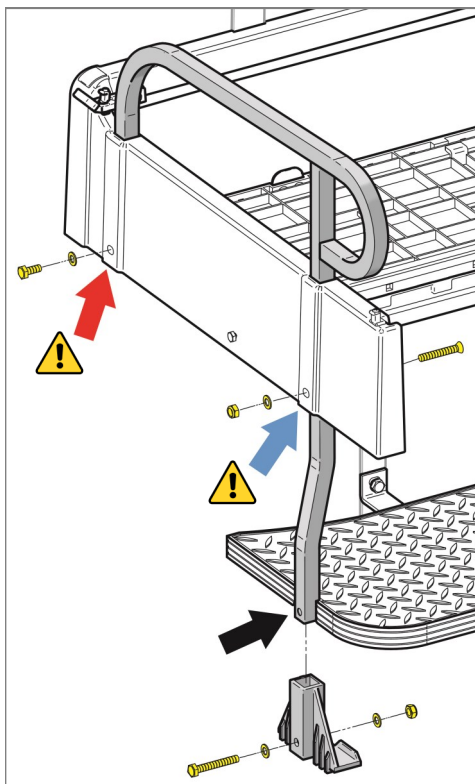

16. Slide the rear seat bottom onto the underside of the utility box deck until it clicks into place on the locking tabs (yellow).

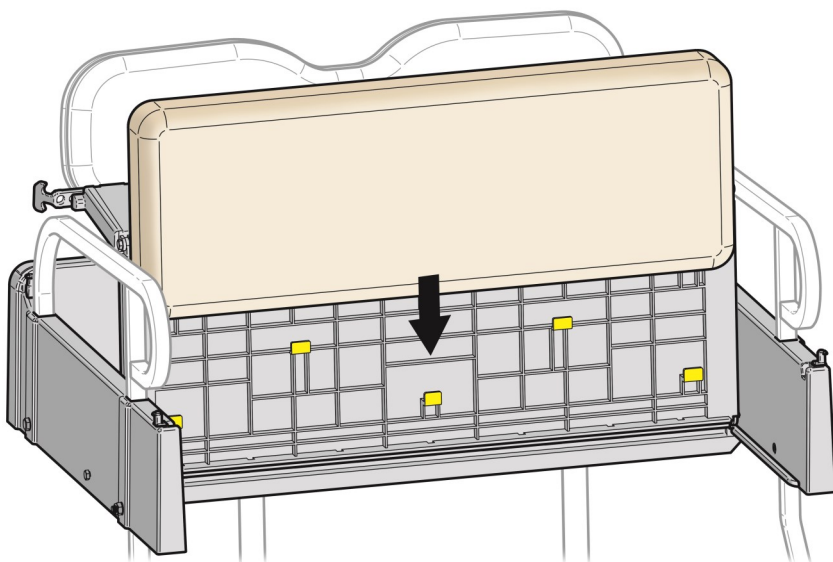

17. Lock the seat bottom into place with the (2) small retaining plates and (4) M6 x 15 Phillips Head Countersunk Screws (**Bag #5**).

NOTE: The retaining plates and screws may be installed on the utility box if not in Bag #5.

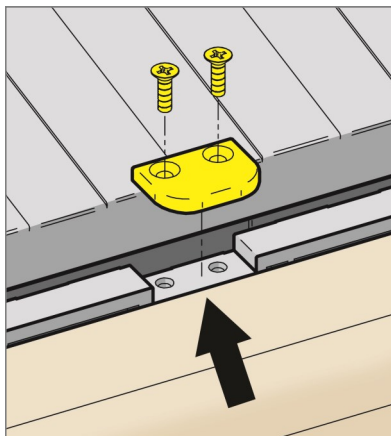

Carts with Collapsible Struts

1. If reinstalling the OE rear struts install them to the front seat back supports (black arrows) using the Original Hardware.
2. Reinstall OE top using Original Hardware.
3. Tighten all hardware.

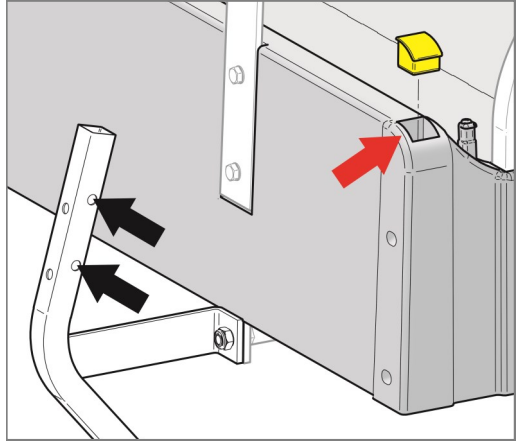

Carts w/ Non-Collapsible Struts or Extended Tops

1. Modify the OE struts as shown to reuse as front and middle portions of struts to support top.

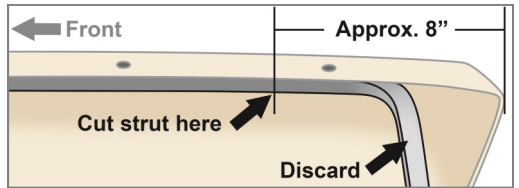

2. Remove the end caps from the front corners of the utility box (red arrow above).
3. Insert the struts inside of the utility box where the end caps were removed. Fasten the struts to the box using the hardware preinstalled on the box. TOP-0108 rear struts are shown.

NOTE: OE Tops require TOP-0101 rear struts.
RHOX 88" Tops require TOP-0108 rear struts.

4. Install OE top or extended top.
5. Tighten all hardware.

This completes the installation of your
RHOX 900 Series Seat Box Kit. Please enjoy safely!

Scan QR code or use the link below to
view the installation video.

<https://vimeo.com/user39935056>

