



USER MANUAL BLACKSYS CH-200

CAMMSYS Blackbox

※ BlackSys Application may vary in function depending on mobile product and OS version.

Thank you for choosing BlackSys.

This manual is based on the **CH-200** model.
The latest firmware & manual can be found at our website
www.blacksys.co.kr/en

■ Please read carefully before using this product.

- ※ This manual should be reviewed and retained for future reference.
- ※ **CAMMSYS** Corp. reserves all rights to this manual in accordance with the copyright law.
- ※ Content of this manual is subject to change without notice to ensure quality control.
- ※ Product functionality may differ depending on firmware.
- ※ This product is designed as an accessory for safe driving. In the event of an accident, all responsibility is borne by the vehicle operator. Please use this product responsibly.

■ Scope of guarantee and responsibility

- ※ This product is a vehicle-accessory for recording video image and sound for the simulation of an accident and recorded data may be used as evidence and reference purposes. We cannot guarantee this product to capture all accident related video image and sound. Quality may differ due to weather condition(s).
- ※ We will not be held responsible for any damages and/or data corruptions or loss caused by a malfunction of this product.
- ※ In general, the memory card lifespan for this product is ~ 6 months and may be subject to data corruption or loss due to static electricity and/or external voltage. For this reason, we highly recommend the user to copy and save important data to external media (hard disc, CD, portable memory, etc.).

※ Although this product was applied format free, Image defects (video recording missing, seamless, frame change or missing, other image saving defect, etc.) can occur due to general speed reduction of the memory card and other defects.

CAMMSY is NOT responsible for any problems and/or damages that may occur from not using genuine SD card. It is strongly recommended that CAMMSYS memory cards are used to minimize memory card error, and the SD card should be formatted every month to maximize the lifetime of the memory card.

※ Please note that CAMMSYS will not be held responsible for traffic accident, any damages caused by ADAS error.

The functions of the ADAS have limitations: Always stay on course using the steering wheel and drive with care. The system is not designed to compensate for a driver's lack of caution and if you rely too much on the ADAS it could lead to an accident. The driver is responsible for assuring lane changes and other maneuvers. Always pay attention to the direction in which the vehicle is traveling and the vehicle's surroundings.

※ The data accuracy of ADAS can vary depending on the user's environment. It is recommended that you use the data only for reference purposes only.

Contents

01 Product Precaution

1-1. Caution	05
1-2. Installation caution	08
1-3. GPS caution	07
1-4. Memory Card	09
1-5. ADAS caution	10

02 Features

11

03 Package & Part Names

3-1. Package Guide	14
3-2. Front & Rear	15
3-3. Left & Right	16

04 Installation

4-1. Front Camera (Main product)	17
4-2. Rear Camera	19
4-3. Memory Card Usage	20

05 Product Usage

5-1. Standard Operation Guide	21
5-2. LED indicator and Voice Guide	25

5-3. Using BlackSys App	28
5-4. Connecting the BlackSys App	29
5-5. BlackSys Viewer	33

06 Firmware Update

6-1. Firmware Update	37
6-2. Download (Firmware & PC viewer)	37

07 How to format SD card

7-1. PC format	38
7-2. Format on product	38

08 Technical Specification

39

09 Customer Service

40

10 Quality Assurances

41

11 Product Warranty

42

01 Product Precaution

1-1 Caution

1. Do not expose product to direct sunlight or cold weather for extended periods of time.

Product exposure to direct sunlight and extreme temperatures may cause damage to the product.

2. Do not dismantle or alter the product.

Do not disassemble, modify, or attempt to repair the product. Any alterations to the product can void the manufacturer's warranty. Please contact your local dealer or the C/S Centre for more information.

3. Do not dismantle or alter the product accessories.

Do not disassemble, modify, or attempt to repair any accessories for this product (Cigar Jack Cable, Mount, etc.). This may cause damage to the vehicle and/or product. Any resulting damage shall be the responsibility of the user and is not covered under the manufacturer's warranty.

4. Do not allow liquid to come into contact with product.

Please note this product is not waterproof and exposure to liquid and foreign substances may cause a product malfunction, short circuit, and/or fire. Use caution when cleaning the product and clean with a soft and dry cloth.

5. Do not expose the product to heavy impacts.

Excessive impacts to this product can cause a malfunction. Handle the product with care.

6. Only use manufacturer's approved power cable and accessories.

Any damages or loss to product/vehicle as a result of accessory incompatibility will not be covered under the manufacturer's warranty.

7. Any accessory or peripheral which manufacturer doesn't supply will not be covered by warranty.

We will not provide warrant for any accessory or peripheral if these are not authorized by us. User will be responsible for the damage caused by using unauthorized accessory or peripheral.

8. Do not operate the product for extended periods of time while the vehicle is not running.

Excessive use of the product while vehicle is off can cause drainage to the vehicle's battery

9. Video quality may vary depending on extreme lighting conditions.

Quality is subject to alterations in extreme dark/light areas and conditions. Most notability when entering/exiting a tunnel or parking garage.

10. Data may not be recorded if accident impact is lower than a predetermined threshold.

In extreme cases the product may not record data during an accident due to low impact forces. In addition, during a high force impact accident power may be cut off to the product and data may be lost.

11. Do not disconnect the power source while the product is turned-on.

Disconnecting the power source may cause the product to malfunction. Please use only the recommended voltage for power connection.

12. Some PCs may not support BlackSys Viewer or there may be some disconnections in voice/image depending on the PC's specifications.

13. AE operations at night may vary depending on vehicle (black, red) low light reflection.

14. There may be frame omissions due to rapid AE operational changes in low light areas.

Please reset the installation angle of the product if AE operation malfunctions.

15. There may be noise in the video when recording in poor lighting environments.

16. In the event of a sudden frame change or switching between parking & driving modes, there may be a loss of data.

17. Motion detectors may malfunction in the event of an extreme increase/decrease to the surrounding lighting conditions of the vehicle.

18. The motion detection function may not operate properly in environments with poor lighting conditions due to noise and vehicle security LED(s).

*AE : Automatic Exposure

- 19. The left/right side image quality of this product may vary due to characteristics of the wide-angle lens.
- 21. Please ensure all accessories are connected to product(s) to avoid data loss.
- 22. The interworking draft using Wi-Fi between smartphone and product cannot be connected simultaneously, also when it is connected with product you cannot access internet.
- 23. Playing video or any other functions may not operate properly on specific kind of smart phone.
- 24. Using internet is restricted on the status of connecting product.
- 25. Do not continue to use this product if a malfunction is apparent. Please contact our C/S center or your local distributor with any questions and/or concerns about this product.

1–2 Installation caution

1. Keep product clear of clutter.

Please ensure the surrounding area is clutter free to avoid reflections/vibrations that may reduce the image/audio quality.

2. Ensure camera lens is clean at all times.

Allowing the camera lens to collect dust/oils will reduce the quality of the image.

3. Do not attempt to operate or install the product while driving.

For your safety, do not attempt to operate or install the product while driving to avoid a traffic accident.

4. Please keep the product securely fixed to mount.

Please check that the product is secured before operating the vehicle. This will ensure the best image quality and avoid distractions to the driver while in motion.

5. Please avoid excessive window tints, as this may distort image quality.

6. Install this product at the point furthest away from the antenna or receiver as possible.

The electromagnetic waves produced by the product may distort receiving sensitivity.

7. Installing camera on the tinted window is not recommended and be careful on damage of tinted window while uninstalling camera for service or other reason. We don't take any responsibility for the damage and so please be careful while uninstalling camera.

1–3 GPS caution

1. There is an error range of over 15m in a normal commercial GPS. There may be situation where the GPS signals cannot be received depending on the environment such as buildings, underground, and tress. This can make the error range bigger.

2. A combination of factors including weather can delay the time to receive the first GPS signal after power is connected to the product.

3. External electronic products and window tinting may affect the GPS reception.
4. Vehicle speed accuracy may vary between 1–30km/h depending on the reception area when stopping the car.
5. GPS may be operated when switching off the product.
6. In case of using anti-ultraviolet glass window, GPS reception won't be working properly.
7. Without GPS, time on the product may not be accurate.

1–4 Memory Card

1. Do not remove the SD card by force while the product is in recording mode.
Please turn off the product before removing the memory card(s). Removing the memory card(s) while the product is turned on may damage the video file or cause an internal operational error.
2. Be sure to periodically reformat the memory cards using the BlackSys Viewer or the product itself.
Repetitive data creation and deletion by the product can cause damage to the SD card(s) and its file. SD card should be formatted once a month. The warranty period of a memory card is 6 months, and we are not held responsible for any recording errors due to prolonged use of a memory card after the 6 month period.
3. After reformatting a memory card, it can be used without configuration files such as firmware.
The latest set value is contained within the product, and will be automatically applied to the SD card(s).
4. Please use Authorized memory cards to ensure the best quality.
5. The memory card(s) operate at high temperatures, and we recommend you use caution when inserting and removing.
6. Please backup your recorded videos using an external storage product (PC, HDD, etc.).
7. Be sure to insert the SD card into the product.
Without the SD card, the camera does not start recording.
9. The device has Format-Free function. With this function, malfunctions may occur if unsupported files are copied to, moved or deleted from the SD card.

1–5 ADAS caution

1. Only usable with GPS installed.
2. To use the ADAS Auto-calibration function, please install the product in accordance with the product installation guide. (see P.17)
3. The system(LDWS) may not operate adequately according to the actual driving conditions, resulting in an accident.
 - Driving on roads with tight curves.
 - Driving under bad weather conditions (rain, fog, and snow).
4. If the dash cam position or angle adjustment are adjusted after completed Auto-calibration, ADAS may malfunction.
5. After adjusting the dash cam position or angle adjustment in the ADAS operation, be sure to reboot after power off and perform auto-calibration.
6. Auto calibration condition
 - Dash cam power ON
 - GPS Data Received
 - Vehicle speed higher than 30 km/h and drive for more than 3 minutes
7. Press the Wifi button in the dash cam for more than 3 seconds to re-calibrate.
8. In a poor sensitivity GPS or shadow areas, the ADAS function may not work or malfunction.
9. The functions of the ADAS have limitations: Always stay on course using the steering wheel and drive with care.
The system is not designed to compensate for a driver's lack of caution and if you rely too much on the ADAS it could lead to an accident. The driver is responsible for assuring lane changes and other maneuvers. Always pay attention to the direction in which the vehicle is traveling and the vehicle's surroundings.

02 Features



+ Clear image with CMOS Sensor

Front: Full HD Sony CMOS Sensor / Rear: Full HD Image Sensor



+ Distortion-free recording with Wide-angle lens

Front: 1920x1080p Full HD, 30fps / 16:9 wide screen with 135° angle of view

Rear: 1920x1080p Full HD, 30fps / 16:9 wide screen with 130° angle of view



+ Wi-Fi Support (802.11b/g/n (2.4~2/4835FHz))

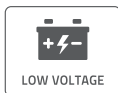

+ Low Voltage Cut-off function

Under 100uA Leakage current.



+ Supports a variety of recording functions

- Continuous recording : Generates recording files at three-minute intervals continuously.
- Event recording : Generates 30sec recording files before and after the event.
- Parking recording : Generates 30sec recording files before and after the motion is detected.
- Time Lapse recording : Captures one frame per second during parking / More recording files can be saved while parked.
- Choosing the Time Lapse recording will disable motion detections in Parking recording.



+ 8GB~256GB Memory Support



+ Multi Language Support

Korean, English, Chinese (Mandarin, Cantonese), Arabic, Russian, French, Spanish (Europe, South America), Japanese, Thai language, Bahasa Indonesia, Vietnamese, German, Turkish, Italian, Czech, Portuguese, Bahasa Malaysia



+ Security LED Support



+ GPS Dual Band (GPS+GLONASS)



+ Built-in microphone

Product records audio simultaneously with video.



+ ADAS

LDWS, FCWS, FVSA can alarm the driver about Lane Departure Warning, Forward Collision Warning and Front Vehicle Start



+ Direct memory card format

Product formats memory card without connection to PC.



+ Built-in super capacitor

Internal battery replacements are not necessary due to a built-in semi-permanent super capacitor. When the vehicle is turned off, the product will save all data before terminating.

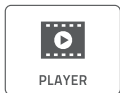

+ Playing

You can check the recorded video and driving information by BlackSys PC viewer and smartphone and also you can use other video player such as Windows media player.

03 Package & Part Names

3-1 Package Guide

■ Standard Components



Main Unit (Product)



User Manual



Cable Holder



SD card

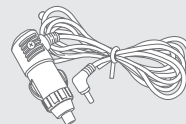

Cigar Jack Cable

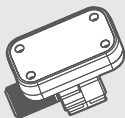

Bracket



Rear Camera



Wi-Fi Dongle

■ Option

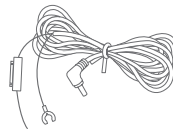

DC Fuse Power Cable

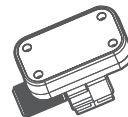

Bracket type GPS

※ Actual components may be different from pictures and some components can be changed in case.
If package doesn't include above components, please contact a retail shop or company where product was sold.

3-2 Front & Rear

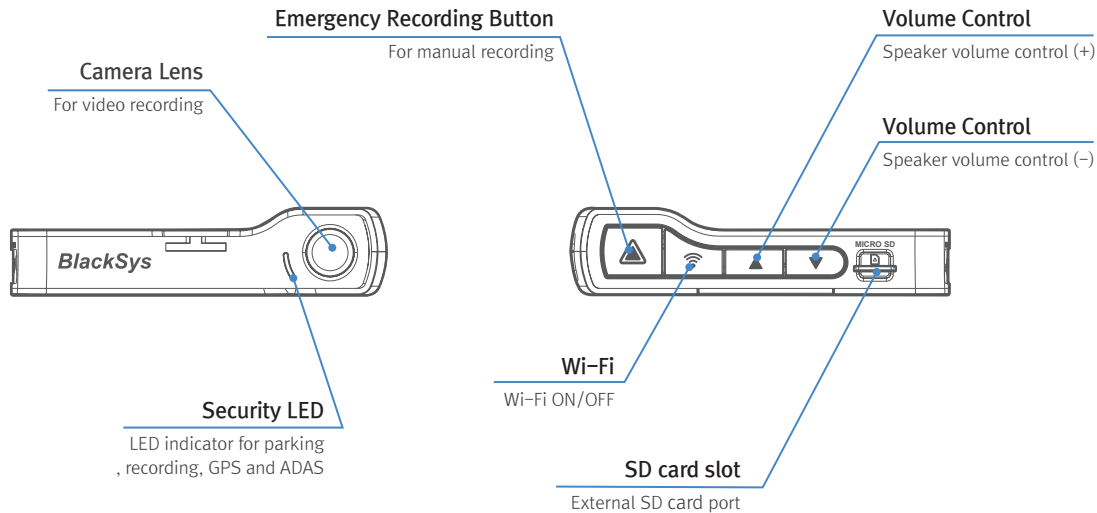

3-3 Left & Right

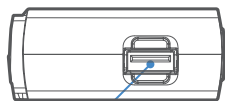

Wi-Fi Port

Wi-Fi Connecting port

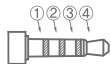

- ① GND
- ② AV OUT
- ③ GPS Data
- ④ Power

GPS Port

Check location and speed of vehicle through BlackSys Viewer program

OBD Terminal

Check driving information by using OBD cable



Rear Camera Connecting Port

Connecting FHD rear camera

Power cable port

Cigar jack power cable port

04 Installation

4-1 Front Camera (Main product)

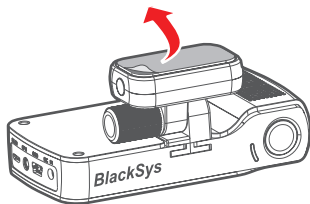

1. Attaching double-sided adhesive tape

Wipe up the foreign matters or moisture completely from the location of installation. Remove the release paper on double sided tape and attach it to the cradle part of holder and remove the red adhesive protector.

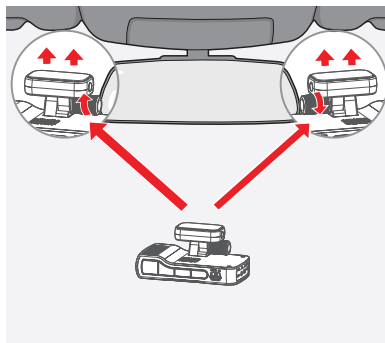

2. Installing unit

Installation is recommended on the left/right of room mirror. Tightly fasten the adhesive of holder to the windshield by pushing it. Adjust the angle of camera to record forward and unit to be vertically installed. Finally, tighten the clamping lever.

※ If a video from navigation system or dashboard reflect in windshield, it could affect video quality.

4-1 Front Camera (Main product)

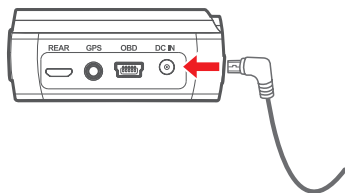

3. Power cable arrangement and connection

By using the cable holder, arrange the Cigar jack cable and connect it to the DC IN port.

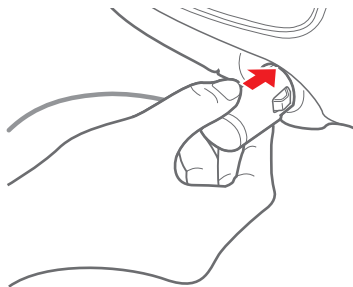

4. Power cable connection and check the LED state

After inserting the Cigar jack cable into cigar jack, turn on the car ignition. If all LEDs of power status are on, installation is completed.

4-2 Rear Camera

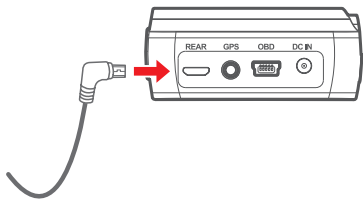

1. Rear Camera Installation

Connect rear camera to the rear camera connector. Clean up the cable of rear camera from the location of installation.

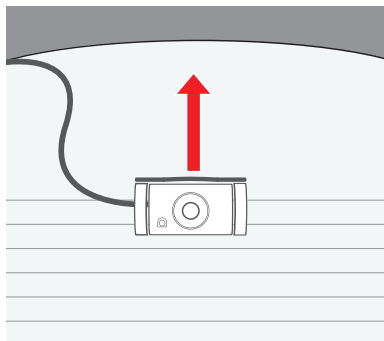

2. Installation

Wipe up the foreign matters or moisture completely from the location of installation. Remove the red adhesive on double sided tape and attach it to the rear windshield. Installation is recommended on the middle of rear windshield.

※ Tinted windows may cause unclear image of video from rear camera.
Avoid tinted window.

4-3 Memory Card Usage

- Video is recorded at 3-minute interval for continuous recording, 30-second interval for motion and event recording.

Below table is based the SD card setting which is set to the following proportional storage assignment for each recording mode :
continuous 70%, motion 20%, event 10%.

1. SD Card Usage Time

SD	Continuous		Motion		Time Lapse		Event	
	Front	Rear	Front	Rear	Front	Rear	Front	Rear
8G	11 files	11 files	20 files	20 files	20 files	20 files	10 files	10 files
	33 min		10 min		150 min (2h 30min)		5 min	
16G	24 files	24 files	41 files	41 files	41 files	41 files	20 files	20 files
	72 min (1h 12min)		20 min 30 sec		307 min 30 sec (5h 7min 30sec)		10 min	
32G	49 files	49 files	85 files	85 files	85 files	85 files	42 files	42 files
	147 min (2h 27min)		42 min 30 sec		637 min 30 sec (10h 37min 30sec)		21 min	
64G	102 files	102 files	174 files	174 files	174 files	174 files	87 files	87 files
	306 min (5h 6min)		87 min (1h 27min)		1305 min (21h 45min)		43 min 30 sec	
128G	202 files	202 files	347 files	347 files	347 files	347 files	173 files	173 files
	606 min (10h 6min)		173 min 30 sec (2h 53min 30sec)		2602min 30sec (43h 22min 30sec)		146min 30sec (1h 26min 30sec)	
256G	404 files	404 files	694 files	694 files	694 files	694 files	346 files	346 files
	1212 min (20h 12min)		347 min (5h 47min)		5205 min (86h 45min)		173 min (2h 53min)	

※ Front 9M/sec, Rear 7M/sec (High quality standard)

※ The number of files and usage times may be different from actual usage time.

※ Total recording time means sum of front and rear recorded videos. (It saves front and rear videos separately)

※ The number of files and usage times may be changed according to the quality of video.

05 Product Usage

5-1 Standard Operation Guide

1. Recording start and end

- Once connecting power, CH-200 gives voice guide, "Start recording" and then it starts recording.
 - Once disconnecting power, CH-200 gives voice guide, "terminating the system".
- ※ Please check whether the SD card is inserted into the main unit or not before connecting power.

2. Recording Mode & Time usage

Mode	Recording Time		Save location
Normal Recording	Normal	3 min	AlwaysMovie folder
	Event	10 sec before / 20sec after	EventMovie folder
	Manual	10 sec before / 20sec after	EventMovie folder
Parking Recording	Motion	10 sec before / 20sec after	MotionMovie folder
	Timelapse	30 sec. video (compressed 450 sec. video)	MotionMovie folder

※ While Event recording and manual recording mode, other event or manual mode will not be operated.

3. Video Playback

- Playback the recorded video: To playback the recorded video, touch "SD Card" or "**BLACKSYS**" (When connecting Wi-Fi) of CammSys application. Also you can check the video on BlackSys Viewer on PC with SD card.

4. Normal Recording

- **Normal recording** : Recording starts when vehicle power is turned on and recorded data are stored in SD card. (“AlwaysMovie” folder)
 - **Event recording** : Recording starts if acceleration sensor(G-sensor) detects impact, sudden unintended acceleration and quick braking, it records 30 sec. of video to the “EventMovie” folder 10 sec. before and 20 sec. after the event.
 - **Manual recording** : Recording starts if user manually pressed the event button during the car runs, it records video (“EventMovie” folder) 10 sec. before and 20 sec. after the event.
- ※ While Event Recording, Manual recording function cannot be operated and during Manual recording, Event recording also cannot be operated.

5. Parking Mode Recording

- **Parking mode is active when the product power is ON.**
 - ※ Note that recording and the product itself will terminate power if the vehicles’ battery drops below a predetermined voltage.
- **Parking Mode Setting** : The product can be programmed with a set time to initiate the ‘auto conversion to parking mode’ function.
When the product converts to parking mode, a voice segment (“Switched to parking mode”) is announced.
- ※ Automatic conversion to parking mode can be programmed in the **Configuration Setting >> Basic Functions** of the BlackSys viewer, or on the BlackSys mobile app : **BlackSys Settings >> Basic Function**.
- ※ As recording stops and converts to parking or driving mode, less than 5 seconds of video may be lost.
- **Recording in Parking mode** “Motion” LED segment will be displayed on lower part of the screen when saved video playing.
- ※ When converting from normal, event, or manual recording mode to parking mode, each recorded file is terminated and converted into parking mode.
For this reason, video loss can occur.
- **When selecting ‘Use motion detection’ in the configuration settings, video will be recorded for 30 seconds in total when motion is detected – 10 sec. before / 20 sec. after. Files will be saved in the “MotionMovie” folder.**
 - ※ For efficient memory management only the rear/front camera that detects the motion will activate.

※ You can set the motion detection function on the BlackSys Viewer : **Configuration Settings >> Motion**.

Or directly from the BlackSys App : **BlackSys Settings >> Motion Detection**.

※ White LED will blink while motion recording is active.

※ Motion detection may fail when the vehicle is in extreme lighting conditions.

※ Recording time during parking mode may vary depending on the vehicles' battery voltage.

※ Motion recording may continue according to changes in the environment, the sensitivity must be set to in accordance with your parking environment.

(E.g. When parking in an alley or underground, frequent movements may interfere with motion recording if set on a high sensitivity.)

6. Time Lapse Recording

– When Time Lapse Recording is enabled in user settings, 30-second videos are recorded and saved in MotionMovie folder. Time Lapse Recording captures at one frame per second when the vehicle is parked.

※ Each file is 30 seconds but the span is 7 minutes 30 seconds.

※ Event/Motion Detection Recording does not operate if Time Lapse Recording is enabled.

7. Driving Information Check

– Configuration setting → GPS function → Driving Information

After you have set the storage intervals for driving information on the configurations settings, the desired data points will then be saved at every programed interval.

8. ADAS(Advanced driver assistance system) Guide

– LDWS : when vehicle speed keeps over 30km/h, function will be calibrated within 2~4 min. and Green LED is ON.

If camera detect lane departure when speed is over than settings, warning alarm comes and Green LED is Blink. (0.3sec.)

– FCWS : If camera detect collision with front vehicle when speed is over than settings, warning alarm comes and Green LED is Blink. (0.2sec.)

– FVSA : If front vehicle departure while vehicle speed is 0km/h, warning alarm comes and Green LED is Blink. (0.6sec.)

- ※ Only usable with GPS option installed.
- ※ If you do not want to use ADAS, you can disable it on your PC viewer or app.
- ※ The functions of the ADAS have limitations: Always stay on course using the steering wheel and drive with care. The system is not designed to compensate for a driver's lack of caution and if you rely too much on the ADAS it could lead to an accident. The driver is responsible for assuring lane changes and other maneuvers. Always pay attention to the direction in which the vehicle is traveling and the vehicle's surroundings.

5-2 LED Indicator and Voice Guide

※ Function can be changed according to product upgrade.

– Sound effect

Function	Voice Guide	Function	Voice Guide
System start	Starting the recording	Time signal (In case of using Fixed time alarm)	10'clock
System OFF (Disconnecting power)	Terminating the system	Voice recording setting	Starting the voice recording Disabling the voice recording
Start recording	None	Convert to parking mode	Switching to parking recording mode
End recording	None	Convert to normal mode from parking mode	Switching to normal recording mode
Connecting /Disconnecting rear camera	None (System will be rebooted if you connect rear camera while operating)	Normal recording	None
GPS satellite positioning	None	Manual recording	Ding-dong, beep sound
Remove SD card while operating	None (System will be rebooted if you connect rear camera while operating)	Event recording	Ding-dong, beep sound
Without SD card	There is no SD card (Repeat, Reboot once insert the SD card)	Start Firmware upgrade	Starting the firmware update. Do not turn off the power.
Manual SD card format	Formatting is on standby. Press the left key to format	Power OFF with High Temperature cut-off function	None
Proceed SD card format (Event Key)	Formatting the SD card. Do not turn off the power.	Low voltage cut-off	None
Security LED setting	None	Volume (+)(-)	Beep sound
		Wi-Fi ON	Ti-ting~ sound

– Hardware (H/W) Status LED ※ If there is no WiFi connection or no response for 5 minutes, the WiFi will automatically switch off.(WiFi LED off)

	LED	Red(REC)	Green(ADAS)	Blue(GPS)	Yellow(Wi-Fi)
Rear camera	Connect / Disconnect	–			
GPS	Connection success	ON	ON	ON	–
	Connection failed	ON	OFF	OFF	–
Wi-Fi	ON	ON	–	–	ON
	OFF	ON	–	–	OFF
ADAS	ON	ON	ON	–	–
	OFF	ON	OFF	–	–

– Security Status LED ※ In parking mode, the WiFi is switched off automatically to reduce current consumption.

	LED	Red(REC)	Green(ADAS)	Blue(GPS)	Yellow(Wi-Fi)	Security LED
Parking Mode	Standby	OFF	OFF	OFF	OFF	Blink 3sec.
	Motion Detection	Blink 1 sec.	OFF	OFF	OFF	Blink 1sec.
	Parking Event	Blink 1 sec.	OFF	OFF	OFF	Blink 1sec.

– Power ON/OFF

Function	Voice Guide	Operating Status
Power ON	Starting the recording	
Power OFF	Terminating the system	

– Operating button (Option Key), Long Key (More than 3 sec.)

Function	Key	Voice Guide
SD card Format	Event Button Long Key	Formatting is on standby. Press the left key to format
	Event Button Long Key	Formatting the SD card. Do not turn off the power.
	Event Button Short / All key down except Long Key	None
Voice Recording ON/OFF	Press long volume button (+)	Starting the voice recording
	Press long volume button (-)	Disabling the voice recording
ADAS re-calibraion	WiFi long key	Beep alram

– Error Occur

Function	Voice Guide
SD Card not inserted	Insert SD card (Repeat, Reboot once insert)
SD Card Defective	Cannot read the SD card. Please check the SD card
Front camera related failure	Recording failure. 1
Rear camera related failure	Recording failure. 2
SD card recording related failure	Recording failure. 3

5-3 Using BlackSys App

1. Start and end recording

- ※ Download the BlackSys application on your smartphone.
 - The BlackSys application can be found on the Google Play Store and the App Store for iPhone.
 - The BlackSys application can be used with Android 4.2 or later, iOS 5.0 or later.
 - The BlackSys App may not be supported depending on the smartphone.

※ Turn the Wi-Fi button located at the bottom of the product.

※ For playback of recorded videos using Wi-Fi, the reception may vary according to the data transfer rate.

※ The range of Wi-Fi reception may vary.

※ The path of recorded videos may vary depending on the smartphone.

※ The App is compatible with CH-100 and CH-200 and select model in the App before using the device.



[Download BlackSys APP from Google play store]

5-4 Connecting the BlackSys App



[BlackSys APP]



[BlackSys APP Main]

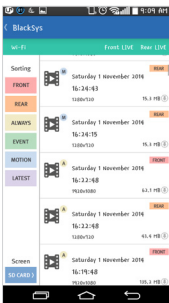

[BlackSys APP Play list]

1. Select the BlackSys Connect button on the main screen.

- ※ When the product is connected with your smartphone, the BlackSys connect icon will turn green.

2. Select 'BlackSys' on the Wi-Fi list.

3. Enter in the default password : 11111111.

- ※ For a stable connection, please remain within close proximity with your product.
- ※ Change your password to prevent others from accessing your product.
- ※ Configure your product name and password on the Blacksys Viewer program.

5-4-1 Using BlackSys App – SD Card

※ You can view your recorded footage saved on the SD Card right from the BlackSys App.

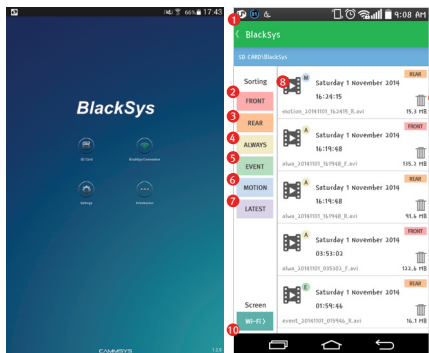

1. Navigation : Navigate to the Main Screen
2. Front Camera : Display all footages except Front Camera
3. Rear Camera : Display all footages except Rear Camera
4. Always Video : Display all footages except Always Recording mode
5. Event Video : Display all footages except Event Recording mode
6. Motion Detection Video : Display all footages except Motion Detection mode
7. Customize : Arrange order of footage by time sequence (ascending/descending)
8. Play : View footage file
9. Delete : Delete footage file
10. Wi-Fi : Navigate to 'BlackSys Connection'

5-4-2 Using the BlackSys App – BlackSys Connection

- ※ Connect with your BlackSys product to view captured footage.
- ※ Green indicates a successful connect on the Main Screen.

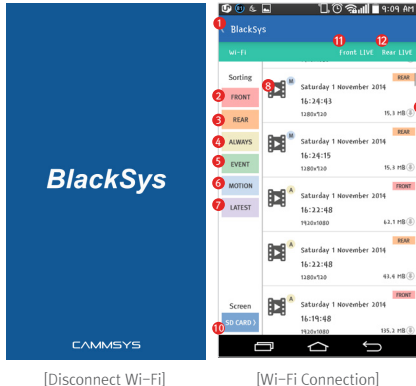

1. **Navigation** : Navigate to the Main Screen
2. **Front Camera** : Display footage captured by the Front Camera
3. **Rear Camera** : Display footage captures by the Rear Camera
4. **Always Video** : Display footage captured in Always Recording mode
5. **Event Video** : Display footage captured in Event Recoding mode
6. **Motion Detection Video** : Display footage captured in Motion Detection mode
7. **Customize Order** : Arrange order of footage by time sequence
(ascending/descending)
8. **Play** : View footage file
9. **Download** : Save footage file onto your Smartphone as a movie clip
※ File path may vary depending on Smartphone and OS.
10. **SD Card** : Navigate to 'SD Card'
11. **Front Camera LIVE** : View a live video stream from the Front Camera
12. **Rear Camera LIVE** : View a live video stream from the Rear Camera

5-4-3 Using the BlackSys App – Configuration

- ※ Configuration only available when BlackSys product is connected to your Smartphone.
- ※ Menu items may vary depending on BlackSys model.
- ※ While saving changed value, either black box and smart phone have to be turned on.

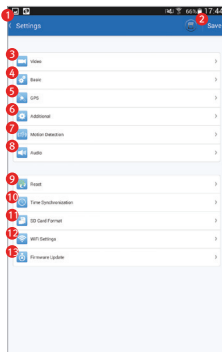

1. **Navigation** : Navigate to the Main Screen
2. **Save Changes** : Changes will be saved and applied
3. **Video** : Configure video settings
4. **Basic** : Configure basic settings & functions
5. **GPS** : Configure GPS settings
6. **Additional** : Additional settings and functions
7. **Motion Detection** : Configure setting for Motion Detection
8. **Audio** : Configure audio quality and settings
9. **Reset** : Reset all settings applied to product to default factory settings
10. **Time Synchronization** : Synchronize product time with Smartphone
11. **SD Card Format** : Format SD card
12. **Wi-Fi Settings** : Verify changes to the Wi-Fi network of the product

5-4-4 Using the BlackSys App – Miscellaneous

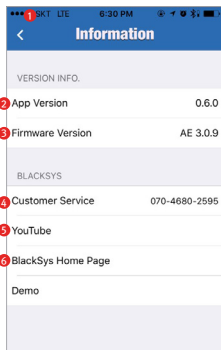

1. **Navigation** : Navigate to the Main Screen
2. **Application Version** : Displays current mobile app version
3. **Firmware Version** : Displays current firmware version of your product
4. **Call Service Center** : Contact BlackSys for more information
5. **YouTube** : View our YouTube channel
6. **BlackSys Homepage** : Visit our homepage for more information

5-5 BlackSys Viewer

1. Program Installation

- You can download the BlackSys Viewer from our webpage
www.blacksys.co.kr/en > GET SUPPORT > Download and execute.
Once installation is completed, click BlackSys Player and execute it.



CH-200
Player

2. Uninstallation (Choose one of 3 options)

- ① Control panel > program uninstallation & change > uninstallation
BlackSys (CH-200) Player
- ② Execute C:\Program Files(x86)\BlackSys\BlackSys Player
\Uninstall BlackSys Player
- ③ Execute Start > All program > BlackSys Player
> Uninstall BlackSys Player

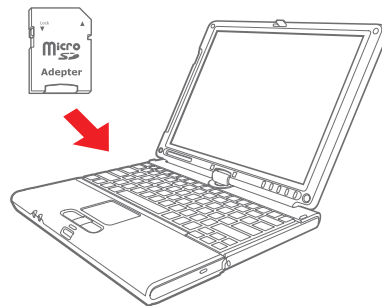

Recommended System for PC viewer

- OS : WIN7, 8, 10(32/64bit)
- H/W: Quad core 2.8Ghz/ 4G RAM or higher
- Web browser: Microsoft internet explorer 7.0 or higher
- Direct X version: Direct X9.0 (JUNE2010) or higher
- Others: Windows.NET Framework 4 or higher

※ Buffering of video and audio, changing in playing speed, and missing files can be happened due to the performance and type of PC.

3. PC Viewer Instructions

Time configuration

Configuration

Save recorded video

Folder open

Play List

Map View

Mian Viewer screen

BlackSys

RECORD INFORMATION

File name of front view video :
alwa_20171112_071532_F.mp4

Rear view indicator icon

Sub Viewer screen :
alwa_20171112_071532_R.mp4

G-Sensor Data Review

Move to 10sec. before

Pause

Move to 10sec. after

Video play speed control

Volume control

Full screen

Switch between Main/Sub videos

Enlarge / Shrink

Rear view video

※ In case of receiving poor GPS signal or disconnecting internet, map information of GPS may not be displayed.

※ It is only interlocked automatically with upper version than explorer 7.

※ Use "Full screen" to watch the video in Full HD.

4. Configuration

- User can change the default setting value such as recording, system, time and more options using “Configuration” on the PC viewer program menu.

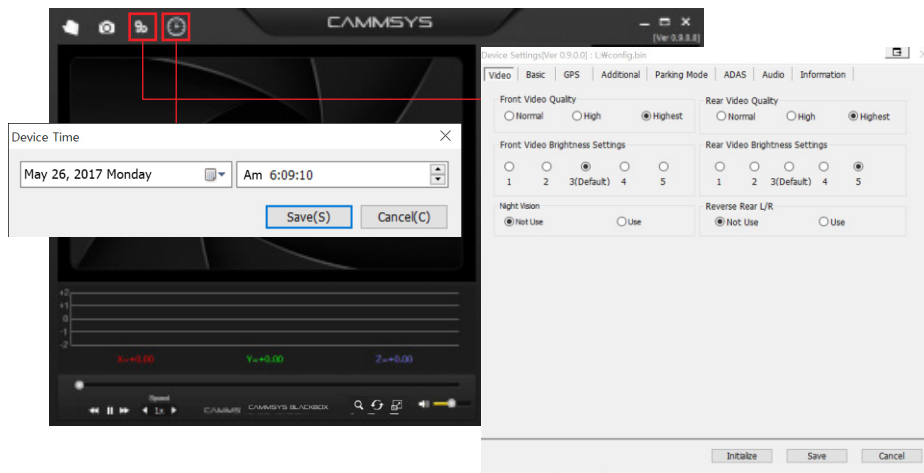

5. Recording screen



- 1 Date, time
- 2 Speed of vehicle (Only with GPS)
- 3 Status of GPS
 - ※ A: GPS receiving
 - ※ V: GPS not receiving
 - ※ F: GPS is not connected
- 4 Driving distance (Only with GPS)
- 5 Voltage
- 6 Recording mode
- 7 Plate number (Max 8 digit)
- 8 Mic (On/Off)
- 9 Firmware version
- 10 Model name
- 11 Front camera quality (S:Ultra / H:High / N:Normal)
- 12 Front camera brightness level(1~5)
- 13 Rear camera quality (S:Ultra / H:High / N:Normal)
- 14 Rear camera brightness level(1~5)

06 Firmware Update

6-1 Firmware Update

✓ Please follow the below process in case of updating firmware.

- ① Remove SD card from the unit.
 - Turn off the ignition first and remove cigar jack cable from the unit.
- ② Access our webpage (www.blacksys.co.kr/en > GET SUPPORT > Download) and download the latest update file.
- ③ Connect SD card to PC and paste downloaded latest update file (**CH200update.zip**) to the root of removable disk.
- ④ Insert SD card which contains latest update file to the unit.
 - Turn on the ignition and connect cigar jack cable to the unit.
- ⑤ All LED is light on and update is initiating. Once finish the update, it starts recording automatically.
 - Do not disconnect power cable while update is in process. It can cause malfunctioning.

6-2 Download (Firmware & PC viewer)

- Access our webpage (www.blacksys.co.kr/en > GET SUPPORT > Download) and download the latest update file and PC viewer.
- Complete program installation
- ※ You must connect internet to download firmware and PC viewer program.
- ※ Please check notice before update your product to avoid from changing in functions.

07 How to format SD card

7-1 PC format

1. PC format

※ “How to format?” is provided from PC viewer. We do not recommend to format on “My Computer”.

- ① Insert or connect SD card to PC.
- ② Click **[Start]** → **[My Computer]**
- ③ Place mouse pointer on **[Portable USB drive]** SD card and click the right button of mouse. Then click the **[Format]**
- ④ Once click the **[Start]** button, format is started.
 - FAT 32 format is required if SD card recognition and record error happen.
Product will format SD card automatically in case of using 32KB cluster size format.
 - Change SD card if PC doesn't recognize SD card or format is not able to be completed.
 - If SD card contains other data, it can cause malfunctioning. Therefore, please remove it.

※ As SD card is expendable supply, manufacturer is not responsible for any data loss and damage.
Also, manufacturer cannot guarantee the recorded data in SD card.

2. Format PC viewer

- ① Click “Configuration”
- ② Click “SD card format”. (Refer to P. 30 Configuration)

7-2 Format on product

※ Formatting SD card is also possible on the product.

- ① Press Event + WiFi button for 3sec. then it will give voice guide “Formatting is on standby. Press the left key to format”.
- ② Press Event button again then format will be started with voice guide “Formatting SD card. Do not turn off the power”.
- ③ It will start recording automatically once the format is done.

08 Technical Specification

※ Technical Specification can be changed without prior notice for product improvement.

Feature	Feature Description
Camera	Front : Full HD, 2.1M Pixels SONY IMX322 Sensor, (1/2.9") Rear : Full HD, 2.1M Pixels SONY IMX322 Sensor, (1/2.9")
Angle of View	Front: 135° / Horizontal(107°), Vertical(55°) Rear: 130° / Horizontal(105°), Vertical(54°)
Bitrate & Frame	Front: 9Mbps 30fps, Rear: 7Mbps 30fps
Video & Audio Format	H.264(MP4), Codec profile : MAIN L5.1 PCM
Recording Method	In case SD card is full, it deletes the oldest files (automatically) in order
Normal Recording	Video is recorded in 3 minute intervals
Manual Recording	10 sec. before and 20 sec. after the event
Shock Detect Recording	10 sec. before and 20 sec. after the shock is detected
Motion Recording	10 sec. before and 20 sec. after the motion is detected
ADAS	LDWS / FCWS / FVSA Auto Calibration through the device *Device ON/ GPS ON/ over 30km/h & over 3 min. running

Feature	Feature Description
Shock Sensor	Tri-axial shock detection G-Sensor
GPS	Dual GPS Module
Memory Storage	SD card: SDHC/SDXC memory card
Video Playing	Normal / BlackSys PC Viewer program
Audio	Built-in speaker and MIC
Power and Power consumption	Input Voltage: DC 9V ~ 24V Voltage consumption: 380mA (13.4V) WIFI OFF
Permanent Power	Cut-off voltage (12.4V~11.8V, 0.2V interval) Cut-off time (3, 6, 12, 24, 48 Hour) Possible to use both functions at the same time
Operation and Storage temperature	Operation temperature : -20°C ~ 70°C Storage temperature : -30°C ~ 80°C
Dimension & Weight	Front : 58x100x34(mm), 98g Rear : 50x26x31(mm), 25g

09 Customer Service

※ We don't take any responsibility for the data loss during the service. Please back up the data before applying for service.



CammSys Customer Service

- Address: (Songdo-dong)26, Venture-ro 100beon-gil, Yeonsu-gu, Incheon, 22013, Korea
- Opening hour: 09:00 ~ 18:00 (Mon. ~ Fri.)
- Closed: Saturday, Sunday and Public Holiday

If you come to customer service center, service personnel will care for the service timely and properly.
For further information regarding customer service, please refer to www.blacksys.co.kr/en

10 Quality Assurances

1. Warranty period

- Product(main unit) : 12 months from the purchase date (But, if purchase date is not clear, it can be applying 3 months warranty after manufacturing date)
- Accessory(expendable supply) : 6 months including SD card.(In case of using DC fuse power cable, memory card life can be shorter than general use)
- Service parts holding period : 5 years after stopping sales

	Type of Damage	Compensation standard	
		Within Warranty Period	After Warranty Period
Claim a service for trouble caused in a normal use condition	Claim a service for a main part within 10 days after purchase	Replacement or refund	Not applicable
	Claim a service for a main part within 1 month after purchase	Replacement or Free repair	Not applicable
	Claim a service for faulty unit	Free repair	Repair at cost
	Repair is not available	Replacement or refund	Replacement or refund after depreciation
	Replacement is not available	Refund at cost	Applicable by bylaw
	Claim a service for a main part within 1 month after unit exchange	Refund at cost	Applicable by bylaw
	Same defect over 3 times	Replacement or refund	Not applicable
	Multi defect over 5 times	Replacement or refund	Not applicable
	Lost by service center during repair service	Replacement or refund	Applicable by by law
Claim a service for not holding service parts within service parts holding period	Trouble caused in a normal use condition	Replacement or refund	Not applicable
	Customer's negligence or fault, functional defect	Repair at cost	
Damaged unit from distribution		Replacement	Not applicable
Damaged unit from installation		Replacement	Not applicable

※ Warranty period is 12 months after purchase.

※ We provide product repair and replacement services within the warranty period in accordance with the consumer protection regulations.
(the Korea Fair Trade Commission Directive 2008-3)

11 Product Warranty

Model Name	CH-200			
Manufacturer	Cammsys Corp.			
Serial No.				
Purchase Date				
Warranty Period	12 months from the purchase date (But, if purchase date is not clear, it can be applying 3 months after manufacturing date)			
Customer Information	Name		Tel.	
	Address			
Assembler information	Shop name		Tel.	

- ※ The warranty for the product is benefited by the details on the warranty card.
- ※ Warranty period is counted from the purchase date. So get the purchase date.
- ※ This warranty card is not reproduced.

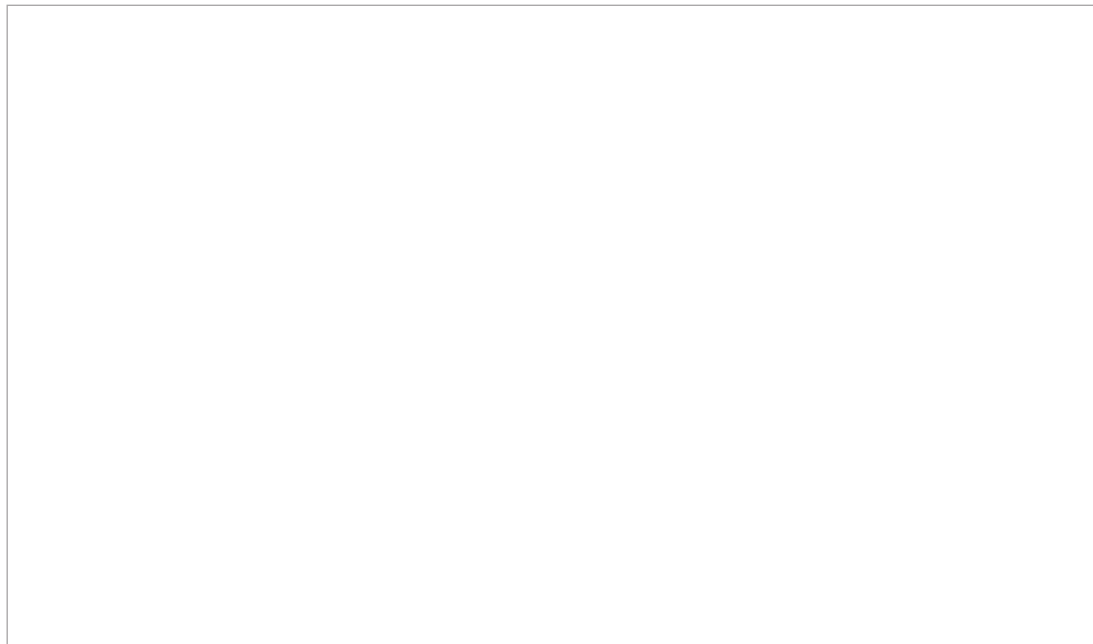

Memo

A large, empty rectangular box with a thin black border, intended for writing a memo. It occupies the majority of the page area below the 'Memo' header.

