

# STITCH™

Mini Wi-Fi® 10A Smart Outlet

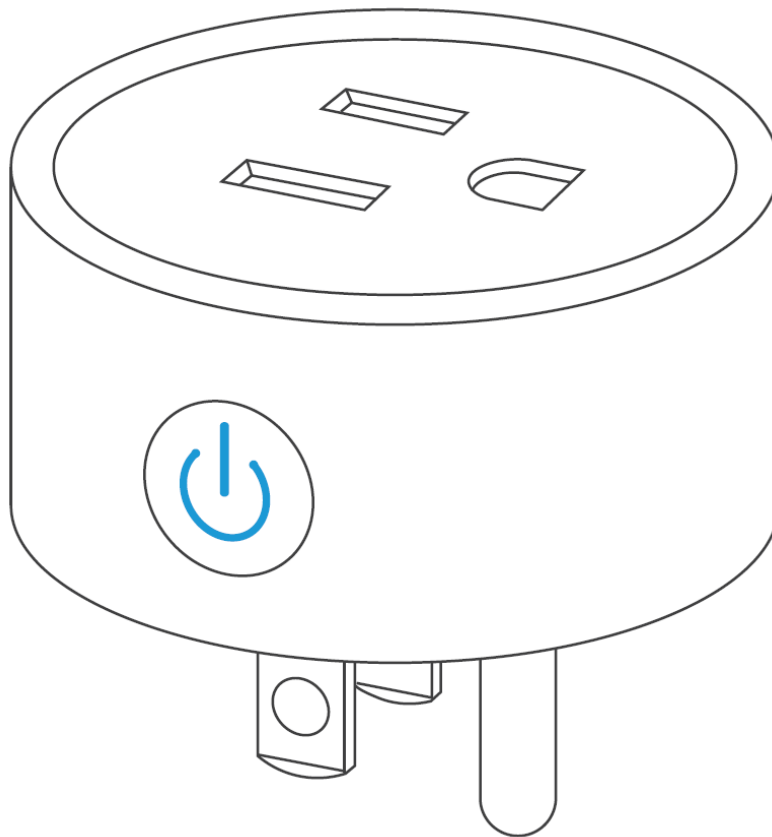

P/N 41730, 41731, 41732

## User's Manual

## TIPS

- Supports 2.4GHz Wi-Fi® networks only
- Easy install from the Apple® App Store® and Google Play™
- Supports Amazon Alexa™ and Google Home™ voice control
- For indoor use only

## PRODUCT OVERVIEW

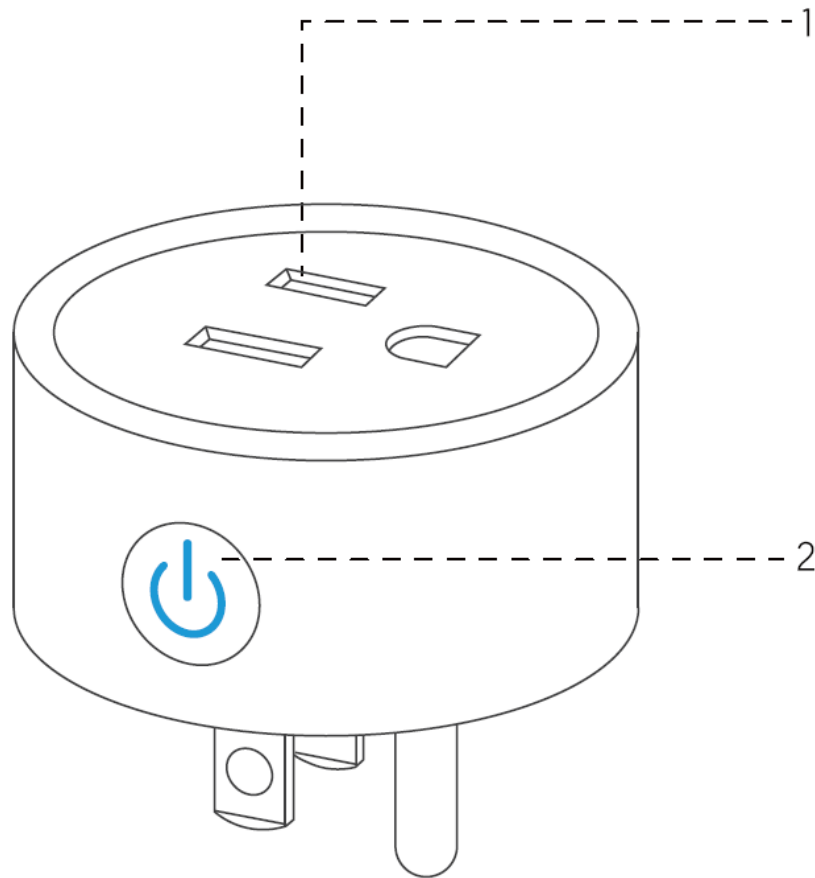

1. AC Outlet
2. Power Switch

## CONNECTING TO WI-FI

1. Search the Apple® App Store® or Google Play™ for the **STITCH™ by Monoprice™** app or scan one of the QR codes below to get to the app page in the store. Download and install to your device.



2. Once the app is downloaded and installed, you will be asked to register using either your phone number or email. If you choose phone, you will be sent a text with a registration code. If you choose email, you will be asked to enter a password instead of getting a registration code.

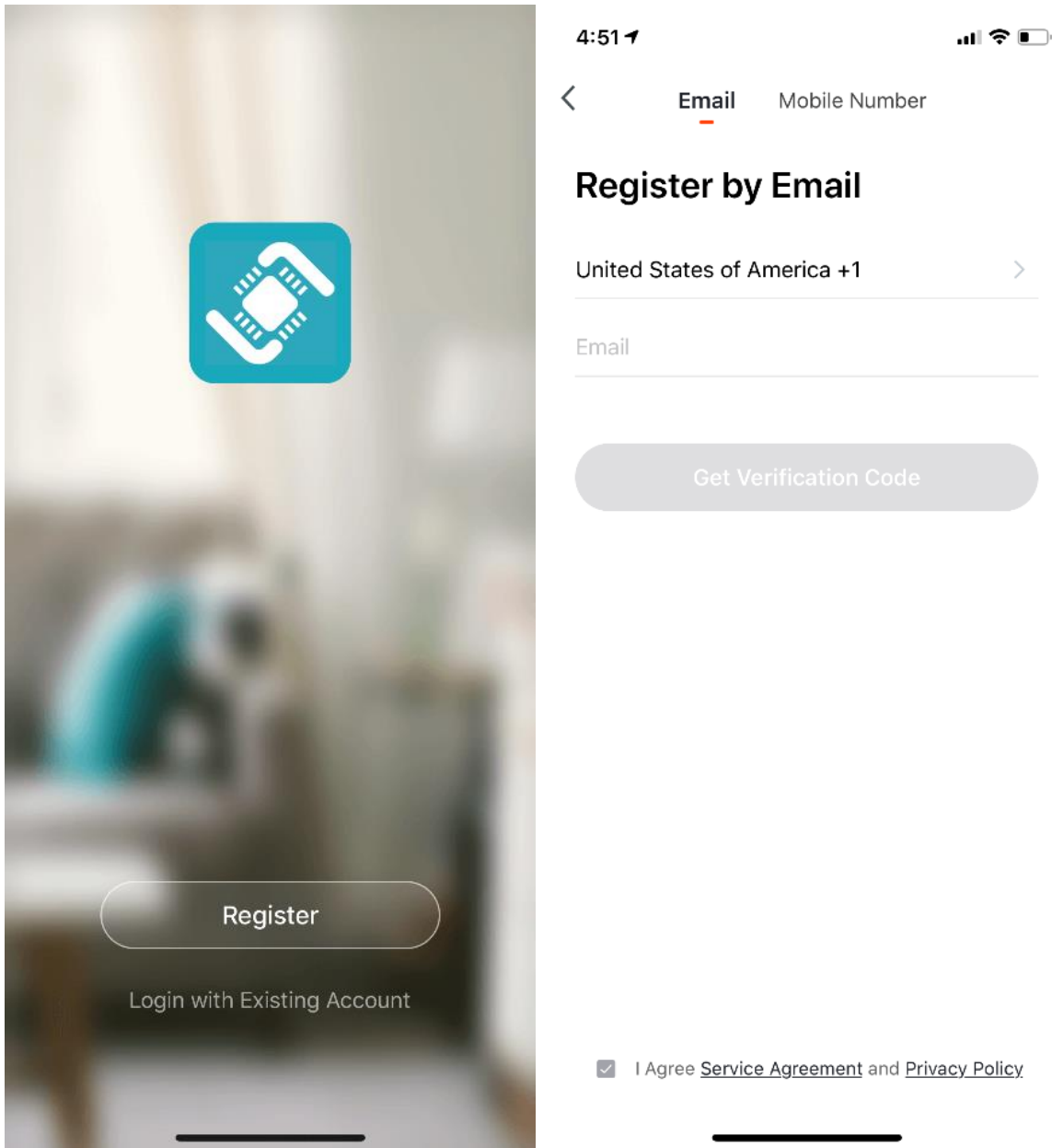

4:51

< Email Mobile Number

## Register by Email

United States of America +1 >

Email

Get Verification Code

Register

Login with Existing Account

☒ I Agree [Service Agreement](#) and [Privacy Policy](#)

Note that there are two Mode Configurations to choose from before adding the device to the app, **Quick Mode** and **AP Mode**. We recommend **Quick Mode**.

## Quick Mode Configuration

1. Check the indicator light. If it is blinking blue about twice per second, you have started in **Quick Mode**. If it is blinking blue about once every 3 seconds, press and hold the **Power** button on the **Smart Outlet** for about 6 seconds until it starts blinking rapidly.
2. Tap the **+** icon in the upper right corner of the app, then select **Smart Outlet** from the list.

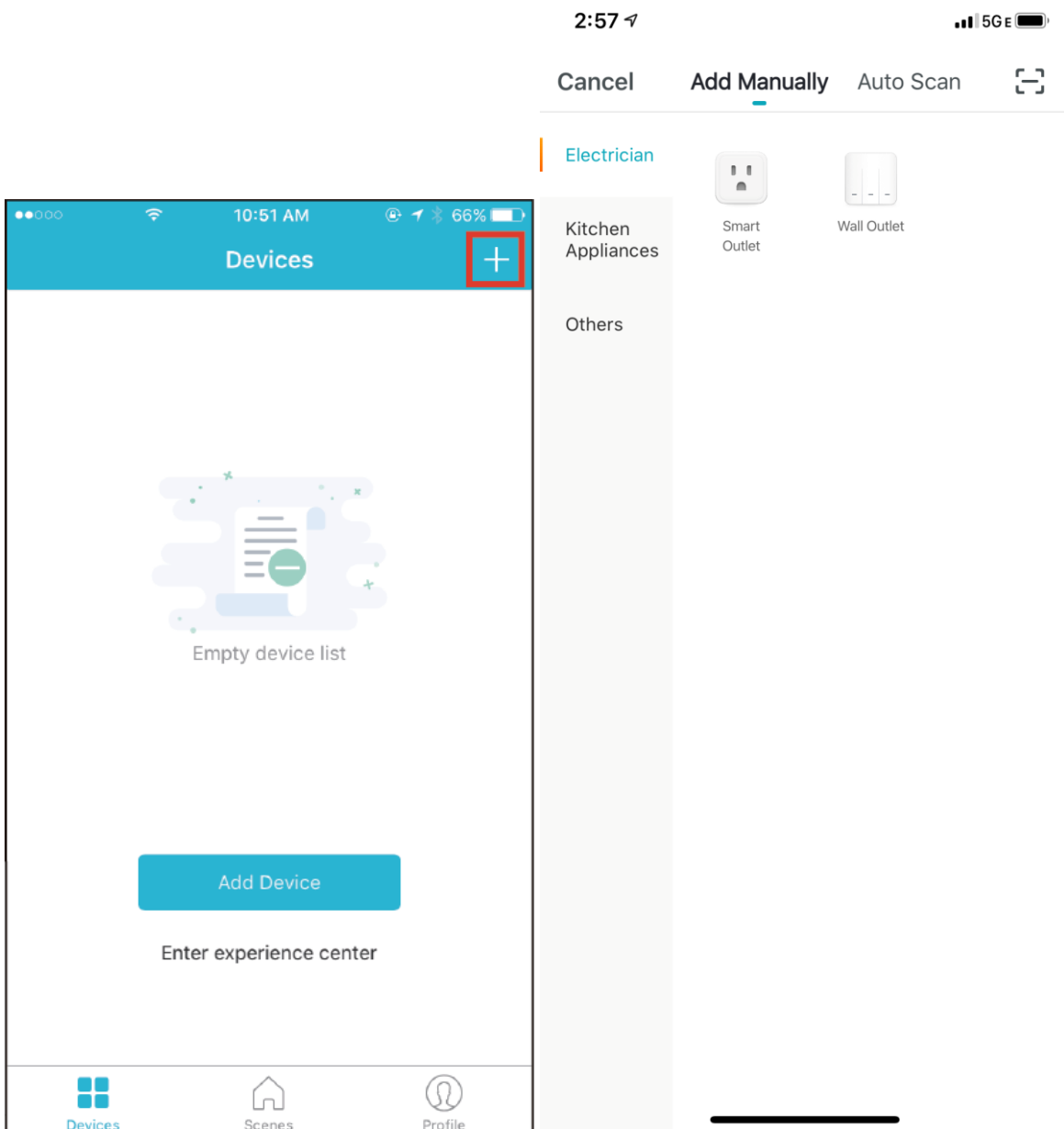

3. Follow the on screen instructions to connect the **Smart Outlet** to your Wi-Fi® network.

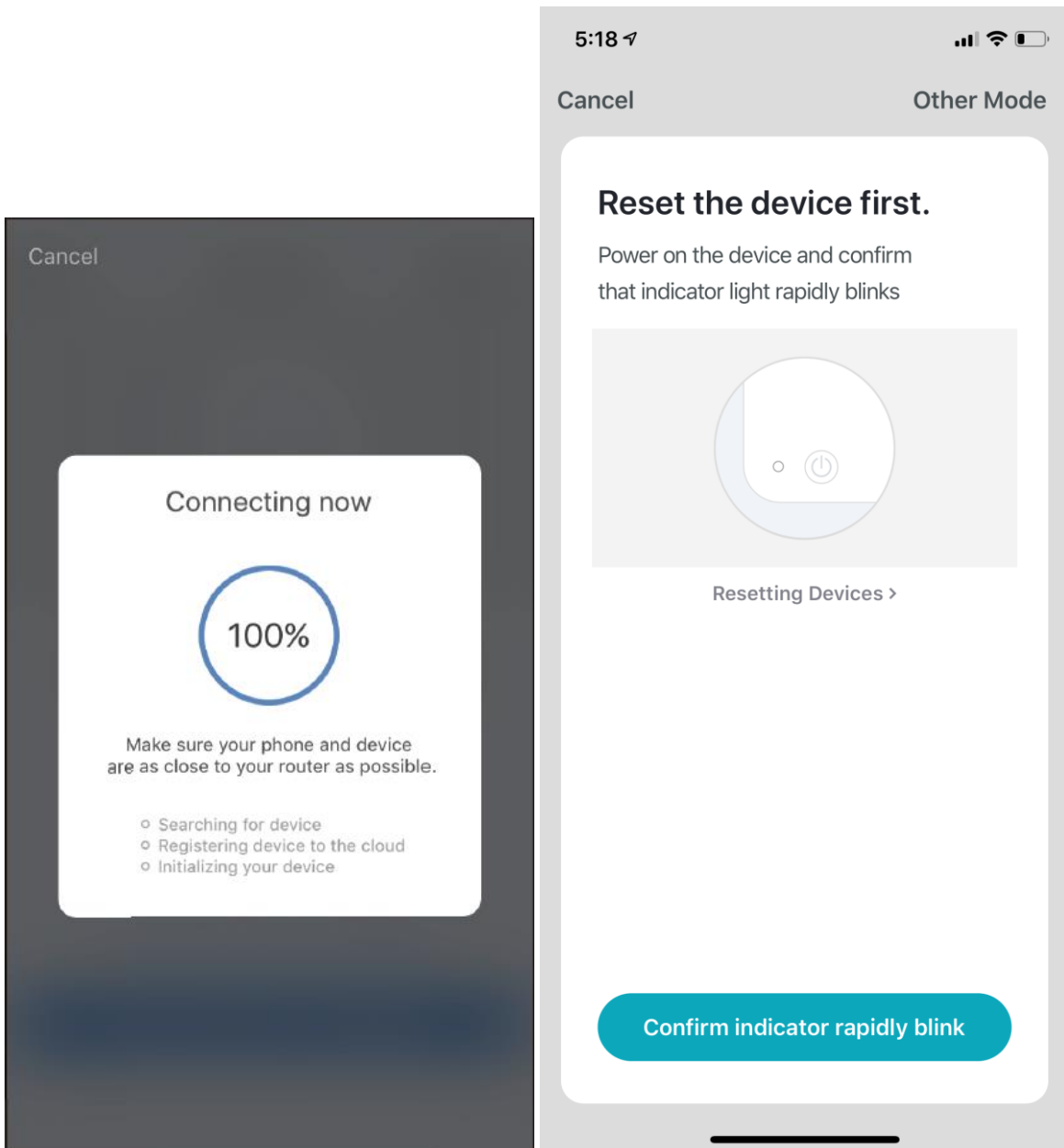

4. Once the app indicates that it is connected, tap **Done**. The indicator changes from rapidly blinking blue to solid red and the **Smart Outlet** is added to the **Device List**.  
  
Note that you can use this Smart Outlet with the Amazon Alexa™ and/or Google Home™ voice assistants by following the instructions in the *VOICE ASSISTANTS* section below.

## AP Mode Configuration

1. Check the indicator light. If it is blinking blue about once every 3 seconds, you have started in **AP Mode**. If it is blinking blue about twice per second, press and hold the **Power** button on the **Smart Outlet** for about 6 seconds until it starts blinking slowly.
2. Tap the **+** icon in the upper right corner of the app, then select **Smart Outlet** from the list. On the following screen, tap **Other Mode** in the upper right corner of the screen, then tap **AP Mode**.

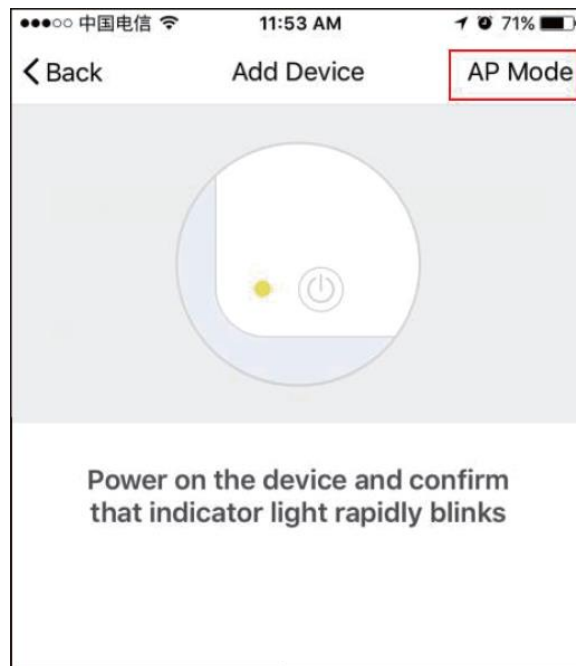

3. Follow the on screen instructions to connect the **Smart Outlet** to your Wi-Fi® network.

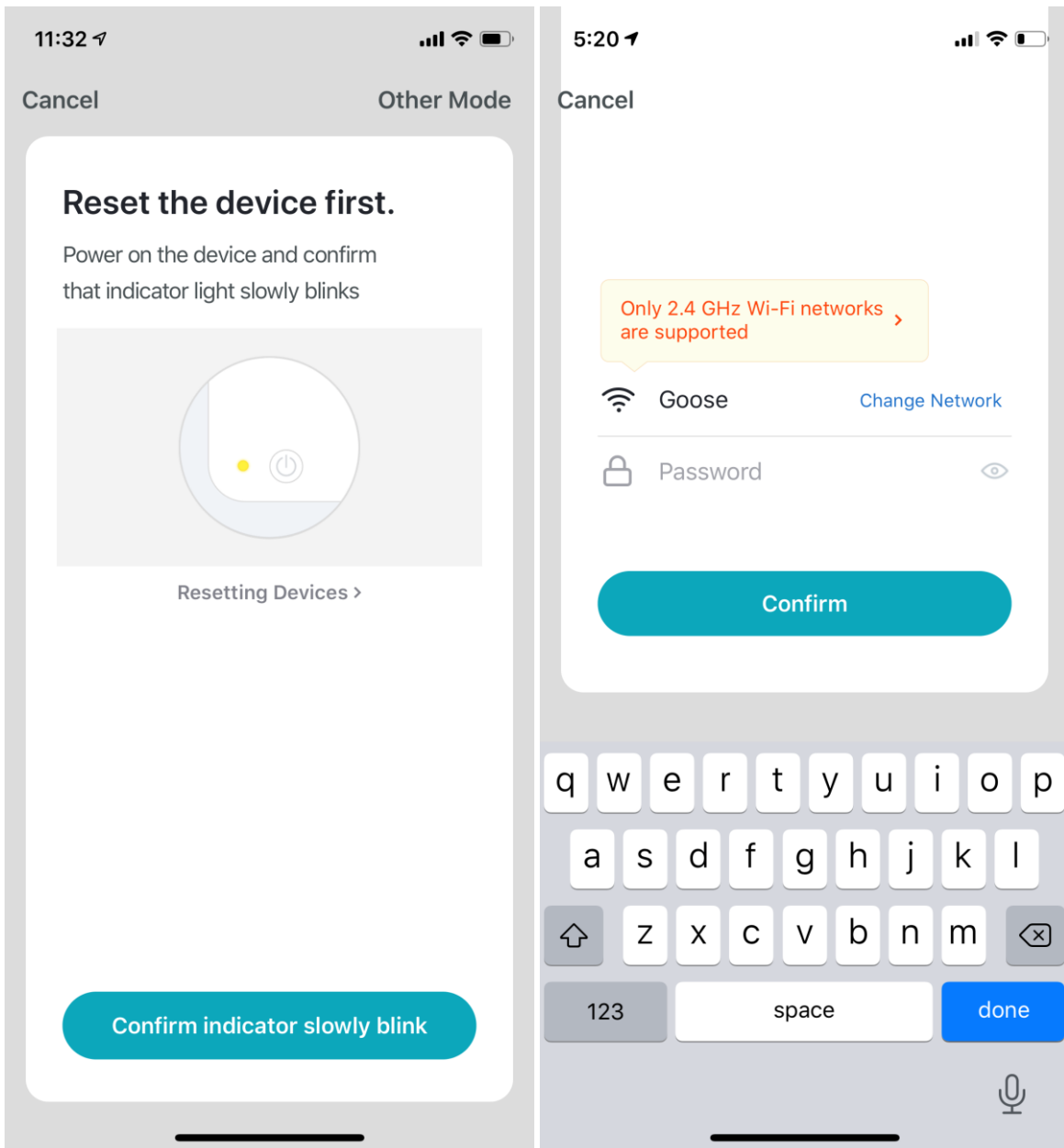

4. Once the app indicates that it is connected, tap **Done**. The indicator changes from slowly blinking blue to solid red and the **Smart Outlet** is added to the app's **Device List**.

Note that you can use this Smart Outlet with the Amazon Alexa™ and/or Google Home™ voice assistants by following the instructions in the *VOICE ASSISTANTS* section below.



# VOICE ASSISTANTS

## Amazon Alexa

1. Launch the **STITCH™** app and verify that the **Smart Outlet** is in the **Device List**.
2. Edit the **Smart Outlet** name to something that Alexa™ will easily recognize, such as Living Room Light, Bedroom Fan, etc.
3. Minimize the **STITCH** app, then launch the **Alexa** app and sign in to your account. Ensure that you have at least one Alexa voice control device installed, such as an Echo™, Echo Dot™, etc.

4. Tap the **More** icon in the lower right corner of the **Home Page** to show the app menu, then tap **Skills & Games** in the menu.

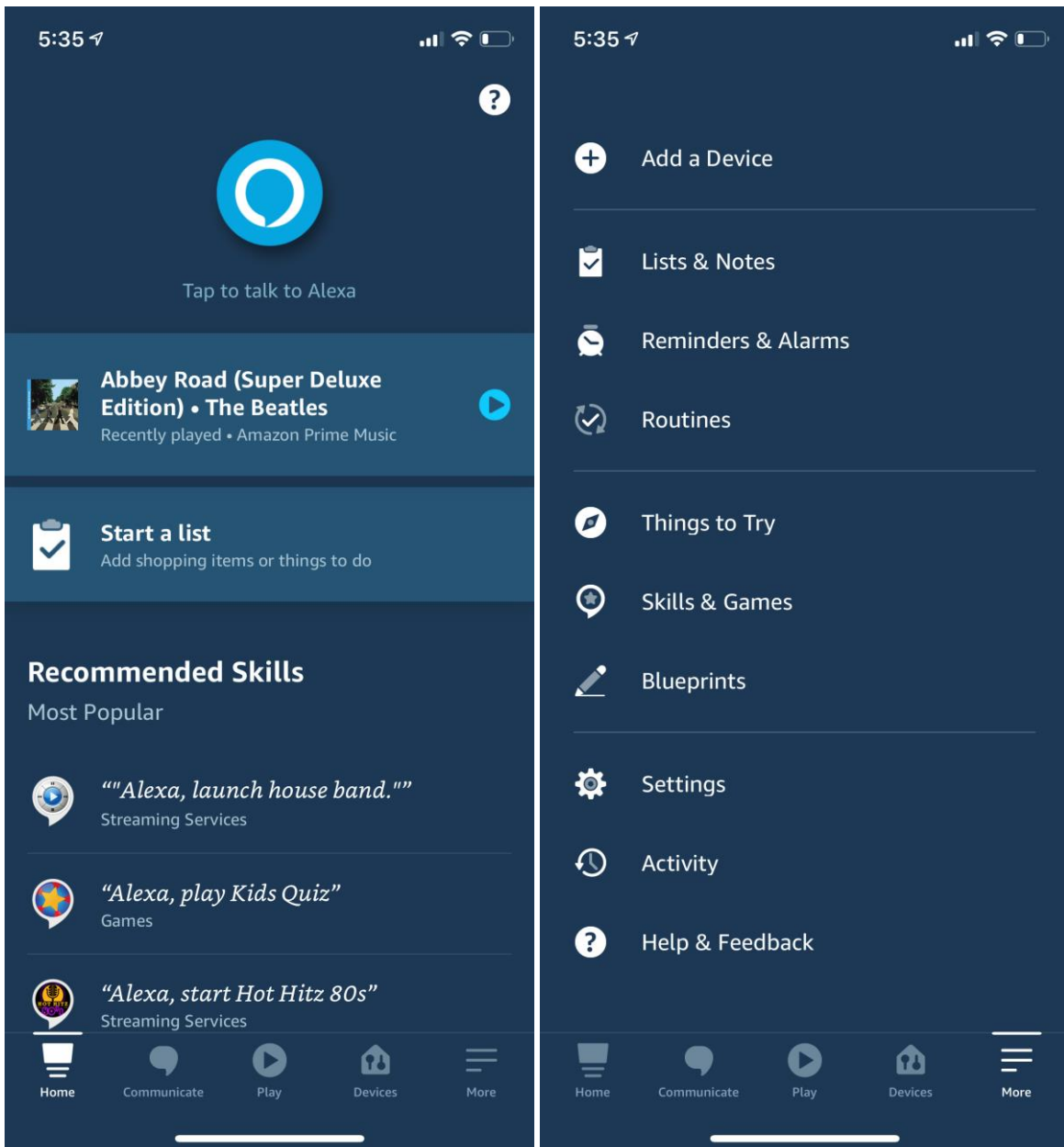

5. Type **STITCH by Monoprice** in the search field, then tap the **STITCH** entry to select it.

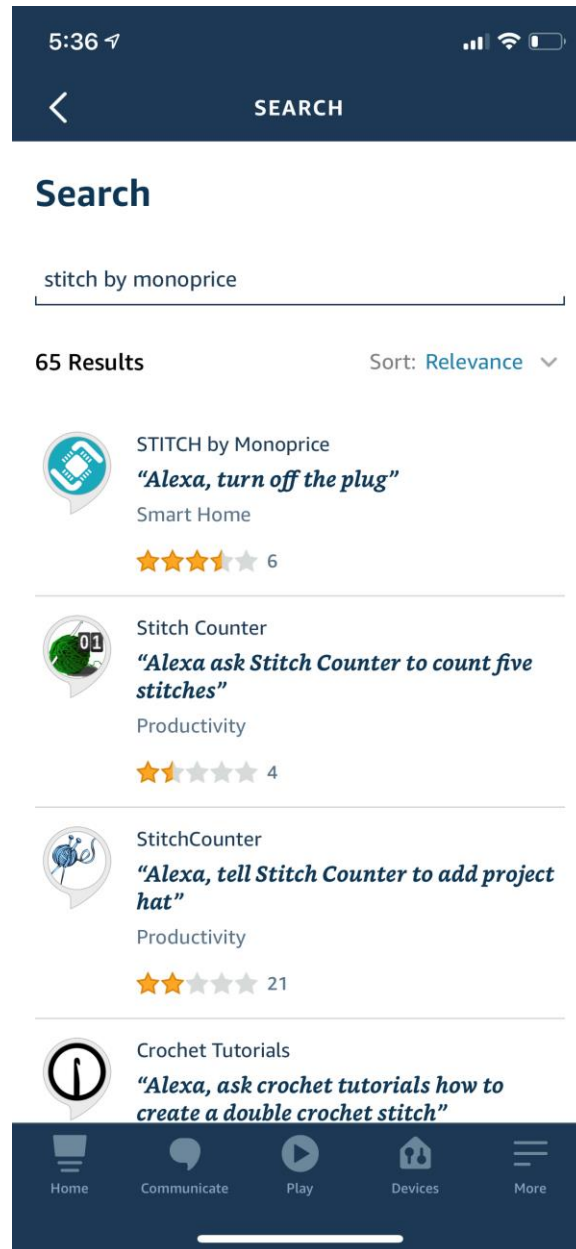

6. Tap the **ENABLE TO USE** button, then sign in to your STITCH™ account to complete the account linking.

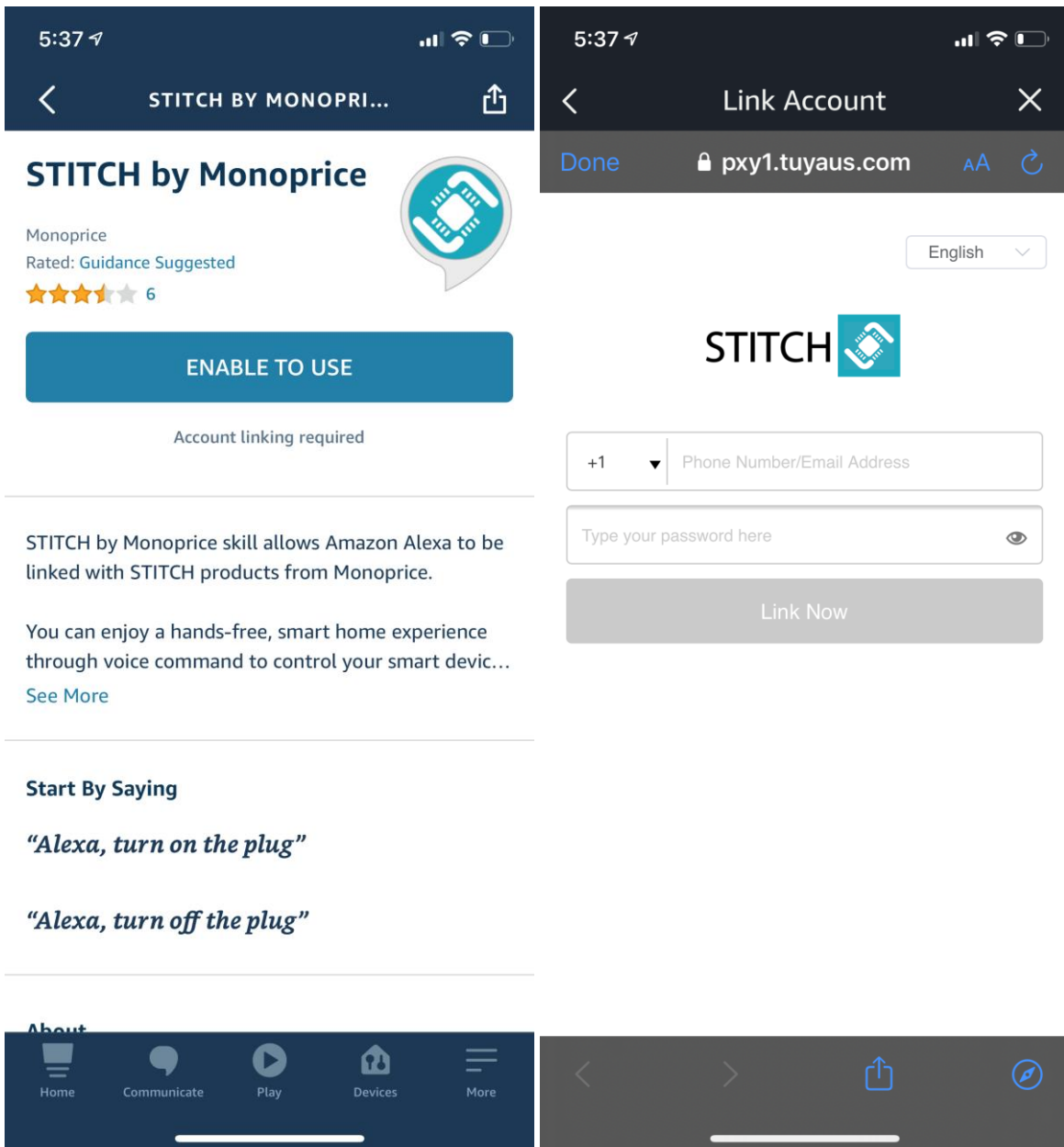

7. After your account is linked, you need to discover the device to use it. Tap the **DISCOVER DEVICES** button. After about 20 seconds Alexa™ will display a list of devices.



## Discover Devices

Smart Home devices must be discovered before they can be used with Alexa.

CANCEL

DISCOVER DEVICES



8. Tap **Devices** to control your **Smart Outlet**, add it to **Groups** or **Routines**, and more.

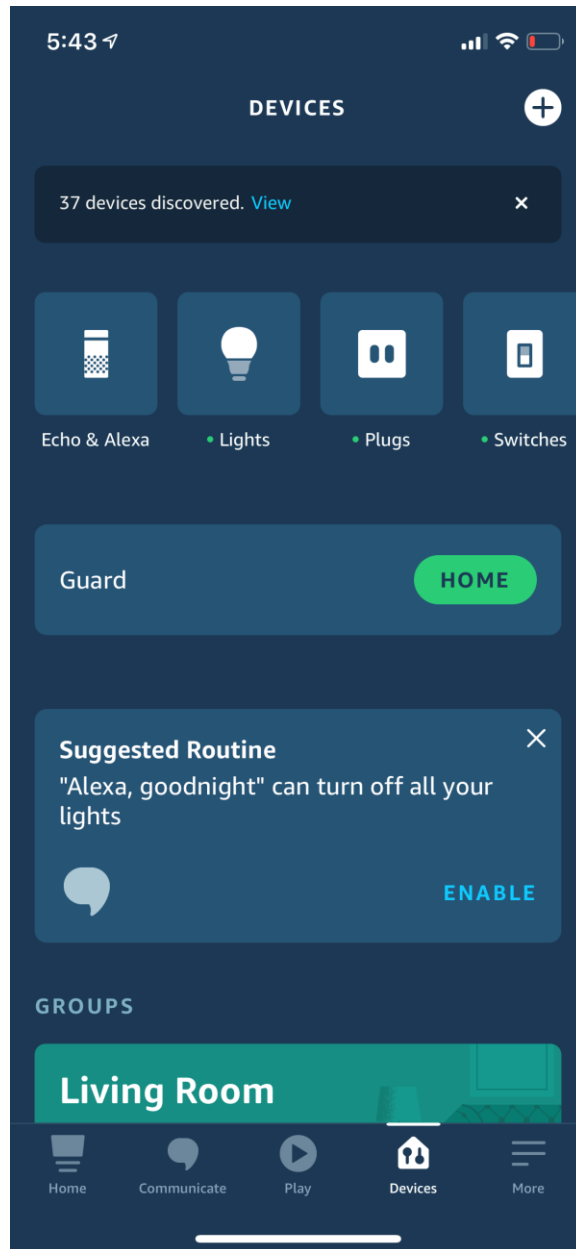

## Google Home

1. Launch your Google Home™ app and verify that your Google Home Speaker is installed. If not, following the Google Home Speaker installation instructions.
2. Once Google Home is installed, tap + in the upper left corner of the home page to show the **Add and manage** screen, then tap **Set up device**.

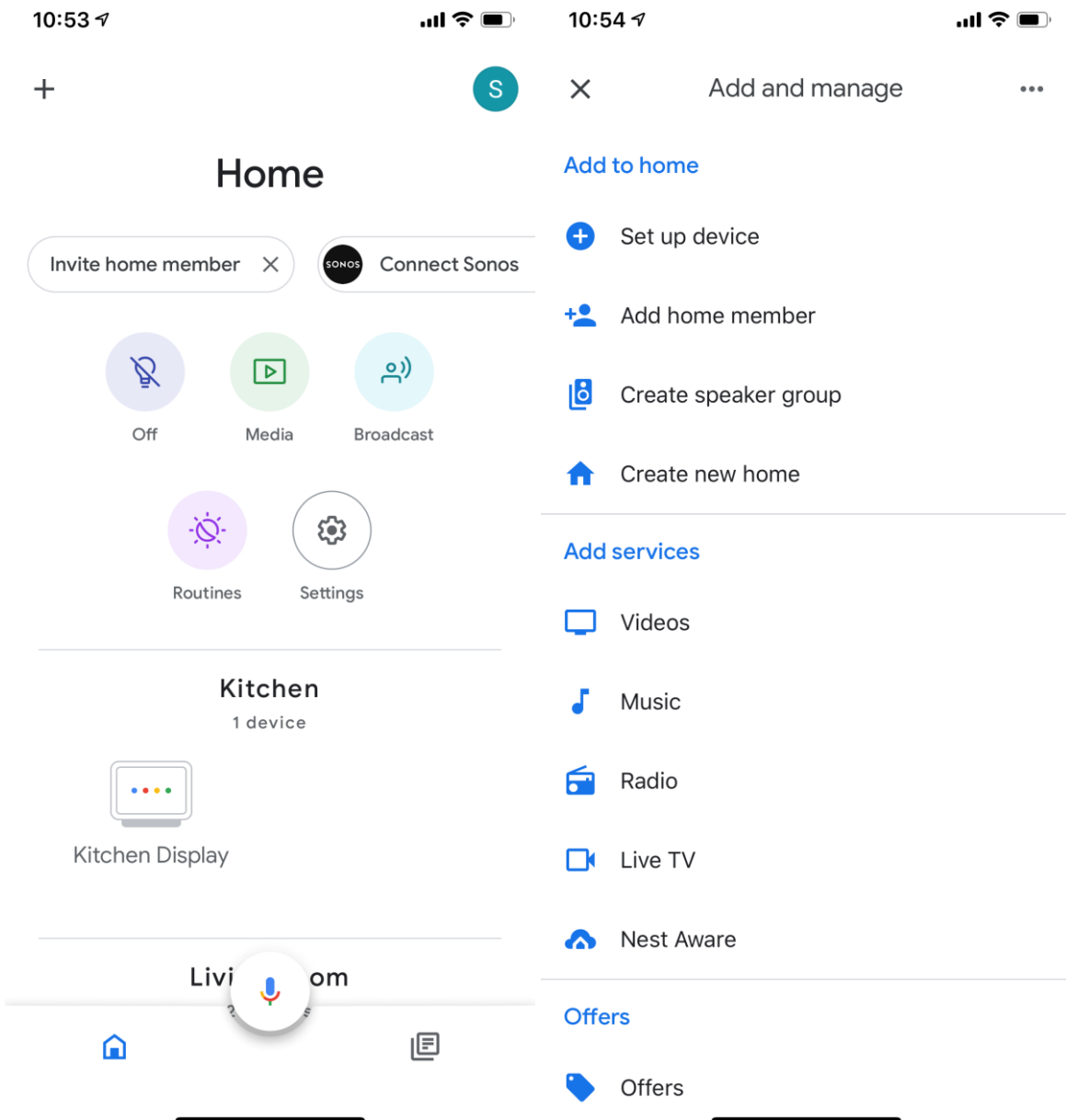

3. Tap **Have something already set up?**. On the following screen, tap the **Search** icon (magnifying glass), then type **STITCH** into the search field. Select the **STITCH™ by Monoprice™** entry, then following the on screen instructions to complete the account linking process.

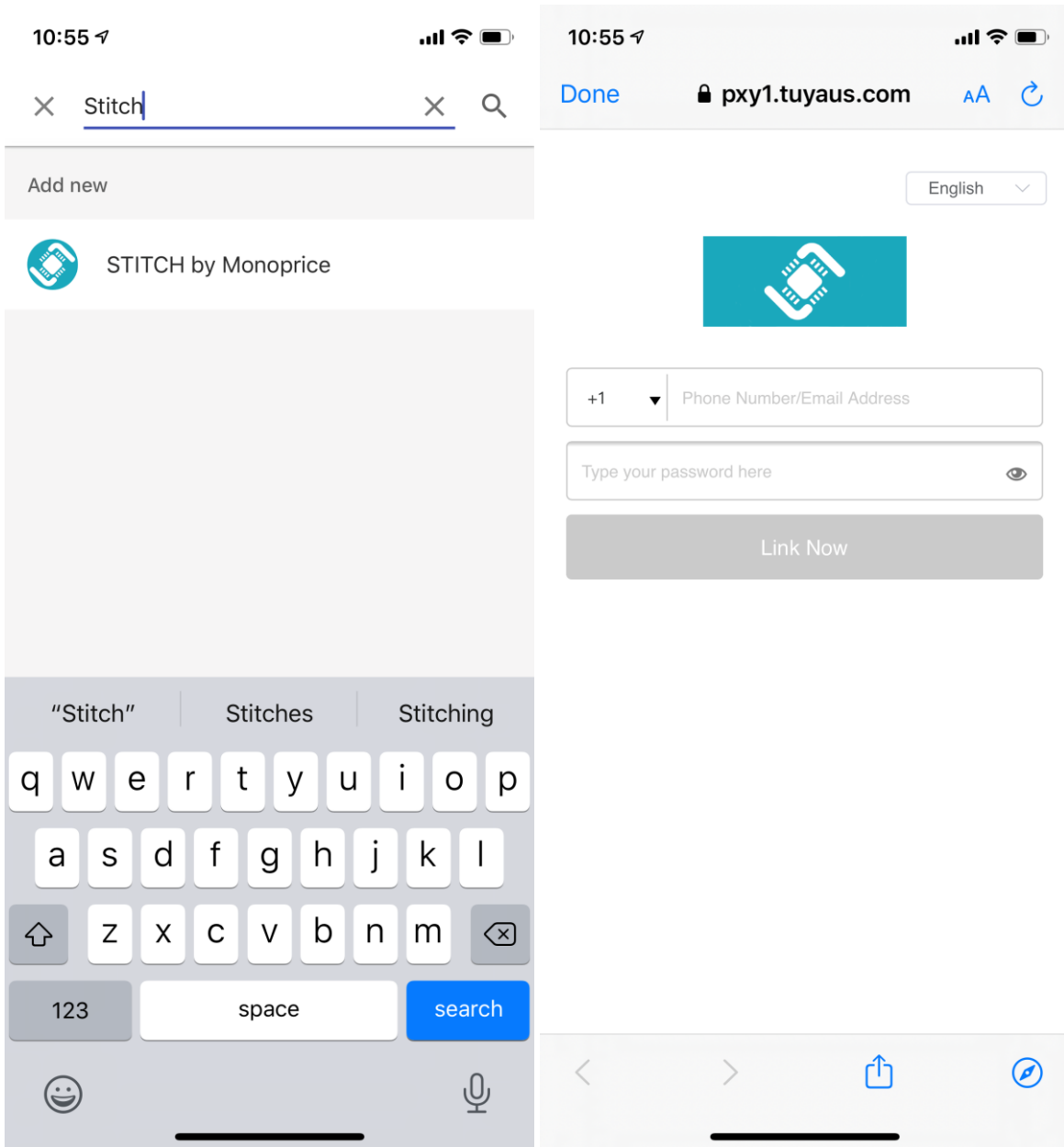

4. After successfully linking your account, you will see all the smart devices in your **STITCH™ by Monoprice™** account. You can assign each device to specific rooms.



5. You can now use your Google Home Speaker to control your smart devices by saying something like:

OK Google, turn on the kids room fan

OK Google, turn off the lamp

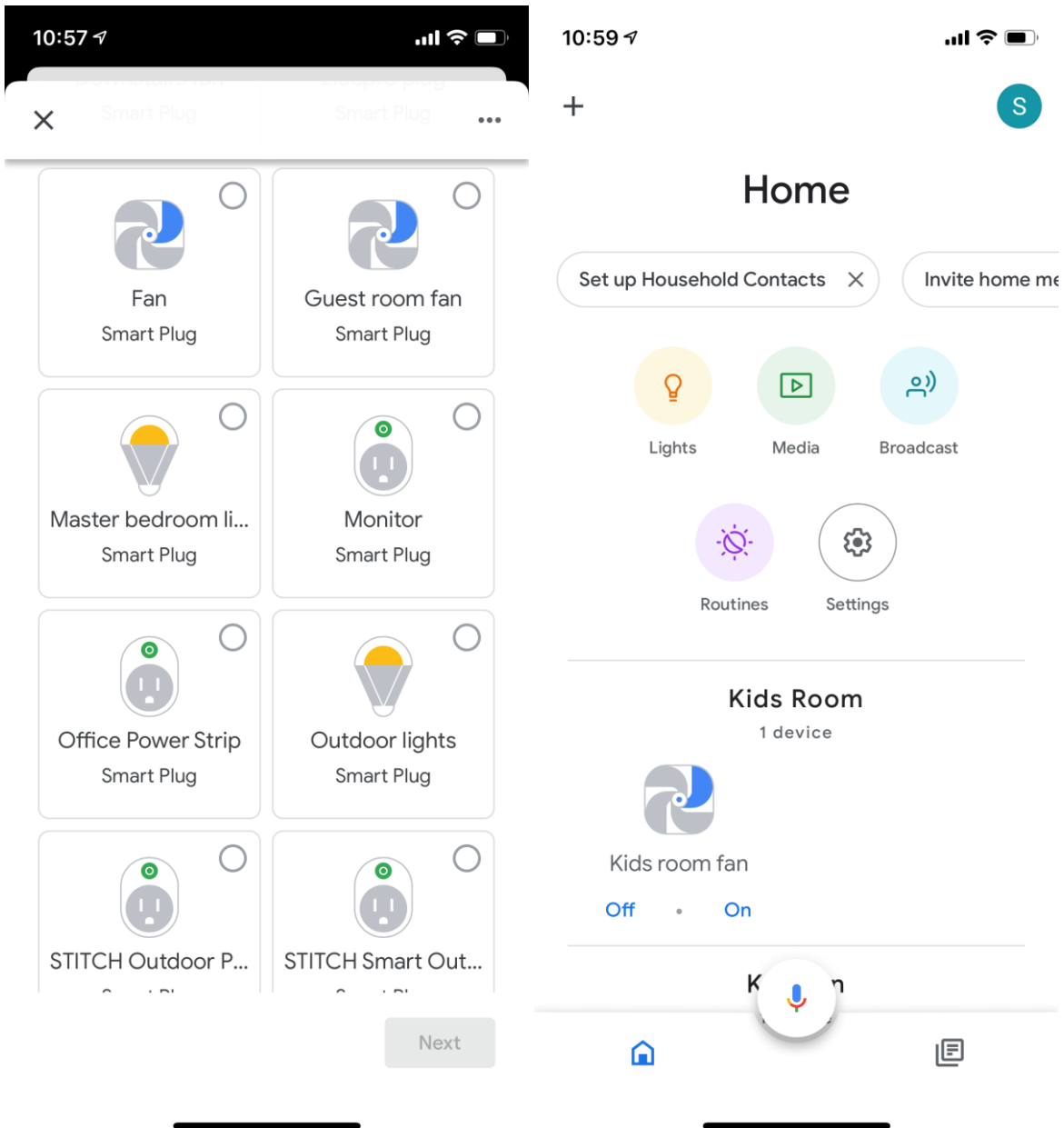

## ONLINE SUPPORT

Monoprice is pleased to provide free online support. For order related issues, contact the Customer Service department through the Live Chat link on our website

[www.monoprice.com](http://www.monoprice.com) or via email at [support@monoprice.com](mailto:support@monoprice.com)

For technical issues, contact the Technical Support department through the online chat button on our website [www.monoprice.com](http://www.monoprice.com) or by sending an email to

[tech@monoprice.com](mailto:tech@monoprice.com)

Check the website for support times and links.

## SPECIFICATIONS

Model	41730, 41731, 41732
Radio Frequency	2.4 GHz
Supported Network Protocols	IEEE802.11 b/g/n
Supported Network Encryption	WAP, WAP2, WEP, TKIP, AES
Input Voltage	100 ~ 240 VAC, 50/60 Hz
Maximum Current	10 amps
Rated Power	1250 watts
Operating Temperature	-4 ~ +122°F (-20 ~ +50°C)
Operating Humidity	0 ~ 80% RH, noncondensing
Storage Temperature	-40 ~ +176°F (-40 ~ +80°C)
Storage Humidity	0 ~ 80% RH, noncondensing
Dimensions	2.1" x 2.1" x 2.2" (54 x 54 x 55 mm)
Weight	1.9 oz. (53 g)

# REGULATORY COMPLIANCE

## Notice for FCC



This device complies with Part 15 of the FCC rules. Operation is subject to the following two conditions: (1) this device may not cause harmful interference, and (2) this device must accept any interference received, including interference that may cause undesired operation.

Modifying the equipment without Monoprice's authorization may result in the equipment no longer complying with FCC requirements for Class B digital devices. In that event, your right to use the equipment may be limited by FCC regulations, and you may be required to correct any interference to radio or television communications at your own expense.

This equipment has been tested and found to comply with the limits for a Class B digital device, pursuant to Part 15 of the FCC Rules. These limits are designed to provide reasonable protection against harmful interference in a residential installation. This equipment generates, uses and can radiate radio frequency energy and, if not installed and used in accordance with the instructions, may cause harmful interference to radio communications. However, there is no guarantee that interference will not occur in a particular installation. If this equipment does cause harmful interference to radio or television reception, which can be determined by turning the equipment off and on, the user is encouraged to try to correct the interference by one or more of the following measures:

- Reorient or relocate the receiving antenna.
- Increase the separation between the equipment and receiver.
- Connect the equipment into an outlet on a circuit different from that to which the receiver is connected.
- Consult the dealer or an experienced radio/TV technician for help.

## RF Exposure Statement for FCC

## Caution

This equipment complies with radiation exposure limits set forth for an uncontrolled environment. End users must follow the specific operating instructions for satisfying RF exposure compliance. This transmitter must be at least 20 cm from the user and must not be collocated or operated in conjunction with any other antenna or transmitter.

## Notice for Industry Canada

This Class B digital apparatus complies with Canadian ICES-003.

Cet appareil numérique de la classe B est conforme à la norme NMB-003 du Canada.

## RF Exposure Statement for Industry Canada

### Caution

This equipment complies with radiation exposure limits set forth for an uncontrolled environment. End users must follow the specific operating instructions for satisfying RF exposure compliance. This transmitter must be at least 20 cm from the user and must not be collocated or operated in conjunction with any other antenna or transmitter.

*STITCH™, Monoprice™, the STITCH logo, and all Monoprice logos are trademarks of Monoprice Inc.*

*Wi-Fi® and Wi-Fi Alliance® are registered trademarks of Wi-Fi Alliance.*

*Apple®, App Store®, and the "Download on the App Store" logo are trademarks of Apple Inc., registered in the U.S. and other countries.*

*Amazon™, Amazon Alexa™, Amazon Echo™, Amazon Echo Dot™, and all related logos are trademarks of Amazon.com, Inc. or its affiliates.*

*Google™, Google Home™, Google Play™, and the "Get It On Google Play" logo are trademarks of Google LLC.*