

GLD09

Lumalou™  
BETTER BEDTIME  
ROUTINE SYSTEM

OWNER'S  
MANUAL

fisher-price®



## LET'S GET STARTED

- 1** Download the app..... 5
- 2** Mount the Lumalou™ unit and the cord wrap cleat to the wall ..... 7
- 3** Pair your device (not included) to the Lumalou™ unit .....15
- 4** Setup routines .....17
- 5** Set sleep and wake times .....18
- 6** Ready to use ..... 20

## HERE IS WHAT YOU GET



Remote uses  
2 AAA batteries

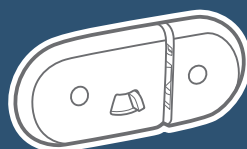

M4 x 25,4 mm Screw



7,6 mm x 25,4 mm  
Wall Anchor

Includes a cord wrap cleat and wall mounting fasteners. You supply the drill, drill bit  $\frac{3}{16}$ " (4,76 mm), hammer, screwdriver and about 20 minutes of your time.

## BEFORE YOU BEGIN



Keep this instruction sheet for future reference, as it contains important information.

The AC adapter and the Lumalou™ unit are not toys.



Adult assembly is required to mount the Lumalou™ unit and the cord storage cleat to the wall and install the batteries in the remote. Tools needed for assembly: electric drill,  $\frac{3}{16}$ " (4,76 mm) drill bit, hammer and Phillips screwdriver (tools not included).



x2

Includes two AAA batteries for remote.



Requires an AC adapter (input 100-240 VAC, 50/60Hz, output: 5 VDC, 1A, 5W) for operation (included).

Current/Power Rating: 0.3A MAX



### **WARNING**

**Strangulation Hazard** – Children have STRANGLED in cords. Keep the cord out of the reach of children (more than 3 feet-0,9 meters) away.



## DOWNLOAD THE APP

Most features of this product only work with the Fisher-Price® Smart Connect™ app.

Download the Fisher-Price® Smart Connect™ app to create routines, set sleep and wake times and music and light color from your smart device (not included). The app is available on the App Store® and Google Play™.



We reserve the right to terminate digital applications after April 30, 2022



**scan for compatibility**



## MOUNTING INSTRUCTIONS



Be sure to check that the Lupalou™ unit is working. Fit the cord into the socket in the adapter and plug it in. The clock should immediately illuminate. Press the button on the remote. Music and light should start. Next, choose an outlet near where you plan to mount the Lupalou™ unit. The cord from the Lupalou™ unit should be at least three feet (about one meter) from your child's crib or bed.

# MOUNTING INSTRUCTIONS

Locate the Lumalou™ unit and cord wrap cleat templates on pages 23 and 25. Using scissors, cut on the dotted lines to remove from this manual.

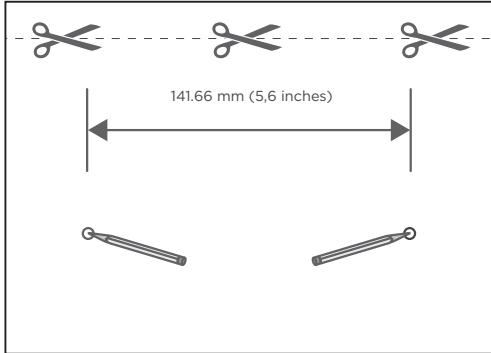

Lumalou™ Template

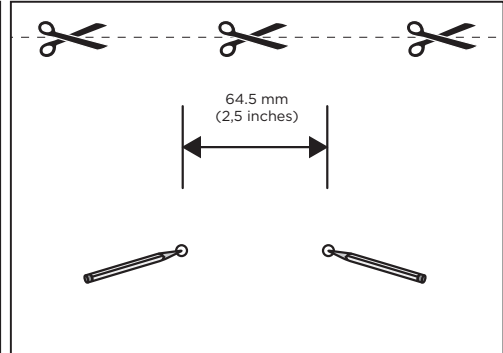

Cleat Cord Wrap Template

1

Tack the Lumalou™ template to your wall. Make sure it's straight. Using a pencil, make a mark through both circles.

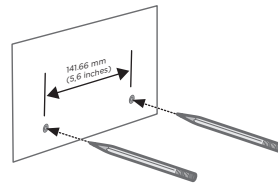

2

7

## MOUNTING INSTRUCTIONS

Check to be sure the holes are level.  
Place a level above both pencil marks. The bubble should be in the middle to indicate the pencil marks are level.

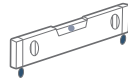

3

Using a  $\frac{3}{16}$ " (4,76 mm), drill bit, drill one hole through each pencil mark you made on the wall.

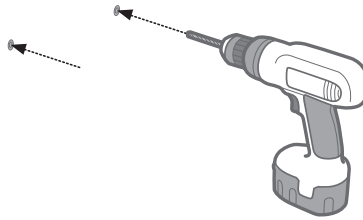

4

8



## MOUNTING INSTRUCTIONS

Fit a wall anchor into each of the drilled holes. Tap each wall anchor lightly with a hammer until the ends of each wall anchor are even with the surface of the wall.

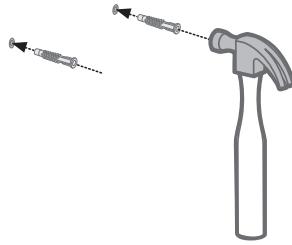

5

Insert a screw into each wall anchor and tighten with a Phillips screwdriver. Do not over-tighten.

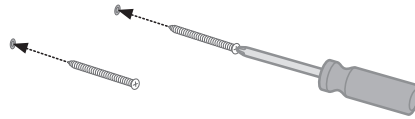

6

9

## MOUNTING INSTRUCTIONS

Attach the Lumalou™ unit to the screws. Gently slide the unit down to secure.

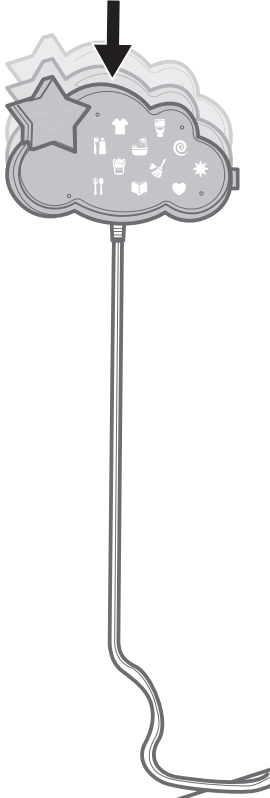

7

10

## MOUNTING INSTRUCTIONS

Tack the cord wrap cleat template to the wall so that it is centered below the Loumalou™ unit and as close to the floor as possible.

Using a pencil, make a mark through both circles.

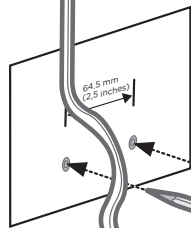

8

11

## MOUNTING INSTRUCTIONS

Check to be sure the holes are level.  
Place a level above both pencil marks.  
The bubble should be in the middle to indicate the pencil marks are level.



9

Using a  $\frac{3}{16}$ " (4,76 mm), drill bit, drill one hole through each pencil mark you made on the wall.



10

12

## MOUNTING INSTRUCTIONS

Place a wall anchor into each of the drilled holes. Tap each wall anchor lightly with hammer until the ends of each wall anchor are even with the surface of the wall.

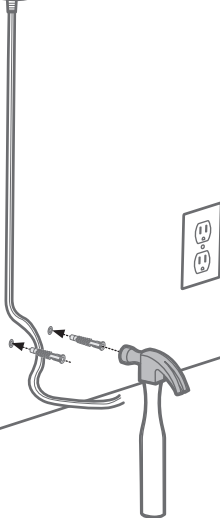

11

Align the holes on the cord wrap cleat with the wall anchors. Insert two screws into the holes in the cord wrap and tighten with a Phillips screwdriver. Do not over-tighten.

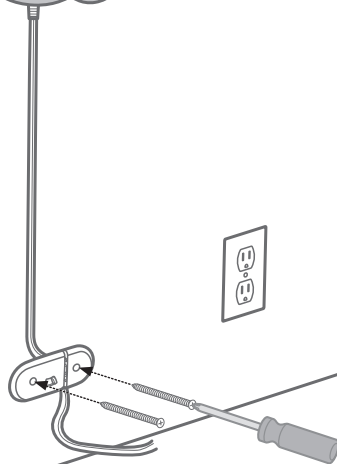

12

13

## MOUNTING INSTRUCTIONS

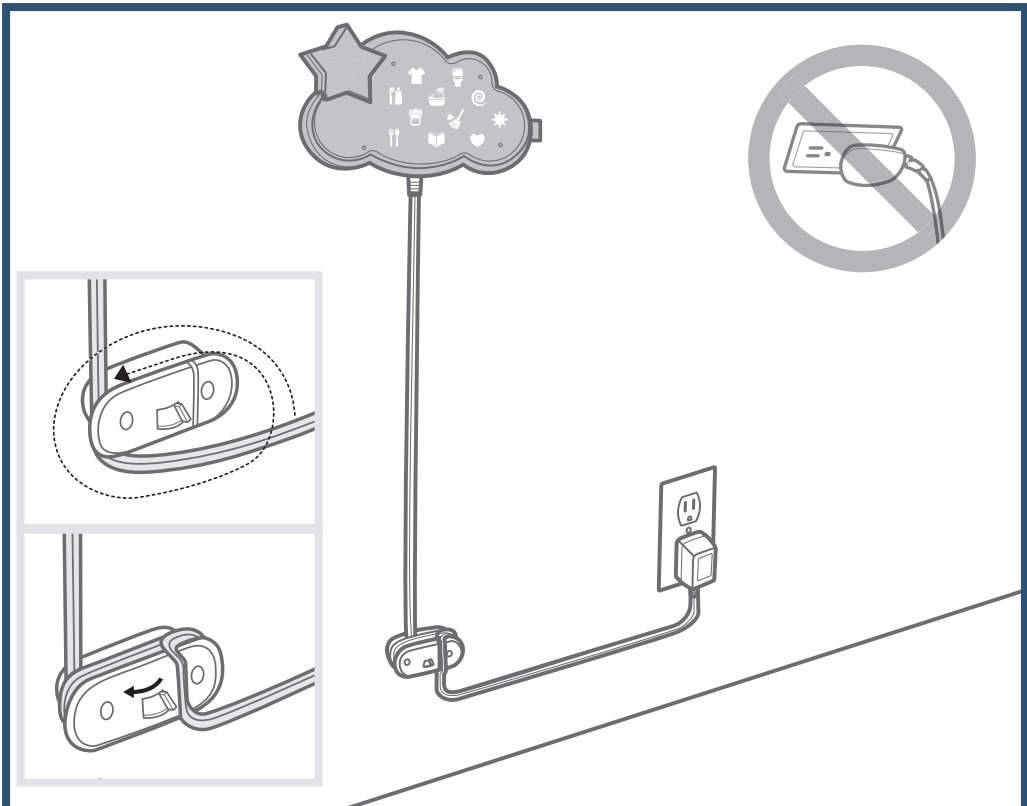

**IMPORTANT!** Make sure the cord is taught between the Lumalou™ unit and cord wrap cleat. Excess cord can form loops and present a strangulation hazard.

Extend the cord straight down the wall to the cord wrap.

Wrap the cord around the cord wrap, leaving just enough to reach the wall outlet. Make sure there is no slack.

Slide the lever on the front of the cord wrap and thread the cord through the groove in the front of the cord wrap. Make sure the cord is fully inserted in the groove.

Plug the cord into the AC adapter.

Plug the AC adapter into the wall outlet.

Use the AC adapter only in a wall outlet. Do not plug the adapter into a ceiling outlet.

If the Lumalou™ unit begins to operate erratically, you may need to reset the electronics. Unplug the AC adapter for approximately 10 seconds and plug it back in.

13

14

# PAIR THE LUMALOU™ UNIT TO YOUR DEVICE



Open the Fisher-Price® Smart Connect™ app on your device (not included) and touch the LumaLou™ icon on the Smart Connect™ dashboard. Be sure your device is within approximately 1,8 meters - 6 feet of the LumaLou™ unit to pair.

Press the pairing button on the LumaLou™ unit. Once paired, the clock on the LumaLou™ unit updates to the current time.

**?** If you cannot pair your device with the LumaLou™ unit, try moving the device closer to the unit.

# HOME SCREEN

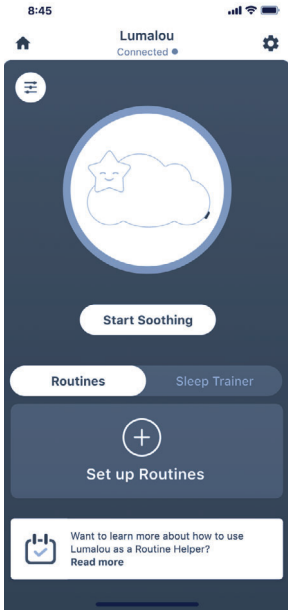

Customize settings like light colors and light brightness, song and sound choices, light and sound timers, volume, and to turn ON/OFF Ready, Settle, Sleep™ lights and sounds playlist.



Choose Routines or Sleep Trainer and then touch this button to setup a routine/sleep times for each day of the week.

There are eight tasks and three custom tasks (you assign them) to create a routine.



Change Clothes



Wash Up



Brush Teeth



Go Potty



Pack Bag



Custom Task 1



Eat



Custom Task 2



Read



Custom Task 3



Clean Up



## LET'S CREATE A ROUTINE

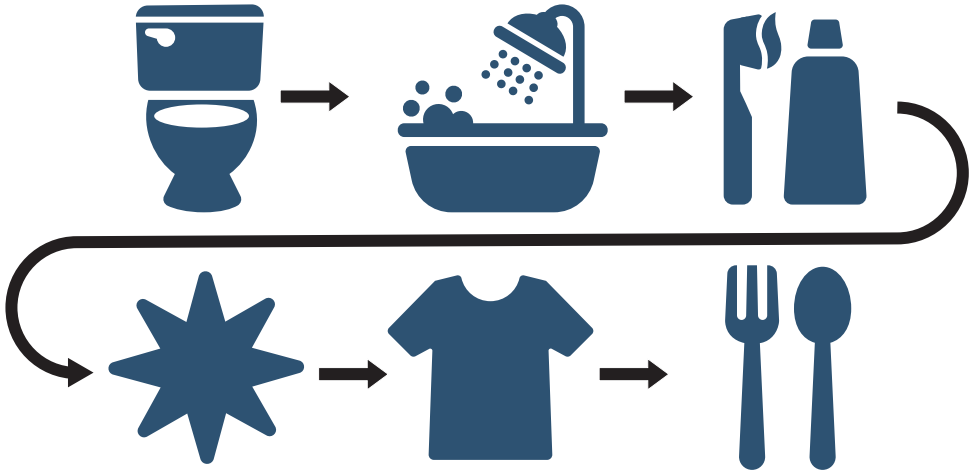

First assign a name to the routine. For example, you could name it "Morning". Next, create the routine by selecting tasks in the order you would like them completed.

Remember, you can create your own task. For example, you can assign "Brush Your Hair" to the asterisk icon. ✨.

| Days   |
|--|
| <input type="radio"/> Su <input type="radio"/> Mo <input type="radio"/> Tu <input type="radio"/> We <input type="radio"/> Th <input type="radio"/> Fr <input type="radio"/> Sa |
| Scheduled Time   |
| START ROUTINE AT   |
| Choose a time <span>▼</span>   |

Then, choose each day of the week this routine should be followed. Use the pull down menu to select a start time for the routine.

You can create multiple routines but only one routine can be saved per day.

# SLEEP TRAINING SCHEDULE

|                                   |    |    |    |    |    |    |
|-----------------------------------|----|----|----|----|----|----|
| <b>Su</b>                         | Mo | Tu | We | Th | Fr | Sa |
| <b>Sleep &amp; Wake Time</b>      |    |    |    |    |    |    |
| <b>Sleep From</b><br>SUNDAY NIGHT |    |    |    |    |    |    |
| 8:00 PM                           |    |    |    |    |    | ▼  |
| <b>Until</b><br>MONDAY MORNING    |    |    |    |    |    |    |
| 6:00 AM                           |    |    |    |    |    | ▼  |

Starting with Sunday, add a bedtime and a wake time for each day of the week by using the pull down menus to choose both times. You can also set up a nap time too!



Monday >

Touch to advance to the next day. Make sure you enter times for each day of the week!

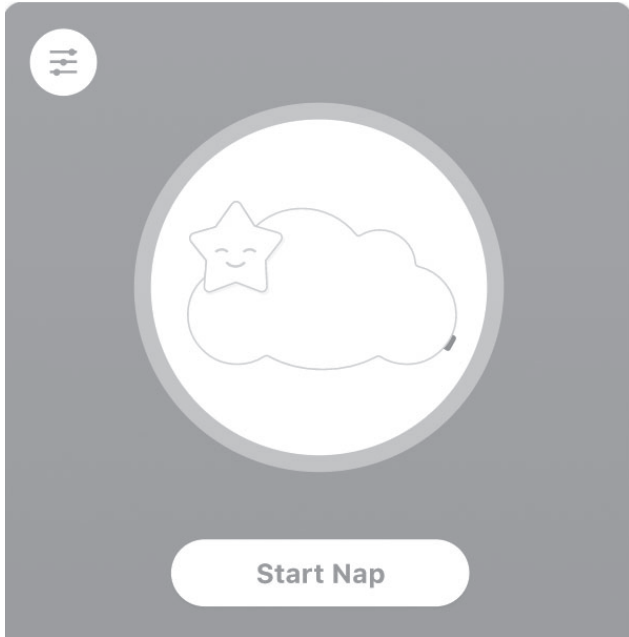
# NAP TIME



**Start Nap**

Touch to start nap time on your device or press the button  on the underside of the remote. The start button changes to a stop button if you'd like to stop the nap timer or press the same button  on the underside of the remote.

**Start Soothing**

Touch this button on the home screen to play your light and sound choices during a nap. Or press the top button on the remote.

## START A ROUTINE



When it's time to start a routine, all of the tasks will pulse until your child presses the button on the remote. Then, only the first task lights. You can end the routine at any time using the app or by pressing the button  on the underside of the remote.

## TASK COMPLETED



After completing a task, your child must press the button on the remote to move on to the next task. Complete all tasks in the routine for a fun reward.

## TIME TO GET UP



A press of the remote button lets your child know when it is time to sleep or time to wake up. Red star means it's time to sleep. Green star means it's time to wake up!



### Here's some help:

If the Lumalou™ unit is unplugged or the power in your home goes out, you will lose the current time. Without the current time, the routine and sleep trainer functions will be disabled until you re-connect the Lumalou™ unit to the app.

## REPLACE BATTERIES IN THE REMOTE

When replacing batteries, use **alkaline** batteries for longer battery life.

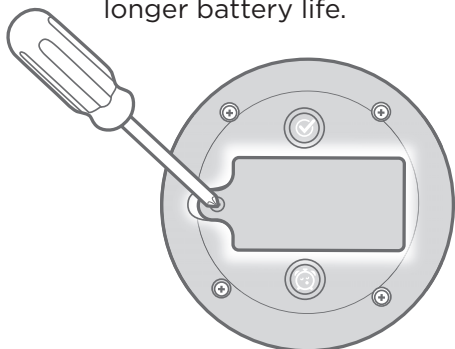

Loosen the screw in the battery compartment door and remove the door.

Remove the exhausted batteries and properly dispose.

Insert two AAA (LR03) **alkaline** batteries.

Replace the battery compartment door and tighten the screw.



### If the remote does not seem to work or works erratically:

- Check to see if the Lumalou™ unit power is on.
- Make sure there is a clear path between the Lumalou™ unit and the remote.
- Remove and reinstall the batteries.
- Check to see if the light on the remote turns on when you press the button. If it does not, it's time to replace the batteries!

### Battery Safety Information

In exceptional circumstances, batteries may leak fluids that can cause a chemical burn injury or ruin your product. To avoid battery leakage:

Do not mix old and new batteries or batteries of different types: alkaline, standard (carbon-zinc) or rechargeable.

Insert batteries as indicated inside the battery compartment (+ and -).

Remove batteries during long periods of non-use. Always remove exhausted batteries from the product. Dispose of batteries safely. Do not dispose of this product in a fire. The batteries inside may explode or leak.

Never short-circuit the battery terminals.

Use only batteries of the same or equivalent type, as recommended.

Do not charge non-rechargeable batteries.

Remove rechargeable batteries from the product before charging.

If removable, rechargeable batteries are used, they are only to be charged under adult supervision.



Protect the environment by not disposing of this product or any batteries with household waste. This symbol indicates that this product shall not be treated as household waste. Check your local authority for recycling advice and facilities.









64.5 mm  
(2,5 inches)





## GENERAL INFORMATION

Always use this product where there is adequate ventilation. To prevent overheating, keep the product away from heat sources such as radiators, heat registers, direct sunlight, stoves, amplifiers, or other appliances which produce heat.

Never use extension cords with the AC adapter.

Never use the product near water (ie.: bathtub, sink, laundry tub or wet basement, etc.).

Do not connect to more than the recommended number of power supplies.

The Lumalou™ unit must only be used with the recommended AC adapter.

Disconnect the AC adapter from the plug before cleaning.

**Adults Note:** If you use this product with the AC adapter, periodically examine the AC adapter for damage to the cord, housing or other parts that may result in the risk of fire, electric shock or injury. If the AC adapter is damaged, do not use the product with the AC adapter.

---

### FCC STATEMENT (UNITED STATES ONLY)

This equipment has been tested and found to comply with the limits for a Class B digital device, pursuant to Part 15 of the FCC rules. These limits are designed to provide reasonable protection against harmful interference in a residential installation. This equipment generates uses and can radiate radio frequency energy and, if not installed and used in accordance with the instructions, may cause harmful interference to radio communications. However, there is no guarantee that interference will not occur in a particular installation. If this equipment does cause harmful interference to radio or television reception, which can be determined by turning the equipment off and on, the user is encouraged to try to correct the interference by one or more of the following measures:

- Reorient or relocate the receiving antenna.
- Increase the separation between the equipment and receiver.
- Consult the dealer or an experienced radio/TV technician for help.

NOTE: Changes or modifications not expressly approved by the manufacturer responsible for compliance could void the user's authority to operate the equipment.

This device complies with Part 15 of the FCC Rules. Operation is subject to the following two conditions: (1) This device may not cause harmful interference, and (2) this device must accept any interference received, including interference that may cause undesired operation.

---

This device contains licence-exempt transmitter(s)/receiver(s) that comply with Innovation, Science and Economic Development Canada's licence-exempt RSS(s). Operation is subject to the following two conditions: (1) This device may not cause interference. (2) This device must accept any interference, including interference that may cause undesired operation of the device.

L'émetteur/récepteur exempt de licence contenu dans le présent appareil est conforme aux CNR d'Innovation, Sciences et Développement économique Canada applicables aux appareils radio exempts de licence. L'exploitation est autorisée aux deux conditions suivantes : (1) L'appareil ne doit pas produire de brouillage; (2) L'appareil doit accepter tout brouillage radioélectrique subi, même si le brouillage est susceptible d'en compromettre le fonctionnement.



**UNITED STATES**

Fisher-Price, Inc., 636 Girard Avenue, East Aurora, NY 14052.  
Consumer Services: 1-800-432-5437.

**CANADA**

Mattel Canada Inc., 6155 Freemont Blvd., Mississauga,  
Ontario L5R 3W2 Consumer Services/Service à la clientèle :  
1-800-432-5437. www.service.mattel.com.

**GREAT BRITAIN**

Mattel U.K. Limited, The Porter Building, 1 Brunel Way, Slough SL1 1FQ, UK.  
www.service.mattel.com/uk.

**NEDERLAND**

Mattel Europa B.V., Gondel 1, 1186 MJ Amstelveen, Nederland.

**AUSTRALIA**

Mattel Australia Pty. Ltd., 658 Church Street, Locked Bag #870, Richmond, Victoria  
3121 Australia. Consumer Advisory Service 1300 135 312.

**NEW ZEALAND**

16-18 William Pickering Drive, Albany 1331, Auckland.

**SOUTH AFRICA**

Mattel South Africa (PTY) LTD, Office 102 I3, 30 Melrose Boulevard,  
Johannesburg 2196.

Apple, & the Apple logo are trademarks of Apple Inc., registered in  
the U.S. and other countries. App Store is a service mark of Apple Inc.,  
registered in the U.S. and other countries.

Google Play and the Google Play logo are trademarks of Google LLC.



©2020 Mattel.  
PRINTED IN CHINA  
GLD09-0970-1102345604-DOM

**Remark:**

| Revision     | Date       | ID#                       | Changes |
|--------------|------------|---------------------------|---------|
| Primary - pr | 07/31/2020 | GLD09-0970-1102345604-DOM | NA      |
|              |            |                           |         |
|              |            |                           |         |
|              |            |                           |         |