

TREK



2022 CHECKPOINT SL/SLR

SERVICE MANUAL SUPPLEMENT

Contents



[Safety](#)

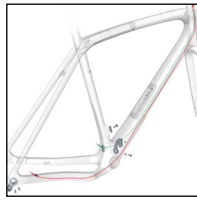

[Brake/shift routing – mechanical](#)

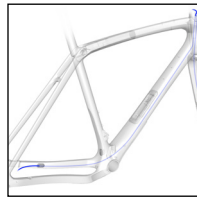

[Brake routing – eTap](#)

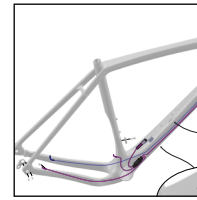

[Brake/shift routing – Di2](#)

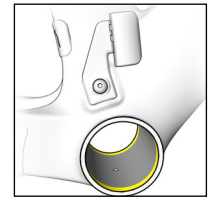

[T47 bottom bracket](#)

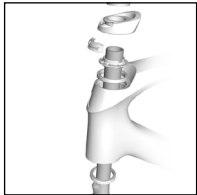

[Headset and fork](#)



[IsoSpeed – SL](#)

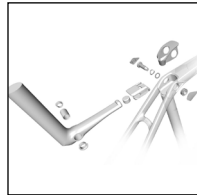

[IsoSpeed – SLR](#)



[Storage door](#)



[Frame guards](#)

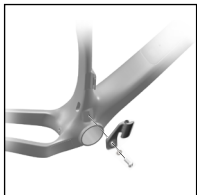

[Chainkeeper](#)

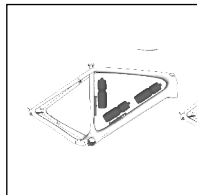

[Accessories – SL](#)

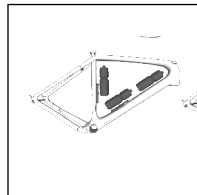

[Accessories – SLR](#)

	SL
Rear hub OD	142mm
Rear axle OD	127mm
Rear post clamp ID	25.5mm
Upper link outer tube OD	28.5mm
Lower link outer tube OD	28.5mm
Rear link OD, top/bottom	45mm/45.5mm
BB max width	74.2-85.5mm
Front axle outer clamp ID	24.5mm
Chainline (SL)	43.5mm (SRAM) 43.7mm (SRM)
Chainline (SLR)	43.5mm
Chainring max (SL)	44.1 (SRAM), 52.8 (SRM)
Chainring max (SLR)	44.1
File width max	50mm
Fronter mount – rear	110mm
Fronter mount – front	110mm
Peak mount	110mm

[Specifications](#)

Safety

WARNING

Properly tighten hardware

Always tighten hardware to the specified torque. Over-tightening hardware could deform or break the hardware or components. Under-tightening hardware could cause hardware or components to become loose. Either situation could damage the bicycle and result in injury to the rider.

WARNING

Reapply threadlocker

All reused-fasteners with pre-applied threadlocker must be cleaned with isopropyl alcohol and have new threadlocker applied before re-assembly. If threadlocker is not applied, the fasteners may loosen which could damage the bicycle and result in injury to the rider.

Legend



Apply grease



Do not apply grease



Apply threadlocker



Torque



Zip tie

Brake/shift routing — mechanical

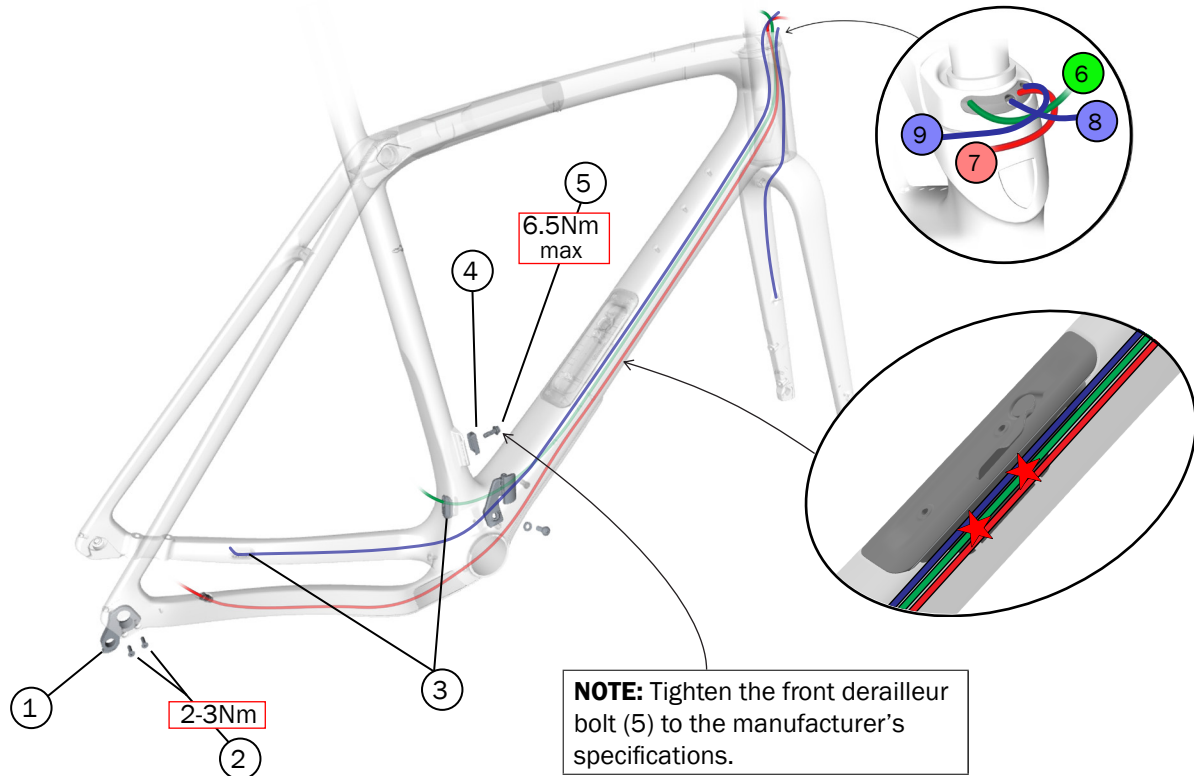

NOTE: Tighten the front derailleur bolt (5) to the manufacturer's specifications.

- ① Rear derailleur hanger — W524188
- ② Rear derailleur hanger bolts — W524884
- ③ Housing grommets — W330578
- ④ Front derailleur washer — W531901
- ⑤ Front derailleur bolt — W543903
- ⑥ Front derailleur cable
- ⑦ Rear derailleur cable
- ⑧ Front brake hose
- ⑨ Rear brake hose
- ⑩ Dropper post cable

Route the brake hoses

1. Connect the calipers to the brake hoses.
2. Route the rear brake hose through the grommet (3). Route both brake hoses as shown.



3. Attach the calipers to the chainstay and fork. Do not fully torque the mounting bolts until the calipers are aligned correctly.



Brake/shift routing — mechanical (continued)

Route the shift cables

1. Mark the rear shift cable with a marker. You will need to tell the cables apart when you assemble the headset.
2. Route the front derailleur shift cable through the grommet (3). Route both shift cables through the frame as shown.

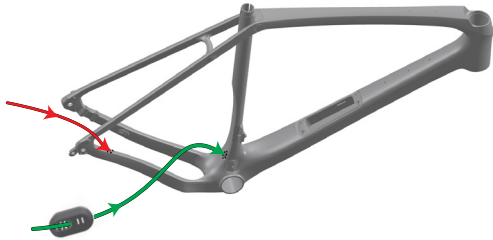

3. Attach the derailleurs to the bicycle.
4. Connect the shift cables to the derailleurs.
5. Zip tie the shift cables and rear brake hose to the outside of the storage door frame.

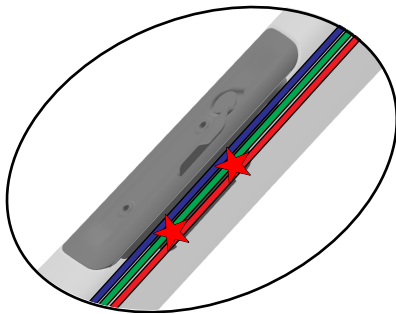

Dropper post cable routing (SL only)

Cut out a hole in the outer dimple on the back of the routing cap grommet. Route the dropper post cable to the handlebars as shown below.

NOTE: A dropper post is not compatible with the SLR model due to the seat mast system.

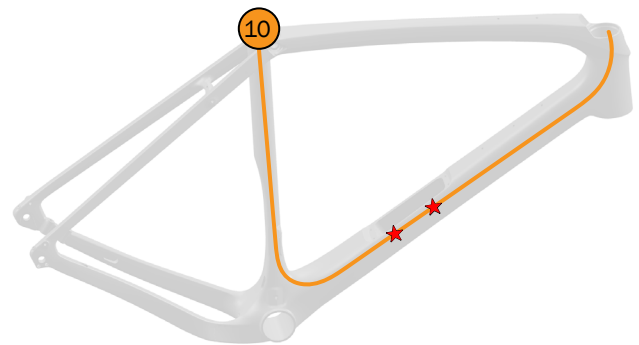
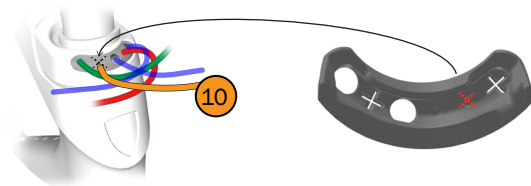

Brake routing — eTap

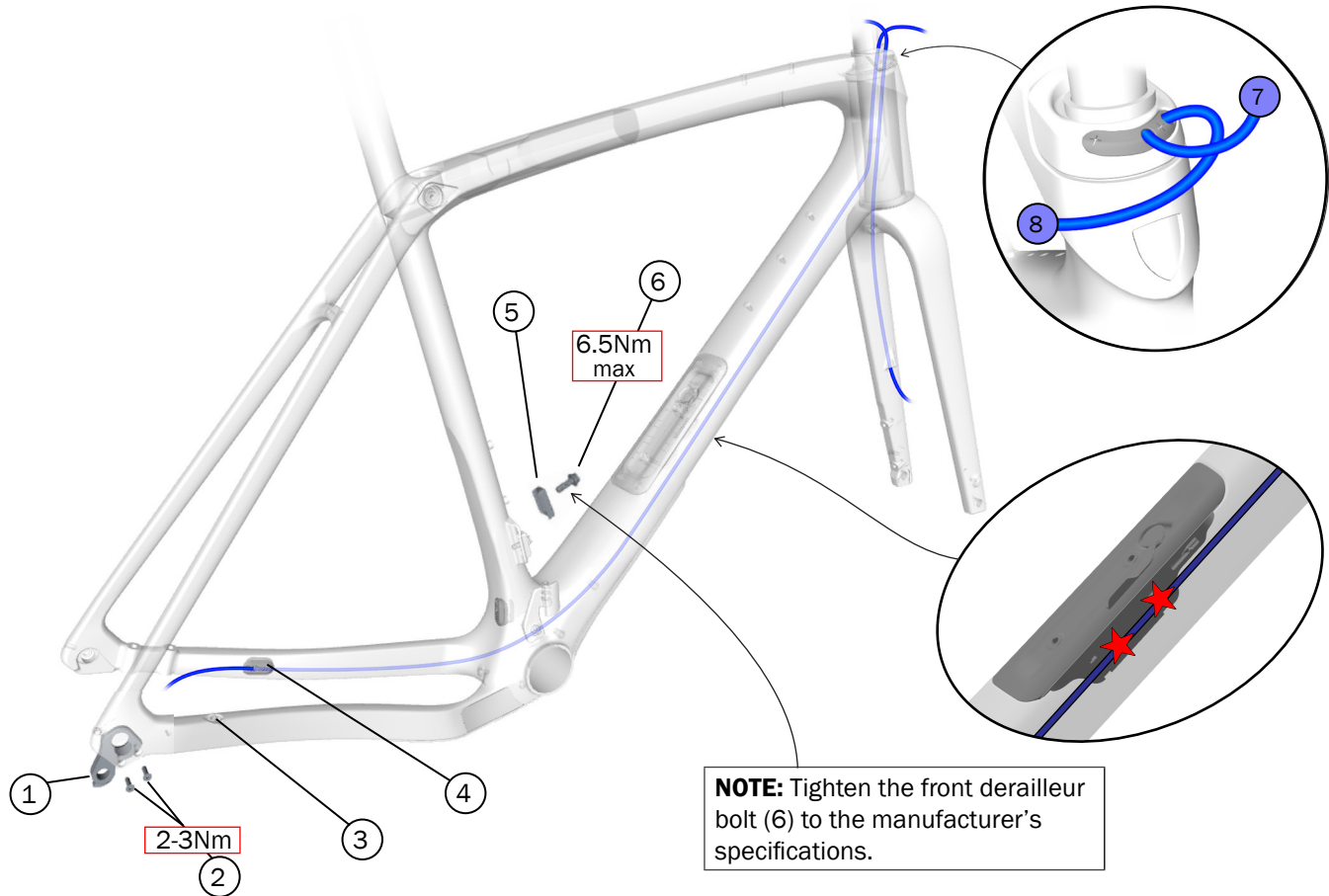

- ① Rear derailleur hanger — W524188
- ② Rear derailleur hanger bolts — W524884
- ③ Plug — W330578
- ④ Housing grommet — W330578
- ⑤ Front derailleur washer — W531901
- ⑥ Front derailleur bolt — W543903
- ⑦ Front brake hose
- ⑧ Rear brake hose
- ⑨ Dropper post cable

Route the brake hoses

1. Connect the calipers to the brake hoses.
2. Route the rear brake hose through the grommet (4). Route both brake hoses as shown.



3. Attach the calipers to the chainstay and fork. Do not fully torque the mounting bolts until the calipers are aligned correctly.
4. Zip tie the rear brake hose to the outside of the storage door frame.

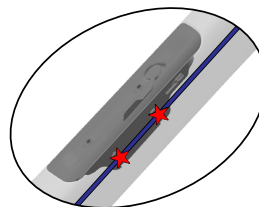

Brake routing — eTap (continued)

Dropper post cable routing (SL only)

NOTE: A dropper post is not compatible with the SLR model due to the seat mast system.

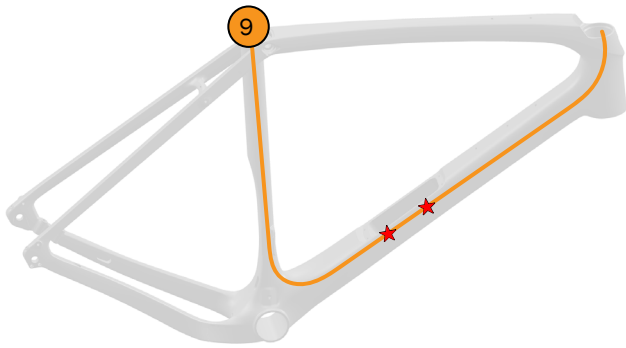
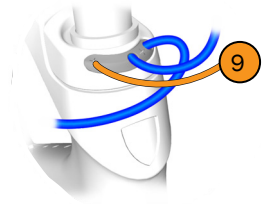

Brake/shift routing — Di2

NOTE: Tighten the front derailleur bolt (6) to the manufacturer's specifications.

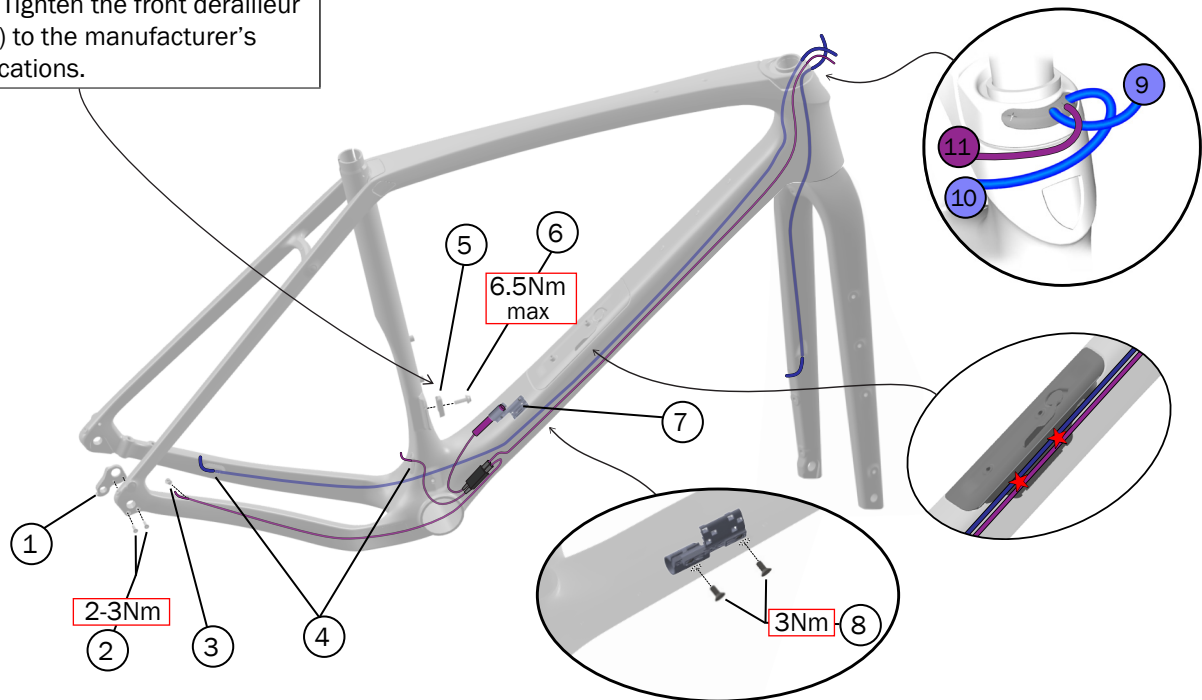

- ① Rear derailleur hanger — W524188
- ② Rear derailleur hanger bolts — W524884
- ③ Di2 exit grommet — 600208
- ④ Housing grommets — W330578
- ⑤ Front derailleur washer — W531901
- ⑥ Front derailleur bolt — W543903
- ⑦ Battery holder and cable guide — 588188
- ⑧ Screws (M4x9mm) — 588188
- ⑨ Front brake hose
- ⑩ Rear brake hose
- ⑪ Di2 wires

Route the brake hoses

1. Connect the calipers to the brake hoses.
2. Route the rear brake hose through the grommet (3). Route both brake hoses as shown.



3. Attach the calipers to the chainstay and fork. Do not fully torque the mounting bolts until the calipers are aligned correctly.



Brake/shift routing — Di2 (continued)

Di2 wiring diagram

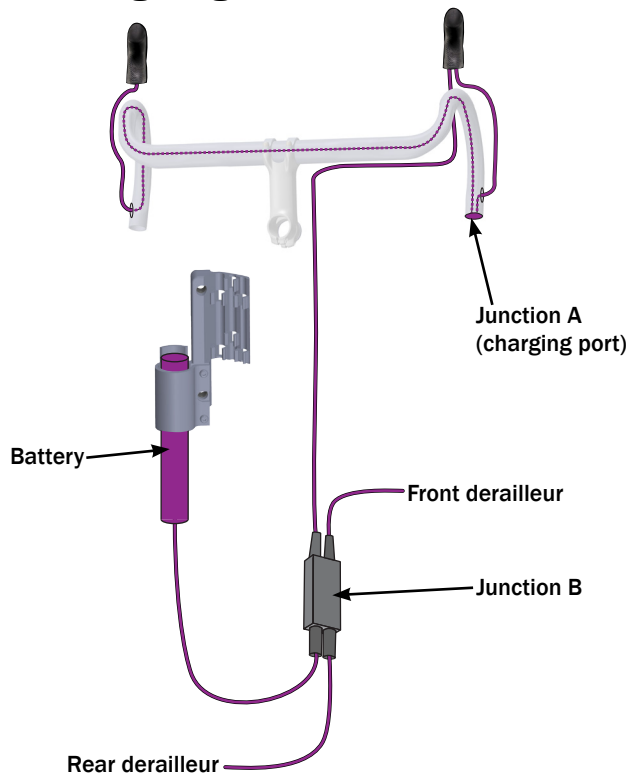

T47 bottom bracket

Install the bottom bracket

1. Apply grease to the threads on both sides of the frame.

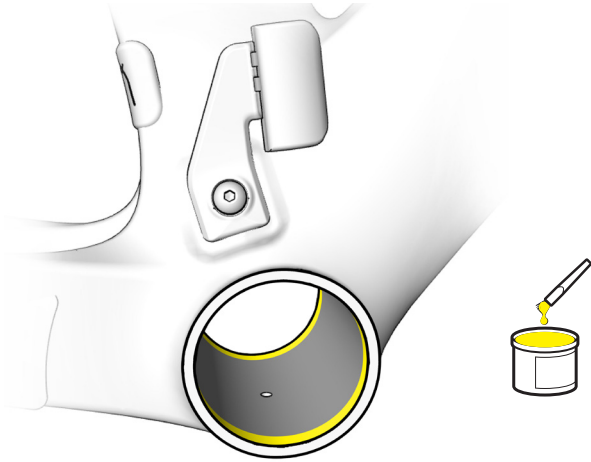

2. Using your hands, thread the bottom bracket onto the frame.

NOTICE: Do not start tightening the bottom bracket with a tool. Dirt and other contaminants can damage the threading.

3. Use the proper tool to torque both sides to specification (see the [Tool and spline compatibility](#) table below).
4. If necessary, add spacers before installing the cranks (see the [Spacers required](#) table at the top right).

Tool and spline compatibility

		Tool Model Part number	Praxis		Unior	Park Tool	Wheels Mfg	CeramicSpeed
			TP-2400 594148	TP-3028 594147	1671.T47 1043614	BBT-47 568922	BBTOOL-48-44 589307	—
Bottom bracket manufacturer	Praxis	24mm	X		X			
		30mm		X	X			
	Wheels MFG						X	
	SRAM DUB				X	X		
	Chris King				X	X		
	Ceramic-Speed	24mm			X	X		X
		GXP						X

Spacers required

The table below contains bottom bracket/crank combinations that require spacers. Your bicycle may have other combinations that do not require spacers.

Crank	Bottom bracket	Spacers required		
		Drive side	Non-drive side	
Shimano	CeramicSpeed 24mm	0.5mm	0.5mm	
SRAM	DUB	SRAM DUB	2-3mm	—
	GXP	Wheels MFG	1.0mm	—

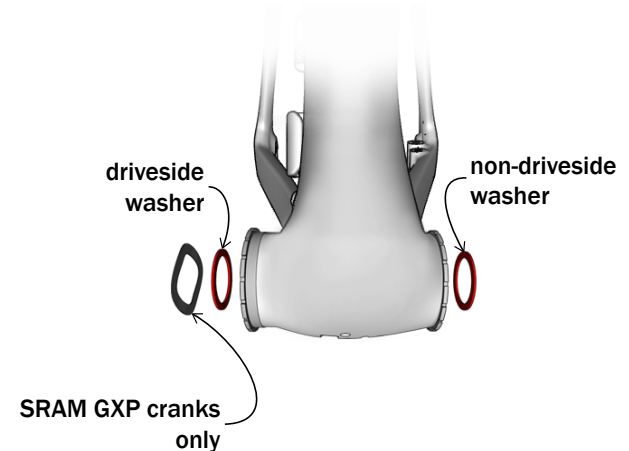

Headset and fork

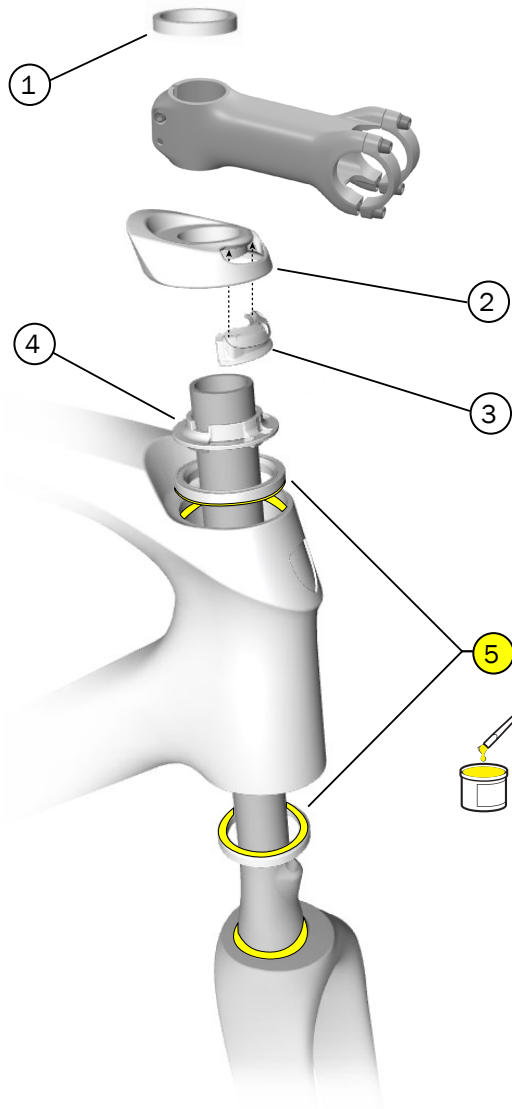

- ① Spacer (5mm) – 5253930
- ② Frame routing cap – W5253579
- ③ Frame routing cap grommet – W5253580
- ④ Headset split ring – W5266050
- ⑤ Headset bearings – W540243
- ⑥ Front derailleur cable
- ⑦ Rear derailleur cable
- ⑧ Front brake hose
- ⑨ Rear brake hose

Install the headset

1. Clean the steerer tube using isopropyl alcohol.
2. Grease both bearings (5), the fork crown race, and the inside of the head tube as shown to the left.
3. Insert the fork into the head tube.
TIP: Support the fork with a table during the assembly.
4. Route the shift cables and brake hoses through the split ring (4) as shown below (see pages 2-7 for different routing examples).

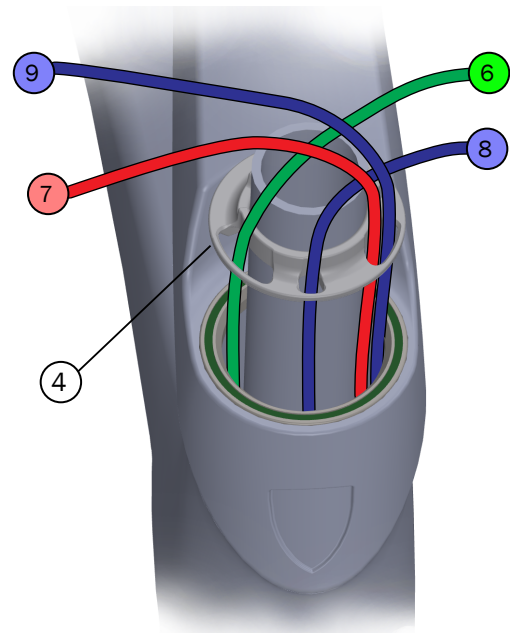

Mechanical routing example

5. Complete the headset assembly as shown to the left.

NOTE: If cutting the steerer tube, cut 2mm above the stem. Make sure the stem is in its final position with the required spacers underneath. The 2mm of clearance is required to hold the 5mm spacer (1) above the stem in place.

IsoSpeed – SL

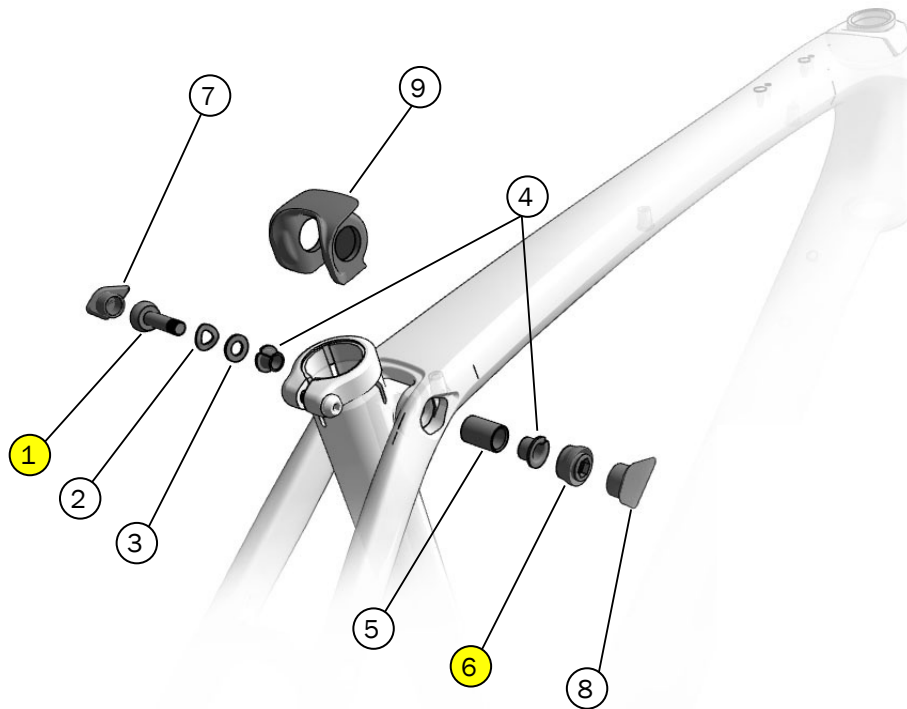

- ① Bolt
 - ② Wave washer
 - ③ Washer
 - ④ Flanged bushing
 - ⑤ Cylindrical bushing
 - ⑥ Nut
- } kit W569265
- ⑦ Cap, non-driveside (as shown) – 5253577
 - ⑧ Cap, driveside (as shown) – 5253576
 - ⑨ Grommet – W5253578

Install the IsoSpeed

1. Carefully remove the IsoSpeed covers (7, 8) with a paint-safe plastic pry bar.
2. Remove the bolt (1), nut (6), and washers.
3. Use a 50/50 isopropyl alcohol/water mix to clean the nut threads (6), bolt threads (1), and the inside of the bushings (4, 5).
4. Apply threadlocker to the nut threads.

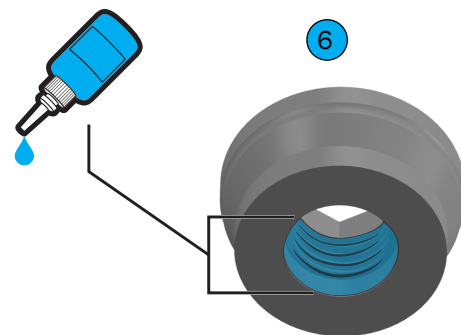

IsoSpeed – SL (continued)

5. Apply grease to the bolt and nut as shown below.

NOTICE: Do not apply grease to the threads.

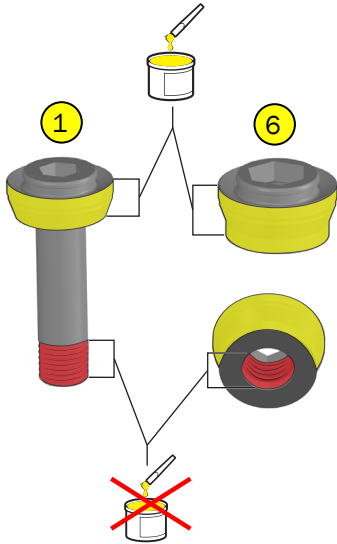

6. Place the washers on the bolt. Tighten the nut to 10Nm while securing the bolt with a wrench as shown below.

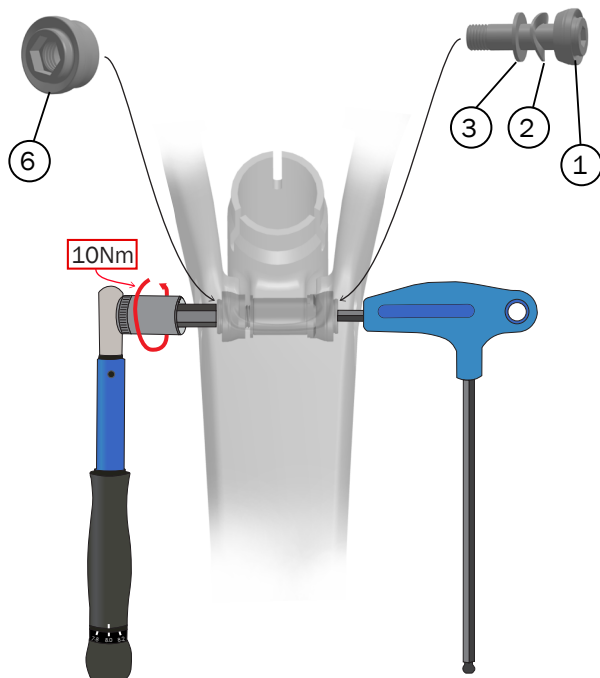

7. Re-install the IsoSpeed covers.
8. Allow the assembly to cure for 24 hours at room temperature (72°F/22°C).

IsoSpeed — SLR

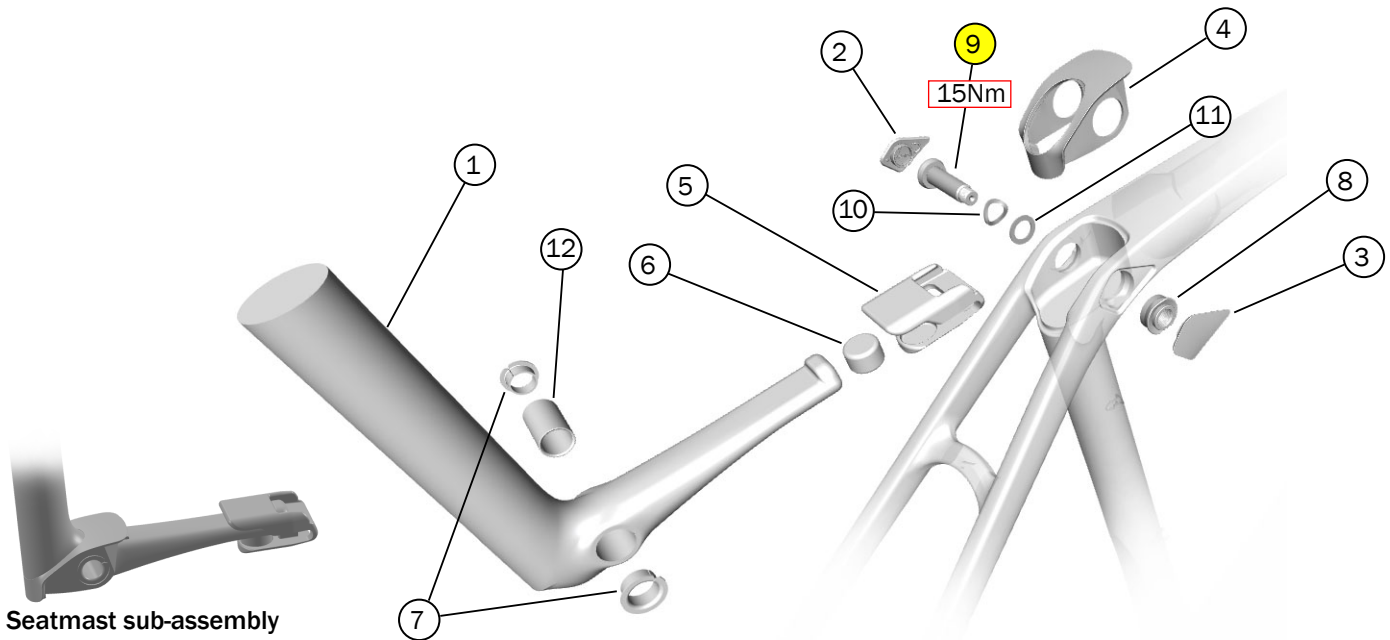

- ① Seatmast
 - ② Side cover, non-driveside (as shown) — 5256900
 - ③ Side cover, driveside (as shown) — 5256899
 - ④ Grommet — W5256901
 - ⑤ Clip — 5256904
 - ⑥ Bumper — 5256904
 - ⑦ Flanged bushings — 5256074
 - ⑧ Nut
 - ⑨ Bolt
 - ⑩ Wave washer
 - ⑪ Flat washer
 - ⑫ Cylindrical bushing
- kit 5271110

Install the IsoSpeed

1. Carefully remove the IsoSpeed covers (2, 3) with a paint-safe plastic pry bar.
2. Remove the bolt (9), nut (8), and washers.
3. Use a 50/50 isopropyl alcohol/water mix to clean the nut threads (8), bolt threads (9), and the inside of the bushings (7, 12).
4. Apply threadlocker to the nut threads.

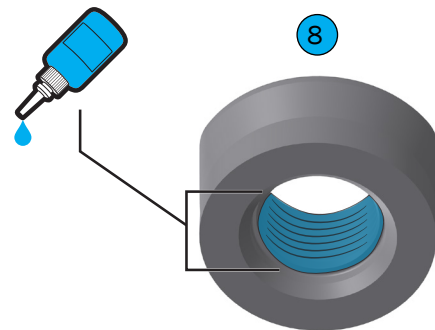

IsoSpeed – SLR (continued)

5. Apply grease to the bolt (9) as shown below.

NOTICE: Do not apply grease to the threads.

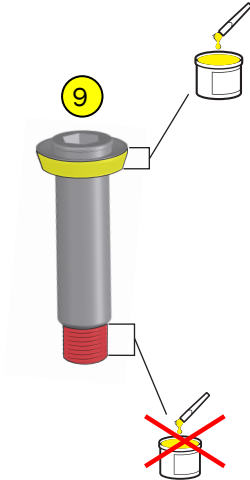

6. Install the hardware as shown on page 12. Torque the bolt (9) to 15Nm.

NOTE: On some early production models, the bolt may have “8Nm” incorrectly etched into the head. Disregard this etching.

8. Re-install the IsoSpeed covers.
9. Allow the assembly to cure for 24 hours at room temperature (72°F/22°C).

Storage door

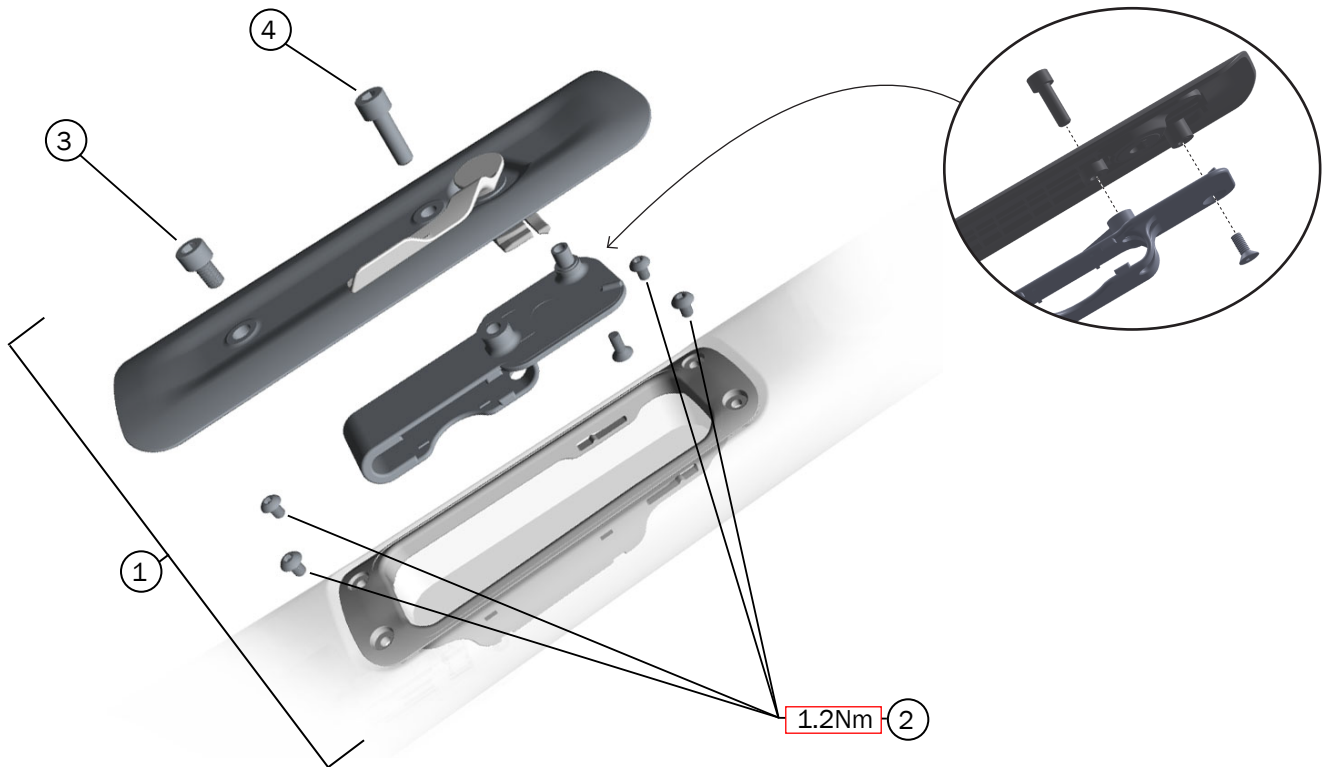

- ① Storage door kit – 5256900
- ② Mount screws
- ③ Bolt (M5x8mm) – 596823
- ④ Bolt (M5x16mm) – 596821

Frame guards

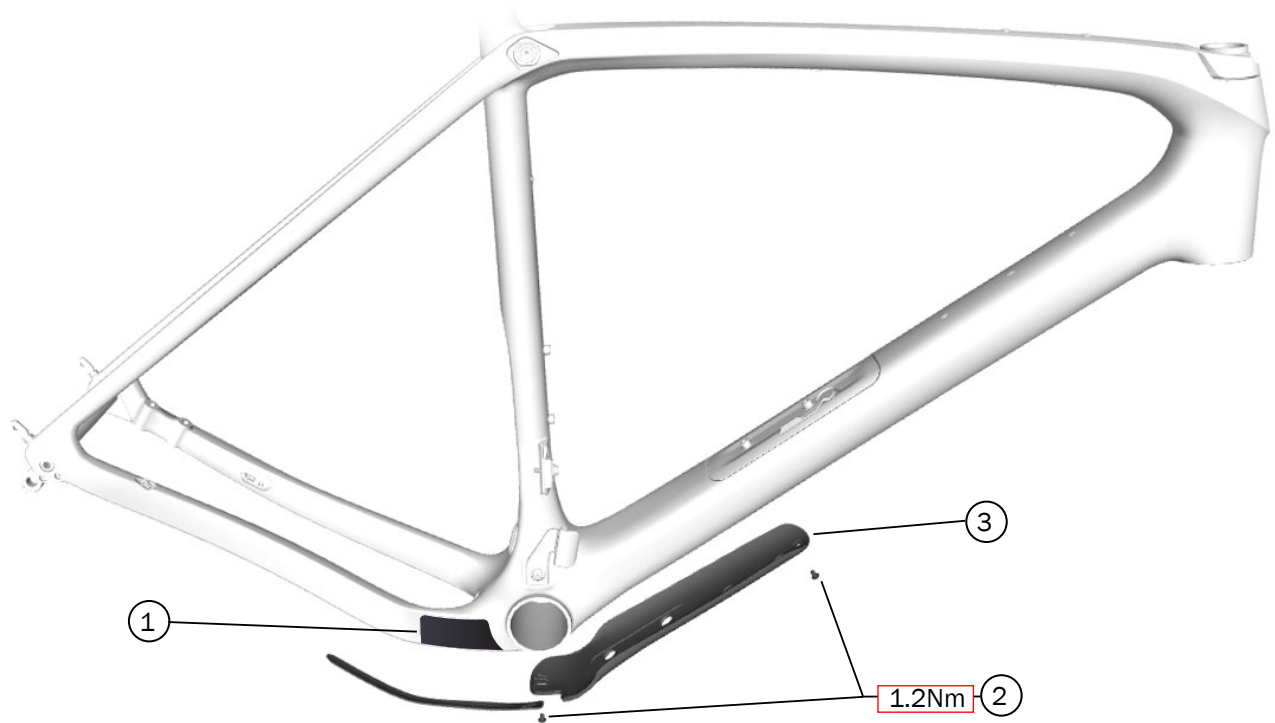

- ① Chainstay frame guard – W5253575
- ② Button head screws – 1042535
- ③ Down tube guard – 5253574

Chainkeeper

Adjust the chainkeeper

1. Shift to the lowest gear (largest rear cassette cog) and inner chainring.
2. Loosen the top screw on the chainkeeper.
3. Rotate the loose piece so there is 1mm of horizontal clearance to the chain.
4. Tighten the top screw.

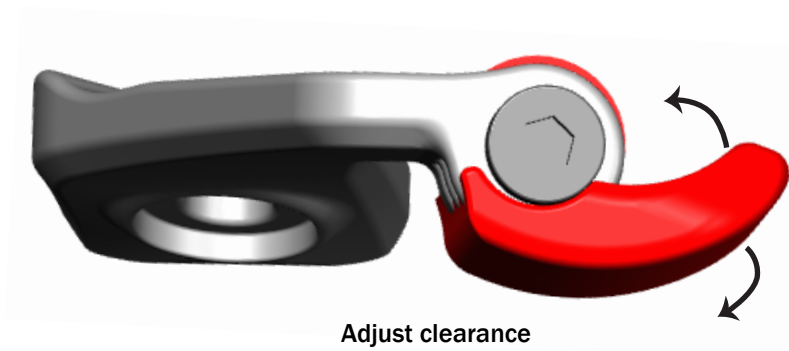
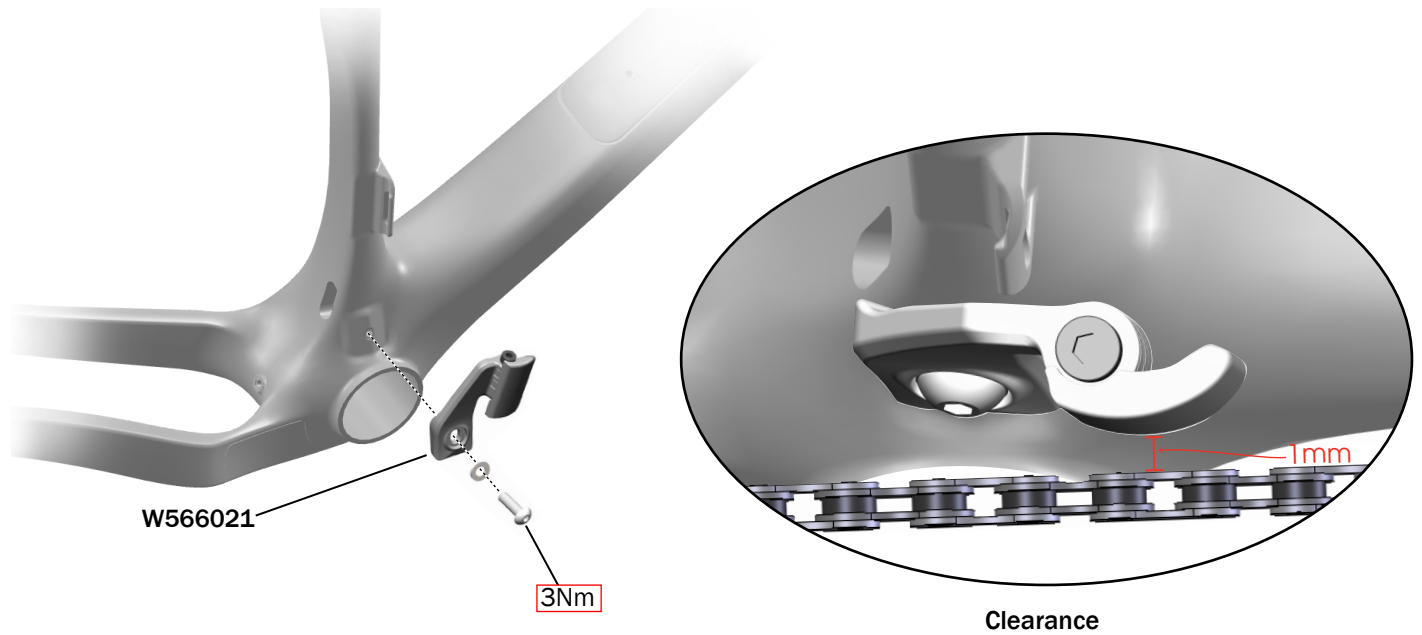

Accessories — SL

Water bottle cage adapters

For frames 54cm or larger, you can fit three water bottle cages in the frame triangle using the adapters.

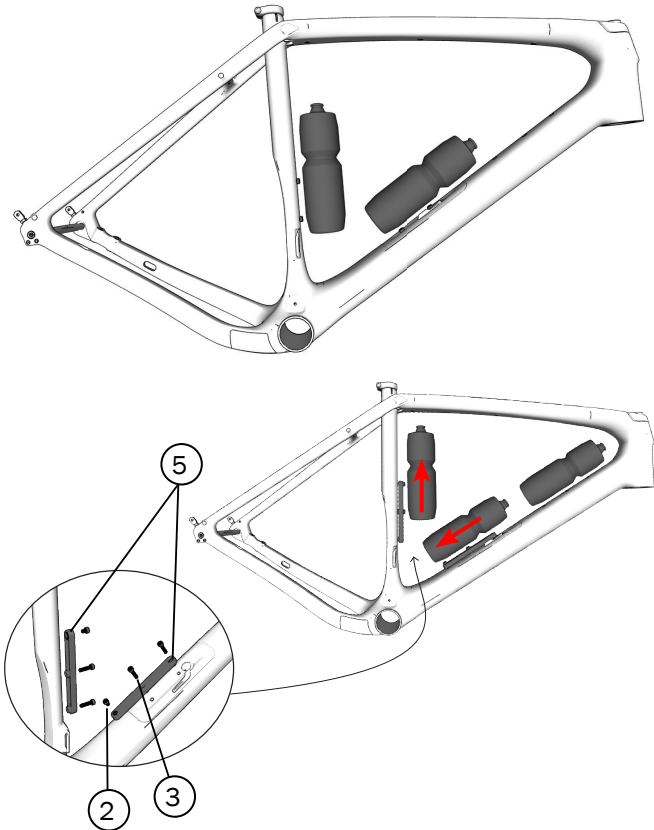

- ① Fender mount bolts — 317700
- ② Bolt (M5x8mm) — 596823
- ③ Bolt (M5x16mm) — 596821
- ④ Frame bag
- ⑤ Water bottle cage adapters — W5271627

Mounting inserts

All mounting inserts are M5x0.8.

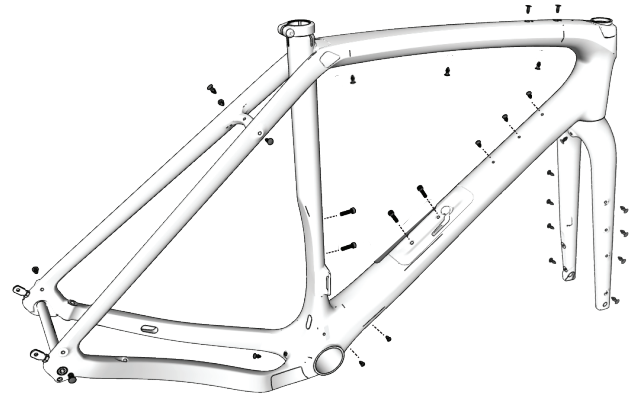

Rack, fenders, and frame bag

NOTE: Use only steel fasteners to attach racks, bags, and fenders. Do not use aluminum fasteners as they are not rated for these loads.

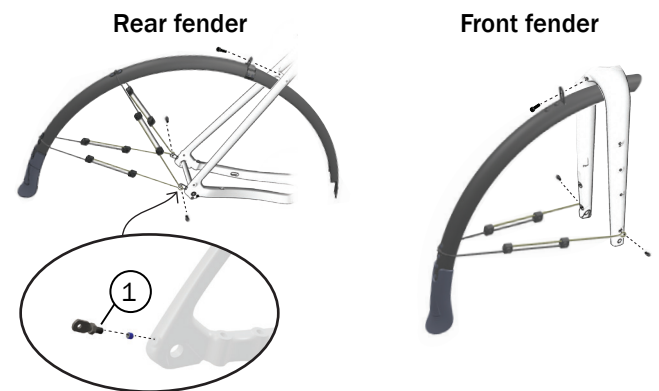
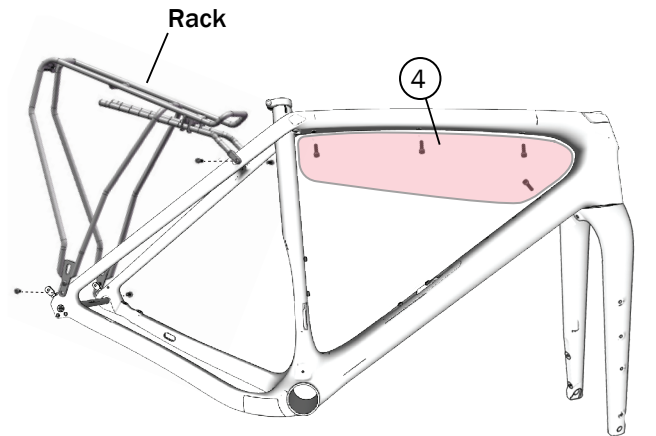

Accessories — SLR

Water bottle cage adapters

For frames 54cm or larger, you can fit three water bottle cages in the frame triangle using the adapters.

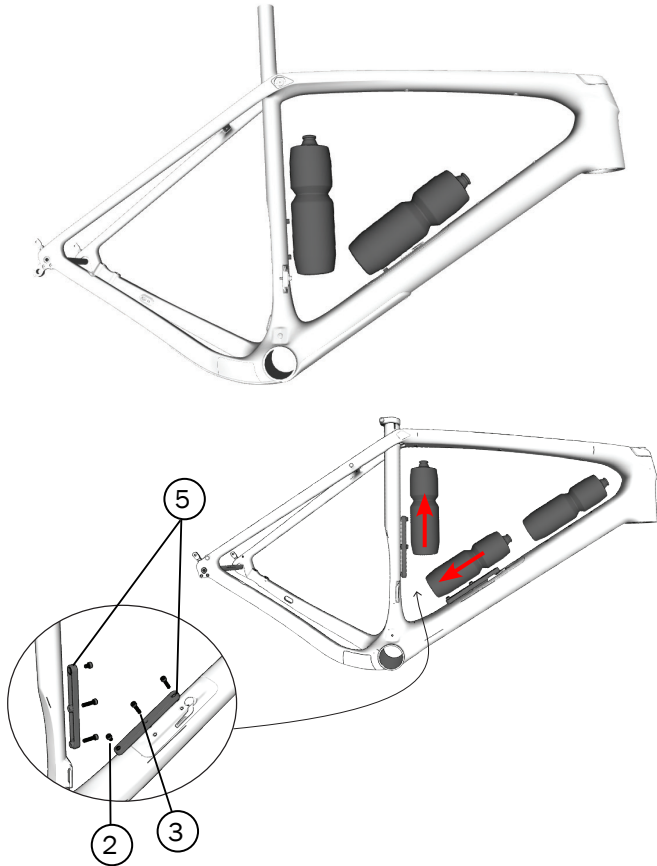

- ① Fender mount bolts — 317700
- ② Bolt (M5x8mm) — 596823
- ③ Bolt (M5x16mm) — 596821
- ④ Frame bag
- ⑤ Water bottle cage adapters — W5271627

Mounting inserts

All mounting inserts are M5x0.8.

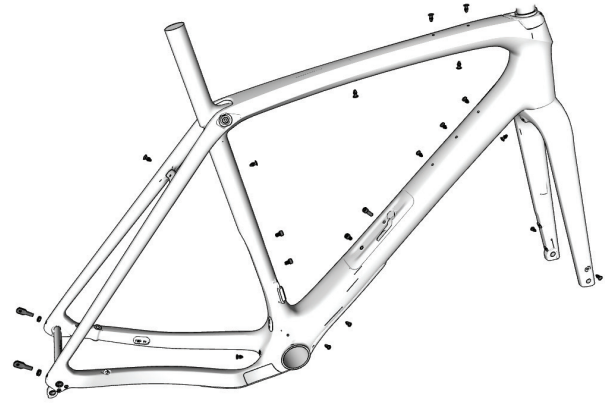

Fenders and frame bag

NOTE: Use only steel fasteners to attach fenders and bags. Do not use aluminum fasteners as they are not rated for these loads.

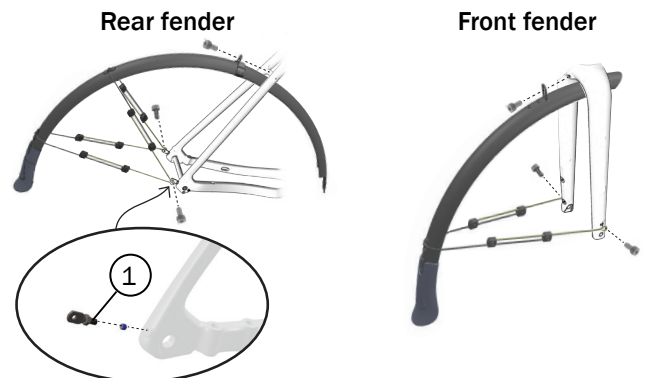
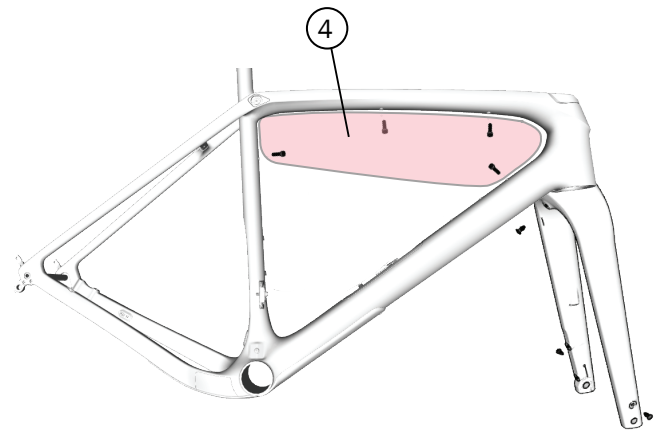

Specifications

	SL	SLR
Rear hub OLD	142mm	142mm
Seat post OD	27.2mm	
Seat post clamp ID	31.9mm	
Seatmast ID		30mm
Upper fork steerer tube OD	28.6mm	28.6mm
Lower fork steerer tube OD	38.1mm	38.1mm
Bottom bracket type/width	T47/85.5mm	T47/85.5mm
Brake rotor diameter min/max	140/160mm	140/160mm
Chainline (1x)	45mm (SRAM)	45mm (SRAM)
Chainline (2x)	45mm (SRAM)	45mm (SRAM)
	43.5 (Shimano)	43.5 (Shimano)
Chainring max (1x)	46t (SRAM)	46t (SRAM)
Chainring max (2x)	Small	37t
	Large	50t
Tire width max 700c (without fenders)	45mm (1.8")	45mm (1.8")
Tire width max 650b (without fenders)	53.5mm (2.1")	53.5mm (2.1")
Fender compatible – rear	Yes	Yes
Fender compatible – front	Yes	Yes
Rack mount compatible	Yes	No
Dropper post compatible	Yes	No

Headset bearing dimensions (W540243)

