



BUILDING STRENGTH™

**BAR SUPPORT
HANDBOOK**

**CONCRETE
CONSTRUCTION
PRODUCTS**





		Page Number								
			Slab	Slab On Grade	Walls and Above Grade	Tilt Wall	Foundation, Below Grade	Precast	DOT, Bridge	
METAL SUPPORTS	Individual	Joist Chair - JC	4	•					•	
		Bar Chair - BC	4	•					•	
		Bar Chair with Plate - BCP	4	•	•					
		Foundation Chair - FC	5	•	•					
		Speed Chair - SC	5	•	•					
		Individual High Chair - HC	6	•			•		•	•
		Aztec Sand Plate - R28	7	•	•					•
		Individual High Chair with Plates - HCP	7	•	•					•
		High Chairs for Metal Decking - HCM	8	•						•
	Continuous	Slab Bolster - SB	8	•		•	•		•	•
		Slab Bolster Upper - SBU	9	•	•		•		•	•
		Slab Bolster with Plate - SBP	9	•	•					•
		Beam Bolster - BB	10	•		•	•		•	•
		Beam Bolster Upper - BBU	10	•	•		•		•	•
		Heavy Beam Bolster - HBB	10	•		•	•		•	•
		Beam Bolster with Plate - BBP	11	•	•					•
		Continuous High Chair - CHC	11	•		•	•		•	•
		Continuous High Chair Upper - CHCU	12	•	•		•		•	•
		Continuous High Chair with Plate - CHCP	12	•					•	•
		Continuous Support - CS	13	•						•
Continuous Mesh Support - K60	13	•		•	•		•	•		
Side	Caisson Alignments Bar - R0	14			•		•		•	
PLASTIC SUPPORTS	Individual	Plastic Paving Chair - PPC	15		•			•	•	
		Aztec Snap-On Mesh Chair - R22	16		•			•	•	
		Aztec EZ Chair - PEZ	16	•		•	•		•	•
		Aztec E-Z Chair Sand Plate - PSP	17	•	•				•	•
		Aztec Tower Bar Chair - PBC	17	•			•		•	•
		Aztec Tower Chair - PTC	18	•			•		•	•
		Aztec Hy-Chair (Hybrid) - PHC	18	•					•	•
		Aztec Straddle Chair - PSC	19	•			•		•	•
		Aztec Tower Chair Sand Plate - PTCSP	19	•	•					•
		Aztec Straddle Chair Sand Plate - PSCSP	19	•	•					•
		Aztec Castle Chair - PCC	20	•	•		•	•	•	•
		Aztec Paving/Sand Chair - PPSC	20	•						•
		Aztec X-Chair - PXC	20	•					•	
		Aztec Snap-On Paving Chair - PSN	21		•					•
		Aztec On Grade Mesh Chair - PPMC	21		•					•
		Aztec Utility Chair - PSUT	21						•	
		Aztec Post Tension (Intersectional) Chair™ - PPT	21	•						
		Aztec Form Anchor - PFA	22	•					•	
		Aztec E-Z Bolt Holder - PEZBH	22	•	•				•	•
		Aztec Dowel Chair and Cap - PDCC	22							•
	Aztec Screed Chair - PAS	22	•	•						
	Continuous	Aztec StrongBack Slab/Beam Bolster™ - PSBB	23	•		•	•			•
		Aztec StrongBack SBU - Slab Bolster Upper - PSBU	23	•			•	•	•	•
		Aztec E-Z Lock Slab Bolster - PSB	24						•	•
	Side Form	Aztec Space Wheel - PSW	24			•			•	
		Aztec E-Z Lok Wheel - PLW	25			•		•	•	•
		BarTender Plastic Foundation Wheel - PFW	25					•	•	•
		ReBoot Plastic Foundation Boot - PFB	25		•			•	•	•
	CEMENTITIOUS	Individual	Plain Dobie - CPD	26	•	•		•		•
			Wire Dobie - CWD	26	•	•	•	•		•
Combination Dobie - CCD			26	•	•			•	•	
Dowel Dobies - CDD			27	•	•			•	•	
REBAR ACCESSORIES	Premium Wire Tie - WTW	28	•	•	•	•	•	•		

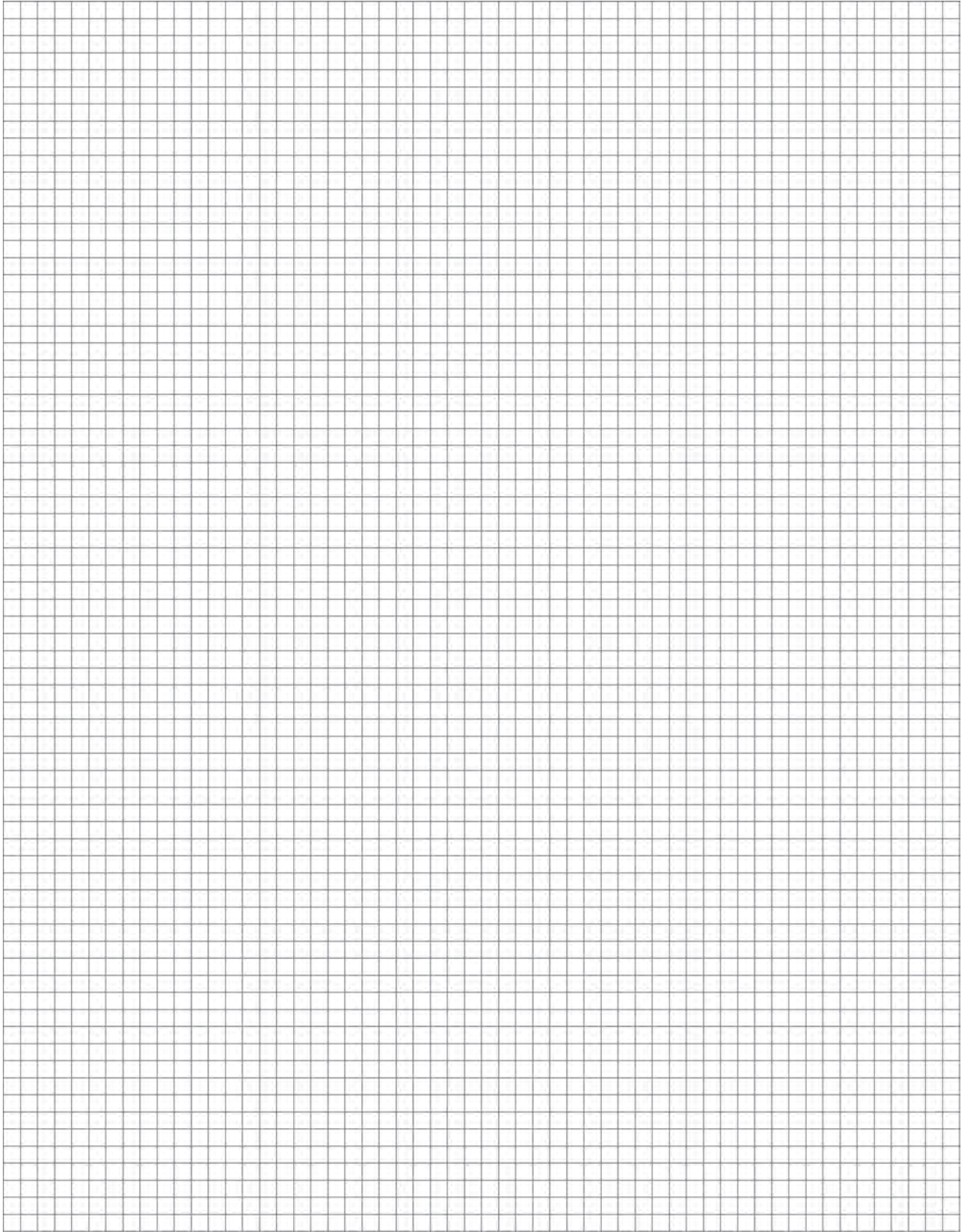

Supports for Rebar and Wire Mesh

Dayton Superior manufactures a complete line of rebar and/or mesh supports. All Dayton Superior rebar supports are manufactured to the recommendations or specifications of the Concrete Reinforcing Steel Institute (CRSI) and comply with American Concrete Institute (ACI) ACI-50-66, ACI-315 and ACI-315R. Supports are available bright basic, plastic protected, epoxy coated, galvanized, and stainless steel for various corrosion resistance protection.

Dayton Superior rebar supports are shipped in convenient cartons, bundles or on skids and are clearly identified.

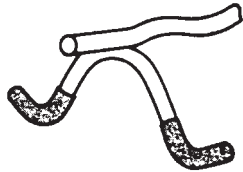

Baked on Plastic Feet



Epoxy-Coated

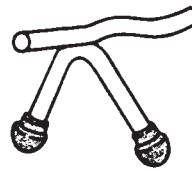

Plastic Tipped Feet

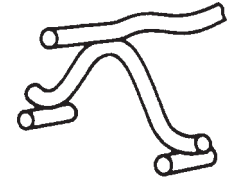

Stainless Steel Tips

General Notes

Pre-galvanized (zinc-coated), hot-dipped and stainless steel supports are furnished with the legs pre-galvanized, hot-dipped, or fabricated exclusively from AISA Type 430 Stainless Steel. All legs on supports will be turned up a minimum of 1/8".

We can plastic dip the top 2" or bottom (not both) on all SBU, BBU, CHCU, CHC and HC. We can put stainless steel or mill galvanized wire runners on all SBU, BBU and CHCU.

Rust Prevention

Bar supports are classified in terms of methods employed to minimize rust spots or similar blemishes on the surface of the concrete directly caused by the bar support. The three classes and their intended degree of protection are:

Class 1

Plastic or Plastic Protected

(FORMERLY CLASS C)

Maximum protection; which is intended for use in situations of moderate to severe exposure and/or situations requiring light grinding (under 1/16") or sandblasting of the concrete surface.

Class 1A

Maximum Protection

(FOR USE WITH EPOXY-COATED REINFORCING BARS)

Epoxy-Coated, Vinyl-Coated, or Plastic-Coated Bright Basic Wire Supports — which are intended for use in situations of moderate to maximum exposure where no grinding or sandblasting of the concrete surface is required. They are generally used when epoxy-coated reinforcing bars are required.

Class 2 Type A

Stainless Steel Protected

(FORMERLY CLASS D)

Moderate protection; which is intended for use in situations of moderate exposure and/or situation requiring light grinding (under 1/16") or sandblasting of the concrete surface.

No non-stainless steel wire of the bar support will be closer than 1/4" from the form surface. Aluminum oxide wheels should be used when grinding is necessary. Iron oxide will leave rust marks.

Class 2 Type B

Stainless Steel Protected

(FORMERLY CLASS E)

Moderate protection; which is intended for use in situations of moderate exposure and/or situation requiring light grinding (under 1/16") or sandblasting of the concrete surface.

No non-stainless steel wire of the bar support will be closer than 3/4" from the form surface. Aluminum oxide wheels should be used when grinding is necessary. Iron oxide will leave rust marks.

Class 3

No Protection

(FORMERLY CLASS A)

No protection against rusting; which is intended for use in situations where surface blemishes can be tolerated, or where the supports do not come in contact with the exposed concrete surface.

Note: CRSI does not identify galvanized coatings as a rust prevention coating.

Dayton Superior offers many wire bar supports with a mill galvanized or hot dipped galvanized finish. No rust preventative standard is expressed or implied.

Joist Chair - JC

APPLICATION:

To support reinforcing bar in ribs of a joist or grid type slab.

Available in plain, Galvanized, plastic protected or epoxy coated.

COVER HEIGHT:

3/4" to 1-1/2"

SIZE	JC3 PLAIN	JC1 PLASTIC DIPPED
	PRODUCT CODE	PRODUCT CODE
3/4" x 4"	75500	---
3/4" x 6"	---	75523
1" x 4"	75530	75533
1" x 5"	---	75543
1" x 6"	75550	75553
1-1/2" x 4"	75560	75563
1-1/2" x 5"	75570	---
1-1/2" x 6"	75580	75583



Bar Chair - BC

APPLICATION:

To support wide spaced light steel in slab or deck construction.

Available in plain, galvanized, plastic protected or epoxy coated finish.

COVER HEIGHT:

3/4" to 2", in 1/4" increments

FEATURES:

- Formed cradle to place wire mesh or reinforcing bar.
- Foot designed to set on most forming surfaces.

SIZE	BC-3 PLAIN	BC-GW GALVA-NIZED WIRE	BC-1 PLASTIC TIPPED	BC-1 PLASTIC DIPPED	BC-1A EPOXY
	PRODUCT CODE	PRODUCT CODE	PRODUCT CODE	PRODUCT CODE	PRODUCT CODE
3/4"	75400	75401	75406	75403	75407
1"	75410	75411	75416	75413	75417
1-1/4"	75420	75421	75426	75423	75427
1-1/2"	75430	75431	75436	75433	75437
1-3/4"	75440	75441	75446	75443	75447
2"	75450	75451	75456	75453	75457



Bar Chair with Plate - BCP

APPLICATION:

To support wide spaced light steel in slab construction on loosely compacted soil, rock base, sand base or carton forms.

Available in bright basic or epoxy coated.

COVER HEIGHT:

Available in heights of 1" to 2", in 1/4" increments.

FEATURES:

- Steel plate provides bearing on forming surface to maintain chair at desired elevation.

SIZE	PLAIN
	PRODUCT CODE
1"	72999
1-1/2"	73002
1-3/4"	73003
2"	73004



Solid plate available on special order.

Speed Chair - SC

APPLICATION:

To support fixed spaced light steel in slab or footer construction on loosely compacted soil, rock base, sand base, or carton forms.

Available in plain only.

COVER HEIGHT:

3" to 8"

FEATURES:

- Formed cradle to place rebar or wire mesh
- On grade penetrating legs for height adjustability

SIZE	PRODUCT CODE
2 Bars	127364

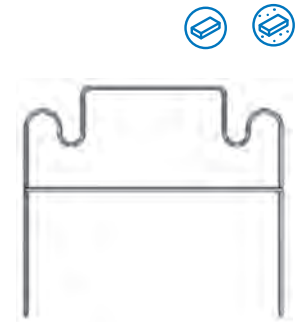

Individual High Chair - HC

Dayton Superior's Individual High Chair is used to support upper steel directly or by means of a carrier bar. Available in 2" to 15" heights in bright basic, plastic protected, or epoxy-coated wire.

APPLICATION:

To support reinforcing bar or wire mesh during concrete placement in Flat Slab, Tilt Wall Panel, Elevated Slabs, Precast Panels projects, to maintain proper concrete coverage.

COVER HEIGHT:

Available in heights of 2" to 15" in increments of 1/4". Chairs over 12" require cross bracing or lacing of legs.

FEATURES:

- Formed cradle for placing reinforcing bar.
- Designed to resist deformation under construction loading.
- Wide leg span to allow chair to straddle lower bars.
- Foot designed for use on multiple forming surfaces. Plastic Dipped and Plastic Tipped chairs designed for exposed conditions, i.e. Tilt Wall Panels.

SIZE	HC-3 PLAIN	HC-1 PLASTIC TIPPED	HC-1 PLASTIC DIPPED	HC-1A EPOXY
	PRODUCT CODE	PRODUCT CODE	PRODUCT CODE	PRODUCT CODE
2"	73100	73106	73103	73107
2-1/4"	73110	73116	73113	73117
2 1/2"	73120	73126	73123	73127
2-3/4"	73130	73136	73133	73137
3"	73140	73146	73143	73147
3-1/4"	73150	73156	73153	73157
3-1/2"	73160	73166	73163	73167
3-3/4"	73170	73176	73173	73177
4"	73180	73186	73183	73187
4-1/4"	73190	73196	73193	73197
4-1/2"	73200	73206	73203	73207
4-3/4"	73210	73216	73213	73217
5"	73220	73226	73223	73227
5-1/4"	73230	73236	73233	73237
5-1/2"	73240	73246	73243	73247
5-3/4"	73250	73256	73253	73257
6"	73260	73266	73263	73267
6-1/4"	73270	73276	73273	73277
6-1/2"	73280	73286	73283	73287
6-3/4"	73290	73296	73293	73297
7"	73300	73306	73303	73307
7-1/4"	73310	73316	73313	73317
7-1/2"	73320	73326	73323	73327
7-3/4"	73330	73336	73333	73337
8"	73340	73346	73343	73347
8-1/4"	73350	73356	73353	73357
8-1/2"	73360	73366	73363	73367
8-3/4"	73370	73376	73373	73377
9"	73380	73386	73383	73387
9-1/4"	72700	72706	—	72707
9-1/2"	72710	72716	72713	72717
9-3/4"	72720	72726	125226	72727
10"	72730	72736	72733	72737
10-1/4"	72740	72746	—	72747
10-1/2"	72750	72756	125403	72757
10-3/4"	72760	72766	—	72767
11"	72770	72776	125227	72777
11-1/4"	72780	72786	—	72787
11-1/2"	72790	72796	—	72797
11-3/4"	72800	72806	—	72807
12"	72810	72816	—	72817



High Chair with turned up leg

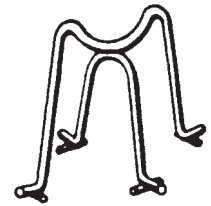

Stainless dowels on chairs over 3"

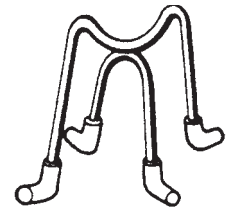

Plastic tipped legs available

Aztec® Sand Plate - R28

APPLICATION:

Attachment to HC to allow for on grade compatibility.

COVER HEIGHT:

Fits 2" to 8" High Chairs

FEATURES:

- Clipped rails for positive connection to HC
- Wide enough to accept multiple height chairs

SIZE	PRODUCT CODE
5"x5"	62990



Individual High Chair With Plates - HCP

APPLICATION:

Support reinforcing steel over loose compacted soil base, rock base, sand base or carton forms during normal construction.

COVER HEIGHT:

2" to 12" on 1/4" increments.

FEATURES:

- Formed cradle for placing reinforcing bar.
- 1" wide steel plates (2) provide bearing surface to allow high chair to remain at elevation.
- Available in epoxy coated or hot dipped galvanized finish on special order basis.

NOTE:

Single solid plate available on special order basis, only.

SIZE	PRODUCT CODE	SIZE.	PRODUCT CODE
2"	73005	7"	73308
2-1/4"	73007	7-1/4"	73318
2-1/2"	73012	7-1/2"	73328
2-3/4"	73014	7-3/4"	73338
3"	73015	8"	73348
3-1/4"	73017	8-1/4"	73358
3-1/2"	73025	8-1/2"	73368
3-3/4"	73027	8-3/4"	73378
4"	73028	9"	73388
4-1/4"	73198	9-1/4"	—
4-1/2"	73208	9-1/2"	—
4-3/4"	73218	9-3/4"	—
5"	73228	10-1/4"	—
5-1/4"	73238	10-1/2"	—
5-1/2"	73248	10-3/4"	—
5-3/4"	73258	11"	—
6"	73268	11-1/4"	—
6-1/4"	73278	11-1/2"	—
6-1/2"	73288	11-3/4"	—
6-3/4"	73298	12"	—



HCP-Individual High Chair with Plates

High Chairs for Metal Decking – HCM

APPLICATION:

To support reinforcing bar on metal deck or uneven forming surface.

Legs of different length to fit the design of the uneven surface.

Available in plain, hot dipped galvanized or epoxy coated finish.

COVER HEIGHT:

Available in heights of 2" to 9" with leg spacing of 4-1/2" to 10"

FEATURES:

Two cradle types.

- Type A positions bar perpendicular to rib.
- Type B positions bar parallel to rib.

Order Information must include:

Cradle Type (A or B), Dimensions for A, B and C, and finish type.

NOTE:

- Leg span "C" must decrease as chair height decreases due to chair geometry.
- ALL HCMs are Made-to-order.
- Some states specify modified chair design. Approval may be required, with a drawing before manufacture of product
- HCM is a made to order item

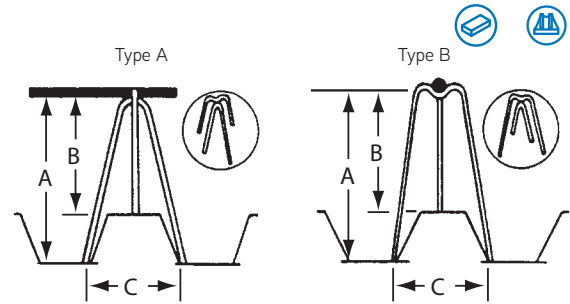

HCM - High Chairs for Metal Decking

Dayton Superior's Slab Bolster is used to support lower slab steel from the slab form. Legs are spaced on 5" centers. Available in 3/4" to 3" heights in 5' lengths and in bright basic, galvanized, plastic protected, stainless steel, or epoxy coated.

Slab Bolster - SB

APPLICATION:

To support lower slab steel, on continuous 5ft long top wire.

Also available in 10ft lengths on special order basis.

COVER HEIGHT:

3/4" to 3", in 1/4" increments.

FEATURES:

- Corrugations on top wire are space on 1" centers to serve as guides for spacing reinforcing bars.
- Available in plain, galvanized, plastic protected or epoxy coated finish

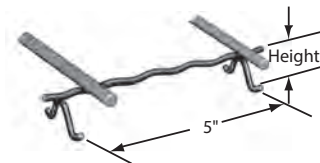

Size	Plain (Class 3)	Plastic Tipped (Class 1)	Galvanized & Tipped (Class 1)	Plastic Dipped (Class 1)	Epoxy Coated (Class 1A)	Epoxy Coated & Plastic Dipped (Class 1A)
3/4" X 5'	70100	70106	--	70103	70107	701073
1" X 5'	70200	70206	70209	70203	70207	702073
1-1/4" X 5'	70300	70306	70309	70303	70307	--
1-1/2" X 5'	70400	70406	70409	70403	70407	704073
1-3/4" X 5'	70410	70416	70419	70413	70417	--
2" X 5'	70420	70426	70429	70423	70427	704273
2-1/4" X 5'	70430	70436	70439	70433	70437	--
2-1/2" X 5'	70440	70446	70449	70443	70447	704473
2-3/4" X 5'	70450	70456	70459	70453	70457	--
3" X 5'	70460	70466	70469	70463	70467	704673

Slab Bolster Upper - SBU



APPLICATION:

To support one layer of steel above another and space them to required distance. May also be used to support steel on soft material form surface, such as carton forms or fill material.

COVER HEIGHT:

3/4" to 3", in 1/4" increments.

FEATURES:

- Some sizes are available with corrugated top wire to serve a guide for spacing reinforcing steel.
- Available in plain, galvanized, stainless steel or epoxy coated.
- 5' lengths standard. Other lengths available as special order.



Size	Plain, Short (Class 3)	Plain (Class 3)	Epoxy Coated (Class 1A)	Galvanized	Plastic Dipped (Class 1)
3/4" X 5'	--	125116	125126	70508	--
1" X 5'	--	125117	125127	70518	--
1" X 15"	143349	--	--	--	--
1" X 20"	143350	--	--	--	--
1-1/4" X 5'	--	125118	125128	70528	--
1-1/2" X 5'	--	125119	125129	70538	--
1-1/2" X 15"	143347	--	--	--	--
1-1/2" X 20"	143348	--	--	--	--
1-3/4" X 5'	--	125120	125130	70548	--
2" X 5'	--	125121	125131	70558	70559
2-1/4" X 5'	--	125122	125132	70568	--
2-1/2" X 5'	--	125123	125133	70578	--
2-3/4" X 5'	--	125124	125134	70588	--
2" X 15"	143351	--	--	--	--
2" X 20"	143352	--	--	--	--
3" X 5'	--	125125	125135	70598	--
3-1/2" X 5'	--	70660	--	--	--
3" X 10"	70492	--	--	--	--
3" X 15"	70494	--	--	--	--
3" X 20"	70496	--	--	--	--
4" X 5'	--	113180	--	--	--
4-1/2" X 5'	--	121250	--	--	--
5" X 5'	--	121251	--	--	--

Slab Bolster with Plate - SBP



APPLICATION:

To support lower slab steel on fill or other soft materials. Continuous 5 ft long top wire eliminates the need for a carrier bar or many individual supports.

COVER HEIGHTS:

3/4" to 3", in 1/4" increments

FEATURES:

- Corrugations on top wire are spaced on 1" centers to serve as guides for placing reinforcing bars.
- Steel plate provides bearing surface on loosely compacted soil, rock base, sand base or carton forms.
- Available in plain, galvanized or epoxy coated finish



Size	Plain (Class 3)
3/4" X 5'	70700
1" X 5'	70710
1-1/2" X 5'	70730
2" X 5'	70750
2-1/2" X 5'	70770
3" X 5'	70790

Application: Dayton Superior's Beam Bolster is used to support lower beam steel from the soffit form. Legs are spaced on 2-1/2" centers. Available in 1-1/2" to 5" heights in 5' lengths. Manufactured in bright basic, plastic protected, galvanized, epoxy coated or stainless steel protected.

Beam Bolster - BB

COVER HEIGHT:

1" to 5", in 1/4" increments

FEATURES:

- Legs placed on 2-1/2" centers to allow Beam Bolster to be field cut to fit soffit width while maintaining adequate support.

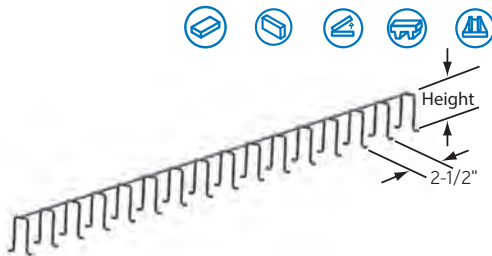

Size	Plain (Class 3)	Plastic Tipped (Class 1)	Plastic Dipped (Class 1)	Epoxy Coated (Class 1A)
3/4" X 5'	113150	--	--	--
1" X 5'	71100	71106	71103	71107
1" X 15"	71150	--	--	--
1" X 20"	71200	--	--	--
1-1/4" X 5'	71250	--	71153	71157
1-1/2" X 5'	71300	71206	71203	71207
1-1/2" X 15"	72350	--	--	--
1-1/2" X 20"	72360	--	--	--
1-3/4" X 5'	72370	--	71253	--
2" X 5'	--	71306	71303	71307
2-1/4" X 5'	--	72356	72353	72357
2-1/2" X 5'	--	72366	72363	--
2-3/4" X 5'	--	--	72373	72377
3" X 5'	72380	72386	72383	72387
3-1/4" X 5'	71310	--	--	--
3-1/2" X 5'	71320	--	71323	113100
3-3/4" X 5'	72410	--	72413	72417
4" X 5'	72420	--	72423	--
4-1/4" X 5'	--	--	72433	--
4-1/2" X 5'	72440	--	72443	72447

Beam Bolster Upper - BBU

APPLICATION:

To support successive layers of steel, one above the other by being placed on and perpendicular to lower steel. Available in plain or epoxy coated finish. Available in 5 ft length, other lengths available on special order basis.

COVER HEIGHT:

1" to 5" in 1/4" increments.

FEATURES:

- Lower runner wires provide bearing on lower mat steel or carton form surface.
- Support legs on 2-1/2" centers allow for cutting to length in the field and reinforcing steel to be spaced closely together.

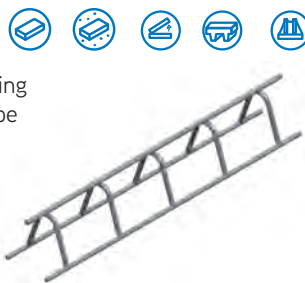

Size	Plain (Class 3)	Epoxy Coated (Class 1A)
1" X 5'	--	72107
1-1/4" X 5'	72110	72117
1-1/2" X 5'	72120	72127
1-5/8" X 5'	72128	--
1-3/4" X 5'	72130	72137
2" X 5'	72140	72147
2-1/4" X 5'	72550	72557
2-1/2" X 5'	72560	72567
2-3/4" X 5'	72570	72577
3" X 5'	72580	72587
3-1/4" X 5'	122098	--
3-1/2" X 5'	72610	100158
3-3/4" X 5'	72620	--
4" X 5'	124167	--
4-1/2" X 5'	72650	--
4-3/4" X 5'	126241	--
5" X 5'	126279	--

Heavy Beam Bolster - HBB

COVER HEIGHT:

1" to 5", in 1/4" increments

FEATURES:

- Legs placed on 2-1/2" centers to allow Beam Bolster to be field cut to fit soffit width while maintaining adequate support.
- The Heavy Beam Bolster is a made to order item



Beam Bolster with Plate - BBP



APPLICATION:

To support lower beam steel on loosely compacted soil, rock base, sand base or carton form surface. Available in plain finish in 5' lengths.

COVER HEIGHT:

1" to 2" in standard (7 ga.) or heavy (4 ga.) wire.

COVER HEIGHT:

2-1/4" to 5", in 1/4" increments (4 ga.) wire.

FEATURES:

- Single plate provides bearing surface to keep Beam Bolster at elevation.
- Support legs spaced on 2-1/2" centers to provide adequate support and allow for cutting to length in the field.
- Top carrier wire allows for reinforcing steel to be spaced closely together.
- The Beam Bolster with Plate is a made to order product

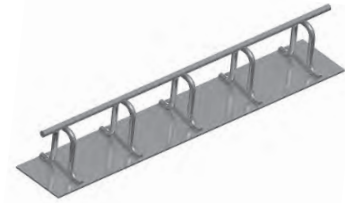

Continuous High Chair - CHC

Dayton Superior's Continuous High Chair provides support for upper slab steel eliminating the need for carrier bars. Fabricated in 2" to 14" heights x 5' lengths with legs spaced on 7-1/2" centers. Available in bright basic, plastic protected, galvanized, epoxy coated and stainless steel.



APPLICATION:

- Support upper slab steel from slab form surface.
- Substitutes for individual chair supports.

NOTE:

Available in 10' lengths on special order basis.



SIZE	CHC-3 PLAIN	CHC-1 PLASTIC TIPPED	CHC-1 PLASTIC DIPPED	CHC-1A EPOXY
	PRODUCT CODE	PRODUCT CODE	PRODUCT CODE	PRODUCT CODE
2"	74000	-	74003	74007
2-1/4"	74010	-	74013	74017
2-1/2"	74020	74026	74023	74027
2-3/4"	74030	-	74033	74037
3"	74040	-	74043	74047
3-1/4"	74050	74056	74053	74057
3-1/2"	74060	-	74063	74067
3-3/4"	74070	-	74073	74077
4"	74080	74086	74083	74087
4 1/4"	74090	74096	74093	74097
4-1/2"	74100	-	74103	74107
4-3/4"	74110	-	74113	74117
5"	74120	74126	74123	74127
5-1/4"	74130	-	74133	74137
5-1/2"	74140	74146	74143	74147
5-3/4"	74150	-	74153	74157
6"	74160	74166	74163	74167
6-1/4"	74170	-	-	-
6-1/2"	74175	124498	74176	-
6-3/4"	74180	-	-	74184
7"	74300	74306	123859	-
7-1/4"	74185	-	-	-
7-1/2"	74190	-	-	74194
7-3/4"	74195	74192	-	-
8"	74310	74316	-	-
8-1/4"	-	-	-	-
8-1/2"	-	74326	-	-
9"	74250	74328	-	-
9-1/4"	-	-	-	-
9-1/2"	-	121104	-	-
9-3/4"	74280	-	-	-
10"	-	74338	-	-
11"	-	-	-	-
12"	-	-	-	-
13"	-	-	-	-
14"	-	74378	-	-

Continuous High Chair Upper - CHCU

Dayton Superior's Continuous High Chair provides support for upper slab steel eliminating the need for carrier bars. Fabricated in 2" to 15" heights in 5' lengths with legs spaced on 7-1/2" centers. Available in bright basic, epoxy coated and galvanized.

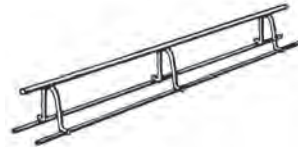

CHCU-Cont. High Chair Upper
Lap Weld



CHCU-Cont. High Chair Upper
Butt Weld

APPLICATION:

Continuous High Chair Upper is used to separate two layers of steel. Runner wire on the bottom allows CHCU to rest on the lower mat of steel to support the upper mat. Available in plain, hot dipped galvanized or epoxy coated finish.

COVER HEIGHT:

Available in heights of 2" to 15" in increments of 1/4" in 5' lengths.

FEATURES:

5' long top wire eliminates the needs for carrier bars to support upper steel.

NOTE:

- Also available in 10' long lengths on special order.
- CHCU has also been used to support upper steel when used on carton form surface. See carton form manufacturer data sheet for recommendations.

SIZE	PLAIN LAP WELD	PLAIN BUTT WELD	EPOXY BUTT WELD
	PRODUCT CODE	PRODUCT CODE	PRODUCT CODE
2"	125146	125176	125197
2-1/4"	-	125177	125198
2-1/2"	125148	125178	125199
2-3/4"	-	125179	125200
3"	125150	125180	125201
3-1/4"	-	125181	125202
3-1/2"	124939	125182	125203
3-3/4"	-	125183	125204
4"	124941	125184	125205
4-1/4"	-	125185	125206
4-1/2"	124943	125186	125207
4-3/4"	-	125187	125208
5"	124944	125188	125209
5-1/4"	-	125189	125210
5-1/2"	124946	125190	125211
5-3/4"	-	125191	127686
6"	124947	125192	125212
6-1/4"	-	125193	125213
6-1/2"	124948	125194	125214
6-3/4"	-	125195	125215
7"	124949	125196	125216

Continuous High Chair with Plate - CHCP



APPLICATION:

Continuous High Chair with Plate is designed to support upper slab steel on fill or sand base or carton form surface.

COVER HEIGHT:

2" to 15" in 1/4" increments.

FEATURES:

- 5 ft. long top wire eliminates the need for carrier bar to support upper steel.
- 1" wide plates (2) provide bearing surface to keep CHCP at elevation while resting on fill or sand.

NOTE:

CHCP will not straddle lower steel due to the continuous bearing plates welded to legs.



CHCP-Cont. High with Plates
Manufactured to Order

SIZE	PRODUCT CODE
2"	74900
2-1/2"	74908
3"	74916
3-1/2"	74924
4"	74932
4-1/2"	74940
5"	74948
5-1/2"	74956
6"	74964



Continuous Support - CS

APPLICATION:

To support and space reinforcing steel in continuously reinforced roadways, decks or slabs. Available in plain finish.

COVER HEIGHT:

2" to 16" in 1/2" increments.

FEATURES:

- Legs spaced on 6" centers, on 4" centers at bend points
- 7 1/2" to 12" have three linear wires
- 2" to 7" have two linear wires

SIZE	PRODUCT CODE
2"	84220
2-1/2"	84222
3"	84224
3-1/2"	84226
4"	84228
4-1/2"	84230
5"	84232
5-1/2"	84234
6"	84236
6-1/2"	84238
7"	84240
7-1/2"	84242
8"	84244
8-1/2"	84246
9"	84248
9-1/2"	84250
10"	84252
10-1/2"	84254
11"	84256
11-1/2"	84258
12"	84260

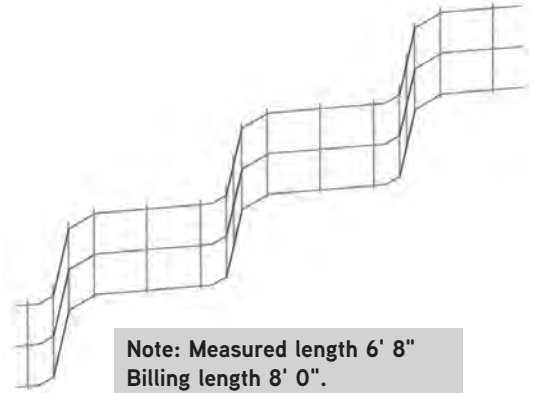

**Note: Measured length 6' 8"
Billing length 8' 0".**

SIZE	PRODUCT CODE
13"	84264
13-1/2"	84266
14"	84268
14-1/2"	-
15"	84272
15-1/2"	84274
16"	84276

Continuous Mesh Support - K60



APPLICATION:

Separates two mats of steel. Runner wire on the bottom allows for resting on the lower mat or on grade.

COVER HEIGHT:

3/4" to 10" in 1/4" increments

FEATURES:

- Available in 5' lengths
- Top wire eliminates the need for carrier bars to support upper steel
- Light gauge wire for right sized capacity
- Lower runner wire for on-grade or upper mat compatibility
- Available in plain, epoxy coated or galvanized finish
- Available in plastisol dipped runners
- Available in carbon steel and stainless steel



SIZE	PRODUCT CODE PLAIN (CLASS 3)
2"	80472
2-1/2"	124546
3"	80473
3-1/2"	124547
4"	80474
4-1/2"	124883
5"	80475
5-1/2"	80485
6"	80476
7"	80477
8"	80478
9"	80498
10"	80479

Caisson Alignment Bar - R0

APPLICATION:

The Caisson Alignment Bar is a side form spacer.

COVER HEIGHT:

15-1/2"

FEATURES:

- Heavy weight wire diameter
- Caisson below grade compliant

SIZE	PRODUCT CODE
15-1/2"	70020



Aztec® Plastic Paving Chair - PPC



APPLICATION:

DOT, on-grade, single mat.

COVER HEIGHT:

1" to 9" in 1/4" increments

FEATURES:

- Clip for positive locking action
- Large foot for superior stability

Meets all requirements to qualify as a CRSI Class 1 bar support.



PRODUCT CODE	PRODUCT SIZE	BAR SIZE
129250	1"	#3 [10mm] - #6 [19mm]
129251	1-1/4"	#3 [10mm] - #6 [19mm]
129252	1-1/2"	#3 [10mm] - #6 [19mm]
129253	1-3/4"	#3 [10mm] - #6 [19mm]
129254	2"	#3 [10mm] - #6 [19mm]
129255	2-1/4"	#3 [10mm] - #6 [19mm]
129256	2-1/2"	#3 [10mm] - #6 [19mm]
129257	2-3/4"	#3 [10mm] - #6 [19mm]
129258	3"	#3 [10mm] - #6 [19mm]
129259	3-1/4"	#3 [10mm] - #6 [19mm]
129260	3-1/2"	#3 [10mm] - #6 [19mm]
129261	3-3/4"	#3 [10mm] - #6 [19mm]
129262	4"	#3 [10mm] - #6 [19mm]
129263	4-1/4"	#3 [10mm] - #6 [19mm]
129264	4-1/2"	#3 [10mm] - #6 [19mm]
129265	4-3/4"	#3 [10mm] - #6 [19mm]
129266	5"	#3 [10mm] - #6 [19mm]
129267	5-1/4"	#3 [10mm] - #6 [19mm]
129268	5-1/2"	#3 [10mm] - #6 [19mm]
129269	5-3/4"	#3 [10mm] - #6 [19mm]
129270	6"	#3 [10mm] - #6 [19mm]
129271	6-1/4"	#3 [10mm] - #6 [19mm]
129272	6-1/2"	#3 [10mm] - #6 [19mm]
129273	6-3/4"	#3 [10mm] - #6 [19mm]
129274	7"	#3 [10mm] - #6 [19mm]
129275	7-1/4"	#3 [10mm] - #6 [19mm]
129276	7-1/2"	#3 [10mm] - #6 [19mm]
129277	7-3/4"	#3 [10mm] - #6 [19mm]
129278	8"	#3 [10mm] - #6 [19mm]
129279	8-1/4"	#3 [10mm] - #6 [19mm]
129280	8-1/2"	#3 [10mm] - #6 [19mm]
129281	8-3/4"	#3 [10mm] - #6 [19mm]
129249	9"	#3 [10mm] - #6 [19mm]

Plastic Individual Supports

Aztec® Snap-On Mesh Chair - R22

APPLICATION:

DOT, On-Grade, wire mesh, single mat.

COVER HEIGHT:

1" to 6" in 1/2" increments

FEATURES:

- Clip for positive locking action
- Large foot for superior stability

Meets all requirements to qualify as a CRSI Class 1 bar support.

PRODUCT CODE (WITHOUT BASE)	PRODUCT CODE (WITH BASE)	PRODUCT SIZE	BAR SIZE
-	62502	1"	W7.5
-	62504	1-1/2"	W7.5
62558	62508	2"	W7.5
62562	62512	2-1/2"	W7.5
62564	62514	3"	W7.5
-	62518	3-1/2"	W7.5
-	62522	4"	W7.5
-	62530	5"	W7.5
-	62534	5-1/2"	W7.5
-	62536	6"	W7.5



Aztec® E-Z Chair® - PEZ

APPLICATION:

Single Mat -Rebar or Wire Mesh, Bottom Layer Double Mat Rebar or Wire Mesh, Tilt-Wall, Side-Form Spacer, On-Grade: when used with Sand Plate

COVER HEIGHT:

From 3/4" to 6" in 1/4" increments

FEATURES:

- Standard "Concrete Gray" color (custom colors available-inquire)
- Minimal surface contact
- Designed for maximum aggregate flow and concrete consolidation
- High load capacity
- Fits up to #8 rebar
- Does not straddle bottom rebar mat in double mat applications (for straddling applications, see Tower Chair or Straddle Chair)

PRODUCT APPLICATIONS:

CRSI Class 1 Bar Support.

Meets all requirements to qualify as a CRSI Class 1 Bar Support.

PRODUCT CODE	COVER SIZE	QTY PER BOX
127667	3/4"	1000
127651	1"	850
127673	1-1/4"	650
127660	1-1/2"	500
127662	1-3/4"	450
127668	2"	350
127652	2-1/4"	300
127674	2-1/2"	300
127653	2-3/4"	300
127663	3"	260
127675	3-1/4"	250
127669	3-1/2"	200
127654	3-3/4"	200
127676	4"	175
127655	4-1/4"	160
127664	4-1/2"	150
127677	4-3/4"	140
127670	5"	120
127656	5-1/4"	120
127678	5-1/2"	100
127657	5-3/4"	100
127665	6"	100



Aztec® E-Z Chair® Sand Plate - PSP



APPLICATION:

E-Z CHAIR™ for slab-on-grade conditions

COVER HEIGHT:

From 1" to 6" for E-Z CHAIRS™

FEATURES:

Provides stable platform

Sold separately. Assembly required.

Meets all requirements and qualifies as a CRSI Class 1 Bar Support.



PRODUCT CODE	FITS SIZE	DIAMETER	QTY PER BOX	WT.LBS. PER BOX
122827	0.75 – 3.00	3.0	550	15
122828	3.25 – 4.50	4.0	300	16
122829	4.75 – 6.00	4.75	250	17

Aztec® Bar Chair - PBC



APPLICATION:

Single Mat-Rebar or Wire Mesh, Bottom Layer Double Mat-Rebar or Wire Mesh, Tilt Wall, Side-Form Spacer, On-Grade: when used with Sand Plate

COVER HEIGHT:

From 3/4" to 10" in 1/4" increments

FEATURES

- Standard "Concrete Gray" color
- Minimal surface contact
- Designed for maximum aggregate flow and concrete consolidation
- Fits up to #8 rebar
- Tower chair straddles lower rebar mat in double mat applications

PRODUCT CODE	COVER	QTY/BOX	WT.LBS. PER BOX
121286*	3/4" - 1"	750	30
121287*	1-1/4" - 1-1/2"	600	27
121288*	1-3/4" - 2"	450	28
121289*	2-1/4" - 2-1/2"	350	24

*Denotes multiple height combinations per chair and comes pre-assembled



Bar Chair (PBC)

Meets all requirements and qualifies as a CRSI Class 1 Bar Support.

Aztec® Tower Chair™ - PTC



APPLICATION:

Single Mat-Rebar or Wire Mesh, Bottom Layer Double Mat-Rebar or Wire Mesh, Tilt Wall, Side-Form Spacer, On-Grade: when used with Sand Plate

COVER HEIGHT:

From 2-3/4" to 10" in 1/4" increments

FEATURES

- Standard "Concrete Gray" color
- Minimal surface contact
- Designed for maximum aggregate flow and concrete consolidation
- Fits up to #8 rebar
- Tower chair straddles lower rebar mat in double mat applications

PRODUCT CODE	COVER	QTY/ BOX	WT.LBS. PER BOX
122821	2-3/4"	100	14
122822	3"	100	14
122823	3-1/4"	100	15
122824	3-1/2"	100	15
122825	3-3/4"	100	16
121290	4"	240	49
121291*	4-1/4" - 4-1/2"	240	58
121292*	4-3/4" - 5"	216	53
121293*	5-1/4" - 5-1/2"	168	45
121294*	5-3/4"	144	40
121295	6"	150	52
121296*	6-1/4" - 6-1/2"	135	52
121297*	6-3/4" - 7"	120	47
121298*	7-1/4" - 7-1/2"	105	43
121299*	7-3/4"	90	38
121300	8"	135	54
121301*	8-1/4" - 8-1/2"	135	63
121302*	8-3/4" - 9"	105	49
121303*	9-1/4" - 9-1/2"	90	41
121304*	9-3/4" - 10"	75	34



Tower Chair (PTC)

Meets all requirements and qualifies as a CRSI Class 1 Bar Support.

*Denotes multiple height combinations per chair and comes pre-assembled

Plastic Individual Supports

Aztec® Hy-Chair™ (Hybrid) - PHC



APPLICATION:

A combination rebar support consisting of high strength plastic base (Tower Chair) and a wire upper wicket insert.

COVER HEIGHT:

From 10-1/4" to 14" in 1/4" increments

FEATURES:

- Provides superior strength
- Supports loads up to 500 lbs
- Clearance heights up to 14"
- Straddles lower rebar mats up to 2-3/4"
- Pre-Assembled prior to packaging
- Plastic base insures minimal footprint
- Eliminates corrosion on exposed surfaces

PRODUCT CODE	COVER	QTY/ BOX	WT.LBS. PER BOX
220352	10-1/4"	75	39
220353	10-1/2"	75	41
220354	10-3/4"	75	42
220355	11"	50	43
220356	11-1/4"	50	28
220357	11-1/2"	50	28
220358	11-3/4"	50	30
220359	12"	50	27
220360	12-1/4"	50	30
220361	12-1/2"	50	30
220362	12-3/4"	50	32
220363	13"	50	31
220364	13-1/4"	50	33
220365	13-1/2"	50	32
220366	13-3/4"	50	33
220367	14"	25	25



Hy-Chair (PHC)

Meets all requirements and qualifies as a CRSI Class 1 Bar Support.

Aztec® Straddle Chair - PSC



APPLICATION:

Single Mat-Rebar or Wire Mesh, Bottom Layer Double Mat-Rebar or Wire Mesh, Tilt Wall, Side-Form Spacer, On-Grade: when used with Sand Plate

COVER HEIGHT:

From 3" to 7-3/4"

FEATURES

- Fits rebar #3 to #11
- Minimal footprint with staple down feature
- With 2 sizes per chair
- Straddles lower rebar mat

PRODUCT CODE	COVER	QTY/ BOX	WT.LBS. PER BOX
127714	3" - 3-1/4"	250	31
127715	3-1/2" - 3-3/4"	200	28
127716	4" - 4-1/4"	200	31
127717	4-1/2" - 4-3/4"	200	34
127718	5" - 5-1/4"	150	27
127719	5-1/2" - 5-3/4"	150	33
127720	6" - 6-1/4"	150	36
127721	6-1/2" - 6-3/4"	150	41
127722	7" - 7-1/4"	125	40
127723	7-1/2" - 7-3/4"	125	42



Meets all requirements and qualifies as a CRSI Class 1 Bar Support.

Aztec® Tower Chair™ Sand Plate - PTCSP



APPLICATION:

On-Grade, DOT

COVER HEIGHT:

Fits 2-3/4" to 10" Tower Chair/Hy-Chair

FEATURES:

- 5" x 5" Plate Dimensions

PRODUCT CODE	FITS SIZES	QTY/ BOX	WT. LBS. PER BOX
122826	2-3/4" - 14"	200	16



Aztec® Castle Chair™ - PCC

APPLICATION:

On-Grade, Single Mat Rebar or Wire Mesh, Bottom Layer Double Mat Rebar or Wire Mesh, Precast, Tilt-Wall, Insulated "Sandwich" Panels

COVER HEIGHT:

From 1-1/2" to 6-1/4" (1/4" increments)

FEATURES:

- Heavy-duty, stackable design
- Fits up to #8 rebar
- Perfect for use on insulating foam or nonpenetrable vapor barriers
- Most stable on-grade chair available
- Supports over 500 lbs
- Each chair comes in two height combinations reducing inventory

PRODUCT CODE	COVER	QTY/BOX	WT. LBS. PER BOX
122835	1-1/2" - 1-3/4"	300 pieces	22
220334	2" - 2-1/4"	400 pieces 24 bags w/ 20 per bag	34
121284	2" - 2-1/4"	480 pieces	38
122837	2-1/2" - 2-3/4"	350 pieces	37
123480	3" - 3-1/4"	288 pieces 12 bags w/ 24 per bag	32
121285	3" - 3-1/4"	288 pieces	32
122839	3-1/2" - 3-3/4"	250 pieces	34
122840	4" - 4-1/4"	200 pieces	38
123562	4-1/2" - 4-3/4"	125 pieces	22
123563	5" - 5-1/4"	100 pieces	20
123564	5-1/2" - 5-3/4"	225 pieces	49
123565	6" - 6-1/4"	200 pieces	45



Round Base



Square Base

Meets all requirements to qualify as a CRSI Class 1 Bar Support.

- Castle Chairs 1-1/2" to 4-1/4" tall have a round base
- Castle Chairs 4-1/2" to 6-1/4" tall have a square base

Aztec® Paving/Sand Chair - PPSC

APPLICATION:

On-Grade, D.O.T.

COVER HEIGHT:

Fits 1-1/2" to 6"

FEATURES:

Ideal for highway paving applications

Meets all requirements to qualify as a CRSI Class 1 Bar Support.

PRODUCT CODE	COVER	BAR SIZE	QTY/BOX	WT. LBS. PER BOX
123585	1 - 1-1/2"	#3 - #4	2200	26
123586	2"	#3 - #4	1250	27
123587	3"	#3 - #4	550	23
123588	4"	#3 - #4	240	22
123589	5"	#3 - #5	170	19
123590	6"	#3 - #5	100	14



5" and 6" Sizes

Aztec® X-Chair™ - PXC

APPLICATION:

Elevated Slabs, Precast

COVER HEIGHT:

From 1/2" to 2"

FEATURES:

- Superior strength
- Modest surface contact
- Supports rebar and mesh

PRODUCT CODE	COVER	BAR SIZE	QTY/BOX	WT. LBS. PER BOX
122830	1/2"	#3 - #7	3500	28
122831	3/4"	#3 - #7	2200	25
122832	1"	#3 - #7	1700	25
122833	1-1/2"	#3 - #7	1500	38
122834	2"	#3 - #7	1100	36



Meets all requirements to qualify as a CRSI Class 1 Bar Support.

Aztec® Snap-On Chair - PSN



APPLICATION:

Precast

COVER HEIGHT:

From 3/4" to 2"

FEATURES:

Designed to fit both small diameter rebar and most diameters of welded wire fabric

PRODUCT CODE	COVER	BAR SIZE	MESH DIA>	QTY/BOX	WT. LBS. PER BOX
123591	3/4"	#2 - #4	ALL	2400	30
123592	1"	#2 - #4	ALL	1700	22
123593	1-1/2"	#3 - #6	—	950	22
123594	2"	#3 - #6	—	600	16



Meets all requirements to qualify as a CRSI Class 1 Bar Support.

Aztec® On Grade Mesh Chair - PPMC



APPLICATION:

On grade

COVER HEIGHT:

2"

FEATURES:

- Lightweight plastic
- Lock reinforcing mesh in place
- Large footprint for good stability on various base materials
- Cost effective
- Easy to handle
- Efficient application

PRODUCT CODE	COVER	QTY/BOX	WT. LBS. PER BOX
125310	2"	800	62



Meets all requirements to qualify as a CRSI Class 1 Bar Support.

Aztec® Utility Chair - PSUT



APPLICATION:

Precast

COVER HEIGHT:

1-1/2"

FEATURES:

- Designed to fit #3 and #4 rebar
- Snap-on design eliminates the need to tie the support to the reinforcement
- Available for 1-1/2" cover

PRODUCT CODE	COVER	QTY/BOX	WT. LBS. PER BOX
220211	1-1/2"	1900	22



Meets all requirements to qualify as a CRSI Class 1 Bar Support.

Aztec® Post-Tension Cable Intersectional Chair™ - PPT



APPLICATION:

Post Tension, On-Grade

COVER HEIGHT:

From 1-1/2" to 3" (1/2" increments)

FEATURES:

- Designed for PT strand with 50 mil sheathing thickness
- Four posts securely fasten at the intersection of two cables

PRODUCT CODE	COVER	CABLE SIZE	QTY/BOX	WT. LBS. PER BOX
123596	1-1/2"	1/2"	500	22
123597	2"	1/2"	225	21
123598	2-1/2"	1/2"	250	26
123599	3"	1/2"	175	12



Meets all requirements to qualify as a CRSI Class 1 Bar Support.

Aztec® Plastic Foam Anchor - PFA

APPLICATION:

Single, multi-layer foam anchor applications

COVER HEIGHT:

6"

FEATURES:

- Spreaded top for easy penetration
- Button head design keeps the mesh firmly in place over the foam panel

PRODUCT CODE	COVER	QTY/BOX
123569	6"	1250



Aztec® E-Z Bolt Holder - PEZBH

APPLICATION:

Support for threaded bolt at multiple heights

BOLT HEIGHT:

2" to 10"

FEATURES:

- Large foot for superior stability
- Adjustable heights in same part
- Nailing holes for attachment to plywood
- Locking ring for secure bolt connection

SIZE	PRODUCT CODE
8-1/4"	123567



Plastic Individual Supports

Aztec® Dowel Chair and Cap - PDCC

APPLICATION:

D.O.T. Retro-fit

COVER HEIGHT:

5/8" only

FEATURES:

- Engineered specifically for highway retro-fit applications
- D.O.T. approved (in most states)
- Fits 1-1/4" and 1-1/2" epoxy-coated steel dowels
- Single unit includes chair and end cap
- Two units are required per dowel

PRODUCT CODE	COVER	BAR SIZE	QTY/BOX	WT. LBS. PER BOX
220110	5/8"	1-1/4"	500	32
220111	5/8"	1-1/2"	500	32



Aztec® Screed Chair - PAS

APPLICATION:

Elevated Slab, Slab on Grade

FEATURES:

- Fits 2x4 lumber or 1-1/2" diameter pipe screeds
- Includes a base, adjustable ring and a screed receiver
- Designed to allow up to ±1" in height adjustment
- 1" O.D. PVC pipe (not included) can be cut to any height
- 300 lb. safe working load compression

PRODUCT CODE	QTY/BOX	WT. LBS. PER BOX
123568	100	17



Aztec® StrongBack Slab / Beam Bolster™ - PSBB

APPLICATION:

Elevated Slab, Tilt-Wall, Precast, Post-Tension, Parking Garage Decks, Side-Form Spacer



COVER HEIGHT:

From 3/4" to 3" (1/4" Increments)

FEATURES:

- High load strength and impact resistant
- Qualifies for use as a Beam Bolster with 2-1/2" leg spacing
- Can be used individually or locked together to create any length
- Manufactured in 30" lengths in standard boxes
- Special packaging available in 5' or 10' sections, bundled and palletized



Meets all requirements to qualify as a CRSI Class 1 Bar Support.

Product Code	Cover	Length	FT/Box
123570	3/4"	2-1/2'	250
220147	3/4"	5'	50
220148	3/4"	10'	100
123571	1"	2-1/2'	225
220149	1"	5'	50
220150	1"	10'	100
123572	1-1/4"	2-1/2'	225
220151	1-1/4"	5'	50
220152	1-1/4"	10'	100
123573	1-1/2"	2-1/2'	200
220153	1-1/2"	5'	50
220154	1-1/2"	10'	100
123574	1-3/4"	2-1/2'	150
220155	1-3/4"	5'	50
220156	1-3/4"	10'	100
123575	2"	2-1/2'	150
220157	2"	5'	50
220158	2"	10'	100
123576	2-1/4"	2-1/2'	125
220160	2-1/4"	10'	100
123577	2-1/2"	2-1/2'	100
220161	2-1/2"	5'	50
220490	2-1/2"	10'	100
123578	2-3/4"	2-1/2'	100
220491	2-3/4"	5'	100
123579	3"	2-1/2'	100
220163	3"	5'	50
220164	3"	10'	100

Aztec® StrongBack SBU™ Slab Bolster Upper - PSBU

APPLICATION:

Supports top layer in Double Mat application, Rebar or Wire Mesh, Slabs, Heavy Duty On-Grade, Corrugated Decking, Side-Form Spacer-below-grade applications only, Precast

COVER HEIGHT:

From 1" to 5" (1/4" increments)

FEATURES:

- Designed for use with Epoxy-Coated/FRP/ Stainless Steel/Galvanized rebar
- For use in corrosive environments
- Spans corrugations in elevated deck applications
- Suitable for use on Vapor Barriers or Insulating Foam
- No overlap required
- Manufactured in 30" lengths in standard boxes
- Special packaging available in 5' or 10' sections, bundled and palletized
- Strong as metal SBU

Product Code	Cover	Length	FT/Box
220165	1"	2-1/2'	100
220465	1"	5'	50
220335	1-1/4"	2-1/2'	100
220166	1-1/2"	2-1/2'	75
220469	1-1/2"	5'	50
129300	1-1/2"	10'	100
220312	1-3/4"	2-1/2'	75
220470	1-3/4"	5'	50
127513	1-3/4"	5'	100
220167	2"	2-1/2'	75
220471	2"	5'	50
220313	2-1/4"	2-1/2'	75
220297	2-1/2"	2-1/2'	50
220314	2-3/4"	2-1/2'	50
220474	2-3/4"	5'	50
126514	2-3/4"	10'	100
220296	3"	2-1/2'	50
220451	3"	5'	50
143437	3"	10'	100
220315	3-1/4"	2-1/2'	50
220475	3-1/4"	5'	50
220384	3-1/2"	2-1/2'	50
220476	3-1/2"	5'	50
220461	3-3/4"	2-1/2'	50
143440	3-3/4"	10'	100
220382	4"	2-1/2'	50
143441	4"	10'	100
220462	4-1/4"	2-1/2'	35
220479	4-1/4"	5'	50
143442	4-1/4"	10'	100
220385	4-1/2"	2-1/2'	35
220480	4-1/2"	5'	50
143443	4-1/2"	10'	100
220463	4-3/4"	2-1/2'	35
220481	4-3/4"	5'	50
143444	4-3/4"	10'	100
220386	5"	2-1/2'	35
220482	5"	5'	50
143445	5"	10'	100

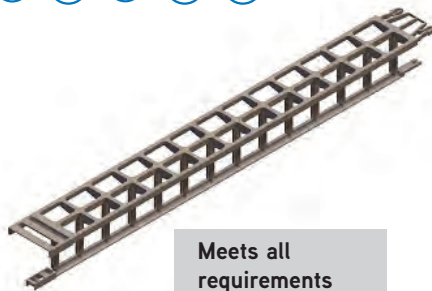

Meets all requirements to qualify as a CRSI Class 1 Bar Support.

Plastic Continuous or Side Supports

Aztec® E-Z Lok Slab Bolster™ - PSB



PATENTED

APPLICATION:

Precast

(For Slabs, Side-Form Spacers, Tilt-Wall and D.O.T. applications, refer to STRONG-BACK BOLSTER™)

COVER HEIGHT:

From 3/4" to 3"

FEATURES:

- Manufactured in 32" lengths in standard boxes
- Can be used individually or snapped together to create any length
- Capable of bending to 180 degrees
- Simple to install, non-corrosive and lightweight

PRODUCT CODE	COVER	FT./BOX	QTY/BOX	WT. LBS. PER BOX
78016	3/4"	325	122	31
78026	1"	293	110	32
78036	1-1/4"	267	100	31
129418	1-3/8"	220	88	29
78046	1-1/2"	213	80	26
78056	1-3/4"	213	80	28
78066	2"	160	60	22
78076	2-1/4"	133	50	20
78086	2-1/2"	133	50	23
78091	2-3/4"	133	50	25
78096	3"	133	50	25



Meets all requirements to qualify as a CRSI Class 1 Bar Support.

Aztec® Space Wheel - PSW



APPLICATION:

Side-Form Spacer

COVER HEIGHT:

From 3/8" to 3"

FEATURES:

- Designed to fit a wide range of bar and wire mesh sizes
- Minimal surface contact
- Standard "Concrete Gray" color
- Lightweight

Please note: Concrete cover is defined as the distance from where the reinforcement sits in the hub of the wheel to the outside of the wheel (where it contacts the form).

Meets all requirements and qualifies as a CRSI Class 1 Bar Support.

PRODUCT CODE	COVER	BAR SIZE	MESH DIA.	QTY/BOX	WT. LBS. PER BOX
121314	3/8"	Fits Mesh	ALL	4000	20
121315	1/2"	Fits Mesh	ALL	3000	21
121316	3/4"	up to #2	ALL	1600	20
121317	3/4"	Fits #2-#4	—	1150	19
121318	1"	up to #2	ALL	900	20
121319	1"	Fits #3-#6	—	500	26
121320	1-1/4"	up to #2	ALL	600	15
121321	1-1/4"	Fits #3-#6	—	375	20
121322	1-1/2"	up to #2	ALL	400	14
121323	1-1/2"	Fits #3-#6	—	300	14
121324	2"	up to #2	ALL	250	13
121325	2"	Fits #3-#6	—	350	24
121326	2-1/2"	up to #2	ALL	350	23
121327*	3"	up to #2	ALL	200	19
121328	3"	Fits #3-#6	—	200	18

* Note: Overall diameter is 6"



Aztec® E-Z Lok Wheel™ - PLW



APPLICATION:
Side-Form Spacer

COVER HEIGHT:
From 1-1/2" to 6-1/2"

FEATURES:

- Multiple hub diameter for rebar sizes #3 to #11
- Designed for medium to heavy duty projects
- Wider locking hub eliminates "racking" and will not fall off
- Industry choice for use in heavy columns
- Once locked onto rebar, this wheel will not change shape and will always provide uniform cover

PRODUCT CODE	STANDARD/HEAVY DUTY	COVER	BAR SIZE	QTY/BOX	WT. LBS. PER BOX
122841	STD	1-1/2"	#3 / #4	300	19
122842	STD	1-1/2"	#5 / #6	290	19
122843	HD	1-1/2"	#3 / #4	200	25
122844	HD	1-1/2"	#5 / #6	200	23
220392	STD	2"	#3 / #4	150	22.5
220388	STD	2"	#5 / #6	200	23
122845	HD	2-1/2"	#3 / #4	75	20
122846	HD	3"	#3 / #4	50	16
122847	HD	3"	#5 / #6	50	17
220389	HD	4"	#5 / #6	50	17
220391	HD	4"	#8	50	23.5
143316	HD	4-1/2"	#9	40	21.6
143428	HD	4-1/2"	#11	40	21.6
143317	HD	5-1/2"	#9	30	19.5
143429	HD	5-1/2"	#11	30	19.5
143318	HD	6-1/2"	#9	25	24
143430	HD	6-1/2"	#11	25	24



Please note: Concrete cover is defined as the distance from where the reinforcement sits in the hub of the wheel to the outside of the wheel (where it contacts the form).

Meets all requirements and qualifies as a CRSI Class 1 Bar Support.

BarTender™ Plastic Foundation Wheel - PFW



DESCRIPTION:

The PFW BarTender Plastic Foundation Wheel is a plastic, locking wheel used to position reinforcing steel. It consists of a sturdy wide outer diameter, an inner collar, structural spokes, and an integral locking mechanism. The PFW is made in the USA.

FEATURES:

- Meets ACI 301 compliance
- Integrated locking mechanism
- Wide outer diameter
- Structural spokes

APPLICATION:

The PFW BarTender is used to maintain the concrete cover around the diameter of a drilled shaft, rebar cage. It may also be used within a caisson ring for the same purpose.

PRODUCT CODE	DESCRIPTION	COVER	WEIGHT
145202	5.6" O.D. #3 [10MM] to #7 [22MM]	2.3"	.29 LB
145203	6.0" O.D. #3 [10MM] to #7 [22MM]	2.5"	.32 LB
145204	8.5" O.D. #3 [10MM] to #7 [22MM]	3.5"	.47 LB
145205	10.8" O.D. #3 [10MM] to #7 [22MM]	4.9"	.71 LB



Plastic Continuous or Side Supports

ReBoot™ Plastic Foundation Boot - PFB



DESCRIPTION:

The PFB ReBoot Plastic Foundation Boot is a plastic, attachable boot used to position reinforcing steel. It consists of a fingered hole, structural base, and large bearing foot. The PFB is made in the USA.

FEATURES:

- Tight fitting rebar fingers
- I-beam constructed base
- Wide bearing foot

PRODUCT CODE	DESCRIPTION	COVER	WEIGHT
145201	#6 [19 MM] to #18 [57MM]	3"	.371 LB



APPLICATION:

The PFB ReBoot is used to maintain the concrete cover from the ends of vertical bars of a drilled shaft, rebar cage. It may also be used within a caisson ring for the same purpose.

Plain Dobies - CPD

APPLICATION:

On-Grade or Below grade, D.O.T. Approved (in most states)

COVER HEIGHT: From 1" to 18"

FEATURES:

- Particularly suited for on-grade reinforcement
- Custom sizes and configurations available upon request
- Standard 4000 PSI. Additional strength available.

Meets all requirements and qualifies as a CRSI Class 1 Bar Support.



PRODUCT CODE	SIZE	COVER
STANDARD		
123710	2" X 2" X 1"	1"
123711	2" X 2" X 1-1/2"	1-1/2"
123713	2" X 2" X 2"	2"
123714	3" X 3" X 2"	2" OR 3"
123715	3" X 3" X 3"	3"
123716	3" X 5" X 5"	3" OR 5"
220010	3" X 3" X 6"	3"
220026	6" X 6" X 6"	6"
220028	3" X 3" X 7"	7"
220032	3" X 3" X 7-1/2"	3"
220036	3" X 3" X 8"	3"
220042	3" X 3" X 9"	3"
220048	3" X 3" X 10"	3"
220054	3" X 3" X 12"	3"
220059	3" X 3" X 14"	3"
220069	3" X 3" X 18"	3"
HEAVY DUTY		
220371	3 x 3 x 2	2" or 3"
220376	3 x 3 x 3	3"

Wire Dobies - CWD

APPLICATION:

On-Grade or Below-Grade, Metal Decks, Side-Form Spacers, Pools, D.O.T. Approved (in most states)

COVER HEIGHT: From 3/4" to 5"

FEATURES:

- Furnished with two 16 gauge wires for secure attachment
- Custom sizes and configurations available upon request
- Standard 4000 PSI. Additional strength available.



PRODUCT CODE	SIZE	COVER
STANDARD		
123700	2" X 2" X 3/4"	3/4"
123701	2" X 2" X 1"	1"
123702	2" X 2" X 1-1/2"	1-1/2"
123704	2" X 2" X 2"	2"
123706	2" X 3" X 3"	2" OR 3"
123705	2-1/2" X 2-1/2" X 2-1/2"	2-1/2"
123707	3" X 3" X 3"	3"
123708	3" X 3" X 4"	4"
220108	3" X 4" X 5"	3", 4" OR 5"
HEAVY DUTY		
220096	2" X 2" X 1-1/2"	1-1/2"
220099	2" X 2" X 2"	2"
220105	3" x 3" x 3"	3"

Meets all requirements and qualifies as a CRSI Class 1 Bar Support.

Combination Dobie - CCD



APPLICATION:

On-Grade or Below-Grade, D.O.T. Approved (in most states)

COVER HEIGHT:

Multi-cover heights

FEATURES:

- Designed with multiple heights within a single unit
- Standard 4000 strength. Additional strength available.



PRODUCT CODE	SIZE	COVER
STANDARD		
123718	2" X 2" X 2-1/2"	1-1/2", 2", OR 2-1/2"
123719	3" X 3" X 4"	2-1/2", 3", 3-1/2", OR 4"

Meets all requirements and qualifies as a CRSI Class 1 Bar Support.

Dowel Dobies - CDD



APPLICATION:

On-Grade or Below-Grade, DOT approved in most states.

COVER HEIGHT:

3" to 5" in 1/2" increments

FEATURES:

- Standard 4000 psi strength
- Additional strengths available
- Dowel hole to accept #3 or #4 rebar

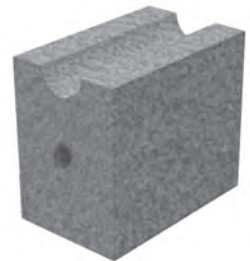

PRODUCT CODE	SIZE	COVER
STANDARD		
123720	3" X 3" X 4"	3", 3-1/2", or 4"
123721	3" X 3" X 5"	3", 4", 4-1/2", or 5"
HEAVY DUTY		
220369	3" X 4" X 5"	3", 4", 4-1/2", or 5"

Premium Tie Wire - WTW



DESCRIPTION:

The WTW Premium Tie Wire is soft, annealed, small diameter wire designed to fit nearly every type of tie wire reel. It consists of clean, spooled wire formed around a square arbor for easy retraction.

FEATURES:

- Soft, annealed composition
- Clean, smooth finish
- Square wound

APPLICATION:

The WTW Premium Tie Wire is used to create a tie wire connection at rebar intersections.



PRODUCT CODE	DESCRIPTION	WEIGHT
145384	16 GA	72 LB

	<div data-bbox="662 258 1333 352"> WARNING</div> <div data-bbox="613 380 1382 453"><h3>Improper Use of Concrete Accessories Can Cause Severe Injury or Death</h3></div> <div data-bbox="574 462 1424 596"><p>Read, understand and follow the information and instructions in this publication before using any of the Dayton Superior concrete accessories displayed herein. When in doubt about the proper use or installation of any Dayton Superior concrete accessory, immediately contact the nearest Dayton Superior Service Center or Technical Service Department for clarification. See back cover for your nearest location.</p></div>
---	--

Dayton Superior products are intended for use by trained, qualified and experienced workers only. Misuse or lack of supervision and/or inspection can contribute to serious accidents or deaths. Any application other than those shown in this publication should be carefully tested before use. The user of Dayton Superior products must evaluate the product application, determine the safe working load and control all field conditions to prevent applications of loads in excess of a product's safe working load. Safety factors shown in this publication are approximate minimum values. The data used to develop safe working loads for products displayed in this publication are a combination of actual testing and/or other industry sources. Recommended safe working loads given for the products in this publication must never be exceeded.

Worn Working Parts

For safety, concrete accessories must be properly used and maintained. Concrete accessories shown in this publication may be subject to wear, overloading, corrosion, deformation, intentional alteration and other factors that may affect the device's performance. All reusable accessories must be inspected regularly by the user to determine if they may be used at the rated safe working load or should be removed from service. The frequency of inspections depends upon factors such as (but not limited to) the amount of use, period of service and environment. It is the responsibility of the user to schedule accessory hardware inspections for wear and remove the hardware from service when wear is noted.

Shop or Field Modification

Welding can compromise a product's safe working load value and cause hazardous situations. Knowledge of materials, heat treating and welding procedures is necessary for proper welding. Consult a local welding supply dealer for assistance in determining required welding procedures. Since Dayton Superior cannot control workmanship or conditions in which modifications are done, Dayton Superior cannot be responsible for any product altered in the field.

Interchangeability

Many concrete accessory products that Dayton Superior manufactures are designed as part of a system. Dayton Superior strongly discourages efforts to interchange products supplied by other manufacturers with components supplied by Dayton Superior. When used properly, and in accordance with published instructions, Dayton Superior products have proven to be among the best designed and safest in the industry. Used improperly or with incompatible components supplied by other manufacturers, Dayton Superior products or systems may be rendered unsafe.

Installation

WARNING

1. Dayton Superior Corporation products shall be installed and used only as indicated on the Dayton Superior Corporation installation guidelines and training materials.
2. Dayton Superior Corporation products must never be used for a purpose other than the purpose for which they were designed or in a manner that exceeds specific load ratings.
3. All instructions are to be completely followed to ensure proper and safe installation and performance.
4. Any improper misuse, misapplication, installation, or other failure to follow Dayton Superior Corporation's instruction may cause product malfunction, property damage, serious bodily injury and death.

THE CUSTOMER IS RESPONSIBLE FOR THE FOLLOWING:

1. Conformance to all governing codes
2. Use of appropriate industry standard hardware
3. The integrity of structures to which the products are attached, including their capability to safely accept the loads imposed, as evaluated by a qualified engineer.

SAFETY INSTRUCTIONS:

All governing codes and regulations and those required by the job site must be observed. Always use appropriate safety equipment

Design Changes

Dayton Superior reserves the right to change product designs, rated loads and product dimensions at any time without prior notice.

Note: See Safety Notes and Safety Factor Information.



DAYTON[®]
SUPERIOR

125 Byers Road
Miamisburg, OH 45342
937-866-0711
888-977-9600
WWW.DAYTONSUPERIOR.COM

**BUILDING
STRENGTH™**

DS98
01/19

Copyright © 2018 Dayton Superior Corporation, All Rights Reserved.