

# Set up Voicemail from your home phone

AT&T U-verse Voicemail incorporates the latest technology to save you time and money, no matter where you are or how you communicate.

## To set up your voicemail from your home phone:

1. Dial \*98 (or dial your home phone number).
2. Follow the prompts to set-up your mailbox.
3. After creating your PIN, be sure to set-up your authentication code. This will allow you to reset your PIN over the phone if you forget it.

After you have set up your voice mailbox, visit [att.com/vmviewer](http://att.com/vmviewer) for the option of automatic delivery of your voicemail messages to your qualifying Wi-Fi device or computer.

By downloading the AT&T Voicemail Viewer App, you can check your voicemail messages visually, choosing the order in which you listen to them or even reading your messages as voicemail-to-text.

## Manage your U-verse Phone and Voicemail features

### To manage Phone Features online:

1. Log in to your online account at [att.com/myatt](http://att.com/myatt)
2. Click on HOME PHONE
3. Click on MANAGE VOICE FEATURES

### To manage Voicemail Features online:

1. Log in to your online account at [att.com/myatt](http://att.com/myatt)
2. Click on HOME PHONE
3. Click on CHECK VOICEMAIL
4. Click on VOICEMAIL SETTINGS

For more information on managing Phone Features or Voicemail Settings go to [att.com/uvfeatures](http://att.com/uvfeatures).

## Having trouble? Here are a few common issues to check:

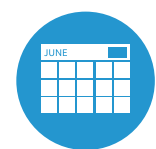

### What is your service activation date?

Do not attempt to install your service until **8pm or later** on your service activation date. You can find this date on your packing slip.



### Did you make the mandatory activation call?

You must complete activation for your AT&T U-verse Voice service to work correctly. See step 3.

Still having problems? Many issues can be resolved with three simple steps:



### 1. Check your connections.

Check all cables and cords to ensure they are connected properly and securely.



### 2a. Power down, power up.

Unplug the BBU power cord from the back of the Wi-Fi Gateway. Leave the Wi-Fi Gateway unplugged for 15 seconds and plug it back in.

### 2b. Wait for blinking indicator lights.

You may need to wait up to two minutes for blinking indicator lights to turn solid green.

## Need more help?

**Go online:** Visit [att.com/versesupport](http://att.com/versesupport).

**Call us:** Dial **1.800.288.2020** and ask for "U-verse technical support."

**¿Habla español?** Por favor visite [att.com/uversequias](http://att.com/uversequias) para ver la información en español. También pueden ver la siguiente guía: ATT122090839 (UV Double Play Internet + Voice) para más detalles.



## AT&T U-verse® Voice and High Speed Internet Wi-Fi Gateway

self-installation guide

### Before installation:

Do not attempt to install your service until your service activation date. You can find this date on your packing slip.



## Get started

Approximate installation time: 55 minutes

### Before you begin:



#### 1. Check your service activation date.

Do not attempt to install your services until **8pm or later** on the date provided to you by AT&T. This date is also located on your packing slip.



#### 2. Do you have a monitored home security system or health alarm?

See "Specific Issues" on the back of this guide.

### In the box:



5031 Wi-Fi Gateway

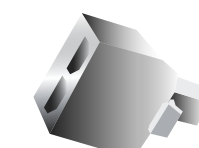

Voice Line Splitter



1 Ethernet cable



1 data cable



Battery Backup Unit (BBU)

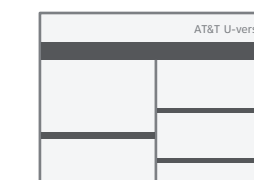

Packing slip



Your 4-digit passcode. You received a separate letter confirming the 4-digit passcode you designated when placing your order.

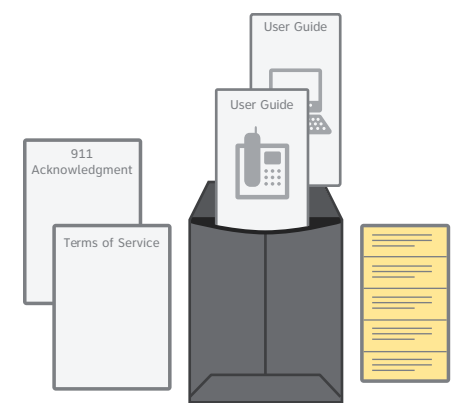

911 Acknowledgment form  
Terms of Service  
AT&T U-verse Voice User Guide  
AT&T High Speed Internet User Guide  
911 stickers

Images are not to scale.



# 1 Set up Approximate time: 10 minutes

**A** Connect the green data cable from the Wi-Fi Gateway's DSL Broadband port to your wall jack.

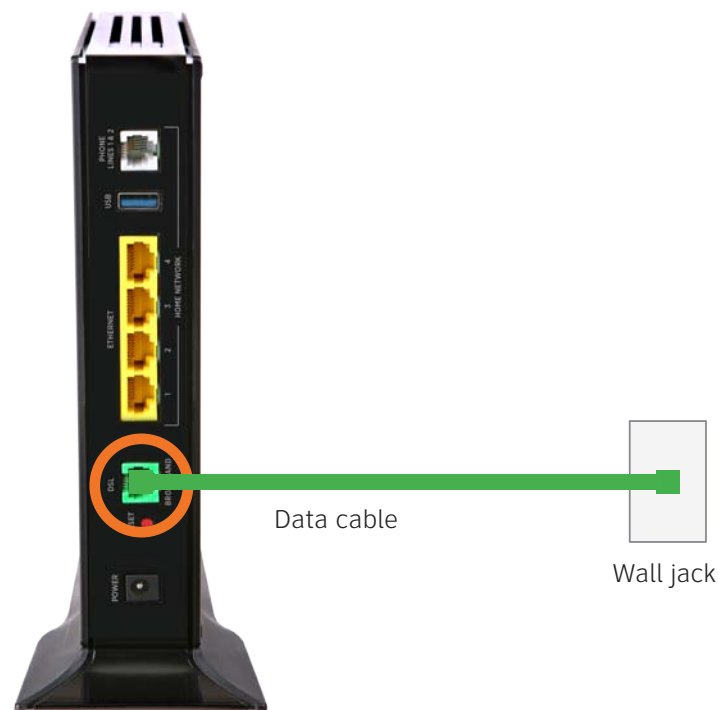

**B** Remove the sticker covering the Power port. Connect the yellow Ethernet cable from the Wi-Fi Gateway's Ethernet port to your computer's Ethernet port.

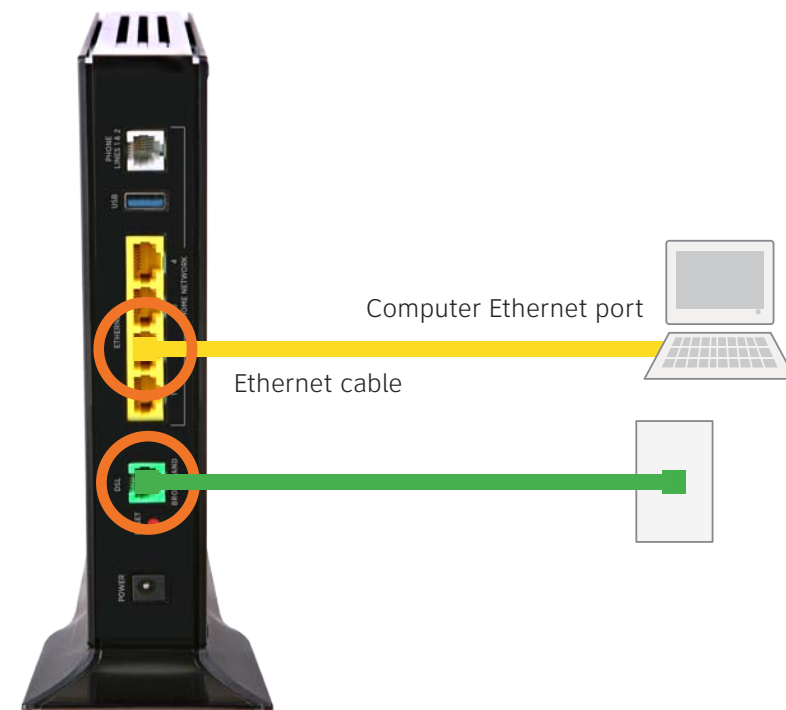

**C** Connect the Battery Backup Unit (BBU) to the Wi-Fi Gateway's Power port. Plug the BBU into a standard electrical outlet only. **Wait until step 2 to power up the BBU.**

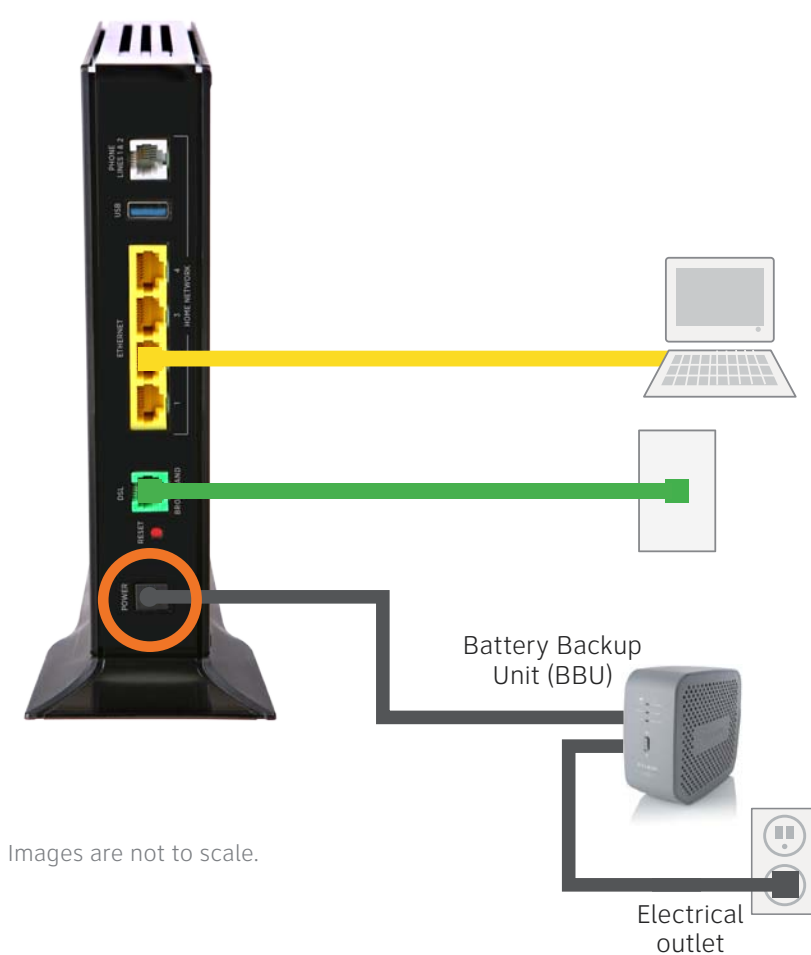

Images are not to scale.

**D** Plug one end of your phone cable into the Wi-Fi Gateway's Phone Lines 1 & 2 port and the other end into a standard phone or cordless base station.

A Voice Line Splitter is required if you have two AT&T U-verse Voice lines.

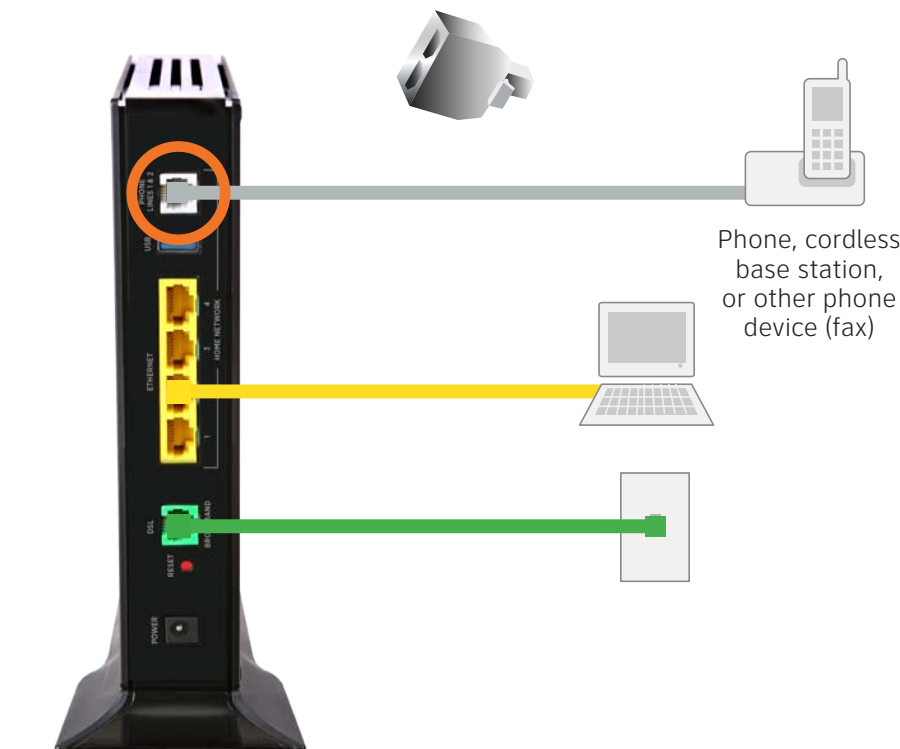

**!** For best results, connect only the devices and power supply depicted above.

# 2 Power up Approximate time: 15 minutes

- Move the switch on the back of the Battery Backup Unit (BBU) to the "on" position.
- Your Wi-Fi Gateway is now powering up. Wait up to five minutes for the Broadband and Service indicator lights to turn solid green.

- !** During this time, do not unplug the BBU or green data cable, as this can permanently damage the gateway and significantly delay your Service Activation.
- If the Broadband and Service lights do not turn solid green or continue to blink after 15 minutes, see the "Having Trouble?" section on the back of this guide.

**Note:** The BBU must be charged for approximately 18 hours before it is fully operational; however installation of your service may continue while the BBU is charging. The BBU may emit a beeping sound while charging.

**!** Important: You will have a dial tone after completing step 2, but will only be able to make emergency and toll-free calls until you activate your service in step 3.

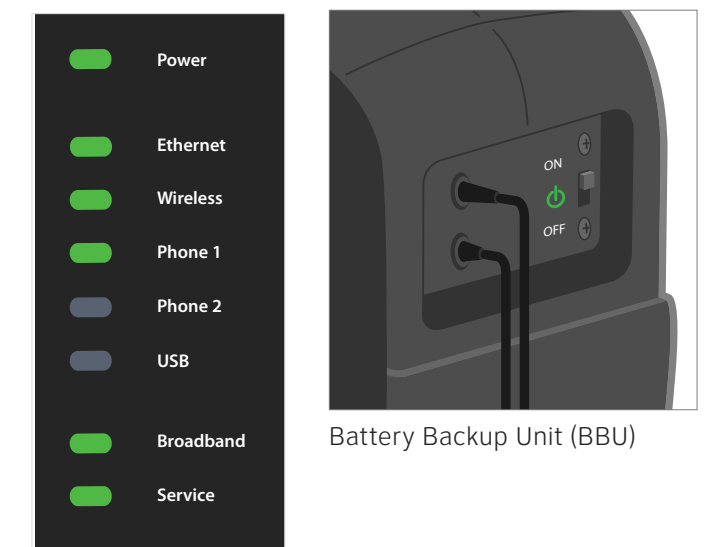

Wi-Fi Gateway indicator lights

Battery Backup Unit (BBU)

# 3 Register (required)

Approximate time: 20 minutes

**Note:** You must complete both activation steps in order to use your Internet and Voice services.

**A** Open your Internet browser (e.g., Internet Explorer, Safari, etc.):

- The online registration process will start automatically to help you activate your Internet and Voice services. If it doesn't start, enter **att.net/uverse** into your address bar.
- Continue your online registration using the **4-digit passcode** you created when you placed your order—it was mailed to you separately for your reference.

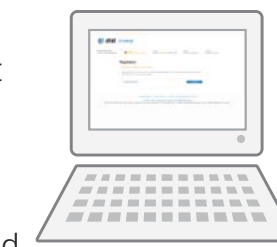

**B** To activate your Voice service to make calls:

Call **1.877.377.0016** from the phone you set up in step 1, and follow the voice instructions to complete the activation.

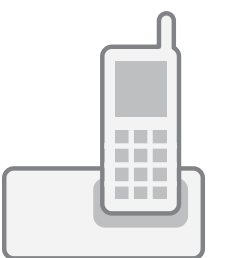

**Upon successful activation, you will hear the following:**  
"Your telephone number XXX.XXX.XXXX has been successfully activated."

# 4 Go Wi-Fi (optional)

Approximate time: 10 minutes

Write down the Wi-Fi Network Name (SSID) and Wi-Fi Password (Wireless Network Key) to configure additional Wi-Fi devices. This information is on the side of your Wi-Fi Gateway. The Wi-Fi Network Name consists of "ATT" plus the last three digits of the Wi-Fi Gateway's serial number. Be sure to record this information in the form below.

**Now configure your Wi-Fi network:**

- Go to your computer's "Wireless Network Settings" and refresh the network list.
- Select your Wi-Fi Network Name (SSID) from the list. You may need to scroll through the list to find your SSID.
- Enter the 10-digit Wi-Fi Password (Wireless Network Key) in the Password field to connect to your network.

**Congratulations! You should now be connected to the Internet via Wi-Fi.**

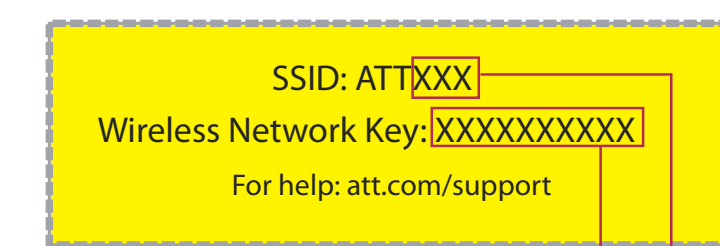

Wi-Fi Network Name (SSID)  
A T T [ ] [ ] [ ]

10-digit Wi-Fi Password (Wireless Network Key)  
[ ] [ ] [ ] [ ] [ ] [ ] [ ] [ ] [ ] [ ]

**Note:** Label is removable for safekeeping.



## Questions?

**Go online:** Visit [att.com/uversesupport](http://att.com/uversesupport).

To learn more about the benefits and features of your AT&T U-verse service, visit [att.com/u-verse/newcustomer](http://att.com/u-verse/newcustomer).

## Stay connected on the go!

AT&T Wi-Fi Basic is included with your AT&T U-verse High Speed Internet service, so you can access the Internet at thousands of AT&T Wi-Fi Hot Spots across the country. Visit [attwifi.com](http://attwifi.com) to learn more.

