



Wireless Doorbell Kit

Model: DC817B

Instruction Manual

Product Overview

Speaker unit (x 2)

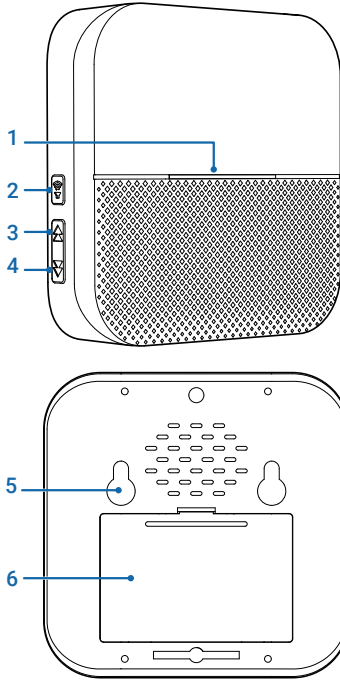

Doorbell unit

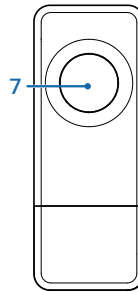

- 1 LED Indicator
- 2 Volume Button
- 3 Previous Melody Select Button
- 4 Next Melody Select Button
- 5 Keyhole Slots (for mounting screws)
- 6 Battery Compartment
- 7 Doorbell Button / LED Indicator

Battery Installation

Speaker

Each Speaker requires 3 x AAA size batteries (not included) to operate.

1. Open the battery compartment cover on the rear of the Speaker.
2. Insert batteries according to the polarity markings (+ and -) indicated inside the battery compartment, as shown on the right. For reliable, long-lasting performance, use high quality alkaline batteries only.
3. Replace the battery compartment cover.

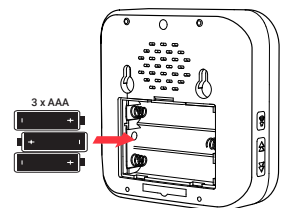

Doorbell

The Doorbell is powered by one "A23" battery which comes preinstalled.

To activate the battery, simply pull the plastic tab out from the side of the Doorbell unit.

Battery replacement is necessary as soon as the LED indicator stops flashing when the Doorbell button is pressed. To replace the battery, insert a small flat-head screwdriver into the small notch at the base and lift the back cover off, as shown on the right. Replace with a battery of the same type (A23). Make sure the battery is installed according to the polarity markings (+ and -) shown in the battery holder before replacing the cover.

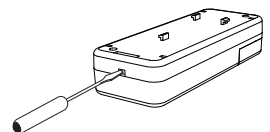

Melody Selection & Pairing

You can personalize the melody played on each Speaker when the Doorbell button is pressed. To select a melody and pair a Speaker with the Doorbell:

1. Press the **Previous** or **Next Melody Select** button repeatedly on the Speaker to cycle through the available sounds. Stop when you hear something you like.
2. Press and hold the **Volume** button on the Speaker for about 5 seconds, until a quick tone is heard and the LED indicator starts blinking. The Speaker is now in pairing mode.
3. Within 5 seconds, press the Doorbell button. The Speaker will confirm pairing by playing the selected melody. If pairing is not completed within 5 seconds, a quick tone is heard and the LED indicator stops blinking on the Speaker. In this case, you will need to repeat steps 2-3 to try pairing again.
4. Repeat the steps above to pair the additional Speaker with the Doorbell. At any time, you can also change the melody using the same steps.

Adjusting the Speaker Volume

There are five volume levels, including mute, on the Speaker. Simply press the **Volume** button until the desired volume level is obtained. You will hear the difference in volume each time the **Volume** button is pressed.

Resetting the Speaker

To reset the pairing information, press and hold the **Melody Select Next** button on the Speaker until a quick tone is heard and the LED indicator blinks once. After you reset the Speaker, you will need to pair it with the Doorbell again.

Mounting the Speaker and Doorbell

Speaker

The Speaker can be completely freestanding or mounted. The operating distance between the Speaker and Doorbell Button is up to 50m/165ft but the range may vary depending on local conditions.

If you would like to mount the Speaker, simply attach the supplied mounting screws to the wall. Depending on the surface, you may also need to use a masonry or dry wall plug. Do not insert the screws all the way in but leave a small gap between screw head and wall so that you can place the keyhole slots on the back of the Speaker over the screws.

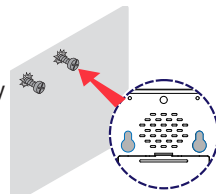

Doorbell

The Doorbell can be mounted to the surface using the supplied double-sided adhesive tape or screws.

- For tape mounting, make sure the surface is dry, smooth and free of dust and other substances that could affect adhesion.
- For screw mounting, slide the rear plate off the back of the Doorbell, screw the plate to the wall using 2 screws, then slide the Doorbell back onto the plate until it secures into place.

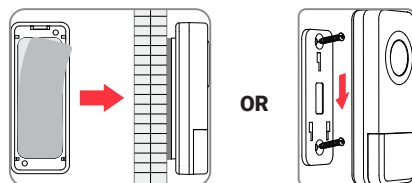

Note: Avoid mounting the Doorbell on metal surfaces, including UPVC doorframes, as this may reduce the transmission range.

Have Questions?

We're here to help! Visit our Support Center at support.swann.com
You can also email us at any time via: tech@swann.com

Limited Warranty Terms & Conditions

Swann Communications warrants this product against defects in workmanship and material for a period of one (1) year from its original purchase date. You must present your receipt as proof of date of purchase for warranty validation. Any unit which proves defective during the stated period will be repaired without charge for parts or labour or replaced at the sole discretion of Swann. The end user is responsible for all freight charges incurred to send the product to Swann's repair centres. The end user is responsible for all shipping costs incurred when shipping from and to any country other than the country of origin.

The warranty does not cover any incidental, accidental or consequential damages arising from the use of or the inability to use this product. Any costs associated with the fitting or removal of this product by a tradesman or other person or any other costs associated with its use are the responsibility of the end user. This warranty applies to the original purchaser of the product only and is not transferable to any third party. Unauthorized end user or third party modifications to any component or evidence of misuse or abuse of the device will render all warranties void.

By law some countries do not allow limitations on certain exclusions in this warranty. Where applicable by local laws, regulations and legal rights will take precedence.

For Australia: Our goods come with guarantees which cannot be excluded under Australian Consumer Law. You are entitled to a replacement or refund for a major failure and for compensation for any other reasonably foreseeable loss or damage. You are also entitled to have the goods repaired or replaced if the goods fail to be of acceptable quality and the failure does not amount to major failure.

Battery Warnings

- Do not dismantle, open or shred secondary cells or batteries.
- Do not expose cells or batteries to heat or fire. Avoid storage in direct sunlight.
- Do not short-circuit a cell or a battery. Do not store cells or batteries haphazardly in a box or drawer where they may short-circuit each other or be short-circuited by other metal objects.
- Do not remove a cell or battery from its original packaging until required for use.
- Do not subject cells or batteries to mechanical shock.
- In the event of a cell leaking, do not allow the liquid to come in contact with the skin or eyes. If contact has been made, wash the affected area with copious amounts of water and seek medical advice.
- Do not use any charger other than that specifically provided for use with the equipment.
- Observe the plus (+) and minus (–) marks on the cell, battery and equipment and ensure correct use.
- Do not use any cell or battery which is not designed for use with the equipment.
- Do not mix cells of different manufacturer, capacity, size or type within a device.
- Keep cells and batteries out of the reach of children.
- Seek medical advice immediately if a cell or a battery has been swallowed.
- Always purchase the correct cell or battery for the equipment.
- Keep cells and batteries clean and dry.
- Wipe the cell or battery terminals with a clean dry cloth if they become dirty.
- Secondary cells and batteries need to be charged before use. Always use the correct charger and refer to the manufacturer's instructions or equipment manual for proper charging instructions.
- Do not leave a battery on prolonged charge when not in use.
- After extended periods of storage, it may be necessary to charge and discharge the cells or batteries several times to obtain maximum performance.
- Secondary cells and batteries give their best performance when they are operated at normal room temperature (20 °C ± 5 °C).
- Retain the original product literature for future reference.
- Use only the cell or battery in the application for which it was intended.
- When possible, remove the battery from the equipment when not in use.
- Dispose of properly.
- The socket-outlet shall be easily accessible.
- **CAUTION: Risk of explosion if the battery is replaced by an incorrect type**

