



Scoop & Learn Ice Cream Cart™ Deluxe



Parent's Guide

This guide contains important information. Please keep it for future reference.

91-003385-021 

INTRODUCTION

Thank you for purchasing the **Scoop & Learn Ice Cream Cart™ Deluxe**. Serve up sweet pretend play with four flavors of ice cream, three ice cream toppings and more to create tons of delicious and imaginative combinations! Use the magic scooper to scoop up the ice cream and ice cream toppings, then ring up the customer's order using the cash register. On the side tray, pick an ice pop from four flavors and choose one of four ice pop toppings. Pretend money is included for extra pretend-play interactions and to reinforce counting.

Order/Activity Cards

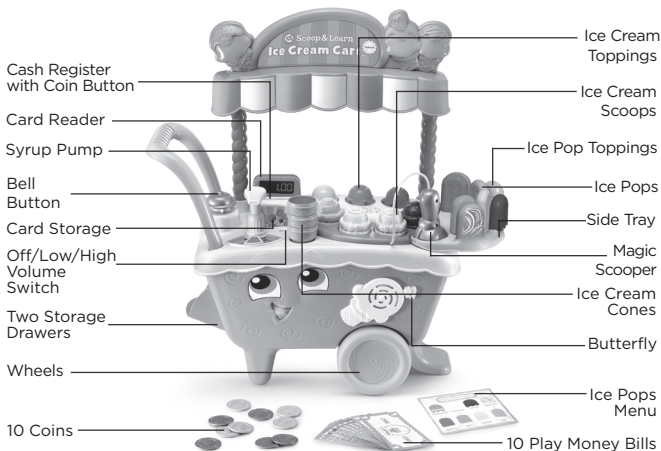

INCLUDED IN THIS PACKAGE

- **Scoop & Learn Ice Cream Cart™ Deluxe**
- Two scoops of mint ice cream
- Two scoops of chocolate ice cream
- Two scoops of strawberry ice cream
- Two scoops of vanilla ice cream
- One whipped cream topping
- One cherry sauce topping
- One orange sprinkles topping
- Three ice cream cones
- Six double-sided order/activity cards
- One canopy
- Two canopy poles
- One cart handle
- One label sheet
- Ten coins
- Ten play money bills
- One ice pops menu
- One raspberry ice pop
- One orange ice pop
- One pineapple ice pop
- One kiwi ice pop
- One confetti sprinkle ice pop topping
- One coconut cream ice pop topping
- One chocolate ice pop topping
- One rainbow swirl ice pop topping
- One side tray
- One parent's guide

WARNING

All packing materials such as tape, plastic sheets, packaging locks, removable tags, cable ties, cords and packaging screws are not part of this toy, and should be discarded for your child's safety.

NOTE

Please keep this parent's guide as it contains important information.

ATTENTION

Pour la sécurité de votre enfant, débarrassez-vous de tous les produits d'emballage tels que rubans adhésifs, feuilles de plastique, attaches, étiquettes, cordons et vis d'emballage. Ils ne font pas partie du jouet.

NOTE

Il est conseillé de conserver ce guide des parents car il comporte des informations importantes.

GETTING STARTED

Battery Removal and Installation

1. Make sure the unit is turned **Off**.
2. Find the battery cover located on the bottom of the unit, use a coin or a screwdriver to loosen the screw and open the battery cover.
3. Remove old batteries by pulling up on one end of each battery.
4. Install 3 new AA batteries following the diagram inside the battery box.
5. Replace the battery cover and tighten the screw to secure.

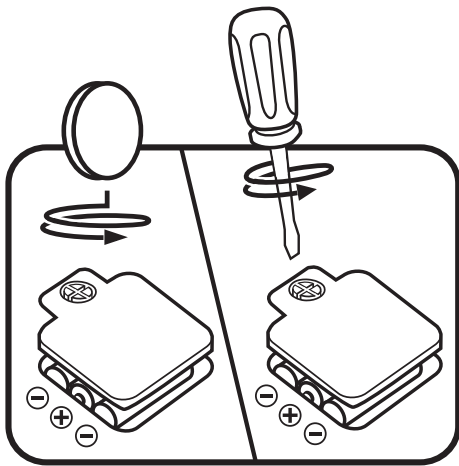

BATTERY NOTICE

- Use new alkaline batteries for maximum performance.
- Use only batteries of the same or equivalent type as recommended.
- Do not mix different types of batteries: alkaline, standard (carbon-zinc) or rechargeable, or new and used batteries.
- Do not use damaged batteries.
- Insert batteries with the correct polarity.
- Do not short-circuit the battery terminals.
- Remove exhausted batteries from the toy.
- Remove batteries during long periods of non-use.
- Do not dispose of batteries in fire.
- Do not charge non-rechargeable batteries.
- Remove rechargeable batteries from the toy before charging (if removable).
- Rechargeable batteries are only to be charged under adult supervision.

MISE EN GARDE

- Utilisez de nouvelles piles alcalines pour une performance maximale.
- Seules des piles du type recommandé doivent être utilisées.
- Ne pas mélanger différents types de piles ou d'accumulateurs, ne pas mélanger des piles ou des accumulateurs neufs avec des usagés.
- Ne pas utiliser des piles ou des accumulateurs endommagés.
- Mettre en place les piles ou les accumulateurs en respectant les polarités + et -.
- Ne pas mettre les bornes d'une pile ou d'un accumulateur en court-circuit (en reliant directement le + et le -).
- Enlever les piles ou les accumulateurs usagés du jouet.
- Retirer les piles ou les accumulateurs en cas de nonutilisation prolongée.
- Ne les jeter ni au feu ni dans la nature.
- Ne pas tenter de recharger des piles non rechargeables.
- Enlever les accumulateurs du jouet pour les recharger.
- Les accumulateurs ne doivent être chargés que sous la surveillance d'un adulte.

ASSEMBLY

With the **Scoop & Learn Ice Cream Cart™ Deluxe** safety comes first. To ensure your child's safety, adult assembly is required. Once assembled, the unit cannot be disassembled.

1. Insert the two **Canopy Poles** into the **Canopy** and insert the poles into the top of the cart.

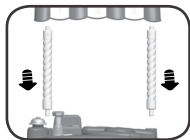

2. Insert the **Cart Handle** into the top of the cart.

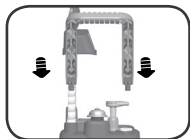

3. Attach the **Side Tray** on to the top of the cart. This can be disassembled after assembly.



LABEL APPLICATION

Please securely adhere the labels to the cart as indicated below:

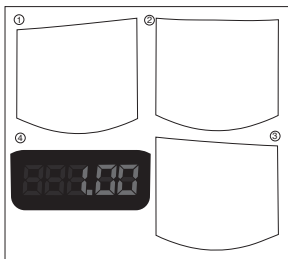

PRODUCT FEATURES

1. Off/Low/High Volume Control Switch

Slide the **Off/Low/High Volume Switch** to turn the toy on and select the volume.

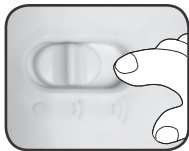

2. Magic Scooper

Place the **Magic Scooper** on the top of an **Ice Cream Scoop** or **Ice Cream Topping** to easily pick them up. To release the **Ice Cream Scoop** or **Ice Cream Topping**, press the button on the side of the **Magic Scooper**.

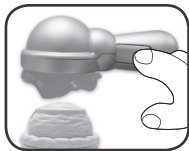

3. Order/Activity Cards

For guided play, insert one of the six double-sided **Order/Activity Cards** into the **Card Reader**.



4. Wheels

Push the cart around to hear songs and music.



5. Syrup Pump

Slide to choose from three flavors, then press down on the **Syrup Pump** to hear numbers as you count along.



6. Bell Button

Press to hear bell sounds and when prompted during guided play with the **Order/Activity Cards**.

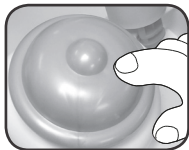

7. Coin Button

Press to hear coin sounds and numbers as you count along.

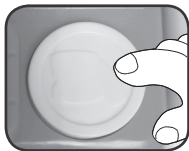

8. Butterfly

Slide the butterfly from side to side to make the ice cream swirl colors change.

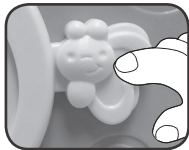

9. Ice Pops and Ice Pop Toppings

Place the **Ice Pop Toppings** on the raised bumps of the **Side Tray** and place the sticks of the **Ice Pops** into the slots on the **Side Tray**.



10. Play Money Bills and Coins

Store in one of the two **Storage Drawers**.



TO BEGIN PLAY

Activate Normal Play Mode

Slide the **Off/Low/High Switch** to the **Off** position, then slide to Low or High volume to turn the toy **On**.

ACTIVITIES

1. Ice Cream and Ice Cream Toppings

Pick up **Ice Cream Scoops** or **Ice Cream Toppings** using the **Magic Scooper**. It will recognize the flavor or color of the **Ice Cream Scoop** or **Ice Cream Topping**.

2. Order Cards

Insert an **Order Card** into the **Card Reader** to hear the customer's order. Listen to the order and the order song and remember the ingredients needed. Build the treat in the correct sequence and ring the bell to finish the order.

3. Colors Activity Card

Insert the **Colors Activity Card** into the **Card Reader**. Listen to the question and try to find the correct **Ice Cream Scoop** or **Ice Cream Topping** color using the **Magic Scooper**.

4. Counting Activity Card

Insert the **Counting Activity Card** into the **Card Reader**. Listen to the question and press the **Syrup Pump** the correct number of times.

5. Flavors Activity Card

Insert the **Flavors Activity Card** into the **Card Reader**. Listen to the question and try to find the correct **Ice Cream Scoop** flavor and learn a fun fact about where the flavor comes from.

6. Numbers Activity Card

Insert the **Numbers Activity Card** into the **Card Reader**. Listen to the question and press the **Coin Button** the correct number of times.

7. Stacking Activity Card

Insert the **Stacking Activity Card** into the **Card Reader**. Stack as many **Ice Cream Scoops** and **Ice Cream Toppings** on the **Ice Cream Cone** as you can before the music stops. When you're done, press the bell.

8. Creativity Activity Card

Insert the **Creativity Activity Card** into the **Card Reader**. Create your own ice cream cone using the **Magic Scooper** or **Syrup Pump**. Press the bell when you're done to hear the daily special.

9. Push Cart

Push the cart for fun music and songs, and exercise gross motor skills.

10. Ice Pops Menu, Ice Pops and Ice Pop Toppings

Look at the **Ice Pops Menu** to learn the flavors of the **Ice Pops** and **Ice Pop Toppings** or make one of the menu specials. Mix and match to create your own and name your tasty treat.

11. Play Money Bills and Coins

Use the **Play Money Bills** and **Coins** for additional pretend play interactions and to reinforce counting.

MELODIES

1. Pop Goes the Weasel
2. The Entertainer

SONG LYRICS

Scoop It Up Song

Scooping ice cream all around
Ice cream for everyone in town
Lots of flavors to try and share
Happy people are everywhere!

We love it!

1. Hot at the beach, so off we go
Ice cream melts so don't eat slow
Come from the water and the sandy beach
Come enjoy an ice cream treat!
2. Hot at school, so off we go
Ice cream melts so don't eat slow
Here come the kids, school's all done
Ice cream cones are lots of fun!

- Hot at the park, so off we go
Ice cream melts so don't eat slow
Come from the swing set and the big slide
I've got a cone for you to try!
- Hot downtown, so off we go
Ice cream melts so don't eat slow
Grown-ups love ice cream too
Ice cream cones for me and you!

We love it!

Ice Cream, Who Wants Some Ice Cream!

Colors Song - Scoop version

I'm scooping up ice cream
Please scoop with me
Scoop a color; What will it be?

- Green
- Brown
- Yellow
- Pink
- Red
- White
- Orange

Colors Song - Pump version

I'm pumpin' up flavors
Please pump with me
Pump a color; What will it be?

- Blue
- Tan
- Purple

CARE & MAINTENANCE

1. Keep the unit and accessories clean by wiping it with a slightly damp cloth.
2. Keep it out of direct sunlight and away from direct heat sources.
3. Remove the batteries if the unit will not be in use for an extended period of time.
4. Do not drop the unit on hard surfaces and do not expose the unit to moisture or water.

TROUBLESHOOTING

If for some reason the unit stops working, please follow these steps:

1. Turn the unit **OFF**.
2. Interrupt the power supply by removing the batteries.
3. Let the unit stand for a few minutes, then replace the batteries.
4. Turn the unit back **ON**. The unit will now be ready to play again.
5. If the unit still does not work, install a new set of batteries.

Environmental Phenomena

The unit may malfunction if subjected to radio-frequency interference. It should revert to normal operation when the interference stops. If not, it may become necessary to turn the power **OFF** and back **ON**, or remove and reinstall the batteries. In the unlikely event of an electrostatic discharge, the unit may malfunction and lose memory, requiring the user to reset the device by removing and reinstalling the batteries.

Impact de l'environnement

Une défaillance de fonctionnement de l'appareil peut survenir s'il est sujet à des interférences avec les fréquences radioélectriques. Le fonctionnement normal de l'appareil devrait reprendre avec l'arrêt des interférences. Si ce n'est pas le cas, il peut s'avérer nécessaire d'éteindre et rallumer l'appareil ou de retirer et réinstaller les piles. Dans l'éventualité peu probable d'une décharge électrostatique, un mauvais fonctionnement et une perte de mémoire de l'appareil peuvent se produire. L'utilisateur doit alors retirer et réinstaller les piles pour réinitialiser l'appareil.

Supplier's Declaration of Conformity
47 CFR § 2.1077 Compliance Information

Trade Name: LeapFrog®
Model: 600761
Product Name: Scoop & Learn Ice Cream Cart™
Deluxe
Responsible Party: LeapFrog Enterprises, Inc.
Address: 6401 Hollis Street, Suite 100,
Emeryville, CA 94608
Website: leapfrog.com

THIS DEVICE COMPLIES WITH PART 15 OF THE FCC RULES. OPERATION IS SUBJECT TO THE FOLLOWING TWO CONDITIONS:(1) THIS DEVICE MAY NOT CAUSE HARMFUL INTERFERENCE, AND (2) THIS DEVICE MUST ACCEPT ANY INTERFERENCE RECEIVED, INCLUDING INTERFERENCE THAT MAY CAUSE UNDESIRED OPERATION.

CAN ICES-3 (B)/NMB-3(B)

IMPORTANT NOTE:

If the problem persists, please call our **Consumer Services Department** at **1-800-701-5327** in the U.S. or email **support@leapfrog.com**. Creating and developing LeapFrog® products is accompanied by a responsibility that we take very seriously. We make every effort to ensure the accuracy of the information, which forms the value of our products. However, errors sometimes can occur. It is important for you to know that we stand behind our products and encourage you to contact us with any problems and/or suggestions you might have. A service representative will be happy to help you.

NOTE:

This equipment has been tested and found to comply with the limits for a Class B digital device, pursuant to Part 15 of the FCC Rules. These limits are designed to provide reasonable protection against harmful interference in a residential installation. This equipment generates, uses and can radiate radio frequency energy and, if not installed and used in accordance with the instructions, may cause harmful interference to radio communications. However, there is no guarantee that interference will not occur in a particular installation. If this equipment does cause harmful interference to radio or television reception, which can be determined by turning the equipment off and on, the user is encouraged to try to correct the interference by one or more of the following measures:

- Reorient or relocate the receiving antenna.
- Increase the separation between the equipment and receiver.
- Connect the equipment into an outlet on a circuit different from that to which the receiver is connected.
- Consult the dealer or an experienced radio/TV technician for help.

Caution: Changes or modifications not expressly approved by the party responsible for compliance could void the user's authority to operate the equipment.

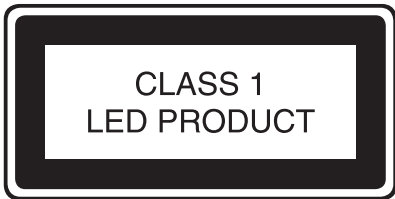



***Visit our website for more
information about our products,
downloads, resources and more.***

leapfrog.com

***Read our complete warranty policy online
at leapfrog.com/warranty***

LeapFrog Enterprises, Inc.,
A subsidiary of VTech Holdings Limited.
TM & © 2020 LeapFrog Enterprises, Inc.
All rights reserved.
91-003385-021 