

***Dahle CleanTec 51414  
Level P-4 Oil-Free  
Cross-Cut Shredder***

Instruction Manual



*Provided by*

**MyBinding.com**

*When Image Matters.*

Call Us at 1-800-944-4573



# Operating Instructions

---

## Dahle Document Shredders

Models 41xxx, 50xxx, 51xxx



MyBinding.com

5500 NE Moore Court  
Hillsboro, OR 97124

Toll Free: 1-800-944-4573

Local: 503-640-5920



**Read the operating and safety instructions carefully before putting the document shredder into operation! You must follow the instructions!**

**Keep them safe for later use.**

- Only store, transport and operate the document shredder in an **upright position!**
- All liquids and gases used on the document shredder must comply with DAHLE guidelines!
- The document shredder must only be operated in enclosed spaces at temperatures of 15 °C to 32 °C (59 °F–90 °F) and non-condensed humidity of 15% to 95%!
- Do not place the document shredder near a heat source!
- Ensure the document shredder is standing firmly on the floor at a distance of 100 mm from the wall; activate brakes and fasten using the mounting kit if supplied!
- Avoid any accumulation of heat!
- The mains socket must be earthed and easily accessible at all times!
- Use only the mains cable supplied with the device by DAHLE and ensure that it is not damaged!
- Ensure that the building installation has short-circuit protection: max. 16 A (US max. 20 A)!
- Do not use near flammable liquids and gases!
- Do not use near caustic substances!
- Do not subject to moisture!
- Do not open up the machine!
- Automatic start-up!
- Do not operate the document shredder without inserting documents!
- Switch off the shredder at the main switch when it is not in use!
- Only use the document shredder provided that it is in perfect working order, while observing the operating instructions and the usual regulations, guidelines and applicable safety and accident prevention requirements. Take the document shredder out of service immediately if faults occur!
- The device is not intended for use by persons (including children) with restricted physical, sensory or mental capabilities or a lack of experience and knowledge, unless they are working under supervision or receive detailed instruction about how to use the device from a person who is responsible for safety.



- 1 - It is obligatory to follow the safety instructions!
- 2 - **Read the operating and safety instructions carefully before putting the document shredder into operation!**
- 3 - This document shredder is not intended to be used by children (the product is not a toy)!
- 4 - Do not touch the paper feed with your hands!
- 5 - Do not allow items of clothing to touch the paper feed!
- 6 - Do not allow your hair to touch the paper feed!
- 7 - Prior to maintenance work, disconnect the document shredder from the electrical power supply!
- 8 - Wear protective goggles when shredding CDs or DVDs!
- 9 - Remove paper clips and staples before shredding! (security level P6 and P7 devices)



## Pay attention to warnings!

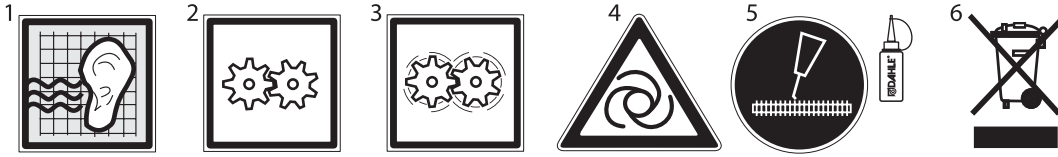

- 1 - Noise level when operated without shredding documents (in accordance with DIN)
- 2 - Document shredder on stand-by
- 3 - Document shredder in operation
- 4 - Automatic start-up
- 5 - Oil (only use DAHLE oil!)
- 6 - Dispose of the document shredder appropriately and in an environmentally friendly manner at an authorised collection point.  
Do not dispose of any parts of the document shredder or packaging in domestic waste.

## Intended use, warranty

The document shredder is intended to be used for shredding paper. Depending on the model variant, a small amount of the following materials can also be shredded:

- CDs/DVDs, bank cards and credit cards (see technical data)
- The normal staples and paper clips found in paper documents (exception: security level P6 and P7 devices)

Wear, damage due to improper use or unauthorised modifications and repairs are not covered by the warranty or the guarantee.

The document shredder was designed for private use and for use in normal office environments.

The following conditions apply to the performance in terms of sheets listed under technical data: Maximum number of sheets that are shredded in one pass under the following conditions: New cutting rollers, oiled if needed, cold motor, power supply with nominal voltage and nominal frequency (230 V/ 50 Hz; 120 V/60 Hz). Deviations may result in reduced sheet processing and increased operating noises. The sheets are fed centrally and lengthwise at a 90 degree angle. The performance in terms of sheets can also vary depending on the paper properties and input.

## Subject to technical modifications!

MyBinding.com  
 5500 NE Moore Court  
 Hillsboro, OR 97124  
 Toll Free: 1-800-944-4573  
 Local: 503-640-5920

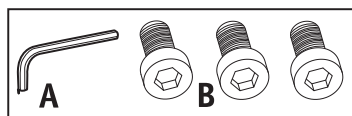
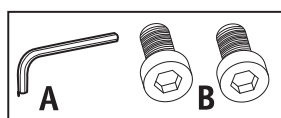
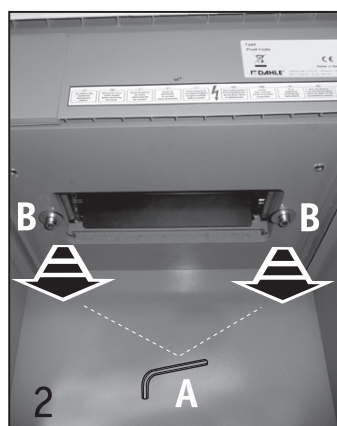
**Remove transport lock!**

1. Apply the brakes! Prior to putting into operation for the first time, open the door and remove the paper collection bin.
2. Remove the screws for the transport lock (paper collection bin compartment) from the base plate underneath the shredding mechanism, re-fit paper collection bin and close door.
3. Each time the appliance is moved, the transport lock must be re-fitted.

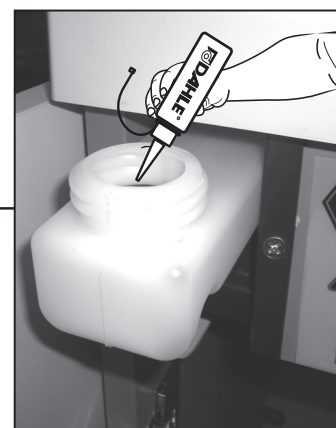
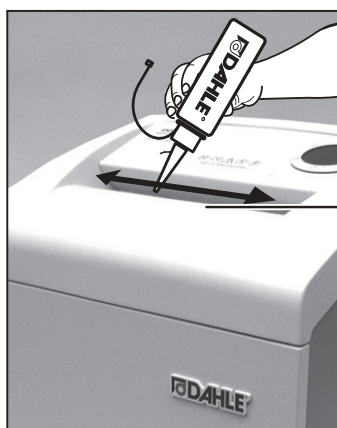

1. Oil the shredding rollers using DAHLE document shredder oil (P5, P6 and P7 cross-cut shredding only)!
2. Fill the oil tank with DAHLE document shredder oil!

MyBinding.com  
 5500 NE Moore Court  
 Hillsboro, OR 97124  
 Toll Free: 1-800-944-4573  
 Local: 503-640-5920



Depending on the model variant, your document shredder may not have all the possible components and functions.

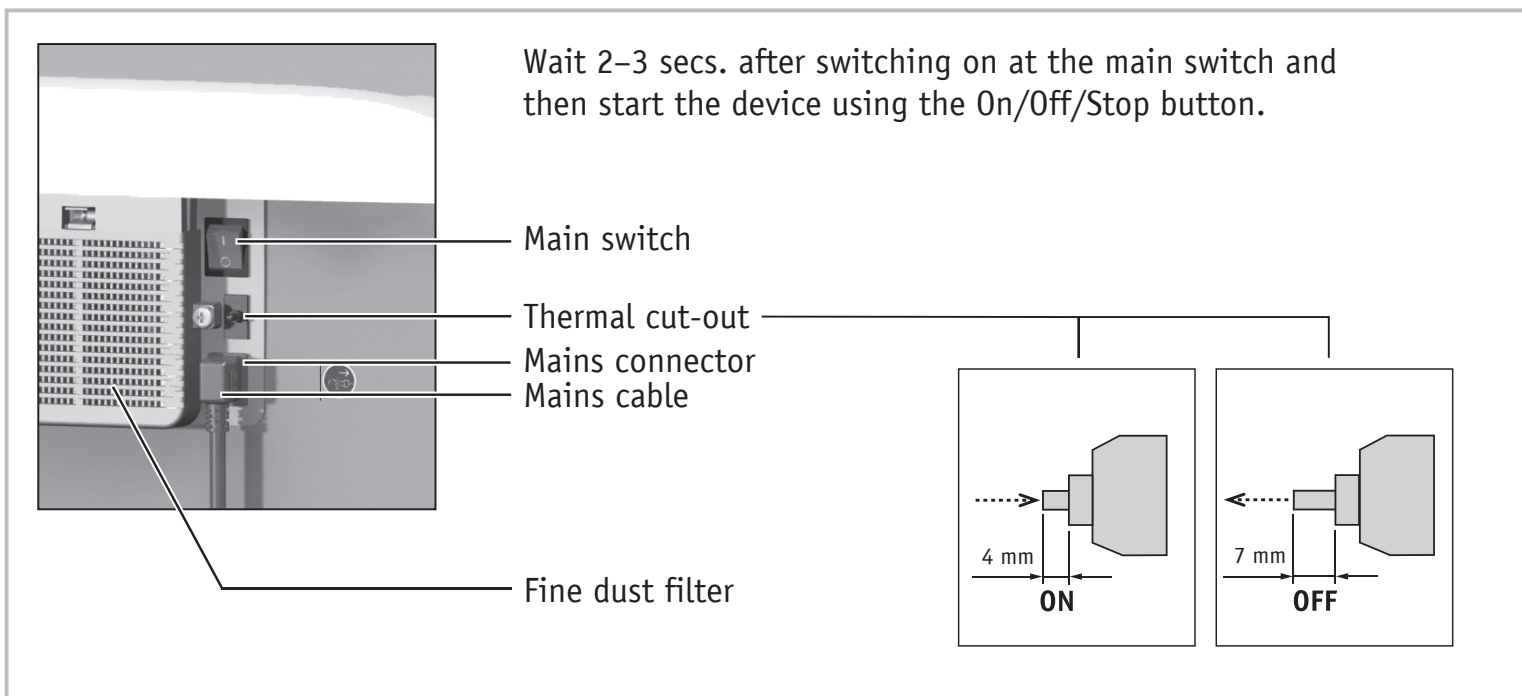
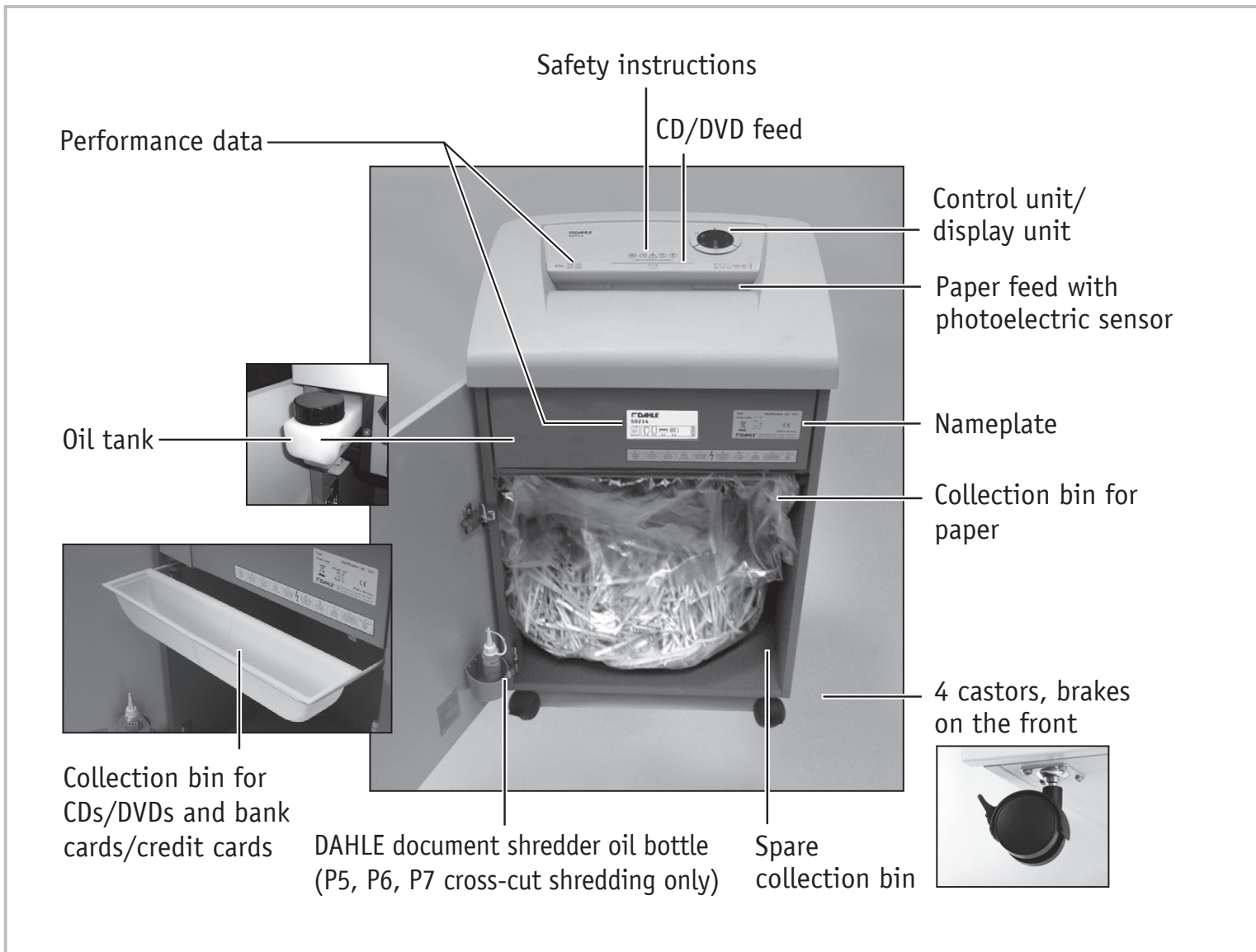



Depending on the model variant, your document shredder may not have all the possible components and functions.

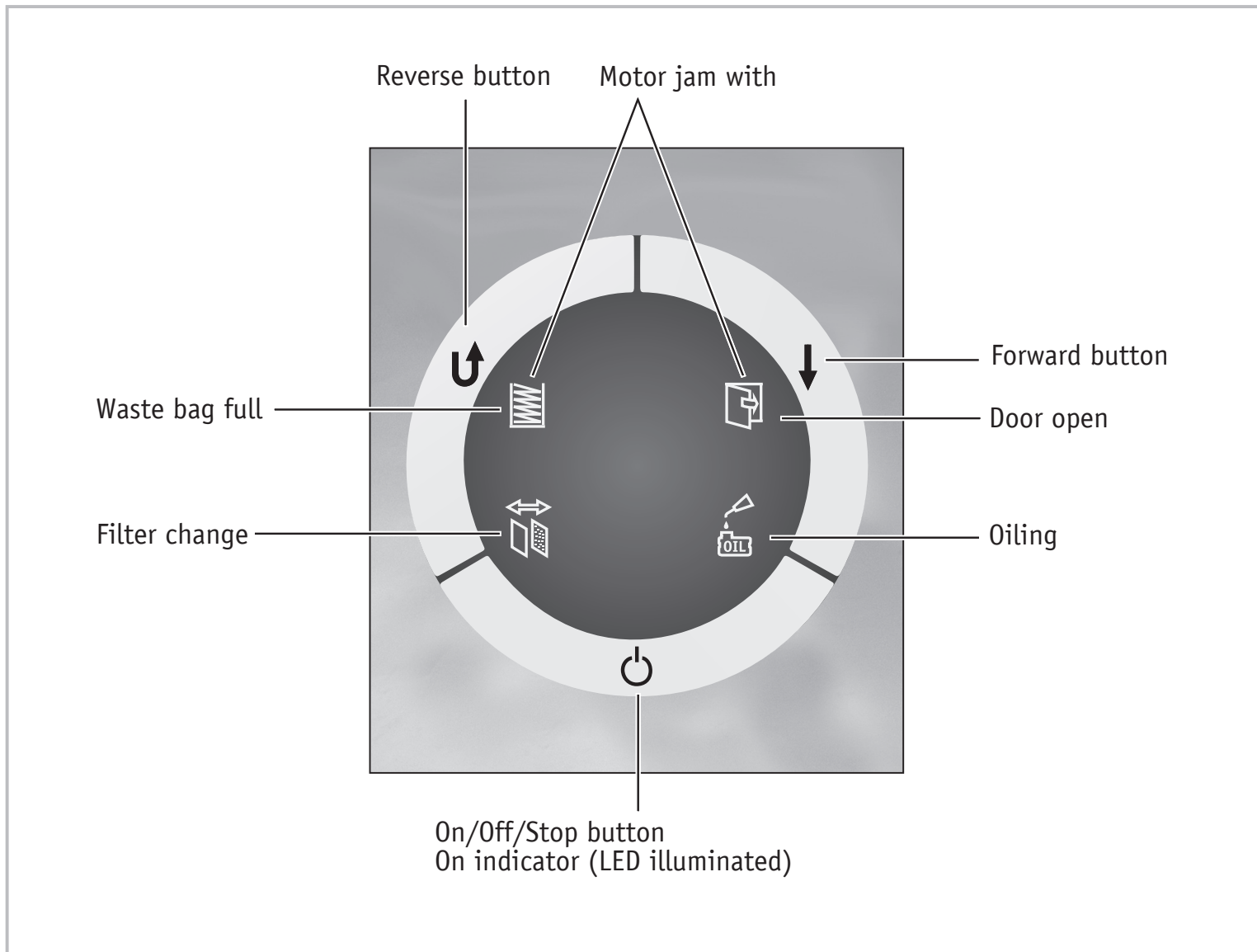

Type  
Prod. Code

XXX-XXX V  
XX Hz

1. Check that the voltage and mains frequency of your electricity supply match the information on the nameplate.



1.

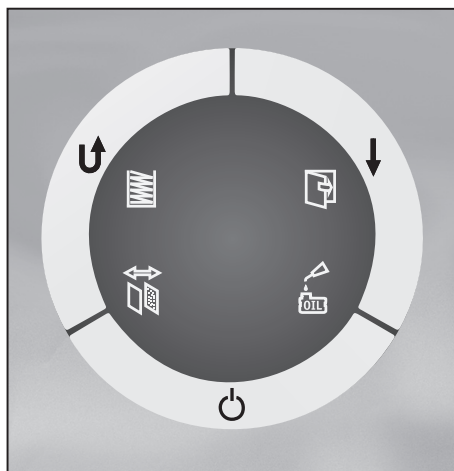

**Please follow the safety instructions.**

1. Prior to using the document shredder, please check the position of the collection bin for CDs/DVDs and bank cards/credit cards. When shredding paper, this bin must be at the front of the collection bin for paper.
2. Close the door of the document shredder.
3. Connect the mains cable supplied to the document shredder and plug into a mains socket. Switch on the main switch. After switching on at the main switch, wait 2–3 seconds.
4. Switch on the document shredder with the On/Off/Stop button.

1.1

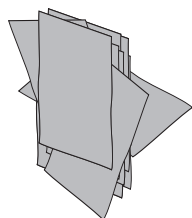

**O.K.**



1. **Observe the maximum number of sheets of paper as stated in the technical data!**
2. Insert the paper into the middle of the paper feed: the built-in photoelectric sensor starts the document shredder automatically.
3. Once the paper feed is clear again, the document shredder switches off automatically and goes into stand-by.
4. **Continuous operation** - If you hold down the Forward button (for approx. 5 sec.), the document shredder changes to continuous operation.
5. If the supply of paper is interrupted for 15 seconds, continuous operation is interrupted.





Depending on the model variant, your document shredder may not have all the possible components and functions.

2.

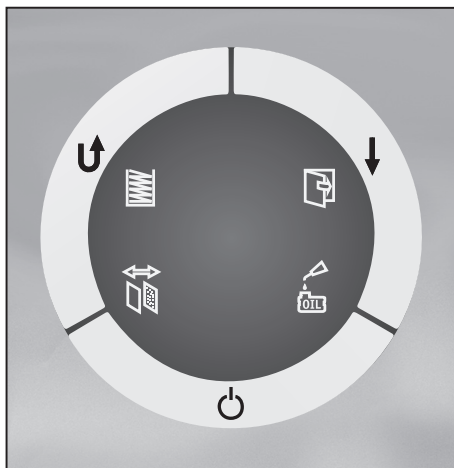

**Please follow the safety instructions: Wear protective goggles when shredding CDs or DVDs!**

1. Prior to using the document shredder, please check the position of the collection bin for CDs/DVDs and bank cards/credit cards. **When shredding CDs/DVDs and bank cards/credit cards**, this bin must be **at the rear** of the collection bin for paper.
2. Pull out collection bin and position the collection bin for CDs/DVDs and credit cards/bank cards at the rear.
3. Close the door of the document shredder.
4. Switch on the document shredder with the On/Off/Stop button.

2.1



1. Insert the CDs, DVDs or bank cards/credit cards in the middle of the feed while keeping the Forward button pressed.
2. Once the CD/DVD feed is clear again, the document shredder switches off automatically and goes into stand-by.



Depending on the model variant, your document shredder may not have all the possible components and functions.

## DAHLE CleanTEC®

### Change DAHLE fine dust filter

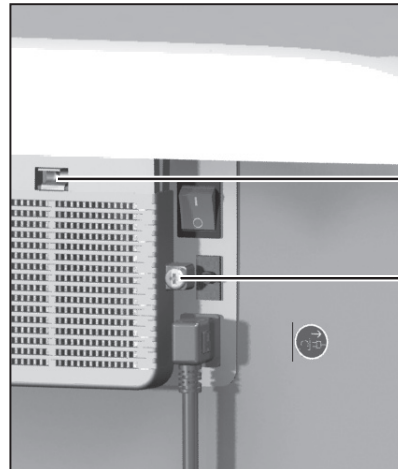
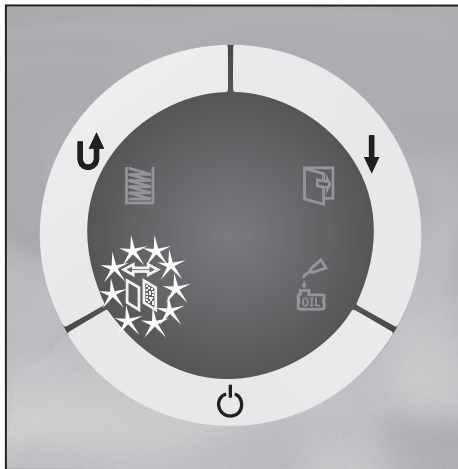

Catch

Screw

1. The filter change indicator (**change DAHLE fine dust filter!**) is illuminated on the control panel.
2. Unplug the mains cable from the mains socket.
3. Change the fine dust filter on the rear of the appliance.
  - A. Undo screw.
  - B. Press catch and remove cover.
  - C. Remove filter and dispose of it. The replacement filter that you fit must be a **DAHLE fine dust filter!**
  - D. Close cover.
  - E. Tighten screw.
4. Plug the mains cable into the mains socket and switch on at the main switch and the On/Off/Stop button.
5. Reset filter change indicator: Keep the Forward and Reverse buttons pressed simultaneously for approx. 5 seconds.

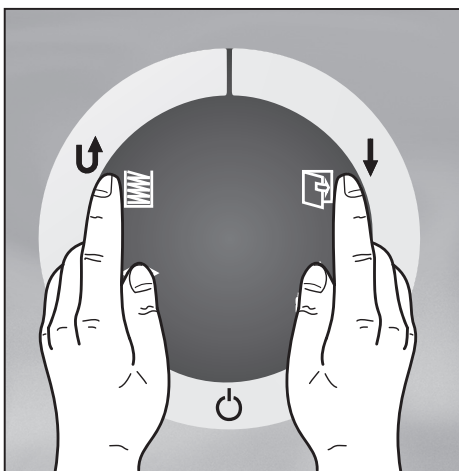

**We do not accept any liability for improper use of the DAHLE fine dust filter or for not changing the DAHLE fine dust filter. The used DAHLE fine dust filter can be disposed in the domestic waste.**

**The fine dust particles are bound into the DAHLE fine dust filter. Please dispose of the DAHLE fine dust filter in a manner so that it is inaccessible for children.**

MyBinding.com  
 5500 NE Moore Court  
 Hillsboro, OR 97124  
 Toll Free: 1-800-944-4573  
 Local: 503-640-5920



Depending on the model variant, your document shredder may not have all the possible components and functions.

## Automatic oiling (only P5, P6 and P7 cross-cut shredding)

Fill oil tank with DAHLE document shredder oil.

Integrated oil tank for regulated, automatic oiling of the rollers.

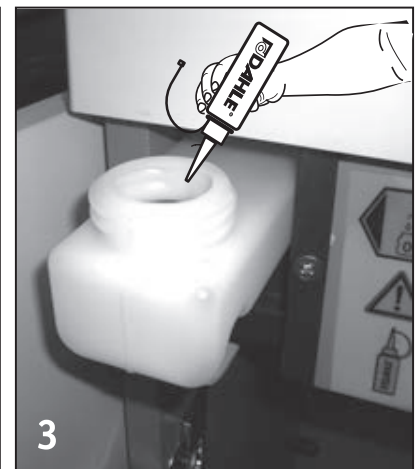
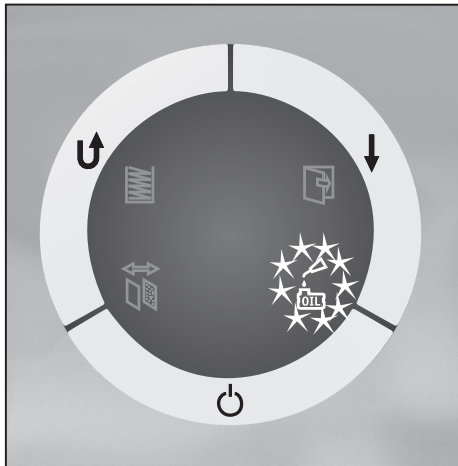

Fill the integrated oil tank in the document shredder when indicated on the display.

1. Switch off the document shredder with the On/Off/Stop button.
2. Open the door. The integrated oil tank is in the cabinet. Open the cap.
3. Fill **oil tank with oil** (use DAHLE document shredder oil!) and close again.

MyBinding.com  
 5500 NE Moore Court  
 Hillsboro, OR 97124  
 Toll Free: 1-800-944-4573  
 Local: 503-640-5920



## Meaning of the signals

Depending on the model variant, your document shredder may not have all the possible components and functions.

**Collection bin full – The LED is flashing.**

3.

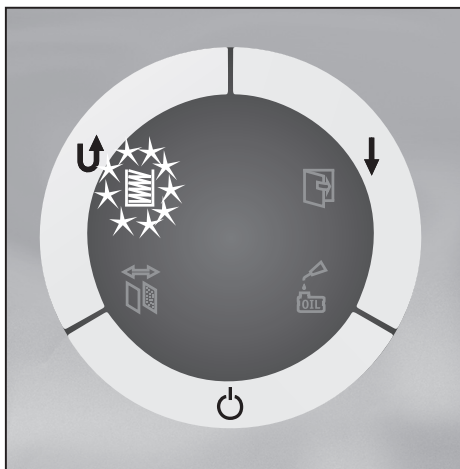

1. 1. If the collection bin is full, the shredding process is stopped; this situation is indicated optically.
2. Switch off the main switch and unplug the mains cable from the mains socket.
3. Remove collection bin, empty and re-fit.
4. Plug the mains cable into the mains socket and switch on the main switch.



Depending on the model variant, your document shredder may not have all the possible components and functions.

**Automatic motor shut-down** – The LEDs for the fill level and door are flashing.

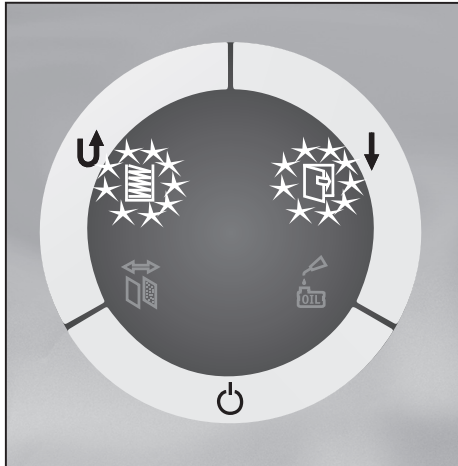

1. Automatic motor shut down in case of:
  - Overheating of the motor
  - Paper jam

**Door open** – The LED is flashing.

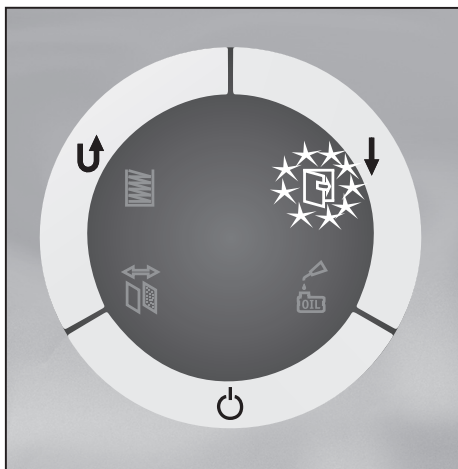

1. If the door is open, the shredding process is stopped and LED is flashing: close the door.

MyBinding.com  
 5500 NE Moore Court  
 Hillsboro, OR 97124  
 Toll Free: 1-800-944-4573  
 Local: 503-640-5920

Depending on the model variant, your document shredder may not have all the possible components and functions.

? 1.

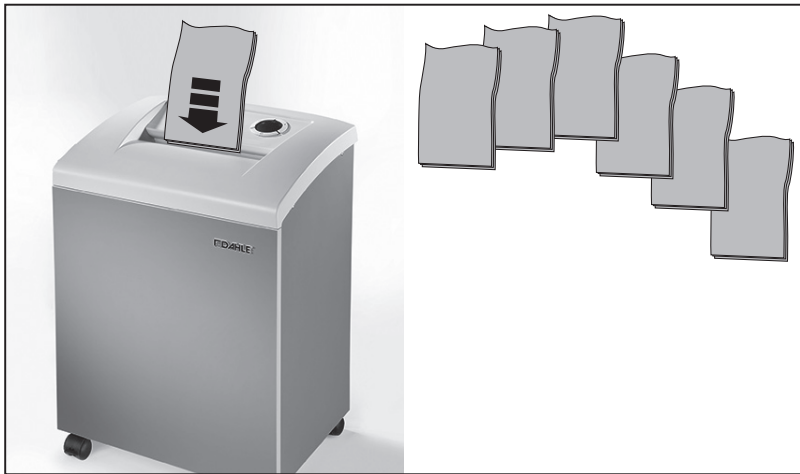

The document shredder switches off automatically after extended operation and/or overload to cool down.

? 2.



Thermal cut-out

### The shredding process is not started:

- Mains cable not plugged into the mains socket
- Main switch not on?
- On/Off/Stop button not switched on?
- Door open
- Collection bin full
- Device overloaded/overheated?
- Thermal cut-out OFF?

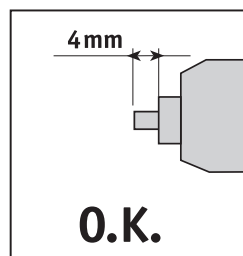
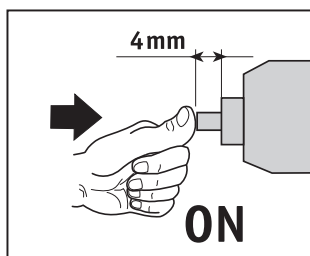
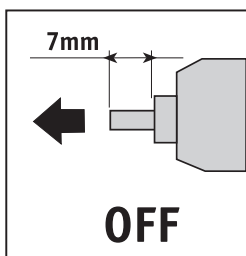

Set the thermal cut-out to the correct position – ON.

MyBinding.com  
 5500 NE Moore Court  
 Hillsboro, OR 97124  
 Toll Free: 1-800-944-4573  
 Local: 503-640-5920

Depending on the model variant, your document shredder may not have all the possible components and functions.

? 3.

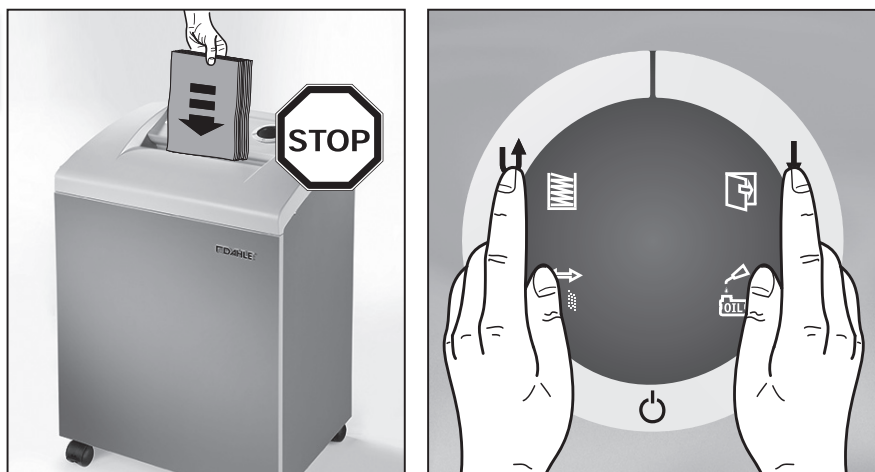

1. If there are too many sheets of paper, the shredding process is stopped.
2. The shredding mechanism automatically runs in reverse for a short time and the paper is ejected.
3. **ATTENTION! To avoid damaging the shredding mechanism, do not operate the Forward and Reverse switches alternately!**

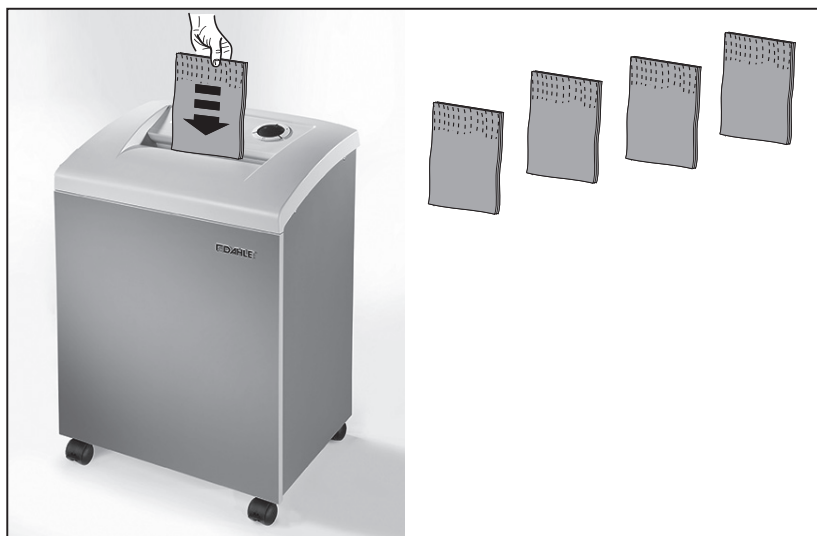

4. If paper continues to be jammed, operate the Reverse button briefly.
5. Reduce the number of sheets of paper by removing or tearing off.
6. The shredding process starts automatically after the paper is inserted again, otherwise operate the Forward button.

#### **40334, 40434, 40534, 41334, 41434, 41534**

1. In the event of a paper jam, the shredding mechanism runs in reverse for 0.5 seconds.
2. Remove the paper. Then operate the Forward switch to clear the shredding mechanism. The Reverse switch is inhibited until the Forward switch has been actuated.
3. Reduce the number of sheets of paper.

Depending on the model variant, your document shredder may not have all the possible components and functions.

## Energy-saving mode

**?** 4.



If not used, the document shredder switches off after approx. 30 minutes (LED off).  
To use the document shredder, switch it back on with the On/Off/Stop button.

MyBinding.com  
5500 NE Moore Court  
Hillsboro, OR 97124  
Toll Free: 1-800-944-4573  
Local: 503-640-5920





Use only DAHLE spare parts!

## Oiling (P5 cross-cut shredding)



If the shredding performance drops, oil the shredding mechanism after each time you empty the collection bin or at least after the operating time stated in the warning notice has elapsed **(for P5 cross-cut shredding only)**.

1. Switch off the document shredder with the On/Off/Stop button. Oil the shredding rollers manually (use DAHLE document shredder oil!).
2. Switch on the document shredder with the On/Off/Stop button and run the shredding mechanism in reverse for 10 seconds without paper feed.



1. Switch off the document shredder and unplug the mains cable from the mains socket.
2. Clean the appliance using only a dry cloth.
3. Plug the mains cable into the mains socket and switch on the document shredder.

MyBinding.com  
5500 NE Moore Court  
Hillsboro, OR 97124  
Toll Free: 1-800-944-4573  
Local: 503-640-5920

