

Nucleus[®] 7 Sound Processor

User Guide



CPI000

Hear now. And always



This guide is intended for Cochlear implant recipients and their carers using the Cochlear™ Nucleus® 7 Sound Processor (model number: CP1000). The processor works with your implant to transfer sound to your ear, and is made up of a processing unit, earhook, coil and cable, magnet and a battery module.

You can power your processor with disposable or rechargeable batteries.

You can control your processor by pressing its button, or by using your Cochlear Remote Control or the Nucleus Smart App.

People with certain types of hearing loss can wear the processor in Hybrid™ mode by adding an acoustic component which sends amplified acoustic sound into the ear canal.

A number of tools and accessories are supplied with your processor.



NOTES

- Refer to the relevant sections for cautions and warnings relating to the use of the Nucleus 7 Sound Processor, batteries and components.
- Please also refer to your *Patient Information* document for essential advice that applies to Cochlear implant systems.

Symbols used in this guide



NOTE

Important information or advice.



TIP

Time saving hint.



CAUTION (no harm)

Special care to be taken to ensure safety and effectiveness. Could cause damage to equipment.



WARNING (harmful)

Potential safety hazards and serious adverse reactions. Could cause harm to person.

Nucleus 7 Sound Processor

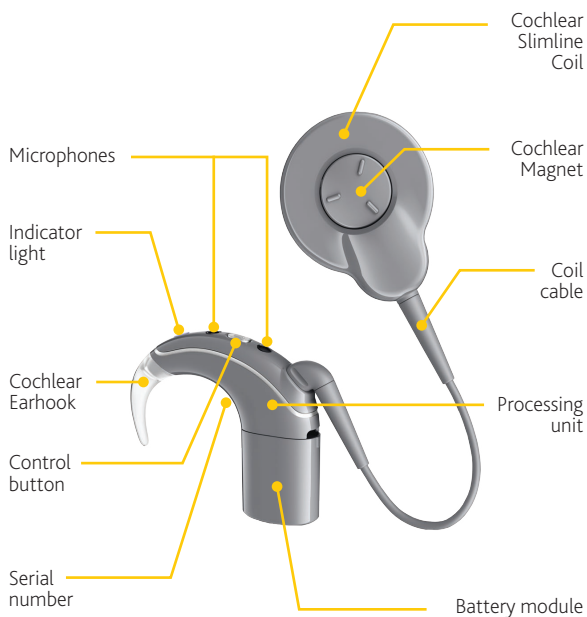

Contents

Power

Batteries	4
Battery life	5
Lock the battery module to the processor	6
Lock the disposable battery module cover	7
Replace the battery module	8
Change disposable batteries	10
Charge rechargeable batteries	12

Use

Pair with remote devices	18
Nucleus Smart App	19
Control options	19
Lock the control button	20
Turn on and off	20
Change program	22
Change volume and sensitivity	22
Telecoil	23
Wireless accessories	24
Use monitor earphones	26
Use Phonak's Roger™ 20	28

Wear

Wear your processor	28
Change earhooks	33
Retention accessories	34
Attach a SoftWear pad	37
Sport and exercise	38
Travel	40
Flight mode	41

Care

Regular care	42
Battery charger care	44
Storage	45
Water, sand and dirt	46
Change microphone cover	48
Change the coil	50
Change the coil magnet	51

Lights and Beeps	52
----------------------------	----

Troubleshoot	58
------------------------	----

Cautions	65
--------------------	----

Warnings

For parents and carers.	66
Processors and parts	67
Batteries	70
Medical treatments	71

Other information	74
-----------------------------	----

Batteries

You have a choice of three battery types for the Nucleus 7 Sound Processor:



The disposable battery module consists of:

- Cochlear Battery Cover
- Cochlear Battery Holder

It uses two disposable batteries and has a tamper-resistant lock.



The Cochlear Standard Rechargeable Battery Module



The Cochlear Compact Rechargeable Battery Module

Battery life

Batteries should be replaced as needed just as you would with any other electronic device. Battery life varies according to the programs used each day, your implant type, the thickness of skin covering your implant, and the size and type of battery.

The rechargeable battery's lifespan is at least 400 charge cycles. A completely empty rechargeable battery will take approximately four hours to recharge.

Rechargeable batteries may take longer to fully recharge with age. To get the longest life from the rechargeable batteries, always recharge before use.

To help you get the longest life from the batteries, your clinician can set your sound processor to turn off two minutes after you take it off your implant.

Lock the battery module to the processor

To increase tamper resistance, the battery module can be locked to the sound processor.



1. Push the lock to the far left to lock the battery module.



2. Push the lock to the far right to unlock the battery module.



WARNING

Some accessories that fit between the sound processor and the battery module prevent the battery module from being locked to the sound processor, which means that the battery module can be removed and poses a choking or ingestion hazard. Always supervise children under 3 years and others who may be at risk of choking on or ingesting small parts if they have these accessories fitted.



CAUTION

Always check this lock is unlocked before attaching or removing the battery module.



Lock the disposable battery module cover

The disposable battery module has a tamper-resistant lock to help prevent children opening the battery cover.



LOCK Turn the locking screw **clockwise** with the battery cover locking tool until it is in a **horizontal** position.

UNLOCK Turn the locking screw **anticlockwise** until it is in a **vertical** position.



CAUTION

Always check the locking screw is unlocked before attaching or removing the battery cover.

Replace the battery module

Remove the battery module



1. Twist the battery module as shown to release it from the processing unit.



2. Pull the battery module from the processing unit.



CAUTION

Always check the tamper-resistant lock is unlocked before removing the battery module (see page 6).

Attach the battery module

1. Fit the parts together with the battery module at a slight angle to the processor socket.

Rechargeable battery module:
align raised marker and arrow on battery module towards back of processing unit

Disposable battery module:
align indents and lock on battery module towards back of processing unit



2. Twist the battery module as shown to attach the parts.

Your processor will turn on automatically.



NOTE

If you do not put your processor on your implant, it will turn off automatically after two minutes, if enabled by your clinician.

Change disposable batteries

The disposable battery module uses two high power zinc air batteries. Cochlear recommends 675 (PR44) zinc air batteries designed for cochlear implant use. Do not use silver oxide or alkaline batteries.



1. **Press and hold** the button for 5 seconds, then **release** to turn off your processor.

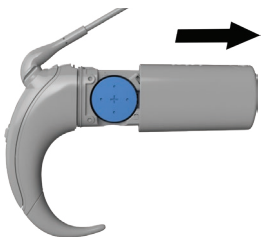

2. Pull the unlocked battery cover away from the battery holder.

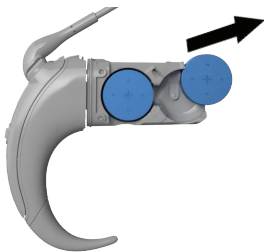

3. Remove the batteries from the battery holder.

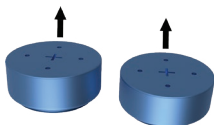

4. Remove the new batteries from the packet, and let them stand for a few seconds.

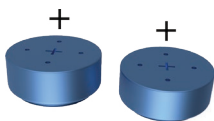

5. Insert the batteries into the battery holder with the flat side (positive terminal) facing up.

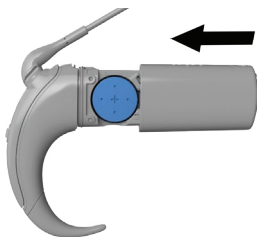

6. Replace the battery cover by sliding it up towards the processing unit.

Lock the cover if required.

Your processor will automatically turn on.



NOTE

If you do not put your processor on your implant, it will turn off automatically after two minutes, if enabled by your clinician.

Charge rechargeable batteries

There are two chargers that can be used with the rechargeable battery modules:

- Cochlear Y Battery Charger (see page 14)
- Cochlear USB Battery Charger (see page 16).

Before you start

Your rechargeable battery module has built-in safety and monitoring features. Read this section before using your battery charger.

NEW BATTERIES

You need to charge new batteries before first use.

WHAT DO I DO?

- Before using a new battery module, you need to connect it to a charger until it is fully charged.

CHARGING TEMPERATURE

The battery chargers have a built-in temperature sensor. Batteries must be charged at 0° C – +40° C (+32° F – +104° F). If battery module temperature is outside this range, the LED will flash orange (error).

WHAT DO I DO?

- Charge rechargeable battery modules at a room temperature of 0° C – +40° C (+32° F – +104° F).

BATTERY HEALTH CHECK

Rechargeable battery modules have a built-in “health check”. If a charged battery detects a problem, it will turn the sound processor off. If the problem is fixed, it will turn back on again.

WHAT DO I DO?

- If a battery turns off, disconnect and reconnect it to your processor. If this does not restore power, contact your clinician.

COMPLETELY FLAT BATTERIES

After many uses or being stored too long, some batteries may be too flat to allow recharging.

WHAT DO I DO?

- If a rechargeable battery module is too flat to charge, the LED will flash orange (error). Replace the battery module.

STORING BATTERIES

Your rechargeable battery module will lose some power if you do not use it for a period of time.

WHAT DO I DO?

- Charge your battery module before storing it.

CONNECTING TO ACCESSORIES

Some accessories (e.g. monitor earphone adaptor, Roger™ 20 receiver) fit between the rechargeable battery module and your processing unit.

If you leave them attached after use, this will drain the battery.

WHAT DO I DO?

- Don't leave your battery module attached to an accessory after use.
- Don't attach an accessory with a rechargeable battery module attached to the battery charger. This will cause an error.

Use the Y Battery Charger

The Y Battery Charger can charge two rechargeable battery modules at once.

It uses **the supplied USB cable** to plug into:

- a wall power outlet **using the Cochlear USB Power Adaptor**, or
- a USB port (e.g. computer).*



- 1 USB cable
- 2 Rechargeable battery module connector
- 3 LED indicator

* USB ports must be high power USB 1.0 or higher. If you use a USB hub to connect more than one USB device to a port, we recommend you use a powered hub.

1. Fit the rechargeable battery module to the charger at a slight angle. Twist to connect.



2. Plug the USB cable into a power outlet or USB port. The LED flashes green while charging.



NOTE

If you use a power outlet, plug the USB cable into the power adaptor first, then plug the adaptor into the power outlet.



3. The LED changes to steady green when the module is fully charged.



Use the USB Battery Charger

The USB Battery Charger can charge one rechargeable battery module at a time.

It uses a USB connector to plug into:

- a wall power outlet **using the Cochlear USB Power Adaptor**, or
- a USB port (e.g. computer).*



- 1 USB connector
- 2 Rechargeable battery module connector
- 3 LED indicator

* USB ports must be high power USB 1.0 or higher. If you use a USB hub to connect more than one USB device to a port, we recommend you use a powered hub.

1. Remove the covers from the charger.



2. Fit the rechargeable battery module to the charger at a slight angle. Twist to connect.



3. Plug the charger into a power outlet or USB port. The LED flashes green while charging.



NOTE

If you use a power outlet, plug the USB cable into the power adaptor first, then plug the adaptor into the power outlet.



4. The LED changes to steady green when the module is fully charged.



Pair with remote devices

Before using your processor with a compatible Apple® or Android™ device, or the Cochlear Remote Control, you need to pair your processor with the remote device.

Please refer to the app or remote user guides for details.



WARNING

Consider security when connecting your sound processor to devices such as smartphones or tablets. Only connect to devices that are protected, e.g. password or PIN access control. Do not connect to devices that have had their operating system altered.

Made for iPhone

Your Nucleus 7 Sound Processor is a Made for iPhone® / iPod® / iPad® hearing device. This allows you to use the control and audio streaming functions of compatible Apple devices.

If you wear a sound processor on one ear and a compatible MFi hearing aid on the other, you may be able to simultaneously control them and stream audio using a compatible iOS device. Your clinician can check compatibility and set this up for you.

Android

Your Nucleus 7 Sound Processor is compatible with the ASHA (Audio Streaming for Hearing Aid) protocol. This allows you to use the audio streaming functions of compatible Android devices.



NOTE

Pairing your sound processor with your device does not enable the functionality of the Nucleus Smart App. If you want to use the app, you need to download it from Google Play or the App Store®.

Nucleus Smart App

With a compatible Apple or Android device, you can use the Nucleus Smart App to control and monitor your sound processor. Please refer to your app user guide for details.

Control options

The table below compares the three ways you can control your sound processor.



NOTE

Some functions are only available if enabled by your clinician.

FUNCTION	PROCESSOR BUTTON	REMOTE CONTROL	NUCLEUS SMART APP
Turn ON/OFF	X		
Program	X	X	X
Volume		X	X
Sensitivity		X	X
Telecoil	X	X	X
Wireless accessories	X	X	X
Master Volume Limit			X
Bass / Treble			X
ForwardFocus			X



NOTE

This means that Volume and Sensitivity can only be changed using the Remote Control or Nucleus Smart App.

Lock the control button

You can lock the sound processor's control button using the Nucleus Smart App.

Please refer to the app's user guide for details.

Turn on and off

1. To turn **on**, either:

- Connect the battery (see page 9), or
- If the battery is already connected, **short-press** the button.





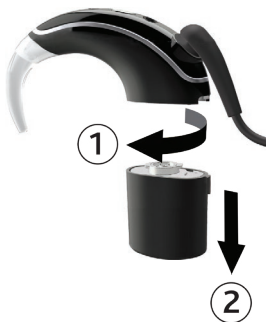

2. To turn **off**, either:

- Disconnect the battery (see page 8), or
- **Press and hold** the button for 5 seconds. The light will change to steady orange as the processor turns off.



NOTE

Your processor will also turn off automatically after being off your implant for two minutes, if enabled by your clinician.

INDICATOR LIGHTS	WHAT IT MEANS
 <p data-bbox="153 418 306 445">Green flashes</p>	<p data-bbox="491 286 891 382">Turning on processor. The number of flashes indicates the number of the current program.</p>
 <p data-bbox="153 508 373 536">Quick green flashes</p>	<p data-bbox="491 474 855 570">Processor flashes while receiving sound from microphones (Child mode only).</p>
 <p data-bbox="153 628 322 655">Orange flashes</p>	<p data-bbox="491 594 803 621">Processor is off the implant.</p>
 <p data-bbox="153 719 381 746">Long flash of orange</p>	<p data-bbox="491 684 752 712">Processor is turning off.</p>

Change program

You can choose between programs to change the way your sound processor deals with sound (e.g. in noisy or quiet places). Usually two programs are all you need, but your clinician can give you up to four programs.

1. **Short-press** the button to switch between programs.



NOTE

If your clinician has enabled SCAN, your sound processor can automatically respond to the sound environment without you needing to change program.

INDICATOR LIGHT

WHAT IT MEANS



Green flashes

Changing the program
(Child mode only).

The number of flashes indicates the
number of the current program

Change volume and sensitivity

If set up by your clinician, you can control the levels of volume or sensitivity (if available) using your remote control or the Nucleus Smart App.

Please see their user guides for details.

Telecoil

Your clinician can enable telecoil if you want to listen to room hearing loops.



NOTE

Telecoil is optimised for room loops. For phone use we recommend the Cochlear Wireless Phone Clip (see page 24) or a compatible smartphone (see page 18).



TIP

You can also use your remote control or the Nucleus Smart App to control telecoil. See their user guides for details.

1. **Press and hold** the button for 2 seconds **then release** to turn on telecoil.



Blue: telecoil is on.

2. **Short press** the button to turn off telecoil.



Wireless accessories

Cochlear True Wireless™ Accessories can wirelessly stream sound to your processor:

- The **Mini Microphone** or **TV Streamer** are controlled from your processor.
- You use the Phone Clip controls for phone calls.



NOTE

You first need to pair your wireless accessories with your sound processor. See their user guide for details.



TIP

You can also use your remote control or the Nucleus Smart App to control wireless accessories. See their user guides for details.

Each button press cycles you through telecoil (if enabled), and then your wireless accessories (in the order in which they were paired to your processor).

Scenario 1: Telecoil is enabled

PRESS	STREAMED AUDIO
1	Telecoil
2	Wireless accessory 1 (e.g. Mini Microphone)
3	Wireless accessory 2 (e.g. TV Streamer)
4...	Telecoil...

Scenario 2: No telecoil

PRESS	STREAMED AUDIO
1	Wireless accessory 1 (e.g. Mini Microphone)
2	Wireless accessory 2 (e.g. TV Streamer)
3	Wireless accessory 3 (e.g. extra Mini Microphone)
4...	Wireless accessory 1...

1. **Press and hold** the button for 2 seconds **then release** to stream audio.

Press and release again if you need to cycle to the next audio source.



Blue: streaming audio.

2. **Short press** the button to stop streaming.



Use monitor earphones

Carers can use monitor earphones to check that a Cochlear implant recipient is receiving sound, and that functions like telecoil or wireless accessories are working.



WARNING

You will not be able to lock the battery module to the sound processor when using the Monitor Earphone Adaptor, which means that the battery module can be removed and poses a choking or ingestion hazard. Always supervise children under 3 years and others who may be at risk of choking on or ingesting small parts if they have the Monitor Earphone Adaptor fitted.



CAUTIONS

- Only use Cochlear-approved earphones with the Cochlear Monitor Earphone Adaptor. You CAN use earbuds. You CANNOT use noise-cancelling headphones.
- Don't connect multiple monitor earphone adaptors in series.
- Don't connect the monitor earphone adaptor to other audio outputs, e.g. computer.



1. Twist to disconnect, then remove the battery module.



2. Insert the monitor earphone adaptor, then twist to connect.



3. Insert the battery module, then twist to connect.



4. Plug the earphones into the monitor earphone adaptor.



CAUTION

Use only Cochlear-approved earphones.

5. Use the earphones to check that the recipient is hearing sound.
6. Remove the earphones and adaptor as soon as you have finished monitoring.



NOTES

- Do not put the sound processor on the recipient's implant while using the monitor earphone adaptor, because there is no signal to the coil while it is connected.
- Remember to reconnect the battery module and lock it to your sound processor using the tamper-resistant lock.

Use Phonak's Roger™ 20



WARNING

You will not be able to lock the battery module to the sound processor when using Roger 20, which means that the battery module can be removed and poses a choking or ingestion hazard. Always supervise children under 3 years and others who may be at risk of choking on or ingesting small parts if they have the Roger 20 fitted.

1. Connect the Roger 20 to your sound processor.



2. Connect the battery module.

3. After use, disconnect the Roger 20.



NOTE

Remember to reconnect the battery module and lock it to your sound processor using the tamper-resistant lock.

Wear your processor



1. Place the processor on your ear, letting the coil dangle.

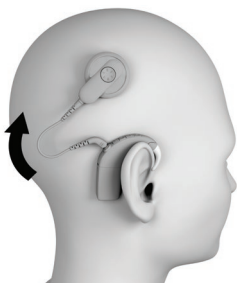

2. Move the coil sideways and onto your implant.

INDICATOR LIGHTS

WHAT IT MEANS



Flash of orange every second

Processor flashes while coil is off
(or connected to the wrong implant).

People with two implants

Ask your clinician to give you coloured stickers (red for right, blue for left) to make identifying left and right processors easier.



CAUTION

If you have two implants, you must use the correct sound processor for each implant.



NOTE

For recipients with newer implants, your sound processor will recognise the implant's ID, so it will not work on the wrong implant.

People with CI600 Series implants

If you have a CI600 Series implant, avoid sliding your processor sideways onto your implant. This could cause the processor magnet to misalign with your implant. Always place the processor down onto your implant.

To place the processor on your head:

1. Hold the processor slightly above the implant location on your head.
2. Rotate the processor slightly in both directions (clockwise and anti-clockwise).



3. When you feel a strong pull, place the processor on the implant.
4. Rotate the processor so that the microphones are facing up.

Change earhooks

The Cochlear Earhook comes in small, medium and large sizes.

For extra help wearing your processor securely and safely, see *Retention accessories* on page 34.



NOTE

Remove your earhook only when necessary—it may become loose if it is removed too often.



1. Pull up on the earhook to remove it.



2. Click the new earhook into place.

Retention accessories

A range of optional Cochlear accessories are available to help you wear your sound processor securely and safely.



WARNING

Only use Cochlear-approved retention accessories.



NOTES

- Hybrid mode cannot be used with retention accessories. They either position the sound processor off the ear, or use a custom earhook which means the acoustic component cannot be fitted.
- See the user instructions that are packed with each accessory.

Cochlear Tamper Resistant Earhook

A small earhook for young children. An extra hook holds it in place to reduce the risk of it becoming a choking hazard.



Cochlear Snugfit

Holds your sound processor more securely in place than an earhook alone.

Available in small, medium and large.



Cochlear Hugfit™

Holds a child's sound processor in place more securely than an earhook alone.

Carers can access controls and accessories.

In three sizes to suit small ears.



Cochlear Earmould Adaptor

Allows you to attach a custom earmould if you prefer this to a normal earhook.



NOTE

The custom earmould is not supplied by Cochlear.



Cochlear Koala Clip

Holds your sound processor so you can clip it onto your clothing. An option for young children until they can wear their processor on their ear.



NOTE

You will need to use a coil with a longer cable.



Cochlear Safety Cord

Clips to clothing so children and active adults are less likely to lose their sound processor.

Available in single or double (for users with two processors).



Cochlear Headworn Adaptor

Holds your sound processor and coil, so you can wear them on your head.



NOTES

- Headworn adaptor comes in right or left side models — your processor needs to face the same way as when you wear it on your ear.
- Headworn adaptor works best with a 6, 8 or 11 cm coil cable and a compact rechargeable battery module.
- Headworn adaptor may rotate on your head. If it does, you may need to use a stronger magnet. But if you already use a strong magnet, you may not be able to use a Headworn adaptor. Contact your clinician.
- Don't forget to change to your original magnet strength when you wear your sound processor behind your ear again.
- If you experience a change in performance when using your processor with the Headworn adaptor, contact your clinician.



WARNING

Increasing magnet strength may cause tightness, pain or pressure sores at the implant site. Contact your clinician.

Attach a SoftWear pad

The Cochlear SoftWear™ pad is optional. If you experience discomfort from your coil, you can attach this adhesive pad to the head side of your coil.

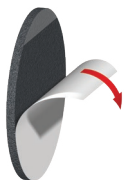

1. Peel off the single backing strip on the adhesive side of the pad.



2. Attach the pad to the head side of the coil—press down firmly.

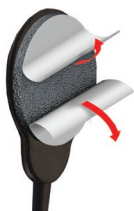

3. Peel off the two semicircle backing covers on the cushion side of the pad.
4. Wear your processor as usual.



NOTES

- The SoftWear pad may affect your sound processor's performance. If you notice any change, contact your clinician.
- Do not use the SoftWear pad with a Cochlear Nucleus 7 Aqua+ Coil or the Cochlear Coil Spacer.

Sport and exercise



TIP

Always ensure the battery cover and battery modules are locked when you exercise or play sport.



NOTE

If you want to use your processor around water, ask your clinician about the Cochlear Nucleus 7 Aqua+.

1. Use retention accessories such as the Snugfit or Safety Cord to help hold your processor in place when you play sport or exercise.





2. After exercise, wipe your processor with a soft cloth to remove sweat or grime.



3. Then check your microphone protectors for dirt.

See *Change microphone cover* on page 48.



Travel



NOTE

Visit www.cochlear.com/clinic-finder to find the nearest clinic in places you are travelling.

- Take a printout from your clinician of your most recent programs in case you need help with your processor.
- If you have a backup sound processor, check that it is programmed correctly and take it with you.
- It's okay to move through metal detectors and full body scanners with your sound processor on. To avoid any possible buzzing sounds in your ear, turn off the telecoil.
- Ask your clinician for a Patient Identification Card. In the unlikely event that your implant sets off a metal detector the ID card will help explain that you have an implanted medical device.
- If you need to remove your sound processor as you move through airport security, place it in a case in your hand luggage.
- Your sound processor transmits high frequency radio waves when switched on, and may need to be placed in a flight-safe mode during takeoff and landing. Check with airline staff before flying if you are unsure.

Flight mode



NOTE

In flight mode, you can change programs as normal using the processor button. You can only use telecoil to stream audio, as True Wireless Accessories will not be available.

To enter flight mode:

1. Disconnect the battery.



2. **Press and hold** the button (1) while reconnecting the battery (2).

Release the button when the green light comes on.



To exit flight mode:

1. Disconnect and reconnect the battery.

Regular care



CAUTIONS

- Do not use cleaning agents or alcohol to clean your processor and accessories.
- Turn your processor off before cleaning or performing maintenance.

Every day

- Check all parts and any accessories you use (e.g. Snugfit, SoftWear pad) for dirt or moisture. Wipe the processor, coil, cable, earhook and accessories with a soft dry cloth. (You can leave accessories on the processor while cleaning.)
- Keep your processor free from moisture by drying it every night in your dry aid kit.
- Remove the battery module and make sure all the contacts are clean. Carefully tap or blow on them to remove any dirt. Wipe the contacts with a soft dry cloth.
- Keep accessories clean. Blow on connectors to remove any dust and clean accessories with a soft dry cloth.
- Check the microphone protectors for signs of dirt or grime and replace if needed. See *Change microphone cover* on page 48.

Every month

- Check if earhooks or retention accessories are becoming loose or showing signs of wear. Replace as needed. See *Change earhooks* on page 33, or your retention accessory's instructions.
- Replace a SoftWear pad (if used) if it is worn or damaged, or has accumulated dirt or moisture that cannot be wiped off. If you have any problem with comfort, that is not helped by changing the SoftWear pad, contact your clinician. See *Attach a SoftWear pad* on page 37.
- If you use disposable batteries, check if the battery cover is becoming loose. If it is, replace the Cochlear Battery Holder O-ring.

Every two months

- Replace the dry brick in your dry aid kit.

Every three months

- Replace the microphone cover—this is very important for the quality of sound. See *Change microphone cover* on page 48.

Battery charger care

Every day

- Check your battery charger is clean. If you notice any dust or dirt:
 1. Disconnect the battery charger from the power source and remove any battery modules.
 2. Hold the battery charger upside down and tap it gently to remove any dirt from the battery charger sockets. Carefully blowing on the sockets may also help remove dirt.
 3. Wipe the battery charger sockets with a soft dry cloth.
- (Y Battery Charger) Use a different charger socket each time you charge to wear the sockets evenly.

If it gets wet

- If the battery charger ever gets splashed with liquid, carefully shake out the liquid and dry the battery charger for 24 hours. Do not use the battery charger until it is dry.

Storage

Dry aid kit

Store your processor at night in the dry aid kit provided by Cochlear:

- using **disposable batteries**: store the processor fully assembled.
- using a **rechargeable battery**: remove the battery module and recharge if necessary. Leave the coil attached to the processing unit and store in the dry aid kit.



Storage case

For long term storage:

- remove disposable batteries and store so they do not touch each other.
- remove rechargeable battery modules and store fully charged.

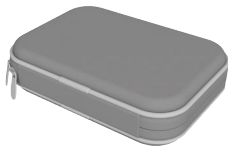

Storage cases are available from Cochlear.

Water, sand and dirt

Your processor is resistant to water, sand and dust. However, it is still a precision electronic device so you should take the following precautions.



If your processor ever gets wet, dry it with a soft cloth.

Then remove the battery module (and disposable batteries if used), dry them and the contacts with a soft cloth, and replace them.

Replace the microphone protectors and place your processor in the dry aid kit provided by Cochlear for 8 hours.

See *Batteries* on page 4.

See *Change microphone cover* on page 48.



If sand or dirt ever enter the processor, shake the components carefully to remove it.

Your processor is protected against failure from dust and temporary immersion in water (IP57 rated) when you wear it with:

- a rechargeable battery module
- a coil
- no acoustic component.



If you use a disposable battery module instead of a rechargeable battery module or use the processor with an acoustic component worn in the ear, it is protected against failure from dust and splashing water (IP54 rated).



Change microphone cover

Replace your microphone protectors every three months, or if they look dirty or you notice any loss in sound quality. They are built into the Cochlear Microphone Cover, which is completely replaced.



Step 1: Remove old microphone cover



1. Hold the coil cable grip and firmly **pull it straight out** of the processor.
Do not tug on the flexible part of the coil cable.

 **CAUTION**
Do not twist the coil cable when you pull it out of the processor.



2. Lift the microphone cover from the bottom edge, then lift it up to remove.

Step 2: Insert new microphone cover



1. Fit the replacement microphone cover onto the processor.



2. Press down firmly with a finger on each end of the microphone cover until you feel a click.



3. Push your coil cable into the processor until it clicks. **Do not twist.**

Change the coil

The Cochlear Slimline™ Coil comes in four cable lengths (6, 8, 11 and 25 cm) so you can choose the most comfortable fit.

You might also need to change to a different cable length to use some retention accessories (e.g. Koala Clip).



NOTE

Only remove the coil from your sound processor when necessary.



1. Hold the coil cable grip and firmly **pull it straight out** of the processor. Do not pull on the flexible part of the coil cable.



CAUTION

Do not twist the coil cable when you pull it out of the processor.



2. Push the new coil cable into the processor until it clicks into place. **Do not twist.**

Change the coil magnet

You need to choose a Cochlear Magnet that is the correct strength—if it is too weak the coil may fall off, and if it is too strong it may cause discomfort.

Magnet strengths range from $\frac{1}{2}$ (weakest) to **6** (strongest) for standard magnets and $\frac{1}{2}$ (I) (weakest) to **5(I)** (strongest) for '(I)' magnets.

You might also need to change to a stronger magnet to use some retention accessories (e.g. Headworn adaptor).



NOTE

If your clinician has provided you with a Cochlear Magnet Reverse Polarity, use it as described here for a normal magnet.



1. With finger grips facing up, unscrew the magnet anticlockwise.



2. Remove the magnet.

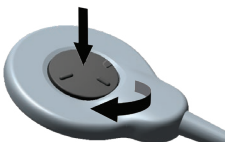

3. Insert the new magnet and turn clockwise until it stops.



4. Turn the magnet a little more until you feel a click.





TIP

The tamper-resistant lock marker aligns with the coil cable when locked.



Lights

Your clinician can set up your processor to show some or all of the following light indications.



Turning on and off

LIGHT	WHAT IT MEANS
 Quick green flashes	Processor flashes while receiving sound from microphones (Child mode only).
 Quick green flashes	Turning on and changing programs. Number of flashes indicates the number of the current program.
 Long flash of orange	Turning off processor.

Locking button

LIGHT	WHAT IT MEANS
 Green flash followed by orange	Locking processor button.
 Orange flash followed by green	Unlocking processor button.
 Orange flash when pressing button	Processor button is locked.

Streaming audio



LIGHT	WHAT IT MEANS
 Flashes blue for 4 seconds	Processor flashes when pairing to wireless accessory is successful.
 Quick blue flashes	Processor flashes while receiving audio from an audio source (Child mode only).

ForwardFocus *



LIGHT	WHAT IT MEANS
 Quick green flash	Turning ForwardFocus on/off (Child mode only).

* If available, Nucleus Smart App only

Alerts

LIGHT	WHAT IT MEANS
 Flash of orange every second	Processor flashes while it is off your head (or connected to the wrong implant).
 Orange flashes	Processor batteries are low. Change batteries.
 Steady orange	Fault. Contact your clinician. Stays on until the issue is resolved.



Battery charging

LIGHT	WHAT IT MEANS
 ...	Battery module is charging.
	Battery module is fully charged.
 ...	Error (see <i>Troubleshoot</i> on page 58).



Beeps

Your clinician can set up your processor so you can hear the following beeps (they are only audible to you).

Turning on and off

BEEP	WHAT IT MEANS
 Short high beeps	Changing the program. The number of beeps indicates the number of the selected program.
 Short high beep	Changing volume or sensitivity level (if available).
 Short high then short low beep	When changing volume or sensitivity, indicates upper or lower limit of volume/sensitivity reached.



Locking button

BEEP	WHAT IT MEANS
 Short low beep when you press button	Processor button is locked.
 Short high then short low beep	Locking processor button.
 Short low then short high beep	Unlocking processor button.



Telecoil

BEEP	WHAT IT MEANS
 Long high beep	Switching between using the microphones and telecoil.



Wireless accessories

BEEP	WHAT IT MEANS
 5 ascending beeps	Connecting with wireless accessory to begin streaming audio.
 Short low beep	When stopping streaming.

Alerts

BEEP	WHAT IT MEANS
 2 Short low beeps	Processor batteries are low. Change batteries.
 Short low beeps for 4 seconds	Batteries are empty and processor is turning off. Change batteries.
 4 long low beeps over 4 seconds	General fault. Consult your clinician.

Adjusting master volume limit, bass and treble *

BEEP	WHAT IT MEANS
 Loud long medium beep	Adjusting master volume limit.
 Loud long high beep	Adjusting treble level.
 Loud long low beep	Adjusting bass level.

ForwardFocus *

BEEP	WHAT IT MEANS
 Short high beep	Turning ForwardFocus on/off.

* If available, Nucleus Smart App only

Troubleshoot

Contact your clinician if you have any concerns regarding the operation or safety of your sound processor.

PROBLEM	RESOLUTION
Processor will not turn on/button will not respond	<ol style="list-style-type: none">1. Try turning the processor on again. See <i>Lock the control button</i> on page 20.2. Try unlocking the button. See on page 19.3. Change the batteries. See <i>Replace the battery module</i> on page 8 or <i>Change disposable batteries</i> on page 10.4. If you are using a new rechargeable battery, that has not been charged it may still be in "Sleep Mode". See <i>Charge rechargeable batteries</i> on page 12.5. If you have two implants, check that you are wearing the correct sound processor on each implant.6. Check the battery contacts are free of dirt and dust. See <i>Water, sand and dirt</i> on page 46.7. If the problem continues, contact your clinician.
The processor switches off	<ol style="list-style-type: none">1. Ask your clinician if "Auto power off" is enabled. If it is, then the processor will switch off after two minutes when not connected to the implant.2. Change the batteries. See <i>Replace the battery module</i> on page 8 or <i>Change disposable batteries</i> on page 10.

PROBLEM	RESOLUTION
The processor will not turn off	<ol style="list-style-type: none"> 1. Check the processor is not locked. See on page 19. 2. Remove the battery module from the processing unit. See <i>Remove the battery module</i> on page 8.
You are not sure what processor beeps or light flashes mean	See <i>Lights</i> on page 52 and <i>Beeps</i> on page 55.
You do not hear sound or sound is intermittent	<ol style="list-style-type: none"> 1. Make sure the coil cable is fully inserted into the socket on the processor 2. Make sure you are using the correct coil magnet for your implant. If unsure, contact your clinician. 3. Make sure the coil is oriented properly on your head. See <i>Wear your processor</i> on page 30. 4. If you use the Remote Control, turn up the volume. 5. If you use the Nucleus Smart App, turn up the volume or sensitivity. 6. Try a different program. See <i>Change program</i> on page 22. 7. Change the batteries. See <i>Replace the battery module</i> on page 8 or <i>Change disposable batteries</i> on page 10. 8. If the problem continues, contact your clinician.
	<ol style="list-style-type: none"> 1. Check for sources of interference such as radio and TV transmission towers (within approximately 1.6 km or 1 mile), Radio Frequency ID (RFID) shop security and card scanners, airport and office security systems, road toll systems and mobile phones. 2. Move away from any source of magnetic, radio or electronic interference. 3. If the problem continues, contact your clinician.

PROBLEM	RESOLUTION
Sound is too loud or uncomfortable	<ol style="list-style-type: none"> 1. If you use a Remote Control, turn down the volume. 2. If you use the Nucleus Smart App, turn down the volume or sensitivity. 3. Try a different program. See <i>Change program</i> on page 22. 4. If you have two sound processors (one for each side), ensure you have them on the correct side. 5. If the problem continues, remove the processor and coil from your head immediately and contact your clinician.
Sound is too quiet or muffled	<ol style="list-style-type: none"> 1. If you use a Remote Control, turn up the volume. 2. If you use the Nucleus Smart App, turn up the volume or sensitivity. 3. Try a different program. See <i>Change program</i> on page 22. 4. Try changing the microphone protectors. See <i>Change microphone cover</i> on page 48. 5. If the problem continues, contact your clinician.
Coil does not attach as strongly as usual	<ol style="list-style-type: none"> 1. Make sure the coil is oriented properly on your head. See <i>Wear your processor</i> on page 30.

PROBLEM	RESOLUTION
You want to confirm your processor is receiving sound	<ol style="list-style-type: none">1. Check the light on the top of the processor (if enabled). See <i>Lights</i> on page 52.2. If you have a monitor earphone adaptor, a hearing person can listen to the sound received by the processor. See <i>Use monitor earphones</i> on page 26.3. If you use the Nucleus Smart App, use the Status screen to check the processor is receiving sound4. If the problem continues, contact your clinician.
The processor or coil become hot	<ol style="list-style-type: none">1. Remove the processor and coil from your head immediately, disconnect the battery module and contact your clinician.
You experience tightness, discomfort or develop a skin irritation at your implant site	<ol style="list-style-type: none">1. Your coil magnet may be too strong or in contact with your skin. Change to a weaker magnet. See <i>Change the coil magnet</i> on page 51.2. Try using an adhesive SoftWear pad. See <i>Attach a SoftWear pad</i> on page 37.3. If you are using a retention aid, such as a headband, this may be placing pressure on your processor. Adjust your retention aid, or try a different aid.4. If the problem continues, contact your clinician.

PROBLEM	RESOLUTION
You do not hear sound from a wireless accessory	<ol style="list-style-type: none"> 1. Testing has shown that interference from nearby electrical devices can sometimes disrupt streaming from a wireless accessory – try moving away from any device that might be causing this interference. 2. Check that the wireless accessory is charged and turned on. 3. Check that the wireless accessory is paired with your processor. 4. Check the volume of the wireless accessory. 5. If you use the Nucleus Smart App, use the Status screen to check the processor is receiving sound from the accessory. 6. If you use the Nucleus Smart App, check and adjust the accessory/microphone volume. 7. If available, try a different processor. 8. For more troubleshooting, see the <i>True Wireless Accessories User Guide</i>.
You do not hear sound from a monitor earphone	<ol style="list-style-type: none"> 1. Check that the monitor earphone cable is fully inserted into the socket on the monitor earphone adaptor. 2. Check that the monitor earphone adaptor is properly connected to the processor and battery module. 3. If you use the Nucleus Smart App, use the Status screen to check the processor volume level. 4. If available, try a different processor.
You hear loud or distorted sound from a monitor earphone	<ol style="list-style-type: none"> 1. Remove the monitor earphone and consult your clinician.

PROBLEM	RESOLUTION
The processor gets wet	<ol style="list-style-type: none">1. Dry the processor with a soft cloth, change the microphone protectors and place the processor in the dry aid kit provided by Cochlear for 8 hours. See <i>Water, sand and dirt</i> on page 46.
You want to perform a regular check on your processor	See <i>Regular care</i> on page 42.
Batteries are not lasting as long as usual	<ol style="list-style-type: none">1. Clean all connections and parts of the battery module.2. Clean all connections on the processing unit.3. Make sure you are using the correct coil magnet for your implant. If unsure, contact your clinician.4. Make sure the coil is oriented properly on your head. See <i>Wear your processor</i> on page 30.5. Try replacing the coil with a new coil.6. If you are using disposable batteries, check that you are using the recommended batteries. See <i>Change disposable batteries</i> on page 10.7. Don't forget to let new disposable batteries stand for a few seconds before you put them in the sound processor.8. If the problem continues, contact your clinician.
The indicator light on the battery charger shows a fully charged battery is still charging	<ol style="list-style-type: none">1. This won't cause any damage to the battery as the charge cycle on a fully charged battery is very short.

PROBLEM	RESOLUTION
The indicator light on the battery charger is flashing orange	<ol style="list-style-type: none"> 1. Only connect rechargeable battery modules to the charger. 2. Try a different rechargeable battery module. 3. If you are using the Y battery charger, try the rechargeable battery module on the other connector on the charger. 4. The room temperature may be outside the operating range of the charger. Try using the charger in a different location. 5. The USB port may not be the correct type. Try another USB port. 6. If using a USB hub, too many devices may be connected to the hub. Try removing some devices from the hub. 7. If using a USB hub, it may not be the correct type. Use a powered hub.
The indicator light on the battery charger does not light	<ol style="list-style-type: none"> 1. The rechargeable battery module is not properly connected. Check the connection. 2. The rechargeable battery module is over-discharged. 3. The rechargeable battery module is faulty. Try a different module. 4. There is no power to the USB port. Check the power supply.

Cautions

- Young children who are developing motor skills are at greater risk of an impact to the head from a hard object (e.g. table or chair). Impact to the sound processor may cause damage to the processor or its parts. Impact to the head in the area of the Cochlear implant could damage it and result in its failure.
- Most patients can benefit from electrical stimulation levels that are considered safe, based on animal experimental data. The long-term effects of such stimulation in humans are unknown.

Warnings

For parents and carers

- Removable parts of the system (e.g. microphone cover, magnets, batteries, battery cover, o-ring, earhooks) can be lost or may be a choking, ingestion or strangulation hazard. Keep out of reach of children and use the tamper-resistant locks to lock the battery module to the sound processor and the cover to the battery holder.
- Some accessories that fit between the sound processor and the battery module prevent the battery module from being locked to the sound processor, which means that the battery module can be removed and poses a choking or ingestion hazard. Always supervise children under 3 years and others who may be at risk of choking on or ingesting small parts if they have these accessories fitted.
- Parents and carers are advised that unsupervised use of long cables (e.g. coil or accessory cables) may present a risk of strangulation.
- Carers must routinely check the device for signs of overheating and for signs of discomfort or skin irritation at the implant site. Remove the processor and coil immediately if there is any discomfort or pain (e.g. if device becomes hot, or sound is uncomfortably loud) and contact your clinician.
- Carers must monitor for signs of discomfort or skin irritation if a retention aid is used that applies pressure to the sound processor or coil. Remove the aid immediately if there is any discomfort or pain, and contact your clinician.
- Keep the dry brick from the dry aid kit away from small children. Swallowing this material can cause serious internal injuries.

- Do not allow children to replace batteries without adult supervision.
- Do not allow children to use a battery charger without adult supervision.

Processors and parts

- Each processor is programmed specifically for each implant. Never wear another person's processor or lend yours to another person.
- Use your Cochlear implant system only with Cochlear-approved devices and accessories.
- If you experience a significant change in performance, remove your processor and contact your clinician.
- Your processor and other parts of the system contain complex electronic parts. These parts are durable but must be treated with care.
- No modification of this equipment is allowed. Warranty will be void if modified.
- Remove the monitor earphones immediately if the sound level is uncomfortably loud and inform your clinician.
- If the coil magnet is too strong or is in contact with the skin, pressure sores may develop at the implant site. If this happens, or if you experience tightness or pain in this area, stop using your sound processor and contact your clinician.
- Do not apply continued pressure to the coil when in contact with the skin (e.g. sleeping while lying on coil, or using tight fitting headwear).
- Do not push the volume too high for comfort in case a loud noise occurs nearby.
- If you need to adjust the volume often, or if adjusting volume ever causes discomfort, contact your clinician.
- Do not use your sound processor in an explosive or oxygen-rich environment.

- Do not let your processor or parts entangle with any jewellery (e.g. earhook and earrings) or machinery.
- Do not place the processor or parts in any household devices (e.g. microwave oven, dryer).
- Do not expose the processor or parts to heat (e.g. never leave them in sunlight, behind a window or in a car).
- Do not use a dry aid kit that has an Ultra Violet C (UVC) lamp (e.g. do not use the Freedom™ Dry and Store).
- The magnetic attachment of your sound processor to your implant may be affected by other magnetic sources.
- The magnetic attachment of your sound processor to your implant may affect hearing aids.
- Your sound processor coil and magnet may be affected by metallic or magnetic objects. Keep metallic or magnetic objects away from your coil.
- Store spare coil magnets safely and away from cards that may have a magnetic strip (e.g. credit cards, bus tickets).
- Your device contains magnets that should be kept away from life supporting devices (e.g. cardiac pacemakers and ICDs (implantable cardioverter defibrillators) and magnetic ventricular shunts), as the magnets may affect the function of these devices. Keep your processor at least 15 cm (6 in) from such devices. Contact the manufacturer of the specific device to find out more.
- Your sound processor and remote control radiate electromagnetic energy that may interfere with life supporting devices, (e.g. cardiac pacemakers and ICDs). Keep your processor and remote control at least 15 cm (6 in) from such devices. Contact the manufacturer of the specific device to find out more.

- Do not place the device or accessories inside any part of your body (e.g. nose, mouth).
- Seek medical advice before entering any environment that may adversely affect the operation of your Cochlear implant, including areas protected by a warning notice preventing entry by patients fitted with a pacemaker.
- Some types of digital mobile telephones (e.g. Global System for Mobile communications (GSM) as used in some countries) may interfere with the operation of your external equipment. You may hear distorted sound when close, 1-4 m (~3-12 ft), to a digital mobile telephone in use.
- For Cochlear Nucleus cochlear implant recipients only, the maximum diving depth is 40 m (~131 ft). Seek medical advice before diving to ensure you do not have any conditions that might make diving contraindicated (e.g. middle ear infection). When wearing a mask, avoid pressure over the implant site.
- Before activities that create electrostatic discharge (e.g. playing on plastic playground equipment), remove your processor. In rare cases, discharge of static electricity can damage or cause your sound processor to shut down. If your processor shuts down, it should resume normal operation after restarting it. If static electricity is present (e.g. when putting on clothes over your head, or getting out of a car), before the Cochlear implant system touches any object or person, you should touch something conductive such as a metal door handle.

Batteries

- Use only Cochlear supplied or recommended 675 (PR44) zinc air batteries designed for cochlear implant use. We do not recommend using silver oxide or alkaline batteries.
- Insert disposable batteries in the correct orientation.
- If disposable batteries are short-circuited the processor will not work and its temperature can reach +42° C (+107° F). Remove the processor and coil immediately and contact your clinician.
- Do not mix disposable batteries that differ by manufacturer, brand, type, age or previous usage.
- Do not leave flat disposable batteries in the sound processor.
- Replace both disposable batteries at the same time.
- Dispose of used batteries promptly and carefully, in accordance with local regulations. Keep away from children.
- Do not short-circuit batteries (e.g. do not let terminals of batteries contact each other, do not place batteries loose in pockets, etc.).
- Do not disassemble, deform, immerse in water or dispose of batteries in fire.
- When processor is not in use, remove the batteries and store separately in a clean and dry place.

- Wipe batteries with a clean dry cloth if they become dirty.
- Store unused batteries in original packaging, in a clean and dry place.
- Do not use damaged or deformed batteries. If skin or eyes come into contact with battery fluid or liquid, wash out with water and seek medical attention immediately.
- Do not expose batteries to heat (e.g. never leave batteries in sunlight, behind a window or in a car).
- Never put batteries in your mouth. If swallowed, immediately contact your physician or local poison information service.
- Do not recharge disposable batteries.
- Only use rechargeable batteries and battery chargers supplied or recommended by Cochlear. Use of other batteries or battery chargers may result in harm or injury.
- Charge rechargeable batteries before use.

Medical treatments

Magnetic resonance imaging (MRI)



The Nucleus 7 Sound Processor, remote and related accessories (such as the Wireless Programming Pod) are MR Unsafe.

Full MRI safety information is available at www.cochlear.com/warnings or by calling your regional Cochlear office (contact numbers available at the end of this document).

Medical treatments generating induced currents, heat and vibration

Having a cochlear implant means extra care must be taken when receiving some medical treatments. Before starting medical treatment, the information in this section should be discussed with the recipient's physician.

The sound processor must be removed before starting any of the medical treatments listed in this section.

Some medical treatments generate induced currents that may cause tissue damage or permanent damage to the implant. Before initiating any of the following treatments deactivate the device.

Warnings for specific treatments are provided below.

CONDITION	WARNING
Diathermy	Do not use therapeutic or medical diathermy (thermopenetration) using electromagnetic radiation (magnetic induction coils or microwave). High currents induced into the electrode lead can cause tissue damage to the cochlea/brainstem or permanent damage to the implant. Medical diathermy using ultrasound may be used below the head and neck.
Electroconvulsive therapy	Do not use electroconvulsive therapy on an implant patient under any circumstances. Electroconvulsive therapy can cause tissue damage or damage to the implant.

CONDITION	WARNING
Electrosurgery	<p>Electrosurgical instruments can induce radio frequency currents that could flow through the electrode.</p> <p>Monopolar electrosurgical instruments must not be used on the head or neck of an implant patient as induced currents could cause damage to cochlear/neural tissues or permanent damage to the implant.</p> <p>When using bipolar electrosurgical instruments on the head and neck of a patient, the cautery electrodes must not contact the implant and should be kept more than 1 cm (½ in.) from the electrodes.</p>
Ionising radiation therapy	<p>Do not use ionising radiation therapy directly over the implant. It may cause damage to the implant.</p>
Neurostimulation	<p>Do not use neurostimulation directly over the implant. High currents induced into the electrode lead can cause tissue damage to the cochlea/brainstem or permanent damage to the implant</p>
Therapeutic ultrasound	<p>Do not use therapeutic levels of ultrasound energy directly over the implant. It may inadvertently concentrate the ultrasound field and cause tissue damage or damage to the implant.</p>

Other information

Physical configuration

The processing unit comprises:

- Two omni-directional microphones for receiving sound.
- An internal telecoil for receiving magnetic fields radiated by neck loops and room loops.
- Custom analogue and digital integrated circuits with digital signal processing (DSP) and bidirectional wireless communication capabilities.
- A tri-colour visual indication of processor function or problem.
- Control button allowing user control of key features.
- Custom 4-pin connector for coil cable.
- A range of earhooks and specialised retention options.

The batteries provide power to the processor. The coil acts as a transformer coupling that transfers energy and data to the implant.

Materials

- Processing unit: copolyester.
- Battery modules (all types) are made of copolyester.
- Coil is made of polypropylene (PP), thermoplastic elastomer (TPE).
- Coil magnet casing is made of acrylonitrile butadiene styrene (ABS).
- Coil cable sheath is made of polyvinyl chloride (PVC).
- Coil cable plugs are made of PP and TPE.
- Retention parts are made from polyamide (PA) and liquid silicone rubber (LSR).

Battery life, charge cycles and lifespan

- Battery life means the time a device will run before the disposable batteries must be replaced, or the rechargeable batteries recharged.
- Battery charge cycle is a full charge and discharge of the rechargeable battery.
- Battery lifespan means the total number of charge cycles a rechargeable battery will last before the battery life degrades to 80% of its original fully-charged capacity.

Operating characteristics

Processing unit

CHARACTERISTIC	VALUE/RANGE
Sound input frequency range	100 Hz to 8 kHz
Operating voltage	2.00 V to 4.25 V
Power consumption	20 mW to 100 mW
Charge cycles	≥ 80% capacity after 400 charge/discharge cycles at room temperature
Button functions	Turn processor on and off, turn audio streaming on and off, change program
Remote communication range	<ul style="list-style-type: none">• At least 2 m (remote control)• At least 3 m (Phone Clip)• At least 7 m (Mini Microphone, TV Streamer)• At least 2 m (Made for iPhone control)• At least 7 m (Made for iPhone streaming)• At least 7 m (Android streaming*) * available only on compatible Android devices

Battery module

TYPE	CAPACITY/VOLTAGE RANGE
Disposable battery module	Two PR44 (zinc air) button cell batteries. 1.45 V (nominal) each. Cochlear recommends 675 zinc air batteries designed for cochlear implant use.
Compact rechargeable battery module	91 mAh / 3.7 V
Standard rechargeable battery module	183 mAh / 3.7 V

Coil

CHARACTERISTIC	VALUE/RANGE
Technology	Inductive power and data transfer using coupled resonant coils
Operating voltage	2.0 V to 2.6 V
Data rate	1.25 Mbps (4 CPC), 1 Mbps (5 CPC)
Protocols	Cochlear's proprietary embedded protocol employing a series of 4 or 5 consecutive pulses at 5 MHz
Separation between coil and implant	1-10 mm

Sound processor to implant inductive link

The inductive link between the sound processor coil and the implant performs two functions: it transfers power from the sound processor to the implant; and provides a bi-directional data communication link. Both power and data are transferred in the reactive near H-field. The link uses a Cochlear proprietary embedded protocol employing a series of 4 or 5 consecutive pulses clocked at 5 MHz and operates over a distance of 1-10 mm. Data validity and parity checking is used to ensure correct data transfer. In the presence of interference, the sound processor triggers a "coil-off" orange light indication and the Nucleus Smart App provides a visual indication that the coil is decoupled from the implant.

Wireless technology

CHARACTERISTIC	VALUE/RANGE
Technology	Proprietary low power bi-directional wireless link
Power output	1 mW (0 dBm)
RF frequency	2.4 GHz (range 2.40 – 2.83 GHz)
Radiated power	-3.2 dBm
Channel spacing	1 MHz
Maximum data rate	2 Mbps
Modulation	GFSK
Protocols	NXP2 protocol: Proprietary wireless protocol based on GN ReSound's low power bi-directional wireless link (Proximity 2 protocol). Bluetooth Smart: Commercially available low energy wireless protocol.
Wireless transmission range	At least 3-7 m depending on accessory At least 2 m for CR310 and MFi control At least 7 m for MFi streaming

Wireless communication link

The wireless communication link operates in the 2.4 GHz ISM band using GFSK (Gaussian frequency-shift keying), and a proprietary bidirectional communication protocol. It continuously switches between channels to avoid interference on any specific channel.

- The remote control operates over 4 channels, over a distance of at least 2 metres from the processor. It indicates via its display when the processor is out of operating distance (or switched off) or when the link is interrupted due to broad spectrum interference (see remote's user guide for more information).
- The True Wireless accessories operate over 16 channels, over a distance of at least 3 metres for the Phone Clip, and 7 metres for the Mini Microphone and TV Streamer.

Bluetooth® Smart also operates in the 2.4 GHz ISM band, using frequency hopping over 37 channels to combat interference. Operating range is at least 7 metres, and the app indicates when the processor is out of operating distance (or switched off) or when the link is interrupted due to broad spectrum interference.

Product component dimensions (*Typical values*)

ITEM	LENGTH	WIDTH	DEPTH	DIAMETER
Nucleus 7 processing unit with medium earhook and compact rechargeable battery module	36.5 mm	9.0 mm	45.0 mm	N/A
Disposable battery module	29.4 mm	9.0 mm	17.3 mm	N/A
Compact rechargeable battery module	18.0 mm	9.0 mm	17.3 mm	N/A
Standard rechargeable battery module	24.8 mm	9.0 mm	17.3 mm	N/A
Coil	N/A	N/A	5.8 mm	30.3 mm

Product weight (*Typical values. All weights are measured with a medium earhook.*)

COMPONENT	WEIGHT
Nucleus 7 processing unit (no battery module)	3.9g
Nucleus 7 processing unit with compact rechargeable battery module	7.9g
Nucleus 7 processing unit with standard rechargeable battery module	9.8g
Nucleus 7 processing unit with disposable battery module (including two 675 zinc air batteries)	10.1g
Coil and cable (without coil magnet)	3.9g

Environmental conditions

CONDITION	MINIMUM	MAXIMUM
Storage & transport temperature	-10° C (+14° F)	+55° C (+131° F)
Storage & transport humidity	0% RH	90% RH
Operating temperature (sound processor)	+5° C (+41° F)	+40° C (+104° F)
Operating temperature (battery charger)	0° C (+32° F)	+40° C (+104° F)
Operating relative humidity	0% RH	90% RH
Operating pressure	700 hPa	1060 hPa

Disposable batteries

Check the battery manufacturer's recommended operating conditions for disposable batteries used in your processor.

Electromagnetic compatibility (EMC)

Guidance and manufacturer's declaration – electromagnetic emissions

The Nucleus 7 Sound Processor is intended for use in the electromagnetic environment specified below. The customer or the user of the Nucleus 7 Sound Processor should assure that it is used in such an environment.

EMISSIONS TEST	COMPLIANCE	ELECTROMAGNETIC ENVIRONMENT – GUIDANCE
RF emissions CISPR 11	Group 1	The Nucleus 7 Sound Processor uses RF energy only for its internal function. Therefore, its RF emissions are very low and are not likely to cause any interference in nearby electronic equipment.
	Class A	(Wired Programming Mode) The Nucleus 7 Sound Processor is suitable for use in clinics and hospitals.
	Class B	(Normal Mode, Wireless Programming Mode) The Nucleus 7 Sound Processor is suitable for use in all establishments, including domestic and those directly connected to the public low voltage power supply network that supplies buildings used for domestic purposes.
Harmonic emissions IEC 61000-3-2	Not applicable	
Voltage fluctuations/ flicker emissions IEC 61000-3-3	Not applicable	

Guidance and manufacturer's declaration – electromagnetic immunity

The Nucleus 7 Sound Processor is intended for use in the electromagnetic environment specified below. The customer or the user of the Nucleus 7 Sound Processor should assure that it is used in such an environment.

IMMUNITY TEST	COMPLIANCE LEVEL	ELECTROMAGNETIC ENVIRONMENT – GUIDANCE
Electrostatic discharge (ESD) IEC 61000-4-2	± 8 kV contact ± 15 kV air	Floors should be wood, concrete or ceramic tile. If floors are covered with synthetic material, the relative humidity should be at least 30%.
Electrical fast transient/burst IEC 61000-4-4	Not applicable	Not applicable
Surge IEC 61000-4-5	Not applicable	Not applicable
Voltage dips, short interruptions and voltage variations on power supply input lines IEC 61000-4-11	Not applicable	Not applicable
Power frequency (50/60 Hz) magnetic field IEC 61000-4-8	30 A/m	Power frequency magnetic fields should be at levels characteristic of a typical location in a typical commercial or hospital environment.

Guidance and manufacturer's declaration – electromagnetic immunity

The Nucleus 7 Sound Processor is intended for use in the electromagnetic environment specified below. The customer or the user of the Nucleus 7 Sound Processor should assure that it is used in such an environment.

ELECTROMAGNETIC ENVIRONMENT – GUIDANCE

Portable and mobile RF communications equipment should be used no closer to any part of the Nucleus 7 Sound Processor, including cables, than the recommended separation distance calculated from the equation applicable to the frequency of the transmitter.

IMMUNITY TEST: Conducted RF IEC 61000-4-6

COMPLIANCE LEVEL: 3 V 0.15 to 80 MHz; 6 V in ISM 0.15 to 80 MHz
Recommended separation distance $d=1.16\sqrt{P}$

IMMUNITY TEST: Radiated RF IEC 61000-4-3

COMPLIANCE LEVEL: 10 V/m 80 MHz to 2.7 GHz

$d=0.35\sqrt{P}$ 80 MHz to 800 MHz

$d=0.70\sqrt{P}$ 800 MHz to 2.7 GHz

where P is the maximum output power rating of the transmitter in watts (W) according to the transmitter manufacturer and d is the recommended separation distance in metres (m).

Field strengths from fixed RF transmitters, as determined by an electromagnetic site survey, should be less than the compliance level in each frequency range.

Interference may occur in the vicinity of equipment marked with the following symbol:



IMMUNITY TEST: Proximity fields from RF wireless communications equipment IEC 61000-4-3

COMPLIANCE LEVEL: 385 MHz (27 V/m); 450, 810, 870, 930, 1720, 1845, 1970, 2450 MHz (28 V/m); 710, 745, 780, 5240, 5500, 5785 MHz (9 V/m)



WARNING

Portable RF communications equipment (including peripherals such as antenna cables and external antennas) should be used no closer than 30 cm (12 in.) to any part of your Nucleus 7 Sound Processor, including cables specified by the manufacturer. Otherwise, degradation of the performance of this equipment could result.

NOTE 1: At 80 MHz and 800 MHz, the higher frequency range applies.

NOTE 2: These guidelines may not apply in all situations. Electromagnetic propagation is affected by absorption and reflection from structures, objects and people.

NOTE 3: If abnormal performance is observed, additional measures may be necessary, such as reorienting or relocating the Nucleus 7 Sound Processor.

Radio Frequency Identification (RFID)

RFID uses electromagnetic fields to automatically identify and track tags attached to objects. Interference may occur in the vicinity of equipment that uses RFID, such as shop security and card scanners.

FCC (Federal Communications Commission) and Canadian ISED compliance

This device complies with part 15 of the FCC Rules and with RSS-210 of Innovation, Science and Economic Development Canada. Operation is subject to the following two conditions:

- This device may not cause harmful interference.
- This device must accept any interference received, including interference that may cause undesired operation.

Changes or modifications made to this equipment not expressly approved by Cochlear Limited may void the FCC authorisation to operate this equipment.

This equipment has been tested and found to comply with the limits for a Class B digital device, pursuant to Part 15 of the FCC Rules. These limits are designed to provide reasonable protection against harmful interference in a residential installation.

This equipment generates, uses and can radiate radio frequency energy and, if not installed and used in accordance with the instructions, may cause harmful interference to radio communications. However, there is no guarantee that interference will not occur in a particular installation.

If this equipment does cause harmful interference to radio or television reception, which can be determined by turning the equipment off and on, the user is encouraged to try to correct the interference by one or more of the following measures:

- Reorient or relocate the receiving antenna.
- Increase the separation between the equipment and receiver.
- Connect the equipment into an outlet or a circuit different from that to which the receiver is connected.
- Consult the dealer or an experienced radio/TV technician for help.

FCC ID: WTO-CP1000

IC: 8039A-CP1000

CAN ICES-3 (B)/NMB-3(B)

Labelling symbols

The following symbols may appear on your processor or accessories and/or packaging:



Refer to instruction manual



Specific warnings or precautions associated with the device, which are not otherwise found on the label



Manufacturer



Compatible sound processors



Authorised representative in the European Community



Catalogue number



Serial number



Batch code



Date of manufacture



Use by date



Temperature limits



CE registration mark with notified body number



Radio compliance certification for Australia and New Zealand

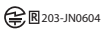

203-JN0604

Radio compliance certification for Japan



Radio compliance certification for Korea

Rx Only

By prescription



Recyclable material



Dispose of electrical components in accordance with your local regulations



Type B applied part



Medical Device



Unique Device Identification

IP54

Ingress Protection Rating

- Protected against access of solid foreign objects greater than or equal to 1.0 mm diameter.
- Protected against failure from dust penetration.
- Protected against failure from splashing water.

IP57

Ingress Protection Rating

- Protected against access of solid foreign objects greater than or equal to 1.0 mm diameter.
- Protected against failure from dust penetration.
- Protected against failure from temporary immersion in water.

Cochlear implant compatibility

The Nucleus 7 Sound Processor is compatible with the following Nucleus Cochlear Implants:

- CI24M, CI24M Double Array and ABI24M,
- CI24R (CA), CI24R (ST) and CI24R (CS),
- CI24RE Series: CI24RE (CA), CI24RE (ST), CI24RE Hybrid L24 and CI422,
- CI500 Series: CI512, CI513, CI522, CI532 and ABI541.

Equipment classification

Your sound processor is internally powered equipment Type B applied part as described in the international standard IEC 60601-1:2005/A1:2012, Medical Electrical Equipment – Part 1: General Requirements for Basic Safety and Essential Performance.

Legal statement

The statements made in this guide are believed to be true and correct as of the date of publication. However, specifications are subject to change without notice.

© Cochlear Limited 2021

Notes

A series of 20 horizontal dotted lines for writing notes.

Hear now. And always

Cochlear Ltd (ABN 96 002 618 073) 1 University Avenue, Macquarie University, NSW 2109, Australia
Tel: +61 2 9428 6555 Fax: +61 2 9428 6352

Cochlear Ltd (ABN 96 002 618 073) 14 Mars Road, Lane Cove, NSW 2066, Australia
Tel: +61 2 9428 6555 Fax: +61 2 9428 6352

Cochlear Deutschland GmbH & Co. KG Karl-Wiechert-Allee 76A, 30625 Hannover, Germany
Tel: +49 511 542 770 Fax: +49 511 542 770

Cochlear Americas 10350 Park Meadows Drive, Lone Tree, CO 80124, USA
Tel: +1 303 790 9010 Fax: +1 303 792 9025

Cochlear Canada Inc 2500-120 Adelaide Street West, Toronto, ON M5H 1T1, Canada
Tel: +1 416 972 5082 Fax: +1 416 972 5083

Cochlear AG EMEA Headquarters, Peter Merian-Weg 4, 4052 Basel, Switzerland
Tel: +41 61 205 8204 Fax: +41 61 205 8205

Cochlear Europe Ltd 6 Dashwood Lang Road, Bourne Business Park, Addlestone, Surrey KT15 2HJ, United Kingdom
Tel: +44 1932 26 3400 Fax: +44 1932 26 3426

Cochlear Benelux NV Schaliënhoedreef 20 i, B-2800 Mechelen, Belgium
Tel: +32 15 79 55 11 Fax: +32 15 79 55 70

Cochlear France S.A.S. 135 Route de Saint-Simon, 31035 Toulouse, France
Tel: +33 5 34 63 85 85 (International) or 0805 200 016 (National) Fax: +33 5 34 63 85 80

Cochlear Italia S.r.l. Via Larga 33, 40138 Bologna, Italy
Tel: +39 051 601 53 11 Fax: +39 051 39 20 62

Cochlear Nordic AB Konstruktionsvägen 14, 435 33 Mölnlycke, Sweden
Tel: +46 31 335 14 61 Fax: +46 31 335 14 60

Cochlear Tibbi Cihazlar ve Sağlık Hizmetleri Ltd. Şti.

Çubuklu Mah. Boğaziçi Cad., Boğaziçi Plaza No: 6/1, Kavacık, TR-34805 Beykoz-Istanbul, Turkey
Tel: +90 216 538 5900 Fax: +90 216 538 5919

Cochlear (HK) Limited Room 1404-1406, 14/F, Leighton Centre, 77 Leighton Road, Causeway Bay, Hong Kong
Tel: +852 2530 5773 Fax: +852 2530 5183

Cochlear Korea Ltd 1st floor, Cheongwon Building 33, Teheran-ro 8 gil, Gangnam-gu, Seoul, Korea
Tel: +82 2 533 4450 Fax: +82 2 533 8408

Cochlear Medical Device (Beijing) Co., Ltd

Unit 2608-2617, 26th Floor, No.9 Jianguo Road, Chaoyang District, Beijing 100022, P.R. China
Tel: +86 10 5909 7800 Fax: +86 10 5909 7900

Cochlear Medical Device Company India Pvt. Ltd.

Ground Floor, Platina Building, Plot No C-59, G-Block, Bandra Kurla Complex, Bandra (E), Mumbai – 400 051, India
Tel: +91 22 6112 1111 Fax: +91 22 6112 1100

株式会社日本コクレア (Nihon Cochlear Co Ltd) 〒113-0033 東京都文京区本郷2-3-7 お茶の水元町ビル
Tel: +81 3 3817 0241 Fax: +81 3 3817 0245

Cochlear Middle East FZ-LLC

Dubai Healthcare City, Al Razi Building 64, Block A, Ground Floor, Offices IR1 and IR2, Dubai, United Arab Emirates
Tel: +971 4 818 4400 Fax: +971 4 361 8925

Cochlear Latinoamérica S.A.

International Business Park, Building 3835, Office 403, Panama Pacifico, Panama
Tel: +507 830 6220 Fax: +507 830 6218

Cochlear NZ Limited

Level 4, Takapuna Towers, 19-21 Como St, Takapuna, Auckland 0622, New Zealand
Tel: +64 9 914 1983 Fax: 0800 886 036

www.cochlear.com

Made for

 iPhone | iPad | iPod

ACE, Advance Off-Stylet, AOS, AutoNRT, Autosensitivity, Beam, Bring Back the Beat, Button, Carina, Cochlear, 科利耳, コクレア, 코클리어, Cochlear SoftWear, Codacs, Contour, コントウア, Contour Advance, Custom Sound, ESPrit, Freedom, Hear now. And always, Hugfit, Hybrid, Invisible Hearing, Kanso, MET, MicroDrive, MP3000, myCochlear, mySmartSound, NRT, Nucleus, Osia, Outcome Focused Fitting, Off-Stylet, Profile, Slimline, SmartSound, Softip, SPrint, True Wireless, the elliptical logo, and Whisper are either trademarks or registered trademarks of Cochlear Limited. Ardium, Baha, Baha SoftWear, BCDrive, DermaLock, EveryWear, Human Design, Piezo Power, SoundArc, Vistafix, and WindShield are either trademarks or registered trademarks of Cochlear Bone Anchored Solutions AB. Bluetooth is a registered trademark of Bluetooth SIG. Apple, iPad, iPhone and iPod touch are trademarks of Apple Inc, registered in the U.S. and other countries. Android is a trademark of Google Inc. Roger is a trademark of Sonova AG.

© Cochlear Limited 2021

D815388 V5 2021-03

Cochlear®