

B-1118 | Ram ProMaster Ambulance

Ex Reliance for elsewhere

A Ram ProMaster Ambulance conversion.

The drawings contained within this document are for representative purposes only. Details are meant to illustrate design intent and are subject to change during design and construction. Dimensions are approximate unless noted otherwise to meet customer requirements.

These drawings are protected under copyright and are the property of Malley Industries.

Not to be reproduced without authorization

Malley Industries
1100 Aviation Avenue,
Dieppe, NB, Canada, E1A 9A3
© 2020

Page 1 of 21.

Dealer
Malley Industries Inc.
1100 Aviation Avenue
Dieppe, NB, E1A 9A3
1 (877) 859-8591

B-1118 | Exterior Components

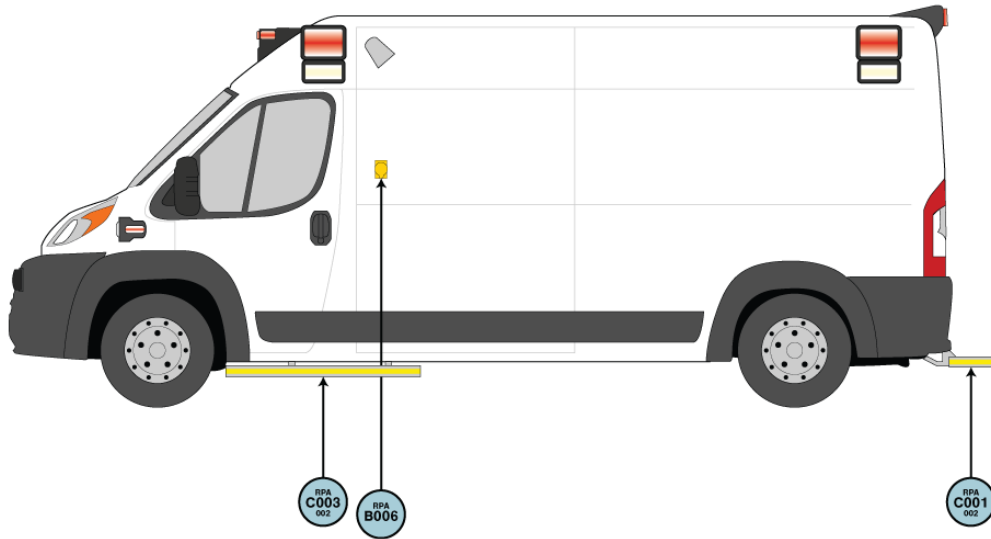

- [RPA-B006-001](#) - SHORE LINE - 20A AUTO-EJECT
- [RPA-B020-001](#) - HIDDEN UNLOCK BUTTON BEHIND FRONT GRILLE
- [RPA-B036-001](#) - SIREN CONTROLLER - WHELEN HFS2
- [RPA-B037-001](#) - SIREN SPEAKERS - 2X SA315P, MOUNT IN BUMPER
- [RPA-B038-001](#) - 2X RED LED & 2X WHITE LED GRILLE
- [RPA-B040-001](#) - BLACK FRONT LIGHT ARRAY (7"X3" LED - 6X RED & 2X CLEAR) USA
- [RPA-B041-001](#) - BLACK BEZELS - 4X 9"X7" RED LIGHTS - LED
- [RPA-B044-001](#) - 2X INTERSECTION LIGHT RED - LED
- [RPA-B045-001](#) - 4X 7"X3" SCENE LIGHTS - LED
- [RPA-B048-001](#) - BLACK REAR LIGHT ARRAY (7"X3" LED - 4X RED, 2X CLEAR & 1X AMBER)
- [RPA-B053-001](#) - MALLEY LIGHT PACKAGE
- [RPA-C001-002](#) - REAR FLIP-UP STEP - YELLOW TAPE
- [RPA-C003-002](#) - RUNNING BOARDS 7" - SHORT DS, LONG PS - YELLOW TAPE
- [RPA-C007-001](#) - EXHAUST OUTLET TO BE ON THE SIDE OF THE VEHICLE. (KKK REQUIREMENT)
- [RPA-Z005-001](#) - DARK WINDOW TINT

Malley Industries
1100 Aviation Avenue,
Dieppe, NB, Canada, E1A 9A3
© 2020

Page 2 of 21.

Dealer

Malley Industries Inc.
1100 Aviation Avenue
Dieppe, NB, E1A 9A3
1 (877) 859-8591

B-1118 | Exterior Components

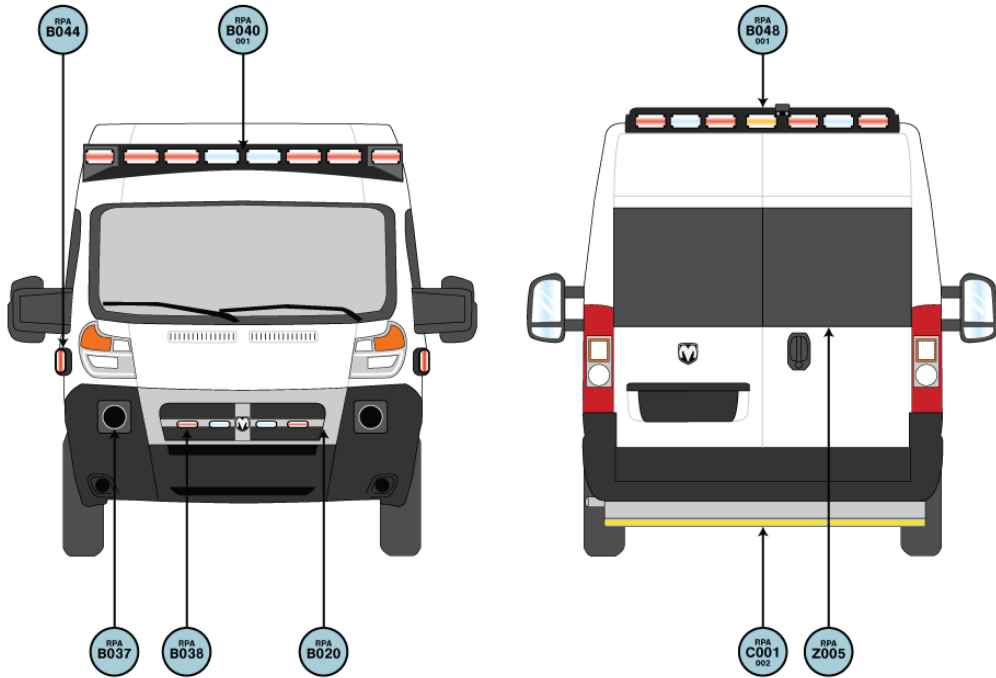

Malley Industries
1100 Aviation Avenue,
Dieppe, NB, Canada, E1A 9A3
© 2020

Page 3 of 21.

Dealer
Malley Industries Inc.
1100 Aviation Avenue
Dieppe, NB, E1A 9A3
1 (877) 859-8591

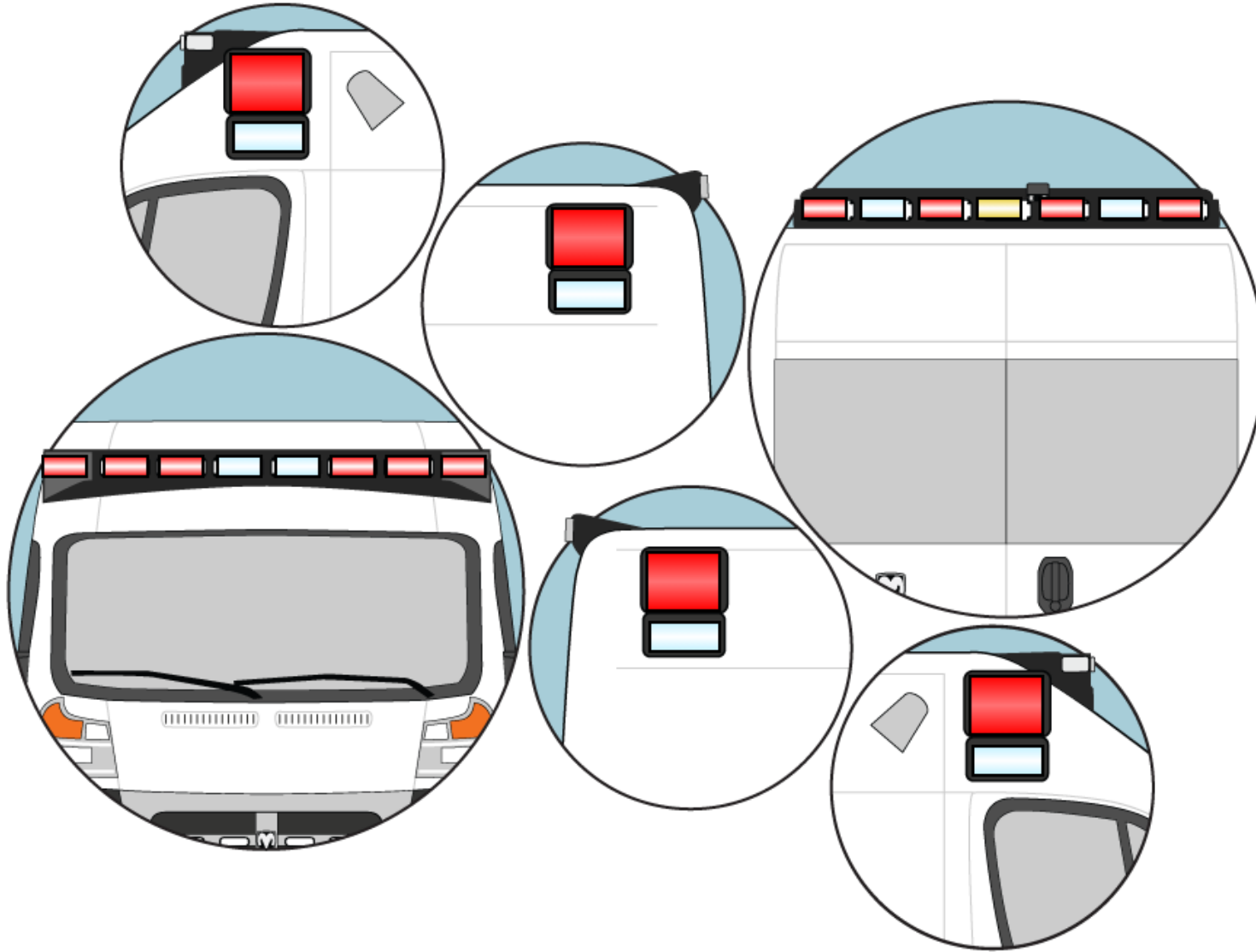

Malley Industries
1100 Aviation Avenue,
Dieppe, NB, Canada, E1A 9A3
© 2020

Dealer
Malley Industries Inc.
1100 Aviation Avenue
Dieppe, NB, E1A 9A3
1 (877) 859-8591

B-1118 | Upholstery, Flooring, and Conspicuity

- [RPA-C008-001](#) - CONSPICUITY TAPE KIT - YELLOW
- [RPA-D001-005](#) - UPHOLSTERY PADDING : BLACK
- [RPA-D002-001](#) - LONPLATE FLOORING : GREY

RPA-D001-005 BLACK

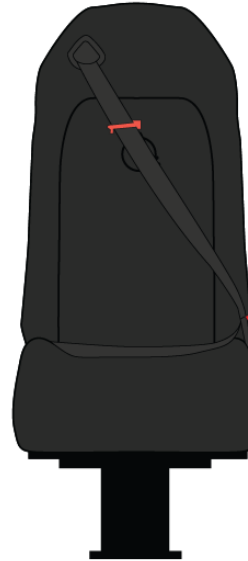

RPA-D002-001 LONPLATE FLOOR - GREY



B-1118 | Upholstery, Flooring, and Conspicuity

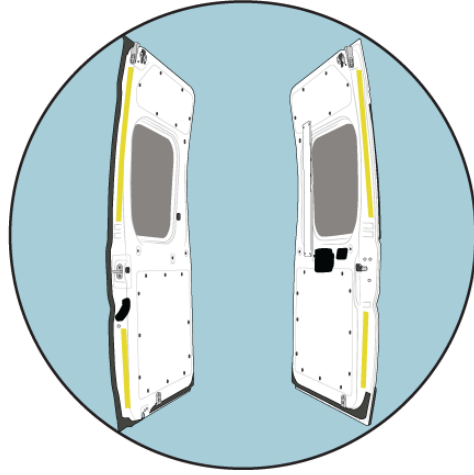
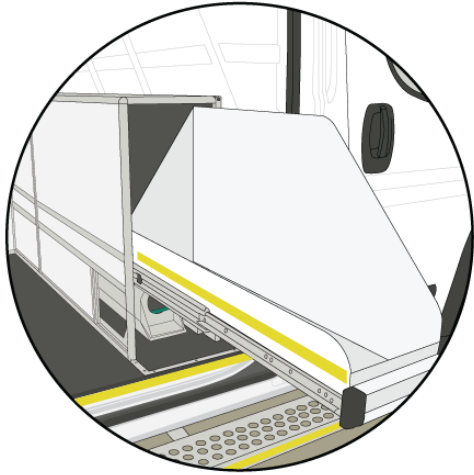

Malley Industries
1100 Aviation Avenue,
Dieppe, NB, Canada, E1A 9A3
© 2020

Page 6 of 21.

Dealer

Malley Industries Inc.
1100 Aviation Avenue
Dieppe, NB, E1A 9A3
1 (877) 859-8591

B-1118 | Electrical

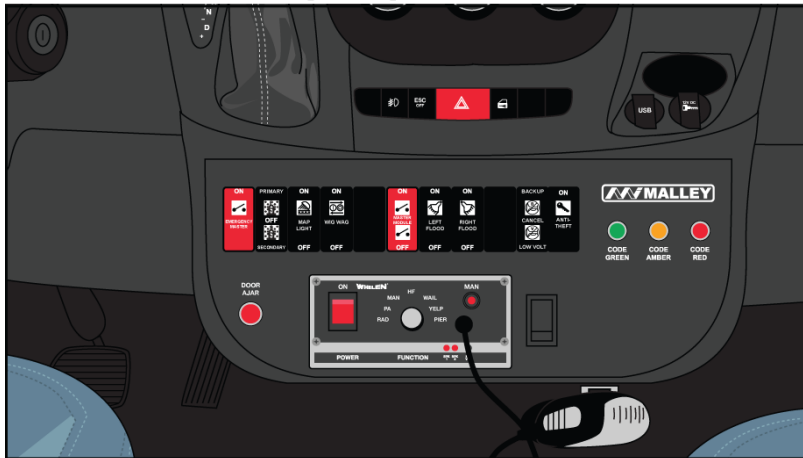
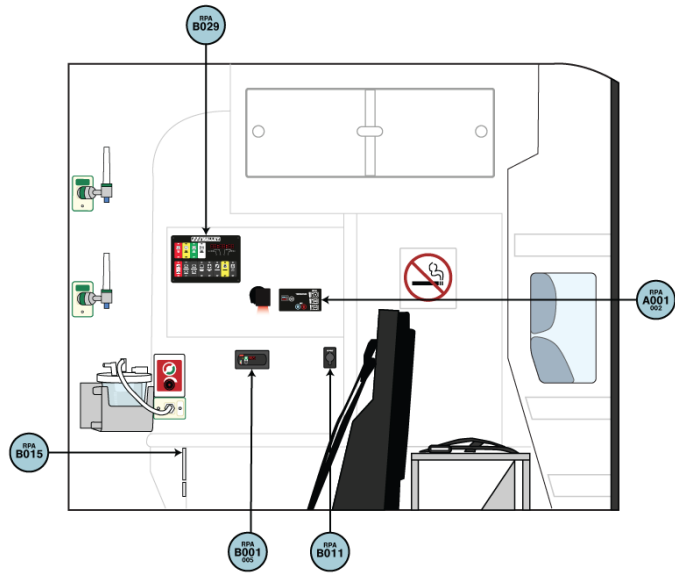

- [RPA-A001-002](#) - TEMPERATURE CONTROLLER WITH IMPERIAL UNITS (F).
- [RPA-A004-002](#) - NO 110V HEATER
- [RPA-B001-005](#) - XANTREX PURE SINE WAVE INVERTER / CHARGER (1000W 55A) AND BATTERY INSIDE VEHICLE
- [RPA-B006-001](#) - SHORE LINE - 20A AUTO-EJECT
- [RPA-B011-001](#) - 12VDC OUTLETS - 2 (1 IN ACTION WALL AND 1 IN FRONT CONSOLE)
- [RPA-B015-001](#) - 110V/15A OUTLETS - 1X DOUBLE DUPLEX & 2X SINGLE DUPLEX
- [RPA-B017-001](#) - EXTRA 110V/15A OUTLET
- [RPA-B029-003](#) - RC TRONICS CONTROL SYSTEM C/W 2 ACTION PANELS (FRONT CONSOLE, ACTION WALL C/W DIGITAL CLOCK)
- [RPA-B056-001](#) - ACTIVTEK INDUCT 500
- [RPA-D019-001](#) - ELECTRICAL CABINET

Dealer

Malley Industries
1100 Aviation Avenue,
Dieppe, NB, Canada, E1A 9A3
© 2020

Malley Industries Inc.
1100 Aviation Avenue
Dieppe, NB, E1A 9A3
1 (877) 859-8591

B-1118 | Action Wall

- [RPA-B034-001](#) - READING LIGHT (MOUNTED ON ACTION WALL)
- [RPA-D026-001](#) - AIRWAY SEAT, SEAMLESS, HI-BAC CHILD SEAT
- 3PT SEAT BELT - WB
- [RPA-D033-001](#) - AIRWAY SEAT BASE, SPACE-SAVER
- [RPA-D034-001](#) - ABS STEEL -REINFORCED PARTITION WITH
FLIP-UP WINDOW
- [RPA-G003-002](#) - OXYGEN FLOW METER, THORPE (TUBE) STYLE
(US - OHMEDA) X 2
- [RPA-G003-004](#) - OXYGEN FLOW METER, THORPE (TUBE) STYLE
(US - OHMEDA) EXTRA
- [RPA-G031-001](#) - SHORT SUCTION CANISTER 1500ML C/W
OHMEDA WALL PLATE

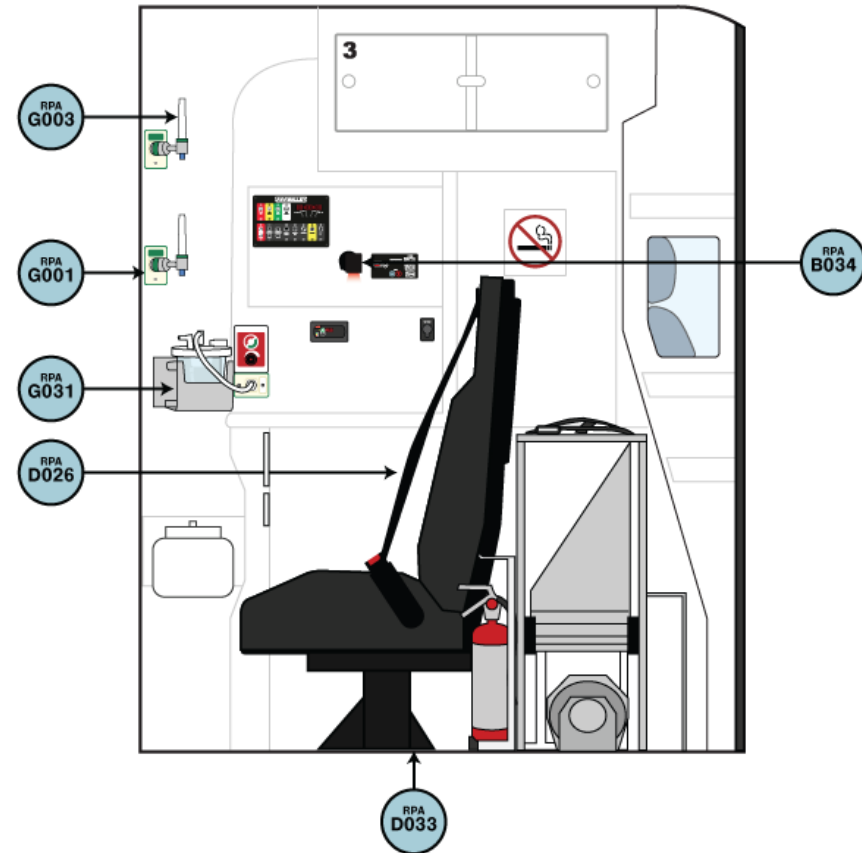

Malley Industries
1100 Aviation Avenue,
Dieppe, NB, Canada, E1A 9A3
© 2020

Page 8 of 21.

Dealer
Malley Industries Inc.
1100 Aviation Avenue
Dieppe, NB, E1A 9A3
1 (877) 859-8591

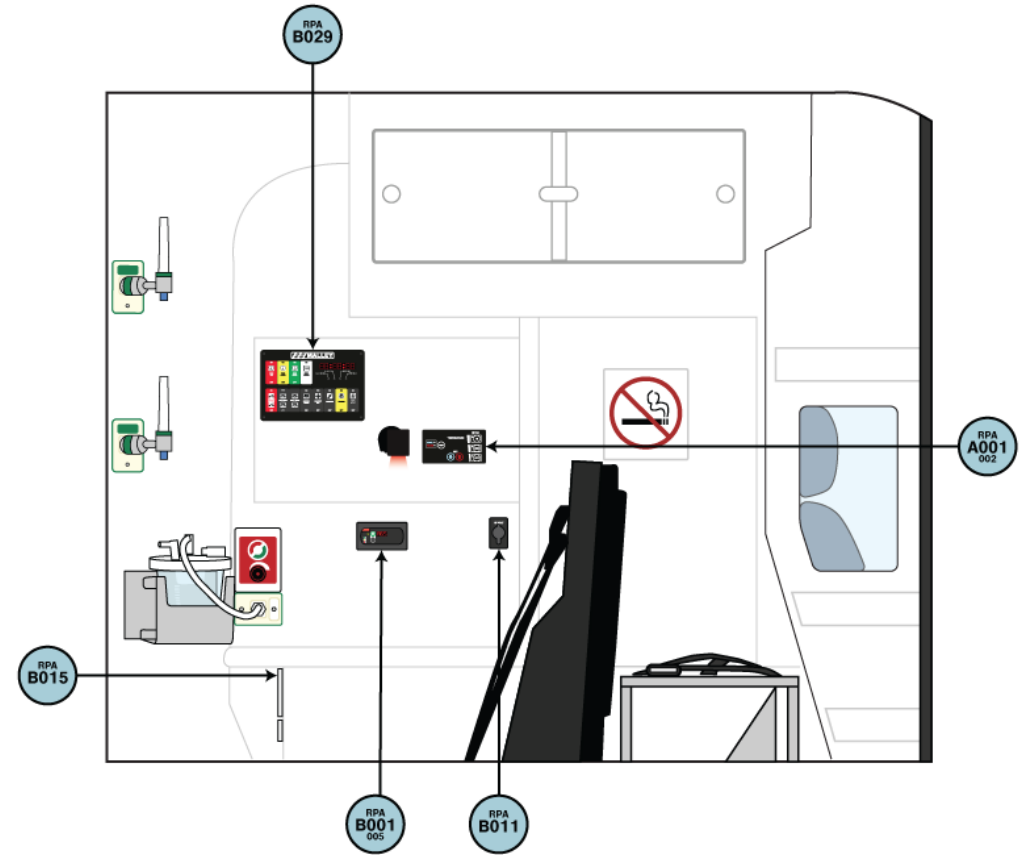

Malley Industries
1100 Aviation Avenue,
Dieppe, NB, Canada, E1A 9A3
© 2020

Dealer
Malley Industries Inc.
1100 Aviation Avenue
Dieppe, NB, E1A 9A3
1 (877) 859-8591

B-1118 | Ceiling

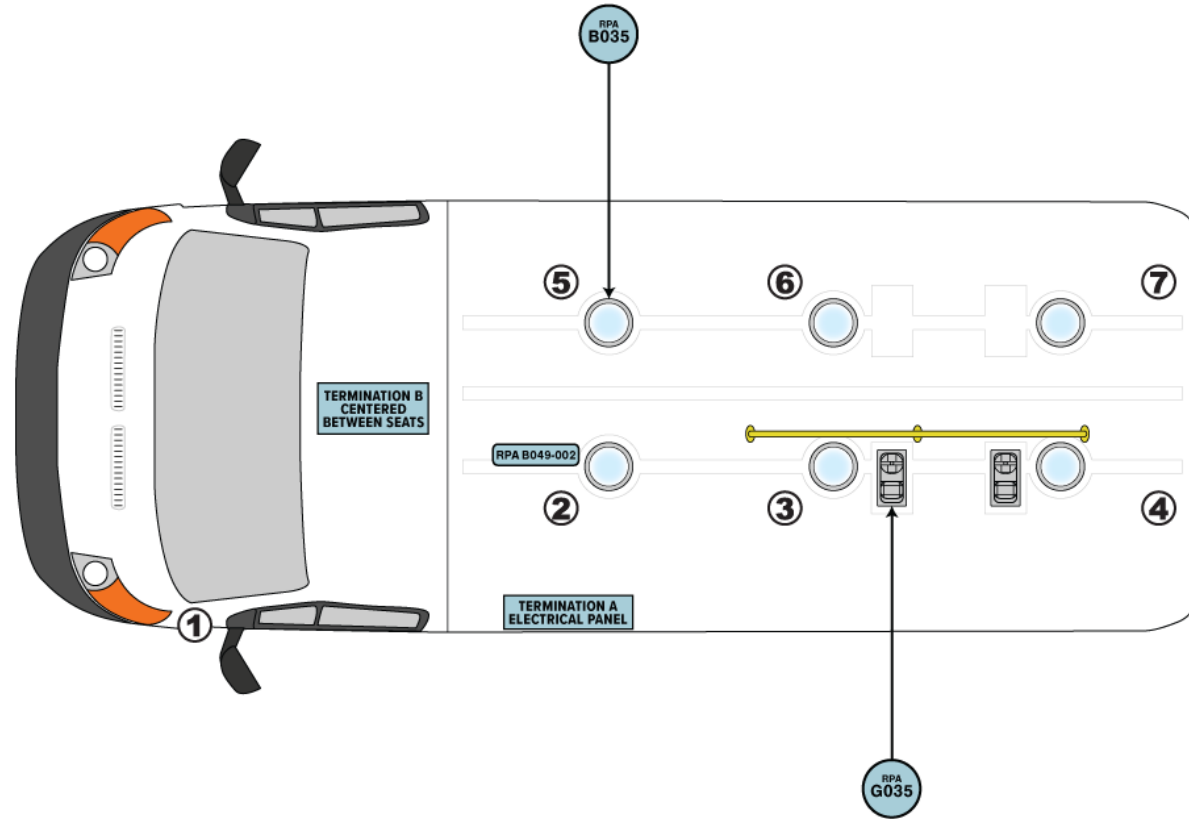

- [RPA-B035-001](#) - COT LIGHTS - 6X 8" ROUND LED - WELDON
- [RPA-B049-002](#) - 1X RADIO ANTENNA MOUNT (WHIP TO BE SUPPLIED BY CLIENT) LOCATION 2
- [RPA-G035-001](#) - CEILING IV HOLDERS X2

Malley Industries
1100 Aviation Avenue,
Dieppe, NB, Canada, E1A 9A3
© 2020

Page 10 of 21.

Dealer
Malley Industries Inc.
1100 Aviation Avenue
Dieppe, NB, E1A 9A3
1 (877) 859-8591

B-1118 | Driver Side Wall

- [RPA-D016-002](#) - DS PLASTIC CABINET WALL (7 CABINET) WITH WHITE LED CABINET LIGHT STRIP
- [RPA-D020-001](#) - GARBAGE CAN NEXT TO AIRWAY SEAT (5 OR 7 CABINETS)
- [RPA-D023-001](#) - FIXED SHELVES C/W SAFETY NETS
- [RPA-D046-001](#) - ADDITIONAL FIRE EXTINGUISHER WITH COMPLIANT BRACKET (KKK REQUIREMENT)
- [RPA-D048-001](#) - FIRE EXTINGUISHER WITH COMPLIANT BRACKET
- [RPA-G037-001](#) - PERKO IV HOOKS

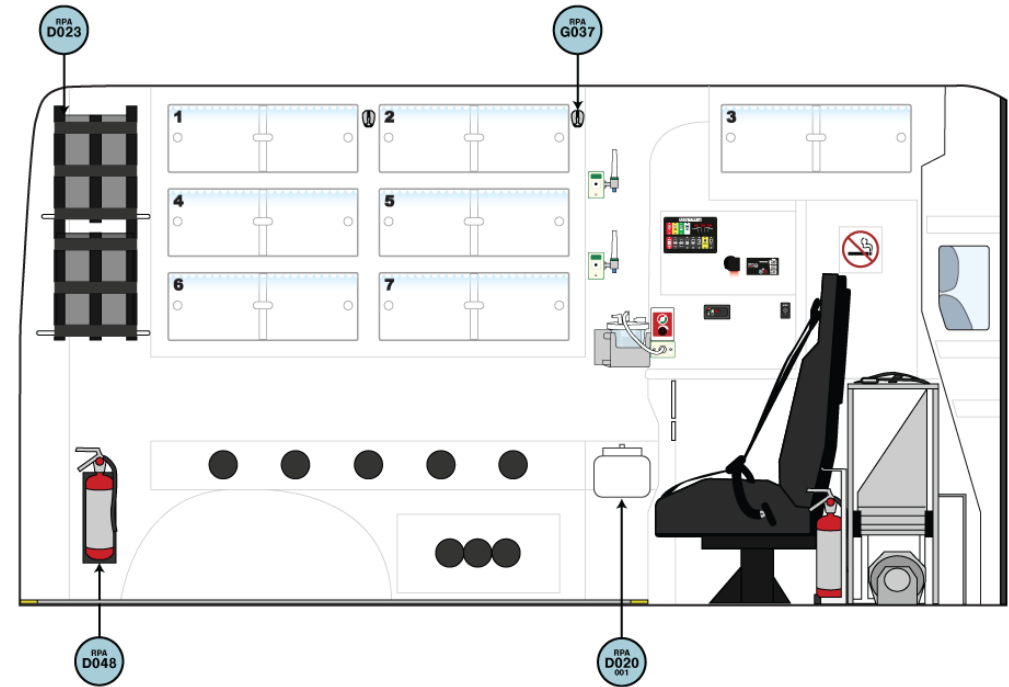

Malley Industries
1100 Aviation Avenue,
Dieppe, NB, Canada, E1A 9A3
© 2020

Page 11 of 21.

Dealer
Malley Industries Inc.
1100 Aviation Avenue
Dieppe, NB, E1A 9A3
1 (877) 859-8591

B-1118 | Passenger Side Wall

- [RPA-D006-003](#) - 1-DRAWER SQUAD BENCH WORKSTATION - DEFIB READY
- [RPA-D011-001](#) - KIT TREE - BENCH - 3 SHELVES WITH NETTING AND ABS ENCLOSURE
- [RPA-D013-001](#) - KIT TREE - REINFORCED SHELVES - BENCH
- [RPA-D051-001](#) - YELLOW HEAD BOLSTERS - ABOVE SIDE AND REAR DOORS (KKK REQUIREMENT)
- [RPA-G002-002](#) - EXTRA OXYGEN OUTLETS (US - OHMEDA)

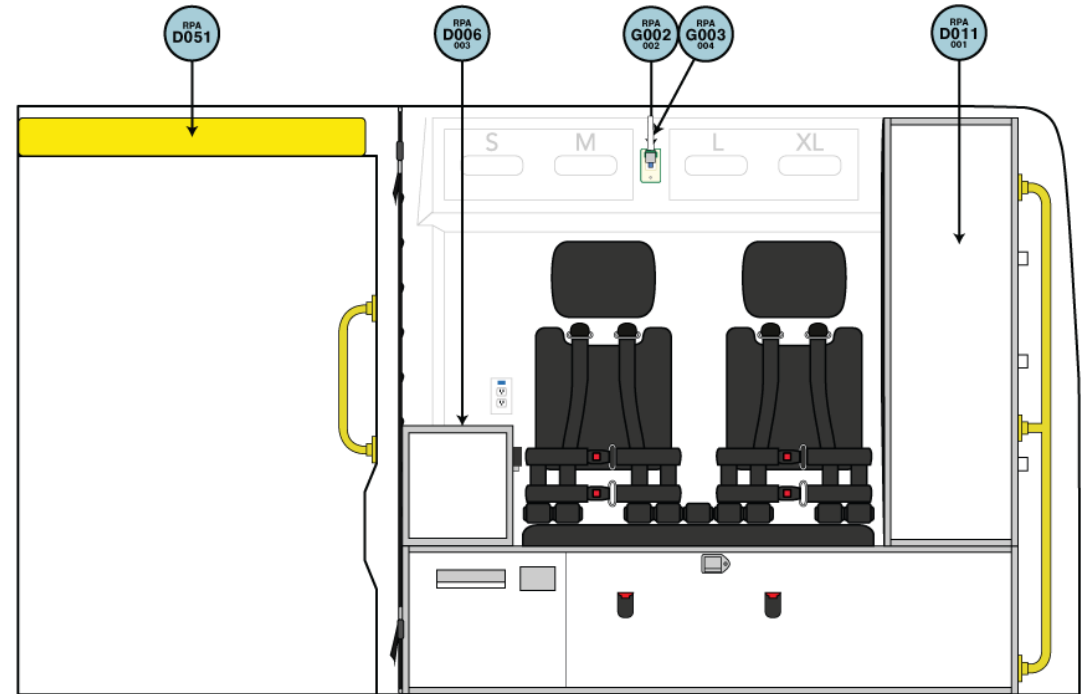

Malley Industries
1100 Aviation Avenue,
Dieppe, NB, Canada, E1A 9A3
© 2020

Dealer
Malley Industries Inc.
1100 Aviation Avenue
Dieppe, NB, E1A 9A3
1 (877) 859-8591

B-1118 | Patient Compartment

- [RPA-B019-001](#) - ANALOG CLOCK
- [RPA-D038-001](#) - LOCKING PLASTIC DOOR - ABOVE PARTITION @ SIDE DOOR (COMBO LOCK)
- [RPA-D040-001](#) - STAIR CHAIR CABINET / OXYGEN AND SPINE BOARD TUNNEL
- [RPA-D041-001](#) - STAIR CHAIR CABINET TOP NET
- [RPA-D042-001](#) - OPEN ACCESS TO O2 TANK
- [RPA-D049-001](#) - REAR DOOR BOTTOM PANELS
- [RPA-D049-002](#) - REAR DOOR GARBAGE CONTAINER ASSEMBLY
- [RPA-D050-001](#) - YELLOW GRAB BARS - REAR DOORS (ACROSS BOTTOM OF WINDOWS)

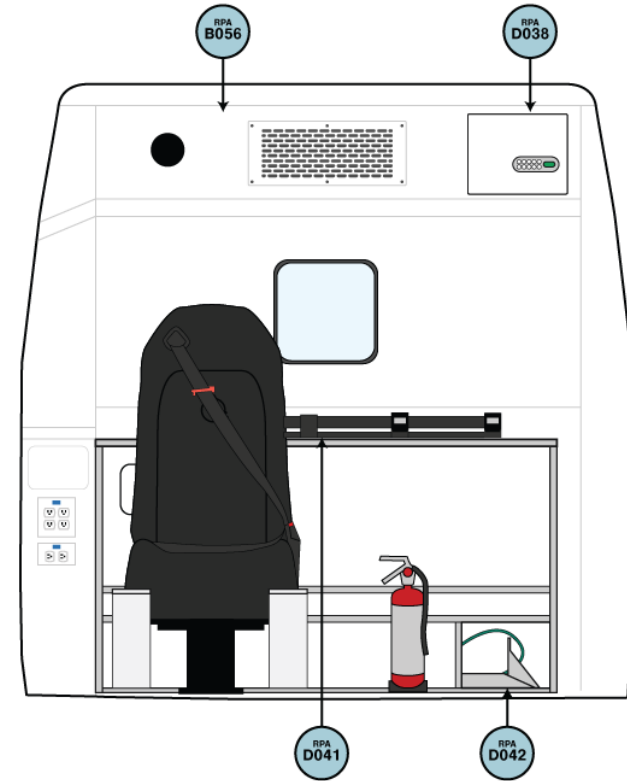

Malley Industries
1100 Aviation Avenue,
Dieppe, NB, Canada, E1A 9A3
© 2020

Page 13 of 21.

Dealer
Malley Industries Inc.
1100 Aviation Avenue
Dieppe, NB, E1A 9A3
1 (877) 859-8591

B-1118 | Patient Compartment

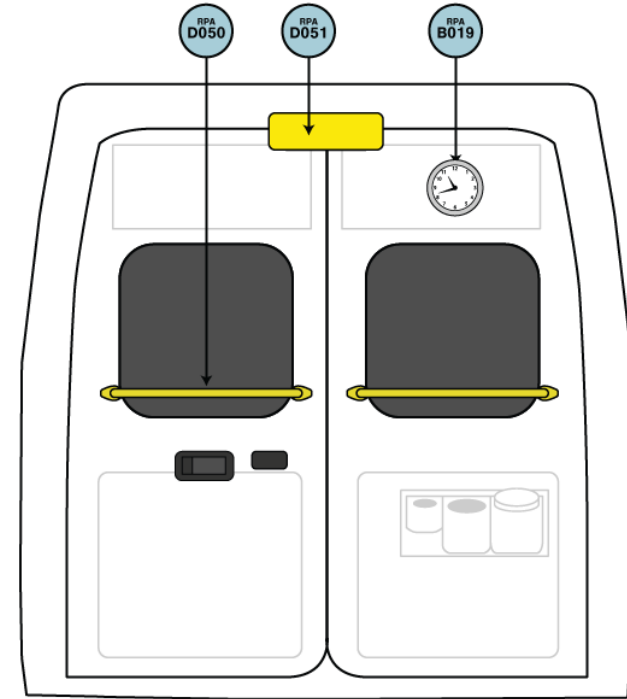

Malley Industries
1100 Aviation Avenue,
Dieppe, NB, Canada, E1A 9A3
© 2020

Page 14 of 21.

Dealer
Malley Industries Inc.
1100 Aviation Avenue
Dieppe, NB, E1A 9A3
1 (877) 859-8591

B-1118 | Floor View

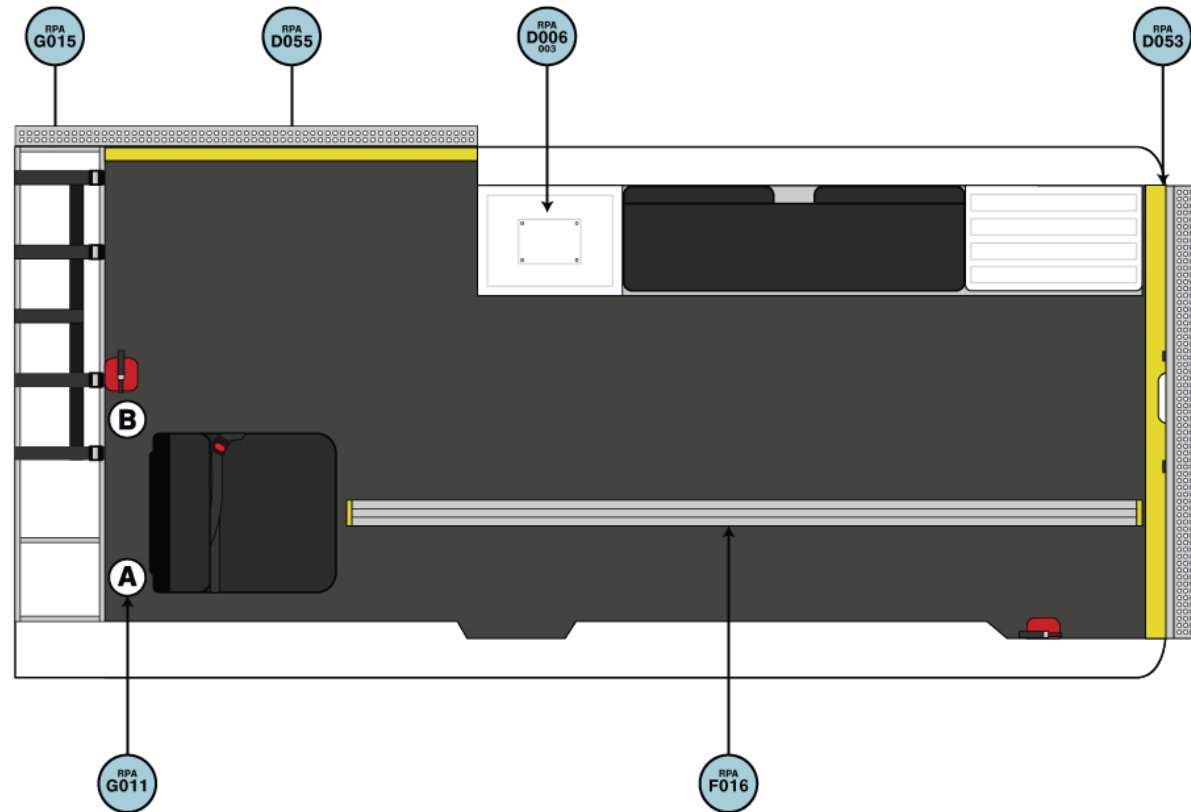

- [RPA-D053-001](#) - 6 - 1/2" YELLOW THRESHOLD PLATE (REAR DOOR)
- [RPA-D055-001](#) - 4 - 1/2" YELLOW THRESHOLD PLATE (SIDE DOOR)
- [RPA-F016-001](#) - STRYKER POWER LOAD / PERFORMANCE LOAD FLOOR TRACK

Malley Industries
1100 Aviation Avenue,
Dieppe, NB, Canada, E1A 9A3
© 2020

Dealer

Malley Industries Inc.
1100 Aviation Avenue
Dieppe, NB, E1A 9A3
1 (877) 859-8591

B-1118 | O2 Tanks

- [RPA-G001-002](#) - OXYGEN OUTLETS - X2 (US - OHMEDA)
- [RPA-G002-002](#) - EXTRA OXYGEN OUTLETS (US - OHMEDA)
- [RPA-G003-002](#) - OXYGEN FLOW METER, THORPE (TUBE) STYLE (US - OHMEDA) X 2
- [RPA-G011-001](#) - O2 TANK HOLDERS : 1XD@ A AND 1XD@ B
- [RPA-G015-001](#) - O2 TANK HOLDER - TYPE M (KKK/NFPA COMPLIANT)
- [RPA-G018-001](#) - PRE-SET OXYGEN TANK REGULATOR (EA) (M2-540-P)

Malley Industries
1100 Aviation Avenue,
Dieppe, NB, Canada, E1A 9A3
© 2020

Page 16 of 21.

Dealer

Malley Industries Inc.
1100 Aviation Avenue
Dieppe, NB, E1A 9A3
1 (877) 859-8591

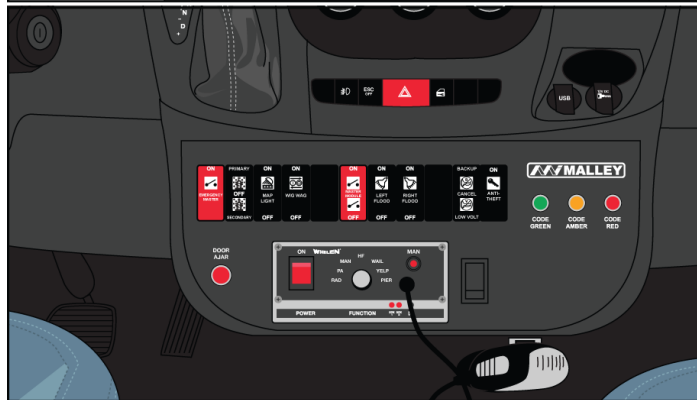
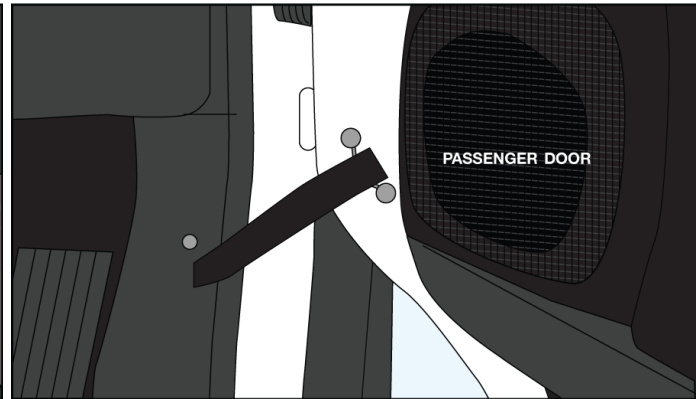
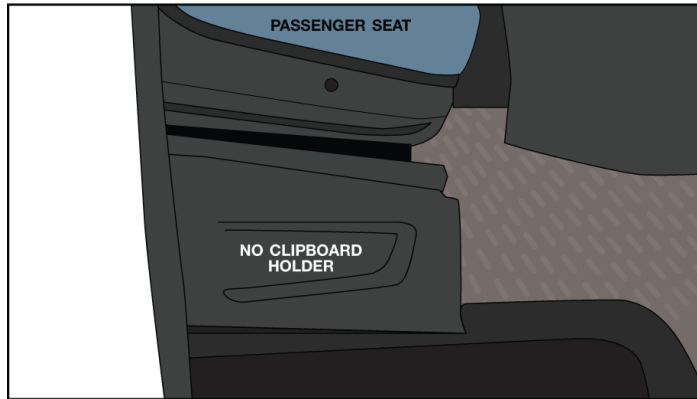

- [RPA-E003-002](#) - CENTER CONSOLE FOR LOWER MOUNTED SWITCH PANEL
- [RPA-E007-001](#) - PASSENGER SIDE OVERHEAD MAP LIGHT
- [RPA-E009-001](#) - CAB DOOR LIMITING STRAPS
- [RPA-E011-001](#) - HANDHELD SPOTLIGHT
- [RPA-E012-001](#) - PARTITION SIDE WINDOW
- [RPA-E014-001](#) - PARTITION FOLDER HOLDER

Dealer

Malley Industries Inc.
1100 Aviation Avenue
Dieppe, NB, E1A 9A3
1 (877) 859-8591

Malley Industries
1100 Aviation Avenue,
Dieppe, NB, Canada, E1A 9A3
© 2020

- [RPA-S001-001](#) - BASE CONVERSION PRICING (INCL ALL STD ITEMS)

Dealer

B-1118 | Light Pod Instructions

FRONT LIGHT ARRAY STANDARD BLACK –

- 55-12037 - Whelen 700 Steady - Red LED / Clear Lens
- 55-12037 - Whelen 700 Steady - Red LED / Clear Lens
- 55-12037 - Whelen 700 Steady - Red LED / Clear Lens
- 55-11887 - Whelen 700 Steady - White LED / Clear Lens
- 55-11887 - Whelen 700 Steady - White LED / Clear Lens
- 55-12037 - Whelen 700 Steady - Red LED / Clear Lens
- 55-12037 - Whelen 700 Steady - Red LED / Clear Lens
- 55-12037 - Whelen 700 Steady - Red LED / Clear Lens

Black side pods: front DS MI-PAM1150BLK, front PS MI-PAM1151BLK, rear 2 x MI-PAM1149BLK

- 55-10395 - Whelen 900 Steady - Red LED / Red Lens
- 55-11832 - Whelen 700 Steady - White LED / Clear Lens - SCENE
- 55-10395 - Whelen 900 Steady - Red LED / Red Lens
- 55-11832 - Whelen 700 Steady - White LED / Clear Lens - SCENE
- 55-10395 - Whelen 900 Steady - Red LED / Red Lens
- 55-11832 - Whelen 700 Steady - White LED / Clear Lens - SCENE
- 55-10395 - Whelen 900 Steady - Red LED / Red Lens
- 55-11832 - Whelen 700 Steady - White LED / Clear Lens - SCENE

Promaster Rear Light Bar Black MI-PAM1153

- 55-12037 - Whelen 700 Steady - Red LED / Clear Lens
- 55-11832 - Whelen 700 Steady - White LED / Clear Lens - SCENE
- 55-12037 - Whelen 700 Steady - Red LED / Clear Lens
- 55-12049 - Whelen 700 Steady - Amber LED / Clear Lens
- 55-12037 - Whelen 700 Steady - Red LED / Clear Lens
- 55-11832 - Whelen 700 Steady - White LED / Clear Lens - SCENE
- 55-12037 - Whelen 700 Steady - Red LED / Clear Lens

Dealer

Malley Industries Inc.

1100 Aviation Avenue
Dieppe, NB, E1A 9A3
1 (877) 859-8591

Malley Industries

1100 Aviation Avenue,
Dieppe, NB, Canada, E1A 9A3
© 2020

B-1118 | Summary of All Options

- [RPA-A001-002](#) - TEMPERATURE CONTROLLER WITH IMPERIAL UNITS (F).
- [RPA-A004-002](#) - NO 110V HEATER
- [RPA-B001-005](#) - XANTREX PURE SINE WAVE INVERTER / CHARGER (1000W 55A) AND BATTERY INSIDE VEHICLE
- [RPA-B006-001](#) - SHORE LINE - 20A AUTO-EJECT
- [RPA-B011-001](#) - 12VDC OUTLETS - 2 (1 IN ACTION WALL AND 1 IN FRONT CONSOLE)
- [RPA-B015-001](#) - 110V/15A OUTLETS - 1X DOUBLE DUPLEX & 2X SINGLE DUPLEX
- [RPA-B017-001](#) - EXTRA 110V/15A OUTLET
- [RPA-B019-001](#) - ANALOG CLOCK
- [RPA-B020-001](#) - HIDDEN UNLOCK BUTTON BEHIND FRONT GRILLE
- [RPA-B029-003](#) - RC TRONICS CONTROL SYSTEM C/W 2 ACTION PANELS (FRONT CONSOLE, ACTION WALL C/W DIGITAL CLOCK)
- [RPA-B034-001](#) - READING LIGHT (MOUNTED ON ACTION WALL)
- [RPA-B035-001](#) - COT LIGHTS - 6X 8" ROUND LED - WELDON
- [RPA-B036-001](#) - SIREN CONTROLLER - WHELEN HFS2
- [RPA-B037-001](#) - SIREN SPEAKERS - 2X SA315P, MOUNT IN BUMPER
- [RPA-B038-001](#) - 2X RED LED & 2X WHITE LED GRILLE
- [RPA-B040-001](#) - BLACK FRONT LIGHT ARRAY (7"X3" LED - 6X RED & 2X CLEAR) USA
- [RPA-B041-001](#) - BLACK BEZELS - 4X 9"X7" RED LIGHTS - LED
- [RPA-B044-001](#) - 2X INTERSECTION LIGHT RED - LED
- [RPA-B045-001](#) - 4X 7"X3" SCENE LIGHTS - LED
- [RPA-B048-001](#) - BLACK REAR LIGHT ARRAY (7"X3" LED - 4X RED, 2X CLEAR & 1X AMBER)
- [RPA-B049-002](#) - 1X RADIO ANTENNA MOUNT (WHIP TO BE SUPPLIED BY CLIENT) LOCATION 2
- [RPA-B053-001](#) - MALLEY LIGHT PACKAGE
- [RPA-B056-001](#) - ACTIVTEK INDUCT 500
- [RPA-C001-002](#) - REAR FLIP-UP STEP - YELLOW TAPE
- [RPA-C003-002](#) - RUNNING BOARDS 7" - SHORT DS, LONG PS - YELLOW TAPE
- [RPA-C007-001](#) - EXHAUST OUTLET TO BE ON THE SIDE OF THE VEHICLE. (KKK REQUIREMENT)
- [RPA-C008-001](#) - CONSPICUITY TAPE KIT - YELLOW
- [RPA-D001-005](#) - UPHOLSTERY PADDING : BLACK
- [RPA-D002-001](#) - LONPLATE FLOORING : GREY
- [RPA-D005-008](#) - 2-PERSON SQUAD BENCH 6PT ATTACHMENT BLACK
- [RPA-D006-003](#) - 1-DRAWER SQUAD BENCH WORKSTATION - DEFIB READY
- [RPA-D011-001](#) - KIT TREE - BENCH - 3 SHELVES WITH NETTING AND ABS ENCLOSURE
- [RPA-D013-001](#) - KIT TREE - REINFORCED SHELVES - BENCH
- [RPA-D016-002](#) - DS PLASTIC CABINET WALL (7 CABINET) WITH WHITE LED CABINET LIGHT STRIP
- [RPA-D019-001](#) - ELECTRICAL CABINET
- [RPA-D020-001](#) - GARBAGE CAN NEXT TO AIRWAY SEAT (5 OR 7 CABINETS)
- [RPA-D023-001](#) - FIXED SHELVES C/W SAFETY NETS
- [RPA-D026-001](#) - AIRWAY SEAT, SEAMLESS, HI-BAC CHILD SEAT - 3PT SEAT BELT -

Dealer

Malley Industries
1100 Aviation Avenue,
Dieppe, NB, Canada, E1A 9A3
© 2020

Malley Industries Inc.
1100 Aviation Avenue
Dieppe, NB, E1A 9A3
1 (877) 859-8591

B-1118 | Summary of All Options

WB

- [RPA-D033-001](#) - AIRWAY SEAT BASE, SPACE-SAVER
- [RPA-D034-001](#) - ABS STEEL -REINFORCED PARTITION WITH FLIP-UP WINDOW
- [RPA-D038-001](#) - LOCKING PLASTIC DOOR - ABOVE PARTITION @ SIDE DOOR (COMBO LOCK)
- [RPA-D040-001](#) - STAIR CHAIR CABINET / OXYGEN AND SPINE BOARD TUNNEL
- [RPA-D041-001](#) - STAIR CHAIR CABINET TOP NET
- [RPA-D042-001](#) - OPEN ACCESS TO O2 TANK
- [RPA-D046-001](#) - ADDITIONAL FIRE EXTINGUISHER WITH COMPLIANT BRACKET (KKK REQUIREMENT)
- [RPA-D048-001](#) - FIRE EXTINGUISHER WITH COMPLIANT BRACKET
- [RPA-D049-001](#) - REAR DOOR BOTTOM PANELS
- [RPA-D049-002](#) - REAR DOOR GARBAGE CONTAINER ASSEMBLY
- [RPA-D050-001](#) - YELLOW GRAB BARS - REAR DOORS (ACROSS BOTTOM OF WINDOWS)
- [RPA-D051-001](#) - YELLOW HEAD BOLSTERS - ABOVE SIDE AND REAR DOORS (KKK REQUIREMENT)
- [RPA-D053-001](#) - 6 - 1/2" YELLOW THRESHOLD PLATE (REAR DOOR)
- [RPA-D055-001](#) - 4 - 1/2" YELLOW THRESHOLD PLATE (SIDE DOOR)

- [RPA-E003-002](#) - CENTER CONSOLE FOR LOWER MOUNTED SWITCH PANEL
- [RPA-E007-001](#) - PASSENGER SIDE OVERHEAD MAP LIGHT
- [RPA-E009-001](#) - CAB DOOR LIMITING STRAPS
- [RPA-E011-001](#) - HANDHELD SPOTLIGHT
- [RPA-E012-001](#) - PARTITION SIDE WINDOW
- [RPA-E014-001](#) - PARTITION FOLDER HOLDER
- [RPA-F016-001](#) - STRYKER POWER LOAD / PERFORMANCE LOAD FLOOR TRACK
- [RPA-G001-002](#) - OXYGEN OUTLETS - X2 (US - OHMEDA)
- [RPA-G002-002](#) - EXTRA OXYGEN OUTLETS (US - OHMEDA)
- [RPA-G003-002](#) - OXYGEN FLOW METER, THORPE (TUBE) STYLE (US - OHMEDA) X 2
- [RPA-G003-004](#) - OXYGEN FLOW METER, THORPE (TUBE) STYLE (US - OHMEDA) EXTRA
- [RPA-G011-001](#) - O2 TANK HOLDERS : 1XD@ A AND 1XD@ B
- [RPA-G015-001](#) - O2 TANK HOLDER - TYPE M (KKK/NFPA COMPLIANT)
- [RPA-G018-001](#) - PRE-SET OXYGEN TANK REGULATOR (EA) (M2-540-P)
- [RPA-G031-001](#) - SHORT SUCTION CANISTER 1500ML C/W OHMEDA WALL PLATE
- [RPA-G035-001](#) - CEILING IV HOLDERS X2
- [RPA-G037-001](#) - PERKO IV HOOKS
- [RPA-S001-001](#) - BASE CONVERSION PRICING (INCL ALL STD ITEMS)

Dealer

Malley Industries

1100 Aviation Avenue,
Dieppe, NB, Canada, E1A 9A3
© 2020

Malley Industries Inc.

1100 Aviation Avenue
Dieppe, NB, E1A 9A3
1 (877) 859-8591