

LOAD IT UP: STORAGE-FRIENDLY MOTORHOMES



MotorHome

Travel, Tech, Lifestyle – For the RV Enthusiast

FLOAT ON!

STAND-UP
PADDLEBOARDS

CLASSIC RIDE

CHEVROLET CORVAIR
ULTRA VAN

CLEAR THE AIR

KEEPING
HOLDING
TANKS CLEAN
AND FRESH

COMPACT LUXURY

Dynamax Isata 4 Series



A WHALE OF A TIME IN
NEWFOUNDLAND

PHOENIX

Cruiser

**BUY
FACTORY
DIRECT**



Quality. Customization. Service.

www.phoenixusarv.com

1-833-883-4374



A product of

PHOENIXUSA, INC.

2601 Marina Drive Elkhart, IN 46514



Visitors to eastern Newfoundland encounter nearly 11,000 miles of coastal scenic beauty to explore, and may even spot a whale (see page 19).



Storage-friendly motorhomes make bringing along recreational toys and other bulky items easier than ever. Pg. 32

6 ON RAMP

Like Minds

8 P.O. BOX

MotorHome readers share their opinions

11 ESCAPES

Wheels & Gear, Crossroads

58 TECH SAVVY

Quick Tips, Hot Line, Coach & Powertrain

74 THE ROAD AHEAD

People and places worth the drive

FEATURES

Pages From the Past..... 16

Reliving highlights from *MotorHome's* June issues over the past 50 years

Newfoundland's Eastern Coast.... 19

Exploring The Rock in a motorhome allows visitors close encounters with whales and puffins, vivid views of colorful buildings and a sampling of delicious seafood

Get Fit — It's SUP to You..... 24

A stand-up paddleboard is a great way to keep in shape and to connect with your aquatic surroundings

More in Store..... 32

These motorhomes up the storage ante to allow owners to bring along SUPs, kayaks, canoes or other large items

Isata 4 Series..... 40

The Dynamax 25FW Class C takes cues from its larger siblings to provide a highly maneuverable luxury motorhome

Flush With Confidence..... 46

A roundup of products designed to help maintain a motorhome's holding tanks while keeping foul odors at bay

The Classic Ride — A Whale of a Motorhome..... 55

The Chevrolet Corvair Ultra Van sports a unique look and a loyal group of owners willing to turn a wrench or two



ON THE COVER

At 27 feet, 5 inches long, the luxury-appointed Dynamax Isata 4 Series 25FW is easy to maneuver on the road, or while backing in to campground spaces or parking areas (see test on page 40). Photo by Shawn Spence.

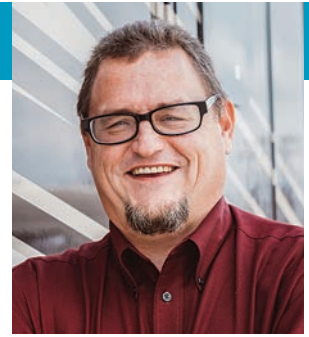

By Kristopher Bunker

Like Minds

Camping can be a polarizing word among motorhome owners, and RVers in general. After all, campers sleep in tents and sleeping bags on the ground, while RVers slumber luxuriously in their own, comfortable beds. Campers don't have their own belongings or hot and cold running water at the ready, nor do they have access to residential comforts like refrigerators, climate control or LED TVs with Blu-ray players.

All of that may be true but, especially seeing as how June is National Camping Month, there's no better time to put aside such trivial differences to embrace the outdoor lifestyle we all love.

When it comes down to it, it's all about spending time in the great wide open, and reaping the benefits that our common wanderlust tendencies bring to the forefront.

What better way to enjoy, say, waterborne recreation, than to set up camp by the shores of the lake, gulf or ocean, with nothing but the lapping of the waves against the rocks to lull you to sleep? In the morning, you are just a few steps away from water's edge, the perfect place to launch your personal watercraft, kayak or stand-up paddleboard (SUP). What's an SUP, you ask? Well, apart from offering an ideal vantage point of said body of water (gliding over its surface like so many fish through the depths below), time spent on an SUP is a wonderful way to stay in shape, find inner peace and

to breathe in some fresh air. Turn to page 24 for a primer (and SUP buyers guide) on this highly enjoyable and rewarding activity that continues to gain in popularity as novice paddlers conquer the learning curve and line up for the rides of their lives.

Once you've mastered the art of stand-up paddle boarding (or you at least get the hang of it), you'll no doubt be enticed to purchase your own. But, where to store it?

Most every motorhome can accommodate some version of an SUP, considering they don't weigh too much and can fit in the rear aisle of the rig while en route. But, if you're looking for the ultimate in SUP (or kayak, or canoe, or folding chair, or any other bulky item) storage, we've gathered

some of the top motorhomes that live large and still have plenty of room for your gear. Check out "More in Store" on page 32 to find your next storage-friendly motorhome.

This month also features a look at one of the benefits of RVing that no doubt turns many tent campers green with envy: onboard plumbing; more specifically, the wastewater systems that allow us to avoid crowded, over-filled pit toilets in some campgrounds. Maintaining those systems starts with better living through chemistry: Adding the proper holding-tank deodorizers helps maintain the balance needed to properly break down solids, while keeping the associated odors at bay and smelling fresh. "Flush with Confidence" on page 46 features the specifics on some of the best holding-tank products available.

Camping and RVing have always gone hand in hand, and will continue to, so we should celebrate everybody who prefers to watch the sunrise from a camp chair, hot cup of coffee in hand, while the songs of a new summer day play softly in the background. **M**

“It's all about spending time in the great wide open, and reaping the benefits that our common wanderlust tendencies bring to the forefront.”

Contributors | June





Ann Eichenmuller is a freelance writer in Virginia who loves exploring the country with her husband, Eric, in their Minnie Winnie. Ann is the author of the novel "Kind Lies" (www.hightidepublications.com).



Bobbie Hasselbring is an award-winning travel and food writer. She owns a 2015 Pleasure-Way Excel Class B motorhome.



Chris Hemer has been an RV journalist and photographer for nearly 20 years. An avid outdoor enthusiast, he enjoys camping, motorcycle riding, mountain biking and hiking.

Connect with us at motorhome.com and follow us at  MotorHomeMagazine  TrailerLifeDIY  motorhome_magazine



NEVER MASS PRODUCED, ALWAYS
HANDCRAFTED

At Newmar, our 2018 lineup continues a half-century tradition of building motor coaches by hand, one at a time, with help from the dedicated people of Nappanee, Indiana. Individuals to whom superior craftsmanship is not a goal, but a way of life. It's why we say when you know the Newmar difference, you know our people.

See all 11 of our 2018 models at NewmarCoaches.com



**REDESIGNED
2018 BAY STAR**



**ALL-NEW
2018 NEW AIRE**



**REINVENTED
2018 ESSEX**

Newmar Corporation, Circle 115 on Reader Service Card



The Little SUP That Does It All!

Surf, SUP,
Kayak, Fish!!!



Shown with optional accessories.

Sea Eagle HB96 Inflatable SUP

Versatile, portable iSUP perfect
for bays, lakes, coves, rivers
& even ocean surf!

Just \$599*
includes HB96 SUP, paddle, pump & bag.
FREE SHIPPING to the continental U.S.
*NY & WA residents add sales tax.

Fits in a bag!



SEA EAGLE.com

for full details
or Call 1-800-944-7496
for Catalog Dept. MH068B

- 32" wide
- 9' 6" long
- Weighs 23 lbs.
- Inflates in 5 minutes to 15 PSI
- Packs to just 34" x 13" x 7"

Sea Eagle, Circle 129 on Reader Service Card

MotorHome

Publisher Ann Emerson
Editorial Director Eileen Hubbard
Managing Editor Kristopher Bunker
Technical Editor Chris Dougherty
Art Director Rick Damien
Production Director Bob Dawson
Production Manager Brenda Hutchinson
Prepress Specialist Rob Roy
Digital Special Projects Manager Gabe Herrera
Marketing Manager Lorisa Pierson
Business Manager Katey Purgatorio
Publisher Emeritus Bob Livingston

Consulting Editors Ken Freund, Jeff Johnston

Contributors Morey Edelman, Ann Eichenmuller, Bobbie Hasselbring, Chris Hemer, James Richardson, Alan Rider, Shawn Spence, Mary Zalmanek

Vice President National Sales Terry Thompson

RV Classifieds Katey Purgatorio
Tel 847-229-6756 Fax 270-495-6278
katey.purgatorio@goodsam.com

Advertising Sales Representatives
Sue Seidltz (Southwest Region)
847-229-6813, sue.seidltz@goodsam.com

Kim Whitaker (Southeast Region)
919-412-6325, kim.whitaker@goodsam.com

Lou Cicirelli (Northeast Region)
954-297-9234, lou.cicirelli@goodsam.com

Scott Oakes (Northwest Region)
Tel 847-229-6758 Fax 270-282-7356
scott.oakes@goodsam.com

Customer Service

Subscriptions (print and digital)

800-678-1201

motorhome@cdsfulfillment.com

Website www.motorhome.com

Editorial info-motorhomemagazine@goodsam.com

GS MEDIA & EVENTS

Vice President/Publisher Ann Emerson
Vice President/Advertising Sales Terry Thompson

Alliance for Audited Media
The New Audit Bureau of Circulations

MotorHome (ISSN 0744-074X) is published monthly by GS Media & Events (a division of Good Sam Enterprises, LLC), 2750 Park View Ct., Ste. 240, Oxnard, CA 93036. Periodicals postage paid at Oxnard, CA 93036 and additional mailing offices. The annual subscription rate is \$19.97 per year in the U.S. For Canadian and international subscriptions, add \$12 per year. U.S. funds only.

Postmaster Send address changes to MotorHome, P.O. Box 5860, Harlan, IA 51593-1360.

Canadian Return Address GS Media & Events, 4960-2 Walker Road, Windsor, Ontario N9A 6J3. Publication Sales Agreement #40012332.

Printed in the United States.

© 2018 Good Sam Enterprises, LLC. MotorHome is a registered trademark of Good Sam Enterprises, LLC. Unauthorized use of any of Good Sam's trademarks is expressly prohibited. All other trademarks are the property of their respective owners. All rights reserved.

Privacy Promise MotorHome will never intentionally share subscribers' names, addresses or other personal information with other companies when requested not to do so. To opt out from receiving marketing offers in the mail from other reputable companies, or if you opt out and subsequently want to opt back in, contact MotorHome by mail, phone or email: MotorHome Mail Preference Service, P.O. Box 5860, Harlan, IA 51593-1360, 800-825-6861, motorhome@cdsfulfillment.com. This policy applies to postal mail; we will not send commercial emails to subscribers unless authorized to do so.

A DIVISION OF GOOD SAM ENTERPRISES, LLC

Chairman & CEO Marcus Lemonis

Executive VP Tom Wolfe

GOT A V10?

Does your RV look at
a hill and shift?

WE CAN FIX IT!

Want better efficiency?

WE CAN IMPROVE IT!

See in depth article in May 2016 Motorhome page 111



www.5StarTuning.com
843.536.1244

5 Star Tuning, Circle 101 on Reader Service Card

SUPERSTITION VIEWS

Stunning views | Less than
Beautiful custom casitas | **2**
Resort-style living | sites left!

CALL (888) 603-3415
or email shellyb@cal-am.com



Now offering homes at Montesa, our beautiful sister community

MONTESA
AT GOLD CANYON



HOMES AVAILABLE FROM

\$169,900

with RV Pad

(price available for a limited time only)

Contact our sales team
to schedule your private tour

(888) 325-0936

or visit MontesaHomes.com
to learn more

FEATURING RESORT-STYLE AMENITIES & ACTIVITIES

- ✔ Stunning Views of the Superstition Mountains
- ✔ Private Walking Paths with Hilltop Vista
- ✔ Resort Style Pool & Spa
- ✔ Pickleball Courts
- ✔ Bocce ball Courts
- ✔ Tennis Courts
- ✔ Ballroom & Clubhouse
- ✔ Themed Parties & Events
- ✔ 2,700 sq. ft. Fitness Center
- ✔ Pet Agility Park

Cal-Am Properties, Circle 103 on Reader Service Card

Have you, or somebody you know, traded in a large, luxury motorhome for a more Spartan model that's easier to drive? If so, what factors led to that decision?

Those are the questions we asked in the March issue, and here are some of the responses we received.



A Room with a View

We traded a 42-foot diesel pusher for a 30-foot gas coach. The pusher was great for snowbirding, but it was expensive to maintain and repair, hard to wash, difficult to store and imposing to drive. It didn't fit into National Park Service or U.S. Forest Service campgrounds, so instead of staying in peaceful forests, we had to camp outside the parks in sketchy campgrounds, usually located next to a junkyard or railroad tracks. So much for luxury! Also, [we feel that] diesel pushers are useless for dry camping; their residential fridges drain batteries in hours. Our new coach is perfect: it's compact but roomy, easy to drive and to store, and it doesn't have complex systems that can break. For us, it comes down to eating at a Formica (rather than a Corian) dining room table; either way,

your sandwich tastes the same, but the view from the Formica table is that of a stream running by your campsite.

Darin Furry | Bend, Oregon

Lucky Leprechaun

After full-timing for six years, we downsized from a 2006 Itasca Horizon 40KD diesel pusher to a 2017 Coachmen Leprechaun 260DS Class C on a Ford E-450 chassis with a V-10 and six-speed transmission. We really like the Leprechaun's features and floorplan, and the local dealer has a great reputation for standing by its products.

We spent last summer in Maine for more than two months, and the motorhome's smaller size accommodated us fine, giving us plenty of livability. On the road, it handled the Appalachian Mountains with no problems as we towed our Subaru Forester on steep

grades using the transmission's tow mode, which acted like the engine brake we had in the diesel pusher. We were happy to find the Ford engine wasn't as noisy as we thought it would be — especially after driving a diesel pusher — and the ride was comparable to the diesel pusher as well.

Jack Halpin | Patrick AFB, Florida

Oh, the Places You'll Go

We gave up the queen-sized walk-around bed in our 30-foot Class C for a corner double bed in a new 25-foot Class C. We found a floorplan with nearly as much storage as the 30-footer. We wanted a smaller rig to go places we haven't been able to fit in to. I am also hopeful that my wife will learn to drive this one.

**Al and Karen Knorr
Longview, Washington**

Featured Letter

Lifestyle Choice

My wife and I have owned three Class A's in the past 25 years. We recently sold our 40-foot Class A with all the bells and whistles, and are looking for a smaller rig for three reasons.

First, there's the cost of maintenance and operation. Annual lube and oil change for the Class A was \$400-plus; on a Class C, I can do the service myself. The Class A got 8 mpg; a smaller rig can get up to 15 mpg.

Second, there's the cost of longer-term maintenance items — new tires for the Class A cost more than \$4,500, and new batteries were \$1,600.



And finally, a smaller rig fits our lifestyle. It's just the two of us — and our dogs — so we no longer need all the slides and roominess, or all the creature comforts. In a smaller rig, we'll be able to travel lighter and faster.

Lyman and Micki Seamans | Kinderhook, New York

Daily Driver

When we retired and moved to Florida, we traded in our Class A for a Class B. Besides being easier to drive, we were able to sell our other car, and now use the Class B as our second vehicle when our car is in the shop. We also take more day trips now and don't have to worry about finding a bathroom!

Dave and Pat Miller | Ocala, Florida

Pain in the Access

We had a 2004 38-foot Class A motorhome that we traded in for a 2017 Class C Thor Freedom Elite, and we've never been happier. I loved our Class A when it was parked, but driving it on busy highways was a white-knuckle ride. My wife refused to drive it. That said, my biggest pet peeve was that it only had one door, which was a problem when the lock broke and we couldn't get out. Plus, having to constantly climb over the doghouse was a real pain.

Downsizing to a Class C brought happiness back into our marriage. My wife can now share in the driving, and we go into any parking lot without any issues. It can be serviced at any Ford dealership without breaking the bank, and I can find the 16-inch tires at any Walmart or tire store. We have not complained about having less space because we use our motorhome to camp; we don't sit inside all day watching TV. The smaller size has given us the opportunity to get into more remote areas, and we still have all the comforts of home. Every person has to make up their own minds on what they want, but we have been camping for 40 years and found that bigger is not always better.

Tom Kranauer | Parrish, Florida



That's a Wrap

For those owners who want to change their motorhome because they don't like the color, but don't want to pay for a new paint job (which can run \$40,000

or more), there's another option: wrapping. I have a 34-foot 2006 Four Winds Hurricane that I was happy with, but was ready to replace because I didn't like the exterior color. So I did my research and decided to wrap the motorhome. The product I used is made by 3M, and I only spent \$7,000. Take a look at the before and after photos.

Denys D'Anjou | Via email

Question of the Month

Have you changed the color or exterior look (decals, mural, etc.) of your motorhome? If so, did you have it repainted, or did you opt for a wrap? What factors led to your decision?

Send your comments to:

MotorHome, 2750 Park View Court, Suite 240, Oxnard, CA 93036; or email letters@motorhomemagazine.com

WALEX

The first and the finest.

Just Drop It In!

Just Drop It In!

The original drop-in holding tank deodorizer that revolutionized the RV industry.

Still the #1 choice worldwide.

- Commercial Strength Odor Prevention
- Biodegradable & Formaldehyde-free
- Easy to Use Drop-In, No Spills!
- Breaks Down Waste and Paper
- Original Scent or Lavender Breeze

MADE IN USA

AVAILABLE AT LEADING RV SUPPLY STORES

www.rvsanitation.com



THE AKTIV 2.0

for the freedom to go anywhere



gohymer.com



Hymer, Circle 108 on Reader Service Card

EHYMER



There's No Place Like Home

Arizona's Montesa at Gold Canyon offers a true neighborhood feel with large residences and a place for your motorhome

By Mary Zalmanek

Residents of Montesa at Gold Canyon, a Cal-Am Properties community west of Phoenix, Arizona, have plenty to keep them busy. During a full moon, they can enjoy happy hour atop a knoll while watching the sunset over the city and the moonrise over the Superstition Mountains. Earlier in the day, they may have participated in a pickleball tournament, crafted glass mosaics or burned off calories in an aqua cycle class. (Yes, that's a spin class in a swimming pool!) On special occasions, the activities director really cranks up the creativity with events like the St. Patrick's Day golf cart scavenger hunt.

For musical entertainment, residents have access to the Cal-Am Resorts Concert Series, which includes Gladys Knight, LeAnn Rimes and The Lovin' Spoonful in 2018.

When Linda and Gregg Nole were ready to relocate from California to Arizona, they wanted a 55-plus resort-style community with homes large enough to accommodate full-time living and a place to store their motorhome. After a six-month search, they found Montesa. Its latest designs offer manufactured homes from 1,000 to 1,800 square feet, RV pads and rooftop observation decks. The Noles found everything they wanted in a home, plus more than they imagined with the amenities, security and friendships found in the community.

For more information, call 877-355-0580, or visit www.cal-am.com/communities/montesa-at-gold-canyon

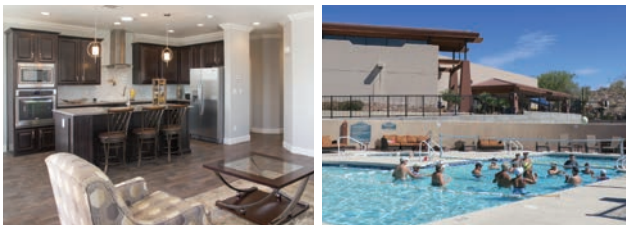

Left: Five model homes highlight available features in each of the current floorplans. Montesa residents gather at the pool for activities including volleyball, water aerobics, aqua cycling and relaxing.



T-Rex Tape

Every motorhome owner's toolbox should have some type of fabric tape for everyday repairs. Such tape is ideal for temporary fixes (and some that are a little more than temporary), and its uses are almost endless. ShurTech has rolled out T-Rex Tape, which is formulated with durable materials to hold longer and stronger than other brands, according to the company. T-Rex Tape is comprised of three layers: a UV-resistant polyethylene skin; an interwoven fabric scrim that provides strength while still being able to be torn by hand; and a double-thick adhesive designed to be effective even on rough and dirty surfaces. T-Rex Tape is available in gunmetal gray, black and white, in rolls that are nearly 2 inches wide and vary in lengths from 12 to 35 yards. MSRP ranges from \$5-\$15, depending on the size and color of the roll.

ShurTech Brands | 440-937-7000, www.shurtech.com

Silver Bullet Baggage

Looking to show off your Airstream affinity while the motorhome is at the RV resort? Airstream has joined forces with travel-goods manufacturer Traveler's Choice to offer a new line of licensed Airstream riveted luggage. Traveler's Choice Airstream Travelware is constructed of durable polycarbonate hardshell materials with a brushed-aluminum textured finish to match the classic Airstream style. Airstream's name and logo is prominent throughout. The lineup also includes features such as round aluminum corner guards; clear, hardshell cases that allow users to insert any high-resolution image for endless customization; comfortable top and side grip handles; 360-degree dual spinner wheels; additional zipper flaps; and interior tie-down straps. The luggage will be available through Airstream dealerships, on the web and at all Traveler's Choice retail channels. MSRP begins around \$300.

Traveler's Choice | 800-237-0387, www.travelerchoice.com



Need a Boost?

To help make sure you receive important (and not-so-important) phone calls, SureCall announces the Fusion2Go 3.0 RV, an in-vehicle cellphone signal booster designed specifically for RVs. Fusion2Go 3.0 RV boosts all North American carrier signals to provide users with reliable voice, text and 4G LTE data. Boosting the existing cellular signals using the Fusion2Go 3.0 RV helps to extend battery life for all devices by offering increased signal strength so the devices aren't wasting power while acquiring a signal, according to the company. The exterior high-gain omnidirectional antenna is designed to capture existing signals from all directions, and no cradle or docking station is required. The kit comes complete with the booster, exterior roof-mounted antenna, interior antenna, 40 feet of coaxial cable, a 12-volt DC power supply and a standard wall-outlet power supply. MSRP: \$449.99.

SureCall | 888-365-6283, www.surecall.com



Wheel Clean

Meguiar's introduces its new Ultimate All Wheel Cleaner. Made with a powerful formula that offers deep cleaning, yet is gentle enough that it can be used on any wheel finish or type, the cleaner combines grime-attacking surfactants with active brake-dust dissolving agents to quickly loosen dirt, grime and brake dust — with little to no agitation — according to the company. The active gel formula is designed to cling to wheels and stay wetter longer, providing better cleaning action than traditional foaming wheel cleaners. After application, Ultimate All Wheel Cleaner turns brake dust purple and road grime brown as it gently loosens stubborn contaminants. The formula is said to be pH balanced and acid-free so that it will not harm wheels or painted brake components. Ultimate All Wheel Cleaner comes in a 24-ounce spray bottle and has an MSRP of \$9.99.

Meguiar's | 800-347-5700, www.meguiars.com





PALA RV RESORT

Your next great vacation. The votes are in, and the Pala Casino RV Resort has been named one of the best places to spend your vacation. Come discover fun and excitement in the foothills of the Palomar Mountains. You'll enjoy comfort, fantastic amenities and unbelievable views. This luxurious RV Resort has a heated pool and 2 spas, and it is just a short shuttle ride to the four-diamond Pala Casino Spa and Resort.

100 Full-service sites

- Grass Lawns and Picnic Tables
- 77 - 30' x 55' Back-In-Sites
- 6 - 30' x 60' Luxury Sites with BBQ Grills
- 17 - 30' x 70' Pull-Through Sites
- 20-30-50 Amp Power
- Electric, Water & Sewer Hook-ups
- Free Wi-Fi & Cable TV
- Restrooms & Showers
- Key Card Access to Amenities
- 24-hour Security Patrol
- Propane Fuel Available
- Free Shuttle to Casino

Indoor amenities

- Games, Billiard Table, Card Tables
- 3 Flat-Screen TVs

Outdoor amenities

- Heated Pool
- 5 BBQ Grill Areas
- Table Tennis
- Horseshoe Pit
- Fenced Dog Park

For additional charge

- Clubhouse with 2 Kitchens
- Laundry (24 Hours)
- 3 Pets Per RV (\$5/Pet - 7-Day Restrictions)
- Early Check-In/Late Check-Out (Based on Availability)



FOR RESERVATIONS CALL 1.844.4PALARV (1.844.472.5278)

Pala RV Resort: 11042 Hwy 76, Pala, CA 92059 • PALACASINO.COM

Please Gamble Responsibly. Gambling Helpline 1-800-522-4700



Photo: Morey Edelman

Estero, Florida

Communing with Nature

In 1894, Dr. Cyrus R. Teed brought 200 followers of his new faith, "Koreshanity," from New York to Estero, Florida, to begin construction of a communal living settlement. Over the next 20 years, the commune built housing, gardens, workshops, an art center and even a power station for generating electricity.

Today, as part of Koreshan State Park, visitors can walk the town sites and learn the history. The Art Hall continues to have performances on many weekends, and also features a display that explains the Koreshans' belief system. The display, which was used to recruit commune members, depicts the Earth as a convex sphere with the entire universe inside of the sphere. Walking the grounds and gardens of this settlement further provides visitors with an understanding of this unique settlement. Many of the buildings have been beautifully restored along with the bridges and gardens.

The park is located on U.S. Highway 41, just south of Fort Myers. There are 42 RV sites with water and electric hookups in the park's campground (maximum RV length is 40 feet). From the campground it's a half-mile walk, following the Estero River, to the village.

For more information, call 239-992-0311 or visit www.floridastateparks.org/park/koreshan — *Morey Edelman*

17TH-ANNUAL CHARITY RAFFLE
WIN

A New Winnebago Forza Motorhome or a Quarter of a Million Dollars in Cash

Tickets Only \$100.00 Each
No More Than 7,500 Tickets Will Be Sold
Drawing Will Be August 31st, 2018

All proceeds benefit Innovations Housing, a 501(c)(3) nonprofit organization that works on much-needed community projects around the world. Raffle monitored by Jessica Tegerstrand, CPA of Redding, CA. State of California, Department of Justice Raffle Registration Number R-173. Must be over 18 to enter. Void where prohibited. Winner need not be present to win. Winner will take home a new 38-foot Winnebago Forza motorhome or \$250,000.00. Winner responsible for taxes, title and license.

To purchase tickets with a Visa, MasterCard, Discover or American Express call **+1 (800) 764-8096** toll free or **+1 (530) 243-5693**. Or mail a check to Post Office Box 991846 Redding, CA 96099-1846, USA. For more information visit **www.innovationshousing.org**

Lubbock, Texas

Blowin' in the Wind

The American Windmill Museum in Lubbock, Texas, contains the world's largest collection of historic windmills in one place. There are more than 160 fully restored windmills spread out over 28 acres, and they demonstrate the history, function and importance of windmills for water collection in the American West.

More than 100 of these rare and historic windmills stand inside

the giant display room. Another 60 windmills are located on the grounds outside. In addition to the windmills, the museum has a massive mural on a 34-foot-tall wall that stretches 172 feet and highlights the history of windmills in west Texas.

We left the museum with a renewed appreciation for the ingenuity of early North Americans and the usefulness of these fascinating structures. Museum hours are Tuesday through Saturday, 10 a.m. to 5 p.m. The museum is also open Sundays from June through August, from 2 p.m. to 5 p.m.

For more information, call 806-747-8734 or go to <http://windmill.com> — *James Richardson* **M**

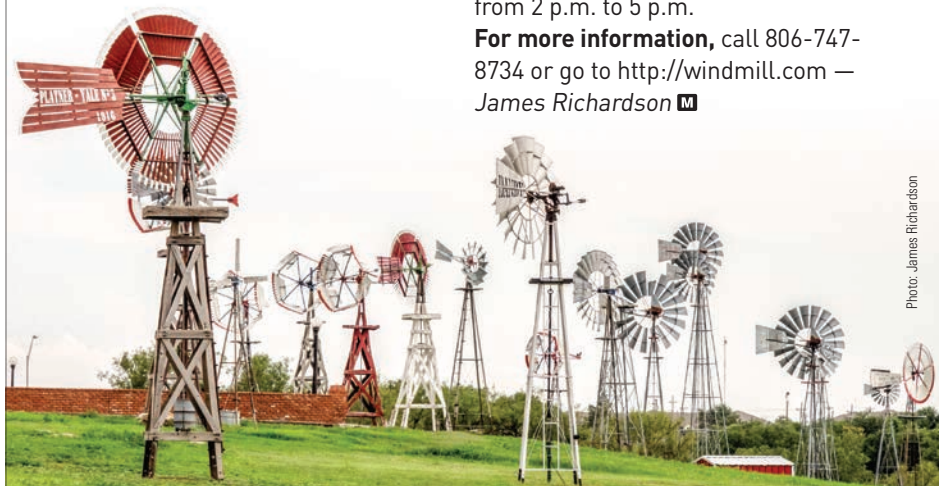

Photo: James Richardson

Winn "Show & Tell"

The new Horizon
is turning heads
everywhere.

The all-new Winnebago®
Horizon® brings a confident,
bold look to the diesel pusher
category, with the power and
performance of our Maxum
Chassis® to back it up.

With its premium amenities,
abundant storage and
contemporary design, the
Horizon lives like a stylish
condo you can take practically
anywhere.

WinnebagoInd.com



©2017 Winnebago Industries, Inc.

Winnebago Industries, Circle 133 on Reader Service Card

WINNEBAGO

The Way To Go™



Pages From the Past

Retracing *MotorHome's* June issues over the years

We often trumpet the forward-thinking mentality of *MotorHome* in this monthly look into the magazine's distinguished past. But, when you're faced with evidence such as "Evans' Heaven on Wheels" from the June 1971 issue, it's clear that *MotorHome* should be celebrated as a true pioneer in seeing beyond the horizon since its inception. "Picture a motorhome with a garage. Built in. What's more, picture that motorhome garage actually containing a car ... Now, picture that motorhome with an electric overhead bed that raises out of sight ... " Granted, the feature in question detailed an actual coach that was designed by Guy and Jeanie Evans, but *MotorHome Life* saw enough validity in such unique appointments as to showcase the vehicle when those innovations were rare.

The June '72 issue featured "Ask a Woman," a guest editorial in which a female reader details some improvements that could be made to motorhomes — in terms of design flaws rather than the expected, "Better décor and a larger kitchen." The fact that this is notable today may be an unfortunate sign of the times of that era, but bucking the social norm in terms of

progress has long been commonplace within this magazine's pages.

The oil crisis in 1979 led to a decade of reflection in the 1980s, and "Falling Oil Prices, Rising Hopes" in the June '86 issue included a quote that remains ahead of its time: "I think we can say ... that the price of gas never really became a significant factor in the average RVer's decision to buy. I think

the real factor has always been, and will continue to be availability." This declaration that RVing would continue to be a popular choice for outdoor enthusiasts contrasted conventional wisdom at the time.

The late 1990s would see what would come to be a momentous occasion for *MotorHome*. A small news item in June 1997 stated that *MotorHome's* parent company (then Affinity Group Inc.) was acquiring an outdoor retailer known as Camping World, in addition to its 26 retail centers and catalog operation. That small bit of forward-thinking led to what is today the most well-known destination for all things RV, with more than 140 retail stores and dealerships in 36 states as of press time.

At the turn of the century, *MotorHome* decided to further engage its audience with an in-depth look at DIY projects created by (and for) its readers. The column would include projects, or tips, that could be done in a short amount of time. Since its debut 18 years ago, Quick Tips remains one of the magazine's most popular items, and we are always on the lookout for the newest way to build a better mousetrap.

And finally, how's this for forward thinking: A search of June issues from the past reveals a number of features with ties to waterborne activities such as innertubing, canoeing and personal watercraft. "Ride a River" in 1981, "Trip Your Canoe And Motorhome Too!" in '82 and "Wet & Wild" in 2004 all championed how popular aquatic recreation activities could be further enhanced with a motorhome at the ready. For a more contemporary perspective, check out "Get Healthy — It's SUP to You!" on page 24. **M**





BORN TO RAMBLE

ROAM SWEET ROAM

ESCAPE INTO THE GREAT OUTDOORS WITH MOTORHOME COVERAGE STARTING AT JUST \$125

PROGRESSIVE

Progressive Insurance, Circle 120 on Reader Service Card

PROGRESSIVE CASUALTY INS. CO. & AFFILIATES. \$125 PER YEAR PREMIUM EXCLUDES STATE FEES AND TAXES. AND IS NOT AVAILABLE IN MS, NJ, & OR.

Power, Performance, Precision & Selection



Isata 3 Series

Available in 24' to 25' lengths

- Four Floor Plans
- Mercedes-Benz® 3500 Sprinter Chassis
- Hellwig® Rear Sway Bar and Bilstein Rear Shocks
- Cut and Buffed Full Body Paint
- Truma® On-demand Water Heater



Isata 4 Series

Available in 27' to 33' lengths

- Two Floor Plans
- Ford® E-450 Chassis
- DynaRide® Custom Suspension
- Cut and Buffed Full Body Paint
- Multiplex® Wiring with Touch Screen Command Center and Bluetooth® Smartphone App Control



Isata 5 Series

Available in 32' to 36' lengths

- Three Floor Plans
- Ram® 5500 Chassis (Optional 4x4)
- Cummins® 6.7L Turbo Diesel Engine (10,000 lb. Towing)
- Hardwood Cabinetry Throughout
- Multiplex® Wiring with Touch Screen Command Center and Bluetooth® Smartphone App Control



Force HD

Available in 36' to 39' lengths

- Three Floor Plans
- Freightliner® M2-106 Chassis
- 33,000-lb. GVWR (20,000-lb. Towing)
- Cummins® ISL 9L (350HP/1,000 lb.-ft.)
- Dual-stage Jacobs® Brake and Rear Locking Differential



DX3

Available in 36' to 41' lengths

- Four Floor Plans
- Freightliner® M2-106 Chassis
- Roof-integrated Awning and Fascia
- 400D Diesel Aqua-Hot® System
- Multiplex® Wiring with Touch Screen Command Center and Bluetooth® Smartphone App Control



DynaQuest XL

Available in 39' to 41' lengths

- Four Floor Plans
- Freightliner® M2-112 Chassis
- 450HP/1,250 lb.-ft.
- 450D Diesel Aqua-Hot® System with Engine Pre-heat
- Multiplex® Wiring with Touch Screen Command Center and Bluetooth® Smartphone App Control



www.dynamaxcorp.com



Dynamax, Circle 109 on Reader Service Card



Learn More
Scan this barcode using a QR Reader on your smart phone to learn more about Forest River.



A Berkshire Hathaway company.

www.ForestRiverBuyLocal.com



Newfoundland's Eastern Coast

With nearly 11,000 miles of shoreline, The Rock is a naturally gorgeous wonderland for exploring in a motorhome

By Bobbie Hasselbring

The sign reads: "St. Vincent's Beach Where the Whales Come to Play." The wet, gleaming back of a 50-foot humpback suddenly appears just 10 feet from where the water meets the sand.

Excited visitors, cameras and phones in hand, scurry along, tracking the whale as it rises and falls in the shallow water. I rush toward the beach just as the cetacean's bumpy head and back crest the water, and it blows a jet of water and air with a whooshing sound. All around are tiny bubbles. The whale is bubble-net fishing — corralling tiny smelt-like capelin.

Another cetacean, slightly smaller, swims along the beach-line, showing its back, then its curved tail fluke. A third whale bobs a little farther down, swimming toward me, circling back to catch more fish. In the bay, a dozen whale waterspouts blow high into the air.

I reach the water's edge just as the big whale lifts its knobby head completely out of the water. It opens its vast mouth, displaying long black and white grooves under its jaw. It gulps a huge mouthful of water, then crashes with a torrent of spray, disappearing under the water. This really is where whales come to play.



NEWFOUNDLAND'S
EASTERN COAST

Getting There ➔

Although the author chose to fly into Saint John's and rent a motorhome from Islander RV, visitors to Newfoundland have another option: take a ferry from North Sydney, Nova Scotia, to either Port aux Basques or Argentia, the latter of which is a 90-minute drive from St. John's.

We're in Newfoundland, the island portion of the Canadian province of Newfoundland and Labrador. At more than 42,000 square miles with nearly 11,000 miles of coastline, Newfoundland, affectionately called "The Rock," is the country's fourth-largest island. It's a wild, untamed land encompassing vast distances and surprises around every corner.

For an RVer, Newfoundland isn't easy to reach, yet many do — and it's worth the effort. You can take a Marine Atlantic ferry (www.marineatlantic.ca/en) from North Sydney, Nova Scotia, to Port aux Basques, in southwestern Newfoundland, or from North Sydney to Argentia, which is a 90-minute drive from the capital city of St. John's. We chose to fly into St. John's and rent an RV from Islander RV (<https://islanderrvs.com>). Because the island is the size of California, we couldn't see it all — or even a large part of it — in the week we allotted. We settled on exploring the island's eastern coast along the Avalon and Bonavista peninsulas and Twillingate Island, aka Iceberg Alley.

Colorful St. John's

St. John's is a lively harbor town of 100,000 that's the provincial capital and its largest city. The walkable downtown is filled with historic buildings in a riot of reds, blues, pinks, yellows and oranges. The vibrant architecture may be a defense against gray, cloudy weather. St. John's residents

happily boast their city is “the rainiest, foggiest, snowiest and windiest place in North America.” It certainly has variable weather. During our late-July visit, St. John’s treats us to sunshine, cool cloudy skies, misty fog and a few moments of driving rain.

The downtown’s two main streets are packed with one-of-a-kind shops and plenty of bars, cafés and coffee shops. We trundle down McMurdo’s Lane to the Duke of Duckworth, a popular bar/restaurant serving Irish fare and tasty fish and chips. (You might recognize it from the Netflix series “Republic of Doyle.”)

St. John’s is brimming with history. Signal Hill, a former military citadel built in the 17th century overlooking the city and harbor, defended the town through World War II. In 1901, Guglielmo Marconi received the first trans-Atlantic wireless signal here. We scramble up Cabot Tower for a sweeping view.

Twenty minutes from town, Cape Spear National Historic Site, the province’s oldest surviving lighthouse/keeper’s quarters, stands on a windswept coastline. We stroll the rolling hills dotted with wildflowers — bluebells, pink clover, purple iris, white Queen Anne’s lace, yellow buttercups — and, a short jaunt from the lighthouse, gaze at the Atlantic from North America’s easternmost point.

Avalon’s Irish Loop

The next day, we pick up our motorhome and head south on Highway 3/10 to Cape Broyle. This is the Irish Loop, named for Newfoundland’s Irish immigrants.

We wend through hills populated with thick boreal forest and tiny fishing villages nestled around rocky coves and pint-sized harbors. Most of these small towns have fewer than a dozen homes with the occasional store, gallery or bed and breakfast.

Water is a major theme in Newfoundland. It’s surrounded by water and the boggy land is studded with rivers and ponds ranging from the size of a small car to dozens of



Above: On a sea kayak tour, Stan Cook Jr. shows paddlers Cape Broyle’s hidden treasures. Right: The sight of a humpback whale breaching is breathtaking. Below: Atlantic puffins at the Elliston Puffin Site provide visitors with up-close viewing.



acres. The water table is so high that telephone poles are supported by rock piles.

In Cape Broyle, we’re scheduled for a tour with Stan Cook Sea Kayak Adventures (www.stancook.ca). After being outfitted with flotation devices and sea skirts, 16 of us scramble aboard double kayaks and follow Stan Jr. and two other guides into the harbor. Stan paddles along the shoreline, pointing out crabs, sea stars, waterfalls and sea caves. As we slip farther and farther toward the

Atlantic, the swells strengthen, and we ride up one side and down the other.

My arms are beginning to burn at the 4-mile mark when Stan shouts, “Whales!”

I spot first one spout, then another. A mother humpback and her calf are making their way up the harbor. We see a sleek black back; then another; and a tail fluke. My heart is pounding as we paddle toward the big creatures.

Just feet from our kayak, the mother surfaces, her back arching out



of the water. She sends up a massive water spray. The whale is so close I hear her breathe and then, she sings, a long melodious, magical note that rises and falls as she swims past.

Back in the motorhome, we pass La Manche Provincial Park. RV campgrounds are limited in Newfoundland. It's not unusual to see RVers "gravel pitting" on beaches or in parking lots at visitor centers. Provincial parks are a great choice. This one doesn't have hookups, but offers 82 forested, gravel-topped sites, a shower house and laundry right next to La Manche Pond.

We stop at the Colony of Avalon, the best-preserved early English Colonial site in North America and an active archaeology dig where visitors can work as archaeologists-for-a-day, or half-day. We tour the small museum and a reconstructed 17th century kitchen where we sample tasty pea soup and bread made over an open hearth.

Just down the road, the UNESCO

World Heritage Site Edge of Avalon Interpretive Centre boasts a fascinating exhibit about the oldest fossils of complex multicellular life found anywhere in the world. Scientists have discovered soft-bodied creatures without shells or bones that date back hundreds of millions of years on the exposed headlands of eastern Newfoundland.

Since there's summer light until 10 p.m., we cover plenty of territory. Highway 10 angles inland, winding through green hills, bogs and ponds. At St. Vincent's Beach, the vista opens to a 180-degree sea view and we spot whale spouts — two, four, eight, a dozen.

It's here we get up-close-and-personal with those whales along the beach. It's the second time we've encountered 150-ton creatures so close we can almost touch them.

We camp at White Pines Resort RV Park. At \$35 Canadian, this tidy park with partial hookups, gravel-

topped sites, a shower house and swimming pool is a bargain. We wake to warm weather and brilliant skies, and hop down the road to the Salmonier Nature Park, a free, walk-through wildlife rehabilitation center that showcases moose, mink, Newfoundland marten, owls, eagles and more. After yesterday's long drive, the accessible 1.6-mile boardwalk eases road kinks.

Bonavista Peninsula: Icebergs and Puffins

Heading north, we merge onto Highway 1, a fast, well-maintained road loaded with RVs. About 12 miles outside Clarendville, the terrain changes from Avalon Peninsula's green boggy expanses to Bonavista's craggy, heavily treed mountains.

We turn onto Highway 230 and motor into Port Rexton, where we're treated to our first icebergs. Every year, Newfoundland sees several hundred icebergs from the Arctic.

BROKEN WINDSHIELD?

CALL US FIRST

AND WE'LL HELP GET YOU BACK ON THE ROAD.

- Insurance Claims Processing • Nationwide Replacement Services
- #1 Supplier of OE RV Windshields • American-Made Replacement Product

rvglassparts.com • 1-855-782-5246





From far left: Cape Spear Lighthouse, built in 1836, is the oldest surviving lighthouse in the province. St. John's is famous for its brightly colored buildings.

May and June are iceberg months, but sometimes as late as July you'll find them floating like giant ships in bays and coves. A small crowd has gathered on the beach, cameras on hand, to capture the sight of two of these blue-green wonders.

We continue driving north on Highway 230 and then head northeast on Highway 238, a pockmarked bit of asphalt leading to Elliston, a great place to see puffins. We follow signs to Elliston Puffin Site, two giant rocks jutting into the ocean. We walk onto the first rock. Across a 50-foot expanse of water thousands of puffins have dug burrows into the second monolith's soft dirt.

We join a dozen others armed with binoculars and long lenses snapping photos of these funny little birds. Then, a single puffin flaps his short wings and lands just feet from us. He's joined by his posing and preening mate.

We stay at Elliston Municipal Park, a grassy spot across from the beach and puffin site. For \$20 per night, we snug into a large, back-in site with partial hookups, a picnic table and pounding surf that lulls us to sleep.

Peyton's Woods RV Park, near Twillingate, offers plenty of room for motorhomes.

With more than 3,000 people, the town of Bonavista is much larger than Avalon's fishing villages. We grab eggs and tasty fish cakes for breakfast and, under cool but sunny skies, wander the docks shooting photos of lobster boats.

At Cape Bonavista Lighthouse Provincial Historic Site, we tour the squat 1843 lighthouse/keeper's quarters. The waters and many inlets around Newfoundland are treacherous for mariners, and lighthouses save many vessels. Our guide tells us that until 1962, a 200-pound counterweight turned parabolic lights in the 18-foot tower.

Twillingate: Lobster and More

We motor along Highway 1, passing miles of boreal forest, ponds, lakes and fishing villages. In Twillingate, we overnight at beautiful Peyton's Woods RV Park, with full- and partial-hookup sites, and wake to mild temperatures and brilliant skies.

Twillingate is famous for icebergs, but locals say: "It's July. There aren't supposed to be icebergs." Fortunately for us, there are several. And wherever 'bergs appear, so

do visitors. RVers, many in large motorhomes, ply the narrow, winding roads. Residents don't seem to mind as we park willy-nilly and scramble up rocks to see these Arctic wonders.

In the afternoon, we meet Crystal Anstey, owner of Experience Twillingate, for a beach "boil up." She has laid a fire on the sand, with a cooking grate. We stretch out on a quilt and relax while Crystal scoops seawater into a large cooking pot. "Ocean water has the perfect salinity for cooking," she tells us, pouring glistening black mussels into the water.

A few minutes later, the mussels are cooked, their orange flesh peeking from shells. Crystal dumps the steaming mussels onto a large tray and we eat them out of hand. They're delicious. Then she adds four huge lobsters to the pot and, when they're cooked, chops them into pieces. The hot lobster is served with a green salad and crispy French bread.

The lobster is uber-fresh and delicately sweet. As I savor this taste of Newfoundland, I gaze across the water and spot a whale cavorting just offshore. What could be more delicious? **M**

FOR MORE INFORMATION

Elliston Municipal Park
www.rootcellars.ca/attractions/elliston-municipal-park

La Manche Provincial Park
www.tcii.gov.nl.ca/parks/p_lm

Newfoundland and Labrador Tourism
800-563-6353, www.newfoundlandlabrador.com

Peyton's Woods RV Park
709-884-2000, www.peytonswoods.com

White Pines Resort RV Park
709-229-7373, www.whitepinesresort.com





IT'S THE JOURNEY



You've watched an Atlantic sunrise. You've seen a Pacific sunset. You've traversed un-ventured valleys and viewed the world from above the clouds. And you never worried about the destination because you knew your Fleetwood RV diesel would get you there. Here's to the next journey.

Visit [FleetwoodRV.com/Journey](https://www.fleetwoodrv.com/Journey)

to see our legendary diesel motorhome lineup, including Pace Arrow, Pace Arrow LXE, Discovery, and Discovery LXE.



Fleetwood RV, Circle 121 on Reader Service Card

Get Healthy It's SUP to

A stand-up paddleboard is a great way to get in shape while enjoying the outdoors



You!



We've all heard of the "Freshman 15," the unfortunate weight gain that sometimes accompanies living out of college dorm refrigerators and eating cafeteria food. But you might be more familiar with the "Campground 10" — the extra pounds that result from living life on vacation for weeks, and even months, at a time. My first experience with this malady came in the winter of 2015, when we tried snowbirding in Florida for the first time. From fried plantains and 50-cent shrimp to sunset toasts on the Gulf, it felt like two glorious months of nothing but Saturdays. The problem came when I had to switch from shorts to jeans on the way home. It became immediately clear from the way my clothes fit (or didn't) that I was in trouble.

The problem wasn't just food — it was exercise. While many campgrounds provide fitness rooms, who wants to travel hundreds of miles to spend time indoors? Just walking or biking weren't going to do it. What I needed was a portable exercise machine that could give me a complete workout while still letting me enjoy the great outdoors. I got it all, and more, with a stand-up paddleboard (SUP).

Paddle boarding doesn't require any special skills, and it is one of the few sports that has proven equally popular among young and old alike. In fact, stand-up paddle boarding is the fastest growing watersport in the United States,

with more than 2.8 million participants. Best of all, stand-up paddle boarding isn't just aerobic exercise — it utilizes a range of muscles, providing a full-body workout. With so many campgrounds along the coasts, rivers and lakes, it is a great exercise option for RVers like me.

"Stand-up paddle boarding works the core. It's also a great way to sculpt your abs, shoulders, back and hips," says YMCA fitness trainer and certified paddleboard yoga instructor Rebecca Wojtach.

Wojtach, who leads SUP tours and teaches paddleboard yoga classes at the five-star Tides Inn and Spa in Irvington, Virginia, notes that the sport has the added advantage

of getting users outside, enjoying their physical environment in a way that isn't possible with most other forms of exercise. I agree; in my first year with my own SUP, I've seen everything from manatees to mountain waterfalls, all while burning calories, improving balance and toning muscles.

If that sounds better than sweating at the gym, here are some options to consider before adding an SUP to your motorhome's inventory.

Hard Board or Inflatable?

For RVers, it all comes down to space. The typical paddleboard will be more than 10 feet in length, and there aren't a lot of dedicated storage spaces in a motorhome that can accommodate objects of that size. If, like many of us, you barely have room for your golf clubs and scuba gear, an inflatable SUP is a great choice. Look for one constructed of multi-layered cloth, drop-stitched with an outer shell of military-grade PVC. These inflatable boards are lighter than hard boards but are rugged enough to withstand collisions with rocks and hard surfaces. When

DO YOU INSURE YOUR DINGHY VEHICLE SEPARATE FROM YOUR MOTORHOME?

**DON'T GET STUCK PAYING
TWO SEPARATE DEDUCTIBLES**

GET A FAST, FREE QUOTE!

Call: 1-866-789-0125 and mention savings code TD-8N

Click: GoodSamRVInsurance.com/code/8N

**GET A \$10 CAMPING WORLD MERCHANDISE
CERTIFICATE WHEN YOU GET A FREE QUOTE!**

WE REPRESENT THE NATION'S TOP RV SPECIALITY INSURANCE CARRIERS!



PROGRESSIVE

National General 
Auto, Home & Health Insurance

Safeco InsuranceTM
A Liberty Mutual Company

Get Healthy — It's SUP to You!

Inflatables are lightweight enough to be transported around the campground in an SUP backpack.

properly inflated, they have comparable rigidity to a hard board and are generally less expensive. Their biggest advantage is ease of transport — an inflatable SUP, manual pump and two-piece paddle can fit inside a specially designed backpack and be worn while riding a bike.

If you travel with a toy hauler or have a towed vehicle with an empty roof rack, you might want to look at hard boards. The least expensive option in this category is plastic, which has the added advantage of “bomb proof” durability. You can even attach accessories like fishing rod holders or seats to the deck of a plastic SUP without compromising its structural integrity. On the negative side, these SUPs are heavy and can be unresponsive and hard to paddle. Another option is fiberglass. These boards have a foam core and are light, fast and maneuverable. The downside is that they cost more than plastic boards and are easily “dinged” by rocks, docks and pets. Strapping one tightly to a roof rack can even cause minor damage to the rails and deck. The third and most expensive option is carbon fiber.



These high-performance boards are used primarily for racing and touring, and are among the lightest and most rigid manufactured. (For a selection of motorhomes that do offer extra space for a stand-up paddleboard, turn to page 32.)

Shapes and Sizes

In addition to board material, you have a variety of sizes and shapes to choose from. Most new paddlers will want to look for a touring/ cruising or all-around SUP ranging between 10 and 11½ feet. The touring/ cruising board is built for glide, with a V-shaped bow designed to cut through the water for better tracking and speed. All-around boards have a more rounded nose and wider body, providing stability for beginners and for bringing pets or small children along for the ride. Most all-around boards are even stable enough to be used for yoga, though there are also dedicated yoga boards available. These often have bottoms shaped specifically to support the user's balance, a soft top and “bumper” sides, and places to hook on exercise equipment or an anchor.

For experienced paddlers and competitive types, a race board is another option. Ranging between 12½ and 20

An all-around fiberglass board has enough volume to float a paddler and her pet.



Photos: Eric Eichemuller

SUP MSRPs

Plastic stand-up paddleboards like the Lifetime Freestyle and Sea Quest 10 start at as little as \$349, while fiberglass boards range from an MSRP of \$700 to \$2,000. Inflatables, like the Ten Toes Weekender, pictured on the following page, start at about \$600.

SAFE T PLUS

Steering Control

Get Your
White Knuckles
Back to Tan



SAFE T PLUS

PROTECTS AGAINST THE EFFECTS OF:

- Road Wandering
- Over-steering
- Side Winds
- Passing Trucks

LIFETIME VEHICLE WARRANTY

SAFE-T-PLUS.COM

Safe-T-Plus, Circle 128 on Reader Service Card

DIESEL TOWN TEXAS

Airstream Touring Coaches



Leisure Travel Vans



Exclusive Dealer in Texas!
Midwest Automotive Designs



Tiffin Motorhomes



Full-Line Dealer!

VOGT

RV CENTERS

Airstream - Allegro - Jayco
Tiffin - Leisure Travel Vans
Midwest Automotive & More!

VOGTRV.COM

817-831-4222

Get Healthy — It's SUP to You!

feet in length, these boards have a long, narrow profile and pointed nose for excellent tracking ability at high speeds. They are also less stable and extremely responsive to paddler movement, requiring more skill, and are generally much more expensive than other types of boards.

If you'd like to take your SUP in the surf or on whitewater, look at wave boards. These are usually less than 10 feet long with a narrow nose and tail for quick turning. They are lightweight and low volume, meaning they will be less stable. They also don't track well over distance so they do not easily transition to touring/cruising.

After narrowing down the type of board you want, arrange to rent or demo boards from different manufacturers. Small differences in bottom shape, rails and fin configurations can make big differences on the water. Before you buy, also look closely at the volume or displacement and the suggested weight limits by asking for the specs or checking the manufacturer's website. For beginners, bigger is better —especially if you don't want to get wet.

Getting on the Water

An SUP is considered a vessel by the U.S. Coast Guard unless operated in surf or a designated swimming area,



Inflating a board (here at a campground overlooking the Gulf of Mexico) takes about 10 minutes with a hand pump.

so in most states you are required to have a life jacket and signaling device, such as a whistle, on board. A personal flotation device (PFD) specifically designed for paddlers, like a self-inflating SUP belt-style life jacket, will provide the greatest flexibility of movement, but for those who have health issues or are not confident swimmers, a vest-style Type III PFD is a better choice. The majority of accidents occur when paddlers get separated from their boards, so experts recommend wearing a leash in addition to a life jacket, especially in rough water. For your first time, you might also want to sign up for a lesson or an SUP tour. While paddle boarding is not hard, an instructor can show you a few tricks to make balancing, turning, and stopping safer and easier. Then you'll be ready to banish the "Campground 10" forever.



It's a good idea to try out the board in calm, shallow water like this swimming area.

The greatest adventure
is what lies ahead



roadtrek.com

 [/roadtrekmotorhomes](https://www.youtube.com/roadtrekmotorhomes)

 [/roadtrek](https://www.facebook.com/roadtrek)

 [/roadtrekmh](https://www.instagram.com/roadtrekmh)

1.888.roadtrek



 **ROADTREK**
Your destination awaits

Roadtrek Motorhomes, Inc., Circle 107 on Reader Service Card

Sea Eagle SUPs

If an inflatable board is the best fit for your RV lifestyle, Sea Eagle is the place to start. Known for its innovative boards as well as for its customer service, the company is one of the largest manufacturers of economically priced inflatables worldwide. Sea Eagle offers three series of SUPs, each tailored to specific situations and water conditions, to provide users with the highest performance at an affordable price.



LongBoard Series

An all-around or hybrid board, these inflatables allow users to sit, stand, surf, fish, tour and even perform yoga. Designed for stability, Sea Eagle LongBoards are 30 inches wide and 6 inches thick, providing plenty of flotation, and unlike many all-around boards, the Stand Up/Sit Down LongBoard has been updated with premium paddling performance in mind. A newly added 4-inch nose/entry rocker, followed by a slight continuous board rocker and 2-inch tail rocker add up to improved handling, and the full-length EVA foam Diamond Deck Pad provides traction and comfort. These qualities make the LongBoard perfect for surfing and extended touring. Available in 11-foot length for riders up to 200 pounds and 12½-foot length for riders up to 250 pounds.



NeedleNose Series

These high-performance boards offer all the benefits of a rigid SUP with the convenience of an inflatable. The unique, patented design features a sharp, wave-piercing bow, allowing users to slice cleanly through rough water. The sleek touring shape, skeg (tapered stern) design and kick tail maximize tracking and handling and, best of all, each board in this series weighs less than 30 pounds. The touring models are available in 11-foot 6-inch, 12-foot 6-inch, and 14-foot lengths, with two leading side skegs and a removable rear fin, and all feature the same comfortable width and foam deck of the LongBoard Series. Sea Eagle also makes the 126 R, a racing model weighing in at only 23 pounds, with a narrower waist (26 inches) and a single fin for increased speed.



The FishSUP

Sea Eagle's Fishing Inflatable SUP is unlike anything else on the market. Wide and stable, this board has all the benefits of an inflatable kayak while still providing the fun and versatility of an SUP. It features 14 D-ring attachment points for adding accessories and gear, and a removable rear motor mount that can handle up to a 55-pound thrust electric trolling motor. The nonskid EVA foam camo deck is great for standing or sitting, and the FishSUP even includes a built-in 36-inch fish ruler. This inflatable is rated for up to 350 pounds, so you can even bring along the family dog. The design is perfect for families who want a multiuse SUP that can be easily stowed in an RV's limited storage space.



All Sea Eagle inflatable SUPs are constructed of 1,000-denier reinforced drop-stitch material for improved rigidity and durability, and all come complete with a unique paddle pocket for stowing the paddle. Basic LongBoard and NeedleNose packages come complete with hull, paddle, removable skeg, hand pump, backpack, and repair kit, and current MSRPs start at \$699 for the LB11 and \$899 for the NN116. The basic FishSUP package includes hull, both SUP and sitting paddles, backpack, seat, storage box, backpack, hand and foot pumps, and repair kit for \$879.

Sea Eagle Boats, 800-748-8066, www.seaeagle.com M

“

NO ONE EVER SAYS,

I'D RATHER BE
AT THE OFFICE

BUT EVERYONE LOVES TO SAVE MONEY.

”



GEICO® *for your RV*

[geico.com](https://www.geico.com)

800-442-9253

Local Office

Some discounts, coverages, payment plans and features are not available in all states or all GEICO companies. GEICO is a registered service mark of Government Employees Insurance Company, Washington, D.C. 20076; a Berkshire Hathaway Inc. subsidiary. © 2018 GEICO

Geico, Circle 110 on Reader Service Card

MORE IN STORE

MOTORHOMES THAT HAVE EXTRA SPACE FOR STAND-UP PADDLEBOARDS, KAYAKS AND ALL YOUR OUTDOOR GEAR

We've all got stuff. Lots of stuff. Some of us may even have too much. And, especially while spending time in a motorhome, that stuff can add up. It can not only affect the livability inside the motorhome — requiring gymnastics and as-yet-unheard-of yoga poses to navigate the aisles — but

it can also cause the motorhome to become overloaded, which can have disastrous consequences.

As a result, one of the decisions to make before hitting the road (along with where you're headed) is exactly how much of that stuff you should take with you. Space, of course, dictates our final decisions, as does the realistic occupant

and cargo carrying capacity (ROCCC). And, unless you're a minimalist, chances are you'll have to leave some of your favorite stuff behind.

While we would never recommend bringing along everything including the kitchen sink (a motorhome already has one of those, after all), there are many motorhomes that can accommodate quite a bit of stuff, from outdoor gear to recreational toys to tools and furniture. But, you don't need a 45-footer or a toy hauler to enjoy a floorplan with extra room to spare (though that may help). We have gathered a group of motorhomes here that have the capacity, space and storage to allow for all the extras you'll need to enjoy the trip. And now that you know stand-up paddleboards are a great way to enjoy the outdoors while exercising and burning some calories (as are canoes, kayaks, bicycles and the like), the motorhomes included here are a great starting point to enable you to begin your new hobby (or enjoy it more than ever) by seamlessly blending your favorite recreational pursuits — while at the same time staying within the weight limitations of a highly livable floorplan.

The Sunlight RV Van Two can easily be configured to allow for storage of bulky items in camp or on the road.





COACH HOUSE PLATINUM II 241XL

With 10 different floorplans to choose from, the Platinum II 241XL from Coach House is sure to provide a configuration that works well for on-road performance, living and bulky-item storage. Buyers who opt for one of the rear twin-bed layouts (two beds that can become one larger bed for sleeping) should find more than enough room for storage in the rear aisle, while exterior storage compartments offer enough real estate for an inflatable kayak or SUP. Premium floor coverings, stainless-steel appliances and a Truma AquaGo continuous water heater are all standard, as are the 3.6-kW LP-gas MicroQuiet AC generator, Wi-Fi booster and power box awning. Driving conditions are improved with the power-assisted steering and in-dash GPS, while campsite rocking and rolling is reduced by the standard Equalizer stabilizer system. Coach House motorhomes are sold factory-direct for maximum value, come with full-body paint (with optional Premium upgrades available), and feature the upscale craftsmanship for which the manufacturer is known.



Chassis	Mercedes-Benz Sprinter 3500
Engine	3.0L turbodiesel
Fuel cap	26 gal
GVWR	11,030 lbs
Exterior length	25' 9"
Exterior width	8'
Exterior height with A/C	10' 8"
Wheelbase	170"
Freshwater cap	31 gal
Black-/gray-water cap	25 gal/ 28 gal
LP-gas cap	15 gal
Base MSRP	\$181,100

Coach House
800-235-0984, www.coachhouserv.com

FLEETWOOD PACE ARROW LXE 38N

With exterior storage totaling 156 cubic feet — in addition to the 151 cubic feet of storage inside — Fleetwood's Pace Arrow LXE 38N offers plenty of room for bulky items without sacrificing on luxury. And seeing as how the 38N floorplan offers two bathrooms, convertible bunk beds and an adjustable king-size bed in the master — the crew you bring along will no doubt find that space necessary. Things inside will seem wide open thanks to the 84-inch soft-touch vinyl ceiling height throughout. The full-wall slide — one of three total slides on the 38N — makes aisle storage an easy affair. But livability is where the Pace Arrow really shines. A full bath serves the bunk area, while an en-suite full bathroom off the master runs the full width of the rear of the coach. A 43-inch LED TV in the living area is mounted above an electric fireplace, while the galley features an induction cooktop, pantry and residential refrigerator. The 38N is built on a Power Bridge chassis, which allows for what the company calls the industry's largest pass-through chassis storage.

Chassis	Freightliner XCM	Exterior height with A/C	12' 10"
Engine	Cummins ISB	Wheelbase	252"
Fuel cap	100 gal	Freshwater cap	100 gal
GVWR	33,000 lbs	Black-/gray-water cap	50 gal/ 75 gal
Exterior length	38' 7.5"	LP-gas cap	38.7 gal
Exterior width	8' 6"	Base MSRP	\$285,860

Fleetwood RV, 800-854-1344, www.fleetwoodrv.com



MORE IN STORE

FOREST RIVER BERKSHIRE XLT 45A

By building the Berkshire XLT 45A on a Freightliner XCR raised-rail chassis, Forest River was able to include a relative surplus of basement cargo storage. All baggage doors are fully insulated, and owners with SUPs or kayaks — or any large, bulky items — can take their pick of one large bay with café-style doors that can accommodate a large slide-out tray, another bay right behind that which could house a tray of its own, and a third compartment that could easily swallow most outdoor gear. But, when the coach you're piloting is nearly 45 feet of luxury on wheels, storage is rarely an issue. The Berkshire XLT is Forest River's flagship motorhome, and the 45A bunkhouse is outfitted with top-shelf appointments. All countertops are polished solid-surface, the flooring is polished porcelain tile with accents and the appliances are all residential-grade. Two full bathrooms and a variety of configuration options make this a great motorhome for families and those who like to bring along guests. New for the model year is a Truma AquaGo continuous water heater, which makes the coach all-electric; however, one interesting wrinkle is that the manufacturer will include a compartment for a customer-supplied LP-gas cylinder to allow for campsite grilling. The Berkshire XLT also boasts a 15,000-pound towing capacity, should your SUP preferences evolve into that of an actual boat.



Chassis	Freightliner XCR	Exterior height with A/C	12' 11"
Engine	Cummins ISL	Wheelbase	294"
Fuel cap	150 gal	Freshwater cap	103 gal
GVWR	44,320 lbs	Black-/gray-water cap	42 gal/ 66 gal
Exterior length	44' 7"	LP-gas cap	N/A (all-electric)
Exterior width	8' 6"	Base MSRP	\$388,562

Forest River Inc., Berkshire XLT Division, 574-522-3963, www.forestriverinc.com

KING Jack™

Over-The-Air Antennas

KING Jack Replacement Head

MFG # OA8300

KING Jack Roof-Mount OTA

MFG # OA8400/01
OA8500/01 (Premium Models)

King, Circle 112 on Reader Service Card



**No Commitment.
No Contract.
No Strings.**

KING OTA antennas have a wider reception angle and greater range than traditional RV antennas, connecting you to more local HD channels.

KING
Simply better, by design.™
kingconnect.com



JAYCO REDHAWK 29XK

After 50 years in the RV industry, Jayco continues to pride itself on customer service, offering peace of mind long after the initial purchase by including a two-year limited warranty on its vehicles. Plus, motorhomes like the Redhawk 29XK are equipped with the JRide Plus system, improving overall ride and handling even with additional cargo aboard by employing Hellwig helper springs, rubber isolation body mounts, Bilstein monotube shocks, jounce bumpers and stabilizer bars, combined with air brakes, computer-balanced driveshaft and rear air suspension. Inside, the Redhawk 29XK offers plenty of sleeping space for six to seven happy campers, including a walkaround queen bed in the rear. A large U-shaped dinette can easily accommodate the whole family, as can the surplus of counterspace and storage areas, while the linoleum flooring makes for easy cleanup or

stress-free SUP transport. When the party moves outside, a large 16-foot awning protects owners from the elements, while the heated holding tanks help with all-season enjoyment. The Redhawk also includes a standard backup camera integrated into a third rear brakelight for added convenience. Further highlights include a 7,500-pound tow rating, a one-piece fiberglass front cap and spacious pass-through storage.

Chassis	Ford E-450
Engine	6.8L V-10
Fuel cap	55 gal
GVWR	14,500 lbs
Exterior length	32' 6"
Exterior width	8' 4"
Exterior height with A/C	11' 6"
Wheelbase	223"
Freshwater cap	43.5 gal
Black-/gray-water cap	32 gal/ 41 gal
LP-gas cap	12 gal
Base MSRP	\$100,755

Jayco, 574-825-5861, www.jayco.com



RV Armor Lifetime Roof



leak and worry-free FOR LIFE.

- **Lightweight:** Seamless, and maintenance-free
- **Convenient:** Don't Move! We'll come to you and install your new roof. Two-day process with nationwide service.
- **Affordable:** Less expensive than a traditional roof replacement
- **Permanent:** Lifetime material and labor warranty. Tracked by the VIN #



SEAMLESS

www.RV-ARMOR.com

Call 855-RV-ARMOR (855-782-7667)



RV ARMOR is a Federally Registered Trademark of RV Armor, Inc. All Rights Reserved.

LEISURE TRAVEL VANS UNITY ISLAND BED

When you think motorhome storage, a compact luxury Class C without any slideouts may not immediately jump to mind. But when it comes to a balance between maneuverability, livability and innovative use of available space, Leisure Van's Unity Island Bed is tough to beat. At just over 25 feet long, the Unity is easy to drive right up to the dock, and its 63 cubic feet of exterior storage — including the rear full pass-through compartment — has a decent amount of space for your bulky aquatic adventure items. The interior of the Unity is designed around the rear walkaround 54-by-74-inch bed, and the clever usage of the footprint (and curved doors) makes the rear of the motorhome feel like its own master retreat. The Unity also features a split dry bath, plenty of interior storage (including a pair of wardrobes in the bedroom) and upscale curved cabinetry. LED lighting, whole-coach water filtration, Corian countertops and the Truma AquaGo comfort plus water heater are much appreciated. Outside, frameless windows and Euro-inspired front and rear caps adorn the Mercedes-Benz Sprinter chassis, which also sports bi-xenon headlamps, collision prevention assist and a standard in-dash GPS system.



Chassis	Mercedes-Benz Sprinter 3500	Exterior height with A/C	10' 6"
Engine	3.0L V-6 turbodiesel	Wheelbase	170"
Fuel cap	26.4 gal	Freshwater cap	30 gal
GVWR	11,030 lbs	Black-/gray-water cap	29 gal/ 37 gal
Exterior length	25' 1"	LP-gas cap	15 gal
Exterior width	7' 10.5"	Base MSRP	\$125,060

Leisure Travel Vans, 877-992-9906, www.leisurevans.com





NEWELL COACH 1642

With almost 500 square feet of living space, the quad slide, bath-and-a-half Newell Coach 1642 is a virtual penthouse on wheels. But its luxury doesn't mean it can't accommodate outdoor equipment: dual pass-through storage bays up front measuring 92 inches deep by 45 inches wide will be more than enough for your floatables. Each tray is controlled via a handy remote, allowing access from both sides of the coach. Inside, everything about this coach exudes luxury, from the limestone tile flooring to the underlit quartz countertops in the bathrooms to the premium leather furniture. Two TVs reside in the front salon area, while a 49-inch TV entertains in the bedroom area. Plus, there's a fourth TV on an articulating arm in the exterior storage bay. The galley features dual stacked pullout pantry cabinets for plenty of food storage, in addition to a Fisher & Paykel DishDrawer dishwasher, garbage disposal, Wolf-brand two-burner cooktop and GE Monogram refrigerator/freezer. And did we mention the stackable Whirlpool washer/dryer located amidships? All this on a motorhome with a gross vehicle weight rating (GVWR) of more than 63,000 pounds.

Chassis	Newell	Exterior height with A/C	13' 4"
Engine	Cummins ISX	Wheelbase	302"
Fuel cap	200 gal	Freshwater cap	143 gal
GVWR	63,300 lbs	Black-/gray-water cap	143 gal (combined)
Exterior length	45'	LP-gas cap	N/A (all-electric)
Exterior width	8' 6"	Base MSRP	\$2,005,610

Newell Coach, 888-363-9355, www.newellcoach.com



PHOENIX CRUISER 2552

With factory-direct pricing and the ability to customize any of its nine floorplans, Phoenix Cruiser is a good choice for RVers who want to be more hands on in the design process. Phoenix says its motorhomes — like the 2552 — are more aerodynamic than other Class C's due to their low center of gravity, shorter profile, and curved fiberglass walls and roof. All that adds up to an enjoyable driving experience, even while the storage areas are stuffed to the gills with recreational equipment (staying within weight limitations). All-LED lighting illuminates the interior, and cabinets come in your choice of hickory or cherry hardwood. Most selections of interior appointments are your own, but the 2552 is standard with a U-shaped dinette and two 32-by-74-inch beds located just off of the large rear bathroom. Outside, a pullout storage tray is rated for 200 pounds of gear, while the rear cap also features a large side-to-side storage compartment for the shorepower cord and bulky items. And, for a more custom storage option, Phoenix can even attach a roof-mounted rack for your favorite toys.

Chassis	Ford E-450
Engine	6.8L V-10
Fuel cap	55 gal
GVWR	14,500 lbs
Exterior length	27' 10"
Exterior width	7' 9"
Exterior height with A/C	10'
Wheelbase	206"
Freshwater cap	45 gal
Black-/gray-water cap	35 gal/ 23 gal
LP-gas cap	10 gal
Base MSRP	\$116,970

Phoenix Cruiser

877-754-8535, www.phoenixusarv.com



SUNLIGHT RV VAN TWO

A division of Erwin Hymer Group North America, Sunlight RV manufactures the Sunlight Van Two Class B that has clearly been designed with access to adventure in mind. The fully equipped no-nonsense interior is thoughtfully laid out and features a rear dinette and bench seating that can convert to a single king-size sleeper or two twin beds. The galley features a 3.1-cubic-foot refrigerator, microwave and two-burner LP-gas stove, while the spacious bathroom with shower, toilet and foldaway sink is a great use of available space. The captain's chairs up front both swivel to turn the front of the Van Two into a dining area, which frees up the rear of the motorhome for storing kayaks, SUPs and the like. Optional EcoTrek lithium batteries and 200-watt solar panels enhance the Van Two's ability to perform off the grid, and climate control is via an 11,000-Btu roof-mounted A/C and an automatic LP-gas heating system. The Sunlight Van Two is available at Camping World locations nationwide.



Chassis	RAM ProMaster
Engine	3.6L V-6
Fuel cap	24 gal
GVWR	11,500 lbs
Exterior length	19' 6"
Exterior width	6' 7"
Exterior height with A/C	9' 5"
Wheelbase	159"
Freshwater cap	17.6 gal
Black-/gray-water cap	23.1 gal (combined)
LP-gas cap	6 gal
Base MSRP	\$68,835

Sunlight RV
 844-745-4410, www.sunlightrv.com



WINNEBAGO TRAVATO 59K

Versatility is what makes the Travato 59K a good choice for RVers who have cargo that may be a bit bulkier than the norm. The seating area located amidships leaves the aisle open for your SUP or kayak by day, and can transform into dual twin beds or a single large sleeper by night. But more than a modest space to lay your head (or canoe), the luxurious Travato is outfitted with standard premium features like Corian countertops, Truma Combi eco plus heating and 200-watt solar panels. The ultraleather captain's chairs turn around to expand the entertainment and dining opportunities in the front living area. A 24-inch LED TV and coach stereo system are also standard, as are the microwave convection oven, two-burner range top and powered patio awning with LED lighting. The bathroom is outfitted with a foot-flush toilet, flexible showerhead and fold-down sink. For more storage versatility, buyers can also opt to add a bike- or luggage rack to help haul additional recreational gear.

Chassis	RAM ProMaster	Exterior height with A/C	9' 4"
Engine	3.6L V-6	Wheelbase	159"
Fuel cap	24 gal	Freshwater cap	23 gal
GVWR	9,350 lbs	Black-/gray-water cap	13 gal/ 13 gal
Exterior length	21'	LP-gas cap	6 gal
Exterior width	6' 9"	Base MSRP	\$106,630

Winnebago Industries, 641-585-3535, www.winnebagoind.com



Powerfully Convenient

Aqua-KEM®

Toss-Ins™ and Shotz™

Powerful Odor Control in Convenient Concentrated Packets!

- Liquefies waste fast to prevent clogging
- Works around the clock in all weather conditions
- 100% biodegradable deodorant



Try NEW *Shotz™* Micro-Concentrates, available in 24-Dose easy-grab container!

The Best RV Toilets

When it comes to replacements & upgrades, Thetford is the best in the business.



Aqua-Magic®
Style II



Aqua-Magic®
Residence



Aqua-Magic®
V

A3326

From the RV Sanitation Expert

THETFORD

www.thetford.com

ON SALE NOW for Good Sam Club members at Camping World. Also available at other RV retailers.

Thetford Corporation, Circle 130 on Reader Service Card



Isata 4 Series

Cues taken from Dynamax's big brother models transform a Class C motorhome into a nimble luxury machine with high-tech features **By Bob Livingston**

When you look at the model lineup at Dynamax, a builder that specializes in luxury motorhomes, you won't find conventional design. The company started its venture into RV manufacturing 21 years ago by mating a commercial, executive-class truck cab to a sleek body that really turned heads. My first encounter with a Dynamax was early on in the company's history, and during a 2,500-mile test journey, I made a lot of friends with guys who loved the boldness of the design, but many of the women were less than enamored, until they stepped inside.

At the time, it was hard to define whether this luxury motorhome qualified as a Class A — certainly the level expected of higher-line coaches — and the company was adamant that it wasn't a Class C. The experience made great happy hour conversations everywhere we stopped.

Fast-forward and the company

has branched out into building Class C motorhomes with the same level of luxury, and clearly there's no controversy on classification. The Isata 4 Series is as classic a Class C as one can get, especially since it's built on the venerable Ford E-450 cab and chassis, and the 25FW we tested meets all the criteria, only notched up with

Dynamax-style flair.

The floorplan elements are not unique to the industry, but after the Dynamax people pulled design cues from its big brother motorhome models, the aura changed dramatically. Here, form and function blend beautifully with the warmth of the décor and the feeling one gets that this Class C is top shelf.

At 27 feet 5 inches long, with some of that space allocated to the engine compartment and cockpit, there are some livability limitations, mostly in the seating configuration in the living room. Fortunately, some of the space constraints are mitigated by the optional swiveling cockpit

ABOVE: The Isata 4 Series is built on a Ford E-450 cab and chassis. Full-body paint and tasteful graphics enhance aesthetics.

BELOW: Compact galley requires advance meal preparation planning; flip-up counter increases counterspace. Huge bathroom is an unexpected feature. Shower is roomy, but narrow counter is on the small side.



seats. And optional booster cushions can be placed on the cockpit seats when facing the living area, which make the seating surface much more comfortable.

Since space utilization is paramount, the front section of the motorhome is shared by the dinette and opposing galley. The proprietary Dream Dinette, with thick cushions and quasi-wraparound bolsters, allows for couch-like habitation and a place for two occupants to watch the 32-inch LED TV nestled in the cabover bunk. When converted into a bed, the surface easily sleeps one adult or two kids.

In true Class C fashion, the cabover can sleep two on the 52-by-81-inch sectionalized mattress. There is 29 inches of headroom up there; cup-holders and a storage area are in place for users to stash a decent amount of items. When not in use, the mattress stacks to make more headroom in the cockpit for easier passage to and from the living area.

“Compact” is the operative word

describing the galley. It took some planning to prepare meals, but the front-mounted flip-up extension saved the day. Fitted under and on the rich-looking solid-surface countertop is an assortment of cabinets and drawers, a stainless-steel sink with a high-rise faucet and a three-burner cooktop with a folding glass top. One of the lower cabinets is huge, and allows access to the contents from the entryway and in front of the galley counter. And, believe it or not, there is even a trash chute built into the structure with a nicely concealed “plug.”

Above the counter are additional cabinets and the microwave convection oven. There’s no range hood, but the nearby MaxxAir power vent suffices, per code, for removing steam and smoke. The RV refrigerator and pantry are adjacent to the galley counter.

What makes the limited amount of floor space work is the full-wall slide on the driver’s side. Occupying this large slideout is the aforementioned dinette, the wardrobe closet

and queen bed — divided appropriately. And while the flooring is not unique, the choice of the plank pattern in shades of gray, brown and white, works visual wonders. At the confluence of the lower front and upper back sections of the floor is a sweeping S-shaped divider that gives the impression that the interior is bigger than it really is. It takes a little acclimation when walking to prevent a misstep due to the raised floor in back, but the learning curve is quick.

Serving as a practical divider between the dinette and rear bed is a gigantic wardrobe closet. Those who like to take along a lot of stuff will be in heaven. Hang-up clothes can be stored in compartmentalized areas that provide enough room for any clothes hog. The front section is lined with cedar and has a drawer below the closet floor. Typically, the front seat bolsters will be stored here. To make the deal even sweeter, a sensor-controlled light makes finding clothing in the dark a breeze.

From left to right: Controls for the optional hydraulic leveling system, power inverter and switches are mounted in the entryway. The touch screen, tied into the Precision-Plex control system, is within easy reach. The Command Center, solar-panel controls and stereo are mounted above the entry door.





Above, from left: Dream Dinette has thick cushions and bolsters for support when stretching out to watch the TV mounted at the end of the traditional cabover bunk. Swiveling cockpit seats help create conversation area in the front living area.

In keeping with a “bigger is better” design mantra, those who like to linger in the bathroom will relish the exceptional floor space. The roomy shower with an Oxygenics showerhead and flex curtain take center stage. While residential-quality fixtures complement the bathroom, the plastic toilet, albeit a large model, is incongruent with the status portrayed by this motorhome. There’s good storage space afforded in the bathroom, but the counter has limited room for essentials, although it’s rather long. Lingering in the shower, to take advantage of the pulsating showerhead, is supported by a Truma AquaGo instantaneous water heater, which encourages longer showers and time in front of the

stainless-steel sink. Another MaxxAir power vent, with rain sensor, takes out the steam and clears the air.

The bedroom is understated, but it works well without the overdose of froufrou items that can be superfluous to RV living. Space limitations at the foot of the bed require the use of a folding mattress, which is very comfortable. At 10 inches thick, the gel-infused memory foam mattress offers great support. Although the bed is tucked tightly into the confines of the slideout, there’s enough room for a small nightstand on one side and a longer version on the other. Across from the bed, on a rather barren wall,

WHAT'S HOT 👍

Huge bathroom with roomy shower, full-body paint, Precision-Plex control system, armless patio awning, suspension upgrade with Hellwig sway bar, Truma AquaGo water heater

WHAT'S NOT 👎

Small galley, 30-amp service, plastic toilet, wheel liners



is a 32-inch LED TV. Even though the area is not fancy, strategically placed windows offer a more open feeling than expected. Privacy is afforded by pull-down roller shades used throughout the interior.

It’s easy to establish that the Isata Series 4 is earmarked for those who relish creature comforts, but Dynamax goes one step further by injecting enough electronic features to make any technoid happy. Beyond the Bluetooth-controlled entertainment system with zoned speaker controls is a multiplex wiring system that’s tied into a touch screen. The Precision-Plex system controls just about anything in the motorhome that’s connected to electrical power. From the screen, the user can control the lights, check tank levels, open and close the awning and slideout, operate the AC generator and turn on the water pump. Without going into infinite detail on all the abilities of this screen, let’s just say, “There’s not much left untouched.” The system also has the ability to monitor 120-volt AC amperage input and shed loads as needed to prevent overloading the circuits — a welcome addition since there’s only 30-amp service into the motorhome.

The Precision-Plex system is supported by an app that can be

DYNAMAX ISATA 4 SERIES

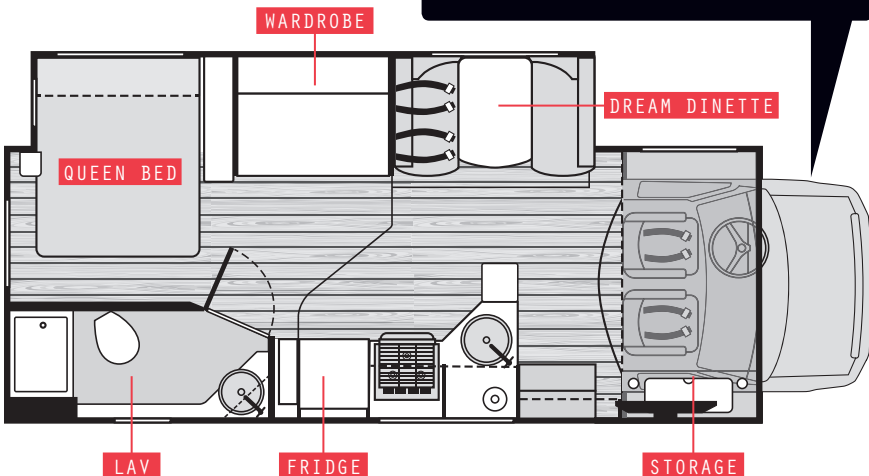

downloaded to an iOS or Android device and paired via a Master Controller. Once paired, the systems can be controlled by a handheld device within Bluetooth range — a feature that soon becomes one that occupants can't live without. Icing on the cake is the optional solar system comprised of two 100-watt panels and a 30-amp controller. The solar system is coupled to a pair of 12-volt AGM batteries and a 1,000-watt power inverter.

There is an expectation that outside storage would be somewhat limited in a Class C this size, but here the opposite is true. While the amount of space is not extraordinary, and will still require preplanning when sorting out what to take along, there's enough space for essentials, and pass-through areas to handle longer items that aren't too tall. Seamless Rotocast compartments are accessed via lateral doors fitted with heavy-duty adjustable latches.

Utility access is well thought out for easy hookups and to keep the hoses and cables organized. A narrow door opens down, exposing the city water hookup, black-tank flush, outdoor shower and a remote Precision-Plex monitor panel. A second access point within the main door offers a clever way to route the hoses. Interestingly, the hookups for cable/satellite TV and 30-amp power are outside of this compartment. There's also an access door for the LP-gas fill, and the dump valves are in a compartment that allows the hoses to be stored neatly.

Full-body paint and pleasant looking graphics tie the accessories and compartments together neatly, and the armless patio awning is a nice touch. Aluminum wheels, in lieu of the stainless-steel liners, would be a good option the company should consider for jazzing up the exterior aesthetics.

Fit and finish of the Isata reinforces the Dynamax reputation for building higher-end motorhomes targeted at discerning buyers. Construction follows proven techniques using aluminum framing and 1½-inch laminated side walls with block-foam insulation. Roof trusses and the floor



Good Sam

RV Loans

LIMITED TIME

Offer

\$399

PROCESSING FEE WAIVED WHEN YOU REFINANCE BY JUNE 30, 2018!†

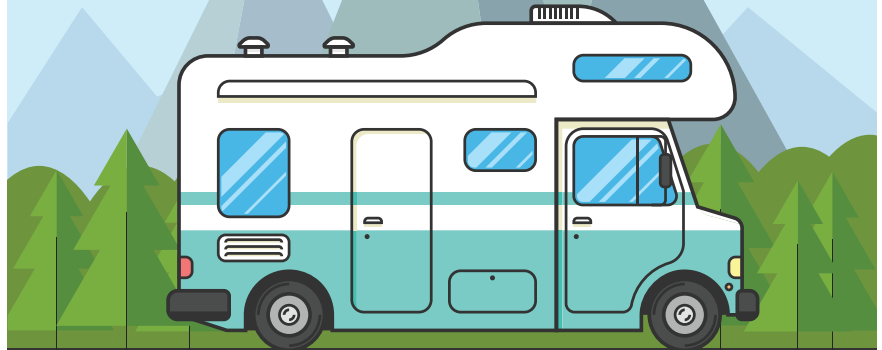

Now is a great time to refinance your current RV loan to lower your monthly payments! You can also finance a 2007 model year or newer RV when you purchase from a dealer or a private party seller. We offer a zero down loan program for up to \$50,000!

APPLY TODAY TO LOCK IN YOUR RATE!

RECREATIONAL USE APRs* AS LOW AS

5.09%

on loan amounts of \$50k+

5.69%

on loan amounts of \$25k to \$49,999

5.89%

on loan amounts of \$15k to \$24,999

APR is fixed for the life of the loan. Other rates with different loan terms are available. Rates are accurate as of March 6, 2018. See our website for current rates and terms, as well as financing for Full-Timers and loan amounts below \$15,000.

CALL

1-800-444-1476
mention priority code 477

VISIT

GoodSamRVLoans.com/477

*Estimated APR (Annual Percentage Rate) based on 7 year loan term; individual rate may vary by loan amount, loan term, vehicle use, model year and type of RV. Subject to consumer loan program requirements and credit approval. Certain fees, closing costs, and restrictions may apply. Rates and terms may vary with market conditions and are subject to change without notice. APR applied to the loan is the APR in effect on the date the application is received and is valid until 30 days after the loan is approved. RV must be 2007 model year or newer; for RV model year 2007 to 2008, add .25% to above rates. Maximum loan term is based on loan amount. Maximum loan amount is calculated using an advance percentage determined by FICO score. For RV, collateral value established using NADA wholesale value (without adds) including mileage adjustment (+/-); multiplied by 110%. Example of a recreational use RV loan: A \$55,000 loan for 7 years with an APR of 5.09% has 84 monthly payments of \$779.69 each.

†Processing fee of \$399 waived for refinance applications submitted by June 30, 2018. Official fees such as state title, state registration, FL doc stamp fee and/or UCC filing fees will apply.

Good Sam Finance Center™ provided through Essex Credit, a division of Bank of the West. Doing business in South Dakota as Bank of the West California. NMLS ID #19116. GOOD SAM and the GOOD SAM ICON are registered trademarks of Good Sam Enterprises, LLC. Unauthorized use of any of GSE, LLC's trademarks is expressly prohibited. All rights reserved. GRL54554 - 0318

Member FDIC.  EQUAL HOUSING LENDER ©2018 Good Sam Finance Center.

The Last LEAK You'll Ever Have... The Last ROOF You'll Ever Need!

**100%
MAINTENANCE FREE**



Before

10 YEARS to get this

- No Caulking Roof Vents, Seams or Skylights
 - No Streaking • No Leaks...EVER!
- Beautifully finished seamless roof*



After

3 DAYS to get this!

- ✓ 10 Year Material & Labor
- ✓ No Leak Guarantee
- ✓ Work performed at our location or yours

Financing Available

RV ROOFING SOLUTIONS

888-847-7010

www.rvroofingsolutions.com

Call for FREE Information Kit

**Booking appointments
May, June, July & Aug.
N. California, Oregon &
Washington**

**Franchises Available
www.RVRoofingFranchise.com**

RV Roofing Solutions, Circle 125 on Reader Service Card

TEST

DYNAMAX ISATA 4 SERIES



Flush-mounted compartment door hides exterior TV, which can be viewed from the patio. Speakers are mounted in the side wall.

are framed in aluminum; the roof is capped with one-piece fiberglass. Gelcoat fiberglass walls have Azdel composite backing and the windows are dark tinted and frameless, which add to the modern look of the exterior. The test chassis was fitted with optional automatic, four-point hydraulic leveling jacks, which is a great investment in convenience and one that most owners will find indispensable.

Ride quality is certainly a product of workmanship, and interior noise on the road was kept to a minimum. This, in big part, is due to the proprietary DynaRide suspension upgrade that employs airless rubber shear springs to smooth out the bumps normally associated with the Ford E-450 chassis and improves handling characteristics. Additionally, the company uses a beefy Hellwig rear sway bar that helps reduce body roll in turns, especially when dips in the road exacerbate the conditions. Driving the Isata was a pleasurable experience, also attributable to the lively performance of the V-10 engine, which was relatively fuel-efficient, turning in a respectable 10.80 mpg under careful driving on open highways.

While the Isata 4 Series has a lot to live up to, given the legacy of the company's larger luxury motorhomes, the long list of standard features and pinpointed option choices put this Class C into a desirable category targeted at those who are willing to pay for upscale amenities but prefer to travel in a more nimble motorhome. **M**

Dynamax

888-295-7859, www.dynamaxcorp.com

Specifications

Chassis

Model	Ford E-450
Engine	6.8-liter Triton V-10
SAE hp	305 @ 4,250 rpm
Torque	420 lb-ft @ 3,250 rpm
Transmission	6-speed automatic
Axle Ratio	4.56:1
Tires	LT215/85R16
Wheelbase	182"
Brakes	Disc
Suspension (F/R)	Coil/rubber shear with Hellwig sway bar
Fuel Capacity	55 gal
Fuel Economy	10.80 mpg
Warranty	3 years, 36,000 miles bumper-to-bumper; 5 years, 60,000 miles drivetrain

Coach

Exterior Length	27' 5"
Exterior Width	8' 5"
Exterior Height with A/C	11' 6"
Interior Width	7' 6"
Interior Height	7' 0"
Construction	Aluminum side wall, roof and floor framing; laminated side walls, fiberglass roof, block-foam insulation
Freshwater Capacity	51 gal
Black-water Capacity	42 gal
Gray-water Capacity	42 gal
Water-heater Capacity	Truma AquaGo instantaneous
LP-gas Capacity	20.3 gal
Air Conditioner (1)	15,000 Btu
Furnace	35,000 Btu
Refrigerator	7.0 cubic-foot
Converter	60 amp
Inverter	1,000 watts
Batteries (1) 12-volt chassis, (2) 12-volt AGM house	
AC Generator	4.0 kW
MSRP	\$123,354
MSRP as Tested	\$129,800
Warranty	2 years/24,000 miles

Wet Weight

(Water and water heater, fuel, LP-gas tanks full; no supplies or passengers)

Front Axle	3,880 lbs
Rear Axle	8,920 lbs
Total	12,800 lbs

Chassis Ratings

GAWR, F/R	5,000/9,600 lbs
GVWR/GCWR	14,500/22,000 lbs
ROCCC	1,700 lbs (deduct weight of passengers for net cargo capacity)

GAWR	Gross Axle Weight Rating
GVWR	Gross Vehicle Weight Rating
GCWR	Gross Combination Weight Rating
ROCCC	Realistic Occupant And Cargo Carrying Capacity (Full Water, No Passengers)



RESORT RV PARK

Our new Full Service RV PARK is open for you to enjoy seasonal outings in beautiful Southeastern Indiana. Located on the Ohio River in Rising Sun, Indiana we're just 45 minutes from Cincinnati and less than two hours from Indianapolis, Dayton or Louisville and just two hours from Columbus and Lexington.

Rising Star makes a great destination as part of a longer journey or a convenient getaway. Whether you're a seasoned RV enthusiast or just beginning your journey, you'll enjoy a quality experience - enhanced by the friendliest service and the most amenities of any RV park in the region.

Discover an impressive array of guest amenities:

- 56 spaces, each with full hookups including power, water and sewer
- Private bathrooms with showers
- Washers & dryers
- Bocce ball court
- Shuffleboard
- Playground
- Dog park
- Picnic tables & grill area
- Cable TV
- Wi-Fi
- Indoor pool access
- The Rising Star golf course
- Two adjoining hotels
- Access to town docks and boat ramps
- Grocery and convenience stores within walking distance
- Casino with 939 slots and 25 table games
- Variety of restaurants including buffet and steak house
- Weekend entertainment
- Three blocks from the charming downtown historic district
- Good Sam member with high ratings



Visit www.RisingStarCasino.com for details. For Reservations, Call 800.472.6311.

For help with a gambling problem, call 800.994.8448.

Flush with

Today's holding tank

With every passing year, it seems the RV experience becomes more like residential living. Manufacturers are constantly striving to incorporate features that mimic the home, including high-end furnishings, stainless-steel appliances and upscale fixtures. But the one place that still detracts from the pleasures of life on the road is the black-water tank. At home, we simply flush the toilet and the deal is done — but in an RV, constant care and maintenance is required to keep everything working correctly and smelling fresh. Thankfully, the RV aftermarket understands that sewage isn't anyone's favorite subject, and is always inventing new products designed to make holding-tank maintenance as painless (and odorless) as possible. Today, there are literally dozens of products available, which can make choosing the right one for your needs somewhat of a challenge. Just remember

that, regardless of the many products on the market, they can still be broken down into two categories: The natural variety that uses friendly bacteria to break down and digest waste and tissue, and the chemical variety that may contain formaldehyde, dyes and perfumes to break down waste and control odor. From there, it's simply a matter of the delivery method: liquid, powder or premeasured drop-in (aka toss-in). There are even products designed to clean and deodorize the gray-water tank as well.

Because everyone has their own preferences, and most RV centers carry a comparatively limited product line (they can't stock everything, after all) we're presenting this guide to the most current holding tank products. Even here we can't cover every product each company makes, but a visit to any of these websites will guide you to a multitude of choices. Happy flushing!

Advance Research Chemicals Products Inc.

Oxy-Kem ▶

Looking for a sewer solution that's safe, environmentally friendly and offers deodorization properties for black- and gray-water tanks? Oxy-Kem claims its Holding Tank Treatment is scientifically proven to clean and deodorize tanks, sinks, drains and sensors up to five times better than chemical, enzyme and formaldehyde products. Available in a package with 12 drop-in Paks, Oxy-Kem is easy to use — you only need to drop one Pak down the toilet along with a gallon of water after dumping the black tank (additional Paks may be needed during periods of heavy usage). For gray tanks, tear open one Pak and pour half down



a sink and the other half down the shower drain, along with a quart of water (after dumping). Each drop-in Pak is designed to treat up to 60 gallons of water.

Advance Research Chemicals Products Inc. | 855-552-6789, <http://productsarc.com/products/oxy-kem-products>

Camco

RhinoFLEX

Camco's RhinoFLEX is said to knock the beast right out of your motorhome's holding tank with a Bacteria/Enzyme formula that digests waste and breaks down tissue for easy biodegradation. Featuring a fresh pine scent, RhinoFLEX harnesses the natural process by which nature digests waste, and only activates in its presence. The advanced formula also contains a buffering agent to prevent acid formation and septic odors. In addition, RhinoFLEX offers a long shelf life, is not temperature sensitive and is biodegradable. It's economical, too, as just 2 ounces treats 40 gallons. Available in drop-in and liquid forms, from 8 to 64 ounces.

Confidence

products can make foul odors a thing of the past



TST ▲

TST stands for “Toilet Stays Tidy.” OK, we made that up. The truth is, Camco’s TST RV toilet treatment products are said to break down waste and tissue and stop odors for up to seven days — and they don’t contain any formaldehyde. They’re 100 percent biodegradable and come in both original and Blue Enzyme versions in liquid and drop-ins. Plus, TST is also available in new Hibiscus Breeze, Lavender and Lemon scents. TST Grey Water Odor Control, meanwhile, removes grease buildup in the gray-water tank as well as sink and shower drain lines, leaving a fresh lemon scent. Other product(s): TST Drain Valve Lube with Coco Oil (16 ounces).

Camco Manufacturing Inc. | 800-334-2004, www.camco.net

Century Chemical

Travel Jon ▶

Established in 1926, Century Chemical will actually be a century old in a few years — and has been manufacturing RV and marine holding-tank products for more than half that time. In addition, the company makes products for aviation, charter bus,



portable and residential septic use, so you could say these people know their way around a toilet — or at least what goes in one. Century Chemical’s Travel Jon Holding Tank Deodorizer/Cleaner has that deep-blue color we all know so well; it’s biodegradable and contains no formaldehyde. Travel Jon helps break down waste and tissue, and the highly concentrated formula (only 2 ounces per charge) contains detergent to help keep the holding tank clean. Other products: Travel Jon Blue Max toss-in packets, Travel Jon Waste Digester. Century Chemical Corp. | 800-348-3505, www.centurychemical.com

Dometic

3 ‘N 1 Bowl Cleaner & Tank Treatment

Dometic manufactures nearly everything for the RV lifestyle, and a few years ago thought, why not get into wastewater? Wait ... that didn’t sound right. No, the company thought, why not offer our own line of holding-tank products? So it did. One of its more innovative solutions is its 3 ‘N 1 Bowl Cleaner & Tank Treatment which, as the name would imply, actually serves three purposes. Drop one of the handy 1.5-ounce packets into the toilet bowl and it quickly dissolves, releasing effervescent cleaning action and a fresh lavender scent. We know — that’s only two things. But then, you use a brush to clean the bowl, flush and the contents treat up to a 40-gallon holding tank.



Premium Holding Tank Treatment ▲

When you want high-performance gasoline, do you get regular? No way ... you go straight for premium, right? With that in mind (sort of), Dometic offers its Premium Holding Tank Treatment, the company’s strongest chemical for reducing odors in an RV waste tank. Available in a variety of liquid and drop-in versions, Premium Holding Tank Treatment is formaldehyde-free and is said to work in the harshest (read: hottest) conditions for five to seven days. The product’s additives also break down waste and help tanks rinse cleaner during the draining process. Other products: Clean ‘N Green Holding Tank Treatment and Gray Water Tank Treatment.

Dometic Corp. | 800-544 4881, www.dometic.com

Eco-Save

Eco-Save Dry ▶

In nature, bacteria break down and digest waste without perfumes, dyes or detergents.



Noticing this, Eco-Save products created Eco-Save Dry, a bacteria/enzyme-based product that works in black- and gray-water holding tanks — and like Mother Nature, uses no perfume or surfactants. In fact, the company claims that the product actually enhances the digestion of waste in septic systems, so you may actually be helping the environment every time you dump the tanks. It's important to note that the environmentally safe, non-staining product does not actually clean the holding tanks, but it does reduce solids, controls odor and lubricates valves. It's inexpensive, too, as an 8-ounce jar treats 30-35 tanks of waste. Other products: Eco-Save Concentrate, Eco-Save Fragrance Enhanced, Eco-Save Original Formula (liquid).

Eco-Save | 800-950-9666, www.eco-save.com

Star brite

Instant Fresh Toilet Treatment ▶

If you can clean it, wash it, wax it, protect it or deodorize it, Star brite has it. The company opened its doors in 1973 with just one product: Star brite Auto Polish. From there, it did what any sensible company would do, and expanded its product line to include marine, aircraft, motorcycle, RV and other markets. Its aptly named Instant Fresh Toilet Treatment comes in Lemon Grove and Pine Forest scents, and was formulated to quickly break down waste, remove odors and lubricate valves. Formaldehyde-free, non-staining and biodegradable, a 32-ounce bottle of Instant Fresh treats 320 gallons. Other product(s): Star brite toilet bowl cleaner.

Star brite Inc. | 800-327-8583, www.starbrite.com



Thetford. Likely standard equipment in your first new RV, Aqua-Kem liquefies waste and breaks down tissue fast to prevent clogs, while powerful detergents clean tank walls and drain lines. Aqua-Kem works around the clock in all weather conditions, and is now available in new Garden Mist scented toss-ins. Formaldehyde is one of Aqua-Kem's ingredients, but the company maintains it is biodegradable and environmentally safe when disposed of properly. Available in liquid, powder and toss-in forms in a variety of sizes.

Eco-Smart, Eco-Smart Free & Clear

Effective and safe for the environment? That's smart. Eco-Smart, actually. Original Thetford Eco-Smart is a non-staining, green, formaldehyde-free formula that quickly breaks down and liquefies waste and toilet tissue — and provides odor control — while a detergent additive helps keep tanks clean. Eco-Smart Enzyme Formula is an orange, non-staining holding-tank additive with a natural enzymatic deodorizer. Eco-Smart Free & Clear, meanwhile, offers the same benefits as the above but is fragrance-, dye- and formaldehyde-free, and is 100 percent biodegradable. Eco-Smart products are available in liquid or toss-in form. Other products: Aqua-Kem DRI, Aqua-Kem Shotz, Aqua Foam, Campa-Chem Natural, Campa-Chem Original, Campa-Chem Shotz, Drain Valve Lubricant, Fresh Water Tank Sanitizer, Grey Water Odor Control, Level Gauge Cleaner, Tissue Digester, and Toilet Seal Lubricant and Conditioner.

Thetford Corp. | 800-543 1219, www.thetford.com



Thetford

Aqua-Kem ▶

It sounds like a superhero from a parallel universe, but Thetford's Aqua-Kem is actually the No. 1 selling holding-tank deodorant of all time, according to



Valterra Products

Odorlos ▶

When bacteria don't get what they want, they punish us by producing foul odors. But, when Odorlos is added to the holding tank, it provides these nasty little critters with a continuous supply of nitrates, the best alternative energy source to pure oxygen. So they're happy, and you're happy. Scent-free, formaldehyde-free and 100 percent biodegradable, all it takes is 1 ounce for every 10 gallons to prevent odors and to break down waste and tissue. The product is available in a variety of liquid forms, dry packets, a 6-pound tub of dry product and quick-dissolving drop-ins.

Coach House® Meet the Family

Luxury downsized motorhomes,
direct from our family to yours.

PLATINUM

Ford
Class B+

PLATINUM II

Mercedes
Class B+

Arriva

Mercedes
Class B



Since 1985, the Gerzeny family has been setting the pace in the downsized motorhome market, manufacturing luxury Coach House recreational vehicles at their family-run factory in Venice, Fla.

Fuel-efficient Coach House RVs, ranging from 23 feet to 27 feet, are available on either the Ford E-450 or Mercedes Sprinter chassis in a wide array of floor plans to fit your lifestyle.

At Coach House, our mission is simple: to build the best RVs in the industry. At the root of our quality is a patented one-piece shell, unique in the RV industry, that is less likely to leak, squeak or rattle over time.

Beyond the unique one-piece shell, here are some of the other factors that

make the downsized Platinum and Platinum II your best motorhome value:

- More standard features than any other motorhome in their class.
- Decorator interiors with solid-surface countertops, hand-crafted cabinets, brand-name appliances, LED lighting throughout, HDTV, and more.
- Choice of chassis: Ford E-450 (gas) or Mercedes Sprinter (diesel).
- Warranty service available nationwide for your peace of mind.
- High ratings for ride and safety.
- Coming soon — the new Platinum III, built on a diesel Ford Transit chassis.



What makes the Coach House Platinum unique? It starts with our patented one-piece hand-laid molded fiberglass body, specifically designed for either the Mercedes or Ford chassis. The shell is reinforced with carbon fiber and the interior is lined with insulation (R-18). The result? "The quietest motorhome I've ever driven," according to FMCA's The RV Doctor.



BUY FACTORY-DIRECT AND SAVE!

Coach House motorhomes are sold direct from the factory — there is no middleman. The "Coach House Buying Experience" includes: personal attention from courteous employees; a generous trade-in allowance for your current RV; on-the-spot financing (for qualified buyers); and instruction in how to operate your new RV.



VISIT THE COACH HOUSE PLANT

See for yourself what makes a Coach House motorhome so special. Visit our factory at I-75 exit 195 near Venice, Fla., where a knowledgeable salesperson can show you the latest Coach House models on display in our showroom. The showroom is open from 9 a.m. to 5 p.m. Monday-Friday or by appointment.



COACH HOUSE, INC. · 3480 TECHNOLOGY DRIVE · NOKOMIS, FL 34275 (941) 485-0984

TOLL-FREE AT 1-800-235-0984 · ONLINE AT CoachHouseRV.com



Pure Power Blue/Green ▲

Why be satisfied with some power when you can have Pure Power? Pure Power Blue and wintergreen scented Pure Power Green are chemical-free, bacterial-enzyme holding-tank treatments that perform in all temperature conditions. Powerful BioBlastPlus technology provides odor control in extreme temperature conditions and will keep holding tanks clean and fresh smelling. Pure Power liquefies all waste and toilet paper, and just 2 ounces treats 40-gallon black- or gray-water tanks. Also available in Bio-Pouch Toss-Ins. Other products: Pure Power Toilet Bowl Cleaner, Sensor Power Sensor Cleaner. Valterra Products | 818-898-1671, www.valterra.com

Walex Products Co.

Bio-Pak, Porta-Pak ▼

Walex may not be a household name, but the company specializes in waste management and odor control for portable sanitation, residential septic tanks, environmental applications (landfills/waste treatment facilities) and, of course, RVs. Its popular Bio-Pak product uses a natural enzyme formula that starts working immediately to control odor, break down solids and liquefy toilet paper. Packaged in a resealable slide zipper bag



BUY **30,000 New & Used Motorhomes**
For Sale By Owners & Dealers



Orlando-Winter Garden, FL - 2018 Newmar Ventana 3715 - \$322,907



Millions of RV Buyers!

Place a Free or Until Sold Ad

SELL

containing 10 drop-ins, the formaldehyde-free formula is available in Alpine Fresh and Tropical Breeze scents. Porta-Pak, meanwhile, offers similar benefits and is now available in two fragrances: Fresh Scent and Lavender Breeze. Other products: Bio-Active Holding Tank Treatment, Commando Black Holding Tank Cleaner.

Elemonate ▶

Most of us associate bad odors with the black tank, but a neglected gray-water system can create a funk all its own. Not to worry — Elemonate Grey Water Deodorizer contains the same odor control formula found in the company's Porta-Pak Holding Tank Deodorizer, plus special enzymes designed to deodorize and dissolve grease, and to break up fat and food particles in gray tanks, garbage disposals, dishwashers, sinks and shower drain

lines. Just drop the tablet into the sink or shower, turn on the water and watch it dissolve with a lemony-fresh scent. Packaged in individual portion-control bags of five inside a resealable slide-zipper bag.

Walex Products Co. | 800-338-3155, www.walex.com



Worldwide Monochem

T-5

When it comes to handling foul odors, experience definitely counts — and Worldwide Monochem's name has been synonymous with holding-tank products for the RV, motor coach, aviation and marine industries for more than 55 years. So even if you haven't used it in your motorhome, you have likely been thankful for its presence in recirculating and portable toilets. The premeasured, 2.25-ounce, moisture-resistant foil packets are simple to use — just pour the contents of one packet into the toilet, and T-5 will immediately begin combating odor-causing bacteria. Other products: Dyna-Bact toss-ins, L-10 liquid toilet chemical, L-10 NF liquid toilet chemical, T-5 NF (non-formaldehyde), T-5 Squeeze & Pour liquid.

Worldwide Monochem | 512-267-5190, www.satellite-environmental.com



2017 RECIPIENT OF THE RVDA QUALITY CIRCLE AWARD, FOR THE 8TH CONSECUTIVE YEAR.

Pleasure-Way
Industries



Superior Quality, Excellent Customer Service.

WWW.PLEASUREWAY.COM | (800) 364.0189 | SASKATOON, CANADA



Pleasure Way, Circle 119 on Reader Service Card

WINNEBAGO ATTRACTING RV NEWCOMERS

Winnebago is always rethinking its lineup to draw new people to RVing. In this history segment, we revisit groundbreaking classics of the '90s — and one creating buzz today.

► THE FOURTH DECADE: 1988 - 1997

By Winnebago's 30th anniversary in 1988, the Flying W was one of America's most recognizable brands, thanks to best-sellers like the Winnebago Chieftain and Itasca Sunflyer series.

After the lean '80s, the '90s looked brighter. The Berlin wall had fallen, Nelson Mandela was released, and the public World Wide Web had burst on the scene. Suddenly a new optimism rippled through the economy.

Winnebago's lineup was ready. The Winnebago Warrior and Itasca Spirit Micro Mini, built on Toyota chassis, came to define affordable, fuel-efficient micro-mini motorhomes, racking up 60 percent of sales in the category. After a dizzying pace of invention, in 1992 Winnebago paused to celebrate two feats: the production of its 250,000th unit; and achieving

90 percent of its sales on models less than two years old.

No resting on laurels, though. In 1993, out came the Vectra, a bus-size motorhome comfortably furnished for extended time on the road; and in 1994, the new



The interior of a 1994 Chieftain.

wide-body Winnebago Minnie Winnie and Itasca Sundancer lines, offering a broad choice of floorplans.

Then, in 1995, Winnebago rolled out two models that are still cult classics: the 21-foot Rialta, a maneuverable, front-wheel drive Class B on a Volkswagen chassis; and the Luxor, an elegant

Itasca
Sunflyer



TODAY'S ADVENTURE VAN: THE REVEL



THE AWARD-WINNING REVEL IS ATTRACTING OUTDOOR ENTHUSIASTS TO RVing, JUST LIKE THE RIALTA DID IN 1995.

Built on a 4x4 Mercedes-Benz Sprinter chassis, this addition to Winnebago's "sweet fleet" of Class B's is built specifically for off-road trips.

The Revel's 3-liter turbo-diesel puts 325 lbs. of torque through an on-demand 4WD system, and has a versatile floorplan featuring:

- Power-lift bed that elevates out of the way to create a 140 cu. ft. "gear garage"

- Power awning and roof rack for watercrafts and bikes
- All-in-one wet bath with cassette toilet removable for added storage
- Full galley with hot-water, sink induction cooktop, and compressor refrigerator
- 200-watt solar power system and available AC
- Aluminum cabinets with locking

latches for rough rides

- LED lights, multiple USB outlets and mobile device mounts

"Whether your passion is off-roading, fishing, or another outdoor activity," says Russ Garfin, Director of Product Management for Winnebago, "the Revel allows you to get to your location faster, stay 'off-the-grid' longer, and enjoy your time doing what you love."

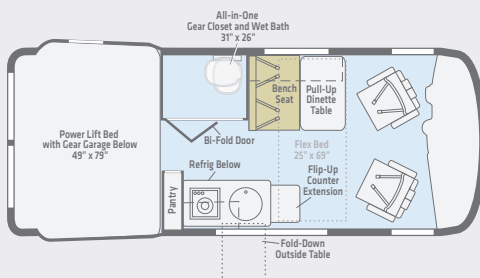

2018 REVEL

EXTERIOR LENGTH:	19'5"
EXTERIOR WIDTH:	7'1"
EXTERIOR HEIGHT:	9'10"
INTERIOR HEIGHT:	6'3"
GVWR:	8,550 LBS.
SEATING CAPACITY:	4
MSRP STARTING AT:	\$134,799

top-of-the-line diesel pusher. These polar opposites expanded both ends of a growing RV fan base — something Winnebago would repeat in 2018 with two new award-winners: the Class A diesel Horizon and the new Class B Revel.

In 1996, Winnebago mourned the death of its founder and Chairman of the Board, John K. Hanson. He'd helped to shape a national pastime — and his legacy of innovation lives on at Winnebago today.

➔ **COMING UP IN JULY:** Roots of the Vista — an affordable Class A that's still going strong.



The Revel's lift bed and gear garage



Peter and Kathy Holcombe, who kayak North American rivers with daughter Abby, spent several weeks in the Revel. "In a small space, everything needs to serve more than one purpose," says Peter. "In the gear garage, you can fit bikes and smaller kayaks, then flip a switch and it transforms into a bedroom — kind of like a treehouse!" Kathy adds, "It's Peter's dream vehicle."

Home of the Happy Camper[®]

NOW WITH FOUR FLORIDA LOCATIONS!



Photos show just some of the brands we carry. Not all brands are available at all locations. Please call!



NOKOMIS
 2110 N. Tamiami Trail
 Nokomis, FL 34275
 (941) 966-2182
 Toll Free 1-800-262-2182

LAKELAND
 940 Lakeland Park Ctr. Dr.
 Lakeland, FL 33809
 (863) 853-9177
 Toll-free 1-877-663-7506

BRADENTON
 6120 S.R. 64 East
 Bradenton FL 34208
 (Just west of I-75)
 (941) 748-8889

FORT MYERS
 5600 Enterprise Parkway
 Fort Myers FL 33905
 (Near I-75 Exit 139)
 (239) 275-4200

www.rvworldinc.com

Turn your RV into \$\$\$.



Consign it. Sell it. Trade it. CALL ANY LOCATION AND ASK FOR THE CONSIGNMENT DEPT.

A WHALE OF A MOTORHOME

THE CHEVROLET CORVAIR ULTRA VAN EVOKES IMAGERY ASSOCIATED WITH THE MASSIVE AQUATIC MAMMALS, AND OWNERS OF THE RARE COACHES ARE HAPPY CAMPERS

This article is one in our continuing series looking at motorhomes that have stood the test of time and can still make dreams come true. Each has earned the right to be called "the classic ride."

The year 1960 ushered in an era of change in the United States. Upheaval was in the air, from John F. Kennedy's election to the dance explosion of Chubby Checker's "The Twist"—not to mention the naming of the air-cooled Corvair as Motor Trend's Car of the Year. It was this last development that captured the attention of aircraft designer Dave Petersen, who had been dreaming of building a new kind of motorhome. He envisioned a motorhome that would be light and nimble, and highly maneuverable, while providing its inhabitants a wide, unobstructed view. Chevrolet's new groundbreaking rear-mounted power package was exactly what Petersen needed to complete his vision. Four months later, his prototype Ultra Van (then called the Go Home) was born.

For its time, the Ultra Van was remarkable. The Class A

industry was still in its infancy, and most motorhomes were versions of a truck chassis with a "trailer" bolted to the top. The Ultra Van was different. Built like an aircraft, it had no frame or chassis. The rounded front and rear were constructed of a composite material, while the center section was a series of C-shaped ribs to which the aluminum skin was riveted. Cast-aluminum A-frames were mounted in the front wheel wells, doubling as a platform for wide bench-type seats. The engine was tucked under the large back bed, creating open space for a wet bath and a full galley. A unique under-floor design integrated the aluminum tanks into the structure, adding to its strength without substantially increasing weight. The result was a surprisingly roomy 22-foot-long, 8-foot-wide motorhome with more than 6 feet of headroom that could be powered by a minimal 80 hp. All of which would certainly qualify



The Hansens' 1969 Corvair Ultra Van looks right at home in front of this vintage motel sign in Amboy, California.

The Classic Ride



A true blast from the past — a five-motorhome Ultra Van convoy (including Mini Mo and Whale) turned plenty of heads in the middle of the Arizona desert.

the Ultra Van as a classic ride — even if it didn't look suspiciously like a cartoon whale.

It's a distinction that modern-day owners embrace, referring to their motorhomes lovingly as "whales on wheels" and some even naming them after the marine mammal. It seems that to see an Ultra Van is to love one — at least for all the owners we have met. Carl Jones still remembers the first time he came across one on eBay.

"I said, 'Fran, you've got to take a look at this,'" he remembers.

She came over and looked closely at the screen. After a minute she said, "You know, it's so ugly that it's cute."

It was all the license he needed. Now they are the proud owners of Righteous Coach, a 1968 Ultra Van and the couple's first motorhome. That was seven years ago, and it took three years of what Carl refers to as "rehab" to bring the motorhome back to life.

"It has been rebuilt, re-floored, reupholstered and repainted," he says with a laugh.

It was a renovation made possible by the Corvair's popularity with collectors. Carl notes that, despite its age, several companies still manufacture or supply rebuilt parts for the



Clockwise, from top left: The original retro dash and between seats table on the Mellos' Mini Mo. The Ultra Van's galley as seen in the Jones' Righteous Coach. Chuck and Cyndie Hansen pose with their award-winning Corvair vehicles, including their motorhome, Whale. Lifting Whale's nifty rear door reveals a convenient place to store larger, bulky items.

engine and Powerglide transmission used in the Ultra Van. For Carl, the trick in taking on such a restoration was having the ability to do the work himself — a sentiment echoed by every owner I interviewed.

"When you buy an Ultra Van, you need to understand you'll be in for a lot of work," agrees Chuck Hansen, who purchased his 1969 motorhome, Whale, with wife Cyndie in 2007. "You

have to be adventurous ... and it helps to have a credit card."

In their case, the two were already self-proclaimed "Corvair nuts," but did not know much about RVs. When they picked theirs up, Chuck began by taking it apart until he found something that worked.

"I took it all apart," he says, only half-joking.

Updates included disc brakes, air

THAT SHE BLOWS!

Only 330 Corvair-powered Ultra Vans were produced before production ended in 1969. A dozen or more are currently available on the used market, ranging in price from \$500 for a true project to \$22,000 for a turnkey motorhome. To learn more, check out the Ultra Van Motor Coach Club (UVMCC) website www.corvair.org/chapters/UltraVan.

▶ Turkel, restored by Chris Brown and Molly Bacon to its better-than-original condition.



Photos: Jerry Mello, Carl Jones, Chuck Hansen

Photo: Molly Bacon

suspension and a 3-liter fuel-injected engine, rebuilt by a Corvair expert, that has twice the power of the stock counterpart. Cyndie, with the help of the couple's daughter, did the interior reupholstering, and Chuck replaced the flooring and the air conditioner. The original cabinets, stove and generator remain. The Hansens also added a few whimsical touches, like a colorful whale clock, to enhance their themed décor. Along with Cyndie's 1964 red Corvair, Whale frequently garners attention — and accolades — at Corvair shows.

The Hansens aren't alone. Molly Bacon and Chris Brown even got an award for Turkel, their 1968 Ultra Van, at a Volkswagen show. Invited because of Turkel's air-cooled engine, they were competing against 125 VW campers and modified Bugs, and didn't expect to be recognized. Instead, "we got the Host Club Choice Award," Molly says proudly.

It is no wonder. Turkel is a little like a time machine — one step inside and you are transported back to the early 1970s. A previous owner decorated the motorhome with a vintage gold color scheme and shag carpet, to which the couple added period-correct touches like an original lava lamp, a green glass 7-Up bottle, 1960s-era throw pillows and a 1970s camping cookbook. Everything is a blast from the past, right down to the melamine tableware.

Despite its vintage appearance, Turkel is definitely travel-worthy. Purchased in 2014 for less than \$5,000, it had a fresh rebuild on the air-cooled, 95-hp Corvair engine, and the generator and air conditioner have been replaced. For the latter, the couple chose a high-efficiency Coleman unit with a heat pump that could be powered by a lightweight 2.6-kW Kohler. Their power needs are minimal, as they chose to forego a microwave or a TV.

"Simple is better," Chris says, and Molly agrees. "We want to get away, leave some of the world behind."

Getting away is also at the top of the list for Ultra Van owners Jerry and Patty Mello. They bought Mini Mo, their

1968 motorhome, in 2009.

"I've had Corvairs since 1975, so I knew about the motorhomes, but I didn't really want one," says Jerry, who was instead looking for a vintage Corvair Rampside to restore.

The purchase of an Ultra Van was his wife's idea. She pointed out that a motorhome would be more comfortable and functional for travel, and they started their search, eventually purchasing one that was the victim of an aborted renovation. It had been sitting in storage for years, its interior totally gutted — headliner down, panels off, insulation removed — and its exterior in dire need of repair.

Jerry began by replacing all the wiring, adding a second alternator and separating electrical systems for automotive, RV and AC loads. He also added a dual-fuel generator, air conditioner with heat pump, power rack-and-pinion steering, and upgraded the brakes and the suspension. Then he tackled the exterior with the help of his brother, a former aviation metalsmith and body shop owner. They replaced "about half" of the aluminum skin, repaired the compound curves and repainted Mini Mo — a job Jerry estimates at about 500 work-hours.

"I've had every threaded fastener off this motorhome at least once," he says.

The result is more than just a "modern but retro" look — it is a fully functioning motorhome. Last year alone, Patty and Jerry spent 102 nights in Mini Mo on the road, traveling and attending rallies and shows. Because fewer than 80 of these motorhomes are still on the road, owners are on a first-name basis, and most are active in the Ultra Van Motor Coach Club, over which Jerry Mello presides, and Carl Jones calls "Ultra Vans and the crazy people who own them."

It might be true that you have to be just a little crazy to take on a 50-year-old motorhome, but it only takes one look at the Ultra Van to understand why these couples made that choice. With its Corvair heritage and its unique body, the "whale on wheels" is the ultimate classic ride. **M**

"It works!"

We looked at a lot of options to fix the leak in our RV roof and couldn't be happier with choosing RVroof.com! They were friendly, knowledgeable, and the product works as guaranteed.

- Happy RV Roof Customers

Need a New RV Roof?
RV FlexArmor® is the solution!

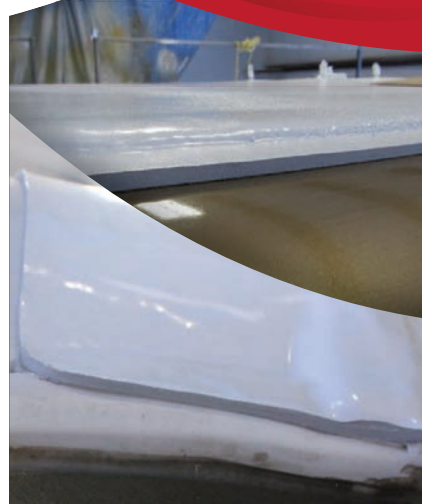

- No Caulking!
- $\frac{3}{16}$ " Thick!
- Puncture Proof!

RV Roof.com, INC.

3236 Hwy 17 | Green Cove Springs, FL 32043
904.814.2104



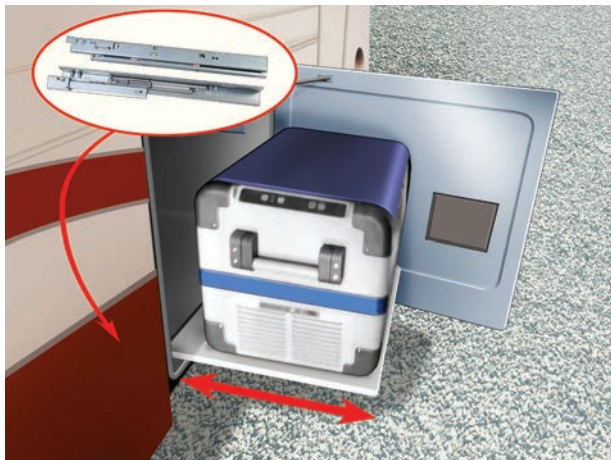

Cooler Tray

I wanted a slide-out tray for the Dometic cooler in my motorhome's basement storage, but could not find one that fit the 22-inch-deep by 32-inch-wide compartment. The closest thing I found was 24 inches deep, and it cost \$400. So, I found heavy-duty undermount drawer slides rated at 120 pounds from Knappe & Vogt, in the appropriate size for around \$50 on Amazon (part No. KV MuV+HD 22). I attached a tray I had on hand to the slides, and they work great! Plus, I got the whole assembly for a fraction of the cost.

Mike Walsh | Salem, Oregon



No Shake, Rattle or Roll

We like to use glassware in our motorhome. After trying a few ideas to keep the glasses in the cabinets while on the road, I came up with this solution. I didn't have any luck finding 2-inch-wide foam to line the floor of the cabinet, so I decided to use two 1-inch pieces of foam and glued them together. After the foam was completely dry, I measured the shelf where I wanted the glasses to rest, and cut a piece of foam exactly to fit. I didn't want the foam to slide around. Once I had the size I wanted, I traced the top rims of the glasses, about an inch apart or so, and cut slits in the foam to keep the glasses in place. I found the best tool to cut the foam is a very sharp carpenter's knife. Once I glued the foam to the shelf, the glasses always stay in place.

Bev Milligan | Hooper, Nebraska

Loop the Loop

Our motorhome doesn't have any towel bars in the bathroom. Instead, the manufacturer included hooks, which don't do a very good job of holding the towels in place. To help keep the towels off the floor, I sewed a loop of elastic onto the edge of each towel. The loops make it easy to hang the towels onto the hooks, and the towels have yet to fall off since I devised this solution.

Judy Richter | Elkhart, Indiana

Command Control

With the proliferation of electronic devices to charge — including phones, tablets and computers — our charging cords were running amok in the motorhome. I tamed them with Command hooks placed inside cabinet doors. I loop the cables, then hang them on the hooks. It is easy to pull the cables out when needed, and also to neatly hang them back up when done.

My next issue was to conquer the ball caps we collect on our travels. I mounted the largest Command hooks I could find in another shallow cabinet, being sure to place them high enough to allow for the size of the cap hanging down. I simply hang the caps from the bottom, and they hang neatly and don't fall out when I open the door.

Nanci Dixon | Sioux Falls, South Dakota



Have an Idea?

Quick Tips is looking for submissions. Please send your DIY ideas to: *MotorHome* Quick Tips, 2750 Park View Ct., Ste. 240, Oxnard, CA 93036, or email letters@motorhomemagazine.com. Be sure to include any photos, illustrations or drawings. If your tip is selected for publication, you will receive \$35. All payments require an FEIN or SSN.

GET OUT & GO!

SAVINGS EVENT

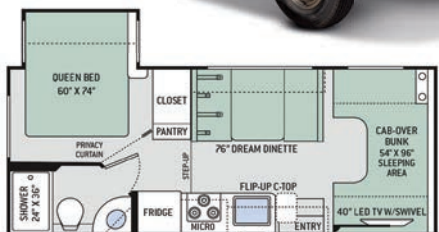

**NEW 2018 THOR MOTOR COACH
FREEDOM ELITE 22FE
NOW ONLY**
\$358 PER MO. OR \$58,999*

CALDWELL, ID | MSRP \$84,000 | SAVE \$25,001
 Stk. #1478497 - Payment based on 10% down @ 5.25% APR for 240 mos.

SAVE OVER 30% ON THIS MOTORHOME!**

CAMPING WORLD®

Official RV Dealer of Major League Baseball 

866-9-RV-CENTER | RV.com/MotorHome

*Government fees, state taxes, dealer fees and emissions testing charges as applicable will be added to comply with state vehicle codes. Freight and prep costs vary by state (Not applicable in CA, OH, TX, TN, GA, LA, WA, OR or UT). **Savings based on MSRP (STK#1478497). Inventory and floorplans vary by location, not all advertised manufacturers available at participating dealers. New units will be delivered from the nearest authorized dealer. Contact your area dealer for availability. VIN numbers posted at dealership. ^All payments to qualified buyers with approved credit. Subject to lender terms. Offer is not retroactive on previous RV purchases. Benefits are subject to certain limitations and restrictions, and are subject to change. Discounts and benefits offered through your Good Sam Elite membership for 3 years from date of RV purchase. See dealer for full program details. Advertised inventory available at time of production. New unit photography for illustration purposes only. May not be combined with any other offer and not applicable to prior sales. Offers valid at any Camping World RV Sales or FreedomRoads dealer only. See dealer for details. © 2018 FreedomRoads, LLC. CAMPING WORLD is a registered trademark of CWI, Inc. and used with permission. Unauthorized use of any of CWI, Inc.'s trademarks is expressly prohibited. All rights reserved. Offers expire 6/6/18. FR09046-0218

CAMPING WORLD

Come in for

SIZZLIN'

LOWEST PRICE OF THE SEASON!

STARTING AT CLUB SALE
\$47⁹⁷ Reg. \$59.99



25' 30-amp cord

Buckle strap and handle included

Power Grip Electrical Cords & Adapters
Built-in sure-grip handles for safer electrical connections and easier removal.

Power Grip Heavy-duty 25 ft. 30-Amp Extension Cord #27989
Club SALE \$47.97 Reg. \$59.99 | 🚚

Power Grip Heavy-duty 30 ft. 50-Amp Extension Cord (not shown) #37814
Club SALE \$134.97 Reg. \$169.99 | 🚚



BEST SELLER!

Club Members
SAVE 30%
\$21⁹⁷

Heavy-duty RV Wash & Wax, Gallon #19909
Formulated for fiberglass, metals, poly finishes, rubber and wood. | Reg. \$31.99

32 oz. (not shown) #19944
Club SALE \$6.97 Reg. \$10.49

**MEMBERS-ONLY SPECIAL!
ONE TIME BUY!**

Adjustable padded headrest



63 3/4" L reclined

21" W seat

Mesh cup holder

Club Members
SAVE 50%
\$49⁹⁷

Blue Jean Recliner #110112
• Features quick dry, fade resistant Oxford fabric
• Full length double bungee for extra support
• Adjustable trigger holds desired position from upright to fully reclined
Reg. \$99.99 | ♥

WHILE SUPPLIES LAST!

300 lb. capacity

Make a Cozy Fire without Smoke or Sparks!

Club Members
SAVE \$25
\$99⁹⁷

Flame Genie #87333
Portable steel fire pit burns wood pellets that produce virtually no smoke or sparks. Burns 8 lbs. of pellets per hour. Storage bag included. Pellets sold separately.
Reg. \$124.99 | 🚚

Wood Pellets, 20 lb. Bag (not shown) #87334
Club SALE \$4.99 Reg. \$5.49



65,000 BTU per hour

Convenient lift top for easy access



NEW!



Club Members
SAVE \$50
\$199⁹⁷

Large Ice Maker #108162
Produces up to 45 lbs. of ice every 24 hours. Electronic controls with indicator lights. Removable ice bin. Ice scoop included. 13 1/2" H x 13 3/4" W x 15 1/4" D.
Reg. \$249.99 | 🚚 | ♥

Club Members
SAVE 25%
\$10⁹⁷

Thetford All-Season Aqua-Kem® Toss-Ins, 12-Pack
Morning Sky #76052
Powder Fresh #27121
Garden Mist #87726
Reg. \$14.99



©2018 CWI Inc. The CAMPING WORLD logo is a registered trademark of CWI, Inc. All other trademarks are the property of their respective owners. Unauthorized use of any of CWI, Inc.'s trademarks are expressly prohibited. All rights reserved.

SuperCenters Nationwide | 1.888.857.6625 | CampingWorld.com/Shop

🚚 Flat shipping fee applies

CW010452_MH

SAVINGS!

PRICES
GOOD THROUGH
6/10/18



Club Members
SAVE \$45
\$199⁹⁷

Coleman NXT Grill #68326
Features porcelain coated
cast iron cooking surfaces,
InstaStart (matchless
lighting system) ignition, 2
independently adjustable
burners and 3 year limited
warranty. | Reg. \$244.99

20,000
BTUs

321 sq. in.
cooking
surface



Stands on end or
lies flat for storage



FOLDS TO ONLY 5"D!

Steel frame

Four folding
side tables with
utensil hooks

CLUB SALE
\$71²⁴

Slim Fold Cook Station #81922
Heat-resistant cook surface. Stands 52 1/4" L x 18" W x 32 1/2" H.
Reg. \$74.99 | 

LOWEST PRICE OF THE YEAR!

Club Members
SAVE \$30
\$149⁷⁵

Roadtrip® XCursion™
Grill #75018
PerfectFlow technology
provides consistent
performance. Folding scissor
legs and aluminum frame
ensure easy set-up and
transport. | Reg. \$179.99

20,000
BTUs

285 sq. in.
cooking
surface



Folds compactly
for transport

**DON'T
MISS OUT!**

2 DAYS ONLY
MAY 18-19
SUPERCENTERS NATIONWIDE

Grillfest
EVENT

SPONSORED BY
Coleman

Club Members ONLY
FREE Apron
with **ANY Purchase!**

**WHILE
SUPPLIES
LAST!**

FREE Lunch!
11 am to 1 pm

CLUB MEMBERS
Save up to 45%
on 2-DAY ONLY
SPECIALS!

Bait and Switch?

At wit's end after a repair cost more than \$4,000 above the shop's initial estimate — without their consent — a couple turned to Hot Line for help.



“ We purchased a 2002 Monaco Windsor in August 2016. On April 27, 2017, the warning light for the Cummins 350 ISC diesel engine flashed for a bit. I checked for water in the fuel at the first filter and didn't see any, but I did release some fuel. The engine would not start, so we had it towed to the local Cummins dealer in Ventura, California.

We left the motorhome for repairs. I checked back at the shop after a couple of hours and the tech said he found black granules in the first fuel filter. As a result, they replaced both fuel filters, but the coach still would not start. When I checked back on the following Tuesday, the tech and Amy, the service rep, said that the fuel pump would need to be replaced. Amy gave me an estimate of \$7,646.26 for the repair. Over the next few days and weeks I stopped by and saw that our rig was still in the shop stall. One time I found a tech working on it, and he showed me the black fuel he had blown back into a bucket. The fuel that was coming out of the diesel tank was clean. He thought that the fuel feed hose had deteriorated and collapsed, and he was replacing it at that time. Amy called me on April 23, 2017, and informed me of the change of cost of work done to the tune of \$11,969.25. We paid that amount to get our coach returned, even though we had not, at any time, been called with any changes to what was being repaired (or charged). We feel that the diagnosis of the problem was incorrect, even though they initially found the black granules in the first fuel filter.

Ken and Ruth Olive | Ventura, California

A shop estimate represents an educated guess as to what the impending repairs will cost (barring unforeseen circumstances). Obstacles often do occur that cause the cost of the repair to rise. However, it is the responsibility of the repair shop to keep the customers informed of such changes, in order to allow them to make a decision as to whether they should be made.

We didn't hear from Cummins for more than six months, but we kept trying. Our persistence finally paid off, as we received a letter directly from the Olives:

“ After [turning down the company's initial offer], we later received a call in December 2017 from a California Cummins representative. He went over our bill with us and offered a

\$2,500 discount, plus some service coupons. We accepted his offer.

— K. and R. O.

Level With Me

“ Back in February 2016, the hydraulic leveling jack pump on my new 2016 American Coach Revolution went out. I took the motorhome to Paul Evert's RV to replace the pump. They did that, and the leveling jacks worked, but couldn't get the auto air dump valve to work, even after they had the coach twice to reprogram the jacks.

The air-dump valve still did not work.

I later took the coach to Valley Freightliner for routine maintenance work. While the motorhome was at Valley, I called and asked if they could check the air-dump valve. I also stated that it should be covered under the factory warranty. A week later I received a call from Valley Freightliner that my motorhome was fixed, and that the charge was \$559.98. At the time this took place, my coach and chassis were under factory warranty. I have sent REV Group [the umbrella corporation for American Coach] several requests for reimbursement of this repair, as this relates to a previous repair. The company has declined.

Wayne Washburn
Stanwood, Washington

As the repairs were made while the motorhome was still under warranty, we agree that at least some amount of reimbursement was due. We soon heard back from REV Group.

We thank you for your letter regarding Mr. Washburn and his 2016 American Revolution. In a review of the repair history and the claims submitted, it is clear that the repairs to the levelers were performed during the warranty period. However, the time to repair is excessive. In a telephone conversation with Washburn, we agreed REV would reimburse him for one-half the total cost of the repair. Washburn thought this was fair, and we will send him a check in the amount of \$270.

Barry Krueckeberg, Dispute Resolution Administrator, REV Recreation Group
Decatur, Indiana 

Take Action Contact Hot Line for Help

Hot Line assists in mediating conflicts between consumers and RV dealers and manufacturers, accessories suppliers and service providers. After exhausting all other resources, send typed letters to *MotorHome* Hot Line, 2750 Park View Court, Suite 240, Oxnard, CA 93036 and enclose copies of appropriate bills and correspondence, plus a self-addressed, stamped envelope. Selected letters will be edited and published unless otherwise requested.

PROTECTION

FROM THE COST OF MAJOR BREAKDOWNS



A Good Sam Extended Service Plan is better than a warranty, it's mechanical breakdown insurance and we not only cover RVs, we cover your auto too.

A Good Sam Extended Service Plan can help take the worry out of paying large repair bills with coverage on your engine assembly, transmission, drive axles, plus RV components like your fridge, awnings, seals, gaskets and so much more.

Go online now to see all that we cover and get your **FREE QUOTE.**

Come see how affordable it can be to repair your RV or vehicle.

GoodSamESP.com/MH0618

877-387-7329



TAKE THE WORRY OUT OF PAYING LARGE REPAIR BILLS

*All program benefits are subject to limitations set forth in the current Terms & Conditions. ESP is available to U.S. residents only. Designed for the Good Sam Club by Affinity Brokerage, LLC. ©2018 Good Sam Enterprises, LLC. GOOD SAM and the GOOD SAM ICON are registered trademarks of Good Sam Enterprises, LLC. Unauthorized use of any of GSE, LLC's trademarks is expressly prohibited. All rights reserved. ADMH0618 GSP54487 - 0218

By Ken Freund

Gas-Tank Filling Problem — Tip

I had the same problem (as in the March letter) with my 1995 Conquest Class C on a Ford chassis. I discovered that it varied from gas station to gas station. Then I figured out that if I parked at the pump with the front and far side lower than the filler tube, it would fill properly. A lot of the gas stations are not 100 percent level. I assumed that it was a vent tube problem, but could deal with it by circling the pump and coming in from a different side.

Bruce Watson | Bloomington, Minnesota



You know the saying about “assume.” Yes, I’ve experienced this a number of times when filling, and it wasn’t always apparent that there was a slight slope. Thanks for sharing your experience.

Diesel Emissions Maintenance

We own a late-model coach with a Cummins diesel. It amazes me how many Cummins owners are told about adding the blue fluid (diesel exhaust fluid, or DEF) but nobody told them about the preventative maintenance (PM) services on diesel engines. There is an article from Heavy Duty Trucking about the filters for the diesel particulates, which is very interesting. It’s another [thing to consider before buying] a diesel coach with a Cummins engine; taking care of the diesel particulate filters.

Stephen Calderwood | Boring, Oregon

The online article you referenced, “What You Should Know About After Treatment System Maintenance,” at www.truckinginfo.com, is aimed at trucking fleet operators and assumes that the vehicles will reach high mileages typical of commercial trucking. As the author notes: “... diesel particulate filters, diesel oxidation catalysts, selective catalytic reduction systems and their associated hardware have proven pretty reliable over time.” The article goes on to state that the estimated safe diesel particulate filter cleaning interval is more than 350,000 to 400,000 miles for most trucks. The

vast majority of motorhomes do not rack up this kind of mileage, so this should not be of great concern to most typical owners. Adding DEF can be a nuisance, but the cost relative to the overall operating cost of the vehicle is not that significant, and makes a huge difference in reducing exhaust emissions and therefore cleaner air.

Thermostat Mystery

Q We own a 2005 Fleetwood motorhome with two Coleman Mach 3 air conditioner units controlled by a single Coleman RV Comfort ZC digital thermostat. Two to three times a year, while running the units, our thermostat will make a popping noise and will instantly give a digital readout of “00.” This effectively shuts off any cooling, as it turns off the compressors. It does, however, allow the fans to continue running. If we are in the motorhome this is no big deal, as we can reset the thermostat by momentarily turning off the house batteries, but this could spell disaster for our dog in hot weather if we are away. When this first started happening, I contacted Coleman and got in touch with one of its engineers. The engineer said that although this problem is rare, it does happen from time to time on some

RVs. He told me that there is some sort of radio frequency interference (RFI) inside my RV, which is causing the thermostat to go into diagnostic mode. He kindly sent me the latest thermostat and radio noise choke filter, free of charge. When this did not help, I called him back. He told me the following items could be causing the interference: fluorescent tube lighting, TV antenna booster, bad inverter/charger and CB radio. I removed all the fluorescent tube lighting and replaced it with LED strips. I replaced the TV antenna booster with a KING Jack antenna and booster (I power down the booster when the RV is unattended). I eventually replaced the Xantrex Freedom SW inverter/charger (when it quit working) with a Magnum PSW inverter/charger. My CB radio is a non-issue, as it is only used while traveling. Another RV tech told me that any battery charger can emit a radio frequency, so he told me to disable my Magnum’s battery charger when it is not needed, which I have. Unfortunately, none of the above measures have solved my problem. I have been dealing with this issue for years. Can you help?

Craig Post | Upland, California

A What you describe is a known problem with this unit, and you’ve

pretty much exhausted most of the common fixes for this. You may be near a strong external source of RFI, which is beyond your control. Another possibility is that you have an intermittent faulty connection. I suggest checking all the connections and wiring to the air-conditioning units, circuit boards and thermostat as carefully as possible. Of course, make certain you have a good 12-volt DC power supply, and consider buying a desktop 12-volt DC power supply. Then, wire the system to that, instead of the coach power supply, and test it to see if it still happens. Next, I would consider replacing the control boards, one at a time. Buy one new board and replace one, but keep the old one. If it happens again, swap the second one and test it.

LP-gas Line Flex

Q We own a 2008 Jayco Melbourne, which we really like. It has a propane stove in the slide and I wonder

if the process of opening and closing the slide puts any fatigue on the gas line. Do RV manufacturers take any preventative measures to prevent fatigue and avoid a rupture?

Terry Chellis | Wooster, Ohio

A RV LP-gas systems have flexible hoses wherever they must flex or bend. These are typically well-made and have a good track record of holding up. However, it doesn't hurt to inspect them from time to time. I suggest you add this inspection to your checklist, especially if the motorhome has been stored for a while.

F-53 Ford Noise

Q In the March issue, you responded to a two-pronged question from Mark Schall ("Concerns on an F-53 Ford"), the second part of which had to do with a loud noise coming from the engine of his Ford V-10 6.8-liter on the F-53 chassis. We, too, are the owners

Dave & LJ RV Interiors, Circle 105 on Reader Service Card

**OVER 265,000 SHOW ATTENDEES.
THOUSANDS OF HAPPY CAMPERS.**

**BEAT THE HEAT
SUMMER SALES!**
COLORADO SPRINGS,
DENVER, GREENVILLE,
MEMPHIS AND
MANY MORE!

CONTACT US FOR MORE INFORMATION ON OUR SUMMER SERIES COMING TO A CITY NEAR YOU.

HOOK UP YOUR TRAILER IN SECONDS!



iBALL 
WIRELESS TRAILER HITCH CAMERA

Starting at
\$169.95
Pro Digital Model
\$229.99

- 100% Wireless & Portable
- Easy—Installs in Seconds!
- Magnetic & Submersible Camera
- Trailers (Boat, Camper, Horse, ATV, livestock and More!)
- Pro Model Now Available

**Plus Get Up to \$50 Off,
Use Promo Code MH618**

Info/Buy Now: 1-877-298-2055 or visit our website at:
www.iballhitchcam.com

iBall Hitch Cam, Circle 116 on Reader Service Card

UltraRVProducts[®]
.COM

**MAKE WHITE KNUCKLE DRIVING
A THING OF THE PAST**



800-417-4559

CHASSIS PERFORMANCE PACKAGES

WWW.URVP.COM

Brazell's RV Performance, Circle 102 on Reader Service Card

COACH & POWERTRAIN

of a Fleetwood Bounder 33C with that engine, though ours is on a 2013 chassis (2014 Bounder model year). We bought the unit used with 20,000 miles on it last summer. When going up a 10,000-foot elevation pass with about a 7 percent grade, we had the same issue Schall did. All of a sudden, a loud noise came from the engine (you can describe it as a whistling, or a jet taking off). It scared us, but we didn't lose power and no gauges were showing abnormal. We went over the hill and everything quieted down with no more problems. Upon returning home, I did some searching online and saw that others had the same issue. However, there seemed to be no solution found, but the word seemed to be that at high load the fan clutch kicks into overdrive, causing the noise. By the way, we did check that all the belts were tight when we returned. Last winter we went down to Arizona, and climbing the mountains I kept the speed and rpm down, and once I heard the engine start to act up, I slowed down before it started up again. In summary, if you could track down whether this is something that is "just the way it is" or if a fan clutch may be bad, there are a whole lot of people who have that issue that would love to know. Climbing a 10,000-foot pass with the doghouse cover off to see if it will do it again is not really a viable option.

Nick Spence | Durango, Colorado

A The noise describe as "a jet taking off" is almost certainly the mechanical fan coming on when the fan clutch engages or, as you describe it, "kicks into overdrive." Normally it freewheels until a temperature sensor causes the fan to engage, which usually occurs on long climbs and in hot weather. It's perfectly normal and, in fact, necessary to keep the engine cool enough for safe operation. The noise level also usually increases when climbing a grade due to downshifting, which raises engine speed.

Rain Gutters

Q I just purchased a new Thor A.C.E. motorhome and was surprised

Great TV on the Road— *Whenever & Wherever* You Want!



Small footprint is perfect
for RV living!



Enjoy DISH® Pay As You Go Programming with the Wally Receiver!

DISH Wally® HD Satellite Receiver #87758 **Club SALE \$79.99** Reg. \$89.99

USER-FRIENDLY FEATURES!

- Works with any DISH® satellite antenna to bring you Pay As You Go Programming
- Radio frequency remote can be used inside or outside the RV, through the wall up to 200 ft. away
- Locate your missing remote with the remote finder
- Easy access to your favorite apps and streaming content like Netflix (requires streaming membership and Wi-Fi Adapter)
- Additional Wally™ accessories available including: Bluetooth adapter and headphones, Wi-Fi adapter and additional remotes

With DISH® Pay As You Go programming*:

- Pay only for the months you use
- Compatible with all DISH-specific antennas and most mobile satellite antennas
- Only DISH lets you watch your favorite shows in HD
- No charge to start or stop monthly service
- Programming for as little as \$34.99 per month!



DISH is ranked **#1 in Customer Service** nationally by J.D. Power and our customers.

Hurry, offer expires June 10, 2018. Call Camping World at 1.877.793.4801 to activate your DISH programming!

***Important Terms and Conditions:** All prices, fees, charges, packages, programming, features, functionality and offers subject to change without notice.

Installation/Equipment Requirements: Monthly fees and limits on number and type of receivers will apply. All charges, including monthly programming, pay-per-view and equipment upgrades, must be paid in advance; failure to pay by due date will lead to service disconnection within 24 hours. Miscellaneous: Offers available for new and qualified former customers. Offers subject to terms of applicable Promotional and Residential Customer agreements. Taxes or reimbursement charges for state gross earnings taxes may apply. Additional restrictions may apply.

CAMPING WORLD®

SuperCenters Nationwide | 1.877.793.4801 | CampingWorld.com/shop

dish
AUTHORIZED RETAILER

DISH Network received the highest numerical score for customer service and second highest score for overall customer satisfaction among national TV providers in the J.D. Power 2017 U.S. Television Service Provider Satisfaction Study, based on 18,685 total responses, measuring the experiences and perceptions of customers with their TV service provider, surveyed November 2016-July 2017. Your experiences may vary. Visit jdpower.com.
Dish Network, Circle 106 on Reader Service Card

axelbloom MADE IN AUSTRIA **866.696.8387** 
 german schlafsysteme **German Beds**

Only Adjustable for Platforms
Lays Flat & Just 5 Inches Thick!

Starting at **\$898!**



Senior, Veteran, Combo Discounts!

Normal Access To Storage with Short Frame Option



Storage Hinge
 Frame Length - (42 - 50 inches) (Up to 30 inches)
 Raise back of Adjustable
 Lift Storage Lid
 Storage Area

Luxurious, Self-Ventilating Mattress
 Natural, Cool, Washable Covers

www.luxuryrv.axelbloom.com

Steele
RUBBER PRODUCTS

OVER 100 RV EXTRUSIONS AVAILABLE

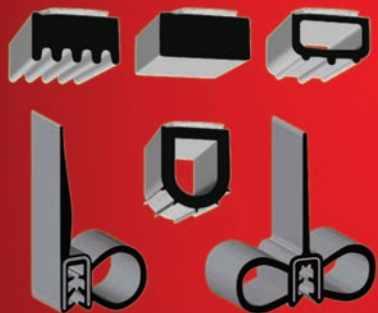

Call for your **FREE RV Catalog**

800-650-5137
www.steelerubber.com

BRAZELS  **PERFORMANCE PRODUCTS**



WORKHORSE CLUSTER REPAIRS

Now Offering D.I.Y. LCD SCREEN KITS!
ONLY \$149



TECHNICAL ASSISTANCE PROVIDED
877-786-1576
www.BRAZELSRV.com

UltraRVProducts
 .COM



Real world tested, dyno-proven custom tunes that boost horsepower, torque and improve transmission shifting

PLUG AND PLAY PERFORMANCE
 +55 HORSEPOWER
 +70 FT-LB TORQUE
 IMPROVED SHIFTING!



800-417-4559
www.URVP.com

TireTraker
 Tire Pressure Monitoring Systems



TT-500
 The Most Innovative TPMS On The Market Today With A "Lifetime Warranty"

- Pressure & Temperature Monitoring
- USB Rechargeable Monitor
- Monitors Up To 22 Tires (0-232psi)
- 0.5 oz. Sensors - Lightest on Market
- User Replaceable Sensor Batteries
 - Visual & Audible Alarms
 - Automatic Update Feature

4 Sensor Systems
 With Lifetime Warranty
\$289.00
 Additional Sensors ~ \$35.00 ea.

LIMITED LIFETIME WARRANTY

866-200-9773
info@tiretraker.com
www.tiretraker.com

EZ OIL DRAIN VALVE US PATENTED **NEW & IMPROVED**



• REPLACES YOUR DRAIN PLUG
 • TURN THE LEVER TO DRAIN OIL

THE EASIEST OIL CHANGE

Optional Hose Connections



ATTACH THE REMOVABLE HOSE END | CONNECT A HOSE | OPEN THE LEVER TO DRAIN OIL | STRAIGHT | L-SHAPED

Available at Participating NAPA Auto & Truck Parts stores nationwide and all Traction and Global Parts locations

www.EZoilrain.com (425) 999-1200

Get the Sheen Back

As seen in **MotorHome Dec. 2016**



Poli Glow Restores Faded Surfaces

Lasts over 12 Months
poliglowproducts.com
 Watch instructional video • 800-922-5013
 FREE SHIPPING COUPON CODE: MH18

MotorHome.com



The online resource for the RV enthusiast

Call or click today to get *MotorHome* delivered right to your mailbox!

MotorHome.com/Subscribe
 or call 866-799-4084

DESTINATIONS

IDAHO

RVers Love IDAHO!

ESCAPE the crowds & high prices.

ENJOY great camping, stunning scenery & amazing wildlife.

EXPERIENCE world-class outdoor recreation & friendly, helpful people.

FREE! Idaho RV Campground Directory



RVidaho.org

To Advertise in MotorHome

Travel, Tech, Lifestyle - For the RV Enthusiast

RV MARKETPLACE or DESTINATIONS Section

Please Contact -

Terry Thompson

206-310-6234

BEST FRIENDS ANIMAL SANCTUARY

Go Fetch Adventure. Book your visit at bestfriends.org/fetch

ADVERTISERS' INDEX

RS #	ADVERTISER	PAGE #
101	5 Star Tuning.....	6
102	Brazel's RV Performance	66
103	Cal-Am Properties	7
	Camping World	60-61
	Camping World RV Sales	59
	Classifieds	70-72
	Coach House Inc.	49
104	Custom Glass Solutions	21
105	Dave & LJ RV Interiors	65
106	Dish Network	67
109	Dynamax.....	18
121	Fleetwood RV.....	23
110	Geico	31
126	Gerzeny's RV World.....	54
	Good Sam Extended Service Plan	63
	Good Sam Media & Events	65
	Good Sam RV Loans	43
	Good Sam VIP Provided by GMAC Insurance	26
	Harbor Freight Tools.....	73
108	Hymer	10
116	iBall Hitch Cam	66
111	Innovations Housing	14
112	King	34
114	Newell Coach Corporation ...	76
115	Newmar Corporation	5
117	Pala Casino Spa & Resort	13
118	Phoenix USA Inc.	2
119	Pleasure Way	51
120	Progressive Insurance	17
122	Rising Star RV Park	45
123	Roadmaster, Inc.	75
107	Roadtrek Motorhomes, Inc. ...	29
124	RV Armor, Inc.	35
	RV Marketplace.....	68-69
125	RV Roofing Solutions	44
127	RVRoof.com	57
113	RVT.com	50
128	Safe-T-Plus	27
129	Sea Eagle.....	6
130	Thetford Corporation	39
131	Vogt RV Center	28
132	Walex	9
133	Winnebago Industries	15
	Winnebago Industries.....	52-53

While every effort is made to maintain accuracy and completeness, last-minute changes may occasionally result in omissions or errors.

to discover it had no rain gutters. I hate to think what the sides of my new motorhome will look like this summer with two air conditioners running. Any suggestions on what might work or a company that makes a rain gutter?

Charlie Bryant | Danville, Indiana

A There are several products available for this purpose. Camping World and other RV shops offer EZE RV Gutter kits. Trim-Lok also makes peel-and-stick PVC rain gutters in either black or white. There are also gutter extenders by Camco (www.camco.net) that cause the water to drip away from the side wall. You can install them yourself or have a shop do it.

Quantum Physics

We purchased a new Thor Quantum Class C, and during the orientation no one could tell us where the water filter was located. Later, while checking the electrical connections in the bedroom, I opened the panel under the mattress and to my surprise there was the water filter tucked in among the electric connections! I used a large plastic trashcan liner to contain spills or leaks during the filter change. Be careful in there!

Dennis and Pat Repasi
Seal Beach, California

Thanks for sharing your experience. It's always a good idea to fully familiarize yourself with the features of a new motorhome and read the owner's manual. Mounting the unit under a bed helps keep it away from freezing temperatures and protects it from physical impacts, such as may occur in a storage compartment. All you need to do is unplug the motorhome from shorepower (make sure the generator is not running and the inverter, if so equipped, is off) to eliminate shock hazards when servicing.

Sticking Slides

Q I own a 2003 Monaco Monarch. Since we bought it new we have had a problem with **(continued on page 72)**

ACCESSORIES

TurboKOOOL®

12-Volt Cooling for RVs

TurboKOOOL Evaporative "Swamp" Coolers
Powered by Battery and/or Solar.
Cools your RV (up to 30° reduction)
Please visit www.TurboKool.com

LEAKY ROOF? Liquid Roof® goes on like paint --

cures to a sealed EPDM rubber membrane. UV & Ozone resistant--good to 300° F. 5-year warranty.
800-467-7135 www.AdvancedRubberCoatings.com

CAMPGROUND MEMBERSHIPS FOR SALE

CAMPGROUND MEMBERSHIP OUTLET-SINCE 1991

To buy 800-272-0401
To sell 800-952-0401
Any Membership-Nationwide. Best prices ever.

Private Camping Resorts located in beautiful

Mt. Rushmore, South Dakota; historic bluff country, Spring Grove MN; Onamia MN; Hinckley MN; & Ham Lake MN. Offering many amenities. Have a personal membership available for sale due to health issues. Call 715-294-2473.

HELP WANTED

BUILDING PRO the OUT HOUSE MASTERS Sales Reps

Vinyl Wrap Your RV & go on the road.
Selling Modular RV Park Bath House Buildings, Meeting Rooms, School and Church Classrooms & Office Modulares to RV Parks, Churches, Private Schools and Daycares.
Email your resume to bill@buildingpro.com

HOMES FOR SALE



TOP RATED RESORT - S. Texas

Retama Village - Supersites \$50s.
RV Casitas \$120s RV Port Homes \$170s.
956-380-6500 www.bentsenpalm.com



Good Sam Club

Now, more money-saving reasons to join!

Join today at
GoodSamClub.com
or call 1.800.234.3450



LILY LAKE GOLF RESORT - FROSTPROOF, FLA

- Manufactured Home Lots, RV Port Lots
- New Home/Lot Packages from the \$130s
- 1-863-635-3685. www.lilylake.com



#1 RATED RV RESORTS - S. Texas

Bentsen Palm Village & Retama Village
Rentals available for Pull-throughs,
Back ins, Super sites, and Casitas
956-585-5568 www.bentsenpalm.com

MAIL/MESSAGE SERVICES

AMERICAS MAILBOX Forwarding in SD/Low Rates

NO Wheel Tax/NO Sales/Income Tax/Save \$\$\$
NO Safety Insp/4-Season Campground & Hotel
We Scan Your Mail/Insurance/Ext Warranties
www.AmericasMailbox.com Call Us First!!
866-747-3700

MOTORHOMES FOR SALE



3 Locations in So. California! 800-961-4464

San Marcos-Off Hwy 78-Camping World
Accessory Store on Site.
Santee - Off Hwy 67 @ Riverford
Palm Desert - Off I-10 @ Washington St.
Over 400 Motorhomes & Towables!
HOLLANDRVCENTERS.COM

HOLLAND MOTOR HOMES - Michigan

Renegade Super C + Sprinter RV's
www.holland-motorhomes.com
800-221-7197

MOTORHOMES WANTED

Fast cash for 2002-2017
gas or diesel motor homes

Free pick up. No hassles.

SELL RV NOW

SellRVNow.com
1.800.607.9754



\$ RV BUYERS OF AMERICA \$
WE BUY YEAR 2008 & NEWER DIESEL
& GAS • FREE NATIONWIDE PICKUP
TOLL FREE 1-888-782-8987
www.rvbuyersusa.com
WE WILL BEAT ANY DEALER PRICE

WANTED:

2003 & Newer Gas or Diesel
"A" "B" or "C" Motorhomes

INSTANT CASH NATIONWIDE PICK-UP

Freedom RV

Please Call
Mike or Bruno
(509)598-9747

MOTOR HOMES WANTED

Cash for 2003-2017 Gas or Diesel
Nationwide Pickup

888-783-4009



WE BUY LATE MODEL MOTORHOMES

- INSTANT CASH
- NATIONWIDE PICKUP



CALL JOE:
831-458-6166



50 Years of Business Integrity



VOGT RV NEEDS YOUR MOTORHOME

We need clean, late model motorhomes
Buy - Sell - Trade - Consign
vogtrv.com - (817) 831-4222

WANTED USED DIESELS
SPECIALIZING IN NEWMARS
NATIONWIDE PICKUP
(602) 421-3870

\$ CASH \$ TOP DOLLAR PAID for late-model motorhomes.
All makes and models.No hassles.
For instant cash call Keith Roy
(toll-free) at 1-888-227-4078, PEDATA RV CENTER.

I BUY MOTORHOMES
CALL RALPH...Regardless of your payoff!
Get Paid in LESS than 48 hours.
I'll come to you...ANYTIME-ANYWHERE!!
NATIONWIDE 210-287-2628

NATIONWIDE RV BUYER
Searching for 2007 and newer Pre-Owned RVs
Call 303.717.0880 or topbuyer@rvbuyerswest.com
www.rvbuyerswest.com

NORTHEAST MOTORHOME WHOLESALER
Cash for your late model gas or
diesel motorhome. Will buy nationwide.
Toll free 866-803-6787 www.futuresrv.com

We can sell your RV Fast & for the Highest Price
Florida's #1 Consignment RV Sales Center
Conveniently located on the Space Coast in
Titusville, FL. Pickup available. Visit us at
Eaglespriderv.com or call AI @ 321-383-4495

I BUY MOTORHOMES
CALL GAVIN...Regardless of your payoff!
Get Paid in LESS than 48 hours.
I'll come to you...ANYTIME-ANYWHERE!!
NATIONWIDE 321-332-8410

RECREATION VEHICLES FOR SALE



125,000+ New & Used RVs for Sale on RVT.COM®
Search *By Owner and Dealer* Listings.
Sell an RV with a Free or Until Sold ad!
www.RVT.com or 1-877-705-0025

RV FINANCING

THE ORIGINAL RV FINANCING ONLINE
LOW RATES, GREAT SERVICE, NATIONWIDE
1998 AND NEWER RVs ALL TYPES
www.RVFINANCING.COM • Facebook.com/rvloans
CALL NOW-toll free 888-929-4424

RV SPACES FOR RENT

LARGE RV SPACES 55+, Bellflower, CA
POOL, CLUBHOUSE, ACTIVITIES, WIFI
Website: rosewoodland.com/mhp
Rosewoodrvpark@gmail.com 562-867-3227

SERVICES

Register your Vehicle & SAVE THOUSANDS

Avoid high licensing fees and sales tax

TAX FREE Montana Vehicle Registration

Assisting clients worldwide with Montana
vehicle registration for over 19 years.

Jared S. Heggen, Licensed Attorney
888-777-5032 | heggenlawoffice.com

HEGGEN
LAW OFFICE, P.C.
Attorney at Law

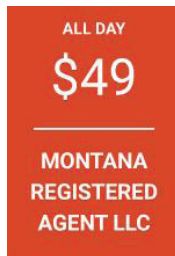

\$800 for a 1 day MT LLC and RV Registration
All fees incl. Plates in your hands in 3 days.
www.49dollarmontanaregisteredagent.com
Call for more info 406-552-0004.



NATIONWIDE WINDSHIELD REPLACEMENT SERVICE
Insurance claim specialists, OEM Glass
All makes and models, National warranty
\$100 off MobileRVGlass.com 855-778-4527

Let us help you BUY YOUR RV ... TAX FREE!
**Setup a Montana LLC today with the most
experienced company in the industry!**
Call 888.430.3388 www.MontanaRV.net

ACTION SERVICES, LLC/WILSON LAW OFFICE
No Sales Tax in Montana. Consult a Licensed
Montana Attorney for an understanding of
LLC vehicle ownership. Call the Professionals
to get a comprehensive explanation.
800-481-0013 www.actionservices-mt.com

#1 IN SALES TAX SAVINGS
PAY NO SALES TAX! We have helped 1000's save
over the past 23 yrs. Call & talk to a CPA for
professional, friendly service! **www.rvtax.com**
Mountain States Consulting 800-565-4504

To avoid paying taxes,
There are laws you must know.
Thus, speak to an attorney,
Not a salesman who just wants your dough!
www.bennettlawofficepc.com 866-543-5803
Three Montana attorneys on staff.

TOURS



RV CARAVANS and RALLIES
Pre-Planned Routes, Expert Guides and
Safe Travel-North America & Overseas.
FantasyRVTours.com or call 800-952-8496

MotorHome.com



The online resource
for the RV enthusiast

(continued from page 69)



Guided RV Tours & Rallies

Lower 48 • Alaska • Canada • Overseas
Free RV Vacation Catalog 844-872-7897 or
www.adventurecaravans.com

MotorHome

Travel, Tech, Lifestyle – For the RV Enthusiast

CLASSIFIED RATES

Display Classified Advertising Rate

1" ad B/W \$395
2" ad B/W \$675
Add \$75 for color.
Frequency discounts apply.

Optional Red Type

For your ad to appear in red type, add \$50
for Commercial ad, add \$25 for Private Party

Photos

For ad with picture, add \$65 (B/W or color
print acceptable; high-resolution digital
image preferred).
Limit one photo per ad.

How To Place An Ad

Submit ad copy by email or fax.
Please include your name, address and
phone number.

Contact

MotorHome Classifieds
Katey Purgatorio

Questions: Phone 847-229-6756

Email: katey.purgatorio@goodsam.com

Subscribe Today

One-Year Subscription Only \$19.97
Save 67% Off Newsstand

Two-Year Subscription Only \$34.97
Save 70% Off Newsstand

MotorHome.com/Subscribe
or call 866-799-4084

the slides. They will not move if it is below freezing outside. Most of the time I can just start the engine and let it warm up and then the slides will work, but sometimes it is too cold and we have to disconnect the motors and push the slides in or wait to warm up. Seems to be a low voltage when the battery is cold. I have replaced the battery and that seemed to help, but the problem comes back. I have also added a trickle charger that feeds the chassis battery while we are plugged in, but still have the problem. Can you help me?

Larry Diemer | Clarkston, Michigan

A Slideout mechanisms require a lot of power, even in ideal conditions. Batteries lose a lot of their capacity in cold weather, which I believe is the reason your slides aren't working at low temperatures. The slide seals also become stiff and cause more resistance at low temperatures. The simple trickle charger may not be doing the batteries much good; it's best to use a "smart" maintenance charger, not a simple trickle charger. It's a good practice to let the engine run while operating slides because it raises the available voltage at the batteries and therefore to the slide mechanism motor. Thoroughly inspect the slide mechanisms and service them as needed. It may be that the wiring connections have become corroded or frayed, further reducing available power to the motor. It's also possible that the wiring is too light, which can create a voltage drop at the slide motor.

Coach Current Draw — Comment

Regarding Denver Isaacs' breaker problems detailed in the March issue, don't rule out fire ants ruining your breakers. I have replaced RV pedestal breakers, pressure switches and GFCI outdoor outlets thanks to these little creatures. Sometimes it is almost impossible to see the ants that have ruined your breaker. Apparently the electromagnetic field (EMF) from the power system attracts them.

Harold Misch | Foley, Alabama

Thanks for writing. I'm sure glad we don't have a problem with fire ants in my area! They are so destructive, it's incredible.

Gas-Tank Filling Problem — Fix

We have a Chevrolet 2006 Express 3500 that is used by Four Winds to build our Class C. I had the exact same problem (as in the March issue) with it not being able to fill all the way, and the worst was in cold weather in Texas. I finally looked underneath to see the filler hose extension from the side of the coach to the normal filler tube that goes into the tank. It was normal size, but had a kink where it bent to curve to the tank. That curved section had a metal piece with clamps on each end to connect the straight pieces of pipe. I found a company that made stiff gas hoses with the curve I needed, but it was too long, so I just cut out the correct section and now all is well. It does not take much of a kink to cause the flow to backup and trigger the sensors in the gas pump handle. Just look for a pipe that has a slight curve to it and can handle gasoline. It will fix the problem. Why didn't they use a metal pipe? Too much flex between the gas tank and the chassis of the motorhome?

William Patterson
Pleasant Hill, California

Thanks for sharing your solution. There is considerable flexing between the frame and body, and as you surmised, a flexible joint is needed in the filler pipe and vent tube. Just as a safety reminder, a hose that is designed to carry fuel is required, as water hoses can melt and leak. **M**

Have a Tech Question?

Contact our experts:

Email tech@motorhomemagazine.com or write to *MotorHome*, 2750 Park View Court, Suite 240, Oxnard, CA 93036 (please include your name, city and state). Selected letters will be answered in the magazine, but time does not permit individual replies.

850 Stores Nationwide • HarborFreight.com

PITTSBURGH Automotive **#1 SELLING JACKS IN AMERICA**

RAPID PUMP® 3 TON LOW PROFILE HEAVY DUTY STEEL FLOOR JACK

Customer Rating **★★★★★**

• Weighs 73 lbs.

NOW \$199.99

~~\$279.99~~

COMPARE TO **\$149.99** HUSKY MODEL: H100022 **SAVE \$89**

ITEM 62326/61282/61253 shown

28977879

LIMIT 3 - Coupon valid through 9/8/18*

PREDATOR Automotive **SUPER COUPON**

8750 MAX. STARTING/7000 RUNNING WATTS 13 HP (420 CC) GAS GENERATOR

Customer Rating **★★★★★**

NOW \$529.99

~~\$599.99~~

• GFCI outlets

COMPARE TO **\$2,700** HONDA MODEL: EG6000KAT **SAVE \$2,170**

ITEM 68530/63086/63085 shown

ITEM 68525/63087/63088, CALIFORNIA ONLY

28984722

LIMIT 4 - Coupon valid through 9/8/18*

SCISSOR SUPER COUPON

FREE WITH ANY PURCHASE

PITTSBURGH Automotive

4" MAGNETIC PARTS HOLDER

- Non-Marring Base
- Stainless Steel

COMPARE TO **\$5.99** TITAN MODEL: L1194

Hardware sold separately.

ITEM 62535/90566 shown

28970648

LIMIT 1 - Coupon valid through 9/8/18*

SCISSOR SUPER COUPON

20% OFF

ANY SINGLE ITEM*

28967482

LIMIT 1 coupon per customer per day. Save 20% on any 1 item purchased. *Cannot be used with other discounts, coupons or any of the following items or brands: Inlets, Fresh Coat membership, Extended Service Plan, gift card, open box item, 3 day Parking Lot Sale Item, compressors, floor jacks, rollers, floor mills, storage cabinets, desks or carts, trailers, trenchers, welders, Admiral, Ames, Bauer, Corona, CoverPro, Dayton, Earthquake, Fisher, Hottel, Inco, Jaxxon, Pexco, Predator, Ridgid, Viking, Vortex, Zoro. Not valid on prior purchases. Non-transferable. Original coupon must be presented. Valid through 9/8/18.

U.S. GENERAL Series 2 **SUPER COUPON**

44" x 22" DOUBLE BANK ROLLER CABINET

NOW \$449.99

~~\$479.99~~

COMPARE TO **\$2,605** SNAP-ON MODEL: K8A813FP80 **SAVE \$2,155**

ITEM 64281 64134 64133 shown

28986038

LIMIT 4 - Coupon valid through 9/8/18*

EARTHQUAKE Automotive **SUPER COUPON**

1/2" HEAVY DUTY COMPOSITE PRO AIR IMPACT WRENCH

950 TORQUE FT. LBS. BOLT BREAKAWAY

Customer Rating **★★★★★**

NOW \$89.99

~~\$119.99~~

• Weighs 5 lbs.

COMPARE TO **\$249.99** CHICAGO PNEUMATIC MODEL: CP7749

ITEM 62835

28987804

LIMIT 3 - Coupon valid through 9/8/18*

BADLAND Battle Tested **SUPER COUPON**

2500 LB. ELECTRIC WINCH WITH WIRELESS REMOTE CONTROL

• Weighs 14.3 lbs.

• 11-1/8" L x 4-1/2" H

Voted Best Winches

NOW \$499.99

~~\$799.99~~

COMPARE TO **\$179.99** SUPERWINCH MODEL: 125220 **SAVE \$130**

Customer Rating **★★★★★**

ITEM 61840/61297/63476/61258 shown

28983039

LIMIT 4 - Coupon valid through 9/8/18*

CENTRAL PNEUMATIC Series 2 **SUPER COUPON**

6 GALLON, 1.5 HP, 150 PSI PROFESSIONAL OIL-FREE AIR COMPRESSOR

• Air delivery: 2.5 CFM @ 90 PSI 3.4 CFM @ 40 PSI

Customer Rating **★★★★★**

NOW \$99.99

~~\$124.99~~

COMPARE TO **\$169.99** DEWALT MODEL: DWFP55126 **SAVE \$70**

ITEM 62511/62894/62380/68149/67696 shown

28929680

LIMIT 4 - Coupon valid through 9/8/18*

CENTRAL MACHINERY Series 2 **SUPER COUPON**

8", 5 SPEED BENCHTOP DRILL PRESS

NOW \$499.99

~~\$679.99~~

Customer Rating **★★★★★**

COMPARE TO **\$102.99** BUFFALO BLACK MODEL: DP10L **SAVE \$53**

ITEM 62520/60238 shown

28949190

LIMIT 3 - Coupon valid through 9/8/18*

PITTSBURGH Automotive **SUPER COUPON**

ATV/LAWN MOWER LIFT

- 300 lb. capacity
- Weighs 72.5 lbs.

NOW \$199.99

~~\$299.99~~

Customer Rating **★★★★★**

COMPARE TO **\$179.99** PROLIFT MODEL: P-5368

ITEM 60395/62325 62493/61523 shown

28954102

LIMIT 5 - Coupon valid through 9/8/18*

COVER PRO Series 2 **SUPER COUPON**

10 FT. x 20 FT. PORTABLE CAR CANOPY

Customer Rating **★★★★★**

NOW \$999.99

~~\$1299.99~~

COMPARE TO **\$205.99** SHELTER LOGIC MODEL: 28522 **SAVE \$106**

ITEM 63054/62858 shown

28955243

LIMIT 4 - Coupon valid through 9/8/18*

HaulMaster Series 2 **SUPER COUPON**

18" x 12" MOVER'S DOLLY

- 1000 lb. capacity

Customer Rating **★★★★★**

NOW \$79.99

~~\$109.99~~

COMPARE TO **\$16.43** BUFFALO TOOLS MODEL: HOFERDOLLY **SAVE \$10.99**

ITEM 61899/63095/63096 63098/63097/93888 shown

28966886

LIMIT 3 - Coupon valid through 9/8/18*

drillmaster Series 2 **SUPER COUPON**

4-1/2" ANGLE GRINDER

Customer Rating **★★★★★**

NOW \$9.99

~~\$14.99~~

SAVE 61%

COMPARE TO **\$25.80** PERFORMAX MODEL: 2411-1 **SAVE \$15.81**

ITEM 69645/60625 shown

28968820

LIMIT 4 - Coupon valid through 9/8/18*

Bunker Hill Security Series 2 **SUPER COUPON**

60 LED SOLAR SECURITY LIGHT

Includes 6V, 900 mAh NiCd battery pack.

Customer Rating **★★★★★**

NOW \$299.99

~~\$399.99~~

COMPARE TO **\$489.94** EATON MODEL: MSLER180W **SAVE \$189.95**

ITEM 62534/69643 shown

28969586

LIMIT 5 - Coupon valid through 9/8/18*

GREENWOOD Series 2 **SUPER COUPON**

1-1/4 GALLON HOME AND GARDEN SPRAYER

Customer Rating **★★★★★**

NOW \$89.99

~~\$129.99~~

COMPARE TO **\$187.1** ROUNDUP MODEL: 190315 **SAVE \$97.11**

ITEM 63124/63145/95692 shown

28972500

LIMIT 9 - Coupon valid through 9/8/18*

CENTECH Series 2 **SUPER COUPON**

2/10/50 AMP, 12 VOLT BATTERY CHARGER/ENGINE STARTER

Customer Rating **★★★★★**

NOW \$299.99

~~\$499.99~~

COMPARE TO **\$69.99** SCHUMACHER ELECTRIC MODEL: SE-125D **SAVE \$229.99**

ITEM 60581/60653 shown

28973283

LIMIT 4 - Coupon valid through 9/8/18*

drillmaster Series 2 **SUPER COUPON**

80 PIECE ROTARY TOOL KIT

Customer Rating **★★★★★**

NOW \$6.99

~~\$9.99~~

COMPARE TO **\$24.81** PROFESSIONAL WOODWORKER MODEL: B68X10-Y **SAVE \$17.82**

ITEM 63292/63235/68986/97626 shown

28977027

LIMIT 9 - Coupon valid through 9/8/18*

SUPER COUPON

7 FT. 4" x 9 FT. 6" ALL PURPOSE/WEATHER RESISTANT TARP

Customer Rating **★★★★★**

NOW \$299.99

~~\$499.99~~

COMPARE TO **\$9.88** BLUE HAWK MODEL: B68X10-Y **SAVE \$65.11**

ITEM 69249/69115/69137/69129/69121/877 shown

28985742

LIMIT 9 - Coupon valid through 9/8/18*

THUNDERBOLT MAGNOLIA Series 2 **SUPER COUPON**

100 WATT SOLAR PANEL KIT

Customer Rating **★★★★★**

RENEWABLE ENERGY ANYWHERE

2X MORE POWER

NOW \$149.99

~~\$199.99~~

ITEM 64335 63585 shown

COMPARE TO **\$325.92** SUNFORCE MODEL: SF180 **SAVE \$176.93**

ITEM 64335 63585 shown

28987665

LIMIT 4 - Coupon valid through 9/8/18*

PITTSBURGH Series 2 **SUPER COUPON**

40 PIECE, 3/8" DRIVE SAE AND METRIC SOCKET SET

Customer Rating **★★★★★**

LIFETIME WARRANTY

NOW \$399.99

~~\$499.99~~

COMPARE TO **\$109.97** KOBALT MODEL: 99899 **SAVE \$289.99**

ITEM 63015/61328/47902/62843 shown

289091501

LIMIT 9 - Coupon valid through 9/8/18*

*Original coupon only. No use on prior purchases after 30 days from original purchase or without original receipt. Valid through 9/8/18.

At Harbor Freight Tools, the "Compare to" price means that the specified comparison, which is an item with the same or similar function, was advertised for sale at or above the "Compare to" price by another national retailer in the U.S. within the past 90 days. Prices advertised by others may vary by location. No other meaning of "Compare to" should be implied. For more information, go to HarborFreight.com or see store associate.



Got Kids?

Immersive experience programs at famous Orlando theme parks make for an even more unforgettable family trip

By Alan Rider

If you've got young kids or grandkids, there's a better-than-average chance that you've got a fanatic in your family. I mean that quite literally, especially when you stop to consider the dictionary definition of that word: "A person with an obsessive interest in, and enthusiasm for, something." It's a sentence that sounds like it was written with my son in mind.

You see, for many years my boy was borderline obsessed with his favorite movies, a big-time fan of all things Star Wars, Harry Potter and Pirates of the Caribbean. All of which, I have to admit, were nearly as much fun for us as they were for him.

So the last time we loaded up the motorhome and headed for Florida, I did a little advance planning because I wanted it to be an unforgettable trip. And that it was.

Now, if you've ever even thought of going to Orlando, a town which both Google and I consider to be the theme park capital of the world, you're probably well aware that said operations have expansive thematic worlds and attractions dedicated to these wildly popular film franchises. I mean the entire *raison d'être* of the forthcoming Star Wars: Galaxy's Edge at Disney's Hollywood Studios, The Wizarding World of Harry Potter at Universal Studios Florida and, of course, the Pirates of the Caribbean ride at Walt Disney World's Magic Kingdom is to allow fans to interact with at least the trappings of some of

their favorite fictional faves.

What you may not know, however, is that all three theme parks offer clued-in families a chance for an even more immersive experience. For example, on our first day in town we visited Disney's Hollywood Studios, where I managed to arrange for my young son Sky (short for Schuyler, not Skywalker) to participate in the Jedi Training Academy. Clad in the order's traditional brown robe, he got to engage in a light-saber duel with Darth Vader himself (he also managed to use The Force to throw the villain's stormtrooper bodyguards to the ground, white armor flailing, with a wave of his hand). Even I thought it was kind of neat.

This was only the beginning of

our deep-dive into these fantasy-made-flesh experiences, however. The following day was reserved for The Wizarding World of Harry Potter at Universal Studios Florida. Here, we signed up for a VIP tour that included a stop for a refreshing "butterbeer" before our visit to Ollivander's Wand Shop, where the wand-master himself helped Sky pick out the "right" magic wand for him (which I, of course, had to purchase; a transaction that only seemed fair, as even Harry didn't get his wand for free).

The next day we were off to Walt Disney World's Magic Kingdom to pursue the young-un's fascination with all things swashbuckling. Though the Pirates of the Caribbean ride itself has been around for decades, we were whisked into a secret Pirate's League lair, where a professional makeup artist transformed us into a devil-may-care pirate family ready to plunder the park for the rest of the day. It's a pirate's life for me, indeed!

In retrospect, the fact that we found ourselves hobnobbing with stormtroopers, wizards and pirates should come as no surprise because, when it comes right down to it, we were in places built on imagination. It also proves my oft-repeated point about what keeps us all out here: that you never know who you're going to run into along The Road Ahead. **M**

“It's a pirate's life for me, indeed!”



Up Close and Personal

Kids of all ages can unleash their alter egos at Walt Disney World with a variety of immersive events, from an intergalactic Star Wars experience to a swashbuckling pirate adventure.

NIGHTHAWK

The world's first illuminated tow bar

A truly non-binding tow bar made from beautifully-styled aluminum. Embedded LED lights in each arm illuminate with the RV's lights for increased safety. What was the darkest portion of your towing system is now easily visible to other drivers, and also visible when it comes time to disconnect.



Questions
about Dinghy
Towing?
Call the experts at
1-800-669-9690



Exclusive features:

- Egg-shaped design provides amazing strength at the lightest weight.
- Recessed channel securely holds & protects waterproof LEDs from road damage.
- Enclosed channel for power cord keeps things tidy & secure.
- Channel path for safety cables keeps the clutter down & protects cables.

Key benefits:

- Easiest to disconnect in the industry with the largest hook-up radius.
- Includes safety cables and power cord that route THROUGH the tow bar!
- Heavy-duty 8,000 lb. capacity for serious towing.
- Crafted in America from aircraft-grade aluminum.

Order 676 for Roadmaster baseplates or order 677 for Blue Ox or Demco

Time Tested
Time Proven



roadmasterinc.com
800-669-9690

THE ULTIMATE MOTORHOME

Of Choice



N E W E L L

At Newell, we want your coach to be uniquely yours. You'll work with our design team to choose everything from its floorplan to its finishes, using the highest-quality materials available. With the only coach on the market built on its own custom body and chassis, Newell offers true flexibility and freedom so you can take the good life with you.

To start your journey, visit newellcoach.com or call 1-888-3NEWELL

Newell Coach Corporation, Circle 114 on Reader Service Card