

# CHALLENGER<sup>®</sup>

BY THOR MOTOR COACH



Made to fit.

# Floor Plans

## 36TL

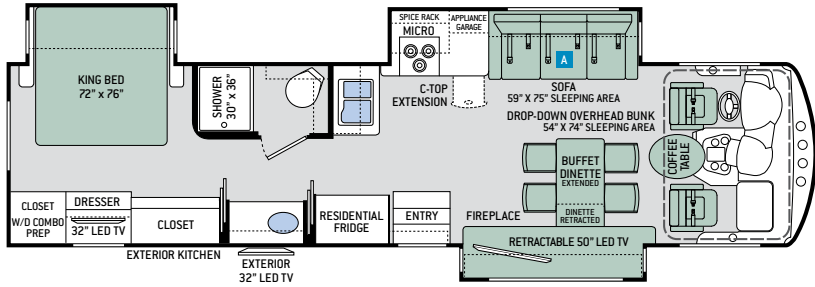

## 37TB

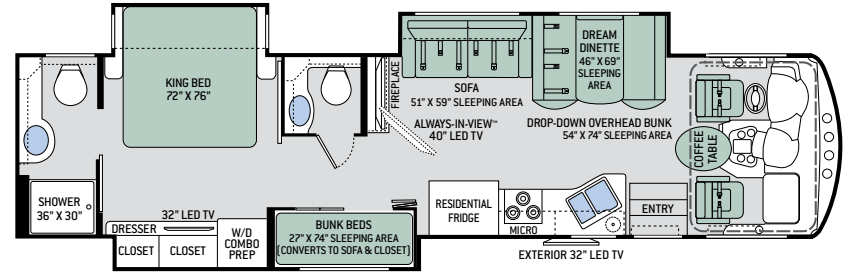

## 37KT

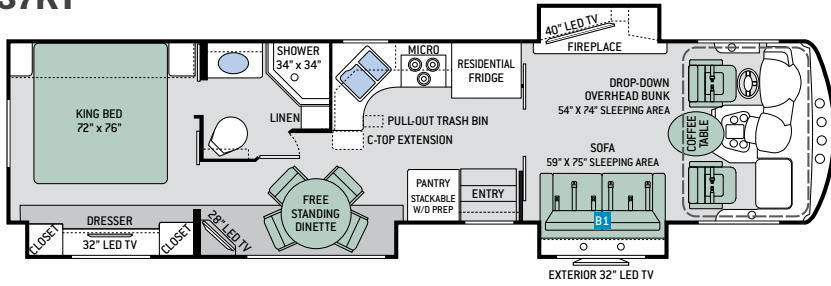

## 37YT NEW

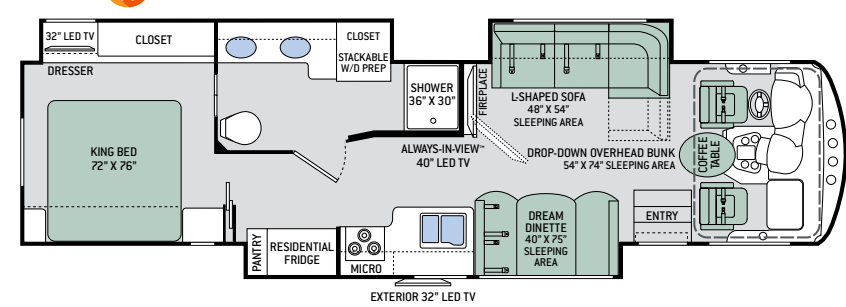

## 37LX

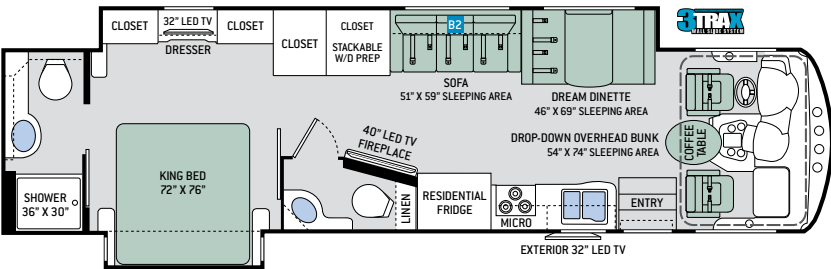

## OPTIONS

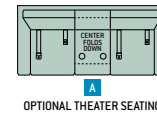

OPTIONAL THEATER SEATING

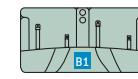

OPTIONAL THEATER SEATING

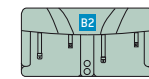

OPTIONAL THEATER SEATING

## Specifications

	36TL	37KT	37LX	37TB	37YT
Chassis	Ford	Ford	Ford	Ford	Ford
Gross Vehicle (GVWR)	22,000	22,000	24,000	24,000	24,000
Gross Combined (GCWR)	26,000	26,000	30,000	30,000	30,000
Wheel Base	242"	242"	252"	252"	252"
Exterior Length (w/out ladder)	37'-1"	38'-1"	38'-1"	38'-1"	38'-1"
Exterior Height (w/AC)	12'-9"	12'-9"	12'-9"	12'-9"	12'-9"
Exterior Width (w/out mirrors)	101"	101"	101"	101"	101"
Interior Height	82"	82"	82"	82"	82"
Awning Size	21'	12' & 16'	16'	10' & 19'	21.5'
Fuel (gal)	80	80	80	80	80
LPG (lbs)	105	105	105	105	105
Fresh/Waste/Gray Water (gal)	100 / 40 / 40	100 / 40 / 80	100 / 80 / 80	100 / 80 / 80	100 / 40 / 80
Water Heater (gal)	6	6	6	6	6
Furnace (BTUs)	35,000	35,000	35,000	35,000	35,000
Exterior Storage Capacity (cu. ft.)	199 / 229'	196	172	172	216



3TRAX™ is our in-wall slideout system, housing all the moving and mechanical parts within the sidewall of the motorhome. This triple track design supports large rooms, like those found in full-wall slideouts, ensuring simple, reliable, maintenance-free operation. What sets 3TRAX™ apart is the patented rail system, in-floor roller guides and electric motor design. For more information, visit [thormotorcoach.com/3TRAX](http://thormotorcoach.com/3TRAX).

<sup>1</sup>Without Exterior Kitchen



# Interior Decor



BAY BREEZE



KITCHEN COUNTERTOP



HIGH-GLOSS GLAZED MILAN CHERRY



CITYSCAPE



BED & BATH COUNTERTOP



HIGH-GLOSS GLAZED PACIFIC CHERRY



WESTWIND



RESIDENTIAL VINYL FLOORING



HIGH-GLOSS GLAZED RESORT CHERRY

# Exterior Graphics



PORT FULL-BODY PAINT



RIVERSIDE FULL-BODY PAINT



TERRAZO FULL-BODY PAINT

# Features

## CONSTRUCTION & EXTERIOR

- Ford® F-53 Chassis – 6.8L Triton® V10 Engine, 320HP, 460 lb.-ft. Torque – TorqShift® 6-Speed Automatic with Overdrive Transmission
- One-Piece Fiberglass Front & Rear Caps
- Welded Tubular Steel Floor
- Welded Tubular Aluminum Roof & Sidewall Cage Construction
- Vacu-Bond Laminated Roof, Walls & Floor with Block Foam Insulation
- Full-Body Paint with Gel Coated Sidewalls
- Automatic Leveling Jacks with Touchpad Controls
- Basement Pass-Through Storage Compartment
- Rotocast Storage Compartments
- Pet-Link™ Multi-Purpose Tie-Down
- Power Patio Awning with Integrated LED Lighting
- Slideout Room Topper Awnings
- 3TRAX® Wall Slide System (37LX)
- Frameless Windows
- Electric Entry Steps
- Roof Ladder
- 8,000-lb. Trailer Hitch with 7-pin Round Connector

## CONSTRUCTION & EXTERIOR OPTION

- Frameless Dual Pane Windows

## AUTOMOTIVE & COCKPIT

- Touchscreen Dash Radio with Bluetooth®
- Back-Up Monitor
- Heated/Remote Exterior Mirrors with Integrated Side View Cameras
- Reclining/Swivel Leatherette Captain's Chairs with Stow-Away Coffee Table
- Power Adjustable Driver's Seat
- Emergency Engine Start Switch

- Power Roller Shade on Windshield
- Manual Roller Shades on Side Windows
- 22.5" Tires with Aluminum Wheels
- Valve Stem Extenders on Rear Wheels
- Fog Lights
- Dash Workstation with 110-volt & 12-volt Outlets

## INTERIOR

- Rubber Tread Entry Steps with Lighted Step Well
- Residential Vinyl Flooring Throughout
- LED Lighting
- Ceiling Ducted Air Conditioning System
- High-Gloss Glazed Cabinetry with Solid Wood Raised Panel Cabinet Doors & Nickel Finish Hardware
- Lambrequin Window Treatments
- Window Solar & Privacy Roller Shades
- Dream Dinette® Booth (37LX, 37TB & 37YT)
- Free Standing Dinette with Two (2) Chairs (37KT)
- Buffet Dinette with Two (2) Chairs (36TL)
- Two (2) Folding Chairs (36TL, 37KT)
- Leatherette Expanding Sofa Bed (37YT)
- Leatherette Sofa Bed (36TL, 37KT, 37LX & 37TB)
- Electric Fireplace with Remote Control

## INTERIOR OPTION

- Leatherette Theater Seating with Recliners & Footrests (37KT & 37LX)
- Leatherette Theater Seating with Recliners & Footrests on End Seats - Center Seat Folds Down for Cup Holders (36TL)

## KITCHEN

- 21 cu. ft. Stainless Steel Residential Refrigerator (36TL & 37YT)

- 22 cu. ft. Stainless Steel Residential Refrigerator (37KT, 37LX & 37TB)
- Recessed 3-Burner Gas Cooktop with Drawers
- 30" Stainless Steel Over-the-Range Convection Microwave
- Solid Surface Countertops
- Solid Surface Cooktop & Sink Covers
- Stainless Steel Double Bowl Sink & Single Handle Faucet with Pull-Down Sprayer
- Decorative Tile Backsplash
- Drop-Thru Waste Receptacle in Countertop (37TB)
- Kitchen Appliance Garage (36TL)
- 12-volt Attic Fan with Cover

## KITCHEN OPTION

- Recessed 3-Burner Gas Cooktop with Oven

## BEDROOM & BATHROOM

- Denver Mattress® King Size Bed
- Bunk Beds – Converts to Sofa & Closet (37TB)
- Power Drop-Down Hide-Away Overhead Bunk with Cotton Cloud™ Mattress & Bunk Ladder
- Designer Headboard, Bedspread & Pillow Shams
- Foot Flush Porcelain Toilet
- Power Vent in Bathroom
- Shower with Obscure Glass Door

## ENTERTAINMENT

- Retractable 50" LED TV in Living Area (36TL)
- 40" LED TV in Living Area (37KT, 37LX, 37TB & 37YT)
- Blu-Ray Player & Sound Bar in Living Area
- 28" LED TV in Dining Area (37KT)
- 32" LED TV in Bedroom
- 13" & 24" LED TV with DVD Player in Bunk Bed Area (37TB)

- Bluetooth® Coach Radio System in Bedroom with Exterior Speakers
- Power Charging Center for Electronics
- Cable TV & HDMI Video Ready
- Digital TV Antenna
- Exterior 32" LED TV
- Exterior Kitchen with 2.6 cu. ft. Refrigerator, Sink & Portable Gas Grill (36TL)

## ENTERTAINMENT OPTION

- Storage Area with Shelf IPO Exterior Kitchen (36TL)

## ELECTRICAL & PLUMBING

- Onan® RV QG 5500 Gas Generator
- 50-amp Shoreline Power Cord
- 1800-watt Inverter
- Automatic Generator Start
- Dual 13,500 Low-Profile Roof Air Conditioners
- Dual Auxiliary House Batteries with Battery Tray that Holds up to Four (4) Batteries
- Battery Disconnect Switch
- 55-amp Converter
- 6-gallon DSI Gas/Electric Water Heater
- Water Heater Bypass System
- Enclosed & Heated Holding Tanks
- Whole Coach Water Filtration System
- Black Tank Flush System
- Outside Shower
- Stackable Washer/Dryer Prep (37KT, 37LX & 37YT)
- Washer/Dryer Combo Prep (36TL & 37TB)
- Systems Control Center
- Rapid Camp® Wireless Control System

**IMPORTANT-PLEASE READ:** This brochure reflects product design, fabrication, material, components and specifications at the date of printing, which date is disclosed below. Please visit us online at [ThorMotorCoach.com](http://ThorMotorCoach.com) or consult with your selling dealership for the latest in standards, options, specification and technical information. Photographs in the brochure may depict optional equipment or may only be available in certain floor plans. Components, appliances and the chassis may have been manufactured in a calendar year before the vehicle's designated model year. All capacities are approximate. The actual length of the vehicle may differ from that indicated in the brochure due to variances in the manufacturing processes and/or installed components. All dry weights are based on standard model features and do not include optional features or equipment. Component part and appliance manufacturers issue limited warranties covering portions of the vehicle not covered under the limited warranty we issue. Copyright Thor Motor Coach, Inc. © OH 10/01/16

YOUR LOCAL THOR MOTOR COACH DEALER



**Made to fit.**

[thormotorcoach.com/challenger](http://thormotorcoach.com/challenger)

P.O. Box 1486, Elkhart, IN 46515 Sales Department: 800.860.5658 Customer Service: 877.855.2867

