



## WIRELESS LED TAILGATE SPEAKER

PBT3027 | USER MANUAL



Questions?  
Need some help?  
This manual will help you  
enjoy your new product.



If you still have questions,  
call our help line:  
1-877-768-8481



or visit us at:  
[www.southern telecom.com](http://www.southern telecom.com)  
Click on "Product Support"

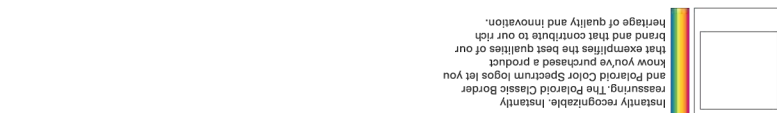

Note: This equipment has been tested and found to comply with the limits for a Class B digital device, pursuant to part 15 of the FCC Rules. These limits are designed to provide reasonable protection against harmful interference in a residential installation. This equipment generates, uses and can radiate radio frequency energy and, if not installed and used in accordance with the instructions, may cause harmful interference to radio communications. However, there is no guarantee that interference will not occur in a particular installation. If the equipment does cause harmful interference, which can be determined by turning the equipment off and on, the user is encouraged to try to correct the interference by one or more of the following measures:

- Reorient or relocate the receiving antenna.
- Increase the separation between the equipment and receiver.
- Connect the equipment into an outlet on a circuit different from that to which the receiver is connected.
- Consult the dealer or an experienced radio/TV technician for help.



### IN THE BOX

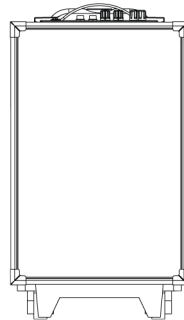

Wireless LED  
Tailgate Speaker

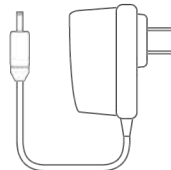

Charging Adaptor

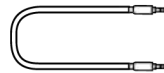

3.5mm Auxiliary  
Cable

### USING THE SPEAKER

#### Power ON and OFF

- Turn the speaker on by sliding the [ON/OFF] switch to the ON position.
- Turn the speaker off by sliding the [ON/OFF] switch to the OFF position.

#### Adjusting the Volume

Adjust the volume by turning the Master volume control knob.

- Turn the master volume control knob to the left to increase the volume.
- Turn the master volume control knob to the right to decrease the volume.

#### Playing Music

To enjoy music wirelessly on your speaker, make sure that the speaker is properly paired to your Bluetooth-enabled device. If you are pairing the speaker for the first time, go to the "Pairing the Speaker" section of this user manual.

Use the controls on your Bluetooth-paired device to play and pause music or to skip tracks.

### LOCATION OF CONTROLS

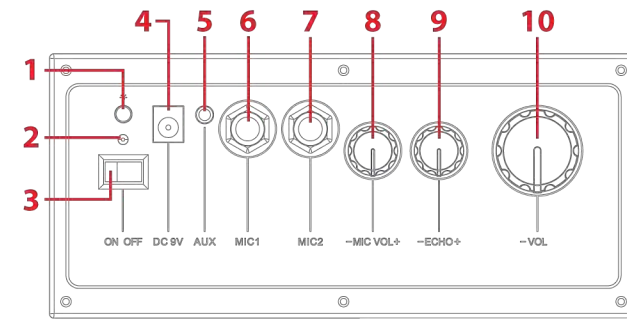

(Top - Control Panel)

1. [ ] Button
2. LED Indicator
3. [POWER] Switch
4. DC 9V Power Jack
5. AUX-In Jack
6. Microphone 1 Input Jack
7. Microphone 2 Input Jack
8. Microphone Vol Knob
9. Microphone Echo Knob
10. Volume Knob

### USING THE SPEAKER (cont'd)

**NOTE:** Microphone not included.

#### Using the Mic Inputs

To use a microphone, plug the 1/8" connector of the wired microphone cable into either the MIC 1 or MIC 2 input jacks.

**NOTE:** Music will continue to play while using the microphones.

#### Adjusting Mic Volume

- Turn the Mic Volume knob to the left to decrease microphone volume and turn to the right to increase microphone volume.

#### Adjusting Mic Echo

- Turn the Mic Echo knob to the left to decrease microphone echo and turn to the right to increase microphone echo.

### CHARGING THE SPEAKER

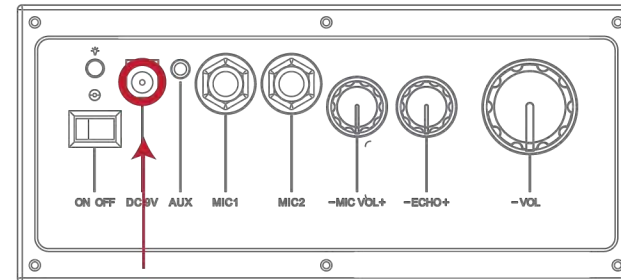

To charge the speaker, attach the charging adaptor to the DC 9V power jack. Plug the adaptor into a working wall outlet. The LED indicator will turn solid RED while charging and turn off when finished.

### USING AS A WIRED SPEAKER

To use the speaker as a wired device, attach the 3.5mm AUX cable to the AUX-in jack and attach the other end to the headphone jack on your media-playing device.

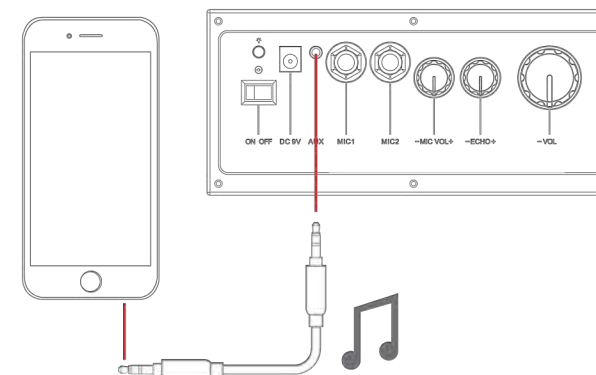

Connecting the audio cable will override Bluetooth mode if it is enabled. When the cable is disconnected, the speaker will automatically reconnect to the last paired device if Bluetooth mode is enabled.

### PAIRING THE SPEAKER

1. Slide the [POWER] switch to the ON position. A tone will be heard, indicating that the speaker is pairing mode. The LED indicator will quickly flash BLUE.

2. Open the Bluetooth settings menu on your mobile device. Set your device to search for other Bluetooth-enabled devices nearby (for detailed instructions for pairing your Bluetooth-enabled device, consult your device's user documentation).

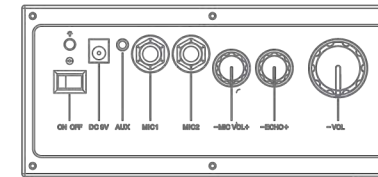
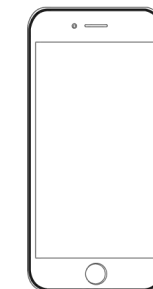

### PAIRING THE SPEAKER (cont'd)

3. Locate the speaker's model number (**PBT3027**) from the list of discovered devices and press it to complete the pairing process.

**NOTE:** If prompted for a password, enter **0000** (four zeros). This step may be necessary for older Bluetooth-enabled mobile devices.



### PAIRING THE SPEAKER (cont'd)

4. Another tone is heard, indicating that your mobile device has successfully paired with the speaker. The LED indicator will slowly flash BLUE.

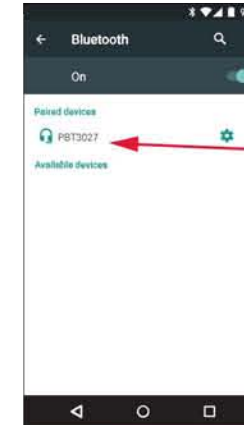

Found devices



The screenshots above are typical of many Bluetooth-enabled devices in the market today, and are used to assist in the explanation of the pairing process. Your Bluetooth-enabled device's interface and interaction with the speaker may differ slightly from the illustrations shown.

### TROUBLESHOOTING

I can pair the speaker with my Bluetooth device, but I cannot hear any music.

1. Make sure your Bluetooth device supports A2DP profile.
2. Turn up the volume on your Bluetooth device.
3. You may have to unpair the speaker, then re-pair to your device.

My Bluetooth device is not able to pair with the speaker.

1. Make sure the speaker is turned ON before beginning the pairing process.
2. Keep the speaker and Bluetooth-enabled device within 3 feet of each other during the pairing process.
3. Check that YOUR device's Bluetooth feature is turned ON.
4. Try repeating the pairing process; see "Pairing the Speaker."
5. Make sure the speaker is charged.

I cannot get the speaker into pairing mode.

1. Make sure the speaker is turned ON before beginning the pairing process.
2. Keep the speaker and your mobile device within 3 feet of each other during the pairing process.
3. Check that the speaker is charged.

### WARRANTY

This product as supplied and distributed new by AIT, Inc. ("AIT") to the original consumer purchaser is warranted by AIT against defects in material and workmanship for a period of one year from your date of purchase ("Warranty"). In the unlikely event that this product is defective, or does not perform properly, you may within one year from your original date of purchase return it to the authorized service center for repair or exchange.

#### TO OBTAIN WARRANTY SERVICE:

- Call the Customer Support number located below, or go to our website portal to receive an SRO number.
- Provide proof of the date of purchase within the package (Dated bill of sale).
- Prepay all shipping costs to the authorized service center, and remember to insure your return.
- Include a return shipping address (no P.O. Boxes), a telephone contact number, and the defective unit within the package.
- Describe the defect or reason you are returning the product.

Your product will be repaired or replaced, at our option, for the same or similar model of equal value if examination by the service center determines this product is defective. Products received damaged as a result of shipping, will require you to file a claim with the carrier.

The shipping address of the authorized service center is:

Customer Service Dept. 36  
c/o Southern Telecom  
400 Kennedy Drive  
Sayreville, NJ 08872

IN NO EVENT WILL AIT, ITS MANUFACTURERS, DISTRIBUTORS OR PLR IP HOLDINGS, LLC BE LIABLE FOR ANY INCIDENTAL, DIRECT, INDIRECT, SPECIAL, PUNITIVE OR CONSEQUENTIAL DAMAGES (SUCH AS, BUT NOT LIMITED TO, DAMAGES FOR LOSS OF PROFITS, BUSINESS, SAVINGS, DATA OR RECORDS) RELATED TO THIS PRODUCT. EXCEPT AS STATED HEREIN, NO OTHER WARRANTIES SHALL APPLY.



Questions?  
Need some help?  
This manual will help you  
enjoy your new product.



If you still have questions,  
call our help line:  
1-877-768-8481



or visit us at:  
[www.southern telecom.com](http://www.southern telecom.com)  
Click on "Product Support"