



# tekweek

Tektronix, Inc., Beaverton, Ore., Oct. 4, 1963, vol. 4, no. 25



## Share transfer steps outlined

By VERNE GRIFFITH

Some details of the proper procedure to transfer Tektronix shares without going through a broker seem to be still unanswered. The following is a more detailed outline of the procedure to follow:

If the transaction involves the sale of *all* the shares on a certificate to one purchaser:

1) Fill in on the back of the certificate the number of shares that appears on the face. (The space for attorney should be left blank.) Take the certificate to your bank and ask them to guarantee your signature.

2) Deliver the certificate to the buyer together with the transfer tax which is four cents per \$100 or major fraction (\$50.01 to \$99.99 is a major fraction) of the amount of the transaction, with a minimum of four cents per transaction.

3) The buyer should properly fill in his name the way he wants to appear, his social security number and his address—all on the back of the certificate.

4) The buyer should make out a "Valuation Certificate" on a separate piece of paper. This should contain essentially the following: "The accompanying shares submitted for transfer have an actual value in the amount of \$\_\_\_\_\_ as determined by the sales price or the quoted prices or other facts." This statement should be signed by the purchaser, and the word "Transferee" should follow the signature.

5) The buyer should then send the certificate, the "Valuation Certificate", and the tax money (always send the *exact* amount) to the Tektronix Transfer Agent.

Continued on Page 2

## Group-rep session, tours and movie launch UGN campaign drive at Tek



PORTLAND CENTER FOR SPEECH & HEARING was toured Monday by a Tektronix group. The center, located at 3515 SW Veterans Hospital rd., is a non-profit voluntary health agency partially supported by UGN. It is affiliated with the University of Oregon Medical School Department of Ear, Nose and Throat. Warren E. Johnson, M.A., director, showed audiological assessment equipment (center photo) and ushered Teks through the building. Considering themselves fortunate, three employees paused to look at hearing aids displayed there.

"If you don't care, who will?"

The 1963 UGN drive moved into full swing this week. A \$100,000 goal has been set for employees this year, Bob Fitzgerald (Vice-president, Operations), Tek campaign chairman, told department managers at a special meeting Monday. The operating managers reviewed and approved the UGN plan last week.

Last year Tektronix employees gave a total contribution of \$97,098 with 85.2 per cent of employees participating. This year employees who can, are urged to contribute 87 cents per pay period—a penny for each of the 87 UGN-benefited agencies. Those of bigger income are asked to refer to the UGN "fair share" scale on the back of the pledge card.

Each area's performance report will be in terms of UGN fair share percentage, not dollar con-

tributions. Group representatives will assist in this year's fund drive by reporting information presented at a mass group rep meeting Tuesday, in Building 45 cafeteria. At the meeting, Fitz presented a campaign schedule and outlined the procedures. Group reps viewed a short Tektronix-produced UGN film entitled "Their Profit Share."

About 45 selected managers and group representatives toured UGN-supported agencies Monday through Thursday.

This week (Tuesday through Friday) department managers appealed to their supervisors. Next week (October 9-13) group managers will hold individual meetings and pass out pledge cards for employees to sign. All meetings will include a showing of "Their Profit Share."

Managers have until Wednesday,

October 16, to collect the pledge cards. The resulting payroll deduction changes will appear in the paycheck distributed October 25.

"If you don't care, who will?"

## ERA/ISA show to open next week in Seattle

Tektronix will exhibit in booths 103-104 at the 1963 ERA/ISA exposition in Seattle next week, October 9 and 10, at the Seattle Center display hall.

ERA/ISA stands for Electronics Representatives Assn. and Instrument Society of America.

Featured instruments will be the Type 647 new environmentalized oscilloscope; the Type 585A scope; Type 567 digital readout scope with the Type 262 programmer; Type 564 general-purpose storage scope; the Types 661 and 502A scopes. Other instruments, plug-in units, trace-recording cameras and accessories will be shown.

## New phones connected for Bldg. 47 offices

These three employees have new delivery station numbers and/or telephone extensions in Plant 4:

	Phone	Del. sta.
Earl Wantland	7394	47/340
Myrna Martin	7393	47/340
Homer Speer	7397	47/354

Their numbers and addresses do not appear in the current edition of the Tektronix telephone directory.

## Group reps, managers tour eight UGN agencies

Group representatives and managers got a first-hand look this week, at eight of the eighty-seven United Good Neighbor agencies in the tri-county area.

"Seeing these agencies personally," one employee remarked, "was an experience I will never forget. I am proud to be a part of a society that so willingly gives assistance to its fellow man. I am proud of, and thankful for, the nurses, doctors, teachers and other volunteers who are giving so freely of their time and talents and, literally, giving of themselves. More than ever I realize how little I am doing to help."

Monday through Thursday four tour groups each saw two of the following agencies: White Shield Home, Portland Center for Hearing & Speech, United Cerebral Palsy (OO Workshop), Volunteers of America Day Nursery, Boys and Girls Aid Society, Research Center—Oregon Heart Assn., Rehabilitation Institute of Oregon and the Fruit & Flower Day Nursery.

These employees participated in the tours and reported back to their groups and departments about what they had observed:

Bill Lowery, Chuck Gasser, Doug Hubbard, Bill Swift, Dick Jamerson,

Ed Srebnik, Esther Miner, Rick Roskopf, Phyllis Jensen, Walt Range, Howard Bingham, Art Stipe, Pete Keitges, Mary Dober, Bill Lee, John Hoekstra, Bob Ricks, Cal Smith.

Carl Taylor, Dale Derby, Jerry Maxwell, Rod Kennedy, Don Postlewaite, Chris Christensen, Gale Byars, Pat Nordone, Gloria Prince, Errol Livesay, Marlow Butler, Jack Rogers, John Mepham, Ralph Ulrich, Egon Ellsner, Bill Parker, Bill Brown, Pat Steerman, Bobbie Klink, Roy Slack, Gerry Taylor, Ingeborg Pierce, Dorothy Thorson.

Jim Margeson, Loyde Osburn, Wally Blackburn, Bob Swanson, Floy Parries, Ted Hiatt, Jim Cobain, Dick Machlan, Mary Whitcher and Lois Lockwood.

Tours were arranged by the Plant Supporting Services department.

## Share transfer

Continued from Page 1

DO NOT send a stamped self-addressed envelope as was previously reported. The Transfer Agent is required to return the certificates in its own envelope.

If the transaction involves the sale of only a part of the shares on a certificate, or if a part of the shares are sold to one person and the remainder to another person, do not perform step (3) above but leave this blank and attach a letter explaining what you want done. Show each purchaser's name, social security number and address and the number of shares that he is buying. If some of the shares are to be reissued to the original owner, show the number of shares and the address to which the new certificate is to be returned. Be sure that the sum of these equals the number of shares shown on the front.

Send the certificate, the letter of instruction, the "Valuation Certificate", and the tax money to the Tektronix Transfer Agent.

Remember the Tektronix Transfer Agent is the Corporate Trust Division, United States National Bank of Portland, P. O. Box 3168, Portland 8, Oregon.

Any further questions concerning the new Tektronix Inc. shares or the old TEKEM shares should be addressed to Les Stevens or Verne Griffith at ext. 7644 or delivery station 74-200.

If any of the shareholders have been married or otherwise changed their name, call Les or Verne for instructions as to how to get new certificates registered in the new name.

## Tek's new salary guide covers new wage laws

With the new minimum wages now effective under both the Walsh-Healey and Fair Labor Standards acts, and new tests of determining persons exempt from these laws, the 1961 Tektronix Reference Guide has been revised by Salary Administration. The revised TRG explains provisions of both federal acts and the Oregon labor law on wages and hours.

Copies of the 1963 guide are being distributed to all managers. Also included is a summary of the federal "equal pay" amendments, barring discrimination due to sex. Oregon has had such a law on the books since 1955.

The Fair Labor Standards act wage revisions went into effect September 3, 1963; Walsh-Healey changes were effective June 28, 1963.

**TEKWEEK** is published every Friday for Tektronix employees by the Communications department, 74/298, ext. 405, in cooperation with the Printing and Photography departments. Staff: Dick Koe, editorial manager; Carol VanderZanden, editor-writer; Jane Martin, staff writer; Charlotte Sneathen, Trading Post; Graphic Arts group layout and pasteup.

## PI booth: Photos, scopes, film

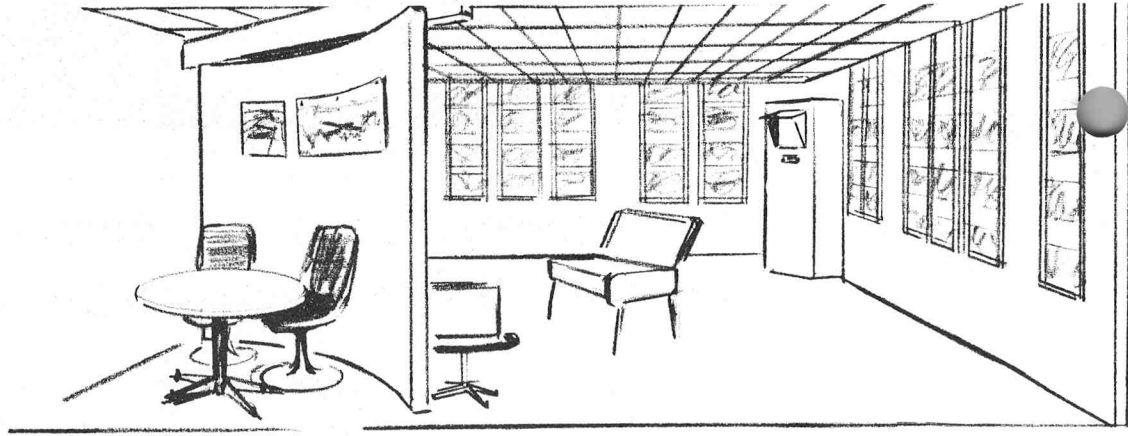

A MODERN, CONTEMPORARY-STYLED BOOTH is being put together for this year's Pacific International, October 12-20, through the efforts of Ken Ireland (Communications, Graphic Arts), booth designer; Tom Williams (Plant Supporting Services manager), coordinator; Harry Allison (Advertising), scope display; Levi Brekken, Mel Morlock and Al Krueger (Facilities, Carpenter Shop), construction. The booth walls are lined with burlap with a blue rug for the floor.

## Junior Achievement gets new advisors

Advisors for the Tek-sponsored Junior Achievement company for 1963-64 are Dick Falk (Employee Relations), management advisor; Norm Silver (Employment), sales advisor; and Al Hayes (Plant 2, Assembly GM), production advisor.

The advisors are now involved in training sessions. They will meet with their Junior Achievement group next Tuesday.

## Departments cooperate to build exhibit for Pacific International

Tektronix' booth for the nine-day Pacific International Live-stock Exposition (PI), October 12-20, is taking shape with Plant Supporting Services, Advertising, Facilities and Communications departments arranging for Tek's display.

It includes: Panels of photographs of scope applications, pro-

duction processes and industrial park scenes; a working display of Tektronix instruments (Types 564, 567 with a 6R1, 502A, 321 and 661); and a five-minute film clip composed of sequences from the Tektronix-produced film, "Tektronix."

Both men and women employees representing all divisions of the company are being selected as booth-tenders.

The Tektronix, Inc. booth is A-9, near the main entrance of the PI building. Neighboring booths will be set up by such local firms as Pacific Northwest Bell Telephone, Northwest Natural Gas and Portland General Electric.

"Pacific Northwest — Future Unlimited" is the theme of the PI this year, which will be held in the PI exhibit building in North Portland on Columbia Blvd.

PI-goers will also be able to see a championship rodeo and horse show; a 20th century revival of Roman chariot races; prize beef, dairy cattle, horses, hogs, sheep, poultry of the West; a wild-game and fish exhibit; flower show and many more displays.

Gate admission for the PI is \$1.00 for adults; children under 12 free. Rodeo and horse show tickets (including gate admission) are \$2.00, \$2.50 and \$3.00. Children's tickets for the show are \$1.00 less than adult fare.

## Credit Union announces its policy on Tektronix, Inc. share dealings

Ted Shaver, board member of Tektronix Employees' Federal Credit Union, gave the following information this week on the Credit Union and Tektronix, Inc. shares:

**Stock Loans**—As announced in last Friday's Tekweek, the Credit Union will loan up to 70 per cent of the previous week's average bid price on Tektronix shares at  $\frac{3}{4}$  of 1 per cent per month on the unpaid balance.

Loan value will be set on the first of each week and will remain at that value for that calendar week. As with any other lender, if the value of the security drops to less than 70 per cent of the balance due to the loan, additional collateral may be requested.

**Stock Sell Orders**—Since it is no longer a simple transaction as was the sale of TEKEM, the Credit Union has made an agreement with Walston & Co.; Blyth & Co.; Merrill, Lynch, Pierce, Fenner & Smith; and Dean Witter & Co. to act as brokers for the Credit Union if it becomes necessary to sell stock.

This arrangement can, on request, sell a member's security, receive the proceeds of the sale, pay off the loan and place the remainder into Credit Union shares to be withdrawn at the member's discretion.

If the Credit Union is holding more collateral than needed, the loan may be renegotiated and whole certificates returned to the member. It is also possible to have a certificate split and a part returned.

All members having shares at the Credit Union not pledged as collateral are requested to pick up their certificates.

**Stock Powers**—Stock powers must have a guarantee of signature. As presently stated on the Tektronix Stock Certificate, signatures must be guaranteed by a commercial bank, trust company or a stock exchange or other security dealer whose signature is approved by the transfer office (The United States National Bank of Portland).

In order to provide one-stop convenience for its members, the Credit Union has asked for approval to act as a signature guarantor. Authorization is expected soon.

Larry Bowman (Semiconductor Devices), Ed LaBerge (Ceramics Engineering manager) and Bob Skidmore (Ceramics) left Sunday, September 29, to attend a meeting of the Electronics division of the American Ceramics Society in Gatlinburg, Tenn., October 2-4.

### FREE

**ONE MAD DOG:** take over pending lawsuits. Gale Byars, ext. 7474.

**ROCK FOR ROADS:** fills, etc.; mixed fine to fist-size, U-haul, free, Loyde Osburn, ext. 7241 or JE 8-3923.

### ACREAGE

**CABIN SITES:** Alesia river frontage, approx. \$15 ft. MI 4-7542.

**PANORAMIC VIEW:** of valley and coast range, 135x135 dyft. bsmt. sites, \$6000. NW 124th. 234-8818.

**MISC. FOR SALE**

**SUFFOLK SHEEP:** 2 ewes, \$25 ea. Dorothy Merritt, AV 6-1187.

**FORMICA DINETTE TABLE:** stain. steel pedestal, cast iron base, \$13 or trade for 3-burner camp stove. Ext. 7327 or 2-5164.

**ENGLISH BIKE:** re-cond., \$25; camp stove, 2-burner, \$7.50. MI 4-4188.

**CHEV TRUCK ENGINE:** complete, w/4-speed trans. & pwr. take-off, excel. cond., \$195. MI 4-9752.

**BUNK BEDS:** steel, 2 sets, \$10 set. CH 6-5083.

**FOLK GUITAR:** 6-string, mahog. body, cedar top, rosewood neck, very mellow tone, had gd. care, w/case, capo & pick, \$20. Glenn, ext. 452 or OL 4-4671.

**ROCK TRIM SAW:** 10-in. Franton w/motor, auto. feed, plastic cover, \$100. MI 4-9287 eves, or Don, ext. 7206.

**RARE ANTIQUE BUY:** white marble-top table, Victorian dresser, needs refinish., \$50. MI 8-1625.

**GE UPRIGHT FREEZER:** 20 cu. ft., \$198.50. MI 4-5312.

**CARTOP CARRIER:** 36x48, covered, like new cond., \$12.50. MI 8-3806.

**WINCHESTER:** 22 auto. rifle. \$25; AM-FM table radio, \$15. Lloyd, ext. 266 S.

**DEER HUNTERS:** meat wrap paper, pre-cut in 35x40 sheets; have 100 lbs., sell all (\$15) or part (25 cents lb.). MI 4-5625.

**WOMEN'S ROLLER SKATES:** Chicago, in case, size 8, like new, \$30. Donna, ext. 333 S or 282-5345 aft. 6.

**RADIO CRYSTALS:** set 15, 58.6 mc to 72.6 mc by 1 mc steps; highest bidder takes. Ray Nelson, ext. 7314.

**BE READY:** for the Oct. 12 storm with Kamp-Kook camp stove, burns reg. or white gas, \$8.50. Ray ext. 346 S.

**13-FT 9-IN BOAT:** w/steering & trailer, \$75. Bob Valley, ext. 295 S or BU 9-0782.

**ADMIRAL HI-FI:** port., 4-speed, auto., \$35. Dolores, ext. 7796 or 9708.

**MAPLE SOFA:** gd. cond., \$35. MI 4-0238 aft. 4:30.

**2-WHEEL TRAILER:** custom built, all alum., sleeps 2, butane stove, 50 gal. water tank. Best offer. MI 4-7520.

**STURDY CRIB:** & matt., \$15; highchair \$3.50. MI 4-6374.

**335 CHEV CAM:** \$10; David Bradley rototiller, used approx. 2 hrs., \$75 or trade. Larry, ext. 7175 or 292-5514.

**GIRL'S BIKES:** 20-in., \$12; 26-in., \$15; 4-spring rocking horse, \$9.50. Steve, ext. 7606.

**HAM GEAR:** Viking Ranger I transmitter w/time seq. keying, excel. cond., push-to-talk, \$160. Don Tucker, MI 6-1765.

**ALTO SAXOPHONE:** gd. cond., \$85. Norm Gust, MI 6-2874.

**FORMICA-TOP TABLE:** yellow, oval, 30x48, ex. leaf, \$15; Craftsman reel mower, \$18; earth shredder & grinder, \$20. John Fremault, MI 6-3771.

**NEW WEDDING DRESS:** size 8, \$22.50. BE 4-1808.

**PISTOL:** Crosman 150, 22 cal. pelgun, carbon-dioxide powered, \$8. Don Clark, ext. 7466.

**ANTIQUÉ WRITING DESK:** and bookcase comb., curved glass, \$100. MI 8-3287.

**WINCHESTER:** mod. 12, 12 gauge shotgun, full choke, \$75 or best offer. John, ext. 7324.

**TERRY TRAILER:** 16-ft. '60 mod., elec. brakes, wall furnace, extend. hitch, heavy-duty springs, gd. tires, sleeps 5, excel. cond., \$1150. MI 8-1654 aft. 5.

**LACE WOOD:** \$15 lge. pickup delivered; \$16 per cord U-haul. MI 4-8115 or MI 4-6321.

**RED WOOL DRESS:** size 11-12, full lined, like new, \$12. MI 8-5236.

**MOTOROLA STEREO:** port., 3-channel, 5-speaker, 4-speed, w/stand, \$150. Bob Zurcher, ext. 369 S or MI 4-4864 aft 5:30.

**MISC. FOR SALE**

**HAM GEAR:** Gonset Twins, G66 & G77, \$200; Elmac AF-67, \$85. Lloyd, ext. 344 or BE 4-9163 aft. 5.

**TRAILER HOUSE:** 15-ft., '56 Cardinal, gd. for fishing & hunting, excel. cond. \$695. Arlin, ext. 351 or CY 2-6176.

**ITALIAN ACCORDION:** & case, 120 bass, \$75. BE 5-1903 wkends, eves.

**'59 PONTIAC ENGINE:** 280 hp, compl. rebuilt & guaranteed, \$350. MI 6-3437.

**SHEPHERD PONY:** 3-yr. old, gentle, Best offer. MI 4-3746.

**GIRL'S BIKE:** 20-in., \$20. Floy, ext. 452 or AL 3-5097.

**GLO-BAR:** use to operate 6 volt auto radio on 12 volts, new, \$3. LeMoyné, ext. 7136.

**SKI RACKS:** assort. sizes & colors, \$5 to \$10. 289-8116 afternoons bef. 3.

**LIBERTY HEAD NICKEL:** 1912-S, full Liberty. Best offer over \$30. BU 5-6530.

**POLAROID 80A CAMERA:** print copier, wink lite, flash gun, close-up lens kit, 3 rolls film case; cost over \$160, sell \$75. Ext. 217 or 292-1479.

**TOY POODLE:** silver gray, 16 mos. old, \$50. CH 6-5112.

**WOOL RUG:** 9x12 w/foam pad, \$20; 11-x16 foam pad, \$20; 9x12 cotton rug & match, 2x3, \$10. MI 4-0436.

**H-O LAYOUT:** eng., 4 cars, bldg. assort., trees, \$15. AL 3-5790.

**ADJUST. BABY BED:** w/matt., \$16; stroller \$4; fold. walker \$4; 2-wheel trailer \$35. Mary Losli, ext. 7696 swing or EL 7-9587.

**WHITE MINIATURE POODLE:** male, 7 mos., AKC reg.; trade for port. TV or \$75. Joe, ext. 223 S.

**HUSQVARNA DEER RIFLE:** 270, excel. cond., \$139 new, sell for \$100. Don, ext. 7270 or MI 4-2055.

**GARDEN MARK ROTOTILLER:** 3½ hp, 26-in. tiller width, friction reverse, 2 yrs. old, gd. cond., \$80. Walt, ext. 263 or OL 4-2844.

**DOG HOUSE:** for medium-size dog, new roof \$12 or best offer. Leon Duff, 665-2937.

**MODEL "A" PARTS:** Ruth Williams, page 7201.

**BEDSPREAD:** pink quilted, 2 pr. Priscilla curtains to match, like new, \$20. Helen Johnson, page 7201.

**ELEC. RANGE:** \$125; wringer washer \$75; metal lathe & motor \$125. Don, ext. 7460 or ME 9-3026 aft. 4.

**26-IN. RIDING MOWER:** Garden Mark, 5 hp Briggs & Stratton, variable speed clutch, bevel gear trans., 1 yr. old; cost \$284, sell \$170. Clyde, ext. 7585 or ME 9-4942.

**TRADE HAM GEAR:** for test equip.—RME 4300 & 90 watt CW homebrew transmitter. Jim Tester, ext. 7474 or JE 8-3789.

**STROLLER:** \$15; girl's 26-in. bike, \$12. MI 4-9630.

**GO-CART ENGINE:** 2½ hp Clinton, best offer. MI 8-1994 weekdays aft. 5.

**HAM GEAR:** CDR HAM-M rotor \$60; AR-22 rotor \$15; D-140 mike w/PTT stand \$17; Vibroplex bug \$12. Bob Wruble, ext. 583 or MI 4-0023.

**SEEBURG JUKE BOX:** 78 rpm only, \$40. MI 8-5459 aft. 4 p.m.

**16-FT TOLLYCRAFT:** Best offer. 288-2727.

**2-WHEEL TRAILER:** wired, \$65. MI 4-4032.

**REMINGTON:** 12 gauge pumpgun & leather case, \$25; sheepskin-lined case for rifle w/scope, \$4. Bob, ext. 315 S or MI 4-4808.

**COLLIE PUPS:** \$10, male & female, excel. health; Remington noiseless typewriter w/mimeograph carriage, \$40. Paul, ext. 375.

**CLOTHES DRYER:** used, 220V, \$35. Charles Rhodes, CA 8-3685.

**YORK TRUMPET:** excel cond., \$65. Edna Wetzel, CH 6-3080 aft. 4 p.m.

**TRADING POST** is a free service to Tektronix employees. Mail ads to delivery station 74-298 or call ext. 405. **Deadline:** Fridays at 12 noon, one week before publication. One ad per employee per week. Ads offering to buy or sell Tektronix, Inc. shares will not be accepted. Prices must be included on "for sale" items and rentals.

**RENTALS**

**1-2 BDRM:** Sunset apts., corner Cornell & Murray rds., range & refrig., unfurn., \$82.50 & \$59.50. Inquire: Apt. 8 or MI 6-1377.

**BOARD, ROOM:** & laundry; clean, quiet room; \$20 week. BE 2-5789.

**1-BDRM:** house, gar., 2845 SW 226th, Aloha, \$60. MI 8-3412.

**2-BDRM:** trailer house, Cornelius Manor trailer pk., 35 ft. w/compl. bath., \$65. Warren Brown, CH 4-4233 or MI 8-4645.

**1-BDRM:** neat, part. furn., 1-A, Hillsboro area, no children, \$50. MI 8-5948.

**1-BDRM:** bachelor apt., furn., Tigard area, \$50. AT 1-5705.

**2-BDRM:** lge. apt., birch kitch., builtin range & refrig., drapes & curtains, \$100. MI 4-0793 or MI 4-0635.

**1-BDRM:** house w/gar. & workshop, Aloha area, \$55. MI 4-1247 or Bill, ext. 390.

**2-BDRM:** all-elec. duplex w/fp, sep. util., attach. gar., close to Tek, bus, shop; \$88.50. 18393 Blanton st., Aloha.

**1-BDRM:** duplex, SxS, part. furn., liv. rm. w/fp, din. rm., kitch., full bath, gar., \$79.50. 10585 SW Denny rd. CA 6-2941.

**1-BDRM:** house, 53rd & Barbur, \$60. CH 4-2947 or KE 9-8666.

**2-BDRM:** triplex, gar., water & garb., no pets; prefer adults; 1 unfurn., \$65, w/child \$70; 1 furn., \$75. MI 4-1507.

**HOUSES FOR SALE**

**HOUSE TRAILER:** 1-bdrm, 42x8, 1800. MI 8-2276.

**3-BDRM:** dylt. bsmt., 2 fp, 2 bath, lge. gar., 1-A on creek, \$21,000; consider trade for home on farm in Hillsboro area. MI 8-3609.

**3-BDRM:** fam. kitch., builtin appli., drapes, & w/w carp. quarry tile ent., ceramic tile bath, 3 mi. to Tek, ½ bath in dble. gar., \$19,000. MI 4-4725.

**3-BDRM:** Hillsboro, 2 bath, lge. fp, lge. fam. rm. & party rm., patio, lots storage, dble. carport, l'scaped 1-A, \$20,500. MI 8-1693 or ext. 7491.

**2-BDRM:** dylt. bsmt., 2 roughed in bdrms. & 2/3 bath dnstairs, Sugar Plum Farms dist., \$16,900. Open Sunday, 1-7. Les Diehl, AL 3-0683 eves.

**3-BDRM:** bsmt., party rm., on sewers, 4 mi. from plant, \$17,500 w/\$1500 dn. CY 2-1879.

**3-BDRM:** 12195 SW Douglas, \$700 for equity, take over FHA. AT 2-9510 eves.

**3-BDRM:** w/w carp., fp, wooded jr. A, West Slope, detached bldg., FHA appr. \$12,675. 292-3858.

**WANTED**

**BLDG. TO RENT:** garage, small shop or shed w/elec., in Beav. area, reasonable rent. CY 2-4040.

**WOOD FURNACE:** reasonably priced. ME 9-3008 eves.

**HOUSEKEEPING ROOM:** large or small furnished apt., in Portland. Carolyn Swedberg, ext. 410, 7791 or MO 5-7833.

**DOMESTIC HELP:** woman to vacuum my home, 1 day a week; transp. furnished if needed. MI 4-0790.

**BABYSITTER:** my Beav. home, 7 a.m. to 4 p.m., transp. available. MI 6-4018 aft. 5.

**HEATH AC-IVTM:** model no. AV-1. Dick Moore, ext. 7796 or MI 4-5646.

**FULL CHARGE SITTING:** housekeeper; age 50-60, 4 children on farm; room, board, wages. ME 9-1922 eves & wkends.

**CARS FOR SALE**

'56 FORD: Victoria, hdtp., auto., \$450;

'53 PONTIAC: 4-dr., auto., \$150; both fine cond. Kathleen Stocking, ext. 7698 swing or EL 7-2527.

'55 CHEV: V-8, excel cond., \$565 or best offer. MI 8-5113.

'54 CHEV: gd. tires, new batt., \$200. MI 8-2760 aft. 5 p.m. or wkends.

'60 FALCON: 2-dr. stick, deluxe, r/h, w/s/w, excel. shape, \$925. AV 6-1769.

'56 METROPOLITAN: gd. cond., gd. tires, very economical, \$450. MI 8-5059.

'50 INT. PICKUP: long box, overload springs, gd. hunting rig, \$350 or best offer. Dale Derby, ext. 7185 or EL 7-9865.

'29 MODEL A PICKUP: partly restored. Make offer. MI 6-2511.

'53 FORD: needs some work, \$50 or make offer. CY 2-2746.

'61 MERCURY: Monterey, white; 2-dr., excel. cond., \$1800. Ext. 7326 or MO 5-0226.

'56 DODGE: 9-pass. station wagon, excel. cond., \$595. MI 4-8895.

'62 CORVAIR: 102 hp, 3-speed, runs great and looks as good, \$1695. Ext. 530 or MI 8-2235 aft. 4.

'59 CHEV: Bel-Aire, 6 cyl., stick, r/h, \$895. MI 6-3587 aft. 5.

'61 MONZA: coupe, 4-speed, buckets, w/s/w, radio, low miles, \$1500. Ext. 426.

'53 NASH: auto. trans., r/h, motor excel. cond., \$75. 246-5755.

'55 CHRYSLER: 4-dr., clean, \$350. Ext. 7327 or 246-5764.

'59 HILLMAN: deluxe convert., gd. tires; \$350 cash, \$450 terms. Joyce, ext. 7628.

'60 VESPA: 400 convert., \$195. CY 2-5353 Sat. & Sun., aft. 5:30 wkdays.

'54 PLYMOUTH: 4-dr., r/h, od, gd. tires, excel. cond., \$300. Sharon, ext. 664 or MI 4-9745.

'57 CHEV: V-8, 210, 4-dr., station wagon, pwr. glide, new paint, positrac., r/h, pwr. steer., clean, \$575. Ruth Krieger, page 7201.

'57 FORD: convert., new motor, w/s/w, auto., pwr. steer., good top, \$900. OL 4-1491.

'60 CHEV: white station wagon, V-8, auto., r/h, new tires, \$1500 or offer. Ext. 353 S or MI 8-4321 aft. 5.

'53 KAISER: Dragon, runs. \$50 or offer. MI 4-9767.

**CHILD CARE**

**RELIABLE, EXPERIENCED:** mother w/ references; hot lunches, fenced yd., play equip., \$2 day; 923 SE 11th, Beav. MI 6-4473.

**HILLSBORO:** my home, babysit 5 days a week. Mrs. Morilon, MI 8-2609.

**MY HOME:** in Beaverton. Mrs. Eva Preiskorn, MI 4-0821.

**CEDAR HILLS:** weekdays, my home; care for boy 9 yrs. old or so. MI 4-8143.

**FREE CHILD CARE:** for working mother; need playmate (1 child only, age 2-3) for my 2-yr.-old boy, Bel-Aire dist. MI 4-1398.

**CHRISTIAN MOTHER:** care for children 2-6; fenced yd., play equip. & playmates; over year's experience, ½ blk. W of Beav. hi. MI 4-7666.

**RIDES WANTED**

**FROM 12TH & JEFFERSON:** to Bldg. 47, swing shift. Don Wright, ext. 7313 swing.

**FROM 130TH & STARK:** to Bldg. 47, 7-3:30 shift, starting now. Suzanne Olson, ext. 672 or MI 4-9341.

**FROM 209 AVE:** nr. Reedville, to Plant 1, 7-3:30 shift. MI 6-2204.



RIDIN' HIGH aboard a war-time DUCK is favorite pastime of 10 Tek employees who share ownership in "ugly duckling". (Right) John McAllister (Research) ends demonstration ride and shows bulk by parking next to toy-like auto. DUCK'S deck hides spacious storage room below (left).

## Land and/or sea vehicle, DUCK, provides fun for 10 Tek families

The local press has referred to Tektronix several times recently as "the glamour industry of Oregon." Maybe our industry is glamorous, but one thing's certain—everyone at Tek doesn't drive a glamorous vehicle. In fact 10 employees take turns driving the biggest, greenest, least design-conscious, low-status hunk of metal and machinery that's been seen around for some time.

John McAllister, Norm Winningstad, Mike Park, Bill Polits, Larry Bowman, Bob Ricks, Donald Pratt, Roy Karr, John Rogers and John Kobbe are all co-owners in an amphibious "DUCK," which has been appropriately named "Donald."

Donald paddles its 31-foot self, plus as many as 30 adults and children, around the Columbia river and deposits them on dry-ground for picknicking, camping and fun, almost every sunny week-end. The children roll up in sleeping bags and sleep aboard the DUCK, and the parents pitch tents and sleep nearby.

Built in 1943 as a troop-carrier,

### Tek Bugs start season with ten 200-games

The pins were flying at Valley Lanes Tuesday (September 24) as the men of Tek Bugs bowling league rolled ten 200-plus games and some of the gals picked up difficult splits in their fine games. Two-hundred-plus games:

Arnold Brokaw 214; Tim Harnett 205 and 219, 596 series; Hal Krouth 223; Francis (Andy) Anderson 206; Bill Driver 211; Roger Tippet 216, 583 series; and (bowling way over his head) Harry Stewart, 227, 221, 230 for a 678 series.

### Tek Bug women highlighters:

Lorraine Stewart 216, 544 series (high for the evening); Marge Livermore had a 148 triplicate working, but lost her head and picked up the last five pins, finishing with a third-game score of 153; Helen Sherrod (104 average) raised her average with a 172 game; Audrey Stephenson picked up the 5-10 split; Lorraine Stewart cleaned up a real mess—the 4-7-9-10 split.

the DUCK can whip along at 40 mph on land and at about 10 mph on water, with a diet of one gallon of gas every five miles. It's equipped with a ship-to-shore marine radio, a 160 hp GMC gas engine, a 26-inch prop and enough fresh water in enclosed tanks to keep its passengers from getting thirsty for several days. The newest addition the craft is a fathometer, to measure depth, and according to John McAllister it's sensitive enough to detect a large fish or school of smaller fish, beneath the hull.

What happens when winter comes? Norm Winningstad reports the group plans to install a canvas convertible top, so the rain will run off the DUCK the way it should—and it might be seen on the Willamette from time-to-time, with fishermen aboard or even duck hunters. But mostly, Donald will be resting.

## Employees to receive IBM cards for flu vaccine shots next Friday

Polyvalent influenza vaccine will be available to Tektronix employees next Friday, October 11. A 50-cent payroll deduction will be made for those receiving the vaccine. Supervisors will distribute IBM payroll deduction cards on the morning of October 11 and those who do not wish to receive the flu shot may throw their cards away. Employees must bring the IBM card with them to the immunization center.

Only employees (no dependents) can receive the vaccine and no make-up shots will be given. Minors (single persons under 21) must have written permission from parents or guardian before receiving the flu vaccine. Permission forms may be obtained at the nurse's offices and all minors must bring the signed form with them.

The vaccine will be admin-

### Flag football:

## Wallopin' Wolverines cop top league notch—so far

TEK FLAG FOOTBALL LEAGUE						
Second Week Standings						
	W	L	PF	PA	Pct	GB
Wolverines (Whse. 70)	2	0	41	18	1.000	...
Falcons (Finals)	1	0	18	6	1.000	...
Stompers (Whse. 71)	1	1	37	39	.500	1
Alchemists (Electrochem)	0	1	6	15	.000	1½
Thunderbolts (Plant 3)	0	2	20	43	.000	2

### LAST WEEK'S RESULTS

Falcons 18, Thunderbolts 6  
Wolverines 26, Stompers 12

### NEXT WEEK'S GAMES

Tuesday: Falcons vs. Alchemists  
Thursday: Wolverines vs. Thunderbolts  
Bye: Stompers

### By ED DAVIS

The fleet-footed Finals Falcons outran and outscored the Plant 3 Thunderbolts 18-6, Tuesday, September 24.

A Bill Hardin-to-Jim Tennyson pass was the only paydirt the Thunderbolts could scrape up. Jim Tennyson (at this point) took over second place in the scoring race.

Doyce Brown hit Bob Pyritz with a short pass for the Falcons' first goal, than a pass-run combo from Richardson to Doyce clicked for number two. The third jaunt into the end zone was unexpected but welcomed when Bob Richardson intercepted a Thunderbolt pass and scampered all the way back to score.

On Thursday, September 26, the Warehouse Wolverines chewed the Stompers down, 26-12.

Stompers scoring was limited to two touchdowns: a 40-yard pass-run from Gerry Johnson to John Flett and a 10-yard payoff run by Harve Dethlefs.

Wolverine scoring was spread out considerably: Dick Snyder scored; Delano Dalesky pitched to Don Craig for the P.A.T.; Austin Carpenter intercepted a pass and ran it back for TD No. 2; Dick Snyder threw to Bill Dreyer for TD No. 3; Delano Dalesky ran for the fourth TD and then passed to Dick Snyder for the P.A.T.

The Stompers scored first in both halves of the game, but couldn't hold off their East-Warehouse neighbors.

See inter-departmental flag football games every Tuesday and Thursday afternoon at the field between Mears and the IO building on Millikan way. Games begin at 4:30.

## CRT, Soldering films to be available soon

Two new films, produced by the Communications department Films group, will soon be available for in-plant viewing.

"Cathode-Ray Tubes: Inspecting and Testing" is a 22-minute film, color with sound, that shows some of the defects a technical man might encounter with cathode-ray tubes. Employees would like to schedule or preview the film, or obtain more information, may contact Jack Milway (MSE), ext. 345 or 47/251.

"Soldering Ceramic Strips, No. 2" details the techniques of soldering and shows newer soldering methods. Techniques to be used on the new smaller strips are described. The film runs 22 minutes and is color with sound. For information, previewing or scheduling call Charlotte Sneathen (Communications), ext. 7176.

## CALENDAR

Tek Foto Films—Monday, October 7, 7 p.m., Plant 3 conference room.  
Tek Fall Handicap golf—tomorrow, October 5, Rose City course, tee-off 10:30 to 11:30.

## Job Postings

Tektronix employees should contact Alice Kida, ext. 7620 (8-7620 from Sunset), to apply for positions listed in JOB POSTINGS.

**CUSTODIAN:** Men to work swing shift for the Building Services group of the Facilities department of Central Staff Services (J.P. no. 4710).

**FUNCTIONS:** Keep factory areas, wash rooms and offices clean and orderly.  
**QUALIFICATIONS:** Previous janitorial experience desired, but not required; excellent physical condition.

**RECEPTIONIST:** Woman to work swing shift for the Purchasing department Materials Management (J.P. no. 2277).  
**FUNCTIONS:** Sort and distribute mail; answer telephone call director; file purchase orders, letters and catalogs.  
**QUALIFICATIONS:** Attention to details; ability to work with numbers; filing; typing desirable but not required.

istered at the following times and locations:

Bldg. 45 (Cafeteria)—7 a.m. to 12 noon; 4:30 to 5:30 p.m.  
Bldg. 86 Conf. Rm.—1 to 2 p.m.  
I.O. Conf. Rm.—2:30 to 4 p.m.

Swing shift personnel will receive their shots in building 45. Those groups who have not been assigned a definite time and place can report to whichever location is most convenient at the scheduled times.

Persons with cold or flu symptoms should get their flu shot from their personal physician after the symptoms are gone. Those who have severe allergies (especially egg or chicken) should check with their family doctor before taking the vaccine.

Further questions may be answered by calling one of the nurses at ext. 562 or ext. 303-S.