

# Oster<sup>®/MD</sup>

*User Manual*  
*Manuel de l'utilisateur*

## **My Blend<sup>TM/MC</sup>**

### **Blender** **Mélangeur**



Fill.  
Blend.  
Go.  
Reuse.

Remplissez.  
Mixez.  
Partez.  
Réutilisez.



# IMPORTANT SAFEGUARDS

**When using electrical appliances, basic safety precautions should be followed, including the following:**

## **READ ALL INSTRUCTIONS BEFORE USE**

- To disconnect, grasp plug and unplug cord from electrical outlet.
- To protect against risk of electrical shock, do not immerse the cord, plug or motor base in water or any other liquids.
- Do not let cord hang over edge of table or counter or touch hot surfaces.
- Never leave appliance unattended when in use.
- Close supervision is necessary when used by or near children.
- Avoid contact with moving parts. Keep hands and utensils out of sport bottle while blending to prevent personal injury or damage to the blender.
- The blade is sharp. Handle with care.
- To reduce the risk of injury, never place cutter-assembly blades on base without sport bottle properly attached.
- Do not attempt to bypass the interlock system that powers the unit on.
- Do not blend hot liquids in the blender.
- Do not operate any appliance with a damaged cord or plug or after the appliance malfunctions or is dropped or damaged in any manner. Return the appliance to the nearest Authorized Sunbeam Appliance Service Center for examination, repair or electrical mechanical adjustment.
- Do not use outdoors or for commercial purposes; this appliance is for household use only.
- Always operate on a flat surface.
- Unplug the blender when not in use, before taking off or putting on parts and before cleaning.
- Use this appliance for its intended use as described in this manual. The use of attachments not made by the manufacturer, including canning or ordinary jar and processing assembly parts, is not recommended by Sunbeam Products, Inc. and may cause a risk to persons.

**THIS PRODUCT IS FOR HOUSEHOLD USE ONLY**

## POWER CORD INSTRUCTIONS

Please follow the instructions below to ensure the safe use of the power cord.

- This appliance is equipped with a polarized plug. This type of plug has one blade that is wider than the other. This plug will fit in a polarized outlet only one way. This is a safety feature intended to help reduce the risk of electrical shock. If you are unable to insert the plug into the outlet, reverse the plug and try again. If it still does not fit, contact a qualified electrician to replace the obsolete outlet. Do not attempt to defeat the safety purpose of the polarized plug by modifying the plug in any way.
- You may use an extension cord, if necessary, but be certain to follow these guidelines:
  - The marked electrical rating of the extension cord must be at least 120 Volt, 60 Hz, 10A.
  - The extension must be arranged so that it will not drape over the countertop or tabletop, will not be within the reach of children, and will not be tripped over.
  - Do not pull, twist or otherwise abuse the power cord.

This appliance comes with a thermal resettable fuse feature to prevent damage to the motor in the case of extreme overload. Should the unit shut off unexpectedly, unplug it and let it cool for at least 15 minutes before continuing.

## SAVE THESE INSTRUCTIONS

# Welcome

Congratulations on your purchase of an OSTER® My Blend™ Blender!  
To learn more about OSTER® products, please visit us at [www.oster.ca](http://www.oster.ca).

## Features of Oster® My Blend™ blender

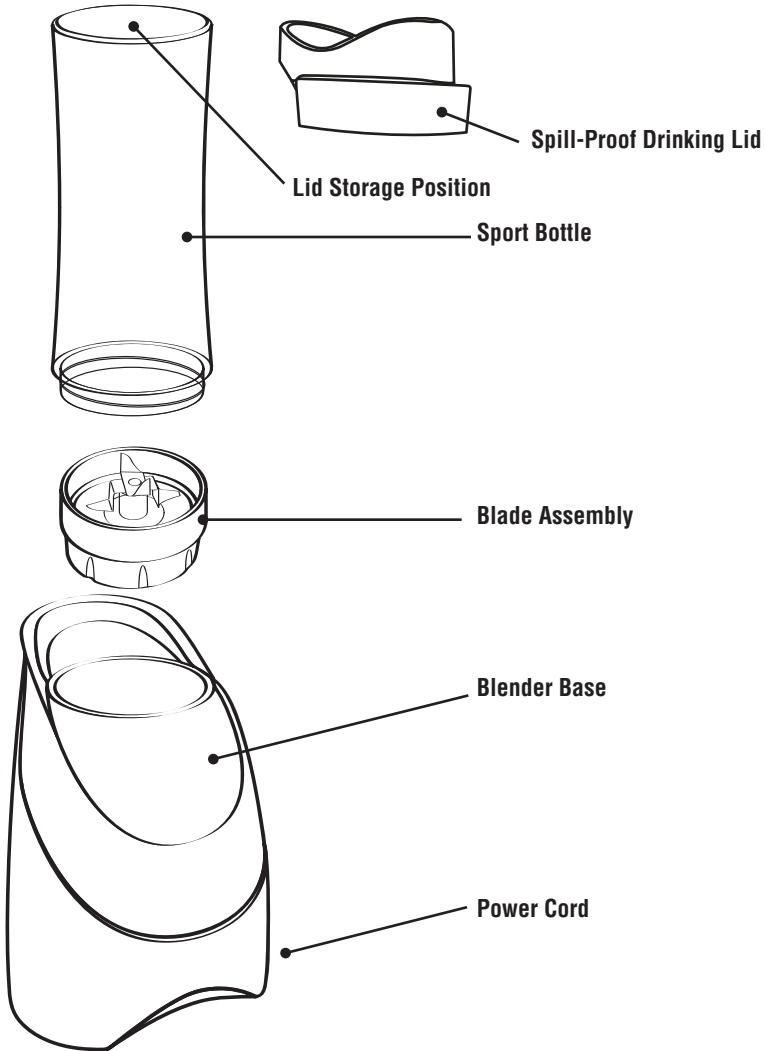

# Using Your Oster® My Blend™ blender

Clean blender according to the instructions in the “Cleaning and Storing Your Blender” section.

1

Place the My Blend™ sport bottle on a flat surface with the open end facing up. Fill the sport bottle with your favorite ingredients. Be sure not to fill ingredients past the 20 oz marking.



2

Fasten the blade assembly on the open end of the sport bottle.

Turn the sport bottle upside down, line up arrows on the blade assembly to the arrows on the base, and place the sport bottle in the base.

With one simple touch blending begins by pressing the sport bottle down in the base.

To lock the sport bottle in the base for hands-free operation, simply turn the sport bottle clockwise in the base.

Blending will stop once you either stop pressing the sport bottle into the base or once you unlock the sport bottle from the base.

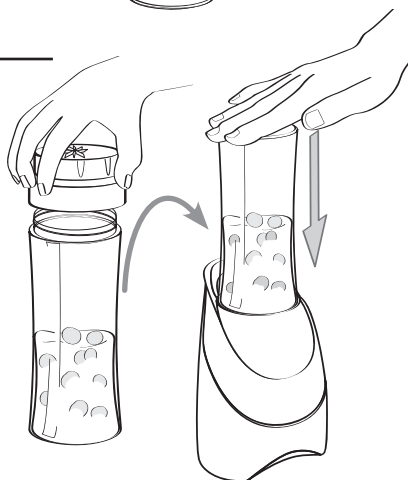

3

Turn the sport bottle over and place on a flat surface. Replace the blade assembly with the drinking lid. Take the My Blend™ sport bottle with you throughout the day to stay hydrated.



**TIP:** After you've consumed your blended beverage, wash out the sport bottle and reuse it throughout the day for water or other cold liquids.

**Note:** For optimal performance, place desired ingredients in the Sport Bottle according to the following order: Liquids, fresh ingredients, frozen fruit, yogurt and ice cream.

## Blending Tips

- Put liquids in the cup first, unless a recipe says otherwise.
- Cut all firm fruits and vegetables into pieces no larger than 3/4 inch (1.8 cm) to 1 inch (2.5 cm).
- Don't overload sport bottle. If the motor stalls, turn the blender off immediately, unplug the unit and let it cool for at least 15 minutes. Then, remove a portion of the food and continue.
- This blender will not mash potatoes, whip egg whites or substitute dairy toppings, mix stiff dough or grind raw meat.

## Cleaning and Storing Your Blender

**IMPORTANT: UNPLUG BEFORE CLEANING. DO NOT IMMERSE THE BLENDER BASE IN WATER OR ANY OTHER LIQUID.** Use a damp, soft sponge with mild detergent to clean the outside of the blender base. All parts except for the blender base are dishwasher-safe. You can also wash the parts, except the blender base, in warm, soapy water. Rinse well and dry.

## Storing Your Blender

After cleaning, reassemble blade assembly to open end of the sport bottle and then place in the blender base. Snap the drinking lid on the other end of the sport bottle.

# Recipes

## Rise 'N' Shine Shake

Makes 1 (18-ounce) serving

- 1 cup milk
- 1 cup strawberries, hulled and halved
- 1 kiwi, peeled and quartered
- ½ cup strawberry frozen yogurt
- 1 tablespoon sugar

Pour milk into My Blend™ sport bottle. Add strawberries, kiwi, frozen yogurt and sugar. Fasten the blade assembly on the open end of the sport bottle.

Turn the sport bottle upside down and place it in the base, lining up the arrows on the blade assembly with the arrows on the base. Press the sport bottle down in the base or turn the sport bottle clockwise to lock it for hands-free operation. Blend 20 to 30 seconds or until smooth.

Turn the sport bottle over and place on a flat surface. Replace the blade assembly with the drinking lid.

## Raspberry-Lemon Smoothie

Makes 1 (18-ounce) serving

- 1 cup milk
- 1 teaspoon vanilla
- 1½ cups frozen raspberries
- 1 container (6 ounces) lemon yogurt

Pour milk and vanilla into My Blend™ sport bottle. Add raspberries and yogurt. Fasten the blade assembly on the open end of the sport bottle.

Turn the sport bottle upside down and place it in the base, lining up the arrows on the blade assembly with the arrows on the base. Press the sport bottle down in the base or turn the sport bottle clockwise to lock it for hands-free operation. Blend 20 to 30 seconds or until smooth.

Turn the sport bottle over and place on a flat surface. Replace the blade assembly with the drinking lid.

# Recipes

## Frozen Hot Chocolate

Makes 1 (18-ounce) serving

- 1 cup milk
- 2 tablespoons hot cocoa mix
- 1 cup ice cubes
- ½ cup chocolate ice cream
- 1 container (6 ounces) vanilla yogurt

Pour milk into My Blend™ sport bottle. Add hot cocoa mix, ice cubes, ice cream and yogurt. Fasten the blade assembly on the open end of the sport bottle.

Turn the sport bottle upside down and place it in the base, lining up the arrows on the blade assembly with the arrows on the base. Press the sport bottle down in the base or turn the sport bottle clockwise to lock it for hands-free operation. Blend 30 to 45 seconds or until smooth.

Turn the sport bottle over and place on a flat surface. Replace the blade assembly with the drinking lid.

## Protein Energy Shake

Makes 1 (18-ounce) serving

- 1 cup plain soymilk
- 2 tablespoons honey
- ¼ cup walnuts
- ¼ to ½ teaspoon ground cinnamon
- 1¼ cups vanilla soy yogurt

Pour milk and honey into My Blend™ sport bottle. Add walnuts, cinnamon and yogurt. Fasten the blade assembly on the open end of the sport bottle.

Turn the sport bottle upside down and place it in the base, lining up the arrows on the blade assembly with the arrows on the base. Press the sport bottle down in the base or turn the sport bottle clockwise to lock it for hands-free operation. Blend 20 to 30 seconds or until smooth.

Turn the sport bottle over and place on a flat surface. Replace the blade assembly with the drinking lid.



# Recipes

## Berry Morning Medley

Makes 1 (18-ounce) serving

- 1 cup milk
- ¼ teaspoon vanilla
- ¼ cup old-fashioned oats
- 1 cup frozen mixed berries
- 1 container (6 ounces) plain yogurt
- 1 tablespoon sugar

Pour milk and vanilla into My Blend™ sport bottle. Add oats, berries, yogurt and sugar. Fasten the blade assembly on the open end of the sport bottle.

Turn the sport bottle upside down and place it in the base, lining up the arrows on the blade assembly with the arrows on the base. Press the sport bottle down in the base or turn the sport bottle clockwise to lock it for hands-free operation. Blend 20 to 30 seconds or until smooth.

Turn the sport bottle over and place on a flat surface. Replace the blade assembly with the drinking lid.

## ***1-Year Limited Warranty***

Sunbeam Products, Inc. doing business as Jarden Consumer Solutions or if in Canada, Sunbeam Corporation (Canada) Limited doing business as Jarden Consumer Solutions (collectively “JCS”) warrants that for a period of one year from the date of purchase, this product will be free from defects in material and workmanship. JCS, at its option, will repair or replace this product or any component of the product found to be defective during the warranty period. Replacement will be made with a new or remanufactured product or component. If the product is no longer available, replacement may be made with a similar product of equal or greater value. This is your exclusive warranty. Do NOT attempt to repair or adjust any electrical or mechanical functions on this product. Doing so will void this warranty.

This warranty is valid for the original retail purchaser from the date of initial retail purchase and is not transferable. Keep the original sales receipt. Proof of purchase is required to obtain warranty performance. JCS dealers, service centers, or retail stores selling JCS products do not have the right to alter, modify or any way change the terms and conditions of this warranty.

This warranty does not cover normal wear of parts or damage resulting from any of the following: negligent use or misuse of the product, use on improper voltage or current, use contrary to the operating instructions, disassembly, repair or alteration by anyone other than JCS or an authorized JCS service center. Further, the warranty does not cover: Acts of God, such as fire, flood, hurricanes and tornadoes.

### **What are the limits on Sunbeam’s Liability?**

JCS shall not be liable for any incidental or consequential damages caused by the breach of any express, implied or statutory warranty or condition.

Except to the extent prohibited by applicable law, any implied warranty or condition of merchantability or fitness for a particular purpose is limited in duration to the duration of the above warranty.

JCS disclaims all other warranties, conditions or representations, express, implied, statutory or otherwise.

JCS shall not be liable for any damages of any kind resulting from the purchase, use or misuse of, or inability to use the product including incidental, special, consequential or similar damages or loss of profits, or for any breach of contract, fundamental or otherwise, or for any claim brought against purchaser by any other party.

Some provinces, states or jurisdictions do not allow the exclusion or limitation of incidental or consequential damages or limitations on how long an implied warranty lasts, so the above limitations or exclusion may not apply to you.

This warranty gives you specific legal rights, and you may also have other rights that vary from province to province, state to state or jurisdiction to jurisdiction.

### **How To Obtain Warranty Service**

#### **In the U.S.A.**

If you have any question regarding this warranty or would like to obtain warranty service, please call 1 800-334-0759 and a convenient service center address will be provided to you.

#### **In Canada**

If you have any question regarding this warranty or would like to obtain warranty service, please call 1 800-667-8623 and a convenient service center address will be provided to you.

In the U.S.A., this warranty is offered by Sunbeam Products, Inc. doing business as Jarden Consumer Solutions located in Boca Raton, Florida 33431. In Canada, this warranty is offered by Sunbeam Corporation (Canada) Limited doing business as Jarden Consumer Solutions, located at 20 B Hereford Street, Brampton, Ontario L6Y 0M1. If you have any other problem or claim in connection with this product, please write our Consumer Service Department.

**PLEASE DO NOT RETURN THIS PRODUCT TO ANY OF THESE ADDRESSES OR TO THE PLACE OF PURCHASE.**



For product questions contact:  
Sunbeam Consumer Service  
USA : 1.800.334.0759  
Canada : 1.800.667.8623  
[www.oster.ca](http://www.oster.ca)

© 2012 Sunbeam Products, Inc. doing business as Jarden Consumer Solutions.  
All rights reserved. In Canada, imported and distributed by Sunbeam Corporation (Canada) Limited  
doing business as Jarden Consumer Solutions, 20 B Hereford Street, Brampton, Ontario L6Y 0M1.

Pour les questions de produit:  
Sunbeam Consumer Service  
États-Unis : 1.800.334.0759  
Canada : 1.800.667.8623  
[www.oster.ca](http://www.oster.ca)

© 2012 Sunbeam Products, Inc. faisant affaires sous le nom de Jarden Consumer Solutions.  
Au Canada, importée et distribuée par Sunbeam Corporation (Canada) Limited faisant affaire sous le  
nom de Jarden Consumer Solutions, 20 B Hereford Street, Brampton (Ontario) L6Y 0M1.