

vtech[®]

Instruction Manual

Play & Heal Deluxe Medical Kit™



INTRODUCTION

Thank you for purchasing the **Play & Heal Deluxe Medical Kit™**. This medical playset includes 33 pieces and a medical bag to store everything inside. Three activities introduce colors, body parts, fun medical facts and more!



ASSORTED



Tweezers



Scissors



Handheld
Mirror



Cup



Spoons



Pager

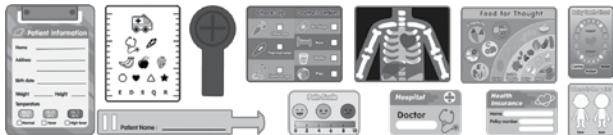

Medical Cards

INCLUDED IN THIS PACKAGE

- **Play & Heal Deluxe Medical Kit™**
- Stethoscope, otoscope, thermometer, syringe, handheld mirror, glasses, 2 bandages, tweezers, scissors, pager, 2 spoons, cup, 2 medicine bottles, 15 medical cards, 2 double-sided patient cards
- Quick Start Guide

WARNING

All packing materials such as tape, plastic sheets, packaging locks, removable tags, cable ties and packaging screws are not part of this toy and should be discarded for your child's safety.

NOTE

Please save this manual as it contains important information.

ATTENTION

Pour la sécurité de votre enfant, débarrassez-vous de tous les produits d'emballage tels que rubans adhésifs, feuilles de plastique, étiquettes, cordons et vis d'emballage. Ils ne font pas partie du jouet.

NOTE

Il est conseillé de sauvegarder ce manuel car il comporte des informations importantes.

Unlock the Packaging Locks

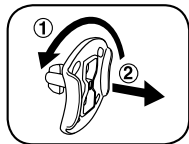

1. Rotate the packaging lock 90 degrees counterclockwise.
2. Pull out the packaging lock and discard.

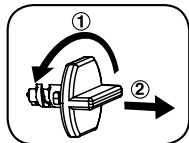

1. Turn the packaging lock counterclockwise several times.
2. Pull out the packaging lock and discard.

Getting Started

Battery Removal and Installation

1. Make sure the unit is turned **Off**.
2. Find the battery cover located on the bottom of the unit. Use a screwdriver to loosen the screw and then open the battery cover.
3. Remove old batteries by pulling up on one end of each battery.

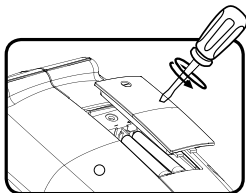

4. Install 2 new AA (LR6/AM-3) batteries following the diagram inside the battery box. (The use of new alkaline batteries is recommended for maximum performance.)
5. Replace the battery cover and tighten the screw to secure.



WARNING:

Adult assembly required for battery installation.
Keep batteries out of reach of children.



ATTENTION :

Les piles ou accumulateurs doivent être installés par un adulte.
Tenir les piles ou accumulateurs hors de portée des enfants.

IMPORTANT: BATTERY INFORMATION

- Insert batteries with the correct polarity (+ and -).
- Do not mix old and new batteries.
- Do not mix alkaline, standard (carbon-zinc) or rechargeable batteries.
- Only batteries of the same or equivalent type as recommended are to be used.
- Do not short-circuit the supply terminals.
- Remove batteries during long periods of non-use.
- Remove exhausted batteries from the toy.
- Dispose of batteries safely. Do not dispose of batteries in fire.

RECHARGEABLE BATTERIES

- Remove rechargeable batteries from the toy before charging.
- Rechargeable batteries are only to be charged under adult supervision.
- Do not charge non-rechargeable batteries.

IMPORTANT : INFORMATIONS CONCERNANT LES PILES

Les piles fournies avec le produit permettent de tester le jouet en magasin mais ne sont pas des piles longue durée.

- Mettre en place les piles ou les accumulateurs en respectant les polarités + et -.
- Ne pas mélanger des piles ou des accumulateurs neufs avec des usagés.
- Ne pas mélanger différents types de piles : alcalines, zinc-carbone et rechargeables.
- Seules des piles du type recommandé doivent être utilisées.
- Ne pas mettre les bornes d'une pile ou d'un accumulateur en court-circuit (en reliant directement le + et le -).
- Retirer les piles ou les accumulateurs en cas de non-utilisation prolongée.
- Enlever les piles ou les accumulateurs usagés du jouet.
- Ne les jeter ni au feu ni dans la nature.

PILES RECHARGEABLES :

- Enlever, lorsque c'est possible, les accumulateurs du jouet pour les recharger.
- Les accumulateurs ne doivent être chargés que sous la surveillance d'un adulte.
- Ne pas tenter de recharger des piles non rechargeables.

PRODUCT FEATURES

1. Off/Activity Slider

Move the **Off/Activity Slider** to select an activity to play. To turn the unit **Off** move the slider to **Off**.



2. Light-Up Tool Buttons

Press the **Light-Up Tool Buttons** to learn medical tool names, colors, fun facts or answer the questions in related activities.



3. Rolling Ball

Spin the **Rolling Ball** to hear melodies and sing-along songs, learn fun medical facts or get helpful hints in related activities. The eyes will also move when rolling the ball.



4. Double-Sided Patient Cards

Insert either card into the **Card Slot** to perform guided exams. The medical kit will ask you to find and use the medical tools to treat the patients in addition to introducing body parts and playing songs.



5. Cover

Open or close the **Cover** to store the pieces and hear fun responses.



6. Volume Control Switch

Slide the **Volume Control Switch** to the right for high volume or slide to the left for low volume.



7. Accessories

Use the **Bandage, Otoscope, Stethoscope, Syringe, Thermometer** and other included accessories for role-play fun.



8. Automatic Shut-Off

To preserve battery life, the **Play & Heal Deluxe Medical Kit™** will automatically power down after several seconds without input. The unit can be turned on again by sliding the **Off/Activity Slider** to any of the three modes.

ACTIVITIES

Learning Mode

Move the **Activity Slider** to the second position  to enter this mode. Press any **Tool Button** to learn the tool's name, facts and colors. Spin the **Rolling Ball** to learn fun medical facts. Insert a **Patient Card** to perform an exam and treat the patient.

Quiz Mode

Move the **Activity Slider** to the third position  to enter this mode. The medical kit will ask a series of questions about tools, facts or colors. When a **Patient Card** is inserted into the **Card Slot**, the medical kit will ask questions about the patient. Press the **Tool Buttons** to answer.

Music Fun

Move the **Activity Slider** to the fourth position  to enter this mode. Spin the **Rolling Ball** to hear fun medical songs or melodies. Press any of the **Tool Buttons** to add silly sounds into the songs, and watch the lights flash with the music!

SONG LIST

Song 1

Going to the doctor is no big deal
Doctors and nurses want to help you heal
Be sure to tell them how you feel
So you can stay healthy happily

Song 2

Head, shoulders, knees and toes, knees and toes
Head, shoulders, knees and toes, knees and toes
And eyes and ears and mouth and nose
Head, shoulders, knees and toes, knees and toes

Song 3

I'm just what the doctor ordered, I'm a medical kit!
House calls and helping people make me smile
So does playing with you for awhile

Song 4

Doctors need tools to do their job
An otoscope to see in your mouth, say "ahhhh"
A stethoscope to hear your heart beat
Doctors' tools can be really neat

CARE & MAINTENANCE

1. Keep the unit clean by wiping it with a slightly damp cloth.
2. Keep the unit out of direct sunlight and away from any direct heat sources.
3. Remove the batteries if the unit will not be in use for an extended period of time.
4. Do not drop the unit on hard surfaces and do not expose the unit to moisture or water.
5. If the unit stops working or malfunctions, install a new set of batteries.

IMPORTANT NOTE

If the problem persists, please call our **Consumer Services Department** at **1-800-521-2010** in the U.S., **1-877-352-8697** in Canada, or visit our website **vtechkids.com** and fill out our **Contact Us** form located under the **Customer Support** link. Creating and developing **VTech®** products is accompanied by a responsibility that we take very seriously. We make every effort to ensure the accuracy of the information, which forms the value of our products. However, errors sometimes can occur. It is important for you to know that we stand behind our products and encourage you to contact us with any problems and/or suggestions you might have. A service representative will be happy to help you.

CAUTION

Changes or modifications not expressly approved by the party responsible for compliance could void the user's authority to operate the equipment.

NOTE

This equipment has been tested and found to comply with the limits for a Class B digital device, pursuant to Part 15 of the FCC Rules. These limits are designed to provide reasonable protection against harmful interference in a residential installation. This equipment generates, uses and can radiate radio frequency energy and, if not installed and used in accordance with the instructions, may cause harmful interference to radio communications. However, there is no guarantee that interference will not occur in a particular installation. If this equipment does cause harmful interference to radio or television reception, which can be determined by turning the equipment off and on, the user is encouraged to try to correct the interference by one or more of the following measures:

- Reorient or relocate the receiving antenna.
- Increase the separation between the equipment and receiver.
- Connect the equipment into an outlet on a circuit different from that to which the receiver is connected.
- Consult the dealer or an experienced radio/TV technician for help.

Supplier's Declaration of Conformity
47 CFR § 2.1077 Compliance Information

Trade Name: VTech®
Model: 1783
Product Name: Play & Heal Deluxe Medical Kit™
Responsible Party: VTech Electronics North America, L.L.C.
Address: 1156 W. Shure Drive, Suite 200
Arlington Heights, IL 60004
Website: vtechkids.com

THIS DEVICE COMPLIES WITH PART 15 OF THE FCC RULES. OPERATION IS SUBJECT TO THE FOLLOWING TWO CONDITIONS: (1) THIS DEVICE MAY NOT CAUSE HARMFUL INTERFERENCE, AND (2) THIS DEVICE MUST ACCEPT ANY INTERFERENCE RECEIVED, INCLUDING INTERFERENCE THAT MAY CAUSE UNDESIRED OPERATION.

**Visit our website for more
information about our products,
downloads, resources and more.**

vtechkids.com
vtechkids.ca

Read our complete warranty policy online at
vtechkids.com/warranty
vtechkids.ca/warranty

