

SURFLINK[®]





MINI MOBILE ADAPTER



OPERATIONS MANUAL

IMPORTANT: SurfLink Mini Mobile Adapter is *ONLY* compatible with SurfLink Remote Microphone 2.

Table of Contents

Introduction	4
 Basic Use	5
 Controls Overview	10
 Operation	
Low Battery and Charging	12
Multi-Function Push-Button	13
Power On/Off	13
Bluetooth Pairing	14
Interacting with Phone Calls	16
Listening to Music	18
Resetting	18
LED	19
Typical Use Cases	20
 Troubleshooting	22
 Regulatory Notices	24

Introduction

When **SurfLink Mini Mobile Adapter** is attached to SurfLink Remote Microphone 2, the resulting configuration can stream audio from your Bluetooth device to your 900 MHz wireless hearing instruments.

Prior to use, both **SurfLink Remote Microphone 2** and **SurfLink Mini Mobile Adapter** will need to be separately set up. SurfLink Remote Microphone 2 will be synced to your hearing instruments. SurfLink Mini Mobile Adapter will be paired to your Bluetooth device.

Basic Use

To quickly start using SurfLink Mini Mobile Adapter:

1. Ensure SurfLink Remote Microphone 2 has been properly setup with your hearing instruments and is in powered on state.



2. Insert the male microUSB jack on SurfLink Mini Mobile Adapter into SurfLink Remote Microphone 2's female microUSB jack.



3. To turn on SurfLink Mini Mobile Adapter, press its push-button for 2 seconds and release when the green LED appears.



4. Put your Bluetooth device into pairing mode.

NOTE: Some devices may ask for the SurfLink Mini Mobile Adapter PIN, which is 0000.

5. While the green LED is slowly pulsing, double-click the push-button. The LED starts rapidly blinking blue, which puts SurfLink Mini Mobile Adapter into Bluetooth Pairing Mode.



6. On your Bluetooth device, select SurfLink Mini to complete the pairing process.

7. A green LED confirms a successful Bluetooth pairing.



8. To verify your setup, ensure LED is slowly pulsing blue and either:
 - Play music on your Bluetooth device
 - Have someone call your Bluetooth device
 - o When you hear the incoming call ringtone in your hearing instruments, briefly press and release the push-button on SurfLink Mini Mobile Adapter.
 - o Speak into SurfLink Mini Mobile Adapter microphone.
 - o To end the call, briefly press and release the push-button.

9. To turn off SurfLink Mini Mobile Adapter, press the push-button for 2 seconds and release it. The red LED briefly appears to provide confirmation.



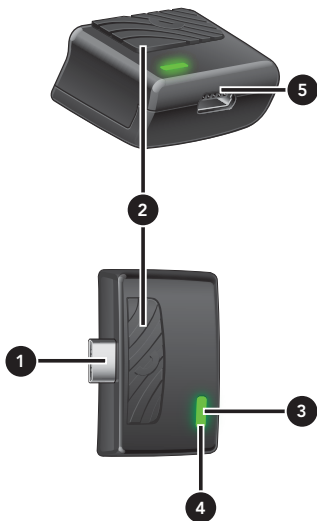

Controls Overview

1. Male MicroUSB Jack

Attaches SurfLink Mini Mobile Adapter to SurfLink Remote Microphone 2.

2. Multi-Function Push-Button

Provides control over the operational state of SurfLink Mini Mobile Adapter.

3. LED Indicator

Identifies the current state of SurfLink Mini Mobile Adapter.

4. Built-In Microphone

Picks up your voice and transmits to caller during phone calls.

5. Female MicroUSB Jack

Charges via battery-charging cable.

Operation

Low Battery and Charging

If SurfLink Mini Mobile Adapter is on and enters a low battery condition, the LED slowly pulses red until it automatically shuts down, or until a power source is applied. When the Mini Mobile Adapter is attached to a power source, the LED becomes solid green and charging automatically begins. When power is on, the solid green LED will be interrupted by other LED behaviors. When the battery is fully-charged, the solid green LED turns off.

Typical Charging Method

To charge the battery, attach the microUSB end of the charging cable to the female microUSB jack on SurfLink Mini Mobile Adapter. Attach the

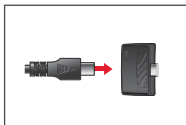

USB end of the charging cable to a female USB jack, such as found on a plugged-in wall power adapter, car charger adapter, or computer.

You can charge both SurfLink Mini Mobile Adapter and SurfLink Remote Microphone 2 at the same time while they are attached.

While charging, you can stream audio for extended periods.

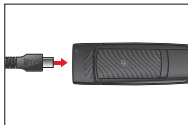

Multi-Function Push-Button

Powering On/Off

Power On – When power is off, press the push-button for 2 seconds and release it. The LED briefly turns green to verify power is on.

Power Off – When power is on, press the push-button for 2 seconds and release it. The LED briefly turns red to verify power is off.

Bluetooth Pairing

For SurfLink Mini Mobile Adapter to receive streamed audio from your Bluetooth device, you must first pair it. To start the Bluetooth pairing process, put your Bluetooth device into pairing mode. If you are unfamiliar with the Bluetooth pairing process, consult your Bluetooth device's operations manual.

To put SurfLink Mini Mobile Adapter into an active Bluetooth pairing state, ensure it is powered on and not Bluetooth-connected to other devices (the green LED will be slowly pulsing). Double-click the push-button so that the LED starts rapidly blinking blue. The Mini Mobile Adapter remains in an active pairing state for up to 60 seconds. When it appears, select the product name (SurfLink Mini) on your Bluetooth device. A green LED for 2

seconds confirms a successful pairing with the Bluetooth device while a rapid blinking red LED denotes an unsuccessful pairing attempt. To cancel pairing mode on Mini Mobile Adapter, press the push-button for 2 seconds and release it, which powers off the Mini Mobile Adapter.

You only need to pair SurfLink Mini Mobile Adapter with your Bluetooth device one time, as they should automatically Bluetooth connect when both are powered on and they are within wireless operating range. The Mini Mobile Adapter can be paired and connected with up to 2 Bluetooth devices at a time.

Bluetooth Overview

Bluetooth is a wireless communication technology used to transmit audio and data.

To interoperate with SurfLink Mini Mobile Adapter, a Bluetooth-enabled device must support at least one of the following Bluetooth profiles:

- To make/receive phone calls, your Bluetooth device must support the "Hands-Free" (HFP) profile.

- To listen to music, your Bluetooth device must support the "Media" (A2DP) profile.

To enable Bluetooth communication, these processes must be completed:

Pairing – Establishes a relationship between a Bluetooth device and SurfLink Mini Mobile Adapter.

Connecting – Establishes the ability to actively stream audio from a previously paired Bluetooth device to your hearing instruments via SurfLink Mini Mobile Adapter.

Interacting with Phone Calls

The SurfLink Mini Mobile Adapter allows you to accept, reject, hang up, and transfer phone calls to/from a Bluetooth-connected phone.

Accept – When you hear the incoming call ringtone in your hearing instruments, briefly press and release the push-button on Mini Mobile Adapter.

Reject – When you hear the incoming call ringtone in your hearing instruments, press the push-button on Mini Mobile Adapter for more than 2

seconds. Release the button after the ringtone stops.

Hang Up – During an active phone call, briefly press and release the push-button on Mini Mobile Adapter.

Transfer – During an active phone call, press the push-button on Mini Mobile Adapter for more than 2 seconds to move the call from Mini Mobile Adapter to the phone. This allows you to directly conduct the call via the phone, if desired. Re-press the push-button for more than 2 seconds to move the call back to Mini Mobile Adapter.

During an active phone call, SurfLink Mini Mobile Adapter picks up your voice so that the caller can hear it during the conversation. In noisy environments, position Mini Mobile Adapter closer to your mouth.

Listening to Music or Other Streamed Audio

To receive music or other audio in your hearing instruments, simply play the audio on your Bluetooth connected device and it will be transmitted via the SurfLink Mini Mobile Adapter. It is not necessary to press the push-button on Mini Mobile Adapter.

Resetting

To reset SurfLink Mini Mobile Adapter back to factory settings, ensure it is powered on and not Bluetooth-connected to other devices (the green LED will be slowly pulsing). Double-click the push-button so that the LED starts rapidly blinking blue. Press the push-button for 12 seconds until LED starts rapidly blinking red. The Mini Mobile Adapter automatically turns off following a reset.

LED

The LED indicator provides helpful information about SurfLink Mini Mobile Adapter:

LED BEHAVIOR	SURFLINK MINI MOBILE ADAPTER STATE
Off	<ul style="list-style-type: none">• Mini Mobile Adapter is off and is not attached to a power source.• If Mini Mobile Adapter is off and is attached to a power source, then battery charging is complete.
Slow pulsing green	<ul style="list-style-type: none">• Mini Mobile Adapter is on, but not connected to Bluetooth device.
Green for 2 seconds	<ul style="list-style-type: none">• Mini Mobile Adapter successfully powers on.• Mini Mobile Adapter successfully pairs with Bluetooth device.
Solid green	<ul style="list-style-type: none">• Charging and power is off.• When Mini Mobile Adapter is charging and power is on, then solid green will be briefly interrupted by other LED behaviors.
Slow pulsing red	<ul style="list-style-type: none">• Low battery state and Mini Mobile Adapter is on.
Red for 2 seconds	<ul style="list-style-type: none">• Mini Mobile Adapter powers off.
Rapid blinking red	<ul style="list-style-type: none">• Failure to pair with Bluetooth device.• Reset to factory settings.
Slow pulsing blue	<ul style="list-style-type: none">• Mini Mobile Adapter is connected to Bluetooth device.
Rapid blinking blue	<ul style="list-style-type: none">• Mini Mobile Adapter is attempting to pair with Bluetooth device.

Typical Use Cases

To effectively use SurfLink Mini Mobile Adapter, it will need to be within easy reach so that you can quickly press the push-button to answer calls and speak into the built-in microphone. Typical operating scenarios include:

SCENARIO

Stream SurfLink Remote Microphone 2 audio from a *distant* talker.

Stream an active phone call.

Stream music or other audio.

Desired hearing instrument microphones to be active, but allow for possibility of incoming phone calls.

OPTIMAL CONFIGURATION

Distant talker wears just SurfLink Remote Microphone 2, which is powered on.

OR

Distant talker wears SurfLink Remote Microphone 2 (which is powered on) attached to SurfLink Mini Mobile Adapter (which is powered off).

SurfLink Remote Microphone 2 is attached to SurfLink Mini Mobile Adapter and both are powered on.

- Press the push-button on Mini Mobile Adapter to answer the phone call.

SurfLink Remote Microphone 2 is attached to SurfLink Mini Mobile Adapter and both are powered on.

- Start audio on your Bluetooth device.

SurfLink Remote Microphone 2 is attached to SurfLink Mini Mobile Adapter and both are powered on.

- There is no active streaming from the cell phone.

Troubleshooting

SYMPTOM / ISSUE	POSSIBLE CAUSE
Streamed audio is too loud or too soft in hearing instruments.	Bluetooth device is streaming at non-optimal volume.
LED is slowly pulsing blue, but no streamed audio is heard in the hearing instruments.	SurfLink Mini Mobile Adapter may be unattached from SurfLink Remote Microphone 2.
	SurfLink Remote Microphone 2 may be powered off.
Caller cannot hear your voice during phone calls.	SurfLink Mini Mobile Adapter may be too far from your mouth.
Streamed Bluetooth audio quality is inconsistent.	Bluetooth device may be on the edge of wireless range.
	Battery level in SurfLink Mini Mobile Adapter is getting low.
	Large object, such as a human body or a wall, may be degrading signal.
Smartphone alerts are not always received.	Alert duration is too short.
Unable to Bluetooth pair with more than one Bluetooth device.	SurfLink Mini Mobile Adapter is already in an active Bluetooth connection.

POSSIBLE REMEDY

Adjust volume control on the Bluetooth device.

Ensure Mini Mobile Adapter is properly attached to SurfLink Remote Microphone 2.

Turn on SurfLink Remote Microphone 2.

Move Mini Mobile Adapter closer to your mouth.

Move Bluetooth device closer to SurfLink Mini Mobile Adapter.

Charge Mini Mobile Adapter.

For best performance, SurfLink Mini Mobile Adapter should be within line-of-sight of your Bluetooth device.

Lengthen alert tone to allow sufficient time for streaming to start.

Terminate the active Bluetooth connection and then try Bluetooth pairing with the new device.

Regulatory Notices

Required Information



Waste from electronic equipment must be handled according to local regulations.

Instructions for Disposal of Old Electronics

Starkey Hearing Technologies encourages, and your local community laws may require, that your SurfLink Mini Mobile Adapter be disposed of via your local electronics recycling/disposal process.

The below instructions are provided for the benefit of disposal/recycling personnel. Please include this manual with your device when disposing of your SurfLink Mini Mobile Adapter.

For Disposal/Recycling Personnel Only

These products contain a Lithium Ion Polymer battery.

To remove this battery from the SurfLink Mini Mobile Adapter:

- Power off the SurfLink Mini Mobile Adapter.

- Insert small screwdriver into a side housing corner and pry apart the housing halves.
- Cut the battery wires from the circuit board to prevent accidental shorting.
- Pry the battery away from the microUSB using your fingers.

Intended Use

SurfLink Mini Mobile Adapter is an accessory to a wireless air conduction hearing instrument. It is intended to wirelessly transfer audio signals between a Bluetooth-enabled device and hearing instruments via the SurfLink Remote Microphone 2 allowing users to better participate in phone conversations.

SurfLink Mini Mobile Adapter is classified as a Type B applied part under the IEC 60601-1 medical instrument standard.

SurfLink Mini Mobile Adapter is designed to comply with the most stringent Standards of International Electromagnetic Compatibility. However, it is still possible that you may experience interference caused by power line disturbances, airport metal detectors, electromagnetic fields from other medical devices, radio signals and electrostatic discharges.

SurfLink Mini Mobile Adapter is designed to be cleaned with a damp cloth moistened with soapy water.

If you use other medical devices or wear implantable medical devices such as defibrillators or pacemakers and are concerned that your SurfLink Mini Mobile Adapter might cause interference with your medical device, please contact your physician or the manufacturer of your medical device for information about the risk of disturbance. SurfLink Mini Mobile Adapter should not be used during an MRI procedure.

Use on Aircrafts

SurfLink Mini Mobile Adapter should not be used on aircrafts unless specifically permitted by the flight personnel.

International Use

SurfLink Mini Mobile Adapter is approved to operate at radio frequencies that are specific to your country or region and might not be approved for use outside your country or region.

Be aware that operation during international travel may cause interference with other electronic devices, or other electronic devices may cause interference with your SurfLink Mini Mobile Adapter.

The battery in your SurfLink Mini Mobile Adapter is not replaceable. Do not attempt to replace the battery.

The SurfLink Mini Mobile Adapter is designed to the following temperature ranges:

- Operating: -10 to +45 degrees C (14 to 113 degrees F), humidity \leq 95% non-condensing
- Battery Charging: 0 to +45 degrees C (32 to 113 degrees F), humidity \leq 95% non-condensing
- Storage: -20 to +63 degrees C (-4 to 145 degrees F)

We are required by regulations to provide the following warnings:

WARNING: Use of SurfLink Mini Mobile Adapter directly next to other electronic equipment should be avoided because it could result in improper performance. If such use is necessary, note as to whether your hearing aids and the other equipment are operating normally.

WARNING: Use of accessories, components or replacement parts other than those provided by the manufacturer of your SurfLink Mini Mobile Adapter could result in increased electromagnetic emissions and decreased electromagnetic immunity and could result in degradation of performance.

WARNING: If Portable Radio Frequency communications equipment is used closer than 30 cm (12 inches) from your SurfLink Mini Mobile Adapter, degradation of the performance of your hearing aid could result. If this occurs, move away from the communications equipment.

The SurfLink Mini Mobile Adapter has a rating of IP 52 per IEC 60529. This means that the SurfLink Mini Mobile Adapter is protected from dust and protected against vertically falling water drops when the enclosure is tilted 15 degrees or less from vertical.

The SurfLink Mini Mobile Adapter does not contain any user-serviceable parts. Do not open or modify this device.

Do not connect the SurfLink Mini Mobile Adapter to any devices not described in this manual.

The expected service life of the SurfLink Mini Mobile Adapter is 3 years.

Wireless Technical Description

The SurfLink Mini Mobile Adapter operates in the 2.4-2.4835 GHz band with a maximum effective radiated power of 5.7 dBm with transmission modulation type of 1M12FXD. The receiver section of the radio has a bandwidth of 1 MHz.

SurfLink Mini Mobile Adapter has been tested to, and has passed, the following emissions and immunity tests:

- IEC 60601-1-2 radiated emissions requirements for a Group 1 Class B device as stated in CISPR 11.
- RF radiated immunity at a field level of 10 V/m between 80 MHz and 2.7 GHz as well as higher field levels from communications devices as stated in Table 9 of IEC 60601-1-2.
- Immunity to power frequency magnetic fields at a field level of 30 A/m.
- Immunity to ESD levels of +/- 8 kV conducted discharge and +/- 15 kV air discharge.

FCC/IC Information

FCC ID: EOA-CMA

IC: 6903A-CMA (Model 500)

FCC/IC Notice

This device complies with part 15 of the FCC rules and with Industry Canada's license-exempt RSS standard(s). Operation is subject to the following two conditions:

- (1) This device may not cause harmful interference, and
- (2) this device must accept any interference received, including interference that may cause undesired operation of the device.

NOTE: The manufacturer is not responsible for any radio or TV interference caused by unauthorized modifications to this equipment. Such modifications could void the user's authority to operate the equipment.

Note FCC/IC

Cet appareil est conforme à la partie 15 des règles de la FCC et avec les normes RSS de licence d'Industrie Canada. Le fonctionnement est soumis à deux conditions: (1) Cet appareil ne doit pas causer d'interférences nuisibles et (2) cet appareil doit accepter toute interference reçue, y compris les interférences qui peuvent causer des fonctionnements du dispositif.

NOTE: Le fabricant n'est pas responsable de l'interférence créée par la modification de cet équipement lors de l'écoute du téléviseur ou de la radio. De telles modifications pourraient entraîner la révocation de l'autorité de l'utilisateur à opérer cet équipement.

Hereby, Starkey Hearing Technologies declares that the SurfLink Mini Mobile Adapter is in compliance with the essential requirements and other relevant provisions of Directive 2014/53/EU. A copy of the Declaration of Conformity can be obtained from the addresses on the next page and from docs.starkeyhearingtechnologies.com

Starkey Hearing Technologies
6600 Washington Ave. South
Eden Prairie, MN 55344 USA



Starkey Hearing Technologies European Headquarters
Wm. F. Austin House, Bramhall Technology Park
Pepper Road, Hazel Grove, Stockport SK7 5BX
United Kingdom



The following symbols are used in this document and on the Mini Mobile Adapter:

This device produces and receives radio frequency energy. Interference may occur in the vicinity of equipment marked with the following symbol.



Class II device



Dispose of properly



Consult operations manual



© 2017 Starkey Hearing Technologies., Inc. All Rights Reserved.

85430-007 8/17 BKLT2941-01-EE-XX