

GETTING STARTED WITH **CONTINUOUS GLUCOSE MONITORING**

My Guardian™ Connect System

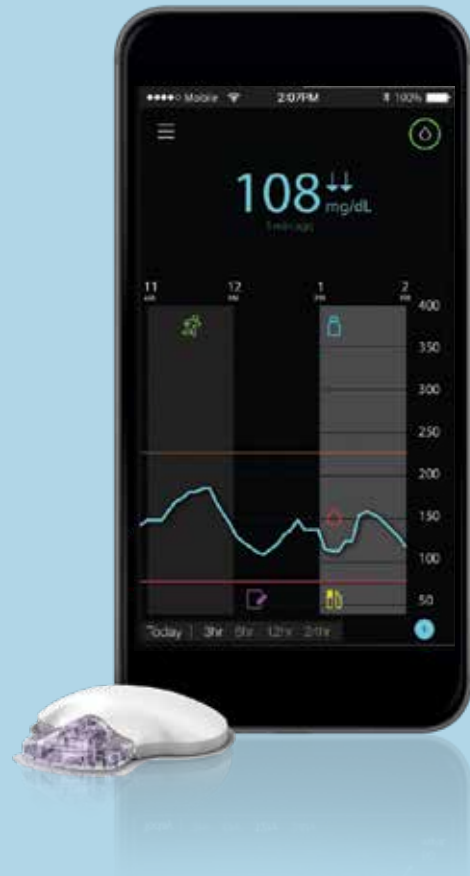

Medtronic

GETTING STARTED WITH CONTINUOUS GLUCOSE MONITORING (CGM)

My Guardian Connect System

| | |
|---|-----------|
| SECTION 1: What's Continuous Glucose Monitoring? | 2 |
| My Sensor Glucose (SG) and Blood Glucose (BG) | 3 |
| My Trends | 6 |
| SECTION 2: Before I Begin Using My Guardian Connect System | 8 |
| SECTION 3: Setting Up My Guardian Connect System | 10 |
| Inserting and Starting my Sensor | 11 |
| Personalizing my Alerts | 19 |
| SECTION 4: Using My Guardian Connect System | 26 |
| Calibrating my Sensor | 26 |
| Reading my Sensor Display | 29 |
| Knowing my Sensor Alerts | 34 |
| SECTION 5: Setting up my Care Partner Account | 38 |
| SECTION 6: Appendix | 42 |
| TRAINING HANDOUTS | |
| Quick Reference Guide for my Sensor Alerts | 45 |
| Quick Reference Guide for using my One-press senter with my Guardian™ Sensor 3 | 47 |

SECTION 1: WHAT'S CONTINUOUS GLUCOSE MONITORING?

Continuous Glucose Monitoring (CGM) lets you see your glucose values more often than when you check with your blood glucose meter. Let's get to know the parts of your CGM system.



Guardian Sensor 3
measures glucose levels under your skin.

Guardian Connect transmitter*
connects to your glucose sensor and sends glucose readings to your app.



Guardian Connect app
shows glucose readings on your own cellular phone or mobile device.

OTHER ITEMS INCLUDED WITH YOUR SYSTEM:

| | |
|------------------------|---|
| One-pressserter | Inserts the sensor into your skin. |
| Oval tape | Helps your sensor stick to your skin for the whole 7 days. |
| Gray charger | Charges your transmitter when you're not wearing a sensor. |
| Tester | Checks that your transmitter is working if you ever need to troubleshoot. Also used when cleaning your transmitter. |

Check out the Guardian Connect System User Guide for more information.

* The transmitter must be within 20 feet (6.1 meters) of the Guardian Connect app in order to send sensor readings.

This is a good time to charge your transmitter if you haven't done so already. Plug your transmitter into your gray charger. The green light on your charger will flash. You'll know that your transmitter is fully charged when the green light on your charger turns off. It can take up to 2 hours to fully charge.

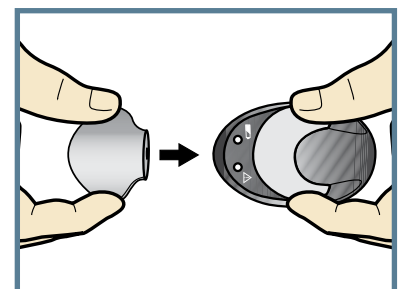

My Sensor Glucose (SG) and Blood Glucose (BG)

Continuous Glucose Monitoring (CGM) lets you see your glucose values when you are not checking with your home BG meter. You will get up to **288 sensor glucose readings every 24 hours**, filling the gaps between your blood glucose (BG) checks. CGM can alert you to your high and low glucose values and show you the speed and direction that your glucose levels are moving.

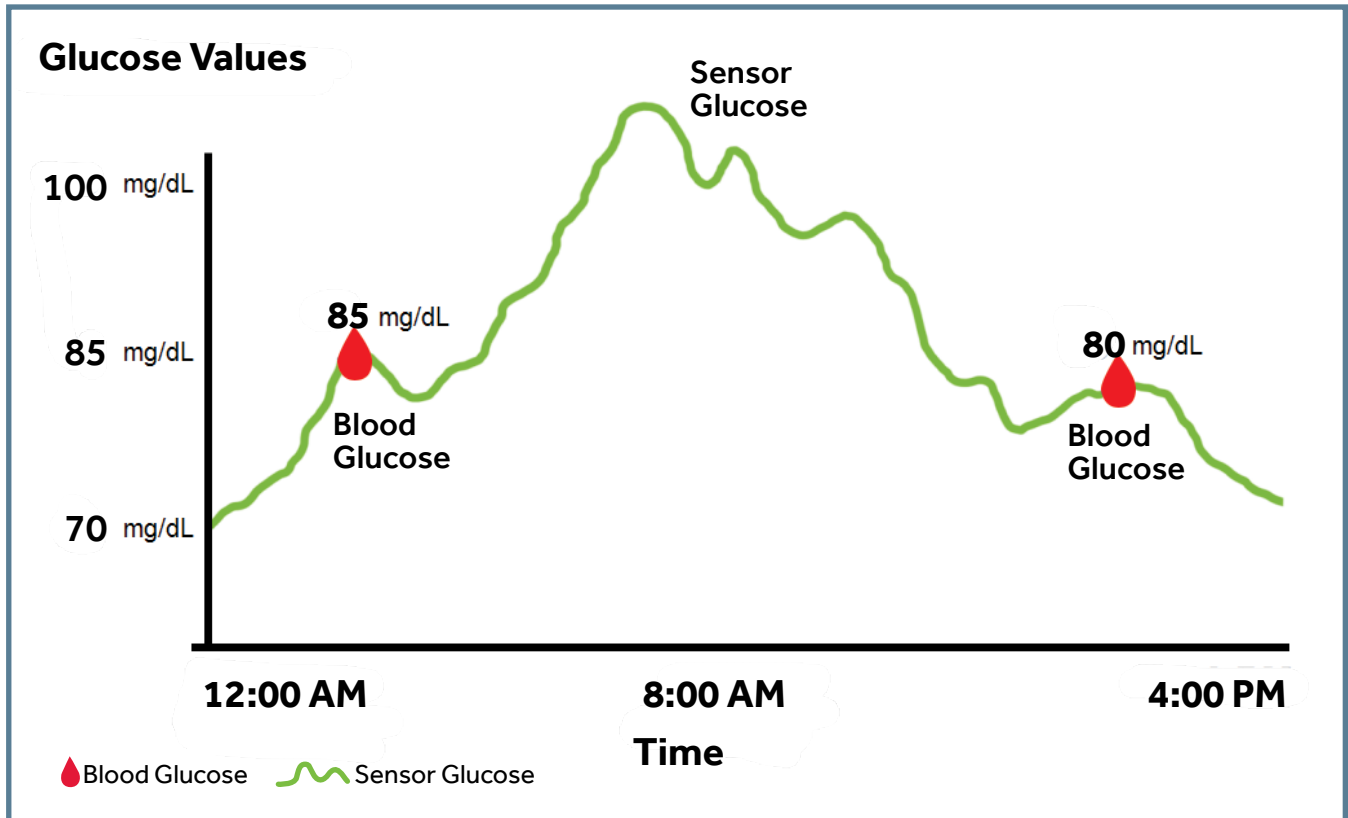

What's the difference between my SG and BG?

Your **BG meter** measures glucose levels in your **blood**. The **glucose sensor** measures glucose in the fluid surrounding the cells of your tissue called **interstitial fluid**.

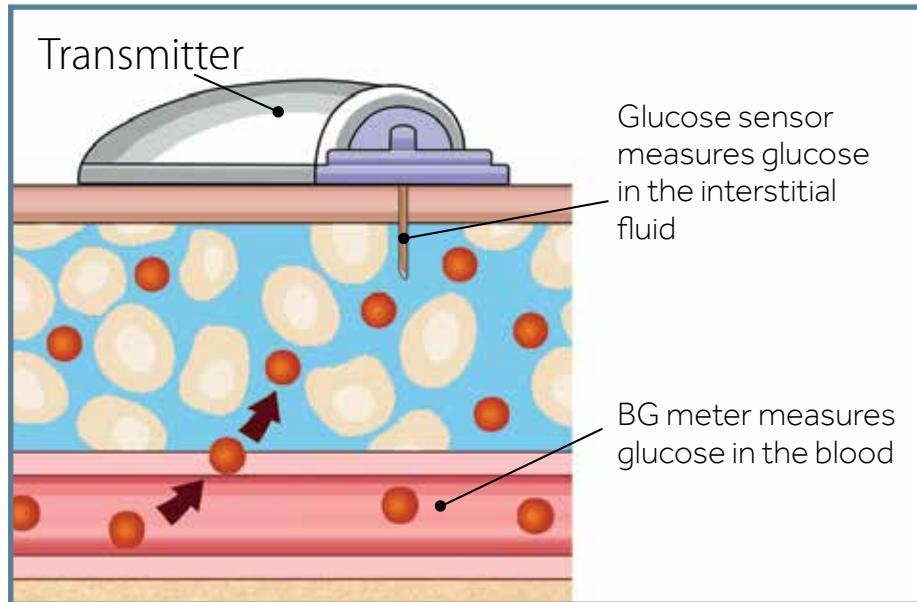

Because your glucose moves between these two places, **your blood glucose meter readings (BG) and sensor glucose readings (SG) will be similar but will rarely be the same.**

This difference in your sensor and blood glucose is normal and should be expected.

You can expect to see a larger difference between your BG meter reading and the sensor glucose reading when your glucose levels are rising or falling quickly.

Examples of times when you might see this larger difference in your SG and BG:

- After meals or taking insulin
- During and after exercise
- When arrows appear on your Guardian Connect app screen.

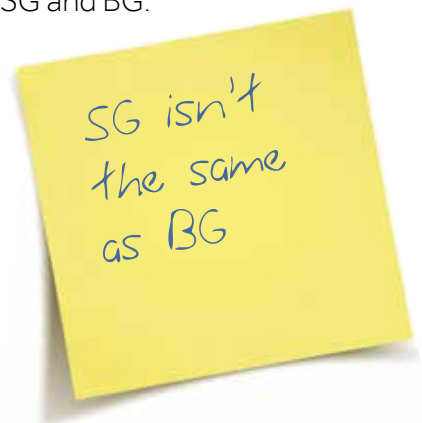



WARNING: If you take medications with acetaminophen such as Tylenol®, fever reducers, cold medicine, or paracetamol while wearing the sensor, your sensor glucose readings might become falsely raised. The level of sensor inaccuracy will depend on how much acetaminophen is working in your body and will be different for each person. Always use your blood glucose meter to confirm your glucose levels before you make therapy decisions.



Your sensor glucose (SG) is not the same as your blood glucose (BG). Your SG and BG readings will be similar to one another but will rarely match exactly.

WARNINGS: Do not make therapy decisions based on your sensor glucose values because your sensor glucose and blood glucose values may be different. Confirm your glucose level with your blood glucose meter before making treatment decisions, such as dosing insulin before a meal or taking carbs to treat a low.

If you "feel" that your glucose is high or low, but your sensor glucose doesn't match what you're feeling, always check your blood glucose using your BG meter.



KNOWLEDGE CHECK

Sometimes your SG and BG will not match exactly.

- A. True
- B. False

Circle either Sensor Glucose (SG) or Blood glucose (BG) to complete each sentence.

SG / BG readings are measured with your blood glucose meter

SG / BG readings are measured using CGM

SG / BG is measured in interstitial fluid

WHAT'S CONTINUOUS GLUCOSE MONITORING?

My Trends

When using CGM, focus on your sensor glucose trends. These trends show you the direction and speed that your glucose is changing.

Looking at your glucose trends lets you:

- **focus less** on the number.
- **focus more** on how quickly your glucose is rising or falling.

Example of sensor information on the Home Screen

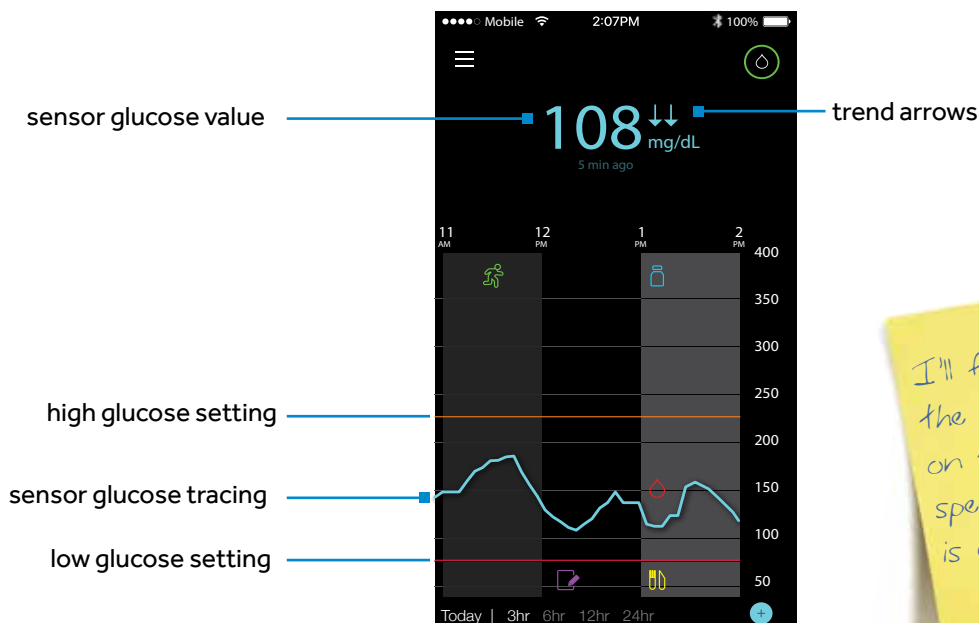

You can see that the sensor glucose value in the picture above is 108 mg/dL. But also notice:

- **the sensor glucose tracing** shows the glucose has been trending downward.
- **the two arrows next to the sensor glucose value** also tell you the glucose has been dropping.

↑ or ↓ - **SG has been changing** by 1-2 mg/dL per minute

↑↑ or ↓↓ - **SG has been changing quickly** by 2-3 mg/dL per minute

↑↑↑ or ↓↓↓ - **SG has been changing very quickly** greater than 3 mg/dL per minute



NOTE: You can expect to see your glucose rising or falling quickly after eating, taking insulin, or when exercising.



KNOWLEDGE CHECK

↑↑ and **↑↑↑** mean your sensor glucose has been _____ quickly.

- A. rising
- B. falling

If a patient was taking insulin and forgot to take it for breakfast, which trend arrows might he see?

- A **↑↑**
- B **↓↓**
- C **↑↑↑**
- D both A and C are possibilities

SECTION 2: BEFORE I BEGIN USING MY GUARDIAN CONNECT SYSTEM

Setting Up My Mobile Device to Use the Guardian Connect App

The Guardian Connect app can send you alerts when your glucose is trending above or below levels that you set. But because it is just like other apps on your mobile device, there are a few things you need to do so you will always get the alerts you want.

- 1** Make sure you know how these mobile device settings work: silent, vibrate, and Do Not Disturb.
- 2** Make sure that notifications are ON for your Guardian Connect app. You will turn on notifications during your app setup.
- 3** Make sure the Bluetooth® feature in your mobile device is always ON.
- 4** If you restart your mobile device (for example, after it's powered off or when the battery dies and is recharged), always open your Guardian Connect app. It will not reopen automatically.
- 5** The Guardian Connect app runs in the background so it can send alerts. Don't force close your app unless you want to stop receiving the alerts.
- 6** Keep your mobile device charged.
- 7** Keep your mobile device and transmitter within 20 feet of each other. Otherwise, the system won't be able to send glucose information.
- 8** Set your mobile device's ringer to a level that you can hear or feel (vibrate).

Please check your mobile device's user manual for more information on adjusting your mobile device's settings.



WARNINGS: If you close the app you will not receive any sensor glucose information or alerts. The app needs to be open or running in the background in order for you to get sensor glucose information.

Every now and then you should check that your app is still open and running. If you're running a few apps at once, it's possible that your Guardian Connect app might close. You may see a "Lost Communication" notification if it closes.

If your mobile device shuts off and turns back on, your app will not reopen on its own. Open the app again after restarting your mobile device in order to avoid missing sensor glucose information and alerts.

Don't assume my app is always open and able to give alerts. Must check app is still running.



WARNINGS: You won't receive any sensor glucose alerts if Bluetooth® is turned off in your mobile device. If you turn on Airplane mode, make sure to turn on Bluetooth®.



WARNING: Do not use your Guardian™ Connect app if your mobile device screen or speakers are damaged. Otherwise, you may miss important sensor information and alerts.

SECTION 3: SETTING UP MY GUARDIAN CONNECT SYSTEM

Now that we have covered the basics of how CGM works let's set up your Guardian Connect app on your mobile device.



Install the application:

- To download your Guardian Connect app:**
1. Search for "Guardian Connect" in your mobile device's app store. Then follow the steps to install it.

- To open the application:**
2. Tap  on your mobile device.
 3. Follow the steps on the screen to set up your Guardian Connect app.
 4. When you have reached the **Start Sensor** screen, go to the next page of this Getting Started Guide for **Inserting and Starting your Sensor**.

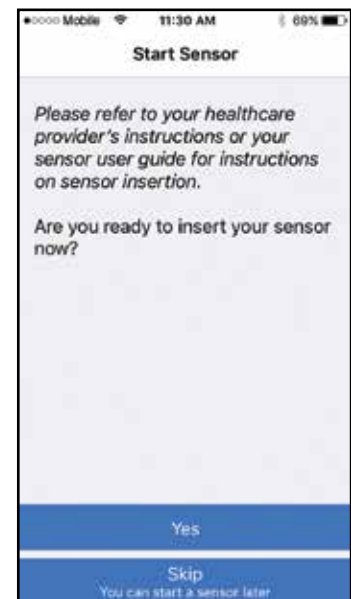

Inserting and Starting My Sensor

Gather all of your supplies to insert your sensor.

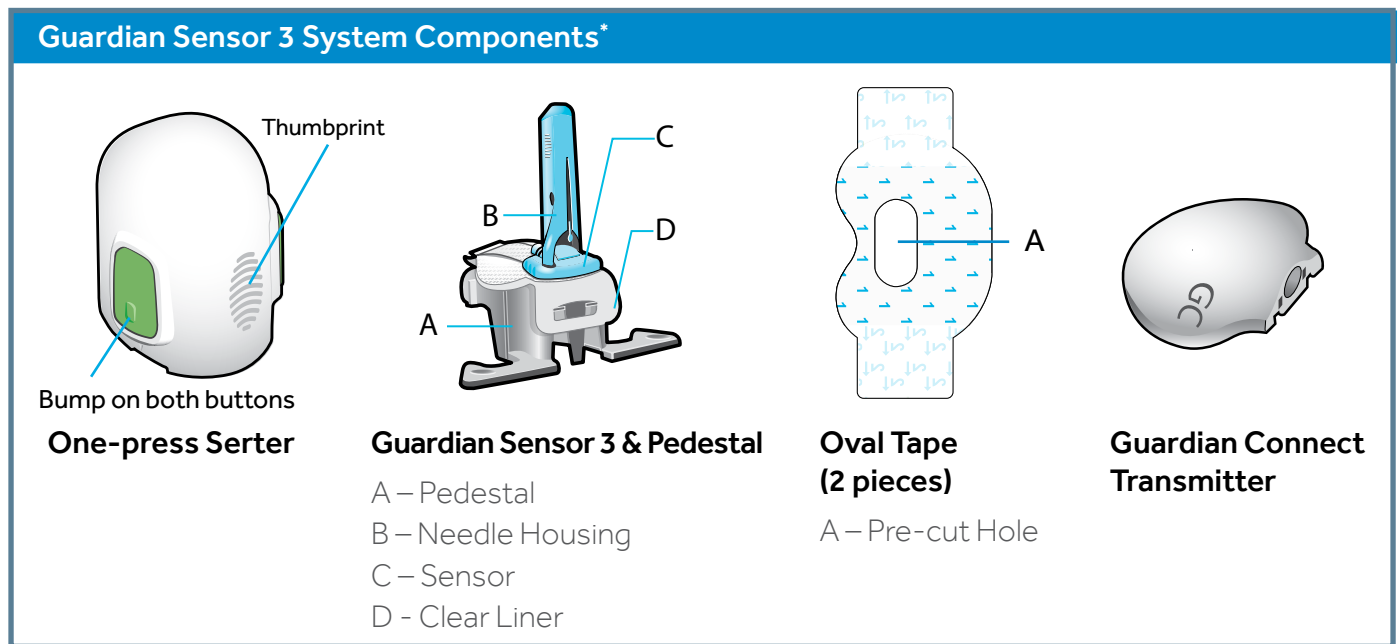

*Check the Guardian Sensor 3 User Guides for more information.

One-press serter is required in order to insert the sensor properly

Guardian Sensor 3 is individually packaged and comes attached to a plastic pedestal which is necessary to properly load the sensor inside the serter

Oval tape is required to keep the sensor in your body

Guardian Connect transmitter is connected after the sensor is inserted and covered with the oval tape



WARNINGS: Do not expose your sensor or transmitter to Magnetic Resonance Imaging (MRI) equipment, diathermy devices, or other devices that generate strong magnetic fields (for example, x-ray, CT scan, or other types of radiation). Always remove your sensor and transmitter before entering a room that has x-ray, MRI, diathermy, or CT scan equipment. Exposing your sensor or transmitter to a strong magnetic field has not been evaluated and can cause the devices to malfunction, result in serious injury or be unsafe.



Selecting My Insertion Site

Choose a site that has enough fat on your abdomen or back of your upper arms. The image shows the shaded areas of the abdomen and back of the upper arms that you can use.**

Note: You may need assistance with inserting the sensor into the back of your upper arm. Some users may find it difficult to insert the sensor in their arm by themselves.

Insert your sensor at least:

- 2 inches (5 centimeters) from your navel
- 1 inch (2.5 centimeters) from your insulin
- 1 inch (2.5 centimeters) from any manual insulin injection site

** Glucose sensors were inserted in the shaded areas of the abdomen and back of the upper arms in clinical trials.

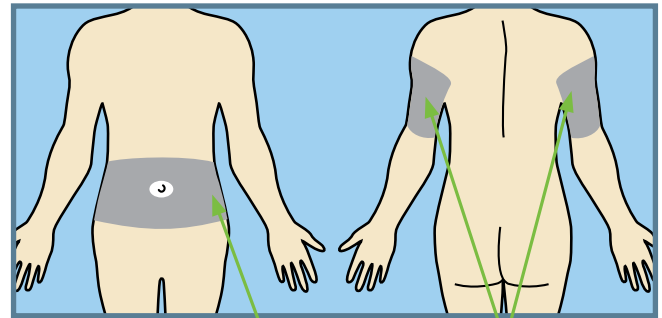

Abdomen

Back of upper arms

For best sensor glucose performance, avoid sites:

- Where your clothing may rub or be too tight (such as your beltline)
- Where your body naturally bends a lot as this may cause the sensor to pull out
- That are scarred, have hardened tissue or stretch marks
- Where there is a lot of movement or rubbing

Preparing My Site

- Wash your hands with soap and water.
- Clean the site you chose with an alcohol swab and allow the alcohol to dry. Do not use IV prep.

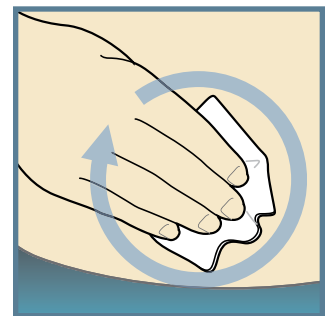
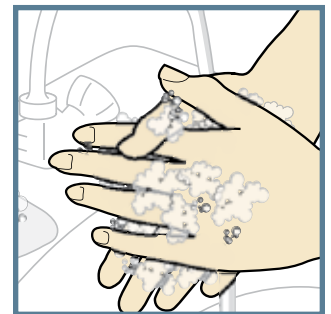

WARNINGS: Only use the One-pressserter to insert the Guardian Sensor 3. Other Medtronic sserters do not work the same way. Follow all instructions carefully to avoid improper insertion, pain, or injury.

Only use the Guardian Sensor 3 with a compatible transmitter. Otherwise, the components may become damaged or you may get inaccurate sensor readings.

Inserting My Sensor

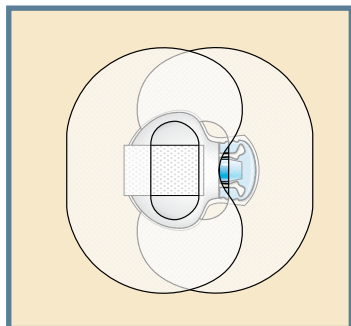

Example of Guardian Sensor 3 after it is inserted and taped.



1. Open the sensor package. Pull the corner of the paper covering to open the sensor package.



WARNING: Sensors are sterile unless the package has been opened or damaged. Don't use the sensor if the package is opened or damaged before use.

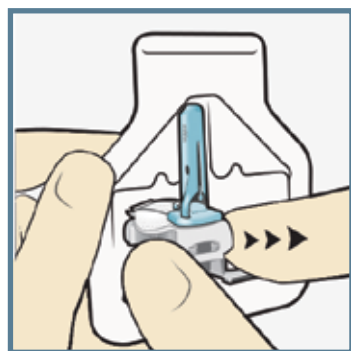

2a. Hold sensor by plastic pedestal.

Hold the pedestal and remove the entire sensor assembly from the package. Place the sensor/pedestal on a clean, hard, flat surface (a table).

The tab is tucked

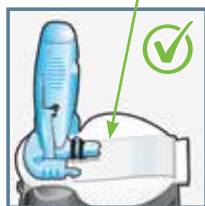

Correct



Incorrect

2b. Tuck adhesive tab.

Make sure that the sensor's adhesive tab is tucked under the sensor connector and snaps.



Correct



Incorrect

3. Hold serter correctly. Place your thumb on the thumbprint marking to hold the serter without touching the green buttons.

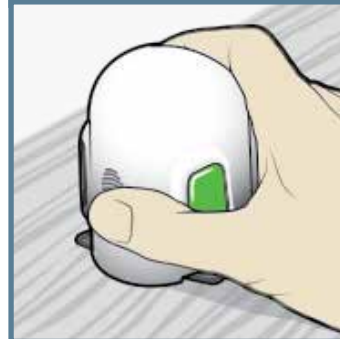

4. Load sensor into serter. Grip the serter exactly as shown **with your thumb placed on the thumbprint marking. Do not hold the green buttons.** Carefully push the serter down onto the pedestal until the base of the serter sits flat on the table and you hear a click.



NOTE: The thumbprint on the serter can be used for either the left or right hand.

Inserting My Sensor, cont'd

Fingers are NOT holding the green buttons.

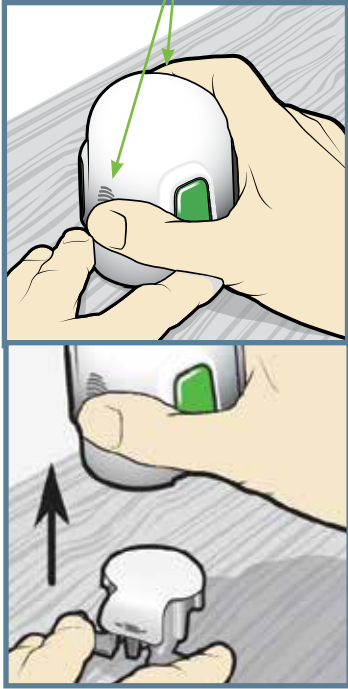

5. Detach serter from pedestal.

Place your thumb of one hand on the thumbprint marking and grip the serter **without touching the green buttons**. With the other hand, place two fingers on the pedestal arms. Slowly pull the serter straight up. **Do not detach the pedestal from the serter in mid-air as this may damage the sensor.**



NOTE: The sensor stays inside the serter after you remove the pedestal. The arrow on each side of the serter shows the location of the sensor needle.

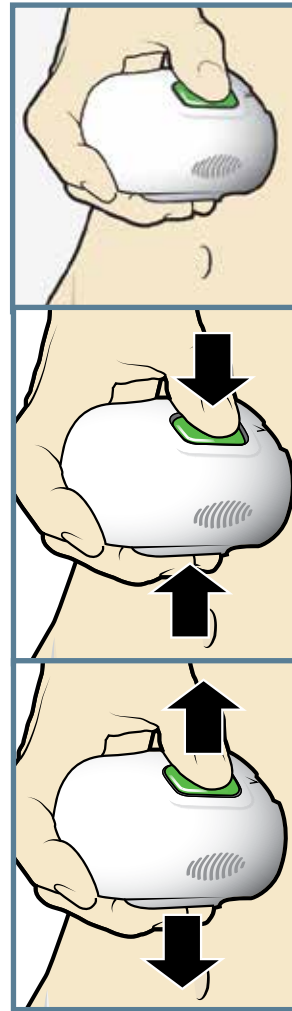

6a. Place serter on body. Hold the serter flat and steady against the cleaned site that you chose. Don't push the serter into your skin.

6b. Insert sensor. Press and release the **bump** on both green buttons at the same time. Don't pull the serter away from your body yet.



NOTE: If you don't hold the serter flat against your body when you press the buttons, the serter might spring back. This could cause the sensor to insert improperly.



6c. Hold serter against body. Keep holding the serter against your body for at least five seconds to let the adhesive stick to your skin.

Do not press buttons

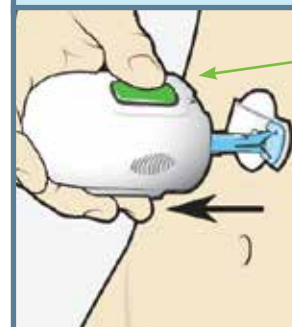

6d. Remove serter from body. Slowly pull the serter away from your skin, **making sure the buttons are not pressed.**

Inserting My Sensor, cont'd



7. Remove needle housing. Hold the plastic sensor base against your skin. (Your fingers should be holding down both the sensor connector with black rings and the other end of the base.) Using your other hand, hold the tip of the needle housing and pull it straight out.

Throw away the needle housing in a sharps container.



WARNING: Check your sensor site for bleeding after you insert the sensor. If there is bleeding, put pressure on it using a sterile gauze for up to three minutes. If the bleeding doesn't stop, or there is a lot of blood under the plastic base, or you have pain, then remove the sensor and insert a new one in a different spot.

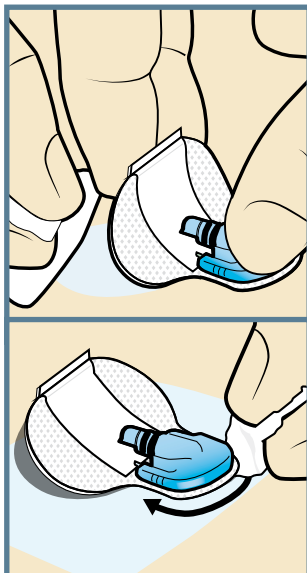

OPTIONAL: Apply additional liquid adhesive. You may use an optional liquid adhesive such as Skin Tac™ if you need the sensor to stick better. Lift the sensor adhesive pad and wipe the Skin Tac on your skin. You can also wipe the top of the adhesive pad and the edges around the sensor.

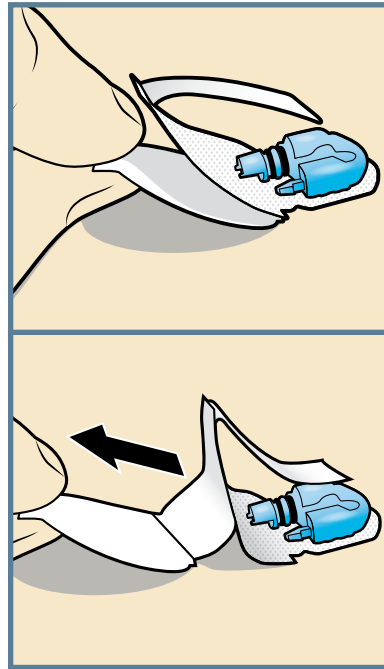

8a. Remove adhesive pad liner. Gently hold down the sensor, and remove the paper liner from under the adhesive pad. Do not remove the liner on the rectangular adhesive tab yet.

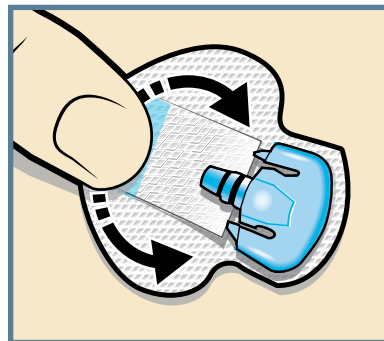

8b. Press entire adhesive pad to skin. Firmly press the entire adhesive pad against your skin so that it sticks to your skin.



NOTE: The Guardian Sensor 3 adhesive sticks better when you press it to the skin well. Make sure to press it to your skin well in order for the sensor to stay inserted for the whole 7 days that you wear it.

Inserting My Sensor, cont'd

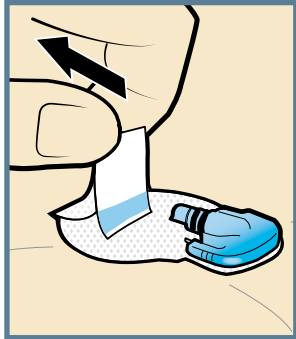

9a. **Untuck adhesive tab.** Untuck the adhesive tab from under the sensor connector.



9b. **Straighten adhesive tab.** Straighten the adhesive tab so that it lies flat against your skin, but don't remove the paper liner yet.

Taping Your Sensor with First Piece of Oval Tape

Before you connect the transmitter to your sensor it is very important that you properly tape the sensor using the oval tape.

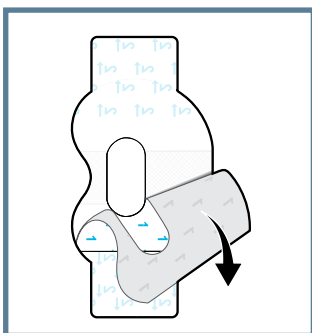

1. **Remove liner 1** from oval tape.

Wide part of tape covers half of sensor base.

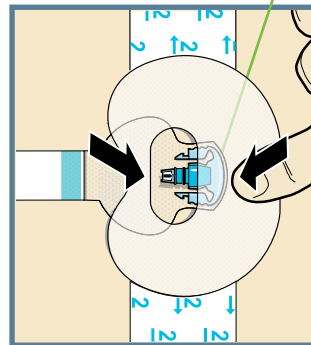

2. **Apply the tape as shown and press down firmly.**

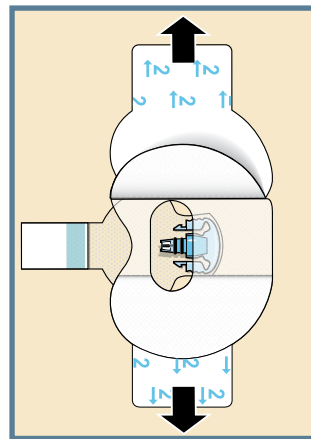

3. **Remove liner 2** from each side.

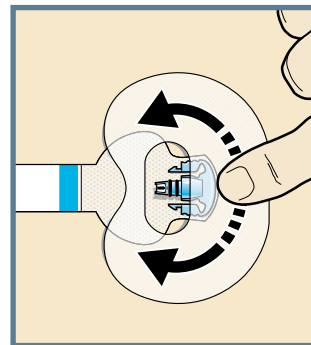

4. **Smooth the tape.**

Connecting Your Transmitter

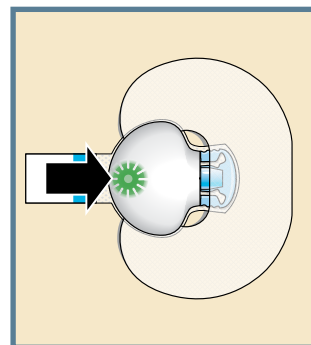

1. **Connect the transmitter to your sensor. Note:** Wait for the green light on the transmitter to flash. If the green light does not flash, check the Troubleshooting section of your transmitter user guide.

Connecting My Transmitter, cont'd.



IMPORTANT: If you don't see a green light flashing on your transmitter after you connect it to your sensor, then disconnect the transmitter and plug it back into the charger to make sure that it is fully charged. Then try again and reconnect your transmitter to your sensor.

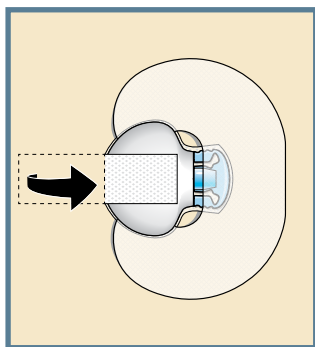

2. **Stick the adhesive tab on the transmitter.** Do not pull the tab too tightly when you stick it on the transmitter. Otherwise, the transmitter may lift from the skin.

Applying Second Piece of Oval Tape

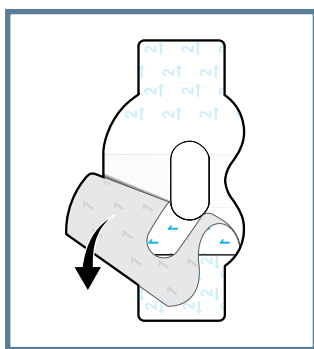

1. To apply the 2nd oval tape, remove liner 1.

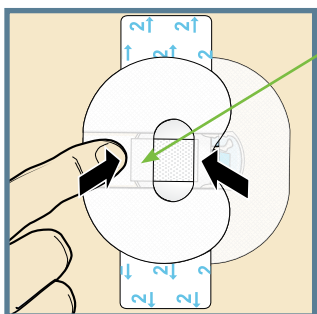

Wide part of tape covers end of transmitter and skin.

2. **Apply the 2nd tape in the opposite direction to the first tape and place it on the transmitter.** Press down firmly.

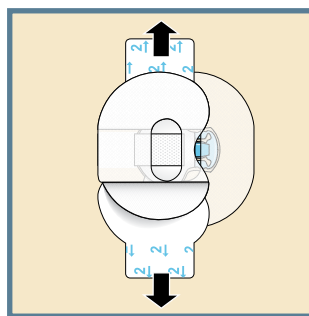

3. **Remove liner 2 from each side.**

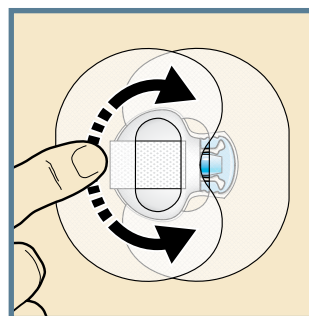

4. **Smooth the tape.**
Note: Check your sensor site regularly. Apply other off-the-shelf tape if your sensor and transmitter aren't secure.

Starting My Sensor

Now that you have inserted and taped your sensor, return to your Guardian Connect app on your mobile device to complete the sensor start up. Tap **Start New Sensor**.



Removing Sensor in Seven Days

1. Peel off tape.
2. Disconnect transmitter by pinching side arms of sensor. Then pull transmitter away.
3. Plug transmitter into charger.
4. Peel off and throw away sensor.



NOTE: When your transmitter is connected to your sensor they are water-tight in 8 feet (2.4 meters) of water for up to 30 minutes. You can shower and swim without removing them.



NOTE: The oval tape is key to your success with the sensor. It's very important to apply the oval tape because your sensor is small and flexible. The oval tape will help prevent your body's motion from pulling it out.

Check that the Oval Tape was Applied Properly

Correct

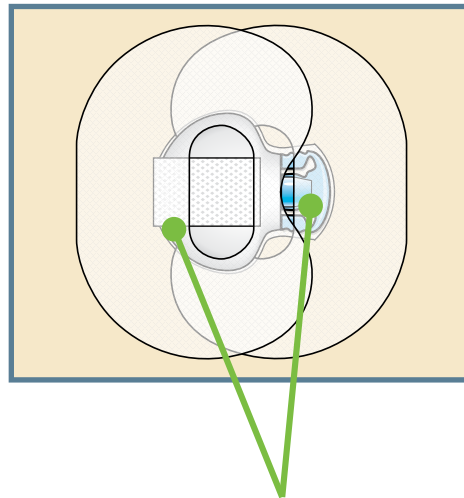

Oval tape is covering the sensor, skin around sensor, and back of transmitter.



KNOWLEDGE CHECK

It is necessary to put your thumb on the thumbprint marking on theserter in order to:

- A. Avoid accidentally pressing the green buttons before you are ready to insert the sensor.
- B. To insert the sensor into the skin.
- C. I don't know.

Taping the sensor for extra security is optional.

- A. True
- B. False

Personalizing My Alerts



Completing Setup of My Guardian Connect System

The Guardian Connect app will give you **sensor glucose alerts** to tell you when your glucose is high or low. It will also give you **system status alerts**.

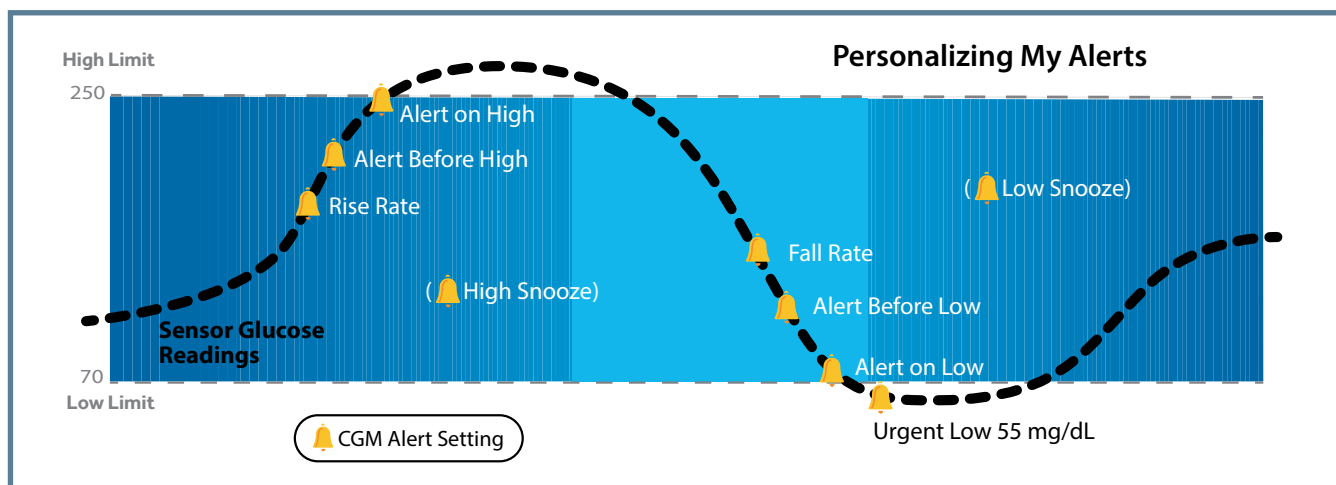
Sensor Glucose Alerts



Notifications

Notifications for your app must be turned ON in order for you to receive any alerts. When you are setting up your app for the first time, it will ask you to allow the notifications. You must NOT turn off the Notifications in your mobile device settings. If you turn off Notifications by mistake,  will appear on the app's home screen. Tap  and then, tap the message.



WARNING: You must allow notifications for your Guardian™ Connect app during setup. Do not turn off notifications for the app in your mobile device settings. If you turn off notifications, you will not receive any alerts.

Audio Override

The app has an override feature that allows your app alerts to sound at maximum volume even if your mobile device's ringer volume is set to Do Not Disturb, low volume, or silent (vibrate). The audio override feature is already turned On for all app alerts when you first start using your app. But you can choose which alerts (Low Glucose, High Glucose, and/or System Status Alerts) will override the ringer volume. You can change this setting in the app menu if you prefer not to override your mobile device's ringer volume.



Turned On

To Change Your Audio Override Setting:

1. Tap  on your app home screen. Tap **Alert Settings**. Then tap **Audio**.
2. Switch **Override** to On or Off.
3. Switch your **Low, High, and/or Status Alerts** to On or Off.
4. At the top of the screen, tap **Save**.



WARNING: If you turn off your audio override, the volume for your app alerts will be the same as your mobile device's ringer volume. You might miss important app alerts when your mobile device's volume is set to Do Not Disturb, silent (vibrate), or low volume. Make sure to set your mobile device's volume high enough so that you can hear the alerts.

| HOW DOES THE AUDIO OVERRIDE WORK? | | |
|---|---|---|
| Your app settings | Your mobile device's volume | App alerts you will get |
| Audio Override ON  | Ringer is ON Ringer is OFF (silent or vibrate) Do Not Disturb is ON | Sound at maximum volume |
| Audio Override OFF  | Ringer is ON | Same sound as mobile device's ringer volume |
| | Ringer is OFF (silent or vibrate) | No sound (and will vibrate if on) |
| | Do Not Disturb is ON | No sound or vibrate |

Using the Audio Override...

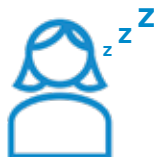

Marley is getting ready to sleep. She sets her phone to Do Not Disturb because she doesn't want to hear any calls or text messages until the next morning. But she wants to wake up if she gets a **low sensor glucose alert**.

Which alert should she set to override her phone's Do Not Disturb?

Answer: Audio Override on for Low Alerts



Urgent Low Alert

There is one exception. You will still get an **Urgent Low Sensor Glucose Alert** that sounds when your sensor glucose value reaches or falls below **55 mg/dL** even if the audio override is turned off. But remember, notifications must be on.



WARNING: Notifications must be turned on for the Guardian Connect app in order for the Audio Override to work and to hear the Urgent Low alert.

This graphic shows whether you will get your app alerts when Notifications are turned On or Off:

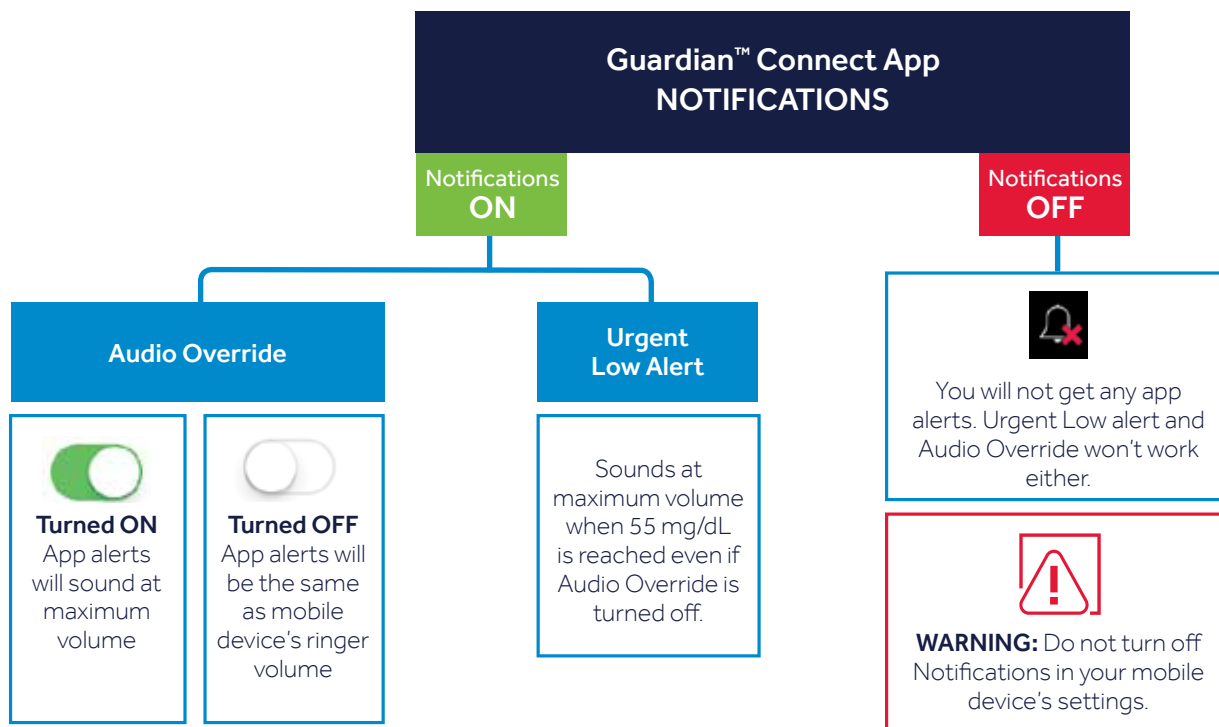

Setting Up Alerts

When you have reached the **Sensor Alerts** screen, set your alerts using your healthcare professional's recommendations.

Then write down your alert settings on the **CGM Settings Form** on page 25.

- Your CGM alert settings will work best if they are personalized for your needs.
- Your healthcare professional will work with you to decide your initial settings and help you adjust them.

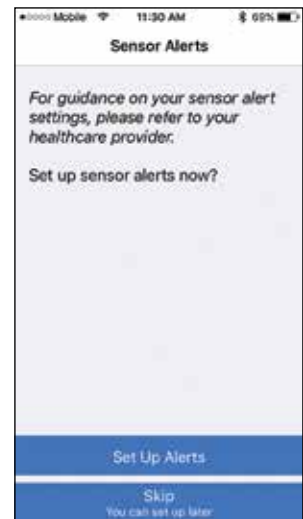

| HIGH GLUCOSE SETTINGS | |
|--------------------------|---|
| ALERT SETTING | WHAT IT MEANS |
| High Limit | The sensor glucose value that your healthcare provider decides is high for you. This is the value that the other high settings are based on. |
| Alert on High | Your sensor glucose value has reached or risen above your high limit. |
| Alert Before High | Your sensor glucose value is predicted to reach your programmed high limit. |
| Time Before High | Your app can notify you from 10 minutes up to 1 hour before your sensor glucose value is expected to reach your high limit. |
| Rise Alert | Your sensor glucose has been rising rapidly. Shown by ↑, ↑↑, or ↑↑↑ |
| Snooze Time | It's the period that you don't want to be reminded that you have a high alert. You can set this time for up to 3 hours. You won't get the same high alert again during this snooze time even if your condition doesn't improve. |

Snoozing an alert...

Stephen's doctor instructed him to turn on **Alert on High**. If his sensor glucose reaches his high limit of 200 mg/dL, he checks his BG and takes insulin if he needs it. If he doesn't want to be alerted again for 2 hours that his SG is still high, what alert setting should he program?

Answer: Snooze Time at 2 hours



LOW GLUCOSE SETTINGS

| ALERT SETTING | WHAT IT MEANS |
|------------------|--|
| Low Limit | The sensor glucose value that your healthcare provider decides is low for you. This is the value that the other low settings are based on. |
| Alert on Low | Your sensor glucose value has reached or fallen below your low limit. |
| Alert Before Low | Your sensor glucose value is predicted to reach your programmed low limit. |
| Time Before Low | Your app can notify you from 10 minutes up to 1 hour before your sensor glucose value is expected to reach your low limit |
| Fall Alert | Your sensor glucose has been falling rapidly. Shown by ↓, ↓↓, or ↓↓↓. |
| Snooze Time | It's the period that you don't want to be reminded that you have a low alert. You can set this time for up to 1 hour. You won't get the same low alert again during this snooze time even if your condition doesn't improve. |

There are also system status alerts. You can find a description of these alerts on page 46.



WARNING: Notifications must be turned ON for your app in order to get any app alerts. Otherwise, you won't get any alerts including the Urgent Low alert even if the Audio Override is turned on.



WARNING: If you miss alerts from your Guardian™ Connect app, you may not know if you have low or high glucose levels. Follow the instructions and safety warnings in the Guardian™ Connect system user guide to make sure you receive alerts.

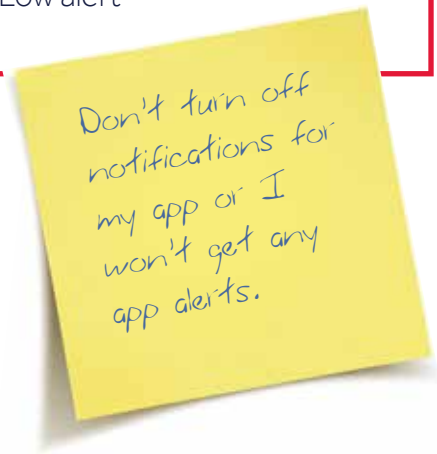

KNOWLEDGE CHECK

Marley is getting ready to go to sleep. She sets her phone to silent because she doesn't want to hear phone calls or texts, but she does want to hear her Guardian Connect app alerts. What should she do?

- A. Check that the Audio Override is ON.
- B. Check that the Audio Override is OFF.
- C. I'm not sure.



KNOWLEDGE CHECK

Stephen is going to a class. He doesn't want to hear any phone calls, texts, or Guardian Connect app alerts. He wants all his phone calls, texts, and app alerts to be silent. What should he do?

- A. Turn the phone's ringer to silent. Turn ON the Audio Override.
- B. Turn the phone's ringer to silent. Turn OFF the Audio Override.
- C. I don't know.

Stephen is going home now that the class has ended. He wants to hear his Guardian Connect app alerts even if his phone calls and texts stay silent. What should he do?

- A. Keep the phone's ringer to silent. Turn ON Audio Override.
- B. Turn ON phone's ringer. Turn OFF Audio Override.
- C. I have no idea.

Marley has High Alerts set up. But she turns OFF Notifications for her Guardian Connect app in her phone's Settings. Now what would happen if she has a high glucose?

- A. She would get the high glucose alert.
- B. She would NOT get the high glucose alert.
- C. I'm not sure.

Marley glances at her Guardian Connect app and sees that her sensor glucose is high, but she didn't get an alert. What should she do?

- A. Check that Notifications are ON for her app in the phone's Settings.
- B. Turn OFF Audio Override
- C. I don't know.

Stephen is going to a loud music festival. What should he do to stay on top of his diabetes?

- A. Do nothing different.
- B. Check his Guardian Connect app more often as he won't be able to hear the alerts.
- C. I'm not sure.

Marley is on a flight to New York. The flight attendant instructs everyone to put their phones in Airplane Mode. What should she do to stay on top of her diabetes?

- A. Turn on Airplane Mode and then turn on Bluetooth®.
- B. Don't turn on Bluetooth® while in Airplane Mode, but know that she won't get any glucose alerts. Check with a blood glucose meter instead.
- C. Either A or B

Guardian Connect - Continuous Glucose Monitoring Settings Form

Write down your CGM settings here for future reference.

| HIGH SETTING | LOW SETTING |
|--|---|
| High Limit _____mg/dL | Low Limit _____mg/dL |
| Alert Before High ____ON ____OFF | Alert Before Low ____ON ____OFF |
| Time Before High _____Minutes ____Hour | Time Before Low _____Minutes ____Hour |
| Alert on High ____ON ____OFF | Alert on Low ____ON ____OFF |
| Rise Alert ____↑ ____↑↑ ____↑↑↑ | Fall Alert ____↓ ____↓↓ ____↓↓↓ |
| Snooze Time _____Minutes ____Hour | Snooze Time _____Minutes ____Hour |
| Audio Override ____ON ____OFF | Audio Override ____ON ____OFF |

My settings may need to be adjusted after I start using CGM.

SECTION 4: CALIBRATING MY SENSOR

You will need to calibrate your sensor in order to get sensor glucose readings and for CGM to work at its best. To calibrate, you must use a fingerstick blood sample to check your BG on your meter and then enter that BG value into your Guardian™ Connect app. CGM does not remove the need for BG meter checks.

You won't receive sensor glucose values if your Guardian™ Connect system isn't calibrated regularly.

You will need to calibrate your sensor after it is inserted:

- About 2 hours after you connect your transmitter to your sensor and start the **Warm up** period. You will receive a **Calibrate now** alert when it is ready for its first calibration.
- Again within 6 hours from the first calibration. You will only need to do this on the day you insert the sensor.
- Again every 12 hours from your last calibration.
- Again if the system asks you to calibrate more often to improve the sensor's performance.

| Calibration Schedule | |
|--------------------------------|-------------|
| Day 1 | |
| Sensor inserted: | _____ AM/PM |
| I will calibrate: | |
| 2 hours after sensor inserted: | _____ AM/PM |
| Within the next 6 hours: | _____ AM/PM |
| At bedtime: | _____ AM/PM |
| Day 2 to Day 7 | |
| I will calibrate: | |
| When I wake up: | _____ AM/PM |
| Again within 12 hours: | _____ AM/PM |
| Again if system asks: | _____ AM/PM |
| At bedtime: | _____ AM/PM |

Calibration Checklist:

- ✓ Wash your hands before checking your BG
- ✓ Calibrate at least 2 times a day or when you get a **Calibrate now** alert. 3 - 4 times a day is best.
- ✓ Calibrate before meals and when there are no arrows showing on your app
- ✓ Enter the BG into the app right away if it is a good time to calibrate
- ✓ Don't use an old BG reading
- ✓ Don't reuse BG readings from earlier calibrations
- ✓ Wait at least 15 minutes in between calibrations

Blood drop







Tap the **blood drop** on the app to calibrate.



Calibrating My Sensor

Calibration timer

On your Home screen the calibration icon tells you how much time is left until your next calibration is due:

-  **12 hours left** before you need to calibrate again
-  **6 hours left** before you need to calibrate again
-  **3 hours** are left
-  **1 hour** is left
-  **Calibration is due now.** Calibrate using your blood glucose meter
-  **Calibration is not allowed yet**



To calibrate:

- 1.** Check your blood glucose on your meter.
- 2.** Tap the **blood drop** on the top right corner of the app's Home Screen.



- 3.** Enter your blood glucose reading using the keypad. It will only accept 40 - 400 mg/dL.



- 4.** Tap **Calibrate** at the top right corner of the screen.



- 5.** Tap **Calibrate sensor -- mg/dL.**

The app will return to the home screen. A  will appear on the graph at the time the blood glucose was entered. Your sensor glucose reading will appear in about 5 minutes after the blood glucose is entered.



IMPORTANT: If you notice a large difference between your BG meter reading and your sensor glucose readings, wash your hands and do another BG check to make sure it is correct. Check the sensor site to ensure that the sensor tape is still holding the sensor in place. If there is still a large difference in glucose readings, you may need to do another calibration. Wait 15 minutes before you try to calibrate again.

Calibration Reminder

You can use the Calibration Reminder to give you advanced notice before the next calibration is due. The Calibration Reminder can be set from 5 minutes to 1 hour from the Alert Settings menu option.

Using a Calibration Reminder

Lina calibrates at 7 AM when she wakes up. Her next calibration would be due 12 hours later at 7 PM.

If she wants to be alerted an hour before her next calibration is due, what setting should she program?

Answer: Calibration Reminder at 1 hour



KNOWLEDGE CHECK

What might happen if a calibration is required and you don't do it?

- A I won't see any sensor glucose readings
- B I will continue to see sensor glucose readings
- C I may not get important alerts such as Low Sensor Glucose
- D Both A and C

Reading My Sensor Display

Viewing My Main Menu

Press  on the top left corner of your app's Home Screen. You will now see 3 icons in the system status bar. (To close the Main Menu, press X at the top left corner).

System Status

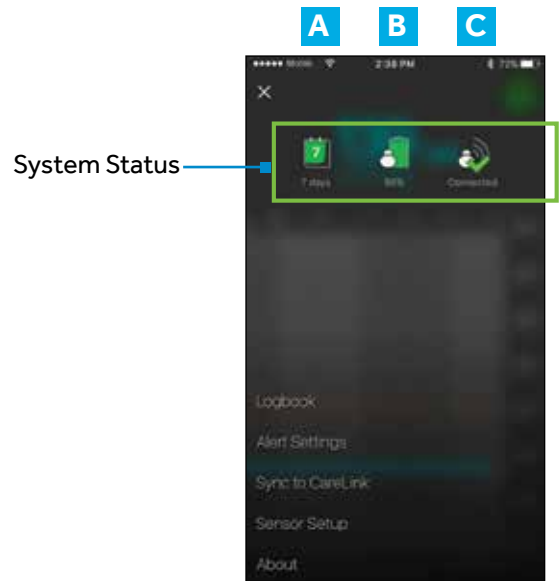

A Sensor Life Icon

After you insert a new sensor you will see how many days your sensor has left. The sensor icon will count down with each day that passes.



B Transmitter Battery Icon

When your transmitter is fully charged, the transmitter battery icon will show as solid green. The icon will change as your transmitter battery drains from 100% to 0%.

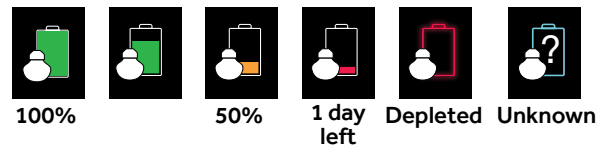

C Transmitter Communication Icon



The transmitter is paired and communicating with your app.



An error in communication, the transmitter is not paired, or Bluetooth® is turned off on your mobile device.

Note: These icons will show at the top of the main menu and home screen when your transmitter battery is low or completely drained, your transmitter is not paired, or your sensor has one day or less before it expires.



Viewing my Home Screen

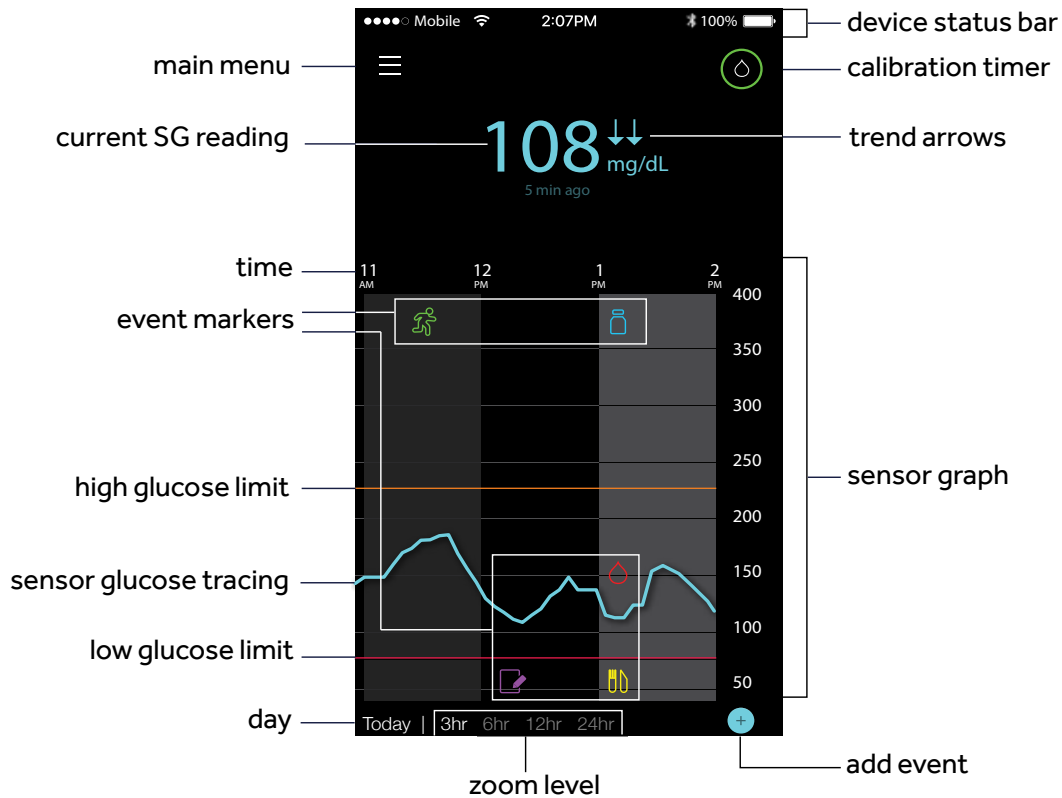

Current Sensor Glucose Value

The most current sensor reading is updated every 5 minutes. The sensor reads glucose values from 40 mg/dL to 400 mg/dL.

Viewing my Sensor Graph

Swipe center of graph, right and left: to view past sensor information

Double tap vertical glucose line on right: to return to current glucose.

Touch SG tracing: to view more details, SG reading, time, date.

Touch event marker on graph: to view more details, event information.

Example of an "info box" for Insulin

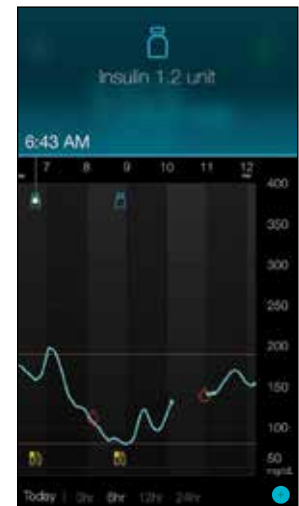

Additional Sensor Graphs

To view 3-hour, 6-hour, 12-hour, and 24-hour glucose graphs:

- tap graph twice or
- select graph hours at bottom of Home screen.

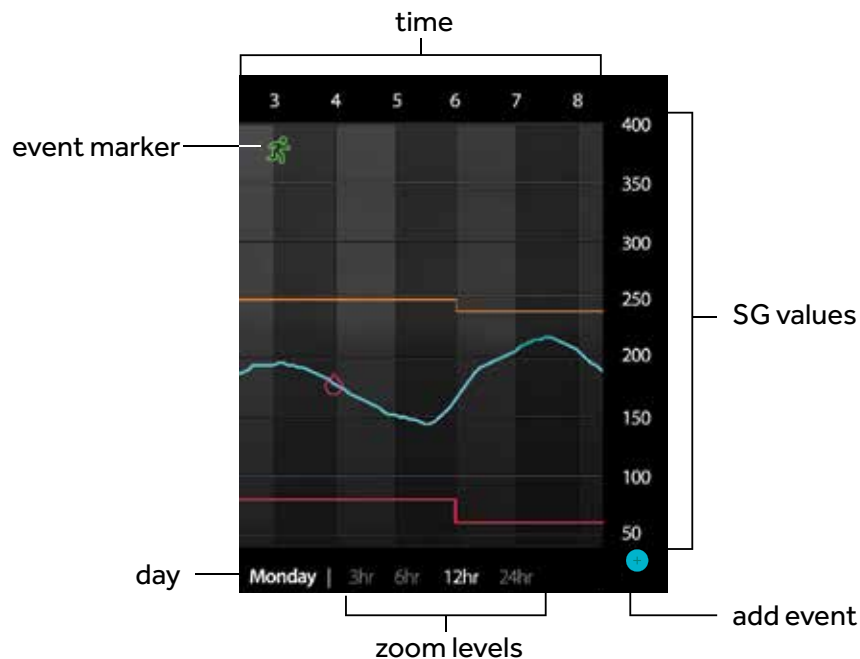

Entering Event Markers

Capture other information right on your app:



Blood Glucose: My BG meter readings. These can be used both to calibrate the sensor and simply to log your BG readings without calibrating the system.



Insulin: The type and amount of insulin you use.



Meal: The amount of carbohydrates you eat or drink.



Exercise: The intensity and duration of exercise you do.



Other: This event can be used to enter any other information about your diabetes management. For example, you can record when you take other medications, when you feel ill, or when you are under stress.



To enter an event marker

1. Tap  on the bottom right corner of your home screen.

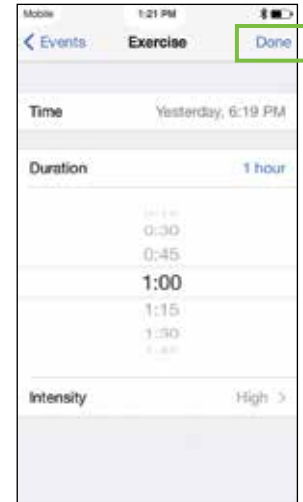

2. Tap the event icon you want.

3. Enter the information for your event.

4. Tap **Done** at the top of the screen when finished.

Your app returns to the home screen and the event icon shows on the graph.



Note: If you entered a BG reading as an event, it can also be used to calibrate the sensor.

1. Enter BG reading
2. Select **Done**
3. When **Calibrate now?** appears, tap **Calibrate sensor -- mg/dL** if you are sure you want to calibrate.



Knowing My Sensor Alerts

What else do I need to know about my app alerts?

When you get a sensor alert:

- **High alerts** will show as **orange**,
- **Low alerts** will be **red**,
- and **Status alerts** (such as Calibrate now) will be **blue**.

Follow the instructions on the screen to address the alert.

Clear alert: Drag bottom of alert screen upwards.

Snooze alert: Drag bottom of alert screen downwards.

Then tap the snooze time or use the - or + to change the snooze time..

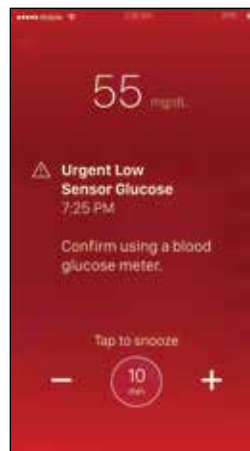
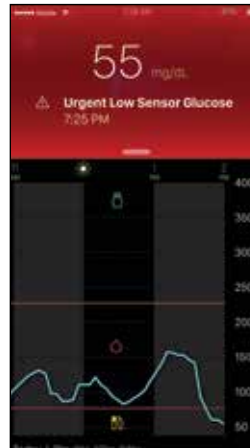

WARNING: If you snooze a sensor glucose alert, you won't get the alert again during the length of the snooze time that you have set, even if your sensor glucose level doesn't improve. Check your glucose with your BG meter while you're in the snooze period.

Sensor Alerts

This screen is an example of a **High Sensor Glucose** alert.



WARNING: If your headphones are plugged into your mobile device and you are not using them, you may not hear important alerts that require you to take action.



WARNING: Notifications must be turned ON for your app in order to get any app alerts. Otherwise, you won't get any alerts including the Urgent Low alert even if the Audio Override is turned on.



See Quick Reference Guides section on page 45 - 46 of this guide for other alerts.

What if I get a **Lost Communication Alert**?

Lost Communication means your app isn't communicating with your transmitter.

The causes include:

- Your app isn't running
- An issue communicating to your mobile device
- An issue with your sensor

Because you may not know what is causing the problem, it is best to follow these steps:

- 1** Open your app to make sure it's still running properly. It may take a few minutes to communicate again.
- 2** Bring your mobile device closer to your transmitter and sensor
- 3** Move away from other equipment (for example, cordless phone or WIFI router) that can cause radio frequency interference
- 4** If that doesn't work, then inspect your transmitter and sensor:
 - Reconnect your transmitter to your sensor **ONLY** if you see that they have disconnected. Note: Doing this will start the warm-up time again which may last up to two hours.
 - Insert a new sensor in a different spot on your body if you see that your current sensor has pulled out from your skin.

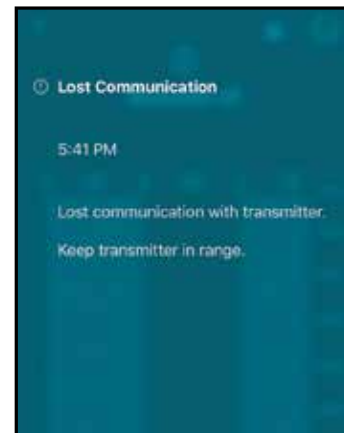

Lost Communication Alert

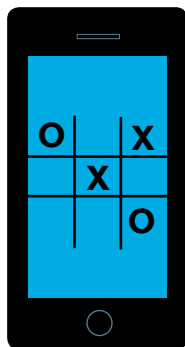

Hanna has a few different apps running on her phone including a game she is playing. Then she sees a **Lost Communication** alert from her Guardian Connect app. This means her app isn't giving her any sensor information.

What should she do?

- Open her app to make sure it's running properly. It may take a few minutes to start working again.
 - She should also check periodically to see if the app is still running in the background.
- If her transmitter is still not communicating with her app, then she should follow the other steps above. If that still doesn't work, then she should call the Helpline to assist her.

USING MY GUARDIAN CONNECT SYSTEM: KNOWING MY SENSOR ALERTS





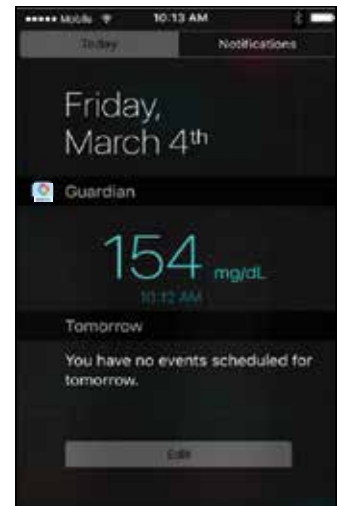





Note: If your mobile device has returned to the locked screen, alerts will also appear on this screen.

Your app must be OPEN or running in the background at all times in order for you to get sensor glucose information and alerts.



KEY REMINDERS:

I will:

-  check my BG with my meter to confirm my SG before making treatment decisions (for example, dosing insulin before a meal or taking carbohydrates to treat a low glucose).
-  calibrate my sensor at least twice a day or more often if the system asks me to. 3 - 4 calibrations a day is best.
-  avoid closing my Guardian Connect app so that I can continue getting sensor glucose alerts.
-  check my Guardian Connect app regularly to make sure it is still running.
-  keep Bluetooth® on so that my transmitter communicates with my app.
-  avoid turning off notifications for my app. Otherwise, I won't get any app alerts.
-  keep Audio Override turned on to hear my app alerts.
-  keep my mobile device charged so that I can always get sensor alerts.
-  select New Sensor (not Reconnect Sensor) each time I insert a new sensor.
-  charge my transmitter after seven days of wearing it.

SECTION 5: SETTING UP MY CARE PARTNER ACCOUNT

Creating My Care Partner's Account and Sharing My Information

Guardian Connect lets you send your glucose data to CareLink Personal software automatically. Your sensor glucose information will show in the **CareLink Connect tab** in the CareLink Personal website every 5 minutes. You can also see your CareLink Personal reports every 24 hours. Your care partner does not need the app in order to see your sensor data.



REMINDER: Ask your healthcare professional (HCP) to look at your CareLink reports at the office or bring your reports with you to your next visit.

You can invite a family member, friend, or other care partners to view your CGM information on the CareLink Personal website by selecting **Manage Care Partners**.

1. Press  on the top left corner of the Home Screen. Tap **Sync to CareLink**.



2. Be sure Sync to CareLink is turned ON. Tap **Manage Care Partners**.

Turned On

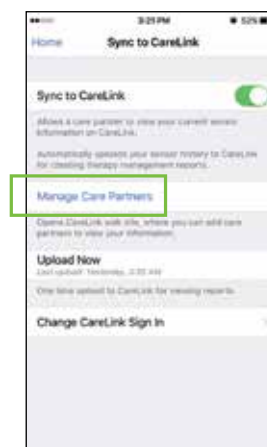

- 2a. If you are at the CareLink Connect screen, tap  on the top left corner of the screen. Tap **Connect Settings**.



3. Set a nickname for yourself. When your care partner receives a text message with an alert your nickname will appear in the message. Then tap Save.

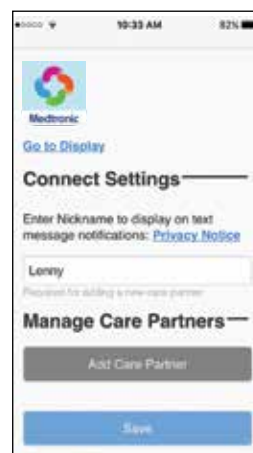

4. Tap **Add Care Partner**. Fill in the required information for your care partner (first and last name). You can add up to 5 care partners to your CareLink Personal account.

Create a unique username for your care partner and temporary password, then tap Save. This temporary password is valid for 24 hours. Give this username and password to your care partner.



Set Up and Access to the Care Partner Account

1. Next, your care partner will need to:
 - go to the CareLink Personal website (carelink.minimed.com) using a web browser on his/her own mobile device or computer.
 - login with the username and temporary password that you created.
 - check all boxes in Terms of Use. Tap **Accept**
 - change the temporary password to a new one. Tap **Next**.



2. Your care partner will fill out the rest of the information on the My Info screen. Then tap Save.

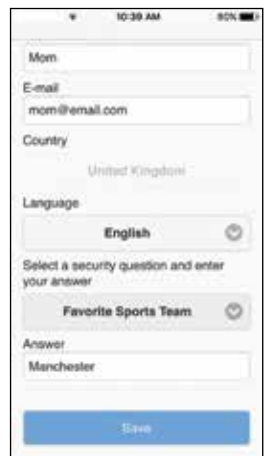

3. Your care partner must enter his/her mobile number and check the **Active** box in order to receive text message alerts. Tap Save when complete.

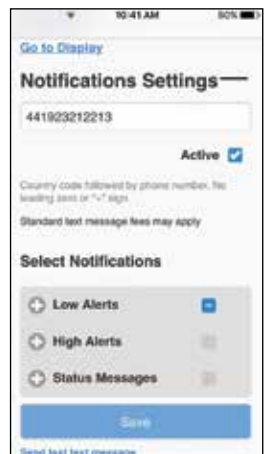

Setting Care Partner Notifications

Selecting Low Alerts and High Alerts

Your care partner can use either a computer or internet browser on a mobile device to choose what Guardian Connect alerts they want to receive. If you haven't cleared an alert in your Guardian Connect app, a text message will be sent to your care partner. The text message will be sent using the 0-30 minute delay that is set in **Select Notifications**. If your care partner does not want a delay in alerts, select 0. Once all desired notifications have been made, tap Save.

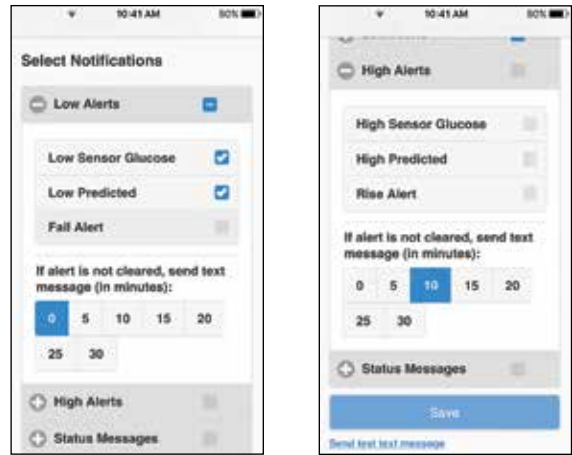

NOTE: Your care partner may only receive alerts and alarms that you have set in your Guardian Connect app regardless of the Notification(s) that your care partner chooses. For example, if you do not set High Alerts in your Guardian Connect app, your care partner will not receive High Alert messages even if it is selected in Select Notifications on the CareLink Personal website.

Selecting Status Messages

Your care partner can also choose to receive text messages for app Status Messages. If you haven't cleared the status alert on your app, a text message will be sent to your care partner using the 0-30 minute delay that is set in **Select Notifications**. If your care partner does not want a delay in alerts, select 0. Once all desired notifications have been selected, tap Save.

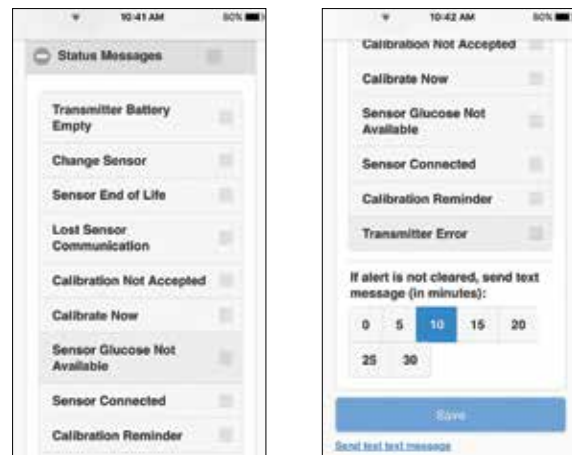

SECTION 6: APPENDIX

Charging and Storing my Transmitter

Charge your transmitter before each use. When your transmitter is charging, a green light will flash on the charger. This green light will turn off when your transmitter is completely charged. You will need to charge your transmitter after each sensor you use. A fully charged transmitter can be used for a maximum of seven days without recharging. It can take up to 2 hours to fully recharge.

When you remove the fully charged transmitter from the charger, you will see 10 quick green flashes on the transmitter followed by 20 minutes of slow green flashes. This means that it has enough battery power for the entire time that you're wearing it. If you do not see these two types of green flashes on your transmitter after it is removed from the charger, plug it back on to the charger until it is fully charged. **Note:** Once you pair the transmitter to the app, the green flashes stop. When you connect the transmitter to the sensor, the transmitter will flash for a few seconds only.

Store the transmitter, charger, and tester in a clean, dry location at room temperature. Do not store the transmitter on the charger for more than 60 days. Otherwise, the transmitter battery will be permanently damaged. If you are not using your transmitter, you must charge it at least once every 60 days.

If you connect transmitter to charger and you see no lights on the charger: replace the battery in the charger.

While charging your transmitter you see a flashing red light on the charger: replace the battery in the charger.

While charging your transmitter you see a mix of short and long flashing red lights on the charger: replace the battery in the charger and fully charge the transmitter.

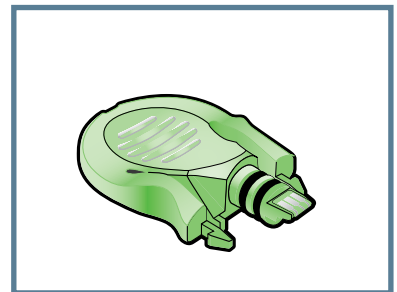
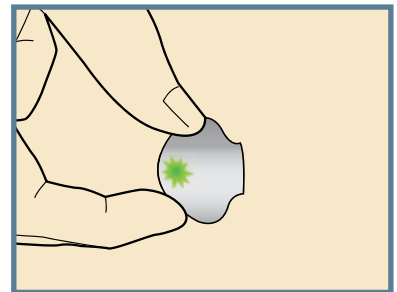
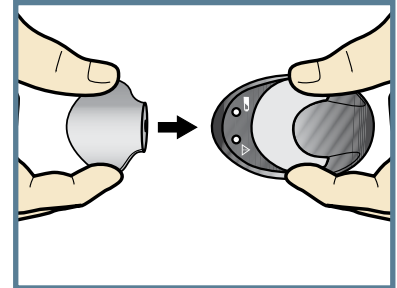

Tester



WARNING: Do not use the transmitter if you see that it's cracking, flaking, or its housing is damaged. These are signs that the transmitter is deteriorating. This deterioration can make it difficult to clean the transmitter properly and could result in serious injury.

Refer to your Guardian Connect System User Guide for more information.

Going through Airport Security

The full body scanner may be a form of x-ray. If you choose to go through the full body scanner, you will need to remove your sensor and transmitter before the scan. To avoid removing your devices, you should ask for an alternative screening process that does not use x-ray. Your CGM system can withstand exposure to metal detectors and wands used at airport security checkpoints.



Traveling by Air

If you wear a CGM device, it is safe for use on commercial airlines. If airline personnel request that you turn off your CGM device, you must comply.



NOTE: It is important that you test your blood glucose (BG) more frequently while you are traveling. The routine hassle of travel, including stress, changes in time zones, schedules, activity levels, meal times and types of food, can all affect your diabetes control. Be extra attentive to monitoring your BG frequently, and be prepared to take action if needed.

Answer Key:

Page 5: 1) A 2) BG, SG, SG

Page 7: 1) A 2) D

Page 18: 1) A 2) B

Page 23-24: 1) A 2) B 3) A 4) B 5) A 6) B 7) C

Page 28: 1) D

What Do My Sensor Alerts Mean?

See your healthcare professional regularly to check your CGM settings. Your settings may need to be changed at times. Follow the instructions on the screen to address the alert.

To **clear the alert**, drag the bottom of the alert screen up.

To **snooze the alert**, drag the bottom of the alert screen down. Then tap the snooze time. You can change the snooze time using the - and +.

| Alert setting | Alert shown on screen | What it means | What I should do |
|------------------------------------|---------------------------|--|--|
| High Limit | High Sensor Glucose | Your sensor glucose value is equal to or greater than your high limit that you have set. | <ul style="list-style-type: none"> Check your blood glucose using your BG meter. Make sure to use a blood sample from your finger. Don't use your sensor glucose values to make treatment decisions (for example, dosing insulin before a meal or taking carbohydrates to treat a low glucose). Follow your healthcare professional's instructions for treating your glucose. |
| Low Limit | Low Sensor Glucose | Your sensor glucose value is equal to or lower than your low limit that you have set. This setting is in addition to Urgent Low alert. | |
| Urgent Low (cannot be changed) | Urgent Low Sensor Glucose | Your sensor glucose has reached 55 mg/dL or below. You will still hear a sound with this alert regardless of your mobile device's volume or Audio Override. But remember, notifications must be kept on. | |
| Alert Before High Time Before High | High Predicted | Your sensor glucose is expected to reach your high glucose limit in the length of time you have set. | |
| Alert Before Low Time Before Low | Low Predicted | Your sensor glucose is expected to reach your low glucose limit in the amount of time you have set. | |
| Rise Alert | Rise Alert | Your sensor glucose has been increasing at a rate that is equal to or faster than the Rise Rate that you have set: ↑, ↑↑, ↑↑↑. | |
| Fall Alert | Fall Alert | Your sensor glucose has been falling at a rate that is equal to or faster than the Fall rate you have set ↓, ↓↓, ↓↓↓. | |

QUICK REFERENCE GUIDE FOR MY SENSOR ALERTS

These sensor alerts come pre-programmed in the Guardian™ Connect app with the exception of “Calibrate by” (setting is called “Calibration Reminder”). You cannot change these alerts. The app requires them.

| Alert | What it means | What I should do |
|-------------------------------------|---|---|
| Calibrate now | You need to calibrate your sensor in order to get sensor glucose readings. | Wash hands and check blood glucose using a fingerstick sample and blood glucose meter. Enter blood glucose value into your Guardian™ Connect app. |
| Lost communication | Your Guardian™ Connect app and transmitter haven't been communicating for 30 minutes. Your app may have closed if there are too many apps running at the same time. Other equipment may be causing radio frequency interference. Another cause is that your transmitter disconnected from your sensor or your sensor pulled out of your skin. | Move your mobile device closer to your transmitter and sensor. Move away from equipment that can cause radio frequency interference. Open app to make sure it is running properly. If it's still not working check that transmitter is still connected to sensor. If not, then reconnect it. Insert a new sensor if you see that it has pulled out. If still not working, call the 24-hour help line. |
| Calibration not accepted | Your BG meter value could not be used to calibrate; it was too different from the SG value. | Wait 15 minutes. Wash your hands and check your blood glucose again. Enter this blood glucose value into app. |
| Sensor end of life | Sensor has reached its maximum life of 7 full days. | Remove your sensor. Recharge your transmitter. Follow the instructions in the User Guide for inserting and starting a new sensor. |
| Change sensor | You may have received a second Calibration not accepted alert or the sensor is not working properly. | Remove your sensor and follow the instructions in the User Guide for inserting and starting a new sensor. |
| Sensor glucose not available | There is no sensor information due to several possible causes. Some causes include the sensor pulling out of your skin or your sensor not working properly. | Don't calibrate unless the app tells you to. The system is trying to correct the problem. This could take up to 3 hours. You don't need to do anything at this time. |
| Calibrate by | You programmed the Calibration Reminder setting to alert you when a calibration will be due. | Do a calibration by the time that the alert shows you. |
| Mobile device battery low | Your mobile device's battery has reached or fallen below 20% of its power. | Charge your mobile device. <div style="border: 2px solid red; padding: 5px; display: inline-block;">  WARNING: Don't let your mobile device shut down due to low battery, or you won't get any alerts. Carry a charger for your mobile device so that you can charge the battery. </div> |

If phone battery dies + recharges, my app will not restart automatically.

Part 1. Removing Sensor in Seven Days

1. Peel off tape.
2. Disconnect transmitter by pinching side arms of sensor. Then pull transmitter away from sensor.
3. Plug transmitter on to charger.
4. Peel off and discard sensor.

Part 2. Inserting a New Sensor

Wash your hands. Choose a site with enough fat on your abdomen or back of your upper arms. Clean it with alcohol.

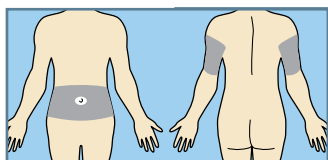

You may need assistance with inserting sensor into back of your upper arm. Some users may find it difficult to insert sensor into their arm by themselves.

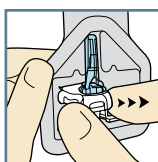

1. Open sensor package.

2a. Hold sensor by plastic pedestal.

Hold pedestal and remove entire sensor assembly from the package. Place sensor and pedestal on a clean, flat surface (a table).

2b. Tuck adhesive tab.

Make sure that sensor's adhesive tab is tucked under sensor connector and snaps.

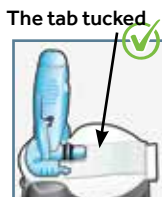

Correct



Incorrect

3. Hold sserter correctly.

Place thumb on thumbprint marking to hold sserter without touching green buttons.



Correct



Incorrect

- ### 4. Load sensor into sserter.
- Place thumb on thumbprint marking on sserter with out touching green buttons. Carefully push sserter down on to pedestal until base of sserter sits flat on table and you hear a click.



Fingers NOT holding side buttons

5. Detach sserter from pedestal.

Place thumb on thumbprint marking on sserter. With other hand, place two fingers on pedestal arms. Slowly pull sserter straight up.

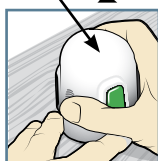

Do not detach pedestal from sserter in mid-air as this may damage sensor.



- ### 6a. Place sserter on body.
- Hold sserter flat and steady against your clean site that you chose. Don't push sserter into your skin. **Note:** If you don't hold sserter flat against your body when you press the buttons, the sserter might spring back. This could cause sensor to insert improperly.



- ### 6b. Insert sensor.
- Press and release **bump** on both green buttons at same time.

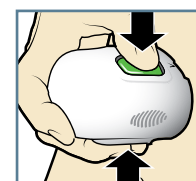

6c. Hold sserter against body.

Keep holding sserter against body for at least five seconds to let adhesive stick to skin.

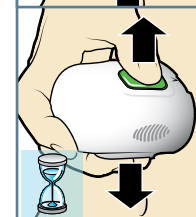

- ### 6d. Remove sserter from body.
- Slowly pull sserter away from skin, **making sure buttons are not pressed.**



- ### 7. Remove needle housing.
- Hold plastic sensor base against your skin. (Your fingers should be holding down both sensor connector with black rings and the other end of base.) Using your other hand, hold tip of needle housing and pull it straight out. Throw away needle housing in a sharps container.

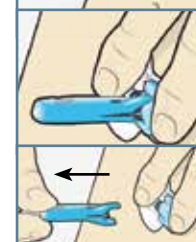

OPTIONAL: Apply additional liquid adhesive. You may use an optional adhesive such as Skin Tac™ under the adhesive pad, prior to removing the liner. It can also be applied to adhesive pad or skin around sensor base. Allow it to dry.

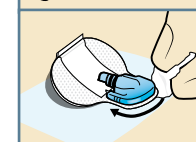
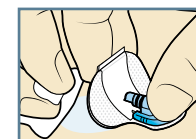

8a. Remove adhesive pad liner.

Gently hold down sensor and remove liner from under adhesive pad. Don't remove liner on rectangular tab yet.

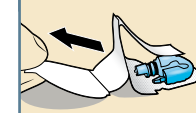
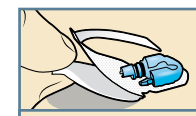

QUICK REFERENCE GUIDE FOR USING MY ONE-PRESS SERTER WITH GUARDIAN SENSOR 3

Part 2. Inserting a New Sensor, cont'd

8b. Press entire adhesive pad to skin.

Firmly press entire adhesive pad against skin so it sticks to skin.

NOTE: Guardian Sensor adhesive sticks better when you press it to skin well. Make sure to press it to your skin well in order for sensor to stay inserted for whole 7 days.

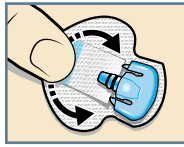

9a. Untuck adhesive tab. Untuck adhesive tab from under sensor connector.

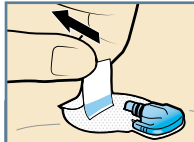

9b. Straighten adhesive tab. Straighten adhesive tab so it lies flat against your skin, but do not remove paper liner yet.



Part 3. Taping Sensor with First Oval Tape

1. Remove liner 1.

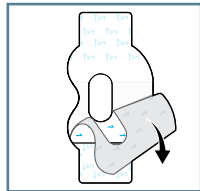

2. Apply tape as shown and press down firmly.

Both sensor and skin are taped

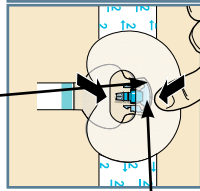

Wide part of tape covers half of sensor base.

3. Remove liner 2 from each side.

Connector and snaps in hole of tape

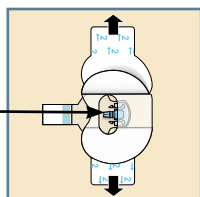

4. Smooth tape.

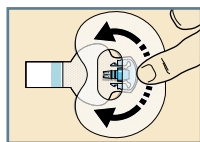

Part 4. Connecting your Transmitter

1. Connect transmitter to sensor.

Note: Wait for green light on transmitter to flash. If green light does not flash, check Troubleshooting section of your transmitter user guide.

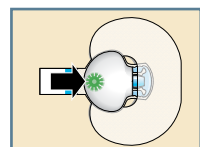

2. Stick adhesive tab on transmitter.

Note: Do not pull tab too tightly.

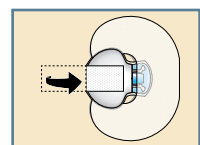

Part 5. Applying Second Piece of Oval Tape

1. To apply 2nd oval tape, remove liner 1.

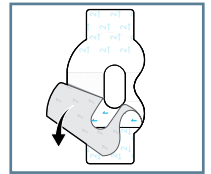

2. Apply 2nd tape in opposite direction to first tape and place it on transmitter. Press down firmly.

Wide part of tape covers end of transmitter and skin.

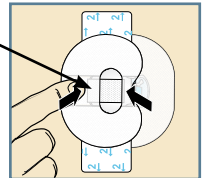

3. Remove liner 2 from each side.

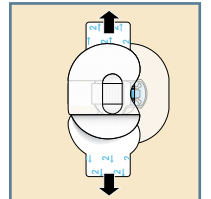

4. Smooth tape.

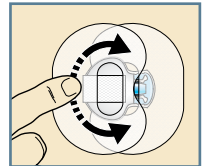

5. This image is an example of oval tape applied correctly.

Note: Check sensor site regularly. If not secure, add additional off-the-shelf tape.

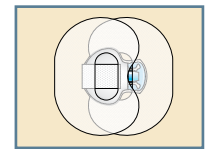

Part 6. Starting the Sensor

1. When Sensor connected screen appears automatically, tap **New Sensor**. Then tap **OK**.



Part 7. Calibrating

1. Check your blood glucose using a blood sample from your finger.
2. Tap  on top right corner of app's Home Screen.
3. Enter your blood glucose reading (40 mg/dL to 400 mg/dL) using keypad.
4. Tap **Calibrate** at top right corner of screen.
5. Tap, **Calibrate sensor -- mg/dL**.



Medtronic

Medtronic Diabetes

18000 Devonshire Street
Northridge, CA 91325
1.800.646.4633

www.medtronicdiabetes.com

M970610A001_A
27APR2018 ©2018 Medtronic. All rights reserved. Medtronic,
Medtronic logo and Further, Together are trademarks of Medtronic. All other brands
are trademarks of a Medtronic company.