

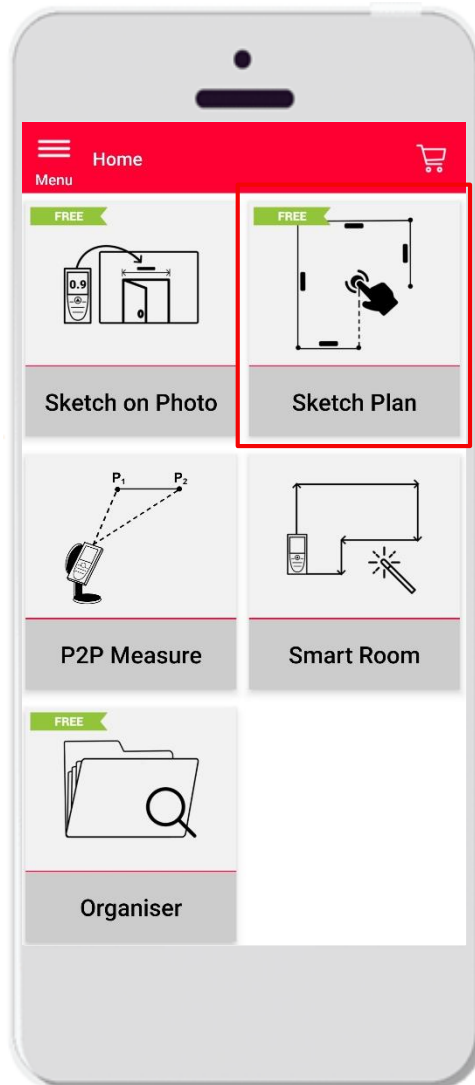

DISTO™ Plan App

Sketch Plan

Sketch Plan Overview



- Create precise floorplans or any other situation plan
- Features:
 - Automatic snapping
 - Auto-scale
 - Add doors, windows and wall openings
 - 3D view
 - Export in jpg, pdf and CAD format (2D/3D)



- when it has to be **right**

Sketch Plan

How to start

- Connect your DISTO with the DISTO Plan App



- Open training materials about **My Devices (ADD THE LINK)**, to learn how to connect with your device



- See also our videos about:

- [How to connect Leica DISTO D1/D110/D2 with a phone/tablet](#)
- [How to connect Leica DISTO D510 with a phone/tablet](#)
- [How to connect Leica DISTO D810 touch/S910 with a phone/tablet](#)
- [How to connect Leica DISTO S910 in WiFi with iPhone/iPad](#)
- [How to connect Leica DISTO S910 in WiFi with an Android phone/tablet](#)
- [How to connect Leica DISTO X3/X4 with iPhone/iPad](#)
- [How to connect Leica DISTO X3/X4 with Android phone/tablet](#)

- when it has to be **right**

Sketch Plan

How to transmit measurements from DISTO

- There are two ways to transfer measurements from DISTO:
 1. With red “ON/DIST” button on the device
 2. With red “ON/DIST” button on the screen (not available for DISTO D510)
- All the measurements will be displayed on the stack bar in the app

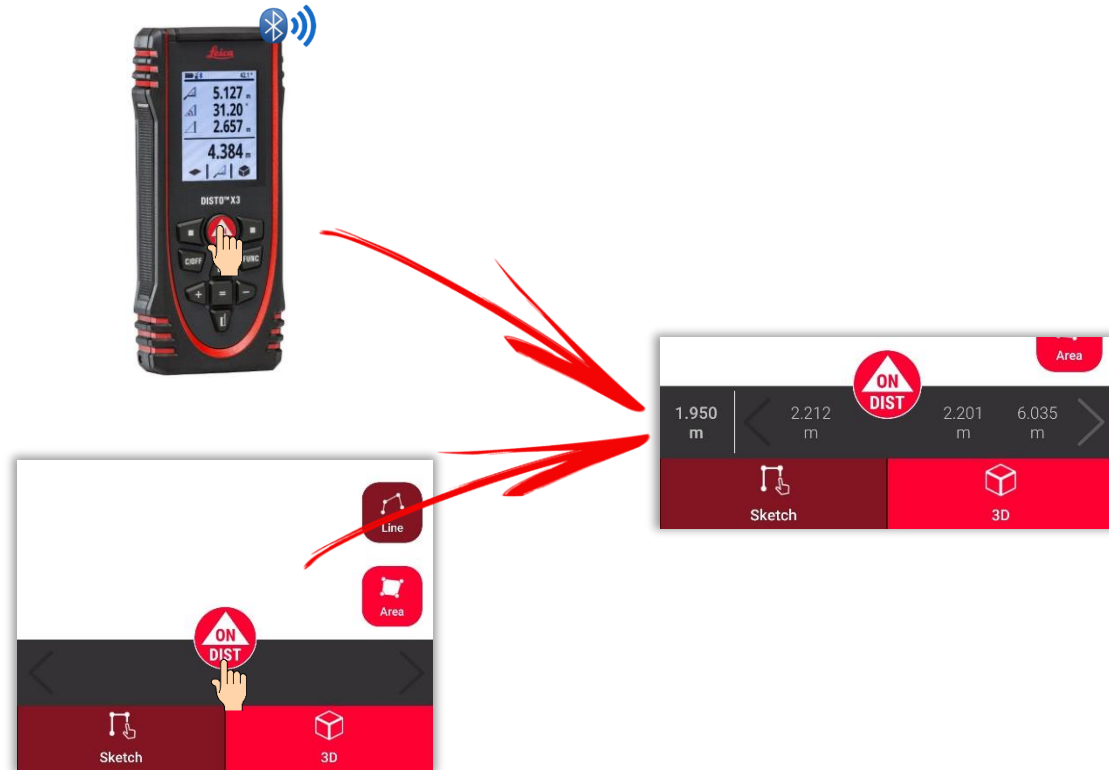

- when it has to be right

Sketch Plan

How to sketch a line

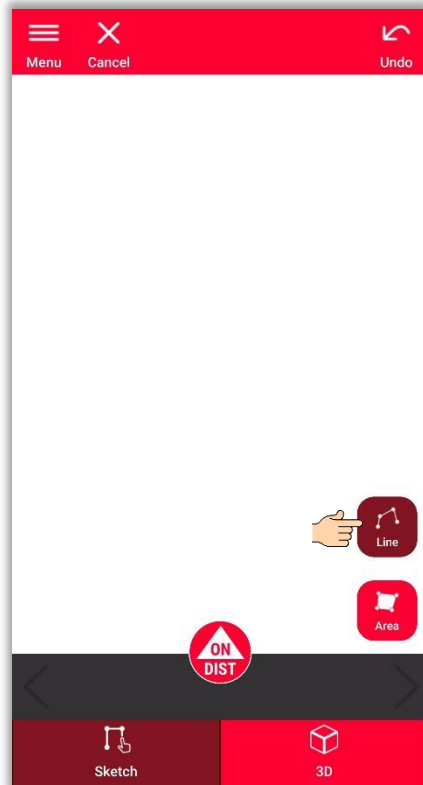
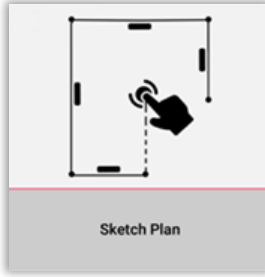

- Tap on the “Line” button to select it

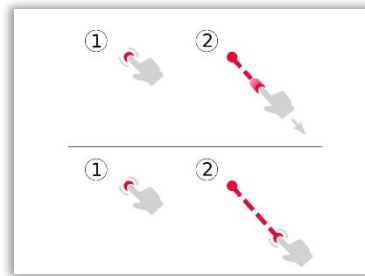

- Tap and swipe or tap and tap to draw a line

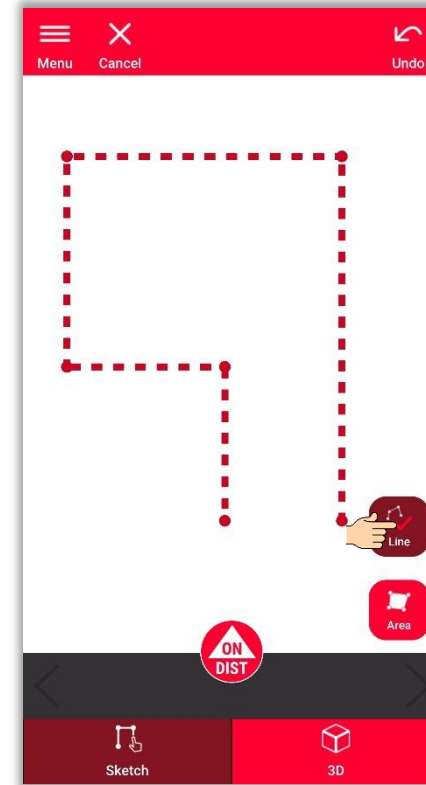

- Press again the button to finish the line

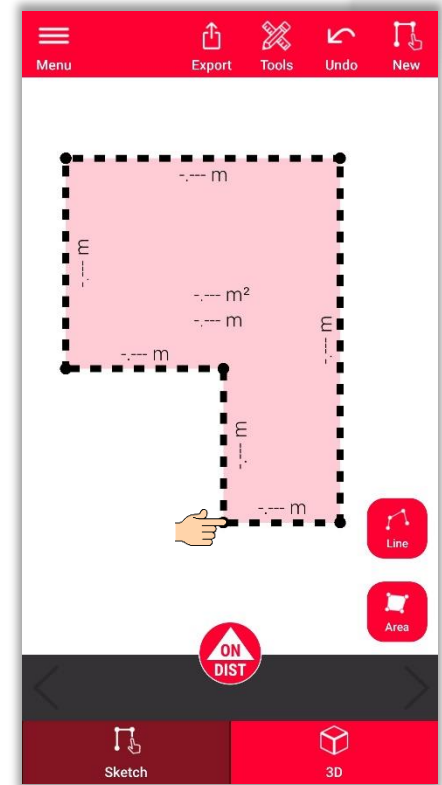

- Line finishes automatically when connecting it to the start point

- when it has to be right

Sketch Plan

How to sketch an area

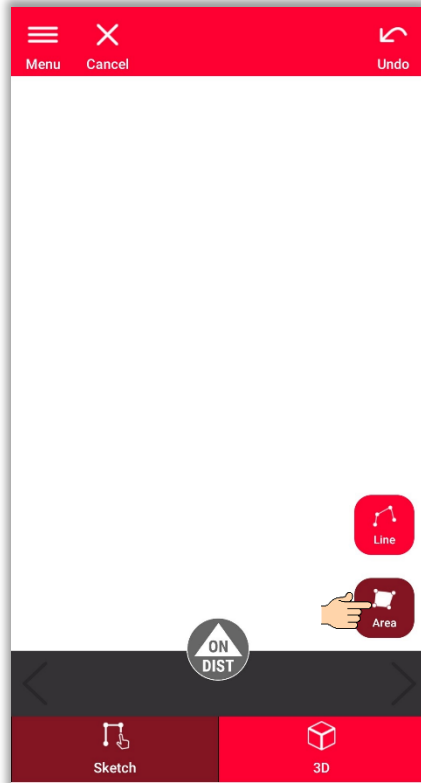
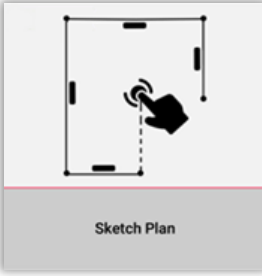

- Tap on the “Area” button to select it

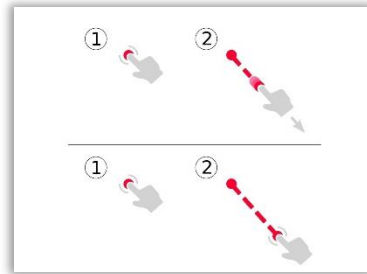

- Tap and swipe or tap and tap to draw a line

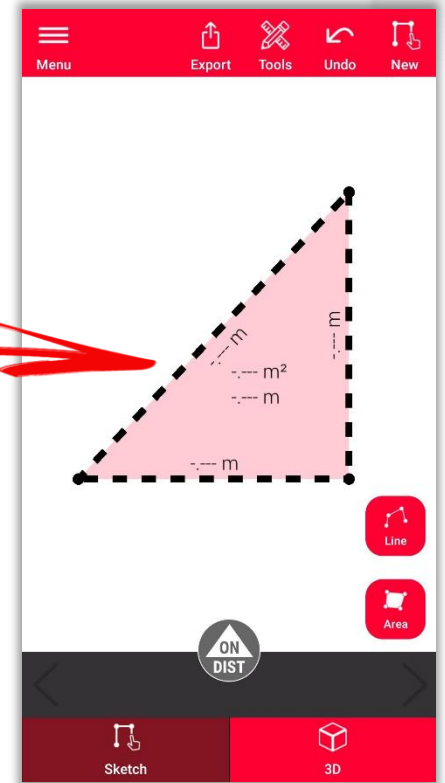
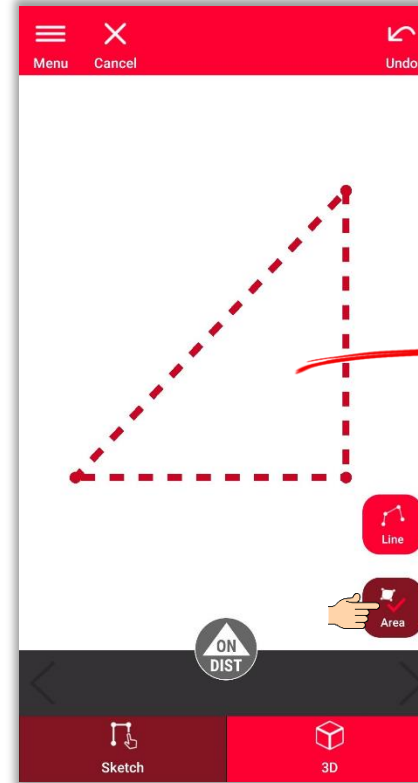

- To create an area, tap at least three points on the screen
Tap “Area” button again to finish defining the area

- when it has to be right

Sketch Plan

How to use snapping

- **Snapping** helps with drawing more precisely by automatically correcting the position of drawn points and lines
- In DISTO Plan App there are several snapping methods applied:

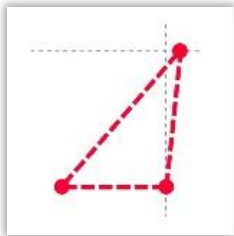

Perpendicular correction

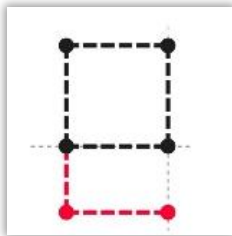

Parallel correction

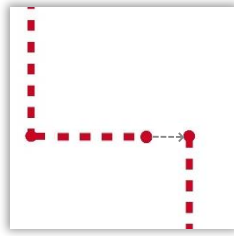

To Point correction

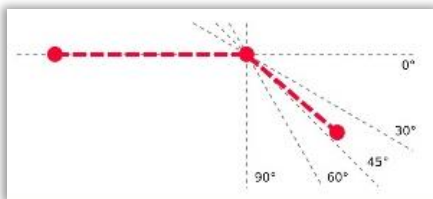

Angle correction

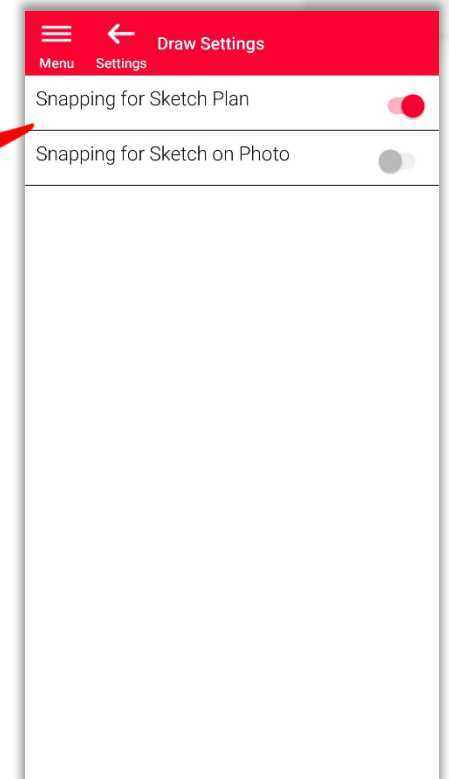
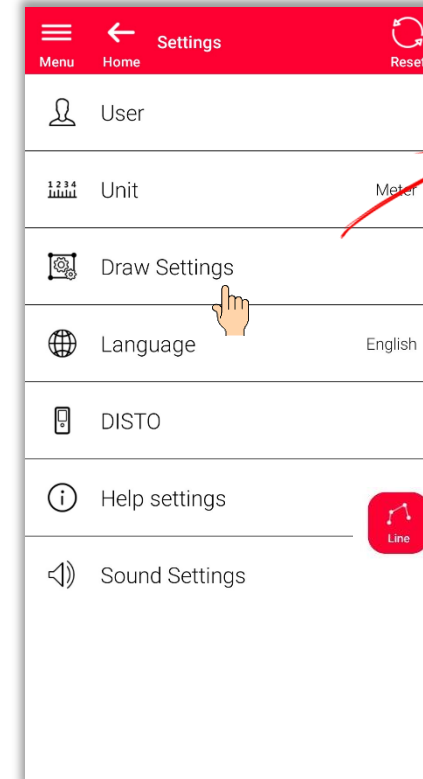

- To turn the snapping ON or OFF go to **Settings** and open the **Draw Settings** menu



Sketch Plan

- when it has to be **right**

Sketch Plan

How to edit

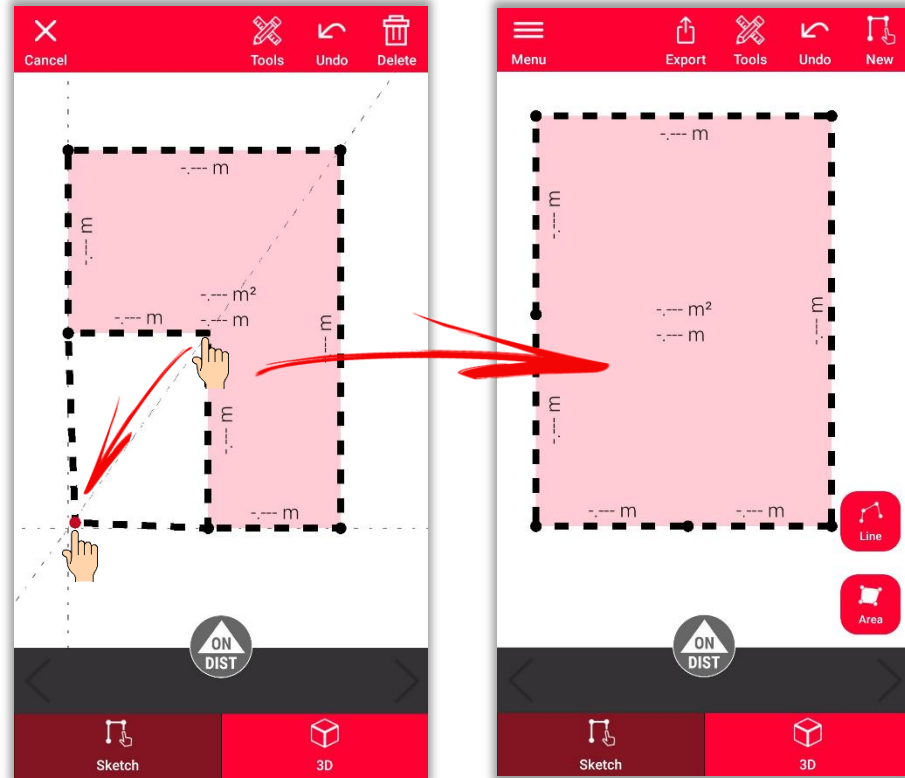

- Long tap on a point and drag it, to move the corner of the room

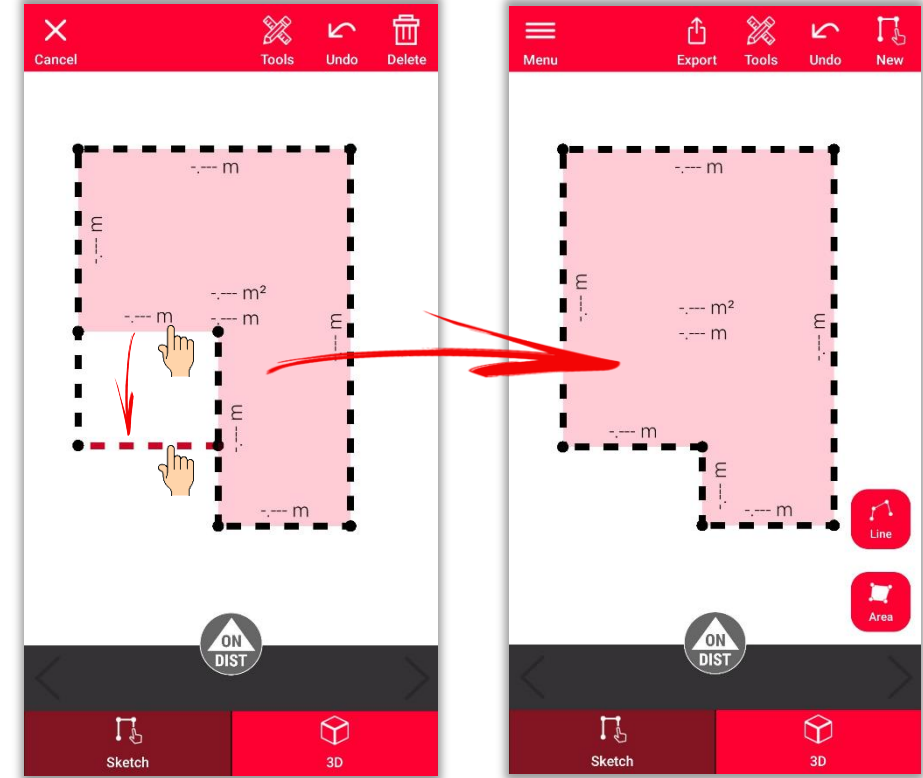

- Long tap on a line and drag it, to move the wall



- when it has to be **right**

Sketch Plan

How to sketch

- Use **Intersect** or **Hidden corner** tools to calculate not visible points

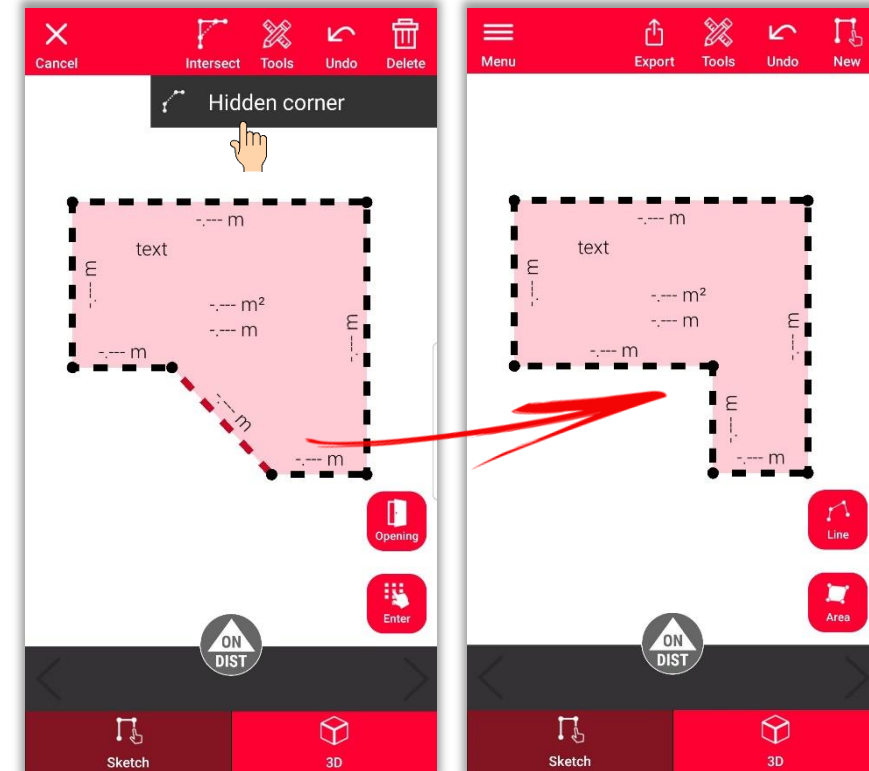
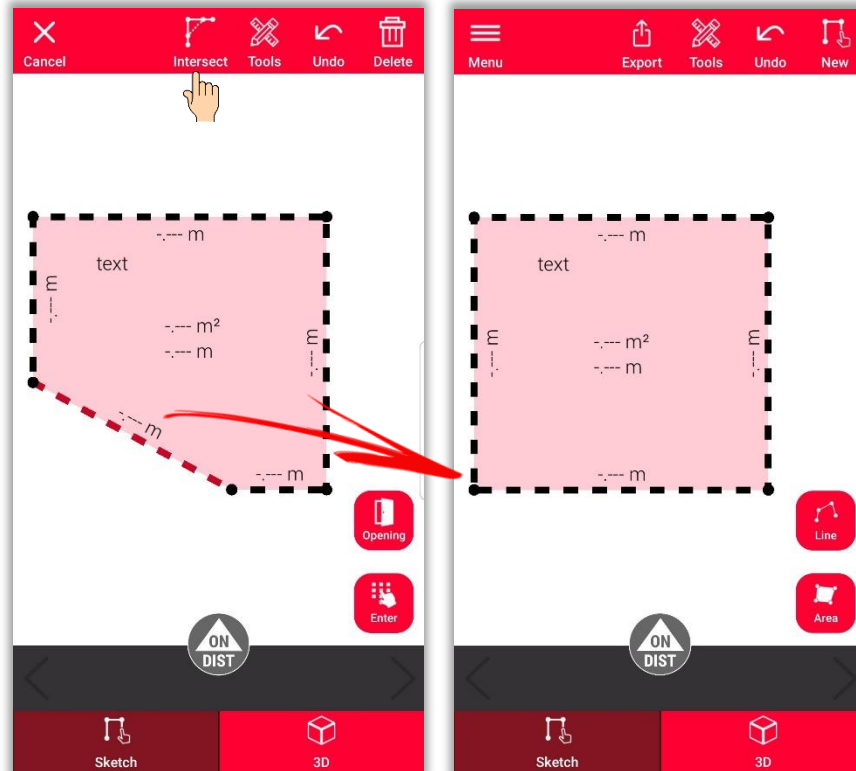

- when it has to be right

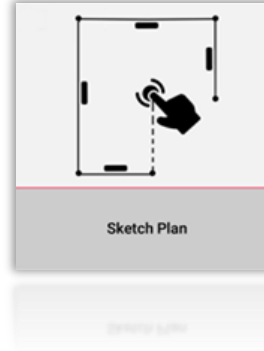

Sketch Plan

How to add measurement to a line

- There are few ways to add new measurements to the sketch:

1. Select a line and Enter the length



Sketch will be automatically re-scaled and adjusted to the measurements

Calculated values will be displayed in brackets

The area and circumference will be displayed in the centre of the area

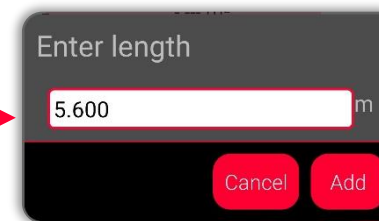
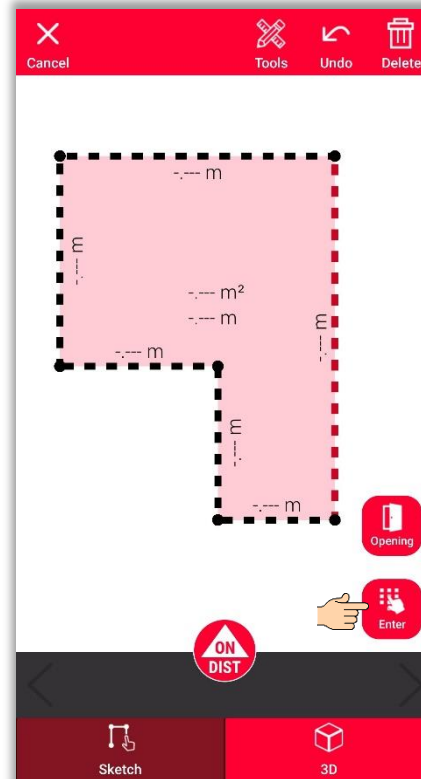

Enter the length of the line

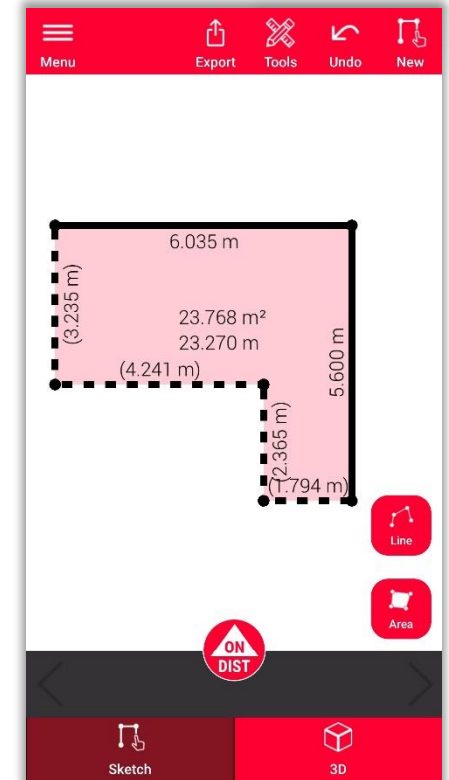

Measured lines will not be displayed as dashed lines anymore

- when it has to be right

Sketch Plan

How to add measurement to a line

- There are few ways to add new measurements to the sketch:

1. Select a line and Enter the length
2. Select a line and select a measurement from the stack bar

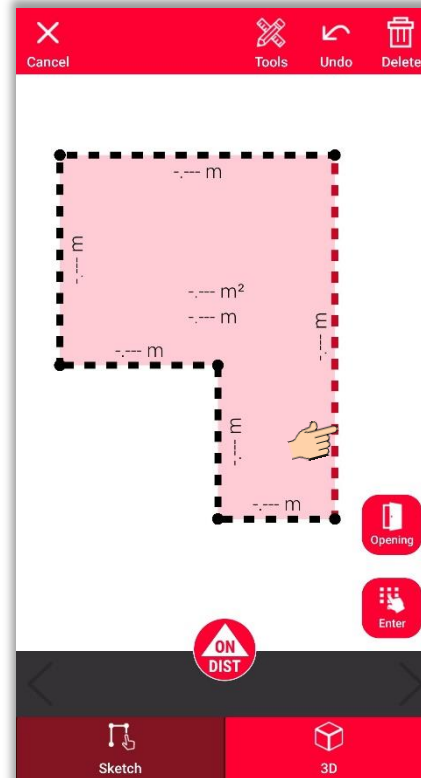

Measurement will be transmitted to the selected line

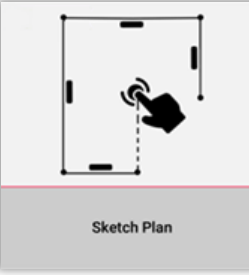
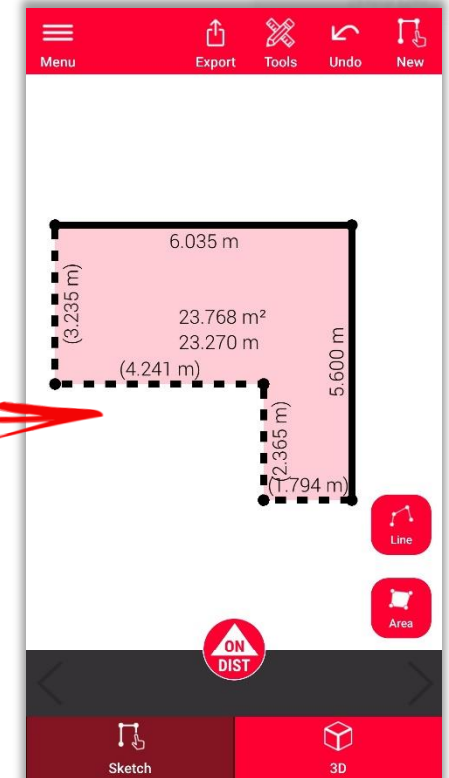

- when it has to be right

Sketch Plan

How to add measurement to a line

- There are few ways to add new measurements to the sketch:

1. Select a line and Enter the length
2. Select a line and select a measurement from the stack bar
3. Select a line and measure it with DISTO using red 'ON/DIST' button on the device or the screen

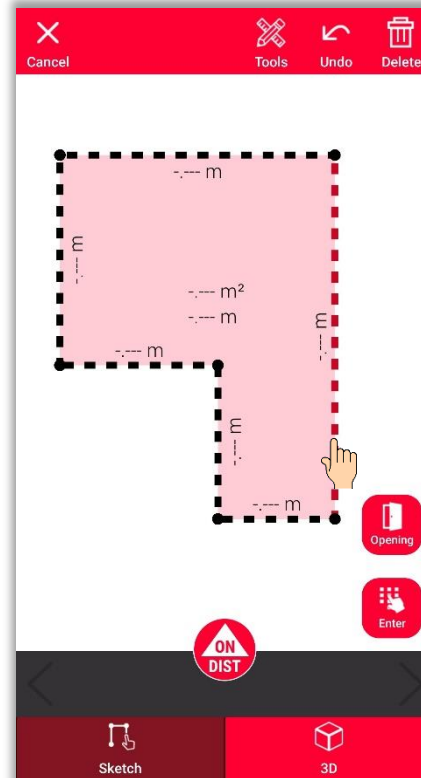

Measurement will be transmitted to the selected line

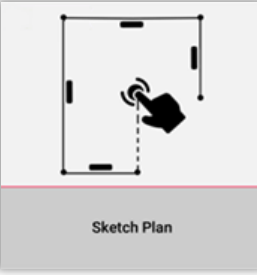
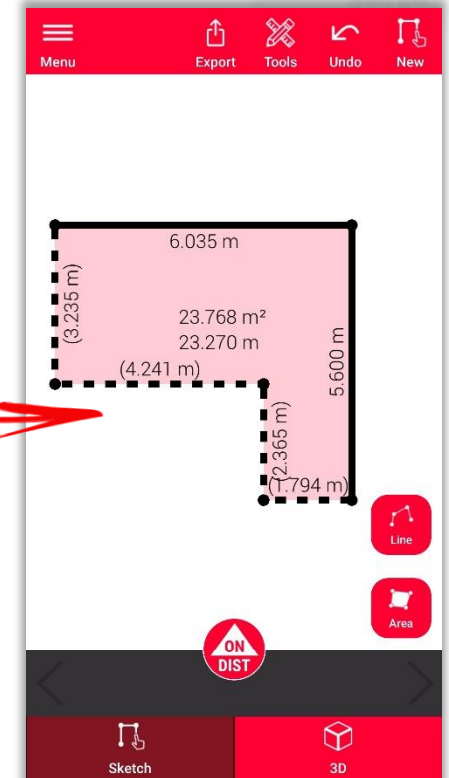

- when it has to be right

Sketch Plan

How to measure

- There are few ways to add new measurements to the sketch:

1. Select a line and Enter the length
2. Select a line and select a measurement from the stack bar
3. Select a line and measure it with DISTO using red 'ON/DIST' button on the device or the screen
4. Drag and drop a measurement to a line



Use 'ON/DIST' button to measure and transmit the measurements to DISTO Plan App



Measured distances will appear in the app

Drag and drop a measurement to a line

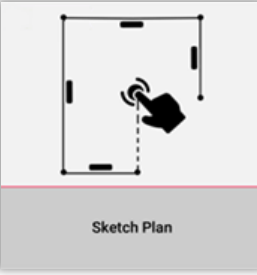
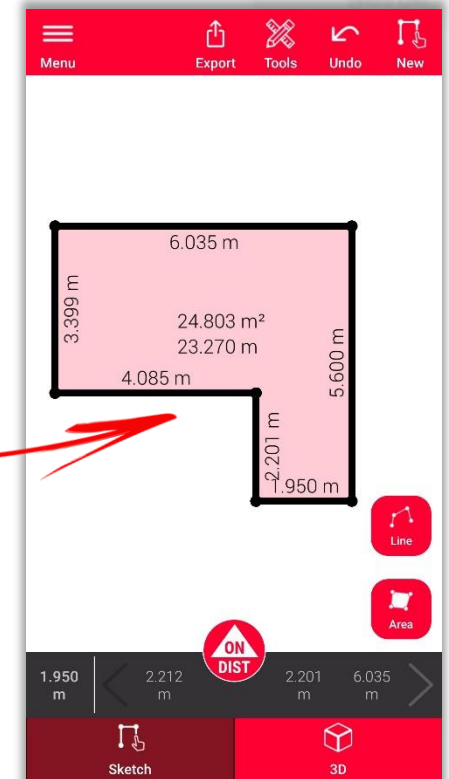
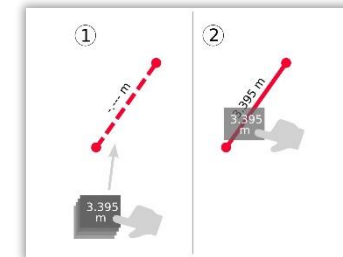

- when it has to be right

Sketch Plan

How to add Openings

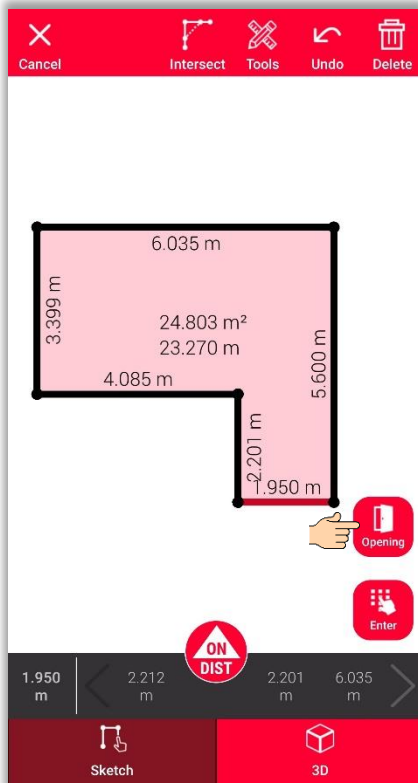

- Select a line and use the **“Opening”** button to add doors or windows

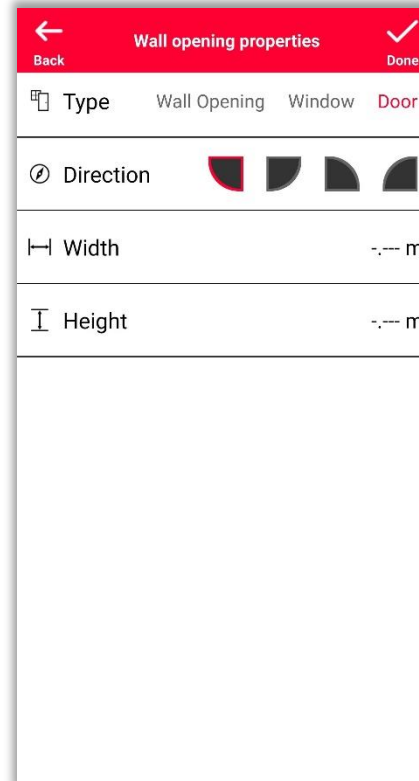

- Modify **Type**, **Direction**, and **Dimensions** of the opening

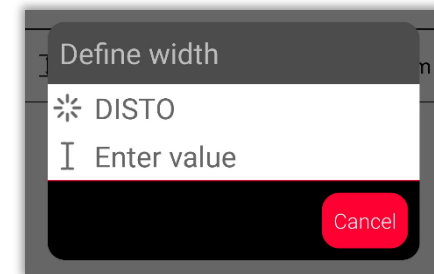
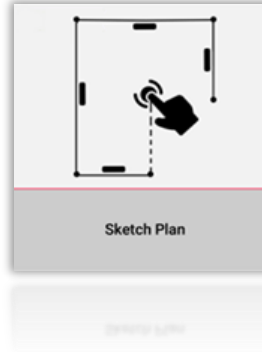

- It is possible to measure the dimension with the DISTO or enter it manually

- when it has to be **right**

Sketch Plan

How to position Openings

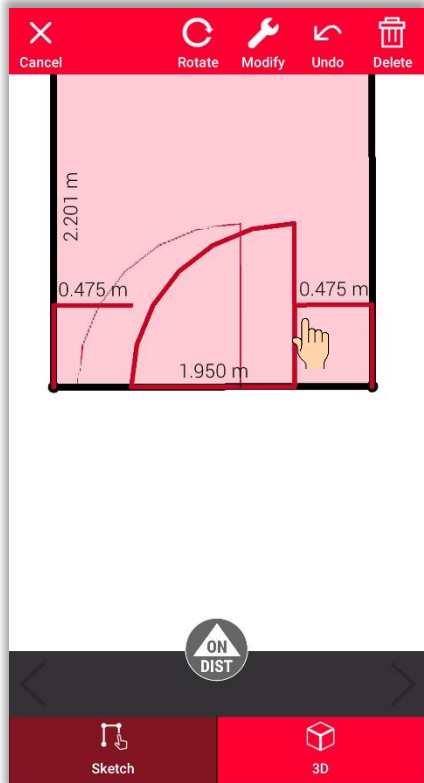

- Long press on the **Opening** and move it, to change its position

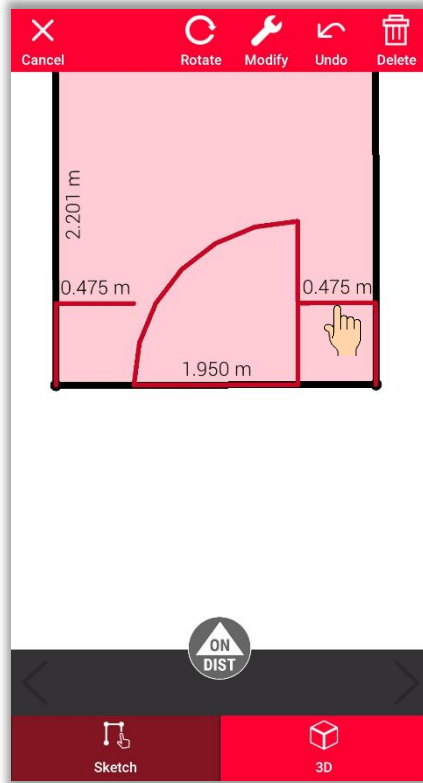

- Or tap on the dimension to change it

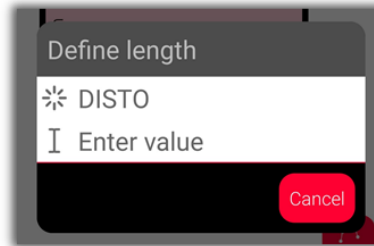

- It is possible to measure the dimension with the DISTO or enter it manually

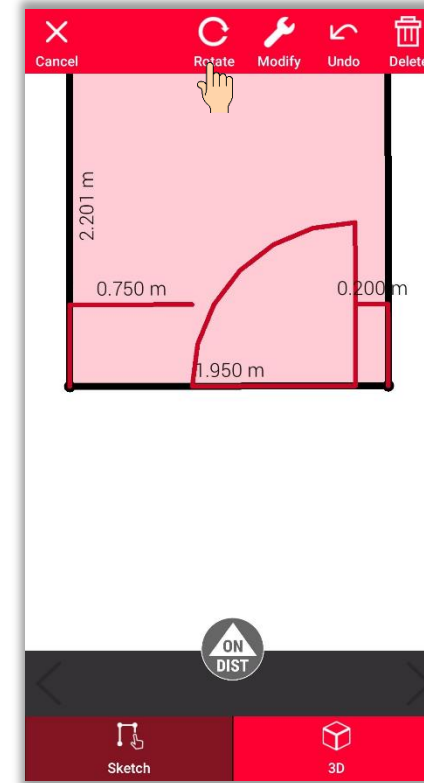

- Use "**Rotate**" button to change the direction of the Opening

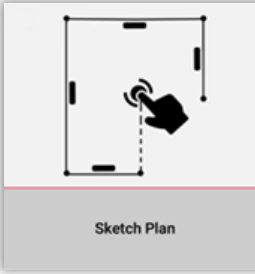
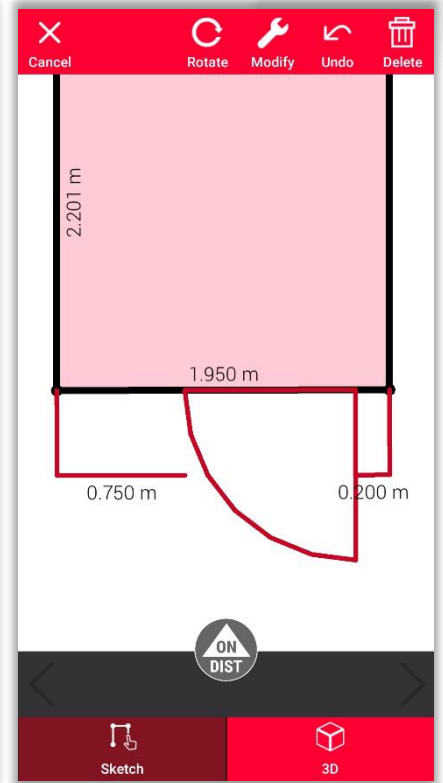

- when it has to be **right**

Sketch Plan

How to define a Room Height

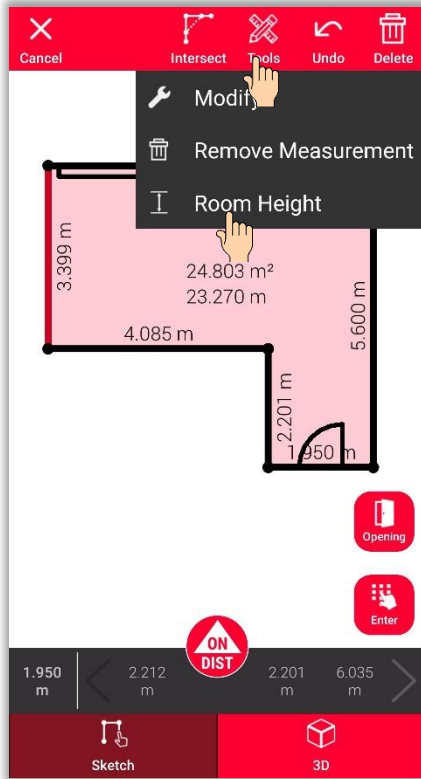
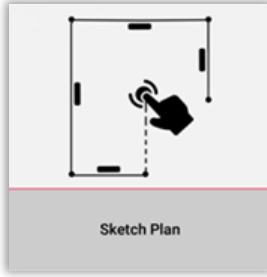

- Select a wall and find the **Room Height** in Tools

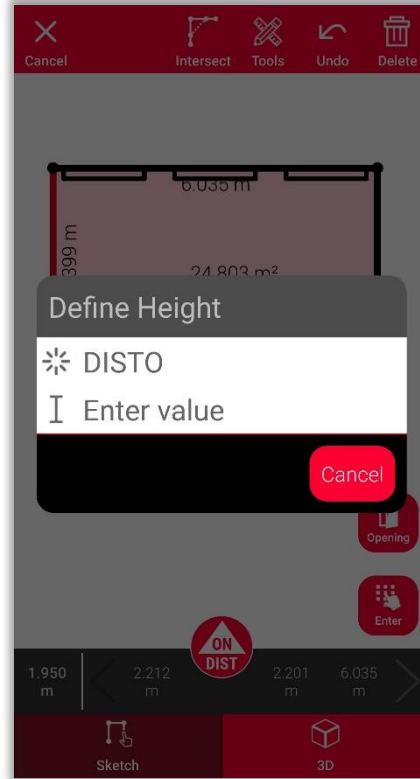

- Choose the method of defining the room height

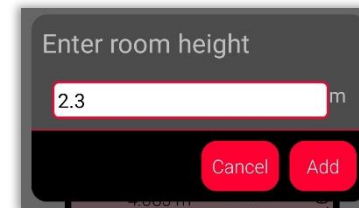

- Measure room height using **DISTO** or **Enter** it manually

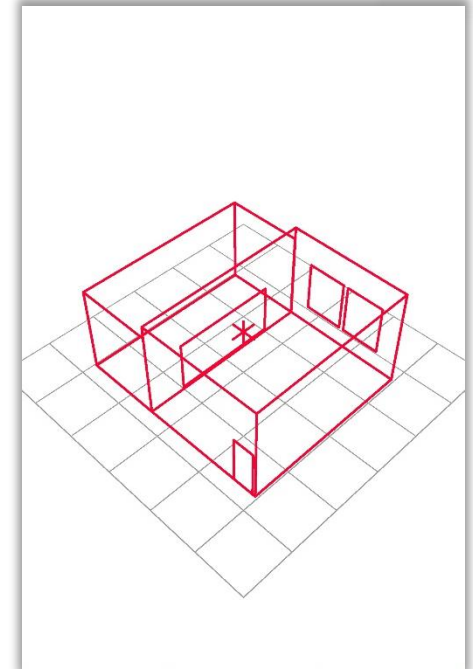

- when it has to be right

Sketch Plan

How to use Tools

- Add **Texts** and **Markers** to create quick notes and annotations
- Move sketch to **Projects** and add **Tags** to better organise

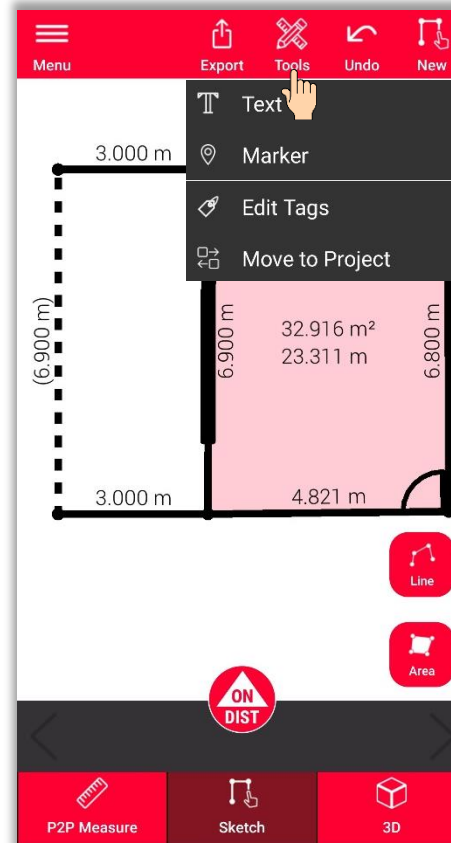

After selecting the tool
click on the screen to add
Text or **Marker**

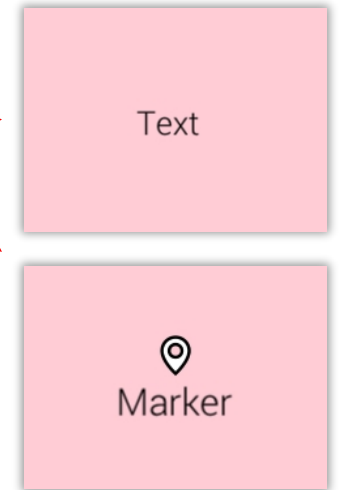

- when it has to be **right**

Sketch Plan

How to use 3D view

- In the **3D view** you can see a 3D representation of measured room
- You can easily zoom and rotate the view
- You can switch the view any time you want

Top

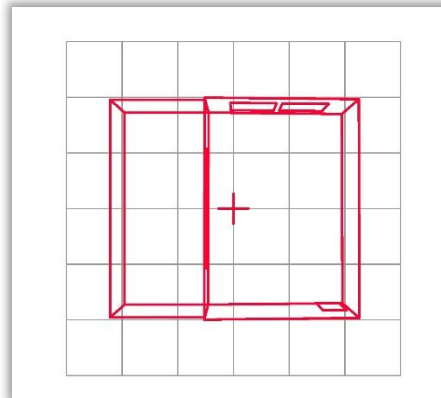

Front

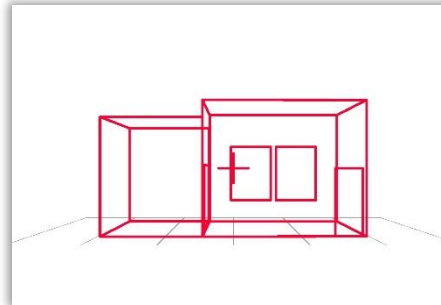

Side

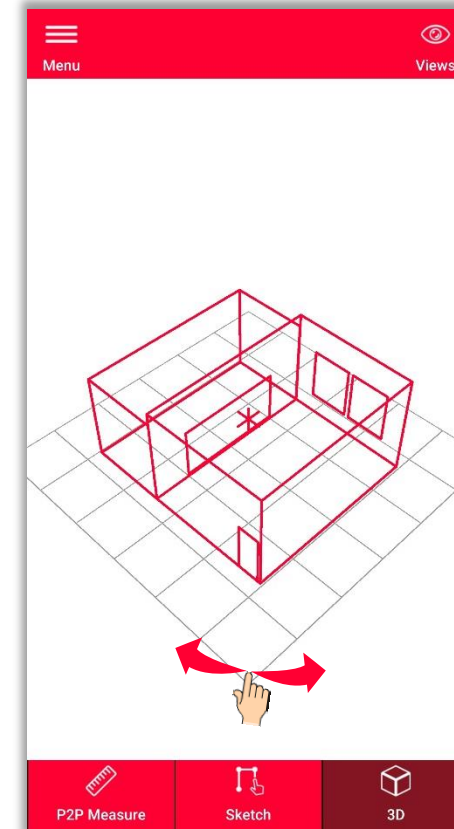
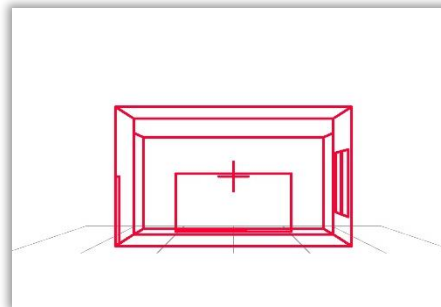

Perspective

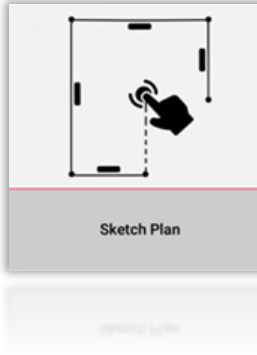

- when it has to be **right**

Sketch Plan

How to Export

- **Export** your plan in multiple formats:
 - **JPG**

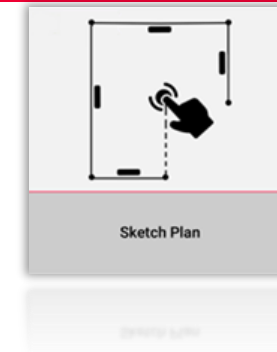
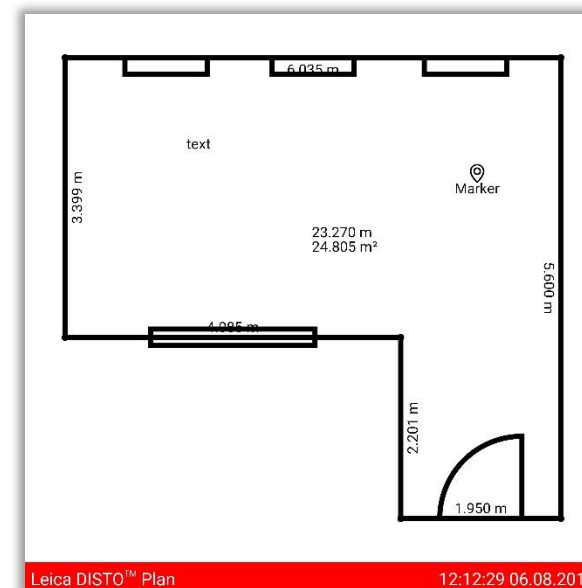
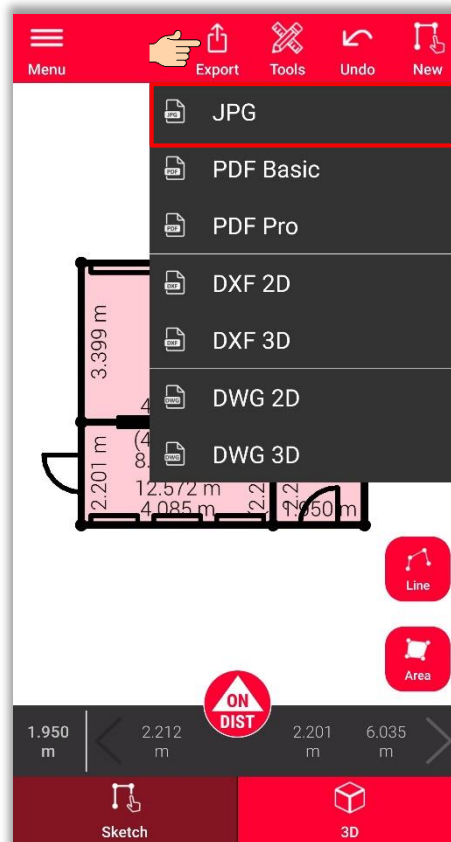

- when it has to be **right**

Sketch Plan

How to Export

- **Export** your plan in multiple formats:
 - JPG
 - **PDF Basic**
 - **PDF Pro**
 - Only available with a valid subscription

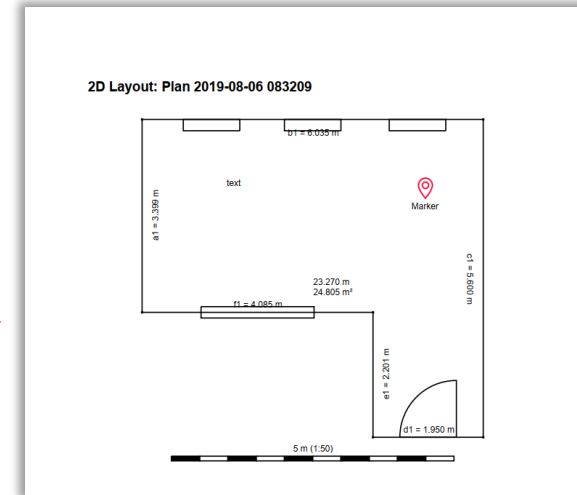
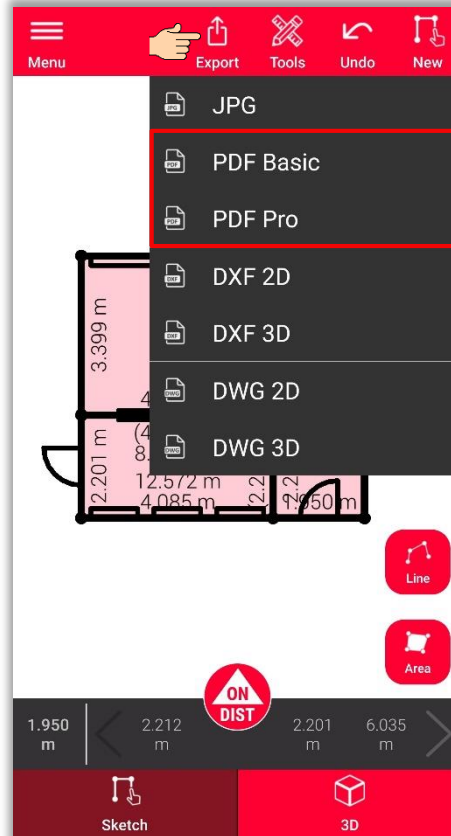

2D Layout: Plan 2019-08-06 083209

Shape 1

Type	Name	Value	Wall Area	Description
Summary				
Floor Area		24.805 m²	-	-
Wall Area		53.521 m²	-	-
Opening Area		9.000 m²	-	-
Wall Area Net		44.521 m²	-	-
Volume		57.051 m³	-	-
Distance				
a		3.399 m	7.818 m²	
b		6.035 m	13.880 m²	
c		5.600 m	12.880 m²	
d		1.950 m	4.485 m²	
e		2.201 m	5.062 m²	
f		4.085 m	9.395 m²	
Circumference		23.270 m	53.521 m²	
Height		2.300 m	-	-
Openings				
Door 1 on line d				
Width		1.000 m	-	-
Height		2.000 m	-	-
Window 1 on line b				
Width		1.000 m	-	-
Height		1.000 m	-	-
Distance		1.000 m	-	-

Powered by Leica Geosystems Page 3/3



- when it has to be **right**

Leica
Geosystems

Sketch Plan

How to Export

- **Export** your plan in multiple formats:
 - JPG
 - PDF Basic
 - PDF Pro
 - **2D DXF**
 - **2D DWG**

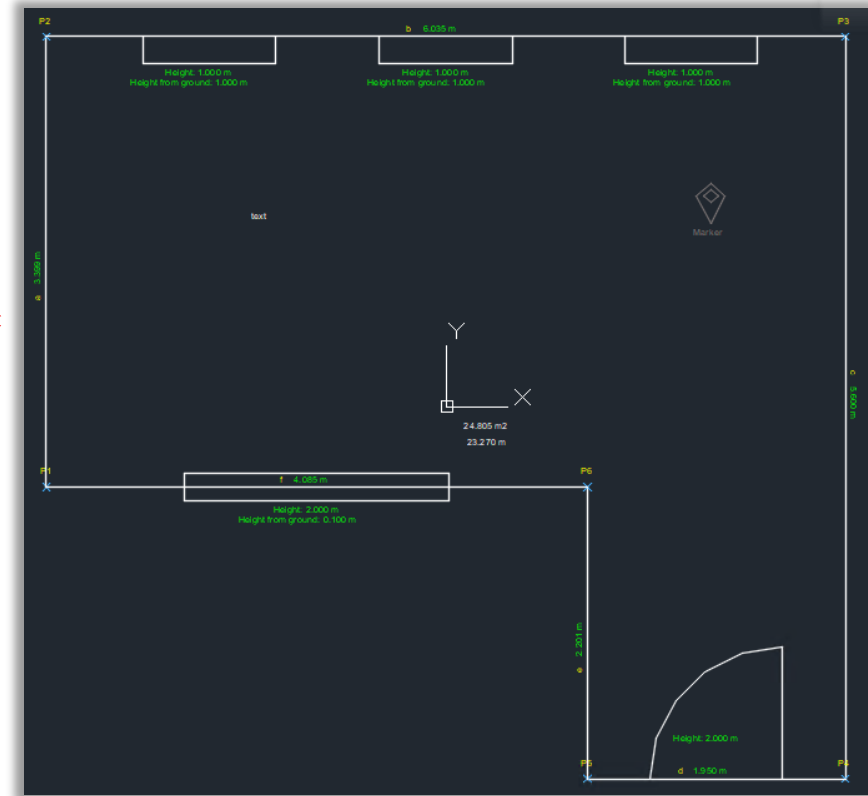
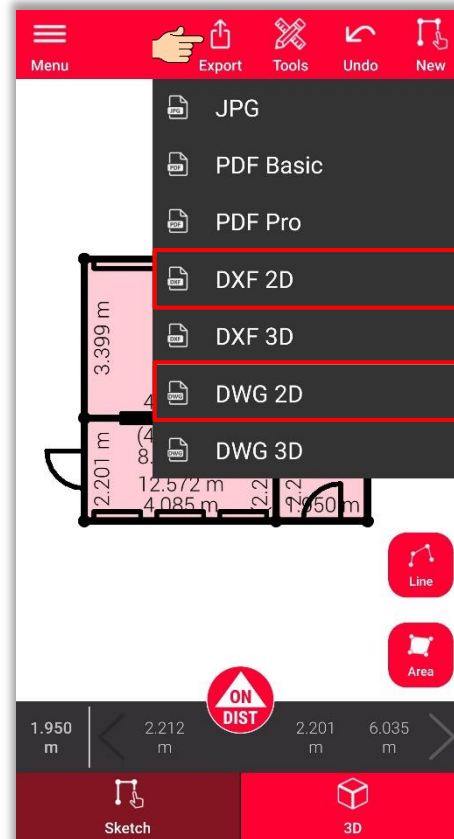

Sketch Plan

How to Export

- **Export** your plan in multiple formats:
 - JPG
 - PDF Basic
 - PDF Pro
 - 2D DXF
 - 2D DWG
 - **3D DXF**
 - **3D DWG**

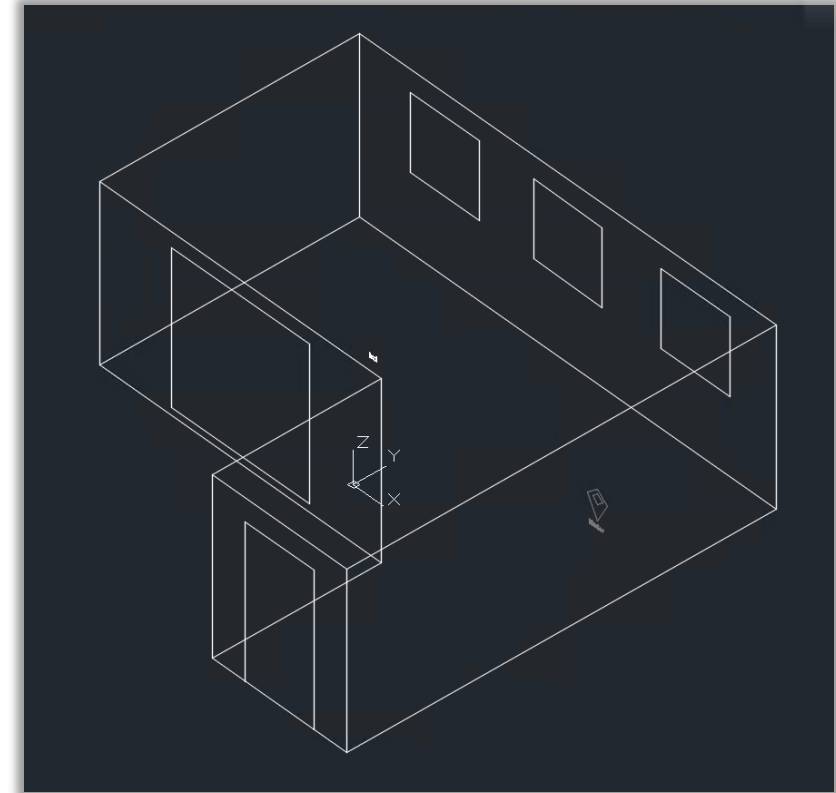
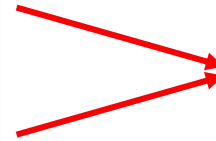
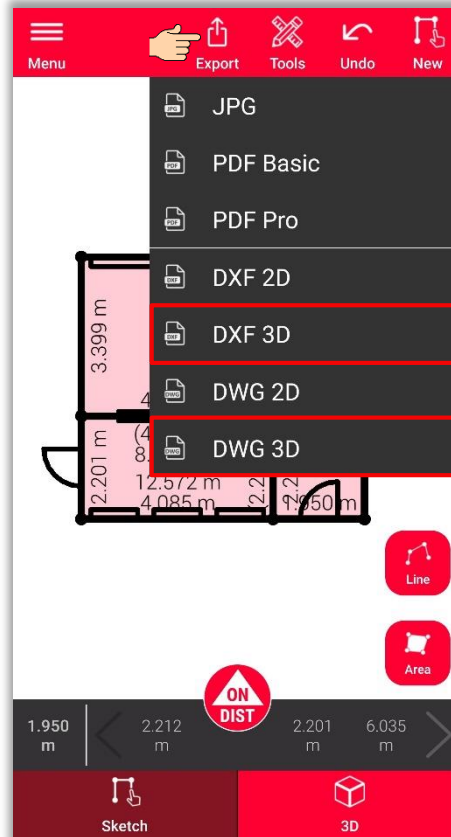



DISTO™ Plan App

Sketch Plan