



# Instruction Manual

## QuietFlow® Internal Power Filters

**Filter Models:** AT10-G, AT40-G



The Aqueon® QuietFlow® Internal Power Filters are listed by Underwriters Laboratories to ensure that they meet the stringent U.S. and Canadian safety requirements.



# IMPORTANT SAFETY INSTRUCTIONS

**WARNING** – To guard against injury, basic safety precautions should be observed including the following:

## READ AND FOLLOW ALL SAFETY INSTRUCTIONS

**DANGER** – To avoid possible electric shock, special care should be taken since water is employed in the use of aquarium equipment. For each of the following situations, do not attempt to repair yourself; return the appliance to an authorized service facility for service or discard the appliance.

1. A. If the appliance shows any sign of abnormal water leakage, immediately unplug it from the power source.  
B. Carefully examine the appliance after installation. It should not be plugged in if there is water on the parts not intended to be wet.  
C. Do not operate any appliance if it has a damaged cord or plug, or if it is malfunctioning or if it is dropped or damaged in any manner.  
D. To avoid the possibility of the appliance plug or receptacle getting wet, position aquarium stand and tank to one side of the wall mounted receptacle to prevent water from dripping onto the receptacle or plug. As shown in the figure below, a "drip loop" should be arranged by the user for each cord connecting an aquarium appliance to the receptacle. The "drip loop" is the part of the cord below the level of the receptacle, or the connector if an extension cord is used, to prevent water travel along the cord and coming in contact with the receptacle. If the plug or the receptacles do get wet, DON'T unplug the cord. Disconnect the fuse to the circuit breaker that supplies power to the appliance. Then unplug and examine for the presence of water in the receptacle.
2. Close supervision is necessary when any appliance is used by or near children.
3. To avoid injury, do not contact moving parts or hot parts such as heaters, reflectors, lamp bulbs, etc.
4. Always unplug an appliance from the outlet when not in use, before putting on or taking off parts, and before cleaning. Never yank the cord to pull plug from the outlet. Grasp the plug and pull to disconnect.
5. Do not use an appliance for other than intended use. The use of attachments not recommended or sold by the appliance manufacturer may cause an unsafe condition.
6. Do not install or store the appliance where it will be exposed to the weather or to temperatures below freezing.
7. Make sure an appliance mounted on a tank is securely installed before operating it.
8. Read and observe all the important notices on the appliance.
9. If an extension cord is necessary, a cord with a proper rating should be used. A cord rated for less amperes or watts than the appliance rating may overheat. Care should be taken to arrange the cord so that it will not be tripped over or pulled.

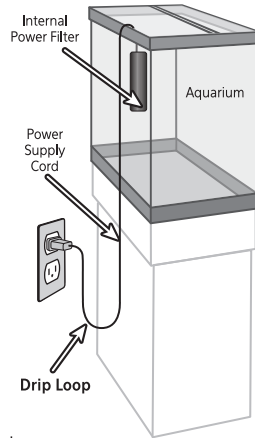

### ONLY FOR POLARIZED ATTACHMENT PLUG APPLIANCES

10. If this appliance has a polarized plug (one blade is wider than the other) as a safety feature, this plug will fit in a polarized outlet only one way. If the plug does not fit fully in the outlet, reverse the plug. If it still does not fit, contact a qualified electrician. Never use with an extension cord unless plug can be fully inserted. Do not attempt to defeat this safety feature.

## SAVE THESE INSTRUCTIONS



# CONSIGNES DE SÉCURITÉ IMPORTANTES

**AVERTISSEMENT** – Pour protéger contre les blessures, respecter les consignes de sécurité de base, notamment ce qui suit :

## LIRE ET RESPECTER TOUTES LES INSTRUCTIONS DE SÉCURITÉ.

**DANGER** – Pour écarter les risques de décharge électrique, faire preuve de précautions particulières en raison de la présence d'eau dans l'aquarium. Dans chacune des situations ci-dessous, ne pas tenter de réparer soi-même ; renvoyer l'appareil à un centre de réparation agréé ou le mettre au rebut.

1. A. Si l'appareil présente des signes de fuites d'eau anormales, le débrancher immédiatement de la source d'alimentation.  
B. Examiner l'appareil avec soin après son installation. Ne pas le brancher s'il y a de l'eau sur des pièces non destinées à être mouillées.  
C. Ne pas utiliser un appareil s'il a un cordon ou une fiche endommagés, s'il fonctionne mal, s'il est tombé ou s'il a été endommagé d'une quelconque façon.  
D. Pour écarter le risque de mouiller la fiche de l'appareil ou la prise de courant, placer le socle et la cuve de l'aquarium sur le côté par rapport à la prise murale, afin d'éviter que l'eau ne goutte sur la prise ou la fiche. Prévoir une « boucle d'égouttement », illustrée ci-dessous, sur chaque cordon qui raccorde un appareil de l'aquarium à la prise de courant. La « boucle d'égouttement » est la portion de cordon en dessous du niveau de la prise, ou du connecteur si un cordon de rallonge est utilisé, pour empêcher l'eau de s'écouler le long du cordon et de venir au contact de la prise. Si la fiche ou la prise sont mouillées, NE PAS débrancher le cordon. Couper l'électricité au niveau du disjoncteur qui alimente l'appareil. Débrancher ensuite le cordon et voir s'il y a de l'eau dans la prise de courant.
2. Une supervision étroite est nécessaire lors de l'utilisation de tout appareil électrique par des enfants ou à leur proximité.
3. Pour éviter les blessures, ne pas toucher de pièces en mouvement ni de pièces chaudes telles que radiateurs, réflecteurs, ampoules, etc.
4. Toujours débrancher un appareil de la prise de courant lorsqu'il n'est pas utilisé, avant de poser ou d'enlever des pièces et avant de le nettoyer. Ne jamais tirer sur le cordon pour sortir la fiche de la prise. Saisir la fiche et tirer pour débrancher.
5. Ne pas utiliser un appareil à d'autres fins que celles prévues. L'emploi d'accessoires non recommandés ni vendus par le fabricant de l'appareil peut produire une situation dangereuse.
6. Ne pas installer ni entreposer l'appareil dans un endroit exposé aux intempéries ou à des températures inférieures au gel.
7. S'assurer qu'un appareil monté sur un aquarium est solidement installé avant de le mettre en marche.
8. Lire et respecter toutes les consignes importantes figurant sur l'appareil.
9. Si un cordon de rallonge est nécessaire, utiliser un cordon de capacité suffisante. Un cordon prévu pour des intensités (A) ou des puissances (W) inférieures à celles de l'appareil peut surchauffer. Veiller à disposer le cordon de manière à éviter tout risque de trébuchement ou d'arrachement.

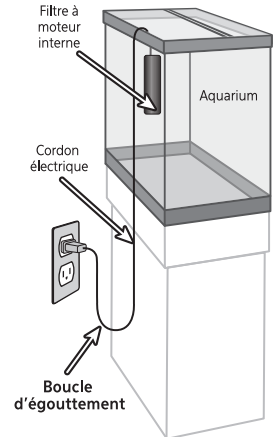

### APPAREILS À FICHE POLARISÉE SEULEMENT

10. Si cet appareil comporte une fiche polarisée (une lame plus large que l'autre) par mesure de sécurité, cette fiche ne peut être branchée dans une prise polarisée que dans un sens. Si la fiche ne rentre pas complètement dans la prise, retourner la fiche. Si elle ne rentre toujours pas, contacter un électricien qualifié. Ne jamais utiliser avec un cordon de rallonge si la fiche ne s'enfonce par complètement. Ne pas tenter de contourner ce dispositif de sécurité.

## CONSERVER CES INSTRUCTIONS



The Aqueon® Internal Power Filter, although small in size, guarantees complete filtering action (see fig.1):

**MECHANICAL:** In the first stage an efficient wedge shaped foam filter traps and holds particles and debris. The wedge shape creates a larger surface area for incoming water to pass through, preventing the filter from clogging too quickly.

**CHEMICAL:** The filter cartridge contains activated carbon which removed toxins, odors, and discoloration from the water.

**BIO GRID:** Lastly, once clean the water passes through the Bio Grid which provides an area for bacterial colonies to grow which help remove toxic ammonia and nitrites.

## Installation - Directions for use

The Aqueon® Internal Power Filter can be placed either vertically or horizontally (fig.2) depending on the water level and on the type of tank. The outlet deflector rotates horizontally and vertically, allowing maximum versatility. However, it is advisable to place it vertically with the outlet on the water surface so as to create a useful surface movement and a light bottom current facilitating waste product intake.

**ROTATING OUTLET:** In order to change the position of the outlet adapter, starting from the standard vertical position, you have to first rotate the outlet deflector (fig.3-4). The extremely versatile water outlet allows the Aqueon® Internal Power Filters to be used in many applications. The flow deflector is completely rotate-able as well as extendable in height. The output connector can be totally rotated (fig.3-4).

To mount the filter simply press the side with the suction cups against the aquarium glass after cleaning the glass to remove algae or other residue.

**NOTE:** Before starting the filter, it is advisable to rinse filtering materials in running water.

## Usage and Adjustment

### MAINTENANCE

**MOTOR AND IMPELLER:** It may be periodically necessary to clean any deposit.

Proceed as follows:

- Separate the motor from the cartridge housing (fig.5).
- Take away the impeller cover (fig.6).
- Remove the rotor and rinse it with warm water.
- Replace all.

**FILTER CARTRIDGE:** (fig.1 item #3) The filter cartridge(s) should be removed and replaced every 30 days or as needed to ensure proper filtration and water flow through the filter. Reference the chart in the instructions or on the filter box to see the size and quantity of replacement cartridges required.

To replace the filter cartridge(s):

1. Separate the motor from the cartridge housing (fig.7)
2. Lift off the black filter chamber cover and slide out the filter cartridge(s) while leaving the Bio Grid in place.
3. Replace the filter cartridge(s) and re-assemble the filter.

**BIO GRID:** (fig.1 item #2) Do not remove the biological filter grid during routine maintenance. This will prevent damage of the beneficial bacterial colonies. If it becomes necessary to clean, rinse it very gently in water from the tank.

(Do not rinse with tap water to avoid damage to the bacterial colonies due to the chlorine present in tap water.)

## QuietFlow® Internal Power Filters Technical Data

Description	Wattage	Flow Rate (GPH)	Replacement Cartridges
AT10-G	2.6	up to 57	1 small
AT40-G	7	up to 155	2 large

## AQUEON® INTERNAL POWER FILTER

### Filtration Scheme

- 1 Adjustable return
- 2 Motor cover
- 3 BioGrid™
- 4 Filter Cartridge
- 5 Cartridge housing

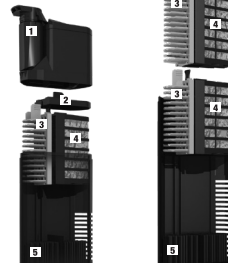

Model AT10-G

Model AT40-G

FIG 1



FIG 2  
applications



FIG 3

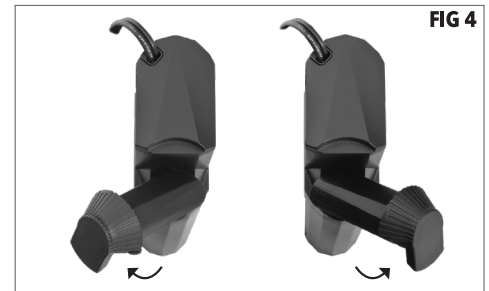

FIG 4

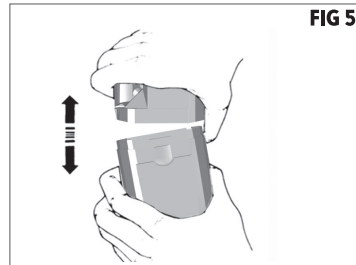

FIG 5

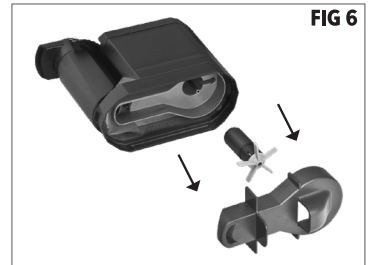

FIG 6



FIG 7

## Limited Lifetime Warranty

### WHAT THE WARRANTY COVERS:

Central Aquatics (Company) warrants this product (see Exclusions below) to the original purchaser against defective material and workmanship that occurs during normal in-home use for the life of the product. Company will, at Company's option, either repair or replace same without charge (but no cash refunds will be made).

### EXCLUSIONS:

1. Damage resulting from accident, misuse, abuse, lack of reasonable care, subjecting the product to any but the specified electrical service, other than normal and ordinary use of the product, subjecting the product to abnormal working conditions or any other failure not resulting from defects in materials or workmanship.
2. Damage resulting from modification, tampering with or attempted repair by anyone other than the Company.
3. Transfer of product to someone other than the original consumer purchaser.
4. The warranty is not valid for components subject to wear.

### FOR WARRANTY OR TECHNICAL SERVICE:

1. Contact the Company by mail or telephone:  
Central Aquatics, 5401 West Oakwood Park Drive, Franklin, WI 53132.  
Telephone: (888) 255-4527 to obtain a return authorization number.  
**NOTE:** Be sure to provide contact information when requesting return authorization number.

2. Deliver, mail or ship the product, together with a copy of the original bill of sale, to:  
Central Aquatics  
5401 West Oakwood Park Drive  
Franklin, WI 53132

You must pay any postage, shipping charges, insurance costs and other expenses to return the product to Central Aquatics, Franklin, WI 53132. However, if the necessary repairs are covered by the warranty, Company will pay the return shipping charges to any destination within the United States or Canada.

**LIMITATION OF IMPLIED WARRANTIES AND EXCLUSION OF CERTAIN DAMAGES:** THE COMPANY DISCLAIMS LIABILITY FOR INCIDENTAL AND CONSEQUENTIAL DAMAGES FOR BREACH OF ANY EXPRESS OR IMPLIED WARRANTY, INCLUDING ANY IMPLIED WARRANTY OF MERCHANTABILITY, WITH RESPECT TO THIS PRODUCT. THIS WRITING CONSTITUTES THE ENTIRE AGREEMENT OF THE PARTIES WITH RESPECT TO THE SUBJECT MATTER HEREOF; NO WAIVER OR AMENDMENT SHALL BE VALID UNLESS IN WRITING SIGNED BY THE COMPANY. Some states do not allow the exclusion or limitation of consequential damages, so the above limitation or exclusion may not apply to you.