



TONNEAU INSTALLATION GUIDE

Warranty, Care & Maintenance

Model 2146 Ford F-150 Ext/Crew Cab
5.5' Short Bed 2009-Current



EASY AS 1-2-3!

NORMAL INSTALLATION TIME



MINUTES

FORM # IG2146HH
Created June 2009

For Warranty Issues, Contact UnderCover Directly
(866) 900-8800 www.undercoverinfo.com

PRE-INSTALLATION NOTES

- 1 Be sure to use only cleaners, waxes, etc., which are labeled 'Safe for Plastics'. Make sure that chemicals or substances, which are not labeled 'safe for plastics', do not come in contact with your Undercover. Failure to do so could cause discoloration and/or structural damage to your Undercover and will void your warranty.
- 2 Paint rubbing of the truck is normally not a problem, but is always a possibility with any tonneau. To ensure less chance of possible paint rubbing of the truck, it is suggested to install a tailgate protector and adhere Cab Skin®, Scotch Cal®, or similar product to the truck bed. These products can provide added assurance against paint rubbing.
- 3 Undercover Tonneaus are designed from trucks that do not have a bed liner (spray-in bed liners pose no problem). Trucks that do have under-the-rail or over-the-rail bed liners will require some minor trimming of the bed liner to ensure proper placement of the mounting brackets. Due to the wide variety of bed liner manufacturers, the modifications will vary slightly between different brands. Any modifications must be made to the bed liner and NOT to the Undercover mounting hardware. Modifications to the mounting hardware will result in improper installation and will void your warranty.

INSTALLATION KIT CHECKLIST

- A: 2 Hydraulic Struts
- B: 2 Forward Mounting Brackets
- C: 2 Rear Mounting Brackets
- D: 4-Bar Hinge with Twist Knobs
(mounted to the Cover)
- E: 2 J-Hooks & Wall Mounting Screws
- F: 8 Clamps with 5/16" x 1 1/4" Stainless Steel Bolts, 5/16" Washers and 5/16" Lock Washers

 **NOTE:** This model **WILL** work with or without a tailgate step.



UNDERCOVER INSTALLATION TOOLS NEEDED



3/8"
WRENCH OR SOCKET



1/2"
WRENCH OR SOCKET



NORMAL INSTALLATION TIME



MINUTES

QUICK REMOVAL & REINSTALL REVIEW

Note: If your Tonneau has already been installed, skip to Page 11 for removal and reinstallation instructions.

Off your truck and on your wall in less than one minute!

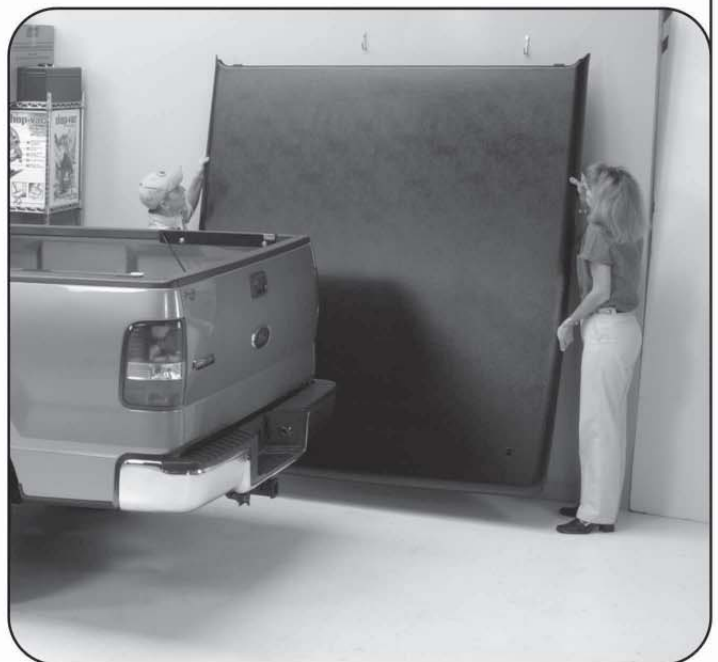

EASY AS 1-2-3

UNDERCOVER INSTALLATION INSTRUCTIONS



FACT:
Undercover is the
lightest hardshell
tonneau in the
industry. Only
58-pounds for full
size trucks.

- A** Place the rear bracket according to the measurements on *Page 4, Figure 1, Pictures A & B.*
- B** Use two of the holes in rear bracket which are unobstructed by the truck bed, (there will be four to choose from), one hole as far forward as possible and one hole as far back as possible (this will vary depending upon truck model) *Page 4, Figure 2.*
- C** Place a 5/16" x 1 1/4" bolt with a 5/16" lock washer and a 5/16" washer through the hole in bracket *Page 4, Figure 3.* Place clamp on backside of bracket behind the bed lip of the truck. Thread the bolt into the clamp and tighten being careful to not let the clamp twist while tightening. Make sure bracket is held down tightly against truck bed rail before tightening. Repeat procedure for second clamp. Mounting bracket bolts must be tightened down without bending the bracket. Keep the clamps straight and do not let them turn while tightening *Page 4, Figure 3, Picture C & D.*



WARNING! Do not over tighten and distort the brackets. Bolts must be checked for tightness periodically. Failure to do so could cause serious damage to both the truck and / or your UnderCover.

- D** Repeat Steps A through C for opposite side of the truck bed.

Footnote: The bolts should be tightened securely, stop tightening at the first sign of the bracket distorting.

UNDERCOVER INSTALLATION INSTRUCTIONS

10

Figure 1

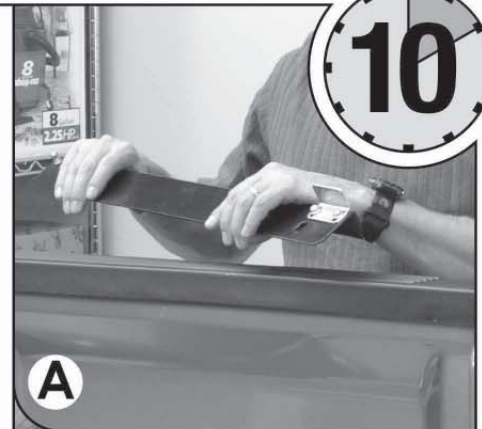
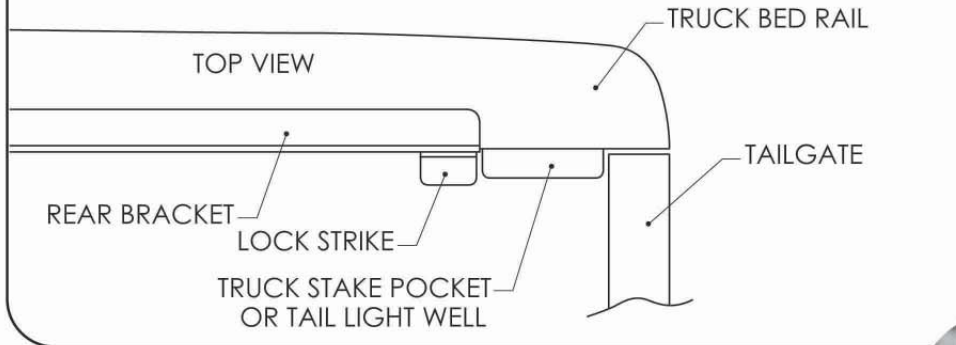

Figure 2

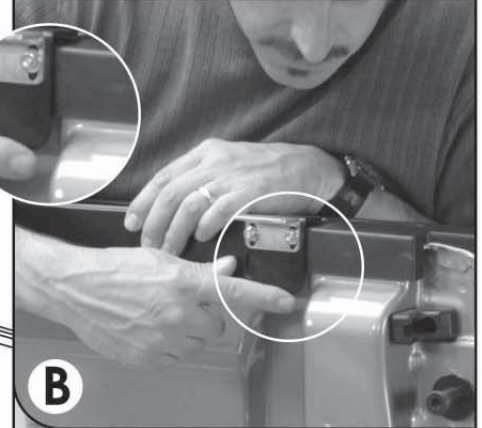
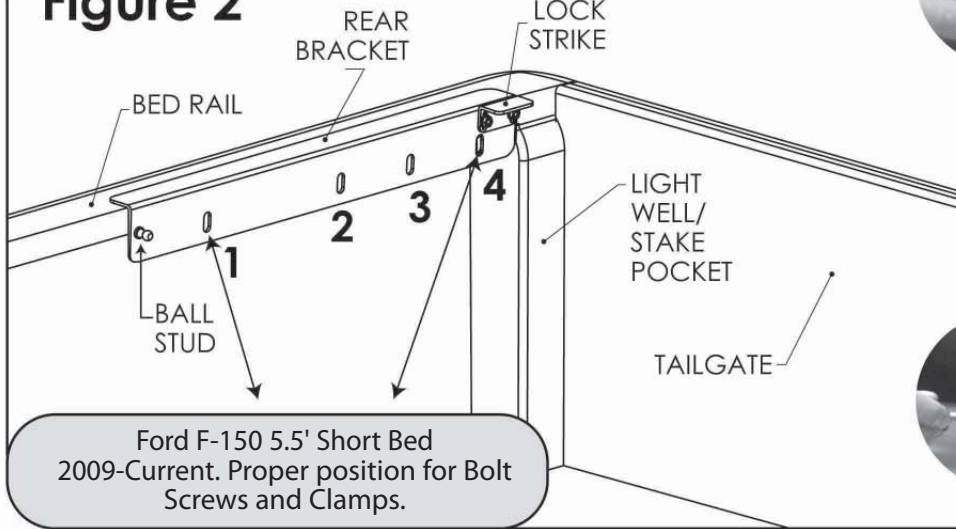
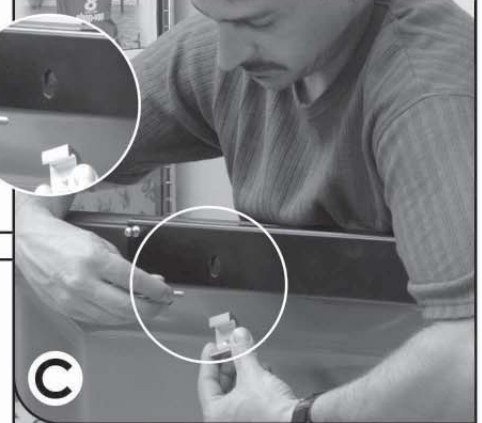
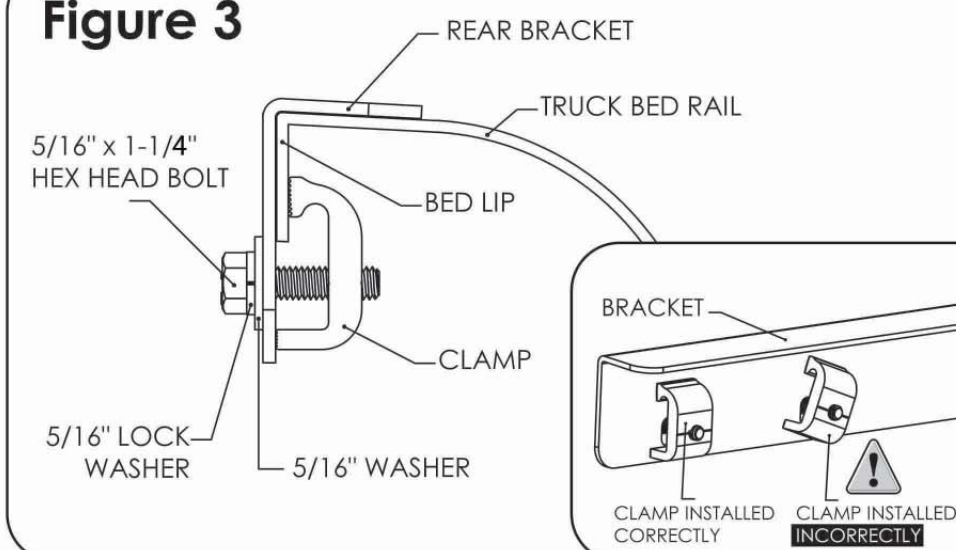

Figure 3



EASY AS 1-2-3

UNDERCOVER INSTALLATION INSTRUCTIONS



FACT:
Undercover's
ABS-Composite
material makes
it the strongest
and most durable
tonneau on the
market.

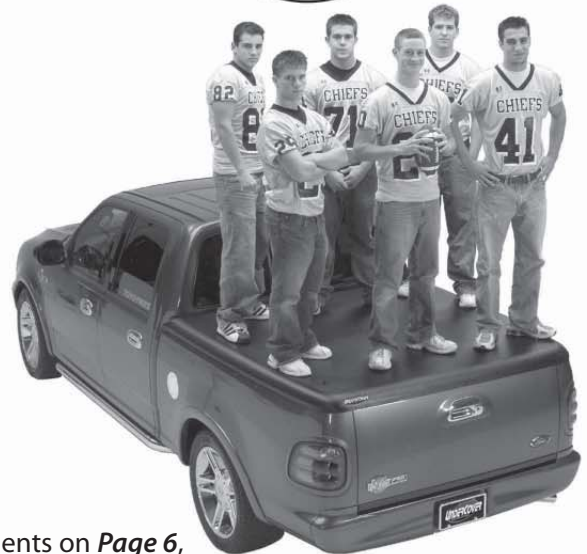

A Install your front mounting bracket using the measurements on **Page 6, Figure 4**. Using a tape measure place the rear end of the front bracket 17 1/8" from the inside wall of the bulkhead. Follow the same steps on the opposite side.

B Now using C clamps provided place 5/16 x 1 1/4" bolt with 5/16" lock washer and 5/16" washer through the hole in the front bracket and thread in the C clamp as shown on **Page 6, Picture A**. Each side will require 2 clamps. Do not completely tighten down the clamps at this point, rather insure that they are secure using a 1/2" socket or wrench. You may need to make some slight adjustments once the cover is in place in order to line up the cover with the bed and avoid rubbing. After you have test fit the cover and feel that the brackets do not require any further adjustment you should then tighten down front bracket clamps to the proper tightness (See footnote below). On Page 8 you can find instructions as to how best to test fit your cover and how to make any adjustments to your front brackets (if necessary).

C You are now ready to install your cover and test for proper fit with the bed rails of your truck. Mounted to your covers are both a left and right 4 bar hinge. See **Page 6, Figure 5, Picture B**. With some assistance, lift the cover up and over the bed bringing the 4 bar hinges over the front brackets see **Page 6, Figure 5, Picture C**. Your front brackets have 2 mounting posts, see **Page 6, Figure 5, Picture D**. The 4 bar hinges attached to your cover have 2 slots on each that slide over the mounting post fixed to the bracket on your truck. Set the cover down sliding the slots over the post on both sides. See **Page 6, Figure 6, Picture E**.

D The cover should be resting on the bed rail of your truck with a larger than normal overhang at the tail gate. See **Page 7, Picture F**. From the rear of the truck you should now be able to push the cover forward sliding the mounting post into the slots of the 4 bar hinge. See **Page 7, Picture G**. Your cover should now be locked into place and your are ready to tighten the twist knobs on the 4 bar hinge into the front brackets. Only hand tighten this and secure as much as possible. See **Page 7, Picture H**. You may need to remove the cover to make adjustments to the front bracket to line up the cover with the bed.

Footnote: The bolts should be tightened securely, stop tightening at the first sign of the bracket distorting.

FRONT MOUNTING BRACKET INSTRUCTIONS



Figure 4

TRUCK BED
TOP VIEW

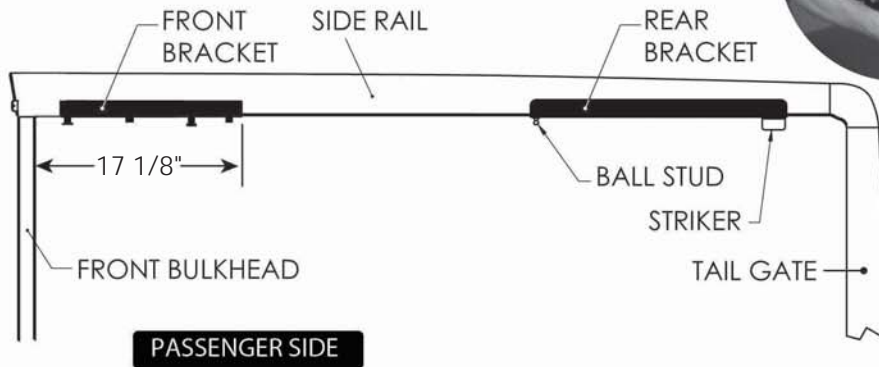

A



B

Figure 5

MARKS LINE UP WITH
SLOTS ON HINGE

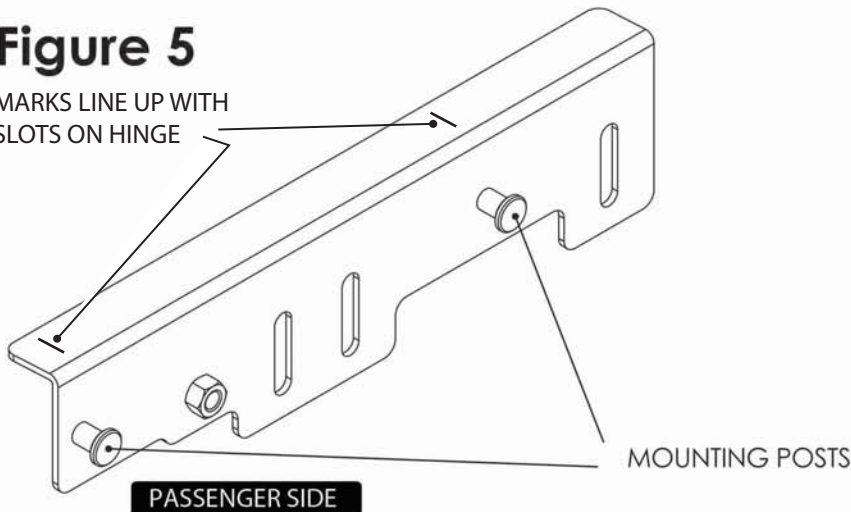

C

Figure 6

FRONT BRACKET
MOUNTED TO BED RAIL

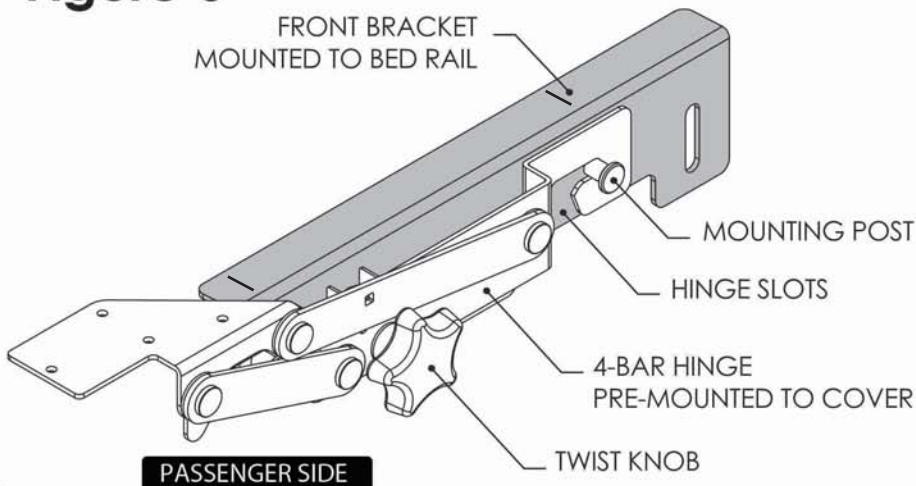

D

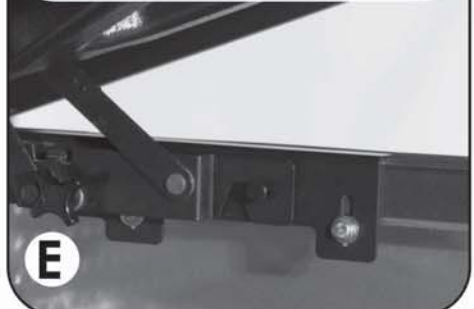

E

UNDERCOVER INSTALLATION INSTRUCTIONS

20

Slots on 4 bar hinge should be sitting on mounting post ready to be pushed into position.



Push 4-bar hinge slots into mounting post securing hinge system.



TEST FIT COVER PROPERLY BEFORE FINAL SECURING OF KNOBS AND CLAMPS.



The measurements given for the front brackets on step 2 are just a starting point. These measurements will work for a large percentage of trucks. Unfortunately not all truck beds are assembled 100% square, so some adjustments may be necessary.

With your cover closed, take a quick inspection to make sure that it is not touching the bed on either side or the tailgate. If it appears square or close to square go on to **Step 3, pages 9 and 10**. If it is making contact with the side of the truck or the tailgate, you may wish to make some adjustments before going to the final step.

To adjust the cover front to back evenly, move both of the front brackets forward or backward accordingly. To adjust one side or the other, move the front brackets forward or backward independently.

Any questions you can call tech assistance Monday through Friday, 8 a.m. – 5 p.m. Central Time (866) 900-8800.



Very Important: Periodically check your truck for rubbing. Make slight adjustments when necessary.

EASY AS 1-2-3

UNDERCOVER INSTALLATION INSTRUCTIONS



FACT:

In less than one minute, you can both take on and off the Undercover tonneau. Fastest removal system in the industry.

A Install hydraulic struts making sure **LARGE** end of strut is attached to the tonneau, and **SMALL** or rod end is attached to the ball stud on rear bracket *Page 10, Figure 7, Picture A*.

B Be sure that the front flap seal hangs over the bulkhead of the truck and is not rolled under the tonneau after installation. If flap seal is rolled under the tonneau, open the tonneau, and from the inside push the flap seal out from under the tonneau and over the bulkhead *Page 10, Figure 8, Picture B*.

C Close tonneau and check length on the truck. There should be 1/8" -to- 3/8" gap between the tailgate and the tonneau. If this is not correct, adjust by moving front brackets forward or backward to achieve correct length. Front brackets may also have to be adjusted independently to "square-up" tonneau on some truck beds.

D Adjust lock strikes *Page 10, Figure 9, Picture C*. When adjusted properly you should be able to turn the lock to the latched position without having to push down on the tonneau. There should be a very slight amount of play between the lock rod and lock strike. A good rule of thumb is to adjust the lock striker to have approximately 1/8" gap between the rod and lock strike with the truck tailgate down. This usually gives you the proper adjustment after the tailgate is shut *Page 10, Figure 9, Picture D*.

WARNING: It is very important to be able to turn the lock without any resistance. Do not try to force the lock rod to turn if you encounter resistance. This could result in a broken lock. Adjustment may be necessary to the lock strike plate to achieve a smooth turn without any resistance.

UNDERCOVER INSTALLATION INSTRUCTIONS



Figure 7

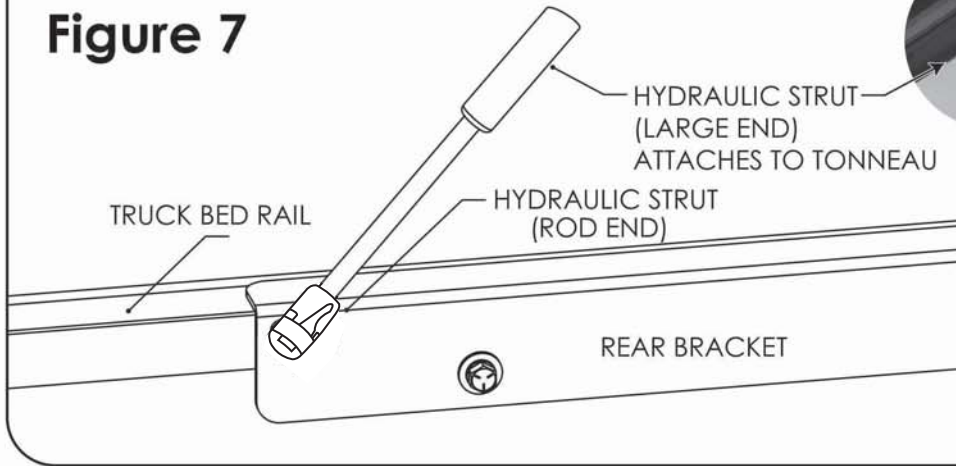

Figure 8

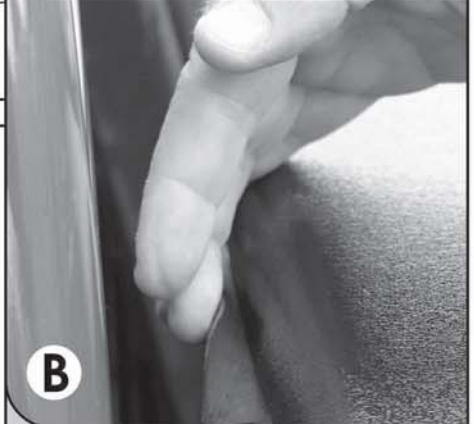
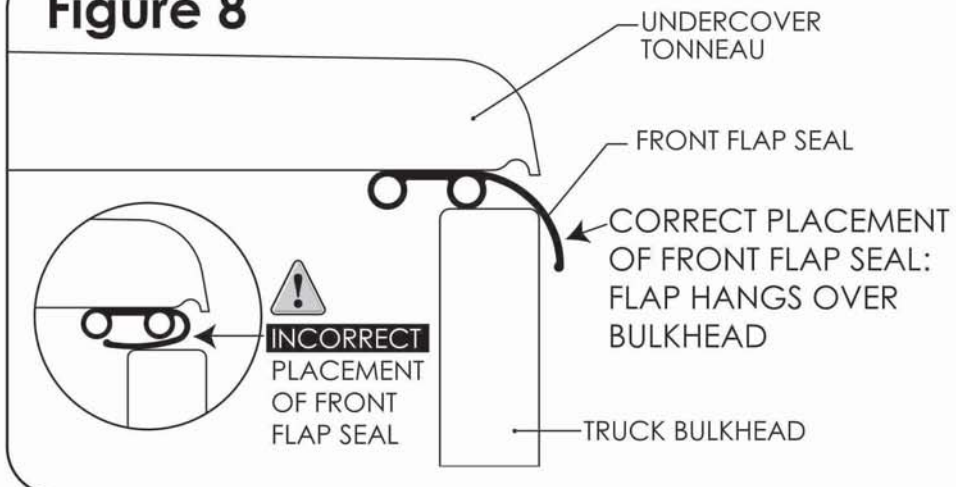
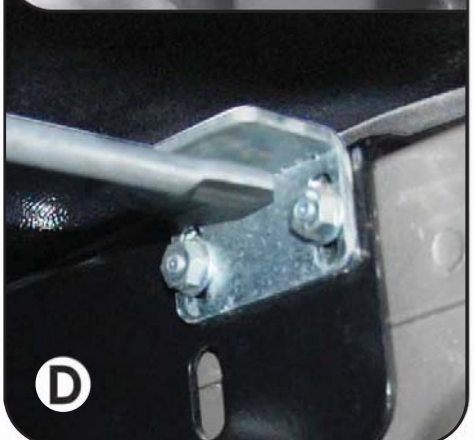
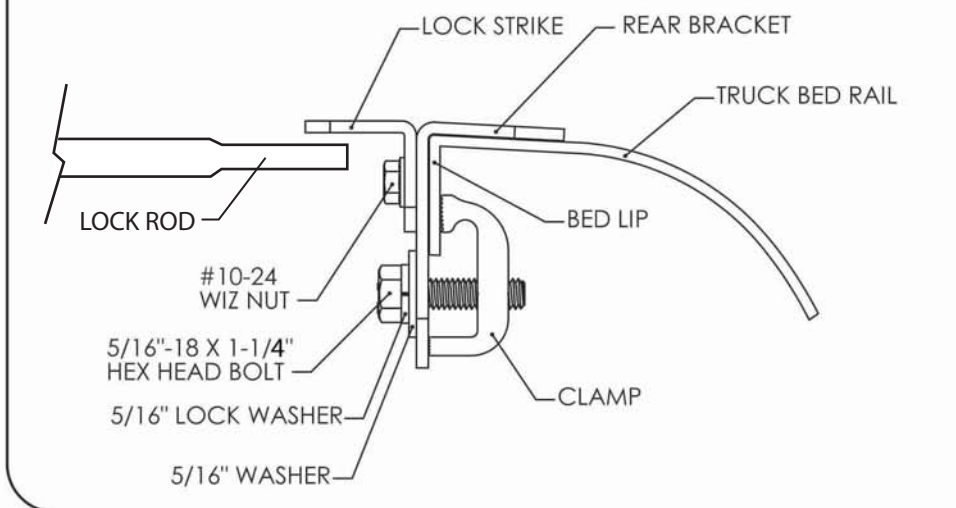

Figure 9



Congratulations! Your 30-minute installation job is now complete. Now, in less than one minute, you will be able to put on and take off your tonneau cover.

UNDERCOVER REMOVAL & REINSTALLATION INSTRUCTIONS

1 Minute Removal

STEP 1 Release strut off of ball stud *Picture B*. Holding tonneau up with one hand, place loose end of strut on storage clip *Picture C*. Repeat for the other side.

STEP 2 Turn twist knobs until they release *Picture A*.

STEP 3 Go to the rear of the truck and pull Tonneau cover back, releasing the post from the hinge slot, *Picture D*. You are now ready to lift the cover off.

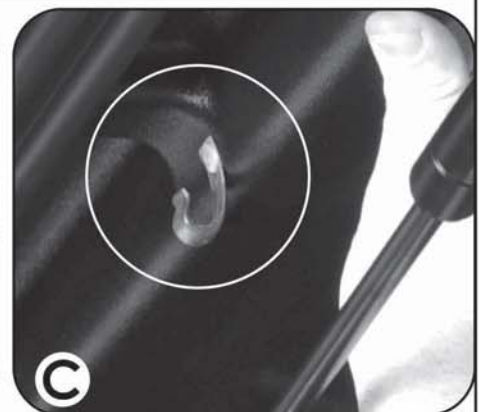
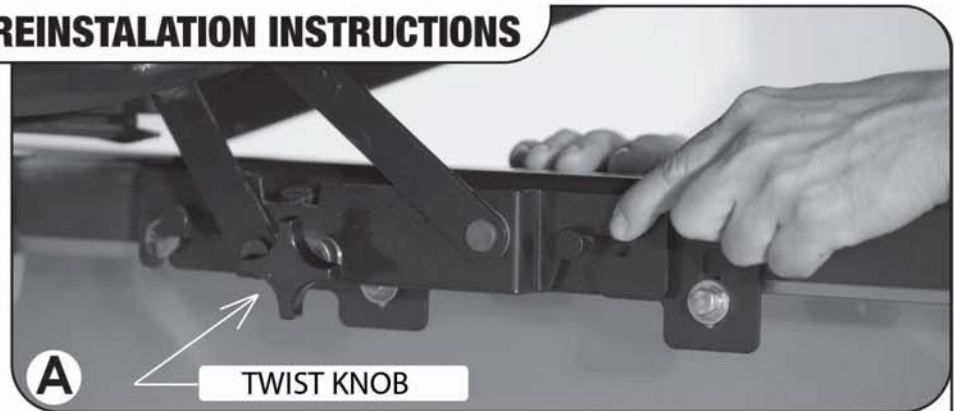

1 Minute Re-Install

STEP 1 Place tonneau on the truck and follow instructions on *Page 7*.

STEP 2 Be sure that the front flap seal is hanging over the bulkhead and not rolled under, see *Picture E* on this page.

STEP 3 Reinstall struts as seen in pictures *Pictures F and G* on this page.

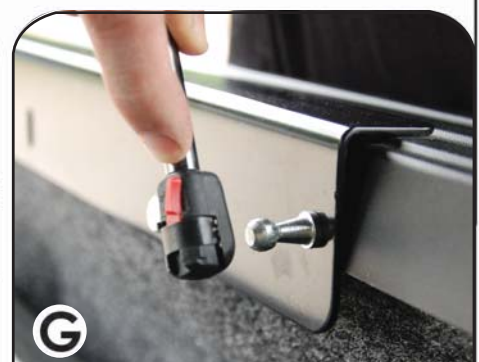
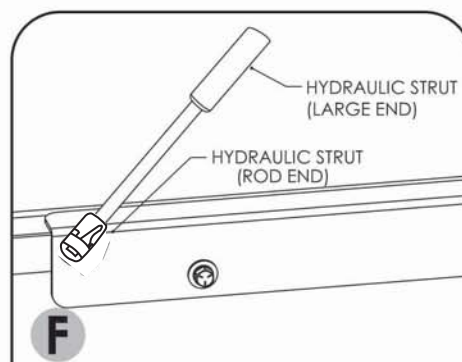
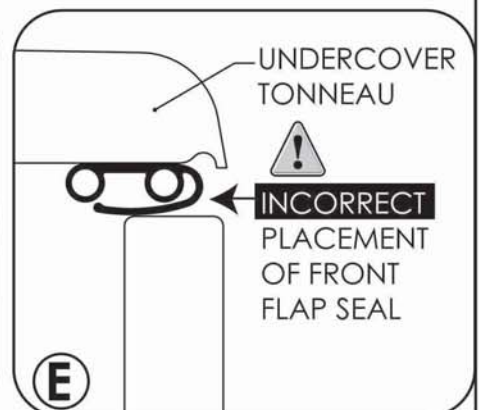

UNDERCOVER WALL HANGING INSTRUCTIONS

STEP 1 Prior to removing the tonneau, mount the two J-Hooks provided on the garage wall. The hooks must have a minimum height from the floor of 84", and be 32" on center horizontally apart *Picture A & B*.

STEP 2 Remove your tonneau from the truck bed according to instructions on *Page 11*.

STEP 3 Hang tonneau vertically on the wall-mounted J-Hooks, with the underside against the wall inserting J-Hooks into the holes provided in *Picture C & D*.

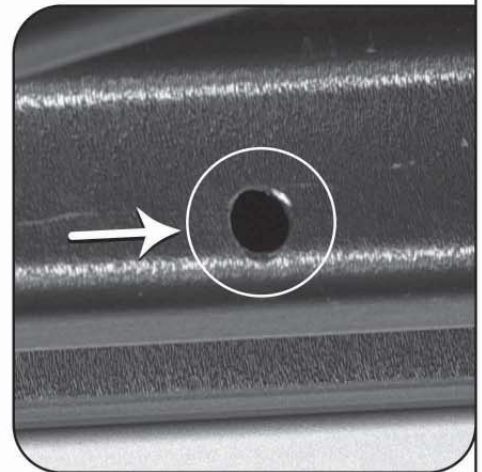
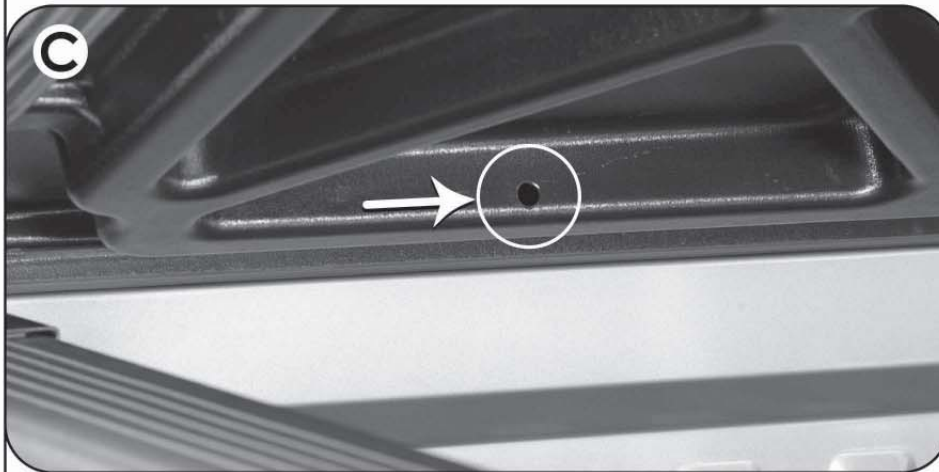
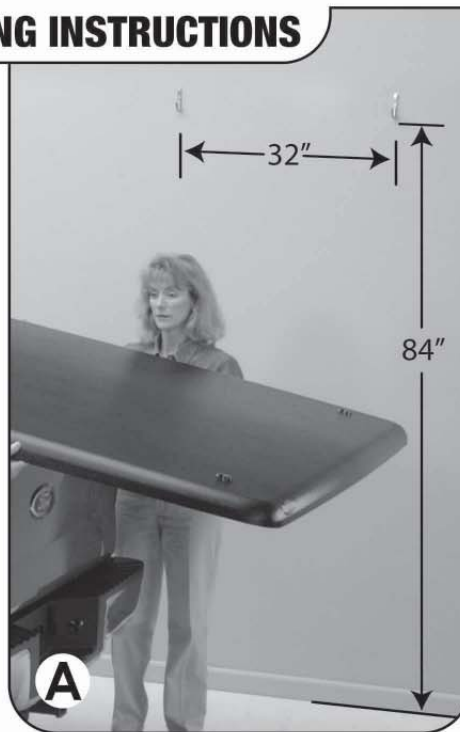

Better Storage Within Your Reach.



Swings Out

Provides easy access from the back of the tailgate...no reaching!



Lockable

The secure, versatile TWIST-LOCK allows you to open your Swing Case with or without a key.



Lift-Off Removal

Easy in, easy out without using tools. Take your gear with you—it even stands upright on its own.

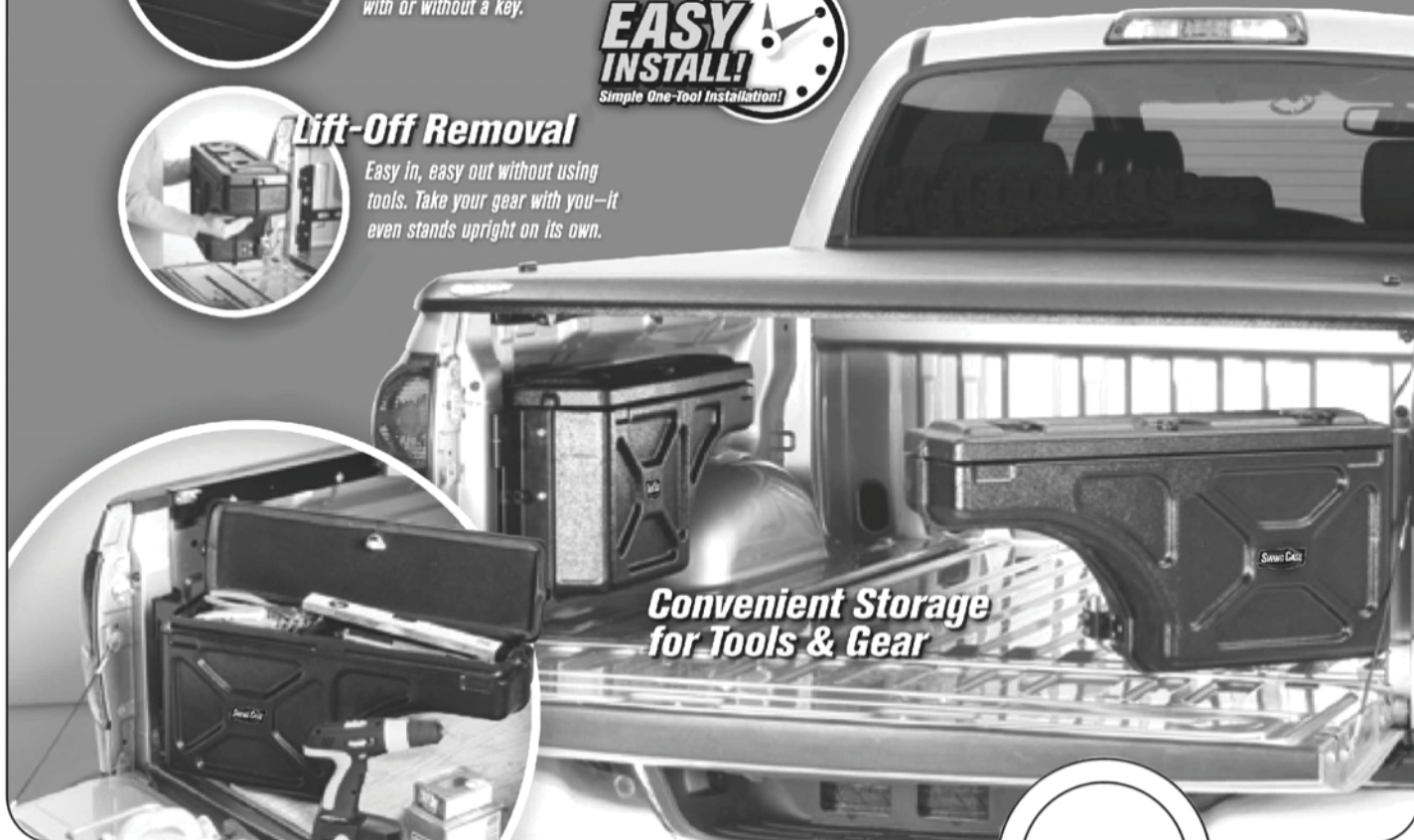

**Convenient Storage
for Tools & Gear**

Visit our website to find a dealer near you.



THANK YOU!



Congratulations! You've just installed the fastest-selling, highest-quality tonneau in the industry. Thank you very much for your purchase of UnderCover!

David Wells

**David Wells
President
UnderCover, Inc.**

UnderCover, Inc.
P.O. Box 620
Rogersville, MO 65742
(417) 753-8000
(866) 900-8800
www.undercoverinfo.com
sales@undercoverinfo.com



© 2010 UnderCover, Inc.
All rights reserved.

For any Warranty issues, contact UnderCover directly.