

Microphone G1T/ G1L >>> User Manual

Thank you for choosing SYNCO product.
Please read this manual carefully before use and follow all instructions mentioned herein.

Caring For Your SYNCO Product

- Please keep the product in a dry, clean, dust-free environment.
- Keep corrosive chemicals, liquids and heat source away from the product to prevent mechanics damage.
- Use only a soft and dry cloth for cleaning the product.
- Malfunction may be caused by dropping, impact of external force.
- Do not attempt to disassemble the product. Doing so voids warranty.
- Please have the product checked or repaired by authorized technicians if any malfunctions happened.
- Failure to follow all the instructions may result in mechanics damage.
- Warranty does not apply to human errors.

Package List

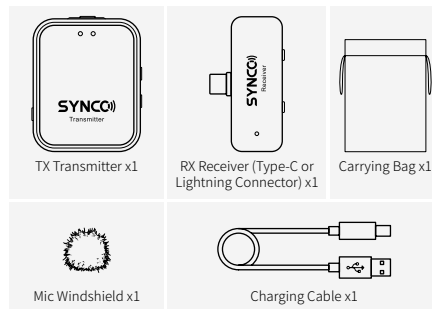

Product Instruction

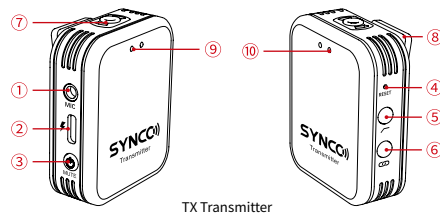

TX Transmitter

- | | |
|------------------------------|-----------------------------|
| ① External Mic Input | ⑥ Pairing |
| ② USB-C Port | ⑦ Built-in Mic |
| ③ Power/ Mute | ⑧ Pocket Clip |
| ④ Reset(Help with Eject Pin) | ⑨ Pairing/ Muting Indicator |
| ⑤ Low Cut | ⑩ Power Indicator |

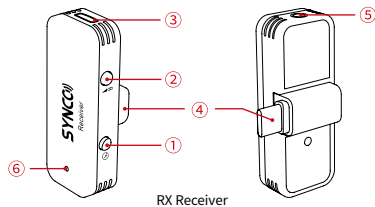

RX Receiver

- | | |
|-------------------------|--------------------------------|
| ① Vocal Effects | ④ Detachable Connector |
| ② Pairing/ Gain Control | ⑤ 3.5mm In-Ear Monitoring Jack |
| ③ USB-C Port | ⑥ Pairing Indicator |

Indicator — TX Transmitter

| | Pairing/ Muting Indicator | Power Indicator |
|--------------------|---------------------------|-----------------|
| | | |
| Slow flashes | System unpaired | / |
| Fast flashes | System pairing | / |
| Keeps on | System paired | Muting |
| Fast flashes twice | Low cut on | / |

Indicator — RX Receiver

| | Pairing Indicator | |
|--------------|-------------------|------------------|
| | | |
| Slow flashes | System unpaired | / |
| Fast flashes | System pairing | / |
| Keeps on | System paired | Vocal effects on |

Operations

TX

1.Power/ Mute

- Long Press 3s: turn on/off the system
 Short Press: mute/unmute the microphone

2.Charging

- 5V/2A;
Please fully charge the product before use with USB-C charging cable.

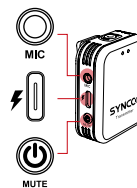

3.External Mic Input

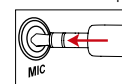

TRS Mic Only
(Note: When using an external mic, please insert it into the mic input properly.)

4.Mic Windshield & Device Installation



5.Reset



Gently poke the pin into Reset for 3 seconds to restore factory defaults.

6.Low Cut

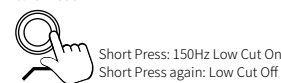

Short Press: 150Hz Low Cut On
Short Press again: Low Cut Off

7.Pairing

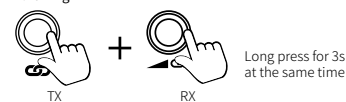

The system will pair automatically after power on.
Manual pairing: long press the pairing button on the RX and TX for 3 seconds at the same time

RX

1.Vocal Effects

Short press to switch sound effects: Original - Studio FX - KTV FX - Voice Amplification - EDM (Electronic Dance Music) - Baby FX - Male to Female - Female to Male - Monster FX

2.Pairing/ Gain Control

The system will pair automatically after power on.

Manual pairing: long press the pairing button on the RX and TX for 3 seconds at the same time

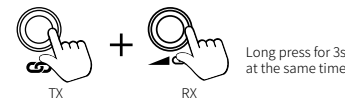

Gain Control: 0-3 Level

Each short press increases gain by one level.

3.USB-C Port

For charging phone device

4.Detachable Connector

G1T: Type-C connector
G1L: Lightning connector
Extra Type-C or Lightning connector is available separately to adapt RX to more phone devices.

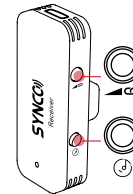

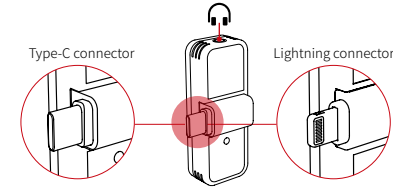

3.5mm In-Ear Monitoring Jack
For real-time monitoring mic recording and device's backgrounding with headphones

Specifications

| | |
|-----------------------|---|
| TX Transmitter | |
| Wireless Transmission | Digital 2.4GHz |
| RF Frequency Band | 2400-2483.5MHz |
| Working Distance | 492ft/150m(LOS area); 164ft/50m(NLOS area) |
| Sampling Rate | 48KHz |
| Bit Depth | 16Bit |
| SNR | > 75dB |
| Audio Input | 1/8" / 3.5mm TRS Mic Input |
| RF Output Power | 20dB |
| Power Requirements | 3.3V-4.7V |
| Battery Type | Built-in Lithium Battery, 400mAh |
| Charging Port | USB-C |
| Battery Charging Time | 1.5H |

| | |
|--------------|------------|
| Battery Life | 8H |
| Dimensions | 52×42×16mm |
| Material | ABS |
| Weight | 35g |

| | |
|--------------------------|---|
| RX Receiver | |
| Wireless Transmission | Digital 2.4GHz |
| RF Frequency Band | 2400-2483.5MHz |
| Working Distance | 492ft/150m(LOS area); 164ft/50m(NLOS area) |
| Sampling Rate | 48KHz |
| Bit Depth | 16Bit |
| Antenna | Built-in |
| Number of Audio Channels | 2 |
| Monitoring | 3.5mm In-Ear Monitoring |
| Audio Output | Lightning or Type-C Output |
| Gain | 0-3 Level |
| Power Requirements | 5V 1A |
| Dimensions | 55X31X13mm |
| Material | ABS |
| Weight | 12g |

| | |
|-----------------|--------------------------------|
| Microphone | |
| Form Factor | Built-in Mic |
| Sound Field | Mono |
| Polar Pattern | Omnidirectional |
| Frequency Range | 50-20KHz |
| Sensitivity | -42dB (±3dB, re 1V/Pa at 1KHz) |
| Maximum SPL | 110dB SPL (at 1KHz) |

Warranty

Warranty Period
Thank you for purchasing SYNCO products.
1. Customers are entitled to free replacement or repair service in case of quality defect(s) found in the product under normal use within 30 days upon receipt of the product.
2. Original SYNCO products are entitled to **12-month** limited warranty service. The warranty period begins on the date of purchase of brand new, unused products by the first end-user.
Within the warranty period, if product defect or failure is attributable to material defection or technological problem, the defective product or defective part will be repaired or replaced without charge (service and materials fee).

Warranty Exclusions and Limitations
Faults resulted from inappropriate use of a product without following its operation specification

- Artificial damage, e.g. crash, squeeze, scratch, or soaking
- Modifications to a product by its user or a third party without prior written consent of SYNCO, e.g. replacement of element or circuit, label alteration
- The code on product is inconsistent with that of warranty certificate, or the code on the product or warranty certificate is altered or torn off
- All consumable accessory attached to a product, like cable, wind muff, battery
- Faults as a result of force majeure, such as fire, flood, lightning, etc.

Warranty Claim Procedure

- If failure or any problem occurs to your product after purchase, please contact a local agent for assistance, or you can always contact SYNCO's customer service through email at support@syncoaudio.com.
- Please retain your sales receipt and warranty certificate as proof of purchase. If any of these documents is missing, only sales return or chargeable service will be provided.
- If the SYNCO product is out of the warranty coverage, the service and the parts cost will be charged.

Guangzhou Zhiying Technology Co., Ltd

📍 Block 15th, No.200 Fangcun Avenue East, Liwan District, Guangzhou, China, 510000
✉ support@syncoaudio.com
🌐 www.syncoaudio.com
📱 https://www.facebook.com/syncomicrophones

| | |
|--|----------------|
| WARRANTY CERTIFICATE | |
| Please register your warranty. Meanwhile, you are welcomed to contact us via Email: support@syncoaudio.com | |
| USER INFORMATION | Customer Name: |
| | Phone Number: |
| | Email: |
| | Address: |
| SALES INFORMATION | Sales Date: |
| | Model: |
| | Product Code: |
| | Dealer: |
| REPAIR RECORD | Service Date: |
| | Technician: |
| | Issue: |

RESULT ☐ Solved ☐ Unsolved ☐ Returned(Replaced)