

Quick Setup Guide

Simple Steps to Get Your AeroGarden Up and Growing (No tools required)



Welcome to the world of indoor gardening!

The AeroGarden *ULTRA* is the most advanced countertop garden in the world, but it's also easy to use. In fact, the *ULTRA* is ready to plant in under 5 minutes with just 7 easy steps that anyone can do!

This handy Quick Setup Guide shows you how to get started and gives you all you need to know about the *ULTRA*'s control panel, as well as tending and harvesting tips for your new garden.

Keep This Guide!

Included in Package



7 Easy Steps

To Get Your AeroGarden Up and Growing

1 Remove Bowl From Base

Lift Bowl straight up from Bowl & Base Assembly

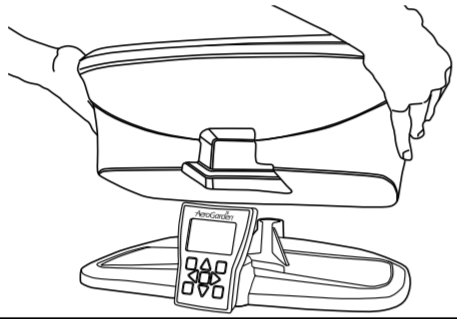

2 Clip in Lamp Arm and Replace Bowl to Base

Push Lamp Arm down until you hear a "click."

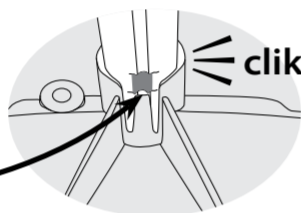

Tab in Base should insert into Lamp Arm slot

3 Plug Pump cord into Back of Garden Base

Pump power cord

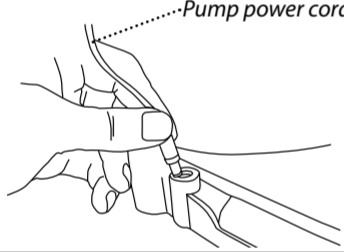

The Pump power cord plugs into base on back of garden

4 Install Grow Lights

Push Grow Lights straight into sockets in Lamp Hood

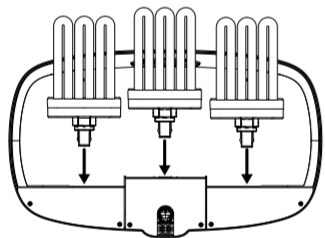

DO NOT TWIST BULBS!

5 Install Lamp Hood

Push Lamp Hood firmly on to Lamp Arm until you hear a click

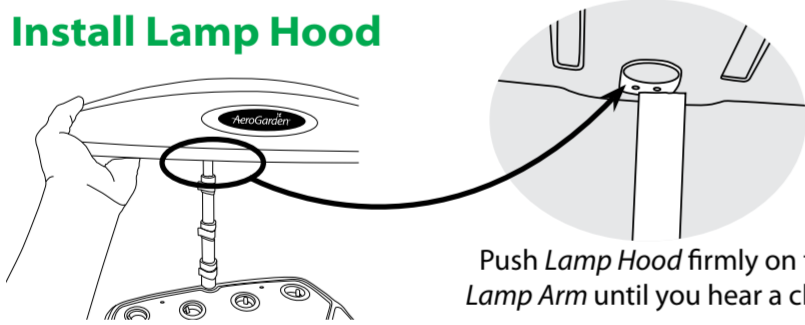

6 Plug in Lamp Hood then Plug Cord into Electrical Outlet

Push Lamp Cord firmly into socket in Lamp Hood.

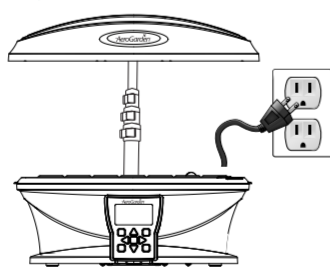
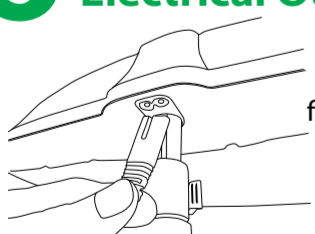

7 Press Quick Plant and Follow On-screen Instructions

Press **Quick Plant** button on the control panel for step-by-step instructions on planting your garden

Turn page for more details on planting, growing and harvesting your AeroGarden

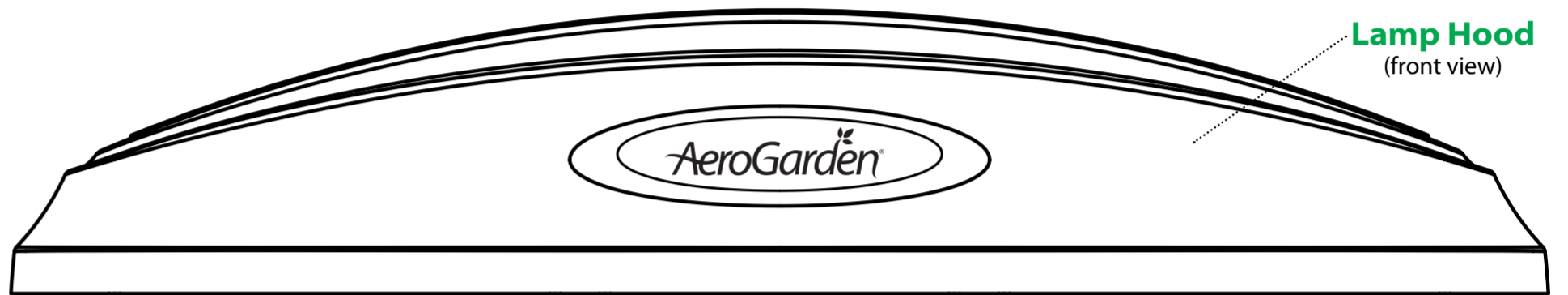
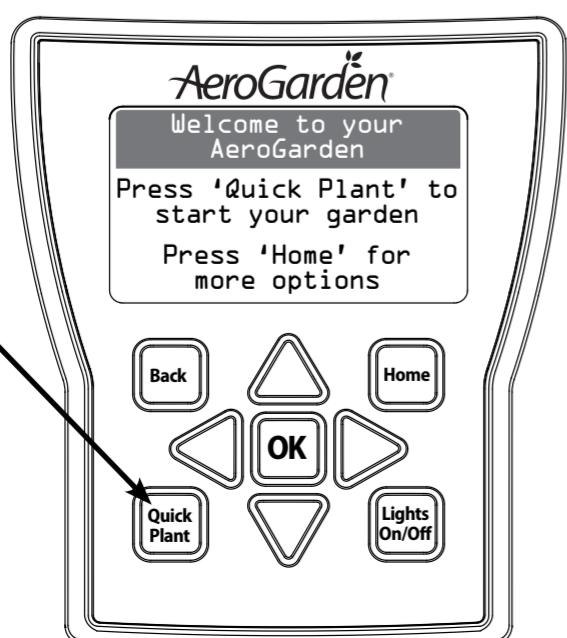

Lamp Hood (front view)

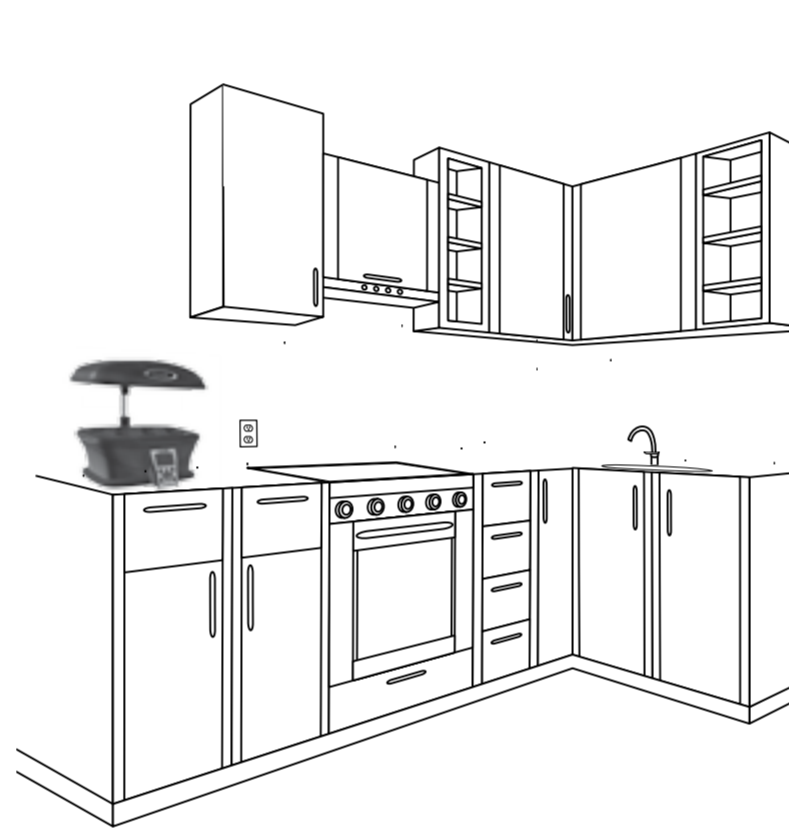

Place Your Garden...

- On a sturdy, water-tolerant surface (metal surfaces may cause noise due to vibration)
- Near a standard electrical outlet, per local regulations
- In a 65-75°F (16-23°C) environment (optimal)
- Away from reach of children or pets
- Away from direct sources of heat or cold
- AeroGardens do not need additional light or a sunny window. In fact, too much direct sunlight can overheat your plants

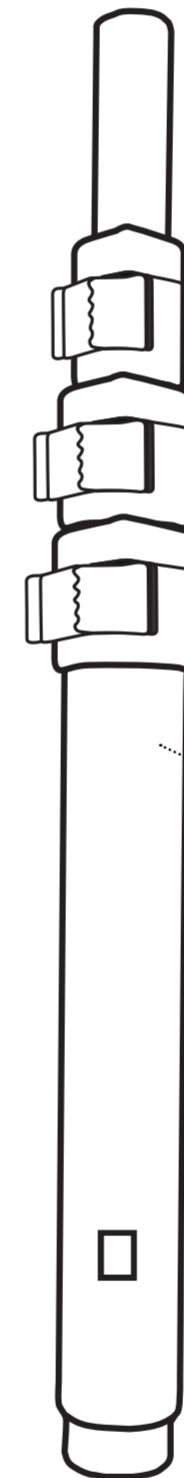

Lamp Arm

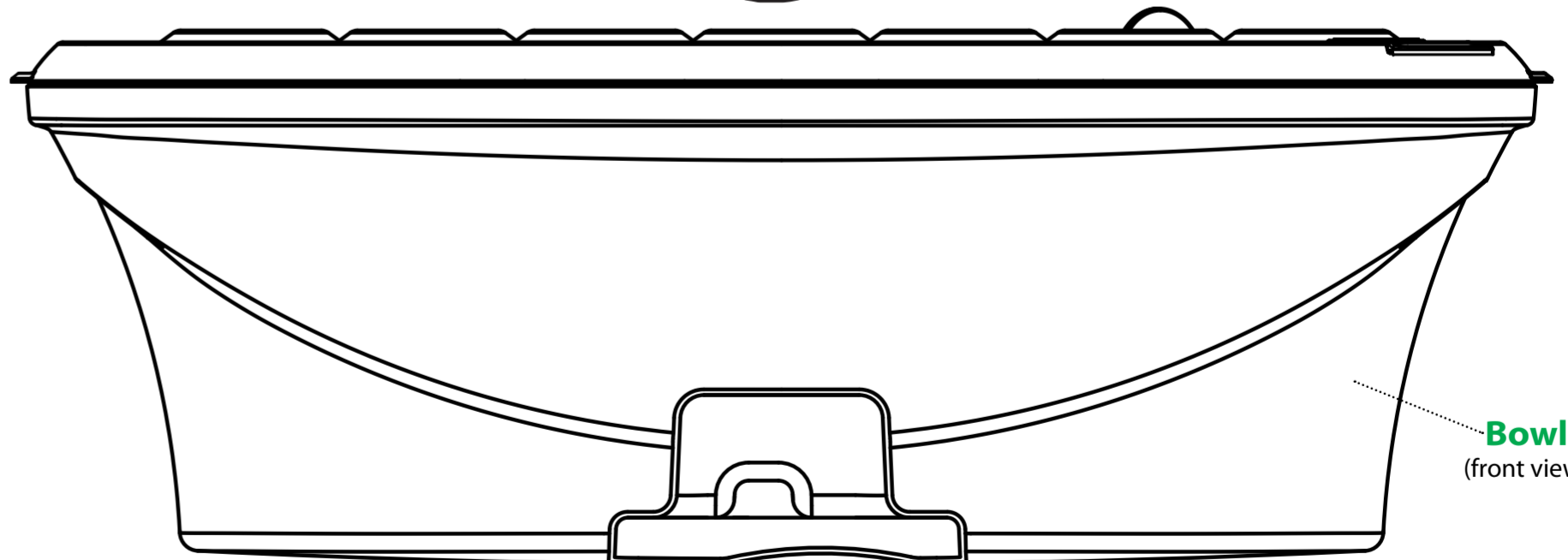

Bowl (front view)

Base (front view)

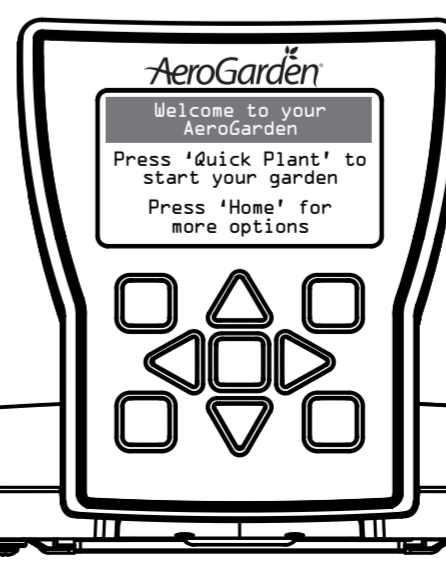

Simple Tips for Successful Growing...

Control Panel Basics

The AeroGarden *ULTRA* control panel makes it easy for anyone to grow indoors. Beginners get step by step instructions of the planting process and coaching to improve gardening skills. And it allows Advanced Users to customize every aspect of their indoor garden, expanding the possibilities of what can be grown indoors.

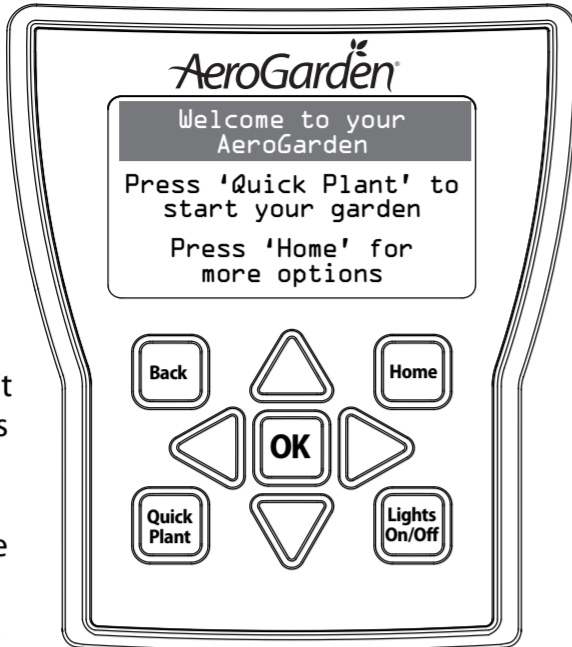

Navigation:

To navigate the control panel, use **Up/Down and Left/Right arrows** to move. Press the **OK Button** to select an option.

Options:

Quick Plant Button: Press *Quick Plant* from any screen anytime you want to plant a new garden.

Lights On/Off Button: Temporarily turns lights on or off. Your lights will automatically go back to their programmed settings.

Back Button: Always takes you back to the previous screen.

Home Button: Press the Home Button from any screen for access to more menu options, including:

▶ **Quick Plant** – Use this menu option to start a new garden. This is the same as pressing the Quick Plant Button.

▶ **Set Lights** – Use this to re-adjust the times your lights will go on and off (you'll set these initially in the Quick Plant function).

▶ **Set Clock** – Use this to re-set your clock time (set initially during Quick Plant). You might do this after a power outage (the AeroGarden automatically holds all your settings during a power outage, but you'll need to re-set your clock).

▶ **Help & Tips** – Use this for easy access to helpful tips and customer support information.

▶ **Set Audio Alerts** – Use this to turn on audio alerts that remind you when to add water and nutrients. You can also easily set the times during which alerts can sound (so they don't wake you up in the middle of the night).

▶ **Custom Settings** – Advanced Users can program all critical elements of their AeroGarden, from lights to pumps to nutrient cycles. This is not needed in normal operations. You can also restore defaults from this page.

▶ **Order Supplies** – Easy access to replacement part numbers and customer support contact information.

▶ **Garden Status** – All your critical garden settings in one place.

Your AeroGarden *ULTRA* defaults to the **Dashboard Screen**. Here you'll find critical information on Days Planted, Days until next feeding, and relevant tips for your garden as it grows. From any other screen, press the home button once or twice to return to the Dashboard.

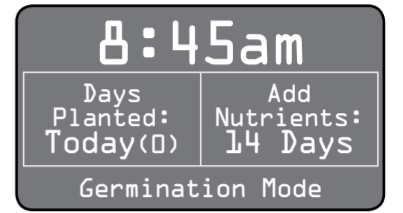

Planting and Harvesting Tips

A few "Bonus" tips for maximum harvests

Planting

▶ Many AeroGarden pods are labeled for height. Gardens grow and look their best when tall plants are planted in back, medium plants in the middle, and short plants in front. If plants are all the same size, like Salad Greens, they can be planted anywhere.

▶ Do not remove labels from seed pods. The labels identify the plant type and plant height, show the germination time, and inhibit algae growth.

▶ Grow domes help regulate moisture and temperature for optimal germination. Leave them on until plants are touching the domes.

▶ Large plants like tomatoes and peppers often receive fewer than 7 pods to compensate for the large plant size. Place seed pods in each front/side opening and in the center back opening. Put plant spacers in the remaining openings.

Germination

▶ Some seeds germinate in less than 24 hours. Some take 24 days or more. Most AeroGarden seed pod labels give an estimate of how long your seeds will take to germinate but many factors impact germination.

▶ As a rule of thumb, if you are comfortable, so are your plants. However plants are impacted by temperature. Cold weather plants like Salad Greens germinate better in cooler weather. Heat lovers like tomatoes and peppers will germinate faster in warmer temperatures (above 70 degrees F). However, don't sweat it! While they may take a bit more time, your seeds will germinate.

▶ If you are growing your own seeds, plant 5-6 seeds per pod and check the seed packet for temperature and days to germination information.

Pruning

▶ Lower your plants, don't raise your lights! You will achieve more compact, beautiful growth and bigger harvests if you prune plants to keep the lights closer to all plants.

▶ Fast growing plants like basil make gardeners want to raise the lights too soon. Resist! Pruning the basil just above a new leaf set (Diagram A) and leaving the lights down low will make sure that slow growing and low growing plants in your garden get all the light they need to flourish.

▶ Not pruning is the number one mistake made by new AeroGardeners! *Prune early and often and enjoy the small harvests!*

▶ Plants compete for light. Left untended, more aggressive growers can actually block enough light to suppress growth of their slower growing neighbors and eventually they can die off due to lack of light. Fast growers must be trimmed (diagram B) to make sure that slow growers get enough light to thrive and produce big yields.

▶ Finally, pruning=harvesting. Each time you prune you get to enjoy fresh herbs in a salad, soup, on pizza or a sandwich. And, a full, bushy garden looks much better than one spindly, giant plant surrounded by straggly, light starved neighbors. Pruning also releases a wonderful scent. So Prune!

▶ Learn more about pruning your plants at www.AeroGarden.com/Help.

Lights

▶ Plants love light! Always keep your grow lights as close to your plants as possible.

▶ However, plants touching the lights will discolor those leaves and they will have to be snipped off. Always check to see if you can prune plants instead of raising the lights.

▶ After pruning, lower your lights back down to within 1-2 inches of plant tops if necessary.

Water

▶ While the AeroGarden control pane will remind you when water gets low, best results are achieved by topping off water regularly.

▶ Plants grown in the AeroGarden are designed to thrive with most municipal tap water. Improved results can be seen with distilled water or reverse osmosis water, but this is not needed in most cases.

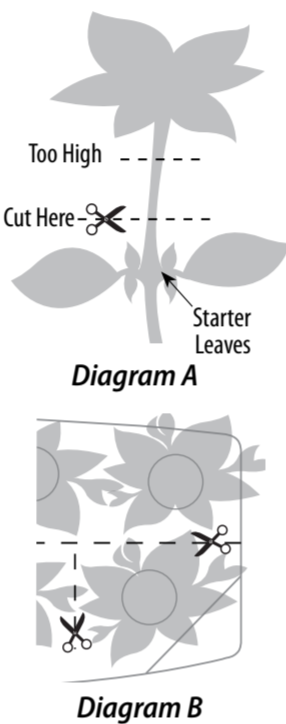

▶ If you have a well or community well, we recommend using distilled water. Most well water contains a high amount of dissolved solids that upset the balance of our nutrients. This can result in plants suddenly browning, or just not growing well.

▶ Do not use softened water as it contains too much sodium and will usually harm your plants.

Nutrients

▶ In general, your plants will need nutrients every two weeks.

▶ Follow instructions for feeding on the nutrient packaging. Add nutrients through the water fill port.

▶ Nutrient requirements may change as plants grow. See nutrient packaging for details.

▶ "More" isn't better. Resist the temptation to add "just a little extra." Too much nutrient can hurt your plants.

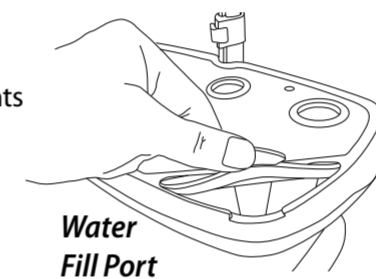

▶ For best results, try a "Rinse and Refill" once a month when it's time to add nutrients. Simply empty all water from the bowl, add fresh water and nutrients and reset your alert. This balances the nutrients, delivering an instant pick up to plants.

Harvesting

▶ Many first-time growers are hesitant to harvest. Don't be! Most gardens will produce more, for a longer period, with frequent harvests. You almost can't begin to harvest (prune) early enough.

▶ AeroGardens work best with a harvesting method called "cut and come again." Simply put, you enjoy frequent small harvests and then watch as the plants rapidly re-grow, ready for harvest again and again.

▶ Enjoy frequent, smaller harvests for the first month or two until plants mature and larger harvests are available.

▶ Never harvest more than 1/3 of the plant at a time.

▶ For salad greens, cut the top 2 inches off the entire garden, or harvest large leaves individually by cutting off at the base of the plant.

Using The Trellis System

The included *Trellis System* will support your large plants, such as tomatoes and peppers by wrapping around the plants as they grow. Additional support may be supplied by tying string or using AeroGarden Trellis Coils.

Once your plants reach a height where they would benefit from extra support, attach the *Trellis System* to the top Lamp Arm section as pictured. The *Trellis* can be repositioned as plants grow.

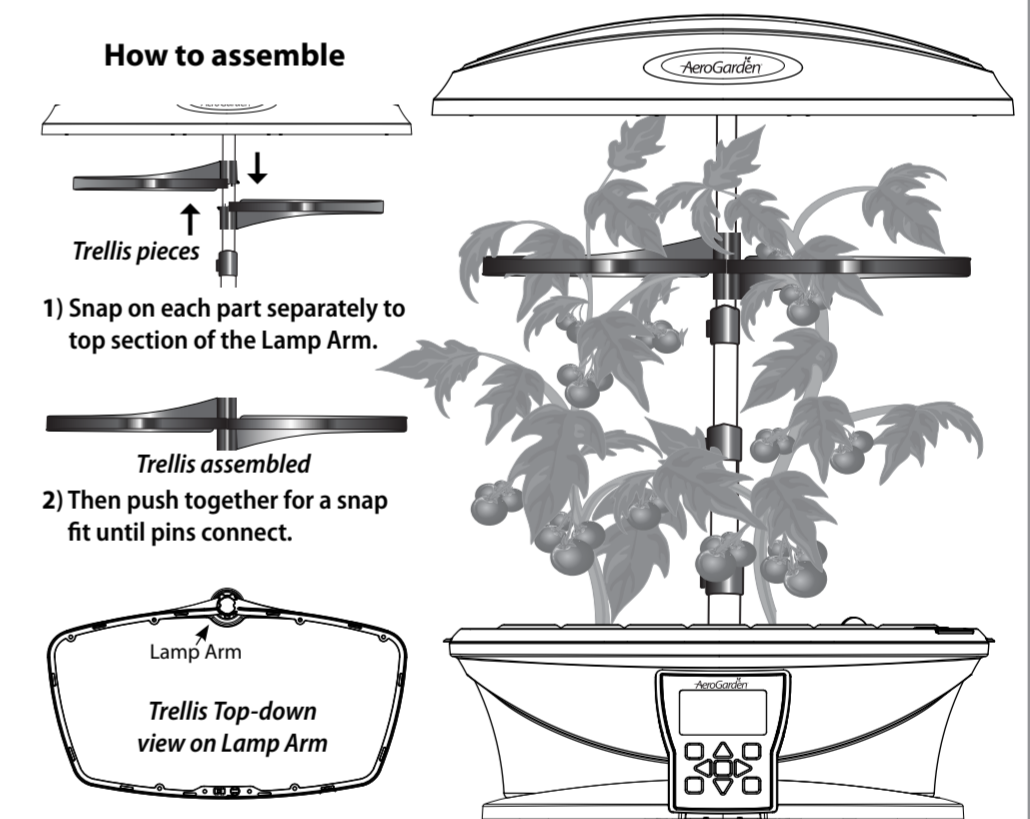

IMPORTANT SAFETY INSTRUCTIONS

(SAVE THESE INSTRUCTIONS)

When using this AeroGarden electrical furnishing, basic precautions should always be followed, including the following:

Read all instructions before using this AeroGarden furnishing.

1. To reduce the risk of electric shock, the AeroGarden has a specific plug. Do not change the plug in any way.

DANGER – to reduce risk of electric shock:

2. Always unplug the AeroGarden from electrical outlet before cleaning or changing Grow Bulbs (light bulbs).

WARNING – to reduce risk of burns, fire, electric shock, or injury to persons:

- Unplug AeroGarden from outlet before putting on or taking off parts.
- Close supervision is necessary when an AeroGarden is used by or near children, invalids, or disabled persons.
- Use AeroGarden only for its intended use as described in the instructions. Do not use attachments not recommended by manufacturer.
- Never operate AeroGarden if it has a damaged cord or plug, if it is not working properly, if it has been dropped and damaged, or if it has been dropped in water. If any of these conditions occur/exist, contact www.AeroGardenSupport.com or your country's local distributor for instructions.
- Keep cord away from heated surfaces.
- Never operate furnishing with air openings blocked. Keep air openings free of lint, hair, and the like.
- Never drop or insert any object into any electrical openings.
- Do not use outdoors.
- Do not operate where aerosol (spray) products are being used or where oxygen is being administered.
- Do not touch moving parts or hot parts such as pumps, bulbs, reflective surfaces, and the like.
- To disconnect, remove plug from outlet.
- Do not place or submerge base, cord, plug, or lamp hood in water or other liquid to clean it.
- Do not allow water to contact hot light bulbs.
- Use only approved and supplied parts and accessories. Use only AeroGarden brand Grow Bulbs with this AeroGarden model. Use of any other kind of accessory is not recommended. Replacement parts can be ordered from www.AeroGarden.com.
- Do not use AeroGarden for other than intended purpose.
- This product is intended for household and residential use only. This product is not approved for commercial applications.
- If supply cord is damaged, it must be replaced by manufacturer, its service agent, or similarly qualified technician in order to avoid a hazard.
- Electrical wiring must be in accordance with local regulations.
- This appliance is not intended for use by persons (including children) with reduced physical, sensory or mental capabilities, or lack of experience and knowledge, unless they have been given supervision or instruction concerning use of appliance by a person responsible for their safety.
- Children should be supervised to ensure they do not play with the appliance.

LIMITED WARRANTY

What Is Covered – This warranty covers any defects in materials or workmanship, with the exceptions stated below.

How Long Coverage Lasts – This warranty runs for one (1) year on this AeroGarden and six (6) months on the Grow Lights(s), from the date of original purchase, for the original purchaser/user.

What is Not Covered – The warranty shall not apply to problems arising from: normal wear; failure to adhere to enclosed operating instructions; serial numbered products if the serial number has been removed or defaced; products subject to negligence, accident, improper use, maintenance or storage; products damaged by circumstances beyond AeroGrow International Inc.'s control; loss or damage to removable parts; or products modified (including, but not limited to, modifications through the use of unauthorized parts or attachments) or repaired by anyone other than AeroGrow International, Inc., or its designee. This warranty excludes all incidental or consequential damages.

What AeroGrow Will Do – AeroGrow International, Inc., at its option, will repair any defects in materials or workmanship or will replace these products with ones of similar features and price. AeroGrow International, Inc.'s sole obligation and your exclusive remedy under this warranty shall be limited to such repair or replacement.

To Return This Product – If you have questions or concerns regarding your AeroGarden, please contact Customer Service at 1-800-476-9669. Please do not return any product without contacting AeroGrow for return authorization. Unauthorized returns, as well as C.O.D. shipments, will be refused. For more information regarding returns, please see the Customer Care section at www.AeroGarden.com.

Due to continuing improvements, actual product may differ slightly from the product described herein. Some states do not allow the exclusion or limitation of incidental or consequential damages, so the above limitation or exclusion may not apply to you. This warranty gives you specific legal rights, and you may have other legal rights that vary from state to state.

If you have any questions please feel free to contact our customer service representatives at 1-800-476-9669.

AeroGrow International, Inc., P.O. Box 18450, Boulder, CO 80308

NEED SUPPLIES, ACCESSORIES OR INFORMATION? Call: 1-800-476-9669 Visit Our Website: www.AeroGarden.com

U.S. CAUTION – You are cautioned that any changes or modifications not expressly approved in this manual could void your authority to operate this equipment.

To reduce the risk of electric shock, this furnishing has a polarized plug (one blade is wider than the other). This plug will fit in a polarized outlet only one way. If the plug does not fit fully in the outlet, reverse the plug. If it still does not fit, contact a qualified electrician to install the proper outlet. Do not change the plug in any way.

CAUTION: TO PREVENT ELECTRIC SHOCK, MATCH WIDE BLADE OF PLUG TO WIDE SLOT, FULLY INSERT.