



Unboxing



Getting started



Basics



Telephone



Message



Multimedia



Network



Bluetooth



Trouble Shooting



Specifications

You may find detailed warranty information at: www.prestigio.com/support/warranty-terms.

© Copyright 2017 Prestigio. All rights reserved.



Inside your package
Your phone at a glance

Unboxing

Congratulations on your purchase and welcome to Prestigio.
To get the most from your product and enjoy all that Prestigio has to offer, please visit:

www.prestigio.com/catalogue/Feature.Phones

More details about your product, please visit:

www.prestigio.com/support

Inside your package

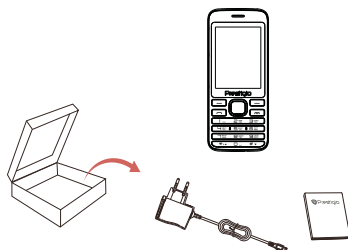

- Prestigio Cellular Phone
- Battery
- Legal and safety notices
- Charger with line
- Quick start guide
- Warranty card



Please read the "Legal and safety notices" in your package before use.

Your Phone

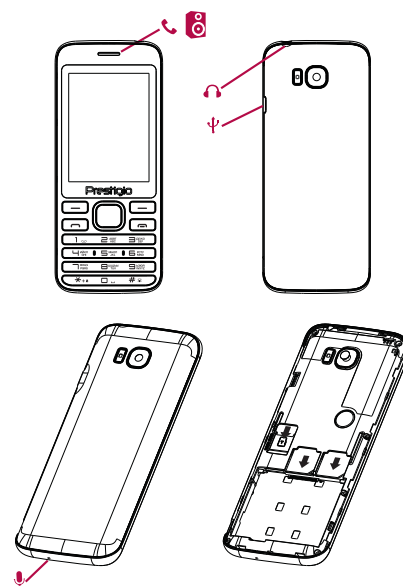



Installation
Home screen
List menu



Installation
Follow the steps below to prepare your phone for using.
Remember to turn off your device before inserting the cards.

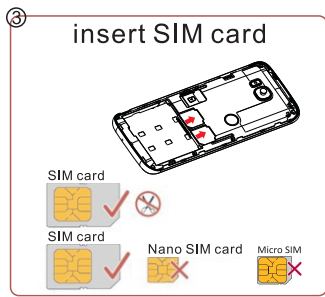
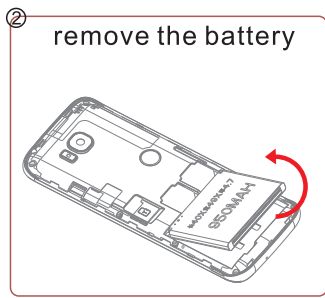
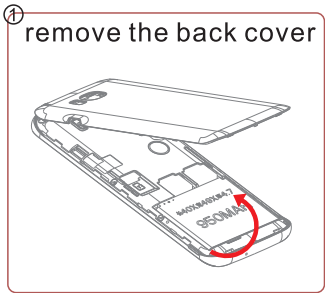

Installation
Home screen
List menu

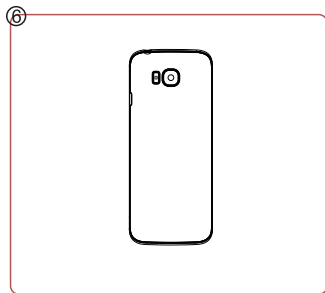
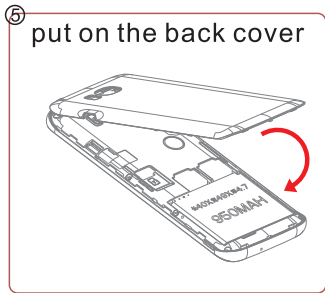
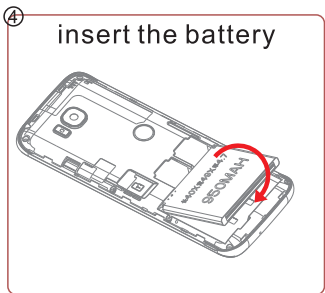

Please insert available Subscriber Identity Module (SIM) card into your phone before using it. SIM card is supplied by your network carrier. All the information related to network connection is recorded on the SIM card, so are the contact information such as names, phone numbers and SMS that you set to store on the SIM. You can take out the SIM card from the phone and insert it into another GSM phone to use it. Most new phones will recognize the SIM card automatically.



Installation
Home screen
List menu



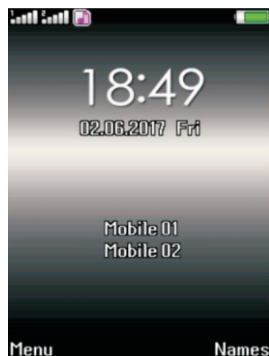

Home screen

Your Home screen is the starting point to access all of your phone features.



Buttons

The menu, home and back keys help you navigate your phone.

- Tap  to open the list menu.
- Tap  to return to the Home screen.
- Tap  to return to the previous screen.



www.prestigio.com



Charge the battery
Power on your phone
Connect your PC
lock and unlock the screen



Charging the battery

A new battery is partially charged. The battery icon at the upper-right corner shows the level of charging status.

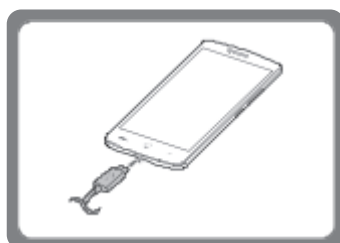

- Plug the small end of the charger into the micro USB port of the device, and plug the large end of the charger into an electric socket.
- After being fully charged, disconnect the device from the charger. First unplug the charger from the device, and then unplug it from the electric socket.



Always use authentic accessories to optimise your battery performance. Non-authentic accessories (eg. chargers) can damage your battery and even your phone.

Optimise your battery performance
Here are some tips to help you optimise your battery performance.

- Always ensure that your phone profile is appropriately set to meet your actual usage.
- If you are not using Bluetooth, Wi-Fi, GPS or other applications, turn them off.
- Adjust the intensity of your display screen's backlight to low or medium level and for the shortest duration.
- Avoid using or placing your phone near magnetic objects (eg. a radio or television) or on metal surfaces, which will impact the network connection and ultimately drain power from your battery.

www.prestigio.com



Charge the battery
Power on your phone
Connect your PC
lock and unlock the screen



Power on your phone

Press and hold the power button  for a few seconds to power on your phone.



To turn off your phone, press and hold the power button .

Connect to your PC

You may need to connect your phone to a PC in order to complete activation. Your phone's micro USB port allows you to exchange media and other files with a PC.

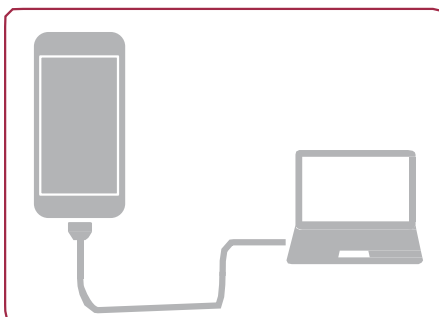

Lock and unlock the screen

When not in use, lock your phone to prevent unwanted operations and save the battery power.

Lock



Unlock

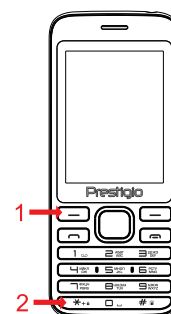

www.prestigio.com





Calls
Contacts
Contact groups





Learn to use calling functions, such as making and answering calls, using options available during a call or customising and using call-related features.

Calls

Make and end a call

- Enter the phone number, and then tap .
- Tap  to end a call.

Answer a call

When you receive a phone call from a contact, the incoming call screen appears. To pick up the phone, Slide  to .

Rejecting an incoming call

When a call comes in, press the power button or volume button to mute the ringing sound without rejecting the call.

Make an emergency call

In some regions, you can make emergency calls even if you do not have a SIM card installed or your SIM card has been blocked.

- Dial the emergency number for your location, and then tap .



If you are out of base station coverage, you will not be able to make an emergency call.



In Europe, the standard emergency number is 112; in the UK, it is 999.

Search for a contact

- Scroll up or down the contact list.
- Tap  and enter the first few letters of the name in the search bar.
- Select the contact from the option list.

Add a new contact

www.prestigio.com



Calls
Contacts
Contact groups



Method one:

- On the home screen or list menu, tap Phone.
- Tap to open the dial pad.
- Enter a number, tap Add to contacts.
- Add details as desired.
- Tap Done to finish and save.

Contacts

Contacts are stored in one of the two available phone books: SIM phone book (located on your SIM card) or the Smart phone book (located on your phone).

- To view your contacts, tap People on the home screen or list menu.

Import/Export contacts

- Go to People to view the contact list.
- Tap > Import/export.
- Select the contacts storage.
- Follow the prompts to finish.

Delete contacts

1. Go to People to view the contact list.
2. Tap > Delete contact.
3. Choose the contacts you wish to remove.
4. Tap OK to delete the contacts.

Contact groups

You can group your contacts as different groups. For different groups, you can use different identifications, and send messages to a group.

Add contacts to a group

1. Go to People to view the contact list.
2. Tap to view contact groups.
3. Tap to add contacts to a group.
4. Enter your group's name, and tap to add contacts.



Send a message
Check your message
Reply to a message
Forward or delete a message
Delete a conversation

Messages let you exchange text messages with other SMS and MMS devices via your cellular connection. Your sent and received messages are neatly grouped into conversations, by contact name or phone number.

Send a message

On the home screen or list menu, tap Messaging. And then tap Write message to start composing a new message.

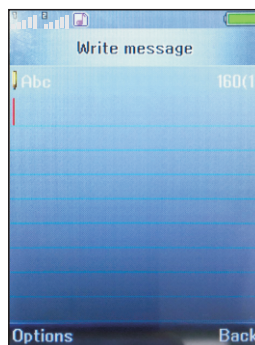

- Enter a phone number
- Add picture/character
- More options
- Add a recipient from your contacts list
- Send the message



There is a limit on the number of characters for a single text message (displayed above the send button). If you exceed the limit, your text message will be delivered as one but will be billed as more than one message.





Send a message

Check your message

Reply to a message

Forward or delete a message

Delete a conversation



Check your message

Depending on your notification settings, your phone plays a sound, vibrates, or displays the message briefly in the status bar when you receive a new message.

- On the home screen or list menu, tap Messaging. To check a message, tap a conversation.

Reply to a message

- On the messages screen, tap the conversation containing the message.
- In the text box, enter your message.
- Tap to send the message.

Forward or delete a message

- On the messages screen, tap the conversation containing the message.
- Tap and hold a message.
- In the pop-up window, select Forward or Delete.

Delete a conversation

1. On the home screen or list menu, tap Messaging to display the messages screen.
2. Tap and hold a contact or phone number.
3. Tap at the bottom of the screen.



Multimedia

Video player

Music player

FM radio

Sound recorder



Multimedia

Images

You can view the photos snapped with the camera through this function.

Video Recorder

- More options: You can switch to Camera mode; modify the Effect, Contrast, Brightness and others.
- Camcorder Settings: Set up the video recorder.

Audio player

You can enjoy the music with this function. You can use the following keys during the play.

- Press Left direction Key to switch to a previous song with cursor. Press Function key to go backwards
- Press Right direction Key to switch to a next song with cursor. Press Function key to go forwards
- Press OK Key to play/pause the Audio.
- Press Up 、 Down key to volume up and down.

Video Player

You can play the video with this function. You can use the following keys during the play.



- Press Left key to go backwards. Press and hold to continuously go backwards.
- Press Right key to go forwards. Press and hold to continuously go forwards.
- Press OK Key to play/pause the video.
- Press Up、 Down key to volume up and down.



Multimedia
Video player
Music player
FM radio
Sound recorder



FM radio

You can listen the FM radio  with this phone, also you can record the FM radio station which do you want record.

- Auto search and save: Search and save the channels.
- Channel List: Play, edit or delete the saved channels.
- Save: Save current playing frequency into channel list.
- Manual search: Search the radio by manual.
- Open speaker  : Playing FM in loudspeaker mode. (It active when headset inserted only)
- Background play: Return the standby interface and keep paying FM radio.
- Record: Record the currently-hearing FM.
- Timing record: You can set up that the FM (one channel which you selected) will record at a specific time with this function.
- Record file List: View the recorded files list.
- Help: You can get the operation guide in here.

Sound Recorder

You can take a recorder  in this function. After record, access Options:

- Start recording: Select this option to record the sound.
- Record file List: View the currently-selected sound files.
- File format: You can choose the format (AMR, or WAV) for record file.

www.prestigio.com



Network



Network

Connections

- Network account: choice the network settings for data account before you want to use internet.
- GPRS Service: Enable/disable the GPRS network .
- Data connection settings: You can control the internet access as "always connect" or "Connect when needed".
- Network selection: choice the modes of searching the phone network, including Auto and Manual modes.

www.prestigio.com



Pair with a Bluetooth device
Receive data via Bluetooth
Send data via Bluetooth

Your phone can connect to a compatible Bluetooth device for exchanging data. Bluetooth creates a direct wireless connection between two devices over short distances.

Pair with a Bluetooth device

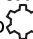
- Go to  Settings > Bluetooth.
- Make sure Bluetooth is switched to On.
- A list of available Bluetooth devices will appear.
- Tap the device you wish to connect with.
- The pairing is made if your pairing request is accepted by the other device.

Receive data via Bluetooth

- Make sure Bluetooth is switched to On.
- Tap your phone model to make it visible to all nearby Bluetooth devices.
- Accept the request and pair with the other Bluetooth device(s).
- Slide to open notifications panel, tap Accept.



The files received via Bluetooth are stored in the Bluetooth folder.



www.prestigio.com



The phone does not switch on

The phone does not switch on
Remove/reinstall the battery. Then charge the phone until the battery icon stops scrolling. Unplug the charger and try to switch the phone on.

The display shows IMSI failure
This problem is related to your subscription.
Contact your operator.

The network symbol is not displayed
The network connection is lost. Either you are in a radio shadow (in a tunnel or between tall buildings) or you are outside the network coverage area. Try from another place, try to reconnect to the network (especially when abroad), or contact your network operator for assistance/information.

The touch screen responds slowly or improperly
If your device has a touch screen and the touch screen is not responding properly, try the following:

- Remove any protective covers from the touch screen. Protective covers may prevent the device from recognizing your inputs and are not recommended for touch screen devices.
- Ensure that your hands are clean and dry when tapping the touch screen.
- Restart your device to clear any temporary

software bugs. Ensure that your device software is upgraded to the latest version. If the touch screen is scratched or damaged, take it to your local dealer

Your battery seems to over heat You might be using a charger that was not intended for use with your phone. Make sure you always use the authentic accessory shipped with your phone. You can not send text

messages
Some networks do not allow message exchanges with other networks. First check that you have entered the number of your SMS centre, or contact your operator for detailed information on this subject.

You feel that you have missed some calls
Check your call divert options.

The display shows SIM failure
Check that the SIM card has been inserted correctly. If the problem persists, your SIM card may be damaged. Contact your operator.



www.prestigio.com



The phone does not switch on

Your phone is not charging
If the battery is completely flat, it might take several minutes of precharge (up to 5 minutes in some cases) before the charging icon is displayed on the screen.

The picture captured with the phone camera is not clear
Make sure that the camera lens on both sides is clean.

Your device freezes or has fatal errors
If your device freezes or hangs, you may need to close programs or reset the device to regain functionality. If your device is frozen and unresponsive, remove the battery and try to switch the phone on. The device reboots automatically. If this does not solve the problem, perform a factory data reset. On the list menu, tap Settings>Backup & reset > Factory data reset .

Others cannot hear you speaking on a call

- Ensure that you are not covering the built-in microphone.
- Ensure that the microphone is close to your mouth.
- If using a headset, ensure that it is properly connected.

Another Bluetooth device is not located

- Ensure that the Bluetooth wireless feature is activated on your device.
- Ensure that the Bluetooth wireless feature is activated on the device you wish to connect to, if necessary.
- Ensure that your device and the other Bluetooth device are within the maximum Bluetooth range (10m).



Specifications

Specifications

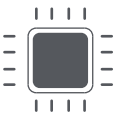

MT 6261D



32 MB



Micro SD Card
up to 32 GB



2.8"inch, 240*320



Bluetooth 2.1



950 mAh



136.6*58*8.5mm(H*W*D)



102 g (approx.)

