

Welcome!

This is your Quick Start Guide

PMN: Safelet

FVIN: 108

HVIN: Indra201501



Contents of this package

- A** Installation
- B** Activate the alarm
- C** Adjust the Milanese strap band
- D** Safety Notice
 - I. Main Warning and tips
 - II. Equipment and Usage Warnings
 - III. Disclaimer
- E** Compliance Information
 - I. FCC Compliance Class 8
Digital Device
 - II. FCC Declaration of Conformity
 - III. Industry Canada Compliance/
Avis d'industrie Canada
 - IV. European Community

A Installation

CHARGE SAFELET

- 1 Charge your Safelet with the supplied magnetic charger cable. A blue LED light will lit up to indicate that Safelet is charging. The charging will take about two hours and after that your Safelet will be charged up to three months. Disconnect Safelet from the charger cable to continue with the installation

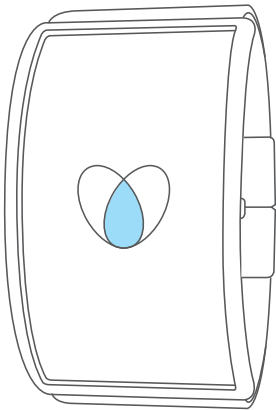

1

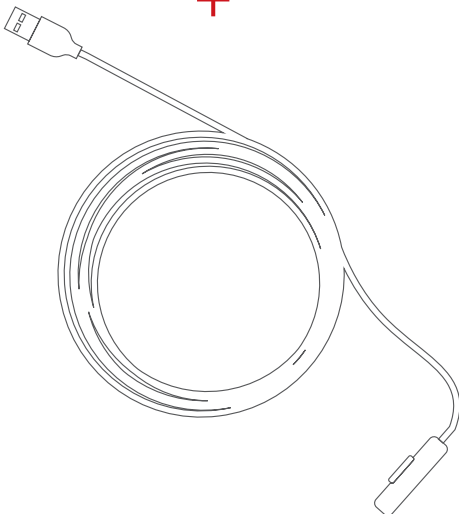

CREATE ACCOUNT

- 2 Install the Safelet App from the App Store or Google Play
- 3 Create an account
- 4 Fill in your name and phone number

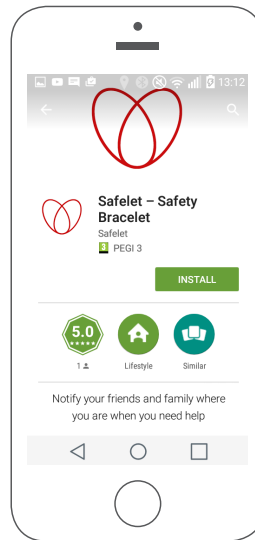

2

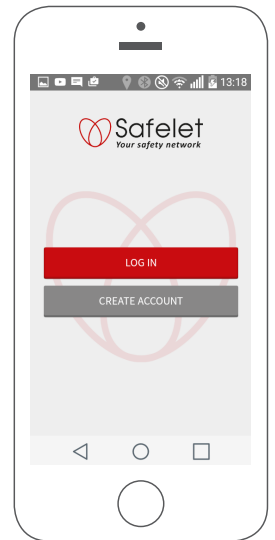

3

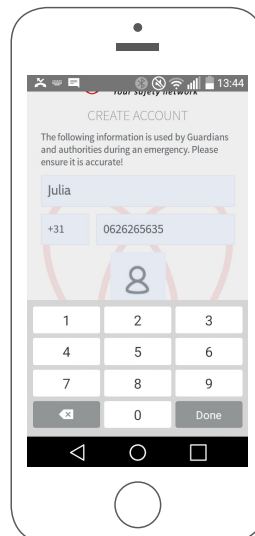

4

BUILD YOUR GUARDIAN NETWORK

- 5 The app will ask you if you want to be a Guardian yourself. Click 'Join' to receive alerts when someone that is within 250 meter of your location needs your help
- 6 You can now invite Guardians. By clicking on '+', the app will load the contact list of your phone
- 7 To see a list of your Guardians, go to 'My Connections' in the main menu of the app

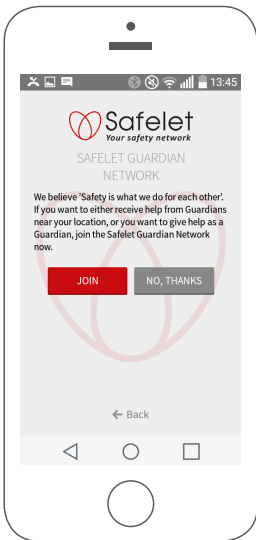

5

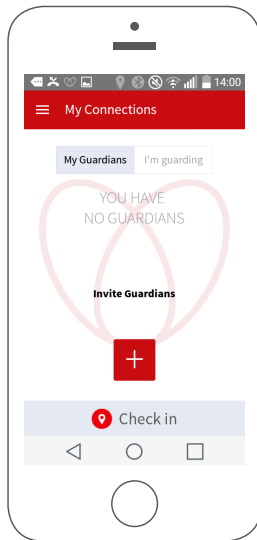

6

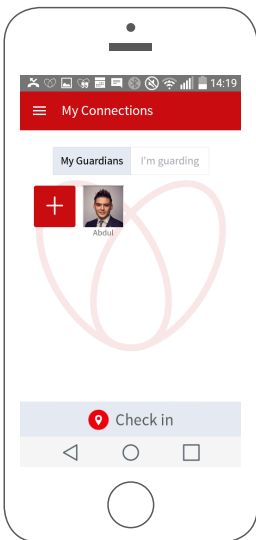

7

CONNECT SAFELET

- 8 Go to the main menu in the app and click on 'Connect Safelet'
- 9 A wizard will help you to establish a Bluetooth connection between Safelet and your smart phone

N.B. Make sure your Safelet is not being charged when establishing the connection
- 10 Safelet is ready.
You are now connected and protected

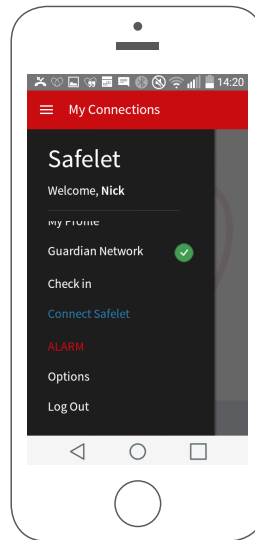

8

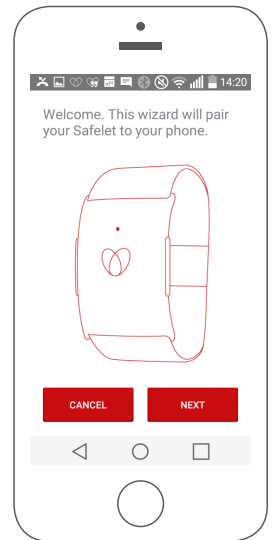

9

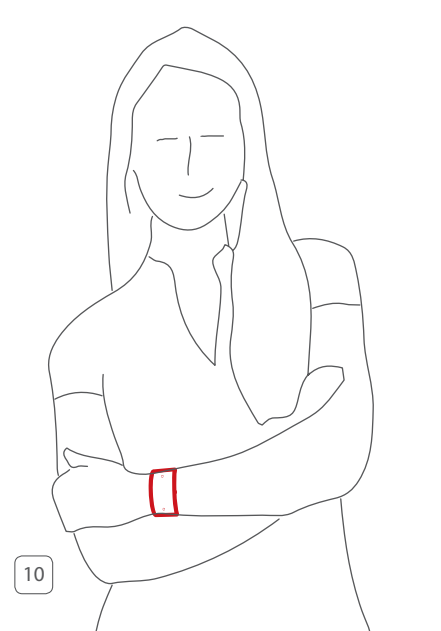

10

B Activating the alarm

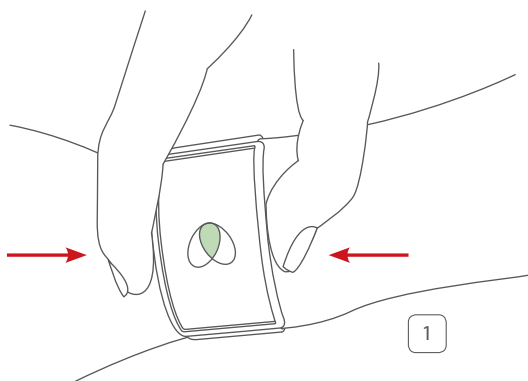

1 When you are in trouble, you can alert your Guardian Network by simultaneously clicking the two buttons on the side of your Safelet. A green LED light will lit up briefly to indicate that Safelet was activated

2 Your Guardian Network will receive a sound and text notification that you need their help

3 Your Guardian Network will see your location, hear what is happening and can notify the police with just one click. They can also let you and the other Guardians know that they are on their way towards your location

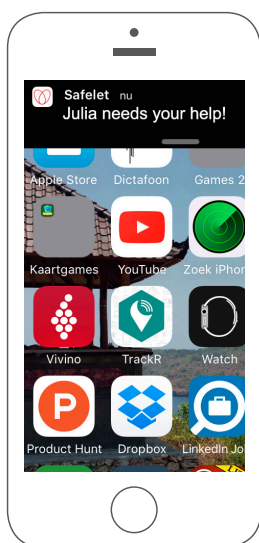

2

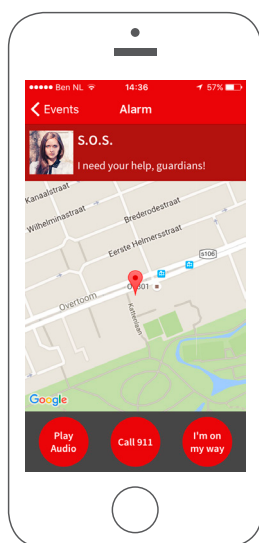

3

C How to adjust the Milanese strap band

1 Hold Safelet upside down and look for the little gap in the clap of the band

2 Gently place a small screw driver in the gap and lift the clap up like a lever

3 Move the clap up or down to make the strap band shorter or longer

4 When the strap band has the desired length, click down the clap

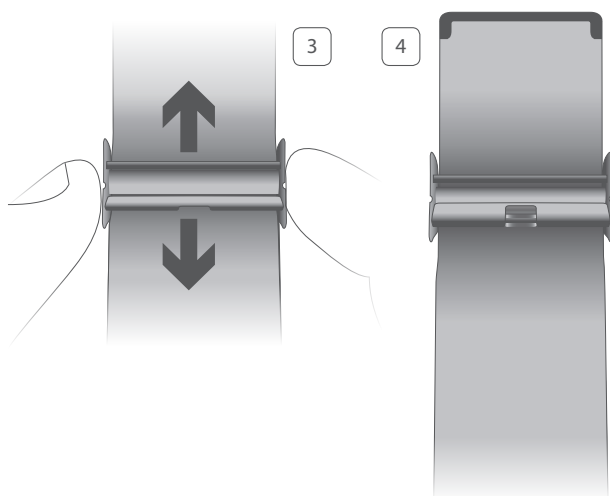
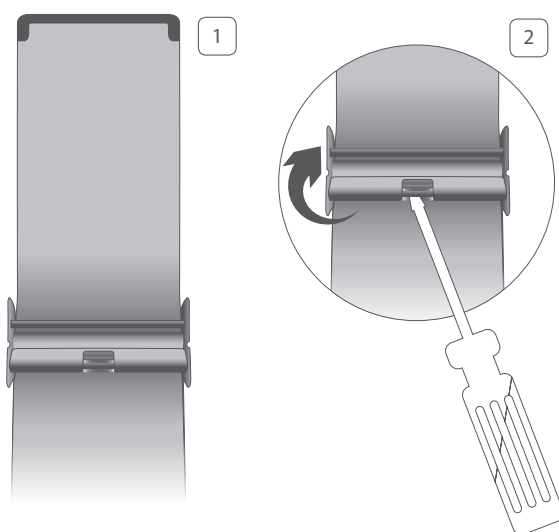

D Safety Notice

WARNING!!!

FAILURE TO READ AND FOLLOW THESE SAFETY WARNINGS MAY RESULT IN SERIOUS BODILY INJURY OR DEATH. PROPERTY DAMAGE MAY ALSO RESULT.

WARNING!!!

THIS IS NOT A LIFE-SAVING DEVICE!

D I. Main Warnings and Tips

- The Safelet bracelet is intended for ages 10+.
- The Safelet bracelet is not a life-saving device and is not a replacement for calling emergency services. In case of an emergency, you should always contact your local emergency services, if able. Only the Safelet+ model has the ability to contact emergency services, and such ability is not guaranteed.
- The Safelet bracelet works via a Bluetooth connection to a smartphone and the Safelet Mobile Application. The Safelet bracelet will not work if the corresponding Mobile Application has not been installed on a fully-charged device, such as a smart phone or tablet, within Bluetooth range of the Safelet bracelet and connect to data.
- When the Safelet bracelet alarm is activated, an alert is sent out to the personal Guardian Network as determined by the user. Think carefully about who to invite in this personal Guardian Network.

D II. Equipment and Usage Warnings

- The Safelet bracelet is a sensitive electronic product and can easily be damaged if dropped, burned, punctured or crushed, or if it comes into contact with liquid. Handle the Safelet bracelet with care. In the event a Safelet bracelet becomes damaged use should be immediately discontinued.
- Do not open a Safelet bracelet or try to repair it yourself. If your Safelet bracelet is damaged or malfunctions, contact Safelet BV at info@safelet.com.
- Do not attempt to replace or fix the Safelet bracelet battery yourself as it may cause overheating and/or injury. The lithium-ion battery in the Safelet bracelet should be replaced only by Safelet BV, and must be recycled or disposed of separately from household waste. Do not incinerate the battery.

D III. Assumption of the risk:

disclaimers of warranty and liability

ASSUMPTION OF THE RISK: You knowingly and voluntarily assume the risks of any environment and/or activity you place yourself in by your own free will and accord while using the Safelet bracelet and the Safelet Mobile Application. Always be aware of your surroundings and utilize common sense, even when wearing the Safelet bracelet and using the Safelet Mobile Application as the Safelet bracelet is not a replacement for emergency services and should not be treated as such. If an emergency situation occurs CONTACT EMERGENCY SERVICES IMMEDIATELY.

DISCLAIMERS OF USE: The Safelet bracelet is designed to be used exactly as described in detail on the Web site bearing the URL www.safelet.com and in any instructions you might receive with your Safelet bracelet. Safelet BV will not be responsible for any injury, death or other damages that may occur while using Safelet Bracelet and/or the Safelet Mobile Application in any way, shape, form, or fashion other than as instructed.

NO WARRANTIES: Unless otherwise expressly stated, no express or implied warranties of any type, including but not limited to implied warranties of merchantability or fitness for a particular purpose, are made regarding the Safelet bracelet. While Safelet BV intends for the Safelet product and Safelet Mobile Application to function as advertised their functioning may not always be uninterrupted or error-free. Therefore, any warranties that the Safelet bracelet shall function uninterrupted and error-free at any time, including but not limited to in emergency situations, are expressly disclaimed. Furthermore, Safelet BV does not make any warranties as to the results that may be obtained from the use of the Safelet bracelet and/or the Safelet Mobile Application.

LIMITATION OF LIABILITY: NEITHER SAFELET BV NOR OUR PARTNERS, PARENTS, SUBSIDIARIES, OFFICERS, DIRECTORS, AGENTS, EMPLOYEES, CONTRACTORS, AND AFFILIATES SHALL BE LIABLE TO YOU OR ANYONE ELSE FOR ANY LOSS OR DAMAGES WHATSOEVER ARISING FROM AND/OR RELATED TO THE USE OR MISUSE OF THE SAFELET BRACELET AND/OR THE SAFELET MOBILE APPLICATION, INCLUDING BUT NOT LIMITED TO ANY DIRECT, INDIRECT, SPECIAL, CONSEQUENTIAL, INCIDENTAL, PUNITIVE, OR OTHER DAMAGES, INCLUDING BUT NOT LIMITED TO PERSONAL INJURY, ALLERGIC REACTIONS, DEATH, PAIN AND SUFFERING, EMOTIONAL DISTRESS, PROPERTY DAMAGE, LOSS OF PROFITS, LOSS OF BUSINESS AND/OR ANTICIPATED SAVINGS, LOSS OF GOODWILL, LOSS OF DATA, AND/OR PROPERTY DAMAGE, WHETHER CAUSED BY TORT, BREACH OF CONTRACT OR OTHERWISE, EVEN IF FORESEEABLE.

THE USE OF THE SAFELET BRACELET AND SAFELET MOBILE APPLICATION MAY BE SUBJECT TO FURTHER DISCLAIMERS AND LIMITATIONS OF LIABILITY AS SET FORTH IN THE TERMS OF USE.

E Compliance Information

E I . FCC Compliance Class 8 Digital Device

This equipment has been tested and found to comply with the limits for a Class B digital device, pursuant to part 15 of the FCC Rules. These limits are designed to provide reasonable protection against harmful interference in a residential installation. This equipment generates uses and can radiate radio frequency energy and, if not installed and used in accordance with the instructions, may cause harmful interference to radio communications. However, there is no guarantee that interference will not occur in a particular installation. If this equipment does cause harmful interference to radio or television reception, which can be determined by turning the equipment off and on, the user is encouraged to try to correct the interference by one or more of the following measures:

- Reorient or relocate the receiving antenna.
- Increase the separation between the equipment and receiver.
- Connect the equipment into an outlet on a circuit different from that to which the receiver is connected.
- Consult the dealer or an experienced radio/TV technician for help.

Changes or modifications not expressly approved by the party responsible for compliance could void the user's authority to operate the equipment.

E II FCC Declaration of Conformity

This device complies with FCC standard CFR47 Part 15 subpart and subpart – section 15.247. Operation is subject to the following two conditions: (1) This device may not cause harmful interference, and (2) this device must accept any interference received, including interference that may cause undesired operation.

FCC ID:2AJA2SFLTPV1A

FCC Warning statements

Per 15.19: THIS DEVICE COMPLIES WITH PART 15 OF THE FCC RULES. OPERATION IS SUBJECT TO THE FOLLOWING TWO CONDITIONS: (1) THIS DEVICE MAY NOT CAUSE HARMFUL INTERFERENCE, AND (2) THIS DEVICE MUST ACCEPT ANY INTERFERENCE RECEIVED, INCLUDING INTERFERENCE THAT MAY CAUSE UNDESIRE OPERATION.

E III Industry Canada Statement/Avis d'industrie Canada

This device complies with Industry Canada license exempt RSS standard(s). Operation is subject to the following two conditions: (1) This device may not cause harmful interference, and (2) this device must accept any interference received, including interference that may cause undesired operation.

Cet appareil est conforme avec les normes de l'Industrie Canada sans les standards RSS (s). L'utilisation est soumise aux deux conditions suivantes: (1) cet appareil ne peut pas provoquer d'interférences et (2) cet appareil doit accepter toute interférence, y compris les interférences qui peuvent causer un mauvais fonctionnement de l'appareil.

FCC ID:2AJA2SFLTPV1A

IC:20716-SFLTPV1A

E IV European Community

Declaration of Conformity with Regard to the EU Directive 1999/5/EC

Safelet BV is authorized to apply the CE Mark on Safelet and Safelet + thereby declaring conformity to the essential requirements and other relevant provisions of Directive 1999/5/EC.



Compliant with the standard R&TTE 99/CE/05
Conforme à la norme R&TTE 99/CE/05

Declaration of Conformity

Product: Safelet
Model No. Indra

This is declares that the above-referenced product, to which this declaration relates, is in conformity with the provisions of:

- Council Directive 2014/30/EU on Electromagnetic Compatibility (EMC)
- Council Directive 1999/5/EC on Radio and Telecommunications Terminal Equipment

Conformity is shown by compliance with the applicable requirements of the following documents :

Reference &	Date Title
EN 300 328 V1.8.1 (2012-04)	Electromagnetic compatibility and Radio spectrum Matters
EN 301 489-17 V2.2.1 (2012-09)	Electromagnetic compatibility and Radio spectrum Matters (ERM); Wideband transmission systems; Data transmission equipment operating in the 2,4 GHz ISM band and using wide band modulation techniques; Harmonized EN covering the essential requirements of article 3.2 of the R&TTE Directive (ERM); ElectroMagnetic Compatibility (EMC) standard for radio equipment; Part 17: Specific conditions for Broadband Data Transmission Systems

Visit: www.safelet.com/support

E-mail: support@safelet.com