



 ORDERMAN® **Don**

User Guide

© 2001 by



Bachstraße 59,  
5023 Salzburg – Austria

[www.orderman.com](http://www.orderman.com)

Rights of modification reserved.  
Duplication of this guide or parts thereof is permitted only  
with a written agreement of think dig.

P3.45-247 V1.0

- |   |
|---|
| <ul style="list-style-type: none"><li>• think dig does not assume any liability or legal responsibility for omissions or errors in this guide.</li><li>• think dig does not assume any liability for any loss or claims of third persons, that are caused by the use of this guide.</li><li>• think dig reserves the right to make changes and improvements in this guide without prior notice.</li><li>• This guide can not be part of a contract.</li></ul> |
|---|

## Contents

<b>ORDERMAN DON overview .....</b>	<b>4</b>
Back view of ORDERMAN DON.....	5
<b>General</b>	
Parts included, warranty.....	6
<b>Correct handling</b>	
Safety precautions, care of the unit.....	7
<b>Battery use</b>	
Charging and exchanging.....	8
<b>Getting started.....</b>	<b>9</b>
<b>Setup-menu</b>	
Display-settings.....	10
Power-settings .....	10
Touch calibration .....	10
<b>Changing menu card.....</b>	<b>11</b>
<b>Technical data .....</b>	<b>12</b>
<b>Radio certification.....</b>	<b>13</b>
<b>CE- declaration of conformity .....</b>	<b>14</b>
<b>FAQs – frequently asked questions.....</b>	<b>15</b>

## ORDERMAN DON overview

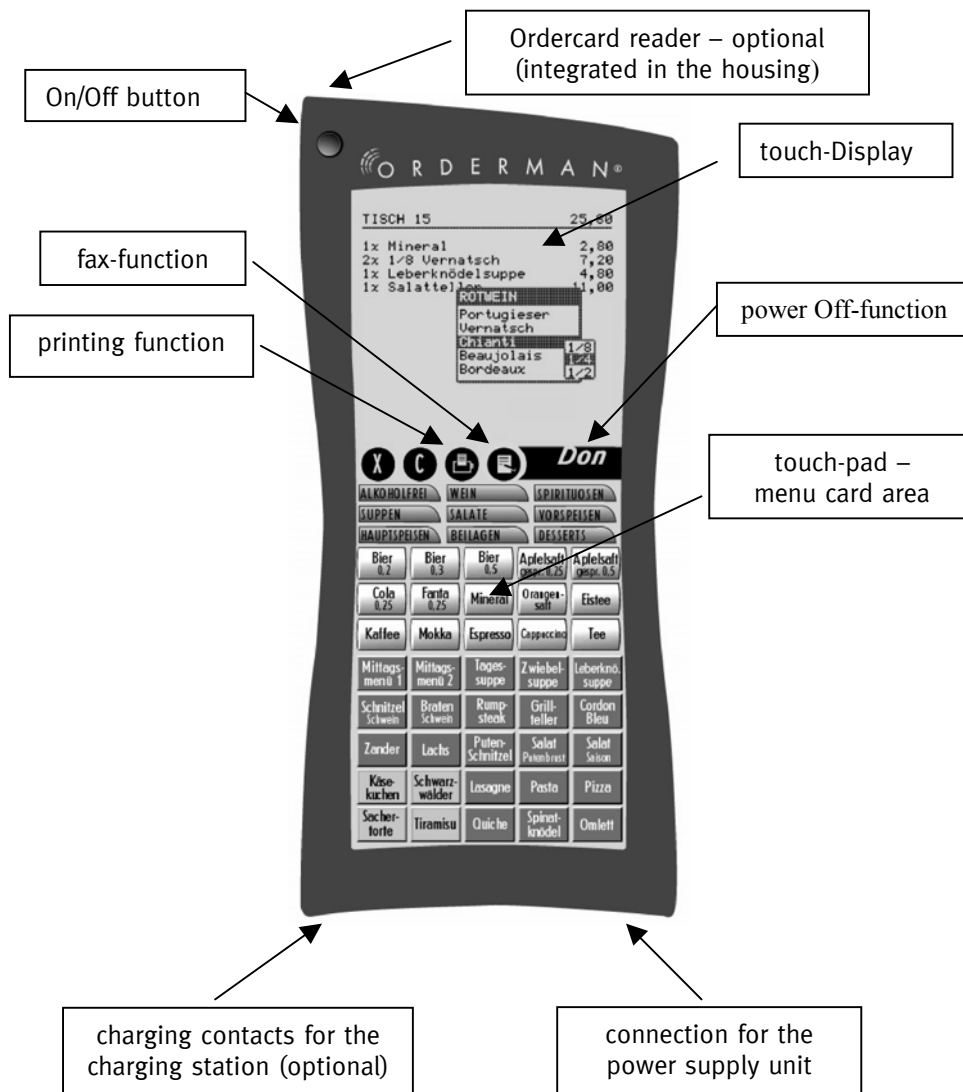

## Back view of ORDERMAN DON

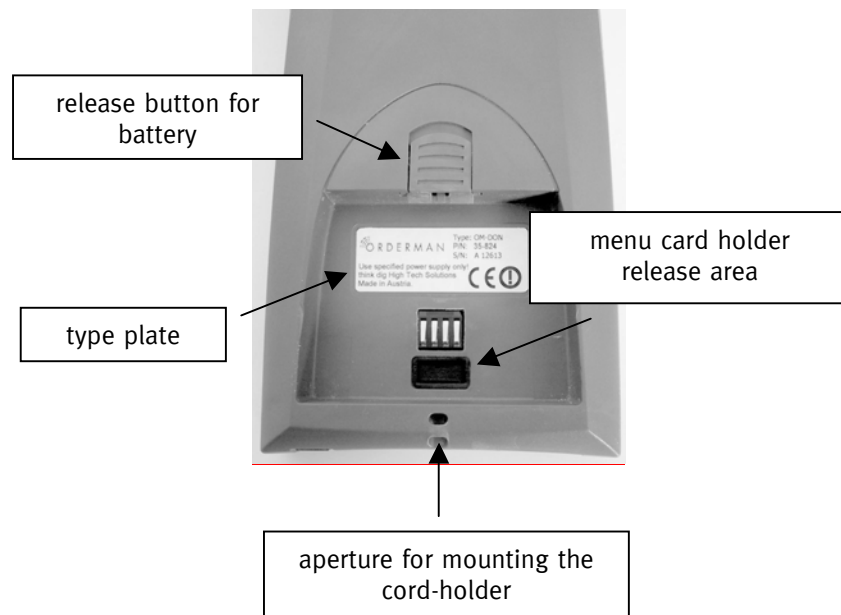

## General information

### ***Welcome to the world of ORDERMAN DON***

Think dig, the company, is among the top international developers and manufacturers of hand-held wireless terminals for the hospitality industry. By purchasing ORDERMAN DON you have acquired a quality product, that brings you future technology today. The use of this product will also bring your company many financial as well as operational advantages.

ORDERMAN DON has been specially developed for the hospitality industry. As an electronic wireless order-pad, it is part of the hardware of your EPOS solution. This manual describes the operation of ORDERMAN DON. Software functions are described in the user manual of your EPOS system.

### ***Parts included***

With your ORDERMAN DON, you will have received a power supply unit, a rechargeable battery (accumulator), a touch-pen and this user guide.

### ***Warranty***

Repairs should be carried out by your ORDERMAN dealer. The warranty is annulled, if the unit is opened.

## Correct handling

### *Safety precautions*

ORDERMAN DON should be used only with an ORDERMAN DON battery resp. with an ORDERMAN DON power supply unit and with the entry pen of the ORDERMAN DON touch pen.

ORDERMAN DON should never be exposed to rain, hail or snow.

If the unit gets damaged, it must be checked by your ORDERMAN dealer for possible defects.

The touch-area of the unit is made of glass, and should therefore be treated carefully.

Never short-circuit the battery and the charging contact surfaces.  
Never expose the battery to open fire – danger of explosion !

Even if tests have proved, that ORDERMAN DON can survive falls of approx. 1 m and still be in working condition with only the case damaged, please treat the unit with the appropriate care.

For the operation of the unit do not use a fountain pen, a pencil or other sharp pens. The surface of the touch-area can get scratched. Use only the entry pen of the ORDERMAN DON touch pen.

### *Care*

Clean ORDERMAN DON with a soft, clean cloth. Never use detergents, chemicals or compressed air to remove dust.  
Be careful, that the battery and the charging contact surfaces do not get dirty. This can prolong the charging time of the battery.

## Battery use

### ***Charging***

Connect the original power supply unit to the underside of the ORDERMAN DON (see also page 4). The charging procedure of the battery (accumulator) inside the unit is shown by the filling battery symbol. A complete charging procedure takes about 4 hours.

The unit can be used during this charging operation.

You may also charge the battery separately from the unit, using the ORDERMAN DON charging station (optional). This charging process takes about 60 minutes.

The operation time with a fully charged battery is about 6 to 16 hours (depending on the use of the backlight).

### **Exchanging the battery:**

After pressing the unlock button (see page 5), the battery rises, and can be easily taken out of the ORDERMAN DON.

When replacing it again, push the battery into the unit until the unlock button fixes it firmly in place.

The battery can be recharged more than 1000 times.  
You can also use a battery with an integrated vibra call (for waiter calling/paging).

Display Indicator for battery level:

While working with the handheld, you can get an information of the battery level (percentage indication), by pressing the battery sign.



## Getting started

To start the operation with ORDERMAN DON, insert the battery and press the On/Off-Button.

Before the first operation, it is advisable to do a complete charge of the battery (see page 8).

After having switched on the unit for the first time, you get the information of the version of the operating system.

By pressing the touch, you arrive at the main menu:

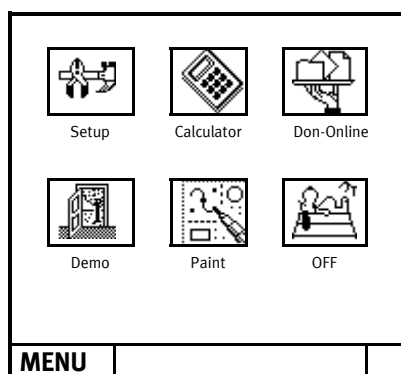

In the setup menu you can change the basic settings of the display, of the touch and of the power consumption of the unit (see also page 10).

In this menu, you can also start the calculator, or go directly to the operation mode of ORDERMAN DON by pressing the button **Don-Online**.

To switch off the unit, you can use the On/Off-Button, the power off function (see page 4) or the automatic-power-off- function (see also page 10).

## SETUP– Menu

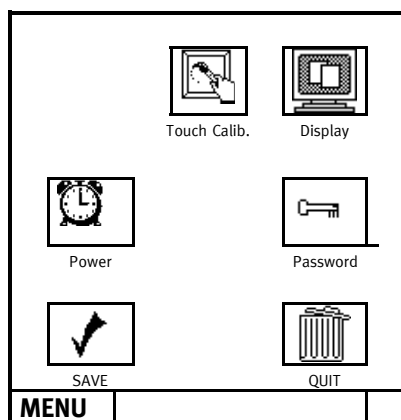

In the menu **Setup**, you can do the touch-calibration in the sub-menu **Touch-Calib.** (see also the following description).

In the sub-menu **Display** you can change the contrast of the display.

The refresh-rate with 81 Hz is a standard setting.

In the sub-menu **Power** you can change the automatic-power-off-time for the backlight and also for the unit.

**For the confirmation of the changing of all the settings, you have to press the SAVE-button !**

The sub-menu **Password...** contains specific settings, which are carried out by your Orderman dealer.

### Touch - calibration:

By pressing the menu-button **Touch Calib.** or by pressing the On/Off-button and the touch at the same time, until the information Calibrate... is shown on the display, you reach the calibration sub-menu, where you can do the touch-calibration with the entry pen of your ORDERMAN DON touch pen.

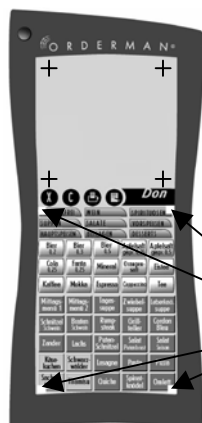

The calibration begins in the display-area, where you have to press one after another of the four reticules, that are shown on the display. After this, you have to press on the four points in the menu-card-area, that are printed on your menu card.

Every calibration point, that you have to press, is described on the display.

**ATTENTION:** For successful calibration, you have to press each calibration point.

To fix the new calibration, you have to press the SAVE-button.

Calibration points (printed circles on the menu card).

## Change of the ORDERMAN DON menu card

The changing of the ORDERMAN DON menu card has to be done in a clean and dry place.

Switch off the unit and take out the battery.

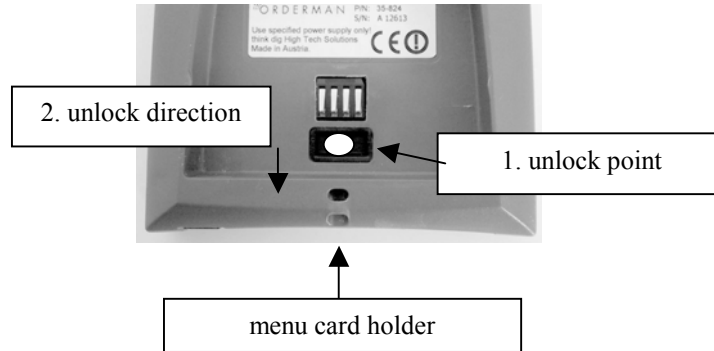

With the end of the entry pen of your ORDERMAN DON touch pen you have to press on to the unlock point. With a simultaneous motion in the unlock-direction, the menu card holder comes out of the housing and can be taken out of the unit. After this, the menu card can be slipped out.

The new menu card has to be inserted fully, gently pushing as far as it will go.

After inserting the menu card holder (once it is locked in the housing again), and after inserting the battery again, you can switch on the unit and start the operations again.

**Attention:** For this unlocking procedure, you must only use the entry pen of your ORDERMAN DON touch pen. Other sharp pens can damage the unlocking area. A new menu card has also to be identified by the unit.

## Technical data

frequency range	902.100 MHz -905.000 MHz
operating frequency range	902.100 MHz -905.000 MHz
radio capacity	lower than 1mW
data transmission	bi-directional, licence free operation
range	indoors: up to 50m outdoors: up to 300m indoor area coverage: up to 7800 sq.m
power supply:	battery (accumulator): lithium-Ion technology, 3.6V, 750mAh or Power supply unit: 7.5V, 800mA
Power supply unit:	
- input voltage	220V-240V
- max. power capacity	84mA/19,4VA
housing dimensions	179 (H) x 81 (B) x 22 (D) mm
operational period with fully charged battery	up to 16 hours (depending on the use of the backlight)
charging time for battery	with power supply unit of ORDERMAN DON: 4 hours with charging station ORDERMAN DON: 60 minutes
weight	handheld device 195 g battery 40 g
splash-proof	IP 64
operating temperature	-5°C to +50°C
storage temperature	-10°C to +60°C



## Radio certification

**SENTON**

### CERTIFICATE

**Testing to European Telecommunication Standards  
specified in Test Report No. 55416-10128**

<b>EUT:</b>	Orderman Don
<b>Applicant:</b>	think dig High Tech Solutions GmbH
<b>Regulations:</b>	EN 300 220-1 (September 2000) EN 300 220-3 (September 2000) EN 301 489-03 V1.2.1 (August 2000)

**Test result:**

The tested sample is in compliance with the EMC requirements/technical characteristics for radk equipment and systems based on the standard(s) mentioned above.

The appropriate test results are collected in test report no. 55416-10128.

Regarding the Electro-Magnetic Compatibility (EMC) the following severity levels have been achieved:

<b>RFI-Emissions:</b>	Limit Class B according to EN 55022
<b>Immunity:</b>	RF Electromagnetic Field according to EN 61000-4-3:1996 80 MHz - 1000 MHz: 3 V/m, AM 80 %, 400 Hz Electrostatic Discharge according to EN 61000-4-2:1995 Air discharge: 8 kV; contact discharge: 4 kV Electrical Fast Transients (Burst) according to EN 61000-4-4:1995 DC power input/output port: 1 kV Signal/control port: 1 kV RF Common Mode according to EN 61000-4-6:1996 150 kHz - 80 MHz: 3 V rms, AM 80 %, 400 Hz Voltage Dips and Interruptions according to IEC 1000-4-11:1994 Reduction of 30 % of $U_N$ for 10 ms, of 60 % of $U_N$ for 100 ms, voltage interruption for 5000 ms Surges, Common and Differential Mode according to ENV 50142:1994 True common mode (lines-to-ground): 1 kV Differential mode (line-to-line): 0.5 kV

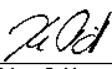
  
 Johann Roidt  
 Senton GmbH

March 14, 2001  
 Date



DAR-Registration No. TT1-P-G 062/94-40

SENTON GmbH - EMV-Prüfzentrum - Äußere Frühlingsstraße 46 - D-94315 Straubing - Tel. 09421/66 22-0

## Declaration of conformity



### Declaration of Conformity

In accordance with EC Directive

- R&TTE Directive 1999/5/EC Radio and Telecommunications Terminal Equipment
- Elektromagnetic Compatibility 89/336/EEG amended by 93/31/EEG

#### The Device ORDERMAN® OM-DON

Is developed, designed and manufactured in accordance with the above mentioned EC – guideline under the sole responsibility of

Fa. think dig High Tech Solutions GmbH, Bachstrasse 59, A – 5023 Salzburg

#### The following harmonized standards were applied:

ETS 300 220	Part 1, 3 :Technical characteristics and test methods for radio equipment to be used in the 25 to 1000Mhz frequency range with power levels ranging up to 500 mW
EN 301 489-03	Electromagnetic Compatibility and Radio spectrum matters (ERM) Electromagnetic Compatibility (EMC) standard for radio equipment and services; Part 3 : specific conditions for Short Range Devices (SRD) operating on frequencies between 9kHz and 40GHz
EN 60950	Safety of information technology equipment including electric office machines

#### Notified Body for Type Examination Certificate:

SENTON GmbH EMI/EMC Testcenter  
Äußere Frühlingsstrasse 45  
D 94315 Straubing

Salzburg, 5.3.2001      Klaus Strasser      R&D Manager

Locality -Date	name	position	signature
Salzburg, 5.3.2001	Klaus Strasser	R&D Manager	

This Declaration certifies the accordance with the mentioned directives .It does not guarantee any specific characteristics of the product.

## FAQs – frequently asked questions

- ***Touch misfunction – bad calibration:***  
By pressing the On-button several times, you arrive at the touch-calibration menu, where you can do a new calibration (see also page 10).
  
- ***Selected button does not correspond with the description on the display:***
  - the touch calibration is inaccurate and has to be reset (see also page 10)
  - the menu card is not in a right position in the unit, and has to be inserted once more (see also page 11)
  - there is a wrong menu card in the unit. Be sure, that the right menu card is in the unit. If you have changed the menu card, the new one has to be identified by the unit (contact also your responsible Orderman dealer).
  
- ***The software functionality operates incorrectly:***  
Contact your Orderman dealer or refer to the software user manual.
  
- ***ORDERMAN DON can not be switched on:***  
The Battery is missing or has to be recharged with the power supply unit or placed in the charging station (optional).
  
- ***ORDERMAN DON breaks down:***
  - A possible short circuit on the charging contacts (position see page 4) has to be removed.
  - The automatic power-off function has turned off the unit (see also settings on page 10).

***For other problems contact your Orderman dealer !***